



WELCOME NORTH MINES LTD.
1027 - 470 Granville St., Vancouver, B.C. V6C 1V5 • Telephone (604) 687-1658

PHYSICAL WORK, GEOCHEMICAL
SURVEY AND PROSPECTING
FOR THE

EUREAKA - ORA CLAIMS

SLOCAN MINING DIVISION
N.T.S. 82K/4 EAST

Latitude 50°02'

Longitude 117°40'

By Owner-Operator Ralph Allen

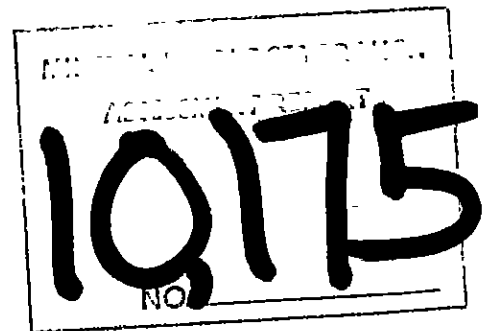

Nakusp, B.C.

January 6, 1982

TABLE OF CONTENTS

	Page
INTRODUCTION	
General Geology	1
History	1
Topography	1
PROPERTY DESCRIPTION	
Location and Access	1
Claims Inventory	2
WORK PROGRAM DESCRIPTION	
Introduction	2
Geology of Claims	2
Physical Work	3
Geochemical Surveys	3
Prospecting Report	4
STATEMENT OF COSTS	5
PLATES and FIGURES:	
PLATE NO. 1 - GEOLOGY	In Pocket
FIGURE NO. 1 - SAMPLE NUMBERS	In Pocket
FIGURE NO. 2 - Ag GEOCHEMISTRY	In Pocket
FIGURE NO. 3 - GEOCHEMISTRY - Pb, Zn, Ag, Au	In Pocket
FIGURE NO. 4 - Zn GEOCHEMISTRY	In Pocket
FIGURE NO. 5 - Pb GEOCHEMISTRY	In Pocket

INTRODUCTION

GENERAL GEOLOGY

The south portion of the claim is underlain by biotite quartz diorite of the lower cretaceous Goat Canyon Halifax Creek stock. The northern portion consists of Lower Jurassic Slocan Group and Upper Paleozoic Group quartzite, argillite and greenstone.

HISTORY

Reports from B.C.D.M from on the EUREAKA property are quite inconsequential. However, reports by word of mouth from a local prospector inferred that reasonable assays can be obtained and that the property deserved a closer look. The original EUREKA (now EUREAKA) workings were developed on a prominent graphitic shear zone which will be covered in more detail in the Geology of Claims portion of this report.

TOPOGRAPHY

These claims cover the very grown-in and steep south slope of Caribou Creek valley. Elevations are from approximately 1,100 m at Caribou Creek to 1,800 m at the L.C.P.

PROPERTY DESCRIPTION

LOCATION AND ACCESS

The EUREAKA and ORA Claims are situated in the south side of Caribou Creek approximately 12 km from Burton, BC.

Access is from Hills Siding on Highway 6, via Shannon Creek forest access road. This route follows over the height of land into the Caribou Creek watershed, to the last switchback on the south side of Caribou Creek about

LOCATION AND ACCESS (cont'd.)

300 m before the second bridge crossing of Caribou Creek. From this point, a 1,500 metre access trail which was flagged and cut, leads across a steep hillside to the middle Showing near the center of the EUREAKA Claims.

CLAIMS INVENTORY

<u>CLAIM NAME</u>	<u>RECORD NO.</u>	<u>NO. OF UNITS</u>	<u>STAKING DATE</u>	<u>EXPIRY DATE</u>
EUREAKA	1781	6 modified grid	Jan. 27, 1980	Feb. 26, 1984
ORA	2434	6 modified grid	Jan. 28, 1981	Feb. 25, 1982

WORK PROGRAM DESCRIPTION

INTRODUCTION

Assessment was carried out on the EUREAKA and ORA Claims between May 1, 1981 and October 31, 1981. The program consisted of nine trips to the property from Nakusp. Eighty-five man hours were spent cutting 2.3 km of access trails, 2,795 metres of geochemical grid lines, collecting 111 geochemical soil and silt samples and prospecting approximately 2.5 hectares.

GEOLOGY OF CLAIMS

The area under consideration is underlain on the south by quartz-diorite of the Halifax Creek stock. Two dominated sets of fractures were noted; some which are quartz-filled with widths to 70 cm.

Set No. 1 Strike 280° DIP S.W. 15°

Set. No. 2 Strike 355° DIP E 80°

At the north end of the claim block, small scattered outcrops of upper Mississippian to Permian Milford Group meta-sedimentary rocks dominantly argillites, previously thought to be small roof pendants have been found to have some continuity and trend. Vague bands of quartzite, argillite and andesite trend north-south and vary between 20 and 80 metres in width.

GEOLOGY OF CLAIMS (cont'd.)

The Main EUREAKA Showing outcrops in a steep gully as a graphitic shear zone. The shear zone marks the contact between greenish meta-volcanics to the east and rusty-weathering black argillites to the west.

In 1934, three adits were driven into the shear zone at respective elevations of 1,248 m, 1,303 m and 1,324 m. The lower Adit #1 was not noted. Adit #2 was collared in the west bank of Eureka Creek and driven southeast under the creek to intersect the shear zone. The portal of Adit #3 has caved and is filled by creek bed. Here, a 3.5 m wide graphitic shear zone is exposed on the west bank of the creek. The shear zone contains brecciated white quartz vein fragments carrying significant amounts of galena.

The EUREAKA shear zone is strikingly similar to the CHIEFTAIN shear zone 2 km to the west, and also to the MILLIE MACK Mine of David Minerals.

PHYSICAL WORK

In the 1981 exploration season, between May 1 and October 31, 2.3 km of access trails were cut over the EUREAKA Claim to approximately the middle of the ORA Claim.

GEOCHEMICAL SURVEYS

The first soil sampling traverse coded A16-6, #1-19 commenced approximately 75 metres west of the middle or #2 adit and continued south at 25 m intervals for 225 m, then turned east and crossed Eureka Creek and continued for 50 m. The remainder of the line went north again, ending on the east side of the middle or #2 adit. These samples were analyzed for Ag, Pb and Zn.

GEOCHEMICAL SURVEYS (cont'd.)

The third soil sampling traverse, coded as A21-08, consisted of 76 samples placed at 20 m spacings on a grid just west of adit #2 and beginning at the access trail and going south.

This grid was established to follow up on high silver values received on traverse A16-6, #1-19. The samples from this grid were analyzed for Ag and Au. The results of these traverses are plotted on maps in the rear folder of this report.

PROSPECTING REPORT

In prospecting the ORA and southern part of the EUREKA Claims, only one new quartz vein was found. This vein is well marked with ribbons and is situated approximately 420 metres south and 80 metres east of adit #2. The vein contains some minor iron sulphides in a bluish quartz matrix, but did not yield any significant values.

STATEMENT OF COSTS

Assays and Geochemical Analysis:

111 samples @ \$6.53 per sample \$ 725.70

Camp Maintenance:

9 days @ \$25/day board 225.00

Maps, Printing, Drafting:

Contract Drafting - 10 hours @ \$18.00/hour \$ 180.00
Typing, copying, secretarial -
3 hours @ \$15.00/hour 45.00 225.00

Rotary Wing:

Terr-Air - July 29, 0.5 hours - - - \$ 226.00
July 26, 0.5 hours - 226.00 452.00

Salaries:

Ralph Allen - 9 days @ \$104.00/day \$ 936.00
W.J. Crawford - 2 days @ \$125/day 250.00
J. Brock - 1 day @ \$250.00/day 250.00 1,436.00

Transportation:

Truck Rental - 9 days @ \$12.22/day 109.98

Administration:

\$3,173.68 x 10% 317.00

\$ 3,490.68
=====

STATEMENT OF QUALIFICATIONS

I, RALPH E. ALLEN, of Box 657, Nakusp, British Columbia, do certify that:

- 1) I am presently active in the mining industry as a prospector.
- 2) In the 1979 field season I learned the fundamentals of geology while in the employ of BRENDA MINES LTD. My duties were:
 - 1) grid establishment and linecutting;
 - 2) geochemical sampling;
 - 3) reconnaissance geological mapping;
 - 4) reconnaissance prospecting
- 3) In January, 1981, I completed a rock and mineral identification course given by Georgie Adie, Resident Government Geologist, from Nelson.
- 4) From May 1, 1981 to October 31, 1981, I was employed by WELCOME NORTH MINES LTD. as a prospector.

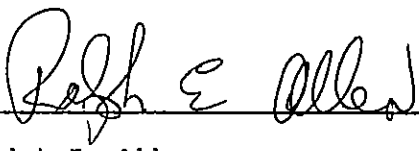

Ralph E. Allen
Prospector

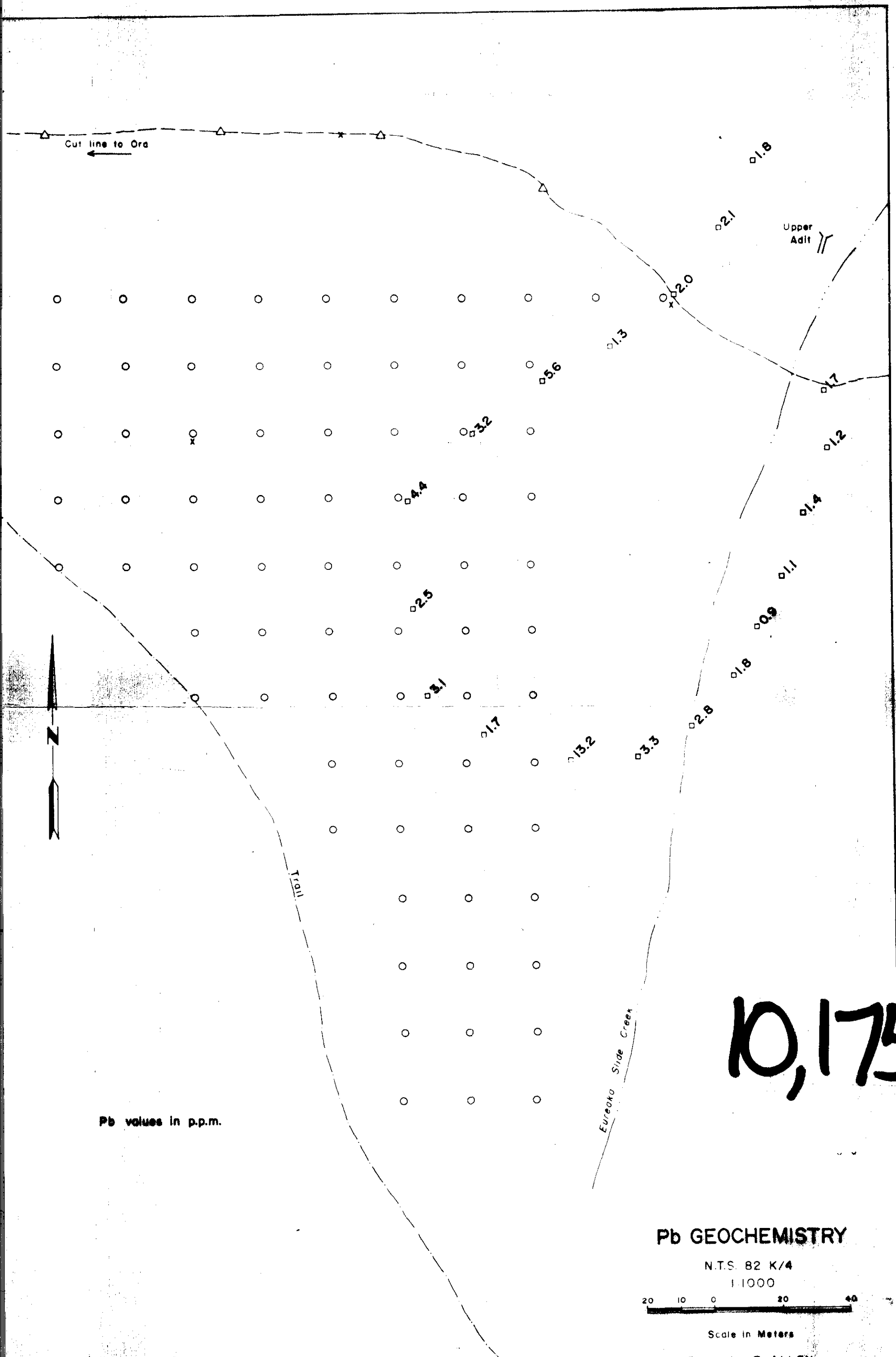

10,175

Pb GEOCHEMISTRY

N.T.S. 82 K/4
1:1000

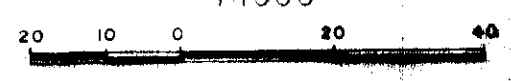

Scale in Meters

Drawn by: R. ALLEN

AUGUST, 1981

FIGURE 5

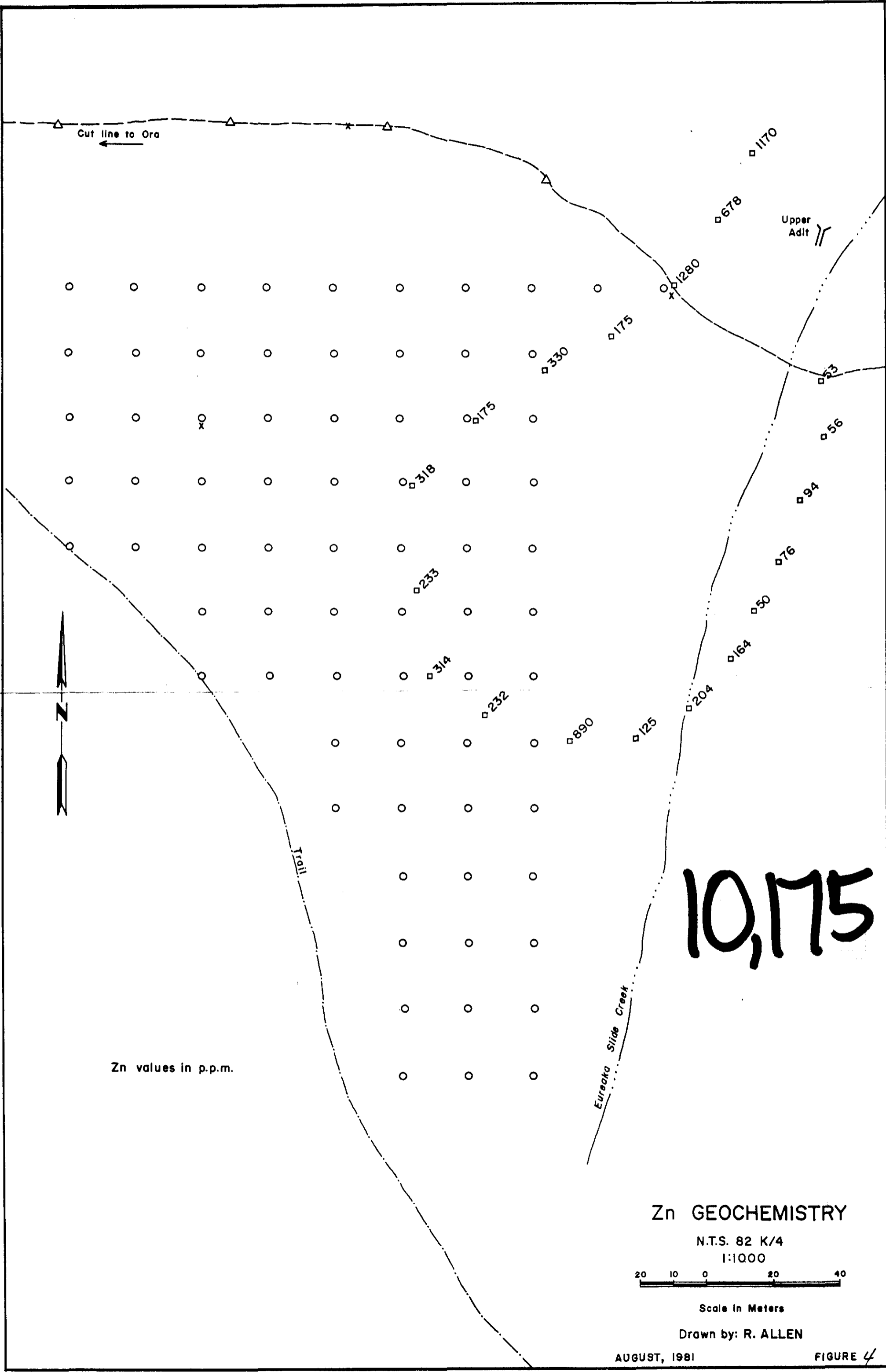

10,175

Zn GEOCHEMISTRY

N.T.S. 82 K/4
 1:1000



Scale in Meters

Drawn by: R. ALLEN

AUGUST, 1981

FIGURE 4

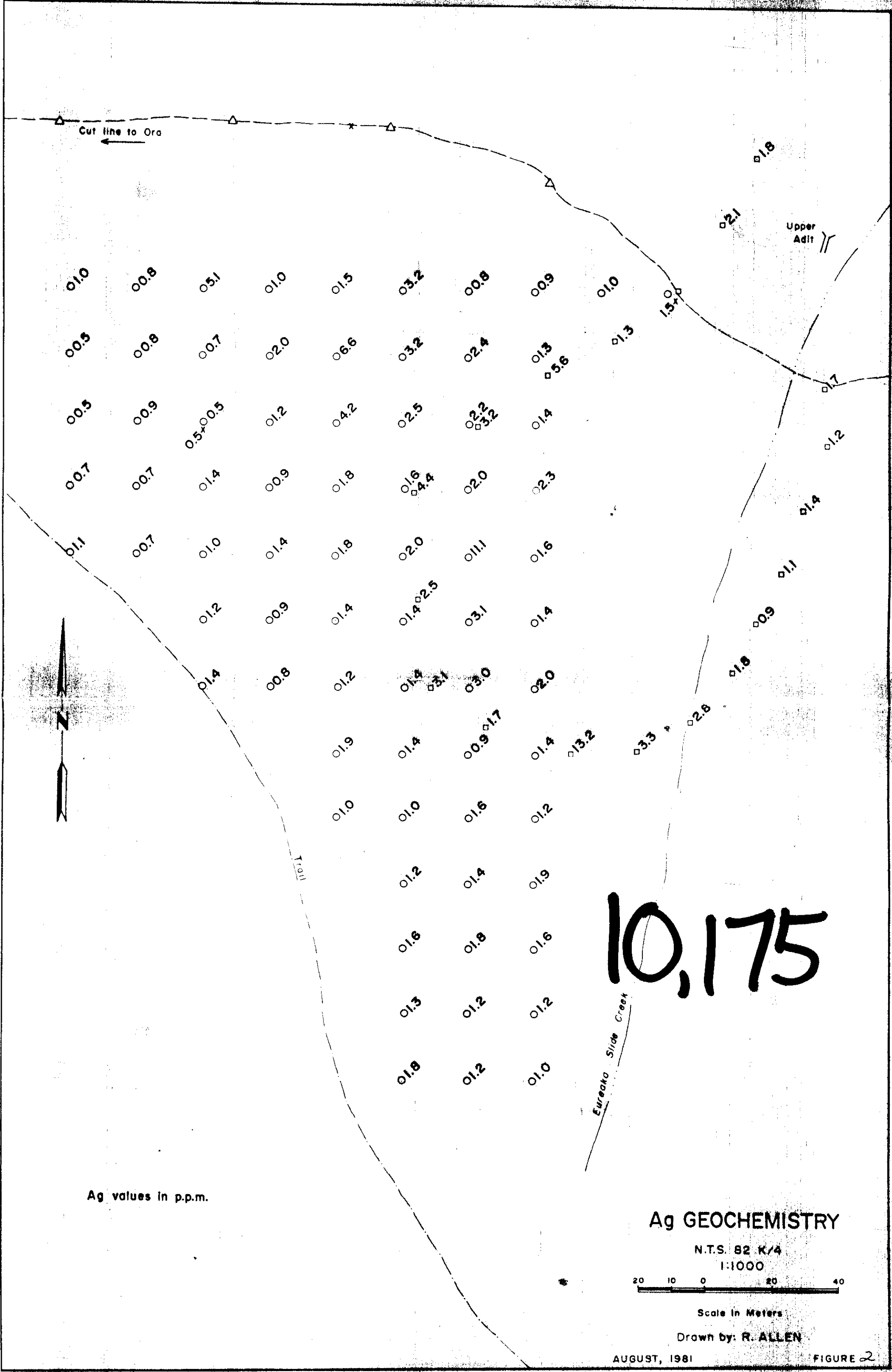

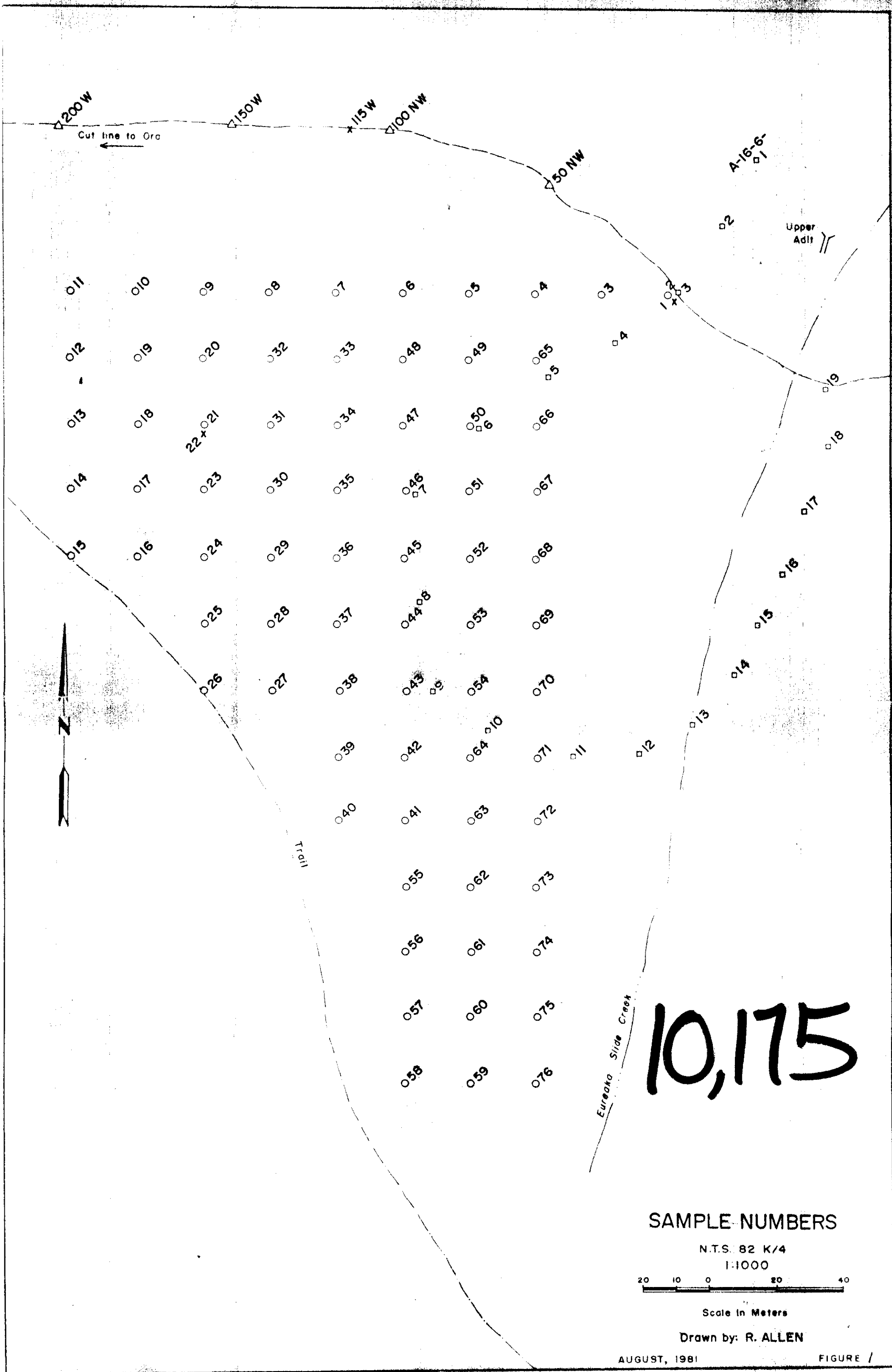

10,175

SAMPLE NUMBERS

N.T.S. 82 K/4
1:1000

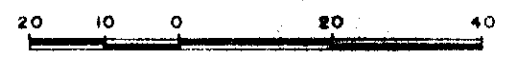

Scale in Meters

Drawn by: R. ALLEN

AUGUST, 1981

FIGURE /

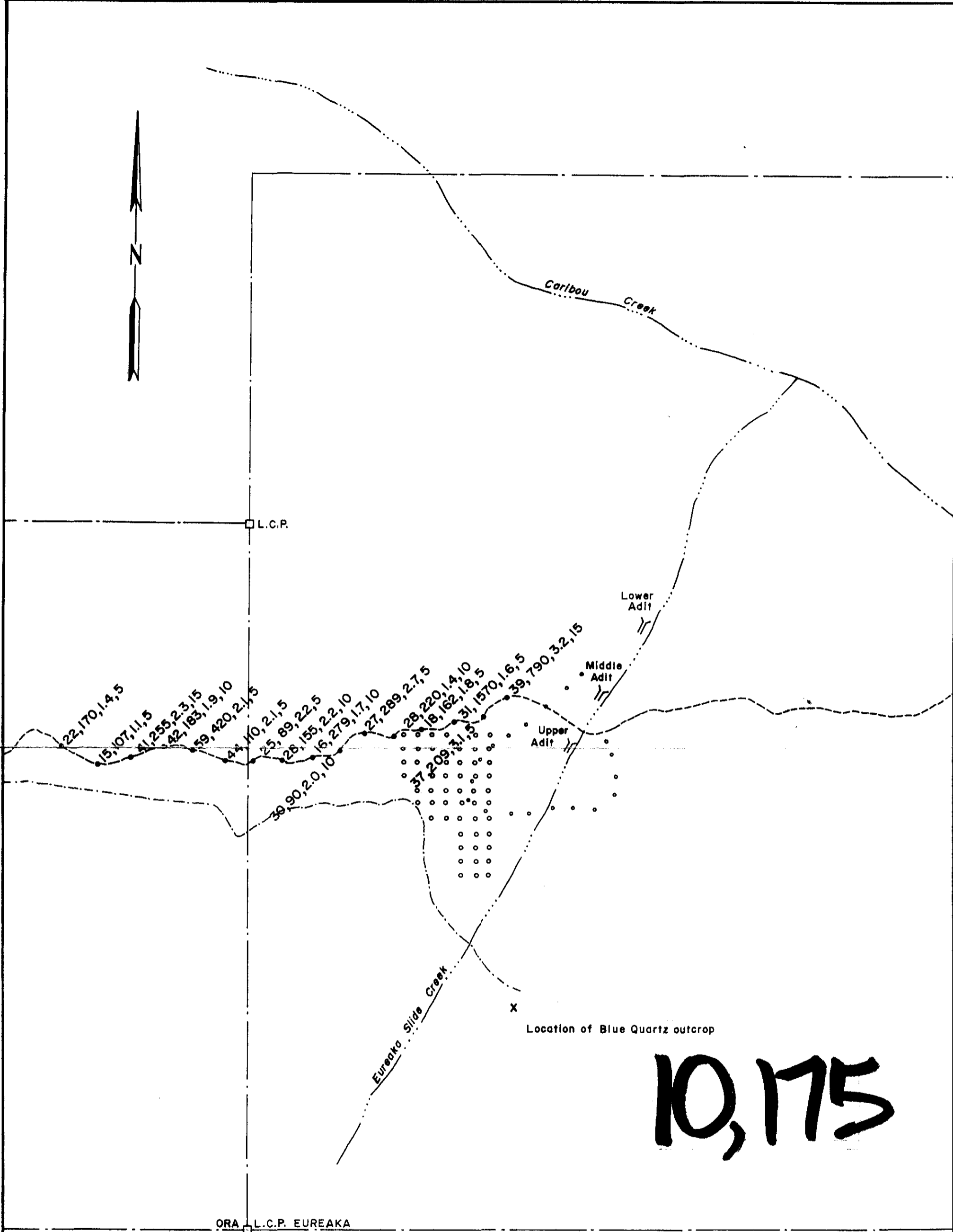

L.C.P.

Lower Adit

Middle Adit

Upper Adit

Location of Blue Quartz outcrop

10,175

ORA L.C.P. EUREAKA

Pb, Zn, Ag values in p.p.m.
Au values in p.p.b.

GEOCHEMISTRY Pb, Zn, Ag, Au

N.T.S. 82 K/4
1:5000



Scale in Meters

Drawn by: R. ALLEN

AUGUST, 1981

FIGURE 3

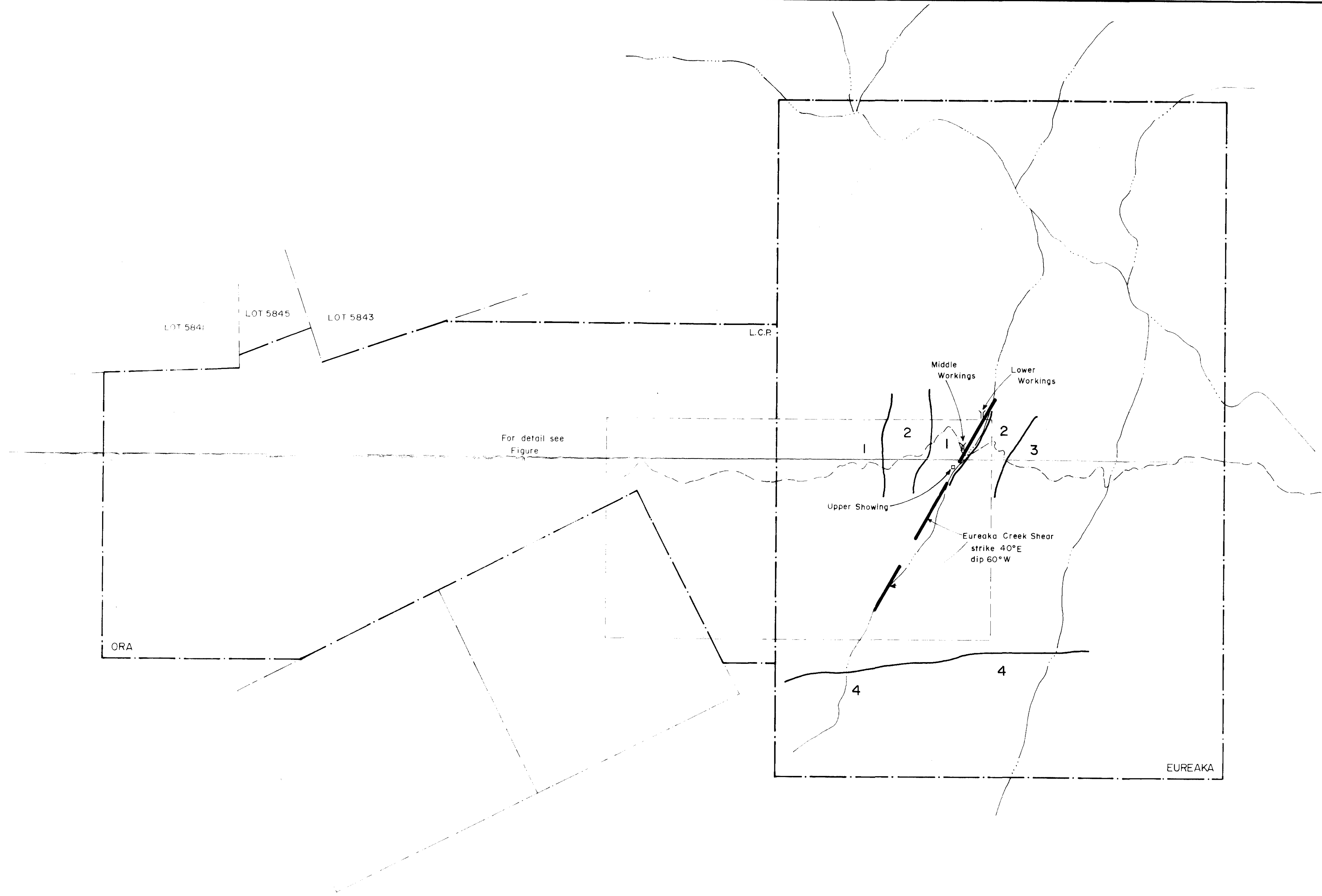

L E G E N D

- 1 GRANITE ARGILLITE
- 2 ANDESITE
- 3 QUARTZITE
- 4 GRANITE

10,175

- GEOLOGICAL CONTACT
- FAULT
- CUT LINE and ACCESS
- STREAM

EUREAKA-ORA CLAIM GROUP
GEOLOGY

NTS. 82 K/4
Scale: 1:5000

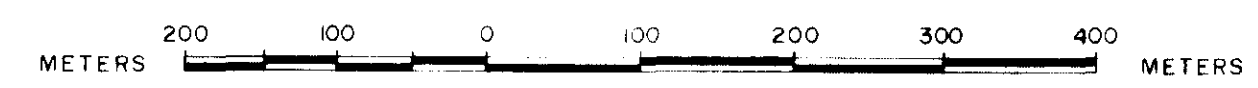

Drawn by R. ALLEN