

RECONNAISSANCE GEOPHYSICAL SURVEYS

T FOX, SNARLY AND JR CLAIMS  
(FOX GROUP)  
ROSEBUD LAKE AREA  
NEAR NELWAY, BRITISH COLUMBIA  
NELSON MINING DIVISION  
82 F/3E and 3W  
Lat: 49°02'N Long: 117°14'W

OWNED BY  
W. ARTHUR HALL

OPERATOR AND CONSULTANT  
INTERPRETEX RESOURCES LTD.  
CALGARY, ALBERTA

MINERAL RESOURCES BRANCH  
ASSESSMENT REPORT  
**10692**

REPORT PREPARED BY  
E. R. ROCKEL, B.Sc., P. Geoph. (Alberta)

**PART  
2 of 2**

OCTOBER 25, 1982

Respectfully Submitted  
INTERPRETEX RESOURCES LTD.

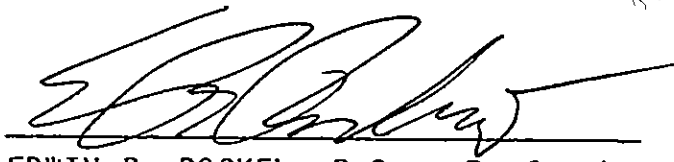

EDWIN R. ROCKEL, B.Sc., P. Geoph.  
Consulting Geophysicist

THE ASSOCIATION OF  
PROFESSIONAL ENGINEERS,  
GEOLOGISTS and GEOPHYSICISTS  
OF ALBERTA  
PERMIT NUMBER  
**P 3100**  
INTERPRETEX  
RESOURCES LTD.

TABLE OF CONTENTS

	<u>Page No.</u>
1. SUMMARY .....	1
2. INTRODUCTION .....	2
3. MINERAL CLAIMS .....	3
4. GEOLOGY AND MINERALIZATION .....	4
5. SURVEY SPECIFICATIONS .....	5
6. DATA .....	6
7. INTERPRETATION .....	7
8. RECOMMENDATIONS .....	8
CERTIFICATE .....	9

LIST OF FIGURES

Figure 1 - Index Map	<i>Following Page 2</i>
Figure 2 - VLF-EM and Magnetic Survey Profiles	<i>Rear Pocket</i>

APPENDICES

Appendix I - Geophysical Data Sheets
Appendix II - Instrument Specifications
Appendix III - Statement of Expenditures

1. SUMMARY

A relatively high conductance VLF-EM anomaly possibly associated with a magnetic low has been located on the Fox Group.

Follow-up of the observed conductor is warranted to establish the strength and validity of the anomaly. A further orientation VLF-EM survey is recommended to establish the anomaly trend. Detailed electromagnetic surveys and geological and geochemical investigations are recommended to follow.

## 2. INTRODUCTION

The Fox Group of claims are situated approximately 1 km east of the Nelson-Nelway highway and approximately 4 km south of the South Salmo River.

A road to Rosebud Lake provides access to the claims.

The claims are partly situated on flat ground in the northwest with upward slopes and hilly terrain towards the south and east.

No outcrop exposure was observed during the surveys. Glacial outwash is prevalent throughout the claims and cover is thickest in low lying areas.

The two-post claims T FOX #1 through #4 have been assigned record numbers 2477 to 2480 respectively. JR claim record number is 2481 and SNARLY claim record number is 2482. All claims were recorded on September 25, 1981 at Nelson.

All claims in the Fox Group are owned by W. Arthur Hall of Calgary, Alberta.

The operator of the 1982 program was Interpretex Resources Ltd., Calgary, Alberta, a firm specializing in geophysical and geological consulting and contracting for mineral exploration.

The Fox claim group was acquired to cover a possible projection on strike of occurrences on the Lone Silver claims to the north.

A location/index map is included in this report as Figure 1.

3. MINERAL CLAIMS

<u>Claim</u>	<u>Record Number</u>	<u>Month of Record</u>	<u>Owner</u>
T FOX #1	2477	Sept.	W. A. Hall
T FOX #2	2478	Sept.	W. A. Hall
T FOX #3	2479	Sept.	W. A. Hall
T FOX #4	2480	Sept.	W. A. Hall
JR	2481	Sept.	W. A. Hall
SNARLY	2482	Sept.	W. A. Hall

4. GEOLOGY AND MINERALIZATION

Although no geological evidence of economic mineralization has been found to date, it is expected that Ag, Pb, Zn mineralization may occur in relation to mineral occurrences to the north.

5. SURVEY SPECIFICATIONS

5.1 Survey Parameters

Survey lines were chained and flagged during the survey. Survey stations were located at 50 metre intervals for reconnaissance. The following coverage was obtained during the survey:

Magnetometer Survey	-	1.40 km (within claim boundaries)
VLF-EM Survey	-	<u>1.30 km</u> (within claim boundaries)
Total Coverage	-	2.70 km (within claim boundaries)

5.2 Equipment Parameters

G-816 Total Field Magnetometer:

- (i) measured total magnetic field
- (ii) magnetic variations controlled using "tie-back" method and linear diurnal curves
- (iii) instrument accuracy  $\pm 1$  gamma
- (iv) station repeatability  $\pm 3$  gammas

EM-16, VLF-EM:

- (i) station used NPG, Seattle, Washington
- (ii) direction operator faced - southerly



6. DATA

6.1 Calculations

No corrections were made to VLF-EM data. During the magnetic survey the tie-back method was used to control magnetic variations. The data was corrected for diurnal variations of the earth's magnetic field using linear diurnal curves.

6.2 Presentation

All data are presented in profile form at a scale of 1:5,000 on plan map Figure 2 containing claim boundaries.

## 7. INTERPRETATION

### 7.1 Discussion of Results

No VLF-EM readings were possible near the northern claim boundary due to noise from high tension power lines. Magnetic readings were taken throughout; however, those readings taken in the vicinity of the power line may have been influenced by the high voltage AC current in the power lines.

A VLF-EM conductor is present between stations 12+00S and 12+50S. Profiles suggest relatively high conductance at a depth of about 100 metres or more. A slight magnetic depression is contiguous with the conductor.

Profiles indicate conductivity to the south of the claimed area. This conductivity will not be discussed here.

### 7.2 Conclusions

The conductive response observed within the claimed area may be related to the magnetic depression mentioned above. If so, it could represent a fault zone possibly mineralized with non-magnetic but conductive minerals.

8. RECOMMENDATIONS

The conductor described between station 12+00S and 12+50S should be followed up to determine if economic minerals may be present.

Additional prospecting and geological investigation is required along with a geophysical orientation survey in order to further define the strike of the conductivity. When the basic trends have been determined, a grid should be cut in the appropriate places for a more detailed geophysical and geochemical exploration program.

VLF-EM and magnetic surveys are recommended for the orientation survey with follow-up using MaxMin II or Elfast Turam.

CERTIFICATE

I, Edwin R. Rockel, hereby certify that:

1. I am a Consulting Geophysicist and owner of Interpretex Resources Ltd. of P.O. Box 6107 Station A, in the City of Calgary, in the Province of Alberta.
2. I currently reside at #4, 12625 - 24th Street S.W., in the City of Calgary, in the Province of Alberta.
3. I obtained a Bachelor of Science degree in Geophysics and Geology in 1966 from the University of British Columbia.
4. I have been practising my profession as an Exploration Geophysicist since 1967.
5. I am a Professional Geophysicist registered in the Province of Alberta.

Nov. 9/82  
Date

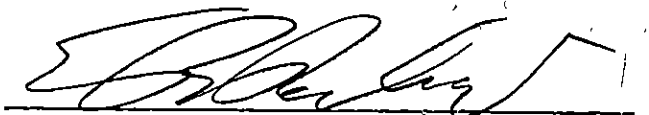
  
Edwin R. Rockel, B.Sc., P. Geoph.  
Interpretex Resources Ltd.

APPENDIX I

GEOPHYSICAL DATA SHEETS



FIELD BASE READING \_\_\_\_\_ 0  
 LINE NO. F00 OPERATOR ADJUST \_\_\_\_\_ 0

TIME	STATION	READING	BASE STN. READING	TOTAL CORR.	FINAL VALUE	REMARKS
9.27	00+5	57654		0	57634	
9.31	+100	57681		0	57681	
9.34	+150	57716		0	57716	
9.35	+200	57742		0	742	
9.37	+250	57977		-1	976	
9.38	+300	57712	power ahead 100 m power line	-1	711	
9.39	+350	57734		-1	733	
9.41	+400	57746		-1	745	
9.43	+450	57661		-1	660	
9.44	+500	57669		-1	668	
9.45	+550	57676		-1	675	
9.46	+600	57664		-1	663	
9.47	+650	57699		-1	698	
9.49	+700	57683		-1	682	
9.50	+750	57684		-1	683	
9.52	+800	57655		-2	653	
9.53	+850	57652		-2	650	
9.55	+900	57664		-2	662	
9.56	+950	57696		-2	694	
9.57	+1000	57689		-2	687	
9.58	+1050	57739		-2	737	
9.59	+1100	57701	*	-2	699	
10.34	+1100	57691	+10	-4	697	
10.35	+1150	57676		-4	682	
10.36	+1200	57592		-4	598	
10.38	+1250	57631		-4	637	

DATUM LEVELS: BASE STN. \_\_\_\_\_ 0 FIELD BASE \_\_\_\_\_ 0  
 JOB NO. \_\_\_\_\_ AREA Fox DATE June 26  
 INST. TYPE 6816 Mag SERIAL NO. \_\_\_\_\_  
 OPERATOR \_\_\_\_\_ PAGE NO. 1 of 2  
 PROTON  
 FLUXGATE  
**CAN-LAKE**  
 EXPLORATIONS LTD

FIELD BASE READING \_\_\_\_\_ 0  
 LINE NO. F00 OPERATOR ADJUST \_\_\_\_\_ 0

TIME	STATION	READING	BASE STN. READING	TOTAL CORR.	FINAL VALUE	REMARKS
10.39	+1300	57652	+10	-4	57662	
10.40	+1350	57672		-4	678	
10.42	+1400	57658		-4	664	
10.43	+1450	57656		-4	662	
10.44	+1500	57690		-4	696	
10.45	+1550	57668		-4	674	
10.46	+1600	57671		-4	677	
10.47	+1650	57670		-4	676	
10.49	+1700	57643		-5	648	
10.50	+1750	57603		-5	608	
10.51	+1800	57636		-5	641	
10.53	+1850	57640		-5	645	
10.54	+1900	57624		-5	629	
10.55	+1950	57625		-5	630	
10.57	+1950	57630		-5	635	
10.58	+2000	57626		-5	631	
<del>10.59</del>	+2005	57649	57634	-15		Tie back
1404						

DATUM LEVELS: BASE STN. \_\_\_\_\_ 0 FIELD BASE \_\_\_\_\_ 0  
 JOB NO. \_\_\_\_\_ AREA Fox DATE June 26/82  
 INST. TYPE 6816 Mag SERIAL NO. \_\_\_\_\_  
 OPERATOR \_\_\_\_\_ PAGE NO. 2 of 2  
 PROTON  
 FLUXGATE  
**CAN-LAKE**  
 EXPLORATIONS LTD.

APPENDIX II

INSTRUMENT SPECIFICATIONS



GEONICS LIMITED  
VLF EM 16

Source of Primary Field: VLF transmitting stations

Transmitting Stations Used: Any desired station frequency can be supplied with the instrument in the form of plug-in tuning units. Two tuning units can be plugged in at one time. A switch selects either station.

Operating Frequency Range: About 15-25 Hz

Parameters Measured: (1) The vertical in-phase component (tangent of the tilt angle of the polarization ellipsoid).  
(2) The vertical out-of-phase (quadrature) component (the short axis of the polarization ellipsoid compared to the long axis).

Method of Reading: In-phase from a mechanical inclinometer and quadrature from a calibrated dial. Nulling by audio tone.

Scale Range: In-phase  $\pm 150\%$ ; quadrature  $\pm 40\%$

Readability:  $\pm 1\%$

Reading Time: 10-40 seconds depending on signal strength

Operating Temperature Range: -40 to 50° C.

Operating controls: ON-OFF switch, battery testing push button, station selector, switch, volume control, quadrature, dial  $\pm 40\%$ , inclinometer dial  $\pm 150\%$

Power Supply: 6 size AA (penlight) alkaline cells. Life about 200 hours

Dimensions: 42 x 14 x 9 cm (16 x 5.5 x 3.5 in)

Weight: 1.6 kg (3.5 lbs)

Instrument Supplied With: Monotonic speaker, carrying case, manual of operation, 3 station selector plug-in tuning units (additional frequencies are optional), set of batteries

Shipping Weight: 4.5 kg (10 lbs.)

Name and Address of Manufacturer: Geonics Limited  
1745 Meyerside Drive/Unit 8  
Mississauga, Ontario  
L5T 1C5

APPENDIX III

STATEMENT OF EXPENDITURES

Labour Costs

Geophysicist (E. R. Rockel) 1.5 days @ \$350.00/day	\$525.00
Junior Assistant (W. A. Hall) 1 day @ \$125.00/day	125.00
Junior Geophysicist (H. M. Rockel) 1 day @ \$160.00/day	160.00

Other Costs

Mobilization/Demobilization/Vehicles	125.00
Travel, Field Support @ \$25.00/day/man	75.00
Geophysical Instrument Rental	180.00
Report, Materials, Maps	<u>60.00</u>
Total	\$1250.00

Dates

June 26, 1982  
Oct. 20, 1982 (Report)

MINERAL RESOURCES BRANCH  
 ASSESSMENT REPORT  
**26701**  
 NO.

**2482**  
**TRM**

Rosebud Lake Area  
 TFOX # 1 to 4, TR and SNARLY Claims  
 VLF-EM and Magnetic Survey Profiles  
 EM-16 and G-816  
 Scale: 1:5,000 N.T.S. 82 F/3W  
 Date: Oct, 1982 Figure # 2

Fox Group

THE ASSOCIATION OF  
 PROFESSIONAL ENGINEERS,  
 GEOLOGISTS and GEOPHYSICISTS  
 OF ALBERTA  
 PERMIT NUMBER  
 P 3100  
 INTERPRETEX  
 RESOURCES LTD.

Legend:

- Claim Boundary
- Claim Post
- Survey Line
- Power Line
- Survey by Hip-chain, Compass and Flagging
- In-Phase %
- VLF-EM 10% Out-of-Phase %
- Total Field (gamma)
- Magnetic Profile
- VLF-EM Conductor
- VLF-EM Station - Seattle
- VLF-EM facing Southely
- Mag. Base Level 57,600
- 1 cm. = 100 gamma

0 50 100 150  
 (meters)

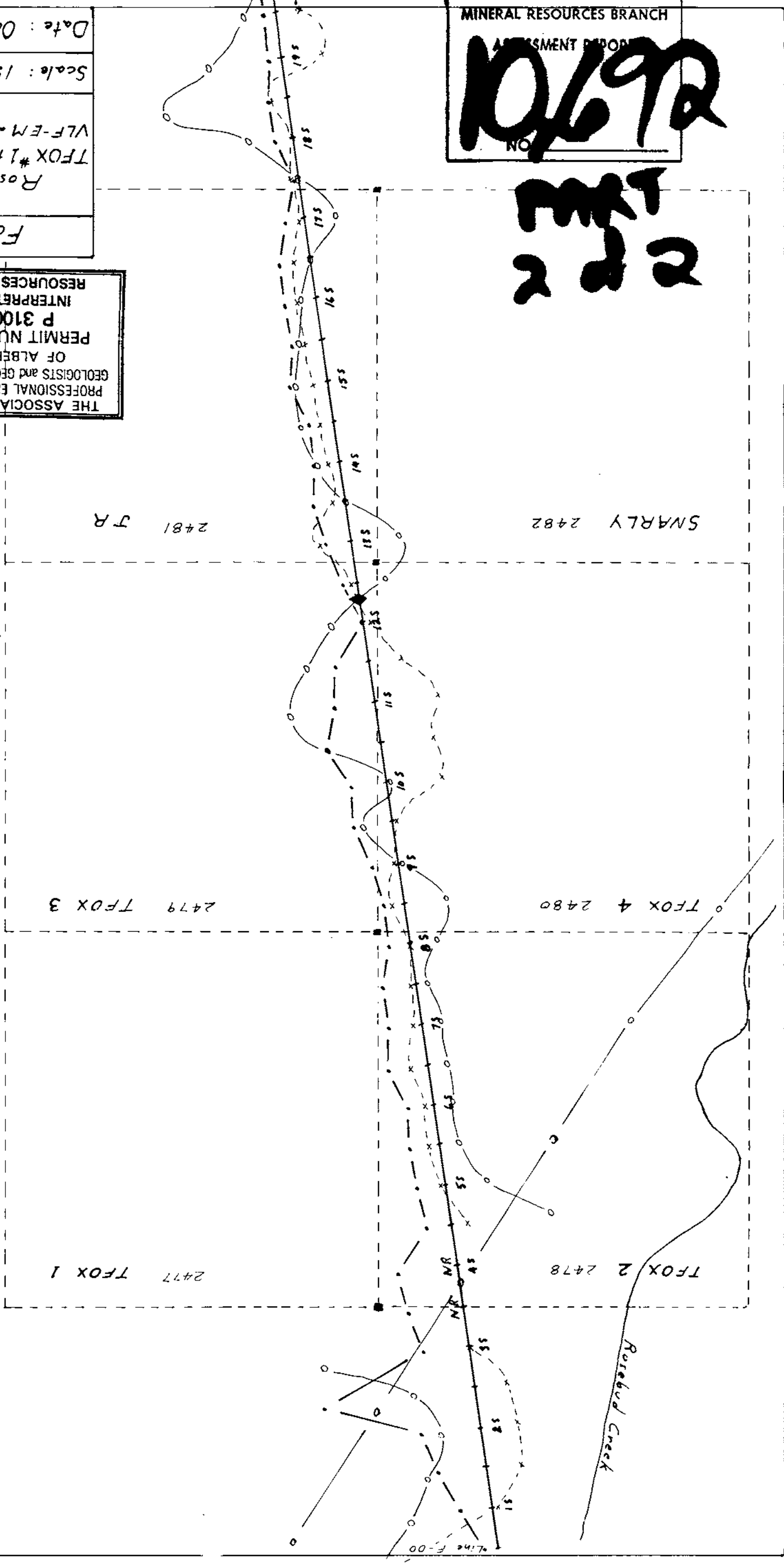

2479 TFOX 3

2480 TFOX 4

2477 TFOX 1

2478 TFOX 2

2481 TR

2482 SNARLY