

REPORT
ON

THE CANTY PROPERTY
DIAMOND DRILLING - 1982

OSOYOOS MINING DIVISION

49° - 25' North Latitude
120° - 00' West Longitude

92H/8E

FOR

GOOD HOPE RESOURCES LTD.
1518 - 1177 West Hastings Street
Vancouver, B.C.

By

A.D. WILMOT P. ENG.
Kelowna, B.C.

November 15, 1982

GEOLOGICAL BRANCH
ASSESSMENT REPORT

10,800

TABLE OF CONTENTS

	PAGE
Introduction.....	1
(1) Location and Access.....	1
(2) Property.....	1
History.....	1
Ownership.....	1
Economic Assessment.....	1
(3) Summary of Work Done.....	1
Claims Explored.....	1
Purpose of Drilling and Results.....	1
(4) Notes on Drilling.....	2
(5) Statement of Expenditures.....	3
(6) Certificate of A.D. Wilmot P. Eng.....	4

APPENDICES

Key Map.....	Plate 1
Claim Map.....	Plate 2
Plan of Surface Drill Holes (in map pocket).....	Plate 3
X - Sections D.D.H. 82-1.....	Plate 4
82-2.....	Plate 5
82-3.....	Plate 6
82-4.....	Plate 7
Drill Hole Logs (in map pocket)	

INTRODUCTION

This is a report on the diamond drilling on the Canty property during the summer of 1982.

(I) LOCATION & ACCESS

The CANTY MINE is located on Nickel Plate Mountain, 18 km. by road from Hedley, B.C. An index map, Plate 1, is appended.

(II) PROPERTY

The property consists of 16 Crown Granted Mineral claims and 31 claims held by right of location.

HISTORY

CANTY GOLD MINES LTD. explored the property continuously between 1835 and 1940 and shipped 1200 tons of ore, grading 0.168 ounces of gold per ton, to the Mascot Mill.

OWNERSHIP

The property is owned by Good Hope Resources Ltd. of 1518-1177 West Hastings Street, Vancouver, B.C.

ECONOMIC ASSESSMENT

Based on old underground assay plans and drill holes, with the added information obtained from the drilling by Good Hope Resources in 1980 and 1981, the engineering firm of Campbell Resources Inc. estimated an ore reserve to a depth of 200 ft. (61 m.) of 608,557 tons grading 0.10 ounces of gold per ton. The 1982 drilling increased this figure of 0.10 ounces of gold ore to 646,282 tons. As none of the 1982 drill holes went below the 61 m. level, the estimated reserve below this level remains the same at 146,580 tons grading 0.13 ounces of gold per ton.

(III) SUMMARY OF WORK DONE

Between August 17th and September 14th 1982, a total of 235.2 meters of "BQ" wireline drilling was completed in 4 drill holes. The location of this drilling was on the Boston & Pittsburg Crown Grants.

The purpose of this work was to further define the ore body indicated by the 1980 and 1981 drill programmes.

(IV) **NOTES ON DRILLING**

While overburden averaged between 3 and 4 m. over the drill site, heavy overburden up to 28 m. was encountered in the proximity of Cahill Creek.

The rock type is a siliccous metasediment, with the gold associated with disseminated arsenopyrite.

The sample interval was 1.5 m. in mineralized zones and 3 m. in sparse mineralization and country rock.

The split core was sent to DANKOE MINES for assay.



A. D. WILMOT, P. Eng.

(V) **STATEMENT OF EXPENDITURES**

(1)	235.2 m. of "BQ" wireline drilling @ 66.89 per m.....	15,732.00
(2)	43 gold assays @ 6.50.....	279.50
(3)	Vehicle rental 4 weeks @ 150.00 per week..... 3121 km. @ 0.25 per km.....	600.00 780.25
(4)	Supervision A.D. Wilmot P. Eng. 30 days @ 150.00 per day.....	4,500.00
(5)	Report including typing, mapping and reproduction.....	400.00
	TOTAL	<u>22,291.75</u>

CERTIFICATE

I, **ASHLEY D. WILMOT** of KELOWNA, B.C.

CERTIFY THAT:

I GRADUATED FROM QUEEN'S UNIVERSITY IN 1936 WITH A BACHELOR OF SCIENCE DEGREE IN MINING ENGINEERING.

I AM A LIFE MEMBER OF THE B.C. PROFESSIONAL ENGINEERS, THE CANADIAN INSTITUTE OF MINING AND METALLURGY AND THE B.C. AND YUKON CHAMBER OF MINES.

I HAVE PRACTICED MY PROFESSION FOR OVER FORTY YEARS.

A handwritten signature in cursive script that reads "A. D. Wilmot".

A.D. WILMOT P. ENG.

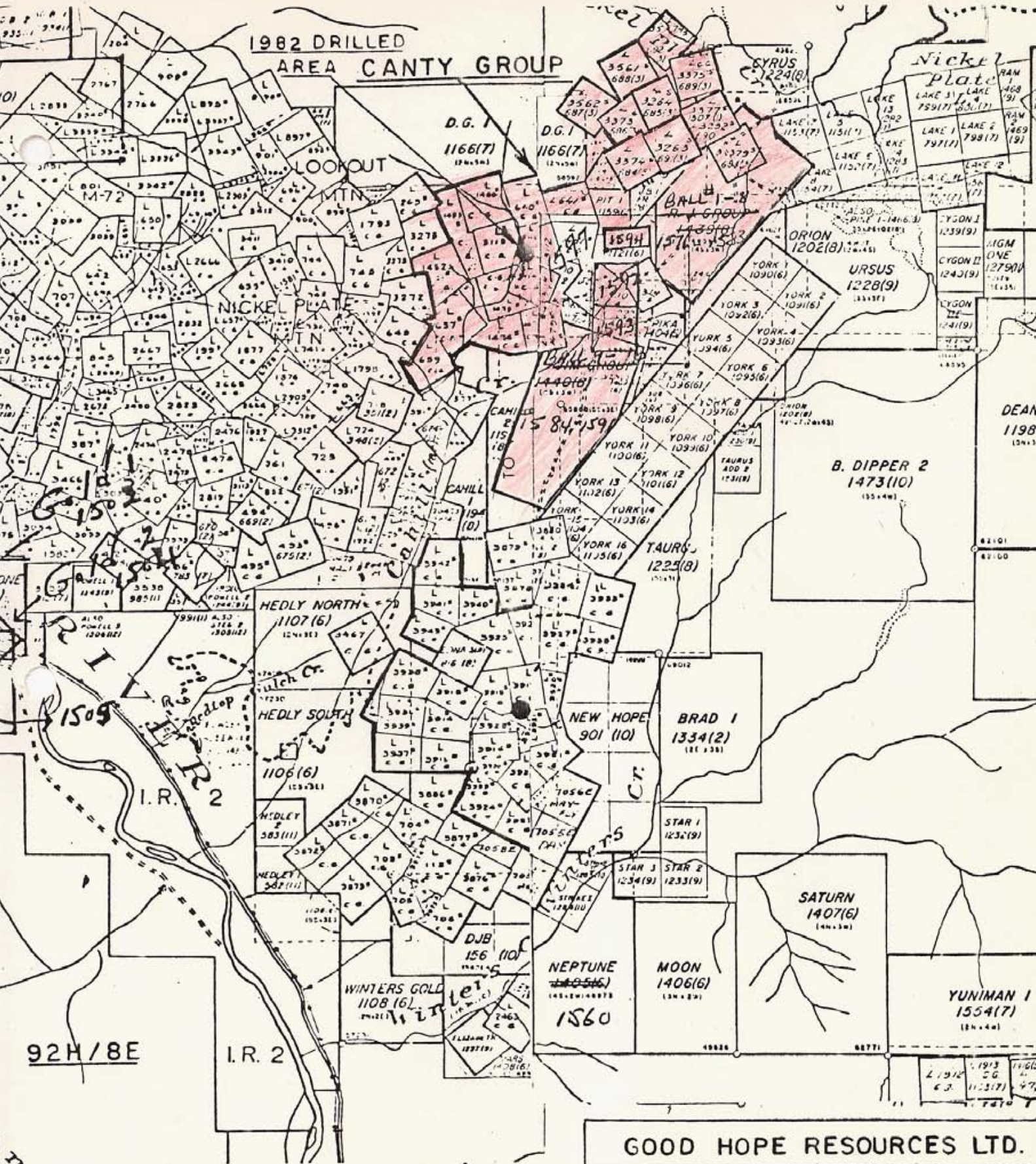


GOOD HOPE RESOURCES LTD.

LOCATION MAP

PLATE I

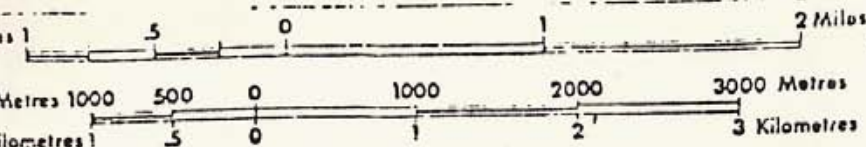
1982 DRILLED
AREA CANTY GROUP



92H/8E

I.R. 2

Province of British Columbia
Ministry of Energy, Mines and Technical Surveys



DATE OF MICROFILM: 81-11-26

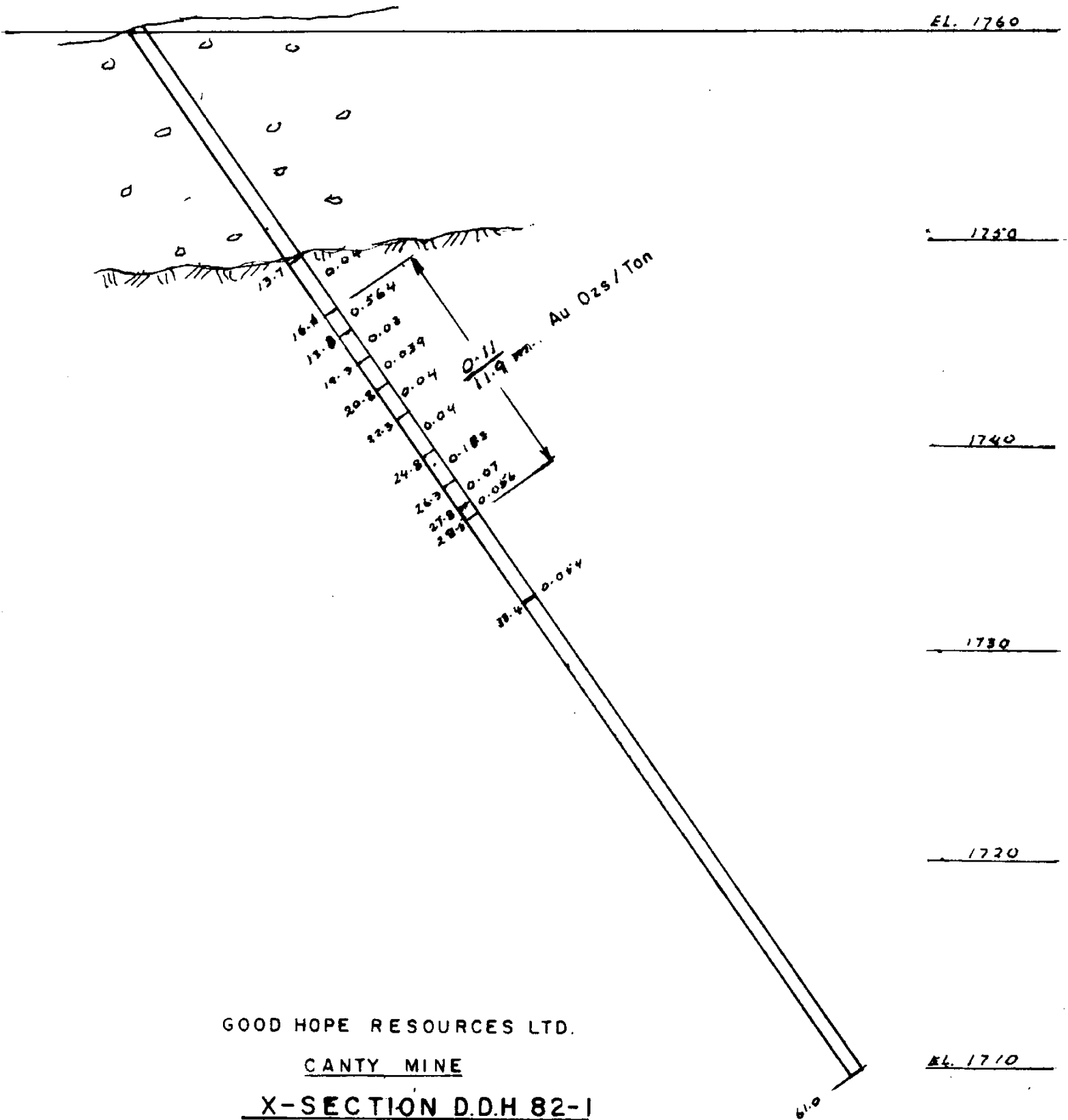
GOOD HOPE RESOURCES LTD.

AREA CLAIM MAP

92H/8E & 82E/5W

SCALE: 1:50,000

PLATE 2



GOOD HOPE RESOURCES LTD.

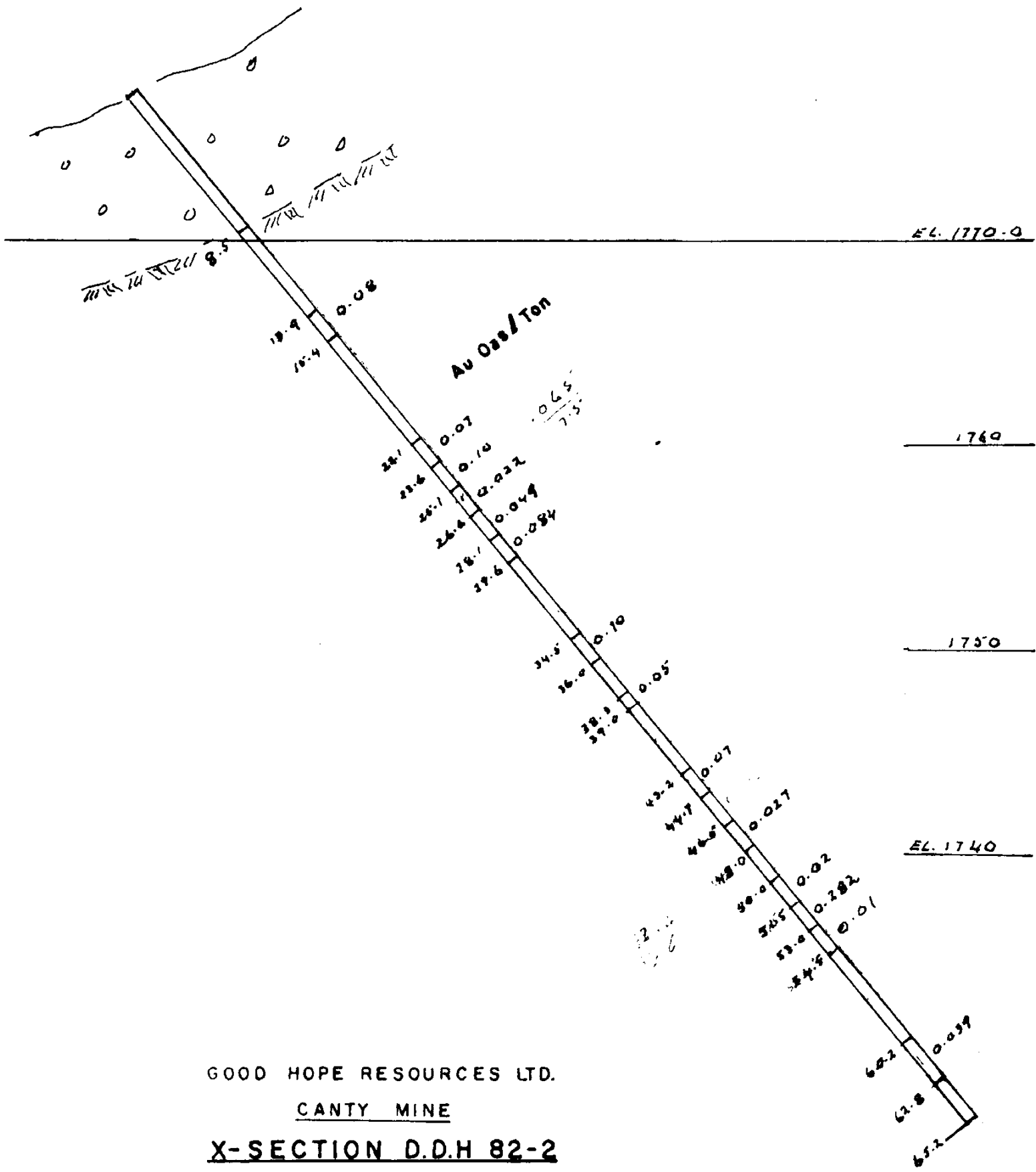
CANTY MINE

X-SECTION D.D.H. 82-1

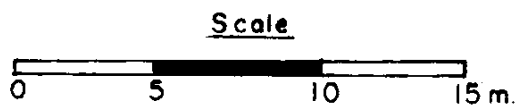
Scale

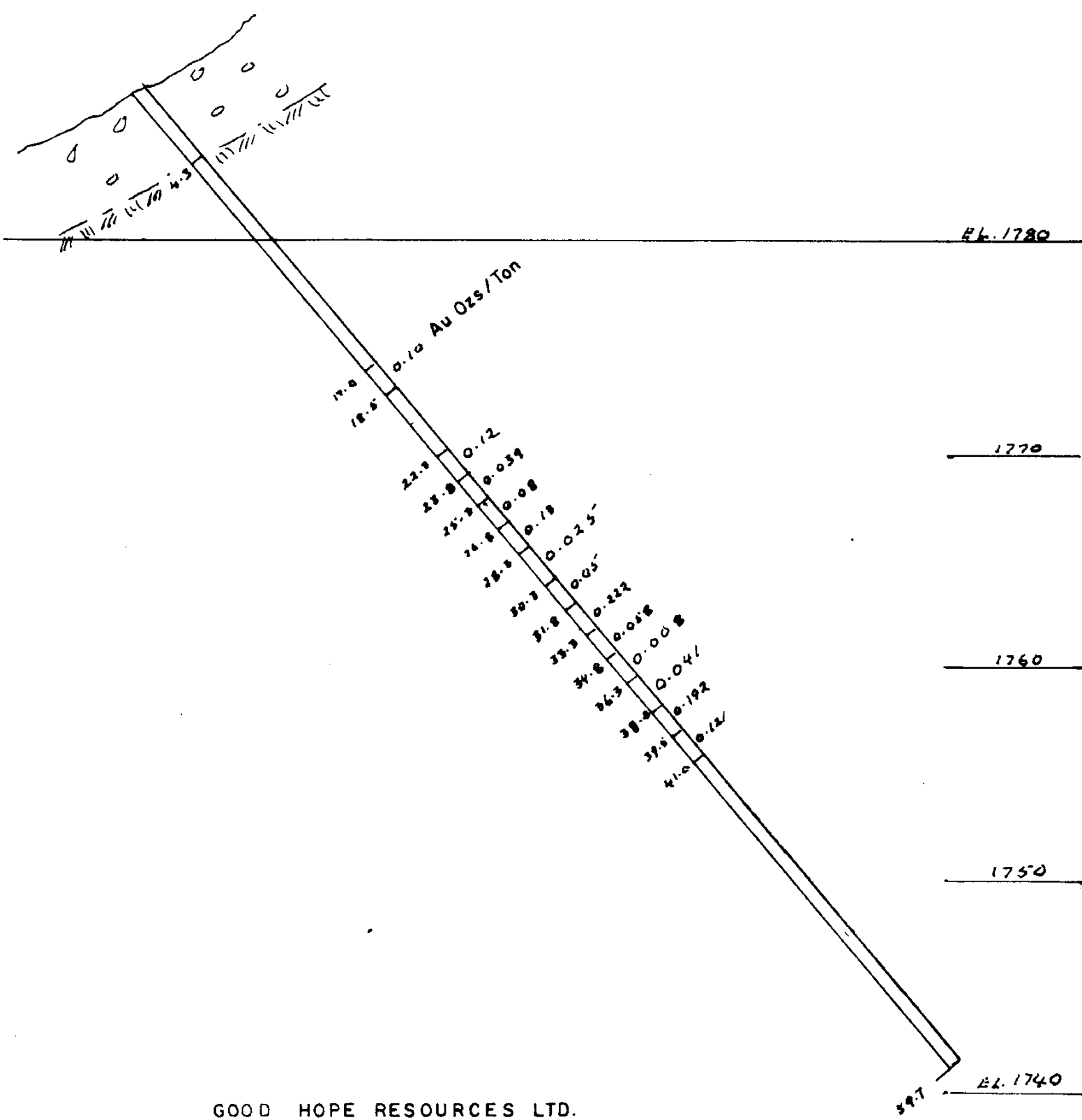


PLATE - 4



GOOD HOPE RESOURCES LTD.
CANTY MINE
X-SECTION D.D.H 82-2





GOOD HOPE RESOURCES LTD.
CANTY MINE
 X-SECTION D.D.H 82-3

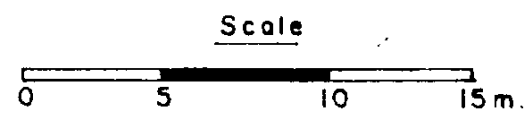
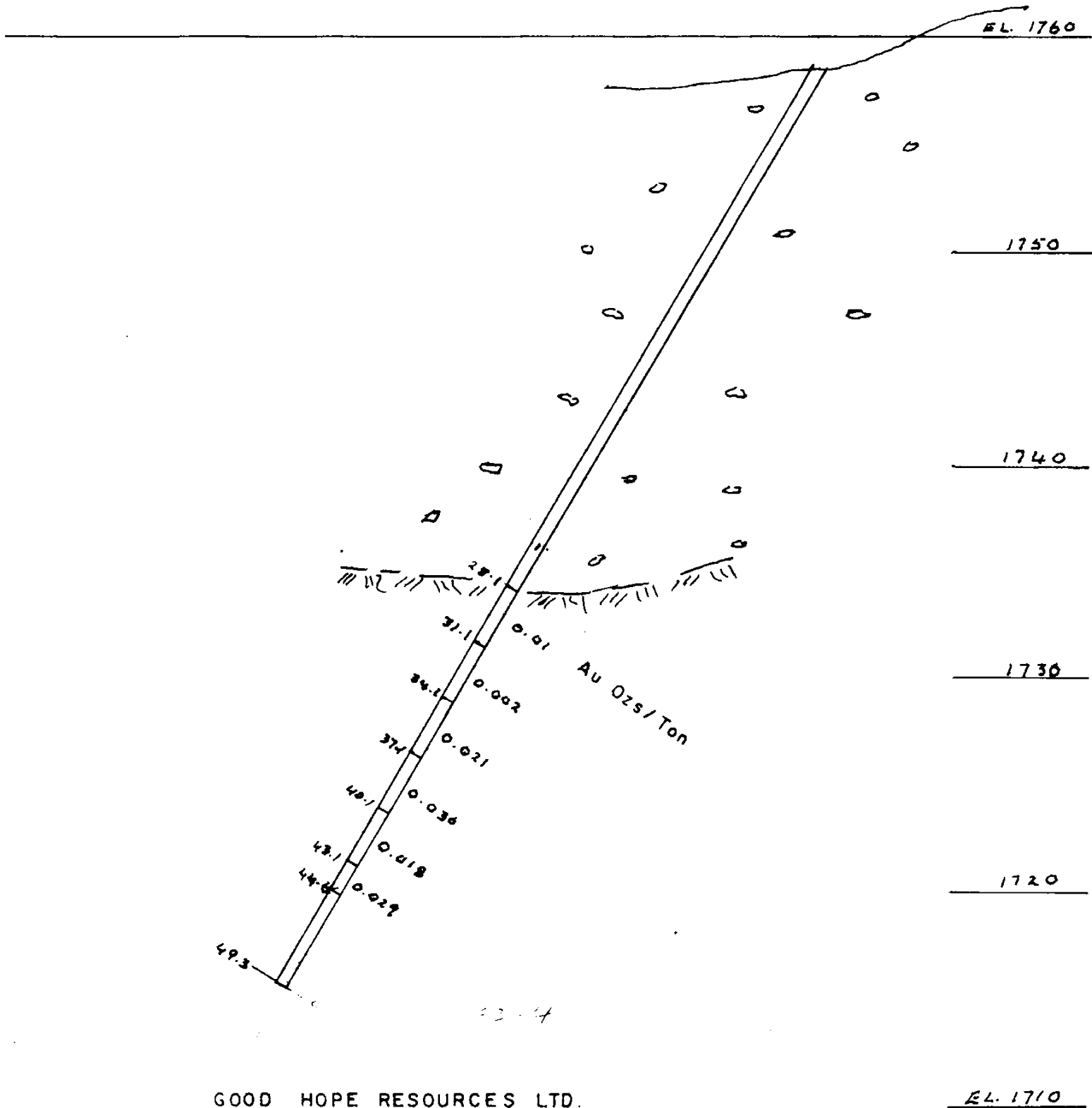


PLATE-6



GOOD HOPE RESOURCES LTD.

CANTY MINE

X-SECTION D.D.H 82-4

Scale

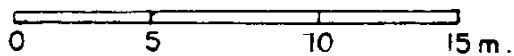


PLATE - 7

DRILL HOLE LOG

DIP TESTS

Ft. _____
 At Ft. _____
 At Ft. _____
 At Ft. _____
 At Ft. _____
 At Ft. _____

Property CANTY
 At _____
 Claim No. _____
 Working Place _____
 Baseline Footage 1470.26 N
 Baseline Offset 900.75 E
 Date Started Aug 21/82
 Date Completed Aug 24

Hole Number 82-1
 Dip -55°
 Length 61.0 m.
 Bearing S 39-36 E
 Elev. Collar 1760.38
 Horiz. Trace _____
 Vert. Trace _____
 Date Logged _____

FROM	TO	DESCRIPTION	SAMPLE NUMBER	ASSAY
0	13.7 m	Casing		
		<u>Metaseds</u>		
		From 13.7 to 14.2 Brecciated with 25% gtz. filling - few specks Arseno		
		From 14.2 to 16.6 Fine grained siliceous some gtz. feldspar replacement bands @ 60° to core. Faint banding 65° to core		
13.7	16.6	Sparres diss. Arseno.	326K	0.04
16.6	17.8	<u>Mineralized Zone</u> . Dark fine grained	327K	0.564
17.8	19.3	siliceous with 3-4% Arseno.	435	0.03
		From 17.8 to 21.4 Fine grained cherty sed.		
19.3	20.8	Faint banding 70-75° to core. Nil min.	436	0.039
20.8	22.3	From 21.4 to 24.8. Zone of alteration	437	0.04
22.3	24.8	mottled actinolite, calcite alteration & in part garnetiferous.	438	0.04
24.8	26.3	From 24.8 to 28.5 As above but	328	0.183
26.3	27.8	mineralized with 2% disseminated	329	0.07
27.8	28.5	arseno pyrite.	330	0.056
		From 28.5 - 37.4 Quartzite contact @ 25° to core. Bleb of Zns at 29.0. Sparse Py & Arseno between 30.1 & 34.3. Garnetiferous band		
33.35	33.40	with blebs of Zns between 33.35 & 33.40	331K	0.054
		From 37.4 to 44.5 Pale green siliceous metaseds with garnetiferous bands		
		44.5 to 56.1 As above but non Garnetiferous & increasingly siliceous		

Logged by DW

DRILL HOLE LOG

DIP TESTS

Property Hole Number 82-1

At Dip

At Claim No. Length

At Working Place Bearing

At Baseline Footage Elev. Collar

At Baseline Offset Horiz. Trace

At Date Started Vert. Trace

At Date Completed Date Logged

FROM	TO	DESCRIPTION	SAMPLE NUMBER	ASSAY
		At 51.5 a fracture 25° to core coated with calcite crystals.		
		From 56.1 to 61.0 cherty, pale green metabeds with some chloritic & garnetiferous alteration		
		End hole.		

Logged by

DRILL HOLE LOG

DIP TESTS

At _____ Ft. _____
 At _____ Ft. _____
 At _____ Ft. _____
 At _____ Ft. _____
 At _____ Ft. _____
 At _____ Ft. _____

Property CANTY Hole Number D.H 82-2
 At _____ Dip -50°
 Claim No. _____ Length 652 m
 Working Place _____ Bearing S 51-39 E
 Baseline Footage 1498.51 N Elev. Collar 1777.17
 Baseline Offset 949.51 E Horiz. Trace _____
 Date Started Aug 25 1982 Vert. Trace _____
 Date Completed _____ Date Logged _____

FROM	TO	DESCRIPTION	SAMPLE NUMBER	ASSAY
0	8.5	Casing Metaseds.		
		From 8.5 to 8.9 Surface oxidation		
		From 8.9 to 16.0 Fine grained siliceous mottled with intruded qtz stringers & irregular qtz-calcite replacements. blobs of Arseno in quartz stringers		
13.9	15.4	at 14.0 & 14.8 sparse diss. Arseno to 15.4	332K	0.08
		From 16.0 to 17.3 Dark, fine grained cherty with 25% quartz-calcite stringers & 3% to core. A little sparse diss. arseno.		
		From 17.3 - 21.8 Fine grained cherty seds facies with calcite filling 45° to core. 5% qtz-calcite filling. A little sparse fine grained diss. arseno.		
22.1	23.6	From 22.1 - 23.6 As above but with 1% diss. Arseno. calcite fractures	333K	0.07
23.6	25.1	medium grained, spotted porphyritic texture - 1.2% Arseno.	334K	0.10
25.1	26.6	Fine grained, 1.2% Arseno, scattered garnets.	335K	0.022
26.6	28.1	As above - 1.2% Arseno	336K	0.049
28.1	29.6	Pale green, mottled with a few garnets < 1% Arseno.	337K	0.084
		From 29.6 - 34.5 - medium grained, green siliceous seds - very lean min.		

Logged by _____

DRILL HOLE LOG

Page
D. H. 82-2

DIP TESTS

At	Fl	Property	Hole Number
At	Fl	At	Dip
At	Fl	Claim No.	Length
At	Fl	Working Place	Bearing
At	Fl	Baseline Footage	Elev. Collar
At	Fl	Baseline Offset	Horiz. Trace
At	Fl	Date Started	Vert. Trace
		Date Completed	Date Logged

FROM	TO	DESCRIPTION	SAMPLE NUMBER	ASSAY
34.5	36.0	From 34.5 to 36.0 metaseds as above but carrying 7 1/2% arseno. band of massive pyr. with a little chalc. between 35.8 & 35.9.	338K	0.10
		From 36.0 - 38.3 Grey fine grained meta seds - fracturing @ 45° to core Nil min.		
38.3	39.0	Medium grained - Green chloritic 1 1/2% arseno.	339K	0.05
		From 39.0 - 43.2 Fine grained cherty fracturing @ 45° to core calcite on fractures. A few specks of arseno @ 43.2		
43.2	44.7	Rock type as above - 1 1/2% arseno.	340K	0.07
		From 44.7 - to 46.5 - Fine grained cherty - nil min.		
46.5	48.0	Fine grained cherty 1 1/2% arseno	341K	0.027
		From 48.0 - 50.0 - Fine grained cherty - nil min		
50.0	51.5	Dark grey, fine grained sil. seds. < 1% arseno.	342K	0.02
51.5	53.0	2 1/2% arseno	343K	0.282
53.0	54.5	From 53.0 - 60.2 Grey med. grained seds - Very sparse arseno between 57.5 + 57.9.	784	0.01
60.2	62.8	As above but carrying 1 1/2% As minor pyr & chalc.	344K	0.039
		From 62.8 - 65.2 Nil min. End hole.		

Logged by _____

DRILL HOLE LOG

DIP TESTS

At _____	Fl. _____	Property _____	Hole Number 82-3
At _____	Fl. _____	Claim No. _____	Dip <u>50°</u>
At _____	Fl. _____	Working Place _____	Length <u>59.7 m</u>
At _____	Fl. _____	Baseline Footage <u>1507.57</u>	Bearing <u>S-45-E</u>
At _____	Fl. _____	Baseline Offset <u>966.33</u>	Elev. Collar <u>1787.09</u>
At _____	Fl. _____	Date Started <u>Aug 30/82</u>	Horiz. Trace _____
At _____	Fl. _____	Date Completed _____	Vert. Trace _____
			Date Logged _____

FROM	TO	DESCRIPTION	SAMPLE NUMBER	ASSAY
0	4.3	Casing METASEDS		
		From 4.3 to 7.3 Green fine grained siliceous, banded at 55° to core. Fractures filled with quartz, Lean py. & a little arsenic at 5.6.		
		From 7.3 to 8.1 black argillaceous fractured at 45° to core.		
		From 8.1 to 17.0 Pale green cherty with a few garnetiferous bands. minor arsenic from 15.7 to 15.9		
17.0	18.5	From 17.0 to 18.5 Green, fine grained - 1% Arsenic, filling fractures & disseminated	345K	0.10
		From 18.5 to 22.3 as above but very sparse min.		
22.3	23.8	From 22.3 to 23.8 Mineralized Zone	346	0.12
23.8	25.3	2% arsenic in stringers blebs	347	0.039
25.3	26.8	& disseminations	348	0.08
26.8	28.3		349	0.13
28.3	30.3	From 28.3 - 30.3 Pale green medium grained - Nil min.	785	0.025
30.3	31.8	As above but mineralized - 1% arsenic	350	0.05
31.8	33.3		426	0.222
33.3	34.8	From 33.3 - 34.8 As above but very	429	0.058
34.8	36.3	sparse min except for 0.2m @ 34.1	786	0.008

Logged by NEW

DRILL HOLE LOG

Page 2

DIP TESTS

At	Fl.	Property	Hole Number 82-5
At	Fl.	At	Dip
At	Fl.	Claim No.	Length
At	Fl.	Working Place	Bearing
At	Fl.	Baseline Footage	Elev. Collar
At	Fl.	Baseline Offset	Horiz. Trace
At	Fl.	Date Started	Vert. Trace
		Date Completed	Date Logged

FROM	TO	DESCRIPTION	SAMPLE NUMBER	ASSAY
36.3	38.0	From 34.0 - 41.0 fine grained	787	0.041
38.0	39.5	scds - 19% arsenic	427	0.192
39.5	41.0	End Ore zone	428	0.121
		From 41.0 to 59.7 massive		
		pale green to dark grey		
		meta scds with some finely		
		diss. pyr between 44.0 and 44.5'		
		From 46.5 to 46.6 - 1% pyr		
		with a little chalc.		
		@ 48.5 diss. arsenic over		
		width of 0.1 m.		

Logged by

DRILL HOLE LOG

DIP TESTS

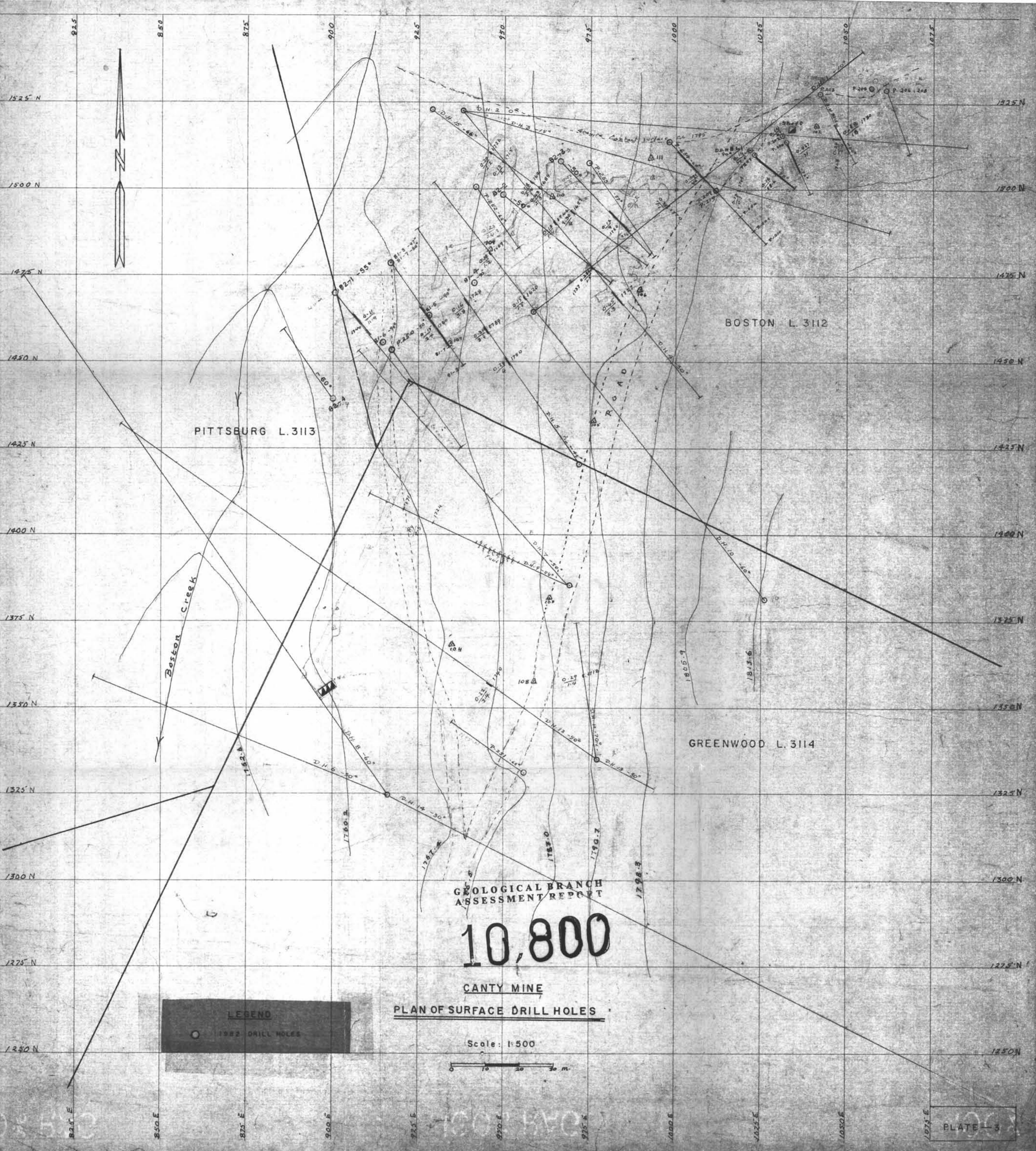
At _____ Ft. _____
 At _____ Ft. _____
 At _____ Ft. _____
 At _____ Ft. _____
 At _____ Ft. _____
 At _____ Ft. _____

Property _____
 At _____
 Claim No. _____
 Working Place _____
 Baseline Footage 1439.38
 Baseline Offset 900.07
 Date Started Sept 2/82
 Date Completed _____

Hole Number 82-4
 Dip -60°
 Length 49.3
 Bearing N 35 W
 Elev. Collar 1758.49
 Horiz. Trace _____
 Vert. Trace _____
 Date Logged _____

FROM	TO	DESCRIPTION	SAMPLE NUMBER	ASSAY
0	28.1	Casing		
		METASEDS.		
28.1	31.1	From 28.1 to 31.1 dark medium grained - / 90° fine diss. pyrohalite, pyrite & minor chalc.	430	0.01
31.1	34.1	From 31.1 to _____ Fine grained quartzite & chert. At 33.0 a band of pyrite & chalc 0.02 m. wide @ 25° to core.	431	0.002
34.1	37.1	blebs of pyrite & chalc @ 36.5° From 38.0 - 39.5 a few narrow	432	0.021
37.1	40.1	bands & sparsely disseminated pyr. py. chalc & Zns.	433	0.08
40.1	43.1	From 42.0 to 44.6 brecciated zone, recemented with quartz & white actinolite some	434	0.018
43.1	44.6	banding @ 45° to core. Calcite on fractures.	439	0.029
		From 44.6 to 48.3 Fine grained grey cherty seds. Nil min		
		From 48.3 to 49.3 medium grained, altered, garnetiferous seds.		
		End Able		

Logged by A. I. W.



LEGEND
○ 1982 DRILL HOLES

**GEOLOGICAL BRANCH
ASSESSMENT REPORT**
10,800
CANTY MINE
PLAN OF SURFACE DRILL HOLES

Scale: 1:500
0 10 20 30 m.