

82-#917-~~10816~~
12 11010

ASSESSMENT REPORT ON THE
SURPRISE CLAIM
NANAIMO LAKES AREA
BRITISH COLUMBIA
NANAIMO M.D.
NTS 92F/1E
49°05'N, 124°24'W

by

P.W. Conroy, B.Sc.

for

CANAMIN RESOURCES LTD.
(owner and operator)

**GEOLOGICAL BRANCH
ASSESSMENT REPORT**

11,010
CLAIM

SURPRISE

January 13, 1933

TABLE OF CONTENTS

	<u>Page No.</u>
INTRODUCTION.....	1
LOCATION AND ACCESS.....	1
TOPOGRAPHY AND VEGETATION.....	1
CLAIMS.....	1
HISTORY AND WORK PROGRAM.....	4
GEOLOGY.....	5
REGIONAL.....	5
LOCAL.....	5-6
ASSAYS.....	8
DISBURSEMENTS.....	9
CERTIFICATE.....	10

APPENDIX 1

DRILL LOGS HOLES 1-4.....	11
---------------------------	----

ILLUSTRATIONS

FIGURE 1 - GENERAL LOCATION MAP.....	2
FIGURE 2 - LOCATION MAP.....	3
FIGURE 3 - GEOLOGIC MAP.....	7

INTRODUCTION

The purpose of this report is to assess work done on the Surprise Claims in 1982. On December 28, 1982 the author visited the claim, the purpose of which was to map, log core, and examine the property.

LOCATION & ACCESS

The Surprise claim is located in the Nanaimo Lakes district of Vancouver Island, B.C. It lies just north-east of Fourth Lake on Rockyrun Creek. Access to the claim is by four-wheel drive on good logging roads operated by Crown Zellerbach Ltd. (Nanaimo Lakes Div.). The claim is approximately 46 kilometres by road from Cassidy.

TOPOGRAPHY AND VEGETATION

The topography in the area ranges from steep to moderate slopes. The claim itself is in relatively steep terrain, at elevations upwards of 550 metres.

The claim area is in cedar forest, with heavy to low underbrush. Some areas have been logged off.

CLAIMS

The Surprise claim was staked from November 24 to 29, 1982 by Efram Specogna for Canamin Resources, Ltd. The claim is 18 units, 6 west and 3 north.

<u>Claim</u>	<u>Record #</u>	<u>Date Recorded</u>	<u>Expiry</u>
Surprise	1058	Dec. 29, 1981	Dec. 29, 1982

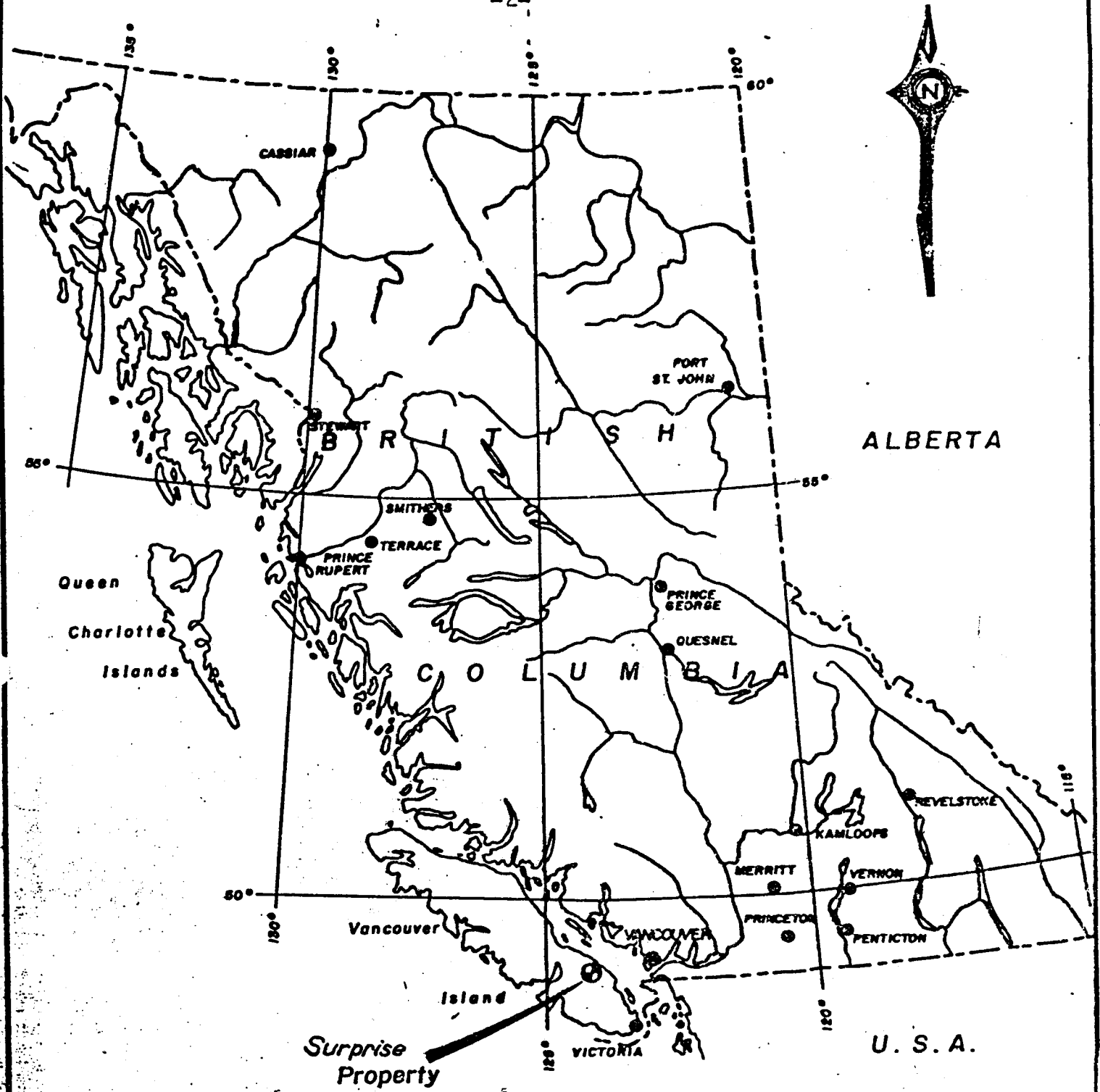

Fig. 1
 GENERAL LOCATION
 OF THE
 SURPRISE PLY.

NANAIMO M.D.

92F/1W

SCALE APPROXIMATELY
 1cm to 87 km.

Fig 2: LOCATION MAP
OF THE

SURPRISE PLY.

NANAIMO M.D.

92F/1W

SCALE: 1:50,000

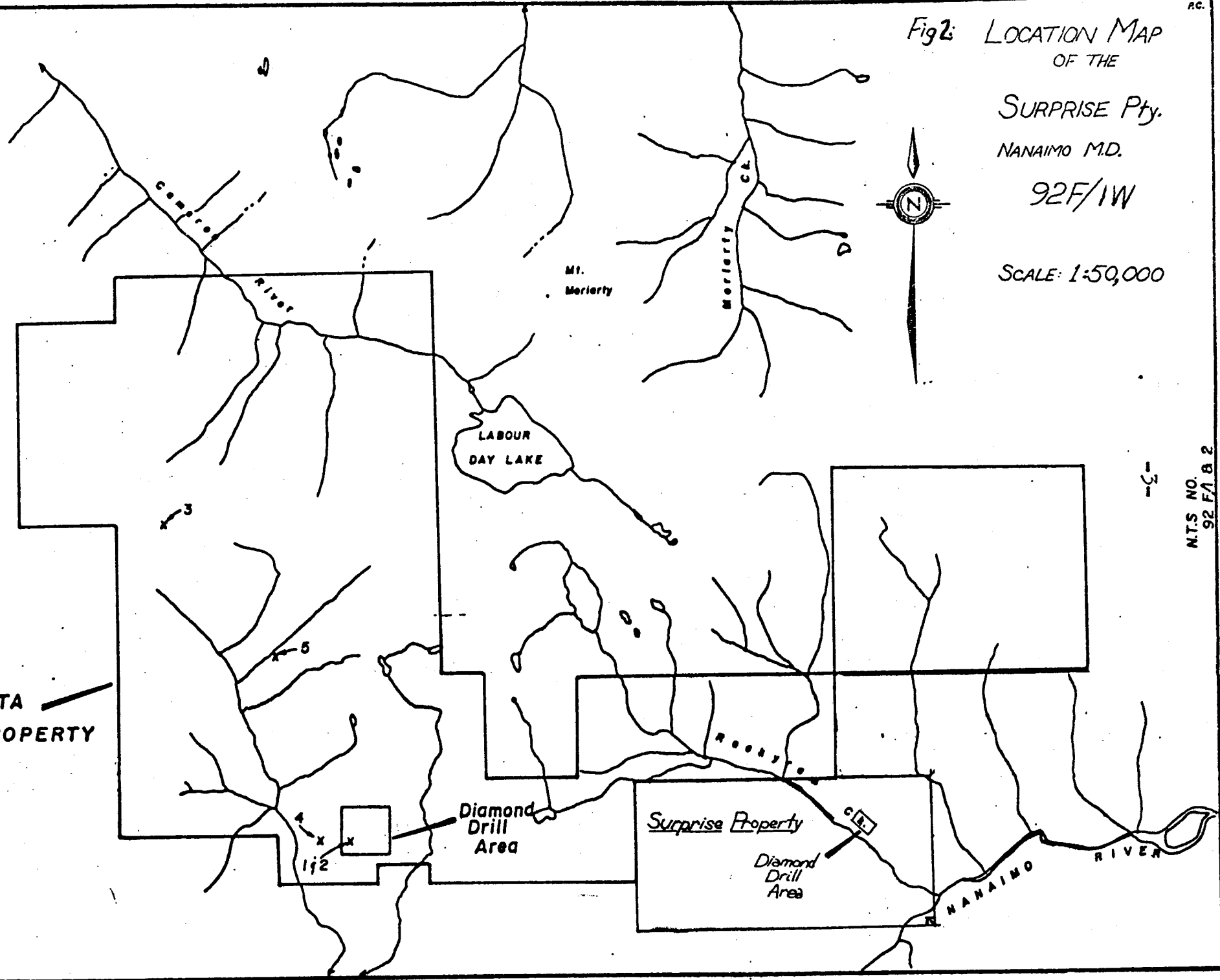

-3-

N.T.S. NO. 92 F1 B 2

VILLALTA
PROPERTY

Diamond
Drill
Area

Surprise Property

Diamond
Drill
Area

NANAIMO
RIVER

LABOUR
DAY LAKE

Mt.
Merlarty

Merlarty
C.R.

Roosevelt

Combs
River

3

5

192

4

C.L.

D

HISTORY

Copper mineralization in the form of malachite was first noticed by Mr. Specogna in 1981, after road repairs were done by Crown Zellerbach crews. The claim was staked in November of that year, and work was done through 1982. One trench (2.5m x 2.5m x 2m) was dug, four diamond drill holes (EXT, approx. 26m), and minor prospecting was done. Ten rock samples were taken on December 28 for assay; eight samples from the core, and two from the trench (assays summarized on a later page).

GEOLOGY

REGIONAL

The claim is in an area consisting primarily of middle Jurassic granodiorites, monzonites, and tonalites. There are some exposures of Triassic Vancouver Group volcanics (Karmutsen formation), and lesser amounts of Paleozoic Sicker Group limestone, tuff, and sediments.

The intrusive bodies are broken by north-westerly and north-easterly trending faults, with the older rocks exposed in faulted sections.

LOCAL

The deposit lies in middle Jurassic Biotite-monzonite, with some tonalite (in cores), and occasional diabasic dykes. Pyrite, chalcopyrite, bornite, tetrahedrite? and molybdenite? (in order of decreasing abundance) were identified in two parallel shears trending 135/70NE. These are from 5 to 20 cm. wide, and are traceable over 200 metres, but appear to be broken up by cross-cutting faults. The shear may be related to a major fault to the north of the claim, which also trends north-east.

Sulfides form from 10% to 100% of the shear fill, along with a dark, chloritic material (diabase?). The sulfides occur as massive, friable masses, as augen, as blebs, and as small veinlets. The shear zones have 5cm silicified envelopes, with up to 5% pyrite.

Also around the shears, the monzonite has been altered, with obvious potassic enrichment, and saussuritized plagioclase. Biotite has been chloritized, and partially replaced by pyrite.

Malachite and tenorite are common alteration minerals, malachite stains being traceable for at least 200 metres.

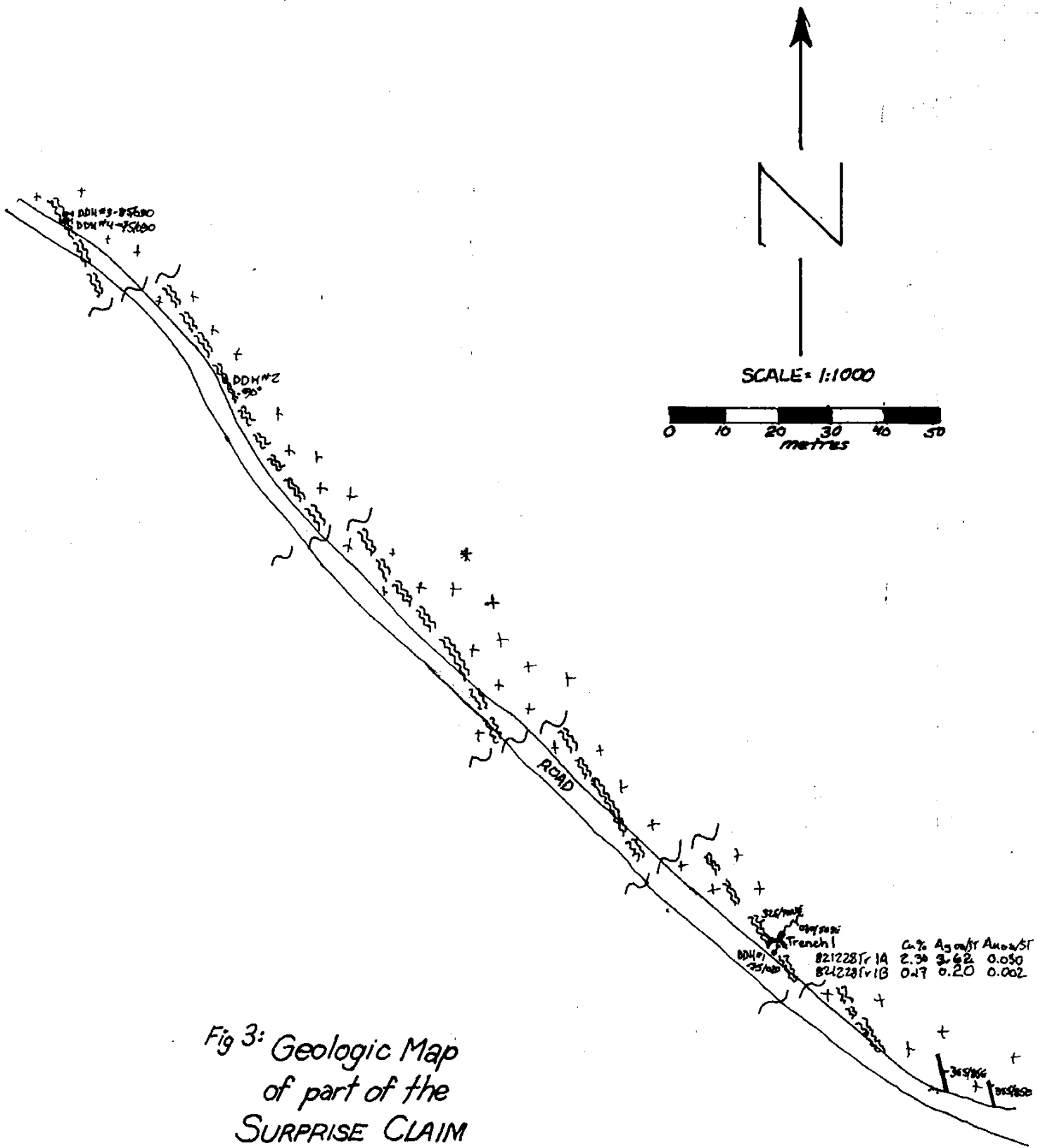

Fig 3: Geologic Map
of part of the
SURPRISE CLAIM

LEGEND: + + BIOTITE MONZONITE
+
/ DIABASE
~~~~~ SHEAR ZONE (ASSUMED)  
~ ~ ~ ASSUMED FAULT

ASSAYS

Ten rock samples were taken on December 28, 1982, two from the trench, and eight from the core. Of the eight core samples, only seven were sent in for assay.

The samples were taken to General Testing Laboratories, and were assayed for copper, silver, and gold.

Results are summarized below:

| <u>Sample #</u> | <u>Copper %</u> | <u>Silver oz/ST</u> | <u>Gold oz/ST</u> |
|-----------------|-----------------|---------------------|-------------------|
| Hole #1         |                 |                     |                   |
| 0' - 12'        | 0.014           | 0.05                | 0.020             |
| 12' - 20'       | 0.023           | 0.20                | 0.006             |
| 20' - 30'6"     | 0.101           | 0.30                | 0.014             |
| Hole #2         |                 |                     |                   |
| 0' - 17'        | 0.054           | 0.22                | 0.020             |
| Hole #3         |                 |                     |                   |
| 0' - 10'        | 0.325           | 0.25                | 0.024             |
| Hole #4         |                 |                     |                   |
| 0' - 5'         | 3.43            | 2.61                | 0.080             |
| 5' - 10'        | 0.50            | 0.93                | 0.072             |
| 821228Tr1A      | 2.30            | 3.62                | 0.030             |
| 821228Tr1B      | 0.17            | 0.20                | 0.002             |

DISBURSEMENTS

Physical Work: one trench, 2.5m x 2.5m x 2m.....\$1000.00  
Drilling: Packsack EXT Diamond Drilling,  
approx. 26 metres @ \$210/metre.....\$5400.00  
Assays: General Testing Laboratories; nine  
samples assayed for Cu, Ag, Au at  
\$16.75 per sample..... \$150.75  
Transportation: one man, Vancouver-Nanaimo return. \$100.00  
Personnel: one man; for examining property,  
logging core, writing report;  
4 days (Dec. 28, 29 1982 & Jan.  
11, 12 1983) @ \$175.00 per day..... \$700.00  
  
TOTAL.....\$7350.75

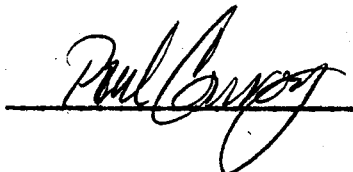

Paul W. Conroy, B.Sc.

January 13, 1983

CERTIFICATE

I, Paul W. Conroy, of the city of Vancouver, British Columbia, do hereby certify that:

1. I graduated from the University of British Columbia in 1982 with a Bachelor of Science degree in geology.
2. I have been practicing my profession as a geologist since May, 1982.
3. I examined the Surprise claim on December 28, 1982.

Dated at Vancouver, B.C. this 4th. day of January, 1983.

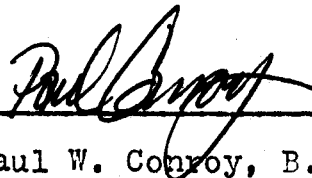
  
\_\_\_\_\_  
Paul W. Conroy, B.Sc.

APPENDIX 1

DRILL LOGS HOLES 1-4

Claim Name: SURPRISE

Hole Number: #1 Drilled by : see below Dip/Bearing : 75/020  
 Total Depth: 9.3 m (30.5') Date Drilled: Nov 15, 1982 Recovery (%): 80%  
 Bit Size : EXT Logged by : Paul Conroy Page 1 of 1

| Depth metres (feet)   | Lithology, etc.                                                                                                                                                                   | Sample #             | Assays |          |          |
|-----------------------|-----------------------------------------------------------------------------------------------------------------------------------------------------------------------------------|----------------------|--------|----------|----------|
|                       |                                                                                                                                                                                   |                      | Cu %   | Ag oz/ST | Au oz/ST |
| 0-3.35 (0-11)         | somewhat altered biotite-monzonite; mottled pink & green<br>-pyrite replacing biotite<br>-pyrite disseminated, or fine fracture fillings<br>-pyrite assoc. with limonite.         | Hole #1<br>0'-12'    | 0.014  | 0.05     | 0.020    |
| 3.35-4.15 (11-13'6)   | less altered biotite-monzonite<br>-some chlorite repl. biotite<br>-very low pyrite<br>-some epidote veins                                                                         | Hole #1<br>12'-20'   | 0.023  | 0.20     | 0.006    |
| 4.15-4.72 (13'6-15'6) | silicified and sausseritized zone, with chloritized biotite<br>-small, thin quartz veins, may contain pyrite and minor chalcopryrite<br>-pyrite to 1%, chalcopryrite less than 1% |                      |        |          |          |
| 4.72-6.20 (15'6-20'4) | as 3.35-4.15; some quartz-pyrite epidote veinlets<br>5.79m: 3-cm. aplite vein, minor sulfides; potassic envelopes                                                                 | Hole #1<br>20'-30'6" | 0.101  | 0.30     | 0.014    |
| 6.20-8.38 (20'4-27'6) | as 4.15-4.72<br>6.86-7.31m: badly fractured<br>7.77m: 6-cm zone with 2% chalcopryrite, malachite coatings<br>7.95-8.08m: as 7.77, less chalcopryrite; some tenorite and malachite |                      |        |          |          |
| 8.38-9.30 (27'6-30'6) | as 0-3.35 metres.                                                                                                                                                                 |                      |        |          |          |

Assays by General Testing Laboratory

Drilled by E. Specogna & R. Wdighill (Packsack EXT Diamond Drilling)

END

Claim Name: SURPRISE

Hole Number: #2

Total Depth: 7.62m (25')

Bit Size : EXT

Drilled by : see below

Date Drilled: Nov. 1982

Logged by : Paul Conroy

Dip/Bearing : vertical

Recovery (%): 70%

Page 1 of 1

| Depth<br>metres (feet) | Lithology, etc.                                                                                                                                                                      | Sample #           | Assays                                        |             |             |
|------------------------|--------------------------------------------------------------------------------------------------------------------------------------------------------------------------------------|--------------------|-----------------------------------------------|-------------|-------------|
|                        |                                                                                                                                                                                      |                    | Cu<br>%                                       | Ag<br>oz/ST | Au<br>oz/ST |
| 0-5.18 (0-17')         | greenish, altered biotite-monzonite; sausseritized and chloritized; some small epidote veinlets with/without pyrite<br>-some silicification<br>-3mm veinlet of pyrite at top of core | Hole #2<br>0'-17'  | 0.054                                         | 0.22        | 0.020       |
| 5.18-7.62<br>(17'-25') | altered biotite-monzonite; pink and green mottled<br>-occasional veinlets of epidote at 10° to axis; some bleaching of walls<br>-some K-spar hematized(?)                            | Hole #2<br>17'-25' |                                               |             |             |
| <u>END</u>             |                                                                                                                                                                                      |                    |                                               |             |             |
|                        | Drilled by E. Specogna &<br>R. Wdighill (Packsack EXT<br>Diamond Drilling)                                                                                                           |                    |                                               |             |             |
|                        |                                                                                                                                                                                      |                    | Assayed by<br>General Testing<br>Laboratories |             |             |

Claim Name: SURPRISE

Hole Number: #3  
 Total Depth: 3.05m (10')  
 Bit Size : EXT

Drilled by : see below Dip/Bearing :-85/090  
 Date Drilled: Nov. 1962 Recovery (%): 75.5  
 Logged by : Paul Conroy Page 1 of 1

| Depth<br>metres (feet) | Lithology, etc.                                                                                                                                          | Sample #          | Assays  |             |             |
|------------------------|----------------------------------------------------------------------------------------------------------------------------------------------------------|-------------------|---------|-------------|-------------|
|                        |                                                                                                                                                          |                   | Cu<br>% | Ag<br>oz/ST | Au<br>oz/ST |
| 0-0.46 (0-1'5)         | dark grey, altered (chloritized)<br>biotite-monzonite(?)<br>-up to 5% chalcopyrite in very<br>fine veins, disseminations, and<br>replacements of biotite |                   |         |             |             |
| 0.46-0.94<br>(1'6-3')  | as 0-0.46m; lighter, no<br>visible sulfides<br>-much limonite on fractures                                                                               | Hole #3<br>0'-10' | 0.325   | 0.25        | 0.024       |
| 0.94-3.05<br>(3'-10')  | pink and green-mottled biotite<br>monzonite; biotite chloritized<br>-limonite on fractures and in<br>biotite (after pyrite replace-<br>ments ?)          |                   |         |             |             |
| <u>END</u>             |                                                                                                                                                          |                   |         |             |             |
|                        | Drilled by E. Specogna and<br>R. Wdighill (Packsack EXT<br>Diamond Drilling)                                                                             |                   |         |             |             |

Assayed by  
 General Testing  
 Laboratories



Claim Name: SURPRISE

Hole Number: # 4  
 Total Depth: 4.88m (16')  
 Bit Size : EXT

Drilled by : see below Dip/Bearing : -75/090  
 Date Drilled: Nov. 1982 Recovery (%): 75%  
 Logged by : Paul Conroy Page 1 of 1

| Depth metres (feet) | Lithology, etc.                                                                                                                                                                              | Sample #          | ASSAYS |          |                                                                              |
|---------------------|----------------------------------------------------------------------------------------------------------------------------------------------------------------------------------------------|-------------------|--------|----------|------------------------------------------------------------------------------|
|                     |                                                                                                                                                                                              |                   | Cu %   | Ag oz/ST | Au oz/ST                                                                     |
| 0-0.76 (0-2'6")     | highly sheared, hematite and limonite-rich chloritic rock, possibly diabase<br>-specks and blebs ("augen") of chalcopyrite and pyrite<br>-chalcopyrite to 5%, pyrite up to 1%, minor bornite | Hole #4<br>0'-5'  | 3.43   | 2.61     | 0080                                                                         |
| 0.76-1.22 (2'6"-4') | dark green, chloritic rock; probably unshered equivalent of 0-0.76m<br>-limonite common on fractures                                                                                         |                   |        |          |                                                                              |
| 1.22-3.05 (4'-10')  | very dark green, chloritized diorite<br>2.44m: 3cm patch of purple bornite; no other sulfides                                                                                                | Hole #4<br>5'-10' | 0.50   | 0.95     | 0072                                                                         |
| 3.55-4.88 (10'-16') | biotite-monzonite; highly sausseritized, and biotite chloritized                                                                                                                             |                   |        |          |                                                                              |
| <u>END</u>          |                                                                                                                                                                                              |                   |        |          |                                                                              |
|                     |                                                                                                                                                                                              |                   |        |          | Assayed by<br>General Testing<br>Laboratories                                |
|                     |                                                                                                                                                                                              |                   |        |          | Note: contacts gradational                                                   |
|                     |                                                                                                                                                                                              |                   |        |          | Drilled by E. Specogna and<br>R. Wdighill (Packsack EXT<br>Diamond Drilling) |



# General Testing Laboratories

A Division of SGS Supervision Services Inc.

1001 EAST PENDER ST., VANCOUVER, B.C., CANADA, V6A 1W2  
 PHONE (604) 254-1647 TELEX 04-507514 CABLE: SUPERVISE

TO:  
**CANAMIN RESOURCES LTD.,**  
 1704 Centenary Drive,  
 Nanaimo, B.C. Canada  
 V9R 5K1

## CERTIFICATE OF ASSAY

No.: 8212-2954      DATE: Jan. 11/83

We hereby certify that the following are the results of assays on: **9 submitted ore samples**

| MARKED          | GOLD  | SILVER | Copper | XXX | XXX | XXX | XXX | XXX |
|-----------------|-------|--------|--------|-----|-----|-----|-----|-----|
|                 | oz/ST | oz/ST  | (Cu) % |     |     |     |     |     |
| <b>HOLE # 1</b> |       |        |        |     |     |     |     |     |
| 0 - 12          | 0.020 | 0.05   | 0.014  |     |     |     |     |     |
| 12 - 20         | 0.006 | 0.20   | 0.023  |     |     |     |     |     |
| 20 - 30'6"      | 0.014 | 0.30   | 0.101  |     |     |     |     |     |
| <b>HOLE # 2</b> |       |        |        |     |     |     |     |     |
| 0 - 17          | 0.020 | 0.22   | 0.054  |     |     |     |     |     |
| <b>HOLE # 3</b> |       |        |        |     |     |     |     |     |
| 0 - 10          | 0.024 | 0.25   | 0.325  |     |     |     |     |     |
| <b>HOLE # 4</b> |       |        |        |     |     |     |     |     |
| 0 - 5           | 0.080 | 2.61   | 3.43   |     |     |     |     |     |
| 5 - 10          | 0.072 | 0.93   | 0.50   |     |     |     |     |     |
| <b>821228</b>   |       |        |        |     |     |     |     |     |
| TR 1 A          | 0.030 | 3.62   | 2.30   |     |     |     |     |     |
| <b>821228</b>   |       |        |        |     |     |     |     |     |
| TR 1 B          | 0.002 | 0.20   | 0.17   |     |     |     |     |     |
| <b>Wiat</b>     |       |        |        |     |     |     |     |     |

NOTE: REJECTS RETAINED ONE MONTH. PULPS RETAINED THREE MONTHS. ON REQUEST PULPS AND REJECTS WILL BE STORE FOR A MAXIMUM OF ONE YEAR.

ALL REPORTS ARE THE CONFIDENTIAL PROPERTY OF CLIENTS. PUBLICATION OF STATEMENTS, CONCLUSION OR EXTRACTS FROM OR REGARDING OUR REPORTS IN NOT PERMITTED WITHOUT OUR WRITTEN APPROVAL. ANY LIABILITY ATTACHED THERETO IS LIMITED TO THE FEE CHARGED.

L. Wong

PROVINCIAL ASSAYER

Analytical and Consulting Chemists, Bulk Cargo Specialists, Surveyors, Inspectors, Samplers, Weighers

MEMBER: American Society For Testing Materials • The American Oil Chemists Society • Canadian Testing Association  
 REFEREE AND OR OFFICIAL CHEMISTS FOR: National Institute of Oilseed Products • The American Oil Chemists' Society  
 OFFICIAL WEIGHMASTERS FOR: Vancouver Board Of Trade