

83-#44-#11053 1

DIAMOND DRILLING PROGRAM CONDUCTED ON
FALCON 3 MINERAL CLAIM OF FALCON GROUP
AT MOUNT FORSTER NEAR HORSETHIEF CREEK
INVERMERE, B.C.
IN THE GOLDEN MINING DIVISION

LOCATION: MAP B2K/9W
LAT. $50^{\circ} 35' N.$
LONG. $116^{\circ} 20' W.$

OWNER: ART LOUIE
M. LARABEE
OF WILMER, B.C.

OPERATOR: AIRBORNE GEOPHYSICAL SURVEYS LTD.
4215A - 11 STREET N.E.
CALGARY, ALTA.
T2E 6K4

CONSULTANT: R. GALESKI
M. MCCORMIE

AUTHOR: J. CARTER, GEOL.

DATE SUBMITTED: JANUARY 26, 1983

**GEOLOGICAL BRANCH
ASSESSMENT REPORT**

11-053

TABLE OF CONTENTS

	<i>Page.</i>
<u>INTRODUCTION:</u>	
1) LOCATION & ACCESS	1
2) HISTORY OF PROSPECT	1
3) SUMMARY OF WORK DRILLING	5
4) LIST OF CLAIMS	6
<u>INTERPRETATION:</u>	
1) CORE LOGS	13
2) CROSS-SECTION OF DRILLING	7
3) RESULTS	8
4) LOCATION OF CORES	8
<u>COST STATEMENTS:</u>	
INVOICES	9
<u>QUALIFICATIONS</u>	10 - 12

1) LOCATION & ACCESS

The Falcon claims are located 12 miles west of Radium Hot Springs and one mile north of the HORSETHIEF RIVER at an elevation of 6,000 feet.

The location of the 1982 drilling is approx:

Lat. 50^o 35' N

Long. 116^o 20' W

This area is approx. 2 miles ~~South~~ west of Mt. Forster.

Access is by gravel road west from Radium Junction and by a logging road from the Horsethief River to the drill sites.

2) HISTORY OF PROSPECT

The area has been prospected for the past 10 years by two local prospectors.

G. LARABEE

ART. LOUIE

who have found scattered Barite in float and debris in the area. Several outcrops mineralized by Barite have also been found and sampled.

From 1980 - 81 Geochemical and geophysical surveys were conducted over a large area and several drill holes checked anomalies.

Minor Barite was cored but not of commercial quantities.

Three more drill holes were cored in 1982 to verify the structure. This work was conducted by Airborne Geophysical Surveys Ltd. of Calgary, Alta.



LEGEND

CROWN-GRANTED MINERAL CLAIM

REVERTED C.G. MINERAL CLAIM

FORFEITED MINERAL CLAIM

VERIFIED LEGAL CORNER POST

LEGAL SURVEY

LEGAL CORNER POST # TAG NUMBER ©12345

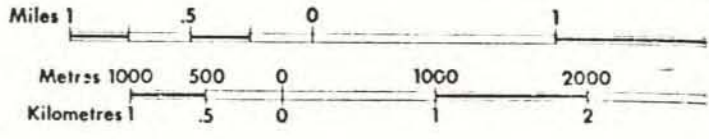

TO EAST SEE MAP 82K/9

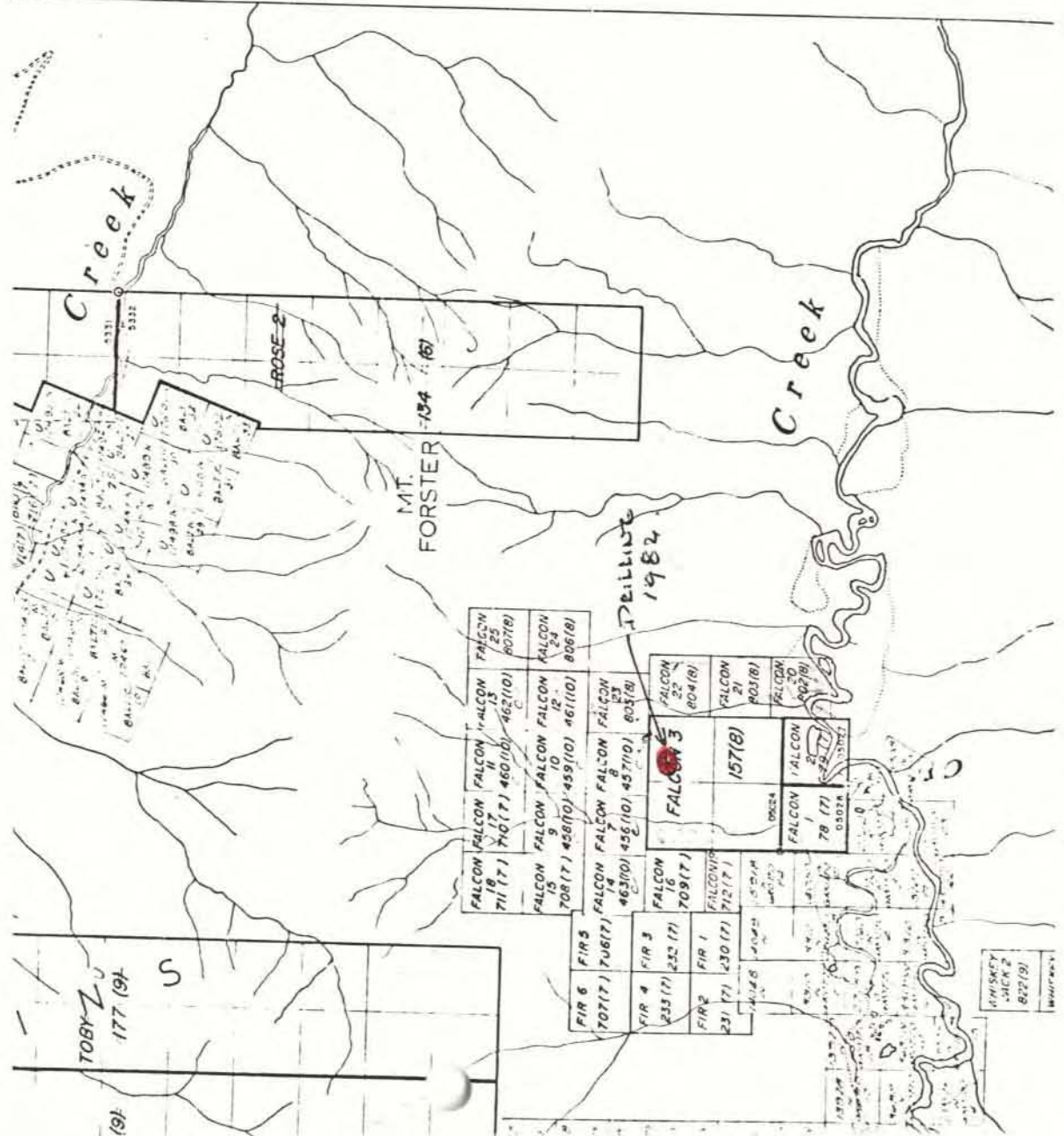

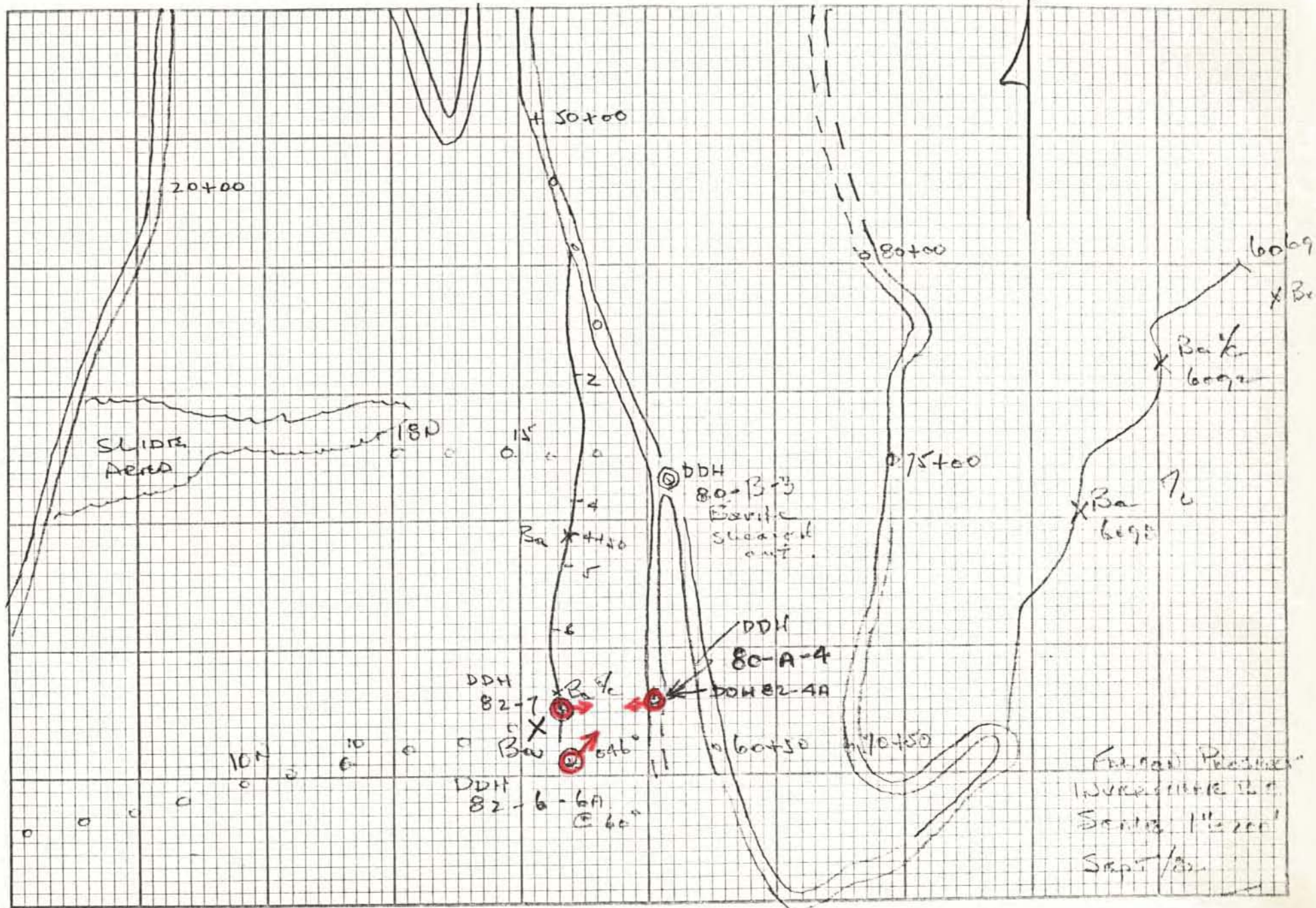

5

3) SUMMARY OF DRILLING

DDH F82-6 was a vertical hole to T.D. 122 feet with AQ - wireline diamond core. This hole cored Barite veins which are visible as outcrop 50 feet westerly.

DDH F82-6A was an angle hole NE at 60° dip which intersected the same veins of Barite at shallow depth. The total depth was 103 feet.

DDH F 82-7 was drilled -60° easterly from a site approx. 80 feet N of DDH F 82-6 at elevation 5864'. These cores indicated the same Barite veins persist northwards at a higher elevation and decreasing thickness.

DDH F82-4A was directed westerly @ 15° dip from an old drill hole F80-A-4 at an elevation of 5970 or 100' above DDH F82-6. This hole was cored to gain information between DDH F80-4 and DDH F82-6.

Only minor Barite was encountered as the core barrel stuck at 166' depth and the hole abandoned.



Falcon
25
807(8)

Falcon
24
806(8)

Falcon
23
805(8)

DDH's/82

Falcon
22
804(8)

Falcon

3
157(8)

Falcon
21
803(8)

Falcon
1
78(7)

Falcon
2
79(7)

Falcon
20
802(8)

FALCON
CHAIN GROUP

Nov/82

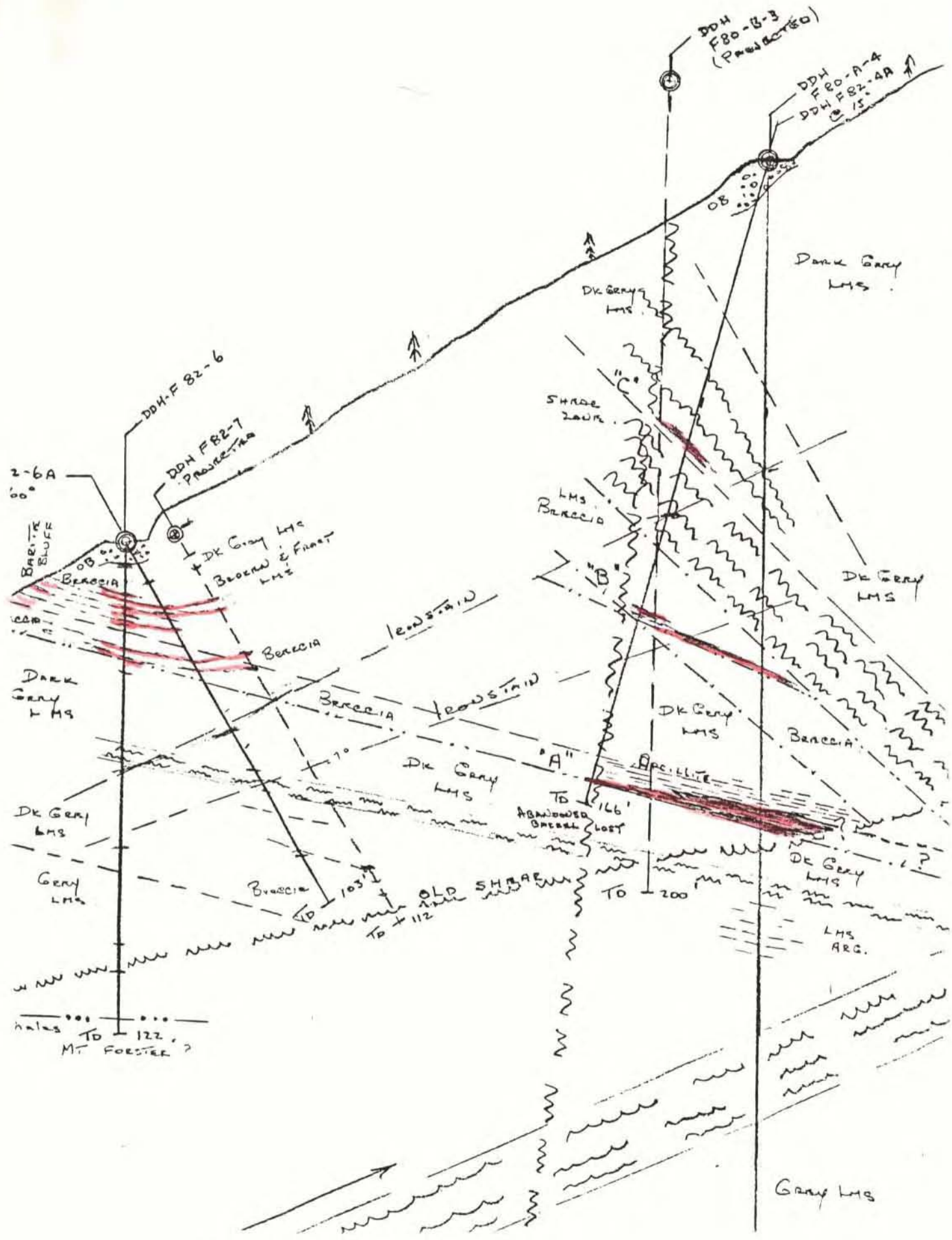

3) INTERPRETATION RESULTS

The formations logged appear to be the Starbird formation (Devonian) composed of sheared faulted, brecciated, limy dolomites and dolomitic limestones.

A few lenses of Argillites were cored and the Barite mineralization appears hydrothermal in origin and trying to replace in limy sections.

Most of the Barite mineralization cored appeared to be fault filling along zones of weakness and sheared in parts by post ore movement.

Only minor sheared veins or lenses of Barite were encountered.

4) The Cores are Stored in Calgary at:

AIRBORNE GEOPHYSICAL SURVEYS LTD.
42150 - 11 STREET N.E.
CALGARY, ALBERTA
T2E 6K4

August 13, 1982
Gordon Larrabee
Box 471, Invermere B.C.
VOA IKO Ph. 604-342-9691

~~_____~~ Please note

Mr. R.B. Galeski;

AQ. D.D.H. B2-

F5 ---- 122 ft.
F6 ---- 173 ft.
F7 ---- 112 ft.

#582

	337 ft. at \$15.00 per foot =	\$5755.00
13 AQ. core bores -----		\$ 130.00
Moving water line, instalation, work with cat and		
wages paid out -----		\$ 300.00
		<u>\$5485.00</u>

October 8, 1982
Gordon Larrabee
Box 471, Invermere
VOA IKO Ph. 604-342-9691

Airborne Geophysical Surveys Ltd.
Mr. R.B. Galeski:

D.D.H. F 32 - 4 A

166 ft. at \$15.00 per foot -----	\$ 2,490.00
4 AQ. core boxes at \$10.00 per box -----	\$ 40.00
	<u>\$ 2,530.00</u>

Falsen

TOTAL COST
DIAMOND DRILLING = \$ 8015.00

7a

Month of July 19 82

IN ACCOUNT WITH
WINSER TIMBER LTD.

Box 366, Invermere, B.C. V0A 1K0

~~R.P.G. "Sp!"
Airborne Geophysical Services Ltd.~~

4215C - 11th Street N.E.

Calgary Alberta.

July	24	Invoice #	28819	675.	00	✓
"	25	"	# 28820	487.	50	✓
"	26	"	# 28821	346.	50	✓
"	26	"	# 28822	750.	00	✓

RECEIVED PWS
9 1982

2259.00

Aug 4/82

28824

600.00

Aug 5/82

28825

589.00

Total Est. Work

3448.00



Airborne Geophysical Surveys Ltd.

CALGARY ————— ALBERTA

10
4215C - 11TH STREET N.E.
CALGARY, ALBERTA T2E 6K4
PHONE: (403) 276-9032

STATEMENT OF QUALIFICATIONS

I, Robert B. Galeski, state that;

1. I am a registered professional geophysicist in the province of Alberta.
2. I reside near Calgary, Alberta.
3. I received a B.Sc. degree in geology from the California Institute of Technology.
4. I have had thirtyseven years professional experience in geology and geophysics.
5. For the past fifteen years I have been a geophysical consultant and president of Airborne Geophysical Surveys, Ltd.

Robert B. Galeski

Robert B. Galeski.
P. Geoph.
April, 1981.



Airborne Geophysical Surveys Ltd.

CALGARY ————— ALBERTA

4215C - 11TH STREET N.E.
CALGARY, ALBERTA T2E 6K4
PHONE: (403) 276-9032

STATEMENT OF QUALIFICATIONS

I Michael McCombe. #5, 27 Silverspring Dve. N.W. Calgary,
state that

1. Mt. Allison University.
2. Have been active in Mining Exploration for 33 years.
3. Have operated Wordon, Sharp & LaCoste & Romberg gravity meters since 1964.
4. Compute Gravity Data up to and including Bouguer and residuals.
5. Presently Party Manager (Gravity Division) for Airborne Geophysical Surveys Ltd. Calgary, Alberta.

M. McCombe

M. McCombe.

STATEMENT OF QUALIFICATIONS

I, John S. Carter, P. Geol. of Calgary, Alberta do hereby certify:

1. I am a Geologist with residence at:
4019 Dalarna Bay N.W.
Calgary, Alberta
T3A 1G8
2. I am a graduate of McGill University, Montreal, P.Q.
BSc. 49 (Geol.).
3. I am a registered Professional Geologist - Alberta and
a member of the C.I.M.M.
4. I have worked as an exploration geologist 30 years mainly
in Western Canada and several Foreign Countries on Petroleum,
Coal, Industrial Minerals and Sulphides.
5. I have been engaged in Mineral Exploration in the Province
of British Columbia for approximately 20 years.
6. I have been engaged in both Airborne & Ground Geophysical
surveys and am familiar with both conducting and interpreting
Geophysical & Geochemical Survey Data.

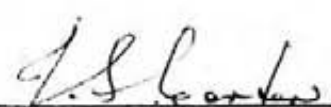

J. S. Carter
P. Geol. (Alta.)

FALCON - MINERAL - PROSPECT

INVERMERE, B.C.

CORE LOGS DRILLED SUMMER, 1982

R. GALESKI

R. GALESKI

COMPANY

DDH No. FB2-4A CLAIM FALCON

LOCATION 15° West from DDH FB2-A-4

DIP ANGLE DATE July/82 PAGE 2

CORED DESCRIPTION

CORED FOOTAGE

INTER-VAL

Logged by JSC.

VISIBLE MINERALS ESTIMATED

SAMPLE

INTER-VAL

From To Feet

Sediment-Metapelite-Igneous

Mineral % No. Feet

Percent

Assays oz. per ton

Cu Pb Zn Ag Au ~~Pb~~ ~~Se~~ ~~A~~ ~~Gr~~

40 - 47 7 Core More Massive @ 60° Qtz. along bedding as breccia Lms. inc. Argillaceous in part.

NS

47 - 53 6 As above Argillaceous Lenses. Beds @ 60° Shearing infilled with Qtz. Breccia Broken Rubble Argillaceous Tr. Red Brown Stain

NS

54 - 60 6 Grey Mottled Dolomitic LMS. Hard Dense Qtz. along beds @ 70 - 80° F.R. Box 2

NS

61 - 63 2 As above Beds 50°

63 - 68 5 Few pieces of core Rec. 6" Sk. Sh. - Argillite & Qtz contact @ 60° Traces of Barite?

(S)

63-68 5.0

68 - 71 3 Recovered 2.0' Cored 3.0' Dk. grey Argillaceous LMS. Breccia Calcite & Qtz Veinlets. Beds ? 30°

NS

71 - 74 3 Broken Core Rubble. Shearing Mainly Breccia. Lost Core 2.0' Rec. 1.0' Trace Barite

(S)

71-74 3.0

74 - 76 2 Full Recovery. Grey Mottled Dolomitic LMS. Mainly Veinlets, Qtz. & Calcite. Beds 30 - 40°

NS

Indications of shearing along drill core

NS

Trace

11.90%

R. GALESKI

COMPANY

DDH No. F02-4A CLAIM FALCON

LOCATION 15⁰ West from DDH F02-A-4

DIP ANGLE DATE July/82 PAGE 4

CORED DESCRIPTION

CORED FOOTAGE

INTER-VAL

Logged by J.S.C.

VISIBLE MINERALS ESTIMATED

SAMPLE

INTER-VAL

From To Feet

Sediment-Metaphroto-Igneous

Mineral % No. Feet

Percent Assays oz. per ton

Cu Pb Zn Ag Au Ba SO₄ Sp. Co

138 - 143 5

138' - 1 Pc Barite % Ba SO₄
Beds 20' - 30'. Rec. 3.0'
Shearing along core Box 3

NS

143 - 155 12

Cored 12.0' Rec. 7.0' Dk. grey LMS
Siliceous Sheared & broken rubble
No Distinct Bedding (149 - 158)
Sample for Ba. Replacement.

(S)

149-158 9.0

3.18%

155 - 158 3

Rec. 0.5' Traces of Barite
Few crystals

(S)

158 - 162 4

Rec. 1.0' Traces of Barite (159 -
160') in Dk. grey LMS. Siliceous

(S)

159-160 1.0

18.94%

162 - 166 4

Rec. 1.0' Hard Dense Siliceous Grey
LMS. Tr. Barite X'ls in Fracture

NS

166 - TD

Stuck Pipe Lost Core Barrel & Bit
Abandoned in Hole.

R. Galeski

COMPANY

DDH No. F 82-6A CLAIM Falcon

LOCATION 160' SW of DDH F00-A-4 Elev 5874' -

DIP ANGLE -60° DATE July/82 PAGE 2

CORED DESCRIPTION

CORED FOOTAGE

INTER-VAL

Logged by J.S.C.

VISIBLE MINERALS ESTIMATED

SAMPLE

INTER-VAL

From To Feet

Sediment-Metaphro- Igneous

Mineral % No. Feet

Percent Assays oz. per ton
Cu Pb Zn Ag Au Sn. Cr.

85 - 88 3 Dk. Grey LMS. Fractured
Tr. Calcite only Box 3

NS

88 - 103 15 Buff Dolomite & Grey Interbedded LMS.
Breccia in Part. Beds 45°
Can Be Vert. or 20° to Horizontal.
Tr. Ba. @ 89'

Ba.

89

24.17

103 TO Elev. 5770' Box 4

