

83-#283-#1181

COMINCO LTD.

EXPLORATION

WESTERN DISTRICT

NTS: 104K/12E

(ASSESSMENT REPORT)

GEOCHEMICAL & GEOLOGICAL REPORT

FOR GOAT I CLAIM

ATLIN MINING DIVISION,

TAKU RIVER AREA, B.C.

**GEOLOGICAL BRANCH
ASSESSMENT REPORT**

Latitude : 58°40'N

Longitude : 133°30'W

11,181

Work Performed : September 4, 1982

Owner and Operator : Cominco Ltd.

JULY 18, 1983

J. PAUL SORBARA

TABLE OF CONTENTS

	PAGE
INTRODUCTION	1
GEOCHEMICAL SURVEY	1
GEOLOGICAL SURVEY	1
INTERPRETATION	2
APPENDIX I	STATEMENT OF EXPENDITURES
APPENDIX II	STATEMENT OF QUALIFICATIONS
PLATE 1	INDEX AND CLAIM LOCATION (IN ENVELOPE)
PLATE 2	GEOCHEMICAL SURVEY (CU/PB/ZN) (IN ENVELOPE)
PLATE 3	GEOCHEMICAL SURVEY (AU/AG) (IN ENVELOPE)
PLATE 4	GEOLOGY (IN ENVELOPE)

COMINCO LTD.

EXPLORATION

WESTERN DISTRICT

NTS : 104K/12E

18 JULY 1983

ASSESSMENT REPORT
GEOCHEMICAL & GEOLOGICAL REPORT
FOR GOAT I CLAIM
ATLIN MINING DIVISION,
TAKU RIVER AREA, B.C.

INTRODUCTION

The GOAT I mineral claim is located on the north side of the Taku River Valley, east of the peak of Mt. Manville, and is centered at $58^{\circ}40'N$ and $133^{\circ}30'W$. Access to the property is by helicopter, usually from Atlin, B.C. The property was staked in July 1982 and 100% owned by Cominco Ltd.

GEOCHEMICAL SURVEY

On September 4, 1982, two north-to-south, soil sampling traverses were completed in the central area of the Goat claim. The sampling was done by S. B. Noakes, a Cominco technician, and an assistant, Chris Parisien, who resides near the site. In total, 70 B-Horizon soil samples were taken at 25 metre intervals. Distances were measured with a hip chain and sample locations were plotted on Air Photo BC 5614, No. 182 (see Plates 2 and 3). Twenty-nine of the samples were analyzed for Cu, Pb, Zn, Ag and Au, in the Cominco Exploration Lab. in Vancouver. Hot extraction using 20% HNO_3 , followed by atomic absorption analysis, was used to obtain the geochemical results.

GEOLOGICAL SURVEY

The geological work conducted on the Goat Claim on September 4, 1982 consisted of one traverse conducted by the author. Outcrop locations, etc were plotted on the same air photo base used for the soil sampling. Rocks along this traverse were found to comprise mainly rhyolite and andesite with minor shale-sandstone. Basalt float was found in a major creek running north-south through the claim.

Sedimentary rocks were found to be striking at about 140° with near vertical dips. The volcanic rocks were massive in nature with minor disseminated pyrite being the only sulphide mineralization seen (see Plate 4).

INTERPRETATION

The geochemical survey results show a cluster of higher-than-average values for Cu, Pb and Zn in the southwest part of the area sampled. Gold and silver values were not significantly high in this same area. Geologic mapping shows that outcrop close to the anomalous soil samples is andesite with only minor pyrite. The source of the anomalous Cu/Pb/Zn values is unknown.

Report by: J. Paul Sorbara
J. P. Sorbara
Geologist

Endorsed by: F. D. Gill
F. D. Gill
Assistant Manager,
Exploration, Western District

Approved for
Release by: G. Harden
G. Harden
Manager,
Exploration, Western District

JPS/jel

Distribution:

Mining Recorder	(2)
W.D. Files	(1)
J.P. Sorbara	(1)

APPENDIX I

STATEMENT OF EXPENDITURES

SALARIES

J. Paul Sorbara	1 day @ \$173/day	\$ 173.00	
S.B. Noakes	1 day @ \$120/day	120.00	
C. Parisienne	1 day @ \$100/day	100.00	\$ 393.00

MOB AND DEMOB

Access to Area (\$1,483.50 of which 20% applied to Goat Claim work)	296.70
Helicopter from Base Camp to Goat Claim & Back	855.00

GEOCHEMISTRY

29 Soil Samples @ \$9.10/sample	263.90
---------------------------------	--------

EXPENSE ACCOUNTS

S. B. Noakes	88.90	
J. P. Sorbara	168.93	257.83

FOOD AND LODGING

(Base Camp)	120.00
-------------	--------

TOTAL EXPENDITURES	<u>\$ 2,186.43</u>
--------------------	--------------------

Signed:

J. Paul Sorbara
J. P. Sorbara
Geologist

18 JULY 1983

APPENDIX II

STATEMENT OF QUALIFICATIONS

I, J. PAUL SORBARA, OF THE CITY OF NORTH VANCOUVER, IN THE PROVINCE OF BRITISH COLUMBIA, HEREBY CERTIFY:-

1. THAT I am a geologist residing at 1209 - 2012 Fullerton Avenue, North Vancouver, British Columbia, with a business address at 409 Granville Street, Vancouver, British Columbia;
2. THAT I graduated with A B.Sc. in geology from the University of Toronto, Toronto, Ontario in 1976, and with a M.Sc. in geology from the University of Toronto in 1979.
3. THAT I have practised geology with Cominco Ltd. from 1979 to 1983.

Signed:

J. Paul Sorbara
J. Paul Sorbara, M.Sc.
Geologist, Cominco Ltd.

18 JULY 1983

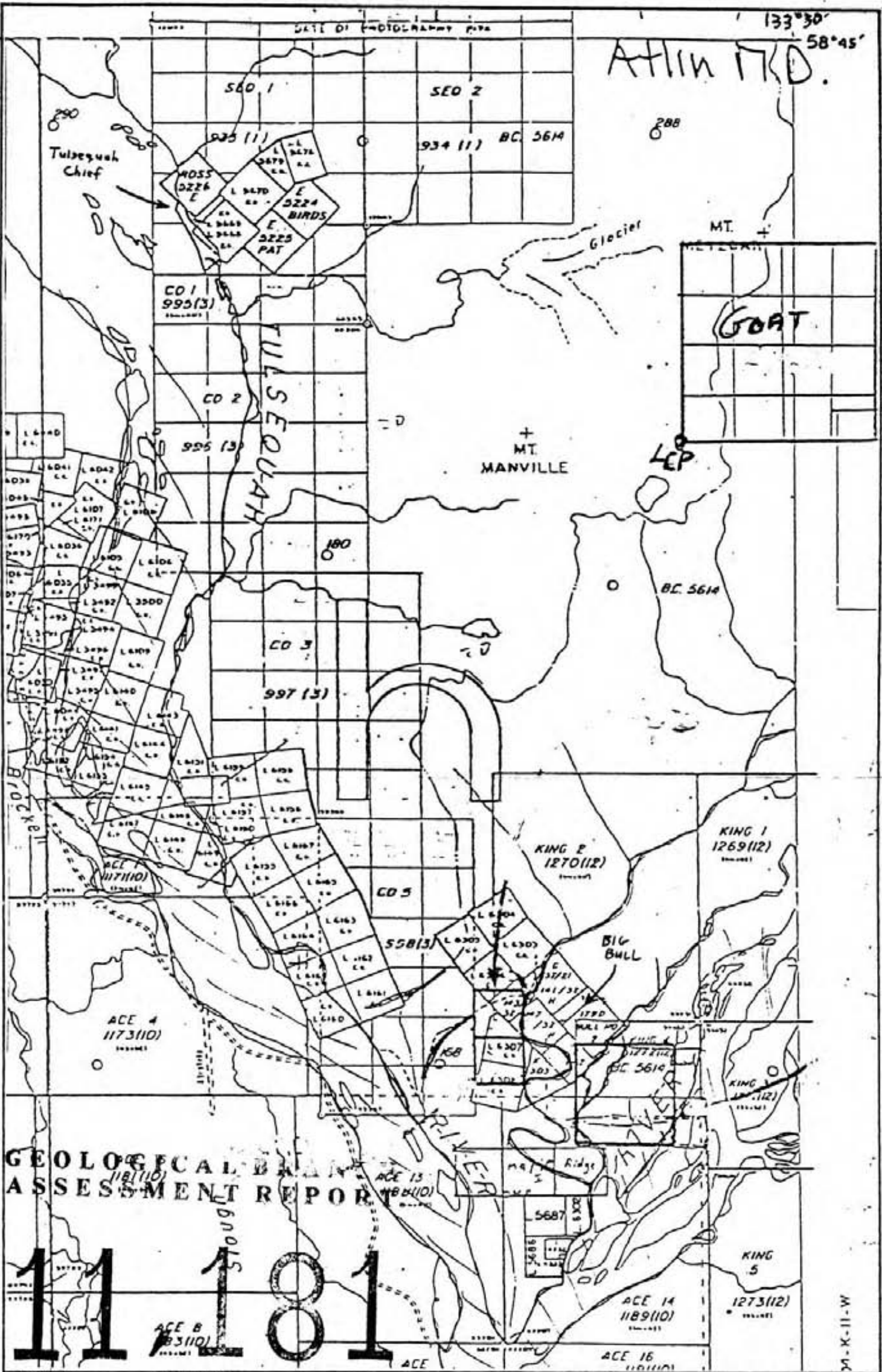

GEOLOGICAL ASSESSMENT REPORT

11181

Drawn by:		Traced by:	
Revised by:	Date	Revised by:	Date

Goat Claim
Index and Claim Location
(From Minerals Titles Reference Map 104K/12E)

Scale: 1:50,000 Date: October 1982 Plate: 1

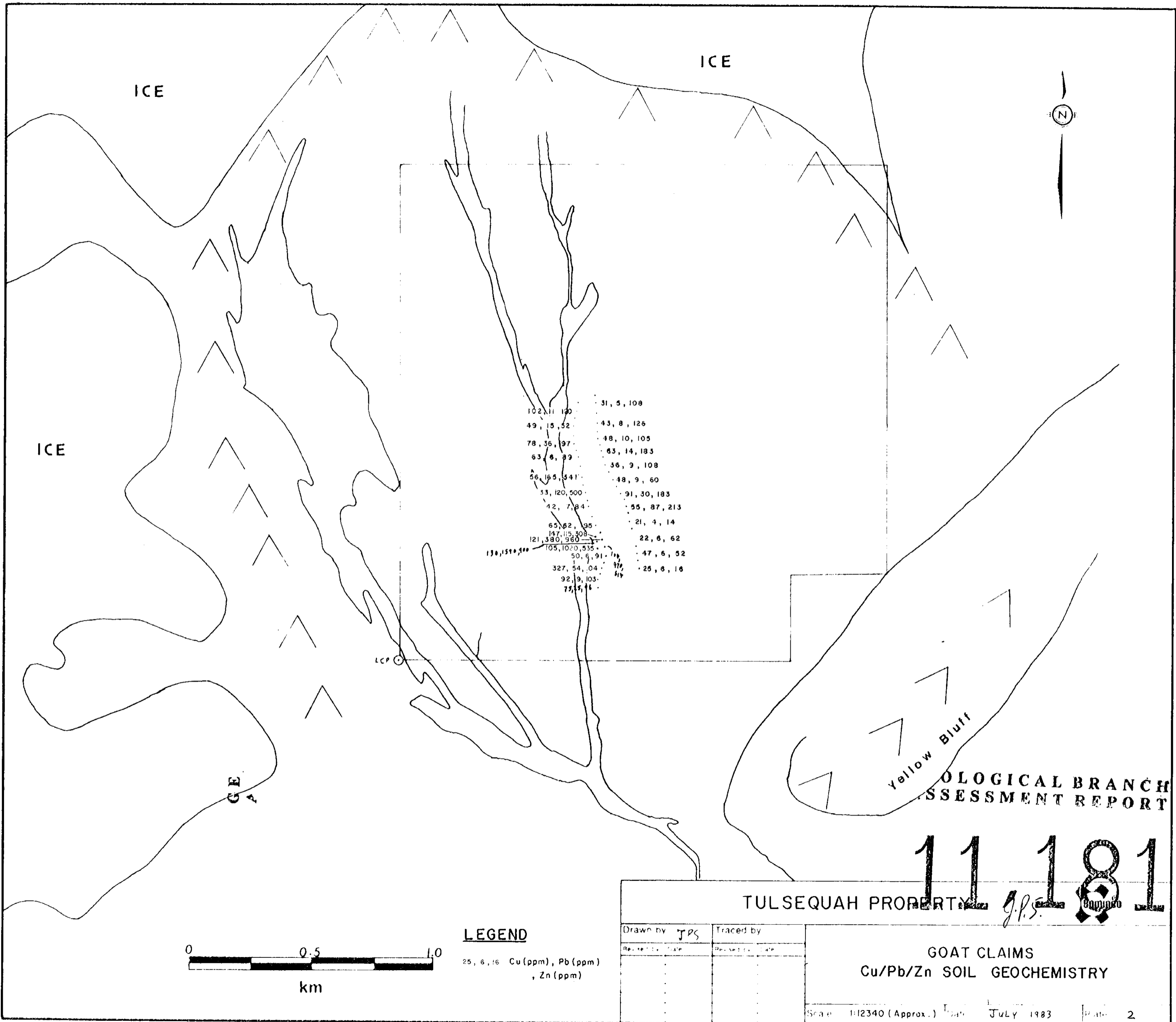

102, 11, 130	31, 5, 108
49, 15, 52	43, 8, 126
78, 36, 97	48, 10, 105
63, 8, 39	63, 14, 183
56, 165, 341	36, 9, 108
33, 120, 500	48, 9, 60
42, 7, 84	91, 30, 183
65, 62, 95	55, 87, 213
147, 115, 308	21, 4, 14
121, 380, 980	22, 6, 62
130, 1510, 300	105, 1020, 535
50, 6, 91	47, 6, 52
327, 54, 04	25, 8, 18
92, 9, 103	
75, 5, 16	

GEOLOGICAL BRANCH
ASSESSMENT REPORT

11181

TULSEQUAH PROPERTY

J.P.S.



LEGEND

25, 6, 16 Cu (ppm), Pb (ppm), Zn (ppm)

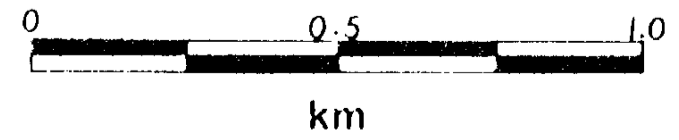

Drawn by <i>J.P.S.</i>	Traced by
Reviewed by	Checked by



GOAT CLAIMS
Cu/Pb/Zn SOIL GEOCHEMISTRY

ICE

ICE

ICE



- 1.  rhyolite
- 2.  andesite
- 3.  shale

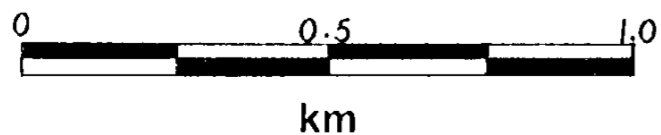

LCP

Yellow Bluff

GEOLOGICAL BRANCH
ASSESSMENT REPORT

11 g.p.s. 131
Comme

Drawn by: JPS		Traced by:	
Revised by	Date	Revised by	Date

GOAT CLAIMS
GEOLOGY

Scale: 1:12340 (APPROX) Date: JULY, 1983 Plate: 4

ICE

ICE

ICE



LCP

<10, .4	<10, .4
<10, .4	<10, .4
<10, .4	<10, .4
<10, .4	<10, .4
<10, .4	<10, .4
<10, .4	<10, .4
<10, 1.2	<10, .4
<10, .9	<10, .8
12, .4	<10, .4
<10, .4	<10, .4
<10, 1.2	<10, .4
<10, 1.8	<10, .4
<10, 2.0	<10, .4
<10, .4	<10, .4
<10, 2.4	<20, .4
<10, .4	

Yellow Bluff

GEOLOGICAL BRANCH
ASSESSMENT REPORT

11.18.81

TULSEQUAH PROPERTY *J.P.S.*

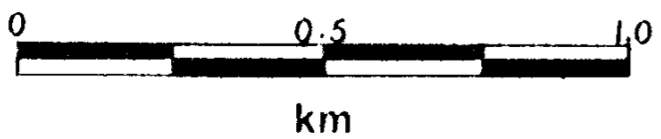

LEGEND

<10, .4 Au(ppb), Ag(ppm)

Drawn by: <i>JPS</i>	Traced by:		
Revised by	Date	Revised by	Date

GOAT CLAIMS
Au/Ag SOIL GEOCHEMISTRY

Scale: 1:12,340 (Approx) Date: JULY, 1983 Plate: 3