

PERCUSSION DRILLING REPORT ON THE NED 2
MINERAL CLAIM (RECORD NO. 385)

50° 39' N; 120° 33' W. NTS 921/10E

KAMLOOPS MINING DIVISION
AFTON OPERATING CORPORATION

by

LORNE A. BOND
Senior Geologist

**GEOLOGICAL BRANCH
ASSESSMENT REPORT**

11,275

March 18, 1983

Kamloops, B.C.

TABLE OF CONTENTS

INTRODUCTION	Page 1	/
DRILLING RESULTS	3	/
ASSAY RESULTS	5	/
STATEMENT OF COSTS	6	/
AUTHOR'S QUALIFICATIONS	7	/

MAPS

INDEX MAP 1: 50,000	Page 2	/
SURFACE PLAN 1: 4800	4	/

PERCUSSION DRILLING REPORT ON THE
NED 2 MINERAL CLAIM (RECORD NO. 385)

50° 39' N; 120° 33' W. NTS 921/10E

KAMLOOPS MINING DIVISION
AFTON OPERATING CORPORATION

Introduction

The Ned 2 mineral claim is part of the Ned Group of mineral claims consisting of:

Ned 1	Record No. 384	3 units
Ned 2	Record No. 385	3 units
Ned 3	Record No. 386	1 unit
Ned 4	Record No. 2499	4 units

The Ned Group is located approximately 16 km West of Kamloops, Situated West of the Afton Operating Corporation mine site and lying between the Trans-Canada Highway and the Cherry Creek-Dominic Lake Road.

The Ned 2 mineral claim was located by A.J. Reed, Agent for Afton Operating Corporation in May 1976.

During the period February 12-14, 1983, a percussion drilling program was carried out on the Ned 2 claim by Afton Operating Corporation. Percussion Hole Q-256, 5 cm in diameter was drilled to a depth of 27.4 meters. The purpose of the program was to determine the Kamloops Group - Nicola Volcanics distribution on the claim and to test for copper mineralization. Samples were collected in 3.1 meter intervals in bedrock and assayed for copper.

The hole was stopped short of the planned depth when a major break or discontinuity was encountered causing a loss of return water. The section of the hole completed was in Kamloops Group volcanic rocks. Copper values were negligible.

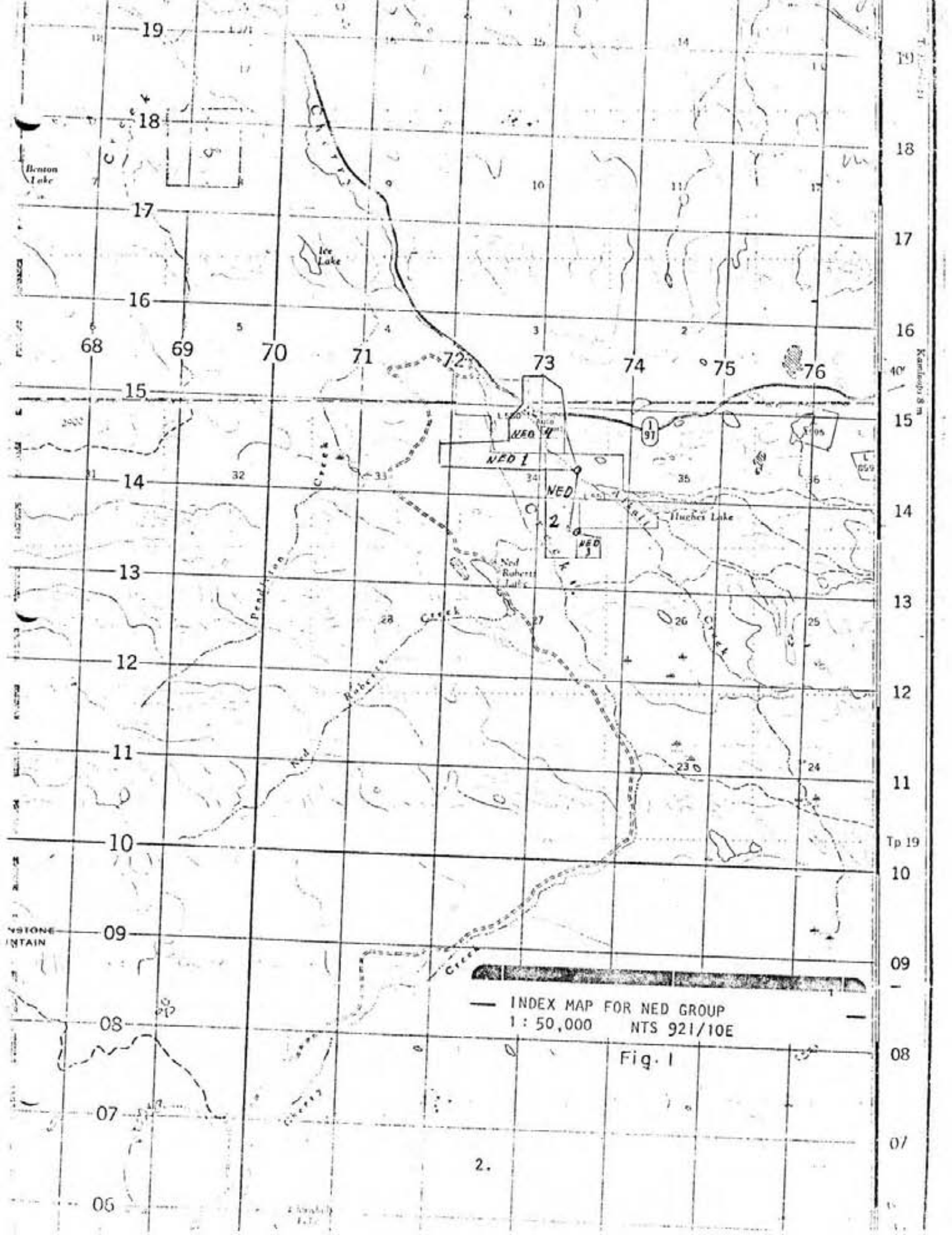

INDEX MAP FOR NED GROUP
 1:50,000 NTS 921/10E

Fig. 1

DRILLING RESULTS

(Coordinates are Afton Mine grid)

Q-256	Latitude:	9323.98 N
	Departure:	46.47 E
	Elevation:	2291.21
	Depth to Bedrock:	4.6 meters
	Bedrock:	Yellow-brown Kamloops Group volcanics. No visible sulphide mineralization.
	Remarks:	Break or discontinuity at 27.4 meters resulted in a loss of return water and the hole was stopped.
	Total Depth:	27.4 meters

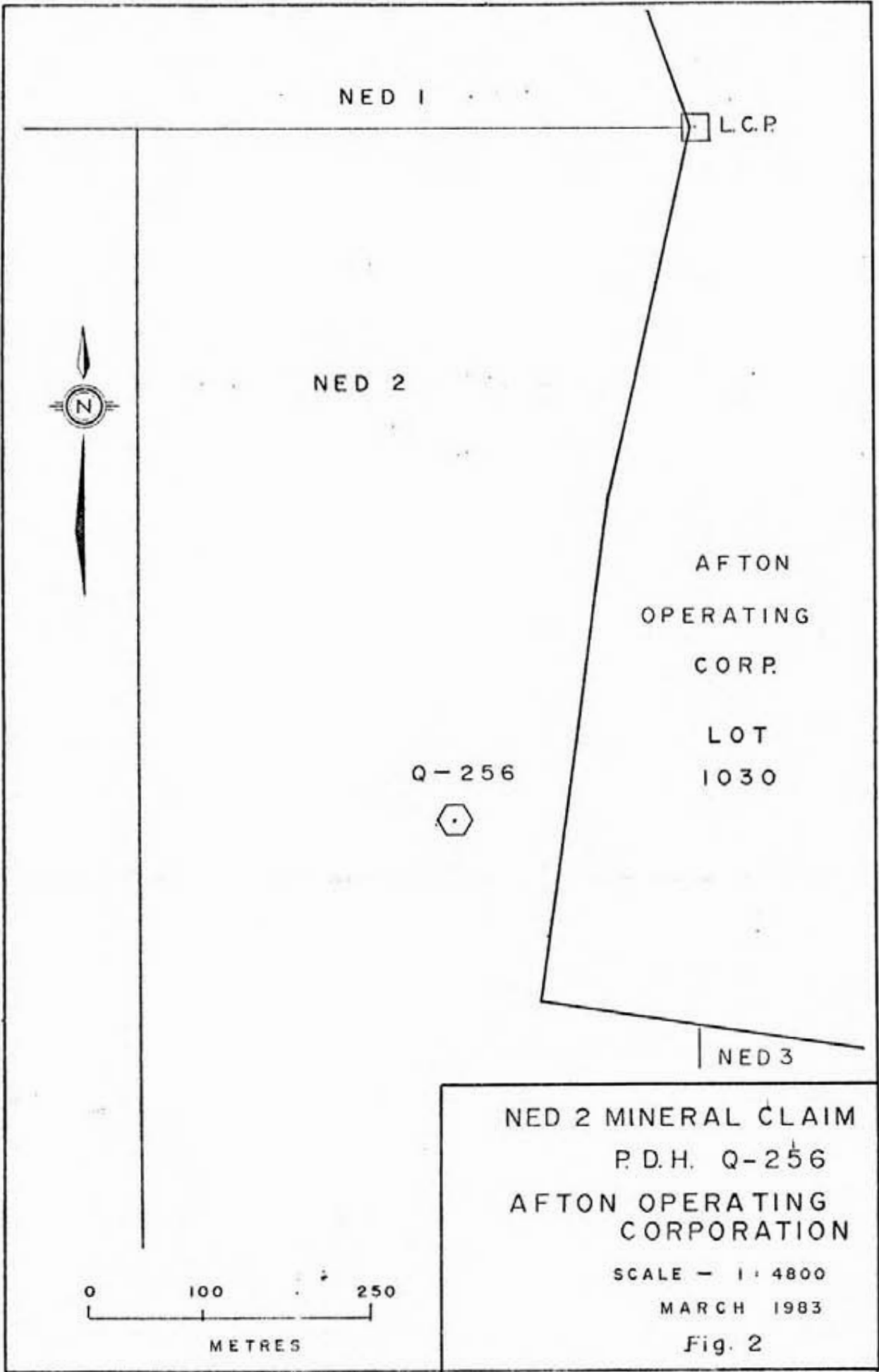



AFTON OPERATING CORPORATION

P.O. BOX 937
KAMLOOPS, B.C.
V2C 5N4

TELEX: PURCH. 048-8326
ADMIN. 048-8327
PHONE: (604) 374-5022

March 15, 1983

CERTIFICATE OF ASSAY

Attention: Lorne Bond

I hereby certify that the following are the assays performed in Afton's laboratory upon the herein described drill chip samples.

<u>Sample No.</u>	<u>Footage</u>	<u>% Cu</u>
Q-256	20-30	.007
	30-40	.005
	40-50	.009
	50-60	.012
	60-70	.015
	70-80	.014
	80-90	.018

Berry Hwa
Registered Assayer
Province of B.C.

/rd

.4

STATEMENT OF COSTS

1. Surveying	Establish survey control, locate sites, pickup hole W. Takashita, K. Smith - 1 day	\$220.00
2. Drilling	Tonto Drilling Co. Ltd. 90 feet x \$7.75 per foot mobilization - demobilization, pulling casing, moving - 10.5 hours @ \$75 per hour	697.50 787.50
3. Assaying	7 samples assayed for Cu @ \$6.75 per sample	47.25
4. L.A. Bond, Geologist	Plan program, supervise drilling, collect and log samples, prepare report 4 days @ \$175. per day	<u>700.00</u>
	Total Costs	<u><u>\$2,452.25</u></u>

STATEMENT OF QUALIFICATIONS

I, Lorne Allan Bond, of the City of Kamloops, British Columbia do hereby certify that:

1. I am a qualified, practising mining geologist.
2. I am a graduate of Loyola College (University of Montreal) with a B. Sc. (1967) in Geotechnical Sciences.
3. I have practised my profession since 1967 while employed with Sherrit-Gordon Mines Ltd., Cominco Ltd. and Afton Operating Corporation.
4. This report describes a percussion drill program performed under my supervision between February 12 and February 14, 1983.

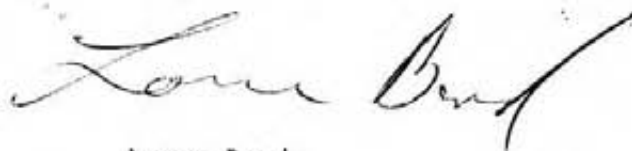

Lorne Bond,
Senior Geologist
Afton Operating Corporation
18th March, 1983