

GEOLOGICAL BRANCH
ASSESSMENT REPORT

11,286

REPORT OF WORK
GEOPHYSICAL SURVEYS
ON THE
FENTON PROPERTY
RED CLAIM - RECORD NUMBER 315
N.T.S. 93L/3 127 00'W, 54 08'N
OMINECA MINING DIVISION

Owner: Vital Mines Ltd.

Submitted by : L. Bradish
Division Geophysicist
Noranda Expl. Co. Ltd., Western Division
Vancouver, B.C.
May, 1983

TABLE OF CONTENTS

		<u>Page</u>
1.0	INTRODUCTION 3
2.0	LOCATION, ACCESS AND GRID 3
3.0	PERSONNEL 3
4.0	INSTRUMENTATION 5
	4.1 Horizontal Loop E.M. survey	
	4.2 Magnetometer survey	
5.0	GEOLOGY 5
6.0	DISCUSSION OF RESULTS AND CONCLUSIONS 6
	APPENDIX 1 Statement of costs 7
	APPENDIX 2 Statement of qualifications 9
 <u>FIGURES</u>		
Fig 1	Location figure 4
 <u>MAPS</u>		
Map 1	Magnetometer survey	1:5,000
Map 2	HLEM survey (f = 1777 Hz)	1:5,000
Map 3	HLEM survey (f = 444 Hz)	1:5,000

REPORT OF WORK
GEOPHYSICAL SURVEYS
ON THE
FENTON PROPERTY (RED CLAIM)

N.T.S. 93L/3
127 00'W, 54 08'N
OMINECA MINING DIVISION

1.0 INTRODUCTION

On January 27, 1983 a three man crew completed a Horizontal Loop EM and Mag survey on a small grid over a swamp on the RED 2 claim where two airborne E.M. surveys (EM-33 and INPUT) had recorded low conductivity anomalies.

2.0 LOCATION , ACCESS AND GRID.

The claims are located approximately 37 Km. southwest of Houston B.C. Access is available via a gravel road from Houston, along the Morice River to mile 26 then south on a dirt logging road for a distance of 9 Km. As the work outlined in this report was completed during the winter, a Helicopter was utilized to provide transportation to the survey area.

A small grid consisting of five survey lines controlled by a baseline 400 meters in length (Az. 0 degrees) was established for the most part over swamp and lake. A total of 2.500 Kilometers of line was flagged.

The RED 2 claim consists of 9 units and was optioned to Mattagami Lake Exploration from Vital Mines Ltd. This claim's record number is 315 with date of record June 4, 1976.

3.0 PERSONNEL

The crew consisted of K. Lillie, Geophysical Field Foreman, K. Irwin, Field Assistant and L. Bradish, Division Geophysicist, all employees of Noranda Exploration Co. Ltd. at the time of the survey.

FIGURE 1
LOCATION AND ACCESS MAP

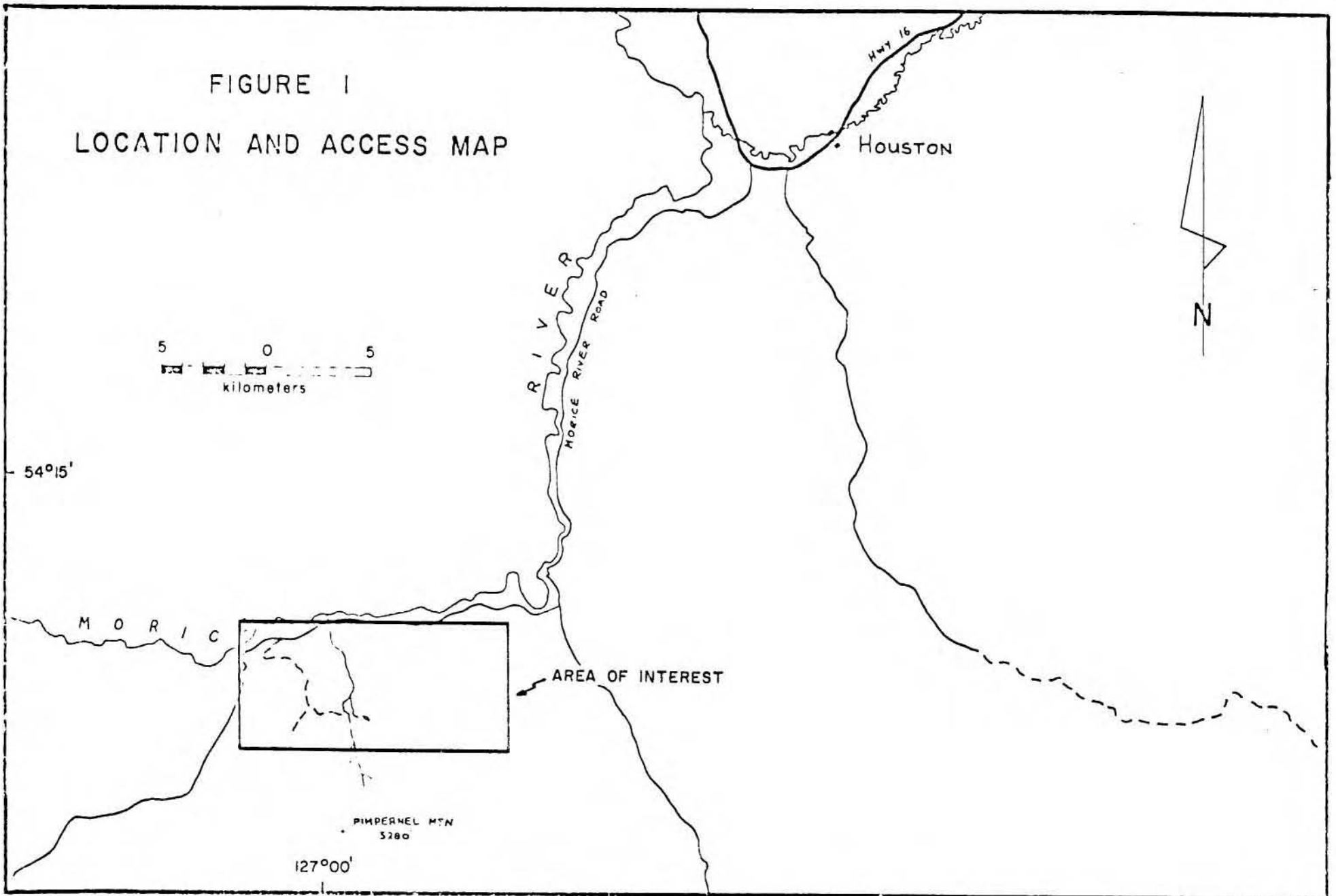

M 93L/2W

6



5

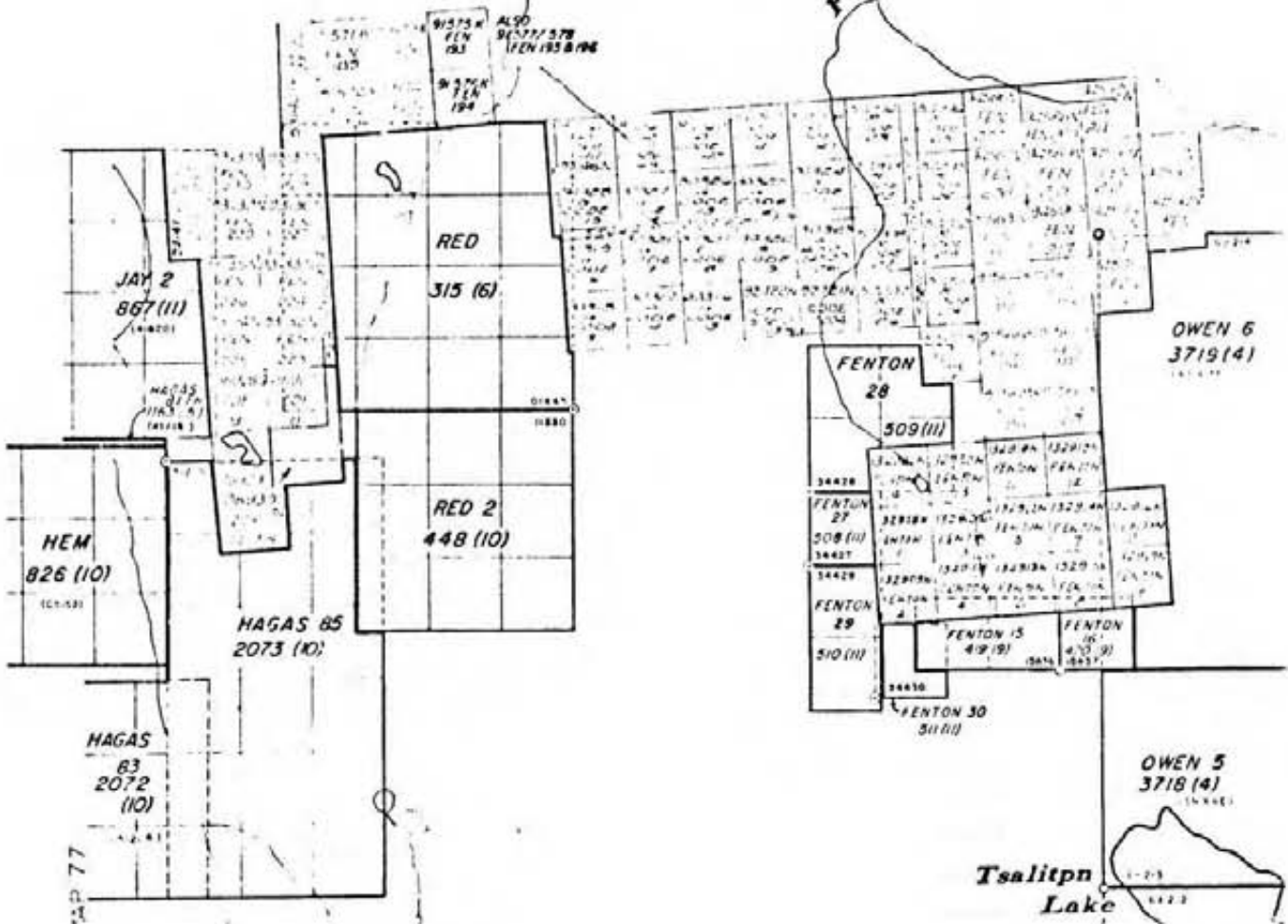

4

4.0 INSTRUMENTATION

4.1 HORIZONTAL LOOP E.M. SURVEY

The HLEM equipment employed on this survey was the MAXMIN II unit manufactured by Apex Parametrics of Toronto, Ontario. The survey parameters were as follows:

Coil separation	: 100 meters
Frequencies	: 1777 Hz and 444 Hz
Reading interval	: 25 meters
Measurements	: In-phase and Quadrature components of the secondary field

4.2 MAGNETOMETER

"UNIMAG" G.836 Proton Precession magnetometers manufactured by Exploranium Geometrics of Ontario were utilized for this survey. The Total Field measurement is read with a resolution of 10 gammas and all recorded values were corrected for diurnal and day to day variations. The correction values were determined from repeat readings taken at control stations which are established at the intersection of the wing lines and the Baseline. Readings were recorded at 25 meter intervals and are plotted in profile at a scale of 1 cm = 100 gammas (datum of 57,000 gammas).

5.0 GEOLOGY

A brief description of the local geology is quoted from a Mattagami Lake Exploration Ltd. report by W. Mercer titled "Houston Project, Exploration Proposal, 1980":

' The geology (in the area of main interest) appears to consist of tuffaceous and brecciated rocks mineralized with ubiquitous pyrite, common sphalerite and rare galena. Indications of trend of mineralization are weak. If it is bedding controlled then the strike may be N or NE with a steep dip to the east.'

DISCUSSION OF RESULTS AND RECOMMENDATIONS.

The HLEM survey was completed over 2.2 line Kilometers and the Mag survey over 2.5 line Kilometers.

The HLEM survey defined a high frequency anomaly over the swamp with no response recorded at the lower frequency. This indicates that the source is probably due to conductive sediment in the swamp. A small mag anomaly is noted on three lines striking approximately NNE. No further work is recommended for this area.

Respectfully submitted,



L. Bradish
Division Geophysicist
Vancouver, B.C.

APPENDIX 1

~~~~~

STATEMENT OF COSTS



NORANDA EXPLORATION COMPANY, LIMITED

STATEMENT OF COST

PROJECT FENTON DATE April 28, 1983

TYPE OF REPORT Geophysics & Linecutting

a) Wages:

No. of Days 10  
Rate per Day \$ 121.47  
Dates From: January & February 1983  
Total Wages 10 x \$ 121.47 1,214.69

b) Food and Accomodation:

No of days 10  
Rate per day \$ 49.12  
Dates From: January & February 1983  
Total Cost 10 x \$ 49.12 491.20

c) Transportation:

No of days 10  
Rate per day \$ 56.69  
Dates From: January & February 1983  
Total Cost 10 X \$ 56.69 566.88

d) Instrument Rental:

Type of Instrument  
No of days  
Rate per day \$  
Dates From:  
Total Cost X \$

Type of Instrument  
No of days  
Rate per day \$  
Dates From:  
Total Cost X \$

f) Analysis  
(See attached schedule)

g) Cost of preparation of Report

|          |        |
|----------|--------|
| Author   | 121.47 |
| Drafting | 121.47 |
| Typing   | 121.47 |

h) Other:

Contractor

Total Cost

\$2,637.18

r) Unit costs for GEOPHYSICS

No of days

No of units 2.5 Line Km

Unit costs 853.18 / L Km

Total Cost 2.5 x 853.18

2,132.96

Unit Costs for Linecutting:

No. of Units 2.9 L km

Unit Costs 173.87 / L km

Total Cost 2.9 x 173.87

504.22

\$2,637.18

APPENDIX 2

~~~~~

STATEMENT OF QUALIFICATIONS

STATEMENT OF QUALIFICATIONS
~~~~~

I, Lyndon Bradish of Vancouver, Province of British Columbia, do hereby certify that:

1. I am a Geophysicist residing at 1826 Trutch St. Vancouver, B.C.
2. I am a graduate of the University of British Columbia with a B.Sc. (geophysics).
3. I am a member in good standing of the Society of Exploration Geophysicists, Canadian Institute of mining and the Prospector's and Developer's Association.
4. I presently hold the position of Division Geophysicist with Noranda Exploration Co. Ltd. and have been in their employ since 1973.

  
-----  
L. Bradish.

**GEOLOGICAL BRANCH  
ASSESSMENT REPORT**

**11,286**

14+00W  
13+00W  
12+00W  
11+00W  
10+00W  
9+00W  
8+00W  
7+00W

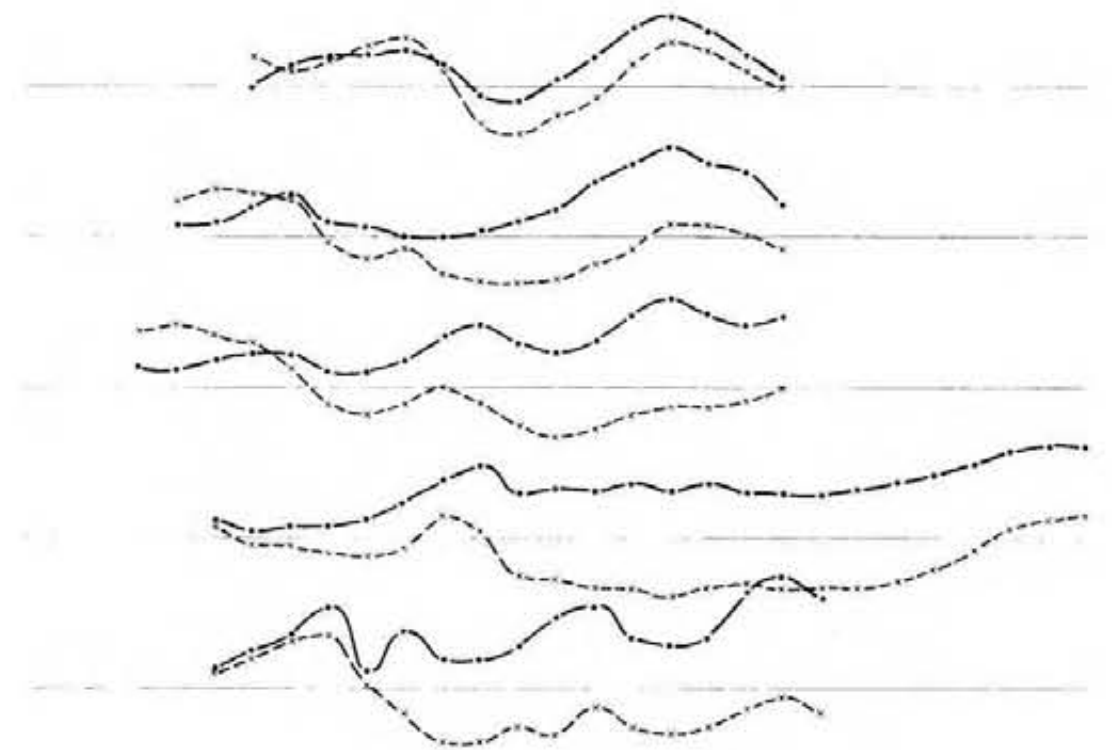

L.13N  
L.12N  
L.11N  
L.10N  
L.9N



**LEGEND**

- INSTRUMENT ——— Max Min II
- FREQUENCY ——— 1777Hz
- PROFILE SCALE ——— 1cm = 20%
- COIL SPACING ——— 100m
- SURVEY DATE ——— Jan./83
- OPERATORS ——— K.L. & L.B.
- Inphase
- - - - - Outphase

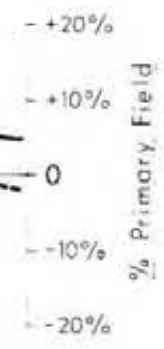

|                    |                                  |                        |
|--------------------|----------------------------------|------------------------|
| REVISED            | <b>FENTON PROPERTY</b>           |                        |
| <i>[Signature]</i> | <b>HLEM SURVEY</b>               |                        |
|                    | Frequency = 1777 Hz. (100m Sep.) |                        |
| PROJ. No. 1028     | SURVEY BY K.L. & L.B.            | DATE Feb./83           |
| N.T.S. 93L/B       | DRAWN BY <i>[Signature]</i>      | SCALE 1:5000 1cm = 20% |
| DWG. No. 2         | <b>NORANDA EXPLORATION</b>       |                        |
|                    | OFFICE: Vancouver                |                        |

GEOLOGICAL BRANCH  
ASSESSMENT REPORT

11,286

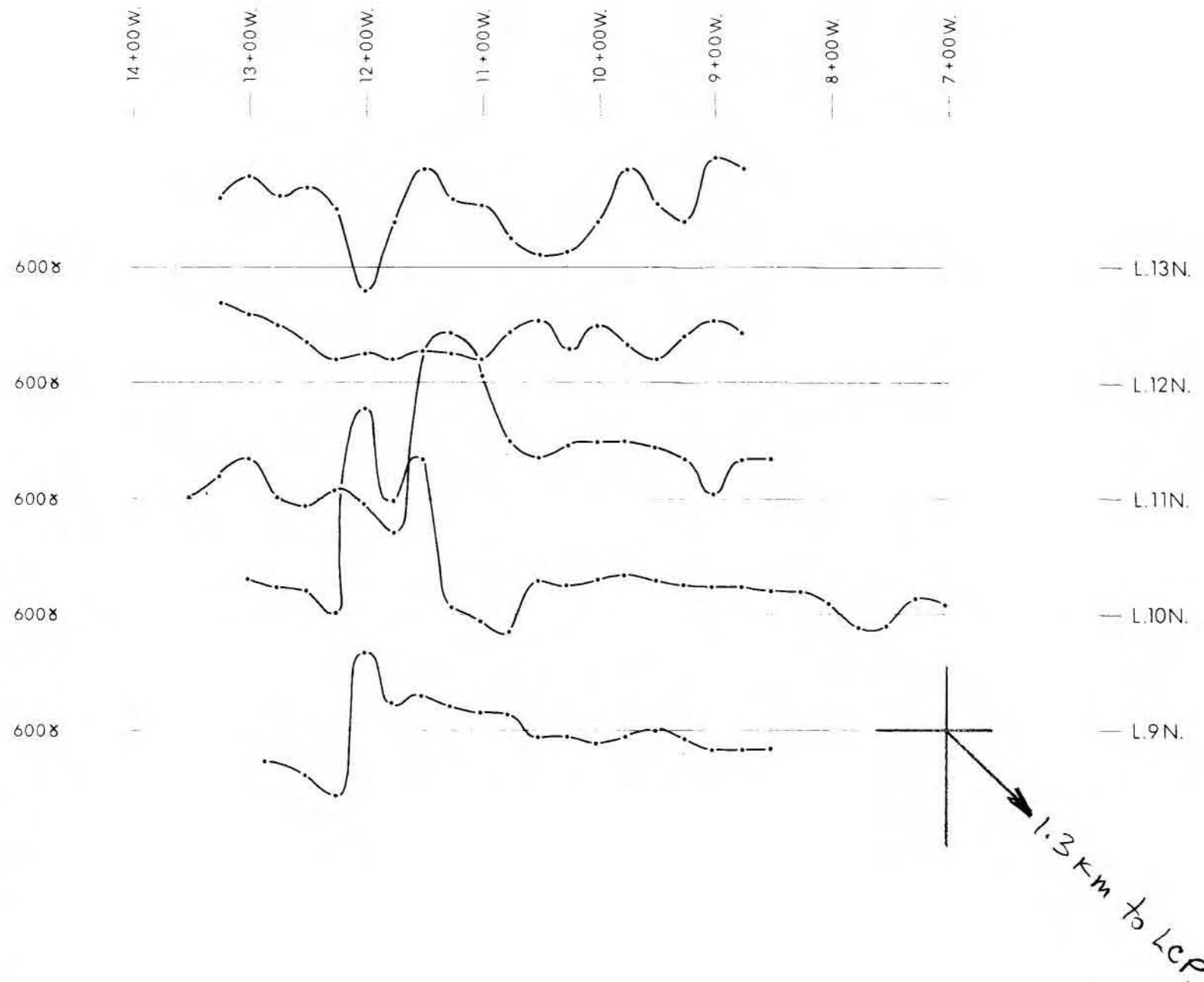

LEGEND

INSTRUMENT — Proton Unimag  
 FIELD — Total  
 DATUM — 57000  
 PROFILE SCALE — 100x  
 SURVEY DATE — Jan./83  
 OPERATORS — K.L. & L.B.

|                  |                        |                          |
|------------------|------------------------|--------------------------|
| REVISED          | FENTON PROPERTY        |                          |
| <i>R. Prater</i> | MAGNETOMETER SURVEY    |                          |
|                  | Datum: 57000           |                          |
| PROJ No. 1028    | SURVEY BY K.L. & L.B.  | DATE Feb./83             |
| N.T.S. 93L/3     | DRAWN BY <i>Prater</i> | SCALE: 1:5000 1cm = 100x |
| DWG. No. 1       | NORANDA EXPLORATION    |                          |
|                  | OFFICE: Vancouver      |                          |

**GEOLOGICAL BRANCH  
ASSESSMENT REPORT**

**11,286**

14+00W.  
13+00W.  
12+00W.  
11+00W.  
10+00W.  
9+00W.  
8+00W.  
7+00W.

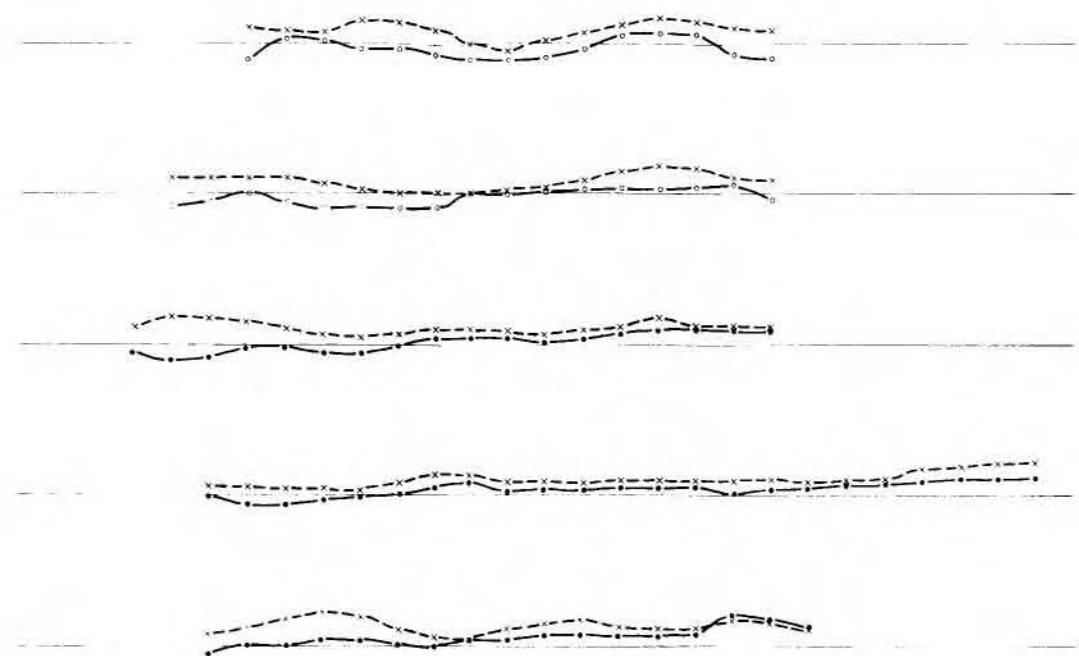

L.13N.  
L.12N.  
L.11N.  
L.10N.  
L.9N.



**LEGEND**

- INSTRUMENT — Max Min II
- FREQUENCY — 444Hz
- PROFILE SCALE — 1cm = 20%
- COIL SPACING — 100m
- SURVEY DATE — Jan./83
- OPERATORS — K.L. & L.B.
- Inphase
- - - - - Outphase

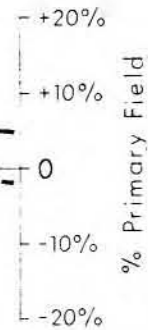

|                    |                                |                         |
|--------------------|--------------------------------|-------------------------|
| REVISED            | FENTON PROPERTY                |                         |
| <i>[Signature]</i> | HLEM SURVEY                    |                         |
|                    | Frequency = 444Hz. (100m Sep.) |                         |
| PROJ. No. 102B     | SURVEY BY: K.L. & L.B.         | DATE: Feb./83           |
| NTS 931/3          | DRAWN BY: <i>[Signature]</i>   | SCALE: 1:5000 1cm = 20% |
| DWG. No. 3         | <b>NORANDA EXPLORATION</b>     |                         |
|                    | OFFICE: Vancouver              |                         |