

GEOLOGICAL BRANCH
ASSESSMENT REPORT

11,381

part 2
of 3

(C Horizon) 3E8000-3E6000(B Horizon)
100 400 50 200
Cu(ppm), Zn(ppm) Cu(ppm), Zn(ppm)

SCALE 1:2500
0 100metres

ESSO MINERALS CANADA

BARRIER PROJECT
GRID B-1
SOIL GEOCHEMISTRY
COPPER(ppm), ZINC(ppm)

Project No. 2189

NTS B2M/12W Long. 119°54' W
Lat. 51°32' N

Mining Division KAMLOOPS Drawn By: C.E.

Date: NOV. 1983 Map No. 1

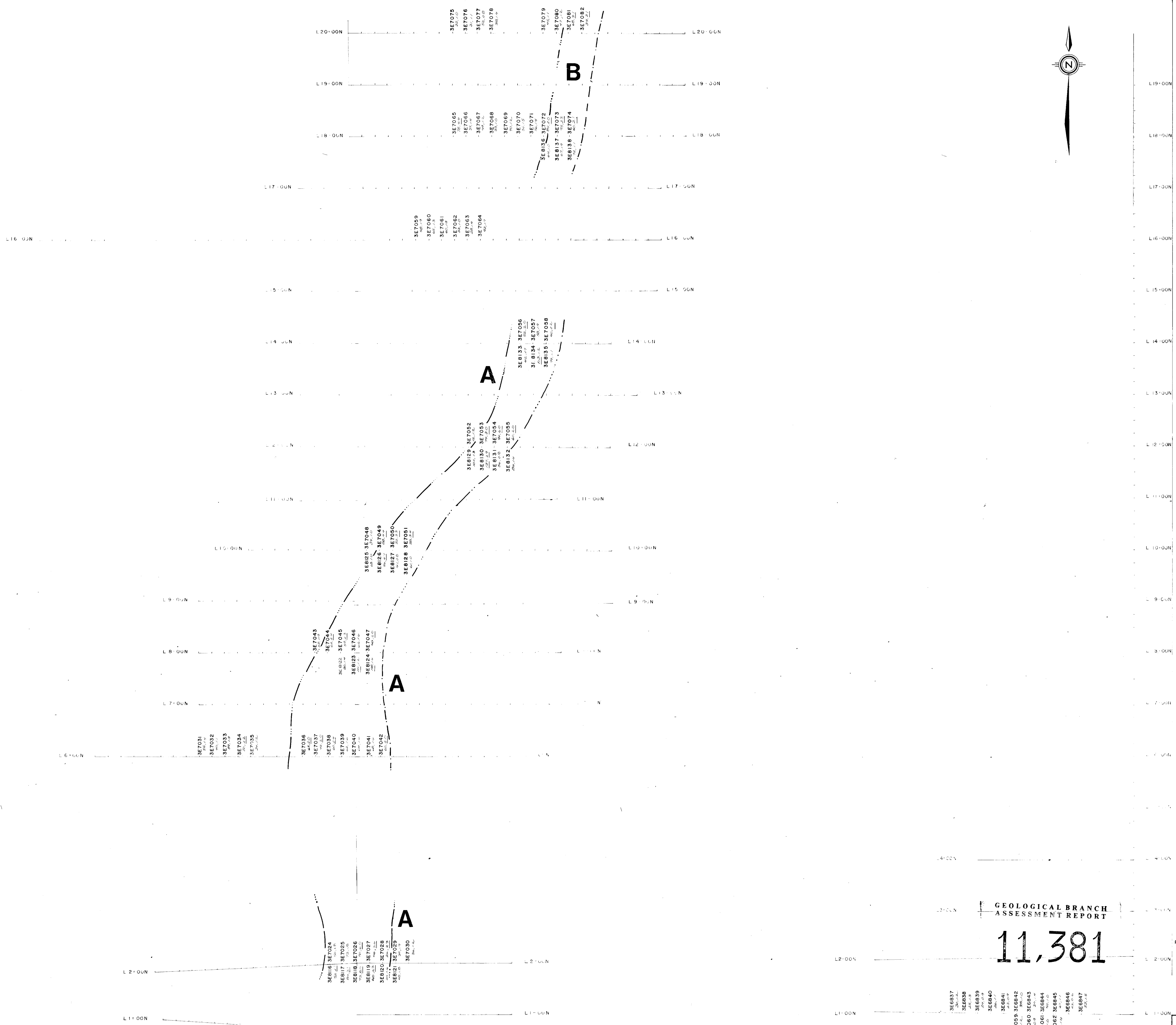

GEOLOGICAL BRANCH
ASSESSMENT REPORT
11,381

part 2 of 3

(C Horizon) 3E8000-3E6000(B Horizon)
100, 2.5, 20, 50, 1.5, 10
Pb(ppm), Ag(ppm), Au(ppb) Pb(ppm), Ag(ppm), Au(ppb)

SCALE 1:2500
0 100metres

ESSO MINERALS CANADA	
BARRIER PROJECT	
GRID B-I	
SOIL GEOCHEMISTRY	
LEAD(ppm), SILVER(ppm)	
± GOLD(ppb)	
Project No. 2189	
NTS 82M/12W	Long 118°54'W
Mining Division/KAMLOOPS	Lat. 51°32'N
Date: NOV. 1983	Map No. 2

3E8021 3E7021
3E8022 3E7022
3E8023 3E7023
3E8024 3E7024
3E8025 3E7025
3E8026 3E7026
3E8027 3E7027
3E8028 3E7028
3E8029 3E7029
3E8030 3E7030
3E8031 3E7031
3E8032 3E7032
3E8033 3E7033
3E8034 3E7034
3E8035 3E7035
3E8036 3E7036
3E8037 3E7037
3E8038 3E7038
3E8039 3E7039
3E8040 3E7040
3E8041 3E7041
3E8042 3E7042
3E8043 3E7043
3E8044 3E7044
3E8045 3E7045
3E8046 3E7046
3E8047 3E7047
3E8048 3E7048
3E8049 3E7049
3E8050 3E7050
3E8051 3E7051
3E8052 3E7052
3E8053 3E7053
3E8054 3E7054
3E8055 3E7055
3E8056 3E7056
3E8057 3E7057
3E8058 3E7058
3E8059 3E7059
3E8060 3E7060
3E8061 3E7061
3E8062 3E7062
3E8063 3E7063
3E8064 3E7064
3E8065 3E7065
3E8066 3E7066
3E8067 3E7067
3E8068 3E7068
3E8069 3E7069
3E8070 3E7070
3E8071 3E7071
3E8072 3E7072
3E8073 3E7073
3E8074 3E7074
3E8075 3E7075
3E8076 3E7076
3E8077 3E7077
3E8078 3E7078
3E8079 3E7079
3E8080 3E7080
3E8081 3E7081
3E8082 3E7082
3E8083 3E7083
3E8084 3E7084
3E8085 3E7085
3E8086 3E7086
3E8087 3E7087
3E8088 3E7088
3E8089 3E7089
3E8090 3E7090
3E8091 3E7091
3E8092 3E7092
3E8093 3E7093
3E8094 3E7094
3E8095 3E7095
3E8096 3E7096
3E8097 3E7097
3E8098 3E7098
3E8099 3E7099
3E8100 3E7100

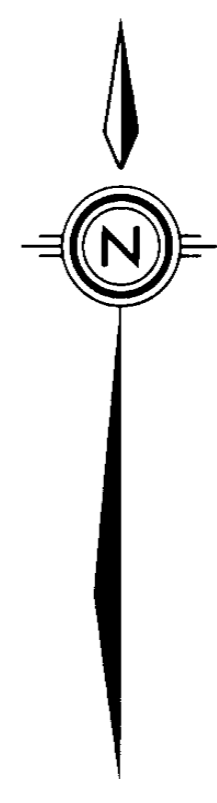
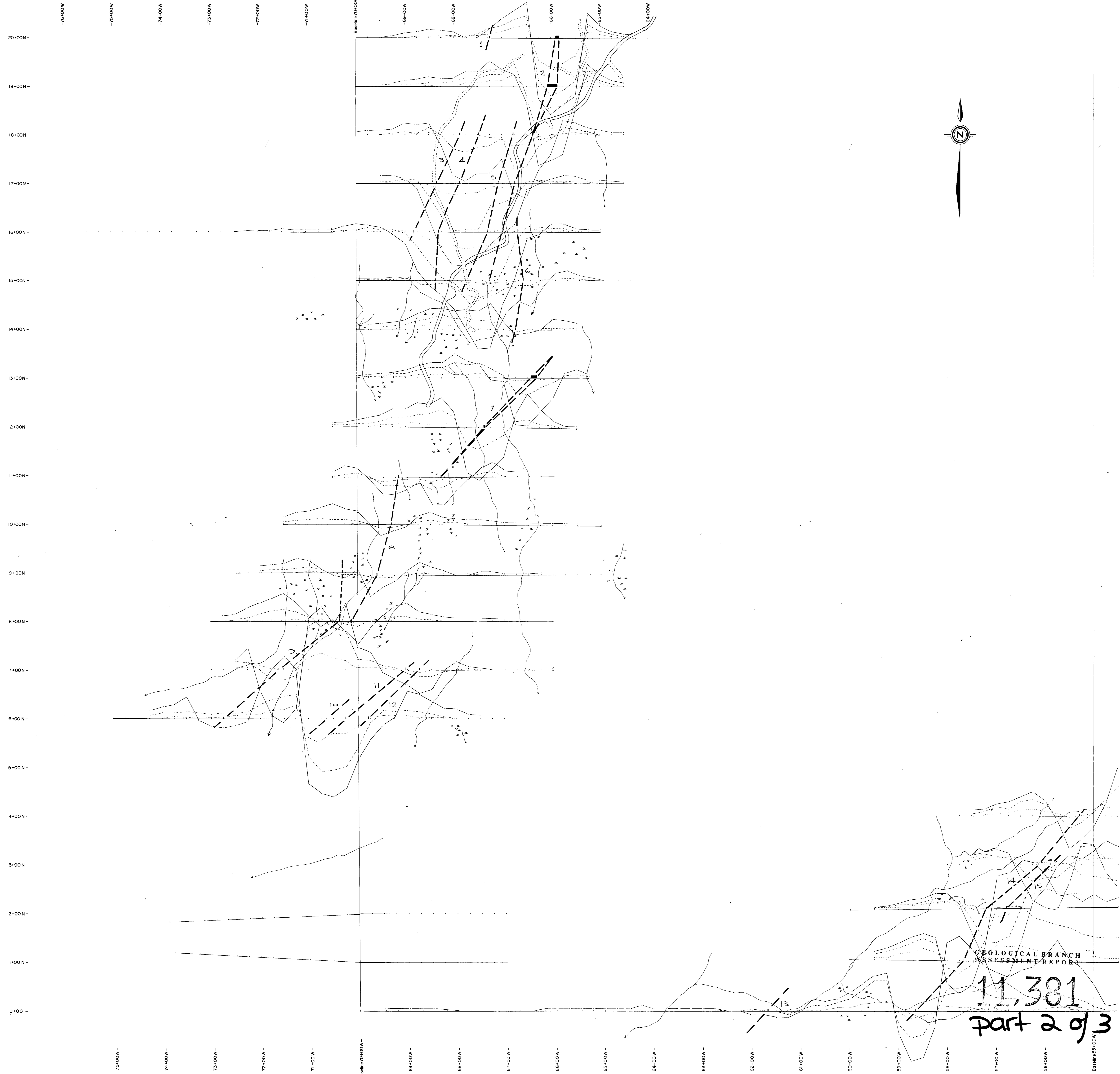

11,381
Part 2 of 3

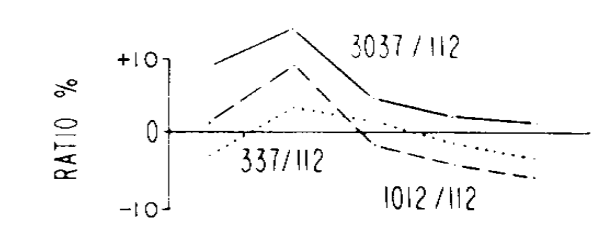

INSTRUMENT SCINTREX SE-88 "GENIE" EM
SEPARATION
1:25
PLOTTING POINT
— DEFINITE CONDUCTOR
— POSSIBLE CONDUCTOR

ES&O MINERALS CANADA DIV. OF ESSO RESOURCES CANADA LIMITED			
PROSPECT: BARRIER			
BI Grid			
HLEM SURVEY			
ACCOUNT NO. M489	FILE NO. 2189	TORONTO	
DRAWN BY: K. SIMPSON	DATE	NTS	EDM
PLANT	SLOWE		
DWG. NO.	MAP NO. 3		
SCALE			
0 50 100m			
1:2500			
To accompany A Report By:			
Date:			

L 20+00N
L 19+00N
L 18+00N
L 17+00N
L 16+00N
L 15+00N
L 14+00N
L 13+00N
L 12+00N
L 11+00N
L 10+00N
L 9+00N
L 8+00N
L 7+00N
L 6+00N
L 5+00N
L 4+00N
L 3+00N
L 2+00N
L 1+00N
L 0+00

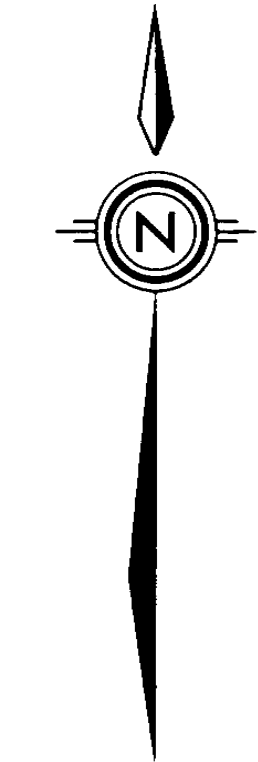
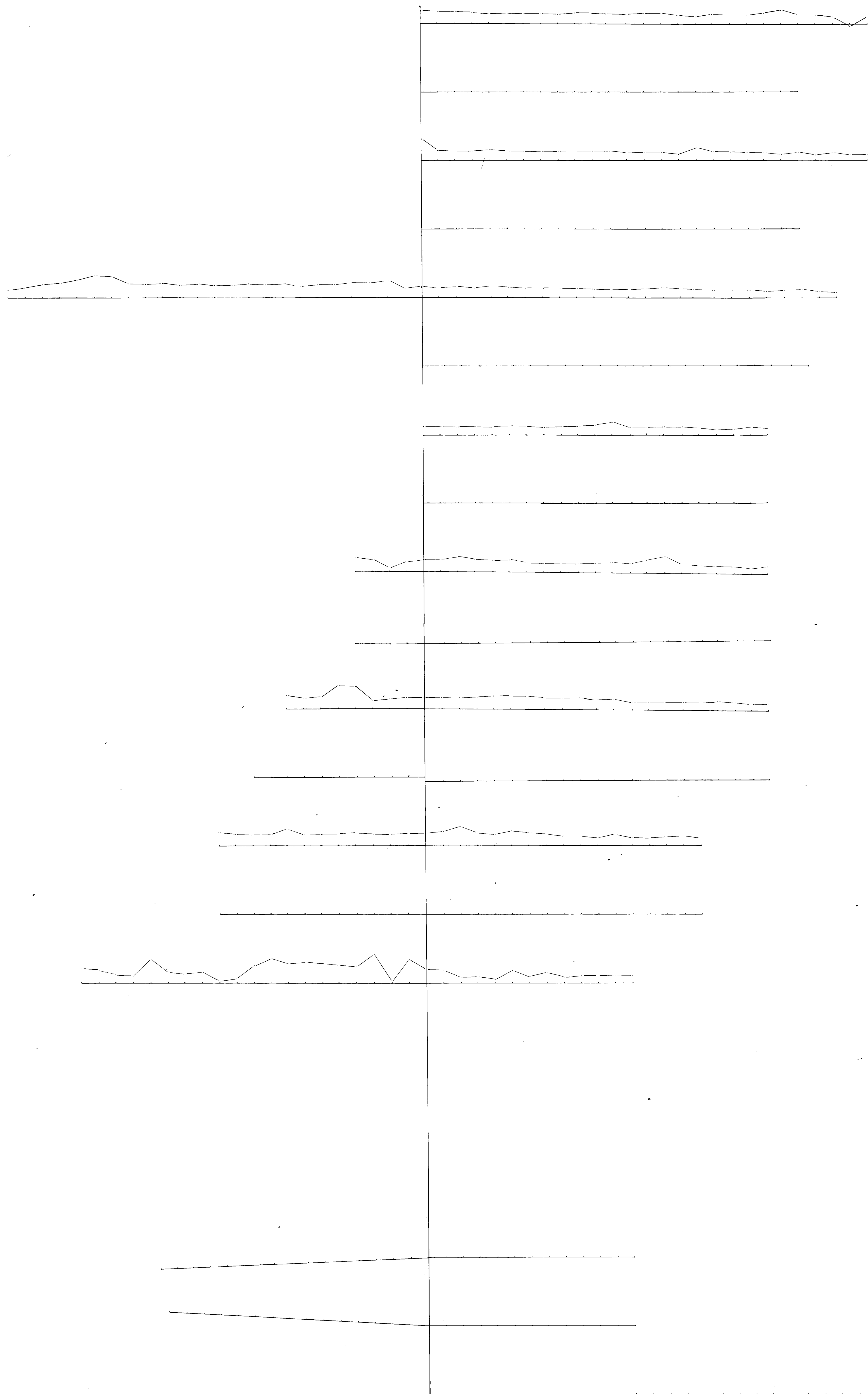

part 2 of 3

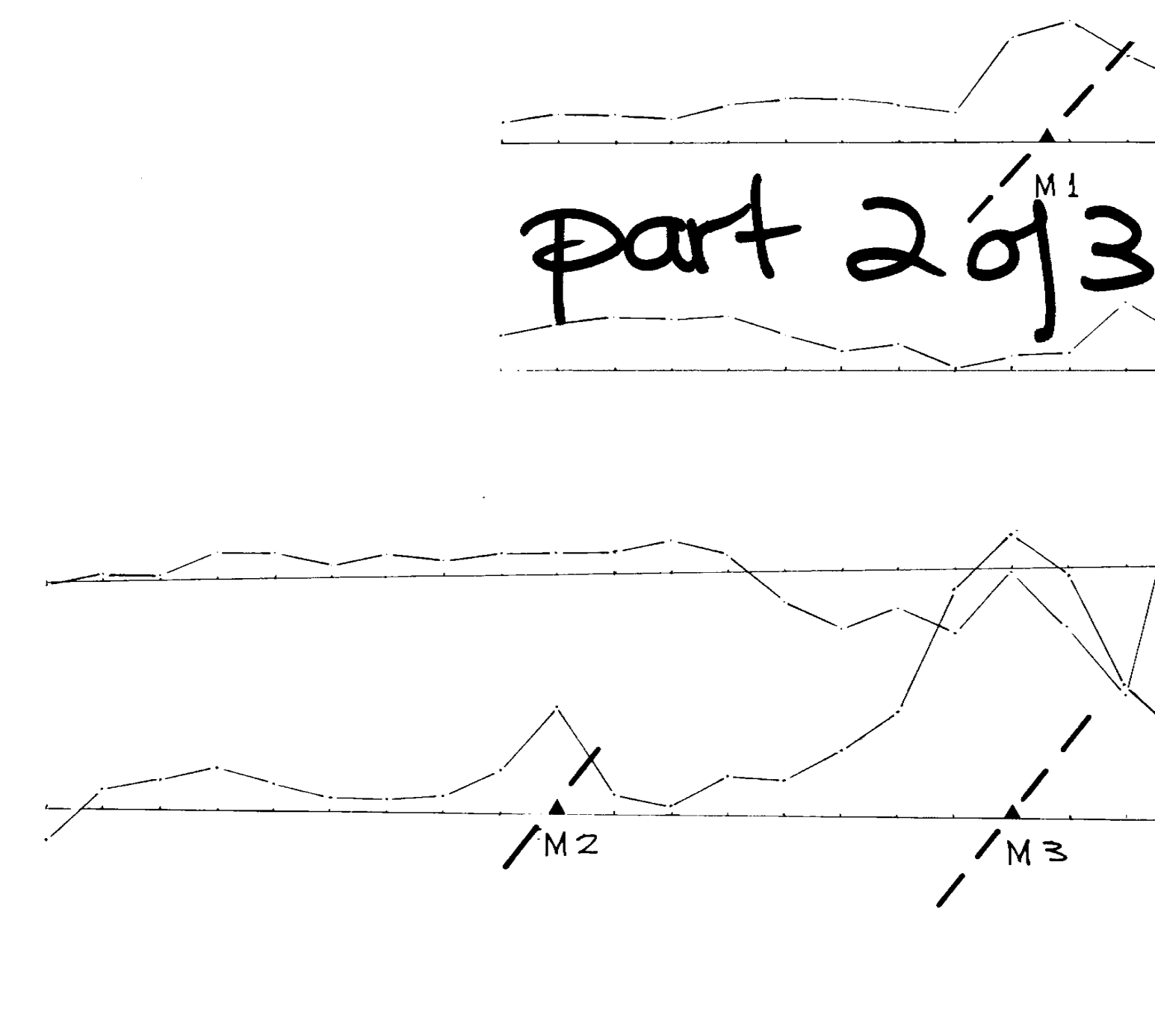

GEOLOGICAL BRANCH
ASSESSMENT REPORT

11,381

INSTRUMENT: GEOMETRIC 2110 PROTON
PRECISION MAGNETOMETER
SENSITIVITY: ± 5 GAMMAS
ASSUMED MEAN GEOMAGNETIC FIELD
STRENGTH: 57930 GAMMAS

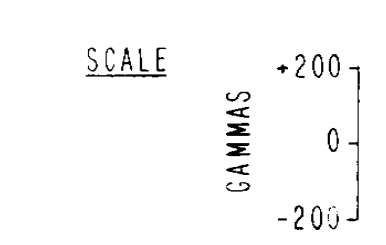

ES&O MINERALS CANADA			
PROSPECT: BARRIER			
BI GRILL			
MAGNETOMETER SURVEY			
ACCOUNT NO: M489	FILE NO: 2188	TORONTO	
DRAWN BY: K. SIMPSON, J. HUNT, S. LOWE	DATE: N.T.C.	82M	
DWG NO:	MAP NO: 4		
SCALE: 1:2500			
DATE: 1982			

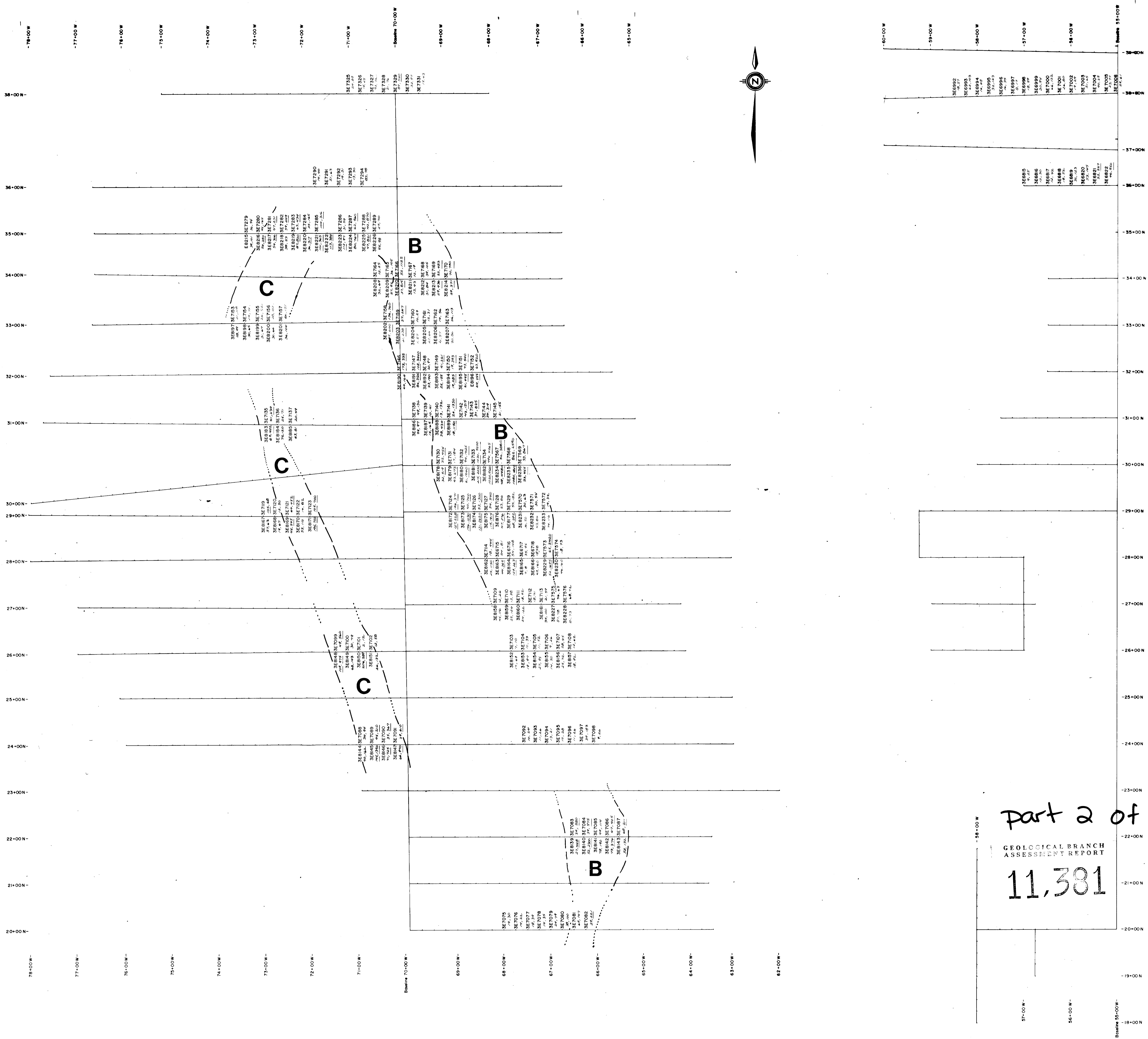

part 2 of 3

GEOLOGICAL BRANCH
ASSESSMENT REPORT

11,381

(C Horizon) 3E6000 3E6000(B Horizon)
100, 400 50, 200
Cu(ppm), Zn(ppm) Cu(ppm), Zn(ppm)

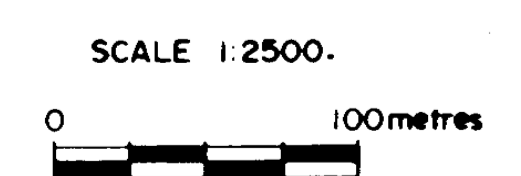

ESSO MINERALS CANADA

BARRIER PROJECT

GRID B-2
SOIL GEOCHEMISTRY
COPPER(ppm), ZINC(ppm)

Project No. 2189

NTS 82M/12 W	Long. 119°54' W
Lat. 51°32' N	
Mining Division KAMLOOPS	Drawn By: C.E.
Date NOV. 1983	Map No. 5

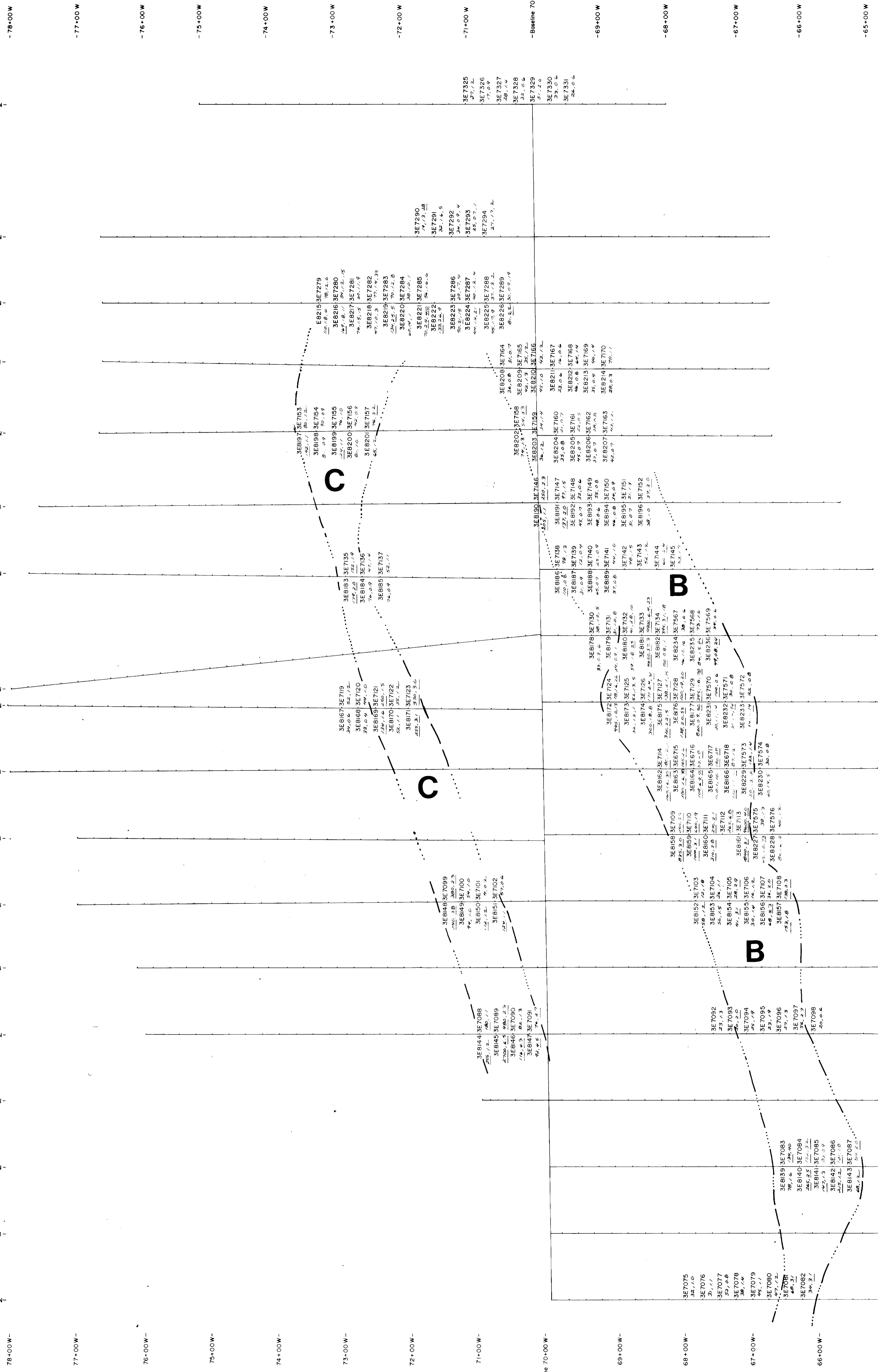

part 2 of 3

GEOLOGICAL BRANCH
ASSESSMENT REPORT
11,381

(C Horizon) 3E8000 3E6000(B Horizon)
100, 25, 20 50, 15, 10
Pb(ppm), Ag(ppm), Au(ppb) Pb(ppm), Ag(ppm), Au(ppb)

SCALE 1:2500
0 100 metres

ESSO MINERALS CANADA	
BARRIER PROJECT	
GRID B-2	
SOIL GEOCHEMISTRY	
LEAD (ppm), SILVER (ppm)	
± GOLD (ppb)	
Project No. 2189	
NTS 82M/12W	Long 119°54'W
Mining Division/KAMLOOPS	Lat. 51°32'N
Date: NOV. 1983	Drawn By: C.E.
Map No. 6	

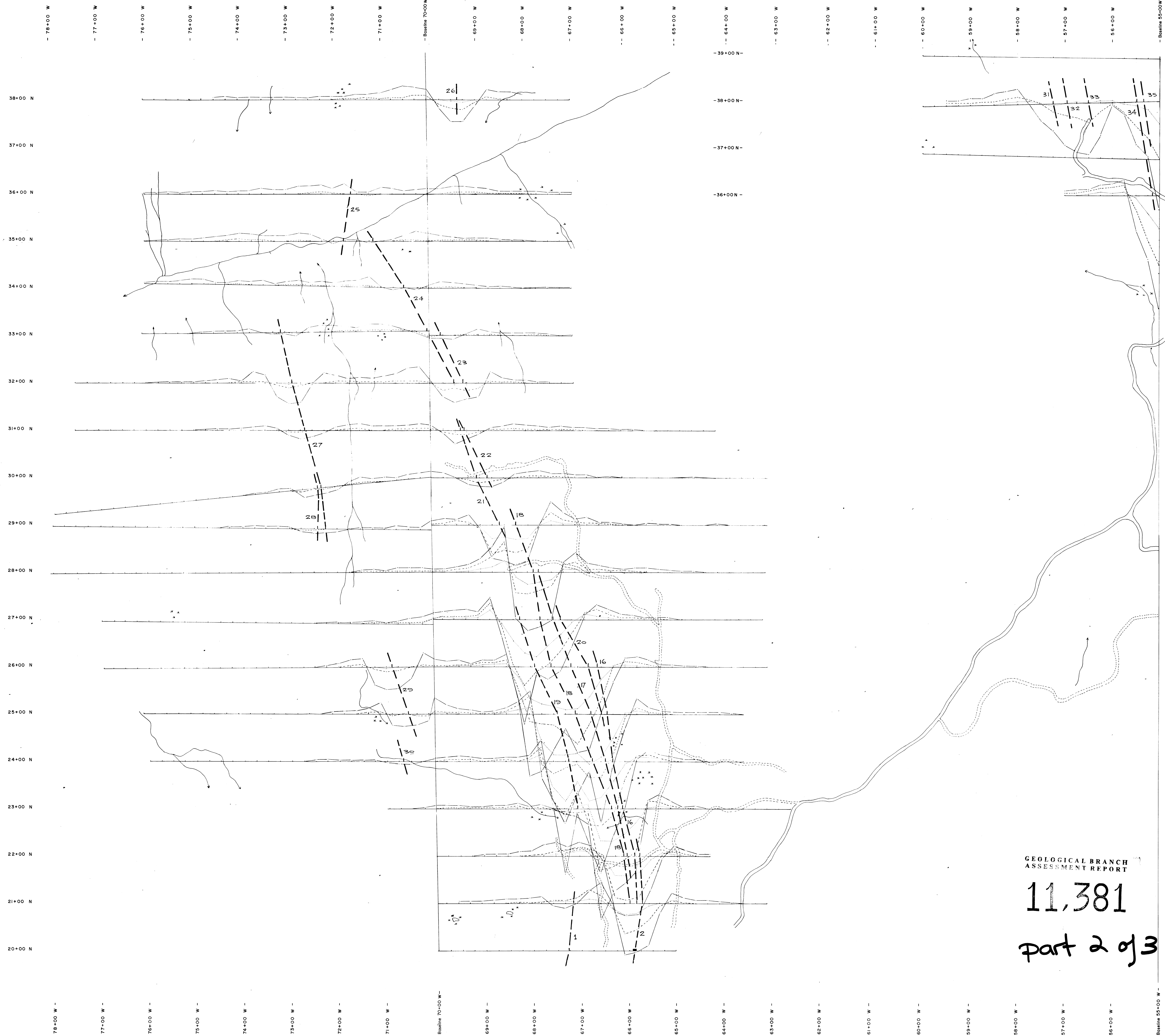

GEOLOGICAL BRANCH
ASSESSMENT REPORT

11,381

part 2 of 3

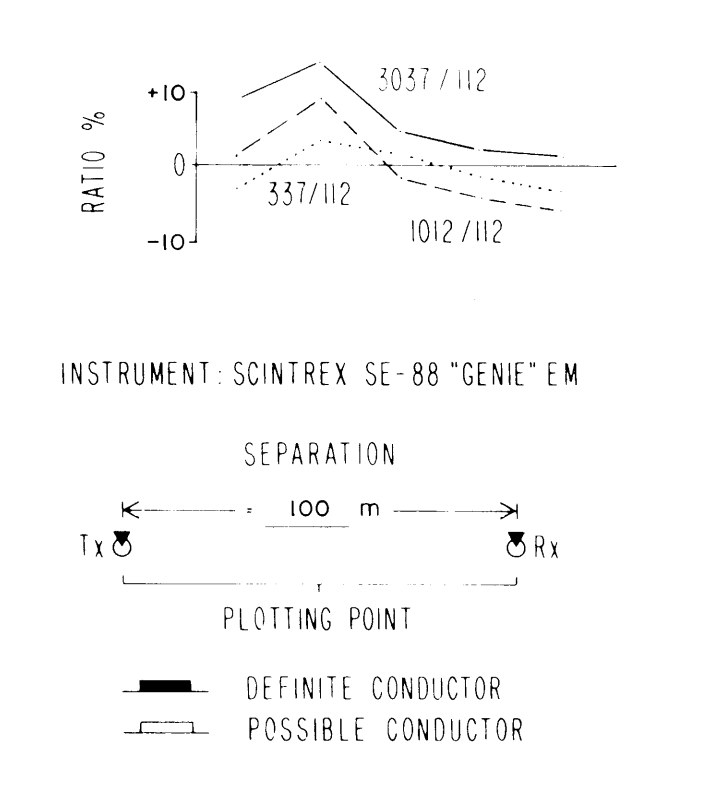

FSD MINERALS CANADA DIV. OF FSD MINERALS CANADA LIMITED	
PROSPECT: BARRIER	FILE # 289 TORONTO
HLEM SURVEY	
ACCOUNT # M89	DATE NTS
DRAWN BY: K. SIMPSON	DATE NTS
DWG. NO. 8107	MAP # 7
SCALE	
0 50 100m	
1:2500	

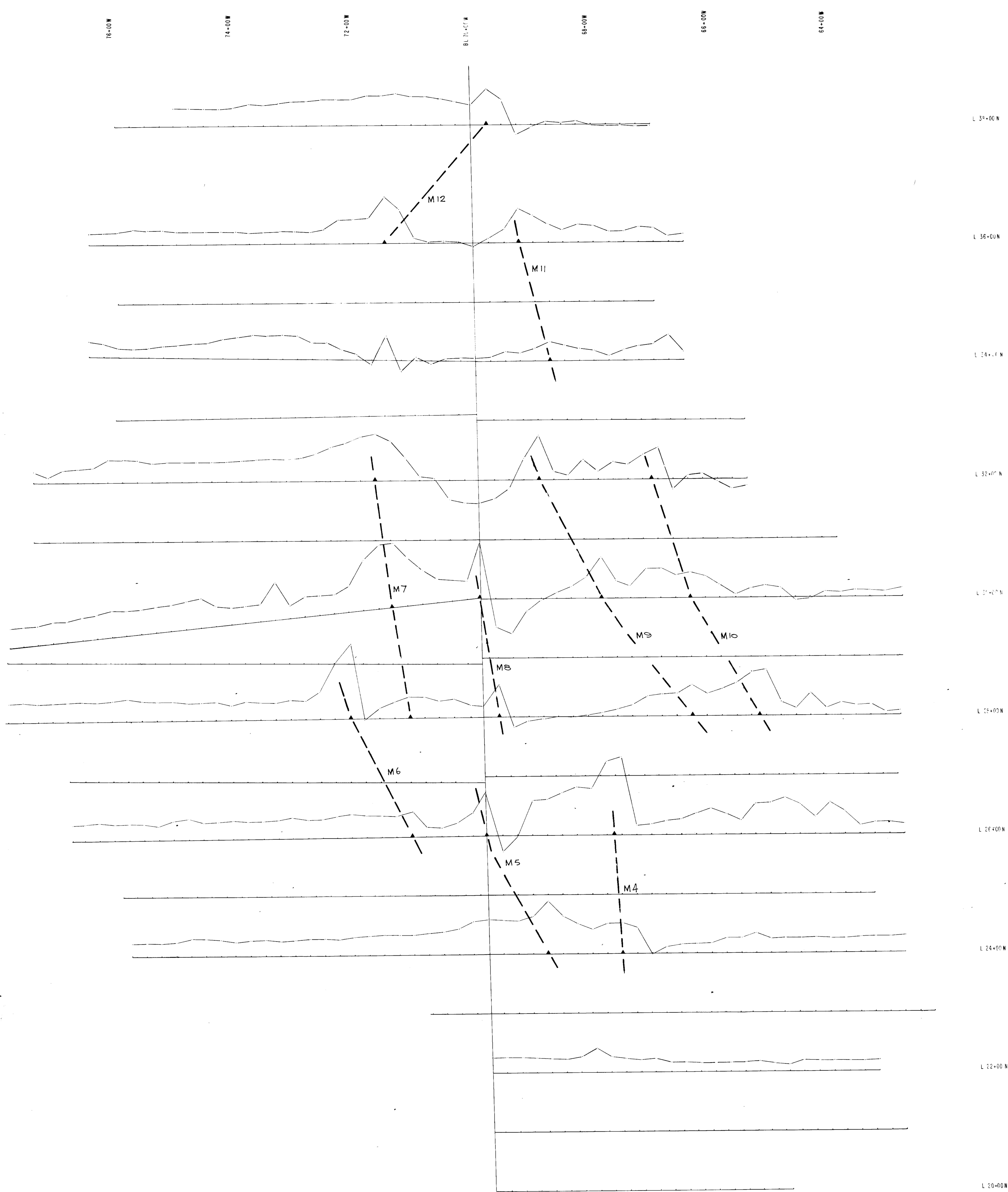

L 37+00 N
 L 36+00 N
 L 34+00 N
 L 32+00 N
 L 30+00 N
 L 28+00 N
 L 26+00 N
 L 24+00 N
 L 22+00 N
 L 20+00 N

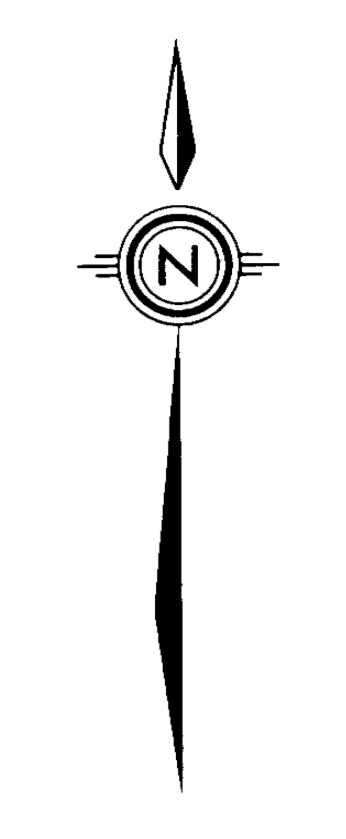
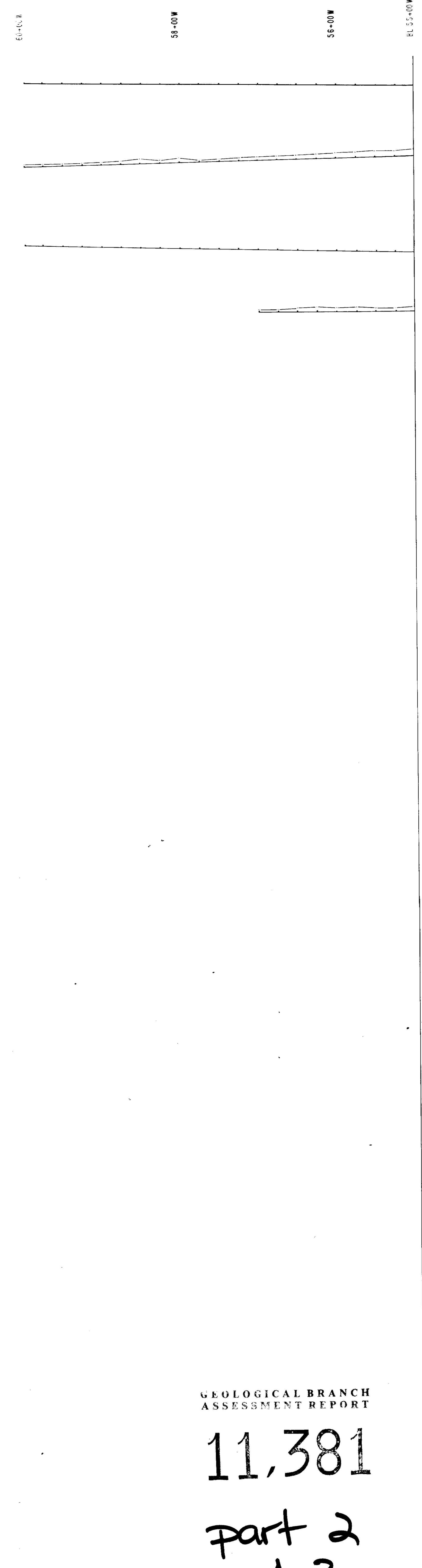

GEOLOGICAL BRANCH
 ASSESSMENT REPORT
 11,381
 Part 2
 of 3

INSTRUMENT: GEOMETRICS 6816 PROTON
 PRECESSION MAGNETOMETER
 SENSITIVITY: ± 5 GAMMAS
 ASSUMED MEAN GEOMAGNETIC FIELD
 STRENGTH: 51930 GAMMAS

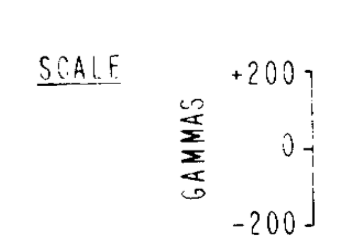

ESKO MINERALS CANADA	
PROSPECT: BARRIER	
B2 GRID	
MAGNETOMETER SURVEY	
ACCOUNT NO: 8889	FILE NO: 2185 TORONTO
DRAWN BY: K. SIMPSON, J. HUNT, S. LONG	DATE: NTS 82M
DWG NO:	MAP NO: 8
SCALE: 1:2500	
0 100M	

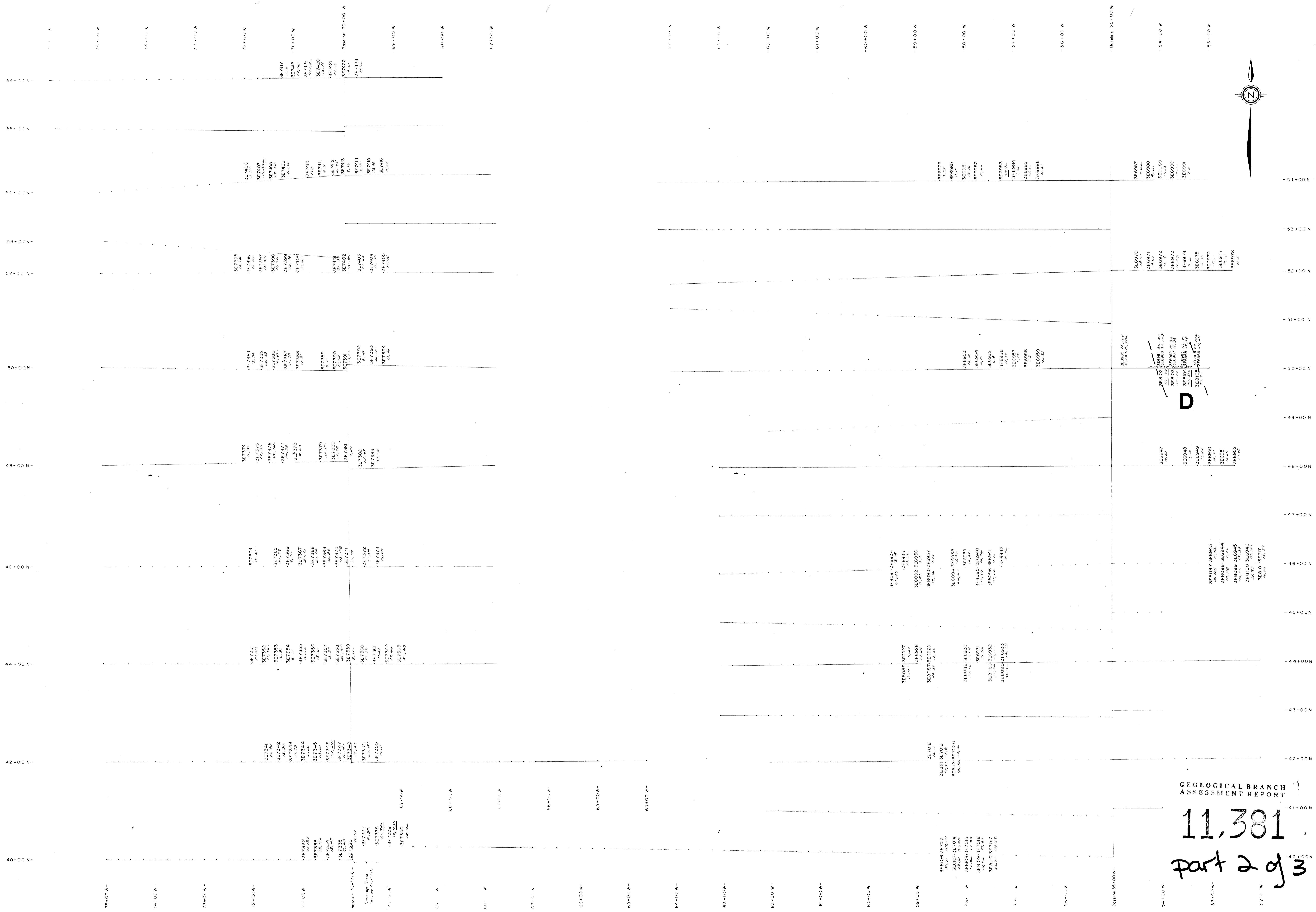

GEOLOGICAL BRANCH
ASSESSMENT REPORT

11,381
part 2 of 3

(C Horizon) 3E8000 3E6000IB Horizon)
100, 400 50, 200
Cu(ppm), Zn(ppm) Cu(ppm), Zn(ppm)

SCALE 1:2500
0 100metres

ESSO MINERALS CANADA	
BARRIER PROJECT	
GRID B-3	
SOIL GEOCHEMISTRY	
COPPER(ppm), ZINC(ppm)	
Project No. 2189	Long. 119° 54' W
NTS 82 M/12 W	Lat. 51° 32' N
Mining Division KAMLOOPS	Drawn By C.E.
Date NOV. 1983	Map No. 9

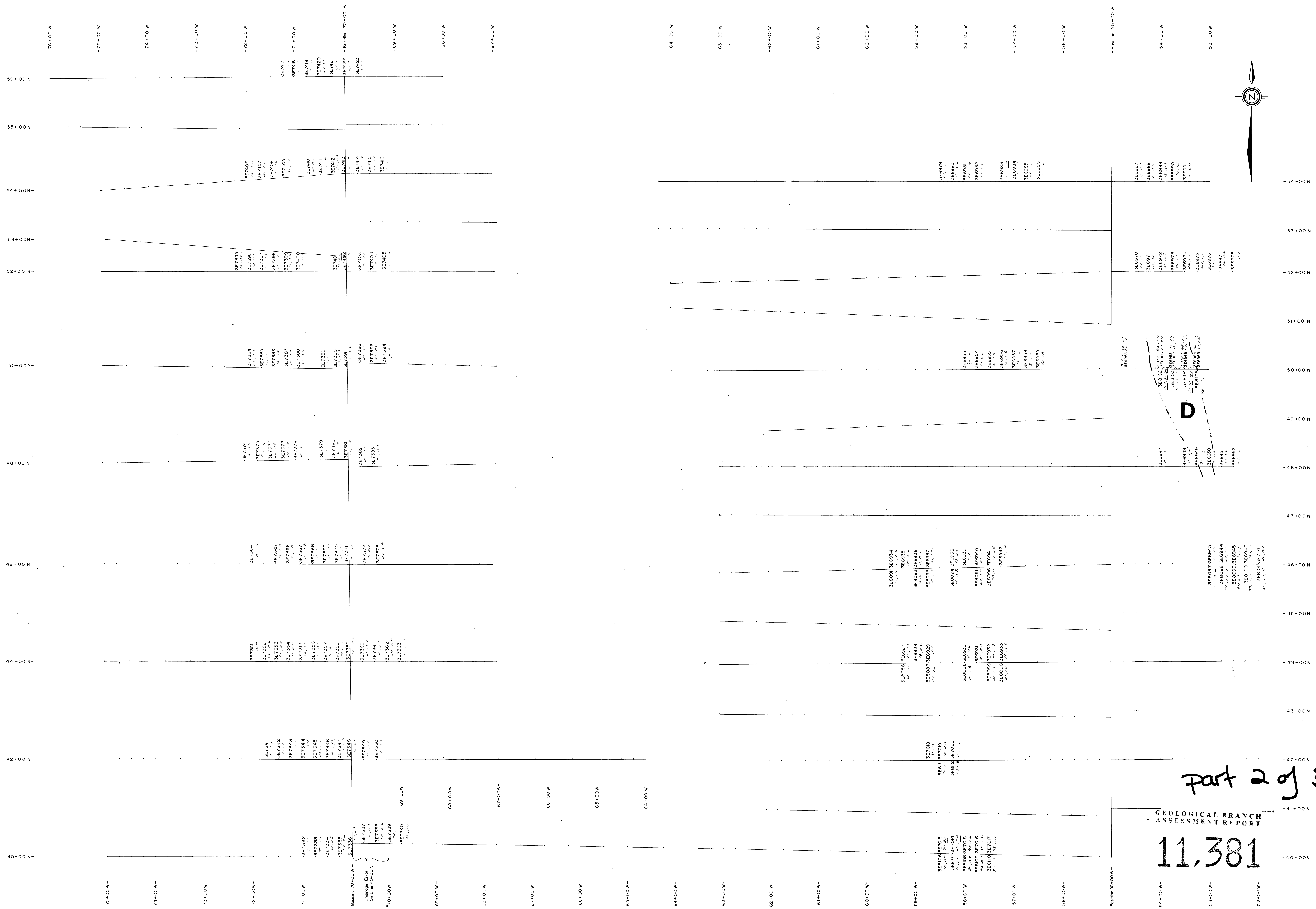

Part 2 of 3

GEOLOGICAL BRANCH
ASSESSMENT REPORT
11.381

(C Horizon) 3E6000 (B Horizon)
100 25 1 20 50 1.5 1.10
Pb(ppm), Ag(ppm), Au(ppb) Pb(ppm), Ag(ppm), Au(ppb)

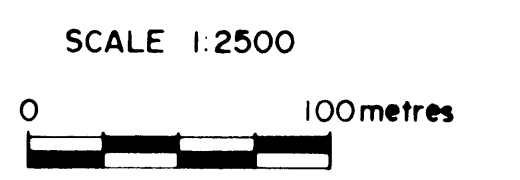

ESSO MINERALS CANADA	
BARRIER PROJECT	
GRID B-3 SOIL GEOCHEMISTRY LEAD (ppm), SILVER (ppm) ± GOLD (ppb)	
Project No. 2189	
NTS 82M/12W	Long 119°54'W
Mining Division: KAMLOOPS	Lat. 51°32'N
Date: NOV. 1983	Drawn By: C. E.
	Map No. 10

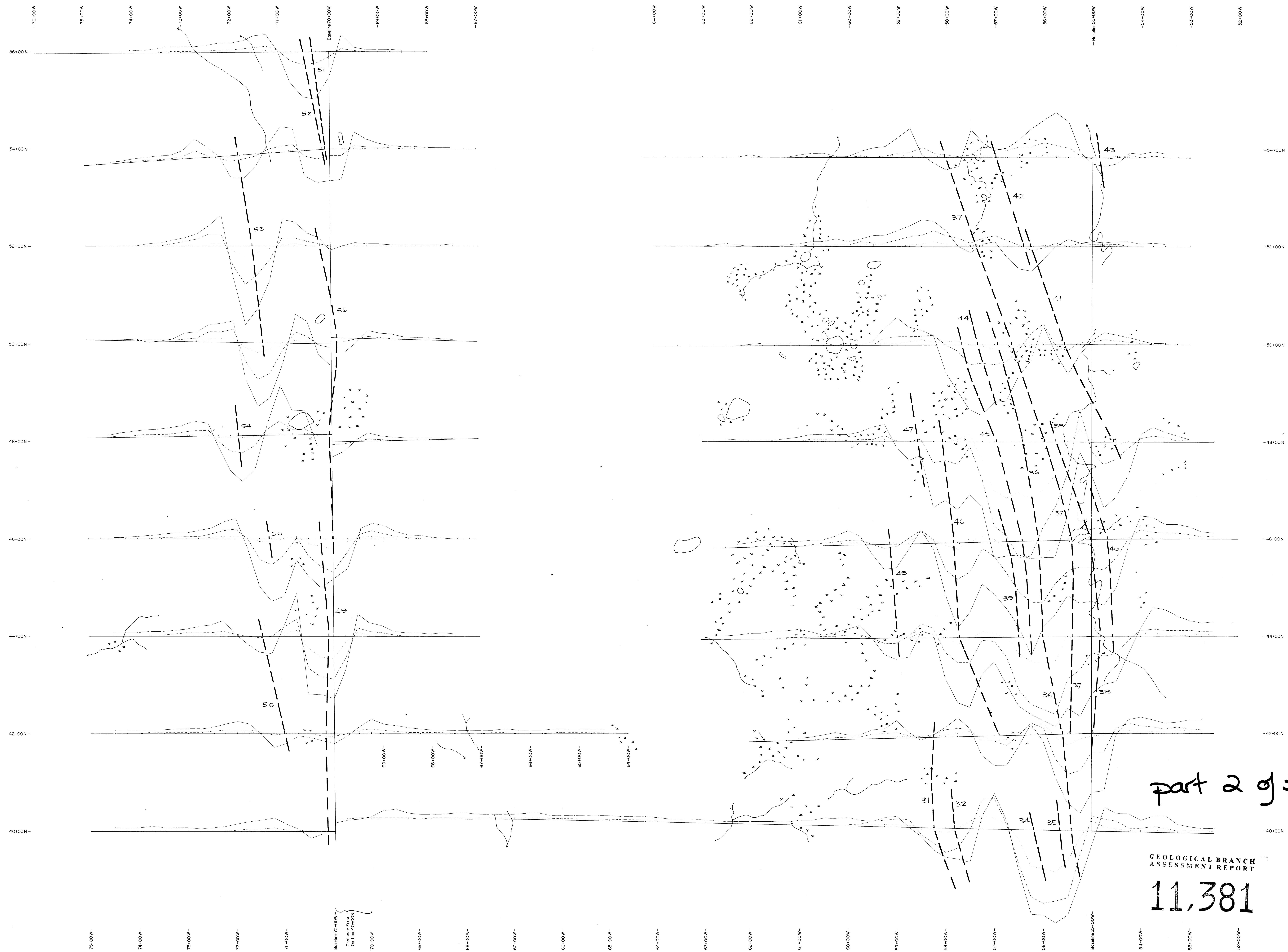

part 2 of 3

**GEOLOGICAL BRANCH
ASSESSMENT REPORT**
11,381

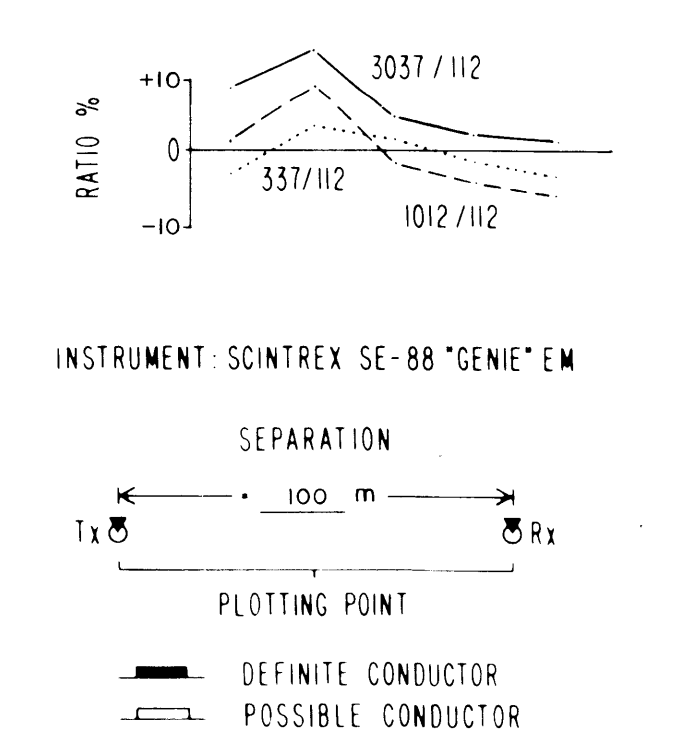

1:500 MINERALS CANADA DIV. OF 1:500 RESOURCES CANADA LIMITED	
PROSPECT: BARRIER	
B3 Grid	
HLEM SURVEY	
ACCOUNT NO. 10480	FILE NO. 2089 TORONTO
DRAWN BY: K. SIMPSON	DATE: NTS
DATE: 2/10/82	DATE: 8/23
DWG. NO.	MAP NO. II
SCALE: 1:500	
To accompany A Report By: 11381	

74-00 W 72-00 W 70-00 W 68-00 W 66-00 W 64-00 W 62-00 W 60-00 W 58-00 W 56-00 W 54-00 W 52-00 W

L 56-00 N
L 55-00 N
L 54-00 N
L 53-00 N
L 52-00 N
L 51-00 N
L 50-00 N

L 48-00 N
L 47-00 N
L 46-00 N
L 45-00 N
L 44-00 N

L 43-00 N
L 42-00 N

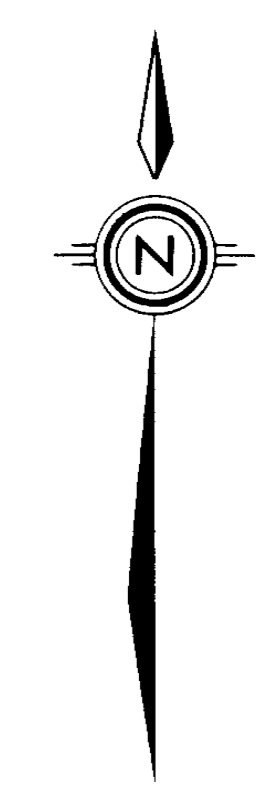
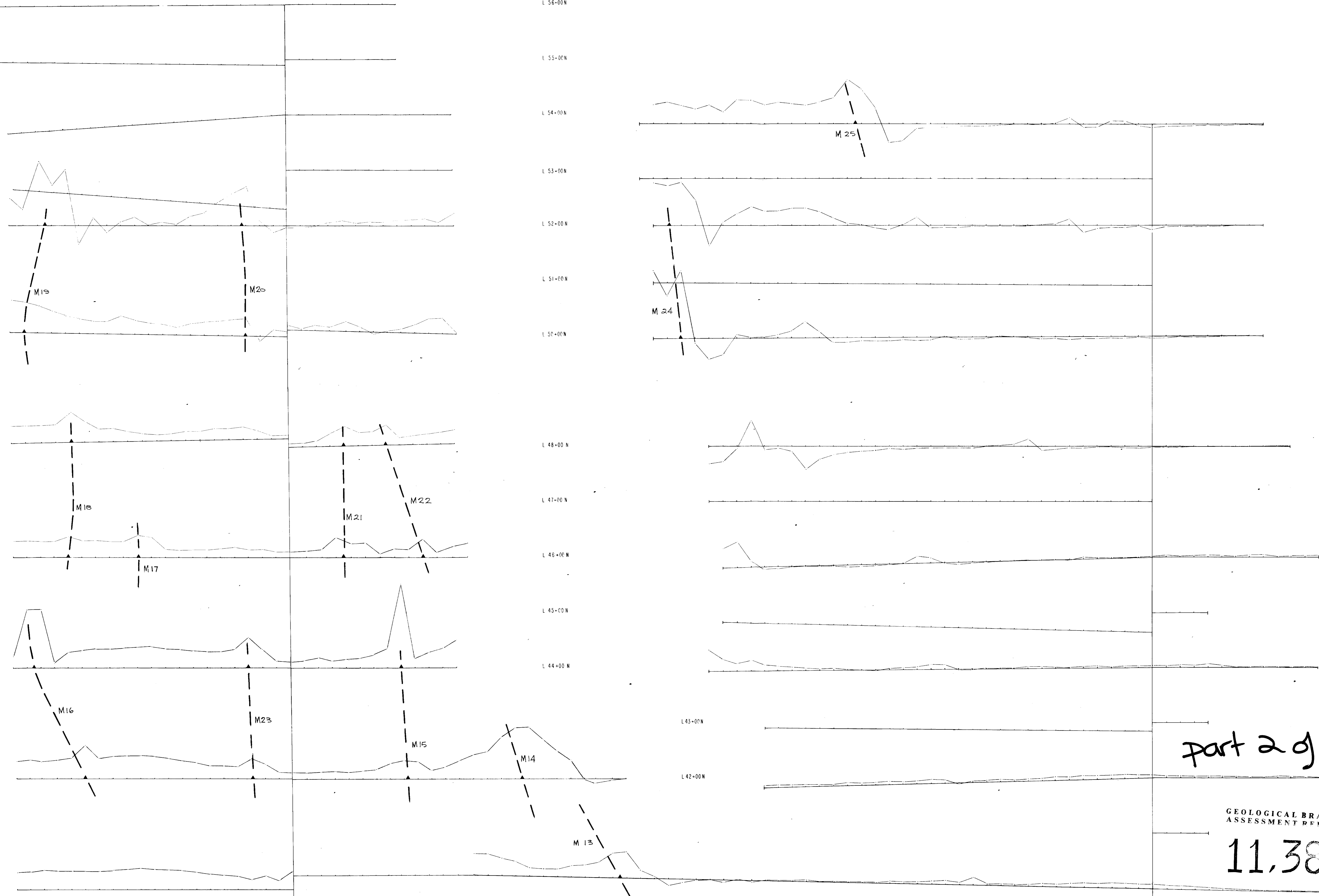

part 2 of 3

GEOLOGICAL BRANCH
ASSESSMENT REPORT

11,381

INSTRUMENT: GEOMETRICS G816 PROTON
PRECISION MAGNETOMETER
SENSITIVITY: ± 5 GAMMAS
ASSUMED MEAN GEOMAGNETIC FIELD
STRENGTH: 51830 GAMMAS

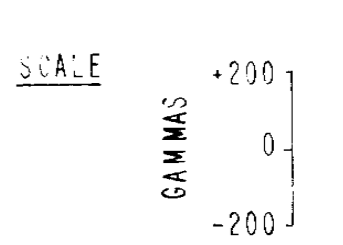

ESSE MINERALS CANADA		ESSE MINERALS CANADA LIMITED	
PROSPECT: BARRIER		MAGNETOMETER SURVEY	
ACCOUNT NO. 11381	FILE NO. 2188	DATE	NTS
DRAWN BY: K. SIMPSON, J. HUNT, S. LOWE			82W
DWG. NO.	MAP NO. 12	SCALE	
		1:2500	150M
© Esso Minerals Canada 1982			

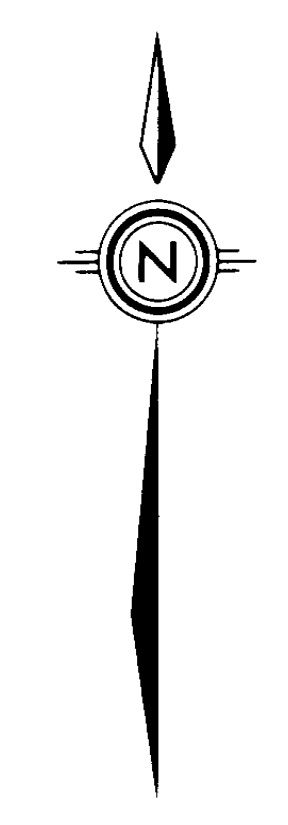
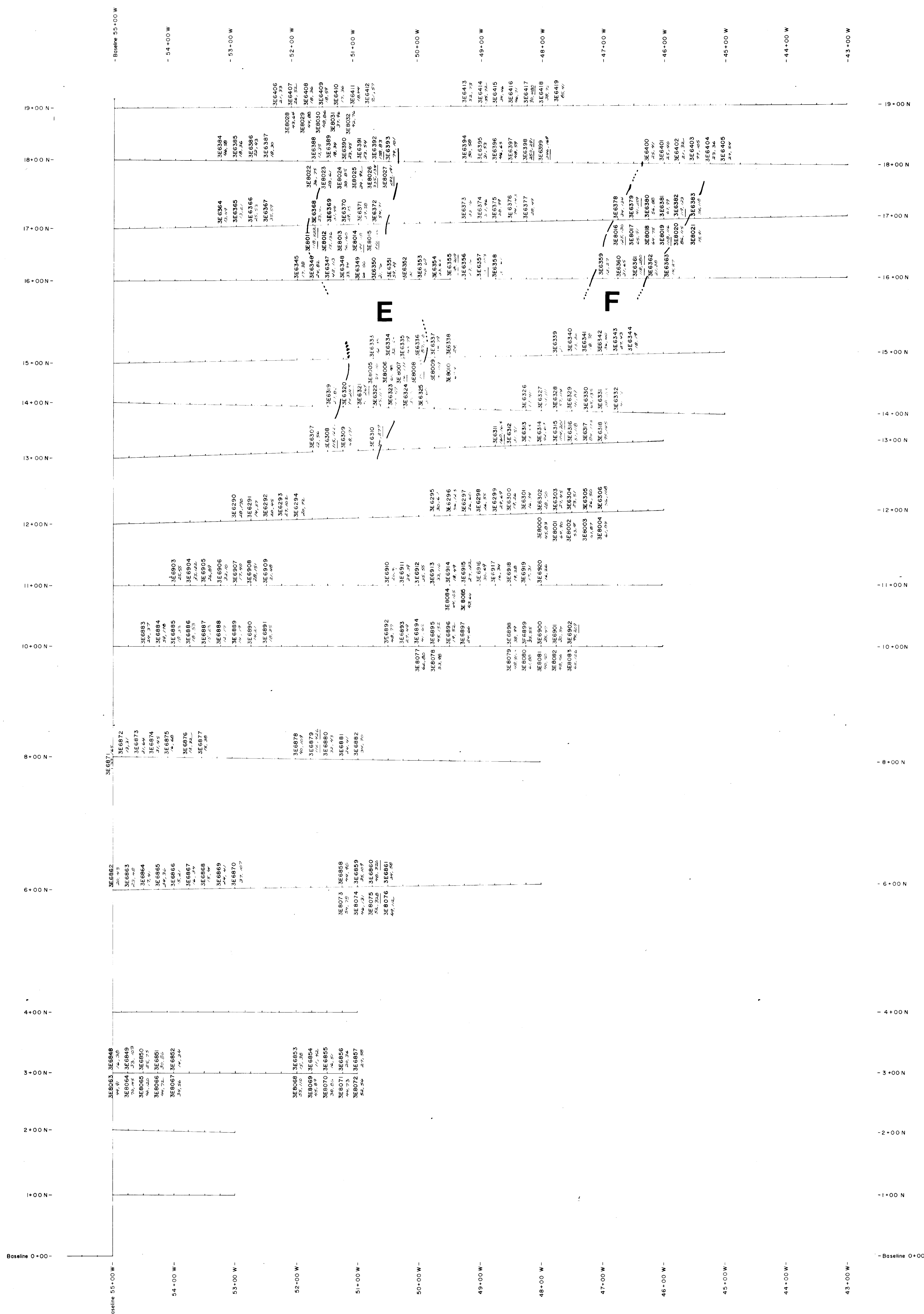

GEOLOGICAL BRANCH
 ASSESSMENT REPORT

11,381
 part 2 of 3

(C Horizon) 3E8000-3E6000(B Horizon)
 100, 400 50, 200
 Cu(ppm), Zn(ppm) Cu(ppm), Zn(ppm)

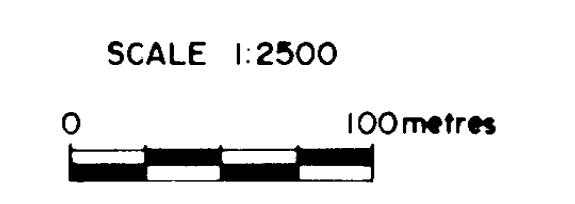

ESSO MINERALS CANADA

 BARRIER PROJECT
 GRID B-4
 SOIL GEOCHEMISTRY
 COPPER(ppm), ZINC(ppm)

Project No. 2189	
NTS 82 M/12 W	Long. 119° 54' W
	Lat. 51° 32' N
Mining Division KAMLOOPS	Drawn By: C.E.
Date: NOV. 1983	Map No. 13

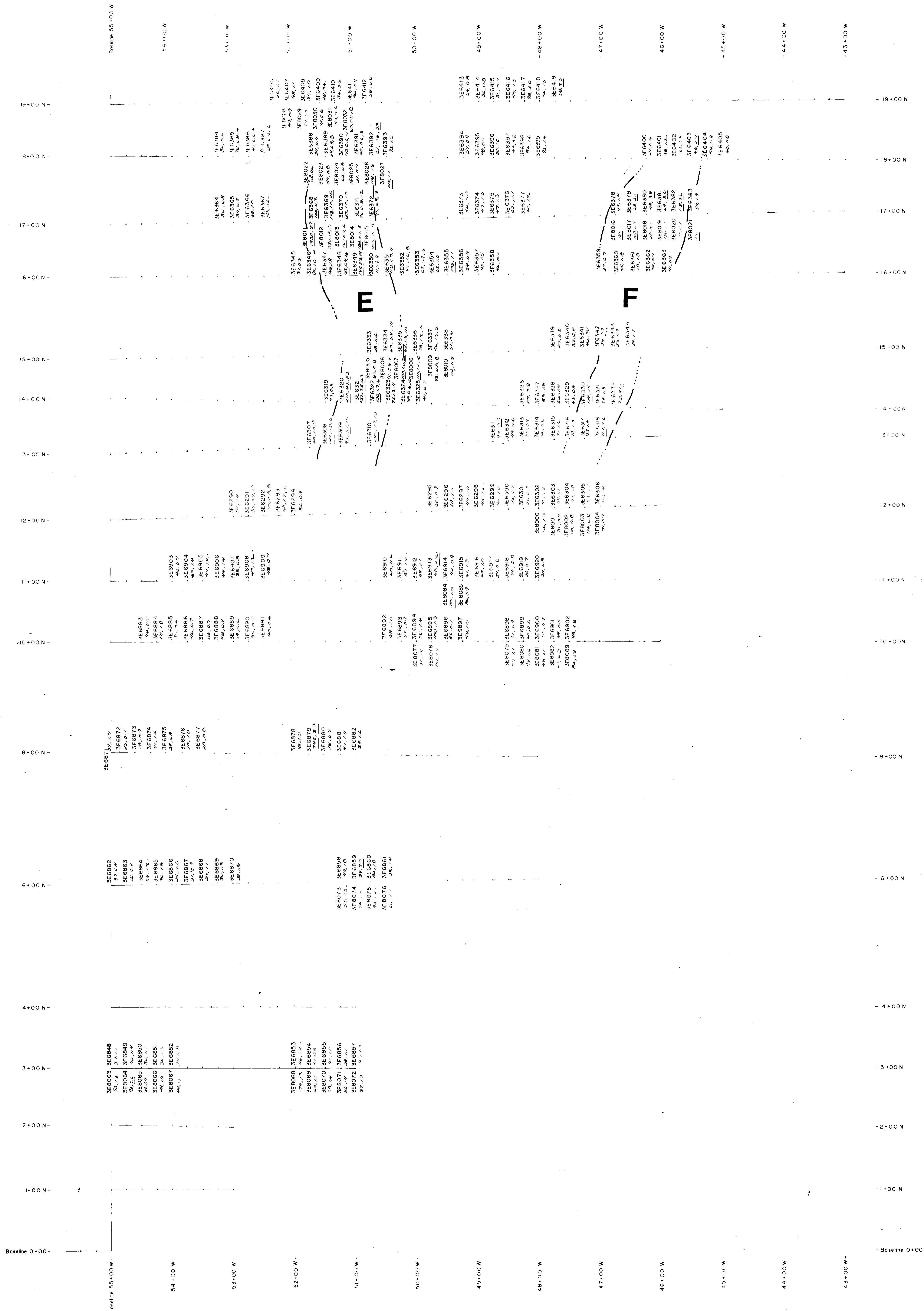

GEOLOGICAL BRANCH
ASSESSMENT REPORT

11,381

part 2
of 3

(C Horizon) 3E8000 3E6000 (B Horizon)
100, 2.5, 20 50, 1.5, 10
Pb(ppm), Ag(ppm), Au(ppb) Pb(ppm), Ag(ppm), Au(ppb)

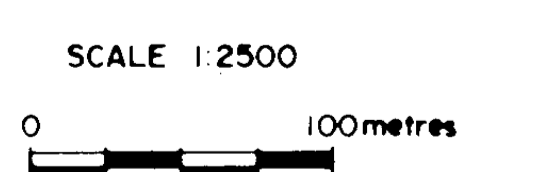

ESSO MINERALS CANADA	
BARRIER PROJECT	
GRID B-4 SOIL GEOCHEMISTRY LEAD (ppm), SILVER (ppm) ± GOLD (ppb)	
Project No. 2189	Long. 119° 54' W
NTS 82 M/12W	Lat. 51° 32' N
Mining Division KAMLOOPS	Drawn By: C.E.
Date NOV. 1983	Map No. 14