

GEOLOGICAL BRANCH
ASSESSMENT REPORT

11,381

part 3
of 3

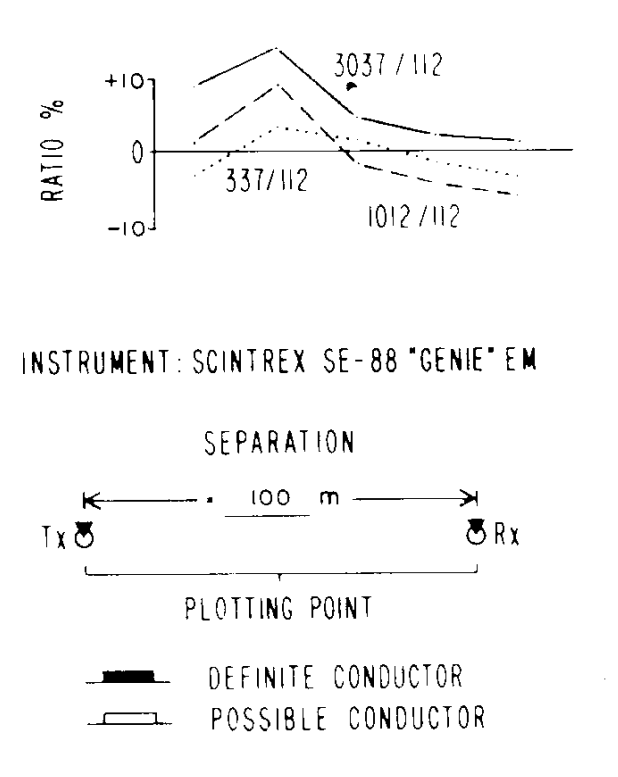
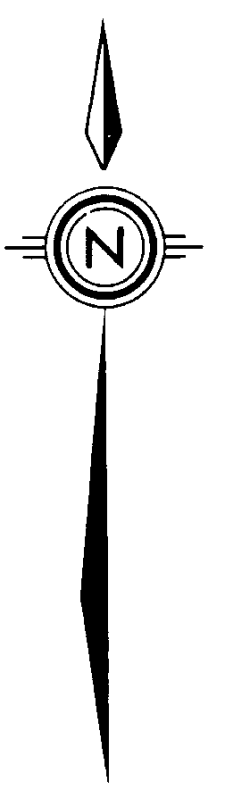

INSTRUMENT: SCINTREX SE-88 "GENIE" EM
SEPARATION
100 m
PLOTTING POINT
DEFINITE CONDUCTOR
POSSIBLE CONDUCTOR

| | | | |
|---|---------------|---------|-----|
| ESKO MINERALS CANADA DIV. OF ESKO RESOURCES CANADA LIMITED | | | |
| PROSPECT: BARRIER B4 Grid HELM SURVEY | | | |
| ACCOUNT NO: MABS | FILE NO: 2189 | TORONTO | |
| DRAWN BY: K. SIMPSON J. HUNT S. LOWE | DATE | N.T.S. | 82M |
| DWG. NO. | MAP NO: 15 | | |
| SCALE 0 50 100m 1:2500 | | | |
| To accompany Report by Date: | | | |

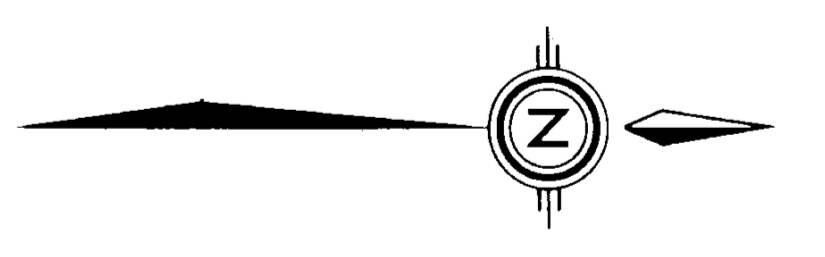
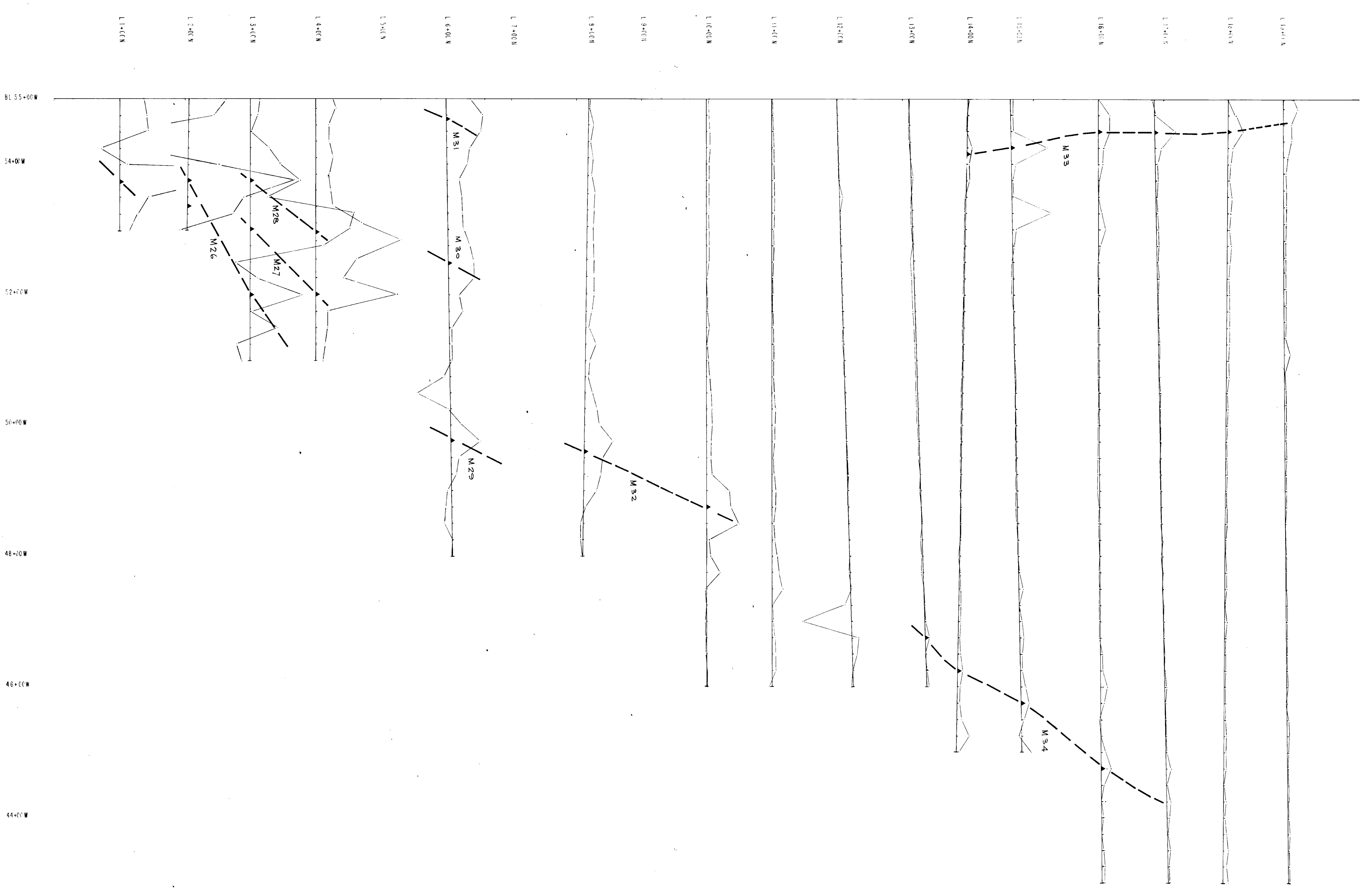

GEOLOGICAL BRANCH
 ASSESSMENT REPORT
11,381
 part 3 of 3

INSTRUMENT: GEOMERICS 0816 PROCTOR
 PRECISION: MICRO METER
 SENSITIVITY: 1.5 GAMMAS
 ASSUMED MEAN GEOMAGNETIC FIELD
 STRENGTH: 5930 GAMMAS
 SCALE
 0 -200
 0
 -200

| | |
|----------------------|--------------|
| ESB MINERAL SERVICES | |
| PROJECT: BARRE | |
| E4 0810 | |
| KAMNETTER SURVEY | |
| ACCOUNT NO. M18 | FILE NO. 113 |
| DRAWN BY: K. SIMPSON | DATE: 16 |
| CHECKED BY: J. HORN | DATE: 16 |
| CAD NO. 16 | SCALE: 1:200 |
| 0 | 100M |

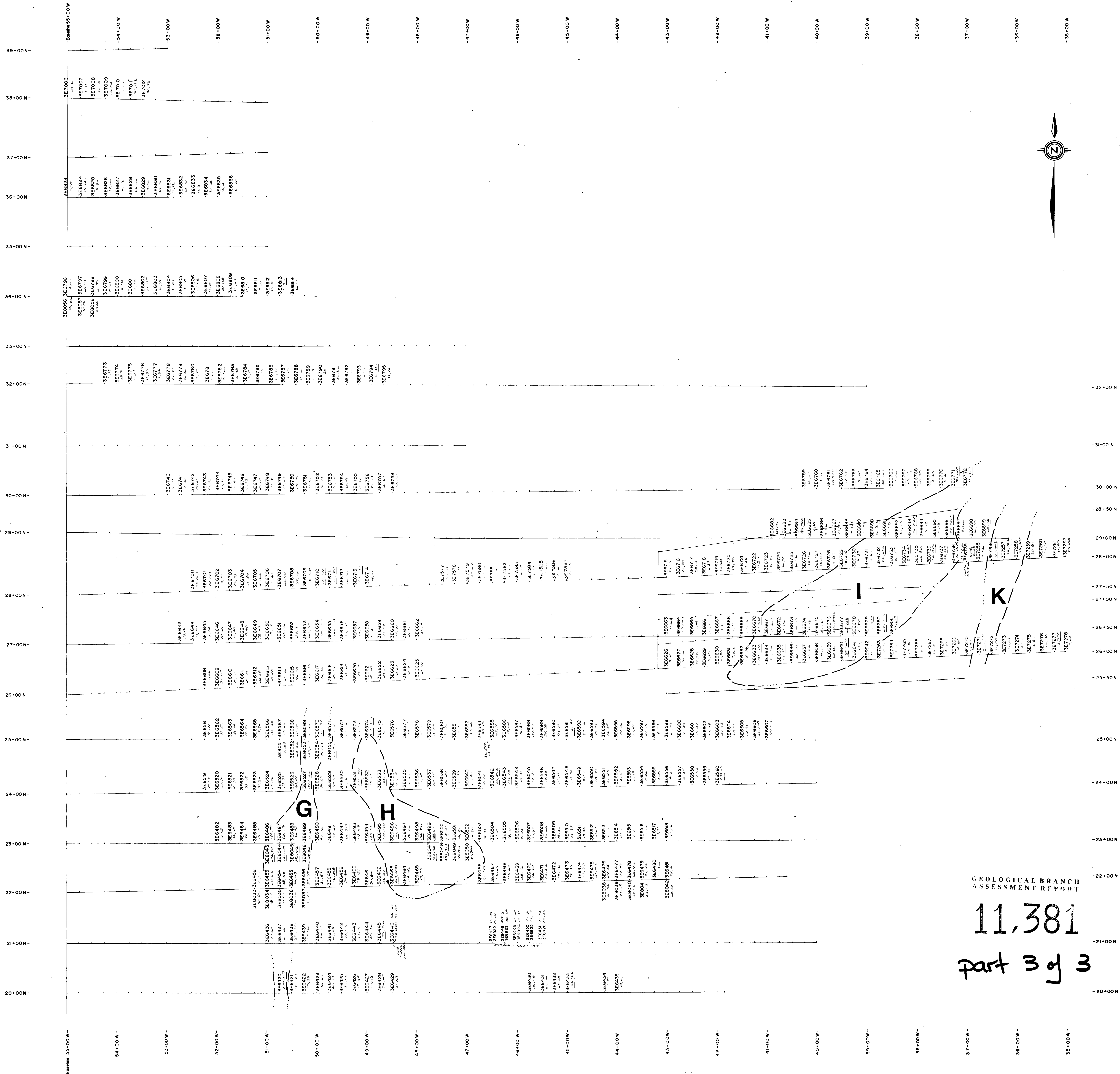

GEOLOGICAL BRANCH
ASSESSMENT REPORT

11,381

part 3 of 3

(C Horizon) 3E6000 3E6000(B Horizon)
100, 400
Cut(ppm), Zn(ppm) Cut(ppm), Zn(ppm)

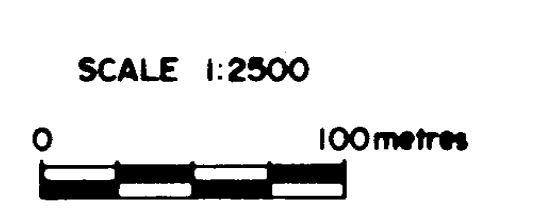

ESSO MINERALS CANADA

BARRIER PROJECT

GRID B-5
SOIL GEOCHEMISTRY
COPPER(ppm), ZINC(ppm)

Project No. 2109
NTS 82M/12W Long. 119°54' W
Lat. 51°32' N
Mining Division/KAMLOOPS Drawn By: C.E.
Date: NOV. 1983 Map No. 17

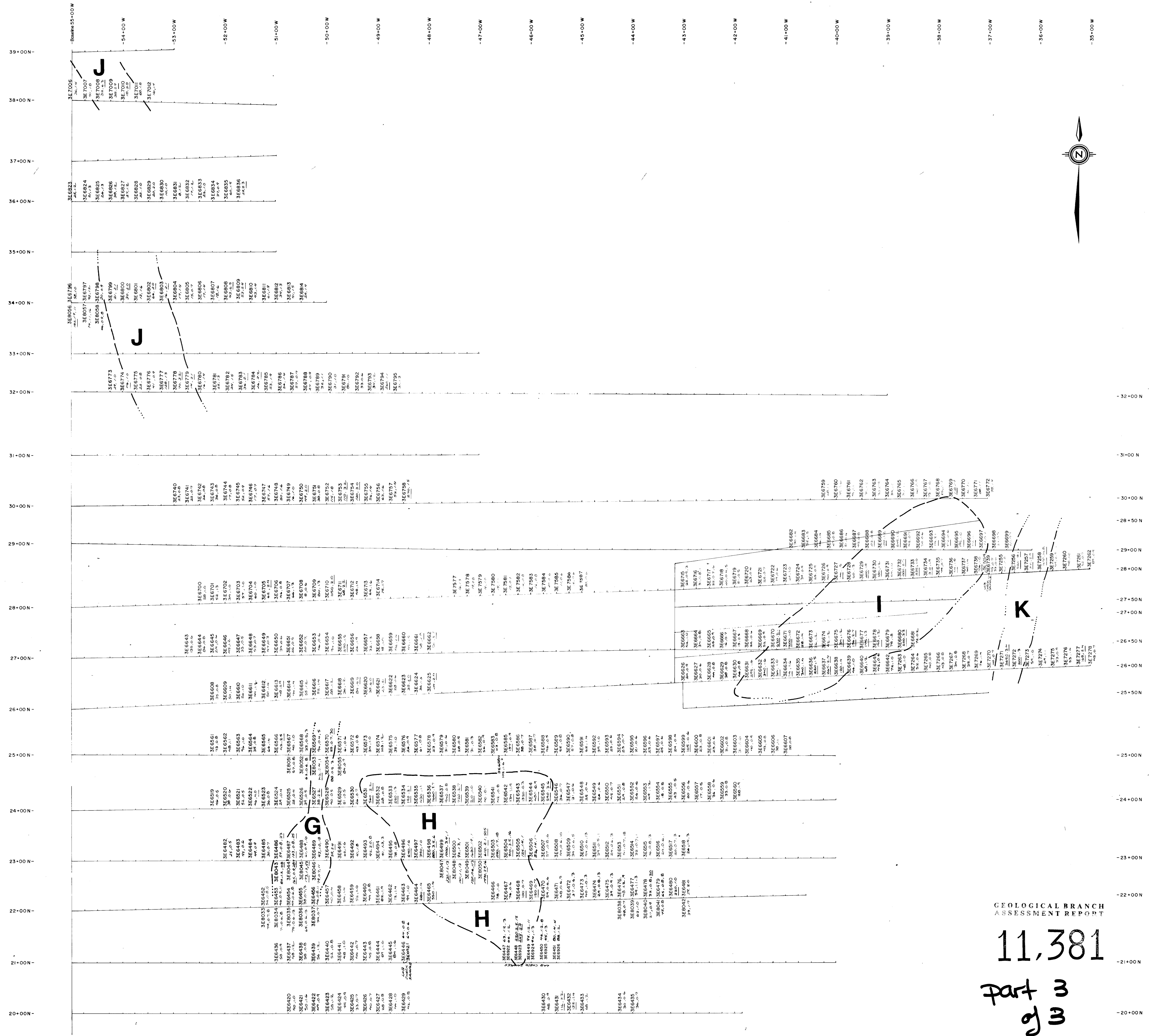

GEOLOGICAL BRANCH
ASSESSMENT REPORT

11,381
part 3
of 3

(C Horizon) 3E6000 (B Horizon) 3E6000 (I Horizon) 3E6000
100, 25, 20 50, 15, 10
Pb(ppm), Ag(ppm), Au(ppb) Pb(ppm), Ag(ppm), Au(ppb)

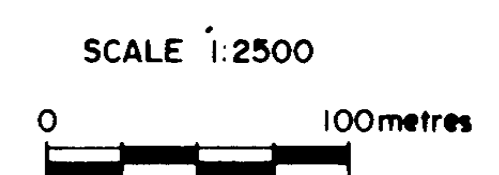

| | |
|---|------------------------------|
| ESSO MINERALS CANADA | |
| BARRIER PROJECT | |
| GRID B-5 SOIL GEOCHEMISTRY LEAD (ppm), SILVER (ppm) ± GOLD (ppb) | |
| Project No. 2189 | |
| NTS 82M/12W | Long 119°54'W Lat 51°32'N |
| Mining Division/KAMLOOPS | Drawn By: C. E. |
| Date: NOV. 1983 | Map No. 18 |

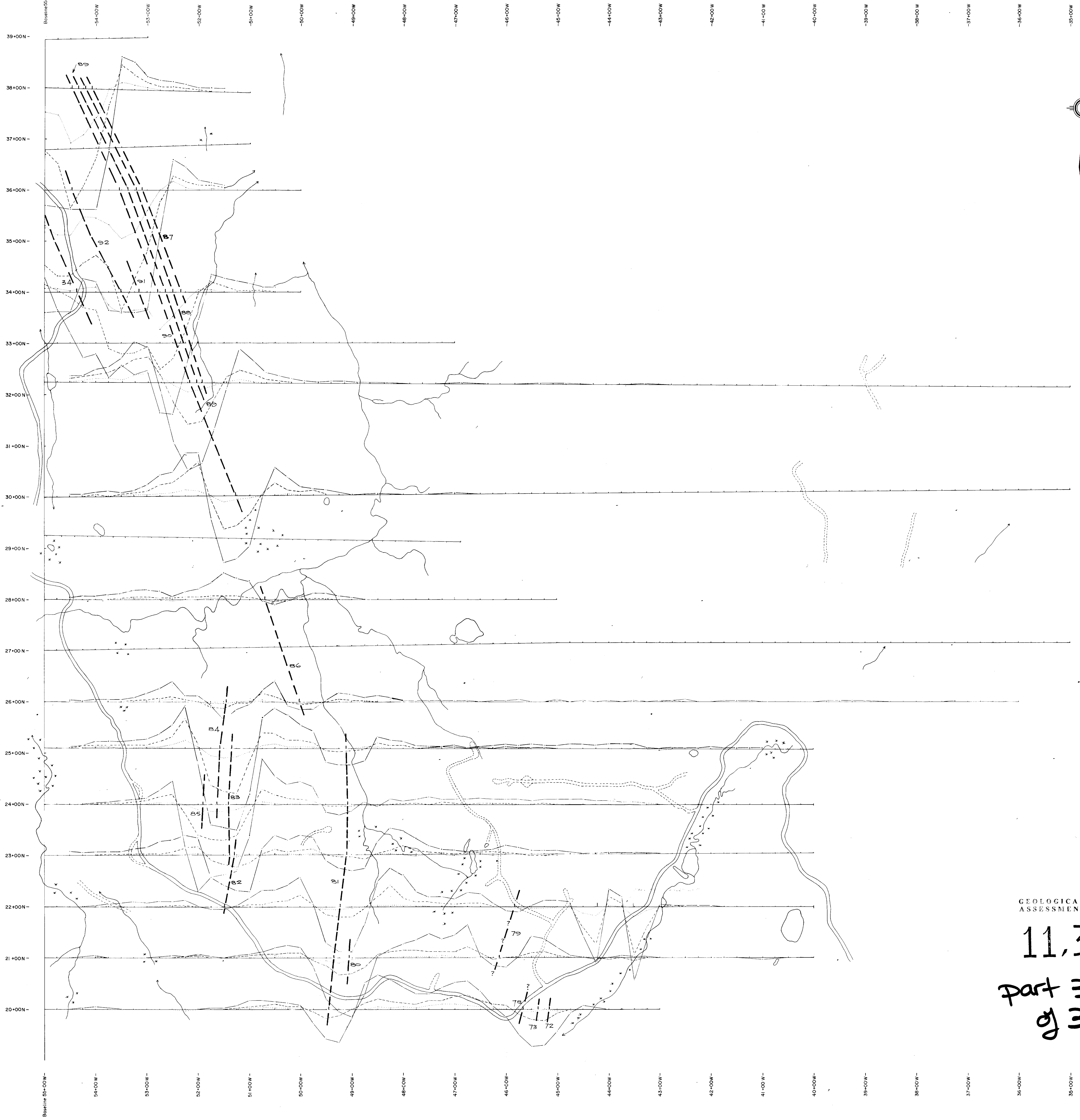

GEOLOGICAL BRANCH
ASSESSMENT REPORT

11,381

Part 3
of 3

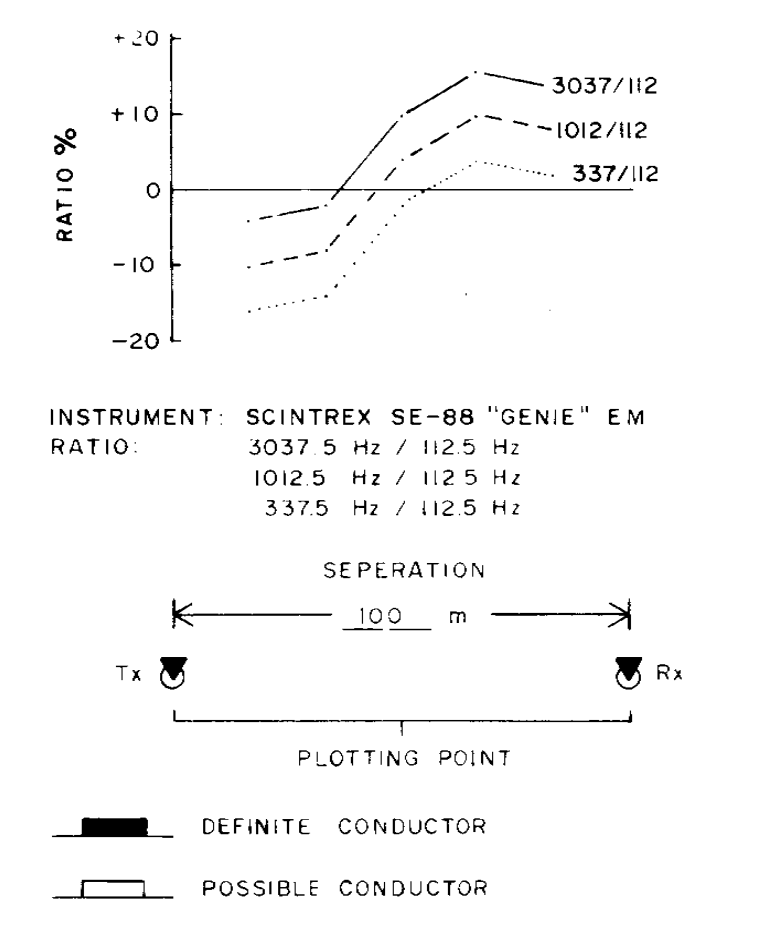

| | |
|---|----------------------|
| ESSO MINERALS CANADA LTD. OF ESSO RESOURCES CANADA LIMITED | |
| PROSPECT: BARRIER NUMBER 5 GRID HLEM SURVEY | |
| PROJECT No 2189 | FILE No 2189 TORONTO |
| DRAWN BY: S. LOWE | DATE: NTS 82M |
| LAT: 51° 32' N | MAP No. 19 |
| LONG: 119° 54' W | |
| SCALE 0 50 100 m 1:2500 | |
| TO ACCOMPANY A REPORT BY: DATED: | |

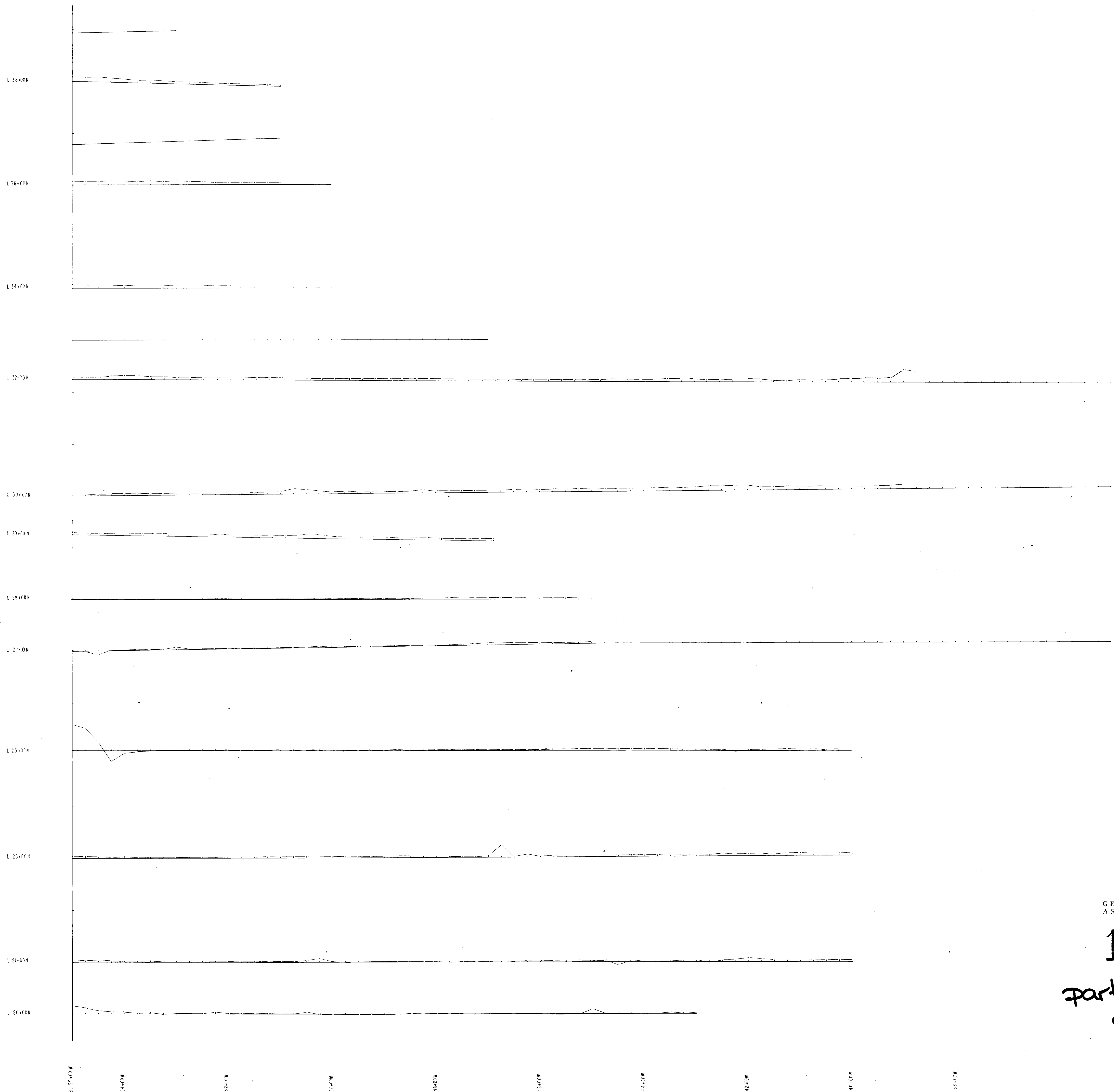
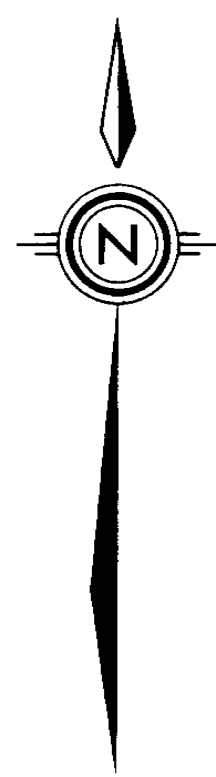

GEOLOGICAL BRANCH
ASSESSMENT REPORT

11,381

Part 3
of 3

INSTRUMENT: GEOMETRICS 016 PROTON
PRECISION: MAGNETOMETER
SENSITIVITY: + 5 GAMMAS
ASSEMBLED MEAN GEOMAGNETIC FIELD
STRENGTH: 5450 GAMMAS

SCALE
GAMMAS
+200
0
-200

| | |
|---|-----------------------|
| ES&O MINERALS CANADA LTD. OF ES&O RESOURCES CANADA LIMITED | |
| PROSPECT: | BARRIER |
| ES GRID | |
| MAGNETOMETER SURVEY | |
| ACCOUNT NO. M883 | FILE NO. 2183 TORONTO |
| DRAWN BY: K. SIMPSON, J. HUNT, S. LOVE | DATE: NTS 82M |
| DWG. NO. | MAP NO. 20 |
| SCALE 1:2500 | |
| 0 100M | |
| Geological Report No. 2084 | |

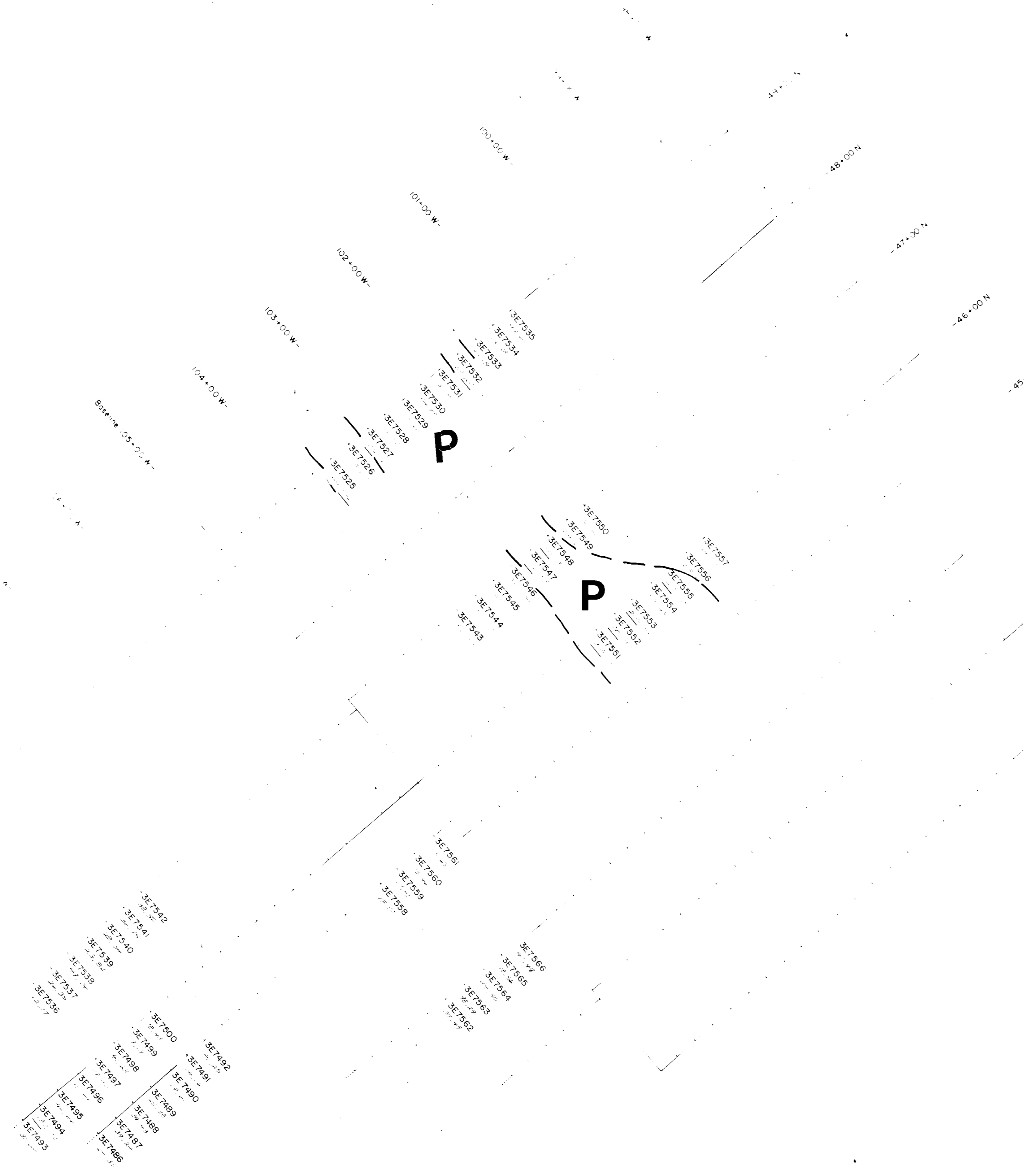
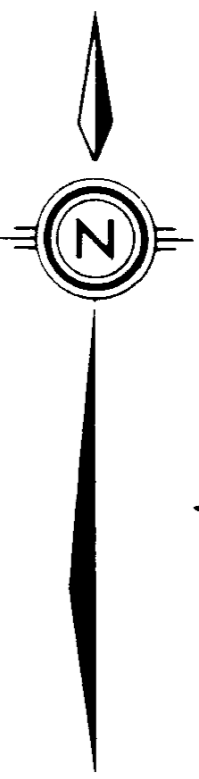

GEOLOGICAL BRANCH
ASSESSMENT REPORT

11,381

part 3
of 3

(C Horizon) 3E8000 (B Horizon) 3E6000
100, 400 50, 200
Cu(ppm), Zn(ppm) Cu(ppm), Zn(ppm)

SCALE 1:2500



ESSO MINERALS CANADA

BARRIER PROJECT
GRID B-8 NORTH
SOIL GEOCHEMISTRY
COPPER(ppm), ZINC(ppm)

Project No. 2189

NTS 82M/12W

Long. 119° 54' W
Lat. 51° 32' N

Mining Division KAMLOOPS

Drawn By: C.E.

Date NOV. 1983

Map No. 21

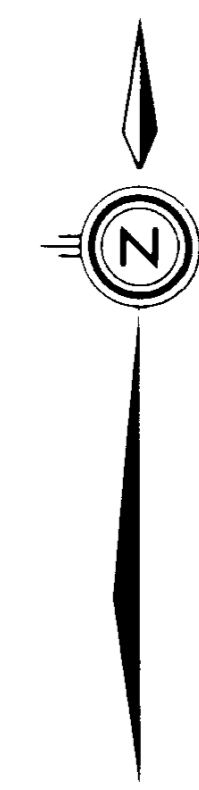

GEOLOGICAL BRANCH
ASSESSMENT REPORT

11,381

part 3
of 3

(C Horizon) 3E8000 3E6000 (B Horizon)
100, 25, 20 50, 15, 10
Pb(ppm), Ag(ppm), Au(ppb) Pb(ppm), Ag(ppm), Au(ppb)

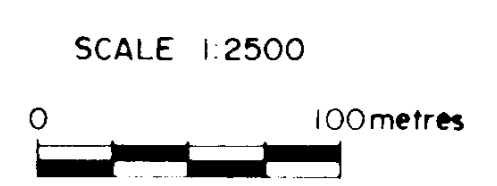

| | |
|--------------------------|-----------------------------------|
| ESSO MINERALS CANADA | |
| BARRIER PROJECT | |
| GRID B-8 NORTH | |
| SOIL GEOCHEMISTRY | |
| LEAD(ppm), SILVER(ppm) | |
| ± GOLD(ppb) | |
| Project No. 2189 | |
| NTS 82M/12W | Long 119° 54' W Lat. 51° 32' N |
| Mining Division KAMLOOPS | Drawn By C.E. |
| Date NOV. 1983 | Map No. 22 |

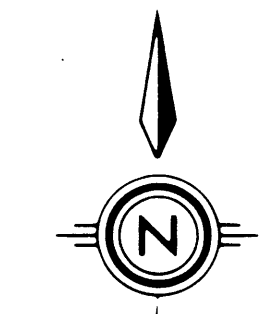
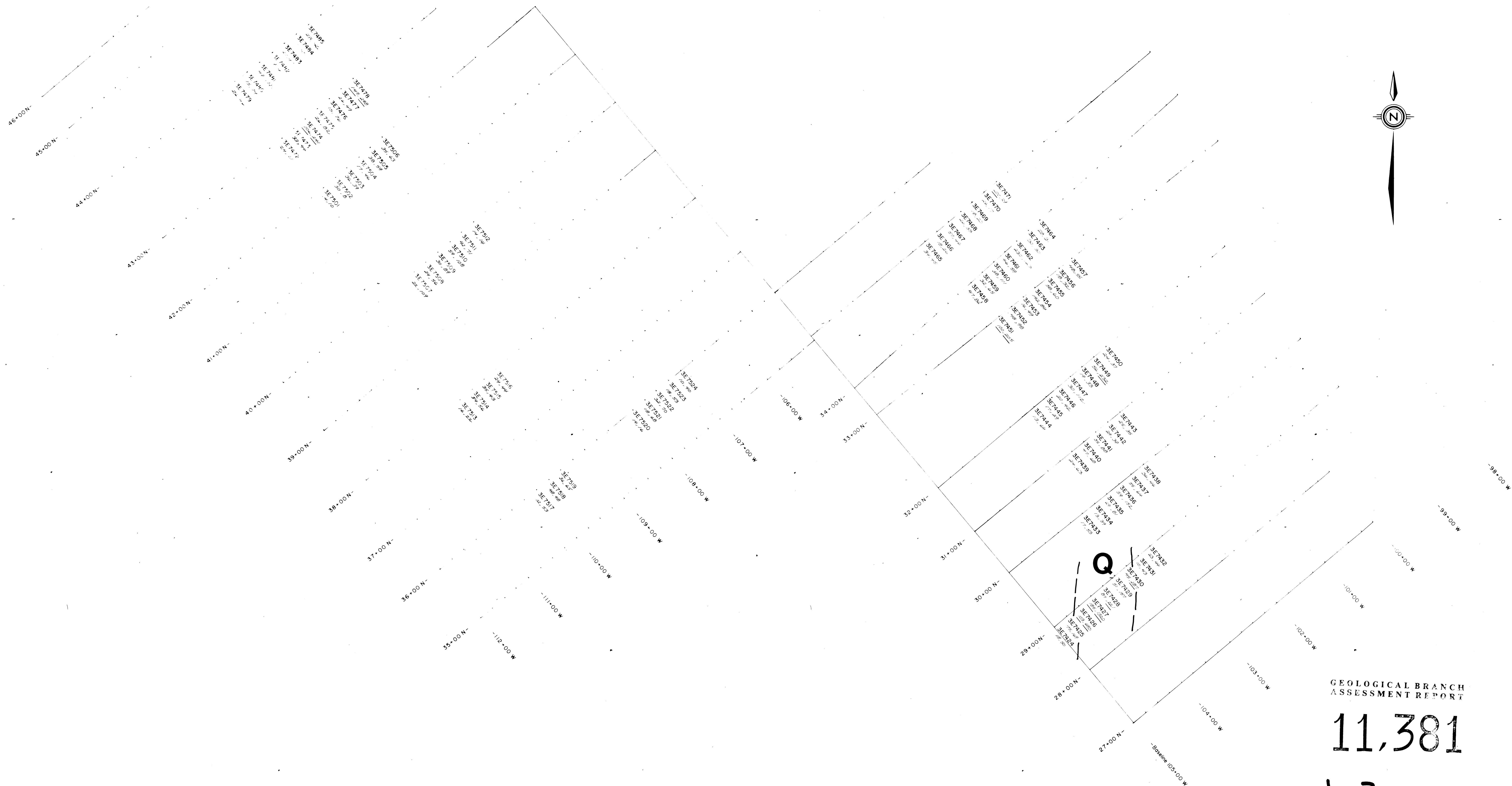

GEOLOGICAL BRANCH
ASSESSMENT REPORT

11,381

part 3
of 3

(C Horizon) 3E8000 3E6000 (B Horizon)
100, 400 50, 200
Cu(ppm), Zn(ppm) Cu(ppm), Zn(ppm)

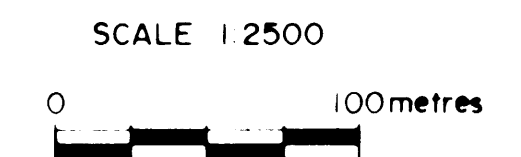

| | |
|---------------------------|------------------|
| ESSO MINERALS CANADA | |
| BARRIER PROJECT | |
| GRID B-8 SOUTH | |
| SOIL GEOCHEMISTRY | |
| COPPER(ppm), ZINC(ppm) | |
| Project No. 2189 | |
| NTS 82 M/12 W | Long. 119° 54' W |
| | Lat. 51° 32' N |
| Mining Division: KAMLOOPS | Drawn By: C.E. |
| Date: NOV. 1983 | Map No. 23 |

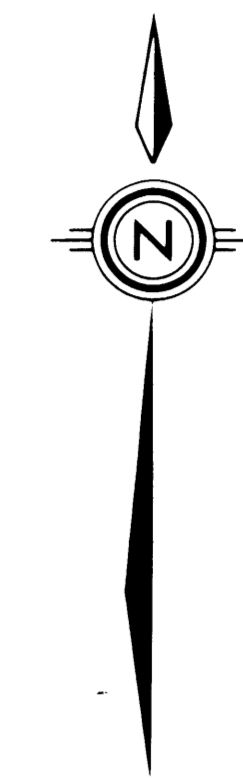
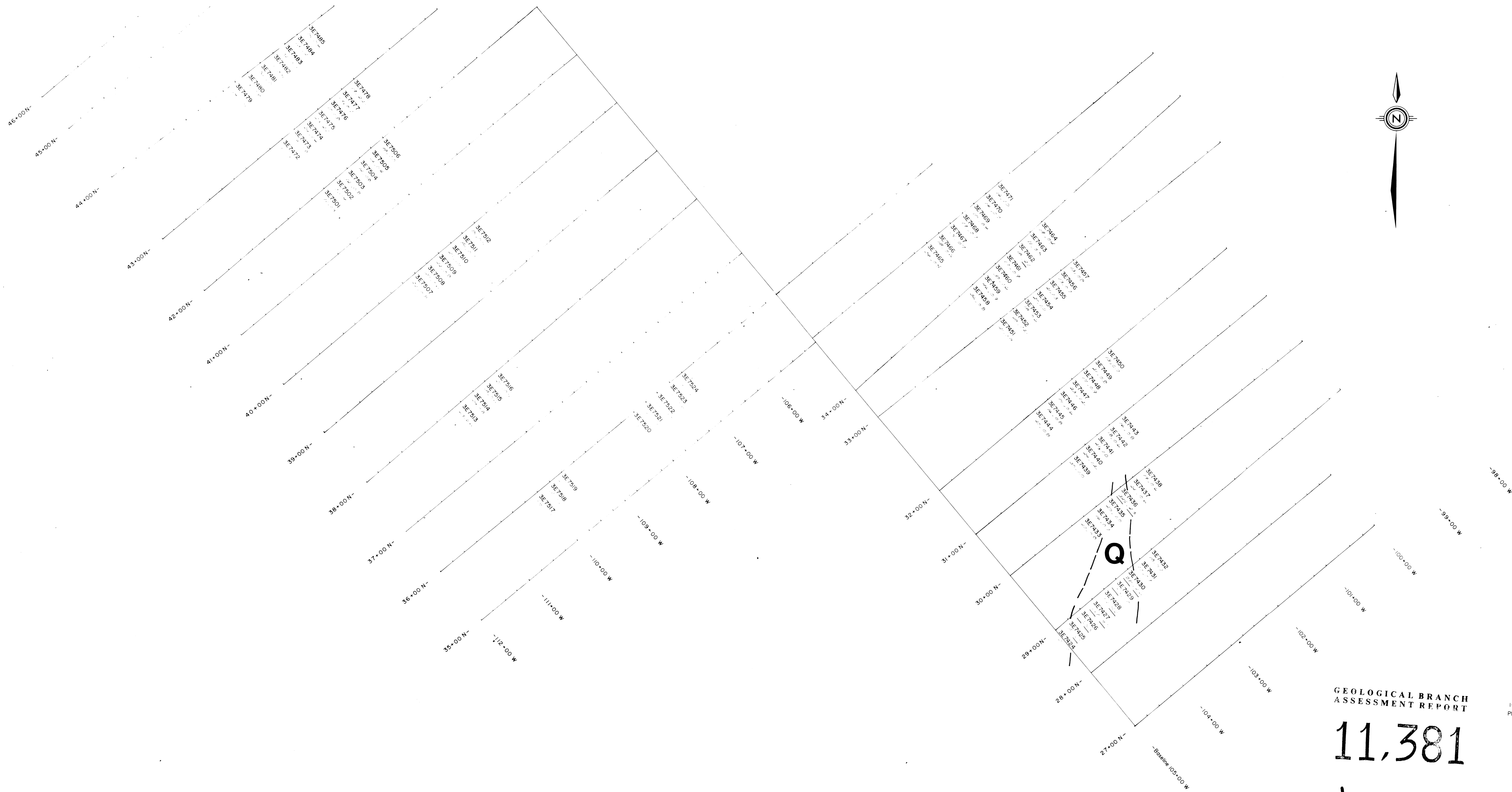

part 3
of 3

GEOLOGICAL BRANCH
ASSESSMENT REPORT

11,381

(C Horizon) 3E8000 3E6000 (B Horizon)
100, 2.5, 20 50, 1.5, 10
Pb(ppm), Ag(ppm), Au(ppb) Pb(ppm), Ag(ppm), Au(ppb)

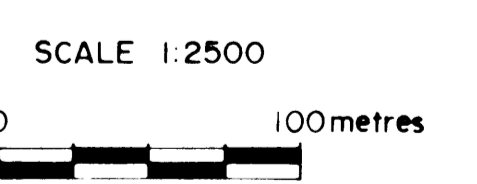

| | |
|---|----------------------------------|
| ESSO MINERALS CANADA | |
| BARRIER PROJECT | |
| GRID B-8 SOUTH SOIL GEOCHEMISTRY LEAD (ppm), SILVER (ppm) ± GOLD (ppb) | |
| Project No. 2189 | |
| NTS 82M/12W | Long 119° 54' W Lat 51° 32' N |
| Mining Division KAMLOOPS | Drawn By: C.E. |
| Date: NOV. 1983 | Map No. 24 |

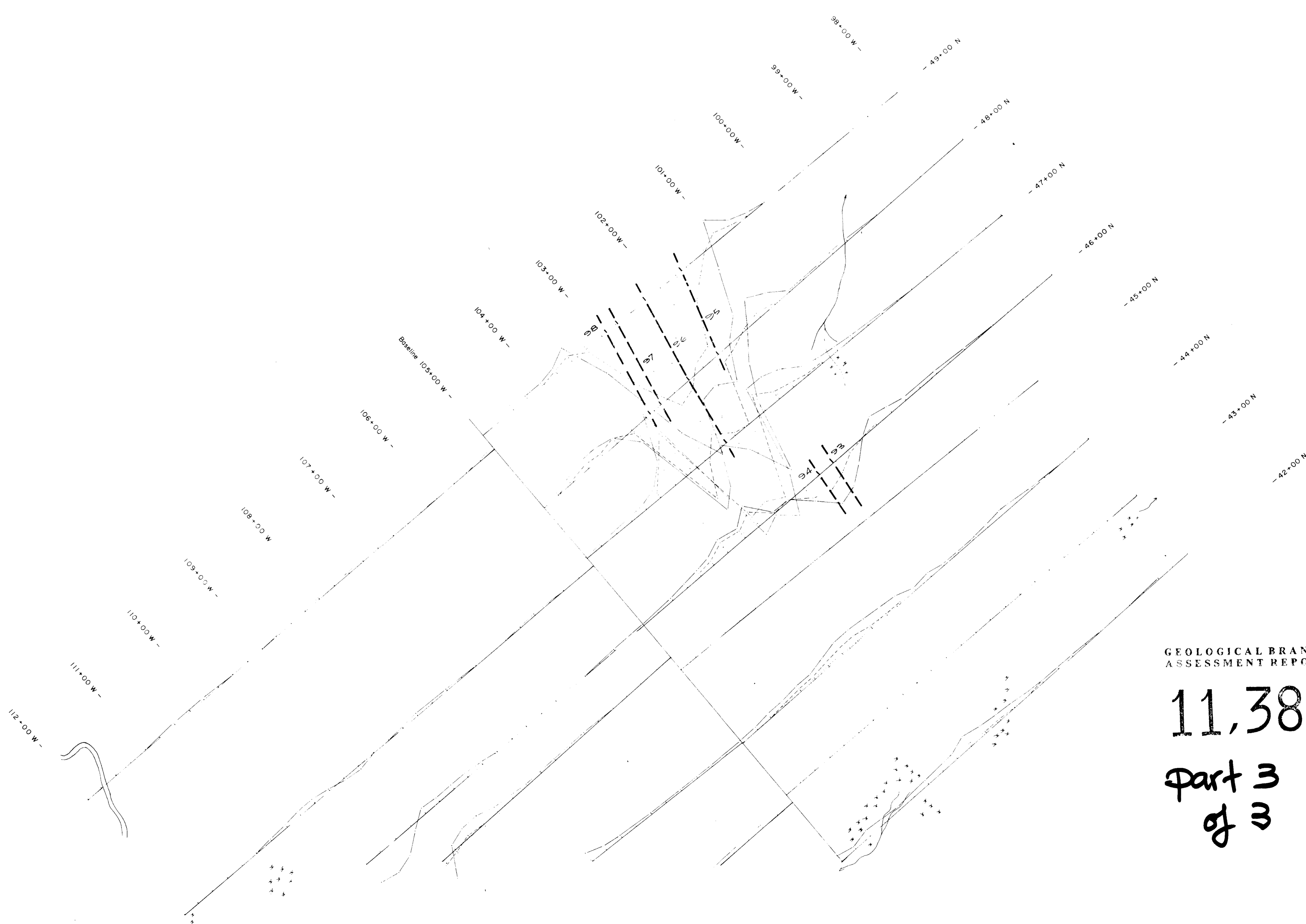

GEOLOGICAL BRANCH
ASSESSMENT REPORT

11,381

Part 3
of 3

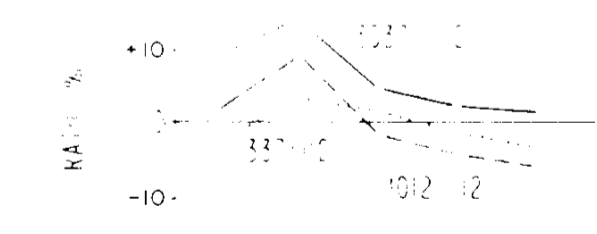

SHEETMENT 50°N 75°E - 88°10'N 10°E
SEPARATION
100 m
PLACING POINT
DEFINITE CONDUCTOR
POSSIBLE CONDUCTOR

| | | | |
|--|---------------|---------|------|
| 1950 MINERALS CANADA | | TORONTO | |
| PROSPECT: BARRIER GRID B-8 NORTH HLEM SURVEY | | | |
| ACCOUNT NO. M489 | FILE NO. 2189 | | |
| DRAWN BY: K. SIMPSON S. HUNT S. LOWE | DATE | NIS | 82 M |
| MAP NO. 20 | SCALE | | |
| 0 50 100 m 1:2500 | | | |

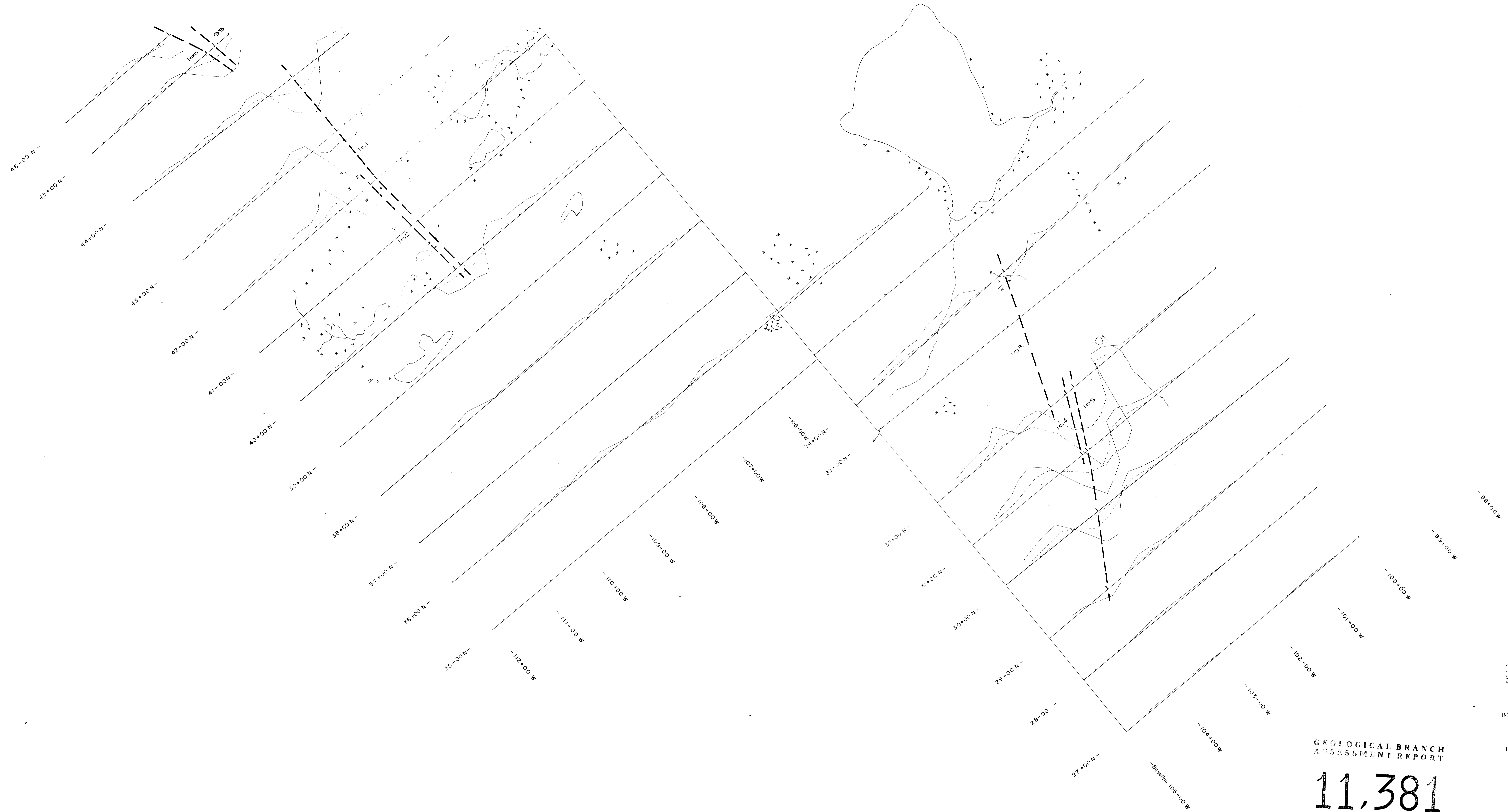

GEOLOGICAL BRANCH
ASSESSMENT REPORT

11,381

part 3 of 3

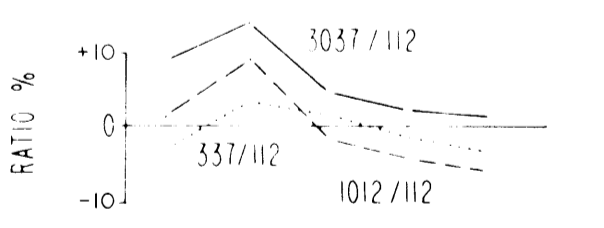

INSTRUMENT SCINTREX SE-88 "GENIE" EM

SEPARATION

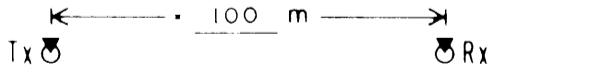

PLOTTING POINT

— DEFINITE CONDUCTOR
- - - POSSIBLE CONDUCTOR

| | | |
|--|--------------|------------|
| ESSO MINERALS CANADA DIV'N OF ESSO RESOURCES CANADA LIMITED | | |
| PROSPECT: BARRIER | | |
| GRID B-8 SOUTH | | |
| HELM SURVEY | | |
| ACCOUNT NO MAB9 | FILE NO 2189 | TORONTO |
| DRAWN BY: K. SIMPSON & R. HUNT S. LOWE | DATE | NTS 82M |
| DWG NO | MAP NO 26 | |
| SCALE 0 50 100 m 1:2500 | | |
| To Accompany A Report By: Date: | | |

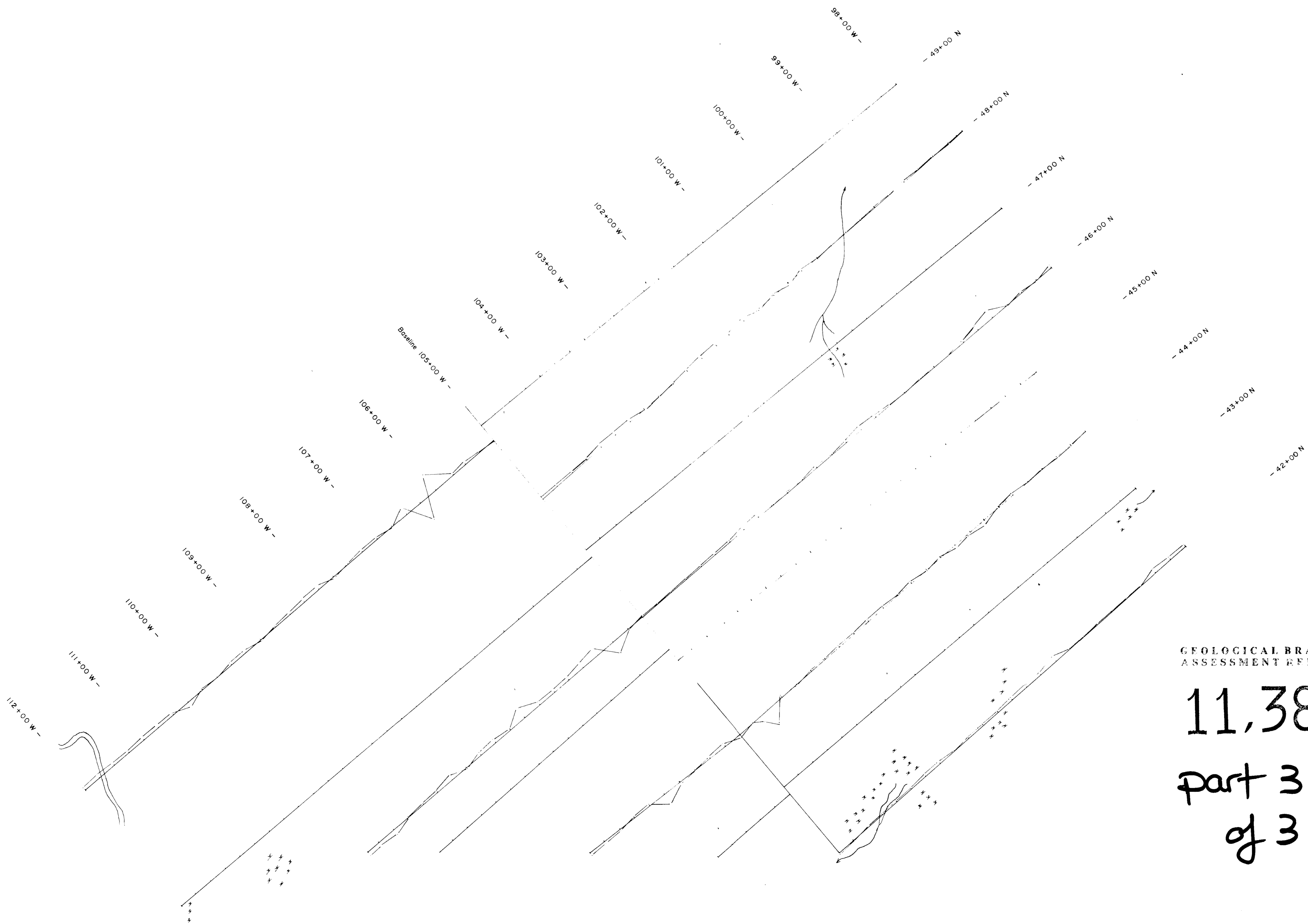

GEOLOGICAL BRANCH
 ASSESSMENT REPORT

 11,381
 part 3
 of 3

INSTRUMENT: GEOMETRIS MODEL 104 PROVA
 PRESSION MAGNETOMETER
 SCALE: 1:50000
 INSTRUMENT: GEOMETRIS MODEL 104 PROVA
 PRESSION MAGNETOMETER
 SCALE: 1:50000

PROJECT: BARRIER
 GRID B-8 NORTH
 MAGNETOMETER SURVEY

| | | |
|--|---------------|------------|
| ACCOUNT NO: M89 | FILE NO: 2189 | TERRITORY: |
| DRAWN BY: K. SIMPSON S. HUNT S. LOWE | DATE: | NIS: 82M |
| AS NO: | MAP NO: 27 | |

SCALE
 0 50 100 m
 1:5000

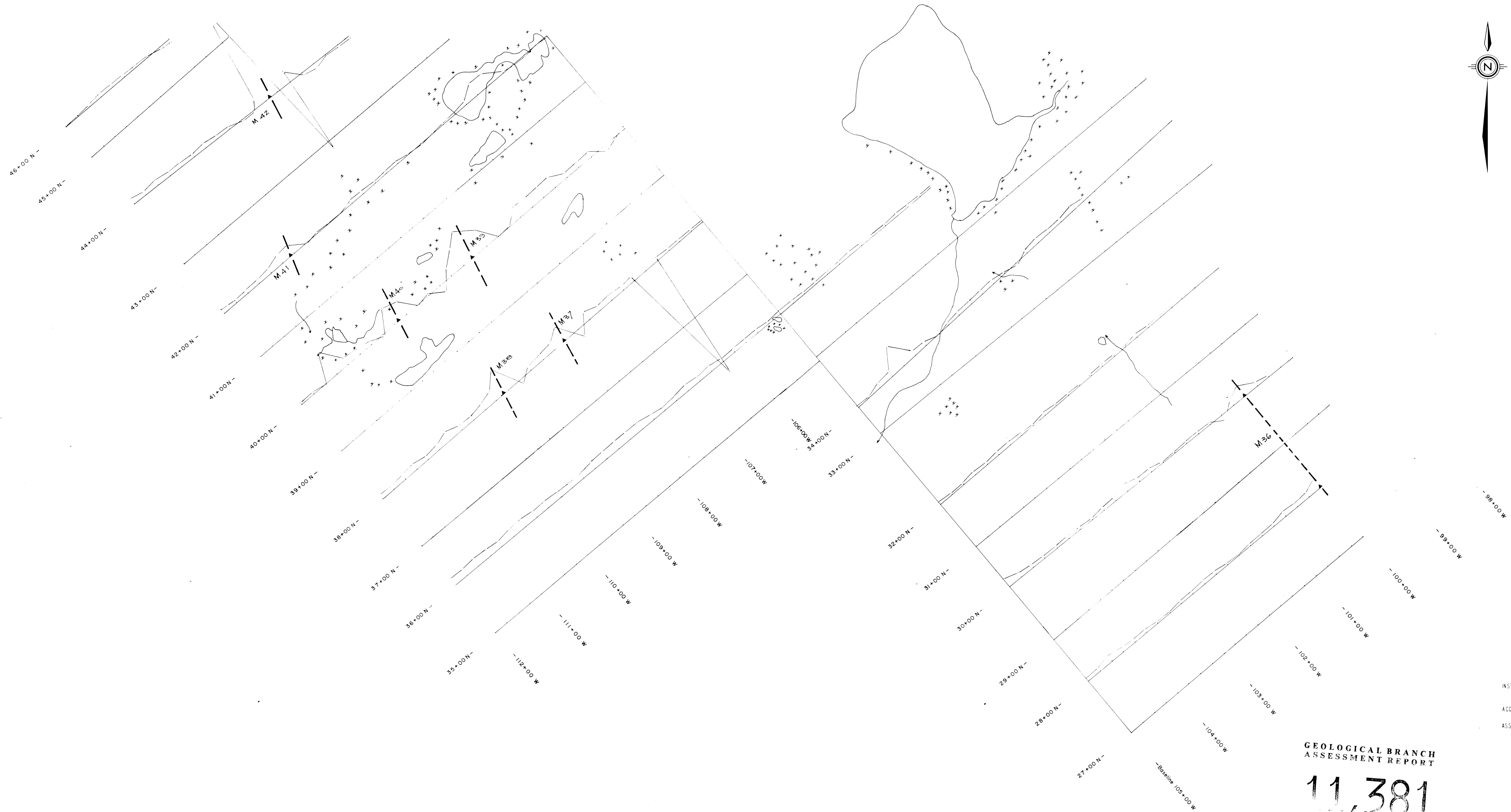

GEOLOGICAL BRANCH
ASSESSMENT REPORT
11,381
part 3
of 3

INSTRUMENT GEOMETRICS MODEL 0816 PROTON PRECESSION MAGNETOMETER
ACCURACY ± 10 GAMMAS
ASSUMED MEAN GEOMAGNETIC FIELD STRENGTH IS

MAG PLOT SCALE
GAMMAS
+200 0 -200

| | | | |
|---|---------------|---------|-----|
| 1-550 MINERALS CANADA DIV. OF 1-550 RESOURCES CANADA LIMITED | | | |
| PROSPECT: BARRIER | | | |
| GRID B-8 SOUTH | | | |
| MAGNETOMETER SURVEY | | | |
| ACCOUNT NO: MAB9 | FILE NO: 2189 | TORONTO | |
| DRAWN BY: K. SIMPSON J. HUNT S. LOWE | DATE | NTS | 82M |
| DWG. NO. | MAP NO. 28 | | |
| SCALE 0 50 100m 1:2500 | | | |
| N. Accuracy & Report By | | | |