

TITLE PAGE

MAGNETOMETER SURVEY AR MINERAL CLAIMS #319(8)

NICOLA MINING DIVISION LAT. $49^{\circ} 50'$
LONG $120^{\circ} 33'$

NTS 92H/15E

For BELMONT RESOURCES

By Stanley L. Beale

September 26, 1983.

GEOLOGICAL BRANCH
ASSESSMENT REPORT

11,468

TABLE OF CONTENTS

- 1) TITLE PAGE
- 2) TABLE OF CONTENTS
- 3) INTRODUCTION
- 4) DETAILED TECHNICAL DATA
- 5) SUMMARY AND CONCLUSIONS
- 6) COST STATEMENT
- 7) AUTHOR'S QUALIFICATIONS
- 8) FIG.#1
- 9) FIG.#2
- 10) FIG.#3

REPORT ON THE MAGNETOMETER SURVEY,
AR CLAIMS #319(8) SOUTH OF MERRIT,
IN THE NICOLA MINING DISTRICT, B.C.

FOR

BELMONT RESOURCES

INTRODUCTION

A MAGNETOMETER SURVEY HAS BEEN CARRIED OUT SOUTH OF MERRIT (APPROX. 30 KILOMETERS), THIS WORK WAS INITIATED BY BELMONT RESOURCES, 805-475 HOWE STREET, VANCOUVER, B.C.

THE SURVEY GRID IS LOCATED 1200 METERS DUE WEST FROM THE MID POINT OF KENTUCKY LAKE. THE CENTER OF THE SURVEY GRID IS POSITIONED APPROX. NORTH LATITUDE $49^{\circ} 50'$ AND $120^{\circ} 33'$ LONGITUDE.

THE GROUND MAGNETOMETER SURVEY WAS CARRIED OUT BY STANLEY L. BEALE AND ASSISTED BY PAUL MacLEAN.

A SCYNTRIX PROTON MAGNETOMETER WAS USED FOR THE SURVEY.

FIELD WORK WAS CARRIED OUT AT THE END OF JULY, 1983.

DISCUSSION OF SURVEY RESULTS

A DETAILED STUDY OF THE MAGNETOMETER SURVEY USING COMPUTER ANALYSIS OR CURVE MATCHING TECHNIQUES HAS NOT BEEN DONE.

THE LOCAL MAGNETIC RELIEF RECORDED ON THE PROPERTY IS ABOUT 5600 GAMMAS. A NORTH-SOUTH TRENDING BAND OF LOW MAGNITUDE RELATIVELY UNIFORM MAGNETIC VALUES COVERS THE WEST 40% OF THE GRID.

THE REMAINDER OF THE PROPERTY DISPLAYS GENERALLY HIGHER AND QUITE VARIABLE MAGNETIC VALUES. A PROFILE OF THE MAGNETOMETER READINGS ON LINE 3400E (FIG.#3) SHOWS THE TYPICAL VARIABLE NATURE OF THE MAGNETIC READINGS OVER THE PROPERTY WITH THE UNIFORM LOW READING TO THE NORTH.

WITHIN THE HIGHER MAGNETIC ENVIRONMENT, LOCAL POSITION CHANGES OF 1-2 METERS CAN RESULT IN MAGNITUDE CHANGES OF UP TO 500 GAMMAS. THESE CHANGES ARE BELIEVED TO BE DUE TO LOCAL VARIATIONS IN MAGNETITE CONTENT OF THE BEDROCK IN SOME CASES. IN EITHER CASE CHANGES OF THE MAGNITUDE ARE INDICATIVE OF SHALLOW OVER BURDEN AND A RELATIVELY SHALLOW ORIGIN OF THE MAGNETIC MATERIAL.

SUMMARY AND CONCLUSIONS

THE MAGNETOMETER SURVEY HAS OUTLINED UNIFORM LOW MAGNITUDE MAGNETIC LEVELS ALONG THE WEST PORTION OF THE GRID. THIS MAY REFLECT DEEPER OVER BURDEN OR A WEAKER MAGNETIC ROCK TYPE.

THREE AREAS OF HIGHER MAGNETIC RESPONSE:

- 1) AT THE SOUTH EAST END OF THE GRID. BETWEEN LINES 0400-3400W and 12400S-15400S.
- 2) IN THE NEAR CENTER OF THE GRID @ LINES 4400W-5400W AND 3400S-6400S.
- 3) EAST CENTER OF THE GRID @ LINES 0400-1400W AND 7400S.

FURTHER GEOLOGICAL OBSERVATIONS IN THESE AREAS SHOULD BE UNDERTAKEN TO ESTABLISH THE CORRECT ORIGINS OF THESE MAGNETIC HIGHS.

COST STATEMENT

Stanley L. Beale		
5 days @ \$200	=	\$ 1,000.00
Paul MacLean		
5 days @ \$150	=	\$ 750.00
Rental Magnetometer		
7 days @ \$ 35	=	\$ 245.00
Transportation	=	\$ 450.00
Accommodation	=	\$ 246.53
Flagging & Thread	=	\$ 61.63
Chain Saw	=	\$ 31.50
		<hr/>
Total		\$ 2,784.66

THE AUTHOR

HAS BEEN INVOLVED IN THE MINING AND
EXPLORATION BUSINESS FOR THE LAST
12 YEARS.

WORKING EXTENSIVELY IN THE GEOPHYSICAL
SCIENCES, THROUGHOUT THE YUKON, N.W.
TERRITORIES, BRITISH COLUMBIA,
CALIFORNIA AND NEVADA.

Stanley L. Beale

1 CM = 100 METRES

FIG # 1

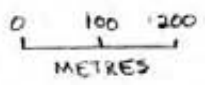

LNO 1 2 3 4 5 6 7 8 9 10

15+00S	1762	1246	588	199	696			-62	-295	364	070
14+00S	170	014	064	1160	935			-110	-117	004	876
13+00S	693	1723	514	1316	739	1539		-130	-87	-40	477
12+00S	428	1819	920	1711	557	530	1542	-006	-178	-64	171
11+00S	484	307	-52	348	659	435	487	-117	-166	-81	-54
10+00S	605	822	-469	-332	1206	741	018	-436	705	197	-178
9+00S	-235	730	88	-32	-700	631	-229	-189	005	446	-294
8+00S	314	1991	285	424	-159	029	178	-325	-500	-499	471
7+00S	1549	1070	228	422	-156	-536	-378	-332	143	-135	-114
6+00S	-33	1478	125	-268	1548	1677	-377	-98	295	038	-109
5+00S	290	574	348	-426	1472	1180	146	-70	65	124	149
4+00S	183	283	565	-409	1191	728	306	-335	-305	215	165
3+00S	367	275	917	-399	1055	066	-352	-429	-401	-252	-35
2+00S	427	1038	962	-403	339	-356	-448	-164	-134	-276	298
100S	674	1101	-29	-459	-177	-627	-432	-67	-320	-364	-436
	312	1123	-264	-780	-003	-385	-302	-157	-117	-284	125
	1100W	2+00W	3+00W	4+00	5+00	6+00	7+00	8+00	9+00	10+00W	

LEGAL
CORNER POST OR MINERAL CLAIMS
319 (8)

BLD

319 (8)

REPORT

304m FIG # 2

120° 33'

BELMONT RESOURCES
805-275 HOME ST.
VAR. BC.

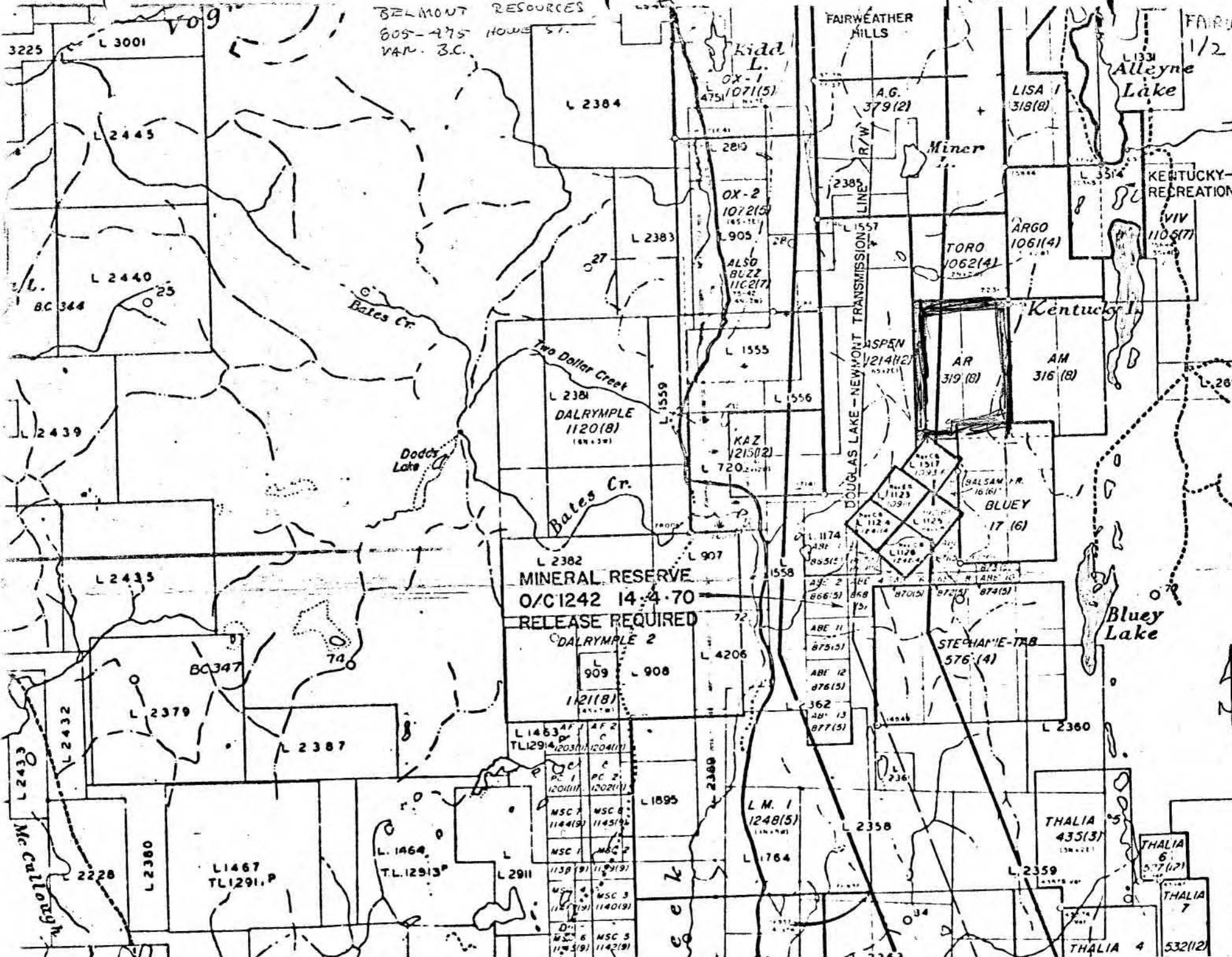

MINERAL RESERVE
O/C 1242 14-4-70
RELEASE REQUIRED
DALRYMPLE 2

McCallough

creek

THALIA 4 532(12)

FIG 93

1 cm = 100 GAMMAS

← NORTH



LN 3400 W

