

83-#366 -11681

RECONNAISSANCE
GEOPHYSICAL SURVEY
HELICOPTER - BORNE
V.L.F. ELECTROMAGNETIC
AND MAGNETIC

GALLOWAY AREA
FORT STEELE M.D., B.C.

Balsam 1-4 & 5-12
Cedar 1 & 2
Cedar South 1 & 2
Elderberry 1
Elderberry South 1 & 2

49°-15'N - 115°-10'W
N.T.S. 82G/6 & 11

15-5-83 : 18-8-83

Alfred R. Allen, P.Eng.
August 18, 1983

GEOLOGICAL BRANCH For:
ASSESSMENT REPORT

R.H. Stanfield
380 - 4723 1st St.S.W.
Calgary, Alberta

By: Allen Geological Eng. Ltd.
503 - 1985 Bellevue
West Vancouver, B.C.

11,681

PART 1 OF 2

CONTENTS

INTRODUCTION..... 1.

LOCATION AND ACCESSIBILITY..... 2.

TOPOGRAPHY..... 2.

HISTORY..... 2.

GEOLOGY..... 3.

PROPERTY..... 3.

HELICOPTER BORNE VLF ELECTROMAGNETIC
AND MAGNETIC SURVEY..... 4.

SUMMARY AND CONCLUSIONS..... 5.

RECOMMENDATIONS..... 5.

COSTS STATEMENT..... 6.

REFERENCES..... 7.

CERTIFICATE

CONSENT

- MAPS:
- 1. Location
 - 2. V.L.F. Electromagnetic Survey
Conductor Zone

A RECONNAISSANCE HELICOPTER BORNE
V.L.F. 20 k h z RANGE
ELECTROMAGNETIC AND MAGNETIC SURVEY

BALSAM 1-12

CEDAR 1-2

CEDAR SOUTH 1-2

ELDERBERRY 1

ELDERBERRY 1-2

FORT STEELE M.D. B.C.

INTRODUCTION

A helicopter borne geophysical survey was conducted over the subject claims area for R.H. Stanfield June 26-29, 1983.

Apex Airborne Surveys Ltd., 512-625 Howe Street, Vancouver, B.C., conducted the survey under the supervision of Mr. Ronald F. Sheldrake, B.Sc., president of the company. Copies of the report are included with the application for assessment credit on the subject claims.

Field assistance was provided by Mr. Ross Stanfield, Jr., Mr. Brent Skene, and Mr. Claire Meglesh of the R.H. Stanfield staff. The writer is retained as consultant.

The purpose of the survey was to detect structural as well as mineralized zones using the 20 k h z phase instrumentation and Hawaii (NPM) transmitter station.

The object of this report is to provide basic regional geologic and topographic information involved with the interpretation of survey results.

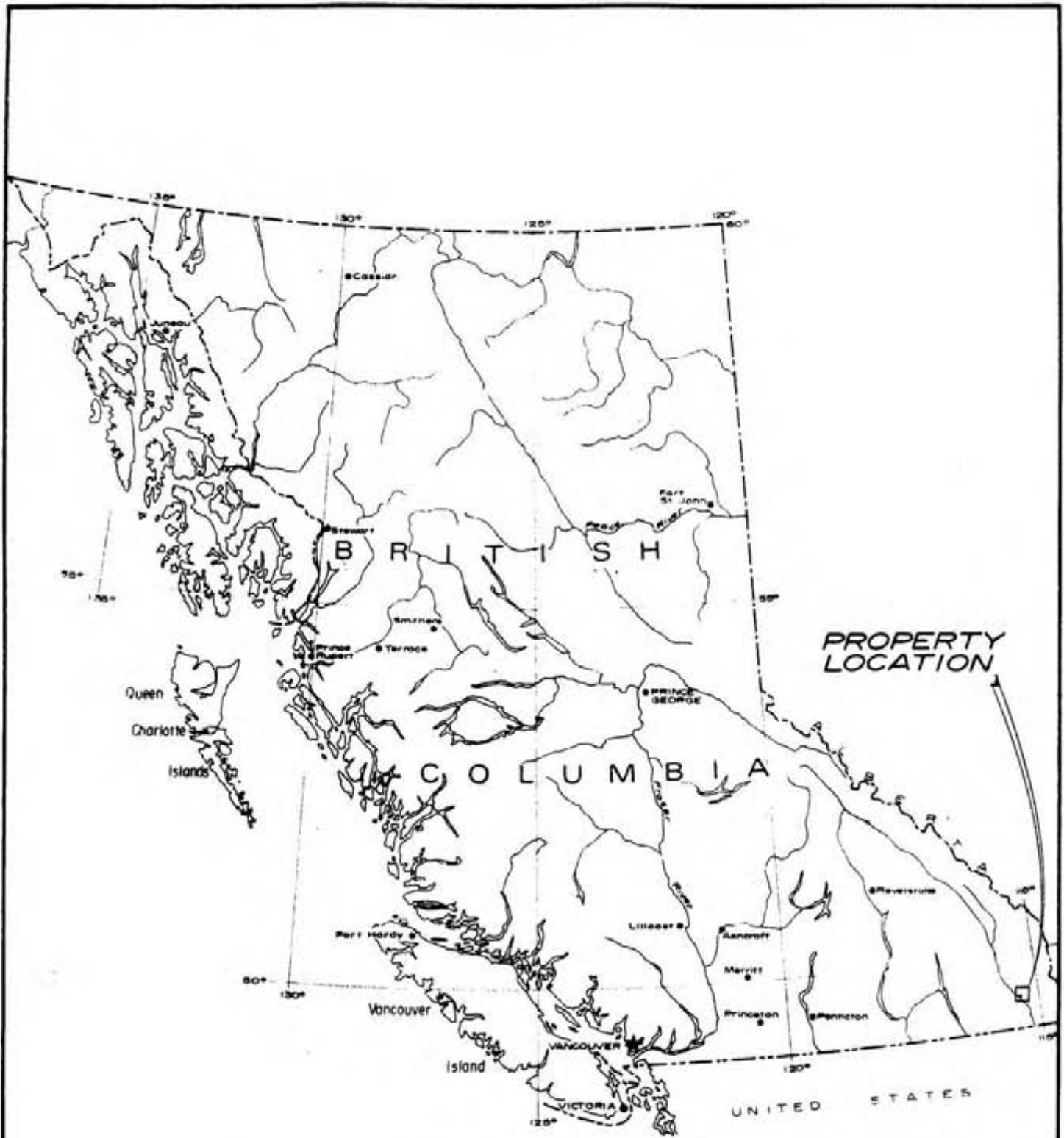

STANFIELD PROPERTY

LOCATION MAP

SCALE: 1" = 136 Mils.

Drawn by	Date
Checked by	Drg no.

ALLEN GEOLOGICAL
ENGINEERING LTD.

LOCATION AND ACCESSIBILITY

The Stanfield property is located in southeastern British Columbia, 27 kilometres east of Cranbrook.

The surveyed area lies east of the Kootenay River and north of the Elk River.

Access is via Highway #3 from Cranbrook.

TOPOGRAPHY

The property extends from the Rocky Mountain Trench, elevation 750 metres above sea level easterly, and includes the Hughes, Lizard and Steeples ranges of the Rocky Mountains, the upper levels of which exceed 2,500 metres elevation above sea level.

Principal drainage is via the Kootenay River, Elk River, Bull River and Sand Creek.

HISTORY

Placer mining was active in the area from the 1860's. Mineral claims had been located on hardrock showings in 1885. The Sullivan mine was located in 1892 and the St. Eugene in 1893. The Strathcona-Empire was acquired by Colonel Samuel Steele in the 1890's, The Estella and Kootenay King were located in the early 1900's.

On the Stanfield holdings ore was shipped from the Strathcona-Empire in the late 1930's and the Bull River mine operated from October 1971 until March 1974. Exploratory investigations have been conducted on the Stanfield holdings since the 1960's.

GEOLOGY

The surveyed area is underlain by Precambrian red-to rusty-weathering Aldridge quartzite, argillaceous quartzite and siltstone.

To the east and north this formation is overlain by grey, green, purple and white quartzite and argillite of the Creston formation.

The youngest member of the Precambrian sequence is the Kitchener formation which is composed of buff-to brown-weathering dolomite with interbeds of grey and green argillite and grey limestone.

The general attitude of the well bedded strata is a strike trend to the northwest and gentle dips from nearly flat to moderately steep to the northeast.

Faulting is evident along the easterly side of the Rocky Mountain Trench. The most prominent fault strikes northerly and dips steeply southwest.

A few narrow lamprophyre dikes and one granodiorite dike occur to the east of the surveyed area.

PROPERTY

The primary claims are as follows: (Map #2)

<u>Claims</u>	<u>Record Numbers</u>	<u>Ex. Dates</u>
Cedar 1 and 2	205 and 206	June 17
Cedar South 1 and 2	1544 and 1545	Aug. 19
Balsam 1-12 inclusive	1035-1038, 478-483	July 5
	512-513	Aug. 19
Elderberry 1	1556	Sept. 1
Elderberry South 1 and 2	1550-1551	Sept. 1

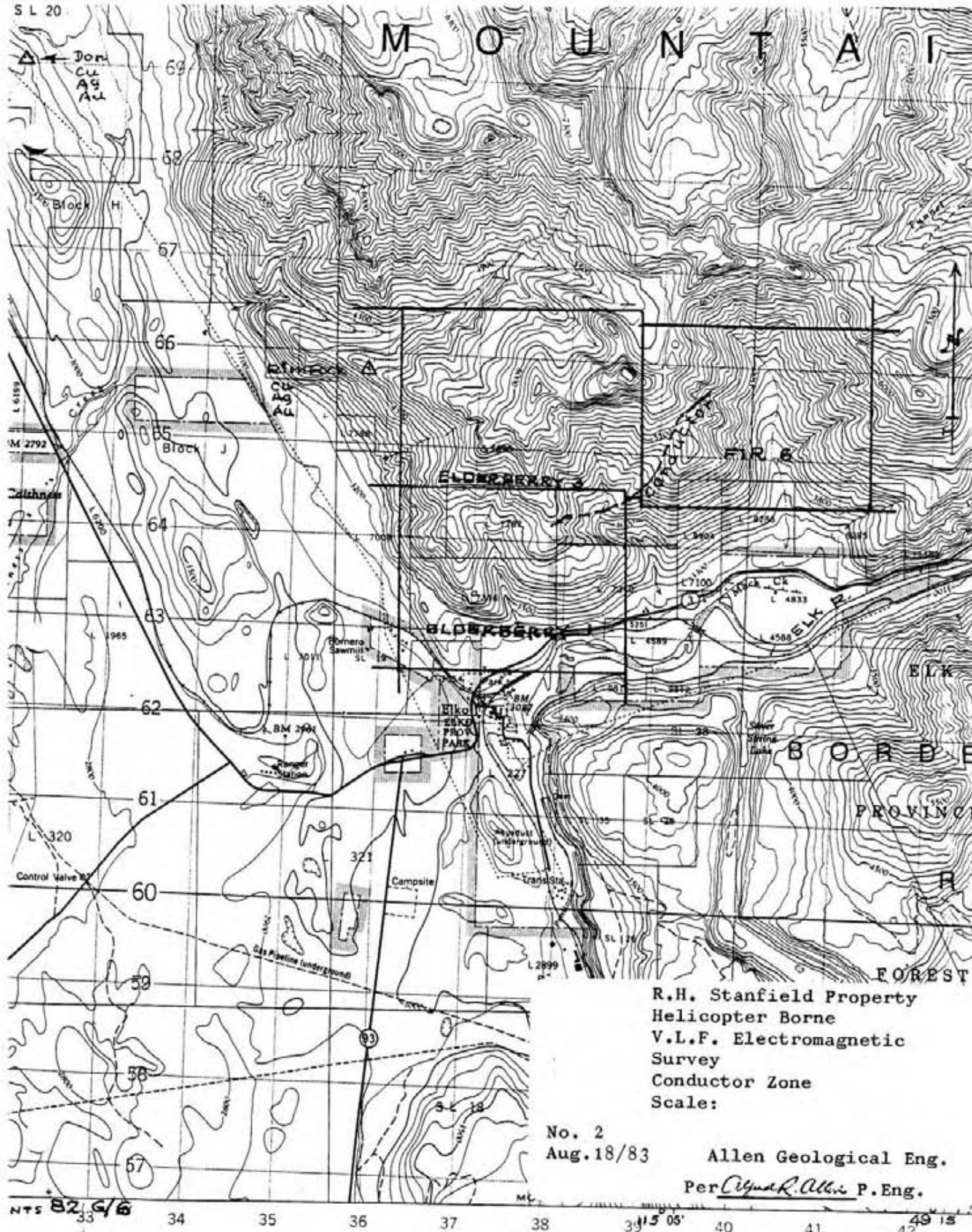

R.H. Stanfield Property
 Helicopter Borne
 V.L.F. Electromagnetic
 Survey
 Conductor Zone
 Scale:

No. 2
 Aug. 18/83

Allen Geological Eng.
 Per Clyde R. Allen P. Eng.

NTS 82 G/6

33 34 35 36 37 38 39 40 41 42

S L 20

HELICOPTER BORNE RECONNAISSANCE MAGNETIC AND
VLF ELECTROMAGNETIC SURVEY

A helicopter borne V.L.F. electromagnetic and magnetic reconnaissance survey, using 20 khz phase instrumentation, was flown over the southwest area of the Stanfield property June 24 - 29, 1983.

The field supervision was undertaken by Mr. Ronald F. Sheldrake, B.Sc., geophysicist. Interpretation and report preparation assistance was provided by Janan T. Sallomy, Ph.D., geophysicist. The helicopter engineer was Herman Lorenz and field technician was Michael Magee.

Assistance was provided from the Stanfield camp by Ross Stanfield Jr., Brent Skene and Clare Meglesh.

The writer assisted with the planning, interpretation and reporting of the survey.

The Apex Airborne Surveys Ltd. report is included with this report in support of assessment requirements for the subject mineral claims.

SUMMARY AND CONCLUSIONS

The helicopter borne geophysical survey over a part of the western section of the R.H. Stanfield holdings in the Fort Steele Mining Division was undertaken with the purpose of acquiring information regarding possible mineral concentrations and structural data.

The 20 khz V.L.F. phase instrumentation was used for this purpose. The Hawaii 23.4 khz transmitter was used throughout the survey period.

The magnetic field configuration was flat and not mapped for the final report.

The anomalous zone detected across the Elderberry 1 and 3 and Fir 6 claims - lines 8, 9 & 10, - will warrant ground investigations.

It is concluded that detailed ground geophysical and geological investigations will be conducted over the anomalous zone.

RECOMMENDATIONS

A ground V.L.F. electromagnetic survey is recommended over a 3 kilometre by 1 kilometre area to include the indicated conductor zone on the Fir 6, Elderberry 1 and Elderberry 3 claims.

Respectfully submitted,
Allen Geological Engineering Ltd.
Per Alfred R. Allen P.Eng.
Alfred R. Allen

West Vancouver, B.C.
August 18, 1983.

COSTS STATEMENTPersonnel:1. R.H. Stanfield A/C

Alfred R. Allen, P.Eng., Planning, scheduling, interpretation, maps, report June, July, Aug.1-18 @ \$350/day 18 days.....	\$ 6,000.00
Ross Stanfield Jr., April, May, June 20-30 @ \$75?day 22 days.....	1,650.00
Brent Skene, " " " 20-30 @ \$75/day 22 days.....	1,650.00
Clare Meglesh, " " " 21-30 @ \$75/day 21 days.....	1,575.00

2. Apex Airborne Surveys A/C

Rooms and meals, Stanfield camp, 12 man days	780.00
380 kilometres flight lines @ \$86.73/km.....	32,960.00
	<hr/>
	\$44,615.00

REFERENCES

- Schofield. S.J., G.S.C. Cranbrook Map-Area, Mem 76 1915
- Rice, H.M.A., G.S.C. Nelson Map-Area,
East Half, Mem228 1937 & 41
- Leech, G.B., G.S.C. Fernie Map-Area, Paper 58-10
60-11
- Chiang, M.C., Placer Oil Company,
Reports & Maps, 1973 - 1976
- Swanson, C.O. &
Gunning, H.C. Geology - Sullivan Mine
Sullivan Mine C.I.M.M. Trans. V
XLVIII 1945
- Cominco Staff, The Sullivan Mine, C.I.M.M. Journal 1954
- Macdonald, B.C., Altemont Exploration Holdings 1965-66
- Allen, Alfred R., R.H. Stanfield Holdings 1967
- Allen, Alfred R., R.H. Stanfield Holdings 1973
- Allen, Alfred R., The Bull River Copper-Silver Gold Mine 1976
- Allen, Alfred R., Preliminary Report Strathcona-Empire
Vein System, 1976
- Allen, Alfred R., Geology and Ore Potential, Stanfield
Holdings in Southeastern British Columbia
1976
- Ronald F. Sheldrake, Report on a Helicopter Multifrequency
Electromagnetic and Magnetic Survey,
June 22 1982
- A.B.L. Whittles, Ph.D. Prospecting with Radio Frequency
E.M. - 16 in Mountainous Regions,
B.C. Institute of Technology, Feb. 1969

* * * * *

503 - 1985 Bellevue Avenue
West Vancouver, B.C. V7V 1B6

(604) 926-4785

CERTIFICATE

August 18, 1983.

I, Alfred R. Allen, certify that:

I am a graduate of the University of British Columbia
and hold the following degrees therefrom:

BASc Geological Engineering 1939

MASc Geological Engineering 1941

I am a Life member of the Association of Professional
Engineers of the Province of British Columbia.

I have practised my profession for the past thirty-seven
years.

I hold no interest in the properties or securities of
R.H. Stanfield, or affiliates thereof, nor do I expect
to receive any directly or indirectly.

The Report on the Reconnaissance Geophysical Survey
Helicopter - Borne V.L.F. Electromagnetic and Magnetic,
Galloway Area, Fort Steele M.D., B.C., is based on
consulting by the writer from June 1983 to August 18,
1983.

I consent to this report being filed with the British
Columbia Securities Commission.

 P.Eng.
Alfred R. Allen

503 - 1985 Bellevue Avenue
West Vancouver, B.C. V7V 1B6

(604) 926-4785

British Columbia Securities Commission
Vancouver, B.C.

Dear Sirs:

Re: R.H. Stanfield

I hereby consent to the use of my report dated August 18, 1983, on the Reconnaissance Geophysical Survey Helicopter-Borne V.L.F. Electromagnetic and Magnetic, Galloway Area, Fort Steele M.D., B.C., in any prospectus or statement of material facts or other material to be filed with the British Columbia Securities Commission or the Vancouver Stock Exchange by R.H. Stanfield.

Yours very truly,

Alfred R. Allen P.Eng.
Alfred R. Allen