

83 #423 - 11827

10

PROSPECTING REPORT
ON THE
SOO #1 MINERAL CLAIM
RECORD NO. 112
VANCOUVER MINING DIVISION
92 J/zw

Latitude 50°14'

Longitude 122°58'

for

MINISTRY OF ENERGY, MINES AND
PETROLEUM RESOURCES
Parliament Buildings
Victoria, B.C.
V8V 1X4

OWNER

JOHN MCGORAN

OPERATOR

JOHN MCGORAN

GEOLOGICAL BRANCH
ASSESSMENT REPORT

11,827

October, 1983

John McGoran B.Sc.
Vancouver, B.C.

TABLE OF CONTENTS

	<u>PAGE</u>
LOCATION	3
ACCESS	3
CONTROL	3
HISTORY	3
PROSPECTING	4
ROCK AND SOIL DESCRIPTION	5
DISCUSSIONS	6
QUALIFICATIONS	7
EXPENDITURES	8
FIG. 1 Scale 1:50,000 + 1:250,000	1
FIG. 2 Scale 1:6000	2

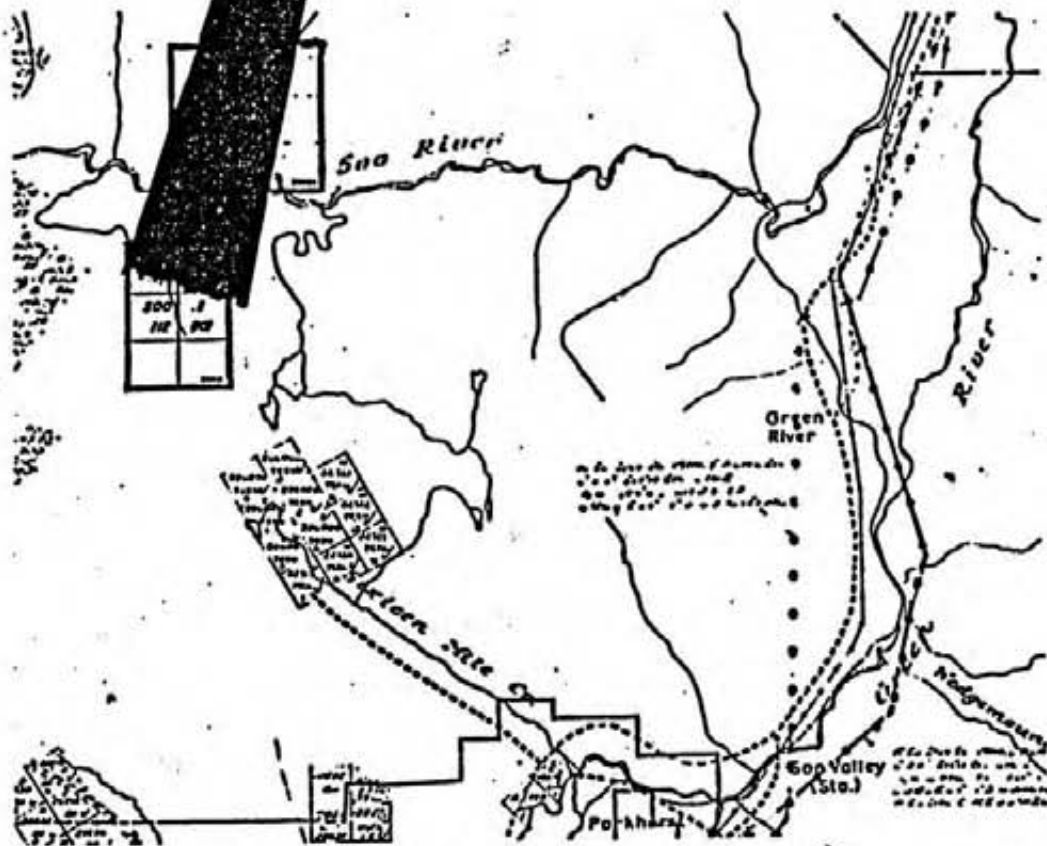
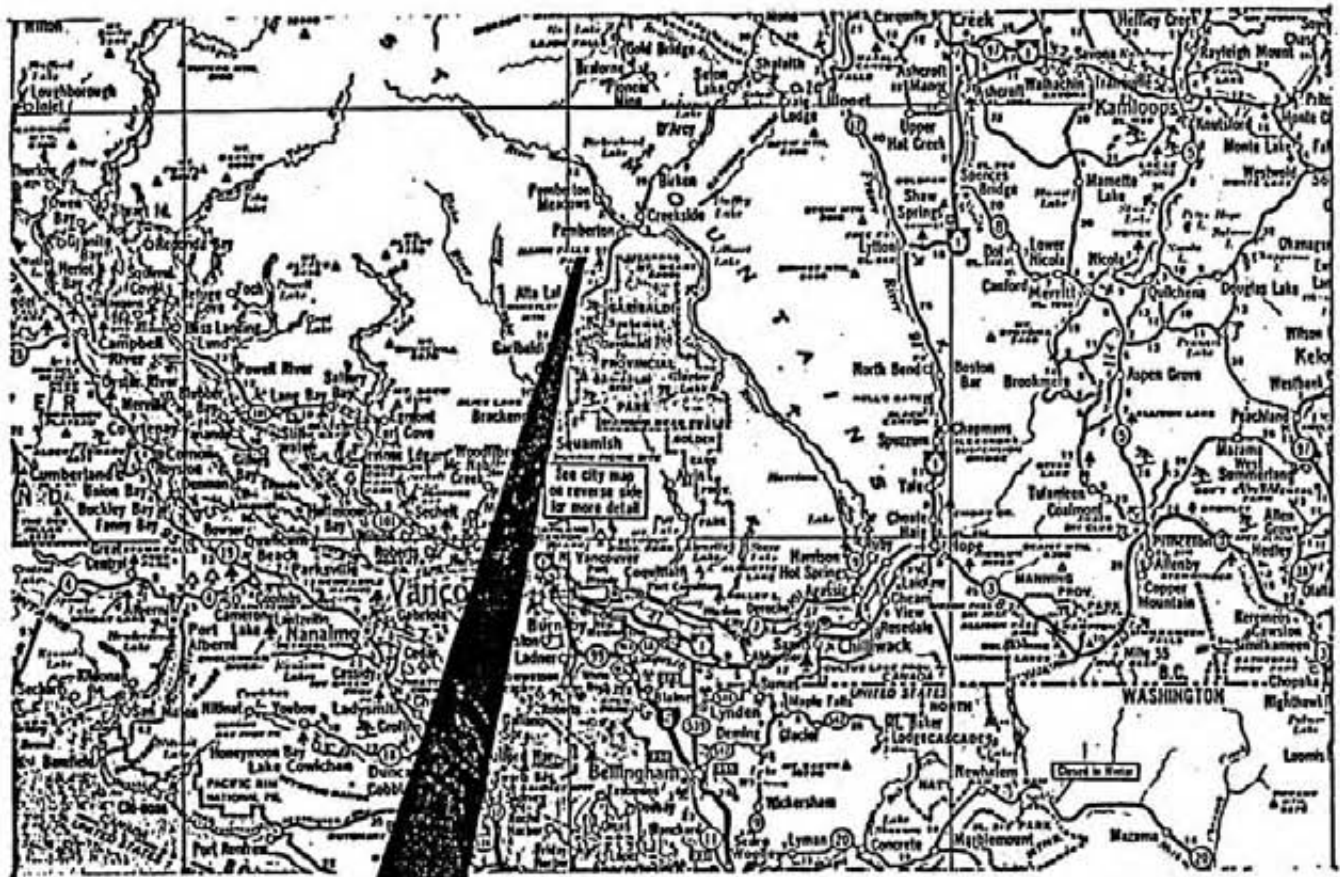

**RAINBOW SYNDICATE
LOCATION AND CLAIM MAP
300 CLAIMS**

ICP GEOCHEMICAL ANALYSIS

A .500 GRAM SAMPLE IS DIGESTED WITH 3 ML OF 3:1:3 HCL TO HNO3 TO H2O AT 90 DEG.C. FOR 1 HOUR. THE SAMPLE IS DILUTED TO 10 MLS WITH WATER.
 THIS LEACH IS PARTIAL FOR: Ca, P, Mg, Al, Ti, La, Na, K, W, Ba, Si, Sr, Cr AND B. Au DETECTION 3 ppm.
 Au: ANALYSIS BY AA FROM 10 GRAM SAMPLE. SAMPLE TYPE - ROCK CHIPS

DATE RECEIVED OCT 18 1983 DATE REPORTS MAILED Oct 24/83 ASSAYER R. Tope DEAN TOYE, CERTIFIED B.C. ASSAYER

JOHN MCGORAN FILE # 83-2610

PAGE # 1

SAMPLE #	Mo	Ca	Pb	Zn	Ag	Ni	Co	Mn	Fe	As	U	Au	Th	Sr	Cd	Sb	Bi	V	Cr	P	La	Cr	Mg	Ba	Ti	B	Al	Na	K	W	Au
	ppm	ppm	ppm	ppm	ppm	ppm	ppm	ppm	%	ppm	ppm	ppm	ppm	ppm	ppm	ppm	ppm	ppm	ppm	%	ppm	ppm	%	ppm	%	%	%	%	%	ppm	ppb
A56F	1	6	3	54	.1	8	4	836	2.27	2	2	ND	2	21	1	2	2	43	.35	.08	2	13	.97	135	.12	4	1.51	.05	.17	2	5
A103F	1	12	6	53	.2	4	2	683	3.15	2	2	ND	2	62	1	2	2	38	.56	.11	2	1	1.21	125	.18	5	1.96	.02	.35	2	5
A139F	1	7	6	24	.2	2	3	290	2.54	2	2	ND	2	56	1	2	2	38	.43	.11	2	1	.58	141	.19	5	1.10	.05	.32	2	5
A268F	1	137	7	38	.7	8	8	308	3.84	5	2	ND	2	44	1	3	5	83	.44	.12	2	15	1.45	14	.25	6	1.38	.09	.05	2	5
A455F	1	14	5	92	.2	16	4	1037	3.91	2	3	ND	2	22	1	2	2	53	.42	.10	2	6	2.55	89	.27	5	3.11	.02	.52	2	5
A541F	1	19	3	65	.2	3	1	558	2.57	4	2	ND	2	92	1	2	2	40	.66	.08	2	2	1.20	148	.16	3	1.89	.05	.35	2	5
A541-	1	21	5	62	.2	4	1	510	2.59	2	2	ND	2	67	1	2	2	35	.47	.07	2	6	1.11	96	.17	4	1.54	.05	.26	2	5
B0	1	63	9	89	.3	4	1	622	4.18	2	3	ND	2	79	1	2	2	93	.53	.06	2	4	1.60	101	.29	5	2.60	.06	.26	2	5
B161F	4	13	12	14	.2	2	2	78	.99	9	2	ND	2	24	1	2	2	7	.20	.05	3	1	.08	323	.08	2	.74	.01	.40	2	5
B262F	1	3	5	47	.1	4	5	657	2.66	3	2	ND	2	77	1	2	2	42	.68	.09	2	3	1.32	23	.15	5	1.87	.06	.04	2	5
B323F	1	3	1	40	.1	6	8	693	2.37	2	2	ND	2	60	1	2	2	48	.60	.08	2	6	1.60	44	.17	3	1.90	.05	.09	2	5
B526F	1	307	4	235	.4	13	13	1883	4.06	2	5	ND	2	33	1	2	2	71	.52	.10	2	4	3.38	89	.21	5	3.30	.02	.16	2	5
20S Z2EF	1	12	5	22	.2	2	1	277	.94	2	4	ND	2	29	1	2	2	8	.18	.02	3	2	.40	61	.09	3	.62	.07	.32	2	5
20S Z2E	3	11	5	40	.2	4	6	585	2.51	3	2	ND	2	103	1	3	4	24	.73	.08	2	4	.70	51	.13	4	1.27	.01	.12	2	5
20+10S Z3EF	1	57	4	46	.2	3	6	664	2.39	3	2	ND	2	36	1	4	2	22	.48	.09	2	2	1.41	96	.11	4	1.73	.02	.30	2	5
20+20S 21+30EF	1	5	4	35	.1	7	4	580	2.36	2	2	ND	2	142	1	2	2	34	1.24	.08	2	13	1.03	71	.17	4	1.56	.02	.07	2	5
2+20SF 21+7SE	3	6	21	12	.2	4	4	179	3.23	4	2	ND	2	33	1	3	5	10	.30	.04	3	5	.18	34	.07	5	.44	.03	.07	2	5
I-1	1	7	3	19	.1	3	1	199	2.87	2	2	ND	2	39	1	2	6	41	.24	.03	2	4	.50	66	.24	4	.82	.04	.12	2	5
I-2	21	1600	16	5	10.2	22	31	170	20.75	2	2	ND	2	23	1	3	21	38	.13	.02	5	7	.09	4	.02	9	.46	.01	.03	2	35
I-3	1	6	1	49	.1	4	7	770	3.29	2	4	ND	2	31	1	4	3	39	.48	.09	2	1	1.67	73	.12	5	2.13	.03	.12	2	5
I-4	7	228	4	77	.3	9	8	1099	3.81	2	4	ND	2	83	1	3	2	60	.78	.10	2	5	2.04	75	.16	5	2.38	.02	.15	2	5
19+95S 22+18E S	24	827	6	295	13.9	19	31	426	40.18	2	2	ND	2	2	1	2	2	69	.02	.11	19	1	.03	9	.01	2	6.88	.01	.01	2	15
20S 22+50E S01L	27	771	22	91	15.6	21	12	239	49.21	2	2	ND	2	2	1	2	2	87	.02	.16	20	1	.04	7	.02	2	3.40	.01	.01	2	10
STD R-1/AU 0.5	1	30	40	184	.3	36	12	1016	2.81	11	2	ND	2	37	1	2	2	60	.59	.12	7	74	.73	278	.09	8	2.07	.02	.20	2	520

APPENDIX 1

Location

The Soo #1 claim is situated along a disused logging road up Sixteen Mile Creek at the north end of Green Lake.

Access

Access is by foot along the disused logging road ten kilometers to the Soo #1 claim from a washout 5 kilometers north of Green Lake.

Another route is along a new logging road which traverses along the south bank of the Soo River from a point of B.C. Railway called Green River Crossing to a point 6 km. east of Soo #1 mineral claim. The unexpected rock faces and large talus.

The first route is recommended.

Control

The prospecting traverses were by compass and topofil which was tied into the grid lines for former geology and geochemical surveys.

History

During a reconnaissance geological and silt sampling survey in 1976 the writer silt sampled the creek on what is now the Soo #1 claim. This sample ran 3000 p.p.m. copper, 1180 p.p.m. zinc, 2.6 p.p.m. silver and anomalous gold. Geological, geochemical and geophysical surveys were subsequently conducted.

The soil geochemical survey was negative except for two soil samples which are 2200 and 2300 feet east of the base line on line 16 S.

Prospecting

John McGoran B.Sc. was assisted by Cecile McGoran M.Sc., David McGoran and Brigid McGoran.

The prospecting was conducted in the vicinity of line 16 S. 2200 and 2300 feet east of the base line as well as between the grid lines in areas where the rock or soil was rusty.

The rock descriptions are on table 1 "Location" refers to the locations of the sample site on Map 2.

A suffix of F on the sample number indicates that the sample was from float. A suffix of S or soil indicates that the sample was a soil sample.

Location of highly anomalous silt sample.

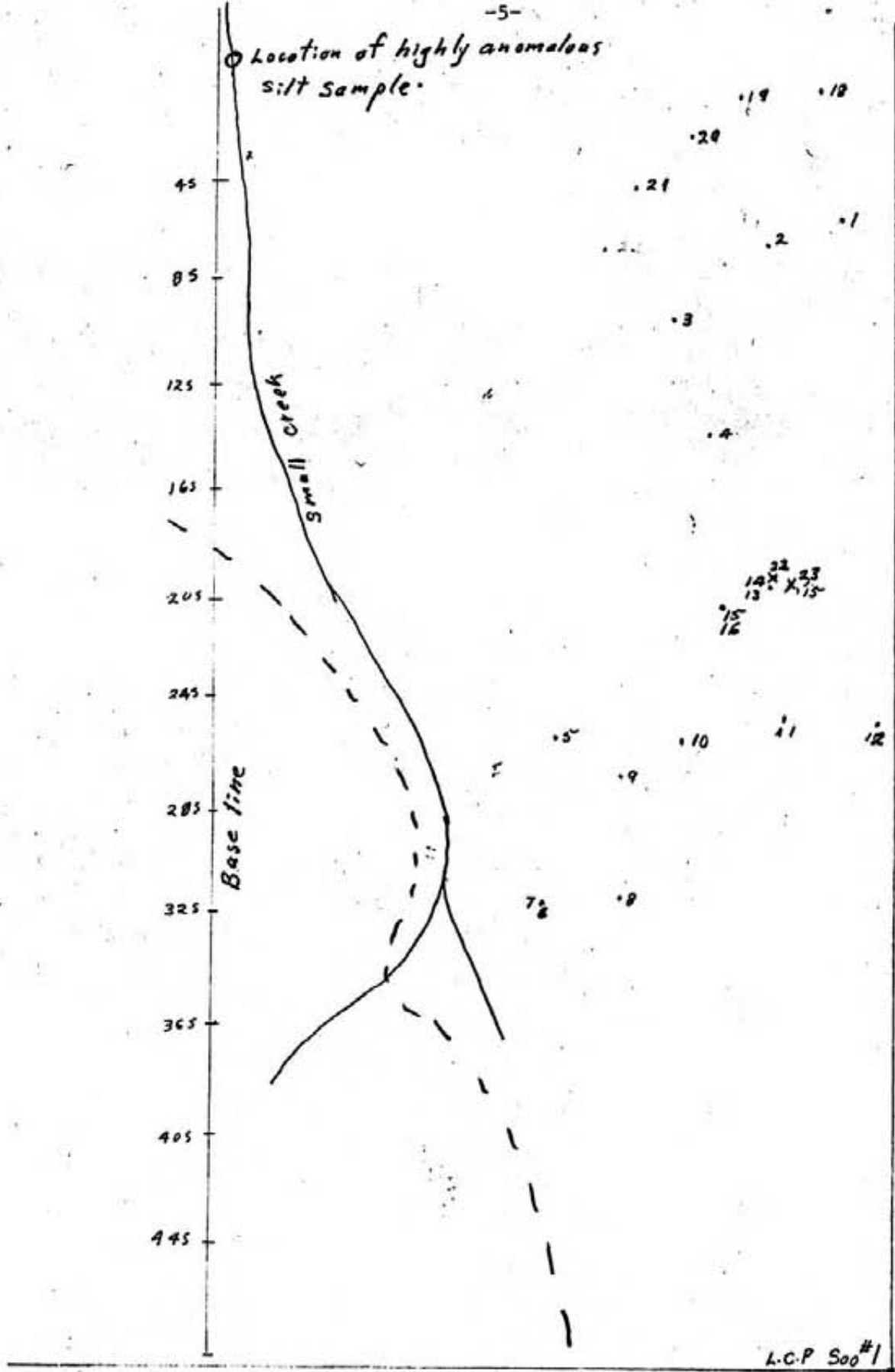

North.

• rock sample site
x soil sample site

Scale
1:6000



road to 16 mi. creek

Fig 2.
Oct 83
J.P.M

Discussion

Twenty three I.C.P. analysis were performed on the material collected. These are tabulated in Appendix 1. The sample descriptions are listed in Table 1.

Sample I2, a rock in place, is a sample of a narrow quartz vein which is relatively insignificant. The two soil samples are anomalous for molybdenum, copper, zinc, silver and are above background for gold.

These soils were a bright orange-red in colour and appears to occur over a width of ten to twelve metres. Outcrop is sparse in this area. Rocks in this vicinity (location numbers 13 to 17 inclusive) are not anomalous for metals. This could be the surface manifestation of the source of the silt anomaly located 800 metres to the north west.

More detailed geophysical and geochemical work is recommended in the vicinity of these soils which are anomalous in colour and in metal content.

QUALIFICATIONS

1. I graduated from Carleton University in 1972 with a B.Sc. in Geology.
2. I spent twelve years prospecting for economic minerals prior to 1972.
3. I have supervised four joint ventures which were financed by major mining companies.
4. I have practised as a Geologist for the past seven years.

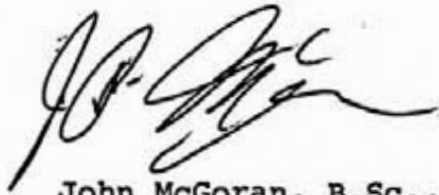
A handwritten signature in black ink, appearing to read 'J. McGoran', written in a cursive style.

John McGoran, B.Sc.,

EXPENDITURES

John McGoran B.Sc.			
September 23, 24, 25	3 days @ \$150./day		\$450.00
Cecile McGoran M.Sc.			
September 23, 24	2 days @ \$100./day		\$200.00
B. McGoran & D. McGoran			
September 23, 24	4 days @ \$50./day		\$200.00
Vehicle 3 days @ \$25./day & fuel			\$ 77.00
Geochemical analysis & preparation			\$266.25
Report preparation			<u>\$185.00</u>
Total cost of expenditures			<u>\$1378.25</u>

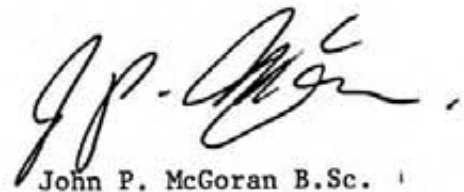
John P. McGoran B.Sc.

REFERENCES

	<u>PAGE</u>
Mineral inventory 92J/SE ²⁹ 53	
Assessment reports	6573, 6581