

83-896 - 11840

9

Assessment Report

on

Diamond Drilling, NQ Size, Hole 83-8

on

Silver Cup Group (Silver Cup #1, #2; Big Qua; Maple Leaf; Vincent; High Command; Sam; Golden Eagle 1-4; Tuya 1-4; Cor 1-3; Cor 1 Fr-3 Ft.), Nez, Kea; Mineral Claims.

known as the

Topley Property

Omineca Mining Division

British Columbia

93L/9; Lat., 54° 32' N  
Long. 126° 13' N

Owners of Claims: Bishop Resources Development Ltd.,  
W.H. Morris, L. Perry, Ronald Williams,  
K.F. Branner.

Optionor and Operator: Bishop Resources Development Ltd.

by

C.H. Stanley, B.Sc. Geophysicist (Author)

Consultant: Mr. R.W. Phendler, P.Eng.

December 1, 1983

Vancouver, B.C.

**GEOLOGICAL BRANCH  
ASSESSMENT REPORT**

**11,840**

R. W. PHENDLER, P.Eng., GEOLOGICAL CONSULTANT,  
EXPLORATION AND MINING  
7360 DECOURCY CRES., RICHMOND, B.C. V7C 4E9 (604) 271-2588

Dec 19, 1983

Bishop Resources Development Ltd,  
305 - 1212 W.Broadway Ave.,  
Vancouver, B.C

Re: Assessment Report on Silver Cup Group, NEZ and KEA Claims

Gentlemen:

I have had the opportunity to examine the Diamond Drilling Assessment Report by C.H. Stanley dated Dec 1, 1983 and am in accord with the interpretation of results and the conclusions.

I have been closely associated with the Silver Cup property as consultant since I recommended it's acquisition in 1980. The exploration program has been jointly planned by Mr. Stanley and myself but he has acted as field manager throughout the job, which has been conducted in a workmanlike manner.

The drilling results to date have been encouraging and warrant further work.

I have been associated with Mr. Stanley for seven years and have found his work to be of a high ethical standard. I fully endorse the report.

  
R.W. Phendler, P.Eng.



COST STATEMENT

TOPLEY PROPERTY DIAMOND DRILL HOLE 83-8

LABOUR (see shift reports, Appendix II)

K.F. BRANNER, (as per contract) 15 days, September 6, 1983 to September 23, 1983; 132 hrs. @ \$14.00/hr. driller and supervisor \$ 1,848.00

SPENCER ACKER, 15 days, September 6, 1983 to September 23, 1983, 132 hrs. @ \$11.30/hr. drill helper 1,491.60

DRILL SUPPLIES

As per invoices, Canadian Longyear, see Appendix III 310.57  
1,043.85  
1,754.80

FIELD SUPPLIES (see Appendix III)

Gas, vehicles, travel: Houston-Smithers-Topley property 1,184.97  
Drilling hand gloves 58.94  
Diesel fuel, cat 243.82  
Cement, hole seal 98.98  
136.37  
Clamp 28.83  
Diesel fuel, drill 254.41  
Cement mixer, hole seal, water return 500.00  
Miscellaneous 107.00  
Machine shop 112.23  
Finning, Cat 10.68

ASSAYS

As per invoices, Acme Analytical Laboratories Ltd. 11.50  
40.00  
252.00

TOTAL \$ 9,488.55

NOTE: This does not show caterpillar charges and other related expenses to the hole.











Province of British Columbia  
 Ministry of Energy, Mines and Petroleum Resources  
 MINERAL RESOURCES BRANCH-TITLES DIVISION

SUB-RECORDER  
 RECEIVED  
 SEP 28 1983  
 M.R. # ..... \$ .....  
 VANCOUVER, B.C.

MINERAL ACT

FORM 1

NOTICE TO GROUP

Mining Division ..O.M.A. U.C.A. Location ..FARMLEY DISTRICT AND F.D. 1000, 200, 300, 400, 500, 600, 700, 800, 900, 1000, 1100, 1200, 1300, 1400, 1500, 1600, 1700, 1800, 1900, 2000, 2100, 2200, 2300, 2400, 2500, 2600, 2700, 2800, 2900, 3000, 3100, 3200, 3300, 3400, 3500, 3600, 3700, 3800, 3900, 4000, 4100, 4200, 4300, 4400, 4500, 4600, 4700, 4800, 4900, 5000, 5100, 5200, 5300, 5400, 5500, 5600, 5700, 5800, 5900, 6000, 6100, 6200, 6300, 6400, 6500, 6600, 6700, 6800, 6900, 7000, 7100, 7200, 7300, 7400, 7500, 7600, 7700, 7800, 7900, 8000, 8100, 8200, 8300, 8400, 8500, 8600, 8700, 8800, 8900, 9000, 9100, 9200, 9300, 9400, 9500, 9600, 9700, 9800, 9900, 10000, 10100, 10200, 10300, 10400, 10500, 10600, 10700, 10800, 10900, 11000, 11100, 11200, 11300, 11400, 11500, 11600, 11700, 11800, 11900, 12000, 12100, 12200, 12300, 12400, 12500, 12600, 12700, 12800, 12900, 13000, 13100, 13200, 13300, 13400, 13500, 13600, 13700, 13800, 13900, 14000, 14100, 14200, 14300, 14400, 14500, 14600, 14700, 14800, 14900, 15000, 15100, 15200, 15300, 15400, 15500, 15600, 15700, 15800, 15900, 16000, 16100, 16200, 16300, 16400, 16500, 16600, 16700, 16800, 16900, 17000, 17100, 17200, 17300, 17400, 17500, 17600, 17700, 17800, 17900, 18000, 18100, 18200, 18300, 18400, 18500, 18600, 18700, 18800, 18900, 19000, 19100, 19200, 19300, 19400, 19500, 19600, 19700, 19800, 19900, 20000, 20100, 20200, 20300, 20400, 20500, 20600, 20700, 20800, 20900, 21000, 21100, 21200, 21300, 21400, 21500, 21600, 21700, 21800, 21900, 22000, 22100, 22200, 22300, 22400, 22500, 22600, 22700, 22800, 22900, 23000, 23100, 23200, 23300, 23400, 23500, 23600, 23700, 23800, 23900, 24000, 24100, 24200, 24300, 24400, 24500, 24600, 24700, 24800, 24900, 25000, 25100, 25200, 25300, 25400, 25500, 25600, 25700, 25800, 25900, 26000, 26100, 26200, 26300, 26400, 26500, 26600, 26700, 26800, 26900, 27000, 27100, 27200, 27300, 27400, 27500, 27600, 27700, 27800, 27900, 28000, 28100, 28200, 28300, 28400, 28500, 28600, 28700, 28800, 28900, 29000, 29100, 29200, 29300, 29400, 29500, 29600, 29700, 29800, 29900, 30000, 30100, 30200, 30300, 30400, 30500, 30600, 30700, 30800, 30900, 31000, 31100, 31200, 31300, 31400, 31500, 31600, 31700, 31800, 31900, 32000, 32100, 32200, 32300, 32400, 32500, 32600, 32700, 32800, 32900, 33000, 33100, 33200, 33300, 33400, 33500, 33600, 33700, 33800, 33900, 34000, 34100, 34200, 34300, 34400, 34500, 34600, 34700, 34800, 34900, 35000, 35100, 35200, 35300, 35400, 35500, 35600, 35700, 35800, 35900, 36000, 36100, 36200, 36300, 36400, 36500, 36600, 36700, 36800, 36900, 37000, 37100, 37200, 37300, 37400, 37500, 37600, 37700, 37800, 37900, 38000, 38100, 38200, 38300, 38400, 38500, 38600, 38700, 38800, 38900, 39000, 39100, 39200, 39300, 39400, 39500, 39600, 39700, 39800, 39900, 40000, 40100, 40200, 40300, 40400, 40500, 40600, 40700, 40800, 40900, 41000, 41100, 41200, 41300, 41400, 41500, 41600, 41700, 41800, 41900, 42000, 42100, 42200, 42300, 42400, 42500, 42600, 42700, 42800, 42900, 43000, 43100, 43200, 43300, 43400, 43500, 43600, 43700, 43800, 43900, 44000, 44100, 44200, 44300, 44400, 44500, 44600, 44700, 44800, 44900, 45000, 45100, 45200, 45300, 45400, 45500, 45600, 45700, 45800, 45900, 46000, 46100, 46200, 46300, 46400, 46500, 46600, 46700, 46800, 46900, 47000, 47100, 47200, 47300, 47400, 47500, 47600, 47700, 47800, 47900, 48000, 48100, 48200, 48300, 48400, 48500, 48600, 48700, 48800, 48900, 49000, 49100, 49200, 49300, 49400, 49500, 49600, 49700, 49800, 49900, 50000, 50100, 50200, 50300, 50400, 50500, 50600, 50700, 50800, 50900, 51000, 51100, 51200, 51300, 51400, 51500, 51600, 51700, 51800, 51900, 52000, 52100, 52200, 52300, 52400, 52500, 52600, 52700, 52800, 52900, 53000, 53100, 53200, 53300, 53400, 53500, 53600, 53700, 53800, 53900, 54000, 54100, 54200, 54300, 54400, 54500, 54600, 54700, 54800, 54900, 55000, 55100, 55200, 55300, 55400, 55500, 55600, 55700, 55800, 55900, 56000, 56100, 56200, 56300, 56400, 56500, 56600, 56700, 56800, 56900, 57000, 57100, 57200, 57300, 57400, 57500, 57600, 57700, 57800, 57900, 58000, 58100, 58200, 58300, 58400, 58500, 58600, 58700, 58800, 58900, 59000, 59100, 59200, 59300, 59400, 59500, 59600, 59700, 59800, 59900, 60000, 60100, 60200, 60300, 60400, 60500, 60600, 60700, 60800, 60900, 61000, 61100, 61200, 61300, 61400, 61500, 61600, 61700, 61800, 61900, 62000, 62100, 62200, 62300, 62400, 62500, 62600, 62700, 62800, 62900, 63000, 63100, 63200, 63300, 63400, 63500, 63600, 63700, 63800, 63900, 64000, 64100, 64200, 64300, 64400, 64500, 64600, 64700, 64800, 64900, 65000, 65100, 65200, 65300, 65400, 65500, 65600, 65700, 65800, 65900, 66000, 66100, 66200, 66300, 66400, 66500, 66600, 66700, 66800, 66900, 67000, 67100, 67200, 67300, 67400, 67500, 67600, 67700, 67800, 67900, 68000, 68100, 68200, 68300, 68400, 68500, 68600, 68700, 68800, 68900, 69000, 69100, 69200, 69300, 69400, 69500, 69600, 69700, 69800, 69900, 70000, 70100, 70200, 70300, 70400, 70500, 70600, 70700, 70800, 70900, 71000, 71100, 71200, 71300, 71400, 71500, 71600, 71700, 71800, 71900, 72000, 72100, 72200, 72300, 72400, 72500, 72600, 72700, 72800, 72900, 73000, 73100, 73200, 73300, 73400, 73500, 73600, 73700, 73800, 73900, 74000, 74100, 74200, 74300, 74400, 74500, 74600, 74700, 74800, 74900, 75000, 75100, 75200, 75300, 75400, 75500, 75600, 75700, 75800, 75900, 76000, 76100, 76200, 76300, 76400, 76500, 76600, 76700, 76800, 76900, 77000, 77100, 77200, 77300, 77400, 77500, 77600, 77700, 77800, 77900, 78000, 78100, 78200, 78300, 78400, 78500, 78600, 78700, 78800, 78900, 79000, 79100, 79200, 79300, 79400, 79500, 79600, 79700, 79800, 79900, 80000, 80100, 80200, 80300, 80400, 80500, 80600, 80700, 80800, 80900, 81000, 81100, 81200, 81300, 81400, 81500, 81600, 81700, 81800, 81900, 82000, 82100, 82200, 82300, 82400, 82500, 82600, 82700, 82800, 82900, 83000, 83100, 83200, 83300, 83400, 83500, 83600, 83700, 83800, 83900, 84000, 84100, 84200, 84300, 84400, 84500, 84600, 84700, 84800, 84900, 85000, 85100, 85200, 85300, 85400, 85500, 85600, 85700, 85800, 85900, 86000, 86100, 86200, 86300, 86400, 86500, 86600, 86700, 86800, 86900, 87000, 87100, 87200, 87300, 87400, 87500, 87600, 87700, 87800, 87900, 88000, 88100, 88200, 88300, 88400, 88500, 88600, 88700, 88800, 88900, 89000, 89100, 89200, 89300, 89400, 89500, 89600, 89700, 89800, 89900, 90000, 90100, 90200, 90300, 90400, 90500, 90600, 90700, 90800, 90900, 91000, 91100, 91200, 91300, 91400, 91500, 91600, 91700, 91800, 91900, 92000, 92100, 92200, 92300, 92400, 92500, 92600, 92700, 92800, 92900, 93000, 93100, 93200, 93300, 93400, 93500, 93600, 93700, 93800, 93900, 94000, 94100, 94200, 94300, 94400, 94500, 94600, 94700, 94800, 94900, 95000, 95100, 95200, 95300, 95400, 95500, 95600, 95700, 95800, 95900, 96000, 96100, 96200, 96300, 96400, 96500, 96600, 96700, 96800, 96900, 97000, 97100, 97200, 97300, 97400, 97500, 97600, 97700, 97800, 97900, 98000, 98100, 98200, 98300, 98400, 98500, 98600, 98700, 98800, 98900, 99000, 99100, 99200, 99300, 99400, 99500, 99600, 99700, 99800, 99900, 100000

Name of group ..S.P.A. U.C.A. Map No. ..R3619  
 We, the undersigned owners\* of the following adjoining claims, desire to group them according to the provisions of the Mineral Act:-

NAME OF CLAIM	No. of Units	Record No. or Lot No.	Month of Record	SIGNATURE OF OWNER*	Free Miner Certificate No.
SILVER LIP	1	2388	June	C. Stanley	200001
SILVER LIP #1	1	10495	July		
SILVER LIP #2	1	10496	July		
SILVER LIP	1	2386	June		
SILVER LIP	1	6798	June		
SILVER LIP	1	2387	June		
SILVER LIP	1	2385	June		
SILVER LIP	1	5537	June		
SILVER LIP 1	1	1414	June	C. Stanley	208009
SILVER LIP 2	1	1421	June	W. H. MORRIS	179780
SILVER LIP 3	1	1422	June		
SILVER LIP 4	1	1423	June		
SILVER LIP 5	1	1424	June		
SILVER LIP 1	1	13775	June	C. Stanley	200001
SILVER LIP 2	1	13776	June	W. H. MORRIS LTD	200001
SILVER LIP 3	1	13777	June		
SILVER LIP 4	1	13778	June		
SILVER LIP 5	1	13779	June		
SILVER LIP 1	4	2382	June	C. Stanley	200001
SILVER LIP 2	6	2383	June	W. H. MORRIS LTD	200001
SILVER LIP 3	7	2384	June		
SILVER LIP 4	1	2385	June		
SILVER LIP 1	1	2386	June	C. Stanley	200001
SILVER LIP 2	1	2387	June	W. H. MORRIS LTD	200001
SILVER LIP 3	1	2388	June		
SILVER LIP 4	1	2389	June		
SILVER LIP 1	22	6798	June	C. Stanley	200001
SILVER LIP 2	16	5537	June	W. H. MORRIS	179780
SILVER LIP 3	1	1421	June		

\* May be signed by agent on behalf of owner.

## TABLE OF CONTENTS

	<u>PAGE</u>
SUMMARY AND CONCLUSIONS	1
A. Introduction	3
1. Geographic and Physiographic Position	3
2. Access	3
3. Property Definition	4
4. History	5
B. Geology	8
C. Summary of Work, Drilling	14
D. Detailed Technical Data and Interpretation	14
1. Purpose	14
2. Results and Interpretation	15
3. Conclusions	16
E. Bibliography	16
F. Certification	17
<u>MAPS AND ILLUSTRATIONS</u>	<u>SCALE</u> <u>PAGE</u>
Figure 1    Location Map, Claim Map, and Area of Drilling	1:50,000                      9
Figure 2    Air Photo, BC 7746, No. 129 (photocopy)	Approx. 1": 1,600'                      10
Figure 3    Air Photo, BC 7746, No. 130 (photocopy)	Approx. 1": 1,600'                      11
Figure 4    Drill Plan	1": 500'                      12
Figure 5    Cross-Section                      Horizontal and Vertical Scale	1": 500'                      13

## Appendices

Title	Appendix
Diamond Drill Logs, NQ Drill, Hole 83-8	I
Assay Certificates, Hole 83-8	I
Daily Time Reports	II
Invoices and Cancelled Cheques	
Supporting Cost Statement	III

## SUMMARY AND CONCLUSIONS

The Topley Property, the subject of this report consists of individual claims known as the Silver Cup claims, the Golden Eagle claims, and the Tuya claims. Contiguous to these claims are 3 COR claims consisting of 30 units and 3 COR fractions, and the NEZ claim of 20 units and KEA claim of 16 units. In total, these claims cover 2061 hectares or 5094 acres.

The above claims have previously been treated as separate properties by different owners, each having their own vein system. Because of the geological environment in which the Topley Property is set, the writer believes that the individual showings in the area of interest could be related. As a result, the company, under the supervision of Mr. R.W. Phendler, P.Eng., undertook to test continuity of mineralization on the Silver Cup claims. The drilling in 1981 revealed that there are high grade sections within a wide (eleven to fifty-two feet) tabular, bleached zone which is open to the west, east, south and at depth. Drilling in 1982 revealed that the tabular bleached zone continues south-easterly and hole 82-7 intersected an additional bleached zone with a one-hundred and thirty foot thickness, at depth.

Follow up drilling in 1983 tested some VLF, E-M 16 conductors with encouraging results. Continued drilling revealed that there is continuity to the top and bottom bleached zones and assay values have improved substantially in the bottom zone. As well, a zone with good assay values is being developed between the top and bottom zones. Hole 83-8, the subject of this report was a hole in which assay values improved in the bottom zone.

Diamond drilling was carried out on hole 83-8 from September 6, 1983 to September 27, 1983 but assessment work was filed for drilling until September 23, 1983 which included 663.0 feet (202.1 m) of core. At a basic industry rate of \$17.00 per foot, the cost of this hole would have been approximately \$11,271.00. \$3,600.00 of assessment work has been applied for and supporting invoices and cancelled cheques are included in appendix III.

Physical work carried out to date, as well as field and literature research has led the writer to believe that Bishop Resources Development Ltd. has a prospect which could be derivative of a massive sulfide type deposit or a hot springs epithermal type deposit. Encouraging drill results in the last few diamond drill holes has given the Company sufficient information to expand its exploration program substantially for 1984, with the view to developing a larger bulk tonnage prospect.



## A. INTRODUCTION

### 1. GEOGRAPHIC AND PHYSIOGRAPHIC POSITION

The Topley Property is located on the north side of Mt. McCrea and Findlay Creek (formerly known as Richfield Creek), between elevations of 975 meters (3200 feet) and 1522 meters (4995 feet) A.S.L., 7.5 km (4.5 miles) north-east of Topley, B.C. The town of Topley, B.C. is situated 40 km (25 miles) east of Houston, B.C. on the Yellowhead Highway 16 which connects Prince George, B.C. to Prince Rupert, B.C. The coordinates are LAT. 54° 32'N and LONG. 126° 13' W. Most of the exploration and development has been at the lower elevations. The 1000 meter U.T.M. grid coordinates are E.290000M., N.6050000M., zone 10.

The northern interior plateau climate here is moderate with below-freezing average temperature from November to March and there is light to moderate precipitation at the lower elevations. Nez Lake, which drains into Findlay Creek, is part of the headwaters which form the Bulkley Valley drainage system. Findlay Creek flows westerly, through the northern edge of the property. Forest cover is predominately lodgepole pine. There is some scattered spruce and balsam and undergrowth in previously fire burned areas is dense, particularly in the swampy areas, and windfalls are plentiful.

Glaciations, as can be seen from striations on outcrop in Findlay Creek, was apparently west to west-south-west. Outcrops are scattered throughout the property and consist of andesite ridges above the swampy areas, and trend generally north-westerly, south-easterly.

### 2. ACCESS

Road access from B.C. Highway 16 is north by paved road along the Granisle-

Babine Lake Road for 4.0 km (2.4 miles), then by good gravel road east for 5.0 km (3.0 miles). The last section of road for 3.2 km (2.0 miles) requires a four-wheeled drive vehicle in wet conditions.

Access by air travel by commercial airlines is to Smithers, B.C. about 1.5 hours flight from Vancouver, B.C. Smithers is 57 km (36 miles) west of Houston, B.C. There is a gravel runway at a Federal Airport 7.2 km (4.5 miles) south-west of Houston, B.C., which is available all year for light aircraft use.

### 3. PROPERTY DEFINITIONS

The Topley Property consists of the following contiguous mineral claims:

<u>CLAIM</u>	<u>RECORD NO.</u>	<u>EXPIRY DATE</u>
SILVER CUP	2388G	June 17, 1987
SILVER CUP #1	10495K	August 3, 1987
SILVER CUP #2	10496K	August 3, 1987
BIG QUA	2386G	June 17, 1987
MAPLE LEAF	4898G	June 25, 1987
VINCENT	2387G	June 17, 1987
HIGH COMMAND	2385G	June 17, 1987
SAM	5537G	June 28, 1987
GOLDEN EAGLE 1-4	132205-132208	July 31, 1987
TUYA 1-4	1919-1922	July 31, 1987
COR 1 (4 units)	3352	November 6, 1987
COR 2 (6 units)	3353	November 6, 1987
COR 3 (20 units)	3354	November 6, 1987

<u>CLAIM</u>	<u>RECORD NO.</u>	<u>EXPIRY DATE</u>
COR 1Fr	3355	November 6, 1987
COR 2Fr	3356	November 6, 1987
COR 3Fr	3357	November 6, 1987
NEZ	4788	October 4, 1984
KEA	4789	October 4, 1984

over an area of 2061 hectares or 2094 acres.

The Cor 1-3, Cor 1Fr-3Fr mineral claims are owned by Bishop Resources Development Ltd. The Silver Cup, Silver Cup #1, #2, Big Qua, Maple Leaf, Vincent, High Command, Sam mineral claims are owned by Laurence Perry, and the late Harry Hagman through the companies Hobby Mines Ltd. and Viscount Kenmure Holdings Ltd. Bishop Resources Development Ltd. has an option to purchase these mineral claims through Geokor Energy Holdings Ltd. Bishop Resources Development Ltd. acquired 50% interest held by Geokor Energy Holdings Ltd., in the Golden Eagle 1-4 mineral claims and is also acquiring an assignment to Laurence Perry of Smithers, B.C., Ronald Williams' remaining 50% interest in these claims, the remaining owner of the property. Bishop Resources Development Ltd. through Geokor Energy Holdings Ltd. has an option to purchase the Tuya 1-4 mineral claims from William H. Morris of Smithers, B.C. K.F. Branner is the owner of the Nez and Kea mineral claims. Bishop Resources Development Ltd. is the operator of all of the above claims known as the Topley Property.

#### 4. HISTORY

The history of the Silver Cup claims, Golden Eagle claims and Tuya claims (formerly known as the BOX group) are well documented in various B.C. Minister of Mines Annual Reports, 1911 to 1953, as well as various Bulletins. The most detailed description of the Silver Cup is in BCMM Annual Report

1937, pp. 27-32, and of the Golden Eagle BCMM Annual Report 1937 pp. 24-26.

There are some records of impressive production from these claims, and some of the highest grade silver in the area was produced from the Golden Eagle. The history and production on these claims has been summarized by Mr. R.W. Phendler, P.Eng., in his reports dated October 29, 1980; October 19, 1981; and January 10, 1982.

Some exploration diamond drilling was done on the Silver Cup claims in 1966 by Silver Cup Mines Ltd. and in 1978, Jim Thomas of Smithers, B.C. drilled two holes south of Adit A. On September 11, 1980, Mr. R.W. Phendler, P.Eng., examined the Silver Cup claims for Geokor Energy Holdings Ltd. and recommended its acquisition in his report of October 29, 1980. Geokor obtained an option on the claims as well as an outright purchase on the ball mill and flotation cells used by Equity Silver Mines Ltd. in their feasibility studies. In the meantime the writer who was intrigued by the possibility of a regional setting of a massive sulfide mineral deposit, began a literature research into neighbouring properties and conducted limited prospecting in the area. As a result, it was recommended that Geokor acquire the Golden Eagle 1-4, Tuya 1-4, and so some additional staking. This was done by November 1980 and in the spring of 1981, Bishop Resources Development Ltd. acquired the Silver Cup mineral claims from Geokor. During September 1981, while diamond drill testing for the veins described in Mr. R.W. Phendler's report of October 29, 1980 and letter attached August 10, 1981, a highly altered bleached rhyolite was encountered in the drill holes which contained fine-grained disseminated sulfides as well as veinlets containing high grade sulfides. This horizontal, bleached altered zone was intersected in a grid pattern measuring 100 meters (300 feet) east to west and 100 meters (300 feet) north to south, and south of an adit which contains high

grade values of silver and base metals. It became apparent that the surrounding claims to the Silver Cup could be geologically related and on October 19, 1981, Mr. R.W. Phendler recommended in this report that the surrounding claims be acquired by Bishop Resources Development Ltd. Up to this time the Silver Cup, Golden Eagle, and Tuya claims were all treated as separate prospects each containing its own quartz veins with high grade precious and base metal values. The Nez and Kea claims were staked after subsequent prospecting revealed that substantial mineralization occurs in outcrop near the long tectonic linear which extends from the Topley Richfield property to the Nez and Kea claims and beyond to the south-east,

In addition to the shallow bleached zone encountered by drilling in 1981, deep drilling in late 1982 showed that a deeper 130 foot (39.6 m) bleached zone exists also. Drill hole 83-8 was spotted to test the northern extension of this zone, and to relate it to mineralization in outcrop on the surface and in Adit A.

The geological setting of shallow to steeply, easterly dipping veins, intermittent with a wide horizontal bleached zone of impressive dimensions in a volcanogenic environment make this an attractive prospect for a massive sulfide deposit. If a deposit does in fact exist, the regional setting suggests that it may contain sizeable bulk tonnages of economic minerals amenable to underground and open pit mining methods. Some of the breccia near surface has been compared to the breccia from Equity Silver Mines Ltd. This type of breccia from the Topley Property can be seen on the surface around the drill pad at hole 82-4. Moreover, if ever a deposit should prove economically viable, the power line to Granisle, B.C. passes within 5 km ( 3 miles) of the property and the Canadian National Railway loading area for Granisle Mines concentrates is on the south side of Topley, B.C. The area of

interest on the property is nearly flat, topographically, making exploration for an orebody inexpensive.

## B. GEOLOGY

With respect to G.S.C. Map 671A "Houston", and G.S.C. Map O.F. 351, Smithers, B.C. 93L, the property is underlain by volcanic fragmental rocks of the Jurassic-Cretaceous Age and possibly belongs to the Hazelton Group, Telkwa Formation. The volcanic rocks are composed of rhyolites, andesites, andesite porphyry, and andesite breccia with included tuff. Regional metamorphism has produced a talc-chloritic alteration in these rocks that forms a silicified, chloritic schist form of volcanics. A granitic stock is found 4.0 km (2.5 miles) to the north-east that trends north-westerly, south-westerly, the Topley intrusions composed of quartz monzonite, quartz diorite, granodiorite, and monzonite. On the most north-western portion of the claims are some waterlain sediments of the Endako Group. Argillites and shales have been found by the writer exposed in cuts along the bank which intersects Findlay Creek.

Within this geology, and within the Silver Cup, Golden Eagle, and Tuya claims are various quartz vein systems described in various reports (see Bibliography) by Mr. R.W. Phendler, P.Eng., Dr. W.R. Newman, P.Eng., John F. Fairley, P.Eng., and various BCMM Annual Reports and Bulletins. Much attention was focused on vein geology in the past. However, most recent development and observations which has been most noteworthy is the amount of disseminated sulfides and veinlets of massive sulfides in the significant widths of alteration and bleaching surrounding the mineralized vein systems. Various grab samples of the host rock have contained visible sulfides of good grade in the absence of quartz-carbonate veining. Mineralization is present in the form of galena, sphalerite, pyrite,



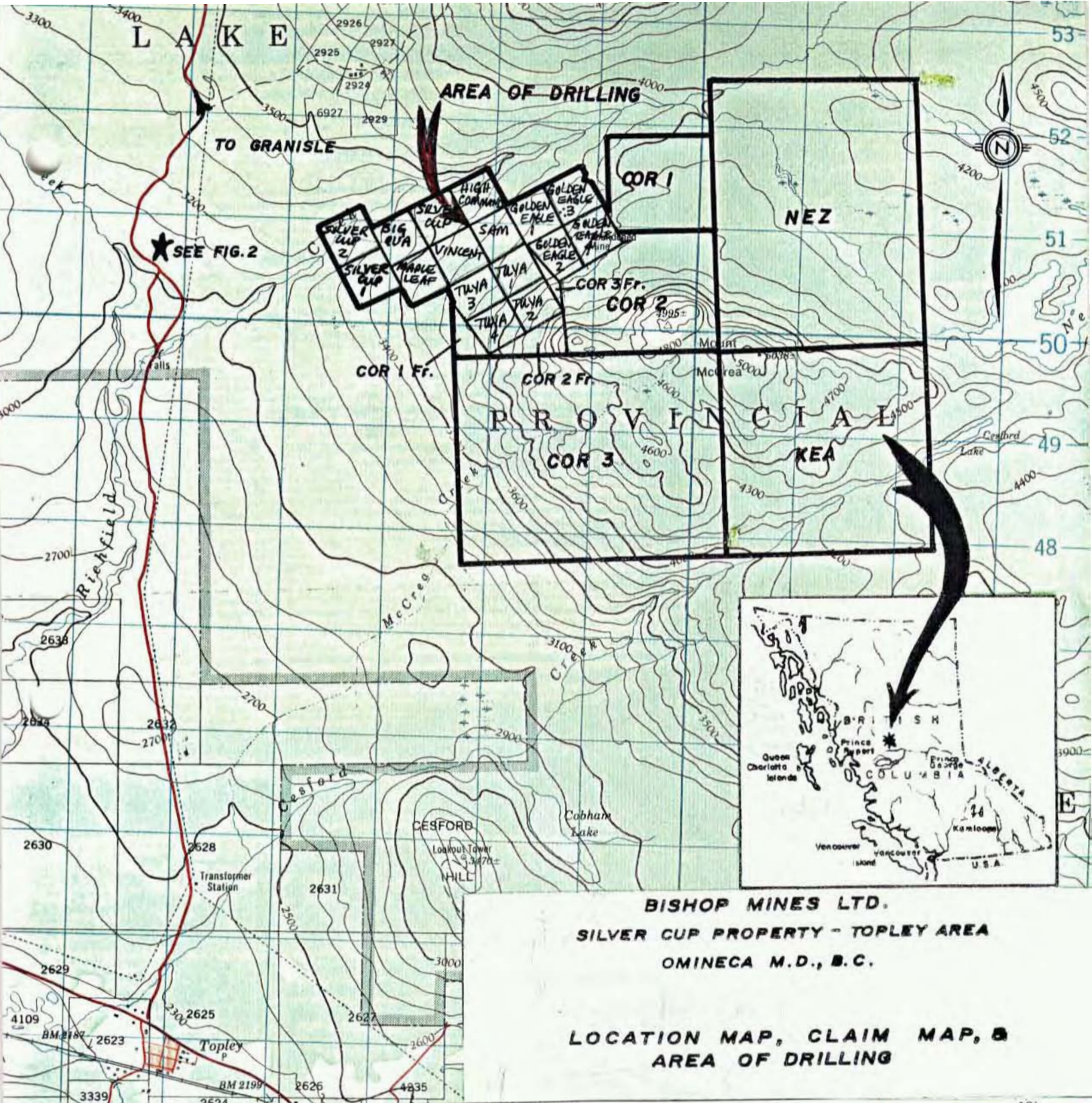

**BISHOP MINES LTD.**  
**SILVER CUP PROPERTY - TOPLEY AREA**  
**OMINECA M.D., B.C.**

**LOCATION MAP, CLAIM MAP, &**  
**AREA OF DRILLING**

**TOPLEY**  
 COAST LAND DISTRICT RANGE 5  
 BRITISH COLUMBIA

This Provisional Map is equivalent to a standard map in accuracy of content

Some names on this map are not shown. Corrections or additions are shown on the original maps. Surveys and Mapping Branch.

CONTOUR INTERVAL 100 FEET  
 Elevations in Feet above Mean Sea Level  
 North American Datum 1983  
 Transverse Mercator Projection





SCALE: 1 in. = 1600 ft.  
approximately

ADIT A



★ CORRESPONDS TO ★ FIGURE 1

BC7746 N° 129

FIGURE 2





SCALE: 1 in. = 1600 ft.  
approximately

ADIT A



\* CORRESPONDS TO \*  
FIGURE 4

BC7746 N<sup>o</sup> 130

Province of British Columbia



FIGURE 3



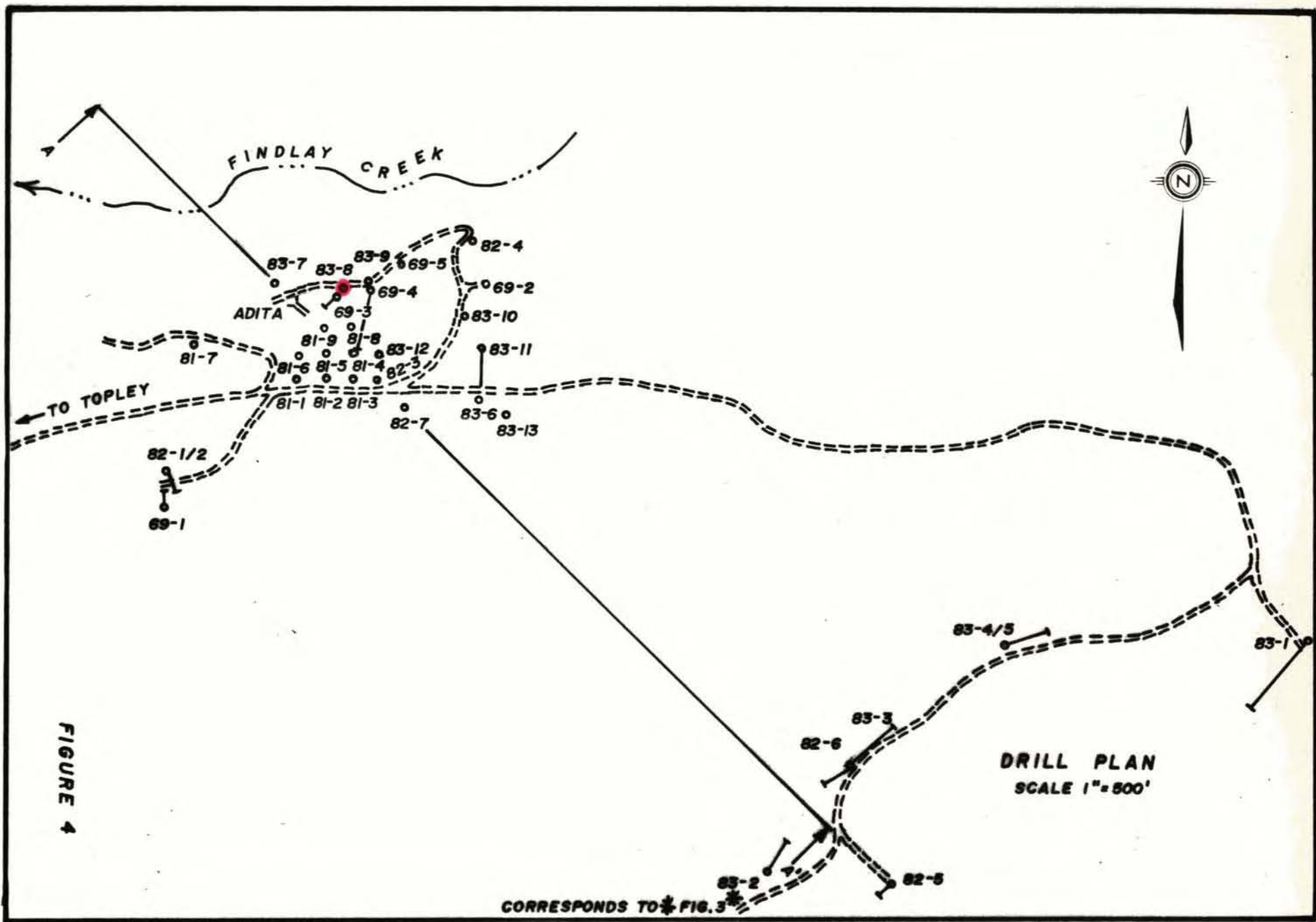
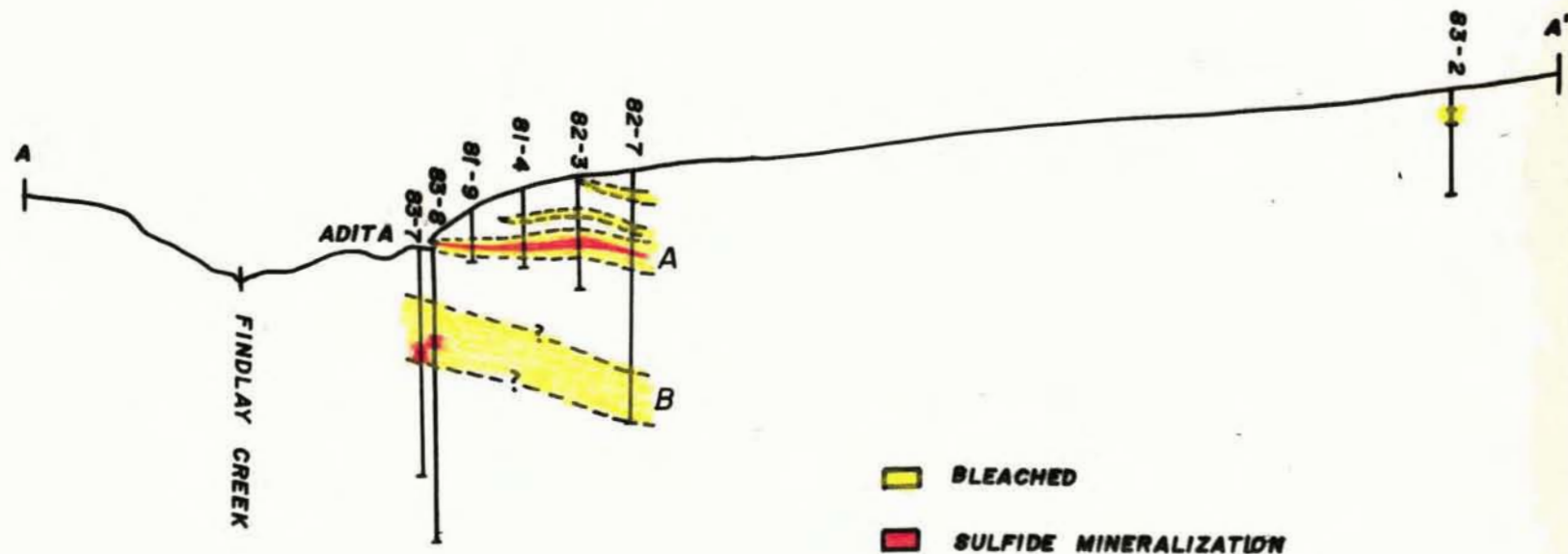



FIGURE 4

FT.' ASL.  
3500  
3000



 BLEACHED  
 SULFIDE MINERALIZATION

CROSS-SECTION A-A'  
LOOKING N-E

VERTICAL AND HORIZONTAL SCALE  
1" = 500'

FIGURE 5

chalcopyrite, tetrahedrite, freibergite, and native silver. A well exposed barite vein outcrops on the Kea claim. The vein measures some 300 feet (91.5 m) by 2 feet (0.61 m). In addition there is abundant specular hematite, chalcopyrite, galena and tetrahedrite in various trenches, south-east of the headwaters of McCrae Creek.

#### C. SUMMARY OF WORK, DRILLING

Drilling on hole 83-8 was commenced on September 6, 1983 and concluded on September 27, 1983/ Assessment work was filed only to September 23, 1983 at which time a total of 663.0 feet (202.1 m) was drilled. At a base cost of approximately \$17.00 per foot in the industry the cost of this footage would have been \$11,271.00. The company drilled this hole, NQ size, using its own equipment which consists of a Longyear Super 38 diamond drill, D-8 Caterpillar, 3 service trucks and all support equipment. The core is stored in core boxes in a core rack which is on the Golden Eagle #3 claim.

Drill logs and assay sheets are included in this report in Appendix I; shift reports are included in Appendix II. Invoices are included in Appendix III as supporting evidence of the Cost Statement. One diamond drill hole 83-8, NQ size, was drilled to a total depth of 813 feet (247.9 m), see Appendix I. Drilling was carried out on the east-west border of the Silver Cup and Vincent mineral claims.

#### D. DETAILED TECHNICAL DATA AND INTERPRETATION

##### 1. PURPOSE

During 1981, diamond drilling, NQ size showed that a tabular, mineralized bleached



zone in andesite exists as zone A in figure 5. Holes 82-3 and 82-7 revealed that this zone continued to the south-east. However, alteration encountered at depth in 82-7 gave encouragement to extend the hole deeper. As expected, a deeper bleached zone, B, was encountered as in figure 5. Alteration and mineralization was described by Dr. Peter B. Read in his reports of February 16, 1983 and March 28, 1983. However, assay results were marginal. Because of the thickness up to 130 feet (39.6 m) of this zone, intensity of alteration; and mineralization present, it was thought that this zone had high potential for bulk tonnages.

Because some 200 feet (61.0 m) of elevation is lost by positioning the drill at collar 83-8 (see figure 4), a less expensive hole could be drilled than by stepping out 100 feet (33.0 m) from 82-7. It was thought that the possibility of the zone continuing northward was good, because of the structures of the zone, as well as intensity of alteration. Furthermore, it was hoped that a better understanding of the relationship of the deep zone to the impressive mineralization in Adit A and the top bleached zone could be made. Hole 83-8 was collared to test for extensions of the bottom bleached zone at the cheapest possible cost.

## 2. RESULTS AND INTERPRETATION

Unlike the zone at 82-7, where sparse assay results exist, the same zone from 266.5 feet (81.3 m) to 271.0 feet (82.6 m) and 319.0 feet (97.3 m) to 329.2 feet (100.4 m) contained some impressive values, although over narrow widths (see Appendix I). Furthermore, these intersections correlate well with mineralized intersections from 83-7 and 83-9, indicating that the bottom zone does indeed hold promise for bulk tonnage potential.

Spot checks for titanium at 407.0 feet (124.1 m) to 412.0 feet (125.6 m) and 532.5 feet (162.4 m) to 534.2 feet (162.9 m) showed that titanium values persist, which were first encountered in hole 83-7.

### 3. CONCLUSION

Drilling from 83-7 thru 83-11 has shown that continuity of both the top zone and bottom zone persists. Mineral values have improved substantially in the lower zone and hole 83-8 gave encouragement for further drilling. Although the most interesting results were narrow widths, it was expected that intersections would widen by stepping south-eastward. Subsequent drilling has shown this to be the case and the results will be the basis for a much expanded program during 1984.

Respectfully submitted



C.H. Stanley, B.Sc  
Geophysicist

December 13, 1983  
Vancouver, B.C.

E. BIBLIOGRAPHY

British Columbia Minister of Mines Annual Reports.

1911, 105, 288; 1912, 113; 1914, 509; 1937, 27-37; 1941, 24, 44; 1952, 95; Bulletin 10, Rev. 1943, 73; Bulletin 45, 1962, 12 for Silver Cup.

British Columbia Minister of Mines Annual Reports.

1927, 48; 1928, 174; 1929, 179, 429; 1930, 143; 1931, 75; 1932, 85; 1933, 99; 1934, A24, C12; 1937, C24; 1938, B36, C49; 1939, 56, 58, 92; 1940, 23, 41, 43, 78; 1941, 24, 41, 42, 55; 1942, 31, 32; 1952, 95; for the Golden Eagle, Tuya.

G.S.C. Summary Report, 1928, Part A, pp 56-77.

G.S.C. Paper 36 - 20, 1936, pp 152 and 153.

Various Assessment Reports, British Columbia 93L/9E  
93L/9W

Phendler, R.W., P.Eng. - "Report on the Silver Cup Property, Omineca Mining Division, British Columbia" - October 29, 1980

Phendler, R.W., P.Eng. - "Report on the Silver Cup Property, Omineca Mining Division, British Columbia" - October 19, 1981

Phendler, R.W., P.Eng. - "Report on Assessment Work" - January 10, 1982

Phendler, R.W., P.Eng. - "Progress Reports" - March 3, 1982  
August 7, 1982

Cummings, J.M. - "Summary of Available Reports on Gold Claim Group - Silver Cup Mines" - February 13, 1980

Fairley, J.F., P.Eng. (Chapman, Wood & Griswold) - "Silver Cup Mines Ltd., Gold Claim Group" - August 19, 1966

B.C. Minister of Mines Annual Report - 1937, pages 27 -32

Card, K. - Core logs with assays of Diamond drill holes #1 to # 5

Newman, W.R., P.Eng. - "Topley Claim Group" - undated

Newman, W.R., P.Eng. - Letter Report - "Topley Claim Group, Babine Lake, B.C." September 3, 1971

Read, Dr. Peter B. - "Petrography of Two Samples of Drill Core" February 16, 1983

Read, Dr. Peter B. - "Ore Microscopy of Samples from the Silver Cup Property, Houston, B.C." March 28, 1983

Stanley, C.H. - "Assessment and Progress Report on Drilling Geophysics and Geology, Topley Property" - September 7, 1982.

Harivel, Colin - Field Notes and Diamond Drill Hole Summary to June 1983.

F. CERTIFICATION

I, C.H. Stanley, of #305 - 1212 West Broadway, Vancouver, British Columbia do hereby certify that:

1. I am an exploration geophysicist, and have worked continuously as an explorationist since graduation in 1971.
2. I am a graduate of the University of British Columbia, with a Bachelor of Science degree in geophysics.
3. I am Secretary and Director of Bishop Resources Development Ltd., and have been engaged principally on this company's projects in both exploration and financial affairs for the company.
4. The subject of this report was written from a great deal of personal research and field work. The report was written under the consultation and supervision of Mr. R.W. Phendler, P.Eng., the company's engineering consultant.



C.H. Stanley, B.Sc.

December 15, 1983

Vancouver, B.C.

DRILL HOLE RECORD

**BISHOP MINES LTD.**

#305, 1212 West Broadway, Vancouver, British Columbia V6H 1G6 247.9 M.

Property Topley District Dumnick Hole No. 83-8 Length 813.0 ft  
 Commenced Sept 6/83 Location Near Adit A North end Silvercup dm. Tests at — Hor. Comp. —  
 Completed Sept 27/83 Core Size NQ Corr. Dip -90° Vert. Comp. —  
 LAT. Survey not completed DEP. Survey not completed ELEV. 1056m 3463 ft True Brq. — Logged by CH Stanley  
 Objective To test northern extension of bleached zone % Recov. > 95% Date —  
82-7, regarding attitude and relationship to mineralization in Adit A'

Claim Silvercup  
 T Brg. —  
 Collar Dip —  
 Elev. 1056m, 3463 ft  
 Length 297.9m, 813.0 ft

METERS from to	DESCRIPTION	ESTIMATED % MINERAL	RECOVERY		SAMPLE INTERVAL	SAMPLE NO.	Length	ANALYSIS		
			RUN	SHORT						% Recovery
0-4.5' (1.37m)	OVERBURDEN.		BLOCKS	INT						
4.5' (1.37m) -	4.5' (1.37m) - 27.5' (8.38m), badly broken feldspar porphyry agglomerate, limonite on fracs., epidote stringers, hematite on fractures, leucocratic from 21.0 ft (6.40m) - 27.5' (8.38m)		BOX 1	4.5 - 27.5						
	27.5' (8.38m) - 75.0' (22.9m), andesite porphyry purple, with epidote stringers, limonite on fracs.		BOX 2	27.5 - 41.5						
	barron qtz veinlet at 42.5', 0.25", 15° to ca; at 43.5', 0.50", 15° to ca; epidote, qtz. veinlet at 62.3', 0.75", 45° to ca; 2 veinlets at 66.5', 0.75" at 30° to ca.		BOX 3	41.5 - 59.0						
	75.0' (22.9m) - 114.5' (34.9m); strongly altered zone, tuffaceous andesite, very fine-grained breccia in tuffs, ash-like, abundant epidote and chlorite in stringers.		BOX 4	59.0 - 75.8						
	Fine-grained breccia, gauge 92.5-93.5', and solidified with 1mm pebbles included. Strong bleaching especially 89.7' - 114.5'.		BOX 5	75.8 - 88.7						
	114.5' (34.9m) - 141.5' (43.1m), Agglomerate, dark green + sometimes porphyritic, broken 124.5'-125.5' stockwork, narrow qtz veinlets, 123.5'-124.5' one veinlet 0.75", 80° to ca and vuggy, well formed quartz crystals inside. Strong clay alteration at 129.0'. Injected qtz-feldspar veinlet at 127.0'-128.0'.		BOX 6	88.7 - 110.0						
			BOX 7	110.0 - 127.0						

















P0712

DRILL HOLE RECORD

**BISHOP MINES LTD.**

Property Topley #305, 1212 West Broadway, Vancouver, British Columbia V6H 1G6 247.9 m  
 District Onimeca Hole No. 83-8 Length 813.0 ft  
 Commercial Sept 6/83 Location near Adit A, north end Silver Cup claim Tests at — Hor. Comp. —  
 Completed Sept 27/83 Core Size NQ Corr. Dip -90° Vert. Comp. —  
 LAT. Completed DEP. Completed ELEV. 1056m 3463ft True Brg. — Logged by CH Stanley  
 Objective To test northern extension of bleached zone 82-7. % Recov. > 95% Date —  
regarding attitude and relationship to mineralization in Adit A

Claim Silver Cup  
 T Brg. —  
 Collar Dip —  
 Elev. 1056m 3463ft  
 Length 247.9m 813.0ft

METERS from to	DESCRIPTION	ESTIMATED % MINERAL	RECOVERY		SAMPLE INTERVAL	SAMPLE NO.	Length	ANALYSIS	
			RUN	SHORT					% Recovery
414.5' (126.4m) - 424.5' (129.4m)	Massive dark green andesite with bleaching, quartz vein at 423.0', alteration and localized bleaching at 422.0' - 424.5'		Blocks	MT					
424.5' (129.4m) - 442.6' (134.9m)	Massive dark green andesite, small 1" quartz veinlet 20' to ca, barren, flow banding at 429.5'. Highly siliceous, pyrite intermittent.		Box 25	423.0 422.6					
442.6' (134.9m) - 451.0' (137.5m)	Medium green, highly siliceous andesite porphyry, some epidote.		Box 26	442.6 451.0					
451.0' (137.5m) - 479.0' (146.0m)	Alterate, porphyritic andesite with bitraces in division. Some massive quartz vein at 454.0' for 2' at 15° to ca., then minor stockwork type veinlets from 454.0 to 454.5'. 0.50" quartz veinlet 459.0', 25° to ca. Pyrite in shps at 15° to core minor chalcopyrite at 473.0'.		Box 27	451.0 479.0					
479.0' (146.0m) - 496.0' (151.2m)	Massive dark green andesite with minor epidote stringers. Small quartz-calcite inclusions or eyes and thread-like stringers.		Box 28	479.0 496.0					

PO 05/12

DRILL HOLE RECORD

**BISHOP MINES LTD.**

#305, 1212 West Broadway, Vancouver, British Columbia V6H 1G6

Property *Topley* District *Ormeau* Hole No. *83-8* Length *247.9m 813.0ft.*  
 Commenced *Sept 6/83* Location *near Adit A, north end of Silvercup claim* Tests at *—* Hor. Comp. *—*  
 Completed *Sept 27/83* Core Size *NQ* Corr. Dip *-90°* Vert. Comp. *—*  
 LAT. *Survey not completed* DEP. *Survey not completed* ELEV. *1056m 3463ft* True Brg. *—* Logged by *Off. Stanley*  
 Objective *To test the northern extension of the bleached zone* % Recov. *> 95%* Date *—*  
*82-7 regarding attitude and relationship to mineralization in Adit A*

Claim *Silver Cup*  
 T Brg. *—*  
 Collar Dip *—*  
 Elev. *1056m 3463ft*  
 Length *247.9m 813.0ft*

METERS from to	DESCRIPTION	ESTIMATED % MINERAL	RECOVERY		SAMPLE INTERVAL	SAMPLE NO.	Length	ANALYSIS								
			RUN	SHORT				Gr	Pb	Zn	Ag	Au	% Recovery			
496.0' (151.2m) - 504.5' (153.8m)	Transition zone where massive dark green andesite lightens in colour, fine-grained, minor hematite and chloritic alteration at 500.0'		Box 29 504.5 511.3	512												
504.5' (153.8m) - 513.0' (156.4m)	Flow banding at 506.0', Core broken 506.0'-508.0'; Local bleaching and clay alteration, Flow with hematite; chloritic; becomes porphyritic; but highly silicified, yet altered for 9.0'															
513.0' (156.4m) - 516.0' (157.3m)	Feldspar porphyry agglomerate, but bleached. Stockwork type quartz veins 514.5' - 515.0'. Pyrite + galena.		Box 30 514.5 524.5	517	513.5 516.0	028925	2.5'	11	29	144	13	ND	1CP			
516.0' (157.3m) - 549.5' (167.5m)	Dark green feldspar porphyry agglomerate. 3" epidote veinlets at 519.5', 537.5', 546.5'. Minor cpy at 532.5' - 534.5'. No smear at 544.0'. Small 0.50" quartz vein at 553.5' at 50° to ca.															
553.0' - 554.5'	steep 0.50" quartz vein at 85° to ca.		Box 31 531.0 539.5	532	531.0 532.5	028926	1.5'	12	15	129	12	ND	1CP			
549.5' (167.5m) - 563.5' (171.8m)	Feldspar porphyry agglomerate with epidote at 550.0' - 551.0'		534.5 537.5		532.5 534.2	028927	1.7'	101	104	102	103	1001	95	T		
553.0' (3")	558.5' (6")	Spatters of Mo, cpy, tet. (grey mineral?)	544.5		540.0 540.4	028928	0.4'	✓	✓	✓	✓	001				
					535.2 535.5	028932	0.3'	5	9	122	11	ND				







P① of 12

DRILL HOLE RECORD

**BISHOP MINES LTD.**

#305, 1212 West Broadway, Vancouver, British Columbia V6H 1G6 247.9m

Property Topley District Omineca Hole No. 83-8 Length 813.0ft  
 Commenced Sept 6/83 Location near Adit A, north end of Silver Cup claim Tests at --- Hor. Comp. ---  
 Completed Sept 27/83 Core Size NR Corr. Dip -90° Vert. Comp. ---  
 LAT. Survey not completed DEP. Survey not completed ELEV. 1056m 3463ft True Brg. --- Logged by CH Stanley  
 Objective To test the northern extension of the bleached zone 82-7 regarding attitude and relationship of mineralization in Adit A % Recov. >95% Date ---

Claim Silver Cup  
 T Brg. ---  
 Collar Dip -90°  
 Elev. 1056m 3463ft  
 Length 247.9m 813.0ft

METERS from to	DESCRIPTION	ESTIMATED % MINERAL	RECOVERY		SAMPLE INTERVAL	SAMPLE NO.	Length	ANALYSIS	
			RUN	SHORT					% Recovery
	675.0' (205.8m) - 679.0' (207.0m) Massive fine-grained dark green andesite. 1" quartz hematite vein; 10° to ca.		Blocks	INT					
			Box 39	673 671					
			674.5 684.5						
	679.0' (207.0m) - 727.0' (221.7m). Massive dark green, feldspar porphyry agglomerate. Strong epidote from 694.5' - 704.5', 723.5', 725.5'. From 679.0' - 679.5', thread-like quartz-carbonate stringers, web-like. At 684.0', 2" quartz vein, weak, thread-like stringers also. Heavy hematite in fractures and shifs which are steep, up to 80°. 0.50" quartz stringer at 708.5', 80° to ca. 1" quartz veinlet with pyrite at 716.5'; epidote predominant.		Box 40	691 709					
			694.5 704.5						
	727.0' (221.7m) - 790.0' (240.9m). Massive lighter green fine-grained andesite, numerous thread-like stringers, quartz-carbonate at 10° to 15° to ca. at 740.0' - 740.5'. Local bleaching, pyrite stringers, epidote stringers (white). 6" flat, quartz vein, minor py, vuggy. at 742.5', 1" quartz vein at 10° to ca, localized bleaching, minor quartz vein at 738.5' and 736.0' at 10° to ca, 0.50" wide. Small thread-like quartz-carbonate stringers throughout. 1" quartz-vein, 10° to ca at 772.0', 779.0', smaller thread-like stringers throughout at 5°-10° to ca.		Box 41	709 726.5					
			714.5 724.5						
			Box 42	726.5 743.0					
			734.5 744.5						
			Box 43	745.0 764.0					
			754.5						
			Box 44	764.0 782.0					
			764.5 773.0 778.0						
			Box 45	782.0 801.0					
			780.0 800.0						



P12 of 12

DRILL HOLE RECORD

**BISHOP MINES LTD.**

#305, 1212 West Broadway, Vancouver, British Columbia V6H 1G6

Property Topley District Drumella Hole No. 83-8 Length 247.9m 813.0ft  
 Commenced Sept 6/83 Location NE of Adit A, north end of Silver Cup claim Tests at — Hor. Comp. —  
 Completed Sept 27/83 Core Size NQ Corr. Dip -90° Vert. Comp. —  
 LAT. Survey not completed DEP. Survey not completed ELEV. 1056m 3463ft True Brg. — Logged by CH Stanley  
 Objective To test the northern extension of the bleached zone % Recov. >95% Date —  
82-7 regarding attitude and relationship of mineralization in Adit A

Claim Silver Cup  
 T Brg. —  
 Collar Dip -90°  
 Elev. 1056m 3463ft  
 Length 247.9m 813.0ft

METERS from to	DESCRIPTION	ESTIMATED % MINERAL	RECOVERY		SAMPLE INTERVAL	SAMPLE NO.	Length	ANALYSIS	
			RUN	SHORT					% Recovery
	790.0' (240.9m) - 813.0' (247.9m) Feldspar porphyry agglomerate, but lighter in colour and epidote stringers almost white. 2" quartz vein at 799.0', 20' to ca. What is green material? GINGER?		BLOCKS	INT					
	813.0 (247.9m) END OF HOLE		Box 46	813.0					
			810.0						

*CH Stanley*

ACME ANALYTICAL LABORATORIES LTD.  
852 E. HASTINGS, VANCOUVER B.C.  
PH: 253-3158      TELEX: 04-53124

DATE RECEIVED SEPT 26 1983  
DATE REPORTS MAILED *Sept 29/83*

### ASSAY CERTIFICATE

SAMPLE TYPE : CORE - CRUSHED AND PRULVERIZED TO -100 MESH.  
AG & AU BY FIRE ASSAY

ASSAYER *W. J. Toy* DEAN TOYE, CERTIFIED B.C. ASSAYER

BISHOP RESOURCES LTD      FILE # 83-2318      PAGE# 1

SAMPLE	CU %	PB %	ZN %	AG OZ/TON	AU OZ/TON
28915	.16	.20	.67	.59	.069
28916	.16	1.69	.86	.41	.156
28917	.01	.01	.01	.01	.001
28918	.01	.02	.02	.01	.001
28919	.01	.05	.29	.03	.002
28920	.01	.44	.03	.09	.005
28921	.01	.01	.01	.01	.001
28922	.24	22.05	.52	3.05	.005
28923	.01	.20	.06	.05	.001

ICP GEOCHEMICAL ANALYSIS

A .500 GRAM SAMPLE IS DIGESTED WITH 3 ML OF 3:1:3 HCL TO HNO3 TO H2O AT 90 DEG.C. FOR 1 HOUR. THE SAMPLE IS DILUTED TO 10 MLS WITH WATER.  
 THIS LEACH IS PARTIAL FOR: Ca, P, Mg, Al, Ti, La, Na, K, V, Ba, Sr, Cr AND B. Au DETECTION 3 ppm.  
 SAMPLE TYPE - CORE

DATE RECEIVED SEPT 26 1983 DATE REPORTS MAILED Sept 29/83 ASSAYER D. Toye DEAN TOYE, CERTIFIED B.C. ASSAYER

BISHOP RES FILE # 83-2321

PAGE # 1

SAMPLE #	Mo	Cu	Pb	Zn	Ag	Ni	Co	Mn	Fe	Au	U	Au	Th	Sr	Cl	Sb	Bi	V	Ca	P	La	Cr	Hg	Ba	Ti	B	Al	Na	K	M
	ppm	ppm	ppm	ppm	ppm	ppm	ppm	ppm	I	ppm	ppm	ppm	ppm	ppm	ppm	ppm	ppm	ppm	I	I	ppm	ppm	I	ppm	I	I	I	I	I	ppm
28925	1	11	29	144	.3	4	8	3326	2.61	30	6	ND	2	76	1	2	2	13	2.76	.06	5	7	.89	53	.01	5	.48	.01	.19	2
28926	1	12	15	129	.2	6	10	784	3.60	13	2	ND	2	53	1	2	2	83	.88	.08	3	33	1.22	42	.20	4	1.95	.12	.07	2
28929	32	4	14	89	.2	5	9	700	2.80	8	2	ND	2	72	1	2	2	43	1.74	.07	4	22	1.04	34	.11	4	1.59	.04	.08	2
28930	3	63	22	199	.4	4	9	954	3.10	3	3	ND	2	84	1	2	2	33	2.37	.07	10	18	.91	108	.01	3	1.53	.04	.19	2
28931	1	4	8	99	.1	6	13	966	3.46	5	6	ND	2	157	1	2	2	38	3.23	.07	9	22	1.60	198	.02	3	1.92	.04	.24	2



ACME ANALYTICAL LABORATORIES LTD.  
852 E. HASTINGS, VANCOUVER B.C.  
PH: 253-3158      TELEX: 04-53124

DATE RECEIVED SEPT 26 1983  
DATE REPORTS MAILED *Sept 29/83*

**ASSAY CERTIFICATE**

SAMPLE TYPE : CORE - CRUSHED AND PRULVERIZED TO -100 MESH.  
AU BY FIRE ASSAY

ASSAYER *Dean Toye* DEAN TOYE, CERTIFIED B.C. ASSAYER

BISHOP RESOURCES DEV. LTD      FILE # 83-2320      PAGE# 1

SAMPLE	AU OZ/TON
28928	.001

*BISHOP RES*

Contract Name *TOPLEY*  
 Date *Sept 6/83* Day \_\_\_\_\_  
 Well No. *83-8* Afternoon \_\_\_\_\_  
 Size *NQ* - *90* Night \_\_\_\_\_

Job No. *Sel Cup*

Drill No. \_\_\_\_\_  
 Name *A. Branner*  
 Name *S. Parker*  
 Name \_\_\_\_\_  
 Name \_\_\_\_\_

	From	To	Feet	Operation	Drill	Hrs	Hrs	Hrs	Hrs
Coring	<del>4.5</del>	<del>11.5</del>	<del>7.0</del>	Coring		<i>3</i>	<i>4</i>		
Overburden	<i>0</i>	<i>4.5</i>	<i>4.5</i>	Overburden		<i>3</i>	<i>3</i>		
Drill Cement				Cementing					
Ream Casing	<del>4.5</del>	<del>11.5</del>	<del>7.0</del>	Reaming Casing					Test Depths
				Testing					
Water Lines Distance		Ft. Lift	Ft.	Water Lines					
Moving: Under Equip. Show Tractor & Truck Hrs.				Moving					
				Set Up/Tear Down					
				Supervision					
Mob. From Base To Truck Unload Point									
Demob: From Truck Load Point To Base				<i>Drill site</i>		<i>1</i>			
Mob: From Truck Unload Point To 1st Hole									
Demob: From Last Hole To Truck Load Point									
Equipment Data:				Mixing Mud					
Unit	Hour	Remarks		Hole Stabilizing					
Tractor	<i>4</i>	<i>3 hrs move</i>		T. Driving					
Pump		<i>1 hr Drill site</i>		Camp					
Truck				Repair & Maint.					
Mud Mixer				Travel		<i>1</i>	<i>1</i>		
				Other					
				Total Hours		<i>8</i>	<i>8</i>		

General Comments: \_\_\_\_\_

Material Used or Lost

Quantity	Items & Remarks	Approval

ENGINEER

*Bishop Res*

Contract Name *Toplay* Job No. *Sil Cup*  
 Date *Sept 7/83* Day       
 Hole No. *83-8* Afternoon       
 Size *NQ - 90°* Night     

Drill No.

*H. Hamner*  
*S. Parker*

	From	To	Feet	Operation	Drill	Hrs	Hrs	Hrs	Hrs
Coring	<i>4.5</i>	<i>31</i>	<i>25.5</i>	Coring		<i>4</i>	<i>4</i>		
Overburden				Overburden					
Drill Cement				Cementing					
Ream Casing	<i>4.5</i>	<i>16</i>	<i>11.5</i>	Reaming Casing		<i>3</i>	<i>3</i>		Test Depths
				Testing					
Water Lines Distance		Ft.Lift	Ft.	Water Lines					
Moving: Under Equip. Show Tractor & Truck Hrs.				Moving					
				Set Up/Tear Down					
				Supervision					
Mob. From Base To Truck Unload Point									
Demob: From Truck Load Point To Base									
Mob: From Truck Unload Point To 1st Hole									
Demob: From Last Hole To Truck Load Point									
Equipment Data				Mixing Mud					
Unit	Hour	Remarks		Hole Stabilizing					
Tractor				T. Driving					
Pump				Camp					
Truck				Repair & Maint.					
Mud Mixer				Travel		<i>1</i>	<i>1</i>		
				Other					
				Total Hours		<i>8</i>	<i>8</i>		

General Comments: \_\_\_\_\_

Material Used or Lost

Quantity	Items & Remarks	Approval

ENGINEER

Contract Name Bishop Res  
Job Job No. 511  
 Date Apr 8/83 Day —  
 Hole No. 83-8 Afternoon —  
 Size 110 - 90° Night —

	From	To	Feet	Operation	Drill No.	Name	Name	Name	Name
Coring	31	94	63	Coring		7	7		
Overburden				Overburden					
Drill Cement				Cementing					
Ream Casing				Reaming Casing					Test Depths
				Testing					
Water Lines Distance		Ft.Lift	Ft.	Water Lines					
Moving: Under Equip. Show Tractor & Truck Hrs				Moving					
				Set Up/Tear Down					
				Supervision					
Mob. From Base To Truck Unload Point									
Demob: From Truck Load Point To Base									
Mob: From Truck Unload Point To 1st Hole									
Demob: From Last Hole To Truck Load Point									
Equipment Data				Mixing Mud					
Unit	Hour	Remarks		Hole Stabilizing					
Tractor				T.Driving					
Pump				Camp					
Truck				Repair & Maint.					
Mud Mixer				Travel		1	1		
				Other					
				Total Hours		8	8		

General Comments: \_\_\_\_\_  
 \_\_\_\_\_  
 \_\_\_\_\_

Material Used or Lost

Quantity	Items & Remarks	Approval

ENGINEER



*Bishop Res*

Contract Name Topley Job No. \_\_\_\_\_  
 Date Sept 9/83 Day \_\_\_\_\_  
 Hole No. 83-8 Afternoon \_\_\_\_\_  
 Size NO - 90° Night \_\_\_\_\_

Drill No.

Name *A. Brannin*

Name *S. Astor*

Name

Name

	From	To	Feet	Operation	Drill	Hrs	Hrs	Hrs	Hrs
Coring	94	164	70	Coring		7	7		
Overburden				Overburden					
Drill Cement				Cementing					
Ream Casing				Reaming Casing					Test Depths
				Testing					
Water Lines Distance		Ft.	Lift Ft.	Water Lines					
Moving: Under Equip. Show Tractor & Truck Hrs				Moving					
				Set Up/Tear Down					
				Supervision					
Mob. From Base To Truck Unload Point									
Demob: From Truck Load Point To Base									
Mob: From Truck Unload Point To 1st Hole									
Demob: From Last Hole To Truck Load Point									
Equipment Data				Mixing Mud					
Unit	Hour	Remarks		Hole Stabilizing					
Tractor				T. Driving					
Pump				Camp					
Truck				Repair & Maint.					
Mud Mixer				Travel		1	1		
				Other					
				Total Hours		8	8		

General Comments: \_\_\_\_\_  
 \_\_\_\_\_  
 \_\_\_\_\_

Material Used or Lost

Quantity	Items & Remarks	Approval

ENGINEER

Contract Name Bishop Res  
Topley. Job No. Sil  
 Date Sept 11/83 Day Cup  
 Hole No. 83-8 Afternoon   
 Size 100 - 90° Night

Drill No.

Name A. Banner  
 Name S. Acker  
 Name  
 Name

	From	To	Feet	Operation	Drill	Hrs	Hrs	Hrs	Hrs
Coring	210	244	34	Coring		9	9		
Overburden				Overburden					
Drill Cement				Cementing					
Ream Casing				Reaming Casing					Test Depths
				Testing					
Water Lines Distance		Ft.	Lift Ft.	Water Lines					
Moving: Under Equip. Show Tractor & Truck Hrs.				Moving					
				Set Up/Tear Down					
				Supervision					
Mob. From Base To Truck Unload Point									
Demob: From Truck Load Point To Base									
Mob: From Truck Unload Point To 1st Hole									
Demob: From Last Hole To Truck Load Point									
Equipment Data				Mixing Mud					
Unit	Hour	Remarks		Hole Stabilizing					
Tractor				T. Driving					
Pump				Camp					
Truck				Repair & Maint.					
Mud Mixer				Travel		1	1		
				Other					
				Total Hours		10	10		

General Comments:

Material Used or Lost

Quantity	Items & Remarks	Approval

ENGINEER



*Bishop Res*

Contract Name *Toplay*  
 Date *Sept 12/83* Day \_\_\_\_\_  
 Well No. *83-8* Afternoon \_\_\_\_\_  
 Size *10 - 90°* Night \_\_\_\_\_

Job No. *Sil Cup*

Drill No.

Name

Name

Name

Name

*H. Brown*  
*A. Decker*

	From	To	Feet	Operation	Drill	Hrs	Hrs	Hrs	Hrs
Coring	<i>244</i>	<i>264</i>	<i>20</i>	Coring		<i>9</i>	<i>9</i>		
Overburden				Overburden					
Drill Cement				Cementing					
Ream Casing				Reaming Casing					Test Depths
				Testing					
Water Lines Distance		Ft. Lift	Ft.	Water Lines					
Moving: Under Equip. Show Tractor & Truck Hrs				Moving					
				Set Up/Tear Down					
				Supervision					
Mob. From Base To Truck Unload Point									
Demob: From Truck Load Point To Base									
Mob: From Truck Unload Point To 1st Hole									
Demob: From Last Hole To Truck Load Point									
Equipment Data				Mixing Mud					
Unit	Hour	Remarks		Hole Stabilizing					
Tractor				T. Driving					
Pump				Camp					
Truck				Repair & Maint.					
Mud Mixer				Travel		<i>1</i>	<i>1</i>		
				Other					
				Total Hours		<i>10</i>	<i>10</i>		

General Comments: *lost circulation.*

Material Used or Lost

Quantity	Items & Remarks	Approval

ENGINEER

Contract Name Bishop Res  
 Date Sept 13/83 Day ---  
 Well No. 83-8 Afternoon ---  
 Size NO -90° Night ---

Job No. S.L  
CUP

Drill No. ---  
 Name S. Brane  
 Name S. Cleker  
 Name ---  
 Name ---

	From	To	Feet	Operation	Drill	Hrs	Hrs	Hrs	Hrs
Coring				Coring					
Overburden				Overburden					
Drill Cement				Cementing		7	7		
Ream Casing				Reaming Casing					Test Depths
				Testing					
Water Lines Distance		Ft.Lift	Ft.	Water Lines					
Moving: Under Equip. Show Tractor & Truck Hrs.				Moving					
				Set Up/Tear Down					
				Supervision					
Mob. From Base To Truck Unload Point									
Demob: From Truck Load Point To Base									
Mob: From Truck Unload Point To 1st Hole									
Demob: From Last Hole To Truck Load Point									
Equipment Data				Mixing Mud					
Unit	Hour	Remarks		Hole Stabilizing					
Tractor				T. Driving					
Pump				Camp					
Truck				Repair & Maint.					
Mud Mixer				Travel		1	1		
				Other					
				Total Hours		8	8		

General Comments: \_\_\_\_\_  
 \_\_\_\_\_  
 \_\_\_\_\_

Material Used or Lost

Quantity	Items & Remarks	Approval
8	Bags Portland Cement	

ENGINEER

*Bishop Res*

Contract Name *Topley* Job No. *111*

Date *Sept 14/83* Day *Wed*

File No. *83-8* Afternoon *cup*

Size *100* *-90°* Night *---*

Drill No.

Name

Name

Name

Name

*K. Brunner*  
*D. Baker*

	From	To	Feet	Operation	Drill	Hrs	Hrs	Hrs	Hrs
Coring				Coring					
Overburden				Overburden					
Drill Cement	<i>130</i>	<i>264</i>	<i>134</i>	<del>Drill</del> Cementing		<i>5</i>	<i>5</i>		
Ream Casing				Reaming Casing					Test Depths
				Testing					
Water Lines Distance		Ft.	Lift Ft.	Water Lines					
Moving: Under Equip. Show Tractor & Truck Hrs.				Moving					
				Set Up/Tear Down					
				Supervision					
Mob. From Base To Truck Unload Point									
Demob: From Truck Load Point To Base									
Mob: From Truck Unload Point To 1st Hole									
Demob: From Last Hole To Truck Load Point									
Equipment Data				Mixing Mud					
Unit	Hour	Remarks		Hole Stabilizing					
Tractor				T. Driving					
Pump				Camp					
Truck				Repair & Maint.					
Mud Mixer				Travel		<i>1</i>	<i>1</i>		
				Other					
				Total Hours		<i>6</i>	<i>6</i>		

General Comments: \_\_\_\_\_

\_\_\_\_\_

\_\_\_\_\_

Material Used or Lost

Quantity	Items & Remarks	Approval



*Bishop Res*

Contract Name *Kopley* Job No. *Sil Cup*  
 Date *Sept 15/83* Day \_\_\_\_\_  
 Hole No. *83-8* Afternoon \_\_\_\_\_  
 Size *NO -90°* Night \_\_\_\_\_

Drill No.

Name

Name

Name

Name

*H. Branner*  
*S. Becker*

	From	To	Feet	Operation	Drill	Hrs	Hrs	Hrs	Hrs
Coring	<i>264</i>	<i>288</i>	<i>24</i>	Coring		<i>7</i>	<i>7</i>		
Overburden				Overburden					
Drill Cement				Cementing					
Ream Casing				Reaming Casing					Test Depths
				Testing					
Water Lines Distance		Ft.	Lift Ft.	Water Lines					
Moving: Under Equip. Show Tractor & Truck Hrs				Moving					
				Set Up/Tear Down					
				Supervision					
Mob. From Base To Truck Unload Point									
Demob: From Truck Load Point To Base									
Mob: From Truck Unload Point To 1st Hole									
Demob: From Last Hole To Truck Load Point									
Equipment Data				Mixing Mud					
Unit	Hour	Remarks		Hole Stabilizing					
Tractor				T. Driving					
Pump				Camp					
Truck				Repair & Maint.					
Mud Mixer				Travel		<i>1</i>	<i>1</i>		
				Other					
				Total Hours		<i>8</i>	<i>8</i>		

General Comments: \_\_\_\_\_

Material Used or Lost

Quantity	Items & Remarks	Approval

ENGINEER

*Bishop Res*

Contract Name *Topley* Job No. *Sil Cup*  
 Date *Sept 16/83* Day       
 Hole No. *83-8* Afternoon       
 Size *110 - 90°* Night     

Drill No.

Name *X. Branner*  
 Name *S. Becker*  
 Name  
 Name

	From	To	Feet	Operation	Drill	Hrs	Hrs	Hrs	Hrs
Coring	<i>288</i>	<i>402</i>	<i>114</i>	Coring		<i>9</i>	<i>9</i>		
Overburden				Overburden					
Drill Cement				Cementing					
Ream Casing				Reaming Casing					Test Depths
				Testing					
Water Lines Distance		Ft.Lift	Ft.	Water Lines					
Moving: Under Equip. Show Tractor & Truck Hrs				Moving					
				Set Up/Tear Down					
				Supervision					
Mob. From Base To Truck Unload Point									
Demob: From Truck Load Point To Base									
Mob: From Truck Unload Point To 1st Hole									
Demob: From Last Hole To Truck Load Point									
Equipment Data				Mixing Mud					
Unit	Hour	Remarks		Hole Stabilizing					
Tractor				T. Driving					
Pump				Camp					
Truck				Repair & Maint.					
Mud Mixer				Travel		<i>1</i>	<i>1</i>		
				Other					
				Total Hours		<i>10</i>	<i>10</i>		

General Comments: \_\_\_\_\_  
 \_\_\_\_\_  
 \_\_\_\_\_

Material Used or Lost

Quantity	Items & Remarks	Approval

ENGINEER

*Bishop Res.*

Contract Name *Topley* Job No. *511*  
 Date *Sept 19/83* Day       
 File No. *83-8* Afternoon       
 Size *100* *-90°* Night     

*511*  
*Cup*

Drill No.

Name *J. Brannen*  
Name *L. Decker*

	From	To	Feet	Operation	Drill	Hrs	Hrs	Hrs	Hrs
Coring	<i>402</i>	<i>443</i>	<i>41</i>	Coring		<i>9</i>	<i>9</i>		
Overburden				Overburden					
Drill Cement				Cementing					
Ream Casing				Reaming Casing					Test Depths
				Testing					
Water Lines Distance		Ft. Lift	Ft.	Water Lines					
Moving: Under Equip. Show Tractor & Truck Hrs.				Moving					
				Set Up/Tear Down					
				Supervision					
Mob. From Base To Truck Unload Point									
Demob: From Truck Load Point To Base									
Mob: From Truck Unload Point To 1st Hole									
Demob: From Last Hole To Truck Load Point									
Equipment Data				Mixing Mud					
Unit	Hour	Remarks		Hole Stabilizing					
Tractor				T. Driving					
Pump				Camp					
Truck				Repair & Maint.					
Mud Mixer				Travel		<i>1</i>	<i>1</i>		
				Other					
				Total Hours		<i>10</i>	<i>10</i>		

General Comments: \_\_\_\_\_

Material Used or Lost

Quantity	Items & Remarks	Approval

ENGINEER



Contract Name

*Bishop Res Topay.*

Job No.

*Sil Cup.*

Date *Sept 20/83* Day

ole No. Afternoon

Size Night

Drill No.

Name

Name

Name

Name

*A. Brume*  
*S. Acker*

	From	To	Feet	Operation	Drill	Hrs	Hrs	Hrs	Hrs
Coring	<i>443</i>	<i>460</i>	<i>17</i>	Coring		<i>9</i>	<i>9</i>		
Overburden				Overburden					
Drill Cement				Cementing					
Ream Casing				Reaming Casing					Test Depths
				Testing					
Water Lines Distance		Ft.	Lift Ft.	Water Lines					
Moving: Under Equip. Show Tractor & Truck Hrs.				Moving					
				Set Up/Tear Down					
				Supervision					
Mob. From Base To Truck Unload Point									
Demob: From Truck Load Point To Base									
Mob: From Truck Unload Point To 1st Hole									
Demob: From Last Hole To Truck Load Point									
Equipment Data				Mixing Mud					
Unit	Hour	Remarks		Hole Stabilizing					
Tractor				T. Driving					
Pump				Camp					
Truck				Repair & Maint.					
Mud Mixer				Travel		<i>1</i>	<i>1</i>		
				Other					
				Total Hours		<i>10</i>	<i>10</i>		

General Comments:

Material Used or Lost

Quantity	Items & Remarks	Approval

ENGINEER

*Bishop Res.*

Contract Name *Topley* Job No. *Sul Cup*  
 Date *Sept 21/83* Day       
 Hole No. *83-8* Afternoon       
 Size *NQ* *-90°* Night     

Drill No.

Name *H. Brannen*  
 Name *S. Acker*  
 Name  
 Name

	From	To	Feet	Operation	Drill	Hrs	Hrs	Hrs	Hrs
Coring	<i>460</i>	<i>574</i>	<i>114</i>	Coring		<i>11</i>	<i>11</i>		
Overburden				Overburden					
Drill Cement				Cementing					
Ream Casing				Reaming Casing					Test Depths
				Testing					
Water Lines Distance		Ft. Lift	Ft.	Water Lines					
Moving: Under Equip. Show Tractor & Truck Hrs.				Moving					
				Set Up/Tear Down					
				Supervision					
Mob. From Base To Truck Unload Point									
Demob: From Truck Load Point To Base									
Mob: From Truck Unload Point To 1st Hole									
Demob: From Last Hole To Truck Load Point									
Equipment Data				Mixing Mud					
Unit	Hour	Remarks		Hole Stabilizing					
Tractor				T. Driving					
Pump				Camp					
Truck				Repair & Maint.					
Mud Mixer				Travel		<i>1</i>	<i>1</i>		
				Other					
				Total Hours		<i>12</i>	<i>12</i>		

General Comments: \_\_\_\_\_  
 \_\_\_\_\_  
 \_\_\_\_\_

Material Used or Lost

Quantity	Items & Remarks	Approval

ENGINEER

*Bishop Res*

Contract Name Topley. Job No. Sil  
 Date Sept 22/83 Day —  
 Hole No. 83-8 Afternoon —  
 Size NO - 90° Night —

*Sil  
Cup.*

Drill No. —  
 Name K. Kramer  
 Name J. Carter  
 Name —  
 Name —

	From	To	Feet	Operation	Drill	Hrs	Hrs	Hrs	Hrs
Coring				Coring					
Overburden				Overburden					
Drill Cement	<u>480</u>	<u>574</u>	<u>96</u>	Cementing		<u>3</u>	<u>3</u>		
Ream Casing				Reaming <del>Casing</del>		<u>4</u>	<u>4</u>		Test Depths
				Testing					
Water Lines Distance		Ft.	Lift Ft.	Water Lines					
Moving: Under Equip. Show Tractor & Truck Hrs.				Moving					
				Set Up/Tear Down					
				Supervision					
Mob. From Base To Truck Unload Point									
Demob: From Truck Load Point To Base									
Mob: From Truck Unload Point To 1st Hole									
Demob: From Last Hole To Truck Load Point									
Equipment Data				Mixing Mud					
Unit	Hour	Remarks		Hole Stabilizing					
Tractor				T. Driving					
Pump				Camp					
Truck				Repair & Maint.					
Mud Mixer				Travel		<u>1</u>	<u>1</u>		
				Other					
				Total Hours		<u>8</u>	<u>8</u>		

General Comments: \_\_\_\_\_  
 \_\_\_\_\_  
 \_\_\_\_\_

Material Used or Lost

Quantity	Items & Remarks	Approval
<u>6</u>	<u>Bags Portland Cement.</u>	



Contract Name Bishop Res  
Topley  
 Date Sep 23/83 Day —  
 Well No. 83-8 Afternoon —  
 Size NQ 90° Night —

Job No. Sil Cup

Drill No.

Name A. Mamer

Name S. Acker

Name

Name

	From	To	Feet	Operation	Drill	Hrs	Hrs	Hrs	Hrs
Coring	574	614	40	Coring		7	7		
Overburden				Overburden					
Drill Cement				Cementing					
Ream Casing				Reaming Casing					Test Depths
				Testing					
Water Lines Distance		Ft. Lift	Ft.	Water Lines					
Moving: Under Equip. Show Tractor & Truck Hrs				Moving					
				Set Up/Tear Down					
				Supervision					
Mob. From Base To Truck Unload Point									
Demob: From Truck Load Point To Base									
Mob: From Truck Unload Point To 1st Hole									
Demob: From Last Hole To Truck Load Point									
Equipment Data				Mixing Mud					
Unit	Hour	Remarks		Hole Stabilizing					
Tractor				T. Driving					
Pump				Camp					
Truck				Repair & Maint.					
Mud Mixer				Travel		1	1		
				Other					
				Total Hours		8	8		

General Comments:

Material Used or Lost

Quantity	Items & Remarks	Approval

ENGINEER

*Bishop Res.*

Contract Name *Topley* Job No. *Sil Cup*  
 Date *Sept 25/83* Day       
 Hole No. *83-8* Afternoon       
 Size *110* - *90°* Night     

				Drill No.	Name	Name	Name	Name
From	To	Feet	Operation	Drill	Hrs	Hrs	Hrs	Hrs
			Coring					
			Overburden					
			Drill Cement					
			Ream Casing					Test Depths
			Testing					
			Water Lines Distance					
			Moving: Under Equip. Show Tractor & Truck Hrs					
			Set Up/Tear Down					
			Supervision					
			Mob. From Base To Truck Unload Point					
			Demob: From Truck Load Point To Base					
			Mob: From Truck Unload Point To 1st Hole					
			Demob: From Last Hole To Truck Load Point					
Equipment Data				Mixing Mud				
Unit	Hour	Remarks	Hole Stabilizing					
Tractor			T. Driving					
Pump			Camp					
Truck			Repair & Maint.					
Mud Mixer			Travel		4			
			Other					
			Total Hours		4			

General Comments: *TRAVEL FROM VANCOUVER TO SMITHERS*

Material Used or Lost		
Quantity	Items & Remarks	Approval

ENGINEER

*Bishop Res.*

Contract Name *Topley*

Job No. *Sid Cup*

Date *SEPT 26* Day *←*

Job No. *83-8* Afternoon     

Size: *NQ* - *90°* Night     

Drill No.       
 Name *HUMTALA*  
 Name *S. Acher*  
 Name       
 Name     

	From	To	Feet	Operation	Drill	Hrs	Hrs	Hrs	Hrs
Coring	<i>614</i>	<i>704</i>	<i>90'</i>	Coring		<i>11</i>	<i>11</i>		
Overburden				Overburden					
Drill Cement				Cementing					
Ream Casing				Reaming Casing					Test Depths
				Testing					
Water Lines Distance		Ft.Lift	Ft.	Water Lines					
Moving: Under Equip. Show Tractor & Truck Hrs.				Moving					
				Set Up/Tear Down					
				Supervision					
Mob. From Base To Truck Unload Point									
Demob: From Truck Load Point To Base									
Mob: From Truck Unload Point To 1st Hole									
Demob: From Last Hole To Truck Load Point									
Equipment Data				Mixing Mud					
Unit	Hour	Remarks		Hole Stabilizing					
Tractor				T. Driving					
Pump				Camp					
Truck				Repair & Maint.					
Mud Mixer				Travel		<i>1</i>	<i>1</i>		
				Other					
				Total Hours		<i>12</i>	<i>12</i>		

General Comments: *PULLED BOOS TO CHANGE BIT AT 634'*

Material Used or Lost

Quantity	Items & Remarks	Approval

*[Signature]*

ENGINEER





COST STATEMENT

TOPLEY PROPERTY DIAMOND DRILL HOLE 83-8

LABOUR (see shift reports, Appendix II)

K.F. BRANNER, (as per contract) 15 days, September 6, 1983 to September 23, 1983; 132 hrs. @ \$14.00/hr. driller and supervisor \$ 1,848.00

SPENCER ACKER, 15 days, September 6, 1983 to September 23, 1983, 132 hrs. @ \$11.30/hr. drill helper 1,491.60

DRILL SUPPLIES

As per invoices, Canadian Longyear, see Appendix III 310.57  
1,043.85  
1,754.80

FIELD SUPPLIES (see Appendix III)

Gas, vehicles, travel: Houston-Smithers-Topley property 1,184.97  
Drilling hand gloves 58.94  
Diesel fuel, cat 243.82  
Cement, hole seal 98.98  
136.37  
Clamp 28.83  
Diesel fuel, drill 254.41  
Cement mixer, hole seal, water return 500.00  
Miscellaneous 107.00  
Machine shop 112.23  
Finning, Cat 10.68

ASSAYS

As per invoices, Acme Analytical Laboratories Ltd. 11.50  
40.00  
252.00

TOTAL \$ 9,488.55

NOTE: This does not show caterpillar charges and other related expenses to the hole.

*C.H. Stanley*

*No used for  
in 1983*

No. 556

# THE TORONTO-DOMINION BANK

CURRENT  
ACCOUNT

560 WEST HASTINGS & SEYMOUR STS.  
VANCOUVER, B.C. V6B 1L6

September 2 1983

PAY TO THE ORDER OF KEVAN BRANNER \$ 600.00

**REGISTERED** **600 DOLS 00 CTS** DOLLARS

BISHOP RESOURCES DEVELOPMENT LTD.

*St Stanley Lorenda Bardell*

⑈ 8# 1941000004: 09000372966# ⑈0000060000⑈

No. 557

# THE TORONTO-DOMINION BANK

CURRENT  
ACCOUNT

560 WEST HASTINGS & SEYMOUR STS.  
VANCOUVER, B.C. V6B 1L6

September 2 1983

PAY TO THE ORDER OF KEVAN BRANNER \$ 600.00

**REGISTERED** **600 DOLS 00 CTS** DOLLARS

BISHOP RESOURCES DEVELOPMENT LTD.

*St Stanley Lorenda Bardell*

⑈ 8# 1941000004: 09000372966# ⑈0000060000⑈



No. 558

**THE TORONTO-DOMINION BANK** CURRENT ACCOUNT

560 WEST HASTINGS & SEYMOUR STS.  
VANCOUVER, B.C. V6B 1L6

September 2 1983

LEADER REGISTERED SEP 2 '83 3410

PAY TO THE ORDER OF KEVAN BRANNER

\$ 800.00

REGISTERED **800 DOLS 00 CTS** DOLLARS

BISHOP RESOURCES DEVELOPMENT LTD.

*Ch. Stanley Brenda Bardell*

8# 0901000004 09000372966# 0000080000#

No. 562

**THE TORONTO-DOMINION BANK** CURRENT ACCOUNT

560 WEST HASTINGS & SEYMOUR STS.  
VANCOUVER, B.C. V6B 1L6

September 16, 1983

2708-001-3038-783

PAY TO THE ORDER OF KEVAN BRANNER

\$ 600.00

SEP 13 REGISTERED

REGISTERED **600 DOLS 00 CTS** DOLLARS

BISHOP RESOURCES DEVELOPMENT LTD.

*Ch. Stanley Brenda Bardell*

8# 0901000004 09000372966# 0000060000#

No. 566

# THE TORONTO-DOMINION BANK

CURRENT ACCOUNT

560 WEST HASTINGS SEYMOUR STS.  
VANCOUVER, B.C. V6B 1G8

September 20, 19 83

PAY TO THE ORDER OF WEST HASTINGS SEYMOUR STS. SPENCER ACKER

REGISTERED 779 DOLS 00 CTS

\$ 779.00

DOLLARS

BISHOP RESOURCES DEVELOPMENT LTD.

*Ch. Stanley*  
*Lorena Bardele*

8# 1941000004 090000372966#

0000077900#

No. 581

# THE TORONTO-DOMINION BANK

CURRENT ACCOUNT

560 WEST HASTINGS SEYMOUR STS.  
VANCOUVER, B.C. V6B 1G8

October 4, 19 83

PAY TO THE ORDER OF WEST HASTINGS SEYMOUR STS. SPENCER ACKER

REGISTERED 1020 DOLS 95 CTS

\$ 1,020.95

DOLLARS

BISHOP RESOURCES DEVELOPMENT LTD.

*Ch. Stanley*  
*Lorena Bardele*

8# 1941000004 090000372966#

0000102095#

**DIAMOND DRILLING EQUIPMENT**

OFFICE & MANUFACTURING PLANT  
 BOX 330, NORTH BAY, ONT.  
 PIB 8H6 705-474-2800

BRANCH OF  
 BOX 1188  
 MONCTON, NEW BRUNSWICK  
 EIC 8L9 506-855-9100

6404 BLVD. DES GL. DE PRAIRIES  
 ST. LEONARD, QUEBEC  
 H1P 1A2 514-327-3311

721 ALDFORD AVE.  
 ANNACIS INDUSTRIAL EST.,  
 NEW WESTMINSTER, B.C.  
 V3M 3P5 604-524-2511

SHIP FROM  SHIPPED TO Bishop Resources Development Ltd. Hold For PickUp Smithers, B.C.  SOLD TO Bishop Resources Development Ltd. 305 - 1212 WEST Broadway Vancouver, B.C. V6H 1G6	F.O.B. Vancouver ORDER DATE MO. DAY YR. 09 02 83 SHIPPING ORDER NO. 1-8030 SHIPPING INSTRUCTIONS P.W.A. w/Bits SHIPPED VIA Pick Up DATE SHIPPED MO. DAY YR. 09 02 83 INVOICE NO. 6145261 CODE 6203 TERR. 062 ZONE 06 REFER TO FOR CORRESPONDENCE INVOICE DATE MO. DAY YR. 09 02 83 GROSS WEIGHT 8 kg. NET WEIGHT NO. OF PKGS. 1
---	---

CUSTOMER ORDER NO.	REQUISITION NO. Ron	FED. SALES TAX INCL. EXTRA EXEMPT. X	PROV. SALES TAX INCL. EXTRA EXEMPT. X	NO. OF INV. 1	TERMS N30D	MO. DAY YR.	DATE REQ'D.
--------------------	------------------------	--	---	---------------	------------	-------------	-------------

IT	QTY.	ORD.	DESCRIPTION	PART NO.	UNIT PRICE	BACK ORDER	QUANTITY SHIPPED	AMOUNT
1	6		NQ Corelifter	30488	10.35		6	62.10
2	1		NQ Stabilizer	44407	19.45		1	19.45
3	1		2 15/16" Tricone		208.70		1	208.70
								290.25
			Plus 7% P.S. Tax					20.32
								310.57

**INVOICE**

TERMS: NET 30 DAYS UNLESS OTHERWISE STATED. INTEREST AT 24% PER ANNUM CHARGED ON OVERDUE ACCOUNTS.



**DIAMOND PRODUCTS DIVISION**

OFFICE AND MANUFACTURING PLANT

BOX 330, NORTH BAY, ONT.  
P1B 8H8 705-474-2800

BRANCH OFFICE

P.O. BOX 1188  
MONCTON, NEW BRUNSWICK  
E1C 8P8 508-855-9190

8404 BLVD. DES GRAN.  
ST. LEONARD, QUEBEC  
H1P 1A2 514-327-3311

RAIRIES

721 ALDFORD AVE.  
ANNACIS INDUSTRIAL EST.,  
NEW WESTMINSTER, B.C.  
V3M 5P5 604-324-2511

SHIP FROM \_\_\_\_\_

SHIPPED TO \_\_\_\_\_

Bishop Resources Development Ltd.  
Hold For Pick Up  
Smithers, B.C.

SOLD TO \_\_\_\_\_

Bishop Resources Development Ltd.  
305 - 1212 West Broadway  
Vancouver, B.C.  
V6H 1G6

F.O.B.		ORDER DATE		SHIPPING ORDER NO.
Vancouver		MO	DAY	YR.
		08	22	83
PPD	COLL	PPD CH.	SHIPPING INSTRUCTIONS	
		X	P.W.A.	
SHIPPED VIA		DATE SHIPPED		INVOICE NO.
227- 01683080		MO	DAY	YR.
		08	22	83
				6311138
CODE	ZONE	SALES		REFER TO FOR CORRESPONDENCE
6203	062	06		
INVOICE DATE		GROSS WEIGHT		NET WEIGHT
MO	DAY	YR.		NO. OF PKGS.
08	22	83	4 kg.	1

CUSTOMER ORDER NO.	REQUISITION NO.	FED SALES TAX INCL.	EXTRA	EXEMPT	PROV SALES TAX INCL.	EXTRA	EXEMPT	NO OF INV.	TERMS	WAYBILL NO.
	Ron			X			X	1	N30D	

QUANTITY			BIT		DESCRIPTION	TOTAL CARATS	UNIT PRICE		AMOUNT
ORD	SHIPPED	BK/ORD	NUMBER	CODE			DIAMONDS	SETTING	
2	2			6460	NQ Imp. Core Bit Green (HM)		475.00	950.00	
					Plus 7% P.S. Tax			66.50	
								1016.50	
					Plus delivery to airport			9.35	
								1025.85	
					Plus prepaid air freight			18.00	
								1043.85	
2	2		09212 09213	6460	NQ Imp. Core Bit Green (HM)				

**CONDITIONS OF SALE** These diamond set pieces are sold on the understanding that we do not obligate ourselves to issue cash credit for diamonds recovered from these parts when they are returned for salvage cut-outs. Usable stones recovered and not required for replacement orders will be held in safe keeping for your account.

TERMS: NET 30 DAYS UNLESS OTHERWISE STATED. INTEREST AT 2% PER MONTH CHARGED ON OVERDUE ACCOUNTS.

**DIAMOND PRODUCTS DIVISION**

OFFICE MANUFACTURING PLANT

BRANCH OFF

BOX 330, NORTH BAY, ONT.  
P1B 8H6 705 - 474-2800

BOX 1188  
MONCTON, NEW BRUNSWICK  
E1C 8P9 506 - 858-9190

6404 BLVD. DES GRANGES PRAIRIES  
ST. LEONARD, QUEBEC  
H1P 1A2 514 - 327-3311

721 ALOPORD AVE.  
ANNACIS INDUSTRIAL EST.,  
NEW WESTMINSTER, B.C.  
V3M 5P8 604-524-2511

SHIP FROM

SHIPPED TO

SOLD TO

Bishop Resources Development Ltd.  
Hold For Pick Up  
Smithers, B.C.

Bishop Resources Development Ltd.  
305 - 1212 West Broadway  
Vancouver, B.C.  
V6H 1G6

F.O.B.			ORDER DATE			SHIPPING ORDER NO.		
Vancouver			MO	DAY	YR	2-7623		
PPD	COLL	PPD CH	SHIPPING INSTRUCTIONS					
X			P.W.A. w/Equipment					
SHIPPED VIA			DATE SHIPPED			INVOICE NO.		
Pick Up			MO	DAY	YR	6311153		
CODE	ZONE	SALES	REFER TO FOR CORRESPONDENCE					
6203	062	06						
INVOICE DATE			GROSS WEIGHT			NET WEIGHT		NO. OF PRGS.
MO	DAY	YR	8 kg.					1
09	02	83						

CUSTOMER ORDER NO.	REQUISITION NO.	FED SALES TAX INCL	EXTRA	EXEMPT	PROV. SALES TAX INCL	EXTRA	EXEMPT	NO. OF INV	TERMS	WAYBILL NO.
	Ron			X			X	1	N30D	

QTY	QUANTITY		BIT		DESCRIPTION	TOTAL CARATS	UNIT PRICE		AMOUNT
	SHIPPED	SK. QTY	NUMBER	CODE			DIAMONDS	SETTING	
1	1			1761	NW Imp. Casing Shoe, Lite Set		215.00	215.00	
3	3			6460	NQ Imp. Core Bit Green (HM)		475.00	1425.00	
					Plus 7% P.S. Tax			1640.00	
								114.80	
								1754.80	
1	1	04452	1761		NW Imp. Casing Shoe, Lite Set				
3	3	09220 09221 09222	6460 " "		NQ Imp. Core Bit Green (HM)				

**CONDITIONS OF SALE** These diamond set pieces are sold on the understanding that we do not obligate ourselves to issue cash credit for diamonds recovered from these parts when they are returned for salvage cut-outs. Usable stones recovered and not required for replacement orders will be held in safe keeping for your account.

TERMS: NET 30 DAYS UNLESS OTHERWISE STATED. INTEREST AT 2% PER MONTH CHARGED ON OVERDUE ACCOUNTS.

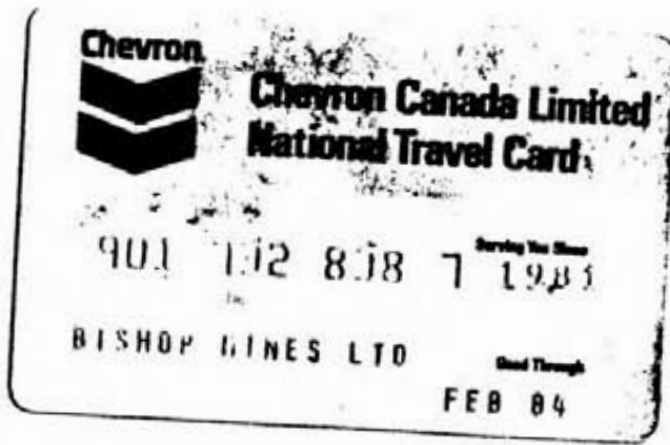

**Chevron** **Chevron Canada Limited**

KEEP THIS **PAID**

PAYMENTS OR CHARGES RECEIVED AFTER STATEMENT DATE WILL APPEAR NEXT MONTH

1109T4CR *Bookup*  
*01451.10*

901 288387 No. OCT 03 1983

145110 **125173**  
 Date TOTAL AMOUNT DUE

2902 275165

2% ANNUAL INTEREST RATE **24% PER ANNUM**

TERMS: ACCOUNTS ARE DUE IN FULL 15 DAYS FROM THIS STATEMENT DATE. PAST DUE AMOUNTS ARE SUBJECT TO A SERVICE CHARGE AT THE RATE SHOWN ABOVE, COMPOUNDED MONTHLY.

-66.26  
 \$1184.97

BISHOP RESOURCES FIELD EXPENSES  
AUGUST 1983

AUG.	1	R.C. TEL	LONG DIST. CALLS	132.93	✓
	1	PWA		19.00	
	2	KAL	TIRE	19.00	✓
	11	MINES	DEPT	8.00	✓
	19	"	"	555.00	✓
	21	PWA		19.00	
	19	Wayside Industrial Supply.		58.94	-
	22	Benzine Holdings		243.82	✗
	22	Houston Coop		28.83	-
	22	PWA		20.50	
	24	Houston Coop	10 cement	98.98	✗
	29	"	" " " Calcium	136.37	✗
	29	Greyhound Express		4.60	
	22	B.U. Farm Supply.		25.17	
	22	Apollo.		3.00	
	24	Acklands		72.55	-
	30	Joply. Garage		705.87	
				<hr/>	
				2151.96	
				<u>2</u>	

K. F. Branner



BISHOP RESOURCES FIELD EXPENSES  
 SEPT 1983

Sept 1 /83	B.C. Tel. Long D. calls.	169.13 ✓
3 /83	Seroopis	107.00
1 /83	Acklands	5.88
6 /83	Bodner Mach. Shop	112.22
6 /83	Tinning	10.68
9 /83	Benzine Holdings	254.41 *
8 /83	Retzma	10.93
10 /83	Acklands	7.53
12 /83	Joe Meyer. (Cement mixer.	500.00
13 /83	Houston Coop. (cement))	79.18
14 /83	Topley Garage	620.38 ✓
26 /83	Benzine Holdings	141.24 ✓
27 /83	Motorway.	154.00
29 /83	Merice River Lumber	23.32 ✓
29 /83	Benzine Holdings	301.32 ✓
30 /83	Decker Lake Forest Products.	116.82
		<hr/>
		2614.04
		<u>          </u>

K. J. Branner





# Benzine Holdings Ltd.

BOX 894, HOUSTON, B.C. V0J 1Z0 PHONE 845-2234

- \* Heatings Oils
- \* Greases
- \* Gasoline
- \* Lube Jobs
- \* Diesel Fuel

Name Bishop Mines

Address \_\_\_\_\_

Date Aug. 22 1983

PRODUCT	NUMBER	PACKAGE	QUAN.	PRICE	TAX	Price Plus Tax	AMOUNT
<u>DK MK</u>			<u>560</u>	<u>3970</u>	<u>0384</u>	<u>4354</u>	<u>243</u>
<u>Paid</u>							

Cash  
Cheque  
Total  
Received by

<u>243.82</u>

No 09464

ALL SALES ARE FINAL

Country Wide Printing - Houston

Sub Total	<u>243</u>
Barrel Deposit	
Federal Excise Tax @ _____	
P.S.T. _____ % of	
<b>TOTAL</b>	<u>243</u>

243.82









# Benzine Holdings Ltd.

BOX 894, HOUSTON, B.C. V0J 1Z0 PHONE 845-2234

- \* Heatings O
- \* Greases
- \* Gasoline
- \* Lube Jobs
- \* Diesel Fuel

Name Bishop Res.

Address \_\_\_\_\_

Date Sept 9 1983

PRODUCT	NUMBER	PACKAGE	QUAN.	PRICE	TAX	Price Plus Tax	AM-
<u>Unsa 8P-10-30</u>	<u>2</u>	<u>20</u>	<u>40</u>			<u>31.50</u>	<u>6-</u>
<u>Marfan AP</u>	<u>1</u>	<u>4</u>	<u>4</u>				<u>12</u>
<u>D/c MK -</u>	<u>1</u>		<u>400</u>				<u>170</u>
				<u>3970</u>	<u>0.84</u>	<u>4354</u>	

Cash  
Cheque  
Total  
Received by

<u>254.41</u>

No 09689

ALL SALES ARE FINAL

Country Wide Printing - Houston

Sub Total

Barrel Deposit

Federal Excise Tax @ \_\_\_\_\_

P.S.T. 7 % of \_\_\_\_\_

TOTAL

254

254.41

No. <u>133</u>	<u>12 SEPT</u>	<u>1983</u>
Received from <u>BISHOP RESOURCES</u>		
<u>FIVE HUNDRED</u> _____ <u>100</u> Dollars		
for <u>cement mixer</u>		
<u>\$ 500.00</u>	MADE IN B.C.	<u>Kay Loughton</u> (for Joe Meyer)

Scroggs Secondhand  
Store

Date Sept 3 1983

M. Bishop Resources

SOLD BY	C.O.D.	CHARGE	ON ACCT.	ACCT. NO.
1		<u>Grease Pump</u>		<u>55 00</u>
2		<u>Pipe Wipe</u>		<u>20 00</u>
3		<u>Tax</u>		<u>5 25</u>
4				
5				<u>80 25</u>
6				
7		<u>Paid</u>		
8				
9				
10		<u>Lamps</u>		<u>25 00</u>
11				<u>1 75</u>
12				<u>26 75</u>
13				
14				<u>107 00</u>
15				<u>70</u>

26

GEORGE L. BROWN





*Kend*

*Paid - Cash -  
Amount - 10.68  
Date - 09-06-83  
R. Dineile*

SHIPPING DEPARTMENT - NUMBER OF PIECES

CODE	DESCRIPTION	AMOUNT
	CARTAGE	
524.10	AIR FREIGHT OR EXPRESS	
528.00	PREPAID FREIGHT	
528.20	INTER BRANCH FREIGHT	

PARTS SALES ORDER  
PACKING SLIP

# FINNING TRACTOR & EQUIPMENT COMPANY LIMITED

HEAD OFFICE: 555 GREAT NORTHERN WAY, VANCOUVER, B.C. V5T 1E2



SHIP TO:  
BISHOP RESOURCES  
HOUSTON BC

BR INVOICE NO.	1 1 87032	CUSTOMER ORDER NUMBER	32 100380
FED. EXEMPT NO.		DATE	09 090683
MAKE	CAT DBH	SHIP VIA	TT CALL.

ITEM	ORDERED	SHIPPED	Y	CREDIT	BACK ORDER	UNIT WEIGHT	LOCATION	QTY	PART NUMBER	DESCRIPTION	UNIT PRICE	TOTAL
1	2	2	✓				0.0R04F04B	1	CF6L1651	SEAL	9.98	9.98

**PAID**

TOTAL WEIGHT: 0.0

9.98 .70 10.68

*R. Dineile*

LEGEND  
"F" INDICATES FEDERAL SALES TAX IS INCLUDED  
"P" INDICATES ITEM IS SUBJECT TO PROVINCIAL TAX

INVOICES ARE PAYABLE BY THE 20TH OF THE MONTH FOLLOWING. A SERVICE CHARGE OF 1% PER ANNUM WILL BE CHARGED ON ALL OVERDUE AMOUNTS. MAKE CHECKS PAYABLE AT PAR VANCOUVER, B.C.  
A MINIMUM HANDLING CHARGE OF 10% WILL BE LEVIED ON ANY PARTS RETURNED AND ACCEPTED FOR CREDIT. NOT ALL PARTS PURCHASED ARE RETURNABLE.

# ACME ANALYTICAL LABORATORIES LTD.

PHONE: 253-3158

851 1st Hastings St., Vancouver, B.C. V 6 1R6

## STATEMENT

Date: Sept. 30, 1983

Bishop Res. Dev. Ltd.,  
305 - 1212 W. Broadway  
Vancouver, B.C.  
V6H 1G6

**TERMS:**  
NET TWO WEEKS  
2% PER MONTH CHARGED ON  
OVERDUE ACCOUNTS

DATE	REFERENCE FILE NUMBER	DEBIT	CREDIT	BALANCE
Aug. 31, 1983	Balance Forward	\$291.00		
Sept. 2, 1983	File # 83-1892 A	134.90		
Sept. 1, 1983	File # 83-1892 B	273.00		
Sept. 8, 1983	File # 83-2002	220.50		
Sept. 29, 1983	File # 83-2320	11.50	—	
Sept. 29, 1983	File # 83-2321	40.00	—	
Sept. 30, 1983	File # 83-2319	71.00		
Sept. 30, 1983	File # 83-2343	16.00		
Sept. 30, 1983	File # 83-2318	252.00	—	
	Total Balance			\$1309.90

**PAID**

*Bishop*

Cheque No. 599

Date Oct 21/83

PLEASE PAY LAST AMOUNT