



exploration ltd.

GEOLOGY • GEOPHYSICS
MINING ENGINEERING

83-#932-11854
12/84

Suite 214-850 WEST HASTINGS STREET, VANCOUVER, B.C.
TELEPHONE (604) 681-0191 V6C 1E1

1983 DRILLING REPORT

on the

VIDETTE LAKE PROPERTY

(CLINTON CLAIMS)

Clinton Mining Division

Lat. $51^{\circ} 09' N$

Long. $120^{\circ} 54' W$

N.T.S. 92P/2W

for

LAKWOOD MINING COMPANY LIMITED

and

GREEN VALLEY MINE INC.

and

MENIKA MINING CO. **GEOLOGICAL BRANCH**
ASSESSMENT REPORT

by

Donald G. Allen, (P. Eng. (B.C.))

11,854

February 14, 1984

Vancouver, B. C.

TABLE OF CONTENTS

INTRODUCTION	1
LOCATION AND ACCESS	2
CLAIMS	2
GEOLOGY	3
DRILLING RESULTS	3
CONCLUSION	4
RECOMMENDATION	4
BIBLIOGRAPHY	
CERTIFICATE	

ILLUSTRATIONS

Figure 1	Location Map	1:10,000,000	After p. 4
Figure 2	Access Map	1:250,000	After p. 4
Figure 3	Claim Map	1:50,000	After p. 4
Figure 4	Compilation Map	1:1,000	In pocket

APPENDICES

Appendix I	Summary Drill Logs
Appendix II	Analytical Results
Appendix III	Affidavit of Expenses

INTRODUCTION

In October, 1983, Lakewood Mining Co. Ltd., Green Valley Mine Inc. and Menika Mining Ltd. carried out a program of access road construction and preliminary diamond drilling on their Vidette Lake gold property (Clinton claims). Four holes totalling 468 metres (1,535 feet) were completed. The drilling was designed to carry out preliminary evaluation of a gold-copper geochemical anomaly in soil and a coincident induced polarization anomaly over an area of 700 by 150 metres. The drill core was examined by the writer and selected intervals sampled and analyzed for gold and copper. This brief report summarizes results of this work.

LOCATION AND ACCESS

The Clinton claims are located in south-central British Columbia, 65 kilometres northwest of Kamloops, and 48 kilometres north of Savona (Figures 1 and 2). The claims lie on the west side of Vidette Lake between elevations 2,800 and 3,500 feet. Topography on the plateau surface is gentle except where cut through by the Vidette Lake-Deadman River valley. Valley slopes range from moderately steep to vertical along the edge of the plateau basalts. Access is by good gravel road to Vidette Lake (and thence by boat to the Clinton claims) or by bulldozer road constructed from the Mowich Lake-Brigade Lake access road.

CLAIMS

The Vidette Lake property comprises 96 claim units as follows:

<u>Claim Name</u>	<u>Record No.</u>	<u>No. of Units</u>	<u>Expiry Date*</u>
CLINTON 1-3	1182-4	12	Jan. 13, 1988
VITO	1243	6	Sept. 20, 1988
ESTER 1-3	1244-6	3	Sept. 20, 1988
DEADMAN LAKE	1285	9	Nov. 1985
NORKAM 1-4	1174-6	66	Dec. 21, 1987

Claim boundaries are shown on Figure 3.

* After applying work represented by this report.

GEOLOGY

The geology of the Clinton claims was summarized by Allen (1982). The Clinton claims are underlain by Upper Triassic Nicola Group volcanic rocks which are covered to the west and east by Miocene Plateau basalts. The Nicola Group is intruded to the north by granodiorite of the Thuya batholith and locally by dikes of feldspar porphyry of diorite to monzonite composition. Anomalous copper and gold values occur in fractured, pyritized and propylitized Nicola Group.

DRILLING RESULTS

A total of 468 metres in four holes was carried out on the Clinton 1 claim. Drill sites are plotted on a compilation map taken from the 1982 report (Figure 7). See Appendix I for drill logs.

All drill holes intersected volcanic flows and breccias of the Nicola Group. A few narrow felsite and porphyritic monzonite dikes were also encountered. All rocks are moderately to intensely propylitized and pyritized. Geochemical analyses of selected samples and intervals indicate anomalous gold values ranging up to 1520 parts per billion (0.048 ounces per ton) and copper values of up to 1200 parts per million (0.12%) throughout (Appendix II). Best values were obtained in the upper parts of drill holes 2 and 2B in strongly

fractured andesite containing moderate to abundant amounts of epidote and pyrite both disseminated and on fractures.

CONCLUSION

Additional diamond drilling is warranted on the Vidette property for the following reasons:

- (1) Anomalous gold and copper values are found on surface and in drill core.
- (2) The Nicola Group volcanic rocks are important hosts for gold-rich porphyry copper deposits such as the Afton Mine and Dome Mines' QR deposit (950,000 tons grading 0.21 ounces per ton gold) near Quesnel.
- (3) The property lies only 1.4 kilometres south of the Vidette Lake gold mine (past production 30,000 ounces).

RECOMMENDATION

Further diamond drilling is warranted as outlined in the February, 1983 report by the writer. All drill core from holes 1 to 4 should be split and analyzed. In addition, further detailed geological mapping should be undertaken in and around the immediate area of interest to help define the geologic setting and fully delineate the area of interest.



Donald G. Allen,
P. Eng. (B. C.)

LAKWOOD MINING CO. LTD.
GREEN VALLEY MINE INCORPORATED
VIDETTE LAKE PROPERTY
LOCATION MAP

SCALE 200 0 200 KILOMETRES
00 0 100 MILES

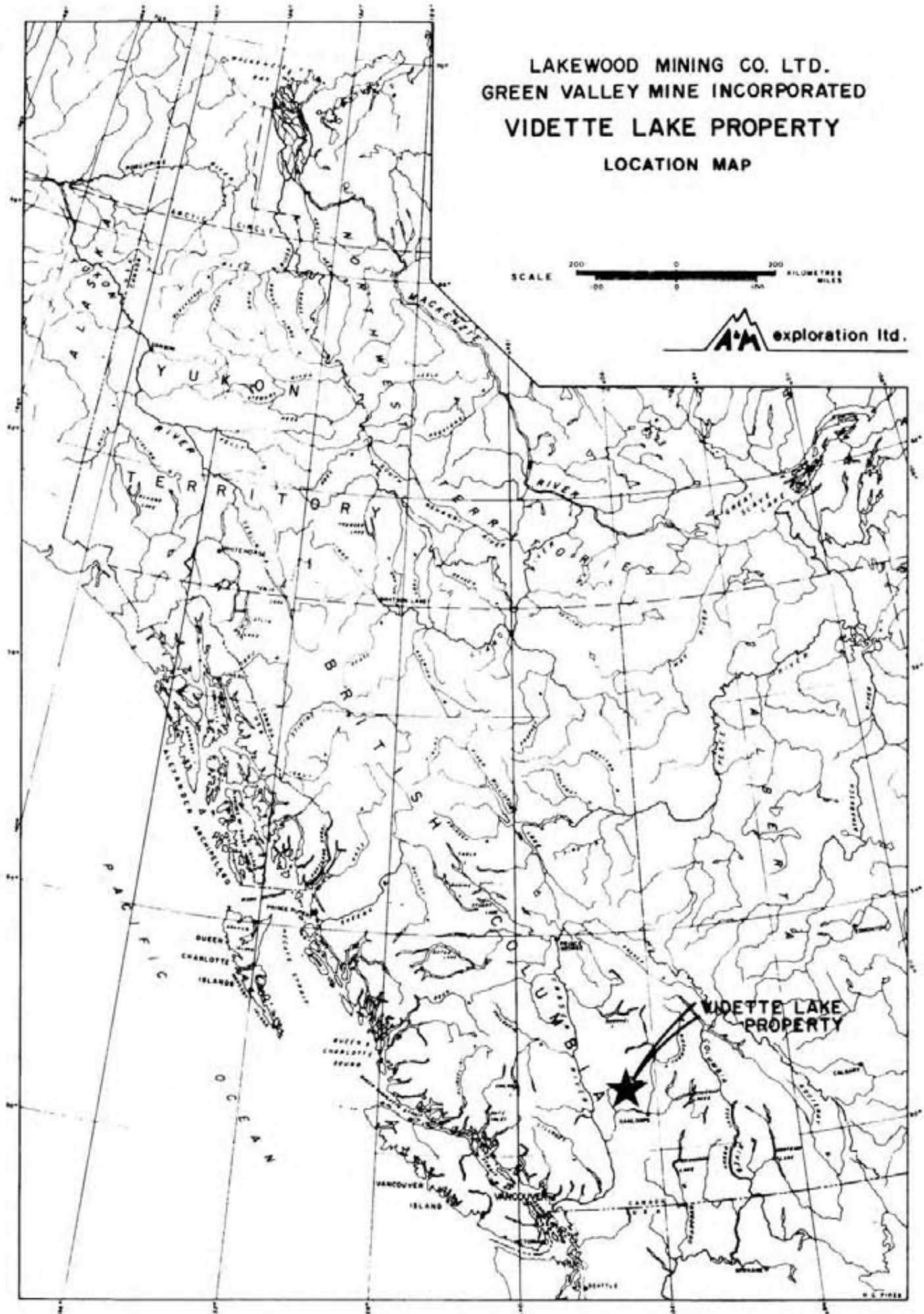
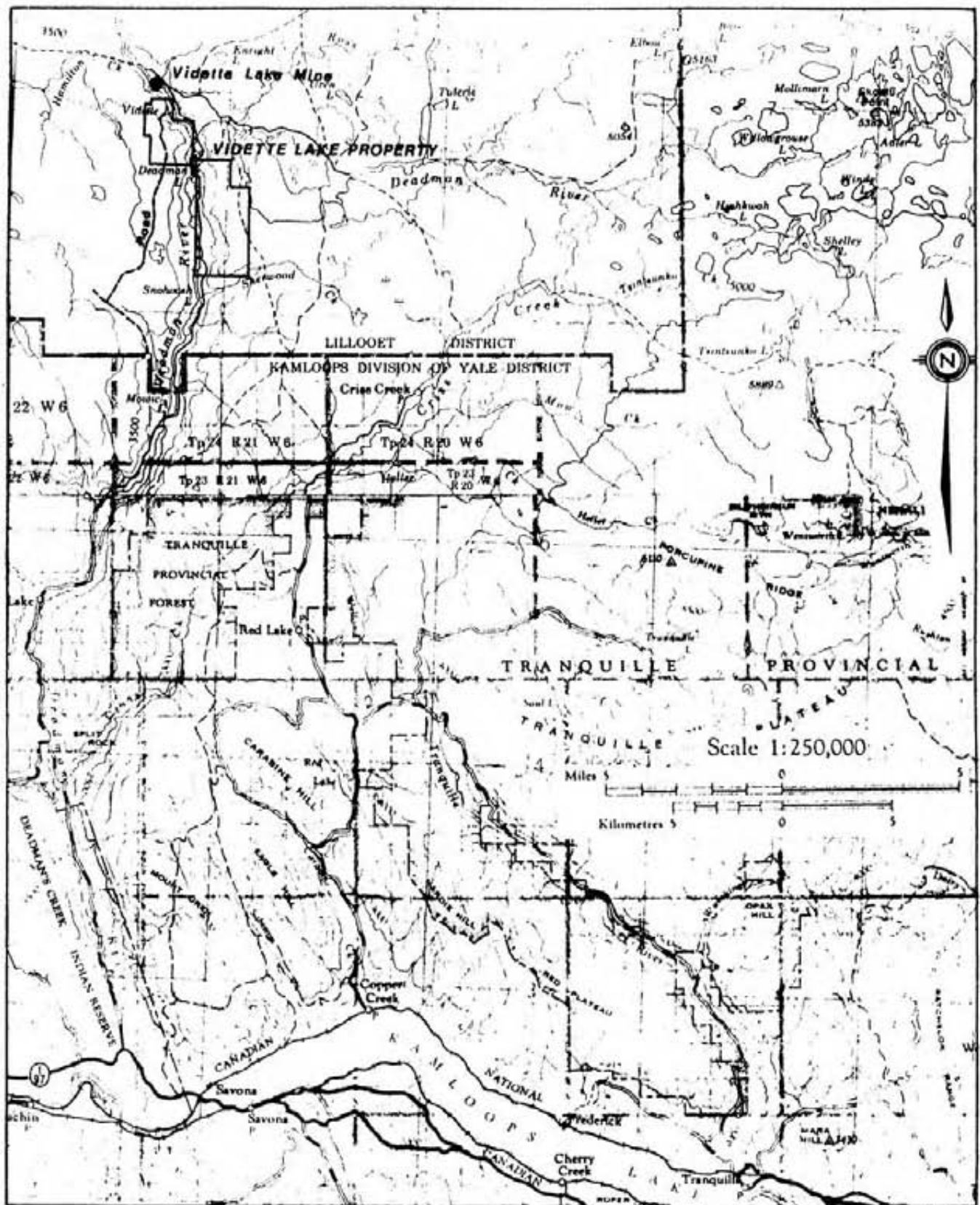

FIGURE - 1



LAKWOOD MINING COMPANY LIMITED

N.T.S. 92P

ACCESS MAP

VIDETTE LAKE PROPERTY

Clinton Mining Division - British Columbia

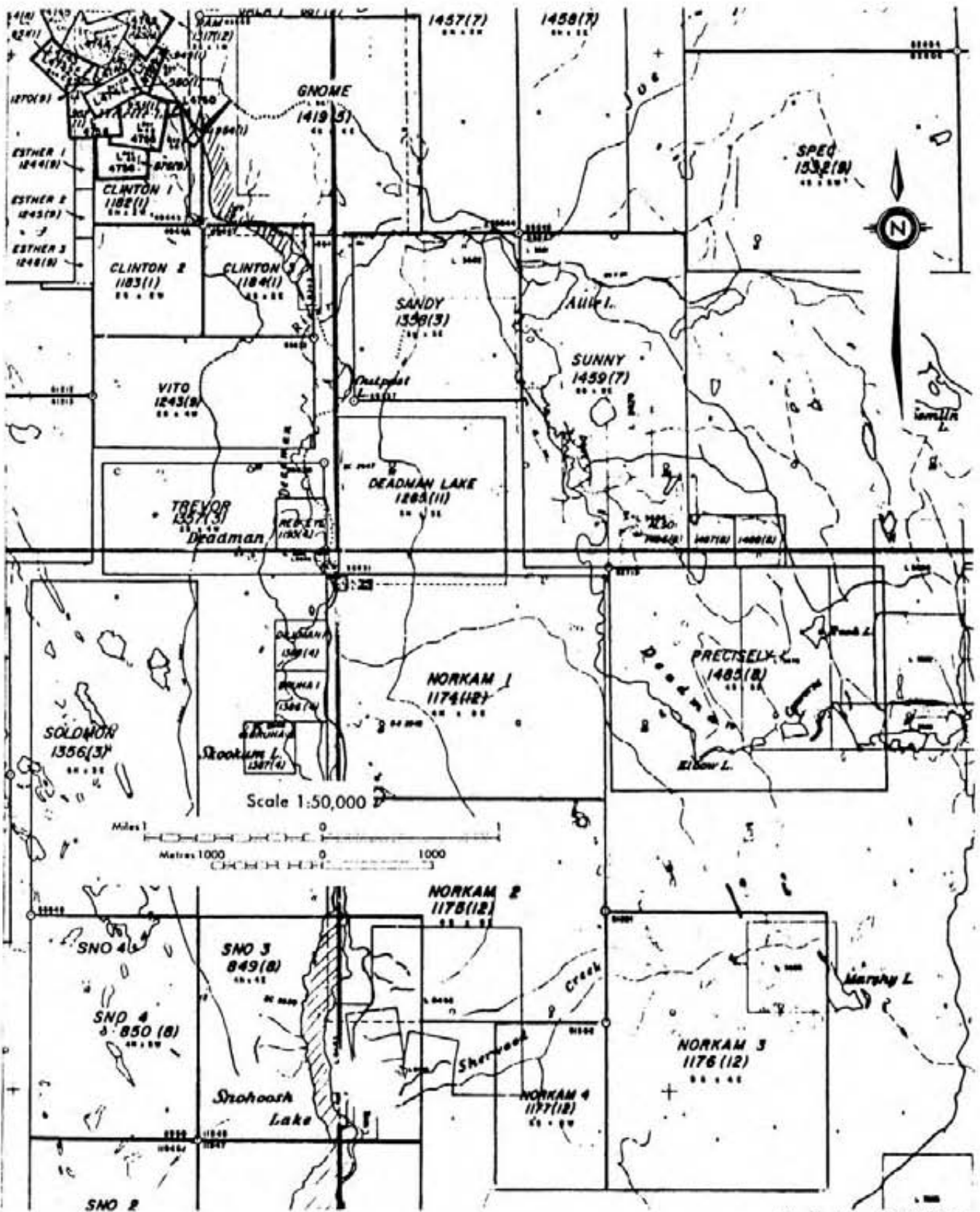

LAKWOOD MINING COMPANY LIMITED

N.T.S. 92P/2W

CLAIM MAP

VIDETTE LAKE PROPERTY

Clinton Mining Division - British Columbia

Donald S. Allen
A.M. exploration Ltd.

Figure 3

BIBLIOGRAPHY

- Allen, D. G. and MacQuarrie, D. R. (1982). Summary Report on the Induced Polarization, Geological and Geochemical Surveys, Clinton Claims. Private Report for Lakewood Mining Company Limited and Green Valley Mine Inc.
- Allen, D. G. (1983). 1982 Exploration Report on the Vidette Lake Property. Private Report for Lakewood Mining Company Limited, Green Valley Mine Inc., and Menika Mining Ltd.
- Campbell, R. and Tipper, H. W. (1971). Geology of Bonaparte Lake Map Area, B. C. Geol. Surv. Can. Memoir 363.
- Cockfield, W. E. (1935). Lode Gold Deposits of Fariview Camp, Camp McKinney, and Vidette Lake Area and the Dividend-Lakeview Property near Osoyoos, B. C. Geol. Surv. Can. Memoir 179, pp. 26-34.
- Dawson, J. M. (1973). Geochemical Report on the Vidette Lake Property, B. C. Private Report for Keda Resources Ltd.
- Mitchell, J. A. (1939). Min. Mines Ann. Rept., pp. 41, 42, 74.
- Mitchell, J. A. (1940). Min. Mines Ann. Rept., pp. 27, 60.
- Mitchell, J. A. (1973). The Vidette Gold Mine. Private Report for Glen Copper Mines Ltd.
- Pezzot, E. T. and White, G. E. (1981). Geophysical Report on The Sno Claims. Private Report for Newhawk Gold Mines Ltd.
- Stevenson, J. S. (1936). Vidette Lake Area in Min. of Mines Ann. Rept., pp. 36-43.

CERTIFICATE

I, Donald G. Allen, certify that:

1. I am a Consulting Geological Engineer, resident at 4570 Hoskins Road, North Vancouver, British Columbia.
2. I am a graduate of the University of British Columbia with degrees in Geological Engineering (B.A.Sc., 1964; M.A.Sc., 1966).
3. I have been practising my profession since 1964.
4. I am a member in good standing of the Association of Professional Engineers of British Columbia.
5. The geological data presented in this report is based on my examination of selected core samples supplied by C. Boitard and also on visits to the property on July 31 and November 28, 1982.
6. I hold no interest at this time in Lakewood Mining Company Limited or Menika Mining Ltd. However, A & M Exploration Ltd. holds a small share position in Green Valley Mine Inc.
7. I consent to the use of this report in a Statement of Material Facts or in a Prospectus for the purpose of raising funds for the project covered by this report.

Vancouver, B. C.
February 14, 1984

Donald G. Allen,
P. Eng. (B. C.)

APPENDIX I
SUMMARY DRILL LOGS

83 12 15

A.M. exploration ltd.

COLLAR COORDINATES: ELEVATION: CORE SIZE: BØ HOLE NO: VØ3-1
 N BEARING: 248° F.C. PROJECT: CLINTON CLAIMS
 E INCLINATION: -45° LOGGED BY: D. ALLEN LOCATION: VIOLETTE 15. (CLINTON)
 STARTED OCT 17, 1983 SCALE: SHEET: 1 of 2
 COMPLETED OCT 25, 1983 TOTAL DEPTH: 526' (160.3m)

SECTION

COORDINATES: 16m WEST OF L3W, @ 40N

EST. %

ALT'N.

FRACTURING

MINERALOGY
GEOLOGY

COMMENTS

DESCRIPTIVE GEOLOGY

INTERVAL

ASSAYS

0 - 22': INTENSELY BROKEN + OXIDIZED.
 22' - 70': EPIDOTIZED AUGITE ANDESITE - ABUNDANT EPIDOTE IN STREAKS. - IRREG VEINLETS AND AS DISSEMINATED CLOTS. ABUNDANT DISSEM. PYRITE. CALCITE + CHLORITE ON FRACTURES.
 70' - 140': GREEN VOLCANIC BRECCIA. ABUNDANT PY + EPIDOTE AS ABOVE.
 115' - 140' - STRONG EPIDOTE, CALCITE VEINING. 152' - 162' - PINKISH GREY FELSITE DYKE. - 5cm FAULT GOUGE @ 055° @ CONTACT @ 152'
 140' - 390': MORE HOMOGENEOUS ANDESITE. - EPIDOTE + PY AS ABOVE. WEAK/MOD. PYRITE. 240' - 246' - DACITE DYKE - FRACTURES @ CALCITE VEINING @ CONTACTS. 262' - 20cm FAULT GOUGES.
 300' - 302' - PERVASIVE CALCITE + EPIDOTE - MINOR GARNET @ 301'
 328 - 330' - FAULT GOUGED 351' - 352' - EPIDOTE - CEMENTED BRECCIA, DISSEMINATED PYRITE.
 390' - 405': GREEN PORPHYRITIC DIORITE, ABUNDANT WHITE FELDSPAR PHENOCRYSTS. 1-2mm IN DIAMETER IN GREENISH GREY FINE GR. GROUNDMASS. EPIDOTE MOD TO ABUNDANT, DISSEMINATED THROUGHOUT GROUNDMASS. WEAK DISSEMINATED PYRITE, CALCITE COATED FRACTURES COMMON.
 405' - 408': GREEN PORPHYRITIC MONZONITE. ABUNDANT 1-3mm PLAGIOCLASE PHENOCRYSTS IN FINE GR. GREENISH GREY GROUNDMASS.
 408' - 490': GREENSTONE - INTENSELY EPIDOTIZED @ ABUNDANT PYRITE, DISSEMINATED AND ON FRACTURES @ CALCITE. AUGITE PHENOCRYSTS

03 12 15

A.M exploration ltd.

COLLAR COORDINATES: ELEVATION: _____ HOLE NO: V 83-1
 N E BEARING: 248° F.C. PROJECT: CLINTON CLAIMS
 STARTED OCT 17, 1983 INCLINATION: -45° LOCATION: VIDETTE LA (CLINTON)
 COMPLETED OCT 25, 1983 TOTAL DEPTH: 526' (160.3m) SHEET: 2 of 2

SECTION

COORDINATES: 18 M WEST OF L 3W, @ 40N

EST. %

ALT 'N.

FRACTURING

MINERALOGY

GEOLOGY

COMMENTS

DESCRIPTIVE GEOLOGY

400' - 490': CONT. COMMON + LOCALLY ABUNDANT FRACTURES COATED w/ CALCITE, CHLORITE + MINOR REDDISH HEMATITE.

402' - 405' - 7cm, 2-3cm CALCITE, MAGNETITE, PYRITE VEINLETS

490' - 510': FINE GRAIN MASSIVE LIGHT GREEN TO GREEN DACITE? - POSSIBLY A DYKE. 492' - 495' SHEARED @ 0-10° TO CORE AXIS - CALCITE + CHLORITE IN FRACTURES, WEAK PYRITE.

510' - 526': DARKER GREEN ANDESITE - ABUNDANT DISSEMINATED PYRITE, MODERATELY EPIDOTIZED. CALCITE, CHLORITE HEMATITE ON FRACTURES.

526' END OF HOLE.

INTERVAL

ASSAYS

631215

COLLAR COORDINATES: N <u>E</u> STARTED <u>OCT 17 / 83</u> COMPLETED <u>OCT 25 / 83</u>		ELEVATION: <u>270° F.C.</u> BEARING: <u>-70°</u> INCLINATION: TOTAL DEPTH: <u>153' (46.6m)</u>	CORE SIZE: <u>60</u> LOGGED BY: <u>D. ALLEN</u> SCALE:	HOLE NO: <u>V03-2</u> PROJECT: <u>CHINTON Ck Arms</u> LOCATION: <u>VIDETTE LK, CLINTON</u> SHEET: <u>7</u> of <u>1</u>	SECTION EST. % ALT 'N. FRACTURING MINERALOGY GEOLOGY	COMMENTS DESCRIPTIVE GEOLOGY <p>0' - 9' OVERBURDEN</p> <p>9' - 117': GREENISH GREY ANDESITE - MASSIVE + WEAK MOTTLED TEXT. PORPHYRITIC TEXTURE LOCALLY. WEAK IRREG. EPIDOTE LOCALLY MODERATELY ABUNDANT.</p> <p>117' - 153': 118.7' - 145' - GREEN VOLCANIC BRECCIA - LOCAL PREDOMINANT FRAGMENTAL TEXTURE. STRONGLY FRACTURED, CEMENTED WITH CALCITE + MINOR QTZ. ABUNDANT DISSEMINATED PYRITE</p> <p>136' - 146' - MODERATELY BLEACHED. 145' - 153' - FAULT GOUGE + SAND GOUGE @ ~035°-045° TO CORE AXIS @ 146'</p> <p>153': HOLE LOST - END OF HOLE.</p>	INTERVAL ASSAYS
---	--	---	--	---	---	---	--------------------

COORDINATES: 20M WEST OF L W, @ 2005

831215

COLLAR COORDINATES:		ELEVATION:	CORE SIZE:	HOLE NO:	SECTION	
N	E	BEARING:	LOGGED BY:	PROJECT:	EST. %	ALT 'N.
STARTED	COMPLETED	INCLINATION:	SCALE:	LOCATION:	FRACTURING	MINERALOGY
		TOTAL DEPTH:		SHEET:	GEOLOGY	
COMMENTS						
DESCRIPTIVE GEOLOGY						
INTERVAL						
ASSAYS						
		2850 F.C.	80	V 83 - 2b		
		-65°	P. ALLEN	CLINTON CLAMS		
		496' (151.2m)		VIBETTE LK. CLINTON		
		25, 83		1 of 2		
COORDINATES & 20M WEST OF L1W, @ 2005						
0' - 10' OVERBURDEN						
10' - 134' MOTTLED GREEN VOLCANIC BRECCIA - STRONGLY EPIDOTIZED LOCALLY. EPIDOTE IN IRREGULAR VEINS + VEINLETS w/ PYRITE. ABUNDANT PYRITE - AS DISSEMINATIONS, CLOTS AND BLEBS. A FEW STREAKS OF PINK ORTHOCLASE - SECONDARY? AS RIMMING SOME FRAGMENTS.						
78' - 145' - CALCITE + GOUGE COATED FRACTURES + SLIP PLANES LOCALLY ABUNDANT.						
88', 93' - QTZ. PYRITE VEINLETS @ ~45°						
111' - 112' FAULT GOUGE @ ~35°						
134' - 160' LIGHT GREY DACITE DYKE, MINOR DISSEMINATED PY, MAGNETITE, Tr CR.						
160' - 177' LIGHT GREEN VOLCANIC BRECCIA. - WEAK - MODERATE EPIDOTE AS SCATTERED CLOTS + EPIDOTE RICH ZONES. ABUNDANT PYRITE DISSEMINATION AND ON CHLORITE - CALCITE COATED FRACTURES.						
177' - 312' GOUGE + CHLORITE-COATED FRACTURE + SHEARS @ LOW ANGLE TO CORE AXIS						
208' - 5CM FAULT GOUGE @ ~035°.						
177' - 312' - INTENSELY FRACTURED GREENSTONE w/ ABUNDANT PYRITE - DISSEMINATION AND ON FRACTURES. CHLORITE ABUNDANT ON FRACTURES + PERVASIVE. IRREG DISSEMINATION CLOTS OF						

B3 12/15

A.M. exploration ltd.

COLLAR COORDINATES: ELEVATION: _____ CORE SIZE: 80 HOLE NO: V B3-3
 N E BEARING: 180° FC LOGGED BY: P ALLEN PROJECT: CLINTON CLAIMS
 STARTED OCT 18 / 83 INCLINATION: -70° SCALE: _____ LOCATION: VIOLETTE LK. (CLINTON)
 COMPLETED OCT 25 / 83 TOTAL DEPTH: 360' (102.7m) SHEET: 1 of 1

SECTION

COORDINATES: L 1 W 9 245 N

EST. %

ALT 'N.

FRACTURING

MINERALOGY

GEOLOGY

COMMENTS

DESCRIPTIVE GEOLOGY

INTERVAL

ASSAYS

0' - 201': NOT LOGGED.

201' - 211': GREENISH GREY ANDESITE - SCATTERED 1mm FELDSPAR AND AUGITE PHENOCRYSTS. CALCITE ON FRACTURES. MINOR DISSEMINATED PYRITE.

211' - 360': MOTTLED GREEN ANDESITE - STRONGLY EPIDOTIZED, ABUNDANT PYRITE - DISSEMINATED + MINOR AMOUNTS IN FRACTURES. CALCITE VEINLETS. + COATED FRACTURES ARE COMMON.

233' - 250' - HOMOGENEOUS TEXTURE - ANDESITE AS IN 201-211. CHLORITE + MINOR REDDISH HEMATITE ON FRACTURES.

311' - 315' - CALCITE HEMATITE VEINING + COATING SLIP PLANES @ 10-45°. SCATTERED EPIDOTE - CEMENTED BRECCIA ZONES

0.5 - 10 cm WIDE - SOME ZONES CONTAIN MONZONITE? FRAGMENTS

342' - 343' - FELDSPATHIC DYKE (TRACHYTE?). RARE QTZ, QTZ CALCITE VEINS.

354' - 355' EPIDOTE CEMENTED BRECCIA.

360': END OF HOLE.

APPENDIX II
ANALYTICAL RESULTS

Kossbacher Laboratory Ltd.

GEOCHEMICAL ANALYSTS & ASSAYERS

BURNABY, B. C.
CANADA
TELEPHONE: 299-8910

Job # 203
VIOLETTE LAB #

CERTIFICATE OF ANALYSIS

CERTIFICATE NO. 83498-1

INVOICE NO.

DATE ANALYSED 83/10/20

PROJECT CLINTON

TO: LAKEWOOD MINING CO LTD.
2245 W. 13th Ave.
Vancouver, B.C.

DDH # 83-1

No.	Sample	pH	Mo	Cu	Ag	PPB Au					No.
01	DDH 1 - 59'			128	0.4	60					01
02	73'			288	0.6	10					02
03	126'			192		100					03
04	256'			122		10					04
05	345'			258		10					05
06	DDH 1 - 387'			138		10					06
07	397'			28		10					07
08	436'			202		20					08
09	450'-460'			208		30					09
10	473'			640		10					10
11	500'			162		10					11
12	DDH 1 - 526'			162		10					12
13											13
14											14
15											15
16											16
17											17
18											18
19											19
20											20
21											21
22											22
23											23
24											24
25											25
26											26
27											27
28											28
29											29
30											30
31											31
32											32
33											33
34											34
35											35
36											36
37											37
38											38
39											39
40											40

VALUES IN PPM, UNLESS NOTED OTHERWISE.

Certified by

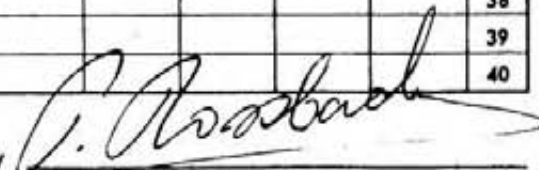

Kossbacher Laboratory Ltd.

GEOCHEMICAL ANALYSTS & ASSAYERS

BURNABY, B. C.
CANADA
TELEPHONE: 299-6910

100 H 463

CERTIFICATE OF ANALYSIS

CERTIFICATE NO. 83498-2

INVOICE NO.

DATE ANALYSED 83/10/20

TO: LAKEWOOD MINING CO LTD.
2245 W. 13th Ave.
Vancouver, B.C.

DDH # 83-2

PROJECT CLINTON

No.	Sample	pH	Mo	Cu	Ag	PPB Au						No.
01	83-2-73'			368		50						01
02	85'			406		660						02
03	89'			1200		320						03
04	91'			146	0.4	1520						04
05	119'			206	0.4	80						05
06	83-2-127'			68	0.4	70						06
07	132'			88	0.8	100						07
08	136'			122		30						08
09	137'			158	0.8	100						09
10	143'			490		130						10
11	146'			110	1.0	90						11
12	83-2-153'			234	0.8	80						12
13												13
14												14
15												15
16												16
17												17
18												18
19												19
20												20
21												21
22												22
23												23
24												24
25												25
26												26
27												27
28												28
29												29
30												30
31												31
32												32
33												33
34												34
35												35
36												36
37												37
38												38
39												39
40												40

VALUES IN PPM, UNLESS NOTED OTHERWISE.

Certified by

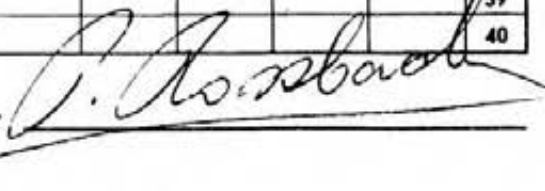

Kossbacher Laboratory Ltd.

GEOCHEMICAL ANALYSTS & ASSAYERS

BURNABY, B. C.
CANADA
TELEPHONE: 299-6910

JOB # 203

CERTIFICATE OF ANALYSIS

TO: LAKEWOOD MINING CO. LTD.
2245 W. 13th Ave.
Vancouver, B.C.

DDH # 83-3

CERTIFICATE NO. 83498-3
INVOICE NO.
DATE ANALYSED 83/10/20
PROJECT CLINTON

No.	Sample	pH	Mo	Cu	Ag	PPB FW						No.
01	83-3-219-222			128	0.2	10						01
02	222-232			86	0.2	10						02
03	264-274			98	0.2	10						03
04	274-282			84	0.2	10						04
05	282-290			94	0.2	10						05
06	290-300			134	0.2	10						06
07	300-311			106	0.2	10						07
08	340			94	0.6	30						08
09	340A			104		10						09
10	344			52	0.6	20						10
11	83-3-354			192		20						11
12												12
13												13
14												14
15												15
16												16
17												17
18												18
19												19
20												20
21												21
22												22
23												23
24												24
25												25
26												26
27												27
28												28
29												29
30												30
31												31
32												32
33												33
34												34
35												35
36												36
37												37
38												38
39												39
40												40

VALUES IN PPM, UNLESS NOTED OTHERWISE.

Certified by

P. Kossbacher

Kossbacher Laboratory Ltd.

GEOCHEMICAL ANALYSTS & ASSAYERS

BURNABY, B. C.
CANADA
TELEPHONE: 299-6910

JOB # 203
VIDETTE LAKE

CERTIFICATE OF ANALYSIS

CERTIFICATE NO. 83534

INVOICE NO.

DATE ANALYSED 83/11/06

TO: LAKEWOOD MINING CO LTD.
2245 W. 13th Ave.
Vancouver, B.C.

PROJECT CLINTON

PPB DDH # 83-2B

No.	Sample	pH	Mo	Cu	Au	Ag	Zn						No.
01	2-B-83-65-74			102	50								01
02	74-82			184	70								02
03	82-88			208	90								03
04	88-95			186	80								04
05	95-103			166	70								05
06	103-112			90	180								06
07	112-117			306	360								07
08	117-124			86	70								08
09	124-131			78	50								09
10	2-B-83-131-138			50	60								10
11	138-145			90	160								11
12	145-155			44	10								12
13	155-163			56	10								13
14	163-173			68	50								14
15	173-180			32	70								15
16	180-188			138	170								16
17	188-194			86	50								17
18	194-201			120	80								18
19	201-209			62	50								19
20	2-B-83-209-215			66	30								20
21	215-223			134	40								21
22	223-231			134	20								22
23	491-496			46	10								23
24	STD B			136	-								24
25	2B 300'			790	130	1.2	76						25
26	2B.83-333-347			180	50	0.2							26
27	347-356			128	10	0.2							27
28	356-366			94	10	0.2							28
29	366-376			58	20	0.2							29
30	376-387			112	10	0.2							30
31	387-397			46	10	0.2							31
32	397-406			84	10	0.2							32
33	406-416			128	10	0.2							33
34	2B83-416-426			72	10	0.2							34
35	188'			28	30								35
36	201'			100	60								36
37	2B83-211'			86	30								37
38													38
39													39
40													40

VALUES IN PPM, UNLESS NOTED OTHERWISE.

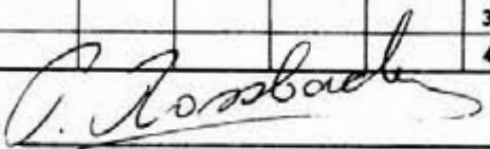
Certified by 

APPENDIX III
AFFIDAVIT OF EXPENSES

AFFIDAVIT OF EXPENSES

This will certify that road construction and diamond drilling were carried out in October, 1983 on the Clinton Claims, Vidette Lake area, Clinton Mining Division, British Columbia, to the value of the following:

Road construction	\$25,231.90
Drill site preparation	3,292.00
Diamond drilling	31,679.20
Core boxes	350.00
Mobilization	392.37
Assay	2,017.70
Geological and consulting fees	2,842.23
	<hr/>
Total	\$65,805.40

Donald G. Allen

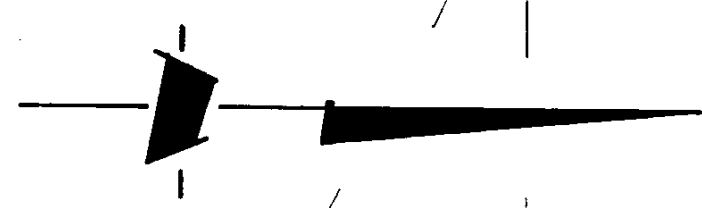
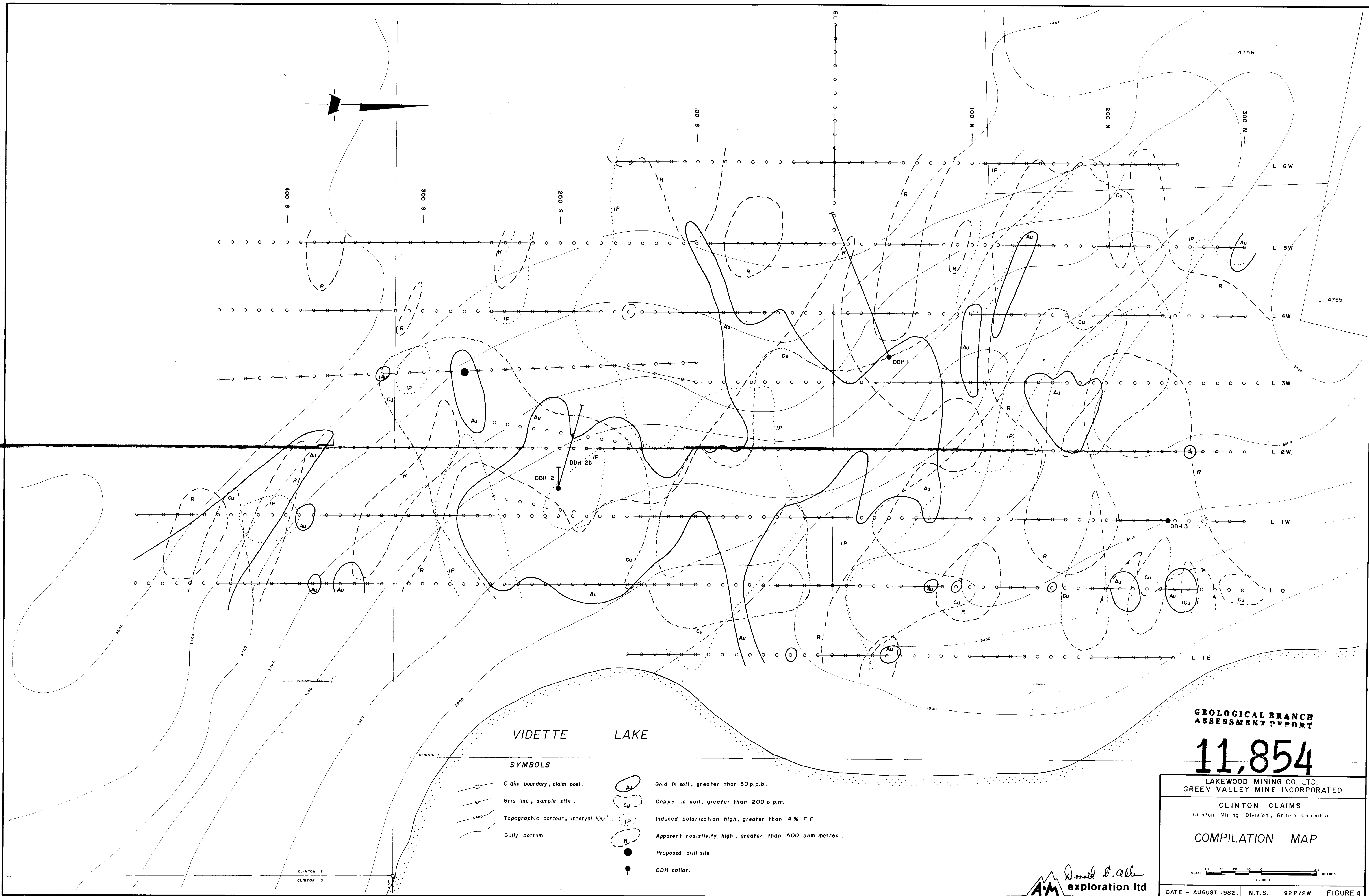

VIDETTE LAKE

- SYMBOLS**
- Claim boundary, claim post.
 - Grid line, sample site.
 - Topographic contour, interval 100'
 - Gully bottom.
 - Gold in soil, greater than 50 p.p.b.
 - Copper in soil, greater than 200 p.p.m.
 - Induced polarization high, greater than 4% F.E.
 - Apparent resistivity high, greater than 500 ohm metres.
 - Proposed drill site
 - DDH collar.

GEOLOGICAL BRANCH ASSESSMENT REPORT

11,854

LAKWOOD MINING CO. LTD.
GREEN VALLEY MINE INCORPORATED

CLINTON CLAIMS
Clinton Mining Division, British Columbia

COMPILATION MAP

