

'84-153-12094.

Assessment Report on the Neewa I and Neewa II
Mineral Claims (93H/4E-53°14'20"N, 121°38'30"E)
Cariboo Mining Division

**GEOLOGICAL BRANCH
ASSESSMENT REPORT**

12,094

Claim Owner/Operator: Mr. G. Gunson
Report Prepared By: S. Tataryn
Submitted: MARCH 19, 1984

TABLE OF CONTENTS

	PAGE
Map 1 - Index Map	1
Introduction	2
i) Physiography and Access	2
ii) Property Definition and History	2
iii) Work Done	3
Map 2 - Physiographic Location	4
Technical Report on Geochemical Reconnaissance Sampling	5
Recommendations	6
Itemized Cost Statement	7
Statement of Author's Qualifications	8
Map 3 - Sample Locations	in back pocket

121°40'

121°35'

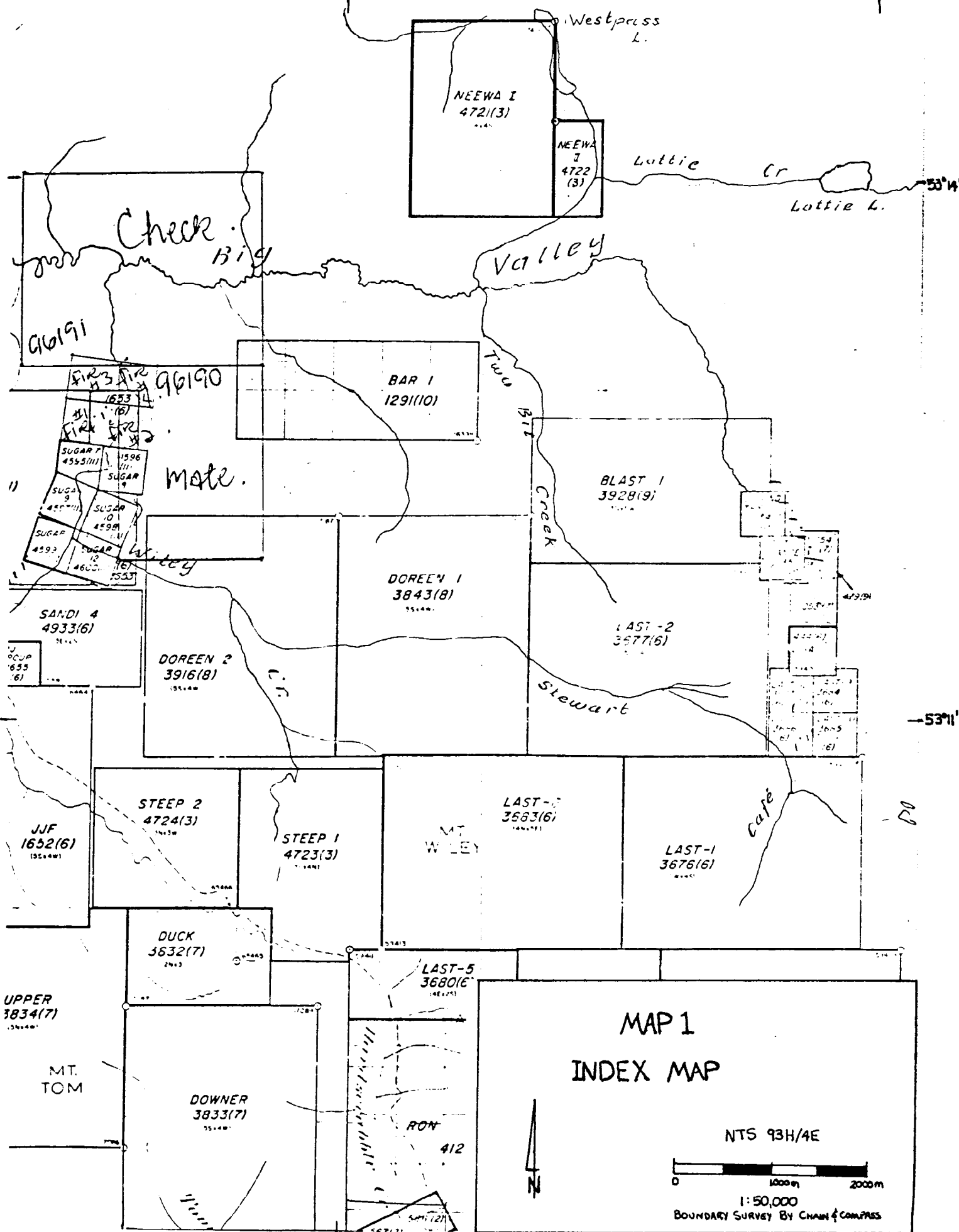

INTRODUCTION

This report has been prepared for the purpose of obtaining assessment credit for the Neewa I and Neewa II claims (Cariboo Mining Division) for the 12-month period March 23, 1983 to March 23, 1984.

i) PHYSIOGRAPHY AND ACCESS

Physiographically, the claims are situated in the Quesnel Highland region of central B.C., and are centred at approximately $53^{\circ}14'20''$ N. latitude and $121^{\circ}38'30''$ E. longitude (NTS 93H/4E). The property is located approximately 200m. west of Westpass Lake, on the east side of an east-west trending ridge lying north of Big Valley Creek. Total relief over the claimed area is in the order of 1100' (333m.).

Access to the Neewa I and Neewa II claims is by the 2400 road (a four-season gravel logging road) and Highway 26, the Barkerville Highway. Total distance from Quesnel, B.C. via the 2400 road and Highway 26 is approximately 100 km..

Map 1 is an index map showing the locations of the Neewa I and Neewa II claims.

ii) PROPERTY DEFINITION AND HISTORY

Neewa I is a 12-unit modified grid mineral claim. It extends 1500 m. west and 2000 m. south of the legal corner post located 750 m. north and 200 m. west of the Westpass Creek outlet on Westpass Lake. The legal corner post of the 2-unit Neewa II claim is located approximately 230 m. south and 200 m. west of the Westpass Creek outlet. Neewa II extends 500 m. east and 1000 m. south of this legal corner post.

Previous history of the ground covered by these claims is unknown. The property does not appear to have been previously staked.

Neewa I and Neewa II were staked and recorded by the current owner/operator, Mr. Gordon Gunson, on March 23, 1983.

Preliminary site investigation revealed traces of visible fine-grained mineralization in basalt of the Mississippian Antler Formation which underlies the property. An accurate determination of the type of mineralization present could not be made due to its extremely fine grain and sparseness. Silver is a possibility.

Reconnaissance geochemical sampling was undertaken to evaluate the silver and gold potential of the property.

iii) WORK DONE

Most of the work done on the Neewa I and Neewa II claims during 1983 was aimed at determining the economic viability of the property.

Approximately 3 to 4 cubic metres of rock was washed from a pyritiferous quartz-fluorite vein exposure in a roadcut on the Neewa I claim (Map 3). The pyrite here is generally medium-grained, rusty-weathering. It is possible that some of this pyrite may be gold-bearing, as auriferous pyrite is known to occur in other quartz vein systems in the area.

Except in roadcuts, very little outcrop is exposed on the property. Two basalt rock samples with traces of fine-grained mineralization were taken from roadcut (see Map 3 for location) and sent to Chemex Labs Ltd. for whole rock and gold analysis. The results proved inconclusive, and it was determined that reconnaissance soil sampling would be a more appropriate prospecting method. A report on sampling procedure is given below.

121°40'

121°35'

53°14'

53°14'

53°11'

53°11'

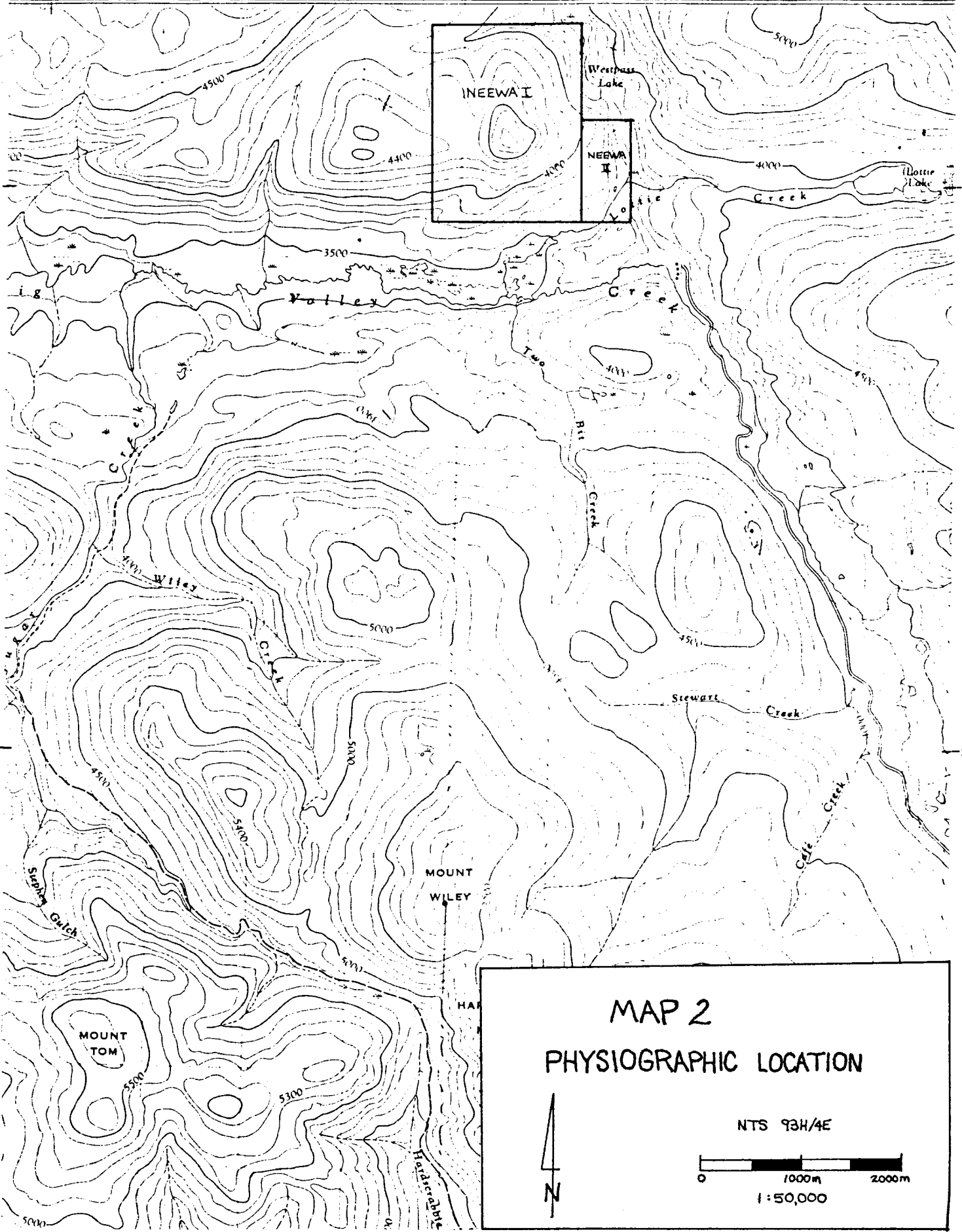
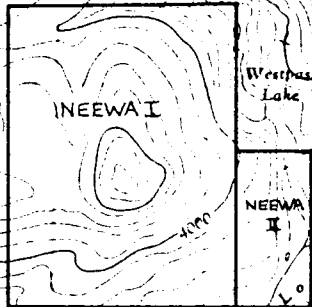

MAP 2
PHYSIOGRAPHIC LOCATION

NTS 93H/4E

N

0 1000m 2000m

1:50,000

TECHNICAL REPORT ON GEOCHEMICAL RECONNAISSANCE SAMPLING

Small-scale reconnaissance geochemical sampling was carried out on the Neewa I and Neewa II claims during the fall of 1983. The primary function of this work was to determine whether a more detailed sampling program is warranted. A total of twelve soil samples were taken at different locations along various creek draws. Ease of access was a major consideration in determining sample locations.

All soil samples were taken from the unaltered mineral ("C") horizon, which generally lies at a depth of about one foot (0.3m.). Approximately 500 g. of soil was collected for each sample.

Samples 1 and 2 were taken from the soil below the creek bed (Map 3). Sample 3 was obtained from an intermittent creek draw. This sample was dry, with no seepage into the sample hole. Samples 4 to 8 were taken in creek draws where seepage did occur. Samples 9 to 12 were taken in a subsequent traverse to determine whether the anomalous gold and silver values obtained in samples 3, 5, and 7 were due to concentration and seepage from the creeks.

Sample analysis was conducted by Kamloops Research and Assay Laboratory Ltd. of Kamloops B.C.. The -80 mesh fraction of all soil samples was analyzed for gold by fire assay and atomic absorption, and for silver by hot acid extraction and atomic absorption. The assay values obtained are shown on Map 3.

Anomalous values of both gold and silver^{were} obtained in seven of the twelve soil samples (values over 10 ppb gold and 1 ppm silver are considered anomalous).

Samples 1 and 2 appear to be seepage anomalies, with gold and silver concentration increasing downstream. The anomalies indicated by samples 3, 4, and 5 also appear to be seepage-related. However, high gold and silver values obtained in sample 5 may be a continuation of the possible anomaly indicated by samples 6, 7, and 8.

Sample number 7 is of particular interest, with a geochem anomaly of 105 ppb Au and 2.4 ppm Ag. Samples 6 and 8 also display high gold and silver values, but these may be seepage anomalies caused by the proximity of these two samples to the creeks.

RECOMMENDATIONS

The northern half of the Neewa I claim seems to warrant further exploration. Geochemical sampling further upstream of samples 6 and 8 may be useful in determining whether these are real anomalies. The area around sample location no. 7, in particular, warrants further exploration. If results prove favourable, a sampling grid on 100 m. centres over the northwest part of the Neewa I claim is recommended.

ITEMIZED COST STATEMENT

WAGES

May 7, 1983; one day; Preliminary site investigation:		
1 Foreman; 10 hrs. at 15.00/hr.	--	150.00
1 Labourer; 10 hrs. at 11.50/hr.	--	115.00
Field consultation with geologist; 1/2 day--		60.00
	TOTAL	<u>325.00</u>
Aug. 14, 1983; one day; Outcrop washing:		
1 Foreman; 10 hrs. at 15.00/hr.	--	150.00
1 Labourer; 10 hrs. at 11.50/hr.	--	115.00
	TOTAL	<u>265.00</u>
Oct. 15, 1983; one day; Soil sampling:		
1 Foreman; 10 hrs. at 15.00/hr.	--	150.00
1 Labourer; 10 hrs. at 11.50/hr.	--	115.00
	TOTAL	<u>265.00</u>
	TOTAL WAGES	<u>\$ 855.00</u>

TRANSPORTATION

May 7, 1983; one day; rental of 1-4X4 truck at		
40.00/day	--	40.00
gasoline -----		15.00
Aug. 14, 1983; one day; rental of 1-4X4 truck at		
40.00/day	--	40.00
gasoline -----		15.00
Oct. 15, 1983; one day; rental of 1-4X4 truck at		
40.00/day		40.00
gasoline -----		15.00
	TOTAL TRANSPORTATION	<u>\$ 165.00</u>

COST OF ANALYSES

2 rock samples - whole rock analysis; 30.00/sample--		60.00
2 rock samples - analyzed for Au; 8.75/sample	--	17.50
	TOTAL	<u>77.50</u>
8 soil samples - analyzed for Au, Ag; 8.60/sample	--	68.80
4 soil samples - analyzed for Au, Ag; 8.75/sample	--	35.00
	TOTAL	<u>103.80</u>
	TOTAL ANALYSIS COST	<u>\$ 181.30</u>

MISCELLANEOUS

Aug. 14, 1983; two days; rental of 1 pump for		
washing at 20.00/day	--	40.00
Greyhound shipping costs on 40 lbs. of rock		
and soil samples	--	19.85
	TOTAL MISCELLANEOUS	<u>\$ 59.85</u>

COST OF ASSESSMENT REPORT PREPARATION

Report fee	--	50.00
Mapping fee	--	75.00
Typing fee	--	15.00
Stationary/xeroxing	--	5.00
	TOTAL	<u>145.00</u>
	TOTAL REPORT FEE	<u>\$ 145.00</u>

TOTAL CLAIMED COST \$ 1406.15

STATEMENT OF AUTHOR'S QUALIFICATIONS

I, Sonia Tataryn, attest that the statements made in this report are correct to the best of my knowledge, and that this report was prepared by me personally.

I graduated from the University of Alberta in 1982 with a B.Sc. in geology, with distinction. I am currently registered as a member-in-training with the Association of Professional Engineers, Geologists, and Geophysicists of Alberta. I have approximately 1½ years of experience in geological exploration.

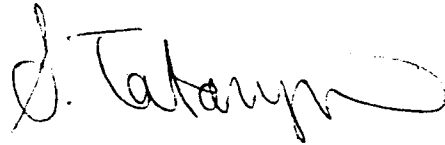
A handwritten signature in cursive script that reads "S. Tataryn". The signature is written in dark ink and is positioned above the printed name.

Sonia Tataryn

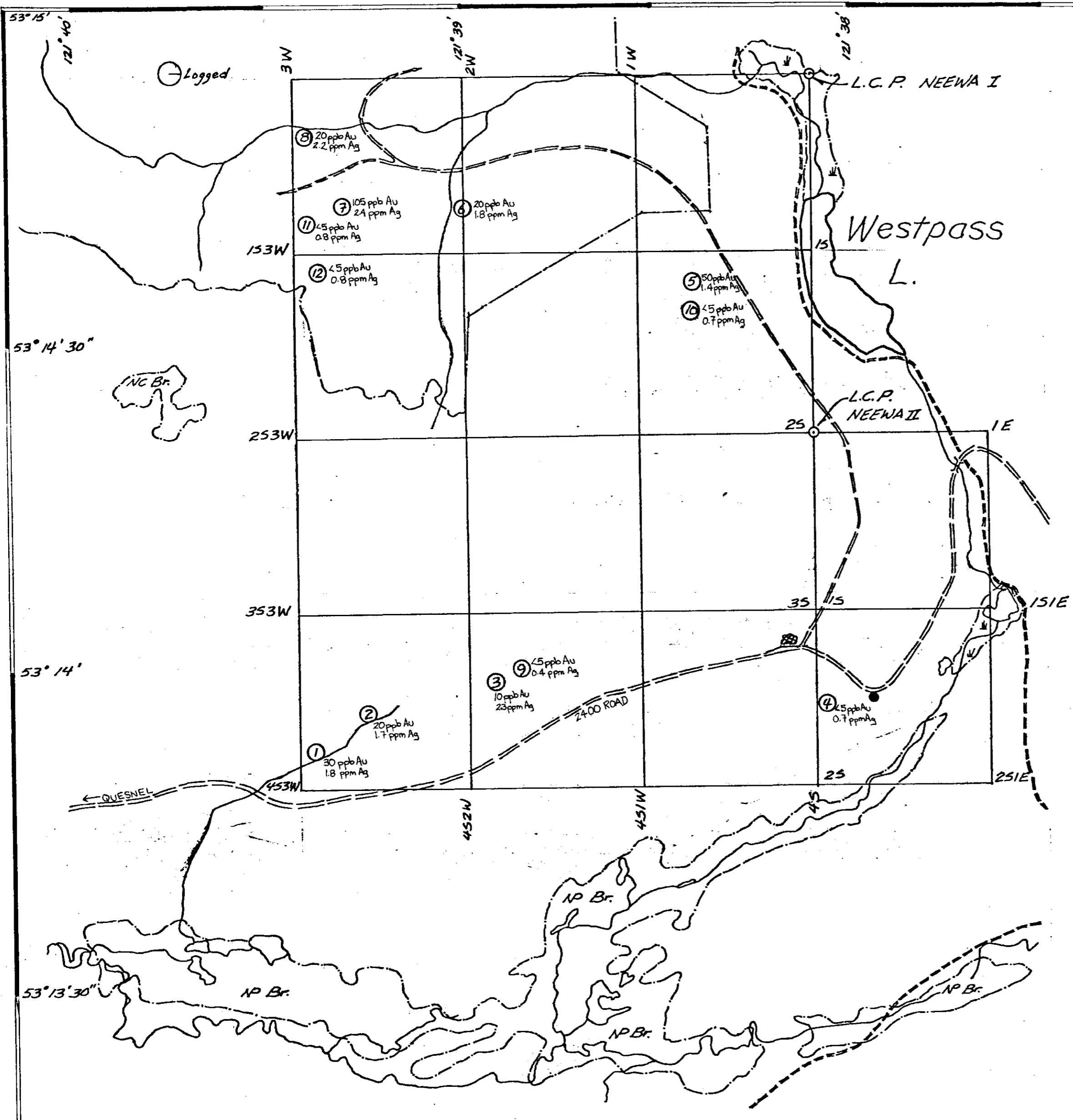

MAP 3
SAMPLE LOCATIONS

- SOIL SAMPLE
 - ROCK SAMPLE
 - ⊞ WASHED AREA
 - ⊙ LEGAL CORNER POST
 - == ROAD
 - CLAIM BOUNDARY
- BOUNDARY SURVEY BY CHAIN & COMPASS
N.T.S. : 93 H/4 E

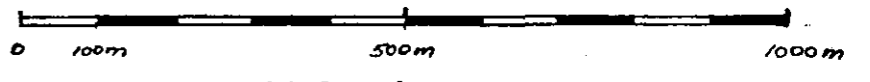

GEOLOGICAL BRANCH
ASSESSMENT REPORT

12,094①