

KEYSTONE EXPLORATIONS LTD.

V1 & V2 MINERAL CLAIMS
SAKINAW LAKE AREA, VANCOUVER, M.D.
LAT 49°40' N 124°00' W

12612W

ASSESSMENT REPORT

on

MAGNETIC SURVEY

GEOLOGICAL BRANCH
by **ASSESSMENT REPORT**

V. CUKOR, P. ENG.

12,104

April 1984

TABLE OF CONTENTS

	Page
1. INTRODUCTION	1 /
2. PROPERTY, LOCATION, ACCESS	2 /
3. GEOLOGY	3 /
4. MAGNETIC SURVEY	4 & 5 /
5. SUMMARY & RECOMMENDATIONS	6 /

APPENDIX:

EXPENDITURE INCURRED DURING MAGNETIC SURVEY

certificate.

ILLUSTRATIONS

- Fig. 1 LOCATION MAP /
- Fig. 2 CLAIM MAP /
- Fig. 3 MAGNETIC SURVEY PLAN /

KEYSTONE EXPLORATIONS LTD.

V1 & V2 CLAIMS

SAKINAW LAKE AREA, B.C.

1. INTRODUCTION

Keystone Explorations Ltd. of Vancouver, B.C. has requested NVC Engineering Ltd. to carry out assessment work on the V1 & V2 Mineral Claims.

Since only limited funds are available for the program selection of the type of work is rather difficult. The mineralized skarn zone contains locally a fair amount of magnetite, and therefore the author has decided to perform a trial magnetic survey.

Although limited to a rather small area, the purpose of the survey is to determine whether it should be expanded over the entire property area.

2. PROPERTY, LOCATION, ACCESS

Two full size, contiguous mineral claims comprise the property. The claims, record numbers and expiry dates are as follows:

Claim	Record Number	Expiry Date
V1	26125	April 17, 1984
V2	26126	April 17, 1984

The claims are located on two post system. Ownership is 100% to KEYSTONE EXPLORATIONS LTD.

The property is located on the Sechelt Peninsula, at the southeastern side of Sakinaw Lake. It is in the Vancouver Mining Division at NTS 92F/9E and 92G/12W. The centre of the property is at approximately latitude 49°40' N and longitude 124°00' W.

The claims are accessible by Highway 101 from Gibsons Landing, for about 44 miles and then for 2 miles by paved road towards Irvines Landing to a dirt road turnoff. The road has recently been repaired and provides an excellent access to the claims.

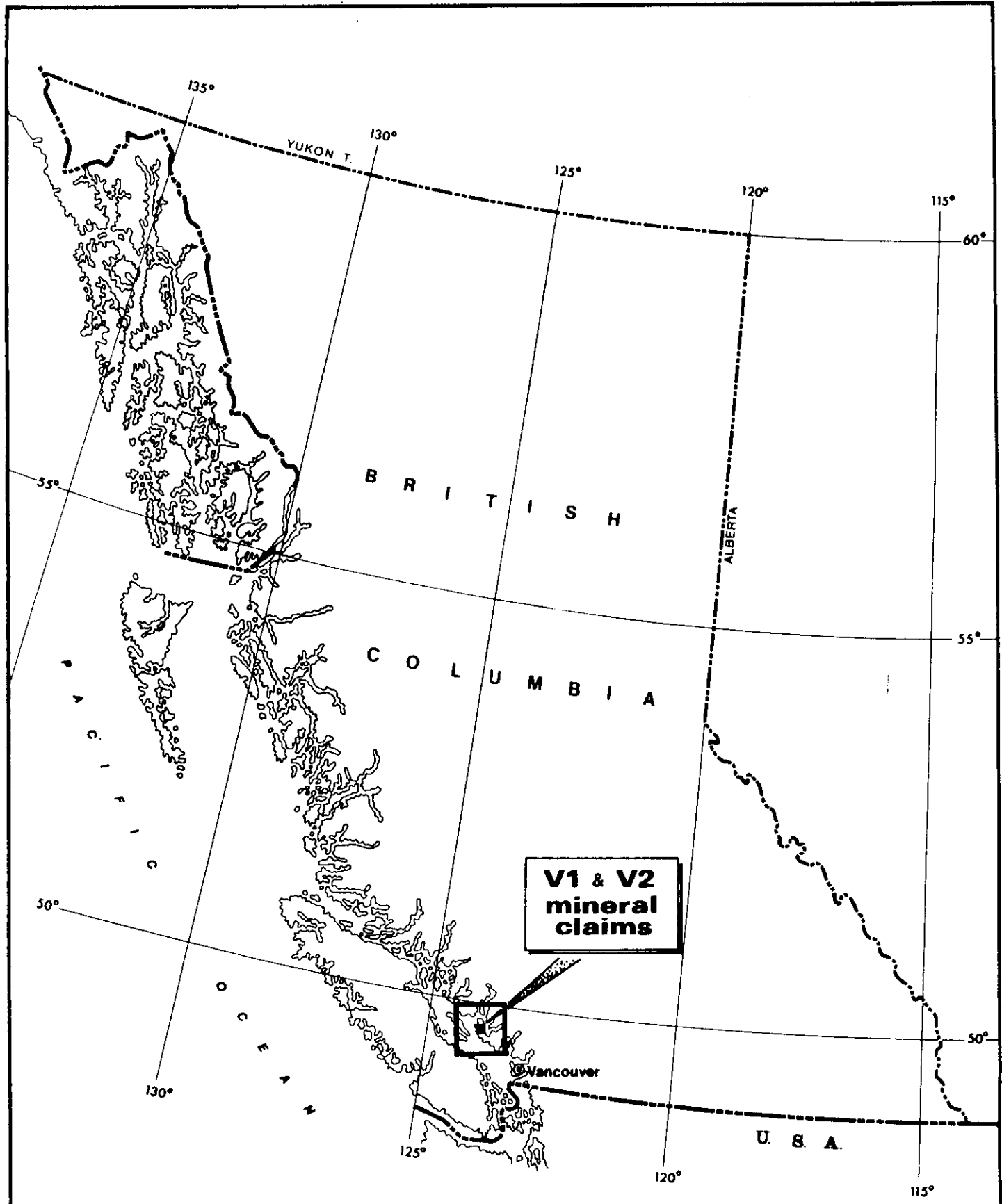

KEYSTONE EXPLORATIONS LTD.		
V1 & V2 mineral claims		
LOCATION MAP		
VANCOUVER M.D., B.C.		NTS 92 F-9E, 92 G-12W
V.CUKOR, P.Eng. - NVC ENGINEERING Ltd. - VANCOUVER, B.C.		
DATE: April 1984	SCALE: 0 100 miles	FIG. 1

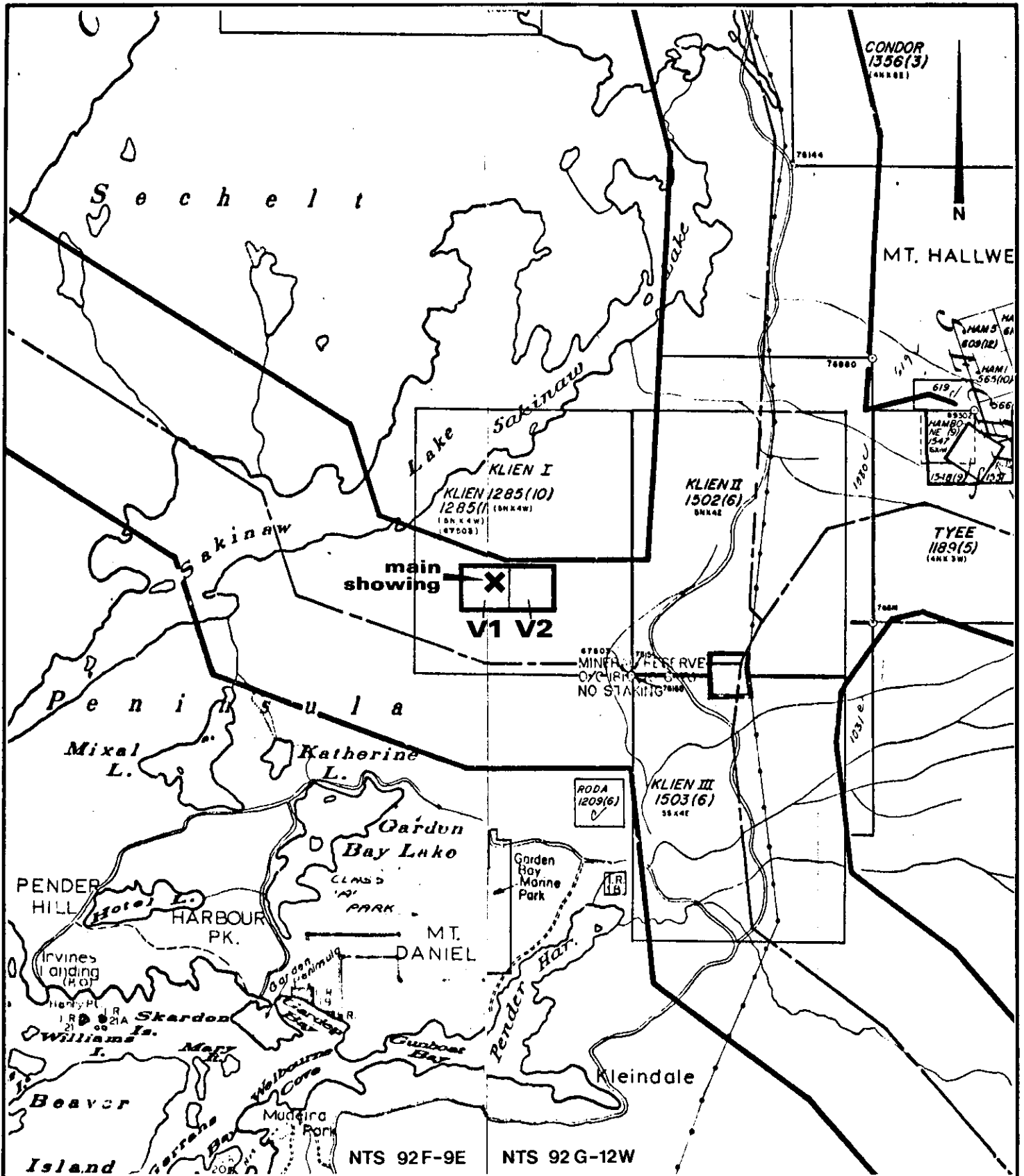

KEYSTONE EXPLORATIONS LTD.	
V1 & V2 mineral claims CLAIM MAP	
VANCOUVER M.D., B.C.	NTS 92 F-9E, 92 G-12W
V.CUKOR, P.Eng. - NVC ENGINEERING Ltd. - VANCOUVER, B.C.	
DATE: April 1984	SCALE: 0 1000 meters
	FIG. 2

3. GEOLOGY

The general geology of the area is shown on 1"=2Mi map, appended to B.C.D.M. Bull. 39, by W.R. Bacon

Quartz diorites of Jurassic Coast Intrusions underlie most of the claim area. To the west, they are in contact with older volcanics and sediments of Jarvis Group. Magnetite rich skarn bodies appear in the contact zone. Some skarn is found within the claim area at the King Midas showings, where good copper-silver mineralization is found. Most of the mineralization consists of pyrite, chalcopyrite and leaves of native copper. Specularite and magnetite are present as well. Some pyrite-chalcopyrite stringers are found to intermingle with epidote, specularite and magnetite as the stockwork within the altered quartz diorite.

A more detailed description of geology and mineral showings is given in the Assessment Report dated May 1975.

4. MAGNETIC SURVEY

This survey was carried out over the showing area as a trial run to assess the applicability of the method to search for the extensions of the mineralized zone.

A. FIELD METHOD

No grid was precut for this survey. A road which more or less parallels the skarn zone was used as a baseline and was chained at 50 meter intervals. Gridlines were extended over the showing area and were chained and flagged at 10 meter stations. The instrument used was a Geometrics Unimag Proton Magnetometer, Model G-836 with a sensitivity of 10 gammas.

The check points for diurnal corrections were established by initially surveying the baseline and after corrections were made, each station on the baseline was considered a base station for a corresponding crossline. During the survey each crossline was tied to the base station at the start and/or completion of each loop, with an average time lapse for the loop completion of approximately one hour.

4. MAGNETIC SURVEY (Cont'd)

B. DATA PRESENTATION

The instrument used for the survey measures the total magnetic field. After diurnal corrections were made all results were reduced by 56,000 gammas (57,000 gammas now reads 1,000 gammas) These relative values were plotted on 1:1,000 plan and contoured at 100 gamma intervals.

C. DISCUSSION OF RESULTS

Magnetic readings over the map area range between 56,530 to 57570 gammas of the total magnetic field, for a total relief of 1,040 gammas.

As expected the skarn zone and the altered intrusive which surrounds the skarn, carry sufficient amount of magnetite as to induce fairly strong magnetic relief. A decidedly higher magnetic anomaly which underlies the showing area and extends to the granitic knob to the south reflects this condition. It is a reasonable expectation that copper and silver mineralization should accompany magnetic alteration.

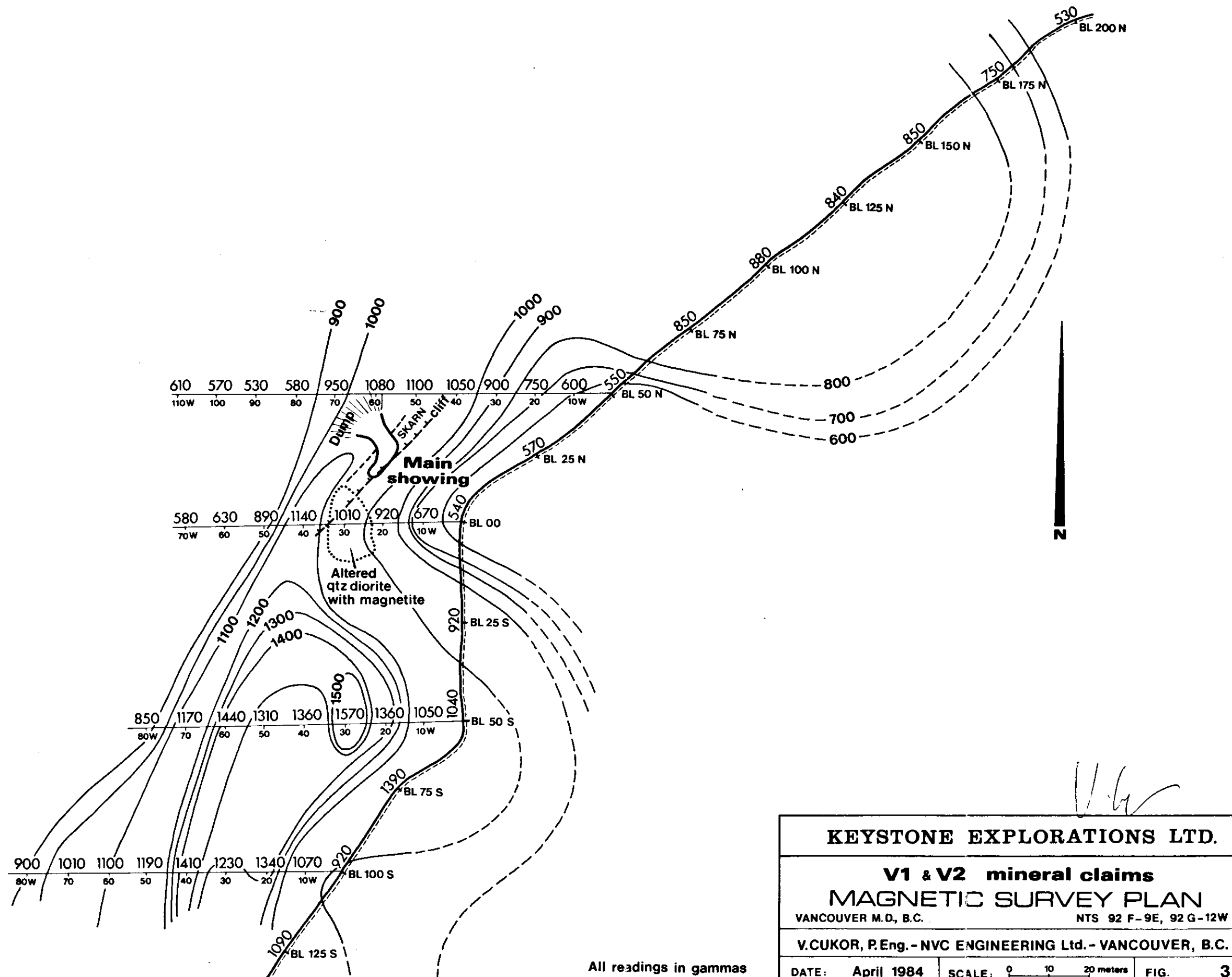

All readings in gammas

KEYSTONE EXPLORATIONS LTD.		
V1 & V2 mineral claims		
MAGNETIC SURVEY PLAN		
VANCOUVER M.D., B.C.		NTS 92 F-9E, 92 G-12W
V.CUKOR, P.Eng. - NVC ENGINEERING Ltd. - VANCOUVER, B.C.		
DATE: April 1984	SCALE: 0 10 20 meters	FIG. 3

5. SUMMARY AND RECOMMENDATIONS

Good grade copper and silver mineralization is found within the skarn zone of the main showing, and some stockwork type mineralization is found in the magnetite-specularite altered granitic rock in the vicinity of the skarn. The main purpose of this survey, that is exploring the applicability of magnetic survey as an exploration tool over the property area, was fully accomplished. A fairly strong magnetic high was outlined in the showing area; the full extent of which remains unknown due to the limited survey performed.

Further exploration of the property should be carried out utilizing magnetic and geochemical methods which should outline targets for diamond drilling

Respectfully submitted



V. CUKOR, P. ENG.
 NVC ENGINEERING LTD.

April 1984

APPENDIX

EXPENDITURES INCURRED DURING THE MAGNETIC SURVEY

FIELD WORK

V. Cukor, P. Eng. 1 Day (April 13, 1984)	350.00
Expenses, ferry, gasoline, meals	78.35

REPORT

V. Cukor, Preparation of report	350.00
Typing, printing and drafting	<u>63.00</u>

Total Expenditures	<u>\$ 841.35</u>
--------------------	------------------

V. CUKOR, P. ENG
NVC ENGINEERING LTD.

CERTIFICATE

I. VLADIMIR CUKOR, of 2830 West 37th Avenue, Vancouver

British Columbia, do hereby certify that:

1. I am a Consulting Geological Engineer with NVC ENGINEERING LTD. and with business address as above;
2. I graduated from the University of Zagreb, Yugoslavia in 1963 as a Graduated Geological Engineer;
3. I am a Registered Professional Engineer in the Geological Section of the Association of Professional Engineers in the Province of British Columbia;
4. I have practiced my profession as a Geological Engineer for the past twenty years, in Europe and North America in engineering geology, hydro-geology and exploration for base metals and precious metals;
5. I have personally carried out the program described in this report.

April 1984

V. CUKOR, P. ENG
NVC ENGINEERING LTD.