

PROSPECTING REPORT  
on the  
WESTRIN GROUP MINERAL CLAIMS  
Records Nos. 1724(4), 1833(8), 1834(8)

Located at  
KENNEDY RIVER - RTB 92 F/3W

in the  
ALBERNI MINING DIVISION  
Latitude -  $49^{\circ} 09' N$   
Longitude  $125^{\circ} 26' W$

by  
Walter Guppy - February 1984.

GEOLOGICAL BRANCH  
ASSESSMENT REPORT

12,304

TABLE OF CONTENTS

|                            |              |
|----------------------------|--------------|
| Index map.....             | Frontpiece   |
| Property definition        | Page 1.      |
| Location & Access          | Page 1       |
| History                    | Page 2       |
| Geology & Mineralization   | Pages 2 & 3  |
| Economic Assesment         | Page 3       |
| Notes on Prospecting       | Page 4       |
| Summary & Conclusions      | Page 4       |
| Detail map                 | Page 5       |
| Statement of Costs         | Page 6       |
| Statement of Qualification | Page 7       |
| Geological Map             | Appendix "A" |

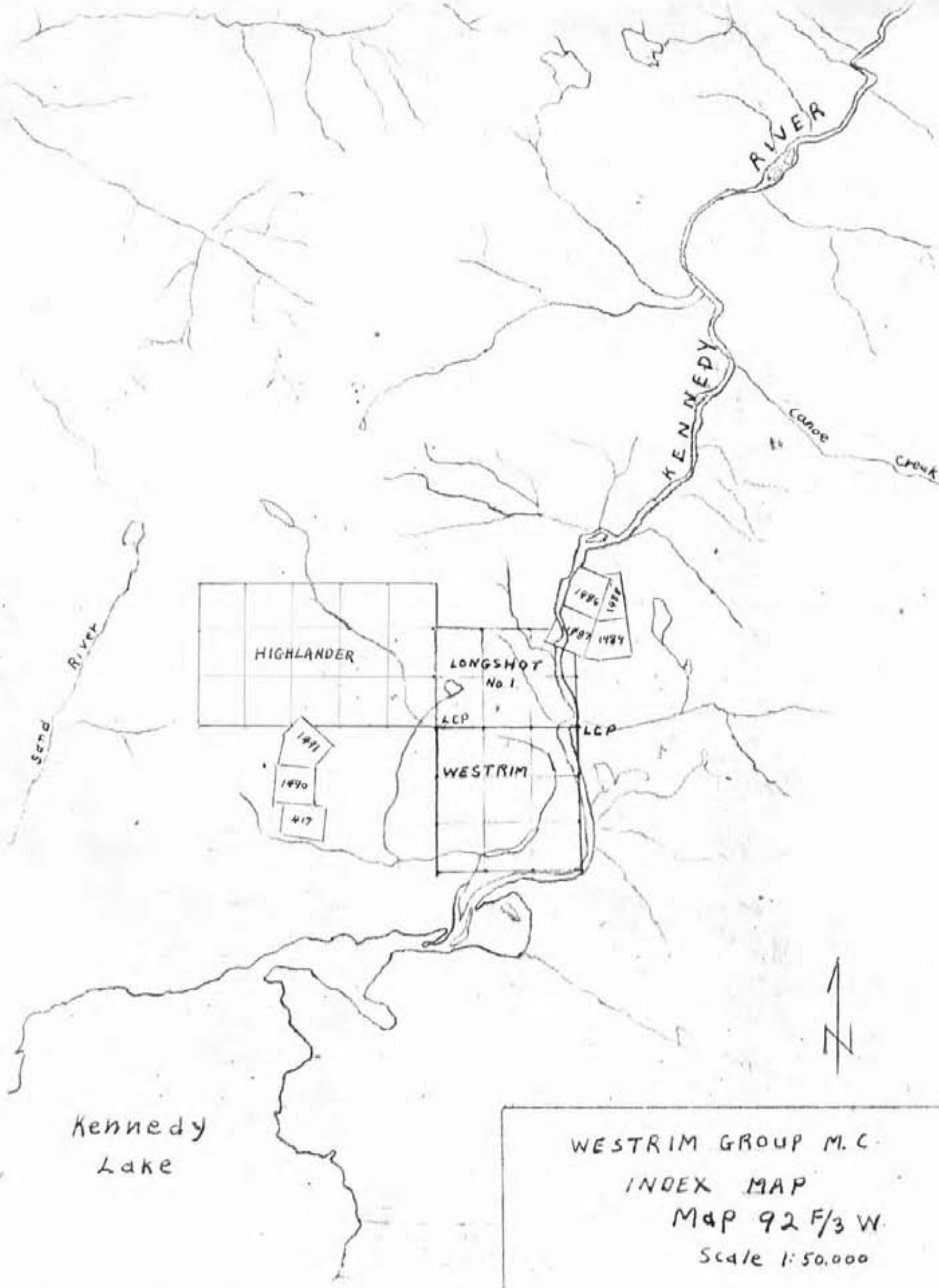

Kennedy  
Lake

WESTRIM GROUP M.C.  
INDEX MAP  
MAP 92 F/3 W  
Scale 1:50,000

PROPERTY DEFINITION

The Westrim Group consists of 3 mineral claims as follows:-

1. Longshot #1, Record No. 1724, located on April 4, 1983 and recorded on April 21, 1983.
2. Westrim, Record No. 1823 located on July 27, 1983 and recorded on August 3, 1983. This is a relocation of Longshot #2 which was located February 24, 1983 and abandoned in July 1983.
3. Highlander, Record No. 1834 located on August 19, 1983 and recorded on August 29, 1983.

The Longshot #1 consists of 6 units, the Westrim 9 units and the Highlander 15 units.

LOCATION & ACCESS

The claims are located on a ridge that lies between the lower section of Kennedy River and a creek in a hanging valley that flows into Kennedy Lake west of the mouth of Kennedy River. Access is by crossing Kennedy River from the end of a short branch road turning off from Highway #4 20 kilometers north of the junction of the roads to Tofino and Ucluelet.

HISTORY

The claims cover some narrow quartz veins that were staked by the writer and some associates in 1930. There is an old adit and winze on the property that probably dates back to around the turn of the century but no record of the original location or when the work was done could be found. There are a number of other old prospects covering narrow quartz veins in the area which were originally investigated around the turn of the century and were investigated again between 1934 and 1943 when underground work was carried out on some of them, including the Leora and Rose Marie which are on the east side of the river opposite the Westrim Group. There has been a recent revival of interest in the gold prospects of the area and both sides of the river for 2 kilometers above Kennedy Lake has been staked from posts placed along the highway.

GEOLOGY & MINERALIZATION

The area covered by the Westrim Group claims appears to be entirely underlain by Karmutsen volcanics. G.S.C. mapping shows Tertiary intrusives 2 kilometers to the west. A small intrusive stock, which is not mapped, was observed by the writer on the ridge above the Rose Marie Crown-grants east of Kennedy River.

The showings on the Westrim property consist of a number of narrow quartz veins on the south side of a small creek about 300 meters south-westerly from the narrows in Kennedy River where the northerly boundary of the Westrim mineral claim crosses the river. These veins occupy fractures striking north-

south and dipping steeply to the west. Quartz exposed in the face, above the old winze, and pieces of ore on the dump indicate widths of up to 30 centimeters but most of the veins are much narrower. All of the veins found, and float indicating similar veins, are within 100 meters west of the old winze except one vein seen under water in the river some distance upstream above the crossing to these showings. Some of the veins are well mineralized with pyrite. Visible gold was seen in some samples of highly oxidized surface material. Assays of samples mineralized with pyrite have run between 3 and 1 ounce of gold per ton.

#### ECONOMIC ASSESSMENT

Judging by ore on the dump of the old workings the winze was put down to explore a mineralized section of the vein that appears to widen as it goes down. The exposure above the portal and in the face above the winze is narrower and sparsely mineralized. The winze is full of water and of unknown depth. As there are no other surface exposures on this vein there is no way to determine if the section explored by the winze was just a short lens or if it might be part of an ore-shoot of a length and width that would support a viable mining operation. Some float found a considerable distance to the west indicates the possibility of a parallel vein with similar widths. In between are a number of very narrow veins with a dip and strike similar to the one in the old workings. These are, no doubt, too narrow to be mined individually but the possibility exists that some could be found spaced close enough to be mined together or that they might combine at some point to form a lense or wider vein.

NOTES ON PROSPECTING

The writer had known about the old workings that are on the Westrim property since he had first found them in the phase of prospecting activity in the Kennedy River area between 1936 and 1942 but had not visited the showings since and only vaguely remembered the location of them.

In March 1984, accompanied by another prospector, R.F. McGreevy, traverses were made of the area and the old workings "re-discovered". Traverses were also made to the creek in the hanging valley to the west, up stream along Kennedy River for 2 KM. and up another small creek north of the one in the draw where the showings are found.

Subsequently prospecting was carried out in the vicinity of the showings and westward to the pass. A route for a trail was scouted out to provide better access to the showings and facilitate prospecting of the area to the west.

SUMMARY & CONCLUSIONS

Although there are numerous exposures of bed rock in the area, in the form of steep rocky ridges, it is difficult to prospect because the areas between these ridges are brushy and debris filled. The two small creeks on the property also provide few exposures. It can be expected that mineralized veins would follow structures of intense fracturing and would therefore not be found on the prominent bluffs that represent areas that were resistant to erosion. For this reason it can be expected that there are veins on the property that have not been exposed and that it has possibilities for systematic prospecting and more advanced exploration.



HIGHLANDER M.C.

LAKE

marsh

KENNEDY RIVER

WESTRIM M.C.

STEEP  
ROCKY RIDGE.

ICP IP

IP

IP offset

DLCP

H.B. Road

old  
nd ip

IP

IP

IP

briny flats

IP

IP

500 metres

SLOUGH

marshy-flooded  
area

IP

navigable river

WESTRIM GROUP  
LEGEND  
Lines Traversed  
Trail Cut  
Scale 1 cm = 100m Approx.



STATEMENT OF COSTS

|                                       |             |               |
|---------------------------------------|-------------|---------------|
| March 16 and 19 - 2 men for 2 days    | 200 per day | \$ 400.00     |
| April 23 and 29 - 1 man for 2 days    | 100 " "     | 200.00        |
| Field maintainance and transportation |             | 300.00        |
| Preparing report                      |             | <u>100.00</u> |
|                                       |             | 1000.00       |

STATEMENT OF JUSTIFICATIONS

I, Walter Guppy, hereby certify that I have had over 40 years experience as a practical prospector.

Walter Guppy.

WESTRIM #2  
(Relocation of Longshot #1)

HIGHLANDER

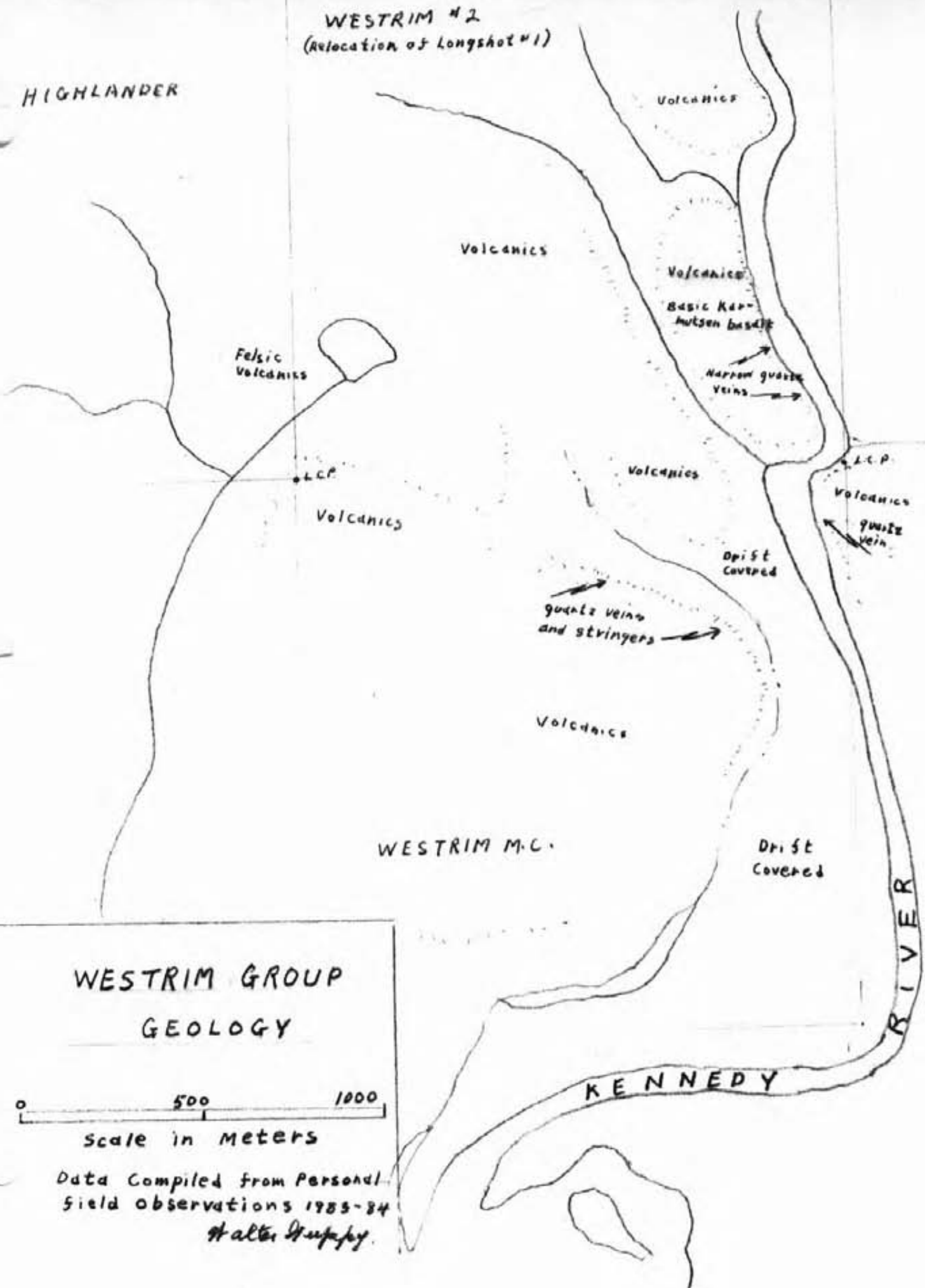

### WESTRIM GROUP GEOLOGY

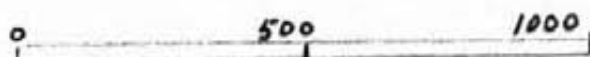

Scale in meters

Data Compiled from Personal  
field observations 1983-84

*Halter Gropfy*