

84-#481 (c) - #12393
07/85

ASSESSMENT REPORT
SUMMARY OF DIAMOND DRILLING
ON THE SASK ~~44~~ 45 MINERAL CLAIMS
~~OMINECA AND~~ CARIBOO MINING DIVISIONS
~~NTS 93K/16,~~ 93J/13 W

54° 56.5' 123° 48'

B.P. EXPLORATION CANADA LTD.

**GEOLOGICAL BRANCH
ASSESSMENT REPORT**

12,393

D. Farmer
C.M. Rebagliati
May, 1984

TABLE OF CONTENTS

	<u>Page No.</u>
RESUME	1
INTRODUCTION	1
LOCATION AND ACCESS	2
CLAIMS	2
DIAMOND DRILLING	3
CONCLUSIONS AND RECOMMENDATIONS	5
COST STATEMENT	6
CERTIFICATE	8

LIST OF FIGURES

	<u>Page No.</u>
FIGURE 1: LOCATION OF THE SASK 43-45 MINERAL CLAIMS	Behind page 1
FIGURE 2: DIAMOND DRILL HOLE LOCATION SASK 43	Behind page 3
FIGURE 3: DIAMOND DRILL HOLE LOCATION SASK 44	Behind page 3
FIGURE 4: DIAMOND DRILL HOLE LOCATION SASK 45	Behind page 3
FIGURE 5: DIAMOND DRILL HOLE SECTION HOLE 83-3-1	Behind page 3
DIAMOND DRILL LOGS	In pocket

LIST OF TABLES

TABLE 1: CLAIM STATISTICS	2
TABLE 2: DRILL HOLE SUMMARY	4

RESUME

During October 1983 three 100 metre NQ diamond drill holes were drilled on the Sask 43, 44, 45 mineral claims to test ground EM conductors. Two holes did not penetrate bedrock, and sheared, graphitic argillite was found to be the cause of the conductor in the third hole.

INTRODUCTION

During October 1983 three diamond drill holes were drilled to test ground electromagnetic conductors on the Sask 43-45 mineral claims, located on NTS map sheets 93K/16 and 93J/13 (Fig. 1). A total of 301.8 metres were drilled.

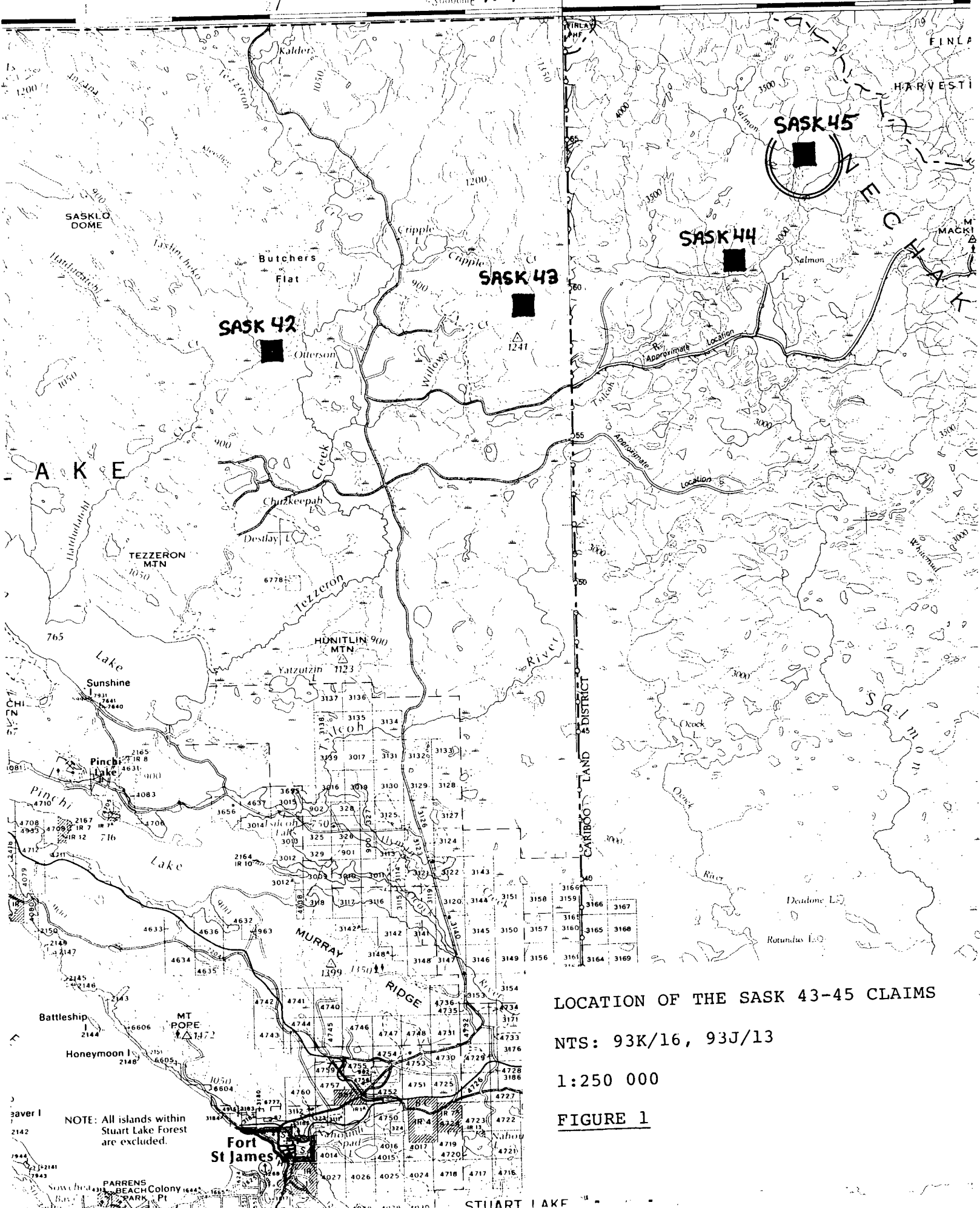

LOCATION OF THE SASK 43-45 CLAIMS

NTS: 93K/16, 93J/13

1:250 000

FIGURE 1

NOTE: All islands within Stuart Lake Forest are excluded.

Fort St James

STUART LAKE

LOCATION AND ACCESS

The Sask 43-45 mineral claims are located approximately 50 kilometers north of Fort St. James, B.C. on NTS map sheets 93K/16 and 93J/13, Omineca and Cariboo Mining Divisions.

Access is provided by the Mansen Creek highway north from Fort St. James, then eastwards along forest access roads to the claims. The Sask 45 claim is reached via helicopter north from Salmon Lake.

CLAIMS

The following table summarizes the claim statistics.

TABLE 1

<u>CLAIM</u>	<u>NO. OF UNITS</u>	<u>RECORD NO.</u>	<u>ANNIVERSARY</u>	<u>MINING DIVISION</u>
Sask 43	6	5488	July 8/83	Omineca
Sask 44	6	5046	July 8/83	Cariboo
Sask 45	6	5047	July 8/83	Cariboo

The area has not been staked previously.

DIAMOND DRILLING

During October 1983, J.T. Thomas Diamond Drilling Ltd., of Smithers, B.C. was contracted to drill three 100 metre NQ diamond drill holes for a total of 301.8 metres. The drill hole locations are shown on Figures 2, 3, and 4.

Detailed descriptions are provided in the drill logs in the back pocket and in Table 2, but generalized results are as follows:

HOLE 83-3-1 (Figure 5) revealed 17 metres of overburden underlain by 70 metres of argillite which in places is intensely sheared. A water saturated fault zone between 35 and 60 metres is the cause of the EM conductor. The final 14 metres of the hole consists of alkaline andesite.

HOLE 83-4-1 did not penetrate bedrock. Clay is the likely cause of the conductor.

HOLE 83-6-1 did not penetrate bedrock. Clay (68-88 metres) is the likely cause of the EM conductor.

All core recovered is stored on the Sask 1-4 claim near Cripple Lake.

There are no known outcrops located in the area of drilling.

LEGAL CORNER POST

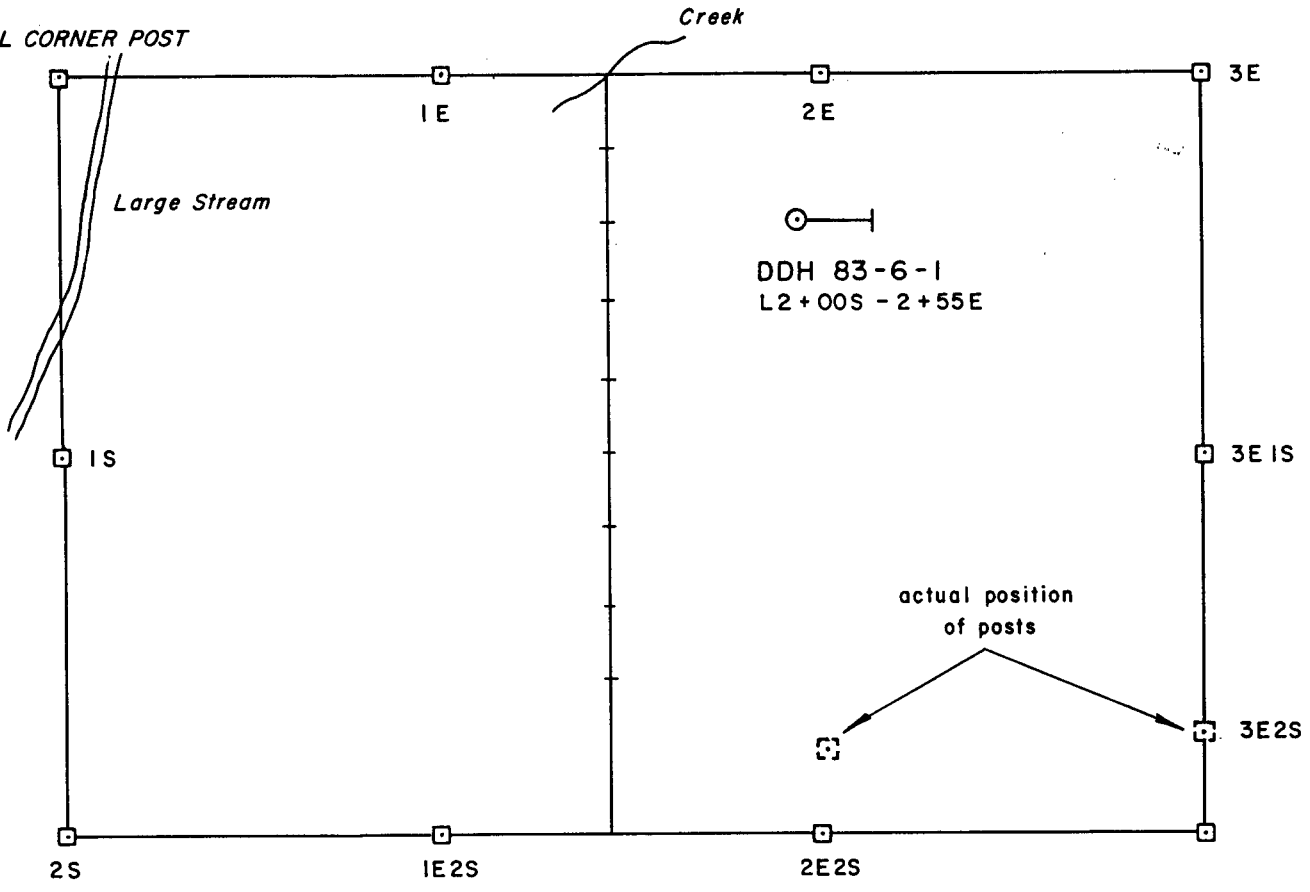

DDH 83-6-1
L2+00S - 2+55E

actual position
of posts

 **SELCO INC.** EXPLORATION
WESTERN CANADA

SASKLO PROJECT
DIAMOND DRILL HOLE LOCATION
SASK 45 - GRID 83-6

DRAWN BY R.F.	DATE MARCH 1984	N.T.S.	PLAN
TRACED BY L.G.	DATE APRIL 1984	93 J / 15	4

TABLE 2
DRILL HOLE SUMMARY

HOLE	AZIMUTH/DIP	DEPTH	OVERBURDEN DEPTH	CONDUCTOR	DEPTH TO CONDUCTOR	COMMENTS
83-3-1	310°/-60°	100.6 m	16.6 m	WATER SATURATED FAULT ZONE	35-58 m	COULD NOT CORE THROUGH CONDUCTOR TRICONED AND COLLECTED SLUDGE SAMPLES
83-4-1	035°/-66°	100.6 m	100.6 m	CLAY	-	HOLE DID NOT REACH BEDROCK
<u>83-6-1</u>	090°/-60°	100.6 m	100.6 m	CLAY	-	HOLE DID NOT REACH BEDROCK

CONCLUSIONS AND RECOMMENDATIONS

Three NQ holes were drilled for a total of 301.8 metres. Two of the holes did not penetrate bedrock, and sheared, graphitic argillite was found to be the cause of the EM response for the third hole.

No further work is recommended for the Sask 43-45 claims at this time due to the disappointing results.

COST STATEMENT1. Diamond Drilling (J.T. Thomas Diamond Drilling)

October 7-16, 1983

Sask 43

100.6 metres @ \$253.54 per metre \$25,506.12

Sask 44

100.6 metres @ \$253.54 per metre 25,506.12

Sask 45

100.6 metres @ \$253.54 per metre 25,506.12

2. Drill Supervision - October 6-19, 1983

1 Geologist

14 days @ \$100 per day \$ 1,400.00

Accomodation

14 days @ \$35 per day 490.00

Food

14 days @ \$25 per day 350.00

Transportation

14 days @ \$20 per day 280.00

Truck Rental

2 weeks @ \$100 per week 200.00

SUBTOTAL DRILLING \$79,238.36

Analytical Costs - Chemex Labs Ltd.

Sask 43

27 samples (Cu, Pb, Zn, Ag, Au, Hg) @ \$15.95 each \$ 430.65TOTAL COST \$79,659.00
=====

COST BREAKDOWN

Sask 43 - 6 Units

Drilling	\$ 26,412.79
Analytical	<u>430.65</u>
TOTAL	\$ 26,843.44

Sask 44 - 6 Units

Drilling	<u>\$ 26,412.65</u>
TOTAL	\$ 26,412.65

Sask 45 - 6 Units

Drilling	<u>\$ 26,412.65</u>
TOTAL	\$ 26,412.65 ✓

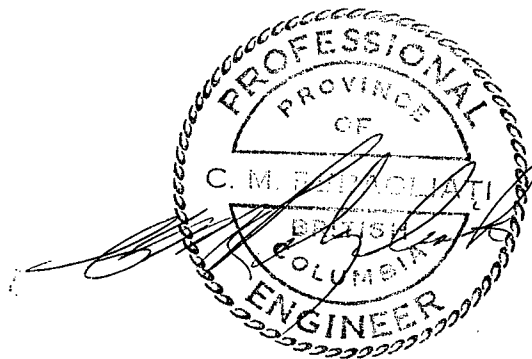

CERTIFICATE

I, C.M Rebagliati, of Vancouver, in the Province of British Columbia, hereby certify the following:

1. That I am a registered Professional Engineer in the Province of British Columbia.
2. That I have practised my profession since graduation from the Haileybury School of Mines of Ontario in 1966 and from the Michigan Technological University in 1969 with a B.Sc. degree in Geological Engineering.
3. That I am presently employed by Selco - A Division of BP Exploration Canada Limited in Vancouver as Senior Geologist.
4. That I personally examined the property to confirm and evaluate the exploration program.

Respectfully submitted,

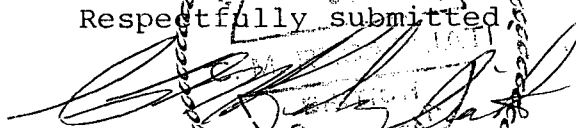
C. M. Rebagliati, P. Eng.

Vancouver, B.C.
May, 1984

DRILL LOG

HOLE NO. 83-6-1.....

DRILLING CO. J.T. Thomas Diamond Drilling Ltd.	LOCATION SKETCH 	DEPTH	TESTS DIP ANGLE	AZIMUTH	DATE STARTED: October 16, 1983	PROJECT: Sasklo
		COLLAR	60°	90°	DATE COMPLETED: October 16, 1983	N.T.S.: 93J/3
					COLLAR ELEV.:	LOCATION:
					NORTHING: 2+00S (Grid)	
					EASTING: 2+55E (Grid)	
					AZIMUTH: 90°	
					DEPTH: 327 ft. (100.6 m)	DATE LOGGED: October 18, 1983
HOLE TYPE DDH				CORE SIZE: NQ	LOGGED BY: J. Conway	

INTERVAL		ROCK TYPE	DESCRIPTION							STRUCTURE	REMARKS
FROM	TO		COLOUR	GRAIN SIZE	TEXTURE	ALTERATION	ORE MINERALS	FRACTURES PER METRE	(FRACTURES, FAULTS, FOLDING, BEDDING, ETC)	MINERALIZATION, TYPE, AGE RELATIONS	
0	100.6	Overburden	-	-	-	-	-	-	-	-	
68.9	88.3	Clay	Gray-green	V. fine	-	-	-	-	-	Gray-green clay with no rock fragments - clay displays pronounced cleavage or parting at 65 v.t.c.a.	
88.3	100.6	Sand	Brown	Fine	-	-	-	-	-	Brown sand with numerous boulders - poorly sorted gravelly sand.	