

REPORT FOR
ASSESSMENT
ON THE

GOLDEN DRAGON, RECORD NO. 3872 (6) 82F-15W, 12 units
GOLDEN, RECORD NO. 3894 (6) 82F-15W, 8 units
DRAGON SOUTH, RECORD NO. 4034 (8) 82F-15W and 82F-14E, 16 units
MARGARET, RECORD NO. 4033 (8) 82F-15W, 6 units

WOODBURY CREEK - KOOTENAY LAKE AREA
KOOTENAY LAND DISTRICT
SLOCAN MINING DIVISION
KASLO, BRITISH COLUMBIA

N. Lat. 49 47'30

82F14E, 15W W. Long. 116 59'

for

GOLDEN DRAGON RESOURCES LTD.
Suite 1020
475 Howe Street
Vancouver, British Columbia

by

Michael J. Linn, Geologist
Box 422
Kaslo, B. C.
VOG IMO

July 3, 1984

Kaslo, B.C.

**GEOLOGICAL BRANCH
ASSESSMENT REPORT**

12,621

TABLE OF CONTENTS

	<u>PAGE</u>
INTRODUCTION	1 /
LOCATION MAP	2 /
CLAIMS	3 /
CLAIM MAP	4 /
UNDERGROUND	5 /
GEOLOGY	6 /
SAMPLES	7 /
SAMPLE PLAN	8 /
CERTIFICATE	9 /
COSTS	10 /
ASSAY	11, 12, 13, 14

INTRODUCTION

The Golden Dragon, Golden, Dragon South and Margaret claims are located on the west side of Kootenay Lake between Cedar and Woodbury creeks. They range in elevation from 3500 to 6500 feet and are mostly heavily treed, with some logged areas. Access to the claims is by two wheel drive roads up Woodbury or Cedar creeks.

There is no known mineral production from the claims, although the Ainsworth Camp is well documented for its mineral production.

A total of 72 Geochem samples and 10 rock samples were analyzed.

Prospecting was done over a large area of the claims. Some work was done on all the claim groups.

Road work clearing with John Deere "Cat" with backhoe and loader and one man with a chain saw from Woodbury Creek to Golden claim group

(3200 meters up from Woodbury Creek)

Road starts to the south past the first bridge over creek 5 miles from Kootenay Lake.

FIGURE 2

AREA MAP
GOLDEN DRAGON RESOURCES
 SCALE 1:600,000
 AUGUST 12, 1983
 DONALD W. TULLY, P. ENG.

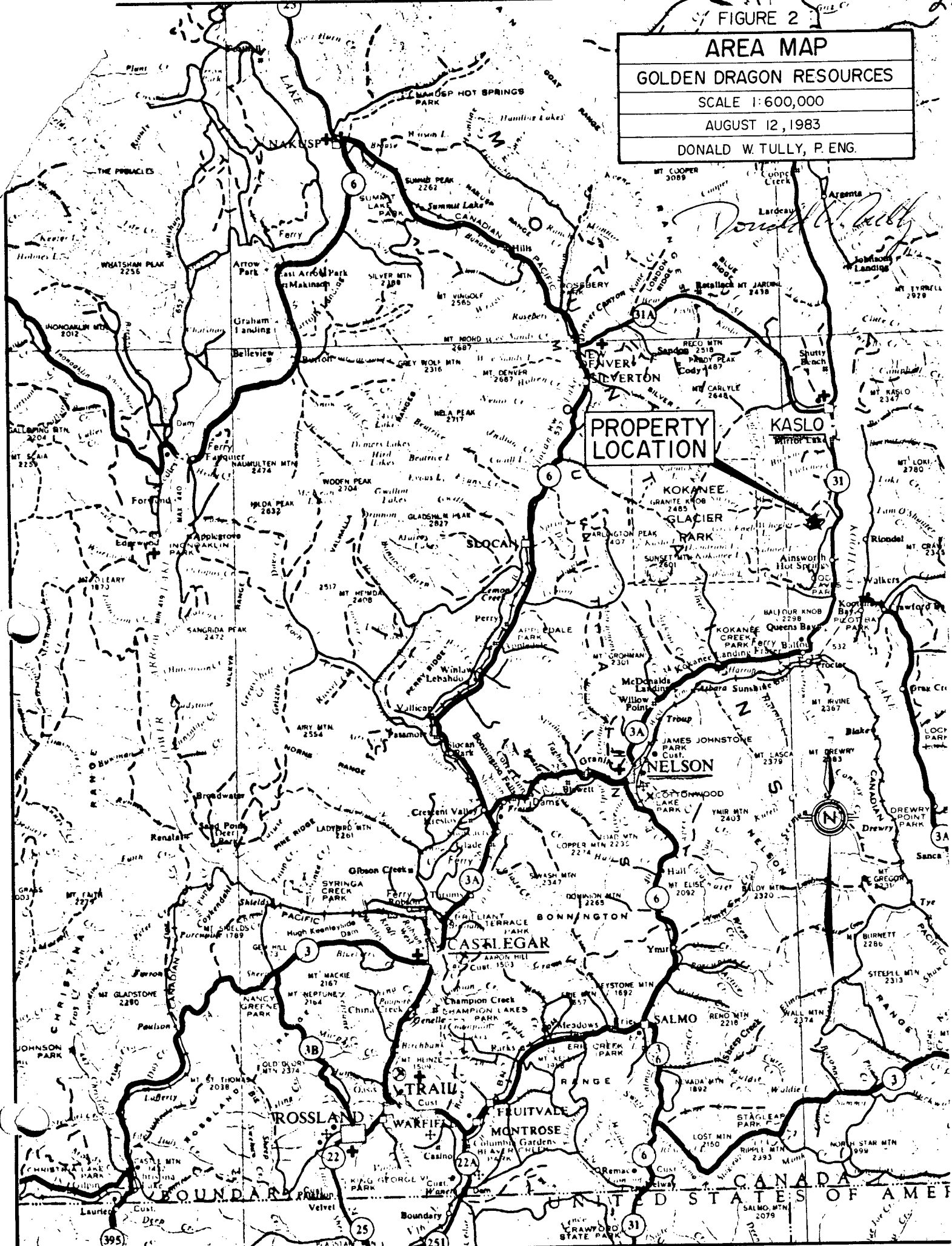

CLAIMS

Golden Dragon (12 units) record No. 3872 (6) June 17

Golden (8 units) record No. 3894 (6) June 27

Dragon South (16 units) record No. 4034 (8) Aug. 23

Margaret (6 units) record No. 4033 (8) Aug. 23

Kootenai

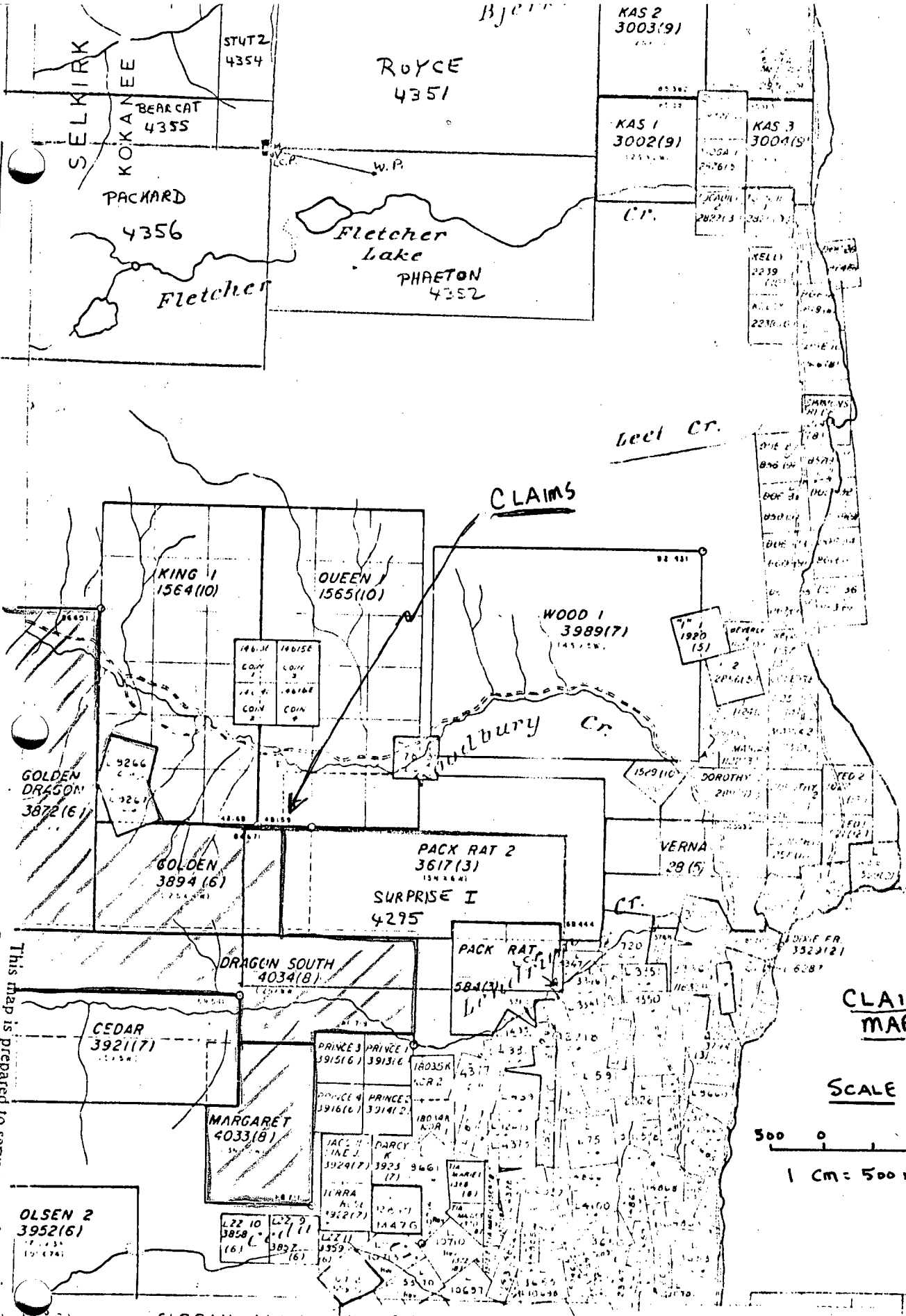

CLAIMS

CLAIM MAP

SCALE

500 0 1000

1 cm = 500 m.

Riondel

ELOCAN MINING DIVISION

TO SOUTH SEE MAP 321 10

This map is prepared to serve as a guide only. Positions of unnumbered claims are not shown.

Bjell

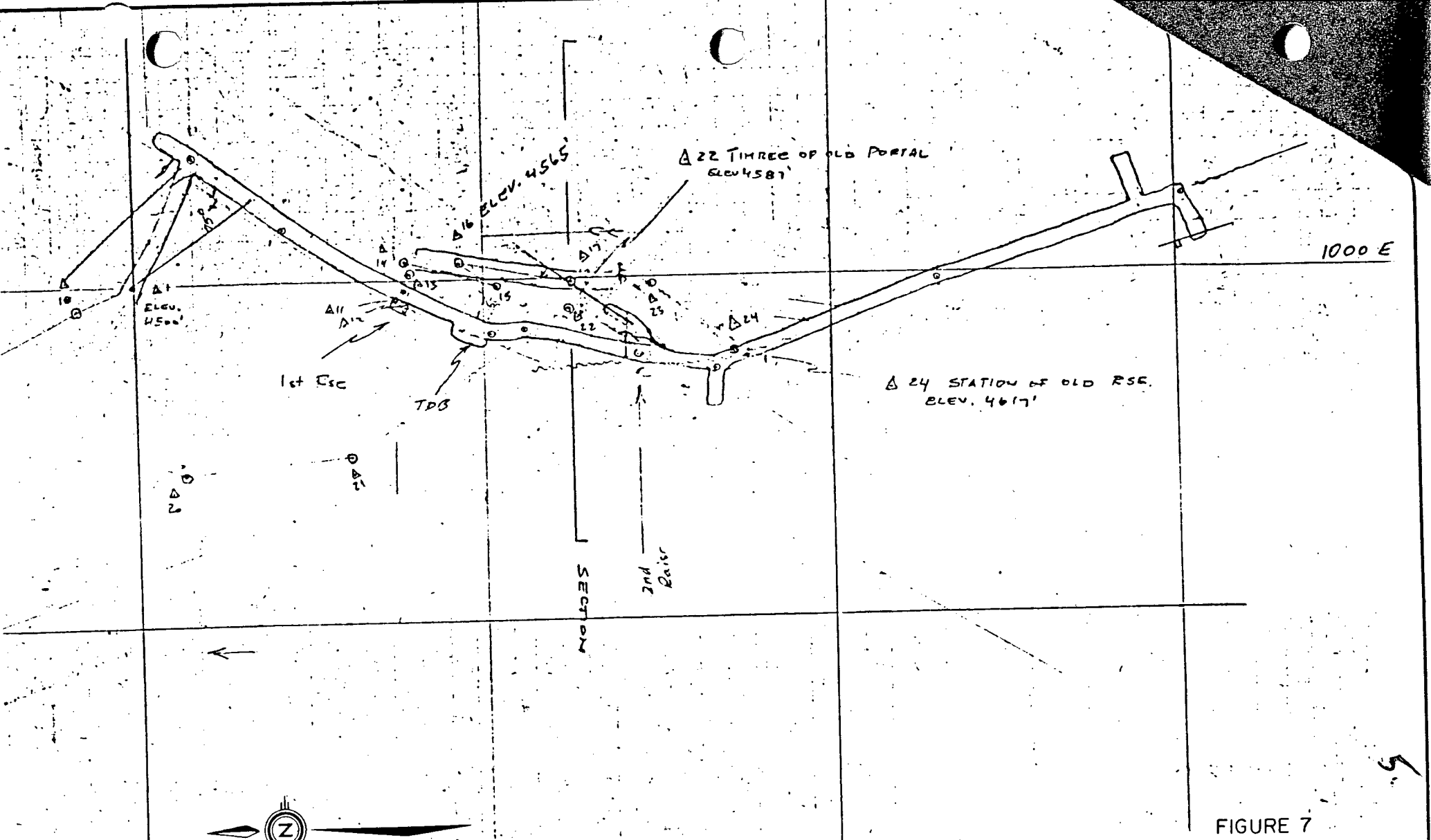

FIGURE 7

PLAN OF UNDERGROUND WORKINGS
GRANT CLAIM
(AFTER A PLAN SUBMITTED BY O. RILEY)
SCALE NOT GIVEN
AUGUST 12, 1983
DONALD W. TULLY, P. ENG.

Donald W. Tully

1000 N

GEOLOGY

Tetrahedrite, with occasional grains of fine pyrite or marcasite, galena and sphalerite, were the sulphide minerals observed in the above samples.

The samples, taken at locations (2) and (4), are from vein structures that are probably parallel or sub-parallel to those vein structures in the underground workings in the mine area to the west.

The trenchings above the former underground working area are caved and do not appear to have exposed the surface bedrock.

The geological structure in the shales and calcareous slate horizon in the outcrops immediately east of the (lower) portal show a north-south-trending structure and dipping nearly vertical. Dragfolding was noted near sample location (4) and this structural feature may be a control for the emplacement of the quartz veins.

O. Riley and M. Linn, B.Sc., performed a reconnaissance geochemical survey, geological mapping and rock sampling during June and July, 1983, over the immediately east and north areas of the underground mine workings. The results of their work are shown on Figure 8 and in the APPENDIX to this report. Thirty-eight soil samples were analyzed. Four anomalous results for silver, eight anomalous results for lead, and one for copper, were obtained. Six rock samples were taken. One of these rock samples assayed 129.53 ounces of silver.

7.e.

Approximately 100 metres to the northeast of the (lower) portal at sample location (4), a similar white porcelaneous vein of quartz was found in situ, striking at 195° and dipping some 70° west across a width of some 60 cm (2 feet) at about the same elevation. The rock is a black argillite.

At elevation 4,600 feet, a zone of carbonate alteration in a greywacke sediment with a central quartz veinlet was exposed at sample location (2) across a width of about 6 cm. This vein, which is located about 65 metres east of the (lower) portal, strikes about 175° and dips vertically.

The assay results of the samples taken at the above-noted locations and shown on Figure 8, were as follows:

<u>Sample Location</u>	<u>Previous Sample Result</u>	<u>Sample Result by D.W. Tully</u>
(1)	-	0.003 ozs gold
	0.04 ozs silver	2.43 ozs silver
	-	0.011% copper
	0.01% lead	0.27% lead
	0.04% zinc	0.37% zinc
(4)	-	0.005 ozs gold
	30.30 ozs silver	5.97 ozs silver
	-	0.58% copper
	0.14% lead	0.44% lead
	0.28% zinc	0.51% zinc
(2)	-	0.003 ozs gold
	8.65 ozs silver	0.47 ozs silver
	-	0.003% copper
	0.63% lead	0.034% lead
	0.41% zinc	0.037% zinc

SAMPLE PLAN
FOR
DRAGON SOUTH
MARGARET
CLAIMS

DS 1 - 25
PE 16 - 24



Wheeler Lake
← Trail

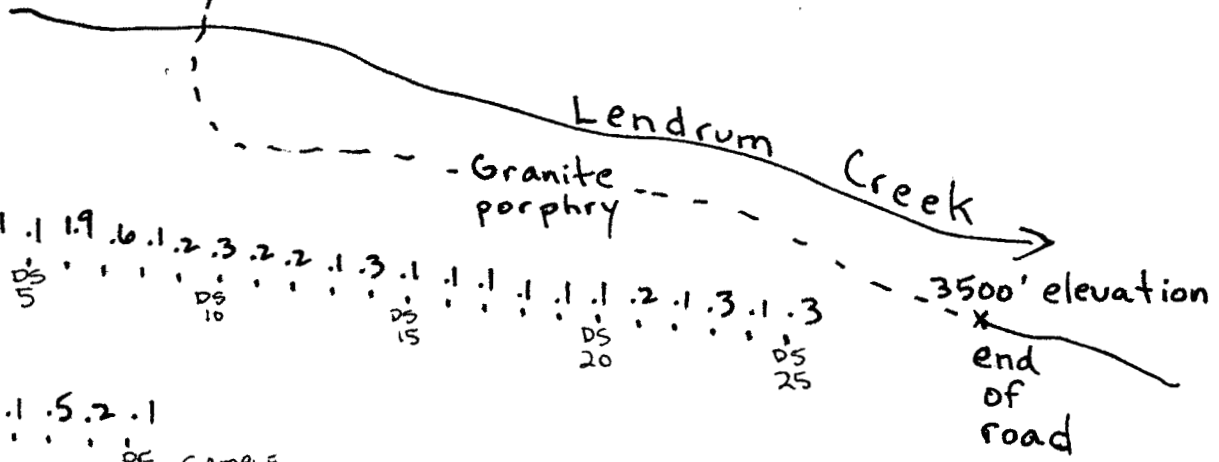

5	.5	.5	.1	.1	1.9	.6	.1	.2	.3	.2	.2	.1	.3	.1	.1	.1	.1	.1	.2	.1	.3	.1	.3	
DS 1					DS 5				DS 10					DS 15					DS 20				DS 25	
SAMPLE NUMBER																								
.3	.1	.1	.1	.1	.1	.5	.2	.1																
PE 24									PE 16	SAMPLE NUMBER														

SCALE
50 0 50 100 150
1 cm = 50 m.

AG PPM
DRAGON SOUTH MARGARET CLAIMS
JUNE 10, 1994
MIKE LINN B.Sc.

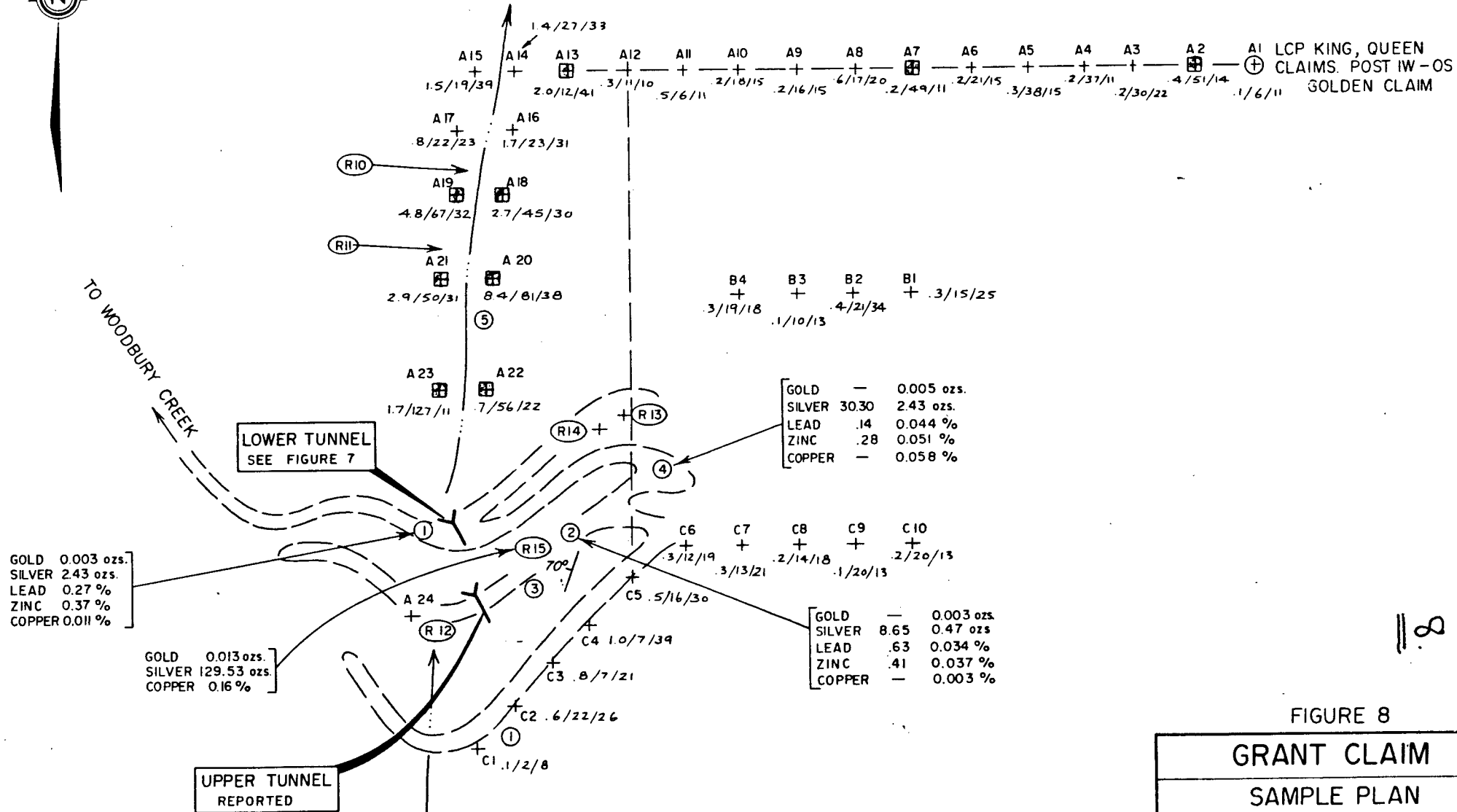

FIGURE 8

GRANT CLAIM
SAMPLE PLAN (AFTER O. RILEY-M. LIN)
SLOCAN MINING DIVISION
SCALE 1 : 250
AUGUST 12, 1983
DONALD W. TULLY, P. ENG.

Donald W. Tully
(All locations subject to survey)

GRANT

Mine Area

LEGEND

- ① Grey limestone
- ② Siliceous limestone
- ③ Quartzite
- ④ Grey argillite
- ⑤ Red granite
- ⑥ Limy schist
- ⑦ Quartz vein
- ⑧ Siliceous dyke

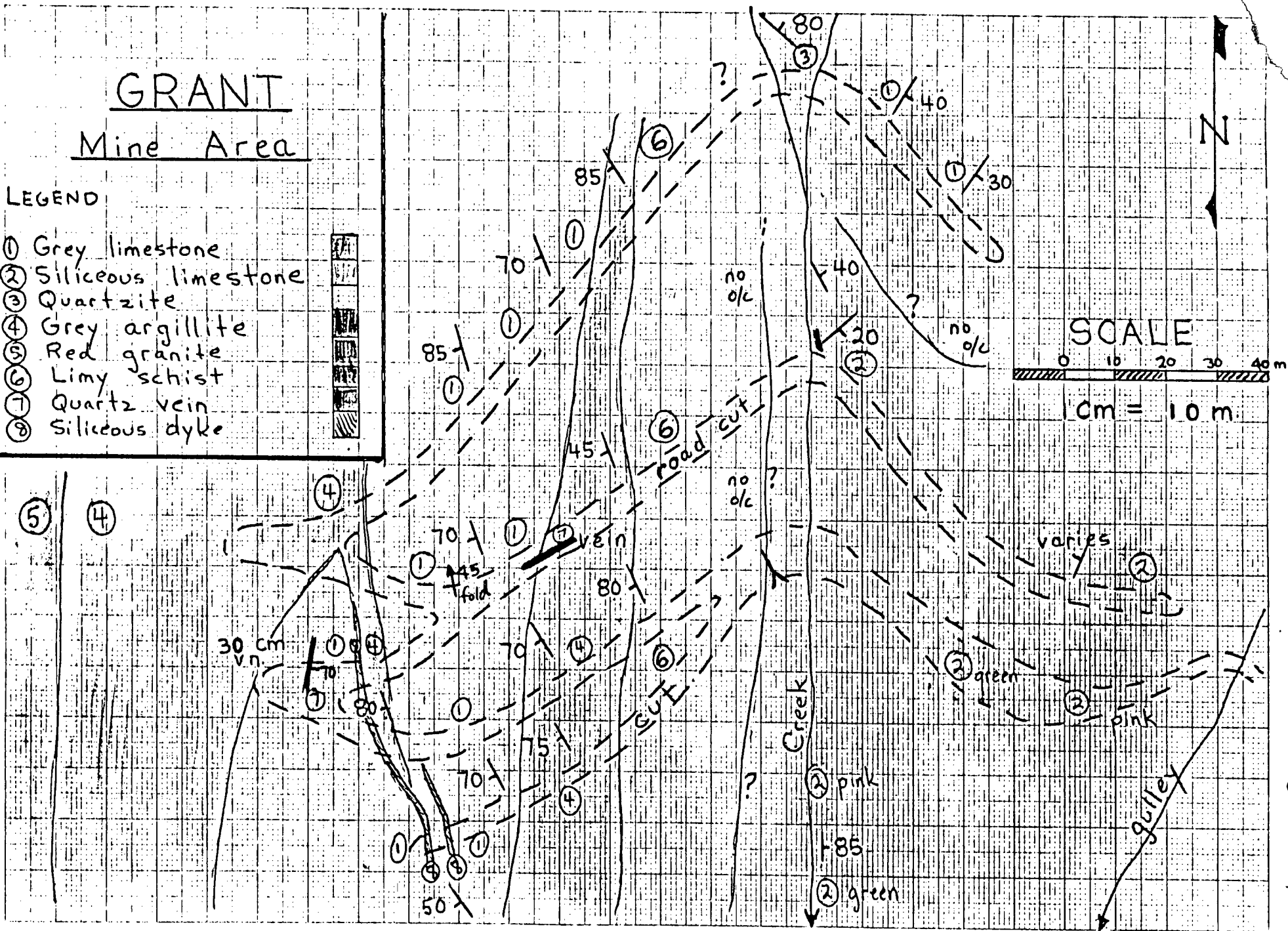

CERTIFICATE

I, Michael Linn, of the Corporation of the Village of Kaslo, Province of British Columbia, hereby certify as follows;

1. I am a Consulting Geologist with an office on Arena Avenue, Kaslo, B. C.
2. I graduated with a degree of Bachelor of Science, Majors in Geology, from U. B. C. in 1970.
3. I have practiced my profession for 14 years.
4. This report is based on a personal examination of the claims during the past year.
5. DATED at Kaslo, Province of British Columbia, July 11, 1984.

Michael J. Linn
Geologist

COST STATEMENT

ROCK AND SOIL SAMPLING, PUTTING IN GRID 15 MAN DAYS AT \$125 PER DAY	\$1875
TRUCK EXPENSE, 10 DAYS AT \$20 PER DAY	.\$200
ASSAYS	\$412.25
ROAD WORK WITH JOHN DEERE LOADER	\$2000.
TOTAL	\$4487.25

ACME ANALYTICAL LABORATORIES LTD.
 852 E. HASTINGS, VANCOUVER B.C.
 PH: 253-3158 TELEX: 04-53124

DATE RECEIVED AUG 26 1983

DATE REPORTS MAILED Aug 29/83

ICP GEOCHEMICAL ANALYSIS

A .500 GRAM SAMPLE IS DIGESTED WITH 3 ML OF 3:1:3 HCL TO HNO3 TO H2O AT 90 DEG.C. FOR 1 HOUR.
 THE SAMPLE IS DILUTED TO 10 MLS WITH WATER.
 THIS LEACH IS PARTIAL FOR: Ca, P, Mg, Al, Ti, La, Na, K, W, Ba, Si, Sr, Cr AND B. Au DETECTION 3 ppm.
 AU* ANALYSIS BY AA FROM 10 GRAM SAMPLE.
 SAMPLE TYPE - SOIL

ASSAYER Dean Toye DEAN TOYE, CERTIFIED B.C. ASSAYER

GOLDEN DRAGON FILE # 83-1862

PAGE# 1

SAMPLE	CU ppm	ZN ppm	AG ppm	AS ppm	Au* ppb
DS-1	16	70	.5	15	20
DS-2	8	152	.5	3	5
DS-3	6	81	.5	6	5
DS-4	3	62	.1	5	5
DS-5	7	118	.1	8	5
DS-6	6	65	1.9	3	5
DS-7	7	124	.6	4	5
DS-8	5	59	.1	4	5
DS-9	7	89	.2	8	5
DS-10	8	102	.3	10	5
DS-11	5	67	.2	11	5
DS-12	12	92	.2	11	5
DS-13	7	173	.1	7	5
DS-14	4	87	.3	6	5
DS-15	5	59	.1	5	5
DS-16	10	95	.1	6	5
DS-17	3	43	.1	6	5
DS-18	8	57	.1	4	5
DS-19	5	81	.1	5	5
DS-20	4	54	.1	3	5
DS-21	5	69	.2	5	5
DS-22	4	56	.1	2	5
DS-23	6	87	.3	3	5
DS-24	5	73	.1	3	5
DS-25	7	107	.3	3	5
FE-16	8	104	.3	2	5
FE-17	10	124	.1	7	5
FE-18	6	73	.1	4	10
FE-19	4	55	.1	3	5
FE-20	4	72	.1	3	5
FE-21	4	51	.1	5	5
FE-22	5	62	.5	4	5
FE-23	7	135	.2	6	5
FE-24	5	113	.1	4	5
STD A-1/AU 0.5	30	183	.3	10	490

Samples sent down mine from Golden Dragon & the lab - class

ASSAY 12

ACME ANALYTICAL LABORATORIES LTD. 852 E. HASTINGS, VANCOUVER B.C. PH:253-3158 TELEX:04-53124

ICP GEOCHEMICAL ANALYSIS

A .500 GRAM SAMPLE IS DIGESTED WITH 3 ML OF 3:1:3 HCL TO HNO3 TO H2O AT 90 DEG.C. FOR 1 HOUR. THE SAMPLE IS DILUTED TO 10 MLS WITH WATER.
 THIS LEACH IS PARTIAL FOR: Ca, P, Mg, Al, Ti, La, Na, K, W, Ba, Si, Sr, Cr AND B. Au DETECTION 3 ppa.
 AUB ANALYSIS BY AA FROM 10 GRAM SAMPLE. SAMPLE TYPE - ROCK CHIPS

DATE RECEIVED AUG 15 1983 DATE REPORTS MAILED Aug 24/83 ASSAYER R. Toye DEAN TOYE, CERTIFIED B.C. ASSAYER

GOLDEN DRAGON RES FILE # 83-1639A

PAGE # 1

SAMPLE #	Mo	Cu	Pb	Zn	Ag	Ni	Co	Mn	Fe	As	U	Au	Th	Sr	Cd	Sb	Bi	V	Ca	P	La	Cr	Hg	Ba	Ti	B	Al	Na	K	M	Au1
	ppa	ppa	ppa	ppa	ppa	ppa	ppa	ppa	%	ppa	ppa	ppa	ppa	ppa	ppa	ppa	ppa	ppa	%	%	ppa	ppa	%	ppa	%	%	%	%	%	ppa	ppb
N1	1	2	3	56	.1	4	5	212	1.73	2	4	ND	2	24	1	2	2	36	.25	.05	2	6	.69	410	.16	3	1.15	.08	.58	2	5
N2	3	3	144	3	.9	18	2	212	.49	62	7	ND	2	2	1	5	4	3	.01	.01	2	20	.07	10	.01	4	.07	.02	.02	2	5
N3	1	10	8	26	.1	7	3	148	1.09	11	2	ND	2	75	1	3	2	22	4.76	.04	3	16	.38	99	.04	19	1.23	.15	.38	2	5
N4	1	2	2	33	.1	1	1	64	.51	2	11	ND	2	3	1	4	2	2	.05	.01	3	5	.05	26	.01	2	.29	.06	.14	2	5
N5	1	31	7	80	.1	8	6	240	3.73	5	2	ND	2	22	1	2	2	116	.52	.05	2	33	1.26	527	.24	3	2.41	.15	1.13	2	5

ACME ANALYTICAL LABORATORIES LTD.
 852 E. HASTINGS, VANCOUVER B.C.
 PH:253-3158 TELEX:04-53124

DATE RECEIVED AUG 15 1983

DATE REPORTS MAILED Aug 20/83

ASSAY CERTIFICATE

SAMPLE TYPE : ROCK - CRUSHED AND PRULVERTIZED TO -100 MESH.

ASSAYER R. Toye DEAN TOYE, CERTIFIED B.C. ASSAYER

GOLDEN DRAGON RESOURCES FILE # 83-1639B PAGE# 1

SAMPLE	PE	ZN	AG	AU
	%	%	OZ/TON	OZ/TON
ROCK	29.20	5.98	13.75	.016