

84-#913 - 12774 7/85

A
REPORT
ON THE
DIAMOND DRILLING PROGRAMME
ON THE
ENERGITE CLAIMS

81785 - 90 Incl., 98209 - 10 69696 - 99
90014 - 15, 98211 - 28, 98381 - 88

NORTH BARRIERE LAKE AREA
KAMLOOPS MINING DIVISION
BRITISH COLUMBIA

FOR
KAM CREED MINES LIMITED

BY
C.T. PASIEKA, P.Eng.

October 10, 1984

Co-ordinates

51° 21' N
119° 58' W

Reference Sheet

B2M/5W

**GEOLOGICAL BRANCH
ASSESSMENT REPORT**

12,774

C. T. Pasieka P.Eng.

BOX 175, MAIN POSTAL STATION

KAMLOOPS, B.C. V2C 5K6

TABLE OF CONTENTS

1. Summary	Page One
2. Property	Page One and Two
3. Location and Access	Page Two
4. Topography and Vegetation	Page Two
5. Geology	Page Two and Three
6. Diamond Drilling Programme	Page Three
7. Discussion Of Results	Page Three and Four
8. Conclusions	Page Four and Five

Appendix

Certification

Bibliography

Drill logs

Maps

A
REPORT
ON THE
DIAMOND DRILLING PROGRAMME
ON THE
ENERGITE CLAIMS

81785 - 90 Incl., 98209 - 10 69696 - 99

90014 - 15, 98211 - 28, 98381 - 88

NORTH BARRIERE LAKE AREA

KAMLOOPS MINING DIVISION

BRITISH COLUMBIA

FOR

KAM CREED MINES LIMITED

BY

C.T. PASIEKA, P.Eng.

October 10, 1984

Co-ordinates 51° 21' N
 119° 51' W

Reference Sheet 82M/5W

SUMMARY

The Energite Group of claims held by Kam Creed Mines Ltd., consists of forty contiguous located mineral claims, located at the headwaters of Birk Creek, North Barriere Lake Area, Kamloops Mining Division, British Columbia. The geological environment is that of a series of metasediments and metavolcanics of the Sushwap Metamorphic Complex. Silicified shear zones and faults transecting the metasediments, have yielded significant values in silver, lead, zinc and gold.

The property was subjected to geochemical and electromagnetic surveys over the central portion and yielded several conductive axes with either co-incident or parallel geochemical anomalies. A programme of diamond drilling was instigated in an attempt to determine the causative factors relative to the conductive axes and to sample any mineralization present. The E.M. conductors are apparently due to a conductive carbonaceous shale, some what brecciated, silicified and with a variable sulphide content. The breccia where impregnated with silica may on occasion, carry sulphides and gold mineralization.

PROPERTY

The Energite Group consists of some forty located contiguous mineral claims as follows:

Energite	1-6 incl.	Record Numbers	81785-90 incl.
Energite	7-8	Record Numbers	98209-10
Energite	9-12 incl.	Record Numbers	69696-99 incl.
Energite	13-14	Record Numbers	90014-15
Energite	15-32 incl.	Record Numbers	98211-28 incl.
Energite	33-40	Record Numbers	98381-88 incl.

(2)

These claims are situate in the North Barriere Lake Area, Kamloops Mining Division, British Columbia.

LOCATION AND ACCESS

The Energite Group is located at the headwaters of Birk Creek, on the north slope of the North Barriere Lake Valley. The property is situate some 46 Km. N.E. of Barriere, British Columbia, which is in turn, 66 Km. North of Kamloops, British Columbia. Focile vehicular access to the property is available by means of the North Barriere Lake road and thence by means of several logging road, which traverse the property itself.

TOPOGRAPHY AND VEGETATION

The surface presented by the property is roughly rolling, with elevations varying from 1,050 M. to 1,500 M., A.S.L. Along the tributaries of Birk Creek, some precipitous banks may be encountered. Over burden is generally light at higher elevations and with heavier over burden in the valleys and on the terraces in the N.E. quadrand of the property. Timber cover is extensive with most areas supporting stands of spruce, fir and cedar, with intermittant areas of alder and second growth spruce and pine.

GEOLOGY

The rocks underlying the area of the property are members of the Shuswap Metamorphic Complex and consist of metasediments and metavolcanics, i.e. limestones, shales, quartzites and greenstones. The general strike of the original sedimentary series is N.N.W., with local variations from the norm. Dips vary from -50° to the N.E. to vertical.

C. J. Pasieka P.Eng.

BOX 175, MAIN POSTAL STATION

KAMLOOPS, B.C. V2C 5K6

(3)

To the Northwest and East of the property, occur outcrops of diorites and granites. These recent intrusives are thought to be the source of the silicification of discordant shear zones and joints occurring within the limits of the property. The quartz present in the joints and shear zones frequently carries sulphides, mostly pyrite, but frequently galena and sphalerite. These sulphides are in part, primary such as the cubed cubes of pyrite in the carbonaceous shales. More frequently, the sulphides are obviously secondary as they occur in the silicified shear zones and brecciated carbonaceous shales.

DIAMOND DRILLING PROGRAMME

During the month of May 1984, a preliminary drill programme of 673' (204m.), of B.Q. Wireline drilling was carried out by P.W. Diamond Drilling of Barriere, British Columbia, on the Energite claim group for Kam Kreed Mines Ltd. A longyear Model 34 was used for the drilling itself and the core is stored in a field trailer near the centre of the property.

The commencement of the programme was some what delayed due to excessive snow, however, acceptable progress was made once entry to the drillsite was gained. Core recovery was excellent with the exception of the interval 180-198 in Hole No. BC-84-1.

DISCUSSION OF RESULTS

Hole No. BC-84-1 was sited at O+75W, 5+25S and drilled westerly in an attempt to determine the causitive factors of a conductive axis, indicated by a previously conduted electro-magnetic survey. Several sections of a carbonaceous shale were sectioned. This shale is somewhat conductive and graphitic.

(4)

In addition, pyrite is ubiquitous in the same formation. These two factors could adequately account for the E.M. conductor.

Hole No. BC-84-2 was collared from the same location and drilled to the N.W. in an attempt to section and sample at depth massive quartz veins observed on surface to the north of the drill site. Quartz veins of the character observed on surface, were not encountered in the drill hole and suggests that the hole terminated short of its target or that the quartz veins observed surface change dip at depth. It is recommended that the hole be deepened.

In Hole No BC-84-1 several short sections of carbonaceous shale containing disseminated to massive sulphides yielded significant values ie. 331.2

331.2-332	.166 Av.	.05 Ag.
332-333	.407 Av.	.12 Ag.

In addition a section of pale green quartzite from 342-347 yielded .16 Av and .03 Ag.

CONCLUSIONS

Sulphide mineralization, mainly iron pyrite, carried by quartz in the carbonaceous shale yielded significant values in gold and nominal values in silver. A five foot section of pale green colored quartzite yielded significant values ie 0.16/ton Av suggesting that the entire section from 342' to 466' be sampled.

The presence of disseminated to massive sulphides in Hole BC-84-1 coupled with the moderate conductivity of the carbonaceous shale offers a plausible reason for the electro-magnetic anomaly present as indicated by a previously conducted E.M. survey.

It is recommended that the drilling programme be extended to include delineation of mineralized structures observed on surface

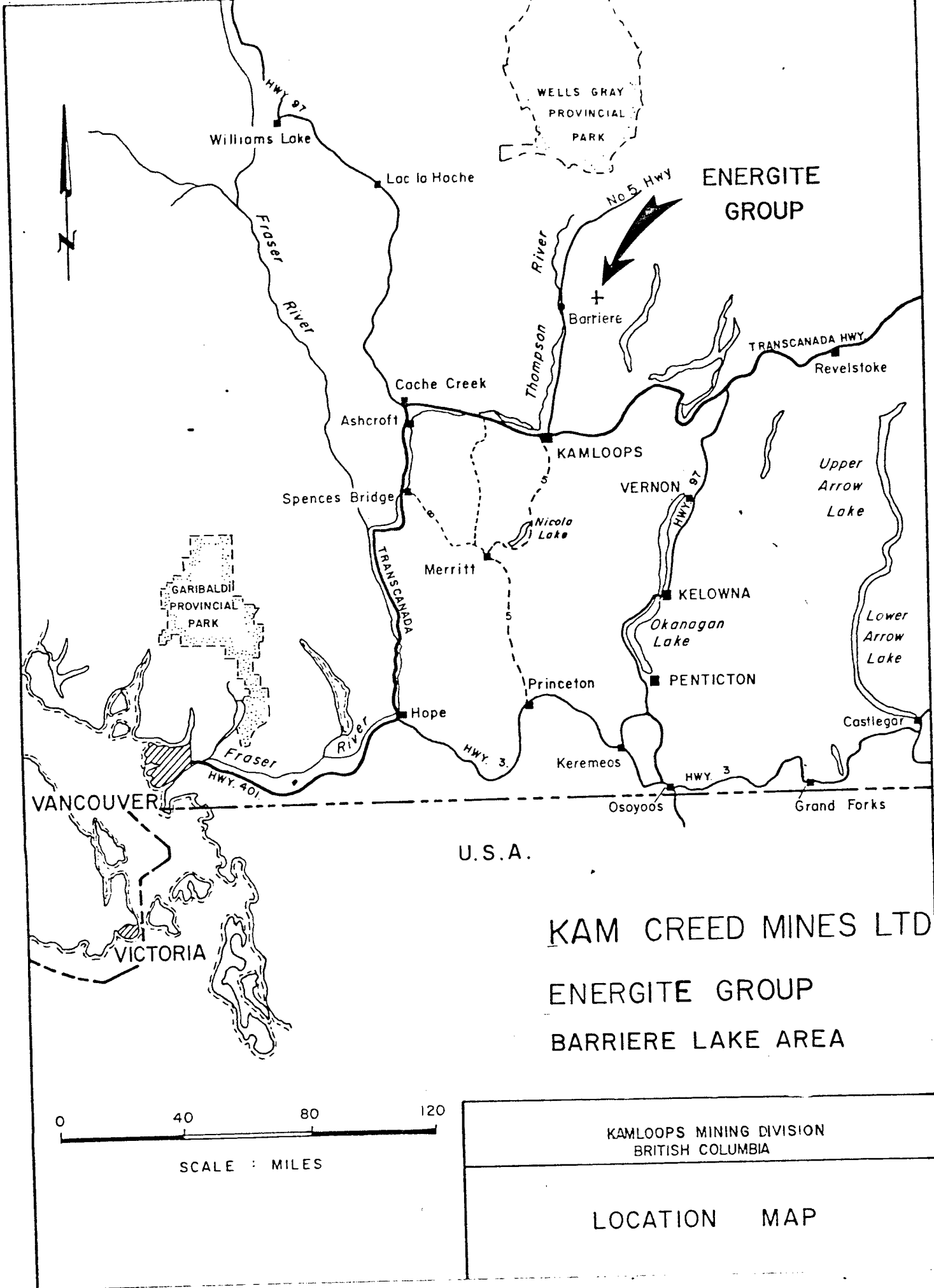

WELLS GRAY
PROVINCIAL
PARK

ENERGITE
GROUP

Upper
Arrow
Lake

Lower
Arrow
Lake

GARIBALDI
PROVINCIAL
PARK

U.S.A.

KAM CREED MINES LTD
ENERGITE GROUP
BARRIERE LAKE AREA



KAMLOOPS MINING DIVISION
BRITISH COLUMBIA

LOCATION MAP

(5)

and mineralized sections indicated during the current drilling.

Respectfully,

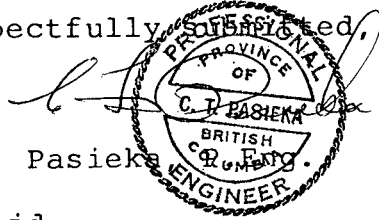

C.T. Pasieka

CTP:jd

lost: contract price, 673 ft @ $\$25.00/\text{ft.} = \16825

RET.

Certification

I, Clemens Terence Pasieka, of the City of Vancouver, in the Province of British Columbia, hereby certify that:

1. I am a geologist and reside at 219-4675 Valley Drive, Vancouver, B.C.
2. I am a graduate of University College, Dublin. B.Sc.1963
3. I have been practicing my profession as a geologist for twenty-one years.
4. I am a member of the Association of Professional Engineers of the Provinces of Alberta, Saskatchewan and British Columbia.
5. I have no interest directly or indirectly in the property or securities of Kam-Creed Mines Ltd. nor do I expect to receive any such interest.
6. That this report is based on data from work carried out on the property under my supervision, inclusive of several visits to the property and from private and published government reports relevant to the area.

Dated this 10th day of October, 1984 in the City of Vancouver, Province of British Columbia.

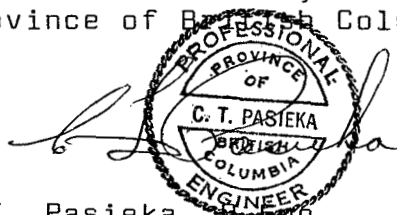

C.T. Pasieka, P.Eng.

CTP:jd

C. T. Pasieka P.Eng.

BOX 175, MAIN POSTAL STATION

KAMLOOPS, B.C. V2C 5K6

Bibliography

1. Reports of the Minister of Mines, B.C. 1934, 1936
2. Report on Birk Creek Property, W.H.Pierre, P.Eng., Aug. 1972
3. Report on Energite Claims, G.E.A. vanRosen, P.Eng., Sept. 1974
4. Report on Energite Group, C.T. Pasieka, P.Eng. Oct. 1980

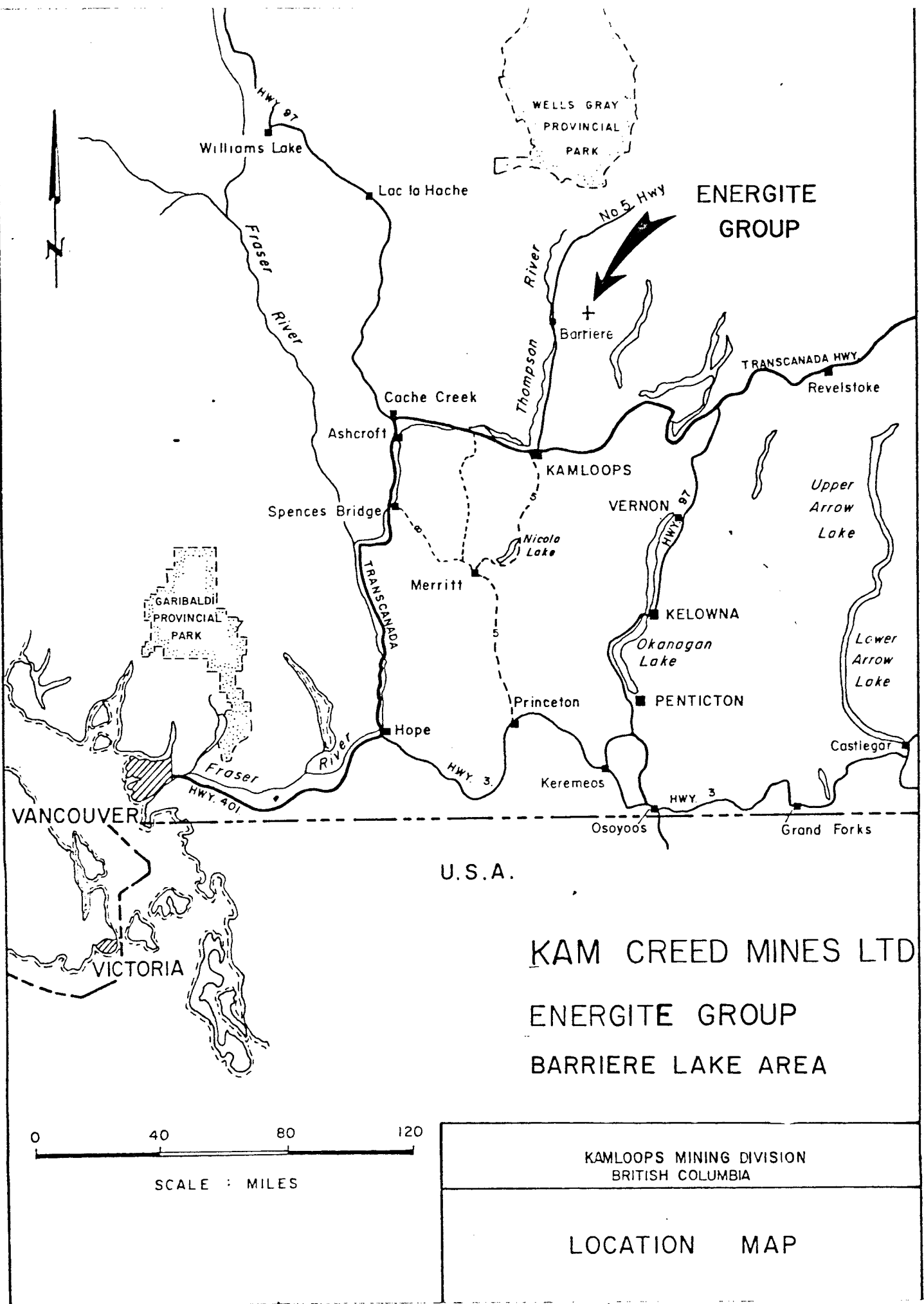

ENERGITE GROUP

**KAM CREED MINES LTD
ENERGITE GROUP
BARRIERE LAKE AREA**



KAMLOOPS MINING DIVISION
BRITISH COLUMBIA

LOCATION MAP

82 M SW

3
1 KM

2
N

1

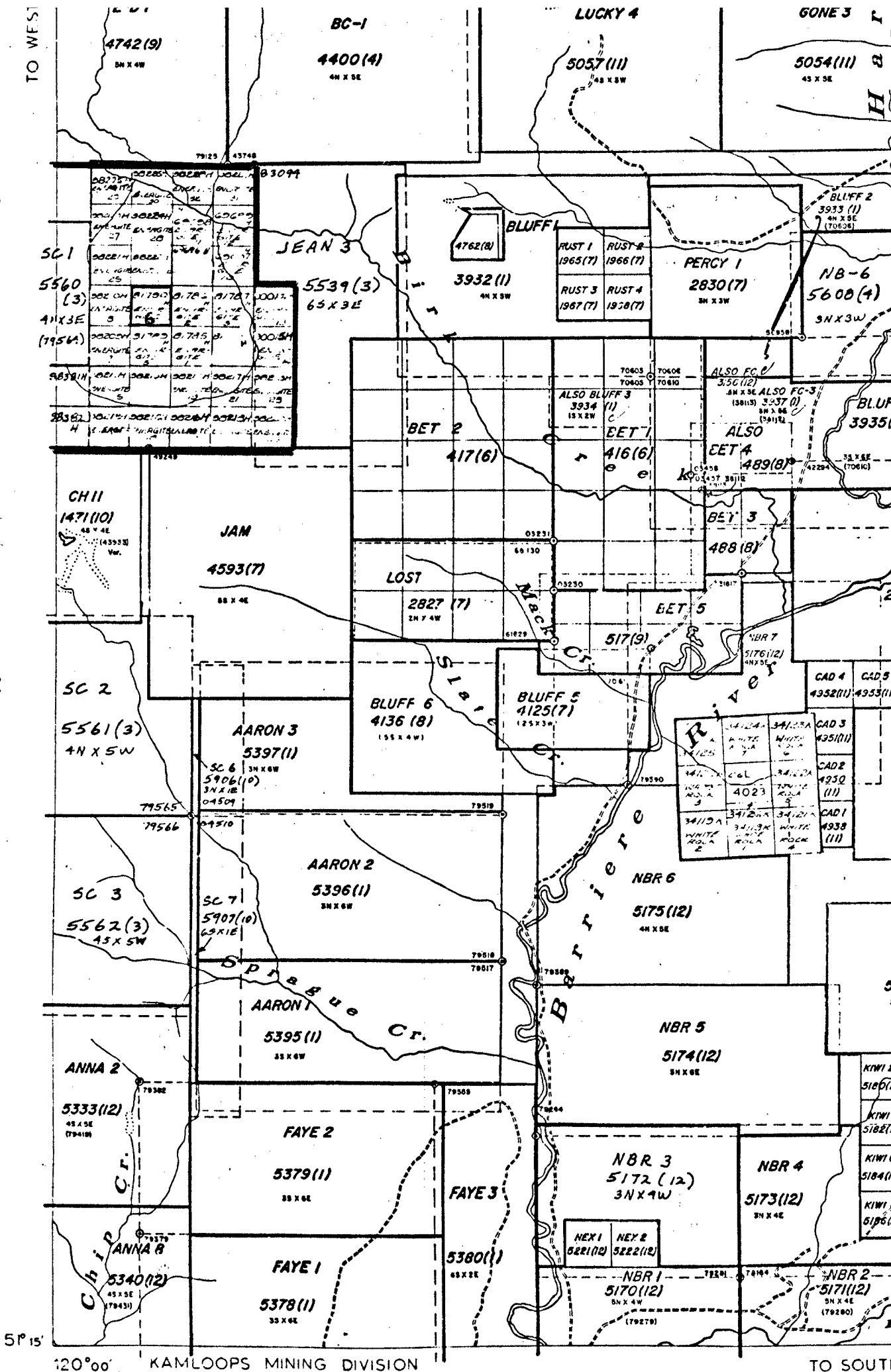

BARRIER

PROVINCIAL

FOREST

EM CONDUCTIVE AXIS

ENERGITE GROUP

INITIAL DRILL SECTION

ENERGITE GROUP
KAM CREED MINES LTD
KAMLOORS MINING DIVISION
BRITISH COLUMBIA

SCALE 1:50 000 SHEET 82 M/5

