

84-#640 - 12895  
6/85

**GEOLOGICAL BRANCH  
ASSESSMENT REPORT**

**12,895**  
A REPORT

ON

A GEOPHYSICAL REPORT

Trout Lake Area, British Columbia  
(50°, 50' N., 117° 40' W)  
N.T.S. 83K/13E

Claims surveyed: DOE, VIK

Survey Dates: June 6th -  
" 12th, 84

FOR

WINDFLOWER MINING LTD.

Vancouver, B.C.

BY

PETER E. WALCOTT & ASSOC. LTD.  
Vancouver, B.C.

JUNE 1984

GEOPHYSICAL SERVICES

TABLE OF CONTENTS.

	<u>Page</u>
INTRODUCTION .....	1
PURPOSE .....	2
SURVEY SPECIFICATIONS .....	3
DISCUSSION OF RESULTS .....	4
SUMMARY, CONCLUSIONS & RECOMMENDATIONS .....	5

APPENDIX

COST OF SURVEY .....	i
PERSONNEL EMPLOYED ON SURVEY .....	ii
CERTIFICATION .....	iii

ACCOMPANYING MAPS - Scale 1:1250

MAP POCKET

PROFILES OF IN & OUT OF PHASE .....	W-346-1
CONTOURS OF TOTAL FIELD INTENSITY .....	W-346-2

INTRODUCTION.

Between June 6th and 13th, 1984, Peter E. Walcott & Associates Limited carried out a limited V.L.F. electromagnetic and magnetic survey over a property located in the Trout Lake area of British Columbia for Windflower Mining Ltd.

The survey was carried out over flagged N 58° E lines 30 metres apart off a N 32°W cut baseline.

Readings of in phase and quadrature were made every 25 metres along the lines using the Cutler, Maine transmission station as the primary source of the magnetic field. In addition readings of the total intensity of the earth's magnetic field were also obtained using a proton magnetometer.

The data are presented in profile form in the case of the E.M. data and contour form for the magnetic data on Maps W-346-1 & 2 that accompany this report.

PURPOSE.

The purpose of the survey was to (1) do the necessary assessment work to hold the property and (2) to see if it was possible to locate any shear zones that might contain gold mineralization.

SURVEY SPECIFICATIONS.

The basic principle of any electromagnetic survey is that when conductors are subjected to primary alternating fields secondary magnetic fields are induced in them. Measurements of these secondary fields give indications as to the size, shape and conductivity of conductors. In the absence of conductors no secondary fields are obtained.

The electromagnetic survey was carried out using a Ronka E.M. 16 reconnaissance electromagnetic unit. This unit utilizes the V.L.F. radio stations that exist for submarine communications. Their vertical antennae create concentric horizontal primary magnetic fields and the receiver, i.e. the E.M. 16 unit, measures the vertical components of the secondary fields that might be induced by the primary ones.

The magnetic survey was carried out using an EDA Omni IV proton magnetometer. This instrument makes measurements of the total intensity of the earth's field to an accuracy of  $\pm 1$  gamma. Corrections for diurnal variations were made by monitoring the field at a single station using an EDA PPM 400 proton magnetometer.

In all some 12 kilometres of E.M. and magnetometer work were completed.

DISCUSSION OF RESULTS.

As the baseline bearing turned out to be  $30^{\circ}$  off advised and as the E.M. 16 unit available at short notice was only equipped with two crystals, Seattle and Maine - the transmitter direction of which faced  $13$  and  $16^{\circ}$  respectively off the lines - the readings from corresponding stations on each line were plotted to obtain the E.M. profiles i.e. lines 25 metres apart and 30 metre readings shown on Map W-346-1.

A perusal of this map shows a few northerly trending conductors that could be attributable to shear zones.

The magnetic survey data was essentially flat with the slight activity in the southern corner due to the greenstone of the Gowett formation.

SUMMARY, CONCLUSIONS & RECOMMENDATIONS.

Between June 6th and 12th, 1984, Peter E. Walcott & Associates Limited carried out a limited V.L.F. E.M. and magnetic assessment survey for Windflower Mining Limited over their Trout Lake property.

The E.M. results showed the presence of a few conductive trends that could be due to shear zones.

The locations of these should be correlated with the known geology with an eye to further exploration.

Respectfully submitted,

PETER E. WALCOTT & ASSOCIATES LIMITED

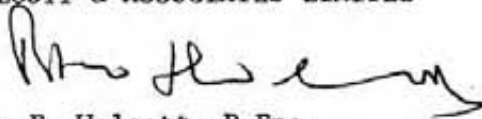
  
Peter E. Walcott, P.Eng.  
Geophysicist

Vancouver, B.C.

June 1984

A P P E N D I X



COST OF SURVEY.

Peter E. Walcott & Associates Limited undertook the survey on a daily basis. Mobilization and reporting costs were extra so that the total cost of the survey was \$6,500.00.

G. Ryznar, PEng., 4405 Glencanyon Dr., North Vancouver, B.C., V7N 4B4

DATE: June 9, 1984

TO: Windflower Mining Ltd.  
4405 Glencanyon Dr.  
North Vancouver, B.C.  
V7N 4B4

INVOICE RE: Goldfinch Group of Claims, Revelstoke M.D., B.C,  
Supervision & Orientation of Geophysical Crew  
June 6/84 - June 9/84

Consultants Fees, G. Ryznar P.Eng, 4 days @\$400	\$1600
Expenses- Daily Living Allowance - 4 days @\$ 75	\$ 300
Transportation Costs	
Truck, four wheel drive 1 week	\$300
Fuel for vehicle	<u>\$ 55.95</u>
	\$355.95
Long distance charges & miscellaneous costs	<u>\$ 40.00</u>
Total This Invoice	\$2295.95

  
G. Ryznar, PEng.

**PETER E. WALCOTT & ASSOC. LTD.**

605 RUTLAND COURT, COQUITLAM, B.C. V3J 3T8 • TEL. 939-0383

I N V O I C E

NO. 1657

Date: June 11th, 1984

Terms: NET 30 DAYS

To: WINDFLOWER MINING LTD.  
4405 Glencanyon Drive,  
North Vancouver, B.C.  
V7N 4E4

Re: E.M. & Mag Survey, Goldfinch Group, Revelstoke Area, B.C.

1. Provision of two operators, V.L.F. E.M. equipment, magnetometer and base recorder, room and board, 4 wheel drive vehicles; period 6th - 11th June = 6 days at \$785.00 per day

\$4,710.00

Project W-345

INVOICE NO. 1657

Please note interest will be charged at the rate of 1 1/2% per month on all overdue accounts.

G  
E  
O  
P  
H  
Y  
S  
I  
C  
A  
L  
  
S  
E  
R  
V  
I  
C  
E  
S

TO WINDFLOWER MINING LTD, (NPL)  
 4405 GLEN CANYON DRIVE  
 NORTH VANCOUVER, B.C. V7N-4B4

FROM TRIATHLON MAPPING CORP.  
 DEPT. 2174 WILLINGDON AVE.  
 BURNABY BC V5C-5Z9  
 DATE 8<sup>TH</sup>/6<sup>TH</sup>/84

RE ATTENTION : GERALD RYZNAR INVOICE

MESSAGE

FOLD

PRODUCTION OF ONE DOUBLE MODEL ORTHOPHOTO  
 ONE DOUBLE MODEL DIGITAL ELEVATION  
 MODEL FOR THE PRODUCTION  
 OF A CONTOUR PLOT WITH A  
 20M CONTOUR INTERVAL.  
 THE FINAL PRODUCT - ONE COMPOSITE REPRODUCIBLE  
 FILM POSITIVE AT 1:5000

REPLY

DATE \_\_\_\_\_ 19\_\_

COST FOR THIS PROJECT TAXES INC ..... \$997.50

FOLD

PERSONNEL EMPLOYED ON SURVEY.

Name	Occupation	Address	Dates
Peter E. Walcott	Geophysicist	Peter E. Walcott & Assoc. 605 Rutland Court, Coquitlam, B.C. V3J 3T8	June 30th, 84
S. Gibbons	Geophysical Operator	"	June 6th - 13th, 1984
C. Speropolous	"	"	June 6th - 13th, 1984
R. Rollings	Drafting	R.W.R. Mineral Graphics 400 - 355 Burrard St., Vancouver, B.C. V6C 2G8	June 30th, 1984
J. Walcott	Typing	Peter E. Walcott & Assoc.	June 30th, 1984

CERTIFICATION.

I, Peter E. Walcott of the Municipality of Coquitlam, British Columbia, hereby certify that:

1. I am a Graduate of the University of Toronto in 1962 with a B.A.Sc. in Engineering Physics, Geophysics Option.
2. I have been practising my profession for the last twenty two years.
3. I am a member of the Association of Professional Engineers of British Columbia and Ontario.
4. I hold no interest, direct or indirect, in the securities or properties of Windflower Mining Limited, nor do I expect to receive any.

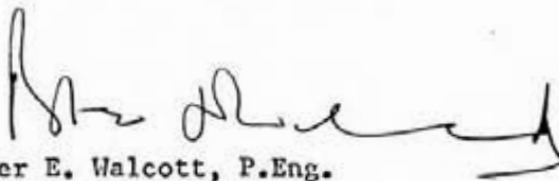
  
Peter E. Walcott, P.Eng.

Vancouver, B.C.

June 1984

117° 45'

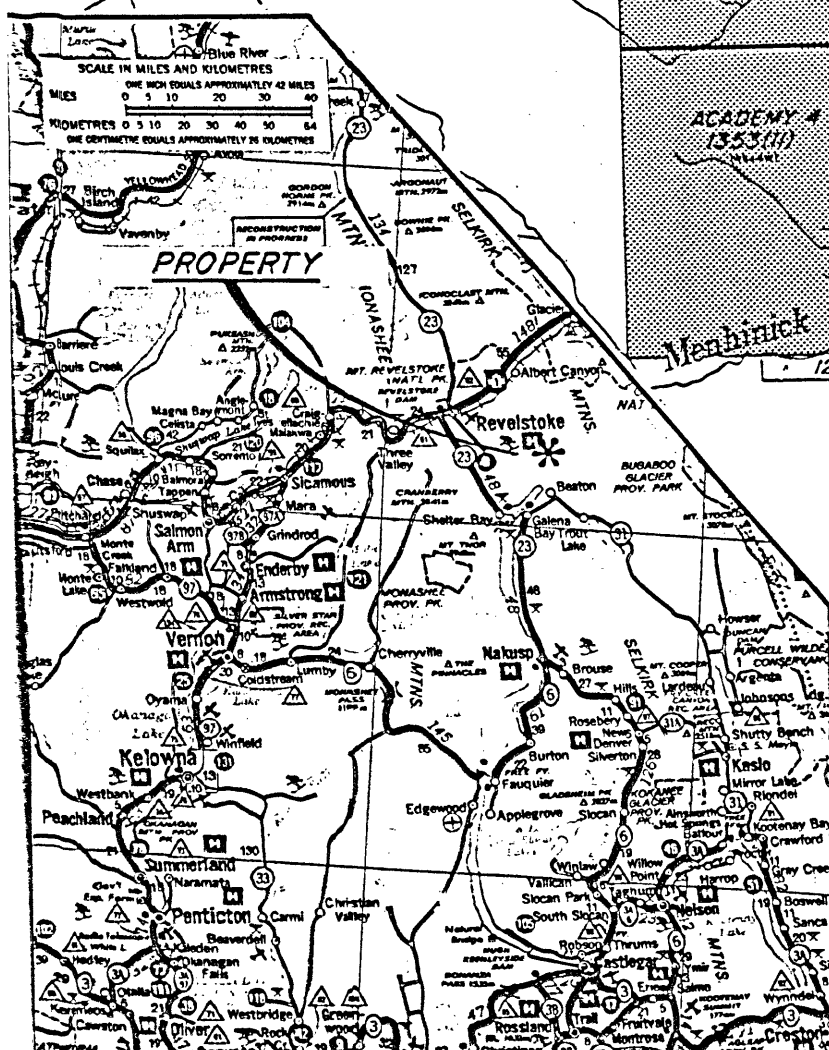
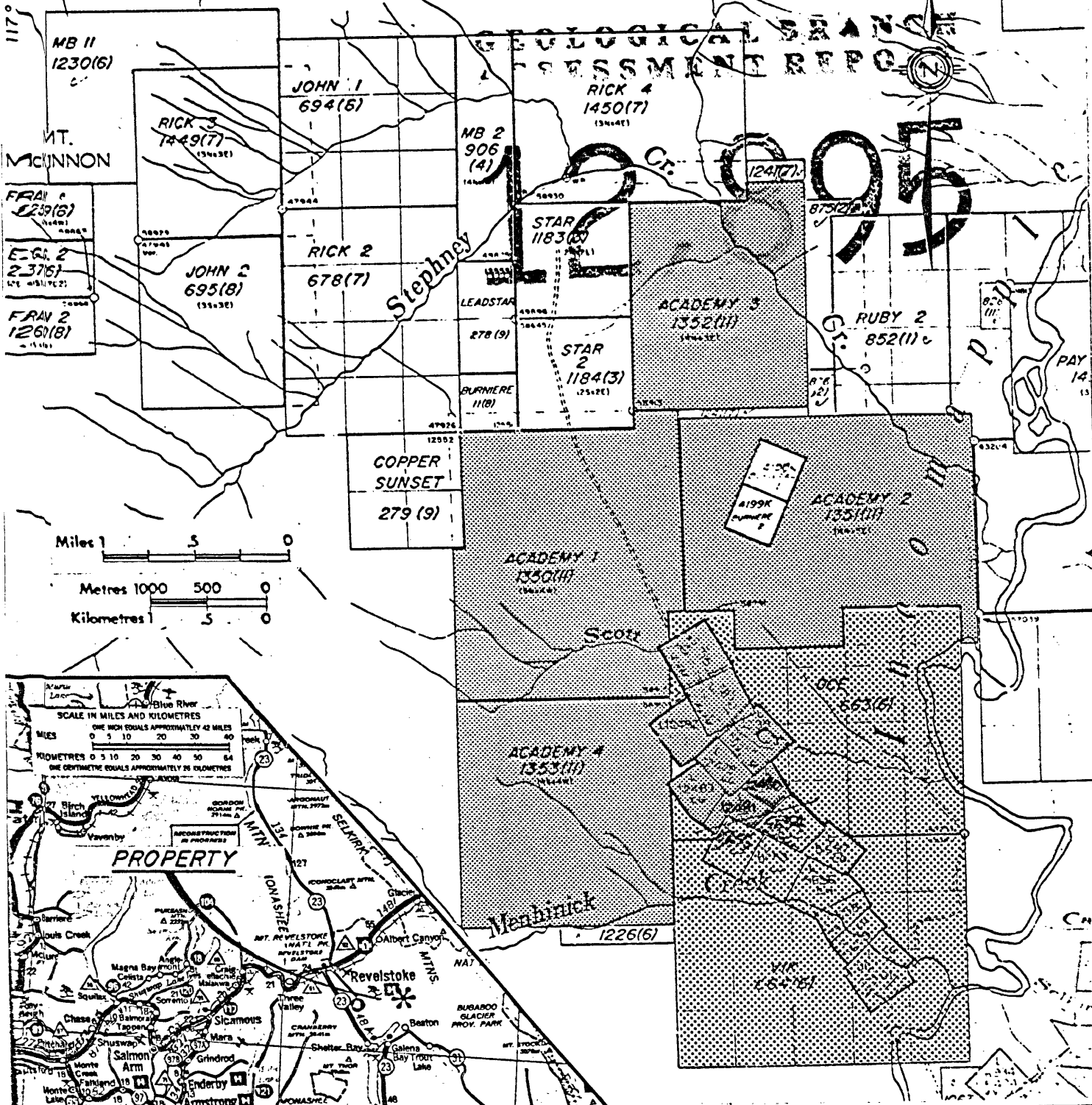

WINDFLOWER MINING LTD.  
 CLAIM & LOCATION MAP  
 GOLDFINCH PROPERTY  
 CAMBORNE, B.C.  
 N.T.S. 82K / 13E

SEPT. 21, 1983	SCALE 1:50000	No. 1
WAYLAND S. READ CONSULTING GEOLOGIST PENG COBBLE HILL, B.C.		

12,895

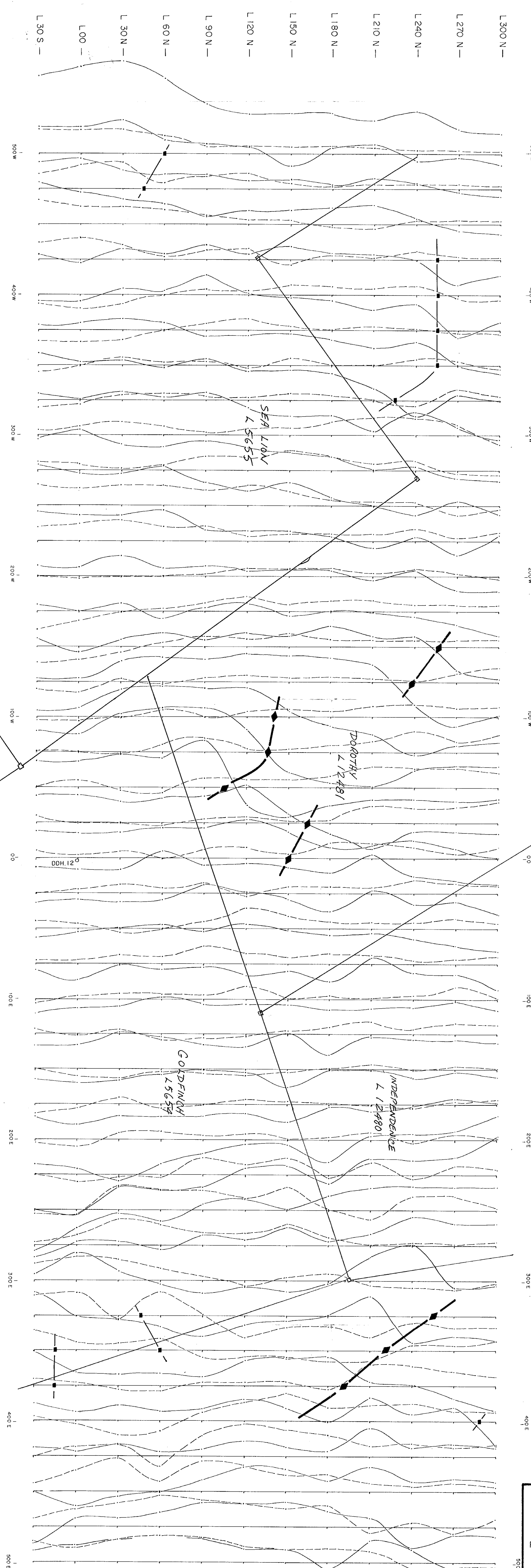

LEGEND:

- +20% — IN-PHASE PROFILE
  - +10% — QUADRATURE PROFILE
  - 0 —
  - STATION: CUTTLER MAINE, DIRECTION N 75° E
  - ◆ — EM CONDUCTOR AXIS
  - — EM TREND
  - — CROWN CRANT BOUNDARY
- NOTE: TO ACCOMPANY A REPORT BY  
PETER E. WALCOTT & ASSOCIATES LTD.

WINDFLOWER MINING LTD.  
GOLDFINCH PROPERTY REVELSTOKE M.D.-B.C.  
VLF  
ELECTROMAGNETIC SURVEY  
PROFILES OF IN-PHASE & QUADRATURE (%)

0 25 50 100 m  
SCALE 1:1250

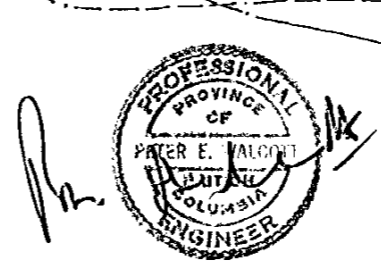



L 300 S —  
L 00 —  
L 30 N —  
L 60 N —  
L 90 N —  
L 120 N —  
L 150 N —  
L 180 N —  
L 210 N —  
L 240 N —  
L 270 N —  
L 300 N —



NOTE: TO ACCOMPANY A REPORT BY  
PETER E. WALCOTT & ASSOCIATES LTD.

— CROWN GRANT BOUNDARY

WINDFLOWER MINING LTD.  
GOLDFINCH PROPERTY REVELSTOKE M.D.-B.C.

MAGNETIC SURVEY  
CONTOURS OF TOTAL FIELD INTENSITY  
(GAMMAS)

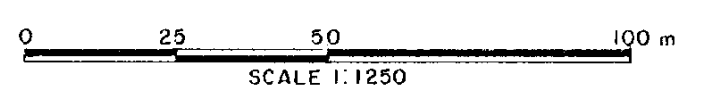

SURVEY BY PETER E. WALCOTT  
& ASSOCIATES LTD.  
JUNE 1984

MAP No. W 346-2

