

TITLE PAGE

Prospecting Report for Bedrock #2 Mineral Claim.

The Bedrock #2 Mineral Claim is in the Victoria Mining Division.

It is located on Mineral Map. M92C/16E, 48°55', 124°03'

The owner of the claim is Allan Francis. Allan paid to have the work done and this report is composed by Allan Francis.

Date submitted

June 19th 1984

Allan Francis

Allan Francis.

**GEOLOGICAL BRANCH
ASSESSMENT REPORT**

12,909

INTRODUCTION

The Bedrock #2 Mining Claim is in the Victoria Mining Division. Located on mineral map M92C 16E.

The claim is of the Mid Sicker Mountain Group. Believed to be formed 500 million years ago.

There are outcroppings of Chlorite Shist which have assayed out as gold and silver.

Lots of quartz mixed with Sericite. Cherty Tuff and Breccia are exposed where logging roads were made

Access to the claim is excellent. Entering through the Chemainus Logging Division Main Road.

Taking R.3. gives access to the Legal Corner Post.

I believe the claim is in a mineralized area with great potential. Overtop of a main ore body yet to be determined.

The owner is Allan Francis Lot #8, Errington, B.C.

INDEX

- 1) Authors' qualifications
- 2) Itemized cost statement
- 3) Prospecting method.
- 4) Copy of Assay report
- 5) Maps S,1 S,2 S,3
- 6 Information about maps
- 7,
7,₁
7,₂
- 8 Additional information

AUTHORS' QUALIFICATIONS

I have spent many hundreds of hours prospecting on Mount Arrowsmith and now in the Copper Canyon area. In locating the Bedrock #2 mineral claim and obtaining gold and silver assays on the claim. I feel that speaks for my ability as a prospector.

The gold and silver were found in a chlorite schist lens, which has sericite mixed with quartz on both sides of the lens.

Where the logging roads have been made on the claim there are many different formations and intrusions. Some of the rock being sericite, cherty tuff and brecca.

I have a friend who is a retired Mining Engineer. He is going to do a minor study of the area. I will send you a copy of this report. It will be much more detailed in a professional way.

Yours sincerely,

Allan Francis

Allan Francis

ITEMIZED COST STATEMENT

<u>Dates worked</u>	<u>\$11.00 per hour</u>
May 18, 1983	10 hours
May 19, 1983	10 hours
May 20, 1983	10 hours
May 21, 1983	10 hours
May 22, 1983	10 hours
May 23, 1983	10 hours
June 1, 1983	10 hours
June 2, 1983	10 hours
July 27, 1983	10 hours
July 29, 1983	10 hours
July 30, 1983	10 hours
September 15, 1983	10 hours
September 16, 1983	10 hours
September 14, 1983	10 hours
October 7, 1983	10 hours
October 8, 1983	10 hours
October 26, 1983	10 hours
October 27, 1983	10 hours
October 28, 1983	10 hours
October 29, 1983	10 hours

ITEMIZED COST STATEMENT CON'D

<u>Dates worked</u>	<u>\$11.00 per hour</u>
November 7, 1983	10 hours
November 8, 1983	10 hours
November 9, 1983	10 hours
November 14, 1983	10 hours
November 15, 1983	10 hours
November 17, 1983	10 hours
November 21, 1983	10 hours
Total hrs worked	270 hours
27 X 10	X 11
	—
	\$2970.00
ASSAY COST	48.00
TOTAL	—
	\$3018.00

In prospecting the claim I tried to keep to a pattern. Starting from "Treks'" legal survey line going east from our Legal Corner Post. I measured off 125 meters. Then I ran lines going south the length of 5 units just checking out the general lay of the claim. I did this in a uniform way moving east each time along our north border. Moving 125 meters each time then I run the lines south. Most of the rock is covered with overburden so it is a lot of work to dig for samples and see what rock is under the overburden. Three units east from our north west post I discovered the lens of chlorite schist. The lens straddles the border of the Trek-Bedrock #2 claims, laying on the surface in a south-east* or north-west direction. The lens at this time seems to be the interesting point of the claim.

This is the lens that the gold and silver were found in.

4

To: ALLAN FRANCIS
GENERAL DELIVERY
NANOOSE BAY, B.C., VOR 2R0



File No. 25693
Date December 13, 1983
Samples Rock

Certificate of
ASSAY of
LORING LABORATORIES LTD.

SAMPLE No.	OZ./TON GOLD	OZ./TON SILVER
<u>"Rock Samples"</u>		
A	.002	.12
#1	Trace	Trace
#2	Trace	.12
#3	.002	.04
<p>I Hereby Certify THAT THE ABOVE RESULTS ARE THOSE ASSAYS MADE BY ME UPON THE HEREIN DESCRIBED SAMPLES</p>		

Rejects Retained one month.
Pulps Retained one month
unless specific arrangements
made in advance.

Assayer

6 The scale of the map is about 1:7000
~~1:7000~~

In formation about Prospecting Map
orange parallel lines represent traverses
compass bearing is marked in the top left hand corner.

orange shaded area is the area in the top
left hand corner of the map that was most heavily
prospected. the black shaded line in the middle
of the orange shaded area marks the lense of schist
the lense of schist is where most of the holes were
drilled.

Page 3 of this report contains information on the drilling

All of the drill holes were marked with
ribbons clearly visible from the logging road B18 A.

All the samples taken from the drill holes
have yet to be assayed.

The assay results in this report were
taken from the schist lense.

Alan Francis

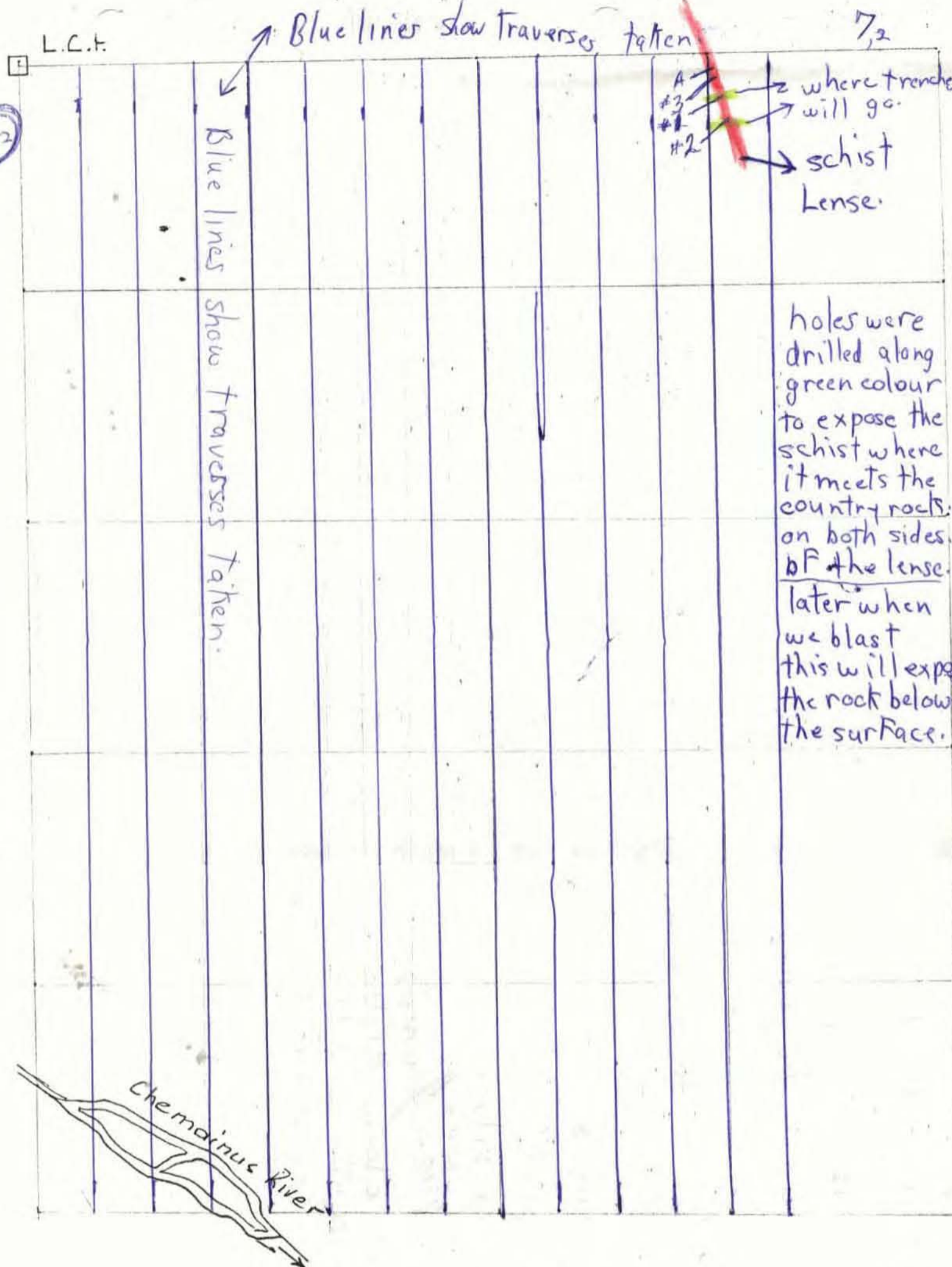

PROSPECTING MAP

BEDROCK CLAIM

Scale 1:10 000

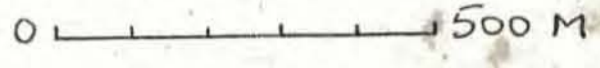

Over
Please.

8 we now believe the bed
of schist is the hanging
wall in a horizontal position.
The Foot wall would be below
the surface of the ground.
Drilling will be needed to determine
this.

That is why any samples of
schist that were sent to the lab
contained gold and silver.

Allan Francis

Bob from the trek claim drilled
100 feet in the schist and the
entire drill core is schist.

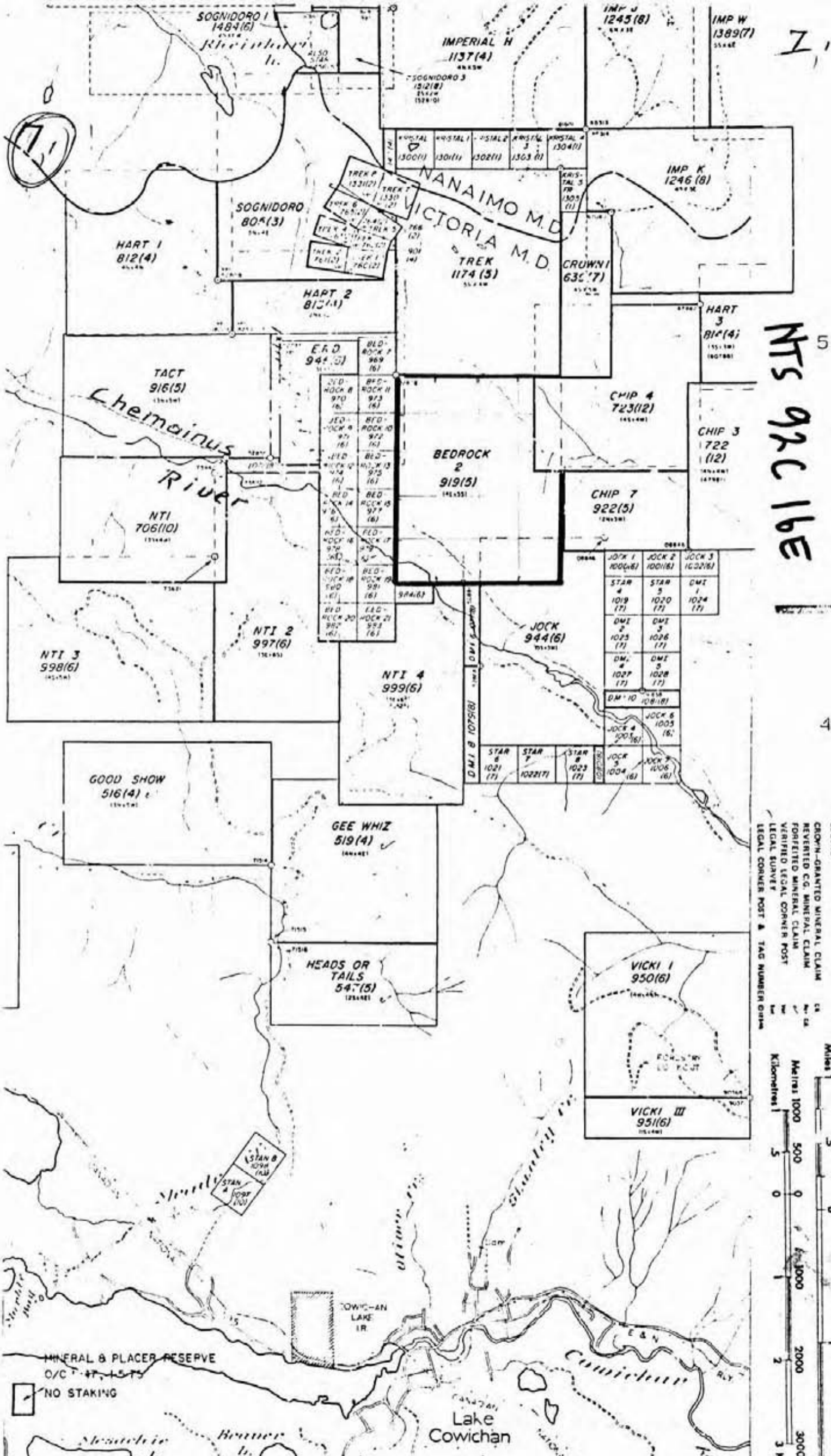

7

NTS 92C 16E

- LEGEND
- CROWN-GRANTED MINERAL CLAIM
 - REVERTED C.G. MINERAL CLAIM
 - FORFEITED MINERAL CLAIM
 - VERIFIED LEGAL CORNER POST
 - LEGAL SURVEY
 - LEGAL CORNER POST & TAG NUMBER ORNA

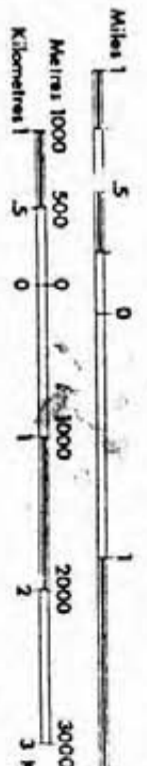

MINERAL & PLACER RESERVE
O/C 47, 45-75

NO STAKING

5,2

schist lense

