

'84-1315-13545
10/85

ASSESSMENT REPORT

1984 Geochemical & Heavy Sediment Survey

KEEFER & CRYSTAL CLAIMS

Keefer Lake Area, Vernon Mining Division

CLAIMS: KEEFER RECORD # 1157
 CRYSTAL RECORD # 1338

MAP: N.T.S. 82 L 1 W

LATITUDE: 50 08'N; LONGITUDE: 118° 10' W
**GEOLOGICAL BRANCH
ASSESSMENT REPORT**

OWNER: DEMUS PETRO CORP.
 #1200, 800 West Pender Street
 Vancouver, B.C. V6C 2V6

13,545

OPERATOR: ANDREAS SCHILDHORN
 2065 West 15th Ave.
 Vancouver, B.C.

NOVEMBER 21st, 1984

TABLE OF CONTENTS

Introduction Page 1

Claims Information 1

Description of Work 2

Analytical Procedure 2

Geochemical Results and Interpretation 3

 Gold 3

 Arsenic 3

 Interpretations 3

Recommendations 3

Cost Statement 4

Statement of Qualifications 5

Statement of Qualifications 6

Maps in Body of Report

 Location Map 1

 Location Map B 1B

Maps in Packet

 Geochemical Survey Sample Location Map

 Geochemical Survey Arsenic Map

 Geochemical Survey Gold Map

Appendix

 Geochemical Analysis Sheets

INTRODUCTION

The Keefer and Crystal Claims are located 500 metres north of Keefer Lake, 72 km east of Vernon, on Highway # 6. At the summit of the Monashee Pass a gravel road connects to Keefer Lake. The road adjoins logging roads and skid trails on the north side of Keefer Lake, continuing easterly to the north end of Holmes Lake.

Geological and geochemical surveys have been conducted by:

- Ducanex Resources (1978 Assessment Report # 5279),
- John P. McGoran, B.S.C., in 1982,
- Demus Petroleum Corp. in 1983,
- Cominco Resources in 1983.

The grid put in under John McGoran's supervision, which Demus used in the previous year, was extended to detail and expand coverage of the previously located anomalies.

CLAIMS INFORMATION

KEEFER	Record # 1157	20 Units	Oct. 1983
CRYSTAL	Record # 1338	12 Units	Nov. 1983

MAC 3
288(11)
MAC 4
297(11)
MAC 5
1299(11)
MAC 6
1299(11)
TOWARD
MTN.

ARON 7
1288(11)

CLAIM LOCATION
(Fig. 1)

RAILROAD 1
1312(11)
(100-001)

J. ONE
1176(11)
(100-001)

KEE 4
1370(11)
(100-001)

RAILROAD 5
1313(11)
(100-001)

RAILROAD 3
1311(11)
(100-001)

RAILROAD 2
1337(11)
(100-001)

KEE 5
1347
(12)
(100-001)

REEFER
1157(10)
(100-001)

CRYSTAL
2
1310(11)
(100-001)
ALSO, KEE 3
1369(11)

VERNON
SLOCAN

KEE 6
1348
(12)
(100-001)

KEE 1
1366(11)
(100-001)

CRYSTAL
1338(11)
(100-001)

PEAK 1
1327(11)
(100-001)

KEE 2
1368(11)
(100-001)

BARN 1
3753(3)
(100-001)

BARN 2
3754(3)
(100-001)

TRAP
1358(12)
(100-001)

PEAK 2
1328(11)
(100-001)

PEAK 4
1330(11)
(100-001)

TAURUS 3
3660(3)
(100-001)

HOLD 7
3758(3)
(100-001)

Holdings

ZAG 1
3339(11)
(100-001)

REKA 1
3755(3)
(100-001)

REK
375
(100-001)

REKA 1
3401(12)
(100-001)

EUREKA 2
3401(12)
(100-001)

SUM OF
COP. CL. #
3303(11)

HOLDING
CREEK 3
3307(11)
(100-001)

HOLDING
CREEK 4

EUREKA 4
3409(12)
(100-001)

EUREKA 3
3408(12)
(100-001)

Eureka
ZAG 2
3340(11)
(100-001)

KEEFER and CRYSTAL CLAIMS

SCALE: 1 - 50,000

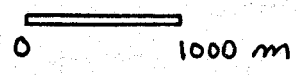

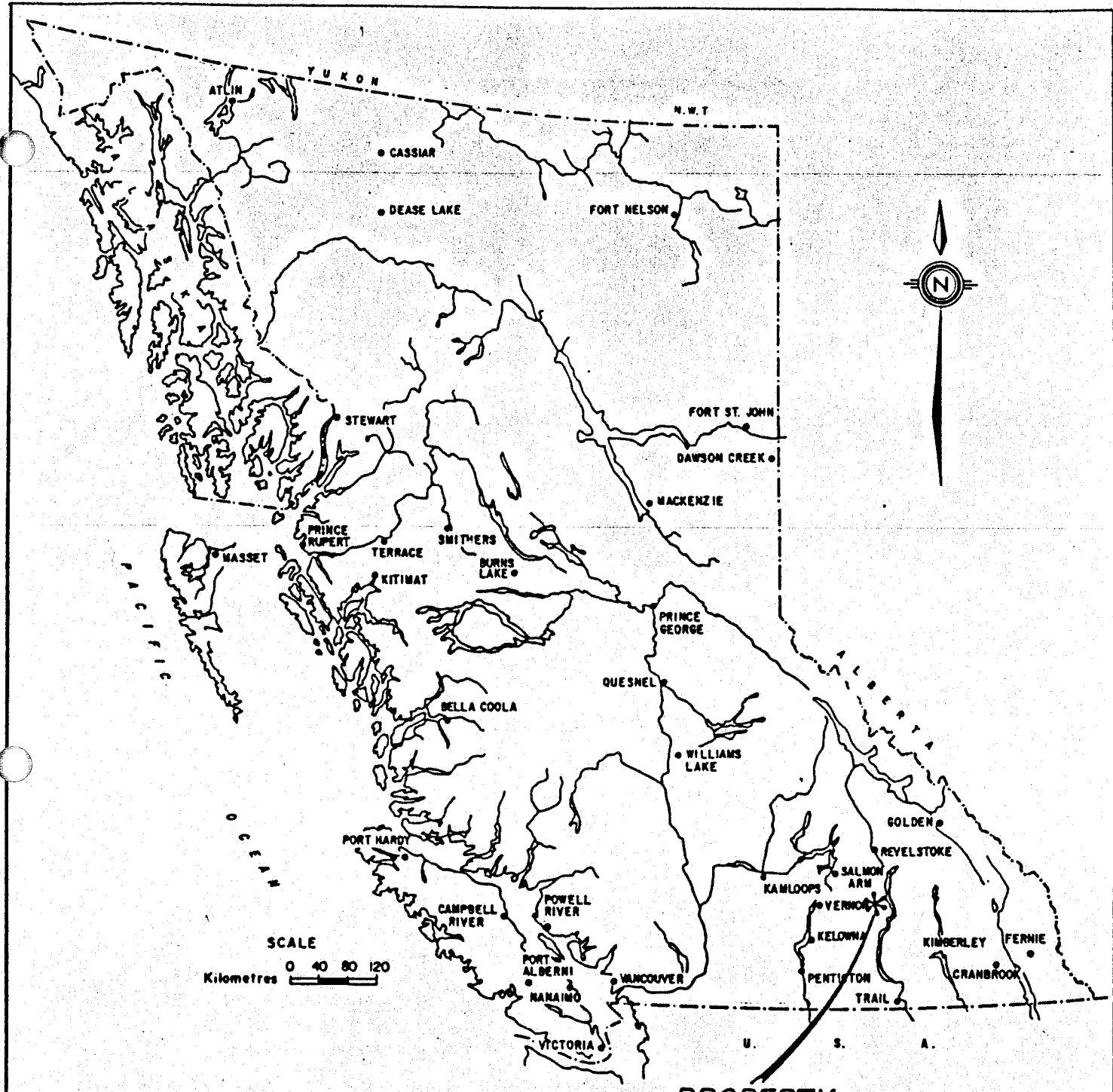

PROPERTY

DEMUS PETRO CORPORATION KEEFER & CRYSTAL CLAIMS MONASHEE PROPERTY VERNON M.D., B.C.	
LOCATION MAP	
NTS: 82L/1W.	SCALE: 1:2,000
DRAWN BY: A. SCHILDHORN	DATE: NOVEMBER, 1984
	FIGURE NO. 1B

DESCRIPTION OF WORK

A total of 187 soil samples and 5 Creek sediment samples were taken on the Keefer and Crystal claims. The existing grid was expanded to include 0 + 00 East to 1200 East on Line 0 + 00 South, 0 + 00 East to 20 + 00 East on Line 1 + 50 North, 0 + 00 East to 5 + 50 East on Line 3 + 00 North and 0 + 00 West to 8 + 00 West on Line 4 + 50 North. See Sample location map in packet.

Soil samples were taken using a Mataxe. Approximately 100 gm of material taken from the "B" horizon was placed in Kraft paper bags and sent to Chemex Labs in North Vancouver for processing. All sample sites were identified by sample number and flagged.

ANALYTICAL PROCEDURE

All these samples were analysed by Chemex Labs Ltd., 212 Brooksbank Avenue, North Vancouver, B.C. Soils were pulverized to 100 mesh - then digested and analysed as follows:

Au - 5 gm ashed digestion by aqua regia, bromide complex extracted with MIBK, atomic absorption finish.

As - 1 gm sample digested in perchloric - nitric acid, aliquot reduced with KI flameless atomic absorption finish - boro hydride reduction.

Gold values are in parts per billion (ppb) whereas arsenic is in part per million (ppm).

GEOCHEMICAL RESULTS AND INTERPRETATION

Gold:

The results ranged from background levels of less than 10 ppb to 10 ppb. These values are not consistent with the results of previous surveys on the grid and are substantially lower. These ranged from 10 ppb to 70 ppb.

Arsenic:

The values ranged from 3 ppm to 130 ppm. Previous soil samples ranged from 1 to 310 ppm and over 100 ppm was taken as anomalous, over 200 ppm as strongly anomalous. The values obtained in the survey are considerably lower than previous surveys.

Interpretation:

There is an unexplained inconsistency in the lower soil sample results with this year's survey, compared to the several soil surveys done in the past. Gold values on this year's grid do not show any particular pattern. An arsenic anomaly extends somewhat to the Northwest of Line 0 + 00 N and Line 1 + 50 N. There also appears to be a small anomaly on Line 2 + 00 N. On Line 4 + 50 N to the Northwest of the grid again there is a small arsenic anomaly.

RECOMMENDATIONS

A geochemical orientation survey of the soil profiles, sampling and analytical techniques is required on the property. To the North and West of Line 4 + 50 N further geochem samples should be taken. On the main As and Au anomaly centered on 3 + 00 S and 10 + 00 E further testing is recommended to the East and South.

COST STATEMENT

A. SCHILDHORN, Sampler

Sept. 24, 25, 26, 27, 28, 29 incl. (6 days @ \$150/day) \$ 900.00

Room: September 24, 25, 26, 27, 28

Unit cost \$10.00/man/day 50.00

Board: September 24, 25, 26, 27, 28

Unit cost: \$24.45/man/day 146.71

Transportation:

4 x 4 rental 6 days @ \$50/day 300.00

Fuel 174.40

Parking 6.00

Clean Up 81.50

Supplies 133.23

Drafting Services 127.66

Geochemical Determinations:

187 soils @ \$10.25 1,916.75

5 heavy sediments @ \$7.00 35.00

1 rock chip geochem. @ \$10.75 10.75

TOTAL \$ 3,882.00

Cost of Report 150.00

TOTAL EXPENDITURE \$ 4,032.00

=====

STATEMENT OF QUALIFICATIONS

I have worked as a Geotechnician for 5 years.

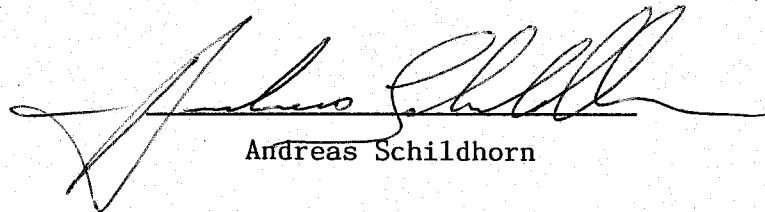

Andreas Schildhorn

STATEMENT OF QUALIFICATIONS

I, Alex BURTON, do hereby certify that I am an independent Consulting Geologist with offices at 810 - 626 West Pender Street, Vancouver, B.C., V6B 1V9.

I FURTHER CERTIFY THAT:

1. I am a graduate geologist and a Registered Professional Engineer in B.C. with Certificate No. 6262.
2. I am a member of the Association of Exploration Geochemists.
3. I am a fellow of the Geological Association of Canada.
4. I supervised the work on the Keefer and Crystal Claims carried out by Mr. Andreas Schildhorn, a geological technician.
5. I have examined the Keefer and Crystal Claims.

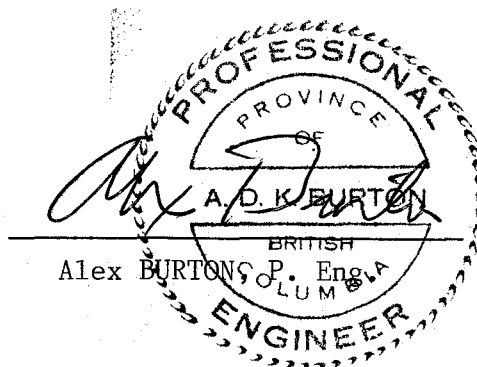



Chemex Labs Ltd.

Analytical Chemists • Geochemists • Registered Assayers

212 Brooksbank Ave.
North Vancouver, B.C.
Canada V7J 2C1
Telephone: (604) 984-0221
Telex: 043-52597

CERTIFICATE OF ANALYSIS

: DEMUS PETROLEUM CORPORATION

** CERT. # : A8416749-001-A
INVOICE # : I8416749
DATE : 12-OCT-84
P.O. # : NONE
KEEPER LK.

620 - 475 HOWE ST.
VANCOUVER, B.C.
V6C 2B3

Sample description	Prep code	AS ppm	AU-AA ppb				
S-001	217	16	<10	--	--	--	--
S-002	217	19	<10	--	--	--	--
S-003	217	130	<10	--	--	--	--
S-004	217	80	<10	--	--	--	--
S-005	217	24	<10	--	--	--	--
S-006	217	15	<10	--	--	--	--
S-007	217	22	<10	--	--	--	--
S-008	217	19	<10	--	--	--	--
S-009	217	63	<10	--	--	--	--
S-010	217	10	<10	--	--	--	--
S-011	217	25	<10	--	--	--	--
S-012	217	23	<10	--	--	--	--
S-013	217	24	<10	--	--	--	--
S-014	217	29	<10	--	--	--	--
S-015	217	27	<10	--	--	--	--
S-016	217	29	<10	--	--	--	--
S-017	217	22	<10	--	--	--	--
S-018	217	12	<10	--	--	--	--
S-019	217	23	<10	--	--	--	--
S-020	217	36	<10	--	--	--	--
S-021	217	25	<10	--	--	--	--
S-022	217	16	<10	--	--	--	--
S-023	217	15	<10	--	--	--	--
S-024	217	9	<10	--	--	--	--
S-025	217	5	<10	--	--	--	--
S-026	217	12	<10	--	--	--	--
S-027	217	10	<10	--	--	--	--
S-028	217	12	<10	--	--	--	--
S-029	217	9	<10	--	--	--	--
S-030	217	6	<10	--	--	--	--
S-031	217	9	<10	--	--	--	--
S-032	217	9	<10	--	--	--	--
S-033	217	9	<10	--	--	--	--
S-034	217	7	<10	--	--	--	--
S-035	217	5	<10	--	--	--	--
S-036	217	5	<10	--	--	--	--
S-037	217	5	<10	--	--	--	--
S-038	217	6	<10	--	--	--	--
S-039	217	5	<10	--	--	--	--
S-040	217	5	<10	--	--	--	--

Certified by Hart Bichler



Chemex Labs Ltd.

Analytical Chemists • Geochemists • Registered Assayers

212 Brooksbank Ave.
North Vancouver, B.C.
Canada V7J 2C1

Telephone: (604) 984-0221
Telex: 043-52597

CERTIFICATE OF ANALYSIS

: DEMUS PETROLEUM CORPORATION

** CERT. # : A8416749-002-A
INVOICE # : 18416749
DATE : 12-OCT-84
P.O. # : NONE
KEEPER LK.

620 - 475 HOWE ST.
VANCOUVER, B.C.
V6C 2B3

Sample description	Prep code	AS ppm	AU-AA ppb				
S-041	217	5	<10	--	--	--	--
S-042	217	7	<10	--	--	--	--
S-043	217	4	<10	--	--	--	--
S-044	217	5	<10	--	--	--	--
S-045	217	11	<10	--	--	--	--
S-046	217	10	<10	--	--	--	--
S-047	217	10	<10	--	--	--	--
S-048	217	10	<10	--	--	--	--
S-049	217	6	<10	--	--	--	--
S-050	217	16	<10	--	--	--	--
S-051	217	15	<10	--	--	--	--
S-052	217	22	<10	--	--	--	--
S-053	217	19	<10	--	--	--	--
S-054	217	22	<10	--	--	--	--
S-055	217	22	<10	--	--	--	--
S-056	217	20	<10	--	--	--	--
S-057	217	22	<10	--	--	--	--
S-058	217	19	<10	--	--	--	--
S-059	217	19	<10	--	--	--	--
S-060	217	15	<10	--	--	--	--
S-061	217	16	<10	--	--	--	--
S-062	217	15	10	--	--	--	--
S-063	217	16	<10	--	--	--	--
S-064	217	11	<10	--	--	--	--
S-065	217	5	<10	--	--	--	--
S-066	217	6	<10	--	--	--	--
S-067	217	7	<10	--	--	--	--
S-068	217	7	<10	--	--	--	--
S-069	217	9	<10	--	--	--	--
S-070	217	12	<10	--	--	--	--
S-071	217	9	<10	--	--	--	--
S-072	217	16	<10	--	--	--	--
S-073	217	11	<10	--	--	--	--
S-074	217	11	<10	--	--	--	--
S-075	217	6	<10	--	--	--	--
S-076	217	11	<10	--	--	--	--
S-077	217	10	<10	--	--	--	--
S-078	217	9	<10	--	--	--	--
S-079	217	16	<10	--	--	--	--
S-080	217	11	<10	--	--	--	--

Certified by Hart Bichler



Chemex Labs Ltd.

Analytical Chemists • Geochemists • Registered Assayers

212 Brooksbank Ave.
North Vancouver, B.C.
Canada V7J 2C1

Telephone: (604) 984-0221
Telex: 043-52597

CERTIFICATE OF ANALYSIS

DEMUS PETROLEUM CORPORATION

** CERT. # : A8416749-003-A
INVOICE # : I8416749
DATE : 12-OCT-84
P.O. # : NONE
KEEPER LK.

620 - 475 HOWE ST.
VANCOUVER, B.C.
V6C 2B3

Sample description	Prep code	AS ppm	AU-AA ppb				
S-081	217	16	<10	--	--	--	--
S-082	217	16	<10	--	--	--	--
S-083	217	12	<10	--	--	--	--
S-084	217	11	<10	--	--	--	--
S-085	217	15	<10	--	--	--	--
S-086	217	12	<10	--	--	--	--
S-087	217	11	<10	--	--	--	--
S-088	217	11	<10	--	--	--	--
S-089	217	10	<10	--	--	--	--
S-090	217	9	<10	--	--	--	--
S-091	217	12	<10	--	--	--	--
S-092	217	9	<10	--	--	--	--
S-093	217	17	<10	--	--	--	--
S-094	217	14	<10	--	--	--	--
S-095	217	12	<10	--	--	--	--
S-096	217	14	<10	--	--	--	--
S-097	217	14	<10	--	--	--	--
S-098	217	15	<10	--	--	--	--
S-099	217	10	<10	--	--	--	--
S-100	217	15	<10	--	--	--	--
S-101	217	15	<10	--	--	--	--
S-102	217	11	<10	--	--	--	--
S-103	217	11	<10	--	--	--	--
S-104	217	22	<10	--	--	--	--
S-105	217	11	<10	--	--	--	--
S-106	217	16	<10	--	--	--	--
S-107	217	15	<10	--	--	--	--
S-108	217	12	<10	--	--	--	--
S-109	217	10	<10	--	--	--	--
S-110	217	11	<10	--	--	--	--
S-111	217	11	<10	--	--	--	--
S-112	217	3	<10	--	--	--	--
S-113	217	15	<10	--	--	--	--
S-114	217	27	<10	--	--	--	--
S-115	217	12	<10	--	--	--	--
S-116	217	16	<10	--	--	--	--
S-117	217	16	<10	--	--	--	--
S-118	217	17	<10	--	--	--	--
S-119	217	19	<10	--	--	--	--
S-120	217	29	<10	--	--	--	--

Certified by *Hart Buchler*



Chemex Labs Ltd.

Analytical Chemists • Geochemists • Registered Assayers

212 Brooksbank Ave.
North Vancouver, B.C.
Canada V7J 2C1
Telephone: (604) 984-0221
Telex: 043-52597

CERTIFICATE OF ANALYSIS

: DEMUS PETROLEUM CORPORATION

** CERT. # : A8416749-004-A
INVOICE # : I8416749
DATE : 12-OCT-84
P.O. # : NONE
KEEPER LK.

620 - 475 HOWE ST.
VANCOUVER, B.C.
V6C 2B3

Sample description	Prep code	AS ppm	AU-AA ppb				
S-121	217	22	<10	--	--	--	--
S-122	217	22	<10	--	--	--	--
S-123	217	14	<10	--	--	--	--
S-124	217	17	<10	--	--	--	--
S-125	217	16	<10	--	--	--	--
S-126	217	19	<10	--	--	--	--
S-127	217	41	<10	--	--	--	--
S-128	217	22	<10	--	--	--	--
S-129	217	15	<10	--	--	--	--
S-130	217	94	<10	--	--	--	--
S-131	217	3	<10	--	--	--	--
S-132	217	12	<10	--	--	--	--
S-133	217	12	<10	--	--	--	--
S-134	217	11	<10	--	--	--	--
S-135	217	15	<10	--	--	--	--
S-136	217	9	<10	--	--	--	--
S-137	217	7	<10	--	--	--	--
S-138	217	12	<10	--	--	--	--
S-139	217	24	<10	--	--	--	--
S-140	217	24	<10	--	--	--	--
S-141	217	30	<10	--	--	--	--
S-142	217	11	<10	--	--	--	--
S-143	217	20	<10	--	--	--	--
S-144	217	17	<10	--	--	--	--
S-145	217	14	<10	--	--	--	--
S-146	217	15	<10	--	--	--	--
S-147	217	19	<10	--	--	--	--
S-148	217	15	<10	--	--	--	--
S-149	217	10	<10	--	--	--	--
S-150	217	16	<10	--	--	--	--
S-151	217	25	<10	--	--	--	--
S-152	217	17	<10	--	--	--	--
S-153	217	14	<10	--	--	--	--
S-154	217	41	<10	--	--	--	--
S-155	217	33	<10	--	--	--	--
S-156	217	38	<10	--	--	--	--
S-157	217	35	<10	--	--	--	--
S-158	217	22	<10	--	--	--	--
S-159	217	16	<10	--	--	--	--
S-160	217	27	<10	--	--	--	--

Certified by Hart Buchler



Chemex Labs Ltd.

Analytical Chemists • Geochemists • Registered Assayers

212 Brooksbank Ave.
North Vancouver, B.C.
Canada V7J 2C1
Telephone: (604) 984-0221
Telex: 043-52597

CERTIFICATE OF ANALYSIS

: DEMUS PETROLEUM CORPORATION

** CERT. # : A8416749-005-A
INVOICE # : 18416749
DATE : 12-OCT-84
P.O. # : NONE
KEEPER LK.

620 - 475 HOWE ST.
VANCOUVER, B.C.
V6C 2B3

Sample description	Prep code	AS ppm	AU-AA ppb				
S-161	217	39	<10	--	--	--	--
S-162	217	32	<10	--	--	--	--
S-163	217	11	<10	--	--	--	--
S-164	217	11	<10	--	--	--	--
S-165	217	12	<10	--	--	--	--
S-166	217	17	10	--	--	--	--
S-167	217	11	<10	--	--	--	--
S-168	217	15	<10	--	--	--	--
S-169	217	10	<10	--	--	--	--
S-170	217	15	<10	--	--	--	--
S-171	217	16	<10	--	--	--	--
S-172A	217	10	<10	--	--	--	--
S-172B	217	12	10	--	--	--	--
S-173	217	23	<10	--	--	--	--
S-174	217	15	<10	--	--	--	--
S-175	217	16	<10	--	--	--	--
S-176	217	17	<10	--	--	--	--
S-177	217	19	<10	--	--	--	--
S-178	217	12	<10	--	--	--	--
S-179	217	15	<10	--	--	--	--
S-180	217	12	<10	--	--	--	--
S-181	217	12	<10	--	--	--	--
S-182	217	10	<10	--	--	--	--
S-183	217	11	<10	--	--	--	--
S-184	217	20	<10	--	--	--	--
S-185	217	12	<10	--	--	--	--
S-186	217	11	<10	--	--	--	--
HS-1	217	--	<10	--	--	--	--
HS-2	217	--	<10	--	--	--	--
HS-3	217	--	<10	--	--	--	--
HS-4	217	--	<10	--	--	--	--
HS-5	217	--	<10	--	--	--	--

Certified by Hart Beckler

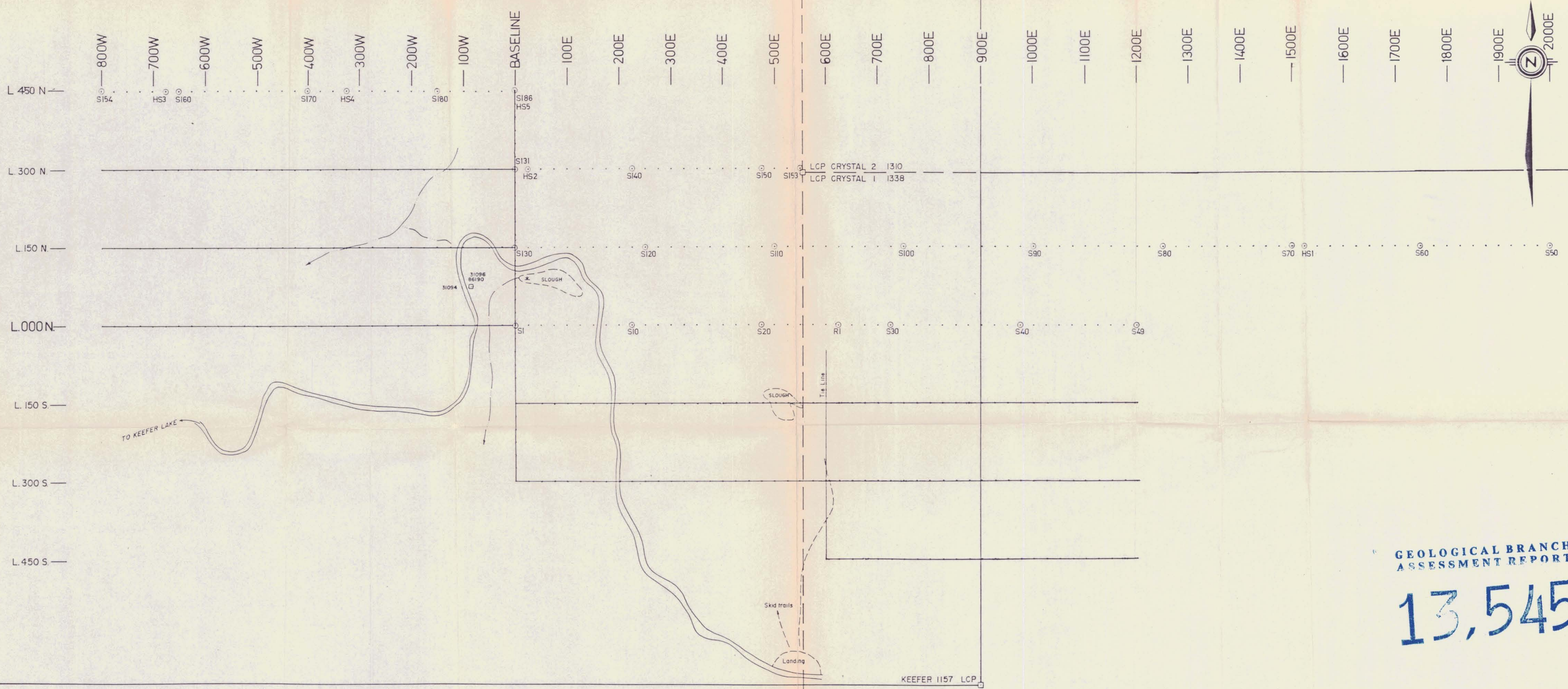

GEOLOGICAL BRANCH
ASSESSMENT REPORT

13,545

DEMUS PETRO CORPORATION	
KEEFER & CRYSTAL CLAIMS MONASHEE PROPERTY VERNON M.D., B.C.	
GEOCHEMICAL SURVEY SAMPLE LOCATION MAP	
NTS: B2L / IW	SCALE: 1:4000
DRAWN BY: A. SCHILDHORN	DATE: NOVEMBER, 1984
POCKET MAP	FIGURE NO. 1 OF 3

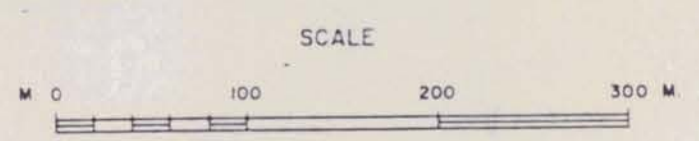
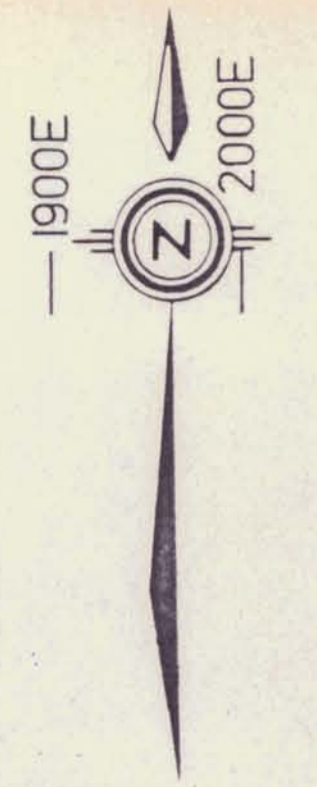
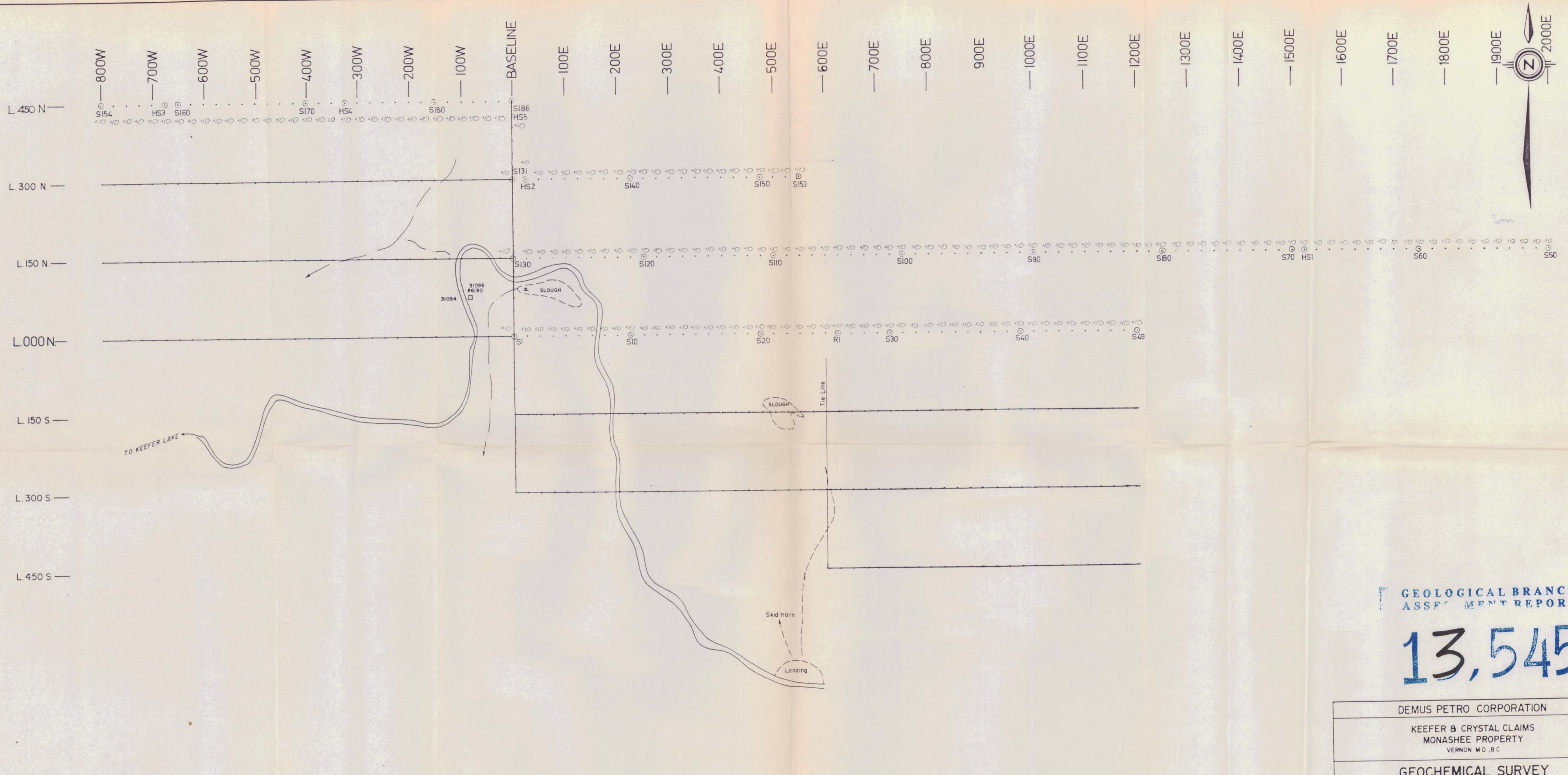

< 10 = LESS THAN 10

GEOLOGICAL BRANCH
ASSESSMENT REPORT

13,545

DEMUS PETRO CORPORATION	
KEEFER & CRYSTAL CLAIMS MONASHEE PROPERTY VERNON M.D., B.C.	
GEOCHEMICAL SURVEY GOLD PPB	
NTS B2L/1W	SCALE 1:4000
DRAWN BY: A. SCHILDHORN	DATE: NOVEMBER, 1980
POCKET MAP	FIGURE NO. 2 OF 3

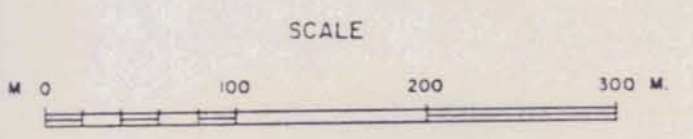
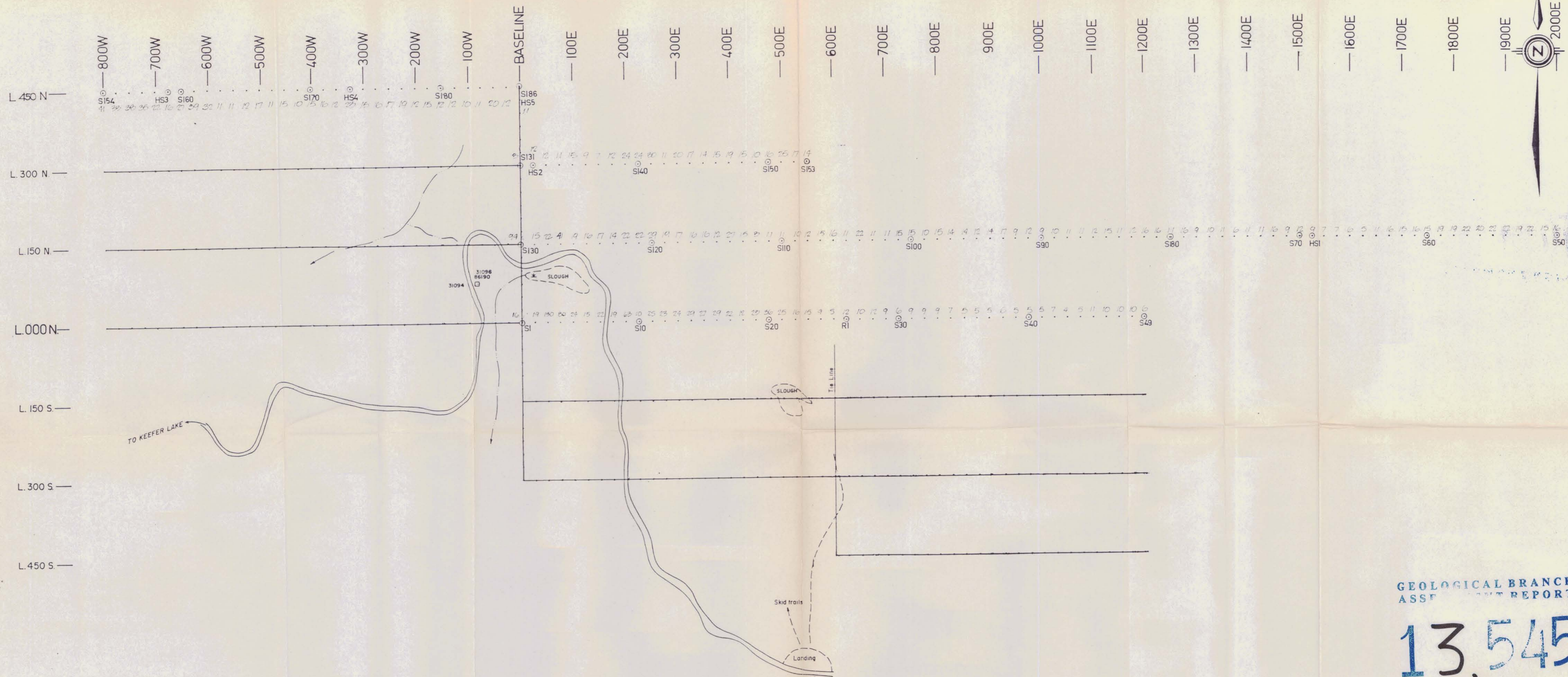

GEOLOGICAL BRANCH
ASSESSMENT REPORT

13,545

DEMUS PETRO CORPORATION	
KEEFER & CRYSTAL CLAIMS MONASHEE PROPERTY VERNON M.D., B.C.	
GEOCHEMICAL SURVEY ARSENIC PPM	
NTS: 82L/1W	SCALE: 1:4000
DRAWN BY: A. SCHILDHORN	DATE: NOVEMBER, 1986
POCKET MAP	FIGURE NO.: 3 OF 3