

85-637-13869

6/86

GEOLOGY AND GEOCHEMISTRY  
OF THE KANGAROO PROPERTY  
KANGAROO 1-5 WANK 1-4 MINERAL CLAIMS  
CARIBOO MINING DIVISION  
NTS 93A/11W  
LATITUDE: 52° 32'N      LONGITUDE: 121° 23'W

DATES OF WORK: JUNE 10 - 24, 1985

OPERATOR: E & B EXPLORATIONS INC.

CONTRACTOR: J.M.T. SERVICES CORP.

WRITTEN BY: G.G. RICHARDS, P.Eng.

DATE: SEPTEMBER 10, 1985

**GEOLOGICAL BRANCH  
ASSESSMENT REPORT**

**13,869**

TABLE OF CONTENTS

	<u>PAGE</u>
INTRODUCTION . . . . .	1
LOCATION AND ACCESS . . . . .	1
MINERAL CLAIMS . . . . .	2
GEOLOGY . . . . .	2
GEOCHEMISTRY . . . . .	5
CONCLUSIONS AND RECOMMENDATIONS . . . . .	6
STATEMENT OF COSTS . . . . .	7
STATEMENT OF QUALIFICATIONS . . . . .	8

APPENDICES

- I Geochemical Analyses
- II Assays for Trench Samples

LIST OF ILLUSTRATIONS

<u>Drawing No.</u>	<u>Title</u>	<u>Scale</u>
Figure 1	Property Location Map	1:2,000,000
Figure 2	Claim Map	1:50,000
Figure 3	Wank #4 Geochemistry Grid	1:5,000
Figure 4	Geology and Geochemistry	1:10,000
Figure 5	Geology and Geochemistry	1:5,000

## INTRODUCTION

Mineral claims have been staked as part of the Kangaroo prospect since May 25, 1981. The area has a long history of gold prospecting including placer gold mining along Cedar and Spanish Creeks. Lode occurrences on Spanish Mountain have been explored intermittently for many years including the old Mariner showing area presently being explored by Mount Calvary. This occurrence, 4 km west, and the discovery in 1983 by Eureka Resources - Amoco at Frasergold creek some 60 km southeast, both occur within upper Triassic black phyllites and has caused intensive exploration within this unit. Previous geologic models on these properties described stratabound controls on mineralization, but more recent detailed mapping at the Mount Calvary property has described an epigenetic model at mineralization with better gold grades (>.1 oz/t Au) occurring in specific strata in areas of abundant quartz veins.

Of several geochemical targets examined by work described in this report, the one occurring in the north part of the property is very similar in geological setting to the Mount Calvary property and is the most promising target for further exploration. Best results from trenching yielded .007 oz/t Au over 20 m collected within black phyllites in an area with no quartz veins. This and other geochemically anomalous zones could be fringe mineralization to areas of better grade mineralization masked by thin but persistent till cover. Further trenching is the cheapest and most direct method of evaluating this potential.

The present survey collected 455 soil samples, 33 rock chip samples from individual outcrops and 129 rock chip samples from the four trenches.

## LOCATION AND ACCESS

The property covers much of the east flank of Spanish Mountain between Quesnel Lake in the south and Spanish Lake in the north. It lies about 15 km southeast of the town of Likely, from which point a network of good logging roads leads to the property area. Particularly good secondary road access occurs throughout the main area of interest in the north portion of the claim block.

MINERAL CLAIMS

The property consists of thirteen contiguous LCP claims (204 units) as listed below and shown on Figure 2.

<u>CLAIM NAME</u>	<u>UNITS</u>	<u>RECORD #</u>	<u>RECORD DATE</u>	<u>OWNER</u>
Kangaroo #1	20	3714 (6)	June 24/81	E & B Explorations Inc.
2	20	3715 (6)	June 24/81	E & B Explorations Inc.
3	20	3716 (6)	June 24/81	E & B Explorations Inc.
4	10	5091 (8)	Aug. 22/83	E & B Explorations Inc.
5	6	5627 (11)	Nov. 22/83	E & B Explorations Inc.
Wank #1	20	3717 (6)	June 24/81	E & B Explorations Inc.
2	20	3718 (6)	June 24/81	E & B Explorations Inc.
3	8	3719 (6)	June 24/81	E & B Explorations Inc.
4	8	3720 (6)	June 24/81	E & B Explorations Inc.
Gold Finger 1	18	5431 (11)	Nov. 22/83	E & B Explorations Inc.
Gold Finger 2	18	5432 (11)	Nov. 22/83	E & B Explorations Inc.
Gold Leaves 1	18	5433 (11)	Nov. 22/83	E & B Explorations Inc.
Gold Leaves 2	18	5434 (11)	Nov. 22/83	E & B Explorations Inc.

GEOLOGY

The southwestern portion of the claims is underlain by a mixed succession of intermediate to acidic volcano-clastic sediments ranging from coarse lapilli tuffs to argillites of Upper Triassic to Lower Jurassic age. Two areas within this area had exploration targets identified from previous surveys and were examined in more detail by the present survey.

One of these targets was a number of airborne VLF anomalies and coincident weak magnetic highs shown on Figure 1 of a report by J.T. Walker dated July 9, 1984. In this area, shown on Figure 4 in southeastern Kangaroo #3, green andestic tuffs containing up to one or two percent pyrite have 10 to

20 m thick argillite interbeds that contain up to five percent pyrite. Exposure is fairly good in this area and the weak VLF-EM anomalies might be caused by the strong contrast between the massive andesites and more by highly pyritic argillites.

Another area of interest in the southern portion of the claims occurs east and west of the legal corner post for the Wank #1 - #4 mineral claims. Here andesite and minor argillite have local areas of sulphide-ankerite alteration with some bull quartz that yielded a high of 370 ppb Au in a soil. The small size of these zones and lack of continuity along strike make these targets unworthy of more detailed examination.

The northeastern portion of the claims is principally underlain by foliated and/or metamorphosed rocks of Upper Triassic age and contains the area explored by trenching. A previous soil sample grid was also enlarged in this area.

Stratigraphy of the Upper Triassic rocks has been mapped in some detail and subdivided into four units which form a syncline-anticline overturned to the west. The stratigraphically lowest and probably oldest unit is black phyllite, slate, shale and argillite with minor limy sections. Wispy quartzose segregations occur in several outcrops and ankerite porphyroblasts up to 0.5 cm diameter form up to 30 percent of rock volume but more typically form less than five percent of rock volume. A few beds of ankerite less than 1 m thick were noted along a road in the western part of the survey area. (Figure 5). The unit is uniformly black to dark grey without any or only a minor volcanic component. Although only the top of the unit is mapped, it is very extensive, underlying much of the area to the northwest and southeast, based on a few reconnaissance traverses.

The black phyllite unit grades upwards into mixed andesite tuffs and tuffaceous argillite. Sections of black phyllite, slate, shale and argillite appear interbedded with tuffaceous sections particularly near the base of the unit. One of the commonest and most striking tuffaceous rock types, particularly higher in the unit, is comprised of multiple tuff beds 2 cm - 6 cm thick with shaly segregations less than 1/2 cm thick. Other more massive argillaceous tuffs also occur throughout the section. This unit appears to be approximately 200 m thick, thickening to 500 m at major fold axes.

Conformably "overlying" the andesite tuff unit is a coarser andesite unit grading from breccia and pillow breccia at the base to pillow lavas higher in the section. The pillows and pillow breccias show 2 cm thick cooling rhinds and variolitic cores but have been deformed somewhat by folding, faulting and regional metamorphism. Some massive fine grained diorite sections are thought to be flows but may be small dykes, sills or plugs. The unit is exposed only in the core of a major syncline without any overlying strata. Thus the thickness is unknown but is at least 100 m thick at this location.

The only other unit mapped by the present survey is a massive, blocky, clean, uniformly pale-grey dacite to andesite tuff with barely discernable bedding. Its age relationship to the other units is uncertain but its distribution suggests it might underlie or occur within the black phyllite unit.

The black phyllite and argillaceous tuff units commonly contain pyrite cube impressions up to 2 cm diameter with rims of quartz less than 2 mm thick. Pyrite is generally not present in the cubic impressions having been removed by weathering or alteration. Silica flooding of the matrix is generally present locally to a minor degree in areas of more intense occurrence of quartz rimmed pyrite cube impressions. The pyrite impressions occur as lenses along bedding up to one or two cm thick and also as lenses along fractures crosscutting bedding. Pyrite mineralization greater than one or two percent is not common but does occur in outcrops along a main creek at R797 to R806, at R639, at R686 to R690, at R692 to R703, and locally along the road cuts and better exposures in the large +20 ppb Au soil anomaly on Figure 5. Quartz veins were only abundant in the creek northwest of Trench #4.

The pillow breccia to pillow andesite unit is variably altered to epidote often quite intensely and in several outcrops cut by zones of intense quartz vein lacework with associated ankerite and sercrite.

Structural interpretation from a previous assessment report by G. Richards dated November 20, 1984 described a major syncline overturned to the west.

The northeastern portion of the claims were examined for mineral potential by extending the grid-controlled soil sampling survey described in the previous report and by trenching two areas underlain by black phyllites with anomalous soil and rock chip gold geochemistry.

### GEOCHEMISTRY

Geochemical sampling was done to provide more detailed examination of the three areas described above; two in the southwestern portion of the claims and one large area in the northeastern portion of the claims.

Soils, silts and rock chips were collected along survey lines and along roads and creeks tied to baselines and topographic features. Soil samples were collected from pits dug with a mattock to a depth of approximately 20 cm. B-horizon soil was collected from the pit using a stainless steel scoop and placed in an identified, gusseted, kraft paper sample bag. Silts samples were collected from active silts using a stainless steel scoop. Rock chip samples consist of from three to ten rock chips small enough to fit into the gusseted kraft paper sample bags used for all samples.

All samples were shipped to Chemex Labs Ltd., 212 Brooksbank Avenue, North Vancouver, B.C. for geochemical analysis. All samples were analyzed for gold, using a fire assay preconcentration with atomic absorption analysis.

Results from the two southeastern areas examined contained only a few anomalous samples. No further work is warranted in these areas.

Four trenches were dug in black phyllites in the northeastern portion of the claims. Results are provided in an Appendix. Trench #1 was sampled from the southwest to northeast using 2 m intervals numbered WL110 to WL170. Four test pits, WL171-174, were dug on the road corner some 50 m further east and Trench #2, WL175-178, occurs 100 m north. Trench #3 was sampled from north to south, also with 2 m intervals numbered WL179 to 228. Trench #4 was sampled from north to south using 5 m samples numbered WL230 to 235, 10 m samples numbered WL236 and 237, and an 18 m sample numbered WL238.

All trench results were well below ore grade. Refer to Appendix II. The best interval occurred in Trench #3 from WL219 to WL228 at the extreme north end of this trench. This interval represents 20 m of .007 oz Au/t.

Results of soil sampling from the northeastern area examined did not appreciably change the anomalous gold patterns described in the November 20, 1984 report. Extensive, although not necessarily deep, glacial till lies adjacent to some of these anomalous gold patterns and offers cover-play targets for further exploration. Referring to Figure 5, there are two such areas; one lying between and south and east of Trench #1 and #3, and the other area lying northwest of Trench #4 beyond the big creek and south and east of Trench #4 as far as R639 and R641. Intervening soil samples in this last area are tills and their low gold values should be ignored in evaluating this area.

#### CONCLUSIONS AND RECOMMENDATIONS

Recent work has evaluated three areas within the claim block: a cluster of low order VLF-EM anomalies coincident with a low order magnetic high; an area of spotty anomalous gold in soils in the southwestern part of the property; and a number of anomalous gold zones underlain by black phyllites in the northeastern part of the property. This last area is similar in geological setting to the Mount Calvary property 4 km west and is the best target for further exploration. Limited trenching was carried out in two areas of strong gold geochemistry with the best results being 20 m of .007 oz Au/t over the extreme north end of Trench #3. Further exploration should consider additional trenching around both areas trenched.

Respectfully submitted,

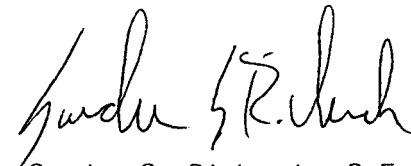
  
Gordon G. Richards, P.Eng.



STATEMENT OF COSTS

J.M.T. INVOICE 85-240-16	\$ 18,744.78
Report, drafting, reproductions	2,000.00
	<hr/>
	\$ 20,744.78
	<hr/> <hr/>

# JMT Services Corp.

8827 HUDSON STREET · VANCOUVER, B.C. V6P 4N1 · TELEPHONE 266-1811

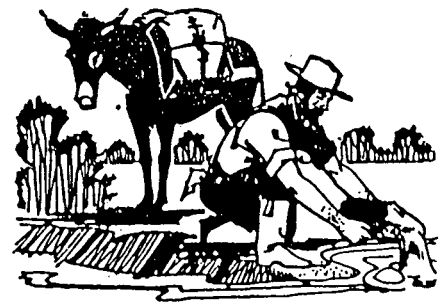

July 12, 1985.

Mr. Len Saleken  
Mascot Gold Mines Ltd.  
#1400-800 West Pender Street  
VANCOUVER, B.C.

JAMES S. CHRISTIE, PhD 228-8054  
K. WAYNE LIVINGSTONE, MSc 266-4208  
GORDON G. RICHARDS, M.A.Sc., P.Eng. 274-2839  
GERALD LAUZON, Mgr. 277-4778  
W.A. HOWELL, Geol. 277-7082

INVOICE #85-240-16

Dear Len:

Re: KANGAROO PROJECT

This is an interim invoice for the recent work on the KANGAROO project:

TIME CHARGES:

K.W. Livingstone	June 18-22, 1/23, 1/24	6 days @ \$250/day . . . . .	\$ 1,500.00
G.G. Richards	June 1/6, 1/7, 14-16, 25 1/28, July 3	6 1/2 days @ \$250/day . . . . .	1,625.00
D. Bennett	June 13-17, 23-26	9 days @ \$200/day . . . . .	1,800.00
S. Courte	June 13-17, 23-26	9 days @ \$175/day . . . . .	1,575.00

TRUCK RENTAL:

GMC Jimmy 4x4--	12 days @ \$40/day + 1,360 miles @ 22¢/mile . . . . .	779.20
GMB Suburban 4x4--	2080 km @ 16¢/km + 12 days @ \$40/day . . . . .	812.80

DISBURSEMENTS:

KWL expenses	\$ 596.91 + 10%	656.60
GGR Expenses	678.65 + 10%	746.51
Northern Lights Lodge	591.18 + 10%	650.30
Trenching	1,946.00 + 10%	2,140.60
N.C.I.	175.37 + 347.38 = 522.75 + 10%	575.03
S. Courte, expenses	91.42 + 10%	100.56
Chemex Labs I 8580569	299.00 + 10%	328.90
I 8513283	1,390.00 + 10%	1,529.00
I 8513284	1,581.55 + 10%	1,739.70
I 8513290	1,629.25 + 10%	1,792.18
I 8513288	288.75 + 10%	317.63
B.C. Tel	50.33 + 10%	55.36
KWL Expenses --B.C.Tel	18.55 + 10%	20.41

Total . . . . . \$ 18,744.78

Please remit \$18,744.78.

Yours very truly,

G.G. Richards

GGR:mh  
Encls.

STATEMENT OF QUALIFICATIONS

I, Gordon G. Richards, of Richmond, British Columbia, do hereby certify that:

1. I am a Professional Engineer of the Province of British Columbia, residing at 5700 Forsythe Crescent, Richmond, B.C., V7C 2C3.
2. I am a graduate of the University of British Columbia, B.A.Sc., 1968, M.A.Sc. 1974.
3. I have practised my profession as a mining exploration geologist since 1968.
4. This report is based on my personal knowledge of the district, and mapping of the geology at the property.

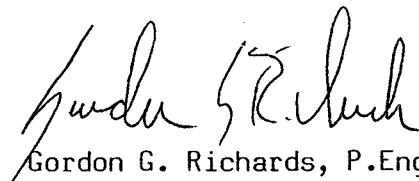
  
Gordon G. Richards, P.Eng.

APPENDIX I



# Chemex Labs Ltd.

Analytical Chemists • Geochemists • Registered Assayers

212 Brooksbank Ave.  
North Vancouver, B.C.  
Canada V7J 2C1  
Telephone: (604) 984-0221  
Telex: 043-52597

## CERTIFICATE OF ANALYSIS

TO : JMT SERVICES CORPORATION

6775 WEST BLVD.  
VANCOUVER, B.C.  
V6P 5R8

CERT. # : A8513283-001-A  
INVOICE # : 18513283  
DATE : 7-JUL-85  
P.O. # : NONE  
KANGAROO

Sample description	Prep code	Au ppb FA+AA						
85J 001	201	25	--	--	--	--	--	--
85J 002	201	<5	--	--	--	--	--	--
85J 003	201	<5	--	--	--	--	--	--
85J 004	201	15	--	--	--	--	--	--
85J 005	201	<5	--	--	--	--	--	--
85J 006	201	20	--	--	--	--	--	--
85J 007	201	<5	--	--	--	--	--	--
85J 008	201	<5	--	--	--	--	--	--
85J 009	201	25	--	--	--	--	--	--
85J 010	201	<5	--	--	--	--	--	--
85J 011	201	<5	--	--	--	--	--	--
85J 012	201	<5	--	--	--	--	--	--
85J 013	201	<5	--	--	--	--	--	--
85J 014	201	10	--	--	--	--	--	--
85J 015	201	30	--	--	--	--	--	--
85J 016	201	<5	--	--	--	--	--	--
85J 017	201	<5	--	--	--	--	--	--
85J 018	201	<5	--	--	--	--	--	--
85J 019	201	<5	--	--	--	--	--	--
85J 020	201	<5	--	--	--	--	--	--
85J 021	201	<5	--	--	--	--	--	--
85J 022	201	<5	--	--	--	--	--	--
85J 023	201	<5	--	--	--	--	--	--
85J 024	201	25	--	--	--	--	--	--
85J 025	201	60	--	--	--	--	--	--
85J 026	201	20	--	--	--	--	--	--
85J 027	201	<5	--	--	--	--	--	--
85J 028	201	50	--	--	--	--	--	--
85J 029	201	25	--	--	--	--	--	--
85J 030	201	<5	--	--	--	--	--	--
85J 031	201	<5	--	--	--	--	--	--
85J 032	201	<5	--	--	--	--	--	--
85J 033	201	<5	--	--	--	--	--	--
85J 034	201	<5	--	--	--	--	--	--
85J 035	201	<5	--	--	--	--	--	--
85J 036	201	<5	--	--	--	--	--	--
85J 037	201	<5	--	--	--	--	--	--
85J 038	201	<5	--	--	--	--	--	--
85J 039	201	25	--	--	--	--	--	--
85J 040	201	15	--	--	--	--	--	--

*Hart Buchler*

Certified by .....





# Chemex Labs Ltd.

Analytical Chemists • Geochemists • Registered Assayers

212 Brooksbank Ave.  
North Vancouver, B.C.  
Canada V7J 2C1

Telephone: (604) 984-0221  
Telex: 043-52597

## CERTIFICATE OF ANALYSIS

TO : JMT SERVICES CORPORATION

6775 WEST BLVD.  
VANCOUVER, B.C.  
V6P 5R8

CERT. # : A8513283-002-A  
INVOICE # : 18513283  
DATE : 7-JUL-85  
P.O. # : NONE  
KANGAROO

Sample description	Prep code	Au ppb FA+AA						
85J 041	201	<5	--	--	--	--	--	--
85J 042	201	<5	--	--	--	--	--	--
85J 043	201	<5	--	--	--	--	--	--
85J 044	201	<5	--	--	--	--	--	--
85J 045	201	50	--	--	--	--	--	--
85J 046	201	<5	--	--	--	--	--	--
85J 047	201	<5	--	--	--	--	--	--
85J 048	201	<5	--	--	--	--	--	--
85J 049	201	<5	--	--	--	--	--	--
85J 050	201	<5	--	--	--	--	--	--
85J 051	201	<5	--	--	--	--	--	--
85J 052	201	<5	--	--	--	--	--	--
85J 053	201	<5	--	--	--	--	--	--
85J 054	201	<5	--	--	--	--	--	--
85J 055	201	<5	--	--	--	--	--	--
85J 056	201	<5	--	--	--	--	--	--
85J 057	201	<5	--	--	--	--	--	--
85J 058	201	<5	--	--	--	--	--	--
85J 059	201	<5	--	--	--	--	--	--
85J 060	201	<5	--	--	--	--	--	--
85J 061	201	<5	--	--	--	--	--	--
85J 062	201	<5	--	--	--	--	--	--
85J 063	201	<5	--	--	--	--	--	--
85J 064	201	<5	--	--	--	--	--	--
85J 065	201	<5	--	--	--	--	--	--
85J 066	201	<5	--	--	--	--	--	--
85J 067	201	<5	--	--	--	--	--	--
85J 068	201	<5	--	--	--	--	--	--
85J 069	201	<5	--	--	--	--	--	--
85J 070	201	<5	--	--	--	--	--	--
85J 071	201	<5	--	--	--	--	--	--
85J 072	201	<5	--	--	--	--	--	--
85J 073	201	<5	--	--	--	--	--	--
85J 074	201	<5	--	--	--	--	--	--
85J 075	201	100	--	--	--	--	--	--
85J 076	201	<5	--	--	--	--	--	--
85J 077	201	10	--	--	--	--	--	--
85J 078	201	<5	--	--	--	--	--	--
85J 079	201	<5	--	--	--	--	--	--
85J 080	201	<5	--	--	--	--	--	--



Certified by Stuart Bichler.....



# Chemex Labs Ltd.

Analytical Chemists • Geochemists • Registered Assayers

212 Brooksbank Ave.  
North Vancouver, B.C.  
Canada V7J 2C1

Telephone: (604) 984-0221  
Telex: 043-52597

## CERTIFICATE OF ANALYSIS

TO : JMT SERVICES CORPORATION

6775 WEST BLVD.  
VANCOUVER, B.C.  
V6P 5R8

CERT. # : A8513283-003-A  
INVOICE # : I8513283  
DATE : 7-JUL-85  
P.O. # : NONE  
KANGAROO

Sample description	Prep code	Au ppb FA+AA						
85J 081	201	<5	--	--	--	--	--	--
85J 082	201	<5	--	--	--	--	--	--
85J 083	201	<5	--	--	--	--	--	--
85J 084	201	<5	--	--	--	--	--	--
85J 085	201	<5	--	--	--	--	--	--
85J 086	201	<5	--	--	--	--	--	--
85J 087	201	<5	--	--	--	--	--	--
85J 088	201	<5	--	--	--	--	--	--
85J 089	201	<5	--	--	--	--	--	--
85J 090	201	<5	--	--	--	--	--	--
85J 091	201	115	--	--	--	--	--	--
85J 092	201	<5	--	--	--	--	--	--
85J 093	201	<5	--	--	--	--	--	--
85J 094	201	<5	--	--	--	--	--	--
85J 095	201	<5	--	--	--	--	--	--
85J 096	201	<5	--	--	--	--	--	--
85J 097	201	<5	--	--	--	--	--	--
85J 098	201	<5	--	--	--	--	--	--
85J 099	201	<5	--	--	--	--	--	--
85J 100	201	<5	--	--	--	--	--	--
85J 101	201	<5	--	--	--	--	--	--
85J 102	201	<5	--	--	--	--	--	--
85J 103	201	<5	--	--	--	--	--	--
85J 104	201	<5	--	--	--	--	--	--
85J 105	201	<5	--	--	--	--	--	--
85J 106	201	10	--	--	--	--	--	--
85J 107	201	<5	--	--	--	--	--	--
85J 108	201	<5	--	--	--	--	--	--
85J 109	201	<5	--	--	--	--	--	--
85J 110	201	<5	--	--	--	--	--	--
85J 111	201	<5	--	--	--	--	--	--
85J 112	201	<5	--	--	--	--	--	--
85J 113	201	<5	--	--	--	--	--	--
85J 114	201	<5	--	--	--	--	--	--
85J 115	201	25	--	--	--	--	--	--
85J 116	201	<5	--	--	--	--	--	--
85J 117	201	<5	--	--	--	--	--	--
85J 118	201	<5	--	--	--	--	--	--
85J 119	201	<5	--	--	--	--	--	--
85J 120	201	<5	--	--	--	--	--	--

Certified by Hart Bichler



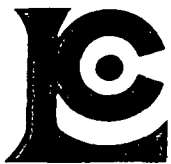

# Chemex Labs Ltd.

212 Brooksbank Ave.  
North Vancouver, B.C.  
Canada V7J 2C1

Analytical Chemists • Geochemists • Registered Assayers

Telephone: (604) 984-0221  
Telex: 043-52597

## CERTIFICATE OF ANALYSIS

TO : JMT SERVICES CORPORATION

6775 WEST BLVD.  
VANCOUVER, B.C.  
V6P 5R8

CERT. # : A8513283-004-A  
INVOICE # : I8513283  
DATE : 7-JUL-85  
P.O. # : NONE  
KANGAROO

Sample description	Prep code	Au ppb FA+AA					
85J 121	201	<5	--	--	--	--	--
85J 122	201	<5	--	--	--	--	--
85J 123	201	40	--	--	--	--	--
85J 124	201	<5	--	--	--	--	--
85J 125	201	<5	--	--	--	--	--
85J 126	201	<5	--	--	--	--	--
85J 127	201	<5	--	--	--	--	--
85J 128	201	<5	--	--	--	--	--
85J 129	201	<5	--	--	--	--	--
85J 130	201	<5	--	--	--	--	--
85J 131	201	<5	--	--	--	--	--
85J 132	201	<5	--	--	--	--	--
85J 133	201	<5	--	--	--	--	--
85J 134	201	<5	--	--	--	--	--
85J 135	201	<5	--	--	--	--	--
85J 136	201	<5	--	--	--	--	--
85J 137	201	<5	--	--	--	--	--
85J 138	201	<5	--	--	--	--	--
85J 139	201	<5	--	--	--	--	--
85J 140	201	<5	--	--	--	--	--
85J 141	201	<5	--	--	--	--	--
85J 142	201	<5	--	--	--	--	--
85J 143	201	60 <sup>+</sup>	--	--	--	--	--
85J 144	201	<5	--	--	--	--	--
85J 145	201	<5	--	--	--	--	--
85J 146	201	20	--	--	--	--	--
85J 147	201	170	--	--	--	--	--
85J 148	201	<5	--	--	--	--	--
85J 149	201	<5	--	--	--	--	--
85J 150	201	<5	--	--	--	--	--
85J 151	201	150	--	--	--	--	--
85J 152	201	20	--	--	--	--	--
85J 153	201	<5	--	--	--	--	--
85J 154	201	<5	--	--	--	--	--
85J 155	201	<5	--	--	--	--	--
85J 156	201	<5	--	--	--	--	--
85J 157	201	<5	--	--	--	--	--
85J 158	201	<5	--	--	--	--	--
85J 159	201	<5	--	--	--	--	--
85J 160	201	<5	--	--	--	--	--



Certified by Hart Bichler



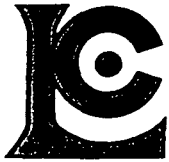

# Chemex Labs Ltd.

Analytical Chemists • Geochemists • Registered Assayers

212 Brooksbank Ave.  
North Vancouver, B.C.  
Canada V7J 2C1  
Telephone: (604) 984-0221  
Telex: 043-52597

## CERTIFICATE OF ANALYSIS

TO : JMT SERVICES CORPORATION

6775 WEST BLVD.  
VANCOUVER, B.C.  
V6P 5R8

CERT. # : A8513283-005-A  
INVOICE # : I8513283  
DATE : 7-JUL-85  
P.O. # : NONE  
KANGAROO

Sample description	Prep code	Au ppb FA+AA						
85J 161	201	<5	--	--	--	--	--	--
85J 162	201	<5	--	--	--	--	--	--
85J 163	201	10	--	--	--	--	--	--
85J 164	201	<5	--	--	--	--	--	--
85J 165	201	<5	--	--	--	--	--	--
85J 166	201	<5	--	--	--	--	--	--
85J 167	201	<5	--	--	--	--	--	--
85J 168	201	<5	--	--	--	--	--	--
85J 169	201	<5	--	--	--	--	--	--
85R 119	201	<5	--	--	--	--	--	--
85R 120	201	<5	--	--	--	--	--	--
85R 121	201	<5	--	--	--	--	--	--
85R 122	201	<5	--	--	--	--	--	--
85R 123	201	<5	--	--	--	--	--	--
85R 124	201	<5	--	--	--	--	--	--
85R 126	201	<5	--	--	--	--	--	--
85R 127	201	<5	--	--	--	--	--	--
85R 128	201	<5	--	--	--	--	--	--
85R 130	201	<5	--	--	--	--	--	--
85R 131	201	<5	--	--	--	--	--	--
85R 132	201	<5	--	--	--	--	--	--
85R 133	201	<5	--	--	--	--	--	--
85R 134	201	<5	--	--	--	--	--	--
85R 135	201	<5	--	--	--	--	--	--
85R 136	201	15	--	--	--	--	--	--
85R 137	201	<5	--	--	--	--	--	--
85R 138	201	20	--	--	--	--	--	--
85R 140	201	<5	--	--	--	--	--	--
85R 141	201	<5	--	--	--	--	--	--
85R 143	201	<5	--	--	--	--	--	--
85R 144	201	<5	--	--	--	--	--	--
85R 145	201	<5	--	--	--	--	--	--
85R 146	201	<5	--	--	--	--	--	--
85R 148	201	<5	--	--	--	--	--	--
85R 149	201	<5	--	--	--	--	--	--
85R 150	201	<5	--	--	--	--	--	--
85R 151	201	<5	--	--	--	--	--	--
85R 153	201	85	--	--	--	--	--	--
85R 154	201	90	--	--	--	--	--	--
85R 156	201	<5	--	--	--	--	--	--

*Hart Bickler*

Certified by .....



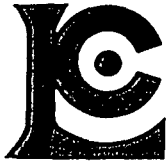

# Chemex Labs Ltd.

Analytical Chemists • Geochemists • Registered Assayers

212 Brooksbank Ave.  
North Vancouver, B.C.  
Canada V7J 2C1

Telephone: (604) 984-0221  
Telex: 043-52597

## CERTIFICATE OF ANALYSIS

TO : JMT SERVICES CORPORATION

6775 WEST BLVD.  
VANCOUVER, B.C.  
V6P 5R8

CERT. # : A8513284-001-A  
INVOICE # : 18513284  
DATE : 7-JUL-85  
P.O. # : NONE  
KANGAROO

Sample description	Prep code	Au ppb FA+AA						
85R 157	201	<5	--	--	--	--	--	--
85T 001	201	<5	--	--	--	--	--	--
85T 002	201	10	--	--	--	--	--	--
85T 003	201	<5	--	--	--	--	--	--
85T 004	201	<5	--	--	--	--	--	--
85T 005	201	15	--	--	--	--	--	--
85T 006	201	75	--	--	--	--	--	--
85T 007	201	<5	--	--	--	--	--	--
85T 008	201	<5	--	--	--	--	--	--
85T 009	201	50	--	--	--	--	--	--
85T 010	203	250	--	--	--	--	--	--
85T 011	201	10	--	--	--	--	--	--
85T 012	201	30	--	--	--	--	--	--
85T 013	201	<5	--	--	--	--	--	--
85T 014	201	45	--	--	--	--	--	--
85T 015	201	15	--	--	--	--	--	--
85T 016	201	<5	--	--	--	--	--	--
85T 017	201	<5	--	--	--	--	--	--
85T 018	201	<5	--	--	--	--	--	--
85T 019	201	<5	--	--	--	--	--	--
85T 020	201	<5	--	--	--	--	--	--
85T 021	201	<5	--	--	--	--	--	--
85T 022	201	<5	--	--	--	--	--	--
85T 023	201	<5	--	--	--	--	--	--
85T 024	201	<5	--	--	--	--	--	--
85T 025	201	<5	--	--	--	--	--	--
85T 026	201	<5	--	--	--	--	--	--
85T 027	201	<5	--	--	--	--	--	--
85T 028	201	<5	--	--	--	--	--	--
85T 029	201	<5	--	--	--	--	--	--
85T 030	201	15	--	--	--	--	--	--
85T 031	201	65	--	--	--	--	--	--
85T 032	201	65	--	--	--	--	--	--
85T 033	201	30	--	--	--	--	--	--
85T 034	201	35	--	--	--	--	--	--
85T 035	201	55	--	--	--	--	--	--
85T 036	201	10	--	--	--	--	--	--
85T 037	201	10	--	--	--	--	--	--
85T 038	201	<5	--	--	--	--	--	--
85T 039	201	<5	--	--	--	--	--	--

*Hart Bichler*

Certified by .....





# Chemex Labs Ltd.

Analytical Chemists • Geochemists • Registered Assayers

212 Brooksbank Ave.  
North Vancouver, B.C.  
Canada V7J 2C1  
Telephone: (604) 984-0221  
Telex: 043-52597

## CERTIFICATE OF ANALYSIS

TO : JMT SERVICES CORPORATION

6775 WEST BLVD.  
VANCOUVER, B.C.  
V6P 5R8

CERT. # : A8513284-002-A  
INVOICE # : I8513284  
DATE : 7-JUL-85  
P.O. # : NONE  
KANGAROO

Sample description	Prep code	Au ppb FA+AA						
85T 040	201	25	--	--	--	--	--	--
85T 041	201	<5	--	--	--	--	--	--
85T 042	201	<5	--	--	--	--	--	--
85T 043	201	<5	--	--	--	--	--	--
85T 044	201	<5	--	--	--	--	--	--
85T 045	201	<5	--	--	--	--	--	--
85T 046	201	<5	--	--	--	--	--	--
85T 047	201	20	--	--	--	--	--	--
85T 048	201	<5	--	--	--	--	--	--
85T 049	201	<5	--	--	--	--	--	--
85T 050	201	<5	--	--	--	--	--	--
85T 051	201	<5	--	--	--	--	--	--
85T 052	201	<5	--	--	--	--	--	--
85T 053	201	<5	--	--	--	--	--	--
85T 054	201	20 <sup>+</sup>	--	--	--	--	--	--
85T 055	201	<5	--	--	--	--	--	--
85T 056	201	<5	--	--	--	--	--	--
85T 057	201	30 <sup>x</sup>	--	--	--	--	--	--
85T 058	201	<5	--	--	--	--	--	--
85T 059	201	<5	--	--	--	--	--	--
85T 060	201	<5	--	--	--	--	--	--
85T 061	201	<5	--	--	--	--	--	--
85T 062	201	<5	--	--	--	--	--	--
85T 063	201	<5	--	--	--	--	--	--
85T 064	201	<5	--	--	--	--	--	--
85T 065	201	<5	--	--	--	--	--	--
85T 066	201	<5	--	--	--	--	--	--
85T 067	201	<5	--	--	--	--	--	--
85T 068	201	370 <sup>x</sup>	--	--	--	--	--	--
85T 070	201	50 <sup>x</sup>	--	--	--	--	--	--
85T 071	201	<5	--	--	--	--	--	--
85T 072	201	<5	--	--	--	--	--	--
85T 073	201	<5	--	--	--	--	--	--
85T 074	201	<5	--	--	--	--	--	--
85T 075	201	<5	--	--	--	--	--	--
85T 076	201	10 <sup>x</sup>	--	--	--	--	--	--
85T 077	201	<5	--	--	--	--	--	--
85T 078	201	<5	--	--	--	--	--	--
85T 079	201	<5	--	--	--	--	--	--
85T 080	201	<5	--	--	--	--	--	--

*Hart Buchler*

Certified by .....





# Chemex Labs Ltd.

Analytical Chemists • Geochemists • Registered Assayers

212 Brooksbank Ave.  
North Vancouver, B.C.  
Canada V7J 2C1  
Telephone: (604) 984-0221  
Telex: 043-52597

## CERTIFICATE OF ANALYSIS

TO : JMT SERVICES CORPORATION

6775 WEST BLVD.  
VANCOUVER, B.C.  
V6P 5R8

CERT. # : A8513284-003-A  
INVOICE # : I8513284  
DATE : 7-JUL-85  
P.O. # : NONE  
KANGAROO

Sample description	Prep code	Au ppb FA+AA					
85T 081	201	<5	--	--	--	--	--
85T 082	201	<5	--	--	--	--	--
85T 083	201	<5	--	--	--	--	--
85T 084	201	<5	--	--	--	--	--
85T 085	201	25	--	--	--	--	--
85T 086	201	<5	--	--	--	--	--
85T 087	201	<5	--	--	--	--	--
85T 088	201	<5	--	--	--	--	--
85T 089	201	<5	--	--	--	--	--
85T 090	201	<5	--	--	--	--	--
85T 091	201	<5	--	--	--	--	--
85T 092	201	<5	--	--	--	--	--
85T 093	201	<5	--	--	--	--	--
85T 094	201	<5	--	--	--	--	--
85T 095	201	<5	--	--	--	--	--
85T 096	201	<5	--	--	--	--	--
85T 097	201	<5	--	--	--	--	--
85T 098	201	<5	--	--	--	--	--
85T 099	201	<5	--	--	--	--	--
85T 100	201	<5	--	--	--	--	--
85T 101	201	<5	--	--	--	--	--
85T 102	201	<5	--	--	--	--	--
85T 103	201	<5	--	--	--	--	--
85T 104	201	<5	--	--	--	--	--
85T 105	201	<5	--	--	--	--	--
85T 106	201	<5	--	--	--	--	--
85T 107	201	<5	--	--	--	--	--
85T 108	201	<5	--	--	--	--	--
85T 109	201	<5	--	--	--	--	--
85T 110	201	<5	--	--	--	--	--
85T 111	203	<5	--	--	--	--	--
85T 112	201	<5	--	--	--	--	--
85T 113	201	<5	--	--	--	--	--
85T 114	201	<5	--	--	--	--	--
85T 115	201	<5	--	--	--	--	--
85T 116	201	<5	--	--	--	--	--
85T 117	201	<5	--	--	--	--	--
85T 118	201	<5	--	--	--	--	--
85T 119	201	<5	--	--	--	--	--
85T 120	201	<5	--	--	--	--	--



Certified by *Hart Bichler* .....

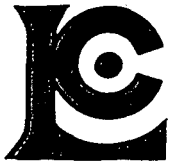

# Chemex Labs Ltd.

Analytical Chemists • Geochemists • Registered Assayers

212 Brooksbank Ave.  
North Vancouver, B.C.  
Canada V7J 2C1  
Telephone: (604) 984-0221  
Telex: 043-52597

## CERTIFICATE OF ANALYSIS

TO : JMT SERVICES CORPORATION

6775 WEST BLVD.  
VANCOUVER, B.C.  
V6P 5R8

CERT. # : A8513284-004-A  
INVOICE # : I8513284  
DATE : 7-JUL-85  
P.O. # : NONE  
KANGAROO

Sample description	Prep code	Au ppb FA+AA						
85T 121	201	<5	--	--	--	--	--	--
85T 122	201	<5	--	--	--	--	--	--
85T 123	201	<5	--	--	--	--	--	--
85T 124	201	<5	--	--	--	--	--	--
85T 125	201	<5	--	--	--	--	--	--
85T 126	201	<5	--	--	--	--	--	--
85T 127	201	<5	--	--	--	--	--	--
85T 128	201	<5	--	--	--	--	--	--
85T 129	201	<5	--	--	--	--	--	--
85T 130	201	<5	--	--	--	--	--	--
85T 131	203	<5	--	--	--	--	--	--
85T 132	201	<5	--	--	--	--	--	--
85T 133	201	<5	--	--	--	--	--	--
85T 134	201	<5	--	--	--	--	--	--
85T 135	201	<5	--	--	--	--	--	--
85T 136	201	<5	--	--	--	--	--	--
85T 137	201	<5	--	--	--	--	--	--
85T 138	201	<5	--	--	--	--	--	--
85T 139	201	<5	--	--	--	--	--	--
85T 140	201	<5	--	--	--	--	--	--
85T 141	201	<5	--	--	--	--	--	--
85T 142	201	<5	--	--	--	--	--	--
85T 143	201	<5	--	--	--	--	--	--
85T 144	201	<5	--	--	--	--	--	--
85T 145	201	<5	--	--	--	--	--	--
85T 146	201	<5	--	--	--	--	--	--
85T 147	201	<5	--	--	--	--	--	--
85T 148	201	<5	--	--	--	--	--	--
85T 149	201	<5	--	--	--	--	--	--
85T 150	201	<5	--	--	--	--	--	--
85T 151	201	<5	--	--	--	--	--	--
85T 152	201	<5	--	--	--	--	--	--
85T 153	201	<5	--	--	--	--	--	--
85T 154	201	<5	--	--	--	--	--	--
85T 155	201	<5	--	--	--	--	--	--
85T 156	201	<5	--	--	--	--	--	--
85T 157	201	<5	--	--	--	--	--	--
85T 158	201	<5	--	--	--	--	--	--
85T 159	201	<5	--	--	--	--	--	--
85T 160	201	<5	--	--	--	--	--	--



Certified by Hart Bichler



# Chemex Labs Ltd.

Analytical Chemists • Geochemists • Registered Assayers

212 Brooksbank Ave.  
North Vancouver, B.C.  
Canada V7J 2C1

Telephone: (604) 984-0221  
Telex: 043-52597

## CERTIFICATE OF ANALYSIS

TO : JMT SERVICES CORPORATION

6775 WEST BLVD.  
VANCOUVER, B.C.  
V6P 5R8

CERT. # : A8513284-005-A  
INVOICE # : I8513284  
DATE : 7-JUL-85  
P.O. # : NONE  
KANGAROO

Sample description	Prep code	Au ppb FA+AA						
85T 161	201	<5	--	--	--	--	--	--
85T 162	201	15	--	--	--	--	--	--
85T 163	201	<5	--	--	--	--	--	--
85T 164	201	<5	--	--	--	--	--	--
85T 165	201	<5	--	--	--	--	--	--
85T 166	201	20	--	--	--	--	--	--
85T 167	201	<5	--	--	--	--	--	--
85T 168	201	<5	--	--	--	--	--	--
85T 169	201	<5	--	--	--	--	--	--
85T 170	201	<5	--	--	--	--	--	--
85T 171	201	30	--	--	--	--	--	--
85T 172	201	40	--	--	--	--	--	--
85T 246	201	<5	--	--	--	--	--	--
85T 247	201	<5	--	--	--	--	--	--
85T 248	201	<5	--	--	--	--	--	--
85T 249	201	<5	--	--	--	--	--	--
85T 251	201	25	--	--	--	--	--	--
85T 252	201	20	--	--	--	--	--	--
85T 253	201	10	--	--	--	--	--	--
85T 254	201	25	--	--	--	--	--	--
85T 255	201	<5	--	--	--	--	--	--
85T 256	201	<5	--	--	--	--	--	--
85T 257	201	<5	--	--	--	--	--	--
85T 259	201	<5	--	--	--	--	--	--
85T 260	201	15	--	--	--	--	--	--
85T 261	201	<5	--	--	--	--	--	--
85T 262	201	<5	--	--	--	--	--	--
85T 263	201	<5	--	--	--	--	--	--
85T 264	201	<5	--	--	--	--	--	--
85T 266	201	<5	--	--	--	--	--	--
85T 267	201	<5	--	--	--	--	--	--
85T 268	201	<5	--	--	--	--	--	--
85T 269	201	<5	--	--	--	--	--	--
85T 270	201	15	--	--	--	--	--	--
85T 272	201	<5	--	--	--	--	--	--
85T 273	201	<5	--	--	--	--	--	--
85T 274	201	<5	--	--	--	--	--	--
85T 275	201	<5	--	--	--	--	--	--
85T 277	201	<5	--	--	--	--	--	--
85T 278	201	<5	--	--	--	--	--	--



Certified by *Hart Bechler*

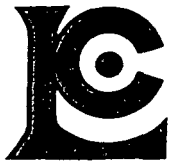

# Chemex Labs Ltd.

Analytical Chemists • Geochemists • Registered Assayers

212 Brooksbank Ave.  
North Vancouver, B.C.  
Canada V7J 2C1  
Telephone: (604) 984-0221  
Telex: 043-52597

## CERTIFICATE OF ANALYSIS

TO : JMT SERVICES CORPORATION

6775 WEST BLVD.  
VANCOUVER, B.C.  
V6P 5R8

CERT. # : A8513284-006-A  
INVOICE # : I8513284  
DATE : 7-JUL-85  
P.O. # : NONE  
KANGAROO

Sample description	Prep code	Au ppb FA+AA						
85T 279	201	25	--	--	--	--	--	--
85T 280	201	<5	--	--	--	--	--	--
85T 281	201	40	--	--	--	--	--	--
85T 282	201	<5	--	--	--	--	--	--
85T 283	201	<5	--	--	--	--	--	--
85T 284	201	<5	--	--	--	--	--	--
85T 287	201	<5	--	--	--	--	--	--
85T 288	201	<5	--	--	--	--	--	--
85T 289	201	<5	--	--	--	--	--	--
85T 290	201	<5	--	--	--	--	--	--
85T 291	201	<5	--	--	--	--	--	--
85T 292	201	<5	--	--	--	--	--	--
85T 293	201	<5	--	--	--	--	--	--
85T 295	201	<5	--	--	--	--	--	--
85T 296	201	<5	--	--	--	--	--	--
85T 297	201	<5	--	--	--	--	--	--
85T 298	201	<5	--	--	--	--	--	--
85T 299	201	<5	--	--	--	--	--	--
85T 300	201	<5	--	--	--	--	--	--
85T 301	201	35	--	--	--	--	--	--
85T 302	201	<5	--	--	--	--	--	--
85T 303	201	<5	--	--	--	--	--	--
85T 304	201	<5	--	--	--	--	--	--
85T 305	201	<5	--	--	--	--	--	--
85T 306	201	<5	--	--	--	--	--	--
85T 307	201	<5	--	--	--	--	--	--
85T 308	201	<5	--	--	--	--	--	--



Certified by Hart Bichler

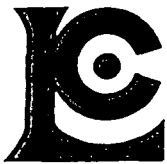

# Chemex Labs Ltd.

Analytical Chemists • Geochemists • Registered Assayers

212 Brooksbank Ave.  
North Vancouver, B.C.  
Canada V7J 2C1  
Telephone: (604) 984-0221  
Telex: 043-52597

## CERTIFICATE OF ANALYSIS

TO : JMT SERVICES CORPORATION

6775 WEST BLVD.  
VANCOUVER, B.C.  
V6P 5R8

CERT. # : A8513288-001-A  
INVOICE # : I8513288  
DATE : 7-JUL-85  
P.O. # : NONE  
KANGAROO

Sample description	Prep code	Au ppb FA+AA						
85R 105	205	<5	--	--	--	--	--	--
85R 106	205	<5	--	--	--	--	--	--
85R 107	205	<5	--	--	--	--	--	--
85R 108	205	<5	--	--	--	--	--	--
85R 109	205	<5	--	--	--	--	--	--
85R 110	205	150	--	--	--	--	--	--
85R 111	205	135	--	--	--	--	--	--
85R 114	205	<5	--	--	--	--	--	--
85R 115	205	<5	--	--	--	--	--	--
85R 116	205	20	--	--	--	--	--	--
85R 117	205	<5	--	--	--	--	--	--
85R 118	205	5	--	--	--	--	--	--
85R 125	205	<5	--	--	--	--	--	--
85R 129	205	<5	--	--	--	--	--	--
85R 139	205	<5	--	--	--	--	--	--
85R 142	205	<5	--	--	--	--	--	--
85R 147	205	<5	--	--	--	--	--	--
85R 152	205	<5	--	--	--	--	--	--
85R 155	205	<5	--	--	--	--	--	--
85R 158	205	<5	--	--	--	--	--	--
85R 159	205	<5	--	--	--	--	--	--
85R 160	205	<5	--	--	--	--	--	--
85R 161	205	<5	--	--	--	--	--	--
85R 162	205	<5	--	--	--	--	--	--
85T 069	205	210	--	--	--	--	--	--
85T 271	205	<5	--	--	--	--	--	--
85T 276	205	<5	--	--	--	--	--	--
85T 285	205	<5	--	--	--	--	--	--
85T 286	205	<5	--	--	--	--	--	--
85T 294	205	<5	--	--	--	--	--	--
WL-85-107	205	<5	--	--	--	--	--	--
WL-85-108	205	<5	--	--	--	--	--	--
WL-85-109	205	<5	--	--	--	--	--	--



Certified by Hart Bickler



APPENDIX II



# Chemex Labs Ltd.

Analytical Chemists • Geochemists • Registered Assayers

212 Brooksbank Ave.  
North Vancouver, B.C.  
Canada V7J 2C1  
Phone: (604) 984-0221  
Telex: 043-52597

## CERTIFICATE OF ASSAY

TO : JMT SERVICES CORPORATION

6775 WEST BLVD.  
VANCOUVER, B.C.  
V6P 5R8

CERT. # : A8513290-001-A  
INVOICE # : 18513290  
DATE : 9-JUL-85  
P.O. # : NONE  
KANGAROO

Sample description	Prep code	Au FA oz/T						
WL-85-100	207	0.004	--	--	--	--	--	--
WL-85-101	207	0.002	--	--	--	--	--	--
WL-85-102	207	0.002	--	--	--	--	--	--
WL-85-103	207	0.001	--	--	--	--	--	--
WL-85-104	207	0.004	--	--	--	--	--	--
WL-85-105	207	0.003	--	--	--	--	--	--
WL-85-106	207	0.004	--	--	--	--	--	--
WL-85-110 + 111	207	<0.001	--	--	--	--	--	--
WL-85-112	207	<0.001	--	--	--	--	--	--
WL-85-113	207	0.001	--	--	--	--	--	--
WL-85-114	207	0.001	--	--	--	--	--	--
WL-85-115	207	<0.001	--	--	--	--	--	--
WL-85-116	207	<0.001	--	--	--	--	--	--
WL-85-117	207	<0.001	--	--	--	--	--	--
WL-85-118	207	<0.001	--	--	--	--	--	--
WL-85-119	207	<0.001	--	--	--	--	--	--
WL-85-120	207	<0.001	--	--	--	--	--	--
WL-85-121	207	<0.001	--	--	--	--	--	--
WL-85-122	207	<0.001	--	--	--	--	--	--
WL-85-123	207	<0.001	--	--	--	--	--	--
WL-85-124	207	<0.001	--	--	--	--	--	--
WL-85-125	207	<0.001	--	--	--	--	--	--
WL-85-126	207	<0.001	--	--	--	--	--	--
WL-85-127	207	<0.001	--	--	--	--	--	--
WL-85-128	207	<0.001	--	--	--	--	--	--
WL-85-129	207	<0.001	--	--	--	--	--	--
WL-85-130	207	<0.001	--	--	--	--	--	--
WL-85-131	207	<0.001	--	--	--	--	--	--
WL-85-132	207	<0.001	--	--	--	--	--	--
WL-85-134	207	<0.001	--	--	--	--	--	--
WL-85-135	207	<0.001	--	--	--	--	--	--
WL-85-136	207	<0.001	--	--	--	--	--	--
WL-85-137	207	<0.001	--	--	--	--	--	--
WL-85-138	207	<0.001	--	--	--	--	--	--
WL-85-139	207	<0.001	--	--	--	--	--	--
WL-85-140	207	<0.001	--	--	--	--	--	--
WL-85-141	207	0.004	--	--	--	--	--	--
WL-85-142	207	0.004	--	--	--	--	--	--
WL-85-143	207	0.004	--	--	--	--	--	--
WL-85-144	207	0.003	--	--	--	--	--	--

VOI rev. 4/85

Registered Assayer, Province of British Columbia



# Chemex Labs Ltd.

Analytical Chemists • Geochemists • Registered Assayers

212 Brooksbank Ave.  
North Vancouver, B.C.  
Canada V7J 2C1

Phone: (604) 984-0221  
Telex: 043-52597

## CERTIFICATE OF ASSAY

TO : JMT SERVICES CORPORATION

6775 WEST BLVD.  
VANCOUVER, B.C.  
V6P 5R8

CERT. # : A8513290-002-A  
INVOICE # : I8513290  
DATE : 9-JUL-85  
P.O. # : NONE  
KANGAROO

Sample description	Prep code	Au FA oz/T						
WL-85-145	207	0.004	--	--	--	--	--	--
WL-85-146	207	0.002	--	--	--	--	--	--
WL-85-147	207	0.003	--	--	--	--	--	--
WL-85-148	207	0.004	--	--	--	--	--	--
WL-85-149	207	0.004	--	--	--	--	--	--
WL-85-150	207	0.004	--	--	--	--	--	--
WL-85-151	207	0.004	--	--	--	--	--	--
WL-85-152	207	0.004	--	--	--	--	--	--
WL-85-153	207	0.005	--	--	--	--	--	--
WL-85-154	207	0.005	--	--	--	--	--	--
WL-85-155	207	0.005	--	--	--	--	--	--
WL-85-156	207	0.005	--	--	--	--	--	--
WL-85-157	207	0.005	--	--	--	--	--	--
WL-85-158	207	0.005	--	--	--	--	--	--
WL-85-159	207	0.006	--	--	--	--	--	--
WL-85-160	207	0.006	--	--	--	--	--	--
WL-85-161	207	0.005	--	--	--	--	--	--
WL-85-162	207	0.006	--	--	--	--	--	--
WL-85-163	207	0.005	--	--	--	--	--	--
WL-85-164	207	0.005	--	--	--	--	--	--
WL-85-165	207	0.004	--	--	--	--	--	--
WL-85-166	207	0.009	--	--	--	--	--	--
WL-85-167	207	0.006	--	--	--	--	--	--
WL-85-168	207	0.006	--	--	--	--	--	--
WL-85-169	207	0.003	--	--	--	--	--	--
WL-85-170	207	0.001	--	--	--	--	--	--
WL-85-171	207	0.005	--	--	--	--	--	--
WL-85-172	207	0.005	--	--	--	--	--	--
WL-85-173	207	0.005	--	--	--	--	--	--
WL-85-174	207	0.005	--	--	--	--	--	--
WL-85-175	207	0.003	--	--	--	--	--	--
WL-85-176	207	0.006	--	--	--	--	--	--
WL-85-177	207	0.003	--	--	--	--	--	--
WL-85-178	207	0.003	--	--	--	--	--	--
WL-85-179	207	0.003	--	--	--	--	--	--
WL-85-180	207	0.005	--	--	--	--	--	--
WL-85-181	207	0.005	--	--	--	--	--	--
WL-85-182	207	0.005	--	--	--	--	--	--
WL-85-183	207	0.006	--	--	--	--	--	--
WL-85-184	207	0.005	--	--	--	--	--	--

VOI rev. 4/85

.....  
Registered Assayer, Province of British Columbia



# Chemex Labs Ltd.

Analytical Chemists • Geochemists • Registered Assayers

212 Brooksbank Ave.  
North Vancouver, B.C.  
Canada V7J 2C1  
Phone: (604) 984-0221  
Telex: 043-52597

## CERTIFICATE OF ASSAY

TO : JMT SERVICES CORPORATION

6775 WEST BLVD.  
VANCOUVER, B.C.  
V6P 5R8

CERT. # : A8513290-003-A  
INVOICE # : 18513290  
DATE : 9-JUL-85  
P.O. # : NONE  
KANGAROO

Sample description	Prep code	Au FA oz/T					
WL-85-185	207	0.003	--	--	--	--	--
WL-85-186	207	0.002	--	--	--	--	--
WL-85-187	207	0.001	--	--	--	--	--
WL-85-188	207	<0.001	--	--	--	--	--
WL-85-189	207	<0.001	--	--	--	--	--
WL-85-190	207	<0.001	--	--	--	--	--
WL-85-191	207	<0.001	--	--	--	--	--
WL-85-192	207	0.001	--	--	--	--	--
WL-85-193	207	0.003	--	--	--	--	--
WL-85-194	207	<0.001	--	--	--	--	--
WL-85-195	207	<0.001	--	--	--	--	--
WL-85-196	207	0.002	--	--	--	--	--
WL-85-197	207	0.001	--	--	--	--	--
WL-85-198	207	0.003	--	--	--	--	--
WL-85-199	207	0.001	--	--	--	--	--
WL-85-200	207	0.006	--	--	--	--	--
WL-85-201	207	0.004	--	--	--	--	--
WL-85-202	207	0.005	--	--	--	--	--
WL-85-203	207	0.004	--	--	--	--	--
WL-85-204	207	0.003	--	--	--	--	--
WL-85-205	207	0.002	--	--	--	--	--
WL-85-206	207	0.003	--	--	--	--	--
WL-85-207	207	0.004	--	--	--	--	--
WL-85-208	207	0.003	--	--	--	--	--
WL-85-209	207	0.005	--	--	--	--	--
WL-85-210	207	0.004	--	--	--	--	--
WL-85-211	207	<0.001	--	--	--	--	--
WL-85-212	207	<0.001	--	--	--	--	--
WL-85-213	207	0.001	--	--	--	--	--
WL-85-214	207	0.005	--	--	--	--	--
WL-85-215	207	0.007	--	--	--	--	--
WL-85-216	207	0.004	--	--	--	--	--
WL-85-217	207	0.005	--	--	--	--	--
WL-85-218	207	0.005	--	--	--	--	--
WL-85-219	207	0.008	--	--	--	--	--
WL-85-220	207	0.009	--	--	--	--	--
WL-85-221	207	0.005	--	--	--	--	--
WL-85-222	207	0.005	--	--	--	--	--
WL-85-223	207	0.007	--	--	--	--	--
WL-85-224	207	0.010	--	--	--	--	--

VOI rev. 4/85

Registered Assayer, Province of British Columbia



# Chemex Labs Ltd.

Analytical Chemists • Geochemists • Registered Assayers

212 Brooksbank Ave.  
North Vancouver, B.C.  
Canada V7J 2C1  
Phone: (604) 984-0221  
Telex: 043-52597

## CERTIFICATE OF ASSAY

TO : JMT SERVICES CORPORATION

6775 WEST BLVD.  
VANCOUVER, B.C.  
V6P 5R8

CERT. # : A8513290-004-A  
INVOICE # : I8513290  
DATE : 9-JUL-85  
P.O. # : NONE  
KANGAROO

Sample description	Prep code	Au FA oz/T					
WL-85-225	207	0.008	--	--	--	--	--
WL-85-226	207	0.005	--	--	--	--	--
WL-85-227	207	0.009	--	--	--	--	--
WL-85-228	207	0.007	--	--	--	--	--
WL-85-230	207	0.002	--	--	--	--	--
WL-85-231	207	0.002	--	--	--	--	--
WL-85-232	207	0.002	--	--	--	--	--
WL-85-233	207	<0.001	--	--	--	--	--
WL-85-234	207	<0.001	--	--	--	--	--
WL-85-235	207	<0.001	--	--	--	--	--
WL-85-236	207	0.002	--	--	--	--	--
WL-85-237	207	<0.001	--	--	--	--	--
WL-85-238	207	<0.001	--	--	--	--	--

VOI rev. 4/85

.....  
Registered Assayer, Province of British Columbia

LIST OF ILLUSTRATIONS

<u>Drawing No.</u>	<u>Title</u>	<u>Scale</u>
Figure 1	Property Location Map	1:2,000,000
Figure 2	Claim Map	1:50,000
Figure 3	Wank #4 Geochemistry Grid	1:5,000
Figure 4	Geology and Geochemistry	1:10,000
Figure 5	Geology and Geochemistry	1:5,000

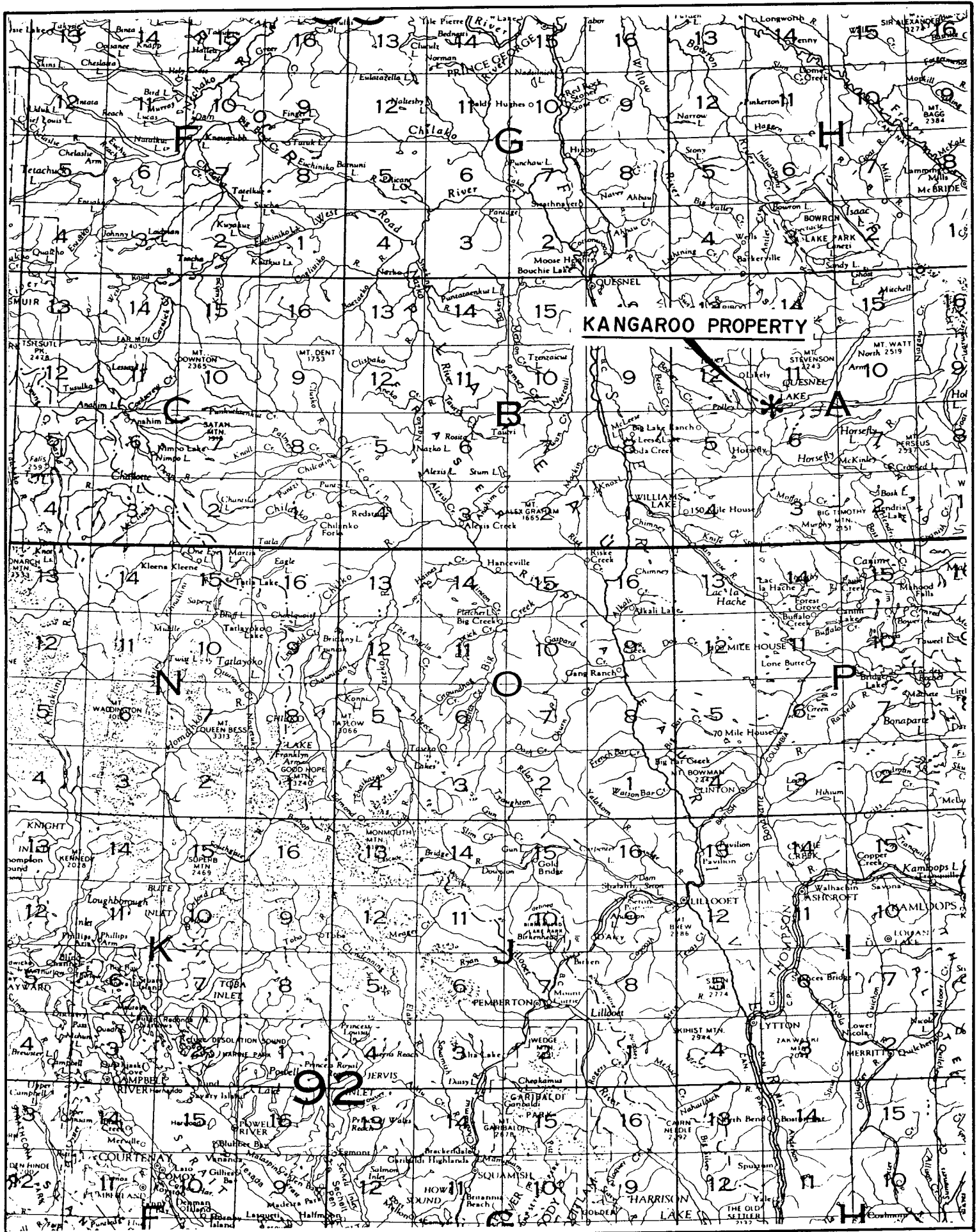

**KANGAROO PROPERTY**

**KANGAROO PROPERTY  
PROPERTY LOCATION**



**E & B EXPLORATIONS INC.**

DATE: Sept. / 1985

SCALE: 1 : 2,000,000



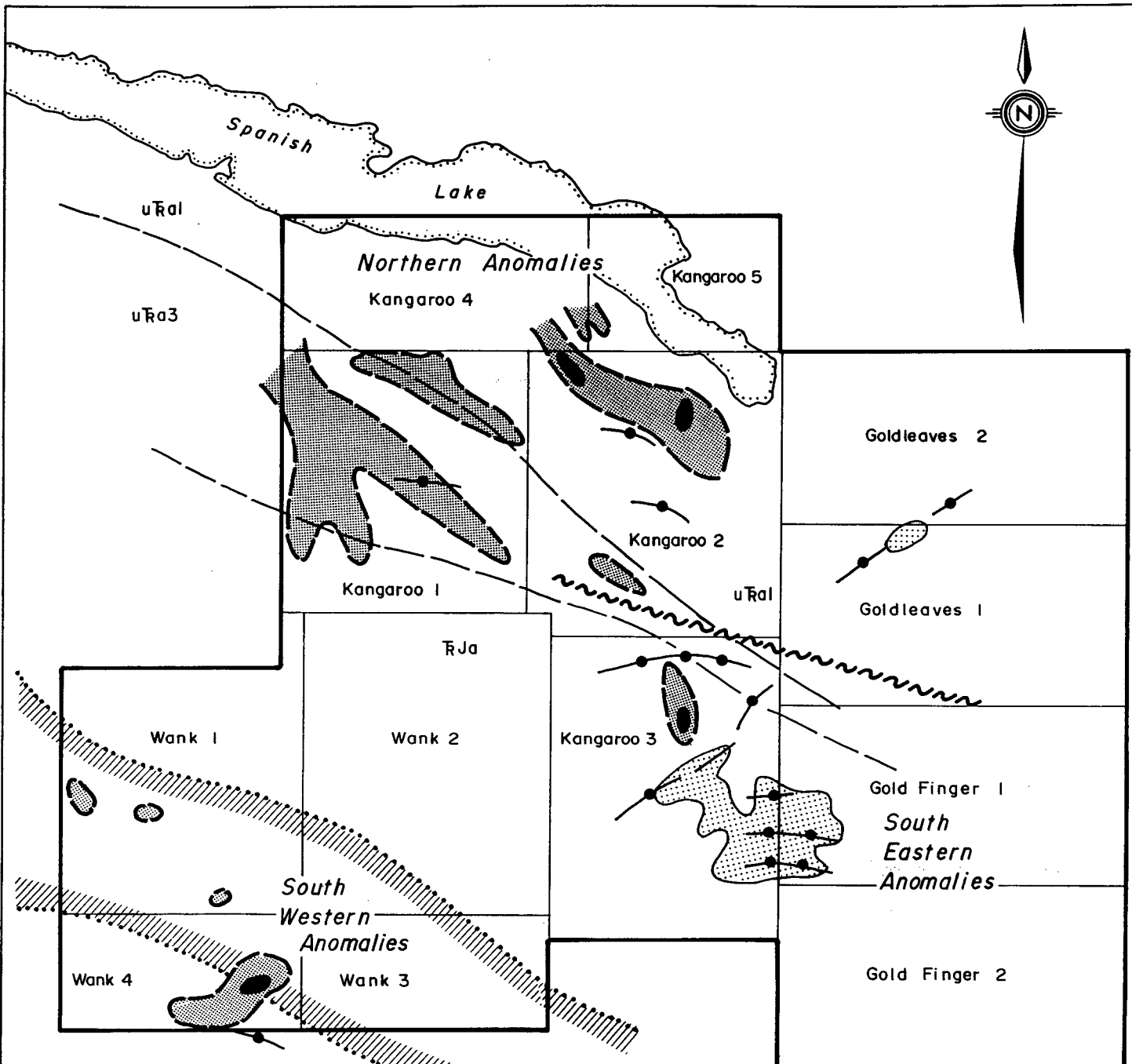

DRAWING No. Fig. 1

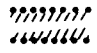

**LEGEND**

- RJa - Basaltic tuff & breccia; argillite, flows, chert
- uRa1 - Phyllite, argillite, minor greenstone (sub-greenschist to amphibolite facies of metamorphism)
- uRa3 - Greenstone, tuff breccia, argillite (may include undivided uRa1)

**ANOMALIES LEGEND**

-  Magnetic Trend
-  Magnetic High
-  VLF Conductors
-  10-50 ppb Au
-  > 50 ppb Au



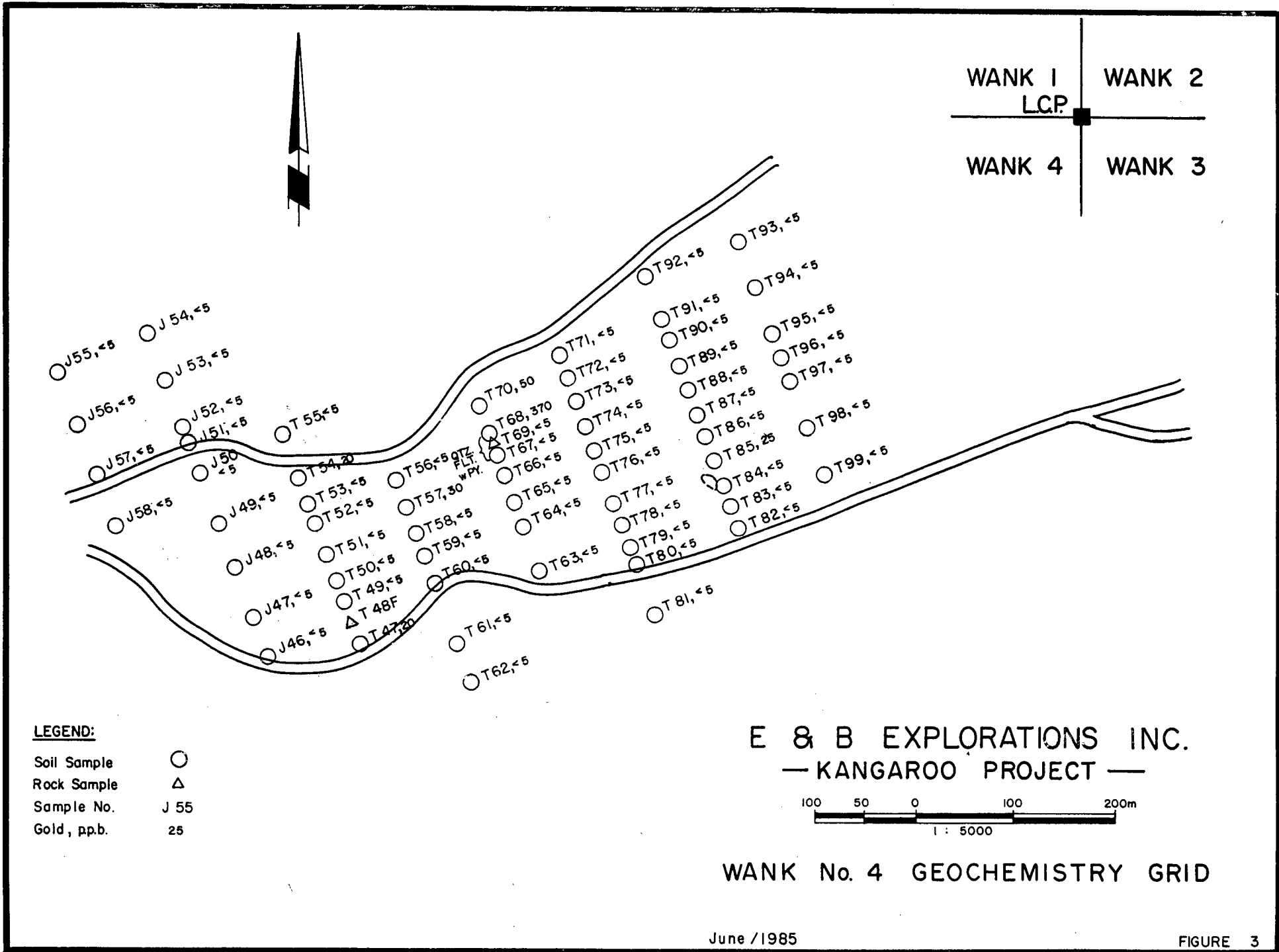

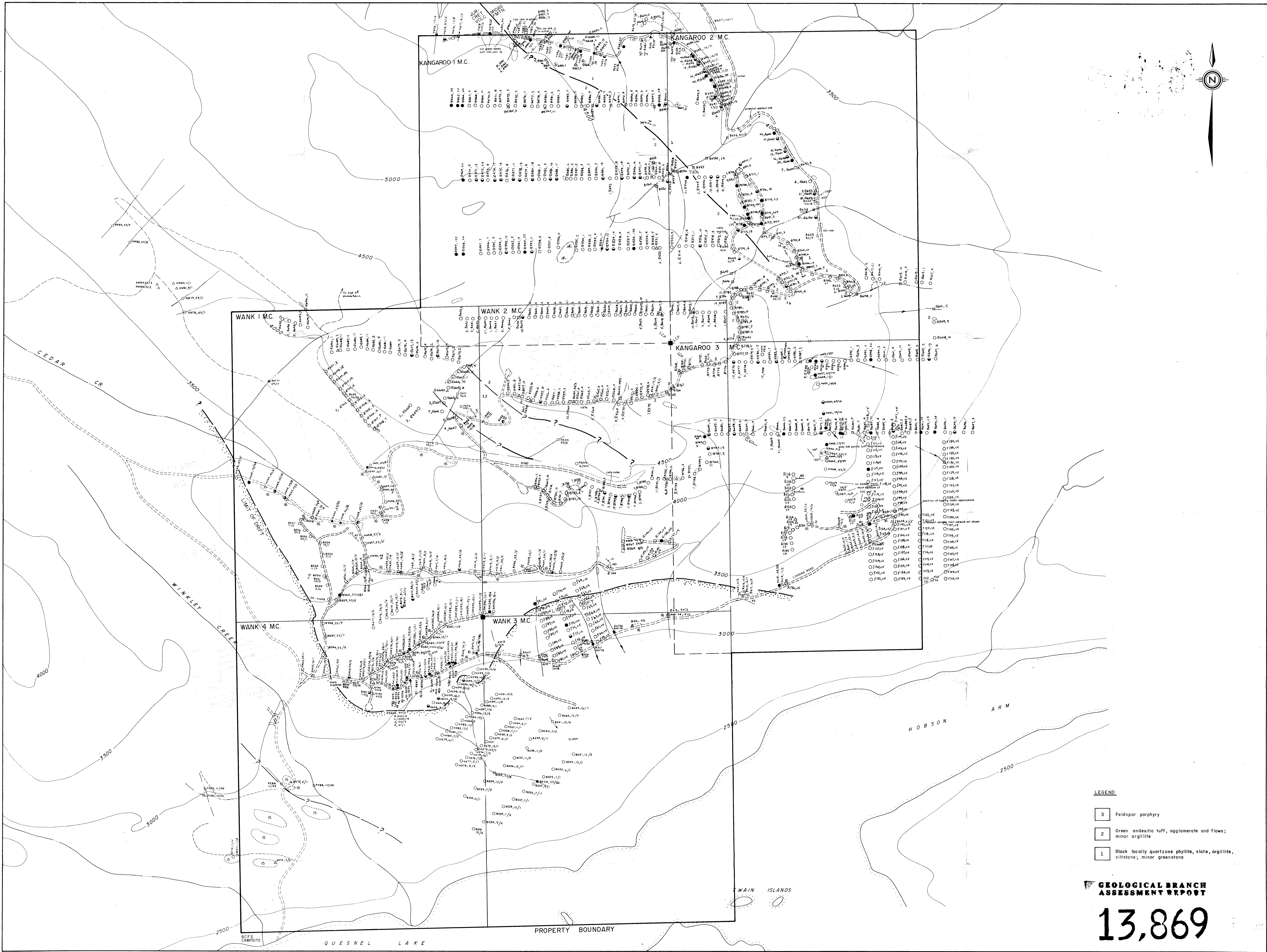
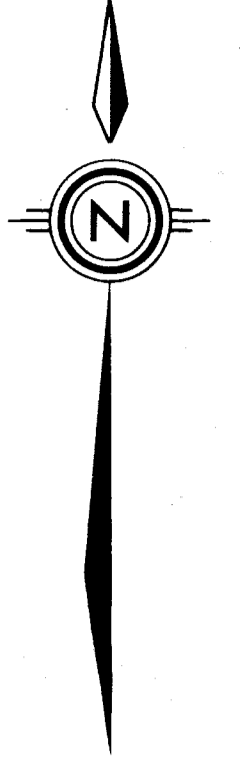

- LEGEND:**
- 3 Feldspar porphyry
  - 2 Green andesitic tuff, agglomerate and flows; minor argillite
  - 1 Black locally quartzose phyllite, slate, argillite, siltstone; minor greenstone

**GEOLOGICAL BRANCH  
ASSESSMENT REPORT**

**13,869**

**GOLD CODING**  
 ○ 10 - 19 Ppb Au  
 ● >19 Ppb Au

--- LIMIT OF OUTCROP  
 ? --- GEOLOGICAL CONTACT ASSUMED

**LEGEND**  
 1982 DATA  
 25 / 10 = ARSENIC (ppm), GOLD (ppb)  
 / - 10 = LESS THAN  
 / + 10 = GREATER THAN  
 Single results - Gold (ppb.)

○ SOIL SAMPLE  
 △ ROCK CHIP  
 □ SILT SAMPLE

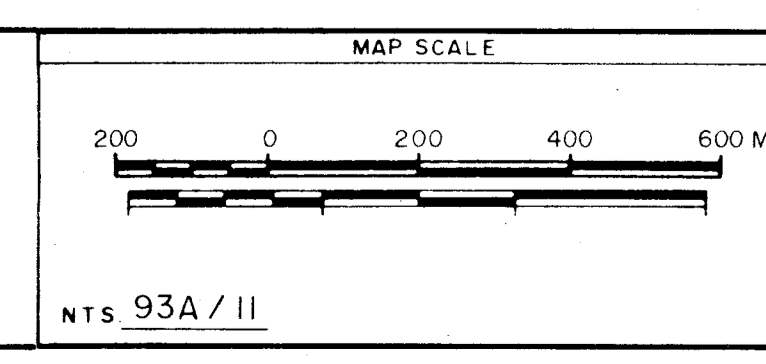

NO.	DATE	DRAWN BY	CHECKED	APPROVED	DESCRIPTION
1	4, 1, 82	J.V.V.			
2					
3					
4					

**E & B** E & B Explorations Inc.

QUESNEL REGIONAL PROJECT KANGAROO PROPERTY	
MAP INDEX NUMBER	SCALE 1:10,000
DEPARTMENT	DRAWING NUMBER FIG. 4

FIGURE 5

**LEGEND:**

- OUTCROP PATTERN
- FAULT
- SHEARING ATTITUDE WITH DIP
- OVERTURNED SYNONYM WITH PLUNGE
- OVERTURNED ANTIFORM WITH PLUNGE
- BEDDING ATTITUDE FLAT
- ROAD
- SKID TRACK
- SOIL SAMPLE LOCATION
- △ ROCK SAMPLE LOCATION
- SILT SAMPLE LOCATION
- SAMPLE NUMBER, PRESENT SURVEY
- SAMPLE NUMBER, PREVIOUS SURVEY

**GEOLOGICAL LEGEND:**

- 4 DACITE TUFFS
- 3 PILLOW AND PILLOW BRECCIAS
- 20 TUFFS / ARGILLACEOUS TUFFS WITH BLACK PHYLLITE
- 1 BLACK PHYLLITE
- 19 P.R.B. Au IN SOIL
- 49 P.R.B. Au IN SOIL
- GEOLOGICAL CONTACT

GEOLOGICAL TRANCH  
 ASSESSMENT REPORT  
 13,869

SURVEY BY HIP CHAIN, COMPASS, ON 1:50,000 N.T.S. MAP ENLARGEMENT

