

9/86

PROSPECTING
ASSESSMENT REPORT

TYPE: Self Potential

CLAIMS: Moon group

MINING DIVISION: Nanaimo, B.C.

NTS LOCATION: 92F/14 - 92F/13

LATITUDE: 49° 49'

LONGITUDE: 125° 27'

OWNERS: R.A. Neill
R.W. Neill
E. Carruthers

OPERATORS: Operated by owners

AUTHOR: R.A. Neill

DATE: October 25, 1985

**GEOLOGICAL BRANCH
ASSESSMENT REPORT**

13,935

TABLE OF CONTENTS

SUMMARY	1
GENERAL	1
CLAIMS AND PROPERTY HISTORY	1
GEOLOGY	2
SELF POTENTIAL SURVEY	2
STATEMENT OF EXPENDITURES	3
QUALIFICATIONS OF OPERATORS	4
DIAMOND DRILL REPORT	5
DRILLING EXPENCE	5
CORE LOG	6
CORE LOG	7

SUMMARY

Five km of grid was marked and chained, and self potential surveys completed on the Moon group about 25 km southwest of Campbell River. A fairly strong minus reading was noted, indicating a mineralized area and should be tested by further drilling.

GENERAL

The Moon group is located at the headwaters of the chute and Balsum Creeks about 25 km southwest of Campbell River and can be reached via the Oyster River logging road. Elevation ranges from 1000 metres to 1400 metres. Most of the area east of Balsum Creek has been logged. The area west of Balsum Creek is mostly virgin forest.

CLAIMS AND PROPERTY HISTORY

The Moon group consists of claims:

Moon and Moon II	1560 - 1561
Moon III to VI	1609 - 1612
Shine I to IV	1613 - 1616
Elsie I to IV	1617 - 1620

Totalling 36 units in the Nanaimo mining district and held by R.A. Neill and Eric Carruthers.

Craigmont Mines hold the claims to the northwest and they indicate a strong zinc anomaly running to the southwest.

GEOLOGY

The property is underlain by upper triassic rocks of the Vancouver group. (Muller et al., GSC Map 2 - 1965) consisting of basalt, black limestone and shale intruded by granitic rocks on the western side of the claims. The eastern side is overlain by conglomerate and sandstone. Outcrop is sparse except in the creek bottoms on the west side.

SELF POTENTIAL SURVEY

Readings were taken 25 m intervals along lines 100 m apart using a voltmeter 200 m No. 18 stranded insulated wire and electrodes consisting of porous pots containing saturated copper sulphate solution.

Draft and map included in this report.

STATEMENT OF EXPENDITURES

PERSONNEL

R.W. Neill - Chaining and marking grid 5 days at \$100 per day	\$ 500
K. Neill - Chaining and marking grid 5 days at \$75 per day	375
R.A. Neill - Supervision and chaining 5 days at \$100 per day	500
R.W. Neill - Self potential survey 5 days at \$100 per day	500
R.A. Neill - Self potential survey, plotting and mapping. 5 days at \$100 per day	500
K. Neill - Self potential survey 5 days at \$75 per day	375
- Accomodations, groceries, meals. 30 man days at \$30 per day	900

VEHICLE AND TRAVEL

- 400 km at 20¢ per km	80
------------------------	----

MISCELLANEOUS

- Maps, string, ribbon, wire	40
------------------------------	----

TOTAL	\$3770
-------	--------

QUALIFICATIONS OF OPERATORS

ROBERT NEILL has completed Grade XII at Belmont High in Victoria, B.C. He has completed the basic prospecting course, and also the advanced prospecting course. He has had 3 years training in the field.

REG NEILL has had 30 years of mining experience. He has been instructed in the basic prospectors course, and has worked in the field for about three years.

DIAMOND DRILL REPORT

There has been four holes drilled on the property, and their locations are marked on the draft.

Hole No. 1 (33 m) was drilled in 1984 and was reported as assessment work that year.

Holes No. 2, 3, and 4 were drilled this year (1985) and their core is stored at 2836 Jacklin Road, Victoria, B.C.

DRILLING EXPENCE

Hole No. 2 - 33 metres at \$48 per metre	\$1584
Hole No. 3 - 20 metres at \$48 per metre	960
Hole No. 4 - 12 metres at \$48 per metre	576
<u>TOTAL COST</u>	<u>\$3120</u>

The core has not been logged as yet.

These holes are in sedimentary rock to their depths. We plan to drill 150 metre hole in the centre of the anomaly.

MOON GROUP CORE LOG

D DRILL HOLE #1

0 - 1 m	Overburden
1 - 6 m	Graywaky
6 - 12 m	Graywaky with mudstone concretions
12 - 20 m	Graywaky with mudstone concretions, unsettled fragments of shale and 20 - 25% calcite carbonates
20 - 25 m	Graywaky with unsettled fragments of shale, mudstone concretions 20 - 25% calcite carbonates and traces of minute fossils
25 - 33 m	Graywaky to sandstone with small deposits of sulfide, unsettled fragments of shale and 20 - 25% calcite carbonate

MOON GROUP CORE LOG

D DRILL HOLE #2

0 - 1 m Overburden
1 - 8 m Graywaky
8 - 25 m Graywaky hosting mudstone concretions,
 unsettled shale fragments and 20 - 25%
 calcite carbonate
25 - 33 m Graywaky and sandstone with unsettled shale
 fragments, 20 - 25% calcite carbonate,
 mudstone concretions and traces of sulphide
 deposits

D DRILL HOLE #3

0 - 1 m Overburden
1 - 5 m Graywaky hosting mudstone concretions
5 - 12 m Graywaky, mudstone concretions and unsettled
 shale fragments
12 - 20 m Graywaky, mudstone concretions and unsettled
 shale fragments with little to no calcite
 carbonate

D DRILL HOLE #4

0 - 1 m Overburden
1 - 7 m Upper cratatic nanimoe sedementry graywaky
 hosting mudstone concretions
7 - 12 m Graywaky hosting small particals of calcite
 carbonate and unsettled fragments of shale

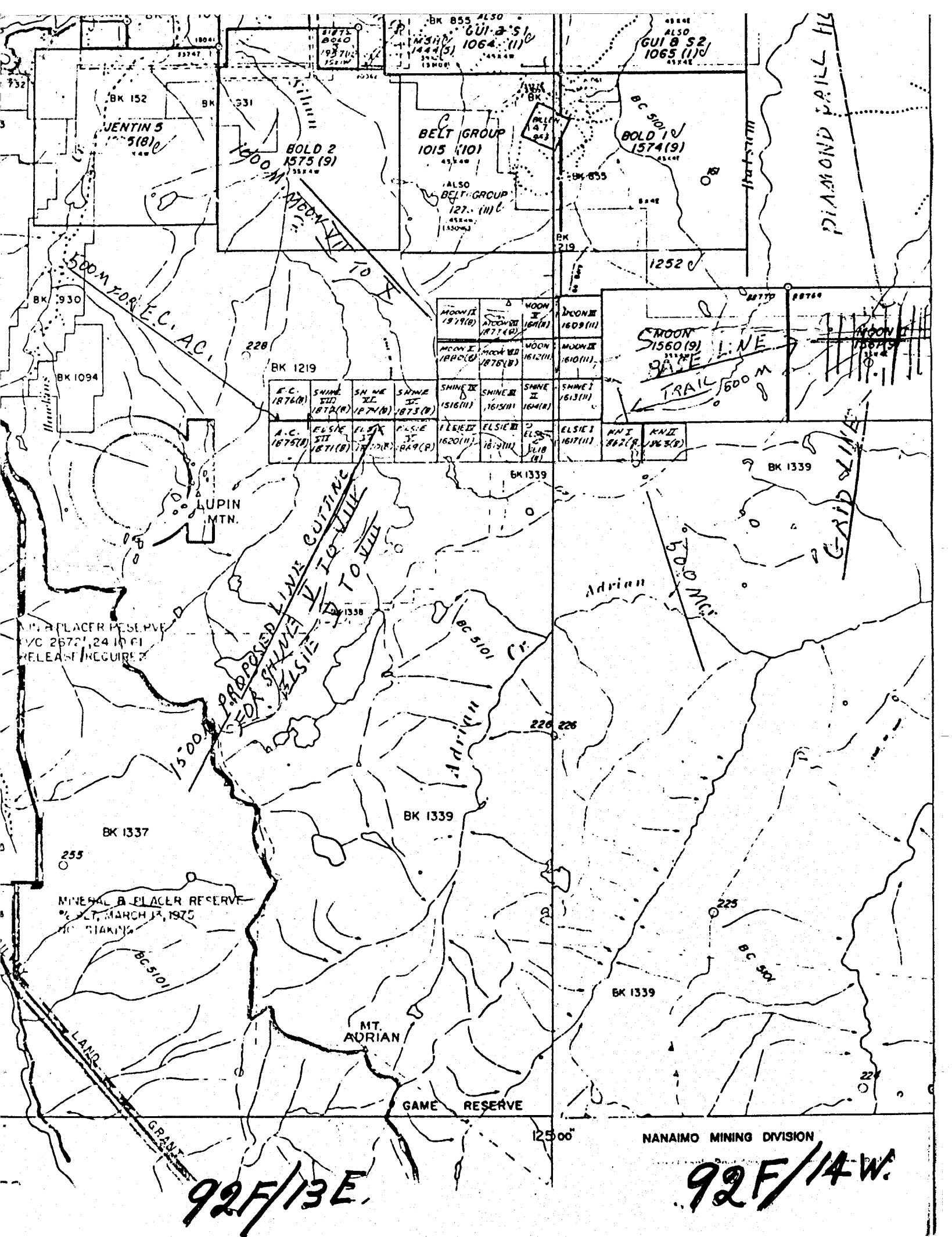

MOON I 1879(B)	MOON II 1877(A)	MOON III 1878(B)	MOON IV 1879(B)	MOON V 1879(B)	MOON VI 1879(B)	MOON VII 1879(B)	MOON VIII 1879(B)	MOON IX 1879(B)	MOON X 1879(B)
SHINE I 1876(B)	SHINE II 1876(B)	SHINE III 1876(B)	SHINE IV 1876(B)	SHINE V 1876(B)	SHINE VI 1876(B)	SHINE VII 1876(B)	SHINE VIII 1876(B)	SHINE IX 1876(B)	SHINE X 1876(B)
E.C. 1876(B)	ELSI 1871(B)	ELSI 1871(B)	ELSI 1871(B)	ELSI 1871(B)	ELSI 1871(B)	ELSI 1871(B)	ELSI 1871(B)	ELSI 1871(B)	ELSI 1871(B)

92F/13E

92F/14W

NANAIMO MINING DIVISION

125 00'

GAME RESERVE

MT. ADRIAN

MINERAL & PLACER RESERVE
EST. MARCH 13, 1975
NO STAKING

BK 1337

BK 1339

BK 1339

BK 1339

BK 1339

BK 1219

BK 1094

BK 930

BK 152

BK 531

BELT GROUP
1015 (10)

BOLD 1
1574 (9)

BOLD 2
1575 (9)

BC 501 V

ALSO BELT GROUP
127 (11)

SMOON
5150 (9)

TRAIL 500M

Adrian

1500M PROPOSED LINE CUTTING
FOX SHINE V TO VILL
ELSI V TO VILL

500M FOR E.C. AC.

DIAMOND PAIL HL

GRID LINE

TRAIL 500M

500M FOR E.C. AC.

MINERAL & PLACER RESERVE
EST. MARCH 13, 1975
NO STAKING

LAND

GRANT

92F/13E

92F/14W

NANAIMO MINING DIVISION

125 00'

GAME RESERVE

MT. ADRIAN

MINERAL & PLACER RESERVE
EST. MARCH 13, 1975
NO STAKING

BK 1337

BK 1339

BK 1339

BK 1339

BK 1339

BK 1219

BK 1094

BK 930

BK 152

BK 531

BELT GROUP
1015 (10)

BOLD 1
1574 (9)

BOLD 2
1575 (9)

BC 501 V

ALSO BELT GROUP
127 (11)

SMOON
5150 (9)

TRAIL 500M

Adrian

1500M PROPOSED LINE CUTTING
FOX SHINE V TO VILL
ELSI V TO VILL

500M FOR E.C. AC.

DIAMOND PAIL HL

GRID LINE

TRAIL 500M

500M FOR E.C. AC.

MINERAL & PLACER RESERVE
EST. MARCH 13, 1975
NO STAKING

LAND



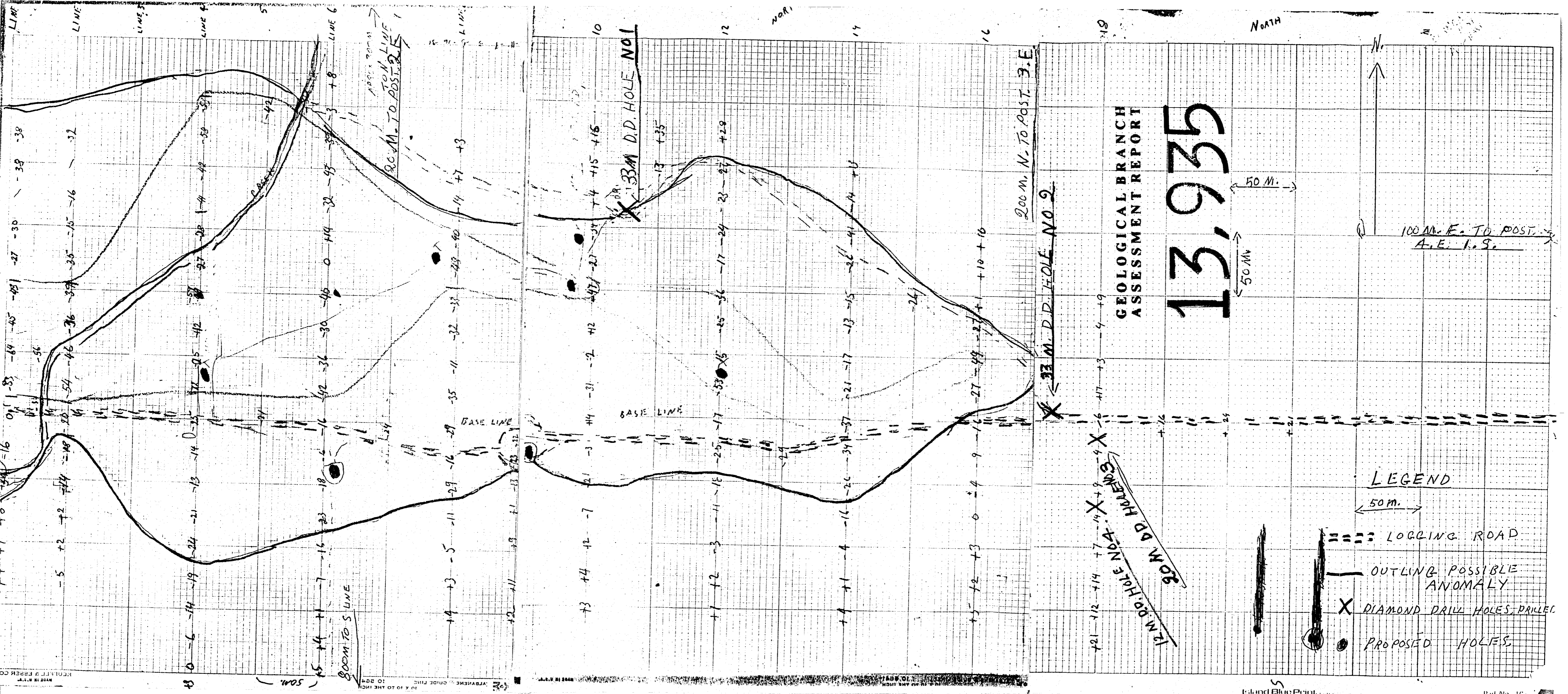

GRANT



GEOLOGICAL BRANCH
ASSESSMENT REPORT

13,935

LEGEND

-  LOGGING ROAD
-  OUTLINE POSSIBLE ANOMALY
-  DIAMOND DRILL HOLES, DRILLED
-  PROPOSED HOLES

200 M. N. TO POST. 3.E

33 M. D.D. HOLE NO. 2

33 M. D.D. HOLE NO. 1

800 M. TO S. LINE

80 M. TO POST. 2.E

100 M. E. TO POST. 4
A.E. 1. S.

50 M.

50 M.

50 M.

12 M. DIAM. HOLE NO. 4
80 M. D.D. HOLE NO. 3