

ASSESSMENT REPORT

A GEOCHEMICAL REPORT ON
GOLD MINE AND GOLD HILL CLAIMS
WHISTLE CREEK
HEDLEY AREA
SIMILKAMEEN MINING DIVISION
92H 8E
49°20' north latitude, 120°07' west longitude

OWNER OF CLAIMS

PHILEX GOLD & ENERGY CORPORATION
717 - 837 West Hastings Street
Vancouver, B.C.

OPERATOR:

B.A. FENWICK-WILSON

**GEOLOGICAL BRANCH
ASSESSMENT REPORT**

B.A. FENWICK-WILSON
October 15, 1985

13,988

TABLE OF CONTENTS

	<u>Page</u>
SUMMARY.....	1
INTRODUCTION.....	2
Location & Access.....	2
Topography & Vegetation.....	2
Property.....	3
History.....	3&4
GEOLOGY.....	5
General Geology.....	5
Local Geology.....	5
FIELD WORK.....	7
Geochemical Soil Survey.....	7
Geochemical Conclusions.....	8
REFERENCES.....	9
CERTIFICATE.....	10
APPENDIX I - Statement of Costs.....	11&12
APPENDIX II - Geochemical Result Certificates.....	13-25
APPENDIX III - Laboratory Procedures.....	26
POCKET INSERTS - Maps of geochemical anomalies.....	

LIST OF ILLUSTRATIONS

FIGURE 1 - Location Map..... 2A
FIGURE 2 - Claim Map..... 3A
FIGURE 3 - Frequency distribution for As in ppm..... 25 A
FIGURE 4 - Frequency distribution for Au in ppb..... 25 B
FIGURE 5 - Frequency distribution for Ag in ppm..... 25 C
FIGURE 6 - Frequency distribution for Zn in ppm..... 25 D
FIGURE 7 - Grid Map of As anomalies in pocket
FIGURE 8 - Grid Map of Au anomalies in pocket

SUMMARY

Between August 12th-31st 1985, a crew consisting of four field assistants under the direction of B. Fenwick-Wilson, conducted a soil geochemical survey program over a portion of the Philex Gold & Energy Corporation's Gold Mine & Gold Hill claims, located some 5 kms. west of Hedley, B.C. (fig.1)

A grid was surveyed at 50 meter intervals N/S.T. and 100 meter intervals E/W.T. All lines were clearly marked and individual sample locations were ribboned with identification numbers.

Later in the fall of 1985 this survey will be enlarged to cover more of this claims, as well as closing in, with closer spacing of soil samples, to better define areas that are anomalous.

This geo-chem grid will be used when this area's geology is mapped in detail.

The grid lines totalled 38 kms. and a total of 529 samples were collected and sent to the Chemex Labs in North Vancouver for analysis.

This program cost some \$11,570.

INTRODUCTION

In August 1985 Philex Gold & Energy Corporation conducted a soil geo-chemical survey of the Gold Mine and Gold Hill claims 5 Kms. due west of Hedley, B.C. This was a reconnaissance program with samples collected at 100 M - 50 M spacings.

Location & Access 49°20' North latitude
 120°07' West longitude

The Philex Gold & Energy Corporation property is located in Southern British Columbia, some 5 Kms. due west of Hedley. It is situated on the south side of the Similkameen River Valley on the wide ridge between Whistle-Pettigrew Creeks and Henri Creek. Elevations range from 550 M to 1525 M above sea level.

Good logging roads lead from Highway #3, 3.5 Km. west of Hedley. Main logging road follows Whistle Creek but a branch road near the 4 Km. mark leads to the claims.

Roads are numerous within the claims area. Most are open, though some of the older ones are overgrown and eroded.

Topography and Vegetation

The topography of the property is a rounded gently sloping ridge top.

Bounded on the north, west and east by steep and very steep slopes.

Some 80% is forested and about 20% open pasture. Douglas

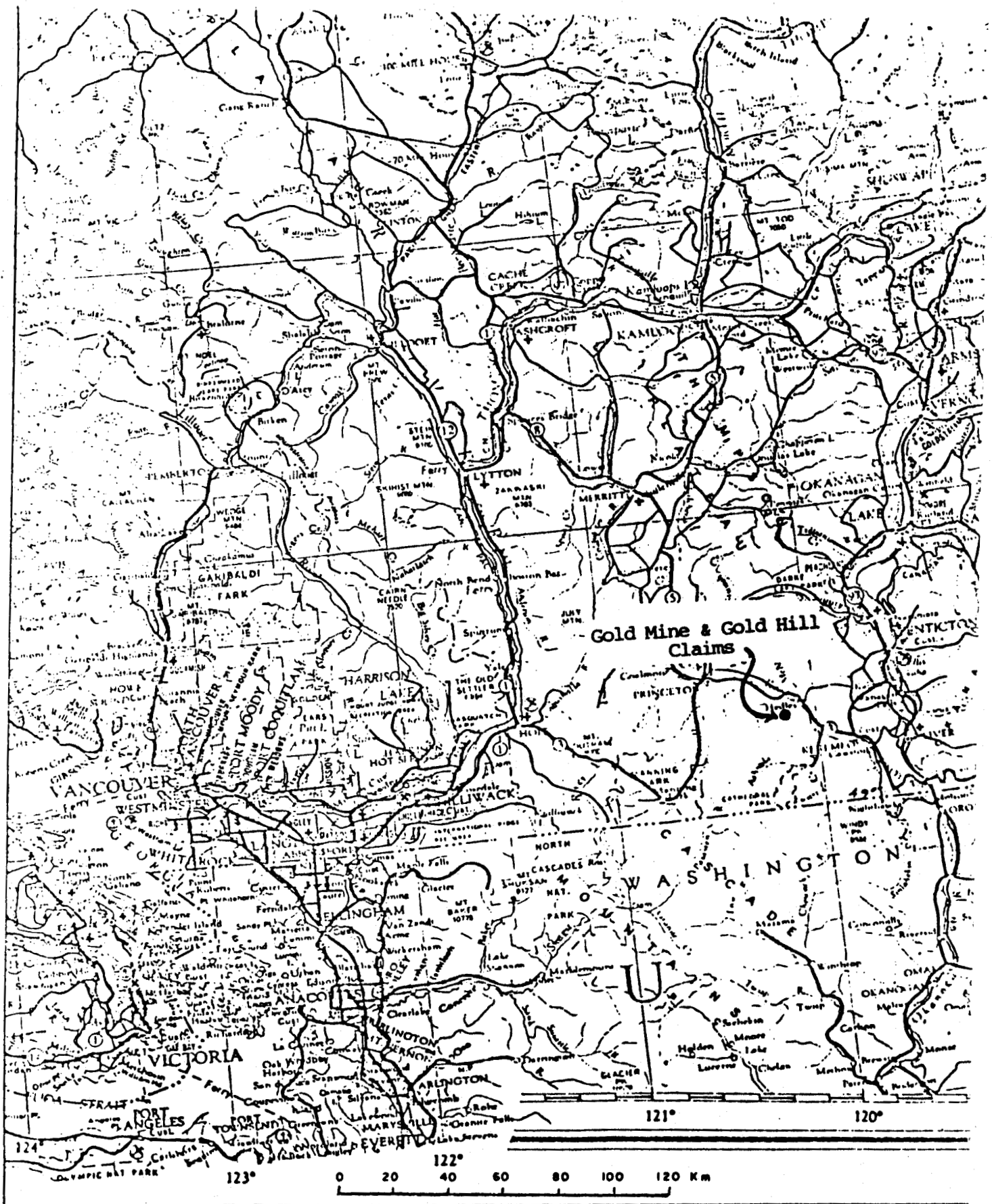

FIGURE I
 LOCATION MAP
 GOLD MINE & GOLD HILL CLAIMS
 HEDLEY AREA
 SIMILKAMEEN M.D.
 1:1,900,800

fir, ponderosa pine, and spruce are the predominant conifers. The southern portion of the Gold Hill group is open, gently sloping grass lands.

Property

The property consists of two claims as follows (fig.2):

<u>Claim name</u>	<u>No.of Units</u>	<u>Record No.</u>	<u>Expiry date</u>
Gold Hill	15	1161(9)	September 8, 1986
Gold Mine	15	1177(9)	September 23, 1986

The claims are owned by Philex Gold & Energy Corporation, 717 - 837 West Hastings Street, Vancouver, B.C.

History

The Hedley area has been the site of much mining activity for many years. The majority of the work has been on the north side of the Similkameen River where there were several successful mining operations. Recently renewed activity in this area is proving up several economic gold ore bodies, open pitable and large tonage.

On the south side of the Similkameen, past work appears to have been limited to searching for and testing quartz veins and skarns. More recently exploration has been directed towards limy rocks with considerable success.

In the past some work has been done in the Gold Hill & Gold Mine claims, principally investigating large quartz-carbonate

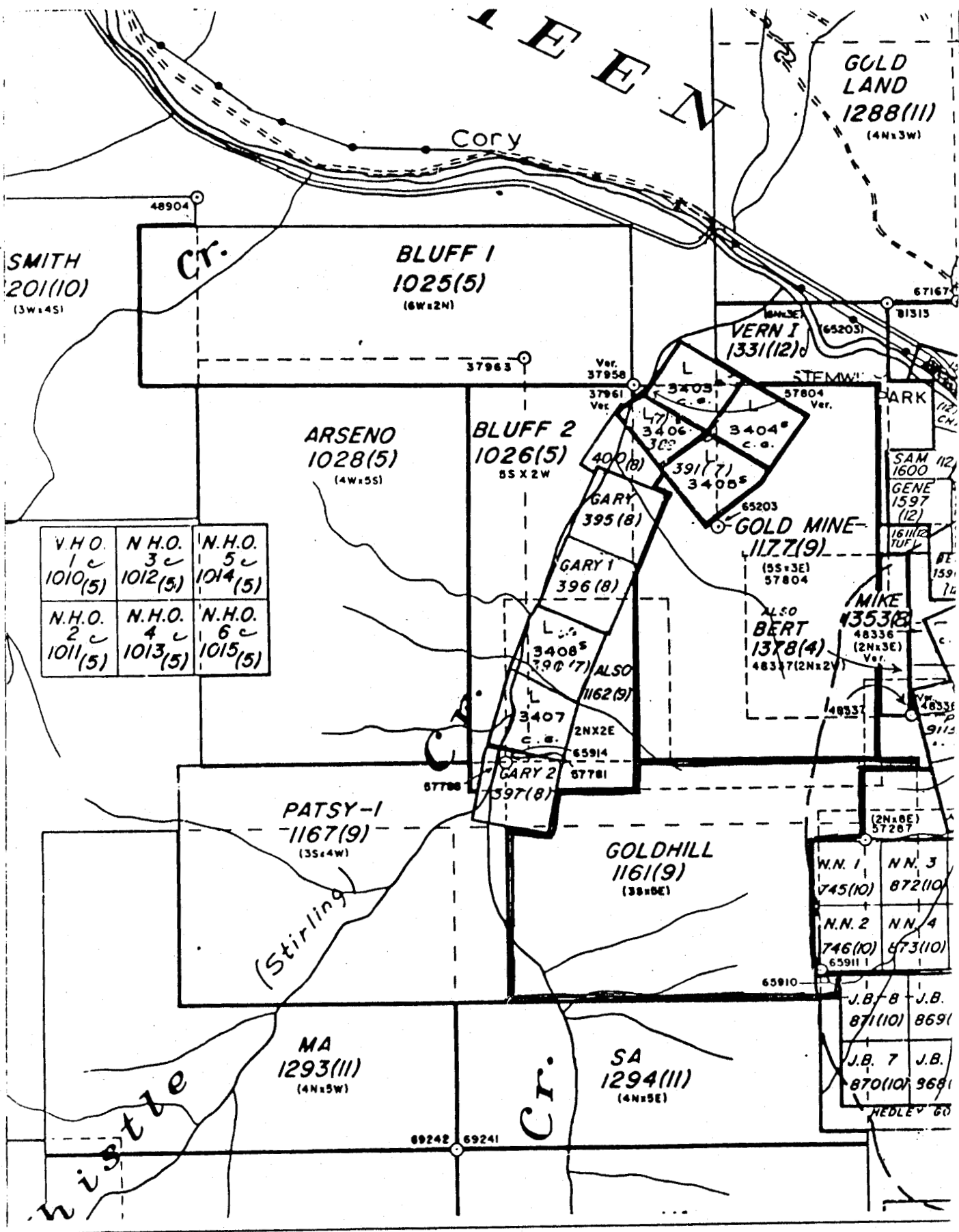

Figure 2
CLAIM MAP
GOLD HILL AND GOLD MINE CLAIMS
HEDLEY AREA
SIMILKAMEEN M.D.
1:10,000

-breccia zone well mineralized with pyrite and lesser arsenopyrite containing significant gold with lesser values in chalcopyrite, galena and sphalerite.

Elsewhere on the property, a few old pits and trenches explored extensive areas within strongly sheered and fractured sediments, investigating quartz veins.

More recently a logging road exposed a large gossan which was partially investigated by Canadian Occidental Petroleum Ltd.

The Philex Gold & Energy Corporation claims lie immediately west of Banbury Gold Mines Henri Creek property, which is being actively explored at the present time - October 1985.

The emphasis of the present program, and this fall's follow-up, is upon investigating the possibility of a large low-grade tonage potential, rather than a quartz vein situation.

GEOLOGY

Introduction:

This general area has been mapped by the G.S.C. (Bostock 1940 G.S.C. map 568 A) but most of the area covered by the present report was either unmapped or left undivided.

Mr. J. Ray of the B.C. Dept. of Mines, during the summer of 1985 commenced detailed mapping of the general Hedley area. This project will take several years.

General Geology:

The area is underlain by Triassic Nicola group sequence of sedimentary and lesser volcanic rocks. These have been intruded by stocks, sills and dykes ranging in composition from quartz diorite to gabbro.

Gold deposits on Nickel Plate Mountain are replacement deposits developed in skarnified limestones adjacent to intrusive rocks.

Property Geology:

The claim area is underlain principally by cherty argillites, limey argillites, greywacke, cherty tuffs, limestones and felsites.

These have been intruded by diorites. The argillaceous rocks adjacent to the intrusions are hornfelsed.

On the property, gold values are associated in several styles:-quartz veins, quartz-carbonate breccias; in fractured and sheered zones and within some limy rocks as fine disseminations as well as within wide sheer-zones. Higher gold values are nearly always adjacent to intrusive dykes.

After the present geo-chem grid has been extended to cover its entire claim groups, this area will be mapped in detail. This should provide a better interpretation of the rather complex geology, and a more definite understanding of the mineralogy of this interesting area will become possible.

FIELD WORK

Geochemical Soil Survey

At the commencement of this survey, two base-lines were run commencing from 00 & 00. One East/West True and the other North/South True. The E/W stations were marked at 100 meter intervals and the N/S at 50 meter intervals. All lines were well marked with flagging. The 00 & 00 location was selected at the approximate centre of the claim group, which was also the height of land. A third control baseline at 00 & 1500 meters south was run east and west to provide a check for the geo-chem lines which were run N/S. This direction was selected as being approximately on the contours, thus making travelling easier along the steep slopes, rather than up and down them.

The soil samples were collected at 50 meter intervals N/S and 100 meter intervals E/W. All soil sample locations were plainly flagged and numbered and notes were taken of all pertinent data.

A mattock was used to excavate the soil locations. A stainless steel spoon was used to collect soil samples from the bottom of the "B" level, where possible. In places the overburden is very deep and notes to this effect were taken by the samplers. The samples were placed in individual water-proof kraft envelopes and sent by Greyhound to Chemex Labs in North Vancouver for analysis.

A total of 38 kms. of lines were run and 529 soil samples were collected.

This program was conducted under the supervision of Mr. Brian Fenwick-Wilson between August 12th-31st 1985.

Geochemical Conclusions

The geo-chemical survey, which is the basis of this report, was in the nature of a reconnaissance with the intention of subsequently following up anomalous areas with closer spacing.

One company, which has been exploring in the Hedley neighbourhood for several years, spaces their sample locations at 5 meter centres.

On analyzing the results of this geo-chemical program the following facts emerge.

- (A) Although As/Au values in the majority of instances were co-incident, there were localities where anomalous gold was indicated but the arsenic values were very low.
- (B) Adjacent to known strong mineralization, in numerous areas, the soils returned weak or almost negligible values.
- (C) A wide range of soil types exist on property.
- (D) In places the "B" horizon is poorly developed.
- (E) In subsequent rechecking some soil locations with a shovel demonstrated the bottom of the "B" to be over one meter below the surface, and even deeper in places. In such cases, obviously, a mattock is an inadequate tool. The "A" horizon, where tested near the conclusion of this program, returned higher values than the poorly developed "B" horizon soils at these particular locations.
- (F) 20 meters downhill from a large gossan, which returned a rock assay of over 2 oz./ton Au, the soils returned very low values. It's been the experience of some recent geo-chemical surveys in the Hedley area, that soil sampling must be spaced no more than 10 meter intervals to more clearly define anomalous areas.

REFERENCES

Assessment Report #6060 for HED. claim group.

Geological Survey of Canada Memoir 2, 1910

Geological Survey of Canada Summary Report, 1929, Part A

Geological Survey of Canada Memoir 243, 1960 and Map 888A

STATEMENT OF QUALIFICATIONS

I, Brian Fenwick-Wilson of Mount Baldy Ski Area, Box 687, Osoyoos, B.C., do hereby certify that:

1. I took two years geology at Lancing College, England.
2. I have been engaged as a prospector and geological-technician for 36 years. My career to date in the mineral exploration field, may be summarized as follows:
 - (a) 1946-1952 Self-employed prospector.
 - (b) 1952-1966 Exploration manager & director of several syndicates and private companies.
 - (c) 1967 Utica Mines and exploration syndicates.
 - (d) 1967-1971 Amax Exploration Inc.
 - (e) 1971-1973 Cerro de Pasco Corp.
 - (f) 1974 Newmont Mining and private exploration companies.
 - (g) 1975-1977 Self-employed and a partner in two exploration syndicates.
 - (h) 1978-1979 Director of American Fluorite and a director and exploration manager of other public companies.
 - (i) 1980-1985 Director and exploration manager of numerous public and private companies.
 - (j) I have conducted many and extensive exploration programmes during the past 14 years.
3. The facts and opinions expressed herein are based on my personal knowledge and work on the ground together with reviewing published maps and reports.
4. I supervised and actively participated in this programme.

B. FENWICK-WILSON
Geological Technician & Prospector

B. Fenwick-Wilson

STATEMENT OF EXPENSES
GOLD HILL, GOLD MINE
GEOCHEMICAL PROGRAM AUG. 1985

FIELD WORK

Meals & Accomodation	\$766.68
Truck rentals & gas	\$953.49
Wages	\$3700.00
Geochem analysis	\$4664.50
Field Expenses: Flagging, soil envelopes, hip chain string rentals, phone calls etc. etc.	\$266.34
Office charges	\$250.00
U.I.C. & W.C.B.	\$78.24

ASSESSMENT REPORT

Compilation	\$500.00
Typing, drafting etc.	\$315.00
Xeroxing & binders etc.	\$76.00
	<u>\$11570.25</u>

STATEMENT OF EXPENSES
GOLD HILL, GOLD MINE
GEOCHEMICAL PROGRAM AUG. 1985
DETAILS OF WAGES

Sylvia Fenwick-Wilson	Fri.16 - Tues.20 5 days x \$80.	\$400.00
Linda Summers	Mon.19 - Thurs.22 4 days x \$80.	\$320.00
Ernest Von Rosen	Tues.13 - Sat.17 Mon.19 - Wed.21 7½ days x \$100.	\$750.00
Ian Floe	Tues.13 - Fri.16 4 days x \$70.	\$280.00
Steve Honcharyk	Sat.17 - Wed.21 5 days x \$70.	\$350.00
Rod Woytowich	Fri.16 - Wed.21 6 days x \$100.	\$600.00
Brian Fenwick-Wilson	Sat.10 - Wed.21 11 days	\$1000.00
		<hr/>
		\$3700.00

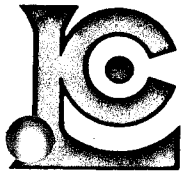

Chemex Labs Ltd.

Analytical Chemists • Geochemists • Registered Assayers

212 Brooksbank Ave
North Vancouver, B.C.
Canada V7J 2C

Telephone: (604) 984-022
Telex: 043-5259

CERTIFICATE OF ANALYSIS

TO : PHILEX RESOURCES

717 - 837 W. HASTINGS ST.
VANCOUVER, B.C.
V6C 1B6

** CERT. # : A8515455-001-
INVOICE # : I8515455
DATE : 30-AUG-85
P.O. # : NONE

ATTN: B. FENWICK-WILSON

Sample description	Prep code	Zn ppm	Ag ppm	AS ppm	Au ppb FA+AA		
PA 01 3+00E 0+50N	201	72	0.1	5	<5	--	--
PA 02 1+00N	201	80	0.1	24	<5	--	--
PA 03 1+50N	201	70	0.1	24	<5	--	--
PA 04 2+00N	201	103	0.1	27	<5	--	--
PA 05 2+50N	201	92	0.1	33	<5	--	--
PA 06 3+00N	201	71	0.1	17	<5	--	--
PA 07 4+00E 3+50N	201	78	0.1	23	<5	--	--
PA 08 3+00N	201	85	0.1	12	<5	--	--
PA 09 2+50N	201	15	0.7	3	<5	--	--
PA 10 2+00N	201	155	0.1	7	<5	--	--
PA 11 1+50N	201	105	0.1	41	<5	--	--
PA 12 1+00N	201	85	0.1	20	<5	--	--
PA 13 0+50N	201	103	0.2	12	<5	--	--
PA 14 5+00E 0+50N	201	130	0.1	29	10	--	--
PA 15 1+00N	201	68	0.1	11	20	--	--
PA 16 1+50N	201	80	0.3	30	<5	--	--
PA 17 2+00N	201	95	0.1	11	<5	--	--
PA 18 2+50N	201	95	0.3	14	<5	--	--
PA 19 3+00N	201	90	0.5	25	10	--	--
PA 20 6+00E 2+50N	201	128	0.1	15	<5	--	--
PA 21 2+00N	201	132	0.3	5	10	--	--
PA 22 1+50N	201	78	0.1	10	<5	--	--
PA 23 1+00N	201	108	0.1	29	20	--	--
PA 24 0+50N	201	100	0.3	9	<5	--	--
PA 25 2+00E 0+50N	201	130	0.3	150	70	--	--
PA 26 1+00N	201	105	0.2	48	<5	--	--
PA 27 1+50N	201	116	1.1	71	<5	--	--
PA 28 2+00N	201	325	1.0	600	350	--	--
PA 29 2+50N	201	87	0.2	15	<5	--	--
PA 30 3+00N	201	148	0.5	61	20	--	--
PL 01 1+00W 0+50N	201	88	0.1	120	10	--	--
PL 02 1+00N	201	68	0.1	19	<5	--	--
PL 03 1+50N	201	92	0.2	36	<5	--	--
PL 04 2+00N	201	142	0.1	29	5	--	--
PL 05 2+50N	201	103	0.3	38	<5	--	--
PL 06 3+00N	201	150	1.2	15	<5	--	--
PL 07 3+50N	201	108	0.2	11	<5	--	--
PL 08 4+00N	201	105	0.2	9	<5	--	--
PL 09 4+50N	201	68	0.1	7	<5	--	--
PL 10 5+00N	201	115	0.8	10	<5	--	--



Certified by Hart Bichler

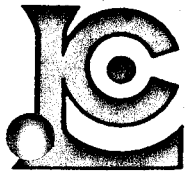

Chemex Labs Ltd.

212 Brooksbank Ave
North Vancouver, B.C.
Canada V7J 2C

Analytical Chemists • Geochemists • Registered Assayers

Telephone: (604) 984-022
Telex: 043-5259

CERTIFICATE OF ANALYSIS

TO : PHILEX RESOURCES

** CERT. # : A8515455-002-
INVOICE # : I8515455
DATE : 30-AUG-85
P.O. # : NONE

717 - 837 W. HASTINGS ST.
VANCOUVER, B.C.
V6C 1B6

ATTN: B. FENWICK-WILSON

Sample description	Prep code	Zn ppm	Ag ppm	AS ppm	Au ppb FA+AA		
PL 11 1400W	5+50N 201	62	0.1	7	<5	--	--
PL 12	6+00N 201	81	0.2	22	<5	--	--
PL 13 2+00W	6+00N 201	90	0.3	25	<5	--	--
PL 14	5+50N 201	58	0.1	6	35	--	--
PL 15	5+00N 201	66	0.2	7	<5	--	--
PL 16	4+50N 201	102	0.2	14	<5	--	--
PL 17	4+00N 201	65	0.2	7	<5	--	--
PL 18	2+50N 201	75	0.3	25	<5	--	--
PL 19	3+00N 201	75	0.2	22	<5	--	--
PL 20	2+50N 201	95	0.2	15	<5	--	--
PL 21	2+00N 201	138	0.3	35	<5	--	--
PL 22	1+50N 201	75	0.2	11	<5	--	--
PL 23	1+00N 201	115	1.1	32	75	--	--
PL 24	6+50N 201	100	0.1	19	20	--	--
PL 25 3+00W	201	108	0.1	25	<5	--	--
PL 25 A	0+50N 201	90	0.2	22	20	--	--
PL 26	1+00N 201	56	0.1	6	<5	--	--
PL 27	1+50N 201	168	2.2	57	<5	--	--
PL 28	2+00N 201	108	0.3	29	<5	--	--
PL 29	2+50N 201	95	0.2	32	<5	--	--
PL 30	3+00N 201	110	0.2	43	<5	--	--
PL 31	3+50N 201	127	0.5	36	5	--	--
PL 32	4+00N 201	98	0.2	29	25	--	--
PL 33	4+50N 201	95	0.1	29	<5	--	--
PL 34	5+00N 201	74	0.3	32	<5	--	--
PL 35	5+50N 201	110	0.6	35	<5	--	--
PR 96 2+00E	8+50S 201	65	0.2	11	<5	--	--
PR 97	8+50S 201	60	0.1	6	<5	--	--
PR 98	9+00S 201	60	0.3	11	<5	--	--
PR 99	9+50S 201	87	0.2	12	<5	--	--
PR 100	10+00S 201	78	0.3	6	<5	--	--
PR 101	10+50S 201	80	0.2	6	<5	--	--
PR 102	11+00S 201	75	0.1	5	<5	--	--
PR 103	11+50S 201	75	0.1	3	<5	--	--
PR 104	12+00S 201	95	0.3	4	<5	--	--
PR 105	12+50S 201	95	0.1	4	10	--	--
PR 106	13+00S 201	80	0.2	4	<5	--	--
PR 107	13+50S 201	118	0.1	4	<5	--	--
PR 108	14+00S 201	75	0.1	3	<5	--	--
PR 109	14+50S 201	88	0.1	3	15	--	--



Certified by Hart Bichler

Chemex Labs Ltd.

212 Brooksbank Av.
North Vancouver, B.C.
Canada V7J 2C

Analytical Chemists • Geochemists • Registered Assayers

Telephone: (604) 984-022
Telex: 043-5259

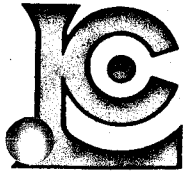

CERTIFICATE OF ANALYSIS

TO: PHILEX RESOURCES

** CERT. # : A8515455-003-
INVOICE # : I8515455
DATE : 30-AUG-85
P.O. # : NONE

717 - 837 W. HASTINGS ST.
VANCOUVER, B.C.
V6C 1B6

ATTN: B. FENWICK-WILSON

Sample description	Prep code	Zn ppm	Ag ppm	AS ppm	Au ppb FA+AA		
PR 110 2+00E	15+00S 201	138	0.1	6	<5	--	--
PR 111 BL	6+00S 201	145	0.4	38	<5	--	--
PR 112	0+50N 201	158	0.5	50	15	--	--
PR 113	1+50N 201	99	0.3	22	<5	--	--
PR 114	1+50N 201	167	1.0	77	55	--	--
PR 115	2+00N 201	147	0.2	45	20	--	--
PR 116	2+50N 201	145	0.4	46	5	--	--
PR 117	3+00N 201	170	0.2	16	20	--	--
PR 118	3+50N 201	150	0.1	6	<5	--	--
PR 119	4+00N 201	100	0.5	15	<5	--	--
PR 120	4+50N 201	105	0.4	22	<5	--	--
PR 121	5+00N 201	130	0.4	27	<5	--	--
PR 122 1+00E	5+00N 201	143	0.3	12	<5	--	--
PR 123	4+50N 201	110	0.4	50	<5	--	--
PR 124	4+00N 201	125	0.2	9	<5	--	--
PR 125	3+50N 201	113	0.4	20	<5	--	--
PR 126	3+00N 201	157	0.7	20	<5	--	--
PR 127	2+50N 201	125	0.2	14	<5	--	--
PR 128	2+00N 201	218	0.2	15	<5	--	--
PR 129	1+50N 201	130	0.1	11	<5	--	--
PR 130	1+00N 201	187	0.2	25	30	--	--
PR 131	0+50N 201	110	0.4	33	15	--	--

Hart Buchler

Certified by



Chemex Labs Ltd.

212 Brooksbank Ave.
North Vancouver, B.C.
Canada V7J 2C0

Analytical Chemists • Geochemists • Registered Assayers

Telephone: (604) 984-0220
Telex: 043-5259

CERTIFICATE OF ANALYSIS

TO : PHILEX RESOURCES

**

CERT. # : A8516110-001
INVOICE # : I8516110
DATE : 17-SEP-85
P.O. # : NONE

717 - 837 W. HASTINGS ST.
VANCOUVER, B.C.
V6C 1B6

ATTN: B. FENWICK-WILSON

Sample description	Prep code	AS ppm	Au ppb FA+AA				
PL-36 4+00W	0+SDN 201	48	35	--	--	--	--
PL-37	1+00N 201	16	5	--	--	--	--
PL-38	1+SDN 201	29	15	--	--	--	--
PL-39	2+00W 201	7	<5	--	--	--	--
PL-40	2+SDN 201	39	15	--	--	--	--
PL-41	3+00N 201	29	<5	--	--	--	--
PL-42	3+SDN 201	30	5	--	--	--	--
PL-43	4+00N 201	27	<5	--	--	--	--
PL-44	4+SDN 201	17	15	--	--	--	--
PL-45	5+00N 201	22	10	--	--	--	--
PL-46	5+SDN 201	29	5	--	--	--	--
PL-47 5+00W	0+SDN 201	12	10	--	--	--	--
PL-48	1+00N 201	32	10	--	--	--	--
PL-49	1+SDN 201	22	5	--	--	--	--
PL-50	2+00N 201	24	5	--	--	--	--
PL-51	2+SDN 201	35	15	--	--	--	--
PL-52	3+00N 201	16	<5	--	--	--	--
PL-53	3+SDN 201	41	10	--	--	--	--
PL-54	4+00N 201	46	10	--	--	--	--
PL-55	4+SDN 201	70	5	--	--	--	--
PL-56	5+00N 201	48	<5	--	--	--	--
PRD-01	0+00 201	20	<5	--	--	--	--
PRD-02	0+SDN 201	83	55	--	--	--	--
PRD-03	1+00N 201	25	75	--	--	--	--
PRD-04	1+SDN 201	22	10	--	--	--	--
PRD-05	2+00N 201	48	45	--	--	--	--
PRD-06	2+SDN 201	65	65	--	--	--	--
PRD-07	3+00N 201	67	140	--	--	--	--
PRD-08	3+SDN 201	48	<5	--	--	--	--
PRD-09	4+00N 201	135	75	--	--	--	--

Certified by Hart Bichler



Chemex Labs Ltd.

212 Brooksbank Ave.
North Vancouver, B.C.
Canada V7J 2C1
Telephone: (604) 984-0221
Telex: 043-52597

Analytical Chemists • Geochemists • Registered Assayers

CERTIFICATE OF ANALYSIS

TO : PHILEX RESOURCES

717 - 837 W. HASTINGS ST.
VANCOUVER, B.C.
V6C 1B6

** CERT. # : A8515323-001-A
INVOICE # : 18515323
DATE : 27-AUG-85
P.O. # : NONE

ATTN: B. FENWICK WILSON

Sample description	Prep code	Zn ppm	Ag ppm	AS ppm	Au ppb FA+AA	<i>Duplicated with PR III</i>	
PE 01 BL	0400S	201	160	0.2	27	<5	--
PE 02	0450S	201	168	0.2	20	<5	--
PE 03	1200S	201	97	0.2	48	<5	--
PE 04	1750S	201	110	0.2	32	<5	--
PE 05	2400S	201	116	0.2	73	<5	--
PE 06	2450S	201	80	0.1	67	<5	--
PE 07	3400S	201	88	0.1	25	<5	--
PE 08	3450S	201	87	0.2	19	<5	--
PE 09	4400S	201	88	0.1	15	<5	--
PE 10	4450S	201	55	0.2	5	<5	--
PE 11	5400S	201	70	0.2	10	<5	--
PE 12	5450S	201	85	0.1	7	<5	--
PE 13	6400S	201	103	0.2	7	<5	--
PE 14	6450S	201	75	0.2	4	<5	--
PE 15	7400S	201	85	0.2	11	<5	--
PE 16	7450S	201	80	0.1	10	<5	--
PE 17 <i>BLW OR 100W</i>	7450S	201	87	0.1	16	<5	--
PE 18	7400S	201	90	0.1	9	<5	--
PE 19	6450S	201	92	0.1	17	<5	--
PE 20	6400S	201	68	0.1	10	<5	--
PE 21	5450S	201	60	0.1	9	<5	--
PE 22	5400S	201	80	0.1	11	10	--
PE 23	4450S	201	125	0.1	11	5	--
PE 24	4400S	201	62	0.1	17	<5	--
PE 25	3450S	201	160	0.2	16	<5	--
PE 26	3400S	201	78	0.1	12	<5	--
PE 27	2450S	201	90	0.1	32	<5	--
PE 28	2400S	201	90	0.2	11	<5	--
PE 29	1450S	201	95	0.1	22	<5	--
PE 30	1400S	201	205	0.1	59	10	--
PE 31	0450S	201	80	0.1	79	5	--
PE 32	0400S	201	68	0.1	43	<5	--
PE 33 <i>2400W</i>	3400S	201	80	0.1	39	<5	--
PE 34	6450S	201	83	0.1	19	<5	--
PE 35	1400S	201	78	0.1	48	<5	--
PE 36	1450S	201	92	0.1	17	<5	--
PE 37	2400S	201	53	0.1	20	<5	--
PE 38	2450S	201	82	0.1	15	<5	--
PE 39	3400S	201	56	0.1	16	<5	--
PE 40	3450S	201	58	0.1	12	<5	--

Certified by *Hart Bichler*



Chemex Labs Ltd.

212 Brooksbank Ave
North Vancouver, B.C.
Canada V7J 2C

Analytical Chemists • Geochemists • Registered Assayers

Telephone: (604) 984-022
Telex: 043-5259

CERTIFICATE OF ANALYSIS

TO : PHILEX RESOURCES

717 - 837 W. HASTINGS ST.
VANCOUVER, B.C.
V6C 1B6

** CERT. # : A8515323-002
INVOICE # : I8515323
DATE : 27-AUG-85
P.O. # : NONE

ATTN: B. FENWICK WILSON

Sample description	Prep code	Zn ppm	Ag ppm	AS ppm	Au ppb FA+AA		
PE 41 ^{200w} 4+00S	201	85	0.1	16	<5	--	--
PE 42 4+S0S	201	62	0.1	14	10	--	--
PE 43 5+00S	201	85	0.1	19	<5	--	--
PE 44 5+S0S	201	113	0.1	12	5	--	--
PE 45 6+00S	201	86	0.2	10	5	--	--
PE 46 6+S0S	201	73	0.1	12	10	--	--
PE 47 7+00S	201	95	0.7	25	15	--	--
PE 48 7+S0S	201	82	0.1	4	<5	--	--

Certified by Hart Bichler



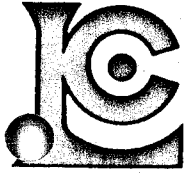

Chemex Labs Ltd.

Analytical Chemists • Geochemists • Registered Assayers

212 Brooksbank Ave
North Vancouver, B.C.
Canada V7J 2C0

Telephone: (604) 984-022
Telex: 043-5259

CERTIFICATE OF ANALYSIS

TO : PHILEX RESOURCES

** CERT. # : A8515358-001-
INVOICE # : I8515358
DATE : 29-AUG-85
P.O. # : NONE

717 - 837 W. HASTINGS ST.
VANCOUVER, B.C.
V6C 1B6

ATTN: B. FENWICK-WILSON

Sample description	Prep code	Cu ppm	Pb ppm	Zn ppm	Ag ppm	AS ppm	
PE 49 3+00w	0+00S 201	33	6	107	--	17	--
PE 50	0+50S 201	24	6	89	--	22	--
PE 51	1+00S 201	31	9	99	--	30	--
PE 52	1+50S 201	25	5	108	--	19	--
PE 53	2+00S 201	30	6	82	--	11	--
PE 54	2+50S 201	18	6	73	--	12	--
PE 55	3+00S 201	22	7	70	--	11	--
PE 56	3+50S 201	19	5	103	--	9	--
PE 57	4+00S 201	32	8	85	--	7	--
PE 58	4+50S 201	28	5	108	--	7	--
PE 59	5+00S 201	38	7	92	--	15	--
PE 60	5+50S 201	44	6	91	--	11	--
PE 61	6+00S 201	37	6	72	--	11	--
PE 62	6+50S 201	57	7	72	--	20	--
PE 63	7+00S 201	62	9	102	--	10	--
PE 64	7+50S 201	31	6	83	--	4	--
PE 65 4+00w	7+50S 201	61	7	77	--	16	--
PE 66	7+00S 201	52	7	86	--	19	--
PE 67	6+50S 201	46	9	84	--	57	--
PE 68	6+00S 201	33	10	68	--	9	--
PE 69	5+50S 201	44	7	75	--	19	--
PE 70	5+00S 201	38	7	93	--	11	--
PE 71	4+50S 201	23	6	94	--	10	--
PE 72	4+00S 201	52	5	82	--	16	--
PE 73	3+50S 201	19	5	102	--	11	--
PE 74	3+00S 201	25	7	64	--	11	--
PE 75	2+50S 201	38	6	80	--	19	--
PE 76	2+00S 201	26	5	83	--	12	--
PE 77	1+50S 201	28	8	78	--	23	--
PE 78	1+00S 201	36	6	92	--	20	--
PE 79	0+50S 201	81	8	96	--	30	--
PE 80	0+00S 201	35	8	80	--	16	--
PE 81 5+00w	0+00S 201	27	6	74	--	14	--
PE 82	0+50S 201	49	6	90	--	41	--
PE 83	1+00S 201	24	4	82	--	16	--
PE 84	1+50S 201	23	3	92	--	10	--
PE 85	2+00S 201	30	6	92	--	29	--
PE 86	2+50S 201	22	3	84	--	7	--
PE 87	3+00S 201	18	7	67	--	5	--
PE 88	3+50S 201	20	3	76	--	6	--

Certified by *Hart Buchler*



Chemex Labs Ltd.

212 Brooksbank Ave
North Vancouver, B.C.
Canada V7J 2C

Analytical Chemists • Geochemists • Registered Assayers

Telephone: (604) 984-022
Telex: 043-5259

CERTIFICATE OF ANALYSIS

TO : PHILEX RESOURCES

** CERT. # : A8515358-002-
INVOICE # : 18515358
DATE : 29-AUG-85
P.O. # : NONE

717 - 837 W. HASTINGS ST.
VANCOUVER, B.C.
V6C 1B6

ATTN: B. FENWICK-WILSON

Sample description	Prep code	Cu ppm	Pb ppm	Zn ppm	Ag ppm	AS ppm	
PE 89 5405W	4+00S 201	23	6	86	--	3	--
PE 90	4+50S 201	17	6	68	--	4	--
PE 91	5+00S 201	30	5	65	--	5	--
PE 92	5+50S 201	21	5	83	--	4	--
PE 93	6+00S 201	21	5	114	--	5	--
PE 94	6+50S 201	21	6	100	--	4	--
PE 95	7+00S 201	40	7	86	--	12	--
PE 96	7+50S 201	33	5	106	--	10	--
PR 01 7+00E	7+50S 201	23	6	108	--	7	--
PR 02	7+00S 201	19	3	82	--	2	--
PR 03	6+50S 201	28	3	32	--	3	--
PR 04	6+00S 201	18	+	76	--	6	--
PR 05	5+50S 201	45	6	94	--	14	--
PR 06	5+00S 201	59	12	116	--	32	--
PR 07	4+50S 201	61	10	128	--	38	--
PR 08	4+00S 201	32	9	115	--	17	--
PR 09	3+50S 201	18	4	111	--	11	--
PR 10	3+00S 201	16	5	107	--	5	--
PR 11	2+50S 201	24	9	176	--	19	--
PR 12	2+00S 201	75	10	165	--	340	--
PR 13	1+50S 201	44	12	109	--	190	--
PR 14	1+00S 201	89	9	995	--	1000	--
PR 15	0+50S 201	16	4	92	--	15	--
PR 16	0+00S 201	24	6	106	--	11	--
PR 17 6+00E	6+00S 201	43	12	117	--	29	--
PR 18	0+50S 201	35	8	113	--	19	--
PR 19	1+00S 201	10	2	64	--	5	--
PR 20	1+50S 201	44	13	158	--	23	--
PR 21	2+00S 201	50	17	120	--	27	--
PR 22	2+50S 201	68	14	155	--	22	--
PR 23	3+00S 201	58	11	145	--	36	--
PR 24	3+50S 201	24	6	135	--	6	--
PR 25	4+00S 201	34	7	118	--	23	--
PR 26	4+50S 201	29	8	121	--	10	--
PR 27	5+00S 201	24	4	106	--	3	--
PR 28	5+50S 201	27	5	110	--	7	--
PR 29	6+00S 201	38	6	125	--	4	--
PR 30	6+50S 201	25	6	88	--	4	--
PR 31	7+00S 201	23	4	93	--	5	--
PR 32	7+50S 201	19	5	92	--	4	--



Certified by *Harold R. ...*

Chemex Labs Ltd.

212 Brooksbank Ave
North Vancouver, B.C.
Canada V7J 2C

Analytical Chemists • Geochemists • Registered Assayers

Telephone: (604) 984-022
Telex: 043-5259

CERTIFICATE OF ANALYSIS

TO : PHILEX RESOURCES

** CERT. # : A8515358-003-
INVOICE # : I8515358
DATE : 29-AUG-85
P.O. # : NONE

717 - 837 W. HASTINGS ST.
VANCOUVER, B.C.
V6C 1B6

ATTN: B. FENWICK-WILSON

Sample description	Prep code	Cu ppm	Pb ppm	Zn ppm	Ag ppm	AS ppm	
PR 33 5+00E	7+SDS 201	30	6	111	--	5	--
PR 34	7+SDS 201	38	7	84	--	9	--
PR 35	6+SDS 201	32	5	93	--	7	--
PR 36	6+SDS 201	15	3	110	--	2	--
PR 37	5+SDS 201	30	5	133	--	4	--
PR 38	5+SDS 201	28	5	121	--	11	--
PR 39	4+SDS 201	40	8	168	--	15	--
PR 40	4+SDS 201	39	6	129	--	12	--
PR 41	3+SDS 201	28	9	102	--	7	--
PR 42	3+SDS 201	36	9	124	--	16	--
PR 43	2+SDS 201	34	6	115	--	27	--
PR 44	2+SDS 201	33	9	106	--	33	--
PR 45	1+SDS 201	31	10	128	--	20	--
PR 46	1+SDS 201	14	3	96	--	9	--
PR 47	0+SDS 201	14	5	120	--	9	--
PR 48	0+SDS 201	35	10	140	--	22	--
PR 49 4+00E	0+SDS 201	26	8	105	--	32	--
PR 50	0+SDS 201	30	11	138	--	43	--
PR 51	1+SDS 201	37	9	114	--	29	--
PR 52	1+SDS 201	38	8	154	--	36	--
PR 53	2+SDS 201	25	7	114	--	20	--
PR 54	2+SDS 201	66	10	126	--	45	--
PR 55	3+SDS 201	54	12	128	--	39	--
PR 56	3+SDS 201	64	10	130	--	23	--
PR 57	4+SDS 201	41	9	103	--	24	--
PR 58	4+SDS 201	46	8	111	--	32	--
PR 59	5+SDS 201	27	5	92	--	11	--
PR 60	5+SDS 201	32	7	109	--	14	--
PR 61	6+SDS 201	28	8	106	--	9	--
PR 62	6+SDS 201	22	6	84	--	7	--
PR 63	7+SDS 201	28	6	132	--	4	--
PR 64	7+SDS 201	27	5	106	--	7	--
PR 65 BL	8+SDS 201	32	11	126	--	9	--
PR 66	8+SDS 201	42	8	93	--	11	--
PR 67	9+SDS 201	40	7	77	--	9	--
PR 68	9+SDS 201	71	7	80	--	12	--
PR 69	10+SDS 201	42	6	76	--	15	--
PR 70	10+SDS 201	39	5	68	--	7	--
PR 71	11+SDS 201	31	7	85	--	6	--
PR 72	11+SDS 201	52	9	81	--	6	--



Certified by *[Signature]*

Chemex Labs Ltd.

212 Brooksbank Ave
North Vancouver, B.C.
Canada V7J 2C

Analytical Chemists • Geochemists • Registered Assayers

Telephone: (604) 984-022
Telex: 043-5259

CERTIFICATE OF ANALYSIS

TO : PHILEX RESOURCES

** CERT. # : A8515358-004-
INVOICE # : I8515358
DATE : 29-AUG-85
P.O. # : NONE

717 - 837 W. HASTINGS ST.
VANCOUVER, B.C.
V6C 1B6

ATTN: B. FENWICK-WILSON

Sample description	Prep code	Cu ppm	Pb ppm	Zn ppm	Ag ppm	AS ppm	
PR 73 BL 12+00S	201	31	7	82	--	4	--
PR 74 12+50S	201	68	12	76	--	11	--
PR 75 13+00S	201	31	6	85	--	5	--
PR 76 13+50S	201	39	9	95	--	9	--
PR 77 14+00S	201	52	7	76	--	14	--
PR 78 14+50S	201	54	3	72	--	6	--
PR 79 15+00S	201	81	8	101	--	12	--
PR 80 1400E 15+60S	201	32	7	107	--	3	--
PR 81 14+50S	201	52	8	--	0.2	7	--
PR 82 14+00S	201	33	7	--	0.5	2	--
PR 83 13+50S	201	39	6	--	0.4	6	--
PR 84 13+00S	201	34	5	--	0.3	5	--
PR 85 12+50S	201	68	11	--	0.4	12	--
PR 86 12+00S	201	24	6	--	0.4	2	--
PR 87 11+50S	201	34	8	--	0.4	6	--
PR 88 11+00S	201	138	4	--	0.8	14	--
PR 89 10+50S	201	35	7	--	0.4	6	--
PR 90 10+00S	201	35	7	--	0.4	7	--
PR 91 9+50S	201	36	9	--	0.4	7	--
PR 92 9+00S	201	95	6	--	0.6	24	--
PR 93 8+50S	201	30	6	--	0.4	6	--
PR 94 8+60S	201	54	5	--	0.5	14	--
PR 95 7+50S	201	87	13	--	0.9	50	--
PS 01 8+00E 8+00S	201	13	3	--	0.3	7	--
PS 02 8+50S	201	35	5	--	0.5	17	--
PS 03 1+00S	201	28	6	--	0.3	12	--
PS 04 1+50S	201	39	5	--	0.3	24	--
PS 05 2+00S	201	12	4	--	0.2	22	--
PS 06 2+50S	201	30	6	--	0.3	17	--
PS 07 3+00S	201	12	5	--	0.3	7	--
PS 08 3+50S	201	35	7	--	0.6	27	--
PS 09 4+00S	201	56	12	--	0.3	30	--
PS 10 4+50S	201	59	12	--	0.2	36	--
PS 11 5+00S	201	95	9	--	0.1	41	--
PS 12 5+50S	201	40	12	--	0.1	25	--
PS 13 6+00S	201	13	6	--	0.2	7	--
PS 14 6+50S	201	19	8	--	0.1	16	--
PS 15 7+00S	201	26	8	--	0.1	9	--
PS 16 7+50S	201	12	7	--	0.2	3	--
PS 17 8+00S	201	34	9	--	0.1	5	--

Certified by Hart Bichler



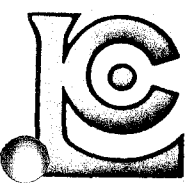

Chemex Labs Ltd.

Analytical Chemists • Geochemists • Registered Assayers

212 Brooksbank Ave.
North Vancouver, B.C.
Canada V7J 2C1
Telephone: (604) 984-0221
Telex: 043-52597

CERTIFICATE OF ANALYSIS

TO: PHILEX RESOURCES

** CERT. # : A8515358-005-A
INVOICE # : I8515358
DATE : 29-AUG-85
P.O. # : NONE

717 - 837 W. HASTINGS ST.
VANCOUVER, B.C.
V6C 1B6

ATTN: B. FENWICK-WILSON

Sample description	Prep code	Cu ppm	Pb ppm	Zn ppm	Ag ppm	AS ppm	
PS 18 8100E	8150S 201	32	10	--	0.1	6	--
PS 19	1100S 201	75	7	--	0.1	10	--
PS 20	1150S 201	16	5	--	0.1	2	--
PS 21	1180S 201	32	10	--	0.2	7	--
PS 22	1250S 201	72	7	--	0.1	10	--
PS 23	12700S 201	71	10	--	0.3	7	--
PS 24	11750S 201	81	9	--	0.1	9	--
PS 25	12700S 201	4	9	--	0.1	6	--
PS 26	12750S 201	37	8	--	0.1	3	--
PS 27	13700S 201	33	5	--	0.1	4	--
PS 28	13750S 201	19	8	--	0.2	2	--
PS 29 1700E	0400S 201	105	18	--	0.3	300	--
PS 30	0650S 201	19	9	--	0.2	15	--
PS 31	1700S 201	42	12	--	0.2	55	--
PS 32	1750S 201	36	10	--	0.2	30	--
PS 33	2700S 201	24	8	--	0.1	29	--
PS 34	2750S 201	27	9	--	0.2	23	--
PS 35	3700S 201	26	8	--	0.3	19	--
PS 36	3750S 201	26	8	--	0.2	17	--
PS 37	4700S 201	38	11	--	0.2	22	--
PS 38	4750S 201	36	9	--	0.1	10	--
PS 39	5700S 201	30	9	--	0.1	9	--
PS 40	5750S 201	35	9	--	0.1	9	--
PS 41	6700S 201	27	9	--	0.1	9	--
PS 42	6750S 201	34	8	--	0.1	9	--
PS 43	7700S 201	25	8	--	0.1	6	--
PS 44	7750S 201	30	7	--	0.1	11	--
PS 45 2700E	7750S 201	16	5	--	0.1	4	--
PS 46	7700S 201	29	6	--	0.1	6	--
PS 47	6750S 201	40	8	--	0.1	9	--
PS 48	6700S 201	40	7	--	0.1	9	--
PS 49	5750S 201	42	3	--	0.3	5	--
PS 50	5700S 201	19	5	--	0.2	3	--
PS 51	4750S 201	39	10	--	0.1	14	--
PS 52	4700S 201	31	7	--	0.1	11	--
PS 53	3750S 201	13	2	--	0.2	7	--
PS 54	3700S 201	12	5	--	0.1	5	--
PS 55	2750S 201	23	4	--	0.2	11	--
PS 56	2700S 201	24	9	--	0.2	19	--
PS 57	1750S 201	5	1	--	0.1	3	--



Certified by Karl Bollen

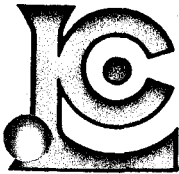

Chemex Labs Ltd.

Analytical Chemists • Geochemists • Registered Assayers

212 Brooksbank Ave
North Vancouver, B.C.
Canada V7J 2C

Telephone: (604) 984-022
Telex: 043-5259

CERTIFICATE OF ANALYSIS

TO : PHILEX RESOURCES

717 - 837 W. HASTINGS ST.
VANCOUVER, B.C.
V6C 1B6

** CERT. # : A8515358-006-
INVOICE # : 18515358
DATE : 29-AUG-85
P.O. # : NONE

ATTN: B. FENWICK-WILSON

Sample description	Prep code	Cu ppm	Pb ppm	Zn ppm	Ag ppm	AS ppm	
PS 58 2+00E	1+00S 201	21	9	--	0.1	10	--
PS 59	0+50S 201	14	4	--	0.1	12	--
PS 60	0+00S 201	42	8	--	0.1	30	--
PS 61 2+00E	0+00S 201	28	7	--	0.1	24	--
PS 62	0+50S 201	39	11	--	0.1	22	--
PS 63	1+00S 201	15	6	--	0.1	11	--
PS 64	1+50S 201	39	6	--	0.1	29	--
PS 65	2+00S 201	19	5	--	0.1	11	--
PS 66	2+50S 201	21	5	--	0.1	10	--
PS 67	3+00S 201	45	8	--	0.1	29	--
PS 68	3+50S 201	60	9	--	0.1	39	--
PS 69	4+00S 201	48	8	--	0.1	25	--
PS 70	4+50S 201	36	7	--	0.3	17	--
PS 71	5+00S 201	35	4	--	0.1	7	--
PS 72	5+50S 201	32	2	--	0.1	6	--
PS 73	6+00S 201	13	2	--	0.1	11	--
PS 74	6+50S 201	26	5	--	0.1	6	--
PS 75	7+00S 201	21	3	--	0.1	11	--
PS 76	7+50S 201	43	5	--	0.1	7	--
PSS 01 5+00E	8+00S 201	32	6	124	--	15	--
PSS 02	8+50S 201	32	6	77	--	11	--
PSS 03	9+00S 201	33	6	93	--	11	--
PSS 04	9+50S 201	26	5	100	--	7	--
PSS 05	10+00S 201	34	6	100	--	7	--
PSS 06	10+50S 201	33	3	110	--	7	--
PSS 07	11+00S 201	34	5	114	--	10	--
PSS 08	11+50S 201	49	7	81	--	11	--
PSS 09	12+00S 201	58	7	86	--	11	--
PSS 10	12+50S 201	26	3	102	--	6	--
PSS 11	13+00S 201	32	5	74	--	5	--
PSS 12	13+50S 201	60	5	84	--	14	--
PSS 13	14+00S 201	18	2	121	--	10	--
PSS 14	14+50S 201	14	3	88	--	5	--
PSS 15	15+00S 201	57	2	56	--	10	--
PSS 16 4+00E	15+00S 201	22	4	98	--	9	--
PSS 17	14+50S 201	24	2	132	--	4	--
PSS 18	14+00S 201	37	4	129	--	3	--
PSS 19	13+50S 201	36	4	71	--	3	--
PSS 20	13+00S 201	35	4	136	--	4	--
PSS 21	12+50S 201	31	6	121	--	4	--

Hart-Burton

Certified by



Chemex Labs Ltd.

212 Brooksbank Av
North Vancouver, B.C.
Canada V7J 2C

Analytical Chemists • Geochemists • Registered Assayers

Telephone: (604) 984-0221
Telex: 043-5259

CERTIFICATE OF ANALYSIS

TO : PHILEX RESOURCES

** CERT. # : A8515358-007-
INVOICE # : I8515358
DATE : 29-AUG-85
P.O. # : NONE

717 - 837 W. HASTINGS ST.
VANCOUVER, B.C.
V6C 1B6

ATTN: B. FENWICK-WILSON

Sample description	Prep code	Cu ppm	Pb ppm	Zn ppm	Ag ppm	AS ppm	
PSS 22 4400E	12+00S 201	68	6	104	--	7	--
PSS 23	11+50S 201	85	6	89	--	9	--
PSS 24	11+50S 201	58	4	75	--	5	--
PSS 25	10+50S 201	49	4	75	--	12	--
PSS 26	10+00S 201	25	3	72	--	6	--
PSS 27	9+50S 201	56	6	98	--	9	--
PSS 28	9+00S 201	17	4	152	--	7	--
PSS 29	8+50S 201	45	6	73	--	14	--
PSS 30	8+00S 201	38	3	122	--	10	--
PSS 31 3400E	8+00S 201	27	6	81	--	9	--
PSS 32	8+50S 201	20	6	80	--	7	--
PSS 33	9+00S 201	17	5	96	--	5	--
PSS 34	9+50S 201	39	8	77	--	5	--
PSS 35	10+00S 201	91	7	78	--	16	--
PSS 36	10+50S 201	61	9	86	--	12	--
PSS 37	11+00S 201	52	8	106	--	9	--
PSS 38	11+50S 201	38	6	113	--	6	--
PSS 39	12+00S 201	39	6	89	--	4	--
PSS 40	12+50S 201	36	4	103	--	4	--
PSS 41	13+00S 201	42	6	113	--	5	--
PSS 42	13+50S 201	19	5	96	--	4	--
PSS 43	14+00S 201	23	6	101	--	4	--
PSS 44	14+50S 201	71	6	88	--	6	--
PSS 45	15+00S 201	53	0	51	--	5	--



Certified by *Barbara Schler*

Gold Hill & Gold Mine Claim Group
Hedley, B. C.
Statistical values of As in soils
August 1985

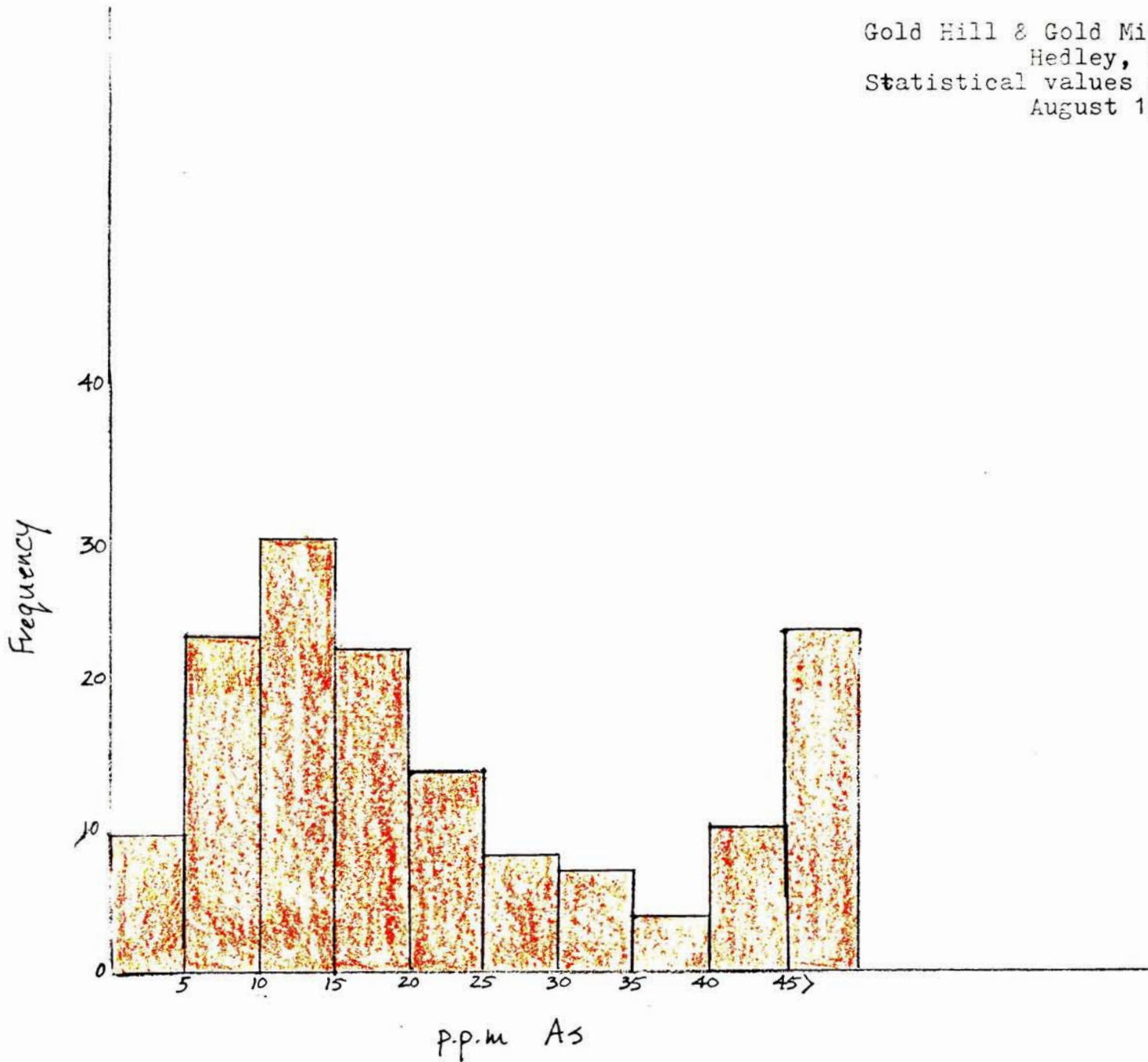

Gold Hill & Gold Mine Claim Group
Hedley, B.C.
Statistical values of Au in soils
August 1985

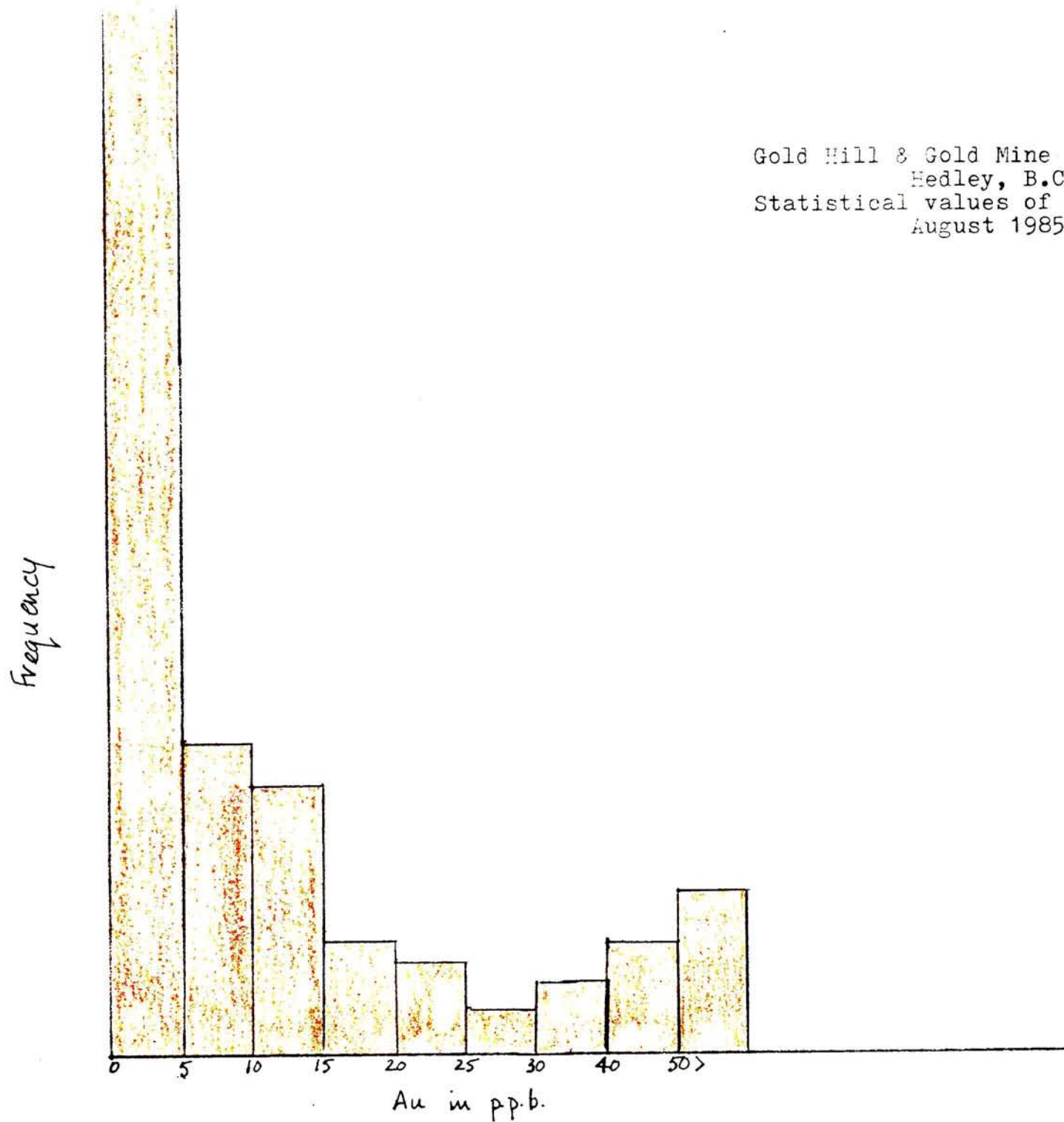

Gold Hill & Gold Mine Claim Group
Hedley, B.C.
Statistical values of Ag in soils
August 1985.

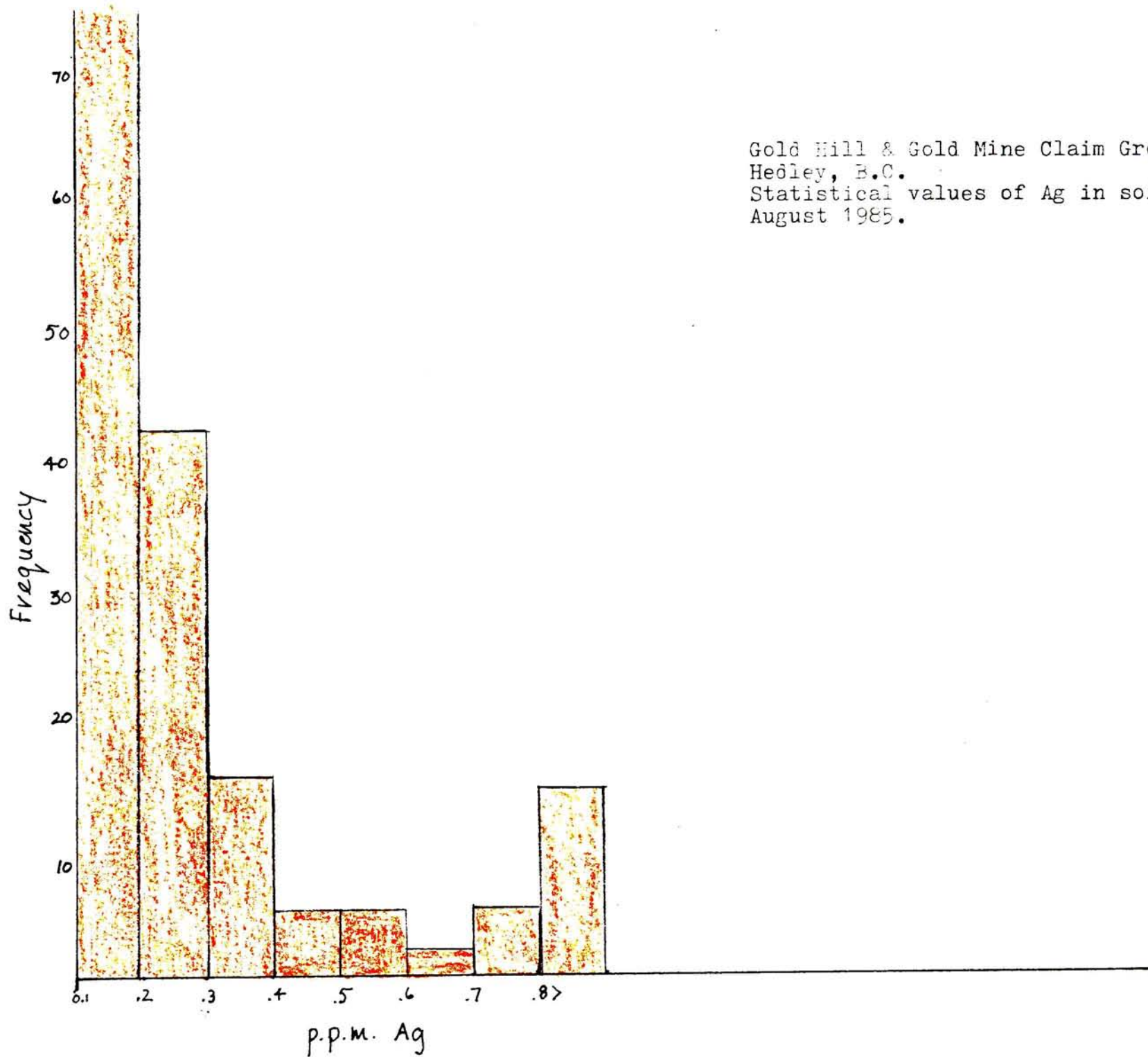

Gold Hill & Gold Mine Claim Group
Hedley, B.C.
Statistical values of Zn in soils
August 1985

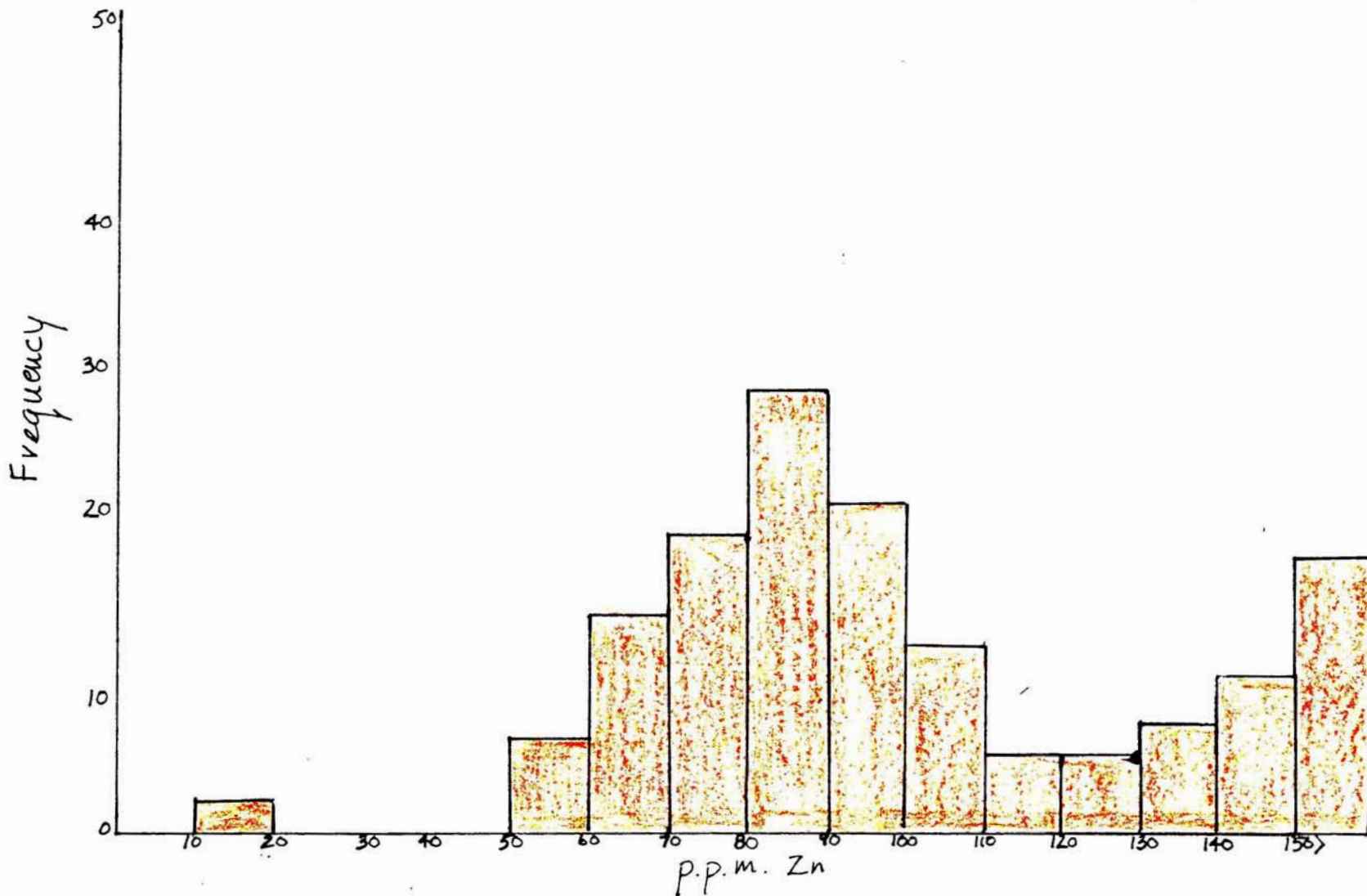

GEOCHEM PROCEDURES

Preparation:

Geochemical samples (soils, silts) are dried at 50 deg. for a period of 12 to 14 hours. The dried sample is sieved to -80 mesh fraction through a nylon and stainless steel sieve.

Rock geochemical materials are crushed, dried and pulverized to -100 mesh. The reject material is retained for possible future use.

Cu, Pb, Zn (ppm):

A 1.00 gram portion of sample is weighed into a calibrated test tube. The sample is digested using hot 70% perchloric acid and concentrated nitric acid. Digestion time - 2 hours. Sample volume is adjusted to 25 mls. using demineralized water. Sample solutions are homogenized and allowed to settle before being analyzed by atomic absorption procedures.

Detection limits using Varian atomic absorption unit are as follows:

Copper	-	1 ppm
Zinc	-	1 ppm
Lead	-	1 ppm

Ag (ppm):

A 1.0 gram portion of sample is digested in conc. perchloric-nitric acid (HClO₄-HNO₃) for approx. 2 hours. The digested sample is cooled and made up to 25 mls with distilled water. The solution is mixed and solids are allowed to settle. Silver is determined by atomic absorption technique using background correction on analysis.

Detection limit - 0.1 ppm

Au (ppb):

5 gram samples ashed @ 800°C for one hour, digested with aqua regia - twice to dryness - taken up in 25% HCl⁻, the gold then extracted as the bromide complex into MIBK and analyzed via A.A.

Detection limit - 10 ppb

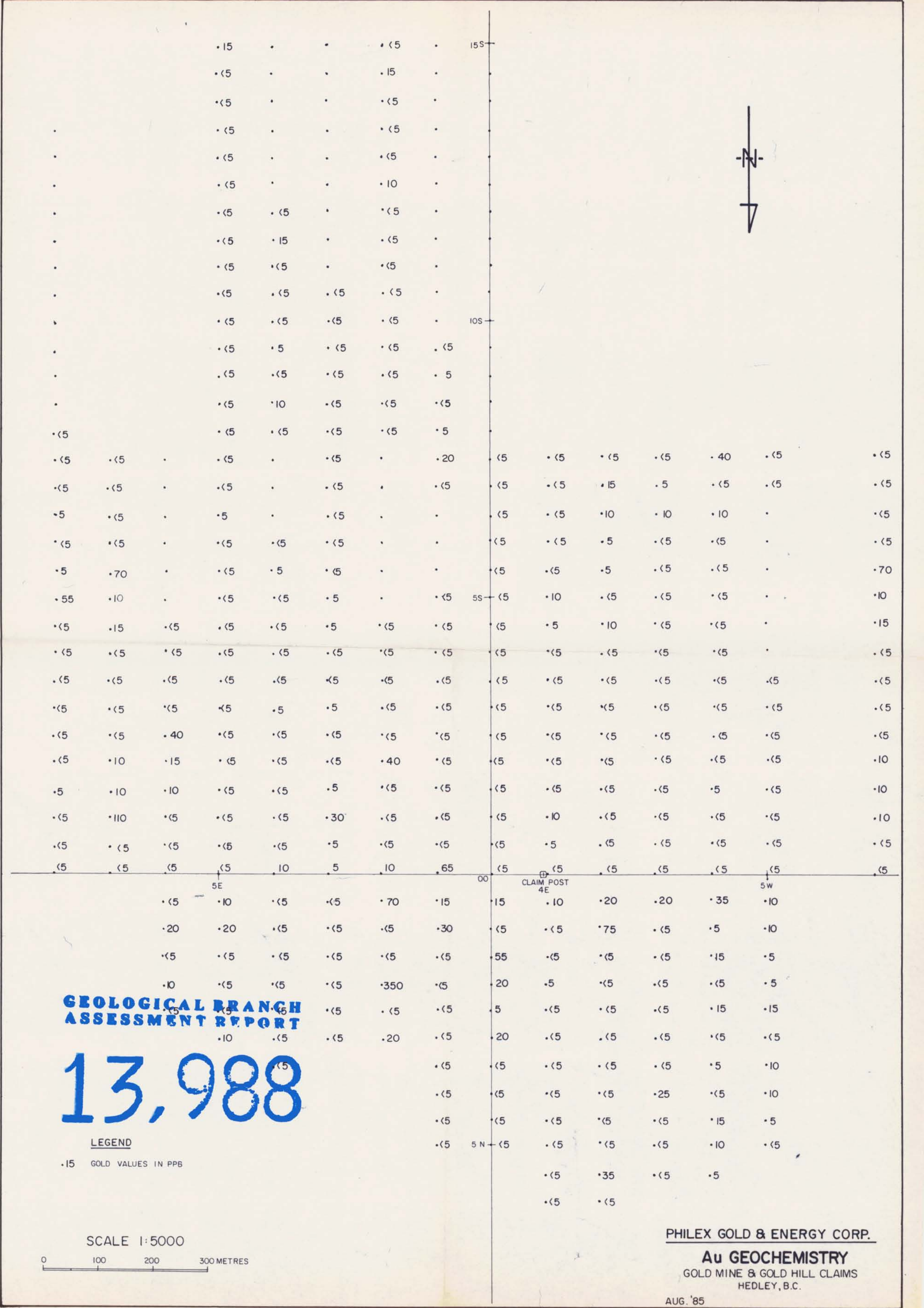

**GEOLOGICAL BRANCH
ASSESSMENT REPORT**

13,988

LEGEND

.15 GOLD VALUES IN PPB

SCALE 1:5000

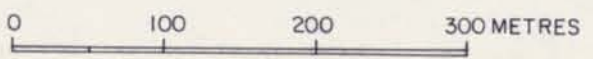

PHILEX GOLD & ENERGY CORP.

Au GEOCHEMISTRY
GOLD MINE & GOLD HILL CLAIMS
HEDLEY, B.C.

AUG. '85

