

11/86

Assessment Work Report

on the

Geochemical Survey  
carried out over the

DIANE Fr No. 2 2695(11)

Goldbridge, B.C.  
Lillooet Mining Division  
92-J-15-W

Long. 122 48 Lat. 50 48

Operated by  
Levon Resources Ltd.  
455 Granville St.  
Vancouver, B.C.

by  
P.S. Friesen P. Eng.  
9 Nov. 1985

**GEOLOGICAL BRANCH  
ASSESSMENT REPORT**

**14,007**

## TABLE OF CONTENTS

	Page
<u>INTRODUCTION</u>	1
General Statement	1
Property, Location and Means of Access	1
Ownership	1
History	1
References	2
<u>GEOGRAPHY</u>	3
Index Map	4
Claim Location Map	5
<u>GEOLOGY</u>	6
<u>GEOCHEMISTRY</u>	7
General	7
Survey Control	7
Sampling Procedure	7
Number of Samples	7
Period of Survey	7
Analyser and Analyses	7
Results	8
Conclusion	8
Recommendations	8
Estimation of Costs	9
Certificate of Qualification	10
Map showing gold in ppb	11
Map showing arsenic in ppm	12
Map showing copper in ppm	13
STATEMENT OF COSTS	14

A Report on the Soil Geochemical Survey of the DIANE Fr 2 mineral claim record No. 2695(11), Goldbridge, B.C., Lillooet Mining Division.

92-J-15-W

by  
P.S. Friesen P. Eng.  
9 Nov. 1985

---

## INTRODUCTION

### General Statement

This report describes the results of a soil geochemical survey carried out over the Diane Fr 2 mineral claim. The survey is part of a much larger survey of the BRX Group. The results of this survey will be incorporated in the report on the BRX survey.

### Property, Location and Means of Access

The DIANE Fr 2 mineral claim, record No. 2695(11) lies on the bench between Fergusson Mountain and Hurley River about 4 kilometers slightly east of south of Goldbridge, B.C. It is in the Lillooet Mining Division, NTS 92-J-15-W.

The claim lies about 400 meters east of the hydro-electric power line which has a road closely paralleling it. This road connects with the road from Bralorne through Goldbridge, to Lillooet.

### Ownership

The claim is wholly owned by Levon Resources Ltd. of 455 Granville St., Vancouver, B.C.

### History

Except for prospecting, no other work is known to have been

carried out over the property.

References

Cairnes C.E. - Geology and Mineral Deposits of Bridge  
River Mining Camp, British Columbia - G.S.C.  
Memoir 213 1937.

GEOGRAPHY

General

The claim lies on a bench which is relatively flat. Commercial timber existed on the claim but is currently being logged.

No creeks are present on the claim but water occurs in small ponds fed by springs and creeks within 500 meters.

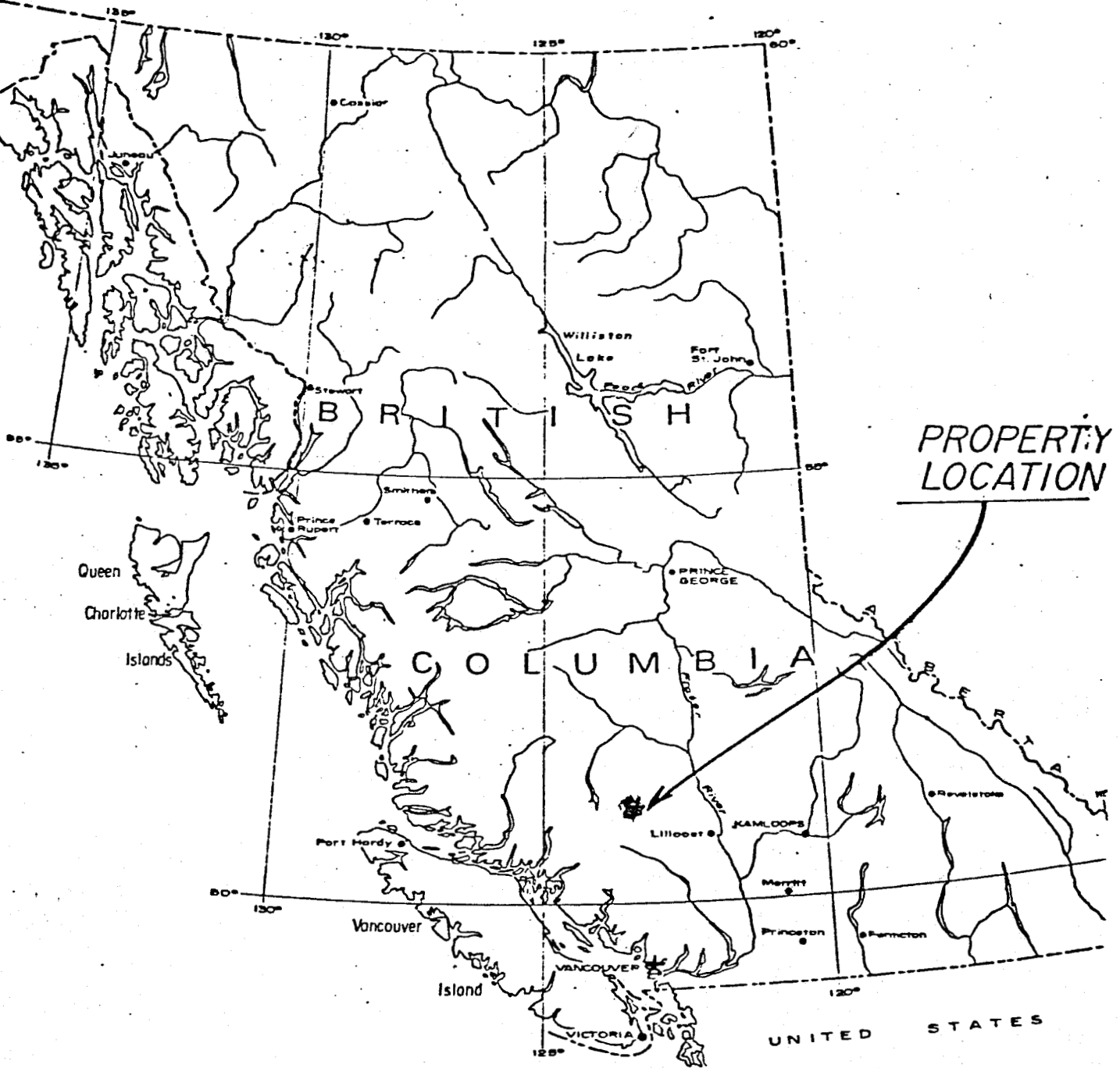

**LOCATION MAP**  
LEVON RESOURCES LTD.

LILLOOET: MD NTS M92/15E

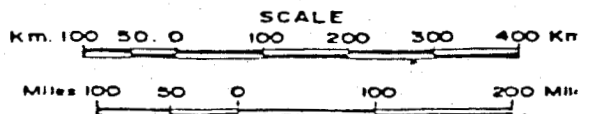

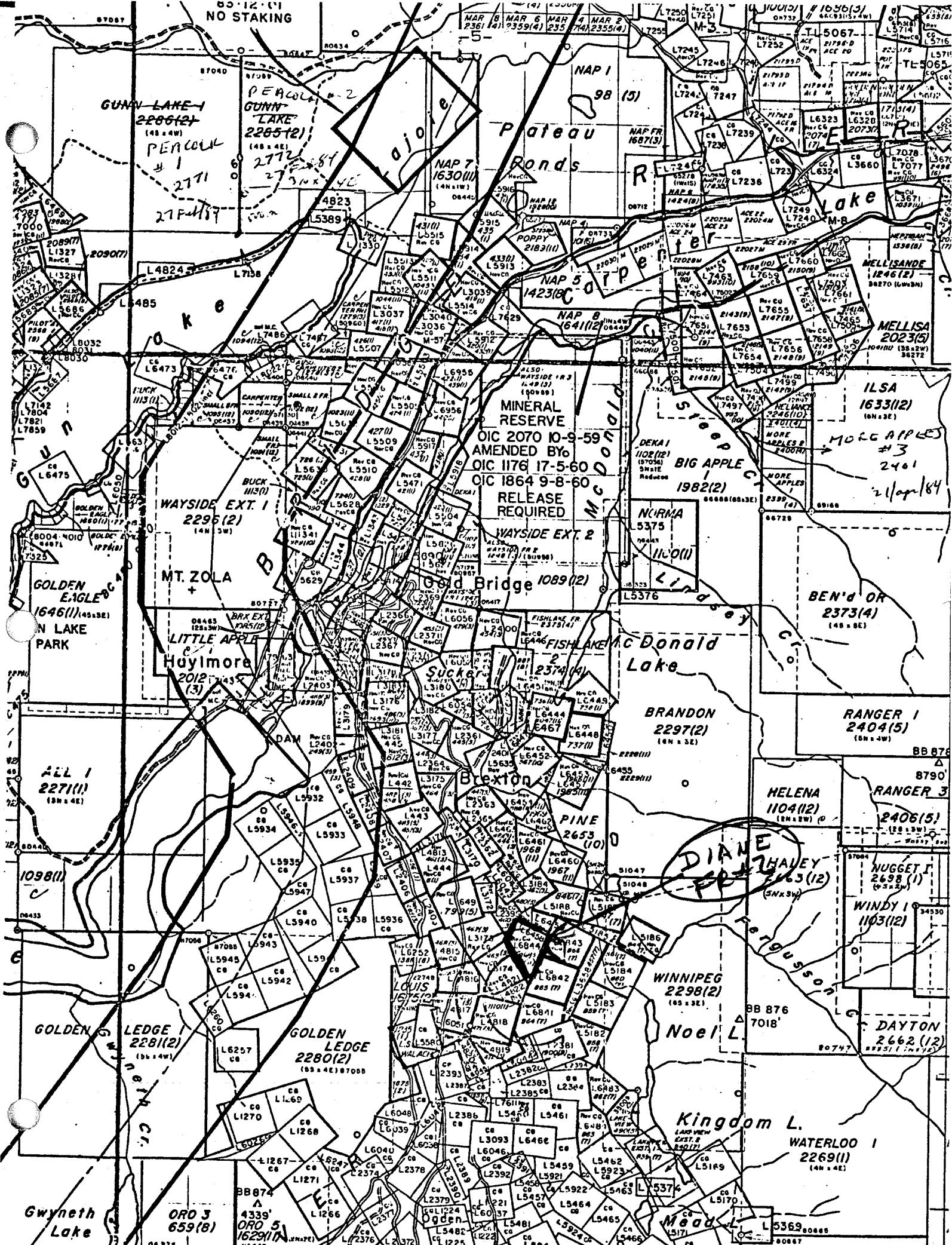

NO STAKING

GUNNY LAKE 1  
2286(2)  
PEARCOLL #1  
2771  
27F-417

PEARCOLL #2  
GUNNY LAKE  
2265(2)  
2772  
27F-418

NAP 1  
98 (5)  
Pateau Ponds

NAP 7  
1630(11)  
4923  
5389

NAP 5  
1423(6)  
NAP 8  
641(12)

MINERAL RESERVE  
OIC 2070 10-9-59  
AMENDED BY  
OIC 1176 17-5-60  
OIC 1864 9-8-60  
RELEASE REQUIRED

WAYSIDE EXT. 1  
2296(2)

MT. ZOLA

Gold Bridge 1089(12)

Little Apple  
Haylmore  
2012(3)

Sucker  
2374(4)

McDonald Lake

BRANDON  
2297(2)

BEN'D OR  
2373(4)

RANGER 1  
2404(5)

ALL 1  
2271(11)

HELENA  
1104(12)

RANGER 3  
2406(5)

DIANE FRZ HAUEY  
2163(12)

NUGGET 1  
2698(1)

WINDY 1  
1103(12)

GOLDEN LEDGE 1  
2281(2)

GOLDEN LEDGE  
2280(2)

WINNIPEG  
2298(2)

Noel L.

DAYTON  
2662(12)

Gwyneth Lake

ORO 3  
659(8)

ORO 5  
1629(11)

Kingdom L.

WATERLOO 1  
2269(1)

Mead L.

L5369

GEOLOGY

General

The claim lies within an area underlain by the Bridge River or Fergusson Group of sediments. These are Triassic in age.

No deposits of economic mineral deposits are known to occur on the property.



## GEOCHEMISTRY

### General

The soil sampling program was designed to test an area under and flanking the high-tension power line which passes through the area. The area sampled bordered the power line for 500 meters on either side of the power line. The DIANE Fr 2 lies within this area.

### Survey Control

The power line was used as the baseline and lines were established due east and west at 100 meter intervals and extended for 500 meters on either side of the baseline. Stations were established along the lines at 20 meter intervals.

The DIANE Fr 2 lies between lines 32S and 37S approximately from stations 3+00 E to 5+00 E.

### Sampling Procedure

All samples were taken at the stations, using a shovel. The sample had to be taken below a volcanic ash layer that varied in thickness from 30 to 90 centimeters.

### Number of Samples

A total of 52 samples were collected.

### Period of Survey

The samples were collected during June 1985.

### Analyser and Analyses

All the samples were submitted to:

CHEMEY LABS LTD.  
212 Brooksbank Ave.  
North Vancouver, B.C.

The samples were geochemically analysed for gold, silver, arsenic and copper.

The gold was analysed using the fire-assay and finished with the atomic absorption method. The detection limit was 5 parts per billion (5 ppb).

The silver, arsenic and copper were also analysed by the atomic absorption method.

### Results

Reasonably close correlation of metallic anomalies occur for copper and arsenic which indicate a zone trending slightly east of due north through the eastern part of the DIANE Fr. 2.

### Conclusion

The soil sampling results indicate a possible gold bearing zone in the western part of the zone. Further prospecting and trenching is warranted.

### Recommendations

- 1) A geologist should examine the area and lay out a trenching program.
- 2) An excavator should be hired for one or two days to trench across the anomalous zones in several places.
- 3) Samples should be taken of bedrock exposed and submitted for assay.

Respectfully Submitted,

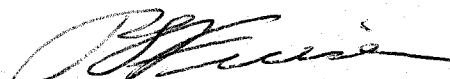
  
P.S. Friesen P. Eng.  
9 Nov. 1985

ESTIMATION OF COSTS

1) Geologist - 4 days @ 250.00/day	\$ 1,000.00
2) Excavator - 16 hours @ 100/day	1,600.00
3) Assaying - 50 samples @ 15.00	<u>750.00</u>
Total	<u><u>3,350.00</u></u>



CERTIFICATE OF QUALIFICATION

This is to certify that:

- 1) I, Peter S. Friesen reside at 6780 Sumas Prairie Road, Sardis, B.C.
- 2) I am a graduate of the University of Saskatchewan where I received a degree of Bachelor of Engineering in Geological Science in 1950.
- 3) I have practiced my profession for 35 years.
- 4) The information in this report is based upon available government records and personal supervision of the diamond drilling program.
- 5) I am a professional engineer registered in the Province of British Columbia.
- 6) I have no interest directly or indirectly in the Property of Levon Resources Ltd. nor do I expect to receive any.

  
P.S. Friesen P. Eng.  
9 Nov. 1985

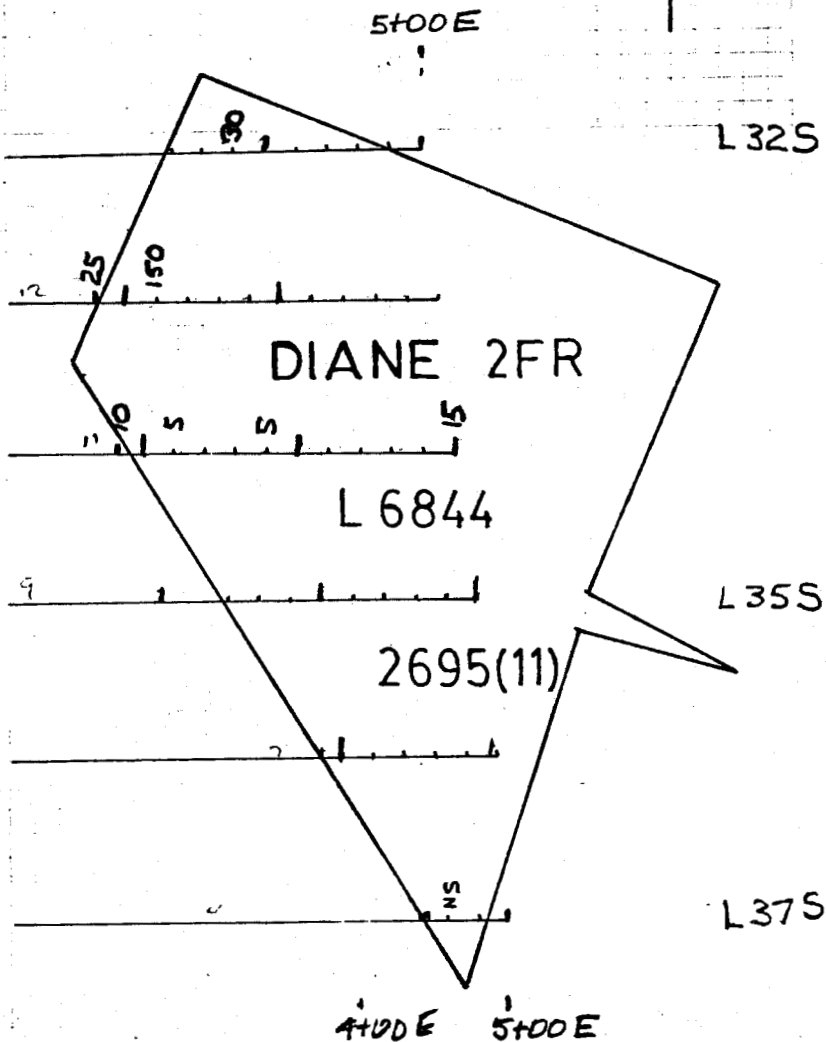

GOLD in ppb

N.B - only values of 5ppb or greater are plotted

NBB - SILVER VALUES WERE ALL 0.10 ppm

### LEVON RESOURCES SOIL GEOCHEMISTRY

NTS: CLAIM: MINING DIVISION:  
 92-J-15W DIANE 2FR LILLOOET  
 LOCATION: DATE:  
 GOLDBRIDGE B.C. JULY 1985

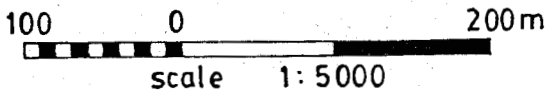

PS FRIESEN CONSULTING GEOL.ENG.

COPYED FROM ORIGINAL FILE

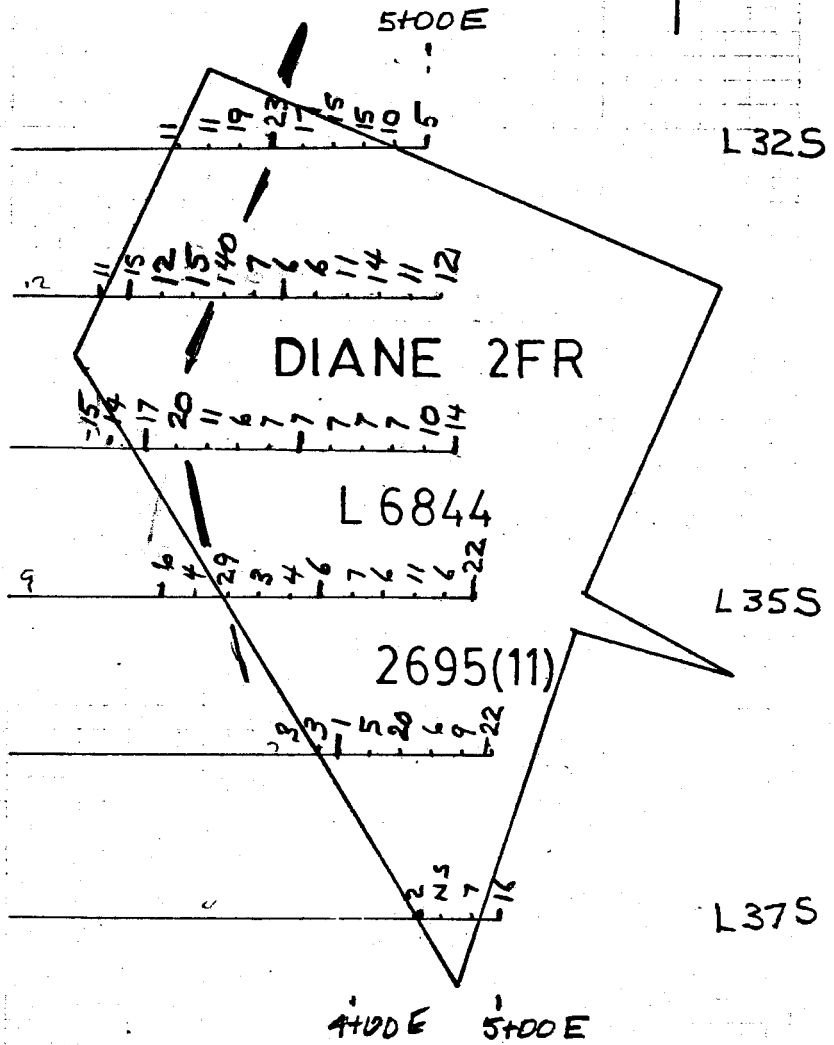

ARSENIC in ppm.

# LEVON RESOURCES SOIL GEOCHEMISTRY

NTS: CLAIM: MINING DIVISION:  
92-J-15W DIANE 2FR LILLOOET

LOCATION: DATE:  
GOLDBRIDGE B.C. JULY 1985

100 0 200m

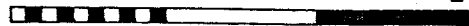

scale 1: 5000

PS FRIESEN CONSULTING GEOL.ENG.

PS FRIESEN CONSULTING GEOL.ENG.

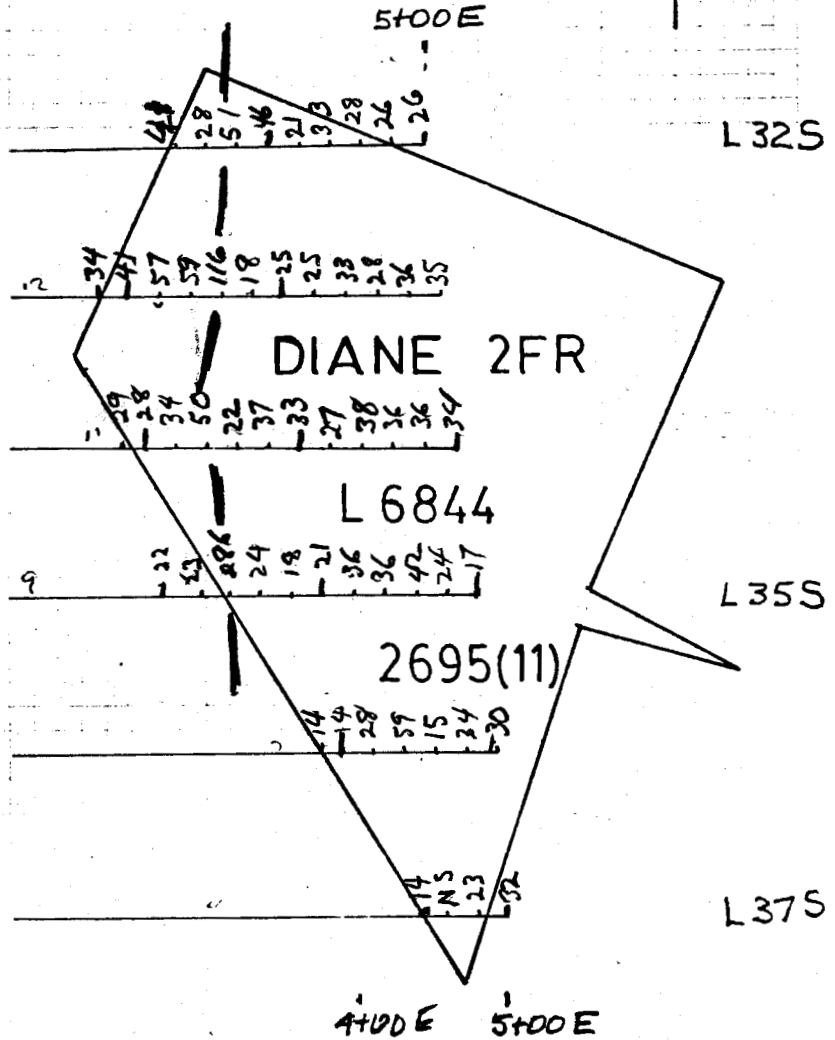

COPPER in ppm

# LEVON RESOURCES SOIL GEOCHEMISTRY

NTS: CLAIM: MINING DIVISION:  
92-J-15W DIANE 2FR LILLOOET

LOCATION: DATE:  
GOLDBRIDGE B.C. JULY 1985

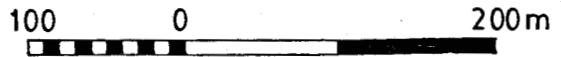

scale 1:5000

PS FRIESEN CONSULTING GEOL.ENG.

L325

52

Diane No. 2 Fr. 2695[11]  
1985 Exploration

STATEMENT OF COSTS

52 samples @ 5.50¢ =		\$	286.00
52 geochem analysis @ 13.35 =			694.20
Engineering & Supervision			<u>400.00</u>
	Sub total		1,380.20
	Office overhead @ 10 %		<u>138.02</u>
	total	\$	<u>1,518.22</u>

