

85-833

14034

8/86

DIAMOND DRILLING  
ASSESSMENT REPORT  
on the  
ADAM GROUP  
(VEGAS, NEVADA & STRIKE CLAIMS)  
GRACE MOUNTAIN  
KAMLOOPS MINING DIVISION, B. C.

NTS: 82M/7W  
Latitude: 51°30'  
Longitude: 119°49'  
Owner: George Adam  
Operators: George Adam & Harold J. Adams  
Core Log  
Consultant: K. L. Daughtry & Associates Ltd.  
Author: Harold J. Adams (Prospector)  
Date: November 5, 1985

GEOLOGICAL BRANCH  
ASSESSMENT REPORT

14,034

TABLE OF CONTENTS

INTRODUCTION.....Page 1  
LOCATION, ACCESS, TOPOGRAPHY.....Page 2  
PROPERTY.....Page 3  
HISTORY.....Page 4  
DIAMOND DRILL LOGS.....Page 5  
DIAMOND DRILL PROGRAMME.....Page 6  
CONCLUSIONS.....Page 7  
STATEMENT OF COSTS.....Page 8

LIST OF ILLUSTRATIONS

Figure 1	Vegas, Nevada & Strike Claims Adam Group Property Location Map	Following Page 3
Figure 2	Plan of Drill Hole Location	Following Page 6

INTRODUCTION

During July and August, 1985, Harold J. Adams and George Adam, Prospectors and Diamond Drillers, carried out an X-Ray diamond drill programme on the Adam Group Property on Grace Mountain in the Kamloops Mining Division, B. C.

The programme was designed to test bedrock formations to a depth of 50 feet (15.4m).

One hole was completed on the Strike #3 claim at an elevation of 4,000 feet (1200m) to explore the surface and formations of rock to coincide with the formations of the adjacent Copper King Adit showings.

The drill programme was supervised by Harold J. Adams.

The core was logged by K. L. Daughtry & Associates Ltd.

LOCATION, ACCESS, TOPOGRAPHYLocation

The Adam Group Property, consisting of the Vegas, Nevada and Strike claims is situated on Grace Mountain. The property is on Blais Creek and runs parallel with Deep Creek, approximately 30 kilometers north of Seymour Arm in the Kamloops Mining Division, B. C.

Access

Good access is provided from Kamloops to Chase, B. C. A secondary road from Chase to Bughouse Bay, B. C. An active, radio-controlled gravel logging road provides access to Blais Creek where the property is situated.

Topography

The National Topographic System map reference is 82M/7W and the co-ordinates of the showings are  $51^{\circ}30'$  North and  $119^{\circ}49'$  West.

Elevations on the property in the area of the drill programme range at 4,000' (1,200m). The topography has a moderate to steep eastern slope down into Deep Creek.

PROPERTY

At the time of the diamond drilling, the property consisted of fifteen modified grid claims and four 2-post mineral claims (Figure 1) as described in the following table.

<u>Claim Name</u>	<u>Record No.</u>	<u>Registered Owner</u>
Vegas - 9 units	98	George Adam
Nevada - 6 units	102	George Adam
Strike - 1-4	4681-4684	Harold J. Adams

The above claims were grouped as the Adam Group Property.

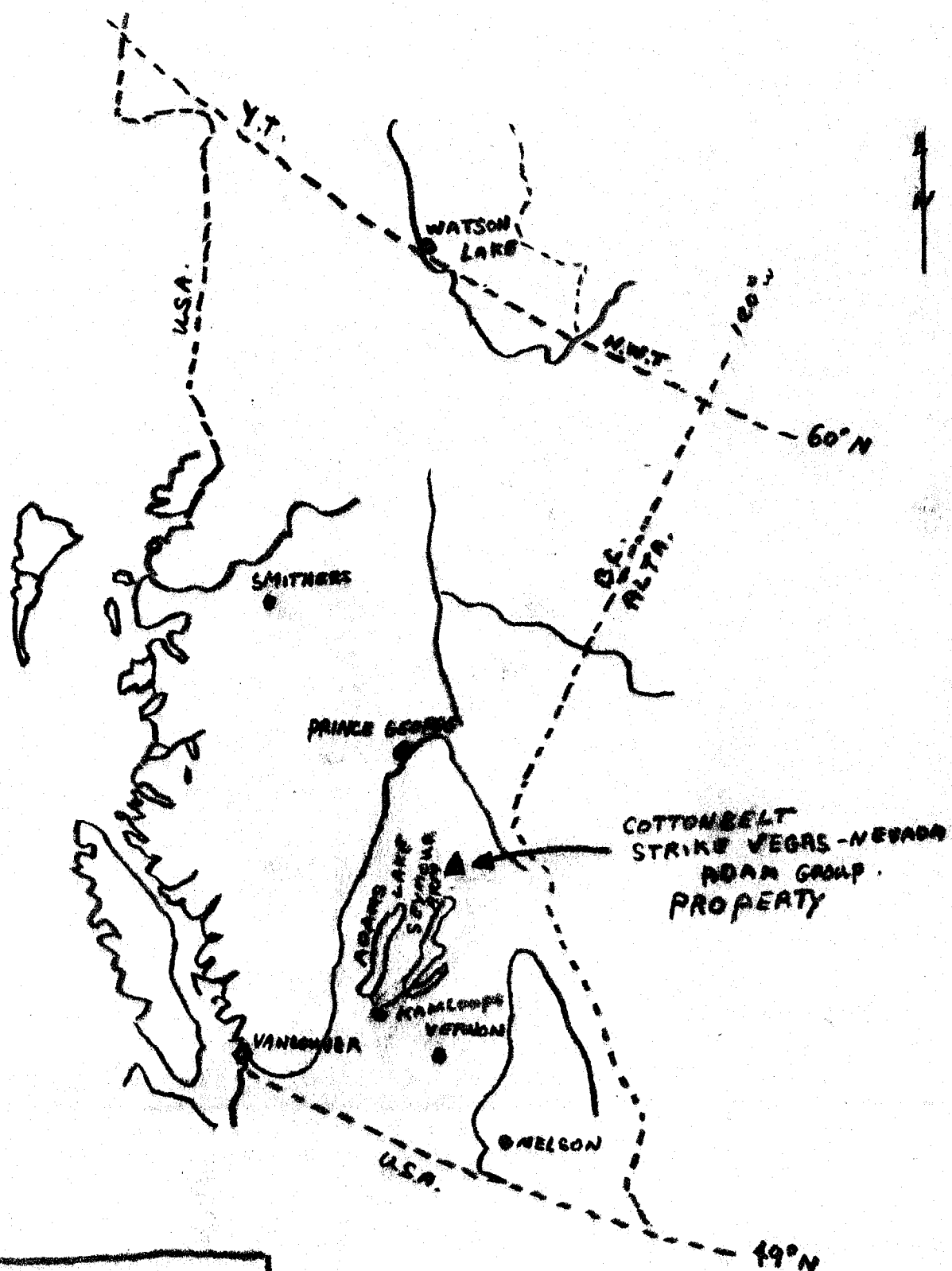

MAP-82M/7N	
H. J. ADAMS	
LOCATION-MAP	
STRIKE-VEGAS-NEVADA	
PROPERTY	
NOV 6/85	Fig No 1

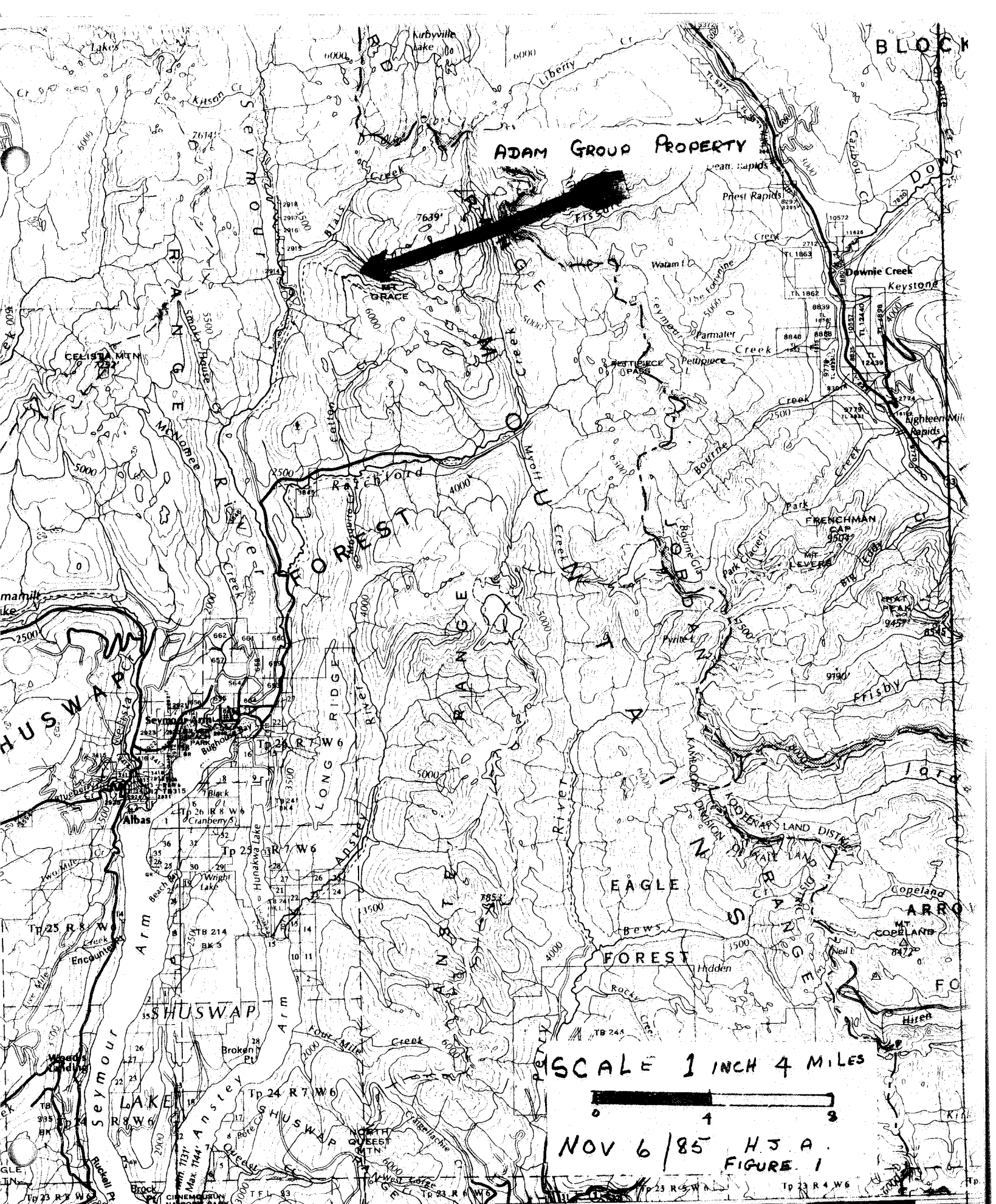

ADAM GROUP PROPERTY

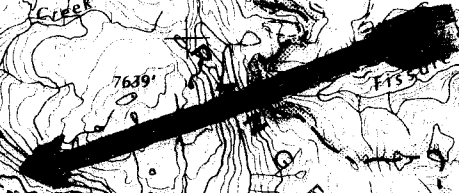

SCALE 1 INCH 4 MILES



NOV 6 / 85 H.S.A.  
FIGURE 1

119°00'

45'

To Sicamous 19 miles

To Revelstake 24 miles

30'

REFERENCE

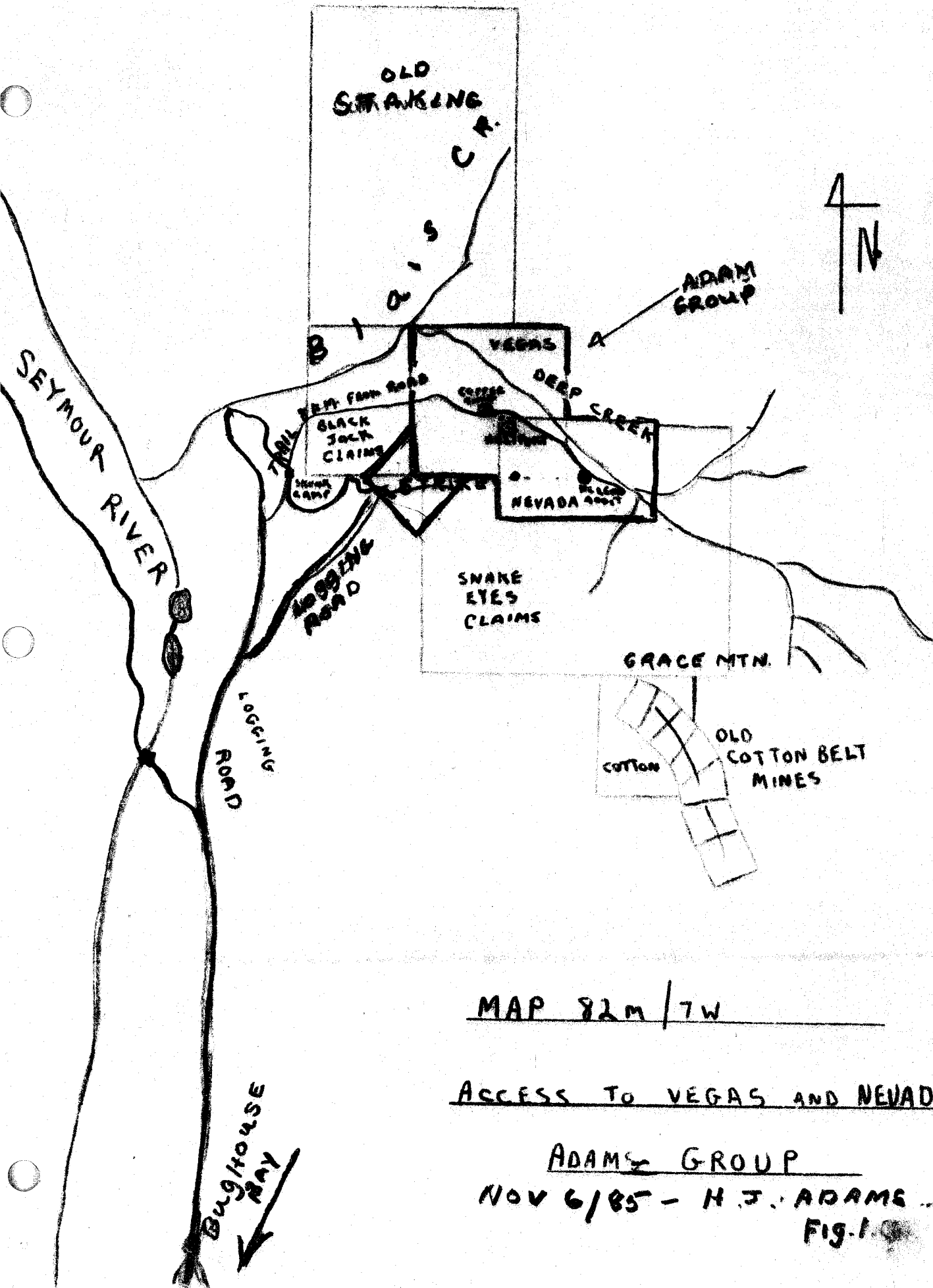

MAP 82M / 7W

ACCESS TO VEGAS AND NEVADA

ADAMS GROUP

NOV 6/85 - H.J. ADAMS

FIG. 1



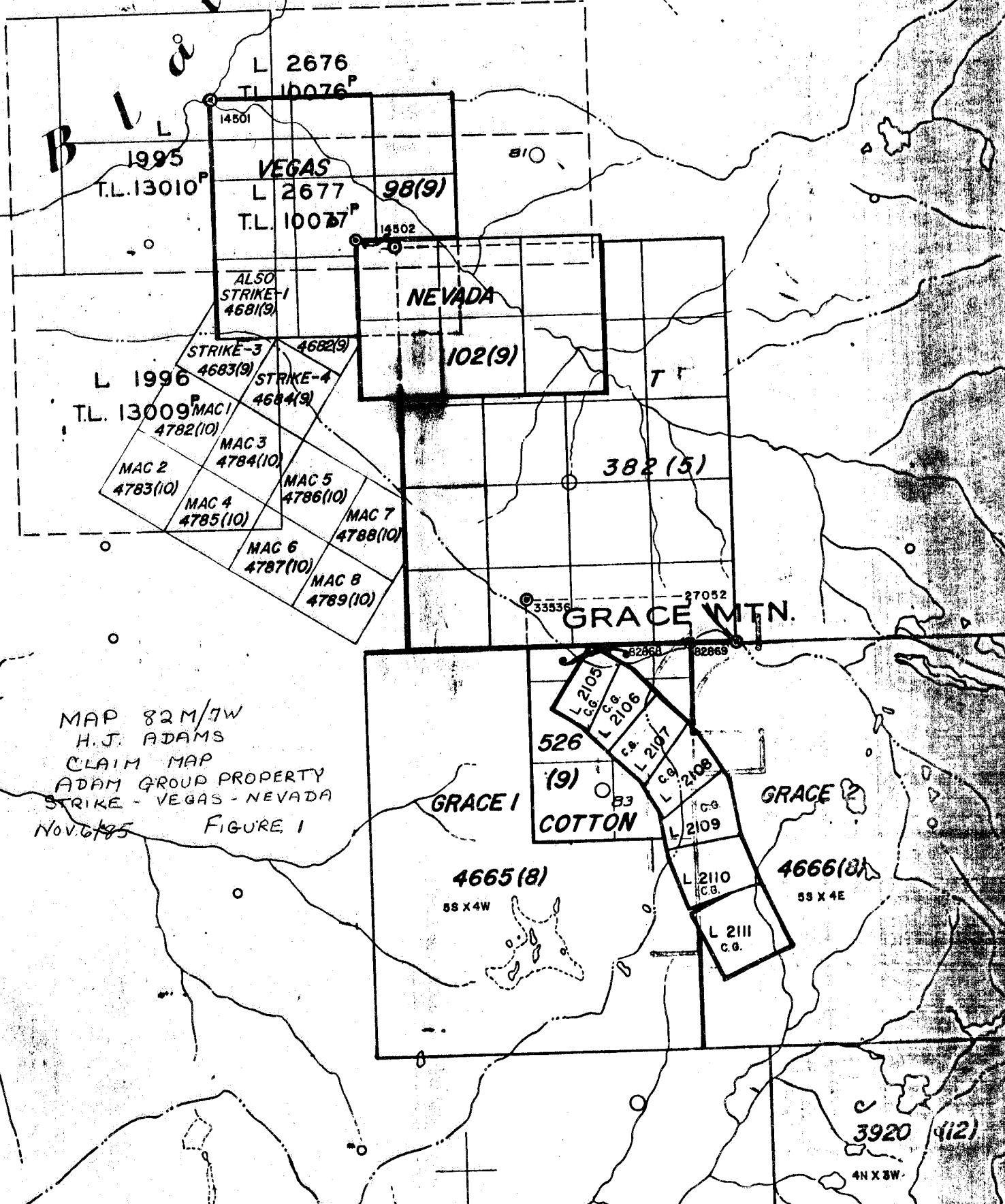

MAP 82M/JW  
 H.J. ADAMS  
 CLAIM MAP  
 ADAM GROUP PROPERTY  
 STRIKE - VEGAS - NEVADA  
 Nov. 6/85      FIGURE 1

HISTORY

The Cottonbelt group of claims was first staked in 1905, on Grace Mountain, and was worked by Granby Light & Power and individual prospectors.

In the following years, the claims were abandoned and left dormant until the middle 1960's.

Great Northern Petroleum & Mines Ltd. (N.P.L.) did some work on the Cottonbelt Crown Grants and surrounding claims from 1967 to 1973 and brought back an interest in the Property.

In 1975, the Property was staked and acquired by the Adams' brothers, who have carried out active exploration such as linecutting, sampling, hand trenching and X-ray drilling. The Property is still held to date.

DIAMOND DRILL PROGRAMME

Between July 23 and July 26, 1985, a programme of X-ray diamond drilling was conducted on the Strike - 3 claim. One hole was successfully completed. The location of the hole is shown on the accompanying plan (Figure 2). The core was logged by K. L. Daughtry, P. Eng. on July 31, 1985, and the pertinent drill hole information is summarized below:

Driller: George Adam

Foreman: Harold J. Adams

Machine: BBS 1 A X-ray

Core Diameter: X.R.P. ( $\frac{1}{8}$  inch)

Hole No.: DDH - 1 - AG - 1 - 85

Location: BL - 1 - 0+50 NW

Direction: 80° NE

Dip: 50°

Length: 50.5 feet (15.4m)

Collar Elevation: 4,000 feet (1,200M)

All core is stored at the Strike No. 3 & 4 Final Claim Post and covered up.

The drill hole was collared on Strike - 3 Claim.

Complete drill log for DDH - 1 - AG - 1 - 85 on Page 5.

All core was logged by K. L. Daughtry, P. Eng.

Figure 2 follows.



VEGAS-CLAIMS

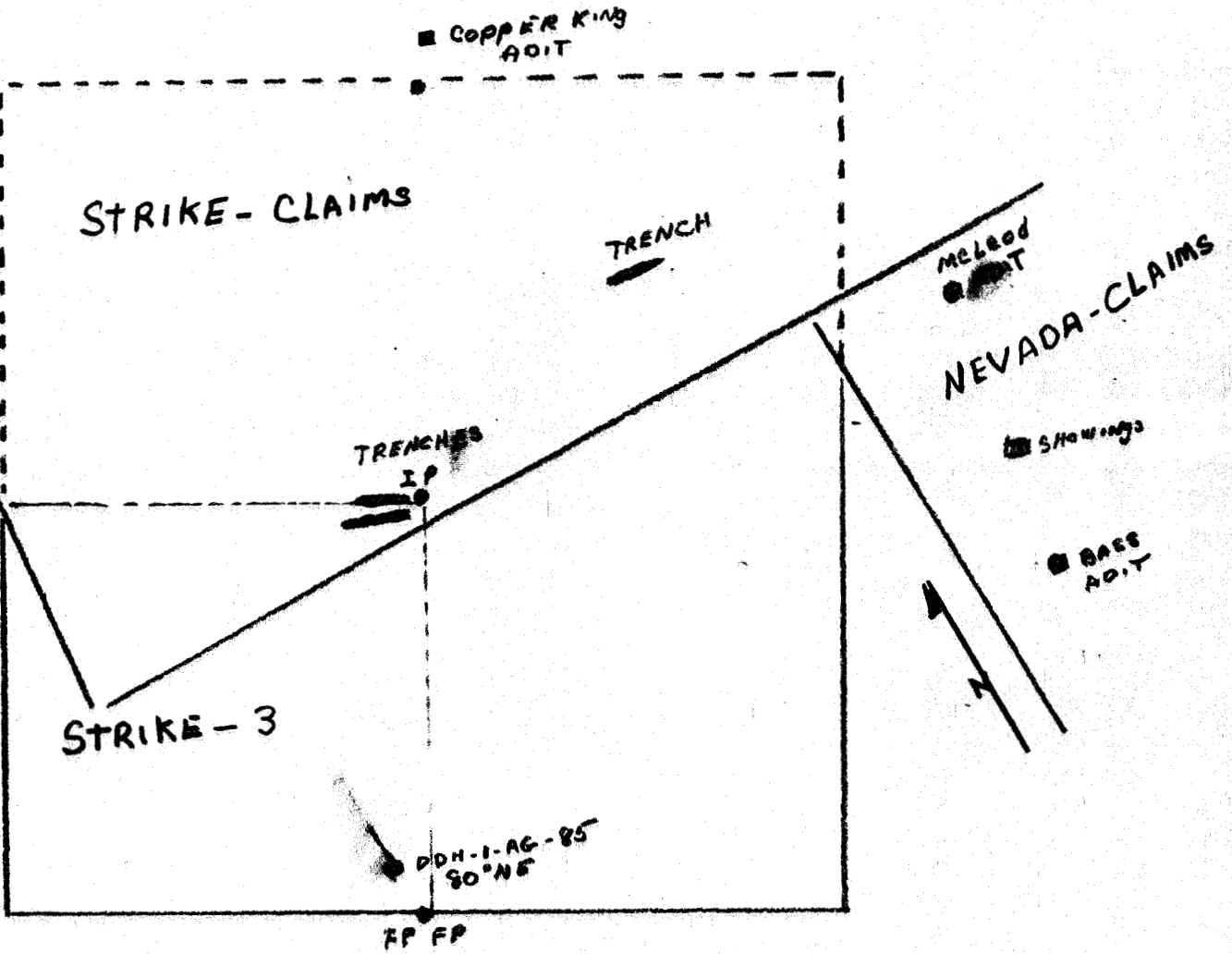

FIGURE 2

ADAM PROPERTY

GRACE MOUNTAIN

DRILL HOLE LOCATION

SCALE 1:500

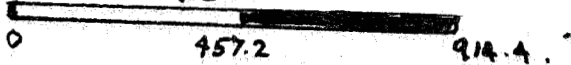
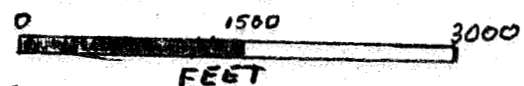

NOV-6/85 H.J.A.

Co-Ords:

K. L. DAUGHTRY & ASSOCIATES LTD.

Hole No. 1-85

Azimuth: 080°

Diamond Drill Record

Property: STRIKE

Dip: -50°

Drill Type & Size: BBS-1A  
XRP (1/2 inch)

Location: STRIKE 3 Claim

Elevation: 4000 ft approx  
(1200m)

Dip Tests: none

Date Started: July 23/85

Date Completed: July 26/85

Length: 50.5 ft (15.4 m)

Logged By: K.L. Daughtry, P.Eng

Section:

Date Logged: July 31, 1985

Purpose:

Footage		Description	Sample No.	Footage		Length	Core Recovery					
From	to			from	to							
0	10.5 (3.2m)	OVERBURDEN (Casing to 12 ft)										
10.5	21.0 (6.4m)	Greenish-gray HORNBLende GNEISS Predominantly weakly foliated medium-grained greenish-gray to green biotite-hornblende gneiss. Occasional bands of white quartzite < 8" (0.2m) wide. Interlayered sections of green hornblende-rich rock and greenish-gray biotite-hornblende rock. 10.5-12.0 Weakly calcareous, garnetiferous Foliation: ~75° c.a.					80%					
21.0	22.0 (6.7m)	Dark gray GARNET-BIOTITE GNEISS Weakly foliated dark gray medium-grained garnetiferous gneiss - as above but much less hornblende and more biotite.					100%					
22.0	25.0 (7.6m)	Greenish-gray HORNBLende GNEISS as above					65%					

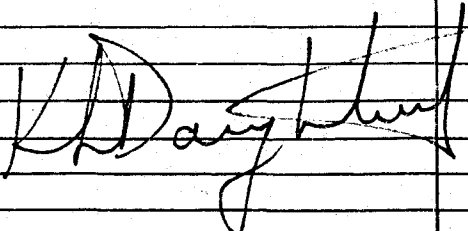
Footage from to		Description	Sample No.	Footage from to		Length	Core Recovery						
25.0	40.7 (12.4m)	Gray BIOTITE GNEISS Medium gray, medium-grained, well-foliated biotite gneiss with several hornblende-rich bands $\leq 4$ in (0.1m). Occasional coarse- grained ( $\frac{1}{4}$ in) white feldspar clots					65%						
40.7	44.7 (13.6m)	Light greenish-gray GARNET-HORNBLLENDE GNEISS Light greenish-gray, medium to coarse-grained weakly foliated garnet-hornblende gneiss. Several coarse-grained, almost porphyroblastic sections with garnets $< 0.3$ cm, hornblende $< 1.2$ cm, feldspar $< 0.6$ cm. BIOTITE-					50%						
44.7	50.5	Greenish-gray HORNBLLENDE GNEISS As at top of hole, but more hornblende Occasional narrow ( $< 1.2$ cm) garnetiferous bands					70%						
50.5		EOH											
Information on hole location, attitude etc and core recovery supplied by H. Adam and G. Adam.													
													

CONCLUSIONS

The Adam Group Property, with it's copper, silver, and zinc showings has great potential. Although much work has been done on the property in the past, it still warrants further exploration and drilling in the future.

Harold J. Adams

*Harold J. Adams*

Prospector  
Diamond Driller



STATEMENT OF COSTS

## Diamond Drilling and Physical Work.

(a) Rental of X-ray Diamond Drill BES - 1 - A	\$ 750.00
(b) Rental of Water Truck	700.00
(c) Labour	3,160.00
(d) Rental of two 4x4 Trucks	600.00
(e) Food and Lodging	<u>720.00</u>
Total	\$5,930.00