

9/86

1985 ASSESSMENT REPORT

For

- AMY-DEE 1 (3818)
- AMY-DEE 2 (3819)
- AMY-DEE 3 (3820)
- AMY-DEE 4 (3821)

MINING CLAIMS

ADAMS LAKE AREA

KAMLOOPS M.D.
 NTS 82 M
 51° 08'N, 119° 43'W

Owner and Operator

CASA DEL ORO RESOURCES INC.
 600-1111 Melville Street
 Vancouver, B.C.
 V6E 3V6

Contractor

HAVILAH GOLD CO. INC.
 P.O. Box 1350
 Dayton, Nevada, U.S.A. 89403

VERIFICATION AND REPORT

BY

MARVIN A. MITCHELL, P. ENG.
 710 - 475 Howe St.
 Vancouver, B.C.
 V6C 2B3

(604) 682-2744

November 25, 1985

GEOLOGICAL BRANCH
ASSESSMENT REPORT

14,046

TABLE OF CONTENTS

	<u>PAGE</u>
INTRODUCTION	
(a) INTRODUCTION	1
(b) CLAIMS AND LOCATION	1
(c) PREVIOUS WORK	2
REGIONAL AND LOCAL GEOLOGY	4
DESCRIPTION OF 1985 DRILLING	5
CONCLUSIONS	9
STATEMENT OF COSTS	10
BIBLIOGRAPHY	11
CERTIFICATE	12

FIGURES

- FIGURE 1 - LOCATION MAP
- FIGURE 2 - CLAIMS AREA
- FIGURE 3 - (In pocket) LOCATION 1985 DRILLING

APPENDICES

- APPENDIX (1) ARNOLD ANECDOTAL NOTES
- APPENDIX (2) ASSAY SHEETS

INTRODUCTION

INTRODUCTION

(a) INTRODUCTION

Casa Del Oro Resources Inc. of 600 - 1111 Melville Street, Vancouver, British Columbia, V6E 3V6 is the owner of the Amy-Dee 1 - 4 mineral claims situated at White Bluffs, on the west side of Adams Lake, Kamloops M.D., British Columbia. During August and September of 1985 an exploration program of fifty short rotary test holes on terraces along the shore of the lake was completed.

The purpose of these holes was to geochemically test the lateral continuity of a quartz vein that is reported to bear zinc, silver and gold mineralization.

The writer was retained to locate and verify the positions of the holes on the property and to compile this report for submission to the Ministry of Energy, Mines and Petroleum Resources.

This report is based on a personal inspection of the property on October 2, 1985, and on references from previously published sources as acknowledged.

(b) CLAIMS AND LOCATION

The Amy-Dee 1 - 4 mineral claims include a total of sixty-four modified grid system claim units located at White Bluffs on the west side of Adams Lake. They lie between Samatosum Creek to the south and west and Brennan Creek to the north. The north west corner of Amy-Dee 1 is located at the south east end of Johnson Lake. The south east corner of Amy-Dee 4 is on the east side of Adams Lake, just north east of Tshinaken Point. Map coordinates are $51^{\circ} 08' N$ and $119^{\circ} 48' W$. The area and claims are

CASA DEL ORO RES, INC.
AMY-DEE CLAIMS
LOCATION MAP

FIGURE 1



MAM

shown on NTS map sheet 82 m (Seymour Arm), on Ministry of Energy, Mines and Petroleum Resources' claim map M82M/4E respectively and on Figure 2 of this report.

Geological Survey of Canada Open File Report 637 includes the Amy-Dee mineral occurrence as "Occurrence 097, Rose Group".

The Amy-Dee 1 - 4 claims are accessible by road from Louis Creek, a village located 41 km to the west on B.C. Highway No. 5 along a gravel road to Skwaam Bay on Adams Lake then along the Adams Lake West Forestry Road to km 29.

Table 1
MINERAL CLAIMS

<u>NAME</u>	<u>NO. OF UNITS</u>	<u>RECORD NO.</u>	<u>RECORD DATE</u>
Amy-Dee 1	20	3818	Sept. 25
Amy-Dee 2	20	3819	Sept. 25
Amy-Dee 3	6	3820	Sept. 25
Amy-Dee 4	18	3821	Sept. 25

The recorded owner of these claims is Casa Del Oro Resources Inc.

(c) PREVIOUS WORK

The Amy-Dee mineral occurrence is located near the south east corner of the Amy-Dee 2 claim and consists of an east-west trending northerly dipping (20 - 25°)

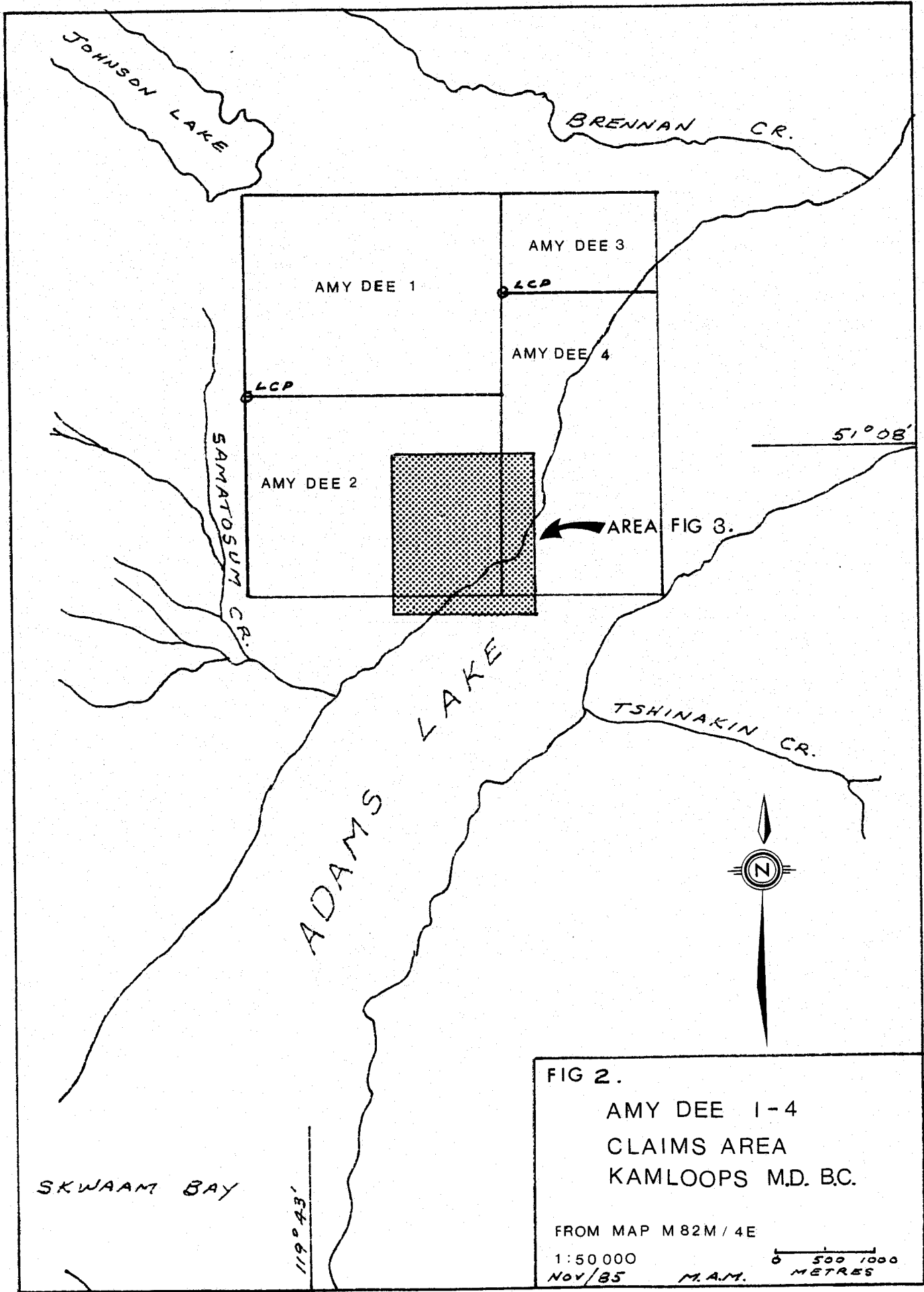

FIG 2.

AMY DEE 1-4
 CLAIMS AREA
 KAMLOOPS M.D. B.C.

FROM MAP M82M/4E

1:50 000

NOV/85

M.A.M.

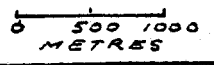

quartz vein containing small but persistent bunches of sphalerite. Prior to 1982 outcrops of this material were extensively trenched. In 1982, a vertical diamond drill hole 82-1 was collared approximately 50 m north of the trenches and encountered a quartz vein from 130.45 m to 133.65 m. This vein contained sphalerite streaks from 131.98 m through 133.65 m. The total depth of the hole was 306 m. The hole was collared in marbelized limestone and save for quartz mineralization remained in this unit until 291 m where until 306 m a gneissic and serpentized meta sedimentary unit was encountered. Ostensoe, 1982, P4.

REGIONAL AND LOCAL GEOLOGY

Ref.

An excellent summary of the geology of the area is presented by Ostensoe, 1982, p. 2 in Assessment report No. 10182. Since that time, no additional mapping has been done by the owners of the property.

DESCRIPTION OF 1985 DRILLING

A series of fifty short 1¼ in (32 mm) diameter rotary drill holes were drilled from old roads along the west shore of Adams Lake. The holes were drilled by Raphael J. Arnold, P.O. Box 1350 Dayton Nv, U.S.A. 89403, contractor.

A copy of Mr. Arnold's anecdotal notes describing the work accomplished is appended to this report.

The drilling was done with a small, truck mounted, gasoline powered drill.

The locations of these holes are shown on Figure 3. Cuttings from the top meter of hole were discarded to avoid contamination from road surface material and a handful of cuttings from each successive meter was combined into one sample and sent for assay.

The holes were surveyed by the writer on October 2, 1985 using a hip-chain and compass. Collar elevations were taken with an aneroid barometer.

An inspection of the cuttings from the holes showed them to be mainly composed of detrital material from the slopes immediately west of the drilling area. No mineralized material was noted.

Forty of the samples were assayed by Budd, F. Rude, 1329 Green Drive, Carson City, Nevada 89701. Gold and Silver were fire assayed.

Ten of the samples were assayed by Chemex Labs Ltd. of North Vancouver, B.C. using Atomic Absorption and fire assay plus Atomic Absorption assay methods for gold, silver and zinc.

The depths, elevations and assay results from the holes are shown on Table 2. (Holes with an asterisk were assayed by Chemex.)

Copies of the assay return sheets are appended to this report. Some of the samples were incorrectly labeled, therefore, they are not reported on Table 2.

The company is in the process of having all of the samples re-assayed.

TABLE 2

Hole No.	Elevation (m)	Depth (m)	Au Oz/T	Ag Oz/T	Zn (PPM)
1	422	10.7			
2	420	11.6			
3	418	9.8			
4	417	9.2			
5	415	9.8			
6	413	9.8			
7	412	9.2			
8	410	8.5	0.021	0.76	
9	409	8.5			
10	408	5.5	0.018	0.65	
11	407	4.9	0.018	0.65	
12	407	3.4	0.021	0.76	
13	408	4.0	0.019	0.67	
14	409	3.0			
15	412	2.4	0.022	0.77	
16	414	4.6	0.020	0.71	
* 17	416	6.7	5ppb	0.1ppm	142
18	419	6.1	0.021	0.72	
19	424	7.3	0.020	0.83	
20	427	7.0	0.027	0.85	
21	428	6.7	0.028	0.85	
22	444	6.1	0.026	0.84	
23	444	7.9	0.030	0.91	
24	445	6.7	0.031	0.92	
25	445	7.0	0.029	0.86	

.... continued....

TABLE 2
Continued

Hole No.	Elevation (m)	Depth (m)	Au Oz/T	Ag Oz/T	Zn (PPM)
26	445	6.1	0.029	0.87	
* 27	447	6.4	5ppb	0.1ppm	95
28	448	5.8	0.027	0.91	
* 29	450	6.1	5ppb	0.1ppm	61
30	450	7.3	0.027	0.87	
31	450	7.0			
32	450	6.4	0.028	0.89	
33	450	3.7			
* 34	450	4.6	5ppb	0.1ppm	89
35	450	3.4	0.029	1.02	
36	466	9.8	0.033	0.95	
37	468	10.7	0.029	0.91	
38	470	11.3	0.31	1.43	
39	472	10.4	0.10	1.09	
40	472	9.8	0.11	1.08	
* 41	475	11.0	5ppb	0.1ppm	80
42	479	11.6	0.037	0.99	
* 43	481	12.8	5ppb	0.1ppm	71
* 44	482	12.2	5ppb	0.1ppm	95
45	482	14.0			
46	483	11.6			
* 47	485	11.9	5ppb	0.1ppm	77
48	487	11.9			
* 49	488	9.8	5ppb	0.1ppm	115
* 50	490	6.7	5ppb	0.1ppm	201

* Holes Assayed by Chemex Labs Ltd.

CONCLUSIONS

The Amy-Dee 1 - 4 mineral claims, comprising 64 claim units cover an area of Shuswap Metamorphic Terrain west of Adams Lake, B.C. Geology of the White Bluffs area is dominated by Limestone of the Tshinakin member limestone of the Cambrian - Ordovician Eagle Bay Formation. Bunches of brown Sphalerite containing gold and silver values are found in a conformable white quartz vein perhaps 2 m wide.

The overburden drilling done in the 1985 assessment year failed to indicate the presence of further mineralization north and south of the immediate vein outcrop area.

The anomalously high gold and silver values obtained in assay results from Mr. Rude do not correlate with those results from Chemex Labs and should be considered suspect.

The company is re-assaying all samples with a view that previous assaying might have been done with contaminated Litharge.

Further exploration on the property should include detailed geological mapping and a geochemical soil survey (zinc to be used as one of the pathfinder elements). The spacing of the samples would be close near the mineralization and more widely spaced in more distant parts of the claims area.

STATEMENT OF COSTS

From R. Arnold (See Appended Notes)

Drilling 399m Drilling @ \$31.25/m	\$ 12,500.00
Room and Board 7 Days @ \$21.43/day	150.00
Assaying (Rude) 40 samples	<u>600.00</u>
	\$ 13,250.00
Assaying (Chemex) 10 for Au Ag and Zn	\$ 116.50
Property Examination 2 days @ \$250/day	\$ 500.00
Expenses	60.00
Transportation	296.50
Report Preparation	<u>640.00</u>
	\$ 1613.00
	<u><u>\$ 14,863.00</u></u>

Respectfully submitted

MARVIN A. MITCHELL, P. ENG.



November 25, 1985

BIBLIOGRAPHY

Jones, A.G., 1959, Vernon Map Area, British Columbia,
Memoir 296, G.S.C.

Campbell, R.B., 1964, Adams Lake and Canoe River Map Areas,
Summary of Activities, Field, 1963, G.S.C.

Okulitch, A.V., 1974, Stratigraphy and Structure of the Mount Ida Group, Vernon (82L),
Seymour Arm (82m), Bonaparte Lake (92P) and Kettle River (82E), Map
Areas, British Columbia, G.S.C.
Paper 74-1, Part A.

Ostensoe, E.A., 1982, Report on Diamond Drill Hole 82-1, Amy-Dee 1 - 4 Claims, White
Bluffs, Adams Lake Area, Kamloops Mining Division, B.C.
Assessment Report 10782 M.E.M.P.R.

1979, Thompson - Shuswap - Okanagan
Open File 637, G.S.C.

CERTIFICATE

I, MARVIN ALFORD MITCHELL DO HEREBY CERTIFY THAT:

- 1) I am a Consulting Geologist residing at Suite 203, 2825 Spruce Street, Vancouver, B.C. V6H 2R4. My office is at #710 - 475 Howe Street, Vancouver, B.C., V6C 2B3.
- 2) I graduated from Montana College of Mineral Science and Technology in 1968 with a B.Sc. in Geological Engineering (Mining Option).
- 3) I have been a member of The Association of Professional Engineers of the Province of British Columbia since 1972 and that I am a member in good standing of that Association.
- 4) The findings of this report are derived from data as acknowledged and from a personal examination of the property and area October 2, 1985.
- 5) I have no interest, directly or indirectly in the properties examined or in Casa Del Oro Resources Inc. nor do I expect to receive any interest in such property or securities.



MARVIN A. MITCHELL, P. ENG.

November 25, 1985

APPENDICES

APPENDIX I

ARNOLD ANECDOTAL NOTES

Amy DEE ASSESSMENT REPORT 85
FOR "CASA DEL ORO RES. INC." :-

SUBMITTED BY AGENT (CONTRACTOR)
"HAVILAH GOLD CO. INC." }
P.O. 1350 }
DAYTON NV., 89403 U.S.A. }
RAPHAEEL J. ARNOLD
P.O. BOX 1350
DAYTON NV., 89403 U.S.A.
TEL. 702) 246-3583.

ASSESSMENT WORK (DRILLING & SAMPLING) —
COMMENCED ON SEPT. 9/85, AT THE 29-K MARKER
ON OR ALONG THE ADAMS LAKE RD (WHITE BLUFFS) — & IS APPROX.
10 KILOMETERS FROM THE (BRIDGE) "AGATE BAY RESORT"
ON SQUAM BAY, AND RUNS TO AND PAST THE 30-K
MARKER BY ANOTHER 1/4 KILOMETER, ENCOMPASSING
AND UTILIZING FOUR TERRACES (TIERS) BEGINNING
AT BOTTOM OF LAKESHORE (ADAMS) AND RISES TO
A LEDGE (JOHNSON LAKE RD. EAST TO WEST
ACCESS) IMMEDIATELY WEST OF WHITE BLUFFS AREA.

DRILLING COMMENCED WITH HOLE #1. ON A LEDGE
PARALLELING ADAMS LAKE-SHORE EAST OF THE 30-K
MARKER BY APPROX. 1/4 KILOMETER AND ALL HOLES
FROM HENCE TO #22 ARE DRILLED AT APPROX.,
100 METERE INTERVALS, AND ARE MARKED WITH THE
IDENTIFYING HOLE NUMBER WITH YELLOW RIBBON, TIED
TO THE NEAREST IMMEDIATE BUSH. THE GROUND FORM-
ATION AS WAS DRILLED — WAS CHIEFLY THROUGH
OVER-BURDEN (SOIL - AND BOULDERS) OF WHICH
ORIGIN WAS SUPPLIED BY EROSION FROM HIGHER
(CONSIDERABLE) GROUND FROM AMY DEE CLAIMS AS
BEING NORTH & NORTH WEST OF THE WHITE BLUFFS
REGION. DRILLING OCCASIONALLY HALTED AFTER
PENETRATION INTO LIMESTONE (BED ROCK) OF THAT
REGION. SAMPLING CONSISTED OF CATCHING DRILL-
SLUDGE AND BAGGING SAME FOR FINAL ASSAY
ANALYSIS FOR AU. & AG. (CONTINUED) —

AMY DEE ASSESSMENT REPORT 185

FOR CASA DEL ORD RESOURCES INC.

SUBMITTED BY AGENT (CONTRACTOR)

HAVILAH GOLD CO. INC.

P.O. BOX 1350
DAYTON NU. 89403 U.S.A.

RADHALEZ J. ARNOLD
P.O. BOX 1350
DAYTON NU. 89403
TEL. 702) 246-3583.

— PAGE TWO —

PROGRESSION OF DRILLING ADVANCED IN A WESTERLY DIRECTION CULMINATING EAST OF THE 30-K MARKER AND JOINING (BRANCH) THE MAIN ROAD PARALLELING ADAMS LAKE.

THE SECOND TERRACE (LEDGE) DRILLED COMENCED NEXT TO ADAMS LAKE-SHORE BETWEEN THE 29-K MARKER & THE 30-K MARKER JUST EAST OF WHITE BLUFF AREA COMMENCING WITH HOLE # 23 (DRILLED AT 100 METER INTERVALS (EAST TO WEST) AND AVERAGING APPROX. 25' PER HOLE THROUGH OVER BURDEN (SOIL AND BOULDERS) INTO AND STOPPING IN THE LIMESTONE BED ROCK, AND CULMINATING WITH HOLE # 28 — (ALL HOLE NUMBERS MARKED WITH IDENTIFYING YELLOW RIBBONS AT THE NEAREST (IMMEDIATE BUSH).

THE THIRD TIER OR TERRACE IS A SWITCH-BACK RISING TOWARDS THE ADAMS LAKE MAIN ROAD AND EVENTUALLY JOINING (BRANCHING INTO) SAID ROAD, THOUGH LIES DIRECTLY ABOVE THE PREVIOUS TIER OR LEDGE AS WAS DRILLED. HOLES DRILLED

UNDOLED # 29 THROUGH # 35 (AT 100 METER INTERVALS), THROUGH OVER-BURDEN (SOIL & BOULDERS) CULMINATING IN BED-ROCK (LIMESTONE) AND AVERAGING 25' PER-HOLE, BEING ACCORDINGLY IDENTIFIED WITH YELLOW RIBBON TIED TO NEAREST (IMMEDIATE) BUSH.

(CONTINUED —)

ARMY D&G ASSESSMENT REPORT 185
FOR CASA DEL ORO RESOURCES INC.

SUBMITTED BY AGENT (CONTRACTOR)

"HAVILAH GOLD CO. INC."

P.O. BOX 1350
DAYTON NO., 89403 U.S.A.

RAFAEL J. ARNOLD

P.O. Box 1350

DAYTON NO., 89403

TEL 702) 246-3583

— PAGE - THREE —

THE FOURTH TIER OR TERRACE DRILLED & SAMPLED COMMENCED AT THE BASE OF WHITE BLUFFS (29-K MARKER) AND PROGRESSED WESTERLY AS CONSTITUTING THE (EAST-TO-WEST ACCESS) RD. JUNCTURE PROCEEDED TO JOHNSON LAKE, THOUGH PARALLELING THE MAIN ADAMS LAKE RD. UNTIL THIS RD. BRANCHE INTO THE (WEST-TO-EAST) ACCESS RD. PROCEEDING FROM THIS JUNCTURE, NORTHERLY & TO JOHNSON LAKE. HOLES DRILLED & SAMPLED COMMENCE WITH HOLE # 36 EAST OF 29-K MARKER AND PROGRESS WESTERLY THROUGH AND TO FINAL HOLE # 50 AND BEING WEST OF 29-K MARKER HOLES ARE DRILLED AT 100 METER INTERVALS THROUGH OVERBURN (SOIL & BOULDERS) OCCASIONALLY CULMINATING IN LIMESTONE FORMATION, AND ARE IDENTIFIED ACCORDING TO HOLE # BY YELLOW RIBBON TIED TO BRANCHOR BUSH IN THE IMMEDIATE AREA OF SAID HOLE.

ARMY DEE ASSESSMENT REPORT 1/85
FOR CASA DEL ORO RESOURCES INC.

SUBMITTED BY AGENT (CONTRACTOR)

"HAVILAH GOLD CO. INC."
P.O. BOX 1350
DAYTON NV, 89403 U.S.A.
TEL. 702) 246-3583

RAPHAEL J. ARNOLD
P.O. BOX 1350
DAYTON NV, 89403 U.S.A.
TEL. 702)

- PAGE - 4. -

SUMMARY:

IN PREVIOUS ASSESSMENT ON THE ARMY-DEE GROUP (CLAIMS), CASA DEL ORO HAD THE WORK CONTRACTED TO ONE OF ITS PARTNERS (GUY DELOKME) OWNER OF 25% OF CASA DEL ORO, AND OWNER OF G. & D. DIAMOND DRILLING, WHO DRILLED A CORE HOLE OF APPROX. 1 1/2 DIA. TO 1000 FEET, HAVING CHARGED CASA DEL ORO \$30.00 PER FOOT WHICH WAS ACCEPTABLE FOR QUALIFICATIONS AS BEING PROOF OF LABOUR BY THE B.C. MINERALS ACT REGULATORS.

HAVILAH GOLD CO. INC. HAS PERFORMED THE NECESSARY PROOF OF LABOUR BY DRILLING AND SAMPLING (ROTARY SLUDGE) (WET) APPROX. 1,250 FEET OF 1 1/4 DIA. THROUGH THE OVERLYING CLAY AND GRAVEL & BOULDERS (OVER-BURDEN) IN THE IMMEDIATE AREA OF THE WHITE BLUFFS, WHICH ARE A NOTABLE LAND MARK OF THE ARMY DEE #4. CLAIM. DRILLING THE OVERBURDEN CONSISTED OF 50 HOLES AVERAGING 25' PER HOLE.

DRILLING COSTS ARE SUBMITTED AT A RIDICULOUS LOW COST OF 10.00 PER FT (INCLUDES TRANSPORTATION COSTS) FOR THE SIMPLE REASONS OF NOT HAVING A GUIDELINE TO FOLLOW CONSIDERING THE MOBILE-COMBINE DRILLING RIG (SEE PICTURE) AND DO NOT WANT TO JEOPARDIZE THE ASSESSMENT APPROVAL
Sept. 18/85 Raphael Arnold

AMY DEE ASSESSMENT REPORT / 85
FOR CASA DEL ORD RESSOURCES INC.

SUBMITTED BY AGENT (CONTRACTOR)

"HAVILAH GOLD CO., INC."
P.O. BOX 1350
DAYTON Nv., 89403 U.S.A.

RAPHAEL J. ARNOLD
P.O. BOX 1350
DAYTON Nv., 89403
TEL 702) 246-3583

— PAGE FIVE —

HAVILAH GOLD CO. INC ASSESS'S CONTRACT FEES FOR DRILLING & SAMPLING AS IS CONSIDERABLY LESS IN AMOUNT OF THAT COST AS IS GENERALLY PERMISSABLE FOR ROTARY-BLAST OR CORE-DRILLING AS PER GUIDE LINE (MAR/82) AT NO LESS THEN \$12.00 AND UP TO \$18.00 PER. FT. WHICH ARE LEAST PRICES QUOTED AND ARE BY TO-DAYS STANDARDS, (185) ECONOMICALLY UNFEASIBLE, WHILE REALIZING THAT ROTARY-SLUDGE DRILLING 1 1/4" IS NOT CORE DRILLING, THE COSTS OF DRILLING SAME, (WET), IS HARDLY ANY LESS AT TO DAYS INELATED COST AND WHEREBY, — HAVING VESTED INTEREST IN CASA DEL ORD RESSOURCES INC. AS SHARE-HOLDERS, DO HEREBY CHARGE FOR DRILLING AND SAMPLING 50 HOLES AVERAGING 25' THE RESERVED AMOUNT OF \$10.00 PER FT.

(a)	FOR 1,250 FEET	\$ 12,500.00
(b)	50 SAMPLES AT \$15.00 ASSAY (AU & AG)	\$ 850.00
(c)	BOARD (LESS THEN PERMITTED)	\$ 150.00
(d)	<u>TRANSPORTATION COSTS (INCLUDED IN DRILLING)</u>	\$ —
	TOTAL	\$ 13,500.00

Sept. 18/85 Raphael J. Arnold

APPENDIX II

ASSAY SHEETS

BUDD F. RUDE
1329 Green Drive
Carson City, Nevada 89701
27 October 1985

Casa Del Oro Res., Inc.
c/o R.J. Arnold
P.O. Box 1350
Dayton, Nevada 89403

8510-7363

MATERIAL: Forty Three samples of ore sampled and identified
by Client as "Amy Dee, Adams Lake, B.C."

TEST RESULTS:

<u>SAMPLE NO.</u>	<u>GOLD, OZ/TON</u>	<u>SILVER, OZ/TON</u>
#1 Rock Vein	0.14	1.09
#5 Rock Vein	0.12	1.06
#1 Drill 35	0.029	1.02
#2 Drill 38	0.031	1.43
#3 Drill 22	0.026	0.84
#4 Drill 30	0.027	0.87
#6 Drill 32	0.028	0.89
#7 Drill 28	0.027	0.91
#8 Drill 21	0.026	0.82
#9 Drill 21	0.028	0.85
#10 Drill 18	0.021	0.72
#11 Drill 16	0.020	0.71
#12 Drill 11	0.018	0.65
#13 Drill 13	0.019	0.67
#14 Drill 10	0.018	0.65
#15 Drill 8	0.021	0.76
#16 Drill 15	0.022	0.77
#17 Drill 22	0.028	0.86
#18 Drill 20	0.027	0.85
#19 Drill 24	0.031	0.92
#20 Drill 23	0.030	0.91
#21 Drill 22	0.028	0.83
#22 Drill 20	0.025	0.79
#23 Drill 26	0.029	0.87
#24 Drill 22	0.027	0.83
#25 Drill 23	0.029	0.86
#26 Soil Drill 20	0.025	0.78
#27 Soil Drill 20	0.023	0.91
#28 Soil Drill 19	0.020	0.83
#29 Soil Drill 20	0.022	0.85
#30 Soil Drill 24	0.026	0.88
#31 Soil Drill 23	0.024	0.84
#32 Soil Drill 12	0.021	0.76
#33 Soil Drill 12	0.021	0.82
#34 Drill 15	0.022	0.79
#37 Drill 35	0.027	0.84
#38 Drill 37	0.029	0.91
#40 Drill 32	0.028	0.90
#41 Drill 36	0.033	0.95
#43 Drill 42	0.037	0.99
#44 Drill 40	0.11	1.08
#47 Drill 39	0.10	1.09
#48 Drill 20	0.093	1.03

The above results were derived by re-assaying the slag and
cupels twice.

Budd F. Rude



Chemex Labs Ltd.

Analytical Chemists • Geochemists • Registered Assayers

212 Brooksbank Ave.
North Vancouver, B.C.
Canada V7J 2C1

Phone: (604) 984-0221
Telex: 043-52597

CERTIFICATE OF ANALYSIS

TO : MITCHELL, MARVIN

203 - 2825 SPRUCE ST.
VANCOUVER, B.C.
V6H 2R4

** CERT. # : A8517183-001-A
INVOICE # : I8517183
DATE : 15-OCT-85
P.O. # : NONE
ELDEN #1961

Sample description	Prep code	Zn ppm	Ag ppm	Au ppb FA+AA			
69951 E	205	95	0.1	<5	--	--	--
69952 E	205	89	0.1	<5	--	--	--
69953 E	205	80	0.1	<5	--	--	--
69954 E	205	95	0.1	<5	--	--	--
69955 E	205	77	0.1	<5	--	--	--
69956 E	205	115	0.1	<5	--	--	--
69957 E	205	201	0.1	<5	--	--	--
69958 E	205	71	0.1	<5	--	--	--
69959 E	205	61	0.1	<5	--	--	--
69960 E	205	142	0.1	<5	--	--	--

Certified by *Hautschler*

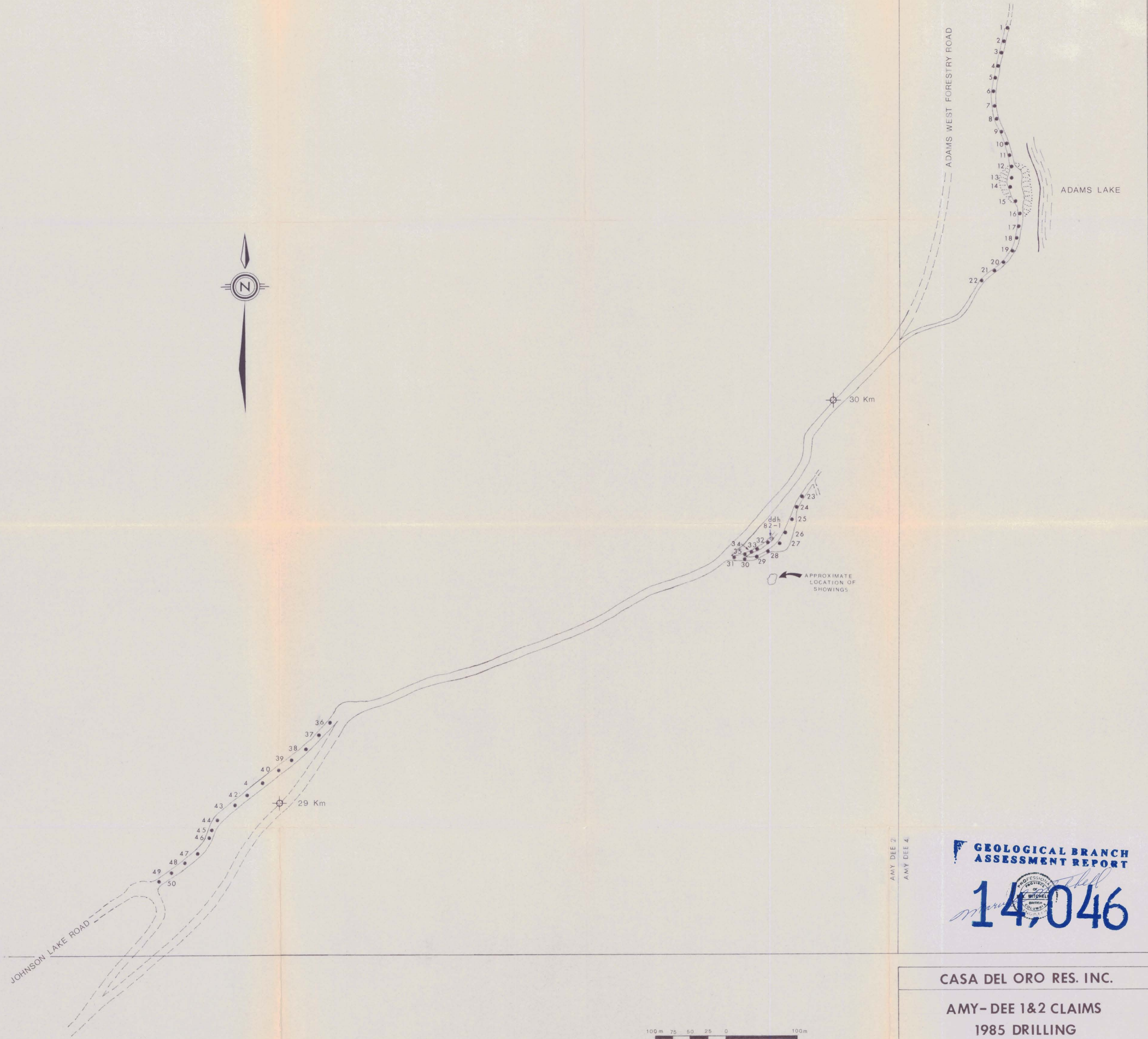

JOHNSON LAKE ROAD

ADAMS WEST FORESTRY ROAD

ADAMS LAKE

30 Km

29 Km

APPROXIMATE LOCATION OF SHOWINGS

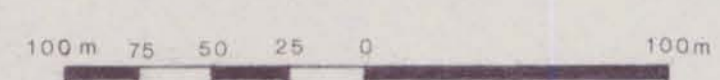

● ROTARY DRILL HOLE
⊙ DIAMOND DRILL HOLE

AMY DEE 2
AMY DEE 4

**GEOLOGICAL BRANCH
ASSESSMENT REPORT**

M. Mitchell

14,046

CASA DEL ORO RES. INC.

AMY-DEE 1&2 CLAIMS

1985 DRILLING

TAPE & COMPASS SURVEY

Scale 1:2500 NOV '85 MAM

Fig 3.