

85-935-14122
11/86

GEOLOGICAL AND GEOCHEMICAL REPORT

ON THE

SA CLAIM

HEDLEY CAMP

SIMILKAMEEN MINING DIVISION

92 H/8E

(49° 20' N. Lat., 120° 10' W. Long)

FOR

TENORE OIL AND GAS LTD.

Suite 1550-609 Granville Street

Vancouver, B. C.

(Owner and Operator)

BY

**GEOLOGICAL BRANCH
ASSESSMENT REPORT**

**FRANK COOPER, B.Sc., FGAC
GEOLOGIST**

14,122
DECEMBER 1985

TABLE OF CONTENTS

	<u>PAGE</u>
INTRODUCTION	1
General	1
Location and Access	1
Physiography	1
Property and Claim Status	2
Area and Property History	2
EXPLORATION PROCEDURE	3
GEOLOGY	4
Regional Geology	4
Claim Geology	4
GEOCHEMISTRY	5
Gold	5
Silver	5
CONCLUSIONS AND RECOMMENDATIONS	6
REFERENCES	7
CERTIFICATE OF QUALIFICATIONS	8
APPENDICES	
Certificates of Analysis	
Detailed Cost Statement	

ILLUSTRATIONS

<u>Figure</u>		<u>Page</u>
1	Location Map	Follows Page 1
2	Claim Map Scale 1:50,000	Follows Page 1
3	Geology Scale 1:5,000	Pocket
4	Au, Ag - Geochemistry Scale 1:2,500	Follows Page 5

INTRODUCTION

General

Field work was carried out on the property by Grant Crooker, Geologist, and Lee Mollison, Assistant, from November 1st through November 4th, 1985.

Geological mapping, prospecting, and geochemical soil sampling were carried out over an anomalous area delineated by 1983 and 1984 soil sampling programs.

Location and Access

The property (Figure 1) is located 7 kilometers southwest of Hedley, B. C. The claim lies at $49^{\circ} 21'$ N. latitude and $120^{\circ} 10'$ W. longitude.

Access is via the Sterling Creek Logging Road which turns off Highway 3, 7 kilometers west of Hedley near the Sterling Creek Bridge. This is a good gravel road, which leads approximately 5 kilometers to the claim.

Physiography

The property is located in the Thompson Plateau of the Similkameen region of British Columbia. Topography is steep, with elevation varying from 900 meters to 1,490 meters above sea level. The property slopes into Pettigrew Creek, which bisects the claim.

Forest cover is mainly pine and fir with occasional spruce.

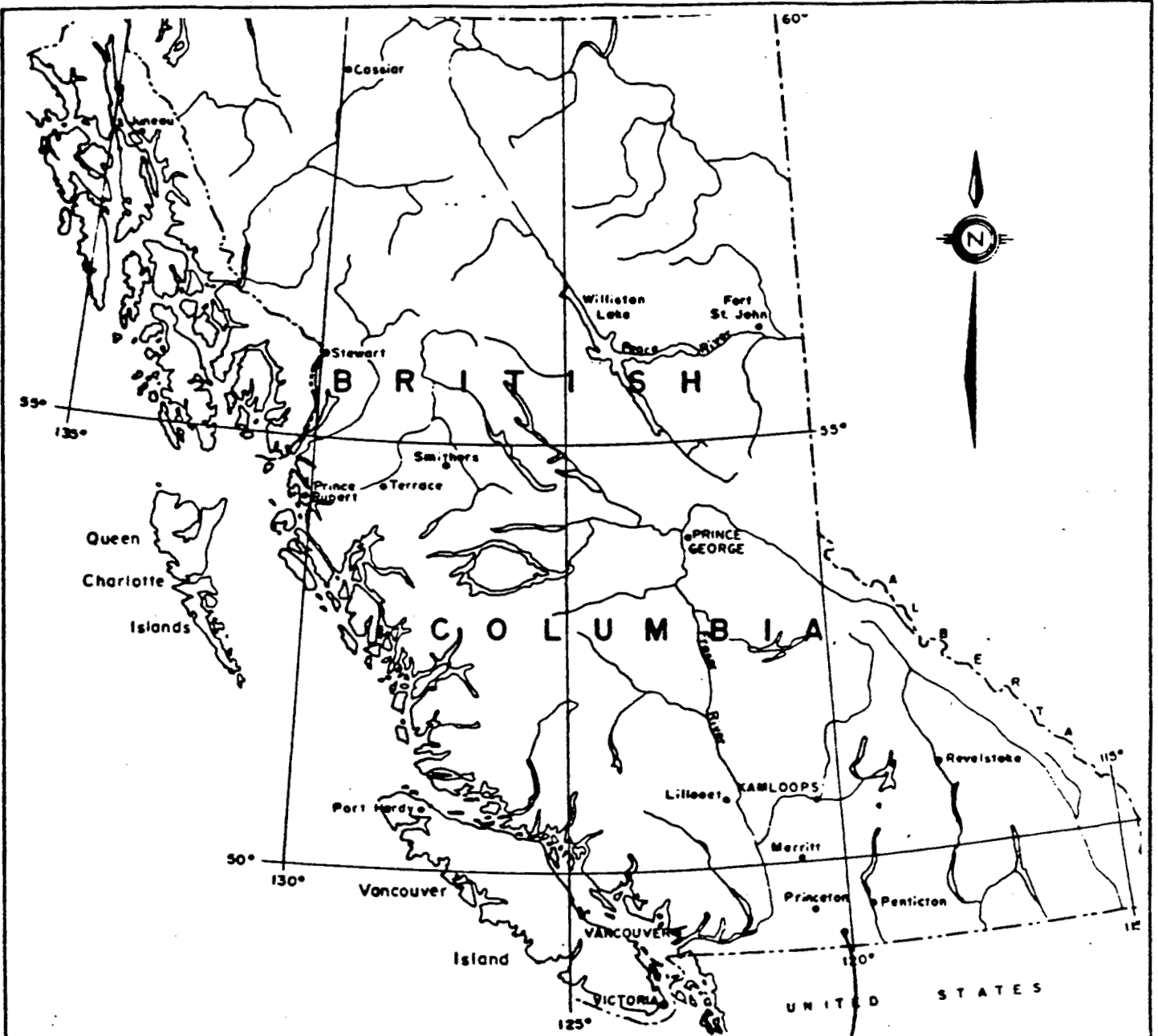

TENORE OIL AND GAS LTD
SA CLAIM

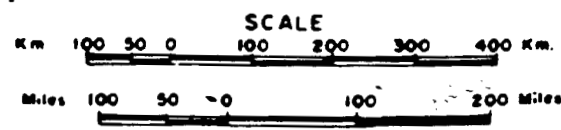

H. C. Crooker

VANCOUVER, B.C.	
TENORE OIL AND GAS LTD	
SA CLAIM	
LOCATION MAP	
DRAWN BY: G. CROOKER	N.T.S. : 92H/8E
DATE: DEC. 1985	FIGURE NO. 1

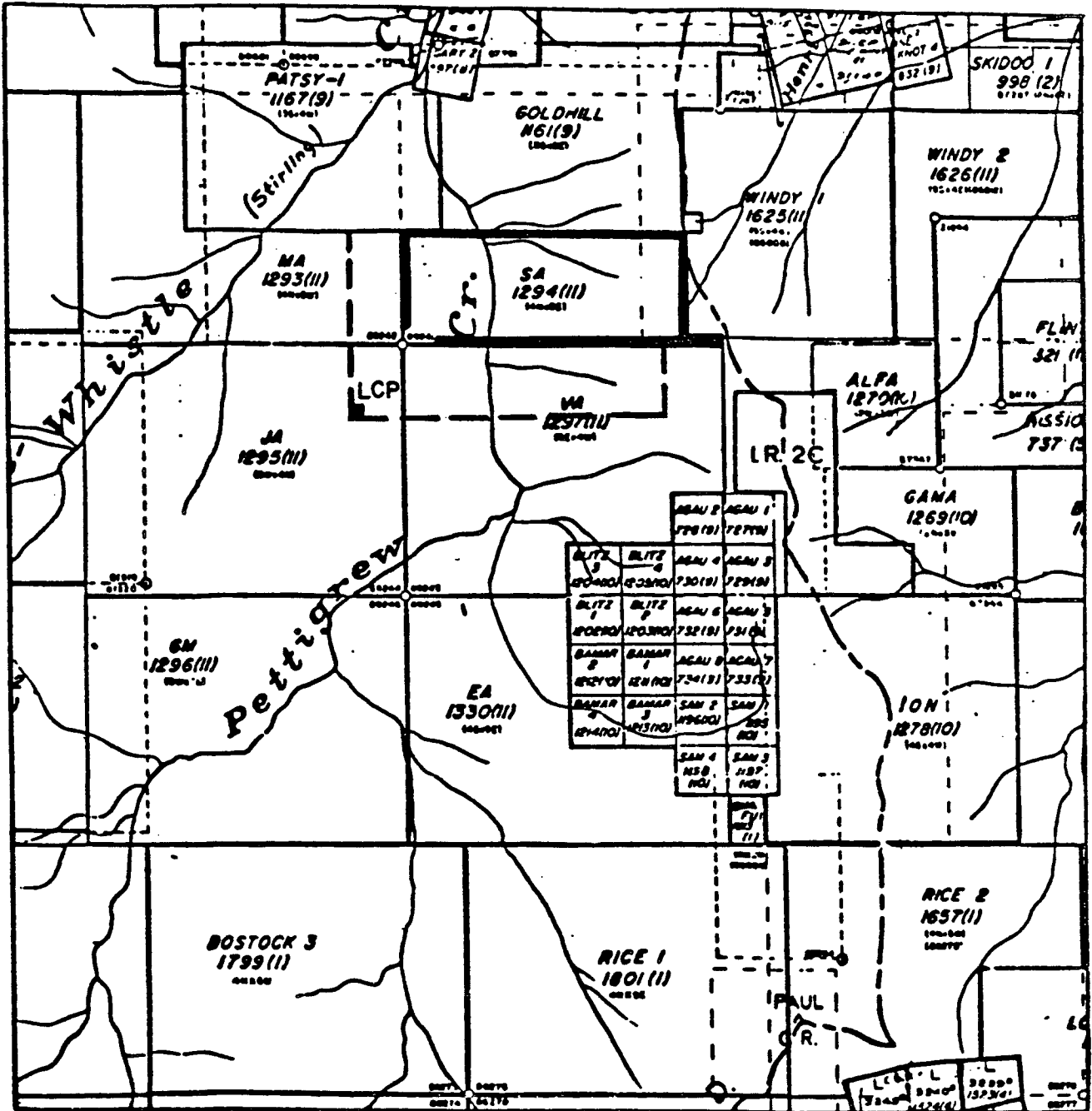

TRUE CLAIM LOCATION

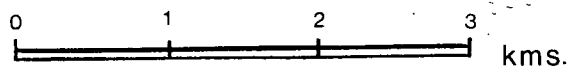

scale

H. Crocker

VANCOUVER, B.C.

TENORE OIL AND GAS LTD

SA CLAIM
CLAIM MAP

DRAWN BY: G. CROOKER

N.T.S. : 92H/8E

DATE: DEC. 1985

FIGURE N^o. 2

Vegetation ranges from mature forest to open, grassy sidehills.

Property and Claim Status

The SA mineral claim (Figure 2) is located in the Similkameen Mining Division and consists of 20 units. The claim extends 4 units north and 5 units east from the legal corner post.

The owner is Tenore Oil and Gas Limited, Suite 1550, 609 Granville Street, Vancouver, B. C.

<u>Claim</u>	<u>Units</u>	<u>Record No.</u>	<u>Record Date</u>
SA Claim	20	1294(11)	November 21, 1980

Upon acceptance of this report the claim will be in good standing until November 21, 1986.

Area and Property History

The Hedley area has been a gold producer intermittently since the late 1800's. The Nickel Plate Mine produced over 1 million ounces of gold up to 1955. Renewed exploration activity by Mascot Gold Mines on the Nickel Plate property has outlined 3.85 million tons of ore grading 0.152 Oz/ton gold, with a 0.05 oz/ton gold cutoff. This ore will be mined by open pit methods.

Banbury Gold Mines owns the Gold Mountain property 4 kilometers northeast of the SA claim. Banbury has outlined some ore reserves.

A number of Crown Grants located 2 to 3 kilometers north of the SA claim have small showings on them. Steeply dipping and folded tuffs, argillites and calcareous argillites have been intruded by irregular bodies of diorite. As well the argillites have been fractured and narrow quartz

and calcite stringers with pyrite, arsenopyrite, sphalerite, galena and chalcopyrite occur. While only narrow widths have been found, samples have assayed up to 0.50 oz/ton gold.

Previous work on the SA claim includes geochemical surveys. These surveys indicated scattered anomalous arsenic, lead, zinc, copper and molybdenum values in the northeast corner of the claim. Additional soil sample lines were ran in the area to try and further delineate the anomalous zones.

EXPLORATION PROCEDURE

The 1985 program consisted of establishing a grid and carrying out geological mapping, prospecting and soil sampling.

The grid established for the previous geochemical surveys was located, and used to establish the grid lines for the 1985 program. Three lines (7+13N, 7+87N, 8+62N) were ran from 19+50E to 12+25E. In addition, lines 7+50N and 8+25N were extended from 15+00E to 12+25E. A total of 2.7 kilometers of grid was established, with stations established at 25 meter intervals.

Geochemical soil sampling (109 samples) was carried out over the grid (Figure 4). Samples were taken along each line at 25 meter intervals. The soil samples were taken at a depth of 10 - 15 centimeters in the brown "B" horizon. The samples were placed in paper geochem bags and sent for analysis for gold and silver. One rock sample was taken and geochemically analyzed for gold, silver, lead and zinc.

All samples were sent to Rossbacher Laboratories Ltd., 2225 South Springer Avenue, Burnaby, B. C. for analysis. Laboratory technique for geochemical analysis consists of preparing samples by drying at 75° C and sieving to minus 40 mesh. Silver, lead and zinc are analyzed by nitric, perchloric digestion while gold is analyzed by aqua-regia digestion. Concentrations of elements are determined by atomic absorption. The geochemical results were plotted at a scale of 1:2500 on Figure 4.

Geological mapping and prospecting were carried out over the grid and several other sections of the claim. The results were plotted at a scale of 1:5000 on Figure 3.

GEOLOGY

Regional Geology

The SA Claim is underlain by the Upper Triassic Nicola group. This group covers a large portion of the Princeton area, extending from the United States border north to Merritt. The unit is mainly a succession of lavas with irregular distributions of tuffaceous and argillaceous rock, along with minor limestone. In the Hedley area the sedimentary strata are relatively free of volcanic debris.

Claim Geology

The SA Claim is underlain by argillites, tuffaceous argillites and tuffs of the Nicola group. Unit 1 is a fine grained, usually black argillite. Unit 2 is a light to dark green fine grained tuff, occasionally becoming an argillaceous tuff. One outcrop of lapilli tuff was observed along line 8+62N and 16+50E.

The argillite has a northerly strike and dips steeply to the east. Prominent jointing is observed in many outcrops.

Limestone float was observed along line 8+62N between 19+00E and 19+50E.

Along L8+62N and 12+50E a number of fractures with calcite were observed. The fractures strike N 45° E and dip 46° southeast. Other fractures were noted near 12+50E along the other lines, but no mineralization was seen in them.

Several narrow quartz-carbonate veinlets with pyrite were observed along the road at the north end of the claim. One sample was taken here but it returned only 10 ppb gold, 0.6 ppm silver, 4 ppm lead and 66 ppm zinc.

Pyrite was noted at a number of locations in the argillite and tuff.

GEOCHEMISTRY

Gold

All gold values were 10 ppb which is a background value.

Silver

The background value for silver was calculated to be 0.26 ppm. Possibly anomalous values are 0.8 ppm and greater.

Three values at 7+50N and 13+00E, 7+87N and 19+25E, and 8+62N and 12+50E were possibly anomalous. The values along all lines from 18+75E to 19+50E were above background, although not highly anomalous. This area

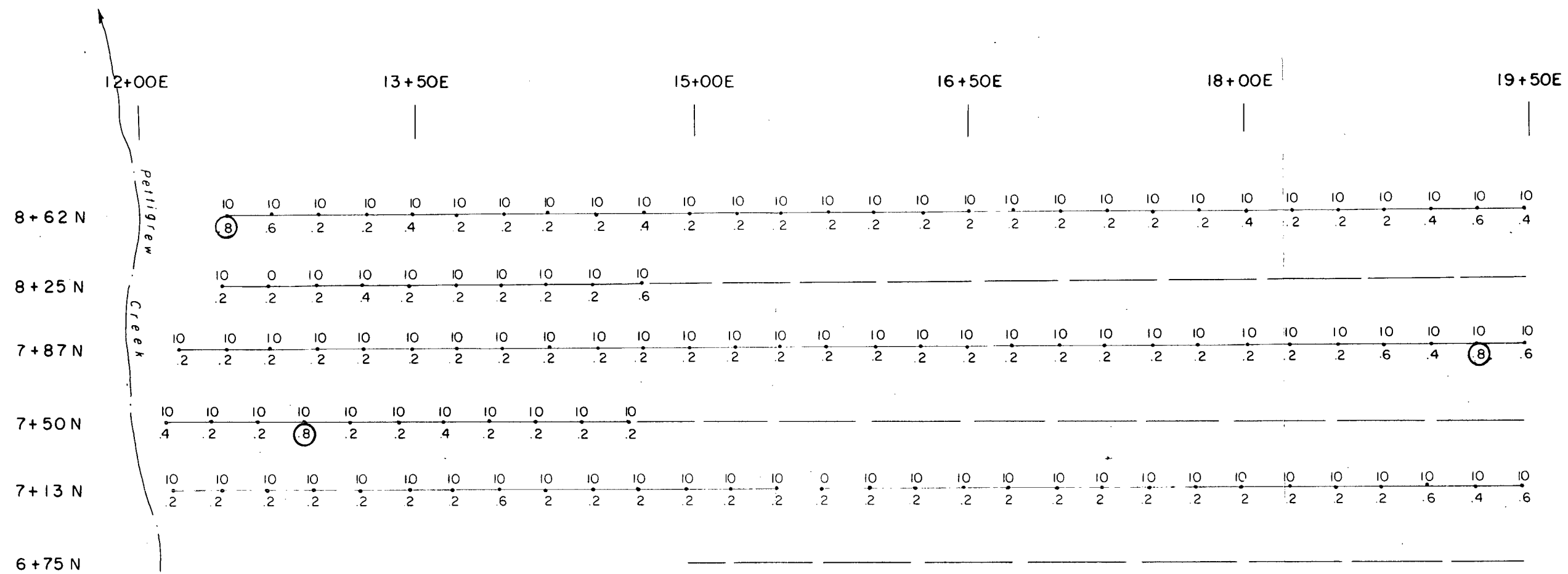

LEGEND

- 1985 GRID
- 1984 GRID
- | | | |
|----|-------------|---------|
| 10 | SOIL SAMPLE | Au, ppb |
| 6 | | Ag, ppm |
- ← CREEK



Grant Crooker

TENORE OIL AND GAS LTD.

SA CLAIM

Au, Ag - GEOCHEMISTRY

SIMILKAMEEN M.D., B.C.

SCALE 1: 2500



WORK BY: GRANT CROOKER, GEOLOGIST

DRAWN BY: G. CROOKER N.T.S. 92H - 8E

DATE: DEC. 1985 FIGURE NO. 4

should be investigated further.

CONCLUSIONS AND RECOMMENDATIONS

The SA claim is underlain by argillites and tuffs of the Upper Triassic Nicola group.

The soil geochem survey did not indicate any anomalous gold values, but three possibly anomalous silver values of 0.8 ppm were returned. In addition, the area along lines 8+62N, 7+87N and 7+13N from 18+75E to 19+50E consistently gave geochem values above background although not anomalous. Several anomalous geochem values were also obtained here in previous geochem surveys.

Several narrow quartz-carbonate veinlets with pyrite were found along the road at the north end of the claim. One sample taken did not return anomalous gold, silver, lead or zinc values, but the area should have additional prospecting carried out on it.

Several areas on the claim deserve additional examination. Recommendations are to geologically map and prospect the claims, concentrating on the areas of quartz-carbonate veinlets along the road, and the area of above background silver values along the east side of the grid.

Respectfully submitted,

Grant Crooker, B.Sc., FGAC
Geologist

REFERENCES

Cavey, G. and Helgason, R. (Jan. 1984) - Geochemical Report on the SA Claims for Tenore Oil and Gas Limited.

Helgason, R. (Aug. 1984) - Geochemical Report on the SA Claims for Tenore Oil and Gas Limited.

Rice, HMA (1947) - G.S.C. Memoir 243, Geology and Mineral Deposits of the Princeton Area.

CERTIFICATE OF QUALIFICATIONS

I, Grant F. Crooker, of Upper Bench Road, Keremeos, in the Province of British Columbia, hereby certify as follows:

- 1) That I graduated from the University of British Columbia in 1972 with a Bachelor of Science Degree in Geology.
- 2) That I have prospected and actively pursued geology prior to my graduation and have practised my profession since 1972.
- 3) That I am a member of the Canadian Institute of Mining and Metallurgy.
- 4) That I am a Fellow of the Geological Association of Canada.
- 5) That I have no direct or indirect interest in the property.

Dated this 10th day of Dec. , 1985, at Vancouver, in the Province of British Columbia.

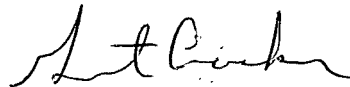

Grant F. Crooker, B.Sc., F.G.A.C.
Geologist

ROSSBACHER LABORATORY LTD.

2225 S. SPRINGER AVENUE
BURNABY, B.C. V5B 3N1
TEL : (604) 299 - 6910



CERTIFICATE OF ANALYSIS

TO : GRANT CROOKER
P.O. BOX 234
KEREMEOS B.C.
PROJECT: TENORE OIL & GAS
TYPE OF ANALYSIS: GEOCHEMICAL

CERTIFICATE#: 85489
INVOICE#: 6127
DATE ENTERED: 85-11-25
FILE NAME: GC85489
PAGE # : 1

PRE FIX	SAMPLE NAME	PPM Ag	PPM Zn	PPM Pb	PPB Au
A	SA-001	0.6	66	4	10

CERTIFIED BY :

[Handwritten signature]

ROSSBACHER LABORATORY LTD.

2225 S. SPRINGER AVENUE
 BURNABY, B.C. V5B 3N1
 TEL : (604) 299 - 6910

CERTIFICATE OF ANALYSIS

GRANT CROOKER
 P.O. BOX 234
 KEREMEOS B.C.
 PROJECT: TENORE OIL & GAS
 TYPE OF ANALYSIS: GEOCHEMICAL

CERTIFICATE#: 85484
 INVOICE#: 6123
 DATE ENTERED: 85-11-25
 FILE NAME: GC85484
 PAGE # : 1

PRE FIX	SAMPLE NAME	-40M	PPM Ag	PPB Au
S	7+13N 12+50E	X	0.2	10
S	12+75E	X	0.2	10
S	13+00E	X	0.2	10
S	13+25E		0.2	10
S	13+50E		0.2	10
S	13+75E		0.2	10
S	14+00E		0.6	10
S	14+25E		0.2	10
S	14+50E	X	0.2	10
S	7+13N 14+75E		0.2	10
S	15+00E		0.2	10
S	15+25E		0.2	10
S	15+50E		0.2	10
S	15+75E		0.2	10
S	16+00E		0.2	10
S	16+25E	X	0.2	10
S	16+50E	X	0.2	10
S	16+75E		0.2	10
S	17+00E		0.2	10
S	7+13N 17+25E		0.2	10
S	17+50E		0.2	10
S	17+75E		0.2	10
S	18+00E	X	0.2	10
S	18+25E		0.2	10
S	18+50E		0.2	10
S	18+75E		0.2	10
S	19+00E		0.6	10
S	19+25E		0.4	10
S	7+13N 19+50E	X	0.6	10
S	7+50N 12+25E		0.4	10
S	12+50E		0.2	10
S	12+75E		0.2	10
S	13+00E		0.8	10
S	13+25E		0.2	10
S	13+50E		0.2	10
S	13+75E		0.4	10
S	14+00E		0.2	10
S	14+25E		0.2	10
S	14+50E		0.2	10
S	7+50N 14+75E	X	0.2	10

CERTIFIED BY :

[Handwritten Signature]

ROSSBACHER LABORATORY LTD.

2225 S. SPRINGER AVENUE
 BURNABY, B.C. V5B 3N1
 TEL: (604) 299-6910

CERTIFICATE OF ANALYSIS

PROJECT: GRANT CROOKER
 P.O. BOX 234
 KEREMEOS B.C.
 TYPE OF ANALYSIS: GEOCHEMICAL

CERTIFICATE#: 85484
 INVOICE#: 6123
 DATE ENTERED: 85-11-25
 FILE NAME: GC85484
 PAGE #: 2

PRE FIX	SAMPLE NAME	-40M	PPM Ag	PPB Au
S	7+87N 12+25E	X	0.2	10
S	12+50E		0.2	10
S	12+75E		0.2	10
S	13+00E		0.2	10
S	13+25E		0.2	10
S	13+50E	X	0.2	10
S	13+75E		0.2	10
S	14+00E		0.2	10
S	14+25E		0.2	10
S	7+87N 14+50E	X	0.2	10
S	14+75E		0.2	10
S	15+00E		0.2	10
S	15+25E		0.2	10
S	15+50E		0.2	10
S	15+75E		0.2	10
S	16+00E		0.2	10
S	16+25E		0.2	10
S	16+50E		0.2	10
S	16+75E		0.2	10
S	7+87N 17+00E		0.2	10
S	17+25E		0.2	10
S	17+50E		0.2	10
S	17+75E		0.2	10
S	18+00E		0.2	10
S	18+25E		0.6	10
S	18+75E	X	0.4	10
S	19+00E		0.8	10
S	19+25E		0.6	10
S	7+87N 19+50E		0.2	10
S	8+25N 12+50E	X	0.2	10
S	12+75E		0.2	10
S	13+00E		0.4	10
S	13+25E		0.2	10
S	13+50E		0.2	10
S	13+75E		0.2	10
S	14+00E		0.2	10
S	14+25E	X	0.2	10
S	14+50E	X	0.6	10
S	8+25N 14+75E	X	0.8	10
S	8+62N 12+50E			

CERTIFIED BY :

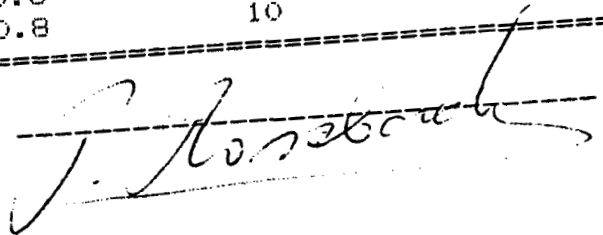

ROSSBACHER LABORATORY LTD.

2225 S. SPRINGER AVENUE
 BURNABY, B.C. V5B 3N1
 TEL : (604) 299 - 6910

CERTIFICATE OF ANALYSIS

TO : GRANT CROOKER
 P.O. BOX 234
 KEREMEOS B.C.
 PROJECT: TENORE OIL & GAS
 TYPE OF ANALYSIS: GEOCHEMICAL

CERTIFICATE#: 85484
 INVOICE#: 6123
 DATE ENTERED: 85-11-25
 FILE NAME: GC85484
 PAGE # : 3

PRE FIX	SAMPLE NAME	-40M	PPM Ag	PPB Au
S	8+62N 12+75E		0.6	10
S	13+00E		0.2	10
S	13+25E		0.2	10
S	13+50E	X	0.4	10
S	13+75E		0.2	10
S	14+00E		0.2	10
S	14+25E		0.2	10
S	14+50E		0.2	10
S	14+75E		0.4	10
S	8+62N 15+00E		0.2	10
S	15+25E		0.2	10
S	15+50E		0.2	10
S	15+75E		0.2	10
S	16+00E		0.2	10
S	16+25E		0.2	10
S	16+50E		0.2	10
S	16+75E		0.2	10
S	17+00E		0.2	10
S	17+25E		0.2	10
S	8+62N 17+50E	X	0.2	10
S	17+75E		0.2	10
S	18+00E	X	0.4	10
S	18+25E		0.2	10
S	18+50E		0.2	10
S	18+75E		0.2	10
S	19+00E		0.4	10
S	19+25E		0.6	10
S	8+62N 19+50E		0.4	10
S	8+75N 18+50E		0.2	10

CERTIFIED BY :

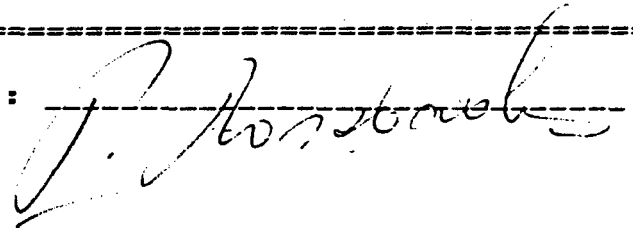

DETAILED COST STATEMENTWages

1 Geologist, G. Crooker 7 1/2 days @ \$300.00/day November 1-5,9,12,13, 1985	\$ 2,250.00
--	-------------

1 Geological Assistant, Lee Mollison 4 days @ \$150.00/day November 1 - 4, 1985	600.00
---	--------

Accommodation

1 Geologist, 4 days @ \$30.00/day November 1 - 4, 1985	120.00
---	--------

1 Assistant, 4 days @ \$30.00/day November 1 - 4, 1985	120.00
---	--------

Meals

1 Geologist, 4 days @ \$30.00/day November 1 - 4, 1985	120.00
---	--------

1 Assistant, 4 days @ \$30.00/day November 1 - 4, 1985	120.00
---	--------

Transportation

Vehicle Rental (Ford 3/4 ton, 4 x 4) 4 days @ \$50.00/day	200.00
--	--------

Gasoline	92.75
----------	-------

Supplies

Hip Chain Thread, Flagging, Geochem bags, etc.	50.00
--	-------

Freight

	11.99
--	-------

Analysis

109 soil samples (Au, Ag) @ \$5.85	637.65
1 rock (Au, Ag, Pb, Zn) @ \$8.70	8.70

Preparation of Report

Secretarial, draughting, reproduction, etc.	<u>500.00</u>
---	---------------

Total	\$4,831.09
-------	------------

LEGEND

- 2 Tuff, argillaceous tuff
- 1 Argillite
- Outcrop
- ↘²⁰ Fractures calcite or quartz veinlets - inclined
- ↘⁴⁰ Bedding - inclined
- ↘³⁰ Jointing - "
- py Pyrite
- 1985 grid
- - - 1984 "
- Legal corner post
- == Road
- ↔ Creek

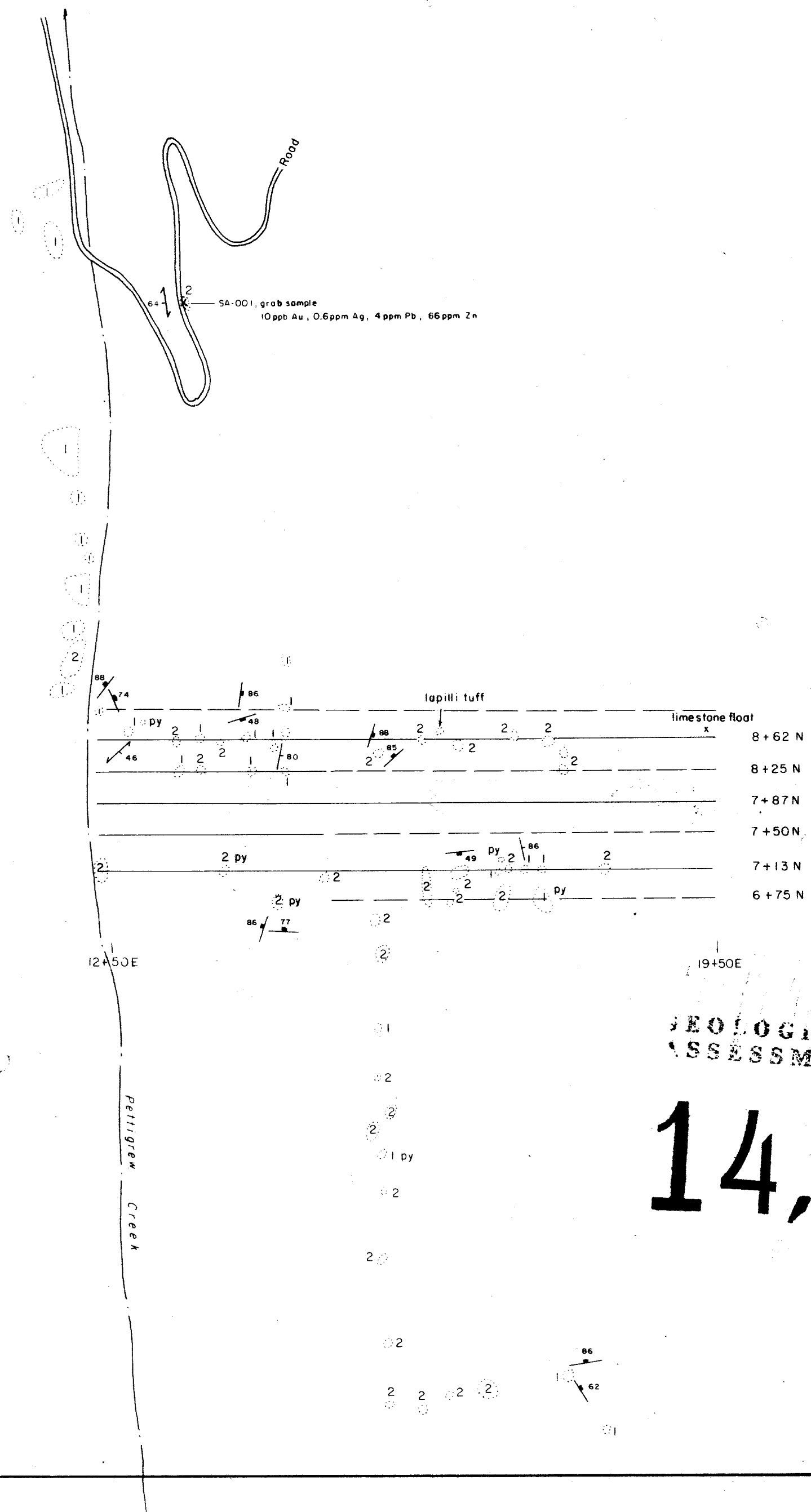

SA-001, grab sample
10ppb Au, 0.6ppm Ag, 4ppm Pb, 66ppm Zn

**GEOLOGICAL BRANCH
ASSESSMENT REPORT**

14,122

SA CLAIM
L.C.P. 4N, 5E

TENORE OIL AND GAS LTD.	
SA CLAIM GEOLOGY	
SIMILKAMEEN M.D., B.C.	
SCALE 1:5000	
0 100 200 300metres	
WORK BY: GRANT CROOKER, GEOLOGIST	
DRAWN BY: G. CROOKER	NTS. 92H-8E
DATE: DEC. 1985	FIGURE N ^o . 3

Grant Crooker