

B.E. Spencer Engineering Ltd.

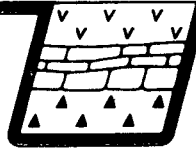

CONSULTING GEOLOGICAL ENGINEER

9/86

REPORT
ON
DIAMOND DRILLING PROGRAMME
HANNA 9 M. C.

LIARD MINING DISTRICT, N.T.S. 104 P/5E

FOR
TAURUS RESOURCES LTD.

BY
B. E. SPENCER, P. ENG.
B. E. SPENCER ENGINEERING LTD.

GEOLOGICAL BRANCH
ASSESSMENT REPORT

14,127

NOVEMBER 14, 1985

TABLE OF CONTENTS

	<u>Page</u>
INTRODUCTION	1
DISCUSSION OF RESULTS	1
INDEX MAP	Following Page 1
DRILL HOLE LOCATION MAP	Following Index Map
STATEMENT OF QUALIFICATIONS	4
APPENDIX I - COST STATEMENT	Following Page 4
APPENDIX II - DRILL LOGS	Following Appendix I

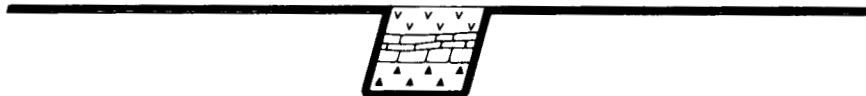

INTRODUCTION

The Hanna 9 M.C. is located 8 kilometres northeast of Cassiar, British Columbia and a branch road from Highway 37 to Cassiar crosses the southern boundary of the claim. Gravel roads extend north to the Snowy Creek area and provide good access to the portion of the claims explored in 1985.

The claim is owned by Mr. M. Cooper of Calgary, Alberta and is under option to Taurus Resources Ltd. Previous trenching on the claim exposed two parallel quartz veins on the slopes northeast of Snowy Creek. The veins are 0.5 to 1 metre in thickness and strike N 60° E with vertical to steep southerly dips. Considerable oxidized pyrite occurs within the veins as well as in the adjacent altered greenstones. Surface samples from the oxidized sections of the veins assayed up to 0.3 oz. Au per ton and four BQ wireline diamond drill holes totalling 417.8 metres were drilled to evaluate the veins at depth.

DISCUSSION OF RESULTS

Diamond drill hole 85-3/-45° was collared near the southwest edge of the surface exposure of the No. 1 vein and intersected quartz veinlets within a broader alteration zone from 120.0 to 144.5 feet. The main vein section from 125.5 - 130.0 assayed .04 oz. Au per ton.

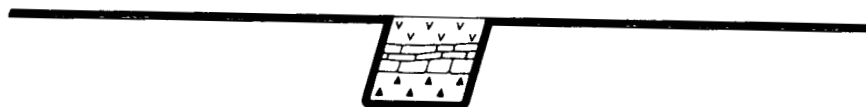

Quartzrock

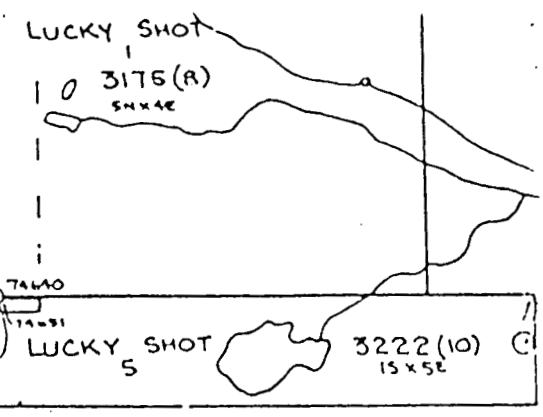

TAURUS RESOURCES LTD.

Index Map
Hanna 9 M. C.

Liard M.D.

N.T.S. 104P/5E

Scale 1:3571

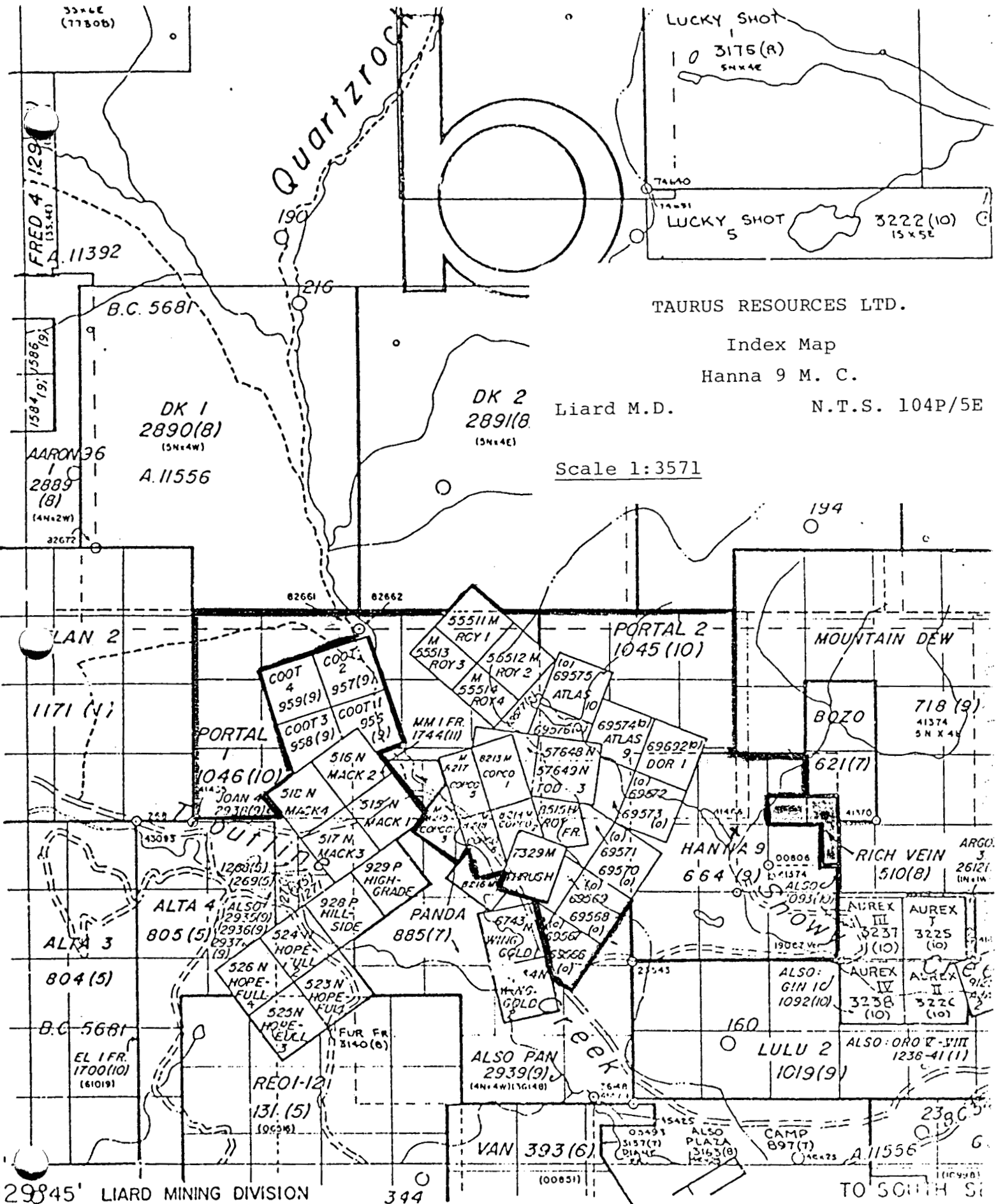

Mining Division Boundary
Indian Reservation
Mineral and Placer Reserve
Ecclesiastical

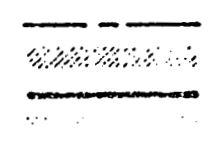

Crown Granted
Reverted C.G. Mineral Claim
Forfeited Mineral Claim
Unsold Legal Claims

CG
CC
C
V

MIN
DEPAR

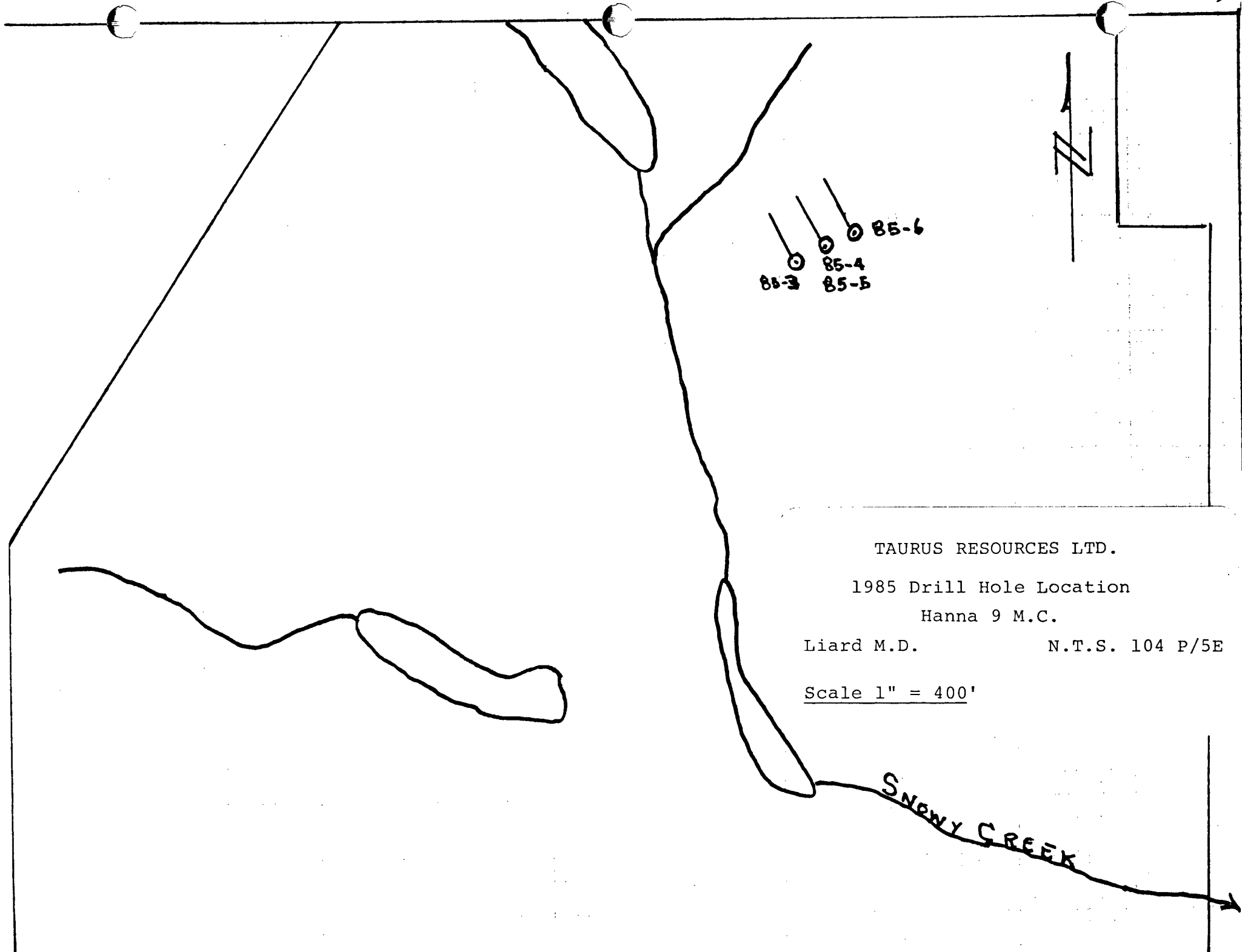

TAURUS RESOURCES LTD.

1985 Drill Hole Location

Hanna 9 M.C.

Liard M.D.

N.T.S. 104 P/5E

Scale 1" = 400'

SNOWY CREEK

Drill holes 85-4 and 85-5 were collared 105 feet to the northeast and drilled at -45° and -60° , respectively. The No. 1 vein and adjacent alteration zone was intersected between 99.7 and 109.4 feet in 85-4 and assayed .087 oz. Au per ton across this 9.7 foot section. Hole 85-5 cut this vein 50 feet below the hole 85-4 intersection and assayed .034 oz. Au per ton across an 8.3 foot intersection. A second vein intersected by these holes assayed .149 oz. Au per ton over a 2 foot intersection in hole 85-4 and .030 oz. Au per ton over a 2.2 foot intersection in hole 85-5 which cut the vein 25 feet below the 85-4 intersection.

Hole 85-6 was collared 100 feet northeast of 85-5 and drilled at -45° . This hole cut the No. 1 vein from 176.5 to 178.9 feet and assayed .113 oz. Au per ton. A section from 173 - 180.9 assayed .053 oz. Au per ton.

In summary, drill holes 85-4 to 85-6 tested the veins exposed by trenching over a 200 foot strike length to a depth of 120 feet below surface. Gold values in the veins are too low grade to be of any interest and no further work is recommended at this time.



Drill core from this programme is stored at the nearby Taurus Resources Ltd. mine-mill site.



B. E. Spencer, P. Eng.

BES:lm

November 14, 1985

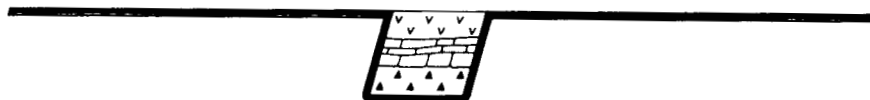

STATEMENT OF QUALIFICATIONS

I, Bruce Everton Spencer, of the City of Vancouver, in the Province of British Columbia hereby certify as follows:

- 1) I am a Geological Engineer residing at 7 - 2485 Cornwall Avenue, Vancouver, British Columbia V6K 1B9.
- 2) I am a registered Professional Engineer of the Province of British Columbia.
- 3) I am a graduate of the University of British Columbia with a degree of B.A. Sc. (1958).
- 4) I have practised my profession as a Geologist for more than twenty years.
- 5) The drill core was logged by David Gunning B. Appl. Sc. Mining, who is the resident Mining Engineer for Taurus Resources Ltd. I also inspected the core at the site and consider the drill core to be logged in a professional manner.

Date

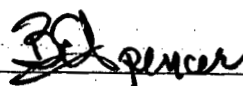
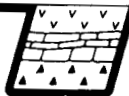
Nov 14, 1985
Bruce Everton Spencer, P. Eng.

APPENDIX I

TAURUS RESOURCES LTD.

COST STATEMENT

DIAMOND DRILLING

HANNA 9 M. C.

Diamond Drilling

- 4 B.Q. Wireline Holes (D.J. Drilling)	\$ 29,000.00
- 417.8 metres (1,371 feet) drilling	
- drilling done during August-September, 1985	

Room & Board for Drill Crews

- 10 days for 4 men @ \$51.00 per man day	2,040.00
---	----------

Cat Rental

- 10 hours @ \$50.00 per hour	500.00
-------------------------------	--------

Fuel for Drill Rig

- 1,364 litres @ .4657 per litre	<u>635.21</u>
----------------------------------	---------------

TOTAL	\$ 32,175.21
-------	--------------

=====

APPENDIX II

DRILL LOGS

DIAMOND DRILL LOG

Property: HANNA 9 M.C.	Core Size: B.Ø.	Location: Not Surveyed
Hole No.: 85-6	Logged by: D. Gunn	Grid: 100' NE of 85-4
Elevation: Not Surveyed.	Bearing: 32.5	Completed:
Depth: 394	Dip: -45	

c.	Feet Meters	Description	Core	Sample	No.	PB	ZN	AG	AU
			Angle	From To					
	0-10	Casing							
	10-394	Greenstone except as noted below.							
	15.5-19	Oxidized breccia zone, some sulphides							.016
	28.4-38.4	Alteration zone with narrow quartz veins		28.4-29.5					.011
				-31.4					.207
				-32.4					.200
				-34.0					.030
				-35.4					.070
				-37.2					TR
				38.4					.058
	173-180.9	Quartz-Alteration Zone							
		Breccia Zone		173-174.6			1.6'		.050
		1.1' Qtz Vein		174.6-176.5			1.9		.024
		20% Py in 1' Qtz Vein		176.5-178.9			2.4		.113
		Breccia Zone		178.9-180.9			2.0		.010
							7.4		

DIAMOND DRILL LOG

Property:	Core Size:	Location:
Hole No.: 85-6 page 2 of 2	Logged by:	Collared:
Elevation:	Bearing:	Completed:
Depth:	Dip:	

c.	Meters	Description	Core	Sample	No.	PB	ZN	AG	AU
			Angle	From To					
	307.2-318	Antkerite		307.2-308.4					.069
		3' Qtz vein		308.4-312.1					.026
		Antkerite		-315.2					.051
		2.5' Qtz vein		-318					.065
	360-363.5	Quartz vein							.012
	366-368.5	Quartz breccia zone							.075
		end of hole.							