

85-102-14239

GEOLOGICAL AND GEOCHEMICAL REPORT

CHRISTMAS #1-#4 MINERAL CLAIMS

CLINTON MINING DIVISION

NTS 92P/15W

LATITUDE 51° 53' N

LONGITUDE 120° 46' W

DATES OF WORK:

Sept 1-Dec 3, 1984

OWNER:

E & B EXPLORATIONS INC.

OPERATOR:

JMT SERVICES CORP.

WRITTEN BY:

GORDON G. RICHARDS, P.Eng.

DATE:

December 3, 1984

FILMED

**GEOLOGICAL BRANCH  
ASSESSMENT REPORT**

**14,239**

## TABLE OF CONTENTS

INTRODUCTION	1
LOCATION AND ACCESS	1
MINERAL CLAIMS	3
GEOLOGY	3
GEOCHEMISTRY	5
CONCLUSIONS AND RECOMMENDATIONS	5
STATEMENT OF COSTS	7
STATEMENT OF QUALIFICATIONS - Gordon G. Richards	8
APPENDIX I - GEOCHEMICAL RESULTS	9

## LIST OF ILLUSTRATIONS

Figure 1	PROPERTY LOCATION MAP	2
Figure 2	MINERAL CLAIMS MAP	4
Figure 3	SAMPLE LOCATION MAP	6

## INTRODUCTION

Field examination of an old Cu-Au occurrence shown on a B.C. Department of Mines mineral inventory map south of Christmas Lake, located several old diamond drill holes in an area of volcanics intruded by quartz diorite. Several rock chips of pyrite-pyrrhotite mineralized hornfels were anomalous for gold with the higher value of 1480 ppb Au. A more thorough second examination yielded results as high as 6290 ppb Au in the same area. None of the rocks and soils were anomalous for arsenic as the highest value was 12 ppm As. Four claims totalling 68 units were staked February 6, 1983.

In the fall of 1983 a grid was completed on part of the hill containing the favorable geology, anomalous gold results and old diamond drill sites. A few reconnaissance traverses were also conducted at this time. In the fall of 1984, additional soils were collected adjacent to areas of anomalous gold geochemistry outlined from the prior study. A total of 60 soil samples were collected. Geological contacts were changed slightly as a result of the present survey but the anomalous gold patterns remained unchanged. More soil sampling and mapping are required prior to a percussion drill program. As the highest gold values are associated with areas of 5-20 percent sulphide, geophysical surveys should be considered prior to drilling.

## LOCATION AND ACCESS

The property is located 6 km northeast of Eagle Creek on the north shore of Canim Lake. Access can be made by paved road from 100 Mile House to Eagle Creek and then by 6 km of good gravel road to Christmas Lake. Secondary dirt roads provide access throughout much of the property.

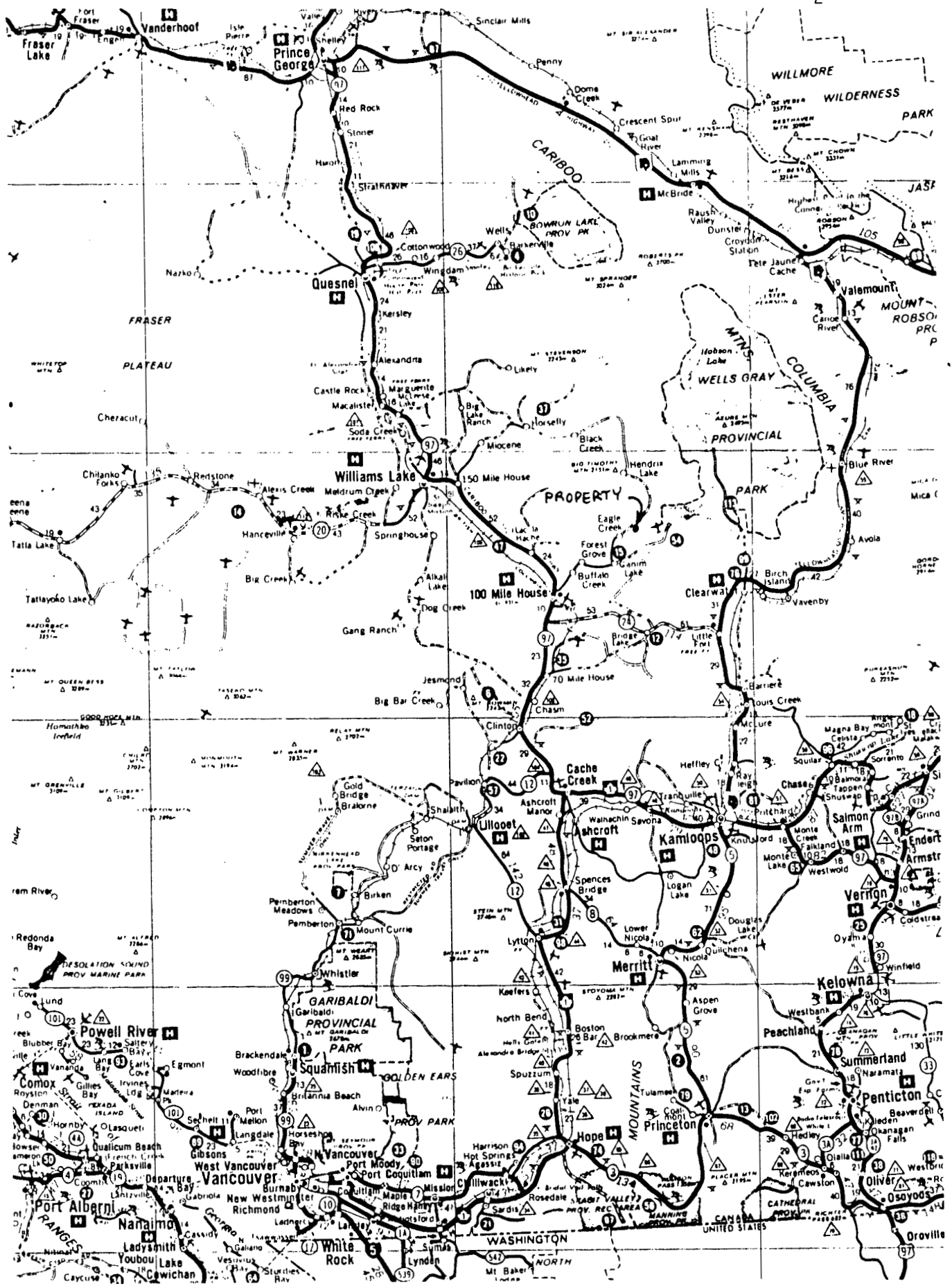

FIGURE 1. PROPERTY LOCATION MAP

JMT SERVICES CORP.

## MINERAL CLAIMS

The property consists of the four LCP claims listed below:

Name	Units	Record No.	Record Date	Owner
CHRISTMAS #1	20	1352(2)	Feb. 25/83	E & B EXPLORATIONS INC.
CHRISTMAS #2*	20	1353(2)	Feb. 25/83	E & B EXPLORATIONS INC.
CHRISTMAS #3	12	1354(2)	Feb. 25/83	E & B EXPLORATIONS INC.
CHRISTMAS #4	16	1355(2)	Feb. 25/83	E 6 B EXPLORATIONS INC.

## GEOLOGY

The following summary is based on 1983 field work. Green andesites, tuffs and sediments are intruded by a diorite plug of unknown dimension. The intrusion outcrops on the hill south of the Legal Corner Post and appears to have been only partially unroofed as abundant xenoliths and roof pendants seem to occur within the intrusion. A numerous hornfels aureole extends outwards up to one or two kilometers from diorite outcrops. Sulphide content consisting of pyrite and pyrrhotite is generally less than one or two percent but local zones of two to ten percent sulphide do occur. High gold values described below have been obtained from these local high-sulphide hornfels areas. Disseminated chalcopyrite with pyrite and pyrrhotite was noted in an old trench about 300 m southeast of the Legal Corner Post, near Z1689. Old workings are evident on the property including dumped A-size diamond drill core, numerous tractor trenches and roads, and an I.P. survey on the flat ground to the east. This work is believed to be at least ten years old. The most recent previous staking recognized in the field was in 1971. The B.C. Department of Mines mineral inventory map shows a Cu-Au occurrence on the property near the area of the old workings. Strong carbonate alteration with up to three percent pyrite occurs in a 100 m wide zone along the main road north of Christmas Lake. Its attitude is unknown.

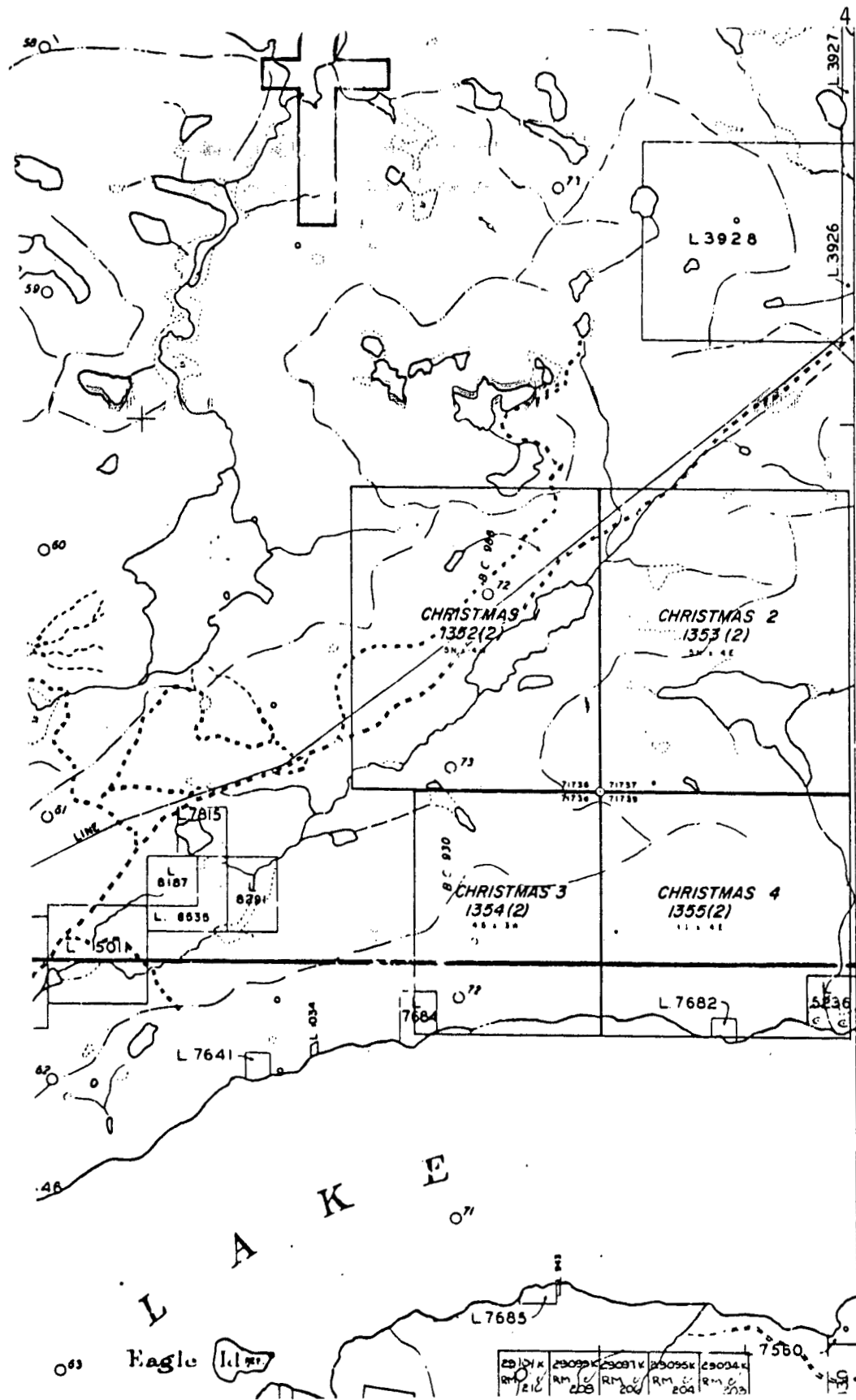

FIGURE 2: CLAIM MAP

JMT SERVICES CORP.

The 1984 survey changed the position of geologic contacts between the diorite and volcanics and sediments as shown on Figure 3, near the R-series samples. A trench was also found in this area near R-1129.

#### GEOCHEMISTRY

The geochemical sampling described in this report was undertaken to extend two areas of high Au geochemistry in soils described in the March 9, 1984 report. The sample locations and results are shown on Figure 3. Soil samples were collected from the B Horizon with metal scoops. Gold analyses were done on the minus 80 mesh fraction by Chemex Labs Ltd., 212 Brooksbank Avenue, North Vancouver, B.C., using Neutron Activation Analysis.

Results of the R-series soil sample area were all less than 10 ppb Au except for R-1134, R-1135 and R-1138 (15, 13, and 14 ppb Au respectively). Results of the D-series soil sample area were much more anomalous for gold and fit the >10 ppb Au pattern described in the March 9, 1984 report and Figure 3.

#### CONCLUSIONS AND RECOMMENDATIONS

Andesite flows, dykes, tuffs and sediments have been intruded by a diorite complex of unknown dimensions. Hornfelsing with associated 1-15 percent pyrite-pyrrhotite mineralization occurs up to at least 500 m from the intrusive contact. Soils were collected to determine the extent of previously identified patterns at geochemically anomalous gold in soils. Results indicate the largest zone of anomalous gold is still open to the north and west. Additional soil samples should be collected to limit the extent of this zone and other gold zones, prior to trenching and/or drilling.

Respectfully submitted,  
  
Gordon G. Richards, P.Eng.

FIGURE 3: SAMPLE LOCATION MAP

JMT SERVICES CORP.



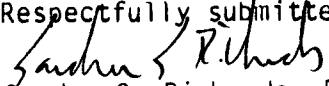
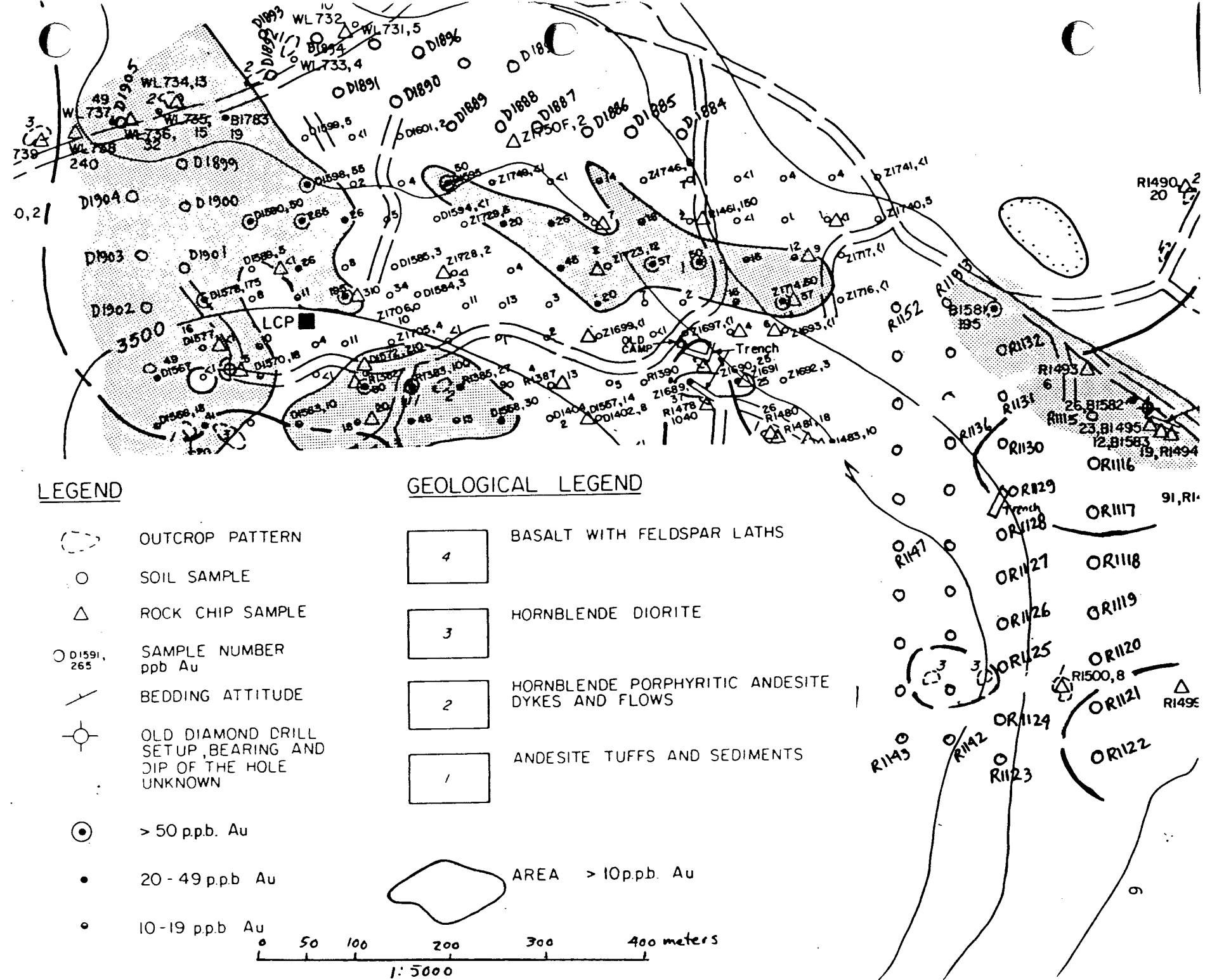

## STATEMENT OF COSTS

## TIME

G. Richards	Oct (1/2)2, 3	1-1/2 days @ \$250.	375.00
D. Bennett	Oct (1/2)2, 3	1-1/2 days @ \$200.	300.00
Truck: 150 km @ .18/km + 2 days @ \$40/day			107.00

## DISBURSEMENTS

G. Richards expenses - share	\$ 60.00 + 10%	66.00
Chemex Labs, I8417731	\$417.00 + 10%	458.70
Hudson Building Supplies	\$ 15.00 + 10%	16.50
Report		<u>200.00</u>

\$1,523.20

## STATEMENT OF QUALIFICATIONS

I, Gordon G. Richards, of Vancouver, British Columbia, do hereby certify that:

1. I am a Professional Engineer of the Province of British Columbia, residing at 6195 Lynas Lane, Richmond, B.C., V7C 3K8.
2. I am a graduate of the University of British Columbia, B.A.Sc., 1968, M.A.Sc. 1974.
3. I have practised my profession as a mining exploration geologist continuously since 1968.
4. This report is based on my personal knowledge of the district, and mapping of the geology at the property.

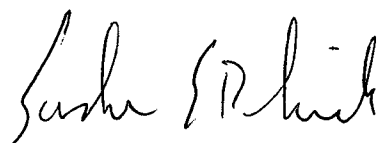

Gordon G. Richards, P.Eng.



APPENDIX I: GEOCHEMICAL RESULTS

CHRISTMAS #1-#4 MINERAL CLAIMS



# Chemex Labs Ltd.

Analytical Chemists • Geochemists • Registered Assayers

212 Brooksbank Ave.  
North Vancouver, B.C.  
Canada V7J 2C1

Telephone: (604) 984-0221  
Telex: 043-52597

## CERTIFICATE OF ANALYSIS

TO : JMT SERVICES CORPORATION

8827 HUDSON STREET  
VANCOUVER, B.C.  
V6B 4N1

CERT. # : A8417731-001-A  
INVOICE # : 18417731  
DATE : 15-NOV-84  
P.O. # : NONE  
XMAS

Sample description	Prep code	Au NAA ppb							
84D 1884	201	4	--	--	--	--	--	--	--
84D 1885	201	<1	--	--	--	--	--	--	--
84D 1886	201	4	--	--	--	--	--	--	--
84D 1887	201	<1	--	--	--	--	--	--	--
84D 1888	201	6	--	--	--	--	--	--	--
84D 1889	201	8	--	--	--	--	--	--	--
84D 1890	201	<1	--	--	--	--	--	--	--
84D 1891	201	8	--	--	--	--	--	--	--
84D 1892	201	89	--	--	--	--	--	--	--
84D 1893	201	3	--	--	--	--	--	--	--
84D 1894	201	2	--	--	--	--	--	--	--
84D 1895	201	17	--	--	--	--	--	--	--
84D 1896	201	<1	--	--	--	--	--	--	--
84D 1897	201	<1	--	--	--	--	--	--	--
84D 1898	201	7	--	--	--	--	--	--	--
84D 1899	201	46	--	--	--	--	--	--	--
84D 1900	201	17	--	--	--	--	--	--	--
84D 1901	201	57	--	--	--	--	--	--	--
84D 1902	201	24	--	--	--	--	--	--	--
84D 1903	201	2	--	--	--	--	--	--	--
84D 1904	201	10	--	--	--	--	--	--	--
84D 1905	201	12	--	--	--	--	--	--	--
84R 1115	201	<1	--	--	--	--	--	--	--
84R 1116	201	2	--	--	--	--	--	--	--
84R 1117	201	<1	--	--	--	--	--	--	--
84R 1118	201	6	--	--	--	--	--	--	--
84R 1119	201	<1	--	--	--	--	--	--	--
84R 1120	201	<1	--	--	--	--	--	--	--
84R 1121	201	<1	--	--	--	--	--	--	--
84R 1122	201	3	--	--	--	--	--	--	--
84R 1123	201	<1	--	--	--	--	--	--	--
84R 1124	201	<1	--	--	--	--	--	--	--
84R 1125	201	<1	--	--	--	--	--	--	--
84R 1126	201	<1	--	--	--	--	--	--	--
84R 1127	201	7	--	--	--	--	--	--	--
84R 1128	201	9	--	--	--	--	--	--	--
84R 1129	201	3	--	--	--	--	--	--	--
84R 1130	201	<1	--	--	--	--	--	--	--
84R 1131	201	<1	--	--	--	--	--	--	--
84R 1132	201	2	--	--	--	--	--	--	--

*Hart Buchler*

Certified by .....





# Chemex Labs Ltd.

Analytical Chemists • Geochemists • Registered Assayers

212 Brooksbank Ave.  
North Vancouver, B.C.  
Canada V7J 2C1

Telephone: (604) 984-0221  
Telex: 043-52597

## CERTIFICATE OF ANALYSIS

TO : JMT SERVICES CORPORATION

8827 HUDSON STREET  
VANCOUVER, B.C.  
V6B 4N1

CERT. # : A8417731-002-A  
INVOICE # : 18417731  
DATE : 15-NOV-84  
P.O. # : NONE  
XMAS

Sample description	Prep code	Au NAA ppb						
84R 1133	201	5	--	--	--	--	--	--
84R 1134	201	15	--	--	--	--	--	--
84R 1135	201	13	--	--	--	--	--	--
84R 1136	201	1	--	--	--	--	--	--
84R 1137	201	2	--	--	--	--	--	--
84R 1138	201	14	--	--	--	--	--	--
84R 1139	201	2	--	--	--	--	--	--
84R 1140	201	7	--	--	--	--	--	--
84R 1141	201	2	--	--	--	--	--	--
84R 1142	201	7	--	--	--	--	--	--
84R 1143	201	9	--	--	--	--	--	--
84R 1144	201	5	--	--	--	--	--	--
84R 1145	201	<1	--	--	--	--	--	--
84R 1146	201	<1	--	--	--	--	--	--
84R 1147	201	7	--	--	--	--	--	--
84R 1148	201	3	--	--	--	--	--	--
84R 1149	201	<1	--	--	--	--	--	--
84R 1150	201	4	--	--	--	--	--	--
84R 1151	201	<1	--	--	--	--	--	--
84R 1152	201	7	--	--	--	--	--	--

Certified by Hart Bichler

