

85-443-14323
04/86

PROSPECTING REPORT

on the

LARRY LAKE (EAST)
HILLTOP

ALBERNI MINING DIVISION
VANCOUVER ISLAND, B. C.

NTS 92F/3W

LATITUDE 49° 14' W
LONGITUDE 125° 28" W

OF

KEN GOURLEY, OWNER
JASMINE RESOURCES LTD., OWNER

FOR

JASMINE RESOURCES LTD.

BY

NORMAN PEARSON
SECORD LAMPMAN

FILMED

JULY 1985

GEOLOGICAL BRANCH
ASSESSMENT REPORT

14,323

04/86

TABLE OF CONTENTS

INTRODUCTION	Page
A. Property - Location	3
B. Status of Property	3
C. History	3
D. Summary of Work Done	3
E. References	4

TECHNICAL DATA AND INTERPRETATION

A. Introduction	5
B. Conclusion	5

APPENDIX I	- Work Cost Statement
APPENDIX II	- Certificate
APPENDIX III	- Assay Certificate

ILLUSTRATIONS

Figure 1	Location Map	Report Body
Figure II	Claims Map	Report Body
Figure III	Detail Map - Traverse & Showings	Map Pocket

INTRODUCTION

A. Property - Location

The Larry Lake East claim is a 6 x 3 block abutting east of the Larry Lake claim. The northwest corner is accessed by two logging roads switchbacking southeastward up a draw draining into Kennedy Lake. Highway #4, the Alberni to Tofino, splits the two claims in the middle at the top by the corner post.

B. Status of Property

The property Larry Lake (East) was under option to Jasmine Resources Ltd. The Hilltop claim is owned by Jasmine Resources Ltd.

Claim Name	Record Number	No. of Units
Larry Lake East	1730(4)	18
Hilltop	2095	8

The claims are shown on Figure II.

C. History

The Kennedy Lake area was first prospected as a follow-up to gold beach placer finds at Wreck Bay and Clayquot. Thereafter, compass deflections led to magnetite-skain contact metamorphic iron deposits, such as the Brynor mine.

The property lies north of the iron-mine geology, and is not marked by any large magnetic anomalies.

D. Summary of Work Done

Where Highway #4 intersects the two claims, there are two logging roads going into the Raven East claim. The first road goes in a north-easterly direction and was traversed to the end of the road approximately 470 meters from Highway #4. This road was beside a ravine at the top and had been completely logged off exposing some outcrops.

Sample G1 was taken 200 meters from Highway #4 on the lefthand side of the road from an exposed outcrop. The samples were all flagged and numbered and placed in plastic bag with corresponding sample numbers. Sample G2 was taken from rock face 146 meters from G1. G3 was taken from Rock Cliff approximately 80' in height and 40 meters from G2. From that point, there was approximately 57 meters till the end of the road.

At this point with the logging operation working in the area in front of us, we decided to walk along the other road.

Sample G4 was taken from a rock outcrop 150 meters from Highway #4. Sample G5 also was taken from rock outcrop 20 meters from G4. Sample G6 was taken from a 1.5" quartz vein exposed over 4', 97 meters from G5.

The road took a turn to the right past the logging company's explosive shack. Sample G7 was taken 245 meters from G6. Sample G8 was taken 97 meters from G7. G9 sample was taken 291 meters from G8 in an outcrop. G10 was taken at the end of the road 167 meters from G9.

We then walked back to the intersection of the two logging roads and proceeded NE up another logging road. Sample G11 was taken from an outcrop 50 meters from the intersection. Sample G12 was taken 48 meters from G11. Sample G13 was taken from a quartz vein system visible for 15' on a downdip which we thought might line up with samples G6 and G7. This whole area has been completely logged off with the logging company still doing work in the area. The elevation is approximately 350'.

The next day we walked in through the Jutland claim across the McMillan Bloedel Bridge and down through the Jutland and Orchid Creek claims to have access to the Hilltop. After traversing for most of the day through swamp at the bottom of the lake, the conclusion was made that the Hilltop claim was mostly in swamp except for a small fraction which abuts the Orchid Creek which rises to an extreme bluff on the SW corner. No samples were taken during this traverse.

E. References

1. GROVES, Dr. W. D. Geological Report
 Ph.D., P. Eng. August 9, 1984
2. EASTWOOD, P. B. C. Dept. of Mines,
 Bulletin on Kennedy Lake Iron Mine
3. CARSON, D. J. T. Geology and Mineral Deposits of
 and MULLER, J. Alberni Map Area, Vancouver Island
 and Gulf Islands, G.S.C. paper
 68-50

TECHNICAL DATA AND INTERPRETATION

A. Introduction

Rock samples, traverse lines, and sample values are reproduced in this report in Figure III. General Testing Laboratories Division, 1001 East Pender Street, Vancouver, B. C., did a 30 chemical ICP analysis.

Samples were taken and marked, placed in plastic bags, and all areas were marked on the areas concerned.

B. Conclusions

The Larry Lake East property has been under option to Jasmine Resources Ltd. for the past 18 months. On the recommendations of the company's directors, we have decided to drop the above mentioned claim in order to proceed with recommendations on the Lakehead, Orchid Creek, Jutland and Lucky River claims in the same area. The Hilltop claim will also be held by Jasmine Resources Ltd.

On the recommendation of the directors of the company from last year's results on the Larry Lake claim, it was decided not to go ahead with the prospecting report and spend any monies so it was dropped.

APPENDIX I -- WORK COST STATEMENT

Personnel:

Norman Pearson, Prospector March 1985 2 days @ \$200/day	\$ 400
Secord Lampman, Assistant March 1985 2 days @ \$200/day	400
Heather Pearson March 1985 2 days @ \$50/day	100
Food: 3 @ \$90/day	270
Accommodation: 2 @ \$90/day	180
Assay's Travel Time: 20% of \$400	80
Truck Rental including Gas: 3 @ \$150/day	450
Ferry Costs:	32
Report Preparation:	
Report Preparation: 2 @ \$150/day	300
Typing, Word Processing, Maps, Xerox and Jackets	150
Statement of Exploration & Development	99
TOTAL	<u>\$ 2,637</u>

CERTIFICATES

I, Norman Pearson, do hereby certify that:

1. I, Norman Pearson, have been active in the mining business since 1970 and reside at 4862 Bessborough Drive, Burnaby, B.C., V5C 1L3.
2. From 1976 - 1985 have done Field Work, Assessments, Trenching, Geochemical and Geophysical Work for Crescent Mines Ltd.
3. From 1980 - 1985 have done Field Work, Assessments for Clear Mines Ltd.
4. I am currently doing Placer Consulting Work for Cascadia Resources.
5. I have consulted on various Placer operations in the United States and Canada.
6. I am the holder of various patents on Placer Mining Equipment.
7. I am the holder of a Free Miners Lic. # *274405*

July 1985

Respectfully submitted

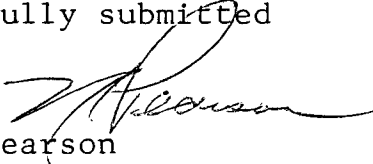
Norman Pearson

CERTIFICATES

I, Secord Lampman, do hereby certify that:

1. I, Secord Lampman, have been active in the mining business since 1983 and reside at #506-1552 Esquimalt Ave., West Vancouver, B.C. V7V 1R3.
2. I am President and Director of Jasmine Resources Ltd., a non reporting company in the province of British Columbia.
3. I do hold shares in Jasmine Resources Ltd.
4. Prior Experience in related field - Securities Salesman 1961-1962, 1969-1970.
5. By way of earlier mining industry experience, father owned a brokerage firm and had a listed company on the Vancouver Stock Exchange which operated a Uranium Mine in North East Sask., which I worked at during summer holidays during school.
6. I am the holder of a Free Miner Lic. # *275000* .

July 1985

Respectfully submitted

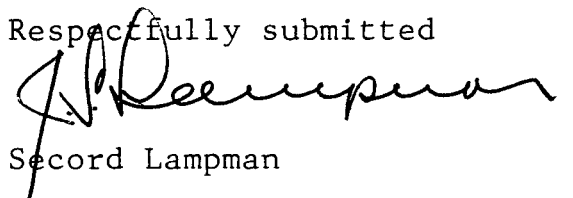

Secord Lampman



No: 8505-3053

Date: June 6, 1985

TO: Jasmine Resources Ltd.
Ste. 506 - 1550 Duchess Ave.
West Vancouver, B.C.
V7V 4S5SGS Supervision Services Inc.
GENERAL TESTING LABORATORIES DIVISION
1001 East Pender Street,
Vancouver, B.C., Canada V6A 1W2
Telephone: (604) 254-1647
Telex: 04-507514

We hereby certify that the following are the results of ICP analysis on : Ore samples

SAMPLE NO.	Mo ppm	Cu ppm	Pb ppm	Zn ppm	Ag ppm	Ni ppm	Co ppm	Mn ppm	Fe %	As ppm	U ppm	Au ppm	Th ppm	Sr ppm	Cd ppm
Raven 1A	4	44	166	231	1.0	4	6	654	2.69	68	8	ND	1	167	1
Lake View 1A	2	64	17	670	1.4	1	1	62	0.20	18	5	ND	1	279	4
Lake View 2A	1	14	19	180	0.7	1	1	59	0.17	9	5	ND	1	258	1
Raven E Line D-D1	2	76	9	98	0.2	39	9	519	2.62	3	5	ND	2	33	1
Raven E Line D-D2	1	15	9	136	0.2	34	12	604	3.08	4	5	ND	1	63	1
Raven E Line D-D3	2	4	20	54	0.1	3	2	488	1.98	8	5	ND	2	18	1
Raven E Line D-D4	1	3	13	57	0.3	6	12	471	5.51	7	10	ND	3	12	1
Raven E Line E-E1	1	124	7	77	0.1	40	14	544	4.89	3	5	ND	2	6	1
Raven E Line E-E2	1	8	6	52	0.1	44	16	759	4.51	3	5	ND	2	6	1
Raven E Line E-E3	3	12	13	81	0.1	3	3	541	2.04	4	6	ND	3	8	1

SAMPLE NO.	Sb ppm	Bi ppm	V ppm	Ca %	P %	La ppm	Cr ppm	Mg %	Ba ppm	Ti %	B ppm	Al %	Na %	K %	W ppm
Raven 1A	2	2	27	1.69	0.12	3	192	0.65	680	0.12	4	1.51	0.07	0.05	1
Lake View 1A	2	2	1	34.18	0.01	2	4	0.10	26	0.01	4	0.13	0.01	0.03	1
Lake View 2A	2	2	1	34.18	0.01	2	10	0.08	52	0.01	2	0.04	0.01	0.01	1
Raven E Line D-D1	2	2	38	1.10	0.07	2	61	1.29	17	0.11	3	1.58	0.07	0.04	1
Raven E Line D-D2	2	5	67	3.89	0.06	2	55	1.42	9	0.30	4	1.62	0.02	0.02	1
Raven E Line D-D3	2	2	17	0.73	0.05	4	66	0.54	49	0.12	3	0.92	0.05	0.05	1
Raven E Line D-D4	2	7	120	0.60	0.12	5	24	1.15	12	0.27	3	1.10	0.05	0.02	1
Raven E Line E-E1	2	6	105	0.64	0.08	2	61	1.59	3	0.17	3	1.40	0.06	0.02	1
Raven E Line E-E2	2	9	105	0.50	0.07	2	38	2.11	6	0.28	2	1.76	0.04	0.02	1
Raven E Line E-E3	8	2	20	0.43	0.04	5	56	0.44	26	0.11	4	0.79	0.05	0.03	1

COPY

APPENDIX III

L. Wong, Provincial Assayer



No: 8505-3053

Date: June 6, 1985

TO: Jasmine Resources Ltd.
Ste. 506 - 15th Ducess Ave.
West Vancouver, B.C.
V7V 4S5SGS Supervision Services Inc.
GENERAL TESTING LABORATORIES DIVISION
1001 East Pender Street,
Vancouver, B.C., Canada V6A 1W2
Telephone: (604) 254-1647
Telex: 04-507514

We hereby certify that the following are the results of ICP analysis on : Ore samples

SAMPLE NO.	Mo ppm	Cu ppm	Pb ppm	Zn ppm	Ag ppm	Ni ppm	Co ppm	Mn ppm	Fe %	As ppm	U ppm	Au ppm	Th ppm	Sr ppm	Cd ppm
Raven E Line E-E5	1	15	12	61	0.2	43	16	983	4.20	4	8	ND	2	6	1
Raven E Line F-F1	1	391	33	90	0.1	36	17	748	3.89	15	5	ND	1	8	1
Raven E Line F-F2	1	110	10	63	0.2	42	16	722	5.38	2	5	ND	2	9	1
Raven E Line F-F3	1	96	10	68	0.2	39	14	896	5.36	2	5	ND	2	19	1
Raven E Line F-F4	1	145	9	62	0.2	42	17	660	5.53	3	5	ND	2	19	1
Larry Lake G-1	1	25	47	136	0.2	13	17	1051	4.80	40	5	ND	3	24	1
Larry Lake G-2	1	35	21	119	0.4	13	6	936	7.59	11	11	ND	3	23	1
Larry Lake G-3	1	58	19	104	0.1	14	20	1437	6.00	12	5	ND	3	16	1
Larry Lake G-5	1	96	80	82	0.4	21	9	436	2.74	2	5	ND	2	12	1
Larry Lake G-6	3	11	59	26	6.4	4	3	373	0.93	6	5	ND	1	49	1
Larry Lake G-4	1	154	741	493	0.7	34	15	759	3.46	15	6	ND	4	9	7

SAMPLE NO.	Sb ppm	Bi ppm	V ppm	Ca %	P %	La ppm	Cr ppm	Mg %	Ba ppm	Ti %	B ppm	Al %	Na %	K %	W ppm
Raven E Line E-E5	3	6	115	0.81	0.05	2	54	2.32	10	0.50	2	1.94	0.10	0.03	1
Raven E Line F-F1	5	3	91	0.61	0.07	2	37	1.64	6	0.27	2	1.72	0.05	0.02	1
Raven E Line F-F2	2	3	121	0.53	0.06	2	34	1.97	8	0.27	5	1.73	0.06	0.03	1
Raven E Line F-F3	2	3	108	0.77	0.07	2	46	1.88	14	0.24	3	2.19	0.12	0.04	1
Raven E Line F-F4	2	2	133	1.07	0.06	2	36	1.81	11	0.32	6	2.10	0.11	0.05	1
Larry Lake G-1	8	2	75	0.68	0.09	3	34	1.81	169	0.11	4	2.35	0.05	0.04	1
Larry Lake G-2	2	3	146	0.40	0.14	2	38	1.41	94	0.37	4	1.73	0.07	0.11	1
Larry Lake G-3	2	2	122	0.90	0.11	2	18	3.07	17	0.20	3	3.14	0.03	0.02	1
Larry Lake G-5	10	2	61	0.56	0.06	2	44	1.24	16	0.12	4	1.42	0.07	0.02	1
Larry Lake G-6	2	2	20	5.43	0.02	2	57	0.40	8	0.05	128	0.52	0.01	0.02	1
Larry Lake G-4	4	2	125	2.14	0.07	4	98	1.44	16	0.34	11	2.15	0.10	0.01	1

COPY

L. Wong, Provincial Assayer



No.: 8505-3053
 Date: June 6, 1985

TO: Jasmine Resources Ltd.
 Ste. 506 - 1500
 West Vancouver, B.C.
 V7V 4S5

SGS Supervision Services Inc.
 GENERAL TESTING LABORATORIES DIVISION
 1001 East Pender Street,
 Vancouver, B.C., Canada V6A 1W2
 Telephone: (604) 254-1647
 Telex: 04-507514

We hereby certify that the following are the results of ICP analysis on :

SAMPLE NO.	Mo ppm	Cu ppm	Pb ppm	Zn ppm	Ag ppm	Ni ppm	Co ppm	Mn ppm	Fe %	As ppm	U ppm	Au ppm	Th ppm	Sr ppm	Cd ppm
Larry Lake G-7	2	4	18	10	0.6	1	1	122	0.50	3	5	ND	16	31	1
Larry Lake G-8	1	63	7	91	0.1	13	20	866	7.49	6	8	ND	3	6	1
Larry Lake G-9	1	74	10	29	0.1	38	10	273	1.87	4	5	ND	1	114	1
Larry Lake G-10	1	129	8	30	0.1	15	7	299	2.24	2	5	ND	2	67	1
Larry Lake G-11	2	3	8	36	0.1	7	3	327	1.05	5	5	ND	1	6	1
Larry Lake G-12	1	87	6	36	0.3	25	10	423	2.72	2	5	ND	2	10	1
Larry Lake G-13	2	14	11	15	0.2	2	1	99	0.53	6	7	ND	27	4	1
Larry Lake G-14	2	33	5	23	0.1	20	6	477	1.73	2	5	ND	1	50	1

SAMPLE NO.	Sb ppm	Bi ppm	V ppm	Ca %	P %	La ppm	Cr ppm	Mg %	Ba ppm	Ti %	B ppm	Al %	Na %	K %	W ppm
Larry Lake G-7	2	2	5	1.69	0.01	8	58	0.16	43	0.03	9	0.32	0.02	0.09	1
Larry Lake G-8	2	5	87	0.14	0.11	6	18	2.20	35	0.01	8	3.16	0.01	0.15	1
Larry Lake G-9	3	2	34	1.86	0.11	2	32	0.85	40	0.09	3	2.73	0.29	0.02	1
Larry Lake G-10	2	2	51	1.07	0.07	2	30	0.87	28	0.18	6	1.38	0.07	0.03	1
Larry Lake G-11	2	2	23	0.54	0.02	2	73	0.31	7	0.14	2	0.54	0.03	0.01	1
Larry Lake G-12	2	2	82	2.37	0.07	2	51	1.03	7	0.20	11	2.15	0.04	0.01	1
Larry Lake G-13	2	2	3	0.61	0.01	18	88	0.12	20	0.03	3	0.59	0.04	0.05	1
Larry Lake G-14	2	2	54	0.99	0.05	2	66	0.63	10	0.22	5	1.09	0.03	0.01	1

COPY

 L. Wong, Provincial Assayer

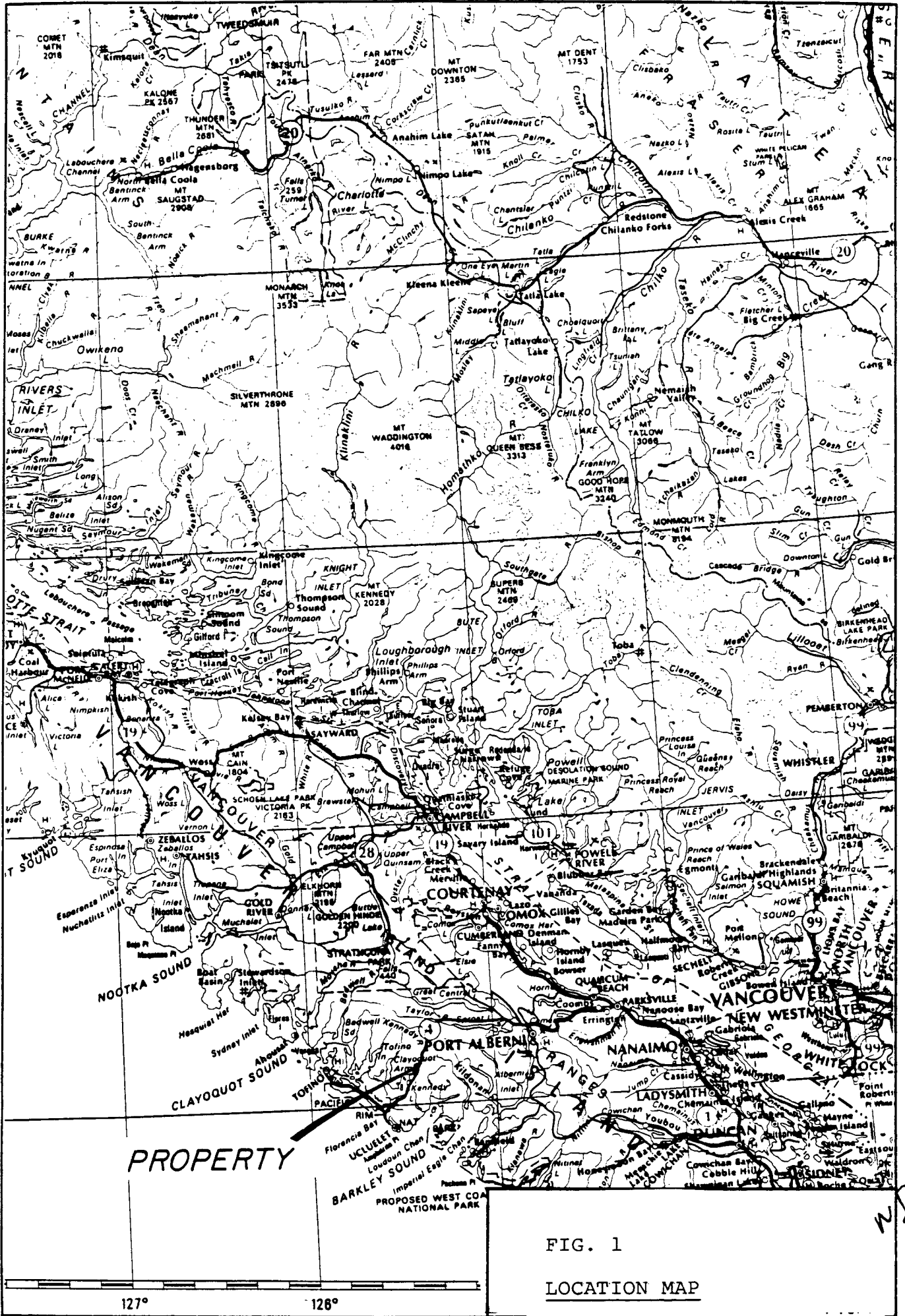

FIG. 1
LOCATION MAP

296

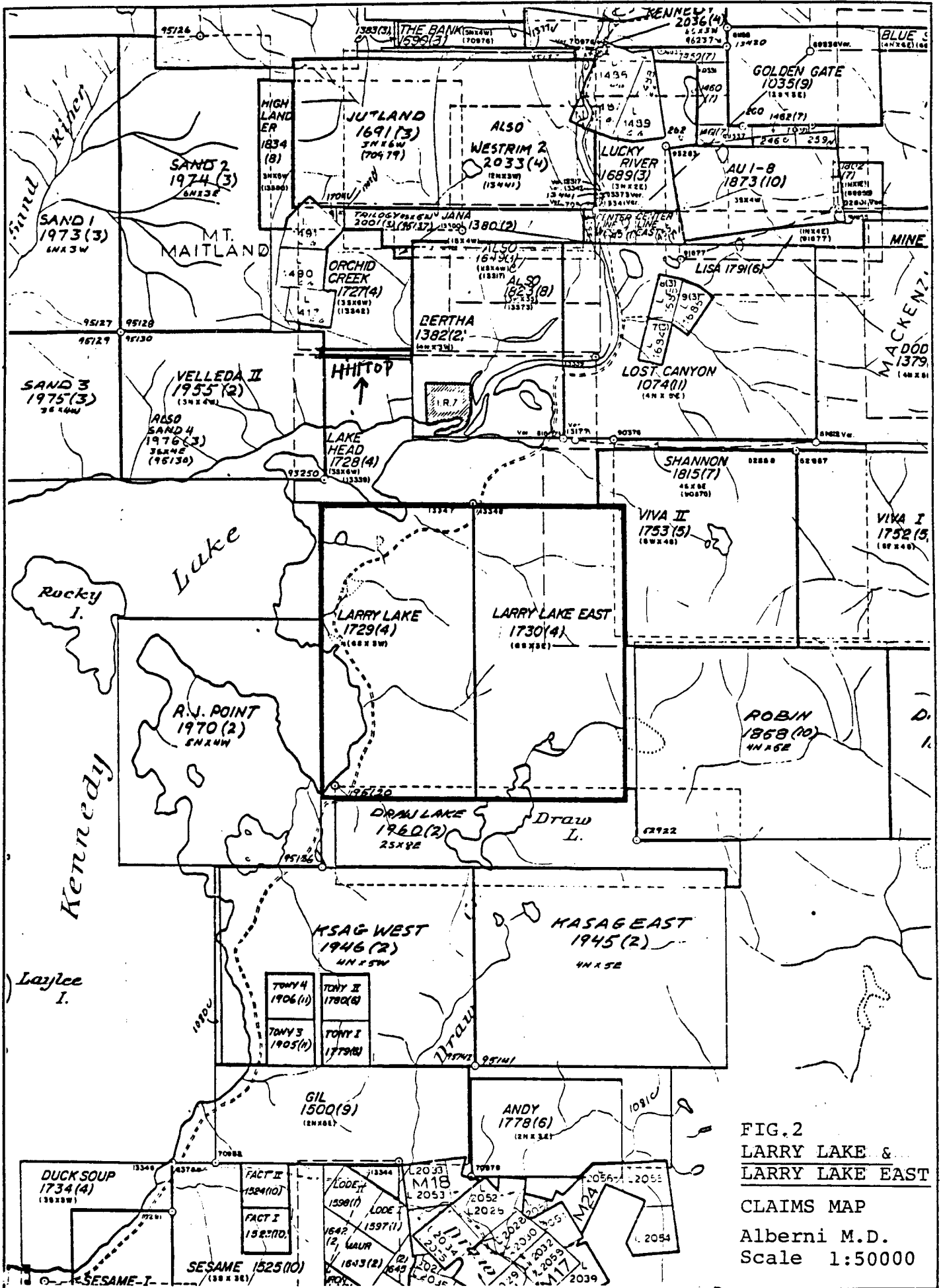

FIG. 2
 LARRY LAKE &
 LARRY LAKE EAST
 CLAIMS MAP
 Alberni M.D.
 Scale 1:50000

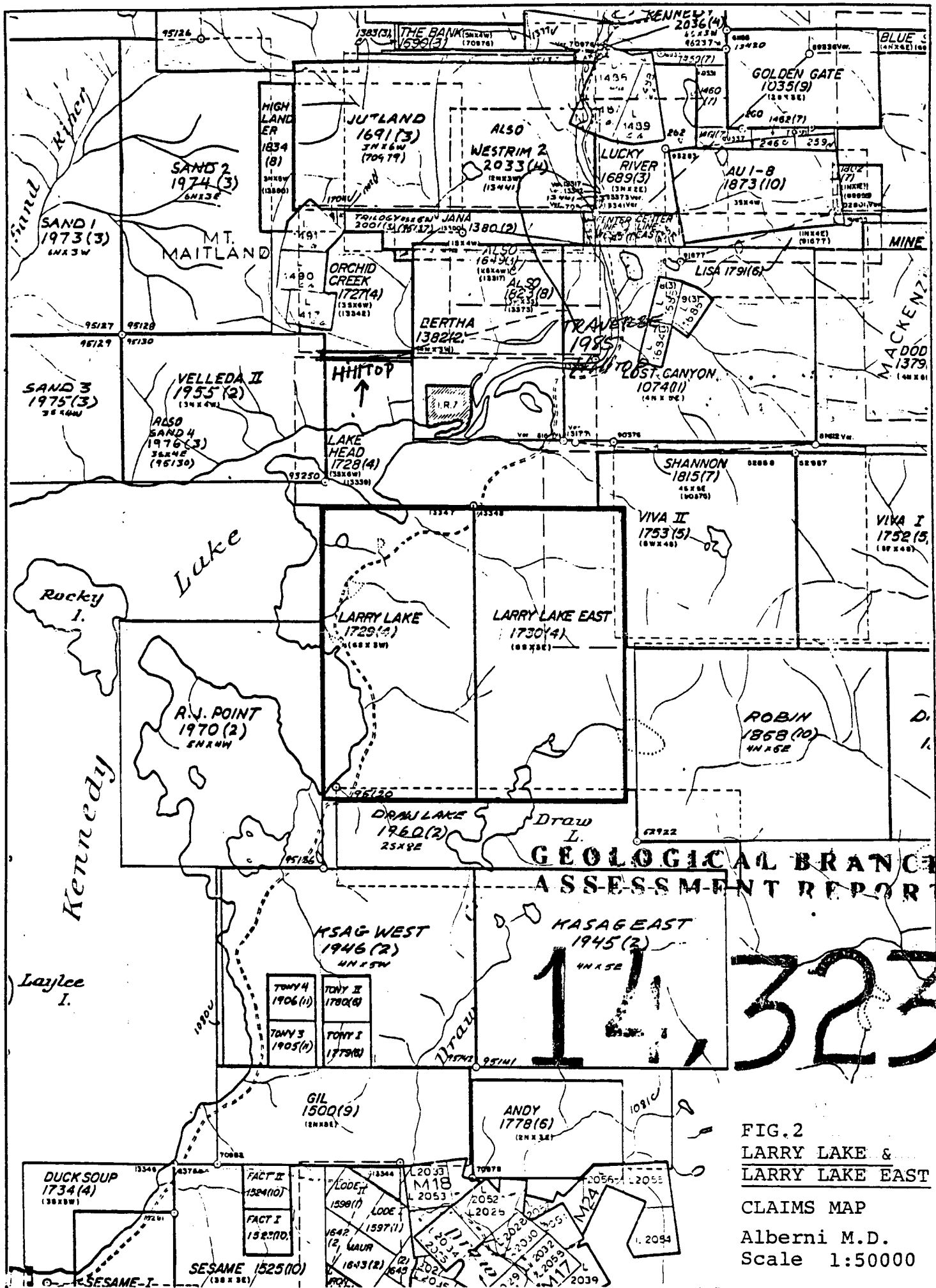
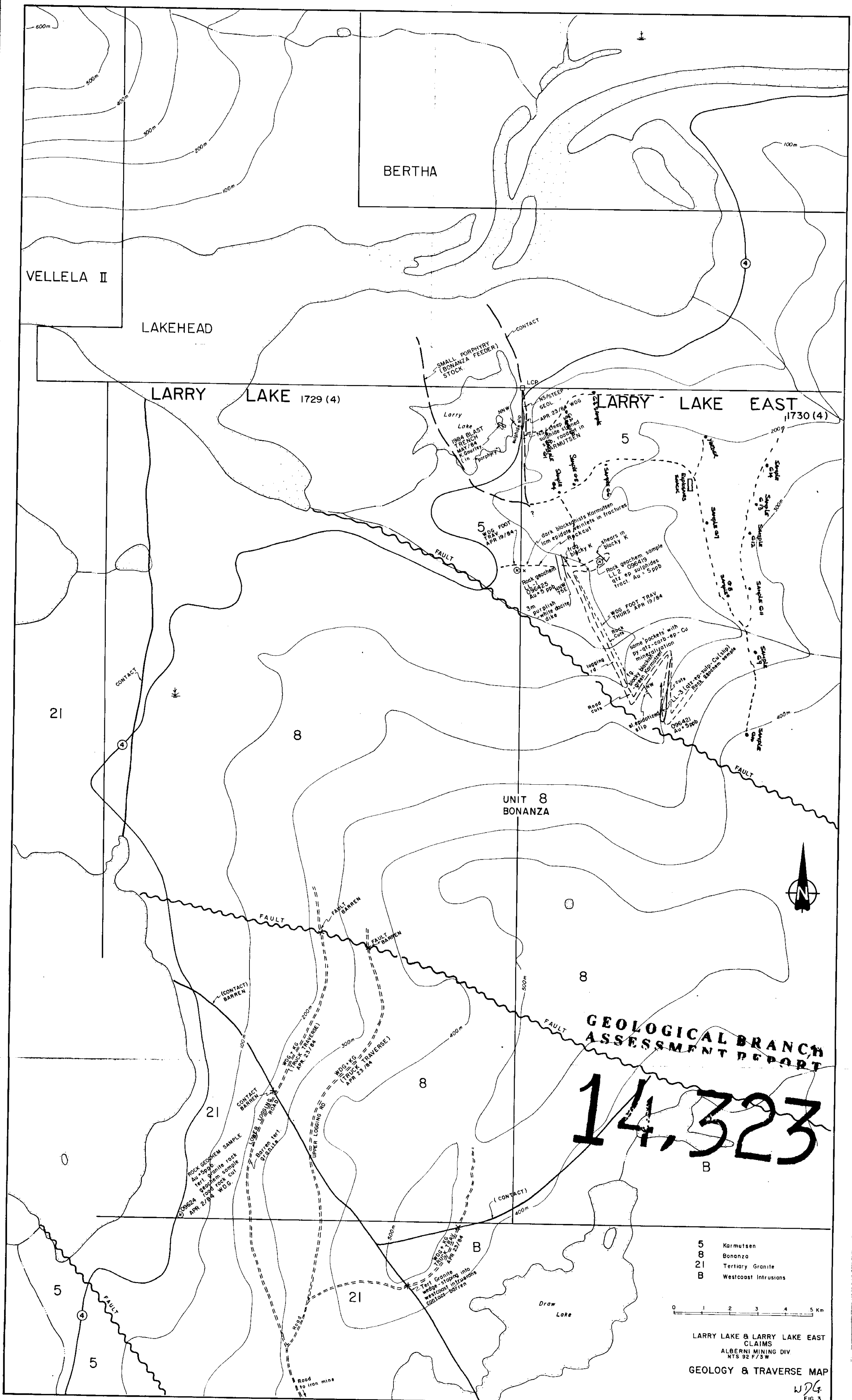

FIG. 2
LARRY LAKE &
LARRY LAKE EAST
CLAIMS MAP
Alberni M.D.
Scale 1:50000



BERTHA

VELLELA II

LAKEHEAD

LARRY LAKE 1729 (4)

LARRY LAKE EAST 1730 (4)

UNIT 8
BONANZA

**GEOLOGICAL BRANCH
ASSESSMENT REPORT**

14,323
B

- 5 Karmutsen
- 8 Bonanza
- 21 Tertiary Granite
- B Westcoast Intrusions

0 1 2 3 4 5 Km

LARRY LAKE & LARRY LAKE EAST
CLAIMS
ALBERNI MINING DIV
NTS 92 F/3 W

GEOLOGY & TRAVERSE MAP

WJG
FIG 3