

85-598-14335

GEOLOGICAL REPORT

HELLROARING CREEK PROSPECT
MARR CLAIMS

FORT STEELE MINING DIVISION
BRITISH COLUMBIA

FOR

06/86

MONALTA RESOURCES INC.

FILMED

**GEOLOGICAL BRANCH
ASSESSMENT REPORT**

14,335

E. A. SCHILLER

July 30th, 1985

06/86

CONTENTS

	Page
Introduction	1
Location and description of Claim Block	1
Geology	4
Area Activities	5
Work Completed	5
Recommended Program	6
Reference	7
Certificate	

ILLUSTRATIONS

MAP 1	INDEX MAP	2
MAP 2	CLAIM MAP	3
MAP 3	GEOLOGICAL MAP	In Pocket

INTRODUCTION

This report describes the geology and mineral potential of a claim block located north of Hellroaring Creek, 20 km southwest of Kimberley, in south eastern British Columbia (Map 1). The block was acquired in 1984 to cover expected northern extensions of a beryllium-bearing pegmatitic body. Immediately south of the block a major exploration program is in progress by Bearcat Exploration Ltd. of Calgary to delineate a beryl-feldspar pegmatite.

LOCATION AND DESCRIPTION OF CLAIM BLOCK

The Marr claim comprises a 20 unit block one kilometer south of St. Mary Lake at 49 degrees 35' and 116 degrees 11' (Map 2). The claim's record number is 2202 and is situated in the Fort Steel Mining division. Hellroaring Creek lies to the south and east of the claim block and flows northward into the St. Mary river.

Access to the claim is via the St. Mary gravel road 14 km west from B.C. highway No. 3/95. A well serviced logging road from the St. Mary road extending south over Hellroaring creek provides good accessibility to both the north and south parts of the claim block. The block was staked by Stuart Travis in 1984 on behalf of Eric Ashcroft of Vancouver and optioned to Monalta Resources Inc. and joint venture partners Silver Cloud Mines Ltd. and Carl Creek Resources Ltd.

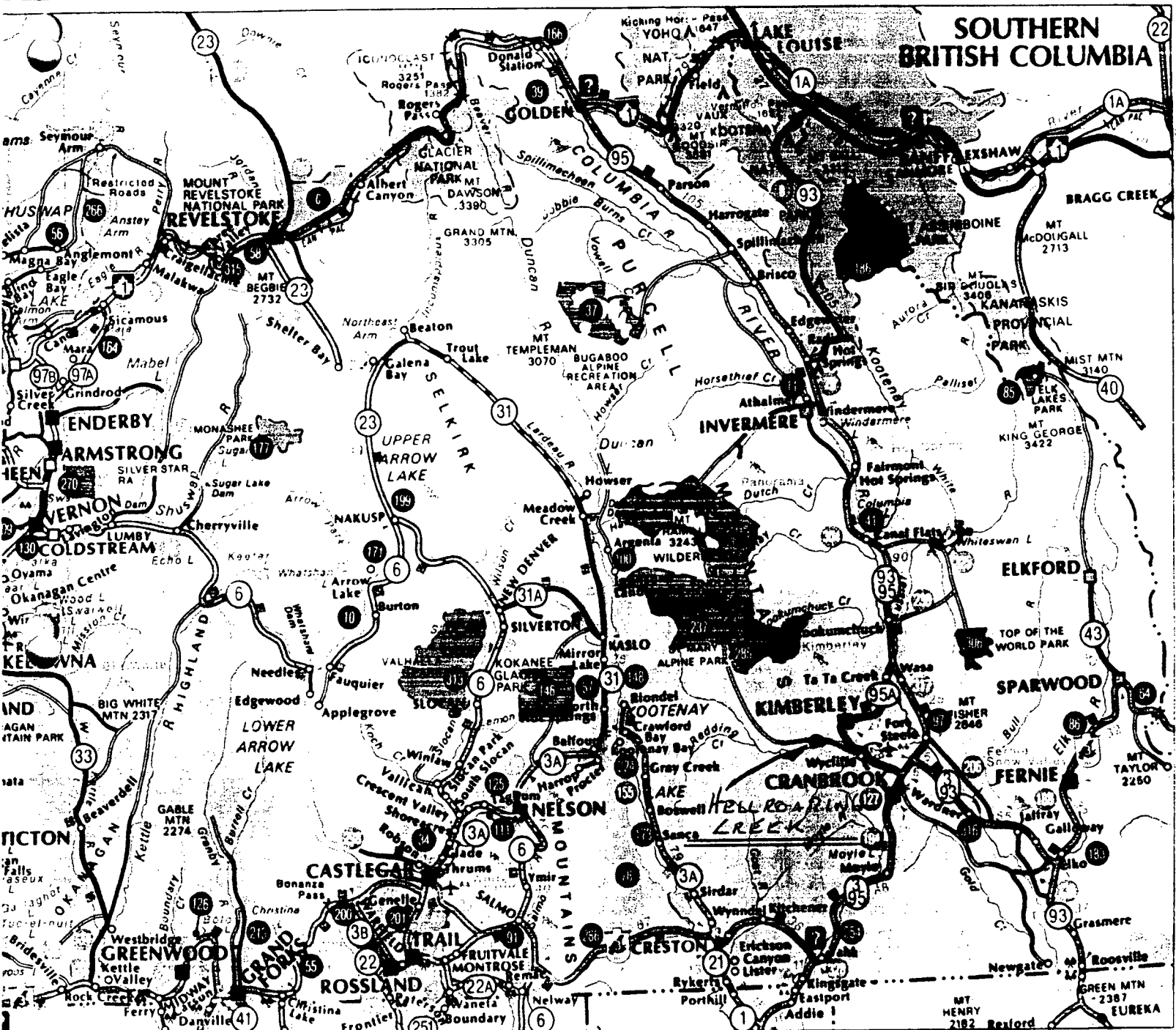

SCALE
1:2,000,000

MAP 1

MONALTA RESOURCES INC.
HELLROARING CREEK PROSPECT
BRITISH COLUMBIA
INDEX MAP

JULY 1985

E.A.S.

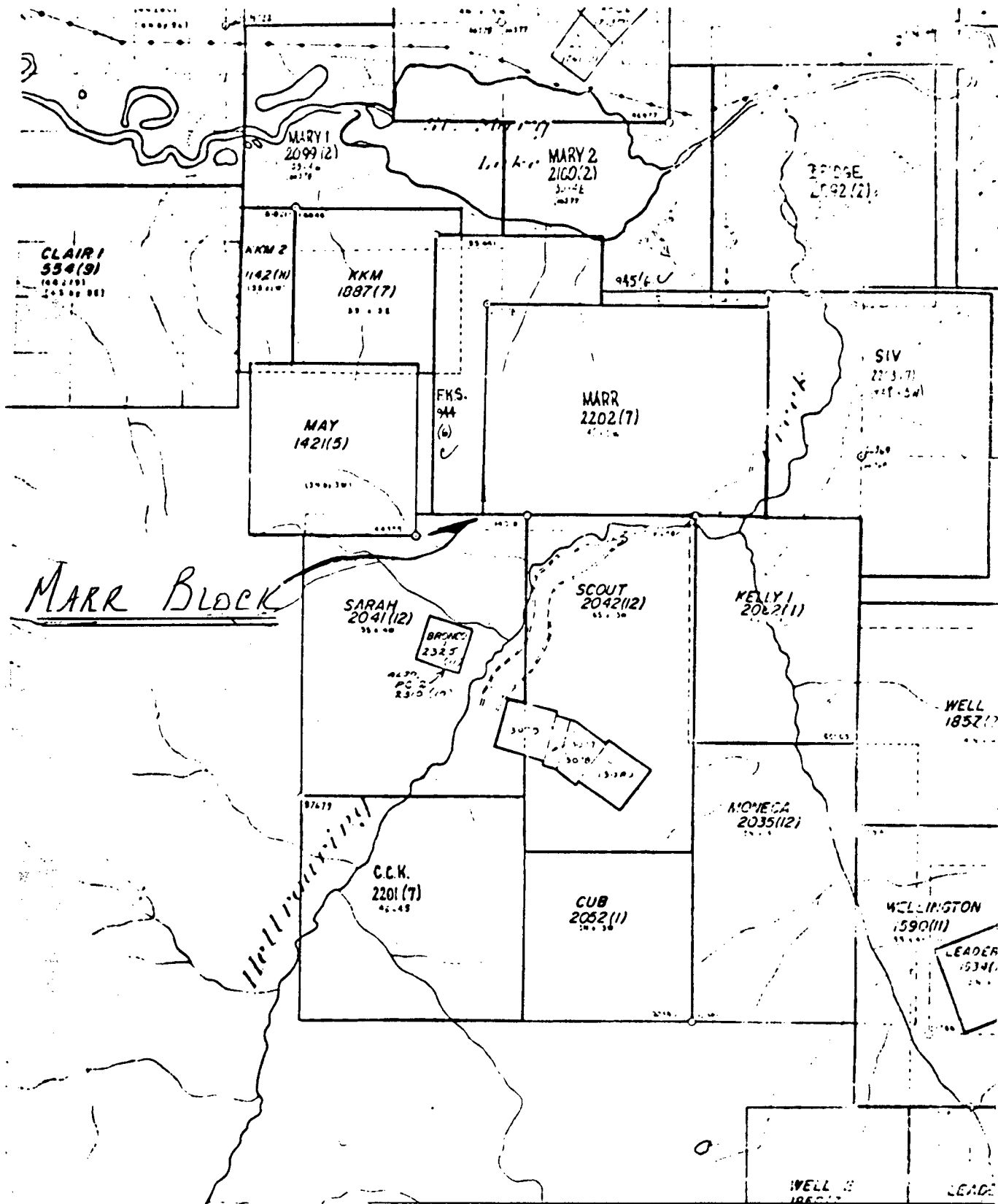

SCALE
1:50,000

MAP 2

MONALTA RESOURCES LTD.
HELLROARING CREEK PROSPECT
BRITISH COLUMBIA
CLAIM MAP
JULY 1985
E.A.S.

GEOLOGY

The claim block is underlain by Proterozoic sedimentary rocks of the Purcell Group (Map 3). The strata are probably part of the Middle Aldridge Formation comprising well bedded quartzite and siltstone. The sequence is intruded by thick sills of diorite of Proterozoic age. (Leech, 1957).

No outcrops of pegmatite or granite were observed however two areas were observed containing pegmatite boulders. It is possible that the boulders represent pegmatite transported from within the claim block.

The boulders contain potash feldspar probably microcline, quartz and coarse books of muscovite. No beryl was noted, however without a beryllimeter the exact content of beryllium could not be ascertained.

Of possible importance is the silver-lead Dan Howe prospect immediately west of the claim block. Some twenty similar lead-silver prospects, in addition to the producing Sullivan mine of Cominco at Kimberley occur in the Aldridge Formation. In conjunction to the pegmatite search attention should be directed to the search for possible extension of this showing eastward onto the Marr claims.

AREA ACTIVITIES

The Marr claim block was acquired in anticipation of finding pegmatite extensions northward from the Bearcat claims to the north. Bearcat have completed detailed mapping, prospecting, trenching and drilling and have delineated a potentially favourable pegmatite containing beryl, muscovite and feldspar. Economically the beryl represents a source of beryllium whereas the feldspar and muscovite represents industrial minerals of importance. Based on the current exploration activities and marketing study by Bearcat Exploration a mining development could commence in 1986 - 1987.

WORK COMPLETED

During the period July 17th - 21st, 1985 the author and geological assistant, Robert Wasylshyn geologically mapped (Map 3) and prospected the claim block. Although no out crops of pegmatite were found, due to the similarity to the geology to the south and the presence of pegmatite boulders on the claim block there could be pegmatite at shallow depths.

RECOMMENDED PROGRAM

Based on the proximity of the Marr claim block to the Bearcat pegmatite body immediately to the south and the presence of pegmatite boulders on the block the claim should be retained.

An effort should be made to find additional pegmatite boulders and attempt made to determine if outcrops lie beneath these boulders. This work would entail placing trenches in areas where pegmatite boulder frequency are highest.

It is recommended that a two week field program comprising detailed mapping and prospecting and trenching be undertaken. The cost to conduct this program is estimated to be five thousand dollars.

REFERENCES

LEECH, G.B., 1957 St. Mary Lake map area Kootenay District, B.C. G.S.C.
MAP 15-1957

CERTIFICATE

I, EDWARD A. SCHILLER, do hereby certify:

1. That I am a consulting geologist with offices at 8 Varview Place, Calgary, Alberta
2. That I graduated in geology from the University of Utah in 1963 with a Doctor of Philosophy Degree
3. That I am a registered professional geologist in the Association of Professional Engineers, Geologist and Geophysicists of Alberta
4. That I have practiced my professional for 25 years
5. That I have no interest direct nor indirect in the mineral claims herein reported nor do I hold securities in any form, direct nor indirect in Monalta Resources Inc. or associated companies
6. That this report dated July 30, 1985 is based on a field examination I conducted July 17-21, 1985 and a review of pertinent reports and maps
7. That I consented the use of this report by Monalta Resources Inc. in a Prospectus or Statement of Material Facts.

Dated at Calgary, Alberta this 30th day of July, 1985.

E. A. Schiller, P. Geol.

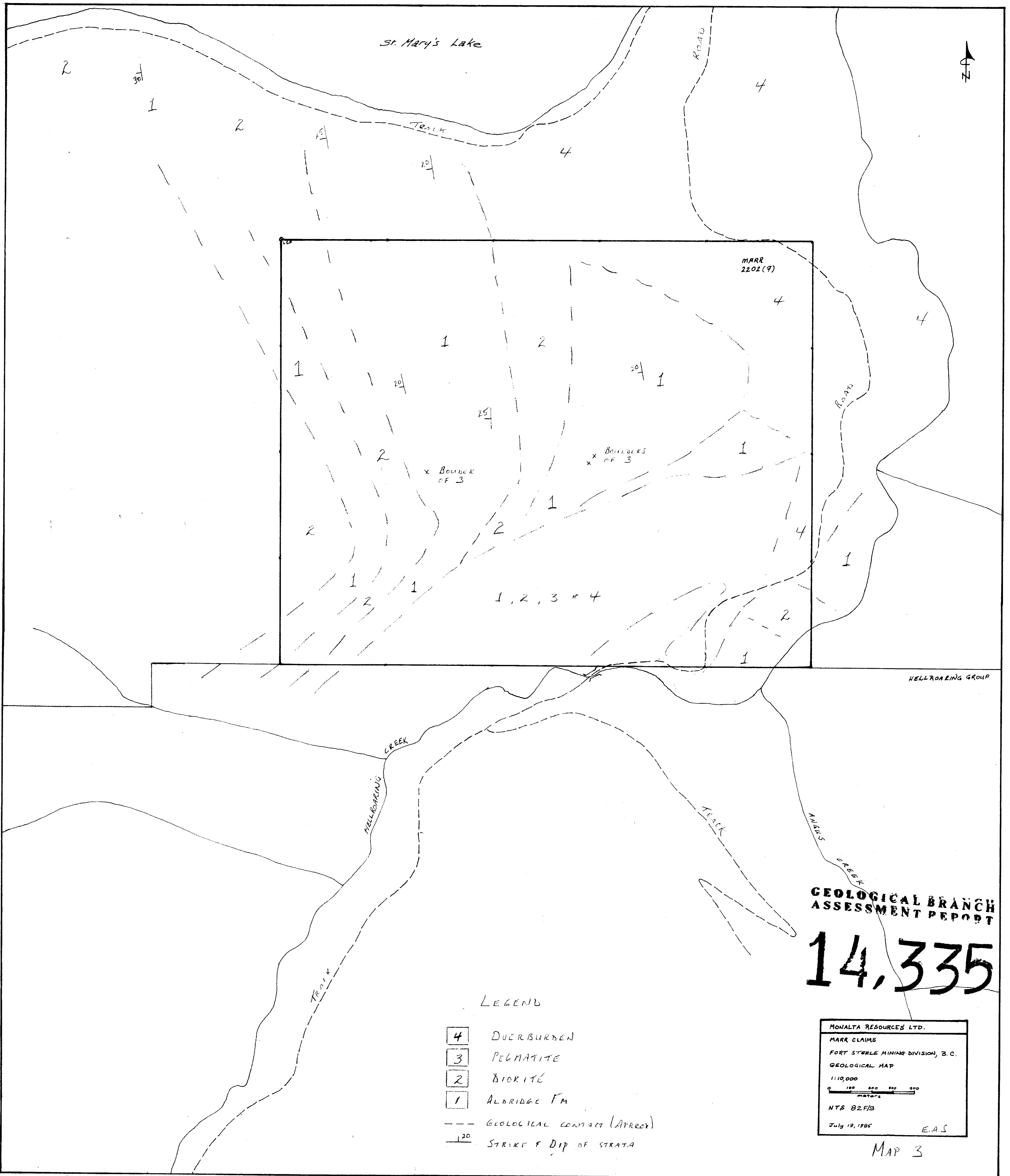

HELLROARING GROUP

**GEOLOGICAL BRANCH
ASSESSMENT REPORT**

14,335

LEGEND

- 4 DUEBURDEN
- 3 PEGMATITE
- 2 DIORITE
- 1 ALDRIDGE FM
- GEOLOGICAL CONTACT (APPROX)
- $\frac{1}{20}$ STRIKE & DIP OF STRATA

MONALTA RESOURCES LTD.
 MARR CLAIMS
 FORT STEELE MINING DIVISION, B.C.
 GEOLOGICAL MAP
 1:10,000
 0 100 200 300
 METERS
 NTS 82F/B
 July 19, 1985 E.A.S.

MAP 3