

REPORT ON
SOIL GEOCHEMISTRY *W/86*
RAFT GROUP
VICTORIA MINING DIVISION
BRITISH COLUMBIA
NTS 92F/2E
49°03'N LATITUDE 124°35.5'W LONGITUDE
FOR
OPERATOR: VANWIN RESOURCE CORPORATION
FEBRUARY 10, 1986
BY: T. NEALE, B.Sc.

FILMED

OWNER: *Lode Resource Corporation*

GEOLOGICAL BRANCH
ASSESSMENT REPORT

14,376

MINISTRY OF ENERGY, MINES
AND PETROLEUM RESOURCES
Rec'd FEB 12 1986
SUBJECT _____
FILE _____
VANCOUVER, B.C.



SUMMARY

A geochemical soil sampling program on the Vanwin Resource Corporation Raft Group has been carried out by MPH Consulting Limited. This report covers only the small portion of the work carried out which is sufficient to fulfill assessment work requirements for the Remy claim.

The area of this report is indicated by geological mapping to be underlain by Nitinat Formation(?) mafic volcanics. A total of 68 soil samples was collected on a 25x100 m grid and analyzed by AAS for Au, Ag, Cu, Zn, and Ni.

Two linear areas of above threshold Ni values were detected. One of the areas also contains above threshold to anomalous Cu and/or Ag values. Both anomalies are believed to be due to disturbance and contamination from roads. No values above threshold for either Au or Zn were obtained.

The results of this soil sampling program do not warrant further work in this area of the Raft Group unless encouragement is provided by subsequent work in surrounding areas.



TABLE OF CONTENTS

	page
SUMMARY	i
1.0 INTRODUCTION	2
2.0 LOCATION, ACCESS, TITLE	3
3.0 PREVIOUS WORK	5
4.0 REGIONAL GEOLOGY	7
4.1 Sicker Group	7
4.2 Vancouver Group	10
4.3 Bonanza Group	11
4.4 Nanaimo Group	12
4.5 Intrusive Rocks	13
4.6 Structure	13
4.7 Economic Setting	15
5.0 SOIL GEOCHEMISTRY	19
5.1 Results	19
6.0 CONCLUSIONS	21
7.0 RECOMMENDATIONS	22
CERTIFICATE - T. Neale, B.Sc.	23
REFERENCES	24

- Appendix I - List of Personnel and
Statement of Expenditures
- Appendix II - Certificates of Analysis

LIST OF ILLUSTRATIONS

	page
Figure 1 Location Map	1
2 Claim Map	4
3 Regional Geology Map	8
4 Soil Geochemistry Cu, Zn	in pocket
5 Soil Geochemistry Ag, Ni	in pocket



RAFT GROUP

VANWIN RESOURCE CORPORATION

**GENERAL LOCATION MAP
RAFT GROUP
VICTORIA MINING DIVISION**

Project No:	V 156	By:	T. N.
Scale:	1 : 8 000 000	Drawn:	J. S.
Drawing No:	1	Date:	FEBRUARY 1986.

MPH **MPH Consulting Limited**



1.0 INTRODUCTION

This report represents the compilation of geochemical fieldwork carried out by MPH Consulting Limited at the request of Mr. Lee Balak of Vanwin Resource Corporation on the Raft Group from November 1 to 2, 1985. The program was carried out and supervised by T. Hayes of MPH Consulting Limited.

Work carried out includes grid installation and soil sampling. This report covers only that portion of the work necessary to fulfill assessment requirements for the Remy claim. A total of 661 soil samples was collected in the period from October 30 to November 15 and analyzed for Au, Ag, Cu, Zn and Ni; however, this report covers only 68 of those samples.



2.0 LOCATION, ACCESS, TITLE

The Vanwin Resource Corporation Raft Group is situated between Rift Creek and the west fork of the Nitinat River, 27 km southeast of Port Alberni, or 34 km northwest of Youbou, in the Victoria Mining Division of British Columbia. The claims are centred at 49°03.1'N latitude, 124°35.5'W longitude on NTS mapsheet 92F/2 (Figures 1,2).

Access to the claims is via MacMillan Bloedel's Museum Creek road from the northwest, or via Crown Forest's Nitinat Main and BR20 roads from the southeast. The Museum Creek road is used if coming from Port Alberni; the Nitinat Main route is used if coming from Youbou. Numerous logging roads, mainly in good condition, provide access to virtually all parts of the claims.

The Raft Group comprises four claims totalling 61 units, as summarized below:

<u>Claim</u>	<u>Record No.</u>	<u>Units</u>	<u>Anniversary Date</u>	<u>Year Registered</u>
Raft 1	642(7)	20	July 27, 1987	1982
Raft 2	643(7)	20	July 27, 1986	1982
Nat	539(5)	6	May 14, 1986	1981
Remy	294(11)	15	November 15, 1986	1979

All of the claims are owned by Lode Resource Corporation. Vanwin Resource Corporation is the operator of the claims by virtue of an option agreement. The claims were grouped as the Raft group by Notice to Group dated November 15, 1985.

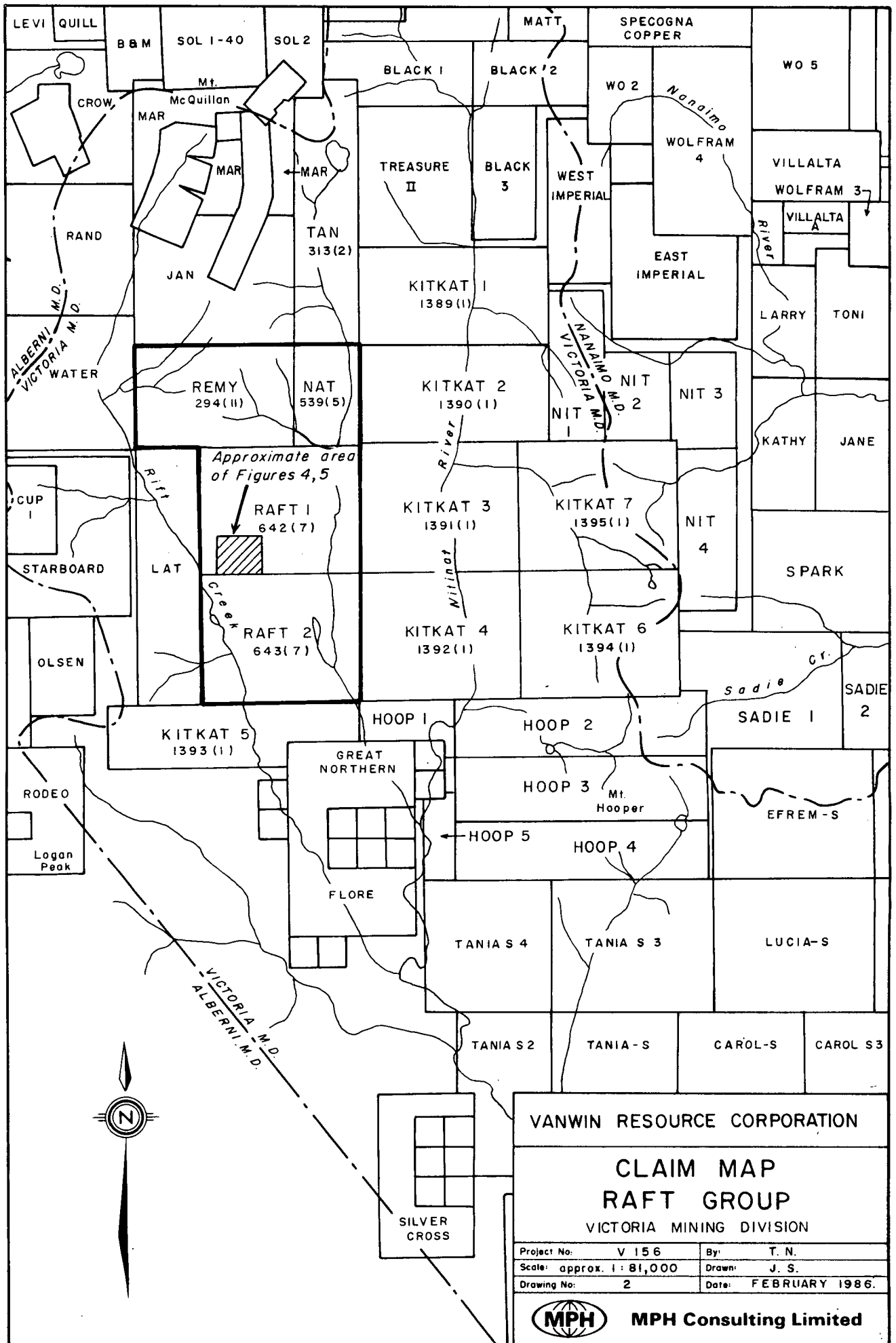

VANWIN RESOURCE CORPORATION

CLAIM MAP
RAFT GROUP
VICTORIA MINING DIVISION

Project No:	V 156	By:	T. N.
Scale:	approx. 1:81,000	Drawn:	J. S.
Drawing No:	2	Date:	FEBRUARY 1986.

MPH MPH Consulting Limited



3.0 PREVIOUS WORK

Government geological work in the area includes mapping by C.H. Clapp (1912), J.E. Muller and D.J.T. Carson (1969), and J.E. Muller (1977 and 1980).

A regional aeromagnetic survey flown by Hunting Survey Corp. Ltd. in 1962 included the area of the Raft Group. The results are not known.

From 1963 to 1966 Gunnex Ltd. carried out a regional mapping program over a large portion of the E&N Land Grant with limited prospecting and silt sampling. They compiled a list of all known mineral occurrences in the area and visited many of them. Silt samples taken in the area of the present Raft Group returned some anomalous results, but were not followed up by Gunnex.

In 1983 a program of reconnaissance silt and soil sampling on the Raft Group carried out for Lode Resource Corporation outlined several areas of interest (House and Sawyer, 1984). A subsequent follow-up silt sampling and geological mapping program indicated that the Black Panther/Black Lion shear zone and Au-quartz veins apparently continue to the south, on the west side of the ridge, while Cu and Zn anomalies occurring on the west side of the ridge could be indicative of a volcanogenic massive sulphide deposit (Laanela, 1984).

A rock sample collected by BP-Selco from a massive sulphide (pyrite) boulder on the Raft claims returned values of 1510 ppb Au, 7.0 ppm Ag, 669 ppm Zn, 544 ppm Cu, 935 ppm Pb, and 235 ppm As.



An engineering report on the Raft property was prepared for Vanwin Resource Corporation by Peter Christopher & Associates Inc. which outlined a recommended work program (Christopher, 1985). No field work was carried out.

In July 1985, reconnaissance geological mapping, prospecting, and rock sampling was carried out by MPH Consulting Limited for Vanwin Resource Corporation on the Raft 1 and 2 claims of the Raft Group (Neale and Hawkins, 1985). This work outlined two types of mineralization occurring in Nitinat Formation(?) mafic volcanics: volcanogenic massive sulphide mineralization exposed over 0.7 m by 8 m; and a large surrounding zone of disseminated to stringer sulphide mineralization 500 m wide by about 5000 m long. The massive sulphide showing returned values of 1379 ppm Cu and 1.0 ppm Ag from a grab sample, while the stringer zone returned analyses of up to 6185 ppm Cu, 6570 ppm Zn, 4.0 ppm Ag, 80 ppb Au, 2291 ppm Mo, 32.5 ppm Cd, and 328 ppm Cr from various grab samples.

4.0 REGIONAL GEOLOGY

The predominant rock units in the Port Alberni-Nitinat River area are the Upper Paleozoic Sicker Group rocks and the Lower Mesozoic Vancouver Group rocks. Both are eugeosynclinal sequences of volcanic and sedimentary rocks. Jurassic Bonanza Group volcanics are present in moderate amounts in the southern part of the area. Lesser amounts of the Upper Cretaceous Nanaimo Group and of intrusive rocks of various ages also occur. (Figure 3)

4.1 Sicker Group

The oldest rocks in the area are those of the Sicker Group. Muller (1980) proposed the following subdivision of the Group from youngest to oldest: Buttle Lake Formation, Sediment-Sill Unit, Myra Formation, and Nitinat Formation.

The Nitinat Formation (Unit 1) consists predominantly of basic volcanic rocks, most commonly flow-breccias, including some massive flows, and rare pillow basalts or agglomerates. Locally, medium grained, generally massive basaltic tuff is interbedded with the flows. The flow-breccia is composed of fragments of basalt up to 30 cm in length containing uralite phenocrysts and black or white amygdules, both from 1 mm to more than 1 cm in size, in a matrix of finer grained, similar basalt(?). Thin sections show that the uralite is replacing diopside. Uralitized gabbroic rocks underlie and intrude the volcanics and are believed to represent feeder dykes, sills, and magma chambers to the volcanics. The Nitinat Formation may be distinguished from the

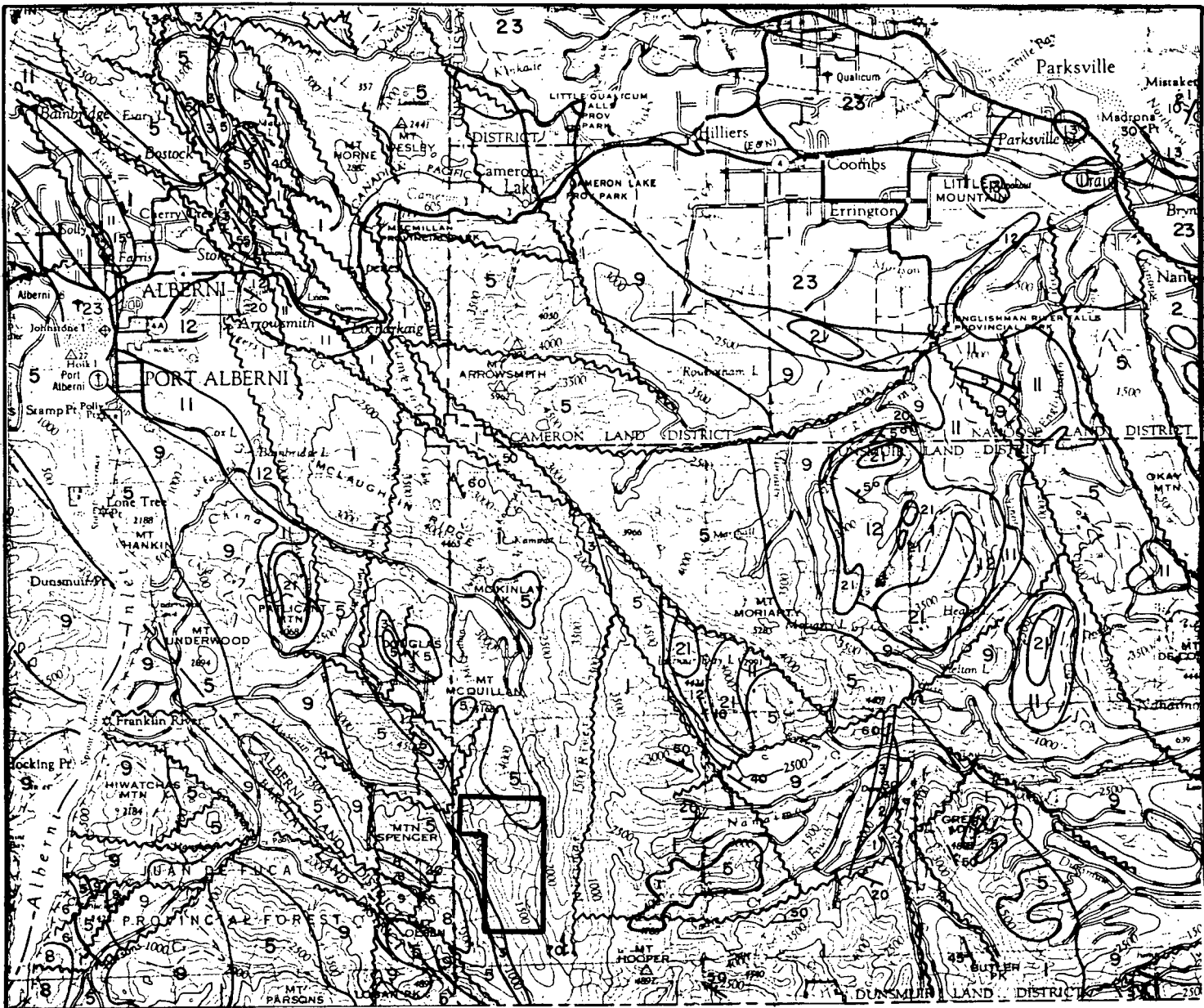

LEGEND

- QUATERNARY**
 23 Glacial and alluvial deposits
- TERTIARY**
 21 Hornblende quartz diorite, leucoquartz monzonite, porphyritic dacite, breccia.
- UPPER CRETACEOUS**
NANAIMO GROUP
 13 EXTENSION-PROTECTION FM.: sandstone, conglomerate, shale, coal.
 12 HASLAM FM.: shale, siltstone, fine sandstone.
 11 COMOX FM.: sandstone, conglomerate, shale, coal.
- MIDDLE TO UPPER JURASSIC**
 ISLAND INTRUSIONS: biotite-hornblende granodiorite, quartz diorite.
 9
- LOWER JURASSIC**
 BONANZA GROUP: andesitic to latitic breccia, tuff, and lava; minor greywacke, argillite, and siltstone.
 8
- UPPER TRIASSIC**
VANCOUVER GROUP
 6 QUATSINO FM.: massive to thick bedded limestone, minor thin bedded limestone.
 5 KARMUTSEN FM.: pillow-basalt and pillow breccia, massive basalt flows; minor tuff, volcanic breccia; Jasperoid tuff, breccia and conglomerate at base.
- TRIASSIC OR PERMIAN**
 4 Gabbro, periodite, diabase.

- LOWER PERMIAN TO PENNSYLVANIAN**
SICKER GROUP
 3 BUTTLE LAKE FM.: limestone, chert.
 2 MYRA FM.: lower unit; argillite, greywacke, conglomerate, tuff, minor limestone. Upper unit; rhyodacite to rhyolite tuff, lapilli tuff, breccia lesser siliceous siltstone, argillite, quartz porphyry and mafic flows.
 1 NITINAT FM.: basaltic uraltite porphyry, agglomerate, pillow lava; greenschist.

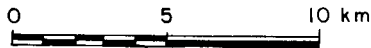

VANWIN RESOURCE CORPORATION

REGIONAL GEOLOGY MAP

RAFT GROUP

VICTORIA MINING DIVISION

Project No:	V 156	By:	TN
Scale:	1 : 250,000	Drawn:	J. S.
Drawing No:	3	Date:	FEBRUARY 1986.

 **MPH Consulting Limited**

similar Karmutsen Formation by the usual lack of pillow basalts, the abundance of uralite phenocrysts, the pervasive shear foliation, and lower greenschist or higher metamorphic grade.

The Myra Formation (Unit 2) unconformably overlies the Nitinat Formation. In the Nitinat-Cameron River area the Myra Formation is made up of a lower massive to widely banded basaltic tuff and breccia unit, a middle thinly banded pelitic albite-trachyte tuff and argillite unit, and an upper thick bedded, medium grained albite-trachyte tuff and breccia unit. In the lower unit, crudely layered mottled maroon and green volcanoclastic greywacke, grit, and breccia are succeeded by beds of massive, medium grained dark tuff up to 20 m thick interlayered with thin bands of alternating light and dark, fine grained tuff with local fine to coarse breccias containing fragments of Nitinat Formation volcanics. The middle unit is comprised of a sequence of thinly interbedded, light feldspathic tuff (albite trachyte or keratophyre composition) and dark marine argillite which has the appearance of a graded greywacke-argillite turbidite sequence. In the upper part of the middle unit, sections of thickly bedded to massive black argillite occur. The upper unit contains fine and coarse crystal tuffs in layers up to 10 m thick with local rip-up clasts and slabs of argillite up to 1 m in length as well as synsedimentary breccias of light coloured volcanic and chert fragments in a matrix of black argillite.

The type locality of the Myra Formation is Myra Creek, at the south end of Buttle Lake, about 92 km northwest of the Raft Group. There, volcanoclastic rocks consisting dominantly of rhyodacitic or rhyolitic tuff, lapilli tuff, breccia, and some quartz porphyry



and minor mafic flows and argillite (Upper Myra Formation) are host to Westmin Resources' Myra, Lynx, Price, and H-W massive sulphide (Cu-Zn-Pb-Au-Ag-Cd) deposits.

Muller (1980) estimated the thickness of the Nitinat Formation at about 2000 m and that of the Myra Formation at 750 to 1000 m. Both the Nitinat and Myra Formations were dated as Devonian and/or older by Muller (1980).

The Sediment-Sill Unit contains thinly bedded to massive argillite, siltstone, and chert with interlayered sills of diabase. It is transitional between the Myra and Buttle Lake Formations. It is not mapped within the report map area.

The Buttle Lake Formation (Unit 3) consists of a basal green and maroon tuff and/or breccia overlain by coarse grained crinoidal and calcarenitic limestone, fine grained limestone with chert nodules, and some dolomitic limestone. Lesser amounts of argillite, siltstone, greywacke, or chert may also be present.

The Buttle Lake Formation is up to 466 m thick. The age of the formation, on the basis of fossil dating, appears to be Middle Pennsylvanian, but could possibly be as young as Early Permian (Muller, 1980).

4.2 Vancouver Group

The Karmutsen Formation volcanic rocks (Unit 5) overlie the Buttle Lake Formation limestone paraconformably to form the base of the

Vancouver Group. They are the thickest and most widespread rocks on Vancouver Island. The formation, which is well exposed south-east of Port Alberni, consists mainly of dark grey to black pillowed basalt, massive basalt and pillow breccia. Flows are commonly aphanitic and amygdaloidal. Pillowed volcanics generally occur toward the base of the section.

Conglomerate containing clasts of Sicker Group rocks and jasperoid tuff form basal sections in the Nitinat-Horne Lake area.

Karmutsen Formation rocks are generally relatively undeformed compared to Sicker Group rocks and are dated Upper Triassic and older.

Massive to thick bedded limestone of the Quatsino Formation (Unit 6) occurs south of Mount Spencer. The limestone is black to dark grey and fine grained to micro-crystalline. In the vicinity of intrusive rocks, coarse grained marble is recognized. Thin bedded limestone also occurs in the formation. Fossils indicate an age of Upper Triassic (Muller and Carson, 1969).

4.3 Bonanza Group

The Bonanza Group (Unit 8) stratigraphy varies considerably from place to place, as it represents parts of several different eruptive centres of a volcanic arc. Basaltic, rhyolitic, and lesser andesitic and dacitic lava, tuff, and breccia with intercalated beds and sequences of marine argillite and greywacke make up the Bonanza Group. In the area south of Mount Spencer and

south of Corrigan Creek it consists of light coloured andesite to latite breccia, tuff, and flows with minor greywacke, argillite, and siltstone. The Bonanza volcanics are considered to be extrusive equivalents of the Island Intrusions and to be of Early Jurassic age.

4.4 Nanaimo Group

Upper Cretaceous Nanaimo Group sedimentary rocks are scattered throughout the area. Extensive exposures occur near Port Alberni, Patlicant Mountain and south and northwest of Mount Moriarty. The formations present comprise the basal portions of the Nanaimo Group.

The Comox Formation (Unit 11) consists mainly of quartzofeldspathic, cross-bedded beach facies sandstone and lesser conglomerate. Numerous intercalations of carbonaceous and fossiliferous shale and coal are characteristic.

The Haslam Formation (Unit 12) is a near shore littoral depositional facies unit characterized by massive bedded fossiliferous sandy shale, siltstone and shaly sandstone.

Interbedded coarse clastic conglomerate, pebbly sandstone and arkosic sandstone of the Extension-Protection Formation (Unit 13) are beach and deltaic sands. Minor shale and coal are reported.



4.5 Intrusive Rocks

Gabbro, Peridotite, Diabase (Unit 4). Mafic and ultramafic rocks of Triassic or Permian age are scattered throughout the area. A large band is exposed approximately 8 km north of Port Alberni.

Although mapped as intrusive, some of these rocks may be basal flow units of the Karmutsen Formation.

Island Intrusions (Unit 9). Exposures of mainly quartz diorite and lesser biotite-hornblende granodiorite occur throughout the area and are assigned an age of Middle to Upper Jurassic. Intrusive contacts with Sicker and Bonanza Group volcanic rocks are characterized by transitional zones of gneissic rocks and migmatite although contacts with Karmutsen Formation volcanic rocks are sharp and well defined. Skarn zones are reported at the contact of Island Intrusion rocks with Quatsino Formation limestone and less frequently with Buttle Lake Formation limestone.

Tertiary (Catface or Sooke) Intrusions (Unit 21). Sills and stocks of mainly hornblende-quartz diorite and dacitic hornblende-feldspar porphyry plus lesser leucocratic quartz monzonite intrude Nanaimo Group sedimentary rocks and Sicker Group rocks in the area.

4.6 Structure

The Buttle Lake Arch, Cowichan-Horne Lake Arch and Nanoose Uplift are north-northwesterly trending axial uplifts and are believed



to be the oldest structural elements in south central Vancouver Island. Uplifting occurred before the late Cretaceous, and possibly before the Mesozoic (Muller and Carson, 1969). Sicker Group volcanic and sedimentary rocks occur at the core of these uplifts.

Asymmetric southwest verging anticlinal structures characterized by subvertical southwest limbs and moderately dipping northeast limbs are reported at Buttle Lake and in the Cameron-Nitinat River area. Intense shearing and metamorphism to chlorite-actinolite and chlorite-sericite schist occurs in steep and overturned limbs of folds. Overlying Buttle Lake Formation limestones are relatively undeformed except where they are thin.

Vancouver Group units are not as intensely folded; gentle monoclinical and domal structures have been mapped. However, Karmutsen Formation volcanic rocks locally conform to the attitude of underlying Myra and Buttle Lake Formations (J.E. Muller, 1980).

Some early Mesozoic faulting occurred in the area prior to emplacement of Island Intrusions. Middle to Upper Jurassic intrusive activity (Island Intrusions) occurred along northwesterly trends.

Extensive west-northwest trending faulting occurred during the Tertiary and is best illustrated by large displacements of Nanaimo Group sediments. The north trending Alberni Valley fault is traced over 45 miles and displaces a section of Karmutsen Formation approximately 5,000 feet (Muller and Carson, 1969).



4.7 Economic Setting

The Sicker Group, and to a lesser extent, the Vancouver Group of volcanic rocks, have been explored intermittently since the 1890's for gold and base metal mineralization.

Until recently, deposits of copper and gold-silver in quartz veins and shear zones hosted by mafic to intermediate volcanic rocks and base metal plus gold-silver skarn deposits were the most widely recognized economic and subeconomic metal concentrations in the Port Alberni area. Placer mining for gold was carried out during the 1940's in various localities, especially in the China, Mineral and Corrigan Creeks area.

The volcanogenic massive sulphide deposits of Westmin Resources Ltd., first discovered in 1917 although not recognized as volcanogenic until the late 1960's, occur at Buttle Lake, approximately 70 km northwest of the Port Alberni area. Four zones of mineralization consisting of the ore minerals sphalerite, chalcopyrite, galena, tetrahedrite-tennantite plus minor bornite and covellite, are hosted by pyritic rhyolitic to rhyodacitic volcanic and pyroclastic rocks of the Myra Formation.

Proven reserves of the Lynx (open pit), Price and Myra deposits are 1,021,400 T grading 1% Cu, 0.9% Pb, 7.4% Zn, 0.06 oz Au/T, 2.6 oz Ag/T (1983). Published reserves of the H-W zone are 15,232,000 T averaging 2.2% Cu, 5.3% Zn, 0.3% Pb, 0.07 oz Au/T and 1.1 oz Ag/T (Walker, 1983). In the 3 years 1980 to 1982, there were 895,048 T of ore milled producing 16,109,000 lbs Cu, 96,356,000 lbs Zn, 14,231,000 lbs Pb, 56,000 oz Au, 2,528,000 oz Ag and 129,000 lbs Cd.



Another volcanogenic massive sulphide deposit in the Sicker Group is the Twin J Mine near Duncan on Mount Sicker, about 65 km south-east of the Raft Group. Two parallel orebodies, each containing pyrite, chalcopyrite, sphalerite and minor galena in a barite-quartz-calcite gangue and chalcopyrite in quartz, occur in schists believed to have been derived from acidic volcanics (Myra Formation).

Total production from 1898 to 1964 was 305,770 tons producing 44,491 oz Au, 934,522 oz Ag, 21,053,360 lb Cu and 45,864,654 lb Zn with at least 362,854 lb Pb and 10 lb Cd.

Chevron Canada Resources Limited has carried out a major exploration program on the Heather property, 8 km southeast of the Raft Group. A pyrite-chalcopyrite stringer zone assaying up to 0.284 oz Au/T, 0.66% Cu is hosted by Myra Formation silty rhyodacite tuff. This band of Myra Formation rocks is indicated by regional mapping to continue onto the Raft claims. A total of \$200,000 had been spent by Chevron on the property as of February 20, 1984; further work including diamond drilling was planned.

A significant recent development in the Sicker Group is the delineation of a large mineralized zone on the Lara property, 54 km southeast of the Raft Group. On the Lara property, Aberford Resources Ltd. has completed at least 69 diamond drill holes on geochemical and geophysical anomalies. In January 1985 an intersection of 26.2 feet (true thickness) of mineralization grading 0.1 oz Au/ton, 1.97 oz Ag/ton, 3.01% Zn, 0.68% Cu and 0.45% Pb was announced. This was the discovery hole of the Coronation Zone. By January 1986 the Coronation Zone had been outlined by drilling



for a length of 1700 feet and to depths varying from 250 to 800 feet. The width averages 20.2 feet. The western 1300 feet of the zone averages 0.051 oz Au/ton, 1.12 oz Ag/ton, 1.98% Zn, 0.44% Cu, and 0.36% Pb; while the eastern, high-grade 400 foot section averages 0.087 oz Au/ton, 2.04 oz Ag/ton, 3.8% Zn, 0.67% Cu, and 0.79% Pb. The Coronation Extension is located about 900 feet southeast of the Coronation Zone. It has been explored over a strike length of 260 feet and to depths of 500 feet and averages about 10 feet in width. Several rich intersections have been drilled, including 12.1 feet of 0.213 oz Au/ton, 8.6 oz Ag/ton, 9.22% Zn, 1.16% Cu, and 2.53% Pb. Both zones are open to depth and the Coronation Zone is open along strike.

The mineralized zones are stratiform and are hosted by a rhyolite porphyry unit of the Sicker Group. Metal ratios of the Coronation zone are very close to those of the Buttle Lake mines of Westmin Resources Ltd. The Twin J Mine is located 9 km southeast of the Lara property (i.e. on strike) and is geologically similar.

Five past producing mines occur in the Port Alberni area. The Thistle Mine produced 2,760 oz Au, 2,120 oz Ag and 681,425 lbs Cu from 6,920 T of ore. It was originally considered to be a skarn deposit (Stevenson, 1945; Carson, 1968). Disseminated and massive sulphide mineralization occurs as lenses and bands within pyritic quartz-sericite schist and at the contact of quartz-sericite schist with chloritized mafic volcanic rocks (Sicker Group). Disseminated sulphide mineralization occurs throughout the host rocks. The deposit is now believed to be of syngenetic-volcanogenic origin. Recent work by Westmin Resources Ltd. (1983, 1984) has located 16 significant Cu and/or Au occurrences over a strike



length of 4.6 km grading up to 0.49 oz Au/ton over 7 feet. Nine diamond drill holes intersected numerous anomalous concentrations of Au, although no ore grade Au-Cu was intersected over mining widths. The Thistle Mine is located 8 km northwest of the Raft Group. Regional mapping indicates that the unit hosting the Thistle Mine mineralization continues onto the Raft property.

The Havilah Mine (1,046 T produced 259 oz Au, 1,404 oz Ag) and the Vancouver Island Gold Mine (483 T produced 384 oz Au, 52 oz Ag) are quartz vein deposits hosted by andesite and andesite tuff of the Sicker Group and are located 8 km and 15 km, respectively north of the Raft Group.

The Black Panther Mine is a quartz vein deposit hosted by a shear zone in Sicker Group andesite and Island Intrusions diorite located 6 km north of the Raft Group. Production of 1,890 T of yielded 509 oz Au, 953 oz Ag, 12,319 lbs Pb and at least 4,478 lbs Zn and 498 lbs Cu.

The other past producer in the area is the 3-W Mine which consists of gold-bearing quartz veins in Island Intrusions diorite and granodiorite. Production amounts to 116 T of ore grading 4.0 oz Au/T, 4.3 oz Ag/T, 0.23% Cu, 1.1% Pb. The 3-W Mine is located 7 km east of the Raft Group.



5.0 SOIL GEOCHEMISTRY

This report covers only a small part of a much larger soil grid. The area was chosen on the basis of its being the closest part of the grid to the Remy claim. A total of 661 soil samples was collected over the whole grid; only 68 of the samples are from the area of this report. The samples were analyzed for Au, Ag, Cu, Zn, and Ni by AAS at Rossbacher Lab in Burnaby, B.C.

5.1 Results

The area of this report was soil sampled at 25 m intervals along grid lines spaced 100 m apart, yielding 68 samples. Results are summarized below:

	Cu (ppm)	Zn (ppm)	Ag (ppm)	Ni (ppm)	Au (ppb)
Range	6-324	16-118	0.2-0.8	4-108	10
Threshold	>180	>158	>0.39	> 76	-
Anomalous	>294	>265	>0.65	>119	-

Full results are included in Appendix II, and plotted on figures 4,5.

No values above threshold were obtained for Au or Zn. An area in the northwestern corner of the grid contains above threshold values in Ni and above threshold to anomalous values in Cu and Ag. The area extends from L16+00N to L18+00N (200 m) and varies in width from 0 to about 65 m from 0+00 to 0+65E. The anomaly is open to the north and west. It occurs along a road and may be due to disturbance and contamination from the road. An area of above



threshold Ni values also occurs on lines 16+00N to 18+00N at 1+50E to 3+00E. There are no corresponding Ag or Cu values in this area. No roads are marked in the area, however, the long narrow shape of the anomaly suggests that it may be associated with a road.

The grid sampled covers an area mapped previously (Neale and Hawkins, 1985) as Nitinat Formation(?) mafic volcanics. No rock samples were collected from the grid area, however, a piece of float collected from 100 m southeast of the grid returned values of 3510 ppm Zn, 0.6 ppm Ag, 13.5 ppm Cd. It appears from the soil sampling results that the source of this float must be off the area of the grid.



6.0 CONCLUSIONS

1. A total of 68 soil samples was collected from a 25x100 m grid over a portion of the Raft Group underlain by Nitinat Formation(?) mafic volcanics, and analyzed for Au, Ag, Cu, Zn, and Ni by AAS.
2. Two areas of above threshold Ni values, one of which has smaller coincident areas of above threshold to anomalous Cu and/or Ag values, are believed to be caused by disturbance and contamination from roads.
3. No other areas of above threshold or anomalous values were detected. A few isolated single-sample above threshold values occur, but are not significant by themselves.
4. This particular area of the Raft Group does not appear to warrant further exploration, unless subsequent work in the surrounding areas provides encouragement.



7.0 RECOMMENDATIONS

1. It is recommended that no further work be done on the area of the 68 soil samples unless work in the surrounding areas provides encouragement.

2. It is recommended that results from the remainder of the soil sampling grid be plotted and analyzed in order to locate alternate target areas on the Raft Group for additional geological, geophysical, and/or geochemical exploration.

Respectfully submitted
MPH Consulting Limited

A handwritten signature in cursive script, appearing to read 'T. Neale'.

T. Neale, B.Sc.

Vancouver, B.C.
February 10, 1986



CERTIFICATE

I, T. Neale, do hereby certify:

1. That I am a graduate in geology of The University of British Columbia (B.Sc. 1978).
2. That I have practised as a geologist in mineral exploration for eight years.
3. That the opinions, conclusions, and recommendations contained herein are based on field work carried out on the claims by MPH personnel in November 1985, library research work, and my experience in the area.
4. That I own no direct, indirect, or contingent interest in the subject property, or shares or securities of Vanwin Resource Corporation or associated companies.

A handwritten signature in cursive script, appearing to read 'T. Neale', is positioned above the printed name.

T. Neale, B.Sc.

Vancouver, B.C.

February 10, 1986

REFERENCES

- Carson, D.J.T. 1968: Metallogenic Study of Vancouver Island with Emphasis on the Relationships of Mineral Deposits to Plutonic Rocks; Ph.D. Thesis, Carleton University.
- Christopher, P.A. 1985: Report on the Raft Property, Nitinat River Area; for Vanwin Resource Corporation, April 3, 1985.
- Clapp, C.H. 1912: Southern Vancouver Island; G.S.C. Memoir 13.
- House, G.D. and J.B.P. Sawyer 1984: Report on Property Exploration Programs in the Mount McQuillan-Mount Spencer Area; for Lode Resource Corporation, May 31, 1984.
- Laanela, H. 1984: Summary Report on 1983 Exploration Programs in the Mount McQuillan Area; for Lode Resource Corporation, May 1, 1984.
- Muller, J.E. and Carson, D.J.T. 1969: Geology and Mineral Deposits of Alberni Map-Area, British Columbia (92F); G.S.C. Paper 68-50.
- Muller, J.E. 1977: Geology of Vancouver Island (West Half); G.S.C. Open File 463.
- 1980: The Paleozoic Sicker Group of Vancouver Island, British Columbia; G.S.C. Paper 79-30.
- Neale, T. and Hawkins, T.G. 1985: Report on Phase I Reconnaissance Geological Mapping and Rock Sampling, Raft 1,2 Claims (Raft Group); for Vanwin Resource Corporation, October 21, 1985
- Stevenson, J.S. 1945: Geology and Ore Deposits of the China Creek Area, Vancouver Island, British Columbia; Annual Report of the Minister of Mines of the Province of British Columbia, 1944, pp.A143-A161.
- Walker, R.R. 1983; Ore Deposits at the Myra Falls Minesite; Western Miner, May 1983, pp.22-25.



APPENDIX I

LIST OF PERSONNEL AND
STATEMENT OF EXPENDITURES



LIST OF PERSONNEL AND
STATEMENT OF EXPENDITURES

The following expenses have been incurred on the Raft Group, as defined in this report, for the purposes of mineral exploration. They are to be applied to the Remy claim in fulfillment of assessment work requirements for 1985.

Personnel

T. Hayes			
Crew Chief	2 days @ \$250	\$	500
R. Garcia			
Soil Sampler	2 days @ 150		300
T. Neale, B.Sc.			
Geologist	2 days @ 325		650
T.G. Hawkins, P.Geol.			
Consulting Geologist	4 hrs @ 80		<u>320</u>
			\$1,770

Expenditures

Food and Accommodation	160.00	
Transportation	214.78	
Analyses		
68 soils @ 8.30 (Au Ag Cu Zn Ni)	564.40	
Report Costs (typing, copying, drafting)	350.54	
Administration Fees	<u>143.96</u>	
		<u>1,433.68</u>
		<u>\$3,203.68</u>



APPENDIX II
CERTIFICATES OF ANALYSIS



ROSSBACHER LABORATORY LTD.

2225 S. SPRINGEF AVENUE
BURNABY, B.C. V5B 3N1
TEL : (604) 299 - 6910

CERTIFICATE OF ANALYSIS

TO : MPH CONSULTING LTD.
301-409 GRANVILLE STREET
VANCOUVER B.C.

CERTIFICATE#: 85510
INVOICE#: 6147
DATE ENTERED: 85-12-12
FILE NAME: MPH85510
PAGE # : 14

PROJECT: V156
TYPE OF ANALYSIS: GEOCHEMICAL

PRE FIX	SAMPLE NAME	-40M	PPM Cu	PPM Ni	PPM Ag	PPM Zn	PPB Au
S	L16N 150E	X	100	84	0.2	72	10
S	175E	X	68	82	0.2	70	10
S	200E	X	96	82	0.2	64	10
S	225E		100	76	0.2	66	10
S	250E		90	82	0.2	68	10
S	275E		22	36	0.2	50	10
S	300E		14	12	0.2	28	10
S	325E		86	62	0.2	112	10
S	350E	X	14	4	0.2	24	10
S	L16N 375E		8	8	0.2	22	10
S	400E		14	8	0.2	24	10

RECEIVED DEC 16 1985

CERTIFIED BY :



ROSSBACHER LABORATORY LTD.

2225 S. SPRINGER AVENUE
BURNABY, B.C. V5B 3N1
TEL : (604) 299 - 6910

CERTIFICATE OF ANALYSIS

TO : MPH CONSULTING LTD.
301-409 GRANVILLE STREET
VANCOUVER B.C.

CERTIFICATE#: 85510
INVOICE#: 6147
DATE ENTERED: 85-12-12
FILE NAME: MPH85510
PAGE # : 15

PROJECT: V156
TYPE OF ANALYSIS: GEOCHEMICAL

PRE FIX	SAMPLE NAME	-40M	PPM Cu	PPM Ni	PPM Ag	PPM Zn	PPB Au
S							
S							
S							
S	L17N OE		324	100	0.4	118	10
S	25E		48	62	0.2	70	10
S	50E		38	44	0.2	48	10
S	75E		20	14	0.4	26	10
S	100E		24	28	0.2	26	10
S	125E		24	32	0.2	36	10
S	L17N 150E		30	24	0.2	34	10
S	175E		18	14	0.2	26	10
S	200E		24	30	0.4	36	10
S	225E		64	100	0.2	74	10
S	250E		26	32	0.2	42	10
S	275E		42	46	0.2	52	10
S	300E		42	50	0.2	56	10
S	325E		34	44	0.2	54	10
S	350E		6	6	0.2	16	10
S	375E		48	72	0.2	58	10
S	L17N 400E		20	22	0.2	32	10

RECEIVED DEC 16 1985

CERTIFIED BY :

**GEOLOGICAL BRANCH
ASSESSMENT REPORT**

14,376

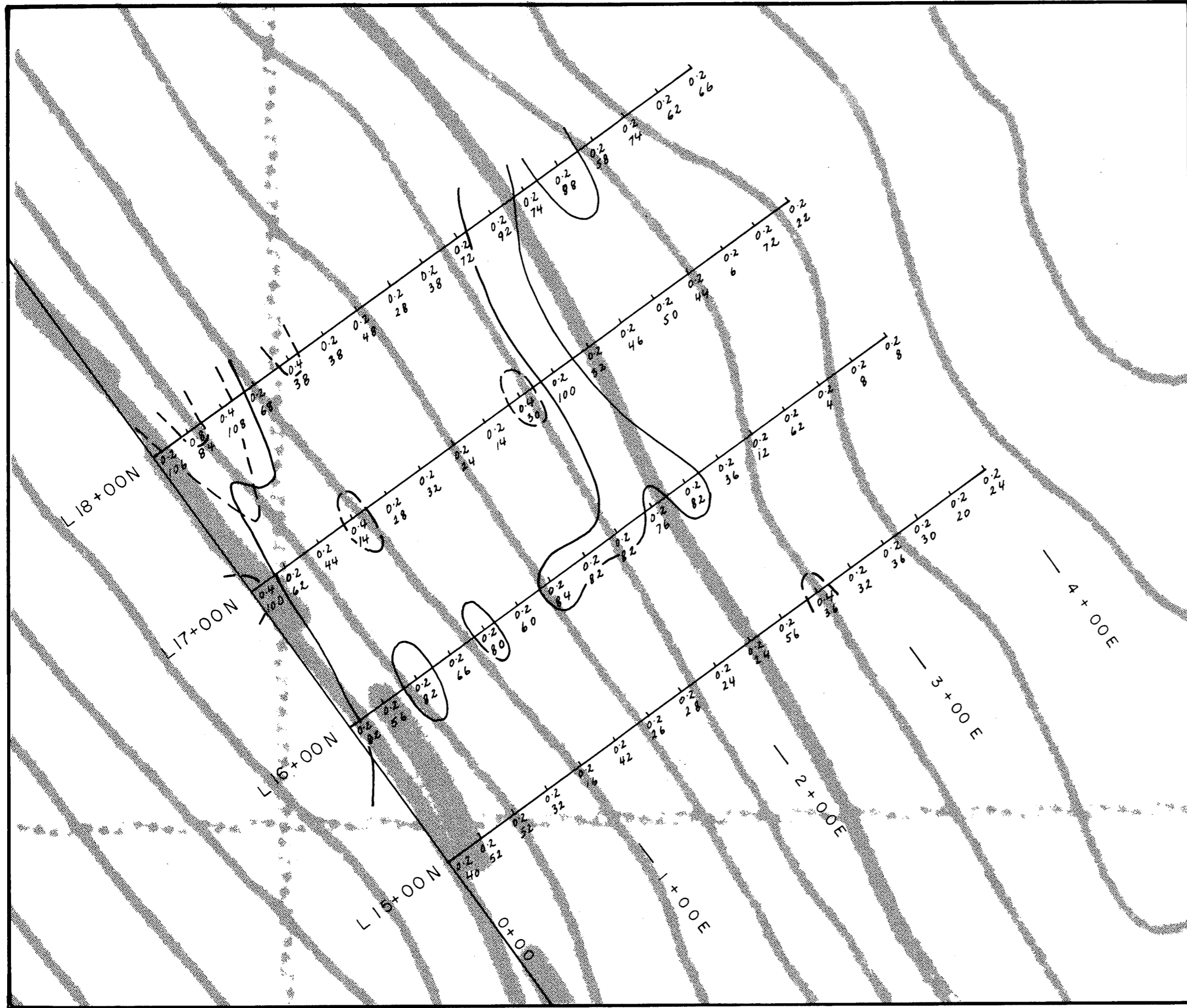

LEGEND

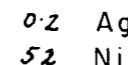
 Grid line with soil sample stations
 Soil geochemical values in ppm
 0.2 Ag
 5.2 Ni

GEOCHEMICAL CONTOURS

Ag ppm(—) Ni ppm(—)
 Threshold 0.4 77
 Anomalous 0.8 (120)

Note : See Figure 2 for location of grid area.



VANWIN RESOURCE CORPORATION	
SOIL GEOCHEMISTRY- Ag, Ni	
RAFT GROUP	
VICTORIA MINING DIVISION	
Project No. V 156	By T.N.
Scale 1 : 2 500	Drawn J.S.
Drawing No. 5	Date FEB. 1986.
 MPH Consulting Limited	

**GEOLOGICAL BRANCH
ASSESSMENT REPORT**

14,376

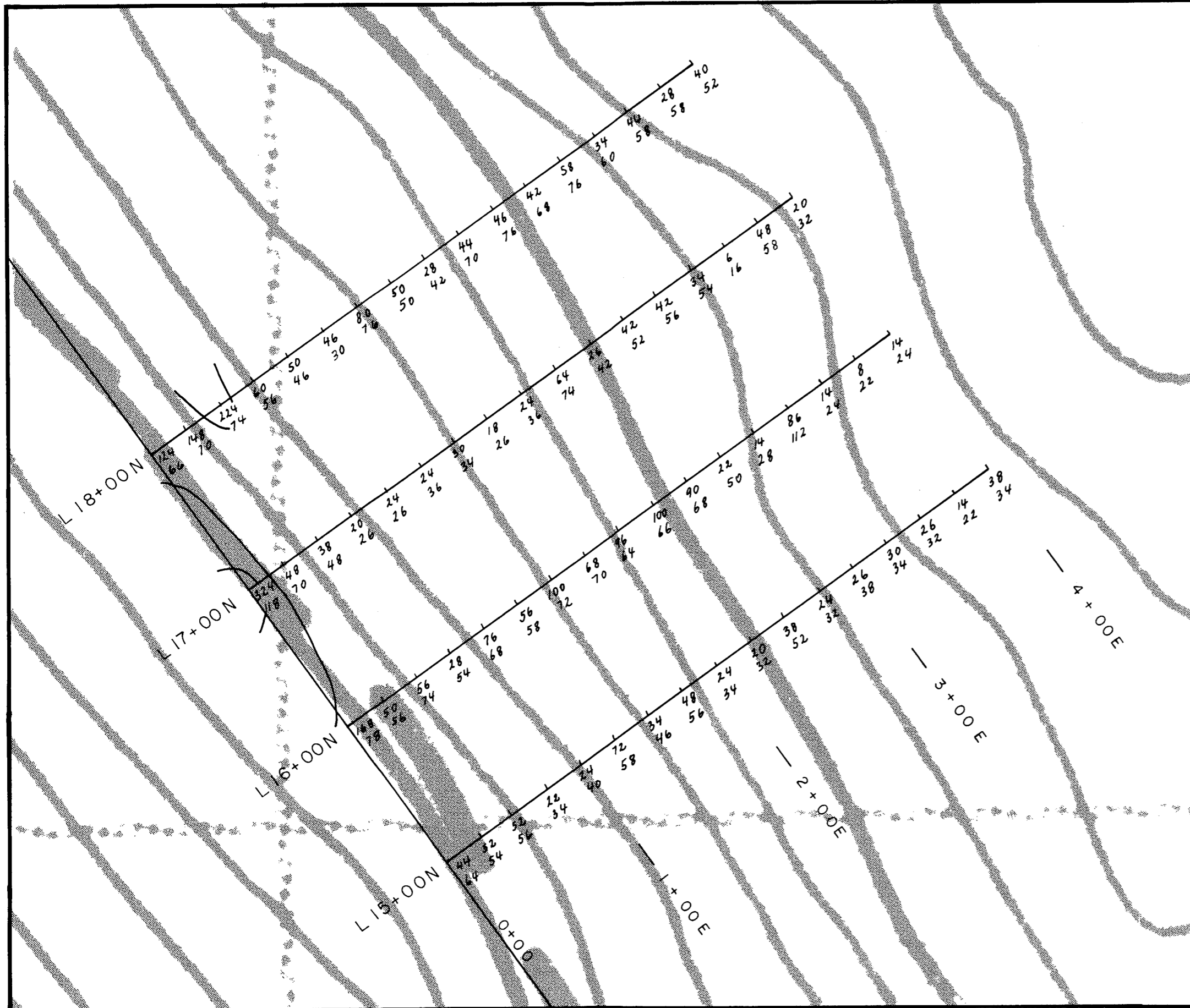

LEGEND

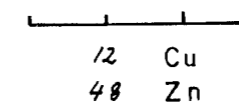

Grid line with soil sample stations
Soil geochemical values in ppm

GEOCHEMICAL CONTOURS

	Cu ppm (—)	Zn ppm
Threshold	181	(159)
Anomalous	295	(266)

Note: See Figure 2 for location of grid area.



VANWIN RESOURCE CORPORATION

SOIL GEOCHEMISTRY-Cu, Zn
RAFT GROUP
VICTORIA MINING DIVISION

Project No	V 156	By	T.N.
Scale	1 : 2 500	Drawn	J.S.
Drawing No	4	Date	FEB. 1986.

MPH MPH Consulting Limited