

TITLE PAGE

Nature of Report: General Prospecting, rock sampling.

Specific Claims: Gus 3 - 1208(5) 16 units, Gus 4 - 1209(5) 16 units

Mining Division: Revelstoke

NTS Map No: 82K11W

Latitude and Longitude: 50 degrees 37', 117 degrees 05'

Owner of Claim: Taban Developments

Author of Report: C. von Einsiedel

Authors Qualifications: Completed BSc. Geology - Carleton University 1982.

Date Submitted: September 6, 1985.

**GEOLOGICAL BRANCH  
ASSESSMENT REPORT**

FILMED

14,561

RECEIVED  
SEP 19 1985  
M.R. # .....  
REVELSTOKE, B.C.

85-609

# RAM EXPLORATIONS LTD.

404 - 850 West Hastings Street  
Vancouver, B.C. V6C 1E1

Telephone: 687-1309

September 16, 1985

RECEIVED  
SEP 19 1985

Ministry of Energy Mines and Petroleum Resources  
Office of the Gold Commissioner  
800 Hornby St.  
Vancouver, B.C.

RE: PROSPECTING REPORT  
GUS 3 AND 4 MINERAL CLAIMS

At the request of Mr. Agoston Morvay, General Manager - Taban Developments, the author prepared a report on prospecting carried out on the Gus 3 and 4 Claims during the 1984 field season. Work was carried out by Mr. Morvay and two assistants during late September and included detailed prospecting and sampling near the head of Lardeau Creek on Map Sheet 82K11W in the Revelstoke Mining Division.

Sample locations, descriptions and assay results were provided by Mr. Morvay and D. McMullen.

Should you require additional information please contact myself or one of my associates at 687-1309.

Yours truly,

*C. von Einsiedel*  
C. von Einsiedel  
Senior Geologist.

RECEIVED  
SEP 19 1985  
M.R. S  
REVELSTOKE B.C.

## TABLE OF CONTENTS

Title Page	1
Table of Contents	2
Introduction	3
Index Map No.1 Claim Location / Access	4
Work Summary	5
Geologic Description	5
Plan Map. No.2 Sample Locations	7
Table 1. Rock Sample Assays	8
Table 2. Rock Sample Descriptions	11
Itemized Cost Statement	13

## INTRODUCTION

The Gus 3 and 4 Claims are located near the head of Lardeau Creek some 10 km east of Trout Lake, B.C. The Claims may be reached by 4\*4 track along Lardeau Creek or by helicopter from either Revelstoke or Nakusp.

The Claims are located within the former Trout Lake Mining Division, a well known Kootenay Silver Camp which was most active at the turn of the century. Geologically the claims are located within Paleozoic and Mesozoic aged metasediments and metavolcanics which form a complex, arcuate fold belt known as the Kootenay Arc. This belt extends from Northern Washington to North of Revelstoke, B.C. and hosts most of the important lead - zinc deposits of southeastern, B.C.

Local prospectors have reported two potentially significant types of mineralization in the area covered by the Gus 1 and 2 Claims. These include an ultramafic unit which in places hosts platinum mineralization and a NW striking shear zone which hosts galena, sphalerite and pyrite as well as tetrahedrite.

The present seasons fieldwork included detailed prospecting and rock sampling designed to locate and evaluate these occurrences.

Index Map No. 1 shows the location of the areas prospected and approximate sample locations. Plan Map No. 2 Shows sample and outcrop locations. Table 1 and 2 are descriptions and assay results of the samples collected.

Prospecting was carried out between September 25 and 30, 1984. Three men established a base camp in Trout Lake and accessed the claims by road and overland traverse. To pick up samples and provide general reconnaissance of the entire claim group a helicopter was chartered on October 2, 1985.

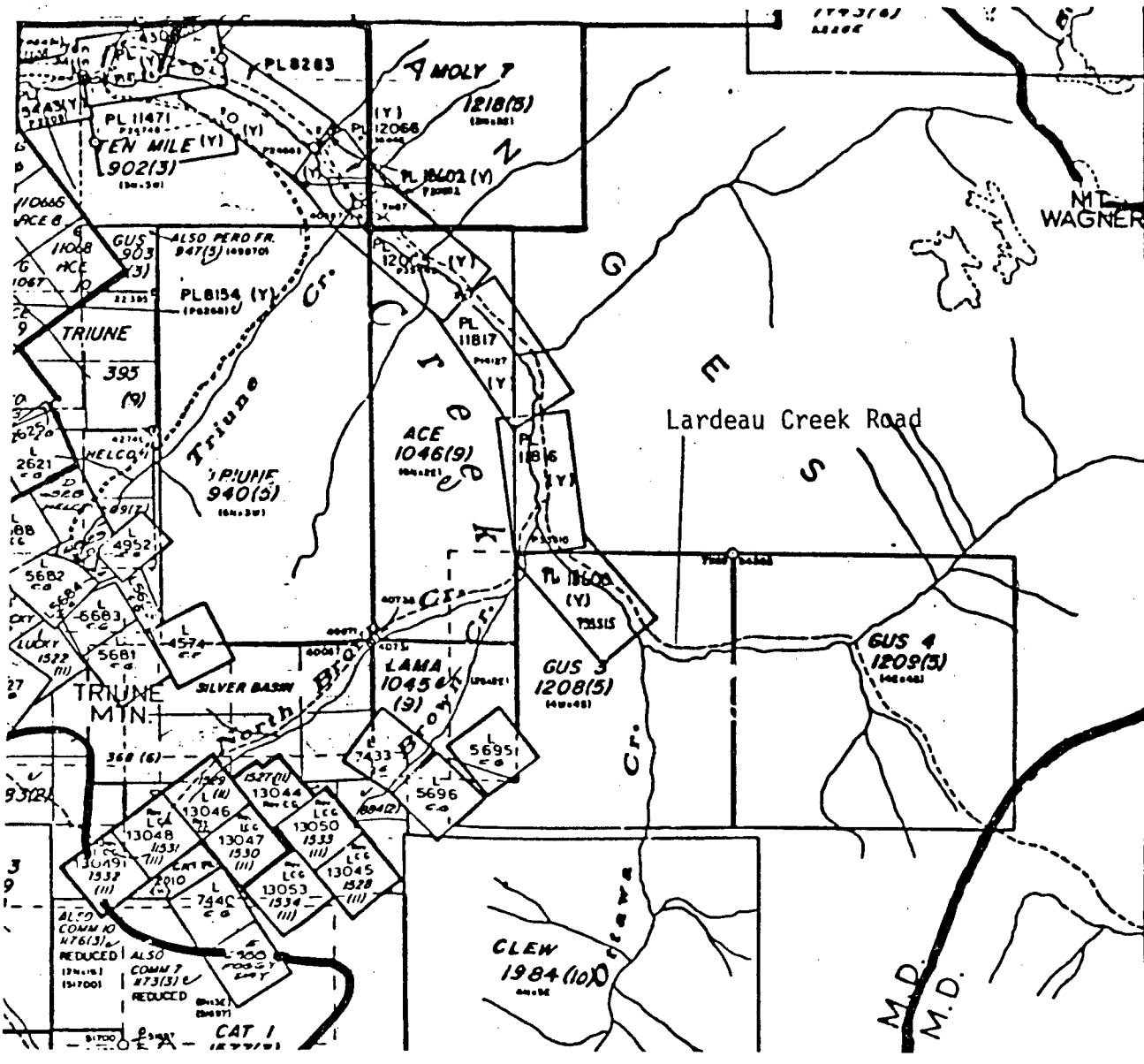

Index Map No. 1  
Claim Location and Access

Map Sheet No. 82K11W  
Mining Division: Revelstoke

REVERTED CU. MINERAL CLAIM  
FORFEITED MINERAL CLAIM  
VERIFIED LEGAL CORNER POST  
LEGAL SURVEY  
LEGAL CORNER POST & TAG NUMBER

## WORK SUMMARY

### Gus 3 Claim

- i) detailed prospecting along the south side of Lardeau Creek Road, (500m \* 500m area).
- ii) 10 rock samples collected along a quartz - carbonate vein traced intermittently over 100m
- iii) clean up slumped trench on vein for sampling (T-5)
- iv) helicopter reconnaissance of the surrounding area

### Gus 4 Claim

- i) detailed prospecting along north side of Lardeau Creek Road (approx 1 sq. km.)
- ii) traced two separate ultramafic units which showed minor pyrrhotite (possible platinum host)
- iii) collected 9 rock samples which are representative of ultramafics in this area
- iv) helicopter reconnaissance of the surrounding area

## GEOLOGIC DESCRIPTION

The Gus 3 and 4 Claims are situated near the southeastern end of the Central Mineral Belt ( a NW trending belt of of lead - zinc - silver occurrences). This belt comprises a complexly folded (NW strike) series of pale grey greywackes, pale green limestones and occasional mafic to ultramafic units. The latter are interpreted as volcanic flows. These rocks are believed to part of the Broadview Formation, a subdivision according to Reesor, (1976).

Prospecting and sampling was carried out in two principal areas as described below:

Location 1: Shear Zone / quartz - galena - pyrite vein

Prospecting was designed to locate a shear hosted quartz vein with scattered sulfide mineralization. The samples collected by prospectors Morvay, Matovich and McMullen comprise quartz and quartz - carbonate gangue material with sulfide contents of up to 75%.

Preliminary results have traced the mineralized zone across a strike length of some 70m within a pale grey, greywacke believed to be part of the Broadview Formation. The shear varies from 0.2 to 1.0m in width oriented along a NW (335 degrees) strike. Wall rocks display chloritic alteration immediately adjacent to the vein (alteration halo 10 - 20cm wide) and the vein itself is typically intensely oxidized (limonite / hematite).

Location 2: Ultramafic Units (possible host for platinum mineralization)

Prospecting was designed to locate dk. green - black metavolcanic units which reportedly host Nickel - Platinum mineralization. Two ultramafic horizons were located and sampled at intervals along strike (traced over some 600m each).

These rocks consist of dk. green - black, well foliated chlorite / pyroxene schists which contain minor amounts of pyrite and pyrrhotite. Sulfides commonly occur along foliation surfaces and typically comprise less than 2% of the samples examined. Assays returned no significant platinum anomalies however nickel, lead and zinc occur in significant concentrations (up to 0.2%). A narrow, shear zone (NW strike) returned no significant results despite intense limonitic staining along fractures.

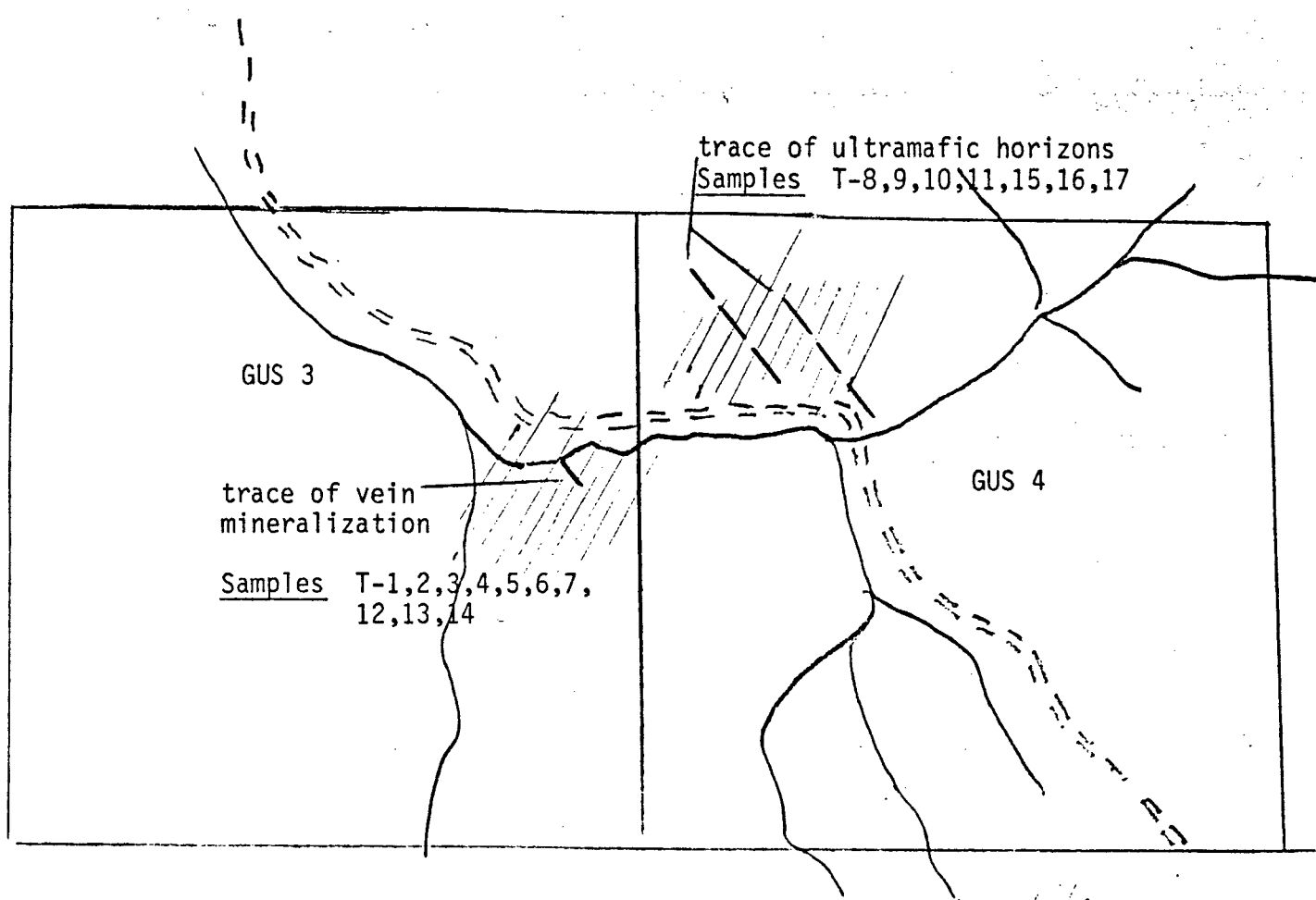

trace of ultramafic horizons  
Samples T-8,9,10,11,15,16,17

GUS 3

trace of vein mineralization  
Samples T-1,2,3,4,5,6,7,  
12,13,14

GUS 4

Plan Map No. 2  
Sample Locations

Scale: 1:25,000

- area prospected

NTS: 82K11W  
Mining Division: Revelstoke



TABLE 1  
ASSAY RESULTS

# LORING LABORATORIES LTD.

Page # 1

SAMPLE No.	OZ./TON GOLD	OZ./TON SILVER	OZ./TON PLATINUM	% As	% Bi	% MoS2
<u>"Chip Samples"</u>						
T- 1	.040	9.60	Trace	.06	.004	-
T- 2	Trace	.06	Trace	-	-	-
T- 3	1.260	28.88	Trace	.14	.004	-
T- 4	.140	18.46	Trace	.28	.003	-
T- 5	.340	20.10	Trace	.07	-	-
T- 6	1.060	9.78	Trace	-	-	-
T- 7	.070	.64	Trace	-	-	-
T- 8	.010	.18	Trace	Trace	.007	-
T- 9	.020	.42	Trace	.05	.007	-
T-10	.020	.12	Trace	.01	.005	-
T-11	.010	.24	Trace	-	-	-
T-12	.160	235.04	Trace	.23	.003	-
T-13	.040	.74	Trace	.03	-	-
T-14	.280	25.16	Trace	.15	.005	-
T-15	.020	.24	Trace	Trace	.005	-
T-16	.020	.32	Trace	.01	.010	-
T-17	.010	.12	Trace	Trace	-	-
T-18	.010	.28	Trace	-	-	-
T-19	.010	.06	Trace	-	-	-

I **Hereby Certify** THAT THE ABOVE RESULTS ARE THOSE  
ASSAYS MADE BY ME UPON THE HEREIN DESCRIBED SAMPLES . . .

Rejects Retained one month.  
Pulps Retained one month  
unless specific arrangements  
made in advance.

*Edm J. Mac*  
Licensed Assayer of British Columbia

SAMPLE No.	% Cu	% Pb	% Zn	% Ni	% Cd
"Chip Samples"					.01
13. T- 1	.06	2.71	1.03	-	-
T- 2	.01	.04	.01	.01	.02
T- 3	.25	18.03	3.10	-	.03
T- 4	.13	5.20	5.08	-	-
T- 5	.13	9.96	3.51	-	-
T- 6	.22	5.62	3.15	-	-
T- 7	.02	.28	.42	.01	.005
T- 8	.01	.04	.04	.10	.005
T- 9	.01	.06	.08	.07	Trace
T-10	.02	.04	.02	.03	-
T-11	.02	.04	.05	.03	.01
T-12	.18	62.82	.21	Trace	-
T-13	.01	.28	.08	-	.04
T-14	.32	2.16	5.96	-	-
T-15	.01	.04	.04	.12	.005
T-16	.01	.12	.05	.02	-
T-17	.01	Trace	.17	Trace	-
T-18	.01	-	-	Trace	-
T-19	.01	-	-	.01	-

I Hereby Certify THAT THE ABOVE RESULTS ARE THOSE  
 ASSAYS MADE BY ME UPON THE HEREIN DESCRIBED SAMPLES . . . .

Rejects Retained one month.  
 Pulp Retained one month  
 unless special arrangements  
 made in advance.

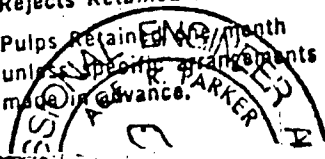

*E. L. M. J. A. C.*  
 Licensed Assayer of British Columbia

TABLE 2

Rock Sample Descriptions

Location 1: Shear zone / quartz - galena - pyrite vein

- T-1: (0.5m chip sample) quartz vein with 8-10% galena, minor pyrite, sphalerite
- T-2: (0.6m chip sample) quartz vein w/ less than 1% sulfides
- T-3: (grab sample from dump @ slumped trench) massive galena, sphalerite, pyrite - highly oxidized - abundant limonitic staining
- T-4: (0.2m chip sample) sheared phyllite with numerous quartz stringers, abundant galena, pyrite, sphalerite
- T-5: (0.5m chip sample) trench sample - quartz - carbonate vein w/ 15% galena, 5% sphalerite, abundant pyrite (Note high gold content associated with pyrite)
- T-6: (grab sample) massive pyrite - highly oxidized (Note high gold content) minor galena, sphalerite
- T-7: (1.0m chip sample) quartz - carbonate vein with minor sulfide (less than 1-2%)
- T-12: (grab sample) massive galena from dump adjacent to slumped trench
- T-13: (0.6m chip sample) quartz - carbonate vein w/ minor sulfide
- T-14: (0.4m chip sample) quartz - carbonate vein w/ abundant sulfide (5% galena, 10% sphalerite, 20% pyrite)

Location 2: Grab samples from ultramafic unit (possible Platinum host)

- T-8: (grab sample) dk. green - black ultramafic - minor pyrite, pyrrhotite - epidote alteration
- T-9: (grab sample) as T-8
- T-10: (grab sample) dk. green metavolcanic - minor pyrite, pyrrhotite along foliation surfaces

T-11: (grab sample) as T-10

T-15: (grab sample) dk. green - black ultramafic - 1-2%  
pyrite, pyrrhotite (Note nickel content 0.12%)

T-16: (0.5m chip sample) highly oxidized shear in dk. green  
ultramafic (shear @ 325/85 NE), nil sulfides

T-17: (grab sample) dk. green - black metavolcanic, minor  
pyrite, pyrrhotite

T-18: (grab sample) as T-17

T-19: (grab sample) as T-17

ITEMIZED COST STATEMENT

General prospecting and rock sampling

Personnel	
A. Morvay -4 days @ 125.00	500.00
D. McMullen -4 days @ 100.00	400.00
A. Matovich -4 days @ 100.00	400.00
Mobilization / Travel expense (Vancouver - Trout Lake Return)	850.00
Camp / Accommodation - 12 man days @ 55.00	660.00
Fuel and supplies	365.00
Shipping (Samples to Vancouver)	110.00
Helicopter Charter - 3.4 hrs (Reconnaissance and Sample pickup)	1,611.00
Assay costs - 19 samples @ 43.00 (Au, Ag, Pt, As, Bi, MoS <sub>2</sub> , Cu, Zn, Pb, Ni, Cd.)	817.00
Preparation of Report	
C. von Einsiedel - 1 day @ 275.00	275.00
Secretarial / Photocopying	300.00
Maps, etc.	130.00
Total Cost	\$6,418.00 =====