

9/86

**GEOLOGICAL BRANCH
ASSESSMENT REP.**

14,629

WESTMIN RESOURCES LTD.

ASSESSMENT REPORT

TASEKO PROPERTY

SOIL GEOCHEMISTRY

BLUFF 9 and BLUFF 10 MINERAL CLAIMS
Clinton Mining Division
NTS 92 0/3W
Lat. 51°07'N Long. 123°19'W
December 19, 1985

FILMED

TABLE OF CONTENTS

	<u>PAGE</u>
I INTRODUCTION	1
A. Exploration Target	1
B. Location, Access and Topography	1
II SOIL GEOCHEMISTRY	1
A. Sampling	1
B. Analysis	1
C. Results	2
III EXPENDITURES	2
IV STATEMENT OF QUALIFICATIONS	3
V ATTACHMENTS	
Taseko Property - 20,000 E Grid	
Figure 2: Location Map, scale 1:50,000	
Figure 75: Au soil geochemistry, scale 1:1,000	
Figure 76: Ag soil geochemistry, scale 1:1,000	
Figure 79: Pb soil geochemistry, scale 1:1,000	
Figure 80: Cu soil geochemistry, scale 1:1,000	

I. INTRODUCTION

A. Exploration Target

Taseko Project exploration target is bulk tonnage gold deposits.

B. Location, Access, Topography

Taseko Property is located in southwestern British Columbia, 200 km. due north of Vancouver. It occurs within the Clinton Mining Division and on the 92 0/3 map sheet at 51.11° latitude and 123.35° longitude.

Access is via road or plane from Williams Lake, 140 km to the northeast. Four wheel drive is required for a few sections of the road near the property.

Relief varies from gentle to steep, and the surrounding terrain is mountainous. Maximum elevation on Bluff 9 and 10 is 2316 m.

Vegetation is subalpine to alpine.

II. SOIL GEOCHEMISTRY

A. Sampling

Fifty-one ~~thirty-one~~ soil samples were collected from the B horizon at 50 m intervals along grid lines spaced 200m apart. Grid lines were established by chain and compass.

B. Analysis

Samples were analyzed by Chemex Labs Ltd., 212 Brooksbank Ave., North Vancouver. Copper, lead and silver analysis were by atomic absorption; gold analysis was by fire assay pre-concentration and atomic absorption finish.

C Results

Results are reported on figures 75, 76, 79 and 80. Anomalous thresholds were calculated statistically from an adjacent, much larger data set, and are as follows: Au - 40 ppb, Ag - 1.0 ppm, Cu - 100 ppm and Pb - 40 ppm. Anomalous areas are outlined on the figures by contouring.

III EXPENTITURES

Labor - Sample collection (0.5 man days)	\$ 50.00
Food and Accomodation	\$ 25.00
Drafting, Reproduction and Report Writing	\$ 50.00
Transportation	\$ 25.00
Analysis and sample preparation (31 samples @ 10.75/sample)	\$ 333.25
Total expenditure	\$ 483.25

Analysis and sample preparation (20 samples @ 10.75/sample)	\$ 215.00
Total expenditure	\$ 215.00

→ 698.25

IV STATEMENT OF QUALIFICATIONS

I, Ron Lane, of 7673 Sutton Place, North Delta, B.C., graduated from the University of Alberta, Edmonton, Alberta, in 1971, with a Bachelor of Science - Geology. Since graduation I have worked on a continuous basis as an exploration geologist in Alberta, British Columbia, Yukon Territory, Northwest Territories, Southern Africa and Italy.

I personally supervised the geochemical work described in this report.



Ron Lane
Project Geologist
Westmin Resources Ltd.

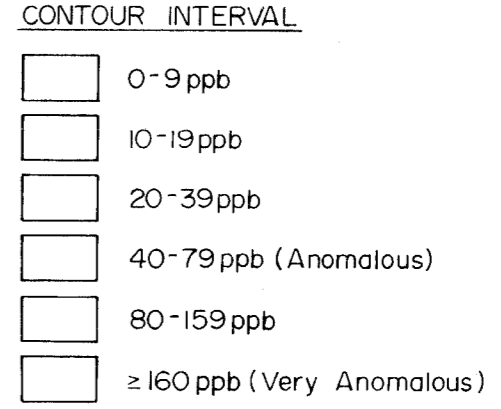
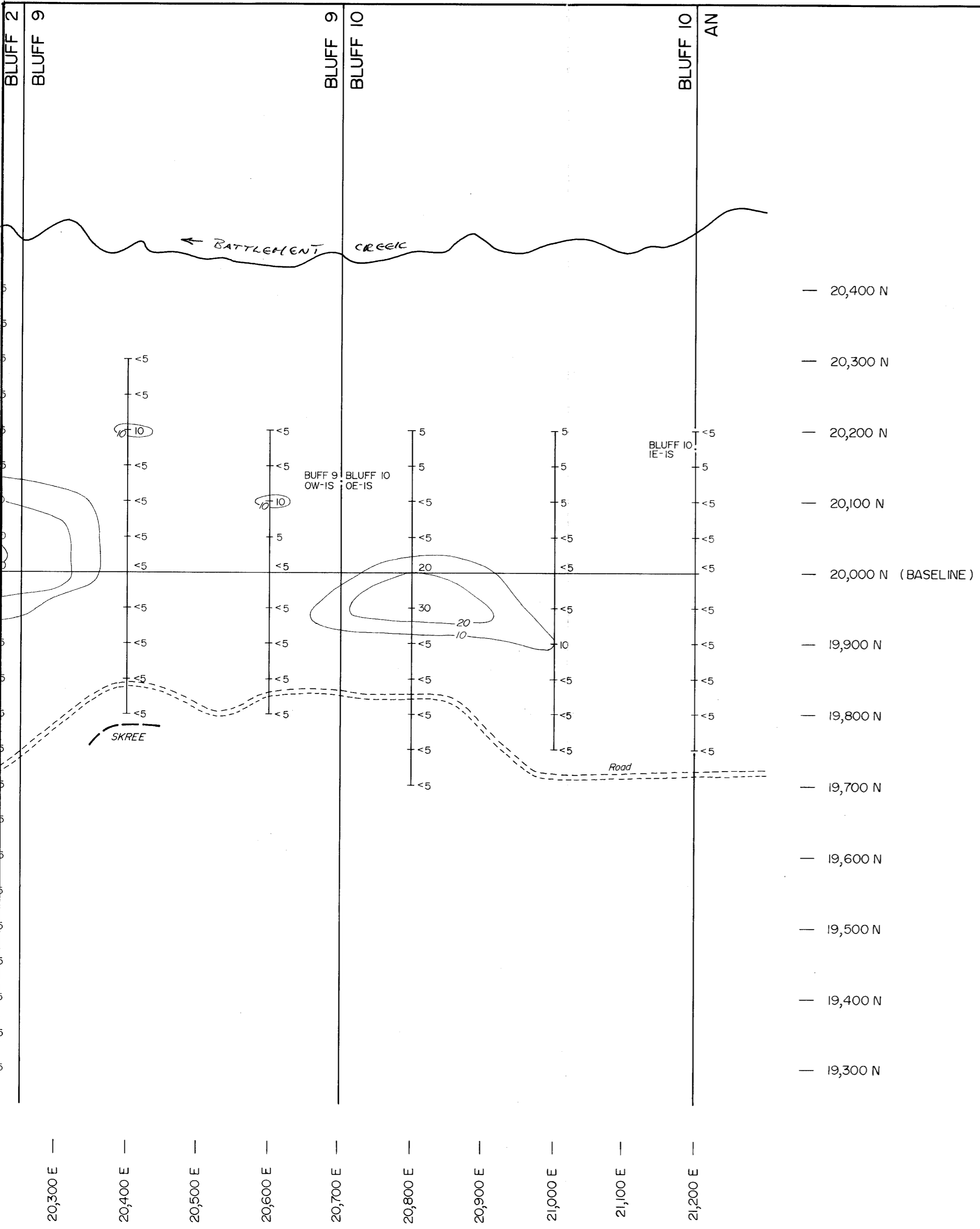

**GEOLOGICAL BRANCH
ASSESSMENT REPORT**

14,629

Westmin Resources Limited MINING DIVISION	
Work By R.W. Lane Date Drafted October 1984 Drafted By R.A. Ivany Date Revised Revised By N.T.S. Number 92 0/3	TASEKO PROJECT 20,000 E GRID Au SOIL GEOCHEM
	 SCALE 1:5,000
	Figure 75

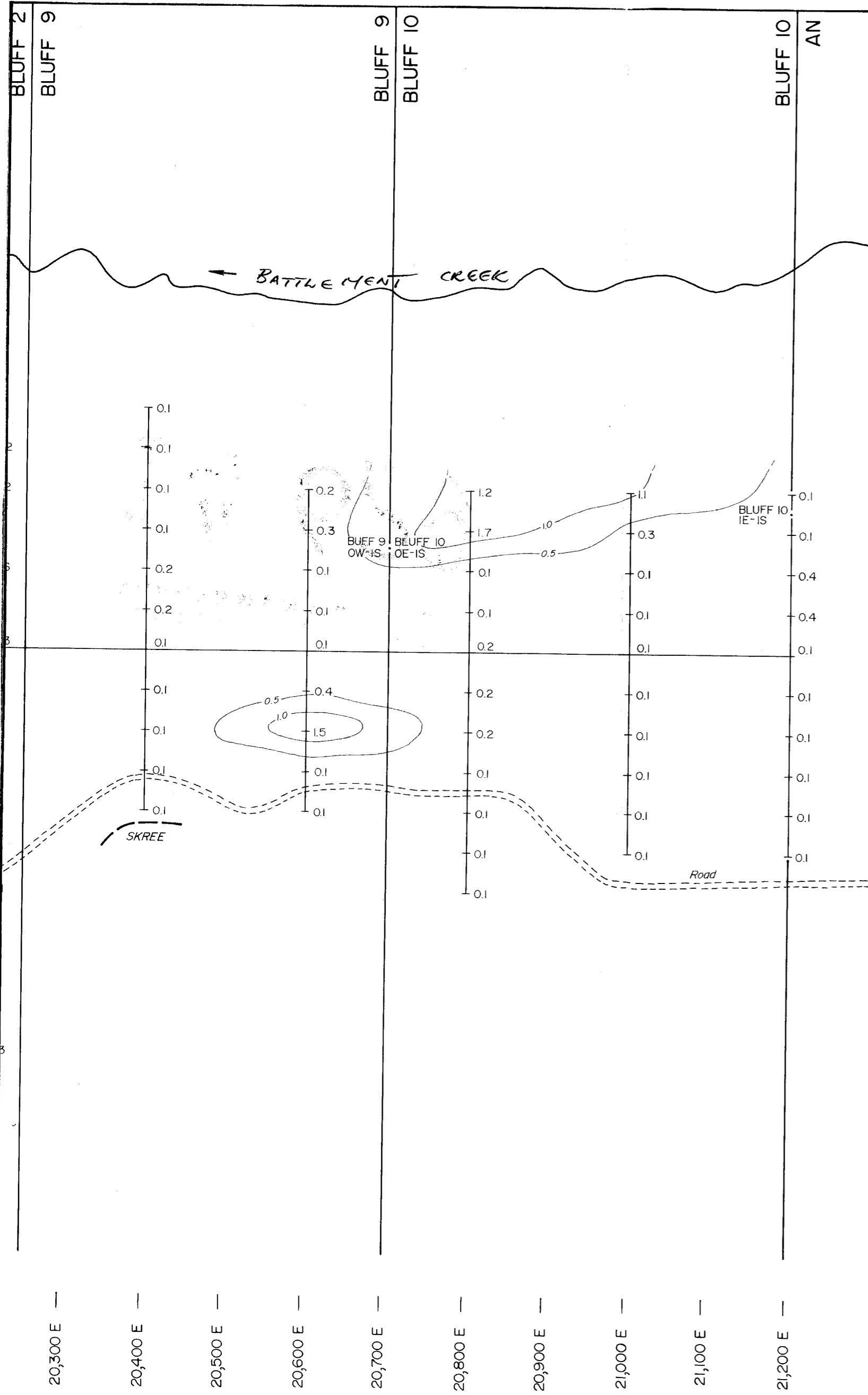

— 20,400 N
 — 20,300 N
 — 20,200 N
 — 20,100 N
 — 20,000 N (BASELINE)
 — 19,900 N
 — 19,800 N
 — 19,700 N
 — 19,600 N
 — 19,500 N
 — 19,400 N
 — 19,300 N

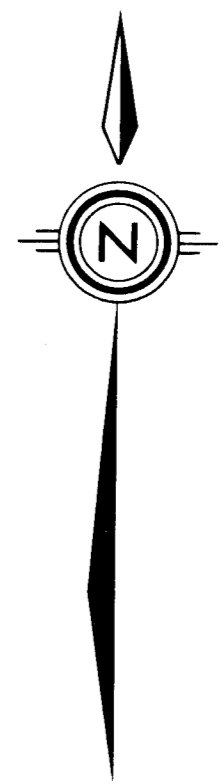

CONTOUR INTERVAL

□	0.1-0.4 ppm
□	0.5-0.9 ppm
□	1.0-1.9 ppm (Anomalous)
□	2.0-3.9 ppm
□	≥ 4.0 (Very Anomalous)

**GEOLOGICAL BRANCH
 ASSESSMENT REPORT**

14,629

		Westmin Resources Limited MINING DIVISION	
Work By	R.W. Lane	TASEKO PROJECT 20,000 E GRID Ag SOIL GEOCHEM	
Date Drafted	October 1984		
Drafted By	R.A. Ivany		
Date Revised			
Revised By			
N.T.S. Number	92 0/3	 SCALE 1:5,000	
		Figure 76	

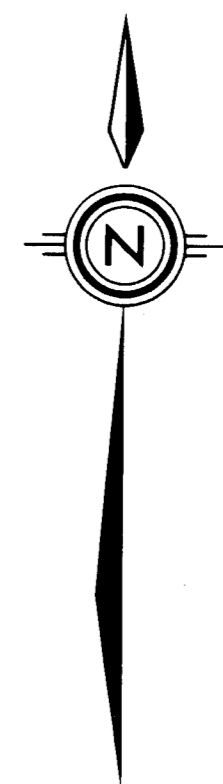
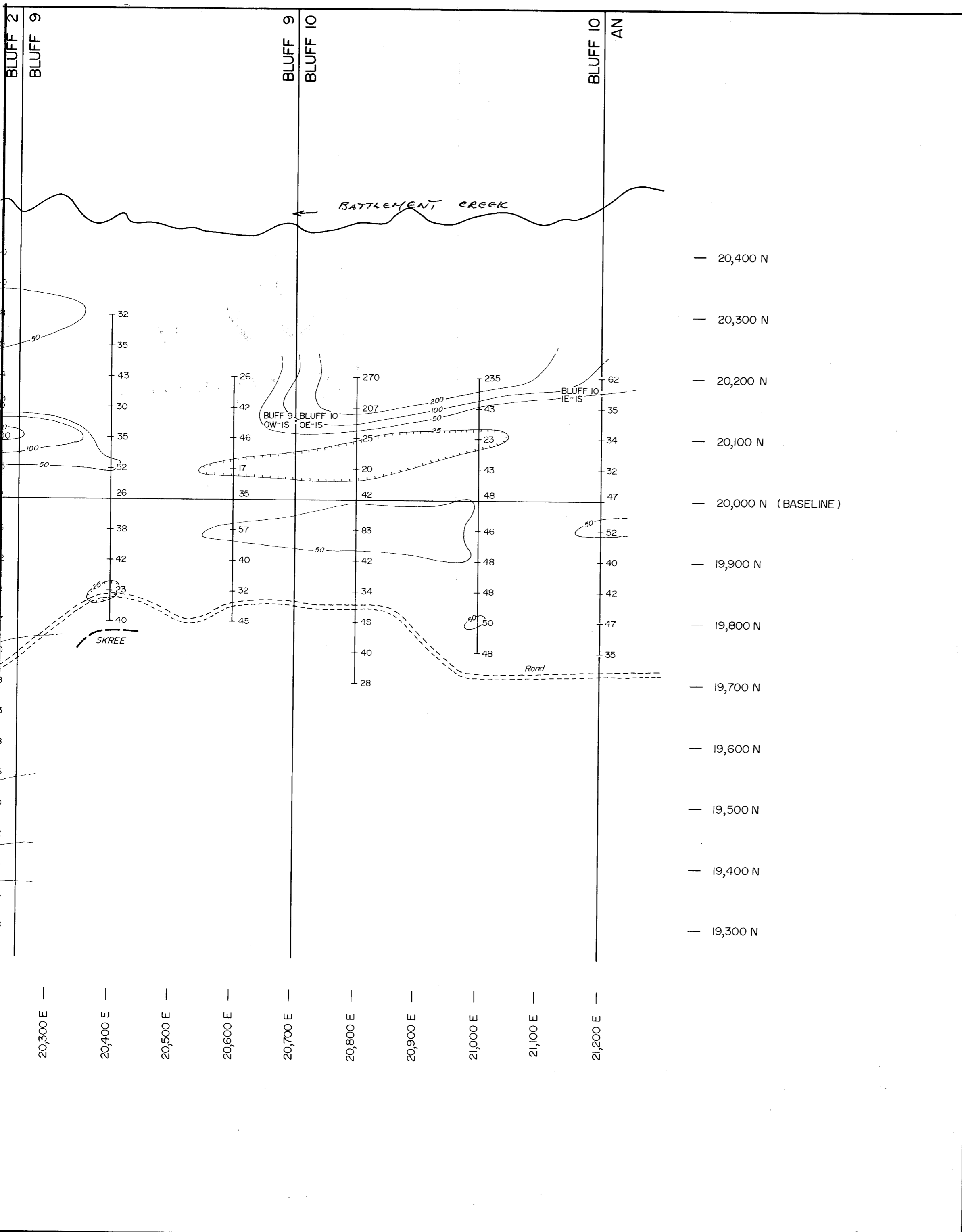

— 20,400 N
 — 20,300 N
 — 20,200 N
 — 20,100 N
 — 20,000 N (BASELINE)
 — 19,900 N
 — 19,800 N
 — 19,700 N
 — 19,600 N
 — 19,500 N
 — 19,400 N
 — 19,300 N

CONTOUR INTERVAL

0-24 ppm
25-49 ppm
50-99 ppm
100-199 ppm (Anomalous)
≥200 ppm

**GEOLOGICAL BRANCH
 ASSESSMENT REPORT**

14,629

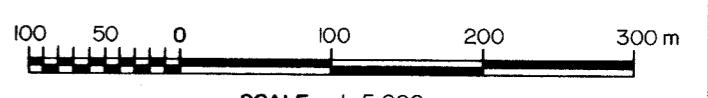
 Westmin Resources Limited MINING DIVISION	
Work By R.W. Lane Date Drafted October 1984 Drafted By R.A. Ivany Date Revised Revised By N.T.S. Number 92 0/3	<p style="text-align: center;">TASEKO PROJECT</p> <p style="text-align: center;">20,000 E GRID Cu SOIL GEOCHEM</p> <p style="text-align: right;"><i>RW</i></p>
SCALE 1:5,000 	Figure 80

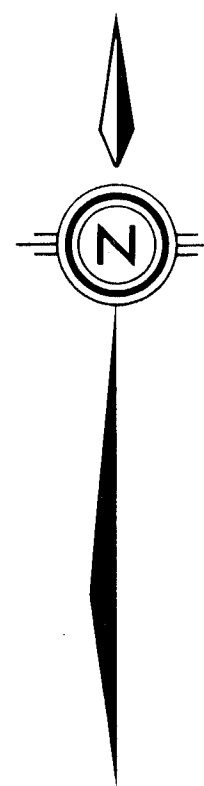
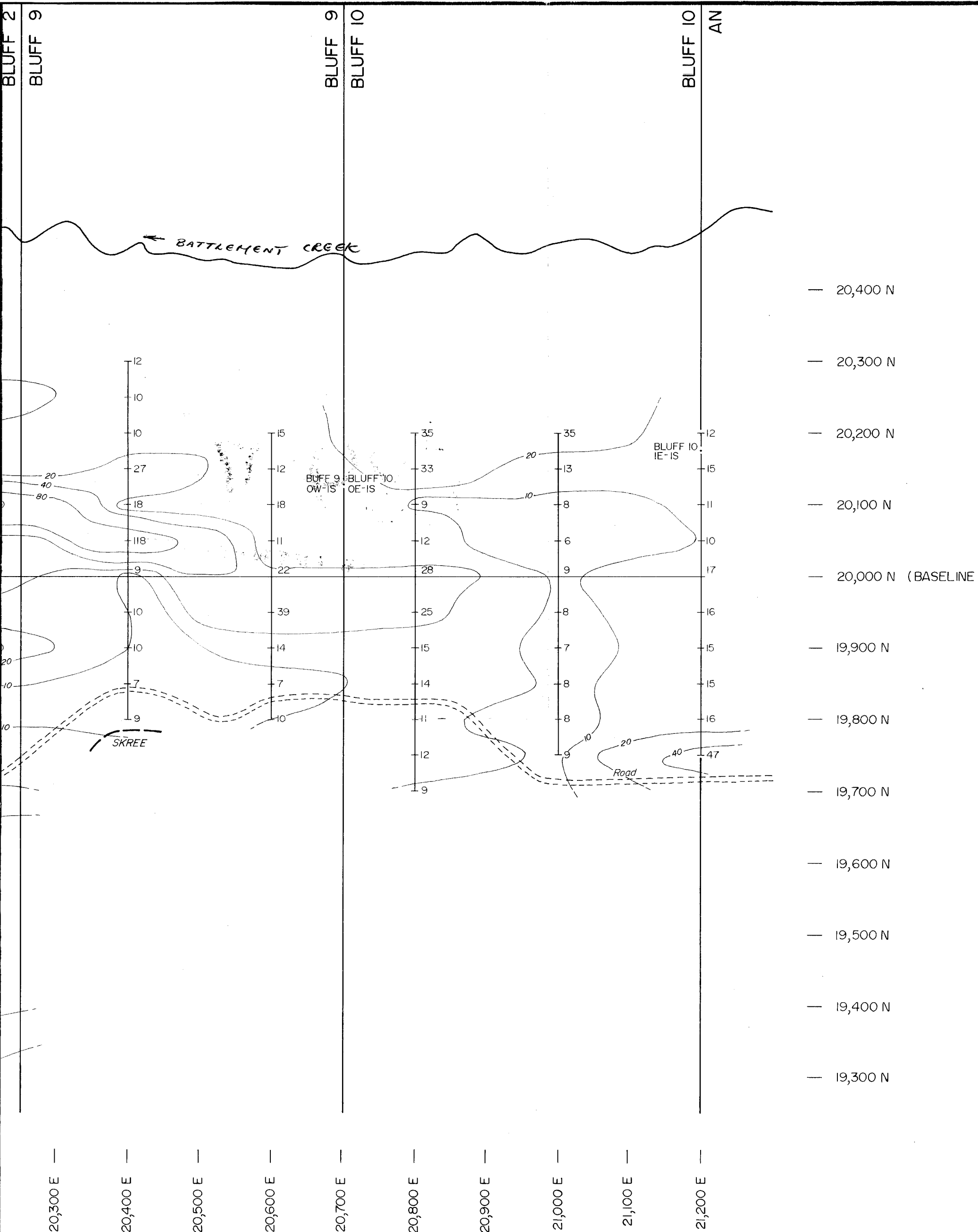

CONTOUR INTERVAL

- 0-9 ppm
- 10-19 ppm
- 20-39 ppm
- 40-79 ppm (Anomalous)
- ≥ 80 ppm

**GEOLOGICAL BRANCH
ASSESSMENT REPORT**

14,629

Westmin Resources Limited MINING DIVISION													
<table border="1" style="width: 100%; border-collapse: collapse;"> <tr><td style="font-size: small;">Work By</td><td>R.W. Lane</td></tr> <tr><td style="font-size: small;">Date Drafted</td><td>October 1984</td></tr> <tr><td style="font-size: small;">Drafted By</td><td>R.A. Ivany</td></tr> <tr><td style="font-size: small;">Date Revised</td><td></td></tr> <tr><td style="font-size: small;">Revised By</td><td></td></tr> <tr><td style="font-size: small;">N.T.S. Number</td><td>92 0/3</td></tr> </table>	Work By	R.W. Lane	Date Drafted	October 1984	Drafted By	R.A. Ivany	Date Revised		Revised By		N.T.S. Number	92 0/3	<p>TASEKO PROJECT</p> <p>20,000E GRID Pb SOIL GEOCHEM</p> <p style="text-align: right;"><i>RW</i></p>
Work By	R.W. Lane												
Date Drafted	October 1984												
Drafted By	R.A. Ivany												
Date Revised													
Revised By													
N.T.S. Number	92 0/3												
SCALE 1:5,000		Figure 79											

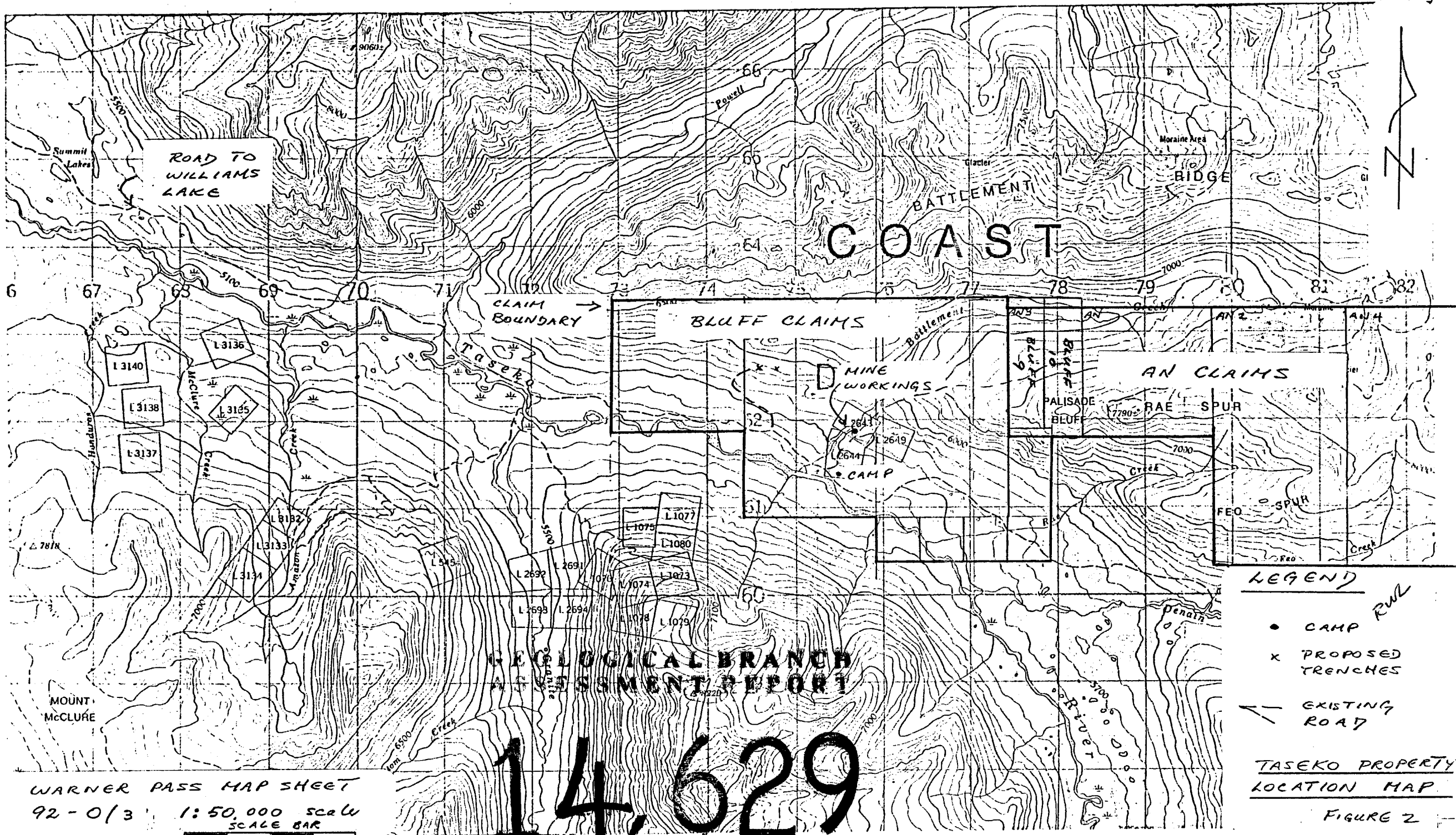

ROAD TO WILLIAMS LAKE

COAST

BLUFF CLAIMS

AN CLAIMS

MINE WORKINGS

CAMP

GEOLOGICAL BRANCH
ASSESSMENT REPORT

14,629

LEGEND

- CAMP
- x PROPOSED TRENCHES
- EXISTING ROAD

TASEKO PROPERTY
LOCATION MAP

FIGURE 2

WARNER PASS MAP SHEET

92-0/3 1:50,000 scale

