

14675

GEOCHEMICAL & DIAMOND DRILLING REPORT

ON

'B' CLAIM

OMINECA MINING DIVISION

FAWNIE NOSE AREA

FILMED

LATITUDE: 53° 19'
LONGITUDE: 125° 10'

NTS 93 F/6 E

**GEOLOGICAL BRANCH
ASSESSMENT REPORT**

HELD BY:

GRANGES EXPLORATION LTD.
900, 625 HOWE STREET
VANCOUVER, B. C.
V6C 2T6

14,675

SEPTEMBER 17, 1985

G. W. ZBITNOFF, P. ENG.
(J. J. LEADER)

TABLE OF CONTENTS

	PAGE
INTRODUCTION.....	1
LOCATION & ACCESS.....	1
PHYSIOGRAPHY.....	1
GEOLOGY.....	1
GEOCHEMICAL SURVEY.....	2
RESULTS.....	2
DIAMOND DRILLING.....	2
COST BREAKDOWN.....	3
AUTHORS QUALIFICATIONS.....	4

ENCLOSURES

1 PLAN SHOWING DRILL HOLE LOCATION	SCALE	1:5000
1 PLAN SHOWING SOIL SAMPLING	SCALE	1:1000

INTRODUCTION

During the period of July 1st to July 26th, 1985, Granges personnel under the supervision of S. Weekes and directed by G. Zbitnoff, undertook a small soil sampling and Winkie diamond drilling program on the 'B' claim near Green lake. The purpose of the program was to further investigate anomalous gold and silver results and showings, located by previous programs.

LOCATION AND ACCESS

CLAIM	RECORD #	DATE	UNITS
B	150	Sept. 26th	18

The 'B' claim is located in the Omineca Mining Division at latitude 53° 19' and longitude 125° 10'. The claim lies approximately 114 Km SE of Vanderhoof, and covers Green Lake and the surrounding area.

Access is via helicopter from Burns lake, approximately 115 Km to the northwest.

The claim is held by Granges Exploration Ltd. for a joint venture agreement with Cominco Ltd.

PHYSIOGRAPHY

The claim lies on a rugged portion of the Fawnie Range, with the elevation ranging from 1495 m at Green Lake to 1828 m in the south and 1676 m in the north. Much of this area is covered by talus.

GEOLOGY

According to G.S.C. Memoir 324, 'Nechako River Map area, British Columbia', the 'B' claim is underlain by the Takla group (unit 2) which consists of andesite and basaltic flows, tuffs and breccias, interbedded argillite and minor limestones. Much of the slopes are talus covered and the ridges are rusty due to the pyritic weathering.

GEOCHEMICAL SURVEY

A small, 14 sample, program of soil sampling was conducted over the area of a previously located showing on July 25th, 1985. The samples were assayed for Mo, Cu, Pb, Zn, Ag, Mn, As, Sb, Ca, Ba and Au.

Soil samples of the Upper 'B' horizon were obtained at an average depth of 0.3 meters with the use of augers. The samples were taken at 25 m spacings on a previously surveyed regular grid. The samples were then placed in Kraft soil envelopes and delivered to Acme Analytical Laboratories Ltd., 852 East Hastings St., Vancouver, B. C. The samples are dried for approximately 16 hours at 75° centigrade and sieved to -80 mesh. A .5 gram sample is digested with diluted Aqua Regia in a boiling water bath and diluted to 10 mls. with demineralized water. A 10 gram sample is used for Au. All the above elements are determined by a direct reading plasma spectrometer analysis (ICP).

DISCUSSION OF RESULTS

Values obtained were not of great significance - the most notable was a coincident reading of 95 ppb Au, 2.1 ppm Ag and 263 ppm Zn. The values obtained are plotted on the accompanying plan.

DIAMOND DRILLING

One Winkie diamond drill hole was drilled for a total of 7.62 m. This hole -GL 1- was drilled by Granges personnel during the period of July 9th to July 24th, 1985. The hole was drilled to test a high Au value (140 ppb) located on a small sampling program at 11+05 N and 39+20E. The program was supervised by S. Weekes, Geologist for Granges Exploration Ltd. No interesting values were obtained but for more information please see appended log and record sheets, or view core at Granges' Vanderhoof location.

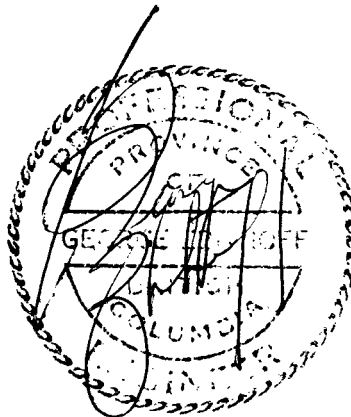

COST BREAKDOWN

PERSONNEL

S. WEEKES	JULY 9TH - JULY 25TH	@ \$65/DAY	\$1105.00
k. TAYLOR	" " " "	" "	\$1105.00
14 SOIL SAMPLES	@ \$9.60		\$ 134.50
4 CORE SAMPLES	@ \$17.75		71.00
CAMP COSTS - 34 MAN DAYS	@ \$40.00		1360.00
ALPINE HELICOPTERS	5.7 HRS. @ \$450.00/2		1282.50
	3.7 HRS. FUEL & OIL @ \$76/2		141.00
REPORT PREPARATION	2 DAYS @ 92.00		184.00
ADMINISTRATION			<u>538.29</u>
TOTAL			\$5921.19

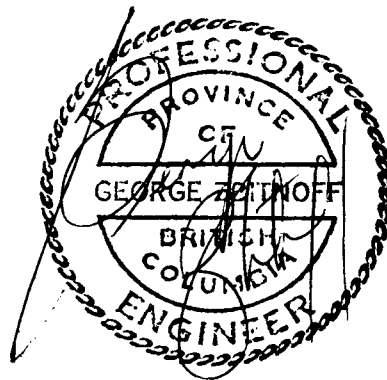

GRANGES EXPLORATION LTD.

STATEMENT OF QUALIFICATIONS

Name: Zbitnoff, George Wm.

Profession: Geologist

Professional Associations: Member of the Association of Professional Engineers of the Province of Manitoba
- Member of the Association of Professional Engineers of the Province of British Columbia since 1973.
- Member of the Canadian Institute of Mining and Metallurgy.

Experience: Pre graduation experience in geology with the Department of Mineral Resources of Saskatchewan.
- Two and a half years, field geologist with Hudson Bay Exploration and Development, Central Canada.
- Six years, field and resident geologist with Noranda Exploration Ltd., Central Canada.
- Fourteen years geologist and Vice-President at Granges Exploration Ltd. Vancouver, B. C.

- Active geological experience in all provinces of Canada and parts of the United States and Mexico.

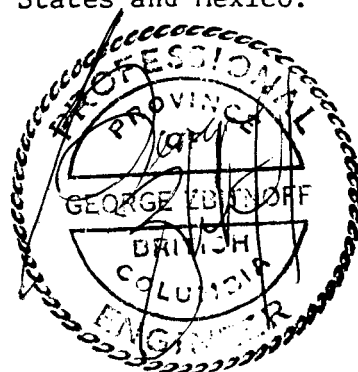

STATEMENT OF QUALIFICATIONS
SCOTT M. WEEKES
1012 BELMONT AVE.
NORTH VANCOUVER, B.C.

NAME: Weekes, Scott Macdonald

BIRTHDATE: July 18, 1961

BIRTHPLACE: Moose Jaw, Saskatchewan

Graduated from Handsworth Secondary School, North Vancouver, B.C.
in 1979.

Graduated from the University of British Columbia with a B.Sc.
Geology major.

EXPERIENCE:

Summers 1980 - 1984

- (1) Field geologist - Granges Exploration Ltd.
 - Involved in all aspects of mineral exploration.

1984 - Present

- (1) Project geologist, Granges Exploration Ltd.
 - Supervision of diamond drill projects.
 - Supervision of regional exploration work.
 - Prospecting and mapping.

ACME ANALYTICAL LABORATORIES LTD.

TELEPHONE: 253-3158

852 East Hastings St., Vancouver, B.C. V6A 1R6

FAX: ~~253-3158~~

Date: AUG 12 1985

GRANGES EXPLORATION LTD
 900 - 625 HOWE ST
 VANCOUVER B.C.
 V6C 2T6

TERMS:
 NET TWO WEEKS
 2% PER MONTH CHARGED ON
 OVERDUE ACCOUNTS.

NUMBER	ASSAY	PRICE	AMOUNT
14	GEOCHEM MO CU PB ZN AG MN AS SB CA & BA ASSAYS @	5.00	70.00
14	GEOCHEM AU ASSAY @	4.00	56.00
14	SOIL SAMPLE PREPARATION @	.60	8.40
			134.40
	10 % DISCOUNT		-13.4
	LOOMIS # 7327148 - TO FOLLOW		
	TOTAL		121.00



GEOLOGICAL BRANCH
ASSESSMENT REPORT

24,675

PLEASE PAY LAST AMOUNT →

ENTERED



**GRANGES EXPLORATION LTD.
DIAMOND DRILL LOG**

Property Green Lake Project No. 113 Depth 7.62 Date Began JULY 9th 1985
 Hole No. GL 1 Co ord. 11+05 N Horizontal Length _____ Date Completed JULY 24th 1985
 Claim No. B claim 39+20 E Core Size EXT Drilled By K Taylor
 Grid No. _____ Angle & Direction -60° NW Elevation _____ Logged By S. Weekes

INTERVAL FEET/METRES	DESCRIPTION	SAMPLE RECORD							
		FROM	TO	WIDTH	SAMPLE	Au.	Ag.	Cu.	Zn.
0-4.26	Casing								
4.26-7.62	Dark to light Grey Rhyolite Tuff - minor qtz fracture filling - minor qtz blebs	4.26	5.33	1.07	3376	.05	1.0		
	5.33-5.94 Brecciated section qtz infilling minor calcite	5.33	5.94	0.61	3377	.05	.5		
	5.94-7.62 Rhyolite becomes more altered down hole epidot minor clay	5.94	6.70	0.76	3378	.05	1.0		
		6.70	7.62	0.92	3379	.05	.5		
	End of Hole								
	Mineralization								
	0-7.62 15% py - diss. and blebby (minor sections to 20% py)								

**GEOLOGICAL BRANCH
ASSESSMENT REPORT**

14,675

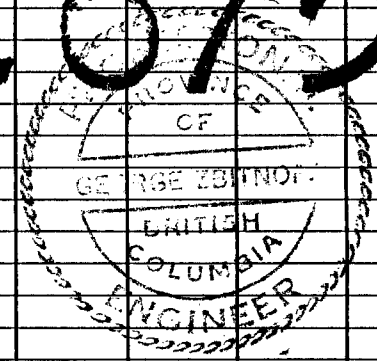

GEOLOGICAL BRANCH
ASSESSMENT REPORT

14,675

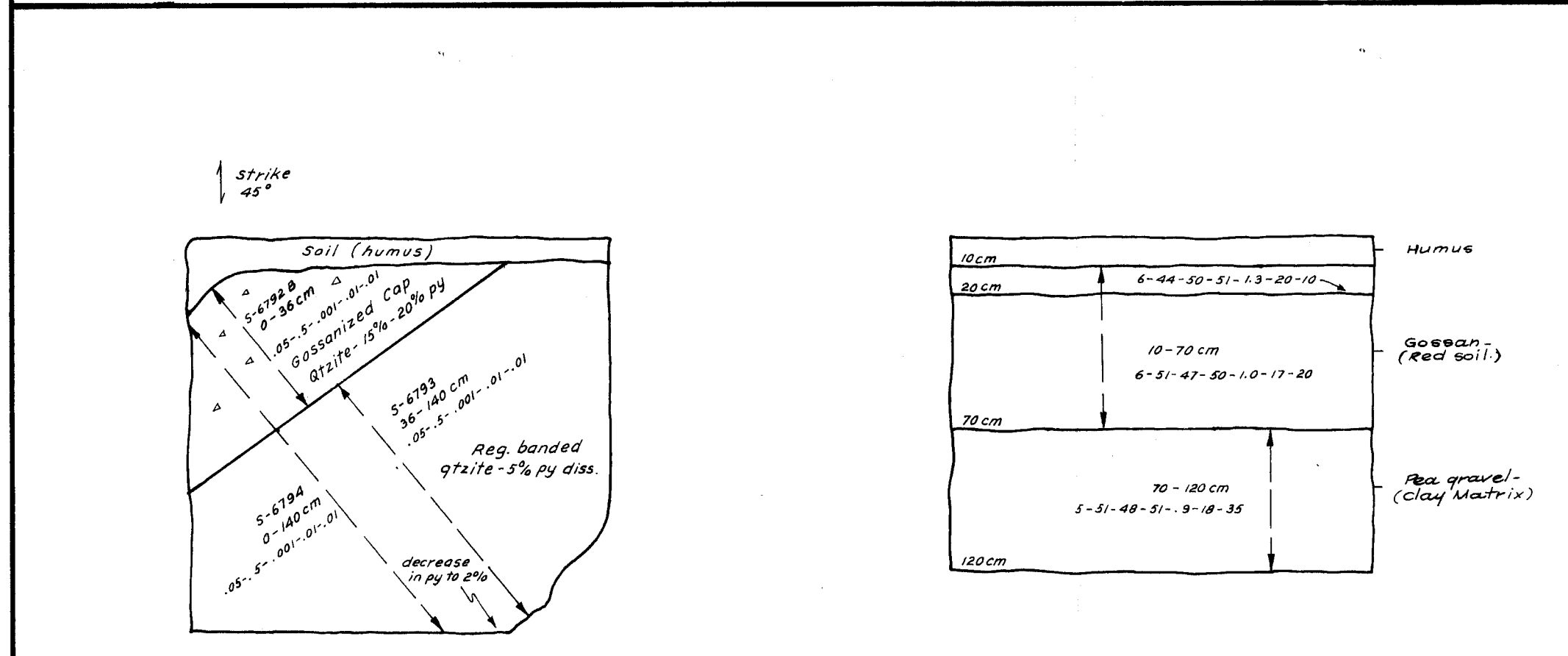
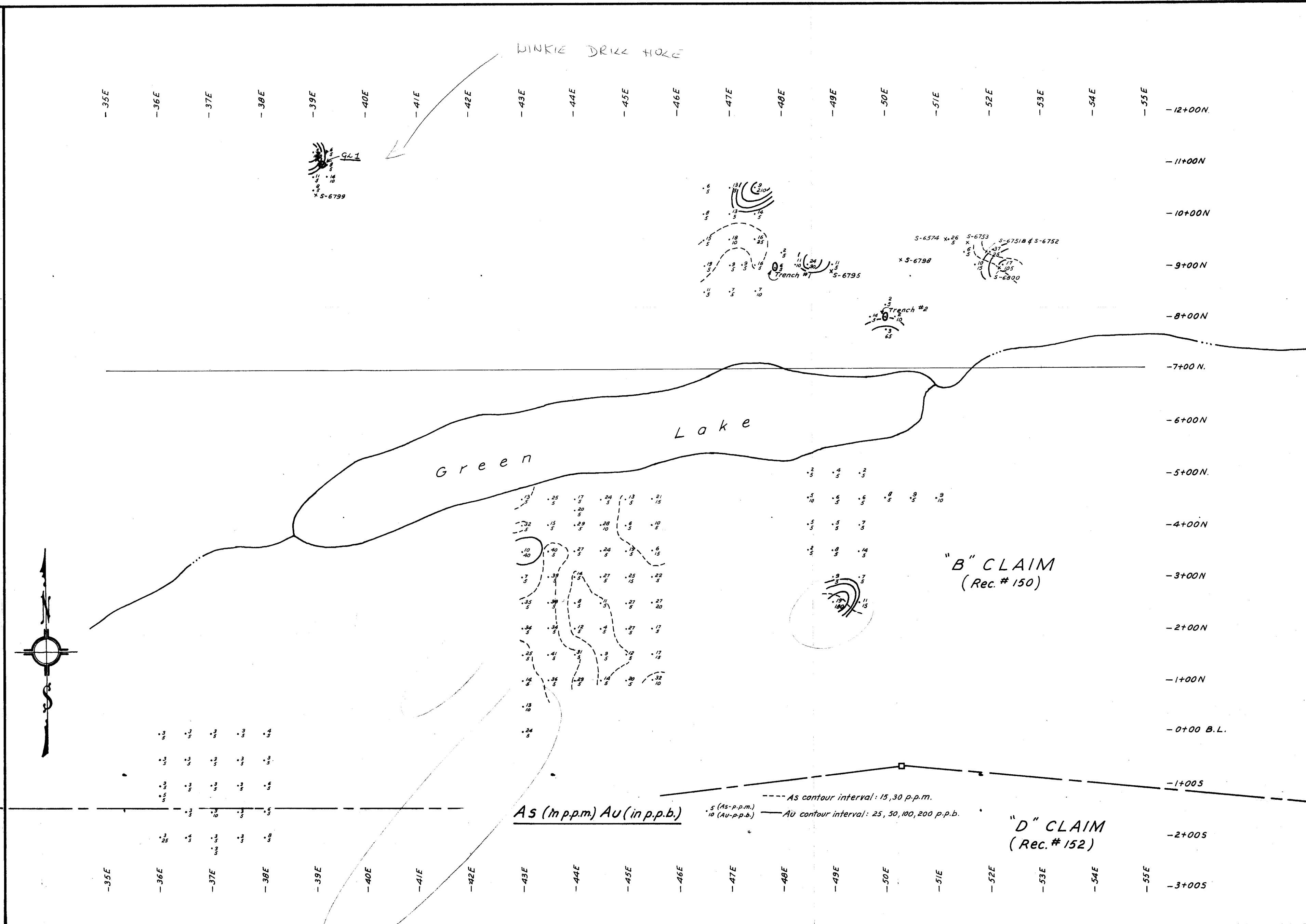
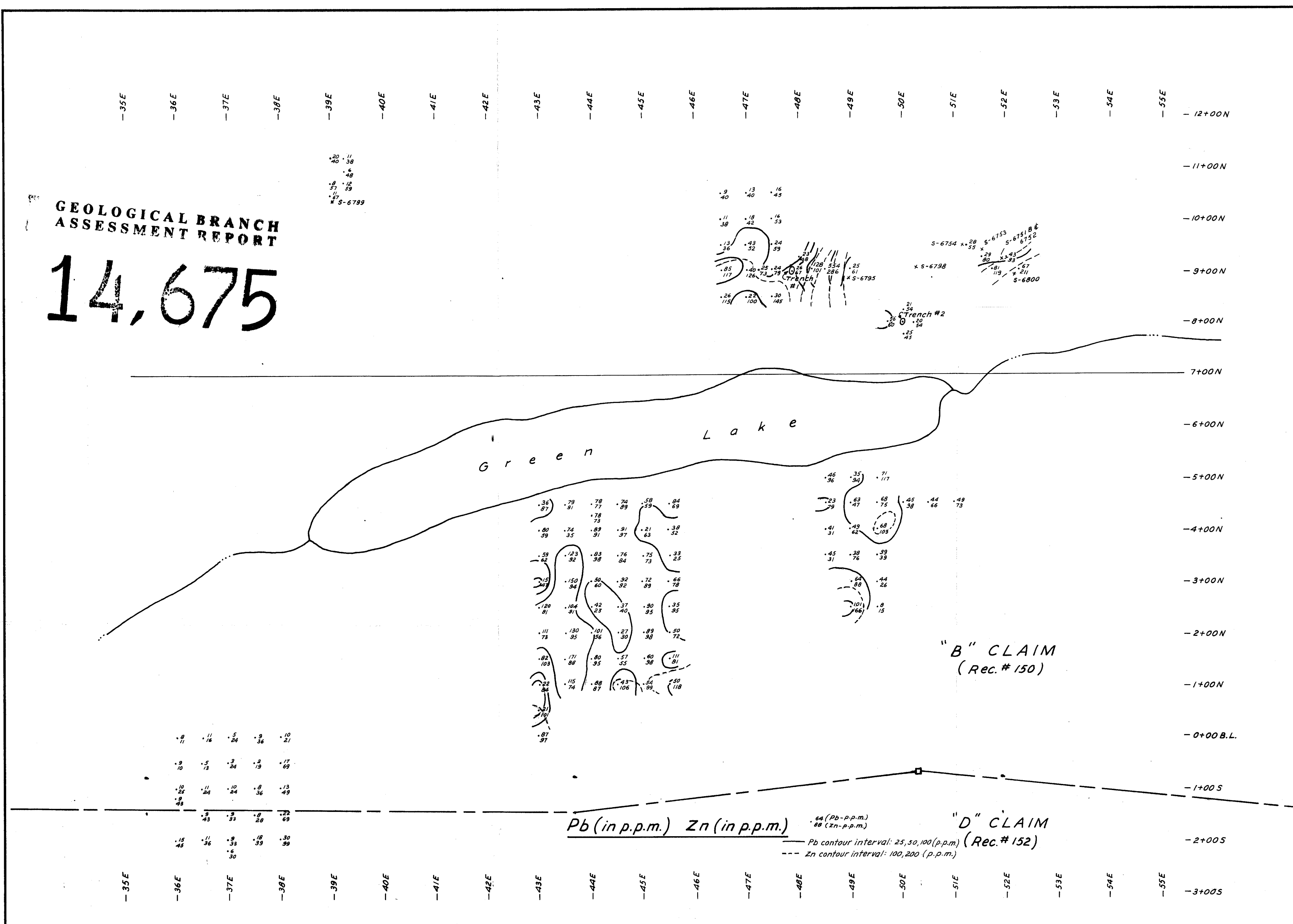

KEY: 02, 4, 001, 01, 01, 06 (Agm%), 13 (Agm%), 00 (Mo %), 01 (Cu %), 01 (Zn %)

TRENCH # 1
47+80E - 3+00N
Scale 1:200

TRENCH # 2
50+00E - 8+00N
Scale 1:200

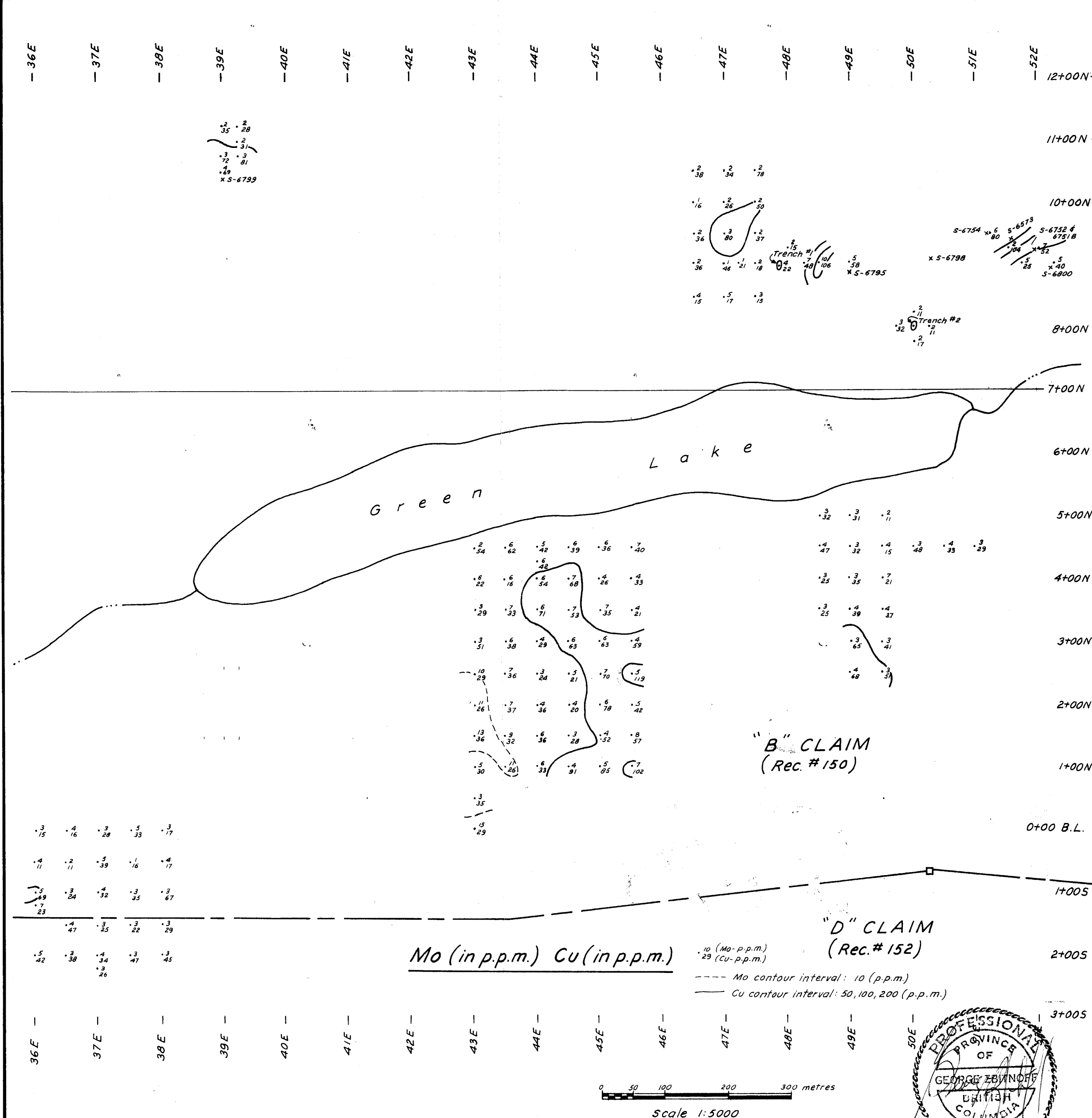
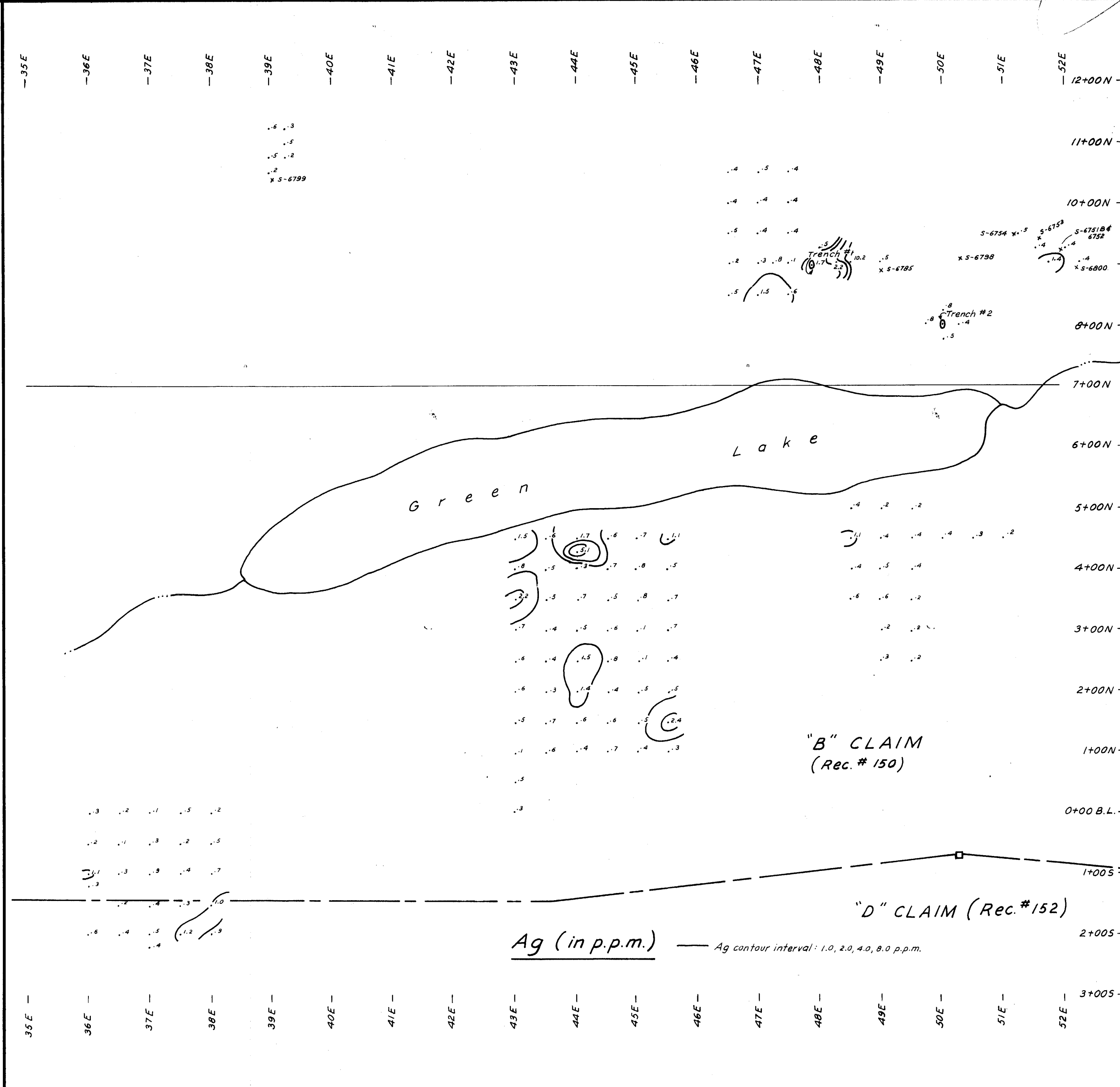
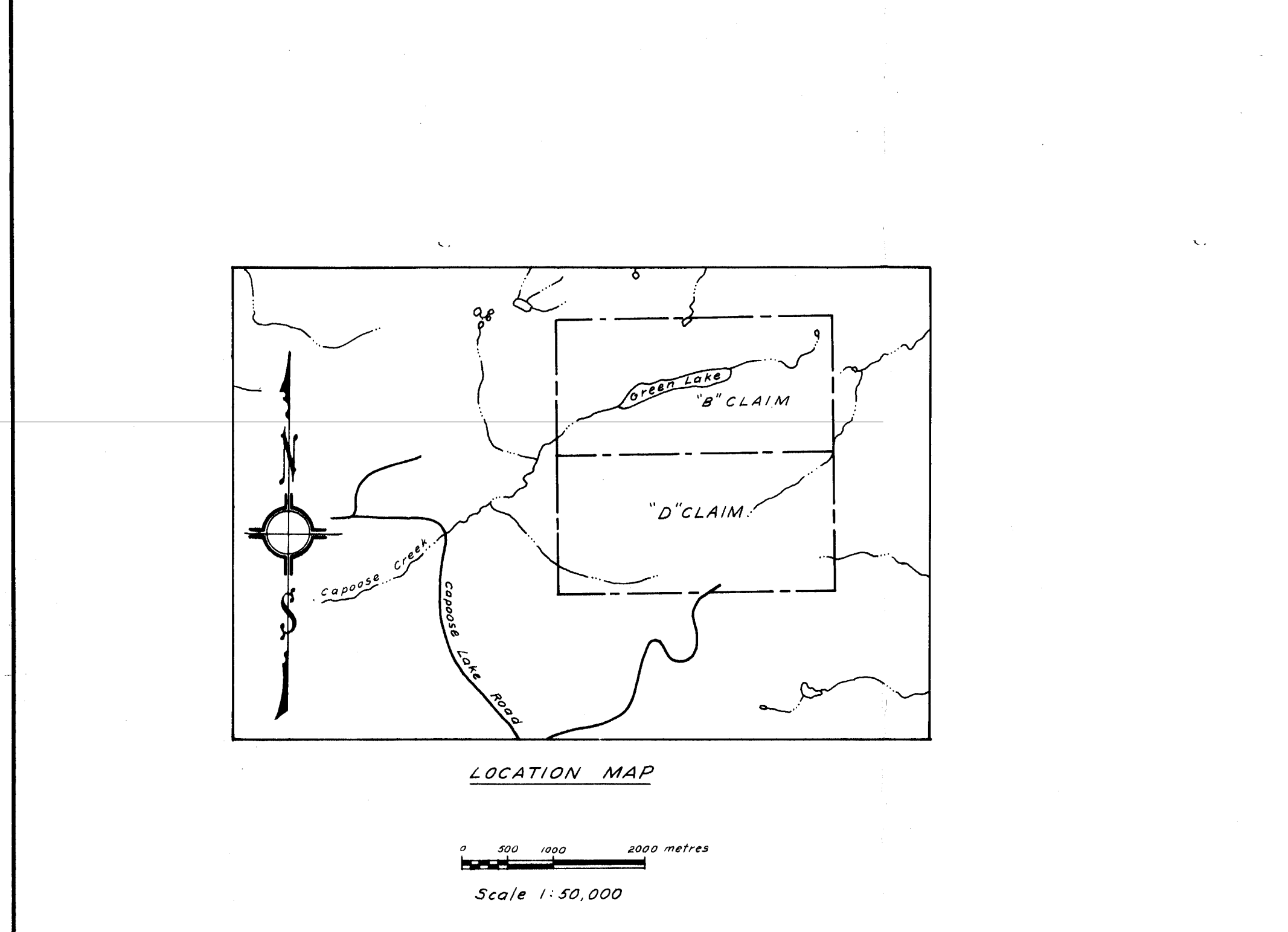

DRAWN BY: G.T.	GRANGES EXPLORATION AB CANADIAN DIVISION VANCOUVER OFFICE	SOIL GEOCHEMICAL SURVEY FOR Mo - Cu - Pb - Zn - Ag - As - Au Claims "B" (150) and "D" (152) CAPOOSE JOINT VENTURE Capoose Lake Area - B.C.	SCALE: 1:5000 PROJECT No.: 70113 N.T.S. No.: 93 F - 6
DATE: JUNE, 1983			

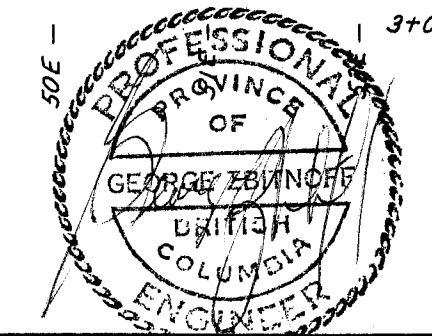

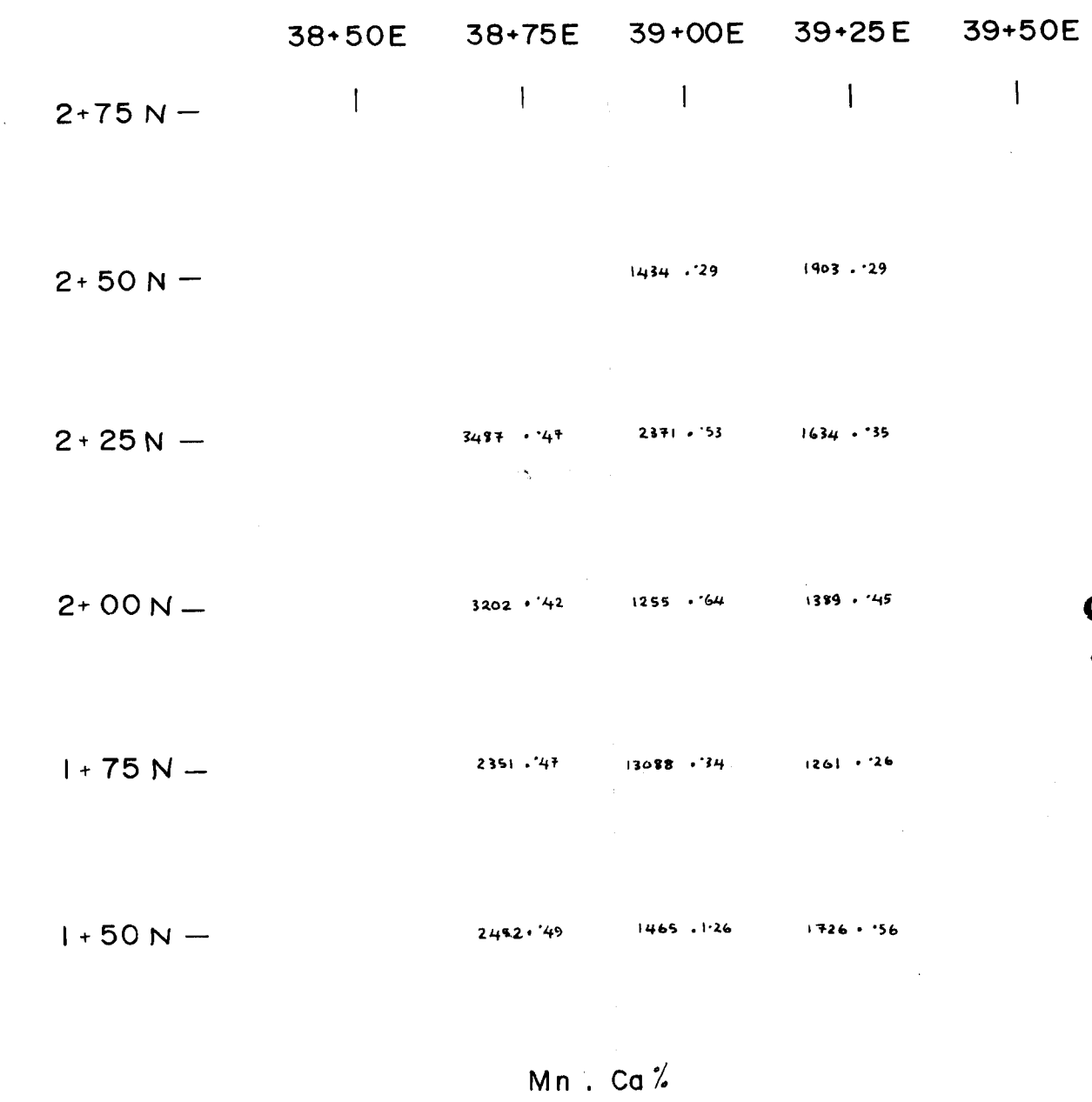
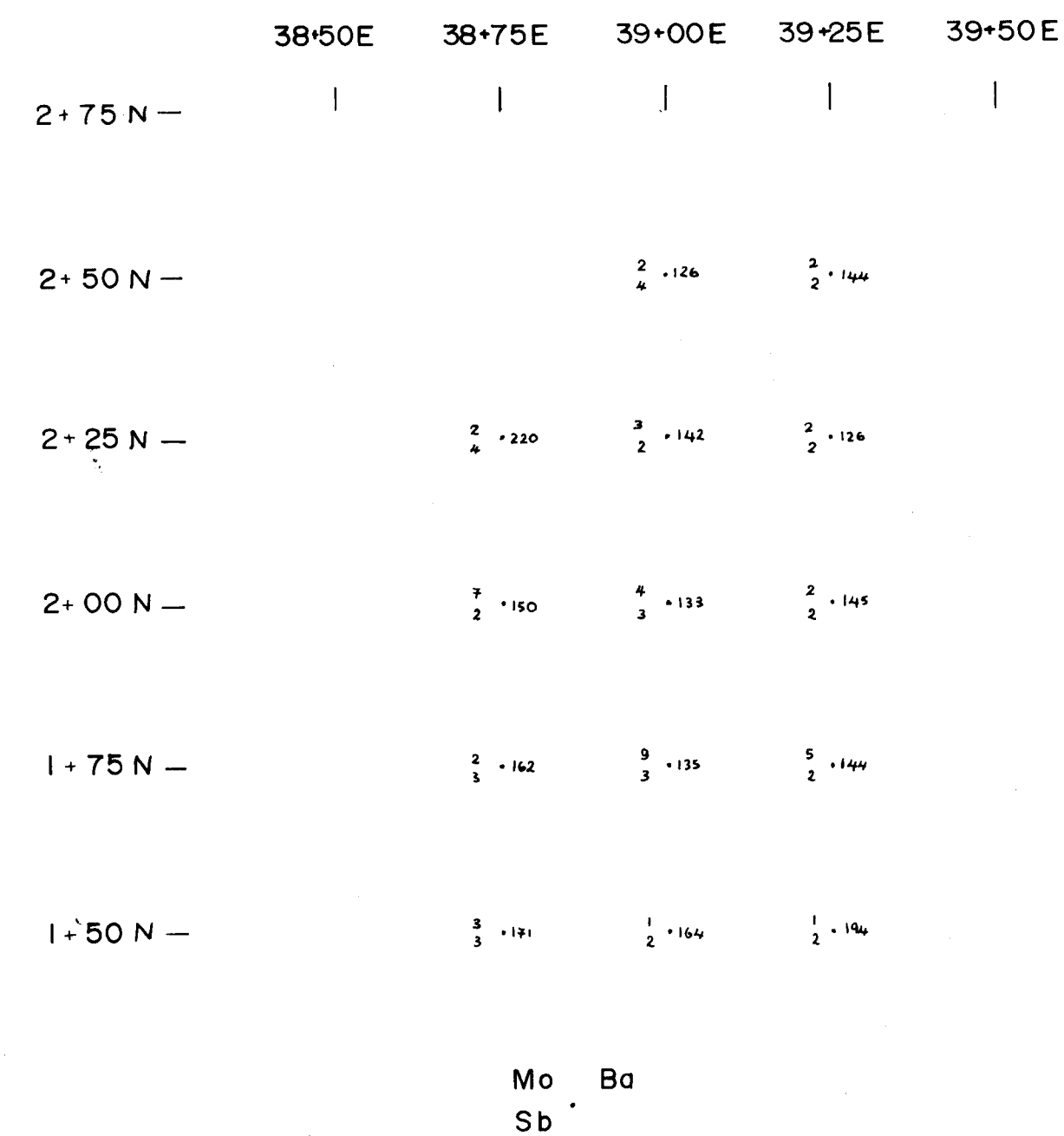
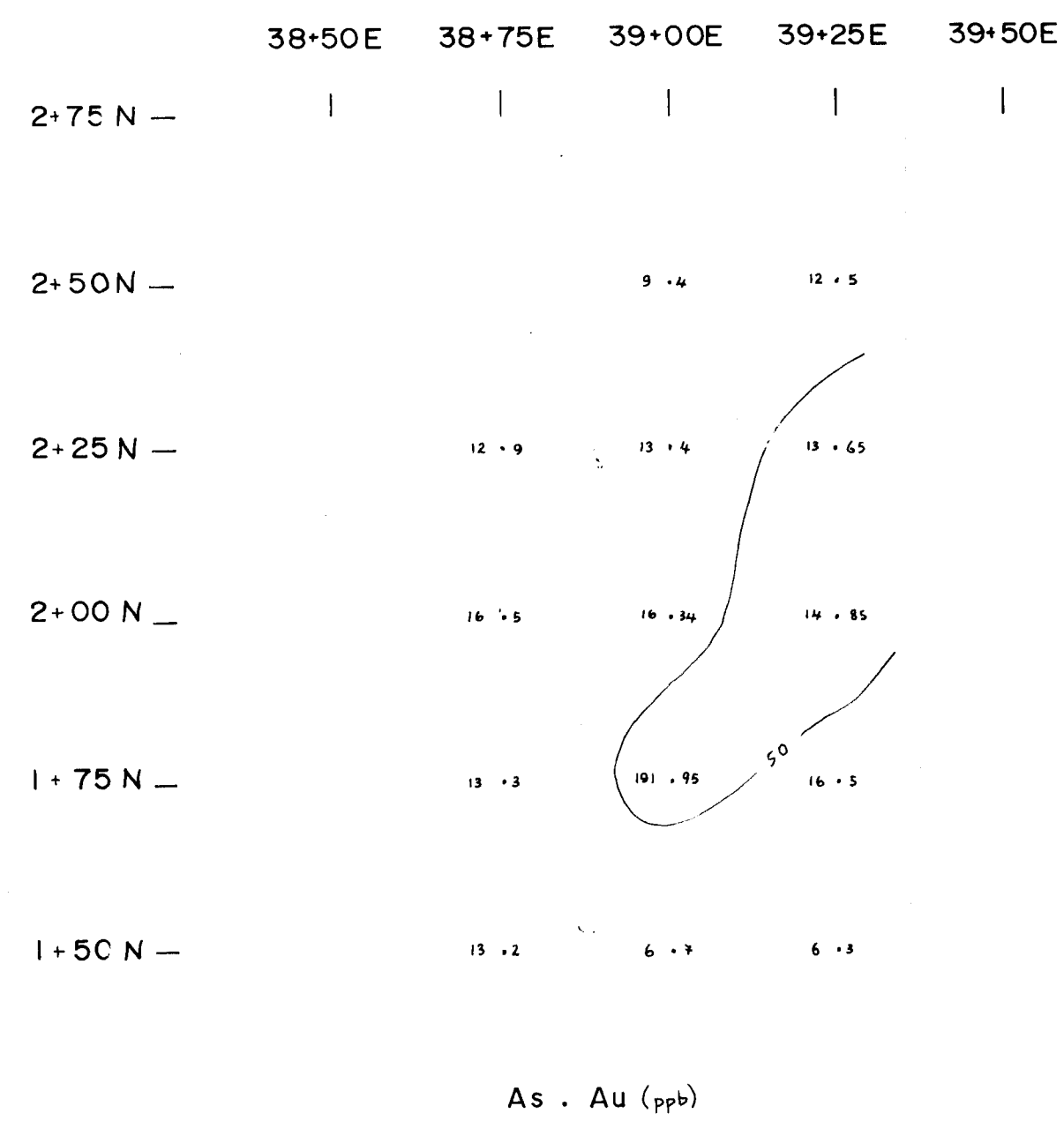
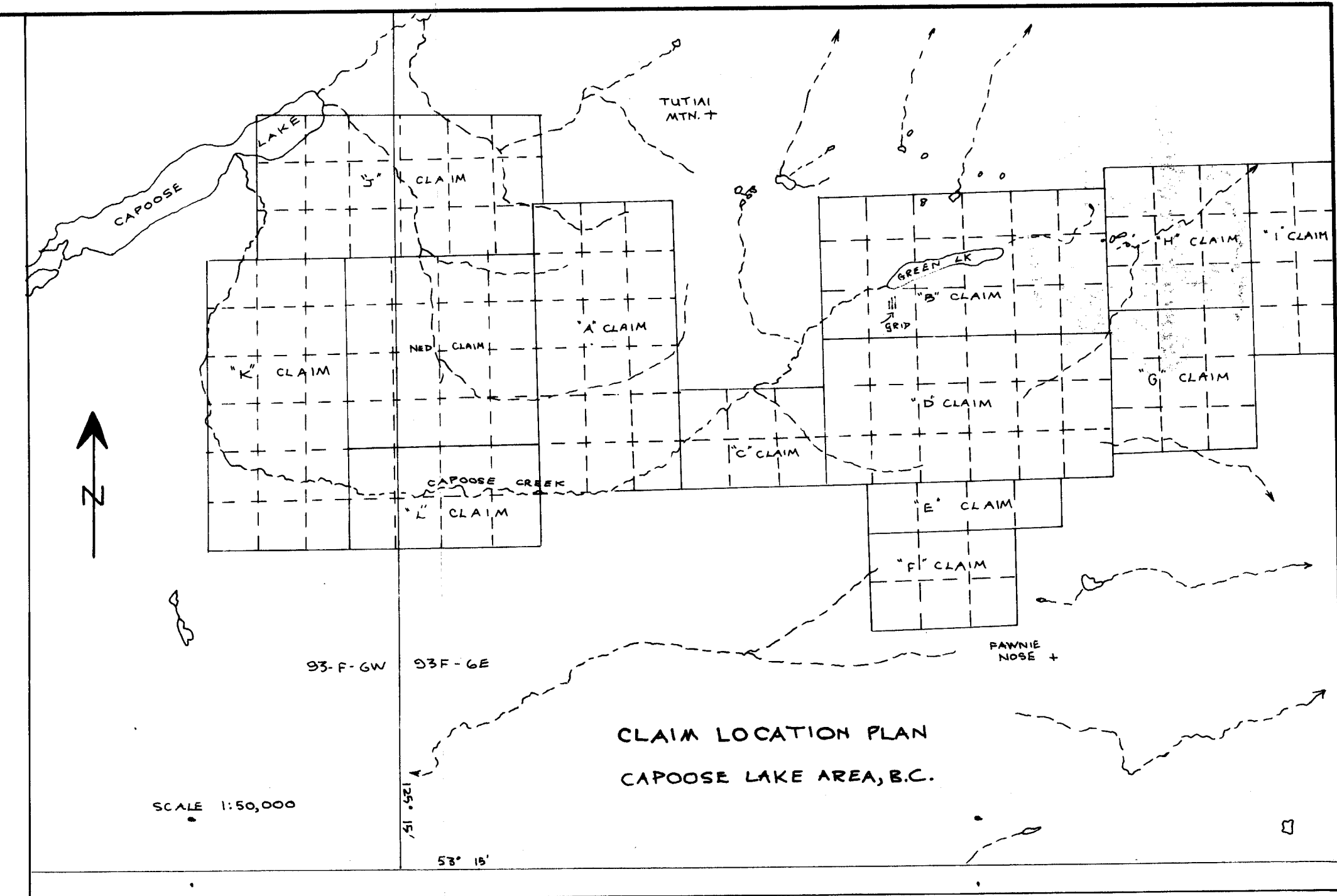
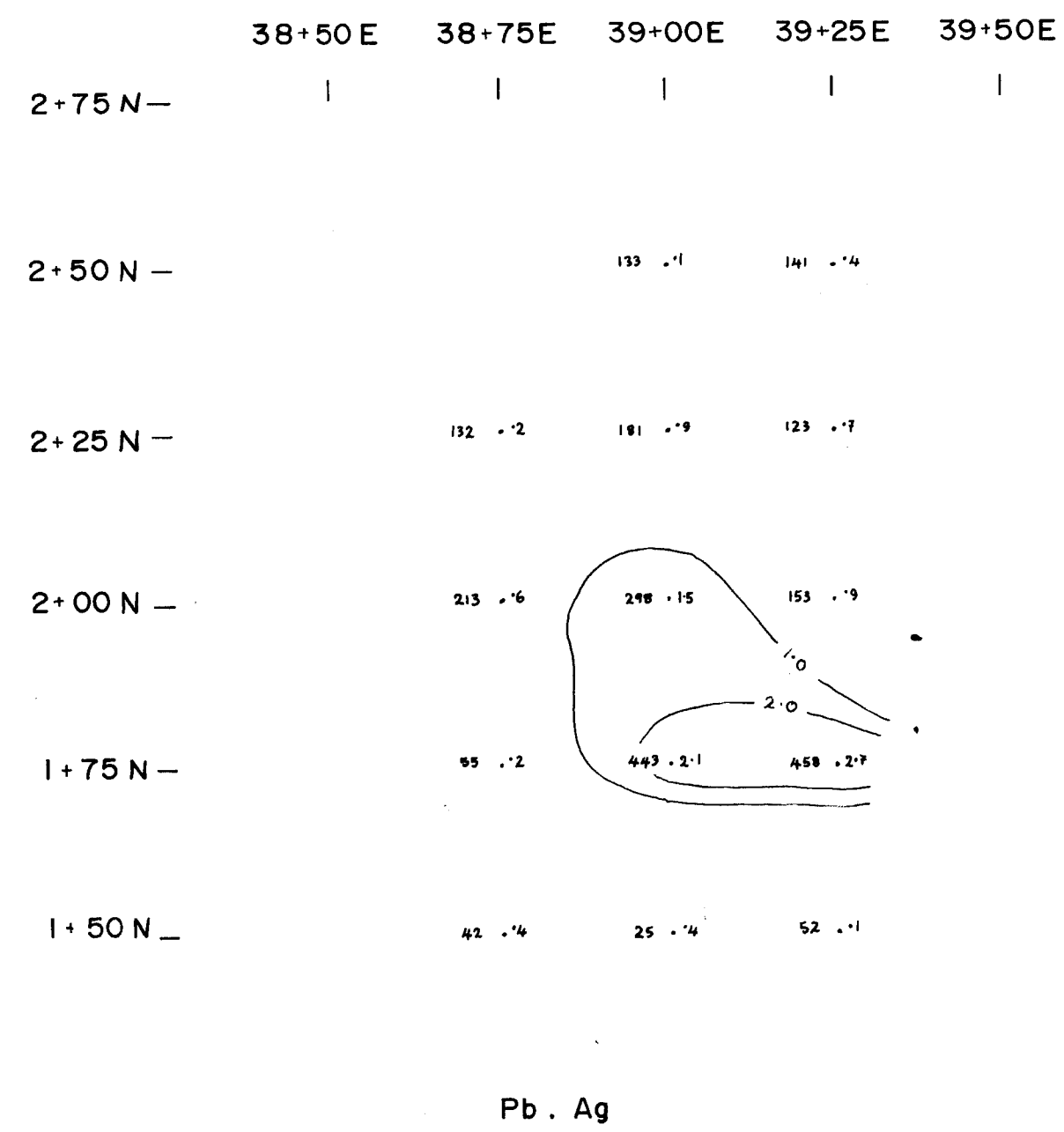
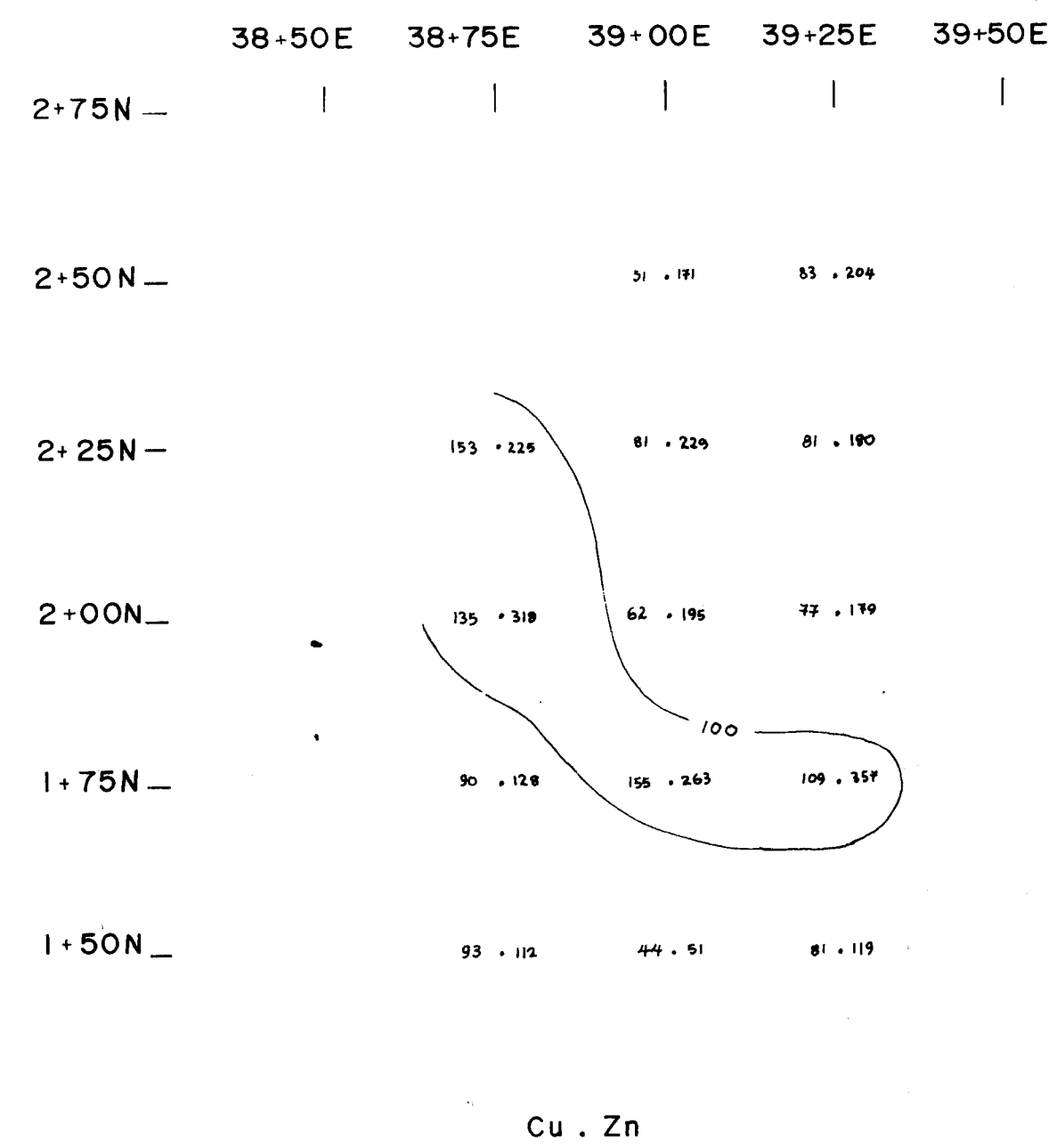

GEOLOGICAL BRANCH
ASSESSMENT REPORT

14,675

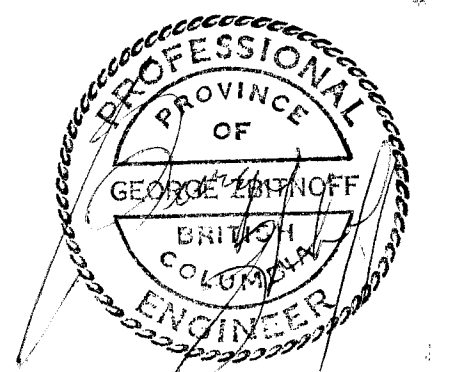

All values in ppm except where indicated	DRAWN BY: JJL	GRANGES EXPLORATION LTD.	GEOCHEMICAL SOIL SAMPLING CAPOOSE LAKE PROPERTY 'B' CLAIM - CAPOOSE LAKE AREA, B.C.	SCALE: 1:1000
	DATE: SEPT. 1985			PROJECT No.: 113
				N.T.S. No.: 93-F-6