

MineQuest Report #114  
Ref. No. RM2302

GEORGINA CLAIMS

Nanaimo Mining Division

N.T.S. 82 F/8

Latitude 49°16'N  
Longitude 124°14'W

by

R.V. Longe, P.Eng.

of

MineQuest Exploration Associates Ltd.

for

L.O. Allen

Work Performed On:

<u>Claim</u>	<u>Record Number</u>	<u>Date Recorded</u>
Georgina 1	2033	Feb. 18, 1985

April, 1986

86-234-14762

MineQuest Report #114  
Ref. No. RM2302

MINISTRY OF ENERGY, MINES  
AND PETROLEUM RESOURCES

Rec'd  
MAY 16 1986

SUBJECT \_\_\_\_\_  
FILE \_\_\_\_\_  
VANCOUVER, B.C.

GEORGINA CLAIMS

Nanaimo Mining Division

N.T.S. <sup>9</sup> 82 F/8E

Latitude 49°16'N  
Longitude 124°14'W

by

R.V. Longe, P.Eng.

FILMED

of

MineQuest Exploration Associates Ltd.

for

L.O. Allen

Work Performed On:

Claim      Record Number      Date Recorded

Georgina 1      2033      Feb. 18, 1985

**GEOLOGICAL BRANCH  
ASSESSMENT REPORT**

14-762

April, 1986

TABLE OF CONTENTS

	<u>Page</u>
1.0 INTRODUCTION	1 /
2.0 LOCATION, TOPOGRAPHY, ACCESS	1 /
3.0 OWNERSHIP AND CLAIM STATUS	2 /
4.0 HISTORY AND PREVIOUS WORK	2 /
5.0 WORK CARRIED OUT IN 1985	3 /
6.0 GEOLOGY	4 /
6.1 Regional Features	4 /
6.2 Airborne Magnetics	4 /
6.3 Observations on the Property	4 /
7.0 GEOCHEMISTRY	6 /
8.0 CONCLUSIONS	6 /
9.0 BIBLIOGRAPHY	7 /

LIST OF ILLUSTRATIONS

<u>Figure</u>		<u>Page</u>
1.	Location Map	after page 1 /
2.	Regional Geology	after page 5 /
3.	Preliminary Geologic Observations (Plan #890) in pocket	/
4.	Location of Rock and Silt Samples and Significant Results (Plan #891) in pocket	/

APPENDICES

Appendix I	Laboratory Reports	/
Appendix II	Cost Statement	/
Appendix III	Statements of Qualifications	/
	- L.O. Allen	
	- R.J. Bilquist	
	- R.V. Longe	
Appendix IV	Statement of Exploration and Development	/
Appendix V	Consecutive List of Samples Collected	/

1.0

INTRODUCTION

The GEORGINA claim was staked to cover a reported copper showing either within or closely associated with Sicker Group volcanic rocks and sediments.

2.0

LOCATION, TOPOGRAPHY AND ACCESS

The GEORGINA claim lies on Vancouver Island, British Columbia, two kilometres west of Nanoose Bay and 20 kilometres northwest of Nanaimo.

Topography, which ranges from 40 to 120 metres above sea level, is subdued. Vegetation consists of third growth conifers with open spaces where arbutus trees flourish.

The Island Highway traverses the property, nearly all points of which can be reached by a network of gravel roads. A B.C. Hydro power line crosses the claim from northwest to southeast. Parts of the claim are scheduled for residential development.

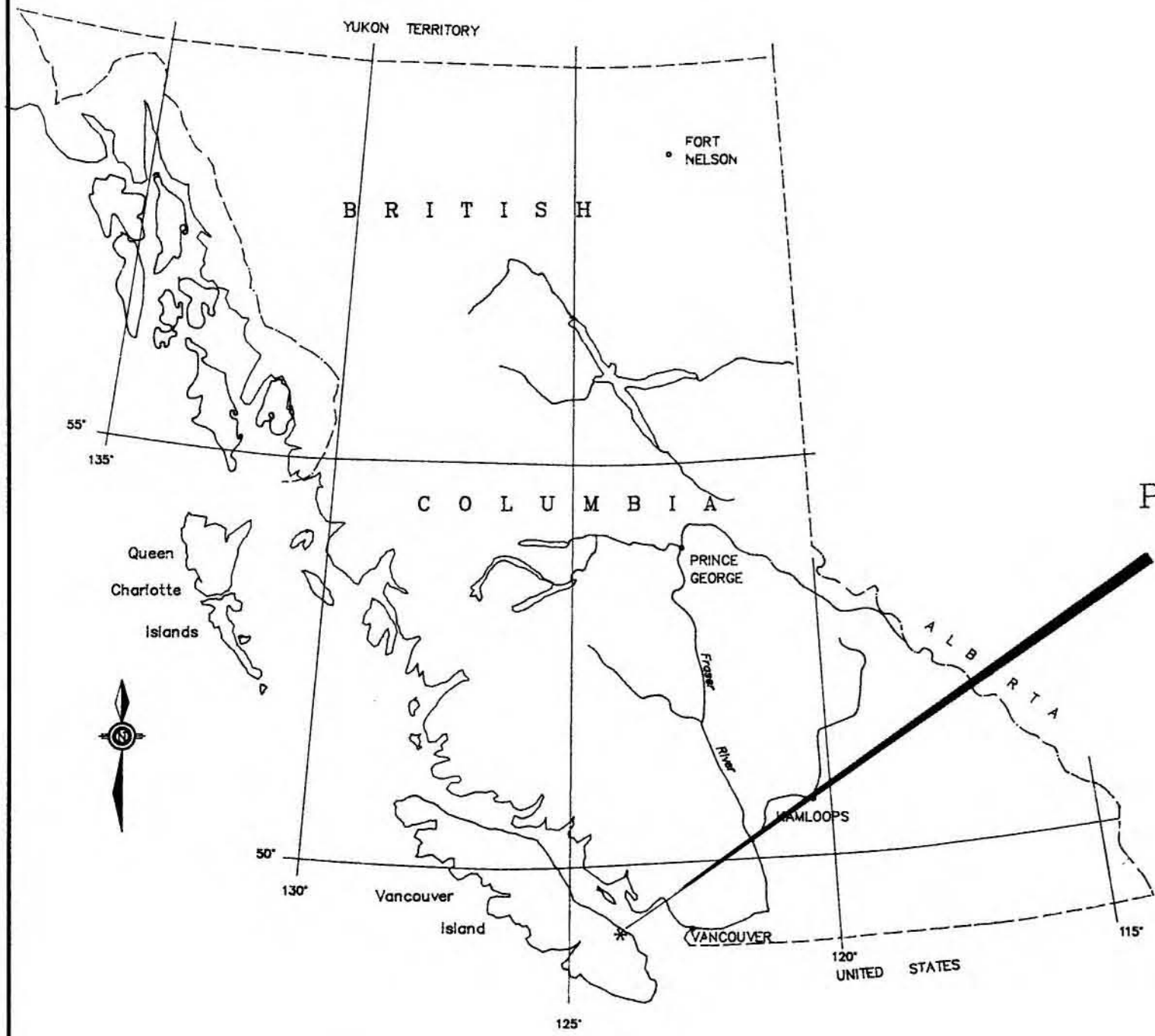

PROJECT AREA

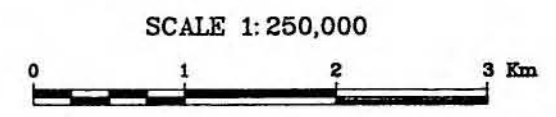
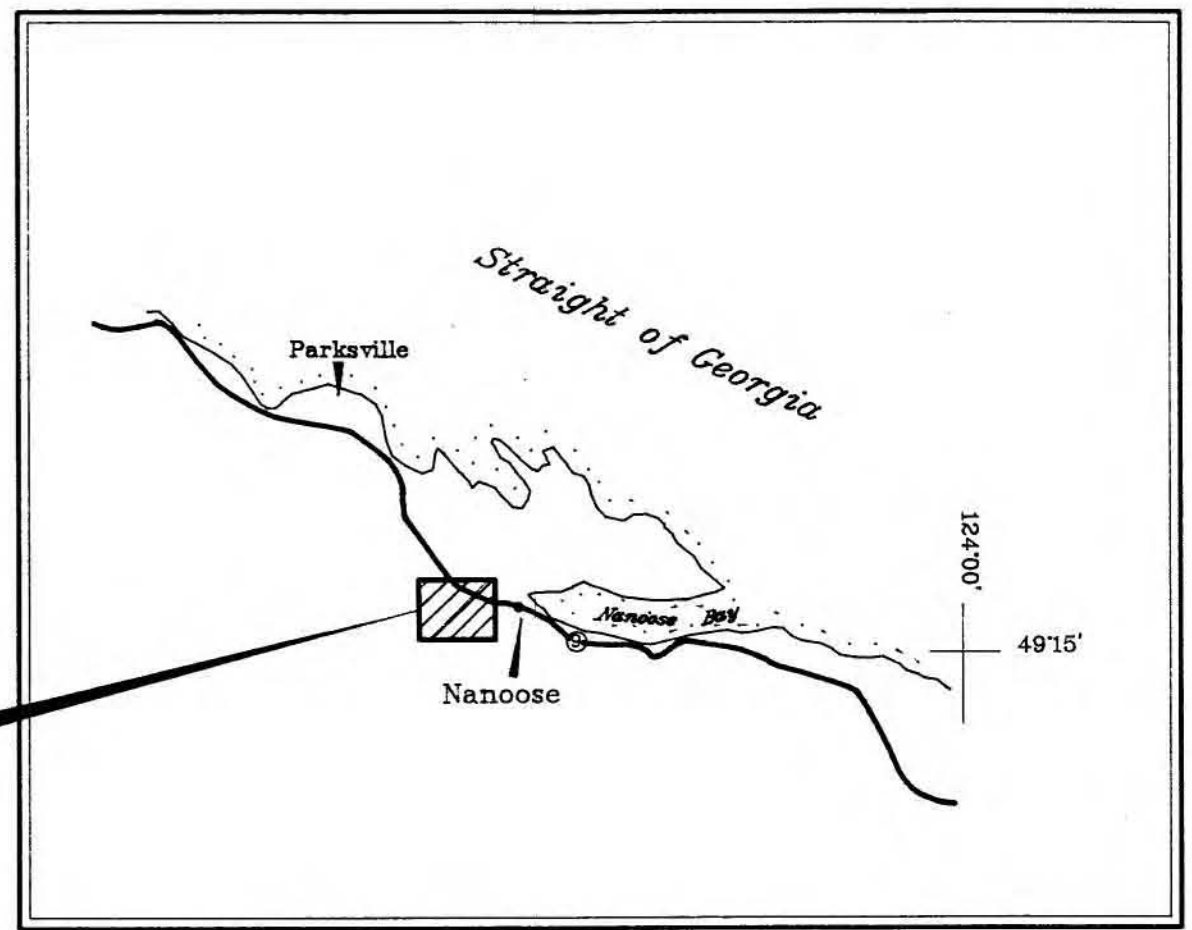

GEORGINA CLAIM			
LOCATION MAP			
PLAN No.	DRAWN BY: GEO-COMP	DATE MARCH '86	FIGURE <b>1</b>
Originator: RVL		N.T.S. 92F 8	
MINEQUEST EXPLORATION ASSOCIATES LTD.			

3.0

OWNERSHIP AND CLAIM STATUS

Property consists of one claim, the Georgina 1 record no. 2033, recorded February 18, 1985 and registered in the name of Leslie O. Allen of P.O. Box 128, Gabriola Island, B.C., VOR 1X0.

The GEORGINA claim surrounds, in its south central part, a single unit claim (West Bay) and partially surrounds another single unit claim (North Bay) astride its northern boundary.

4.0

HISTORY AND PREVIOUS WORK

One showing, also named "Georgina" (MINFILE #92F178) and now covered by the Georgina #1 claim was worked during the period 1934 to 1939 as a gold-silver-copper prospect. During this time a trench (now about 6 metres by 2 metres) and a shaft, reported (B.C. Dept. of Mines, 1939) to be 60 feet (18 metres) were excavated. The claim was again worked in 1965 but appears to have been dormant since.



## 5.0

WORK CARRIED OUT IN 1985

The 1985 program consisted of a one-day geological examination by the writer together with prospecting, collection of ten silt and six rock samples by L. Allen and R. Bilquist. Days worked were as follows:

<u>Date</u>	<u>Name</u>	<u>Activity</u>
1985 April 1	L. Allen	- prospecting and
1985 April 1	R. Bilquist	mapping
1985 April 1	R.V. Longe	- mapping and
		geological
		examination
1985 Aug. 25	R. Bilquist	- prospecting
1986 Feb. 11	R. Bilquist	- prospecting
1986 Feb. 11	K. Bilquist	- prospecting
1986 Feb. 17	R. Bilquist	- prospecting and
		silt sampling
1986 Feb. 17	K. Bilquist	- silt sampling



6.0 GEOLOGY

6.1 Regional Features

Most of the claim is underlain by sediments and volcanics of the Myra Formation, a subdivision of the Sicker Group. Outliers of the overlying Comox Formation (Cretaceous sandstone, conglomerates and shales) occur in one location. Triassic volcanics of the Karmutsen Formation are shown (Muller, 1980) to stratigraphically overlie the Sicker rocks to the southeast of the claims and to lie in fault contact to the southwest.

6.2 Airborne Magnetics

A well-developed magnetic feature trends across the claim in a north-northwest, south-southeast direction, parallel to the schistose foliation. The outcrops of basic intrusive rocks identified by Allen and Bilquist are tentatively assumed to be responsible for the magnetic anomaly with which they coincide.

6.3 Observations on the Property

The GEORGINA showing, reports of which prompted recent staking of the property, consists of a quartz-carbonate vein exposed by an open cut and a shaft, now filled with water. The vein, which appears to strike at approximately 140 degrees, cuts intermediate volcanics assumed from published maps, (notably Muller, 1980, Figure 2) to belong to the Sicker Formation.

During one day of reconnaissance traverses, mostly in the north-centre of the claim, six lithologic units were recognized. Each appears sufficiently distinct to be useful for mapping purposes.

Unit A consists of intermediate volcanics, probably andesite, which may correlate with the Nitinat Formation (Muller, 1980; p.6).

Unit B is a maroon-weathering schistose siltstone typically striking 160 degrees and dipping steeply. This unit is tentatively correlated with the "maroon and green volcanoclastic greywacke, grit and breccia" described by Muller (1980, p.8) in the Nitinat-Cameron area.

Unit C is a grey tuffaceous schist with a pronounced foliation bearing the same orientation as the foliation in Unit B. In one outcrop this rock contains chalcopyrite in a quartz vein cutting the schist and as copper oxide (assumed to be tennerite) along fractures. This unit may represent Muller's (1980 p.9) "dark grey tuff" which succeeds the maroon tuff.

Unit D is a white-weathering thinly-bedded unit containing chert, layers of a very siliceous rock, possibly rhyolite, sericite schist and felsic tuffs, a package which possibly corresponds to Muller's (1980, p.9) "light and dark banded feldspathic tuff".

Data on bedding attitudes in Units B, C and D were sparse and contradictory and must await further work.

Unit E is basic intrusive, observed and plotted by R. Bilquist and L. Allen, and believed to be responsible for the magnetic feature shown in Figure 3.

Unit F consists of conglomerates and sandstone, many of them fossiliferous, of the Cretaceous Nanaimo Group. Outliers of this formation are found in the southeast corner of the claim.

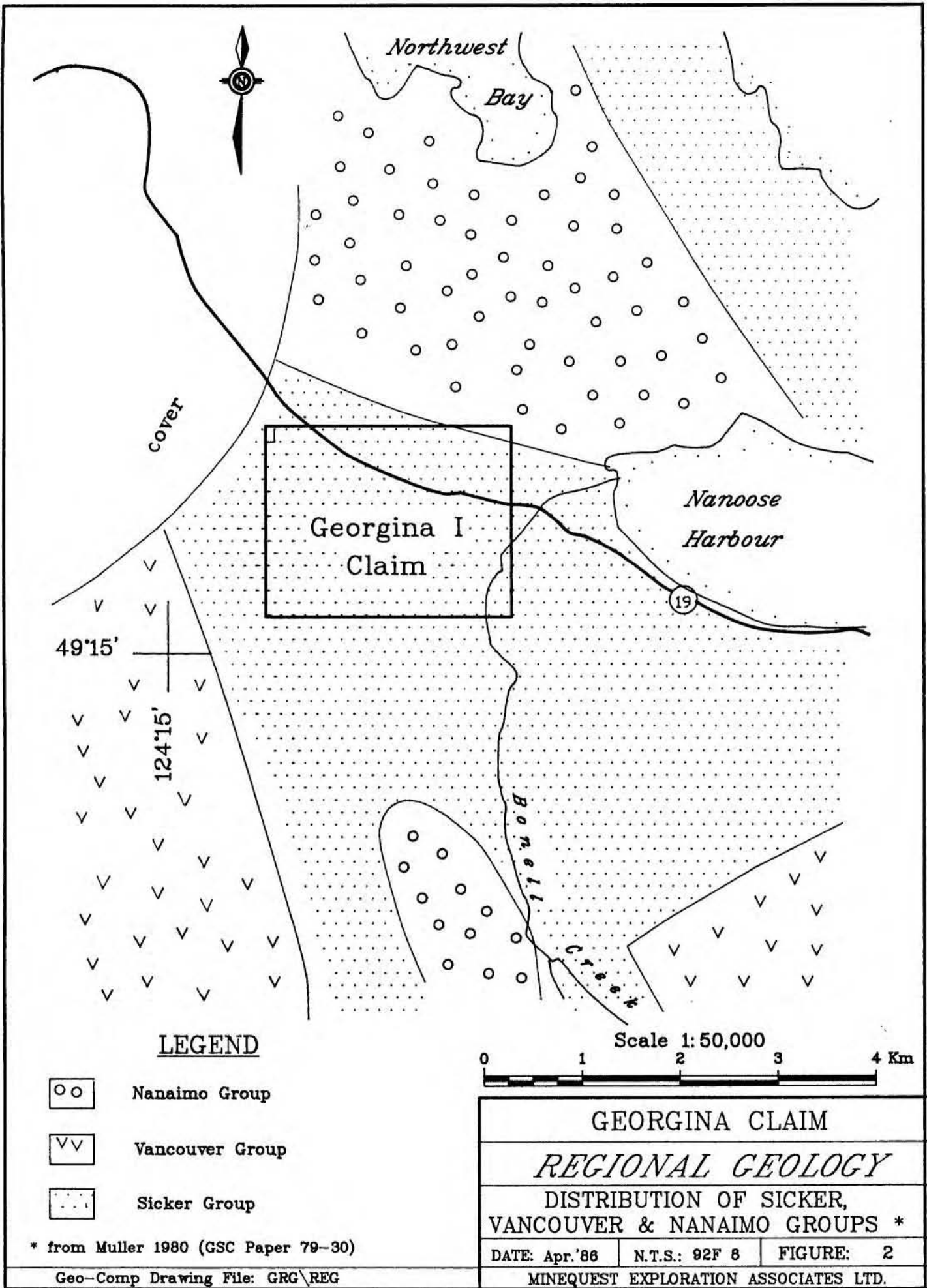

7.0

GEOCHEMISTRY

Rock samples on which analyses have been performed are confined to one outcrop sampled by R. Bilquist and L. Allen. Some vein material (sample GRG04) in intermediate volcanics, contained significant gold and copper (Figure 4).

Silt samples collected from two creeks, one near the western boundary of the claim the other near the southern boundary, revealed no significant values in base metals. Four samples however (GEO10, 11, 12 and 13, Figure 4) showed elevated levels of arsenic.

8.0

CONCLUSIONS

Within the GEORGINA claim, the Sicker Volcanic Group appears to be represented predominantly by the Myra Formation which, because it is host to the orebodies at Buttle Lake and promising prospects elsewhere, must be considered prospective stratigraphy.

9.0

BIBLIOGRAPHY

- MINFILE, 1985  
Georgina, No. 92F178
- Anon  
B.C. Dept. of Mines Annual Reports  
1934-F7  
1935-G46  
1936-F63  
1939-89  
B.C. Dept. of Mines Open File, Prop.  
Rep. Gunnex, 1965
- Muller, J.E., 1977  
G.S.C. Open File Report
- Muller, J.E., 1980  
The Paleozoic Sicker Group of Vancouver  
Island, B.C.  
G.S.C. Paper 79-30
- Muller, J.E. and Carson, D.J.T., 1969  
Geology and Mineral Deposits of Alert Bay -  
Cape Scott Map Area, Vancouver Island, B.C.  
G.S.C. Paper 74-8

**APPENDIX I**

**Laboratory Reports**



# Chemex Labs Ltd.

Analytical Chemists • Geochemists • Registered Assayers

212 Brooksbank Ave.  
North Vancouver, B.C.  
Canada V7J 2C1  
Telephone: (604) 984-0221  
Telex: 043-52597

## CERTIFICATE OF ANALYSIS

TO : BILQUIST, RON

P.O. BOX 81  
GABRIOLA ISLAND, B.C.  
V0R 1X0

\*\* CERT. # : A8510157-C01-A  
INVOICE # : 18510157  
DATE : 17-JAN-85  
P.O. # : NCAE

Sample description	Prep code	Cu ppm	Ag ppm	Au ppb FA+AA			
GRG 01	205	165	1.1	15	--	--	--
GRG 02	205	160	1.0	<5	--	--	--
GRG 03	205	145	0.3	<5	--	--	--
GRG 04	205	1000	0.6	870	--	--	--
GRG 05	205	163	0.2	<5	--	--	--
GRG 06	205	90	0.5	<5	--	--	--



Certified by Hart Buchler .....



copy  
GEORGINA



ACME ANALYTICAL LABORATORIES LTD. 852 E. HASTINGS ST. VANCOUVER B.C. V6A 1R6 PHONE 253-3158 DATA LINE 251-1011

GEOCHEMICAL ICP ANALYSIS

.500 GRAM SAMPLE IS DIGESTED WITH JML 3-1-2 HCL-HNO3-H2O AT 95 DEG. C FOR ONE HOUR AND IS DILUTED TO 10 ML WITH WATER.  
THIS LEACH IS PARTIAL FOR MN, FE, CA, P, CR, MG, BA, TI, B, AL, NA, K, W, SI, ZR, CE, SM, Y, NB AND TA. NO DETECTION LIMIT BY ICP IS 3 PPM.  
- SAMPLE TYPE: SILTS -80 MESH

DATE RECEIVED: APRIL 11 1986 DATE REPORT MAILED: *Apr 15/86* ASSAYER: *D. Toye* DEAN TOYE, CERTIFIED B.C. ASSAYER.

MINEQUEST EXPLORATION FILE # 86-0469

PAGE 1

SAMPLE#	Ko	Cu	Pb	Zn	Ag	Ni	Co	Mn	Fe	As	U	Au	Th	Sr	Cd	Sb	Bi	V	Ca	P	La	Cr	Mg	Ba	Ti	B	Al	Na	K	W
	PPM	PPM	PPM	PPM	PPM	PPM	PPM	PPM	I	PPM	PPM	PPM	PPM	PPM	PPM	PPM	PPM	PPM	I	I	PPM	PPM	I	PPM	I	PPM	I	I	I	PPM
GEO-07	1	33	10	38	.1	18	13	969	3.85	8	6	ND	1	24	1	2	4	100	.64	.04	4	36	.40	88	.17	6	1.69	.02	.03	1
GEO-08	1	32	7	61	.1	22	13	652	3.83	5	5	ND	2	28	1	2	4	102	.98	.06	5	36	.74	72	.27	8	2.03	.06	.04	1
GEO-09	1	38	14	49	.2	20	10	613	2.74	6	5	ND	1	31	1	2	2	78	.85	.05	9	37	.37	101	.14	7	2.28	.02	.03	1
GEO-10	1	38	6	61	.1	25	13	540	3.73	34	5	ND	1	44	1	2	4	99	1.34	.05	7	41	.75	82	.31	13	2.23	.06	.03	1
GEO-11	1	70	10	65	.2	27	18	963	5.30	14	5	ND	2	29	1	2	5	127	.94	.06	5	42	.71	112	.24	14	2.28	.04	.04	1
GEO-12	1	69	16	64	.1	24	19	937	5.39	17	5	ND	2	26	1	2	4	127	.83	.06	6	38	.75	90	.23	7	2.11	.05	.04	1
GEO-13	1	50	5	52	.1	24	13	735	4.20	11	5	ND	1	31	1	2	6	110	.90	.05	7	38	.61	117	.22	12	2.18	.04	.03	1
GEO-14	1	53	10	69	.1	23	19	1133	4.97	9	5	ND	1	25	1	2	3	110	.83	.09	3	39	.69	78	.23	5	2.00	.04	.04	1
GEO-15	1	39	5	48	.1	24	13	686	2.96	3	5	ND	1	27	1	2	5	86	.59	.04	6	34	.47	72	.17	8	1.91	.02	.04	1
GEO-16	1	31	3	31	.1	15	9	438	3.02	2	5	ND	1	22	1	2	4	100	.72	.04	6	30	.37	53	.18	8	1.36	.02	.02	1

**APPENDIX II**

**Cost Statement**

**COST STATEMENT**

**GEORGINA CLAIM**

**APRIL 1, 1985 TO FEBRUARY 28, 1986**

---

**FEES AND WAGES**

L. Allen	1 day	at \$185.00	\$185.00	
R. Bilquist	4 days	at \$185.00	740.00	
K. Bilquist	2 days	at \$120.00	240.00	
R.V. Longe	1 day	at \$485.00	485.00	
R.V. Longe	Report writing			
	Est. 2 days	at \$485.00	<u>970.00</u>	\$2,620.00

**DISBURSEMENTS**

Fuels & Lubricants-Vehicles	81.70	
Taxis, Parking, Fares	35.85	
General Supplies	12.00	
Analyses	72.50	
Courier	6.75	
Reprographics	4.00	
Xerox - In House	.90	
Drafting (Estimated)	250.00	463.70
		<hr/>
		<u>\$3,083.70</u>

**APPENDIX III**

**Statements of Qualification**

L.O. Allen

R.J. Bilquist

R.V. Longe

STATEMENT OF QUALIFICATIONS

I, R.V. Longe, hereby certify that:

1. I am a consulting geologist with a business office at 311 Water Street, Vancouver, B.C., V6B 1B8
2. I am President of MineQuest Exploration Associates Ltd., a company performing geological consulting and contract exploration services for the mineral exploration industry.
3. I am a graduate of Cambridge University, (B.A. Hons., 1961 Natural Sciences Tripos, Parts 1 & 2, Geology) and of McGill University (M.Sc., 1965).
4. I am a Fellow of the Geological Association of Canada, a member of the Canadian Institute of Mining and Metallurgy, and of the Association of Professional Engineers of British Columbia.
5. I have practised my profession as geologist for 18 years.
6. The information used in this report is based on a visit to the property on April 1, 1985, information in the public record, and long association with Messrs. L. Allen and R. Bilquist who carried out the sampling.

Signed

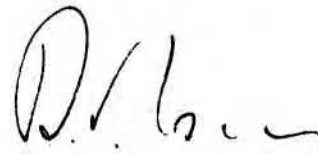

R.V. Longe, P.Eng

dated at Vancouver, B.C.  
this 10th day of May, 1985.

STATEMENT OF QUALIFICATIONS

I have worked in the mining exploration business for a total of 12 years. During this period I have been employed by numerous companies on both salary and contract basis. My duties have included prospecting, trenching (cobra drilling and blasting), claim staking, linecutting, geochemical surveys, geophysical surveys, diamond drilling, drill supervision and placer project supervision.

I have completed the B.C. Dept. of Mines Prospecting class at Castlegar (Selkirk College) in 1978.

Signed Signature on file  
at MineQuest Offices  
Leslie O. Allen

dated at Vancouver, B.C.  
this 1st day of May, 1986

STATEMENT OF QUALIFICATIONS

I have worked in the mining exploration business for a period of 16 years. During this period I have been employed by numerous companies on both salary and contract basis. My duties have included prospecting, trenching (cobra drilling and blasting), claim staking, linecutting, geochemical surveys, geophysical surveys, diamond drilling and diamond drill supervision.

I have written an exam to qualify for the Prospectors Assistance Grants. This took place at the Department of Mines & Petroleum Resources office at Nanaimo in 1975 and was supervised by W.C. Robinson, P.Eng.

Signed Signature on file  
at MineQuest offices  
Ronald J. Bilquist

dated at Vancouver, B.C.  
this 1st day of May, 1986



APPENDIX IV

Statement of Exploration and Development



SUB-RECORDER  
RECEIVED  
Petroleum Resources  
FEB 11 1986  
M.R. # \_\_\_\_\_ \$ \_\_\_\_\_

MINERAL ACT

STATEMENT OF EXPLORATION AND DEVELOPMENT

R.V. Longe	L.O. Allen		
<small>(Name)</small>	<small>Name</small>		
311 Water Street	P O Box 128		
<small>(Address)</small>	<small>(Address)</small>		
Vancouver, B.C.	Gabriola Island, B.C.		
V6B 1B8	669-2251	VOR 1X0	247-8846
<small>(Postal Code)</small>	<small>(Telephone Number)</small>	<small>(Postal Code)</small>	<small>(Telephone Number)</small>
Valid subsisting F.M.C. No. 220682	Valid subsisting F.M.C. No. 261534		

STATE THAT GEORGINA #1

1. I have done, or caused to be done, work on the GEORGINA #1 Claim(s)  
 Record No(s) 2033  
 Situate at Nanoose Harbour in the Nanaimo Mining Division.  
 to the value of at least \$2,000 dollars. Work was done from the 1st day  
 of April 19 85, to the 17th day of February 19 86

2. The following work was done in the 12 months in which such work is required to be done:  
 [COMPLETE APPROPRIATE SECTION(S) A, B, C, D, FOLLOWING]

A. PHYSICAL (Trenches, open cuts, adits, pits, shafts, reclamation, and construction of roads and trails.)

(Give details as required by section 13 of regulations.)

	COST
TOTAL PHYSICAL	

I wish to apply \$ \_\_\_\_\_ of physical work to the claims listed below.  
 (State number of years to be applied to each claim, its month of record, and identify each claim by name and record number.)

B. PROSPECTING (Details in report submitted as per section 9 of regulations.)  
 (The itemized cost statement must be part of the report.)

	COST

I wish to apply \$ \_\_\_\_\_ of this prospecting work to the claims listed below.  
 (State number of years to be applied to each claim, its month of record, and identify each claim by name and record number.)

**APPENDIX V**

**Consecutive List of Samples Collected**

C O N S E C U T I V E   L I S T I N G   O F   S A M P L E S

<u>Sample Number</u>	<u>Date</u>	<u>Sampler</u>	<u>Type</u>	<u>Claim Block</u>	<u>Claim Name</u>	<u>Comments</u>
GEO07	860217	RJB	SILT	GRG	Georgina 1	Gravel
14	860217	RJB		"	"	Fine sandy silt
15	860217	RJB		"	"	Poor clay-silt
16	860217	RJB	SILT	"	"	Fine sandy silt
GRG01	840109	RJB	RKCHIP	GRG	Georgina 1	
02	840109	RJB	"	"	"	
03	840109	RJB	"	"	"	
04	840109	LOA	RKCHIP	"	"	
05	840109	RJB	RKCHIP	"	"	
06	840109	LOA	RKCHIP	"	"	

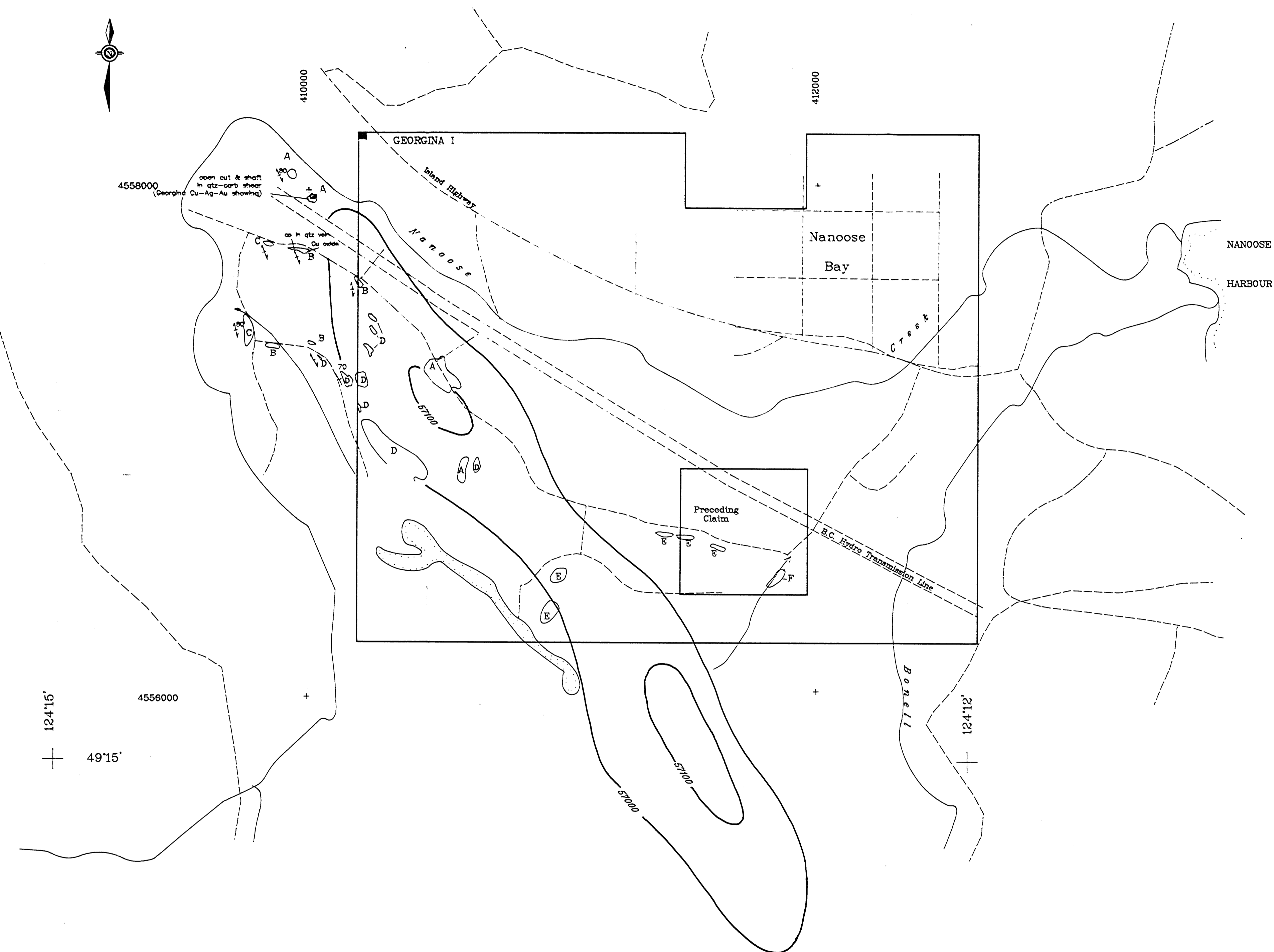

**LEGEND**

- Roads
- ~~~ Creeks
- - - Claim boundary
- Legal Corner Post
- Shaft
- Outcrop
- ↘<sup>80</sup> Strike and dip of foliation

**Lithologic Units**

- Nanaimo Group (Cretaceous)
  - F Sandstone, conglomerate
- Sicker Group (Upper Paleozoic)
  - E Basic intrusives
  - D Felsic schist, chert, siliceous tuff
  - C Grey schist
  - B Maroon schist
  - A Intermediate volcanics

**Geophysical Data**

Isomagnetic lines in gammas from G.S.C. Map 5322G  
Contours selected portray a significant anomaly  
some 400 gammas above background



**GEOLOGICAL BRANCH  
ASSESSMENT REPORT**

**14,762**

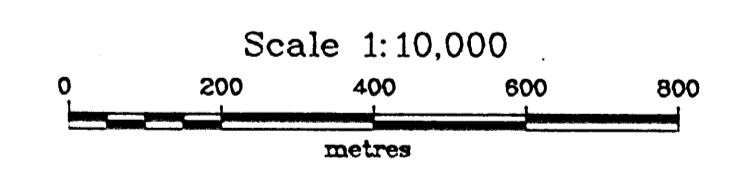

GEORGINA I MINERAL CLAIM					
PRELIMINARY GEOLOGIC OBSERVATIONS					
	Originator	Drawn	Date	PLAN No.	FIGURE
Original	RVL		Apr.'86	890	<b>3</b>
Revision				N.T.S.	
Revision				92F 8	
MINEQUEST EXPLORATION ASSOCIATES LTD.					

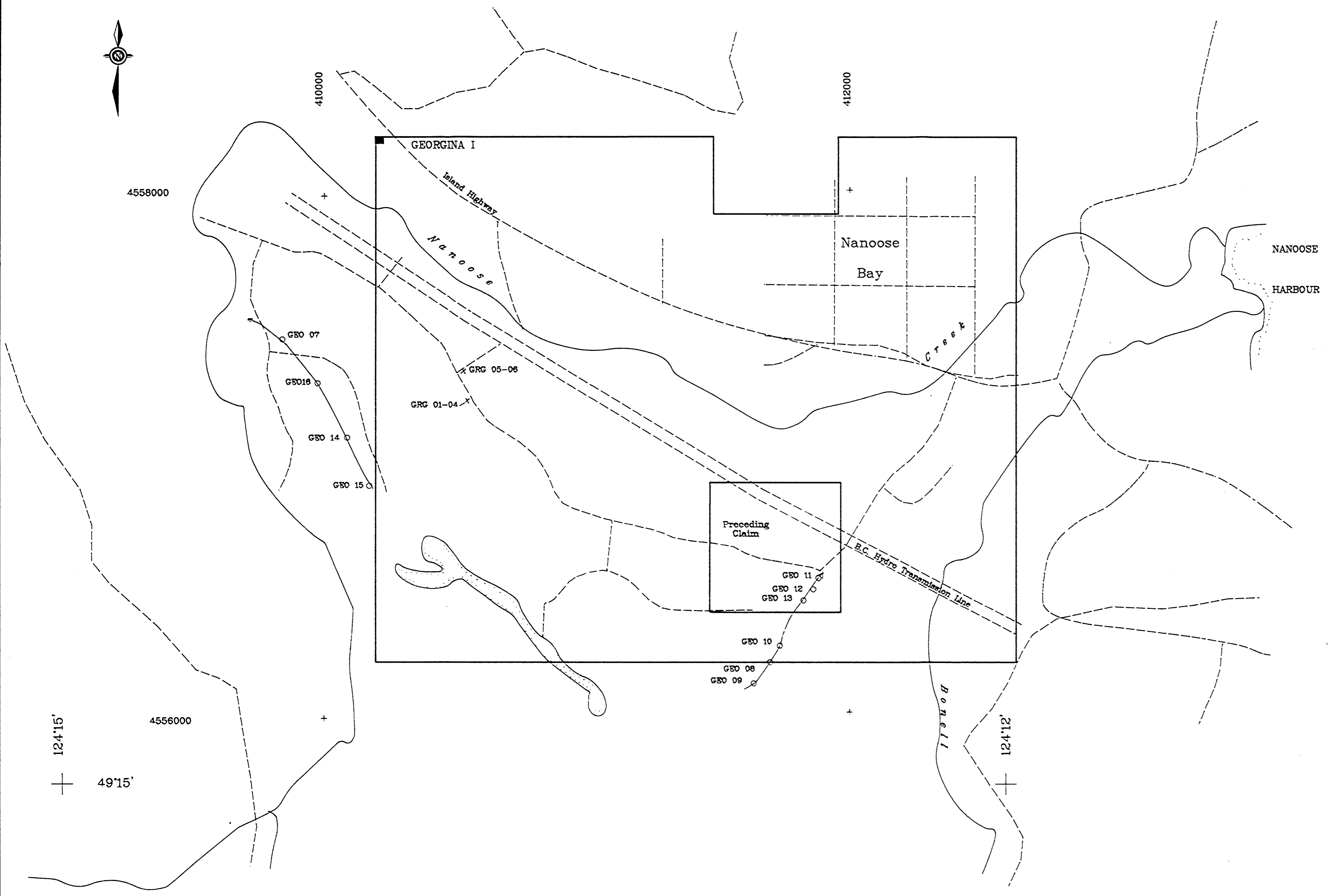

**LEGEND**

- Roads
- ~~~ Creeks
- GRG 05 x Rock samples
- GEO 10 o Silt samples
- Claim outline
- Legal Corner Post

**Results of analyses (significant values only)**

Sample No.	Type	Cu ppm	Au ppb	As ppm
GRG 04	rock	1000	870	-
GEO 10	silt	-	-	34
11	silt	-	-	14
12	silt	-	-	17
13	silt	-	-	11

**GEOLOGICAL BRANCH  
ASSESSMENT REPORT**

**14,762**

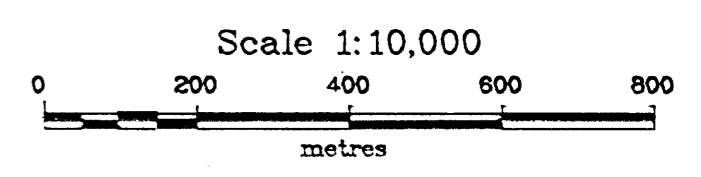

GEORGINA I MINERAL CLAIM					
LOCATIONS OF ROCK & SILT SAMPLES AND SIGNIFICANT RESULTS					
	Originator	Drawn	Date	PLAN No.	FIGURE
Original	RVL		Apr. '86	891	4
Revision				N.T.S.	
Revision				92F 8	
MINEQUEST EXPLORATION ASSOCIATES LTD.					