

MINISTRY OF ENERGY, MINES AND PETROLEUM RESOURCES	
Rec'd	MAY 8 1986
SUBJECT	_____
FILE	_____
VANCOUVER, B.C.	

ASSESSMENT REPORT
 GEOCHEMICAL SOIL SURVEY
 ON THE
 BAR 19 MINERAL CLAIM

N.T.S. 82G/5W
 Latitude 49°^{29.3'}~~29.3'~~ Longitude 115°^{56.5'}~~56.5'~~

FORT STEELE MINING DIVISION

FILMED

GEOLOGICAL BRANCH
 ASSESSMENT REPORT

14,823

Owner-Operator: Noranda Exploration Company, Limited
 (no personal liability)

Author : James McDonald

Date : March 5, 1986

TABLE OF CONTENTS

1. INTRODUCTION
2. LOCATION AND ACCESS
3. TOPOGRAPHY AND VEGETATION
4. CLAIMS INFORMATION
5. GEOCHEMICAL SURVEY
 - 5.1 Soil Geochemical Sampling
 - 5.2 Laboratory Analytical Methods
 - 5.3 Presentation of Results
 - 5.4 Discussion of Results
 - 5.4.1 Molybdenum
 - 5.4.2 Silver
 - 5.4.3 Copper
 - 5.4.4 Lead
 - 5.4.5 Zinc
6. CONCLUSIONS AND RECOMMENDATIONS

APPENDICES

- Appendix 1: Geochemical Soil Results (Cu, Pb, Zn, Ag, Mo)
- Appendix 2: Statement of Costs
- Appendix 3: Statement of Qualifications

MAPS APPENDED

Map 1 : Geochemistry Bar 19 (Cu, Pb, Zn, Ag, Mo)

Scale 1:10,000

BAR 19 2356

LCP

TL 34186



L 6323

L 3562
L 3561
L 3560
L 3563

L 5241

L 5242

L 5243

L 6542

L 2804

L 5255

**CLAIMS LOCATION MAP
BAR 19**

0 500 1500 m

1:50,000

NORANDA EXPLORATION

1.0 INTRODUCTION

During February, 1985 the Bar 19 (8 units) mineral claim was staked by Noranda Exploration Company, Limited (no personal liability), then during November of the same year reconnaissance soiling was conducted over the ground in an attempt to locate anomalous zones.

2.0 LOCATION AND ACCESS

The Bar 19 mineral claim is located approximately 1.1 km west-southwest of Cranbrook and is centered at about Longitude $115^{\circ}55'30''$ and Latitude $49^{\circ}29'25''$. Access is made via Highway 3 for approximately 10 km southward, then west along the Moyie River Road for 3 km before turning north along the fire lookout road for 6 km. Further access is made on the east side of the claim along old logging roads on the west side of Kiakho Creek, and on the west side of the claim along logging roads on the west side of Palmer Bar Creek.

3.0 TOPOGRAPHY AND VEGETATION

The topography is moderate to very steep with a maximum relief of approximately 488 m. Slopes are commonly 40° or more and a canyon runs through the western side of the claim. Most of the claim is covered by second growth pine and aspen, the western most portion of the claim is covered by a logging slash.

4.0 CLAIMS INFORMATION

The Bar 19 mineral claim is recorded by Noranda Exploration Company, Limited (no personal liability), P.O. Box 2380, Vancouver, B.C. V6B 3T5.

Claim Name	Record No.	Record Date
Bar 19	2356	February 20, 1985

5.0 GEOCHEMICAL SURVEY

During November, 1985 three lines for a reconnaissance soil survey were run in a N-S direction across the Bar 19 mineral claim. One line was located over the central portion of the claim and samples were taken at 50 m intervals over a 500 m distance. The remaining two lines were located on the western portion of the claim, and both were run with a 25 m sample interval. The locations and values for all of the samples along these lines are appended in map form.

5.1 Soil Geochemical Sampling

Forty nine samples, collected from the grids were analyzed for ppm copper, lead, zinc, silver and molybdenum in the Noranda Exploration Company, Limited laboratory located at 1050 Davie Street, Vancouver, B.C.

Soil samples, taken where possible, were obtained by digging holes with a maddock to depths between 10 and 30 cm where the visible B horizon, was exposed. The samples were placed in "Hi Wet Strength Kraft 3 1/2" x 6 1/8" Open End" envelopes and the grid co-ordinate was marked on the envelope with an indelible felt pen.

5.2 Laboratory Analytical Methods

Soil samples were placed in a drying cabinet for a period of 24 to 48 hours. The sample material is then screened and sifted to obtain a -80 mesh fraction.

The determination procedure for total copper, zinc, lead, silver and molybdenum is as follows:

0.200 grams of -80 mesh material is digested in 2 ml of HClO_4 and 0.5 ml of HNO_3 for approximately 5 hours. Following digestion, each sample is diluted to 5 ml with demineralized H_2O . Atomic Absorption Spectrophotometer was used to determine the parts per million, copper, lead, zinc, silver and molybdenum content in each sample.

The theory of Atomic Absorption Spectrophotometer is fully outlined in the literature and will not be described in this report.

5.3 Presentation of Results

The geochemical results for the Bar 19 mineral claim are found in Appendix 1. The location and values of these samples are appended in the back of this report in map form.

5.4 Discussion of Results

5.4.1 Molybdenum

All analysis returned a value of 1 ppm. No anomalous zones were defined.

5.4.2 Silver

The majority of samples returned values of 0.2 ppm with the marked exception of sample numbers 65711 and 65712 which returned respective values of 2.8 and 1.6 ppm.

5.4.3 Copper

All analysis returned variable values between 10 and 40 ppm. No anomalous trends were defined.

5.4.4 Lead

The majority of analysis returned values less than 40 ppm. Two samples did return anomalous values of 330 and 310 ppm, these were sample numbers 65711 and 65712 respectively.

5.4.5 Zinc

Analysis ranged in value from 36 to 420 ppm zinc but only one sample may be considered anomalous and that was sample number 65712 at 420 ppm.

6.0 CONCLUSIONS AND RECOMMENDATIONS

No anomalous values were returned from the soil survey with the exception of the most easterly line where samples 65711-12 returned elevated values in lead, zinc, and silver. It is therefore recommended that additional lines be established and sampled to the west and east of this most easterly one to see if any anomalous trends exist. Concordant with this survey prospecting should be conducted over this ground in an attempt to reveal the source of these elevated values.

The underlying rocks are of the Creston Aldridge Formation (Proterozoic). A gently north-plunging anticline crosses the claim, as well as a major northeasterly trending fault with normal movement. Beds dip gently to the northeast or northwest depending on the limb of the fold.

APPENDIX 1

SOIL GEOCHEMICAL RESULTS

NORANDA VANCOUVER LABORATORY

PROPERTY/LOCATION:GENERAL

CODE :8511-048

Project No. :427 Sheet:1 of 2 Date rec'd:NOV.19
 Material :SILT/SOIL Geol.:J.Mc Date compl:DEC.20
 Remarks :

Values in PPM, except where noted.

T. T. No.	SAMPLE No.	Cu	Zn	Pb	Ag	Mo	GCI
77	65696	12	58	6	0.2	1	2359
78	65702	14	110	10	0.2	1	
79	65703	22	92	10	0.2	1	
80	65704	18	110	8	0.2	1	
81	65705	20	130	10	0.2	1	
82	65706	20	98	8	0.2	1	
83	65707	16	110	8	0.2	1	
84	65708	14	200	6	0.2	1	
85	65709	20	150	14	0.4	1	
86	65710	14	140	14	0.2	1	
87	65711	32	120	330	2.8	1	
88	65712	28	420	310	1.6	1	
89	65714	14	140	12	0.2	1	
90	65715	12	110	6	0.2	1	
91	65716	16	90	8	0.2	1	
92	65717	20	66	8	0.2	1	
93	65718	10	40	2	0.2	1	
94	65719	16	38	4	0.2	1	
95	65720	20	42	8	0.2	1	
96	65721	16	36	8	0.2	1	
97	65722	26	56	8	0.2	1	
98	65723	14	56	10	0.2	1	
99	65724	22	40	4	0.2	1	
100	CHECK NL-5	26	66	70	1.6	8	
101	65725	14	66	12	0.2	1	
102	65726	20	62	10	0.2	1	
103	65727	34	88	14	0.2	1	
104	65728	22	90	12	0.2	1	

T. T. No.	SAMPLE No.	Cu	Zn	Pb	Ag	Mo	GCI
105	65729	16	60	8	0.2	1	2359
106	65730	14	52	6	0.2	1	
107	65731	16	48	0	0.2	1	
108	65732	14	40	6	0.2	1	
109	65733	14	54	8	0.2	1	
110	65734	14	66	10	0.2	1	
111	65735	18	50	8	0.2	1	
112	65736	24	50	8	0.2	1	
113	65737	20	56	8	0.2	1	
114	65738	10	74	10	0.2	1	
115	65739	22	52	10	0.2	1	
116	65740	26	80	10	0.2	1	
117	65741	36	48	12	0.2	1	
118	65742	30	60	10	0.2	1	
119	65743	24	54	8	0.2	1	
120	65744	28	60	10	0.2	1	
121	65745	26	52	2	0.2	1	
122	65746	20	48	2	0.2	1	
123	65747	18	48	2	0.2	1	
124	65748	14	78	6	0.2	1	
125	65749	18	58	8	0.2	1	
126	65750	20	52	4	0.2	1	

APPENDIX 2
STATEMENT OF COSTS

NORANDA EXPLORATION COMPANY, LIMITED

STATEMENT OF COST

PROJECT: CRANBROOK

DATE November 1985

TYPE OF REPORT: Soil Geochem

a) Wages:

No. of Days 3

Rate per Day \$ 100.00

Dates From: November 1985

Total Wages 3 x \$ 100.00 \$ 300.00

b) Food and Accomodation:

No of days 3

Rate per day \$ 50.00

Dates From: November 1985

Total Cost 3 x \$ 50.00 \$ 150.00

c) Transportation:

No of days 3

Rate per day \$ 10.97

Dates From: November 1985

Total Cost 3 X \$ 10.97 \$ 32.92

d) Instrument Rental:

Type of Instrument

No of days

Rate per day \$

Dates From:

Total Cost X \$

Type of Instrument

No of days

Rate per day \$

Dates From:

Total Cost X \$

f) Analysis \$ 196.00
(See attached schedule)

g) Cost of preparation of Report
Author \$ 50.00
Drafting \$ 100.00
Typing \$ 50.00

h) Other:
Contractor
Supervision - D. Cross - P. Eng.

Total Cost \$ 878.92

e) Unit costs for Geochem
No of days 3
No of units 49
Unit costs 17.94 / Sample
Total Cost 49 x 17.94 \$ 878.92

NORANDA EXPLORATION COMPANY, LIMITED
(WESTERN DIVISION)

DETAILS OF ANALYSES COSTS

PROJECT: CRANBROOK

<u>ELEMENT</u>	<u>NO. OF DETERMINATIONS</u>	<u>COST PER DETERMINATION</u>	<u>TOTAL</u>
Cu	49	1.60	78.40
Pb	49	.60	29.40
Zn	49	.60	29.40
Mo	49	.60	29.40
Ag	49	.60	29.40
			<hr/>
			\$ <u>196.00</u>

APPENDIX 3

STATEMENT OF QUALIFICATIONS

STATEMENT OF QUALIFICATIONS

I, James McDonald of the City of Vancouver, British Columbia, do certify that:

1. I am a graduate of the University of Alberta with a Bachelor of Science in Geology.
2. I have been steadily employed by Noranda Exploration Company, Limited since May, 1983.

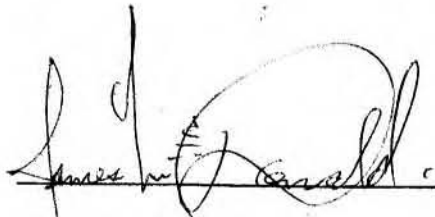
A handwritten signature in black ink, appearing to read 'James McDonald', is written over a horizontal line.

James McDonald
Geologist
Noranda Exploration
Company, Limited
(No Personal Liability)

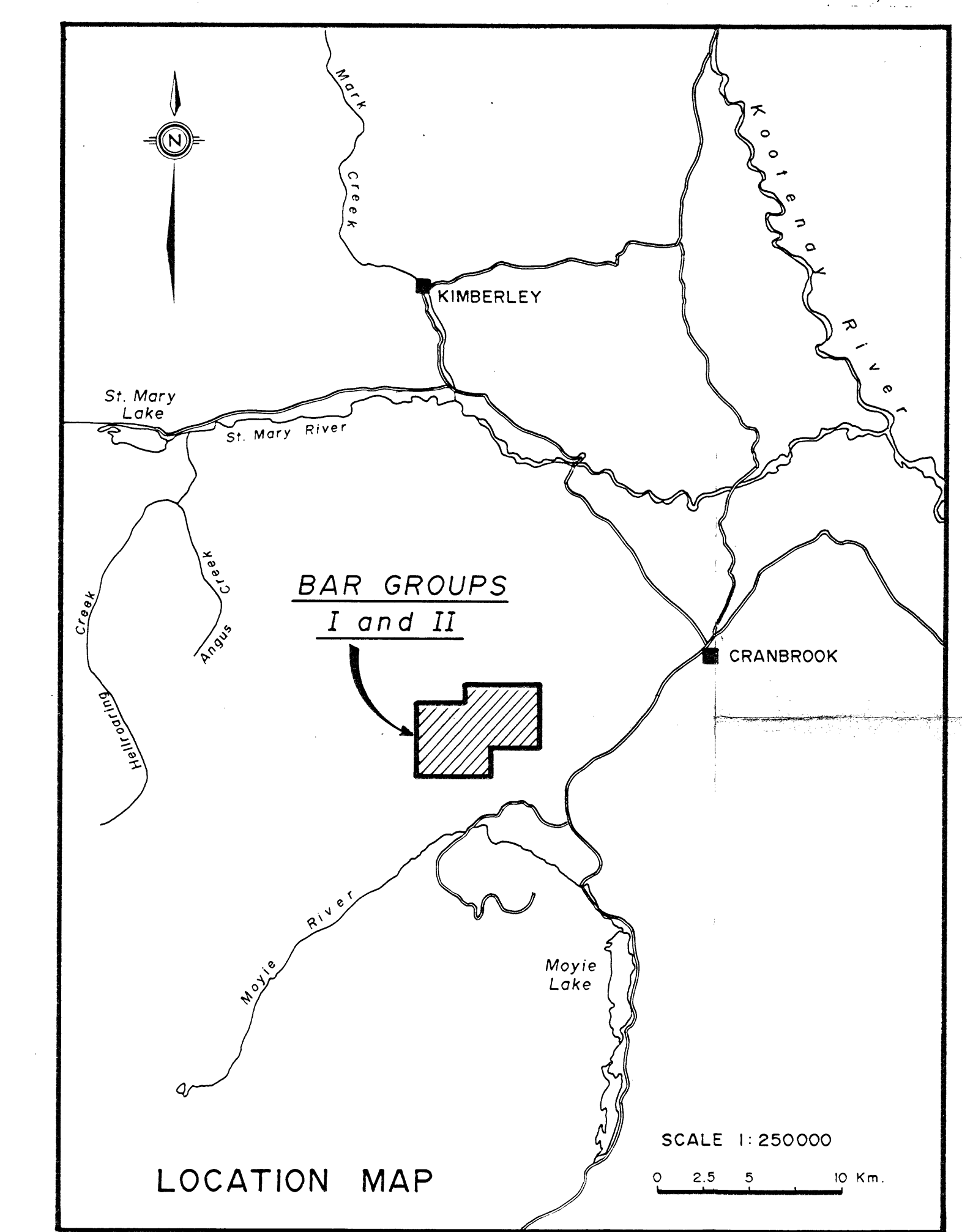
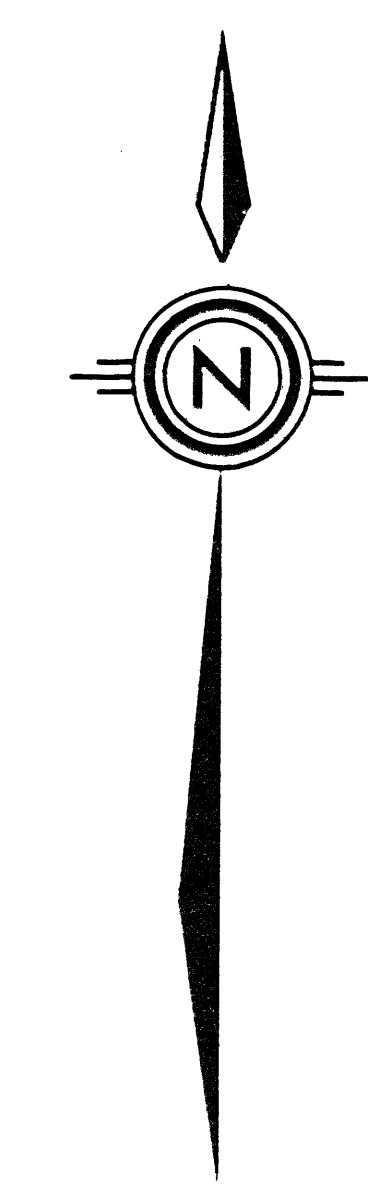
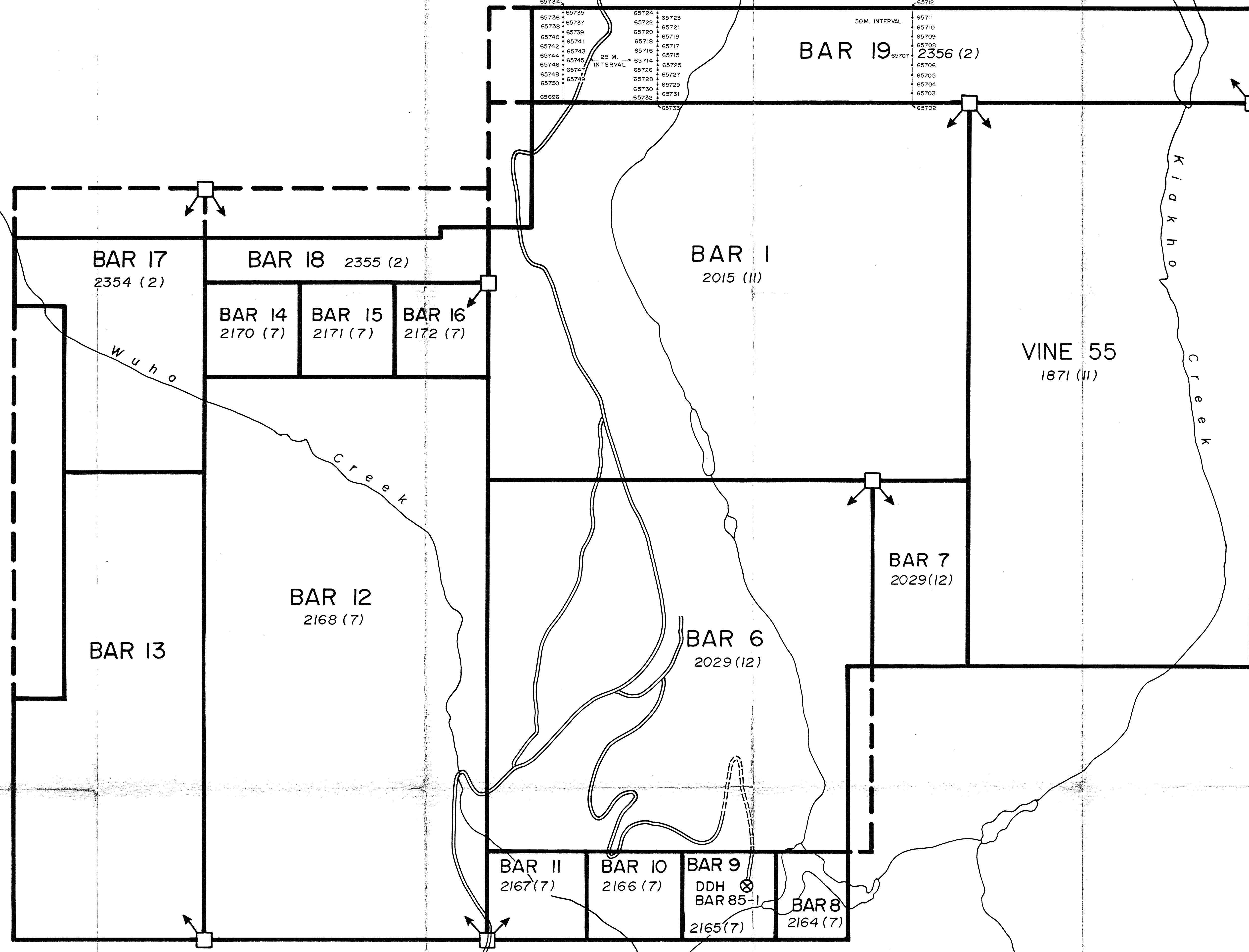

GEOCHEMISTRY RESULTS

SAMPLE	ELEMENTS					SAMPLE	ELEMENTS				
	Cu	Zn	Pb	Ag	Mo		Cu	Zn	Pb	Ag	Mo
65702	14	10	0	0.2	1	65728	22	80	12	0.2	1
65703	22	36	0	0.2	1	65729	16	40	6	0.2	1
65704	18	10	0	0.2	1	65730	14	52	6	0.2	1
65705	20	100	10	0.2	1	65731	16	48	0	0.2	1
65706	20	98	0	0.2	1	65732	14	40	6	0.2	1
65707	14	10	0	0.2	1	65733	14	54	0	0.2	1
65708	14	200	0	0.2	1	65734	14	66	10	0.2	1
65709	20	150	14	0.4	1	65735	18	50	0	0.2	1
65710	14	140	14	0.2	1	65736	24	50	0	0.2	1
65711	32	120	350	2.8	1	65737	20	56	0	0.2	1
65712	28	420	210	1.6	1	65738	10	74	10	0.2	1
65714	14	140	12	0.2	1	65739	22	52	10	0.2	1
65715	12	100	0	0.2	1	65740	26	80	10	0.2	1
65716	16	90	0	0.2	1	65741	36	48	12	0.2	1
65717	20	66	0	0.2	1	65742	30	60	10	0.2	1
65718	10	40	2	0.2	1	65743	24	54	0	0.2	1
65719	16	38	4	0.2	1	65744	28	60	10	0.2	1
65720	20	42	0	0.2	1	65745	26	52	2	0.2	1
65721	16	56	0	0.2	1	65746	20	48	2	0.2	1
65722	26	56	0	0.2	1	65747	18	48	2	0.2	1
65723	14	56	10	0.2	1	65748	14	78	6	0.2	1
65724	22	40	4	0.2	1	65749	18	50	0	0.2	1
65725	14	66	10	0.2	1	65750	20	52	4	0.2	1
65726	20	62	10	0.2	1	65751	12	58	6	0.2	1
65727	34	88	14	0.2	1						

GEOLOGICAL BRANCH
ASSESSMENT REPORT

14,823

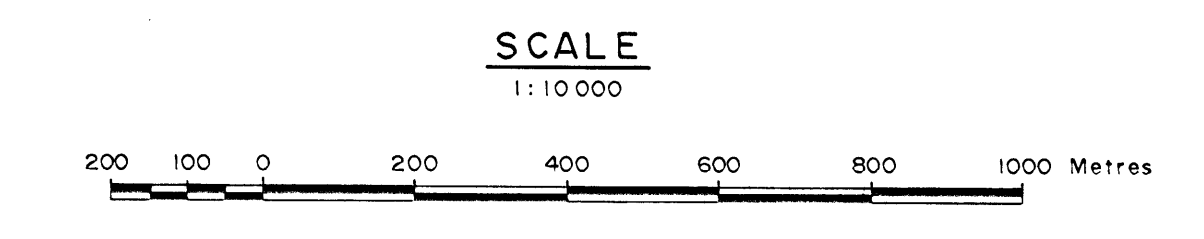

REVISED	BAR GROUP	
	GEOCHEMISTRY BAR 19	
	Cu, Pb, Zn, Ag, Mo in ppm	
PROJ. No. 490	SURVEY BY: J. McDonald	DATE: April 1986
N.T.S. 823/5	DRAWN BY: J. Serwin	SCALE: 1:110,000
DWG. No.	NORANDA EXPLORATION	
	OFFICE VANCOUVER	