

Geophysical Report

KUTCHO PROPERTY

(KUTCHO 1 TO 4 CLAIMS)

FILMED

Liard Mining Division, B.C.

Located at Coordinates: 58 deg. ^{11.6'}~~11.6'~~ N, 128 deg. ^{32.2'}~~32.2'~~ W

LOGICAL BRANCH
ASSESSMENT REPORT

14,897
by Lyndon Bradish

Owner/Operator: NORANDA EXPLORATION COMPANY, LIMITED
(NO PERSONAL LIABILITY)

N.T.S. 104 I/2E, 104 I/2W

February 1986

14897

TABLE OF CONTENTS

	<u>Page</u>
Introduction	2
Location and Access	2
Claim Statistics	2
Regional Geology	2
Topography and Vegetation	2
Previous Work	3
Instrumentation	
Conclusions	4
Recommendations	4

APPENDICES

APPENDIX I	--	STATEMENT OF COSTS
APPENDIX II	--	STATEMENT OF QUALIFICATIONS

LIST OF FIGURES

1. LOCATION MAP	SCALE 1:8,000,000
2. CLAIM MAP	SCALE 1:50,000
3. GRID LOCATION MAP	SCALE 1:25,000

INTRODUCTION:

The Kutcho 1-4 claims were staked by Noranda Exploration personnel in February to cover favourable volcanic stratigraphy following the discovery of the Kutcho deposit. An inline pulse EM survey was carried out over a series of weakly mineralized zones on line 9200 on the Kutcho grid. A crew of six was employed to complete both surveys and was under the supervision of K. Lillie. The survey was completed on July 23, 1985.

LOCATION AND ACCESS:

The Kutcho property is situated in a subalpine area adjacent Kutcho Creek, approximately 95 kilometers southeast off the village of Dease Lake in northwestern B.C.

Access to the area is via fix-winged aircraft to the Kutcho airstrip which is 3 kilometers north of the claims. Local access to the property is by helicopter.

CLAIM STATISTICS:

The property was reduced in size in March 1985. At the present time, the property consists of the following claims:

<u>Claim Name</u>	<u># Units</u>	<u>Record #</u>	<u>Record Date</u>	<u>Owner</u>
Kutcho 1	4	99	March 10, 1976	Noranda Expl. Co., Ltd. (No Personal Liability)
Kutcho 2	9	100	"	"
Kutcho 3	3	101	"	"
Kutcho 4	6	102	"	"

REGIONAL GEOLOGY:

The area has been mapped regionally by the Geological Survey of Canada and their results are available as Open File Map #610 at a scale of 1:125,000.

Regional mapping indicates the area is underlain by a sequence of volcanic, volcanoclastic and sedimentary rocks ranging from Upper Triassic to Lower Jurassic in age. The sequence has been tightly folded with axes trending west northwest, often plunging to the west.

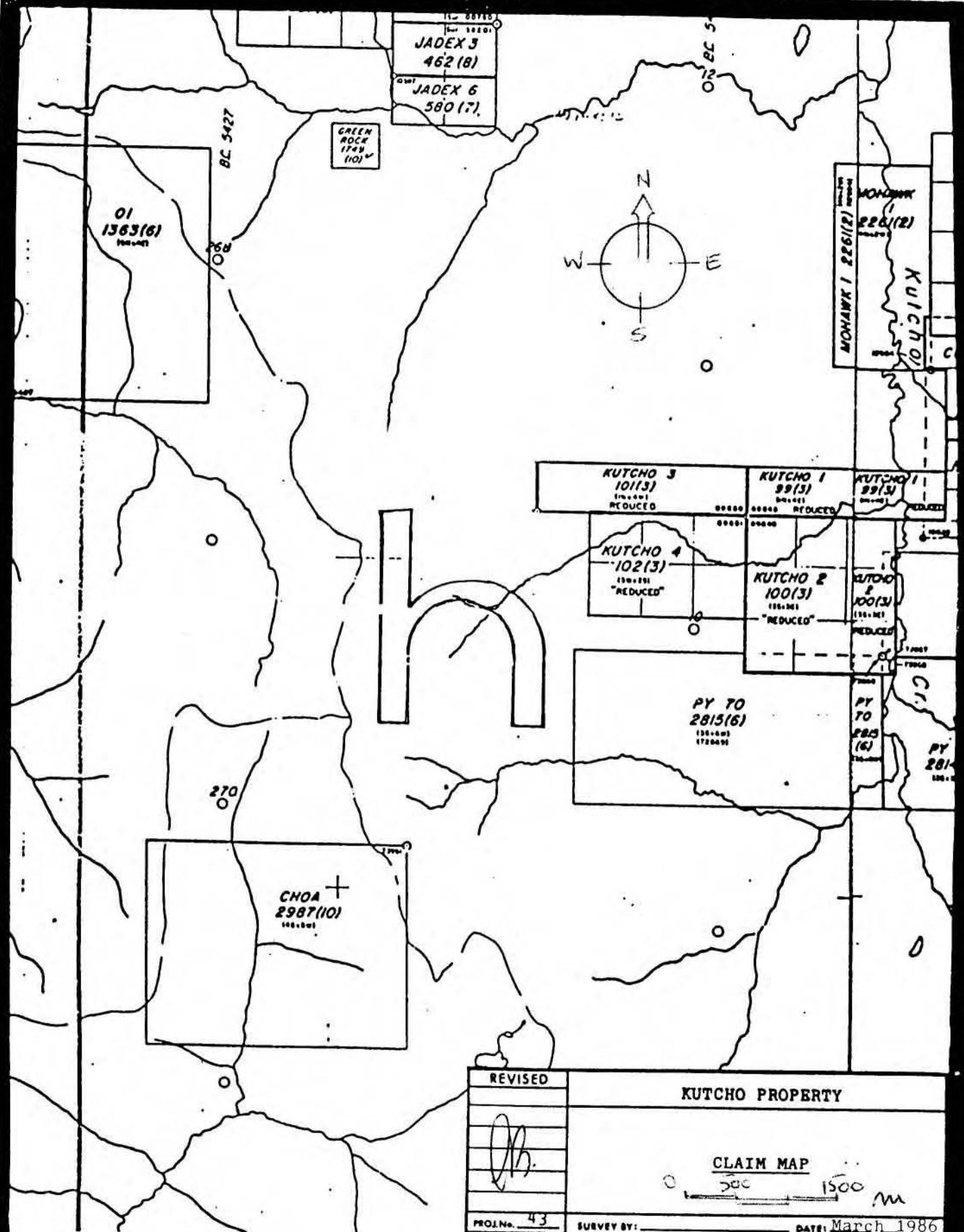

REVISED	KUTCHO PROPERTY	
<i>[Signature]</i>	CLAIM MAP	
	0 500 1500 m	
PROJ.No. 43	SURVEY BY: _____	DATE: March 1986
N.T.S. 1041/2	DRAWN BY: _____	SCALE: 1:50,000
DWG.No.	NORANDA EXPLORATION	
2	OFFICE: Prince George	

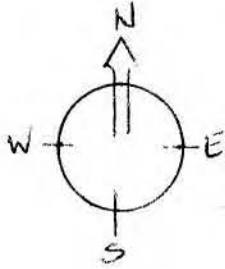

L: 9200E
 PEM SURVEY
 AUG. 1985

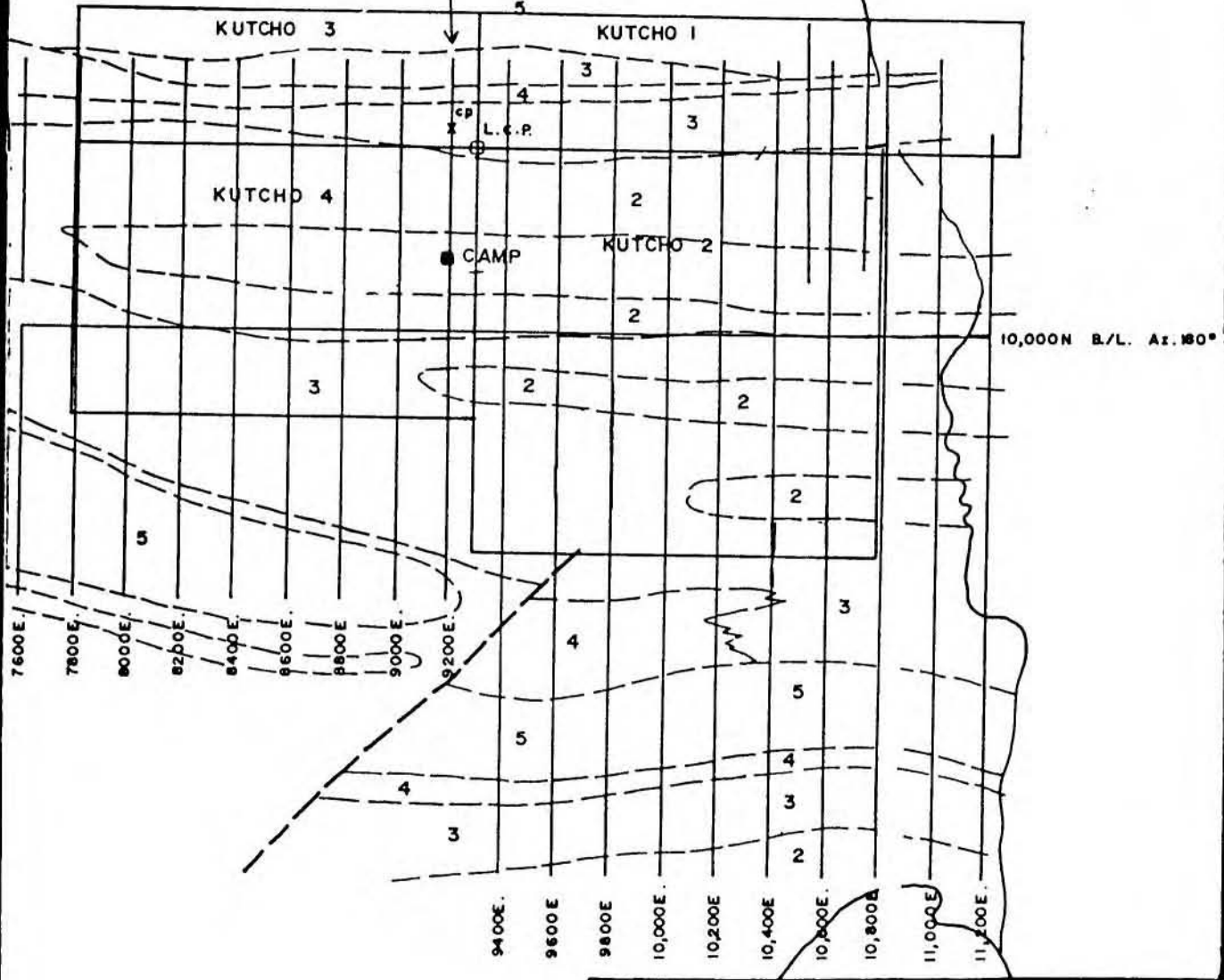

REVISED	KUTCHO PROPERTY	
<i>JB</i>	GRID LOCATION	
	PROJ. No. 243	SURVEY BY: G.M.
N.T.S. 1041/2	DRAWN BY: G.M.	DATE: March 1986
DWG. No. 3	SCALE: 1:25,000	
NORANDA EXPLORATION		
OFFICE: Prince George, B.C.		

TOPOGRAPHY AND VEGETATION:

The area is characterized by mountainous terrain with elevations up to 2200 meters and local relief on the order of 800 meters.

The area has been subjected to glaciation and most of the mountains are covered with a thin veneer of glacial debris while the lower valleys are filled with thick glacial deposits.

Vegetation in the area consists of a dense growth of spruce and fir below 1500 m merging into patches of mountain willow or "buckbrush" up to 1700 m. Above 1700 m there is only short grass and moss.

PREVIOUS WORK:

The property was staked by Imperial shortly after the discovery of the Sumac-Imperial deposit on the nearby "Jeff" and "SMRB" claims. The property was dropped after a limited amount of work.

The property was staked by Noranda in 1976 and the following table outlines the work done prior to the 1983 program.

<u>YEAR</u>	<u>CLAIMS</u>	
1976, Feb.	staking Kutcho 1 to 6	
1976, June/July		geological mapping linecutting soil survey CEM survey vertical loop EM partial IP survey partial VLF survey
1976, August	staking Kutcho 7, 8, 9 & 10	airborne VLF & Mag survey
1977, June/July	Kutcho 1 to 6	grid extension additional mapping CEM, IP, & soil sampling drill holes NK-1, NK-2, NK-3 = 229 m
	Kutcho 7, 8, 9 & 10	Total grid preparation soil survey CEM survey geological mapping
1978, August	Kutcho 8	geological mapping and CEM survey

1980, July	Kutcho 1-6	geological mapping petrographic study
1983, June	Kutcho 1-6	airborne magnetic electromagnetic survey

INSTRUMENTATION

Pulse E.M. System

The Pulse E.M. system was manufactured by Crone Geophysics of Ontario. This transient time domain E.M. system measures at eight discrete time intervals the time derivative of the secondary magnetic field which is generated by the induced current flow following the application of a strong primary E.M. pulse. The survey parameters were:

Loop size	: 13 meters
Coil separation	: 75 meters
Timebase	: 10 ms
Synchronization	: radio link
Reading Interval	: 25 meters

MP-3 Magnetometer System

Magnetometers manufactured by Scintrex Ltd. of Concord, Ontario were employed for these surveys. The MP-3 Total Field Magnetometer System consists of one or more field units and a base station. Diurnal and day to day variations are automatically corrected at the end of the survey by the built in microprocessor giving the data a useable accuracy of 0.1 gammas.

CONCLUSIONS:

The purpose of the P.E.M. survey was to test for bedrock conductivity in the vicinity of several closely grouped surficial showings. The P.E.M. survey failed to define any bedrock conductivity in this region (10500N-10900N) save for some surficial conductivity at 10750N-10900N. A near vertical bedrock conductor was defined at 10175N with an associated magnetic dipole response of 200 nT amplitude. This particular E.M. response is believed to be caused by a graphitic source. The E.M. expression of surficial or geological noise is recorded south of the graphitic horizon.

RECOMMENDATIONS

As the P.E.M. survey failed to detect significant conductivity in the vicinity of the mineralized showing it can be concluded that there is no conductive extent to the observed mineralization. A detail I.P. survey could be employed to obtain a possible signature of the showing and to determine if there is any potential for a significant deposit.

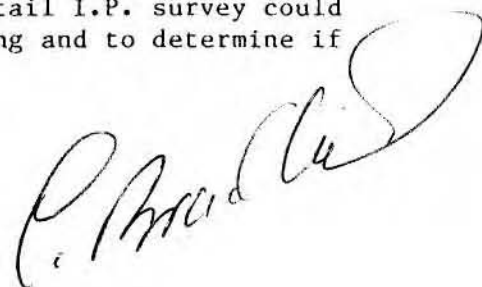

APPENDIX I
STATEMENT OF COSTS

APPENDIX I
STATEMENT OF COSTS

PROJECT: KUTCHO 1 - 4 CLAIMS

REPORT TYPE: Geophysical

a) **WAGES:**

Geophysics - 6 mandays @ \$130.00/day \$ 780.00

b) **FOOD & ACCOMMODATIONS:**

6 mandays @ \$ 50.00/day \$ 300.00

c) **TRANSPORTATION:** (BELL 206 Helicopter) \$ 2000.00

e) **COST OF PREPARATION OF REPORT:**

Author \$ 150.00
Drafting \$ 125.00
Typing \$ 125.00

TOTAL: \$ 3480.00

COST BREAKDOWN:

Geophysics:
 PEM 1.075 km's \$ 2900.00
 Mag 1.075 km's \$ 580.00

TOTAL: \$ 3480.00

APPENDIX II
STATEMENT OF QUALIFICATIONS

STATEMENT OF QUALIFICATIONS

I, Lyndon Bradish of Vancouver, Province of British Columbia, do hereby certify that:

1. I am a Geophysicist residing at 1826 Trutch Street, Vancouver British Columbia.
2. I am a graduate of the University of British Columbia with a B.Sc. (geophysics).
3. I am a member in good standing of the Society of Exploration Geophysicists, Canadian Institute of Mining and the Prospector's and Developer's Association.
4. I presently hold the position of Division Geophysicist with Noranda Exploration Company, Limited and have been in their employ since 1973.



L. Bradish.

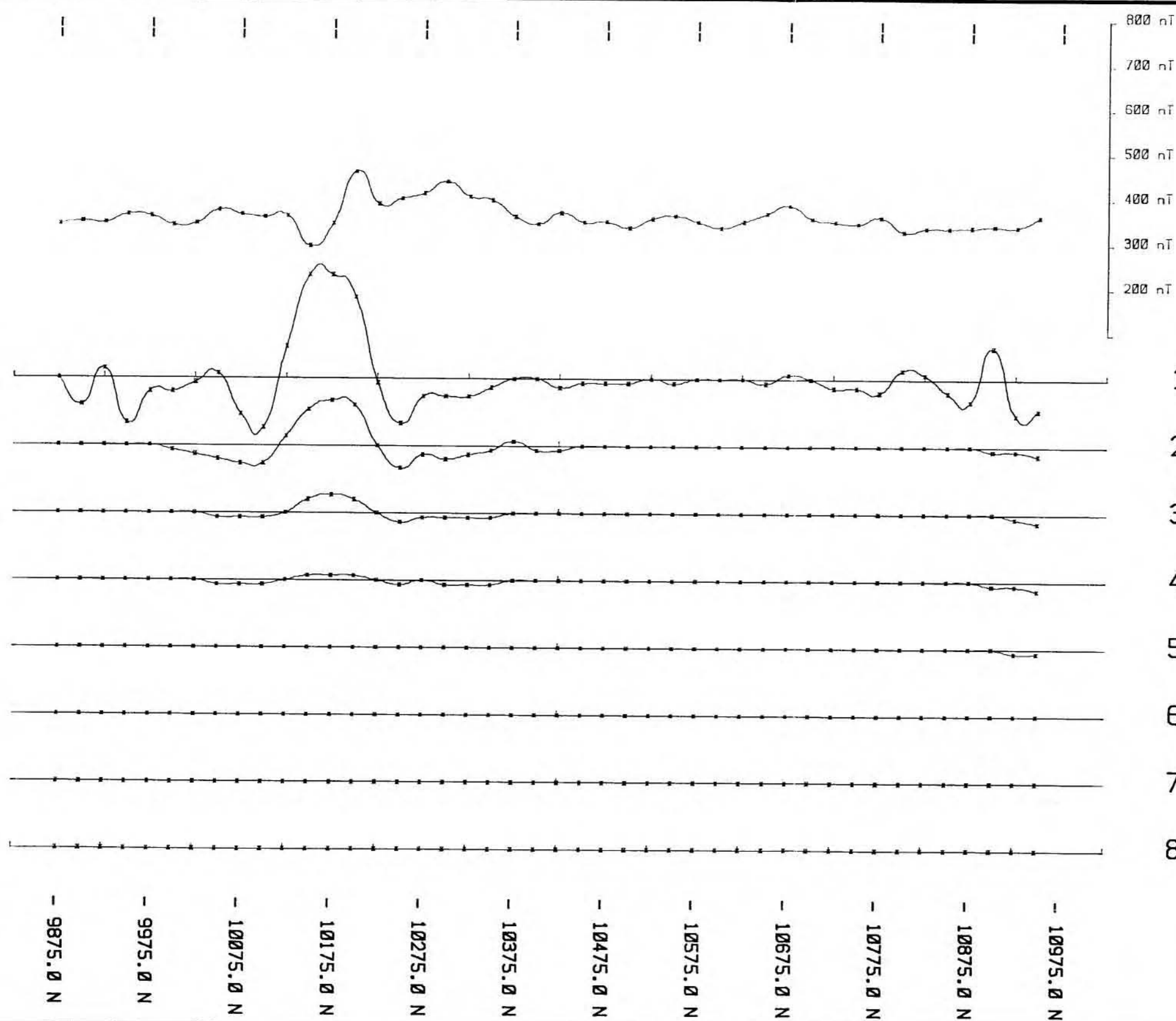

MAGNETOMETER SURVEY

DATUM : 57500 nT
 INSTR : MP-3
 SCALE : 1:100 nT

GEOLOGICAL BRANCH
ASSESSMENT REPORT

14,897

PEM SURVEY

Tx LOOP : 13 M
 TIMEBASE : 10 mS.



KUTCHO PROP.

PEM SURVEY

LINE : 9200E

FILE B:\KUTCHO43.PEM PROJECT 43

SCALE : 1:5000 DATE : 22/07/85
 SURVEY BY : WK/TK N.T.S :

NORANDA EXPLORATION