

86-260-14919  
02/87

PROSPECTING & PHYSICAL ASSESSMENT REPORT

POLY GROUP

Victoria Mining Division  
N.T.S. 92B/13W

Latitude 48 51.1' Longitude 123° 54'

for

Canamin Resources Ltd.

by

FILMED

Owner/Operator: E. Specogna

February 1986

**GEOLOGICAL BRANCH  
ASSESSMENT REPORT**

**14,919**

TABLE OF CONTENTS

	<u>PAGE</u>
Index Map Fig. 1	1 ✓
Claim Map Fig. 2	2 ✓
<del>Air Photo Xerox</del>	2B, - illegible
Introduction and Description	3 ✓
General Geology	3 ✓
Local Geology	3 ✓
Mineralization	3 ✓
Work	4 ✓

APPENDIX

- I. Statement of Expenses ✓
- II. Statement of Qualification ✓
- III. Assay Certificates ✓

MAP

- 1 Rock chip sample and trench location ✓
- 2 Local Geology ✓



POLY & POLY2

Fig. 1 INDEX MAP

SCALE APPROXIMATELY  
1cm to 87 km

# Claim Map 92B13W

Province of British Columbia  
Ministry of Energy, Mines and Petroleum Resources

**LEGEND**  
 CROWN-GRANTED MINERAL CLAIM  
 REVERTED C.G. MINERAL CLAIM  
 FORFEITED MINERAL CLAIM  
 VERIFIED LEGAL CORNER POST  
 LEGAL SURVEY  
 LEGAL CORNER POST & TAG NUMBER

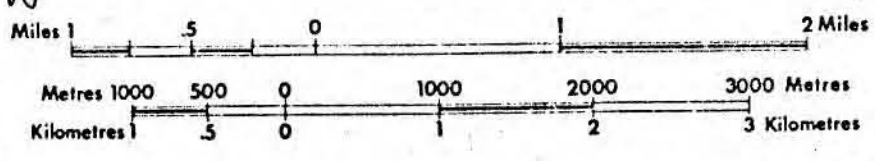

UNLESS OTHERWISE INDICATED  
 LEGAL CORNER POST INFORMATION CONCERNED.  
 DATE OF MICROFILMING

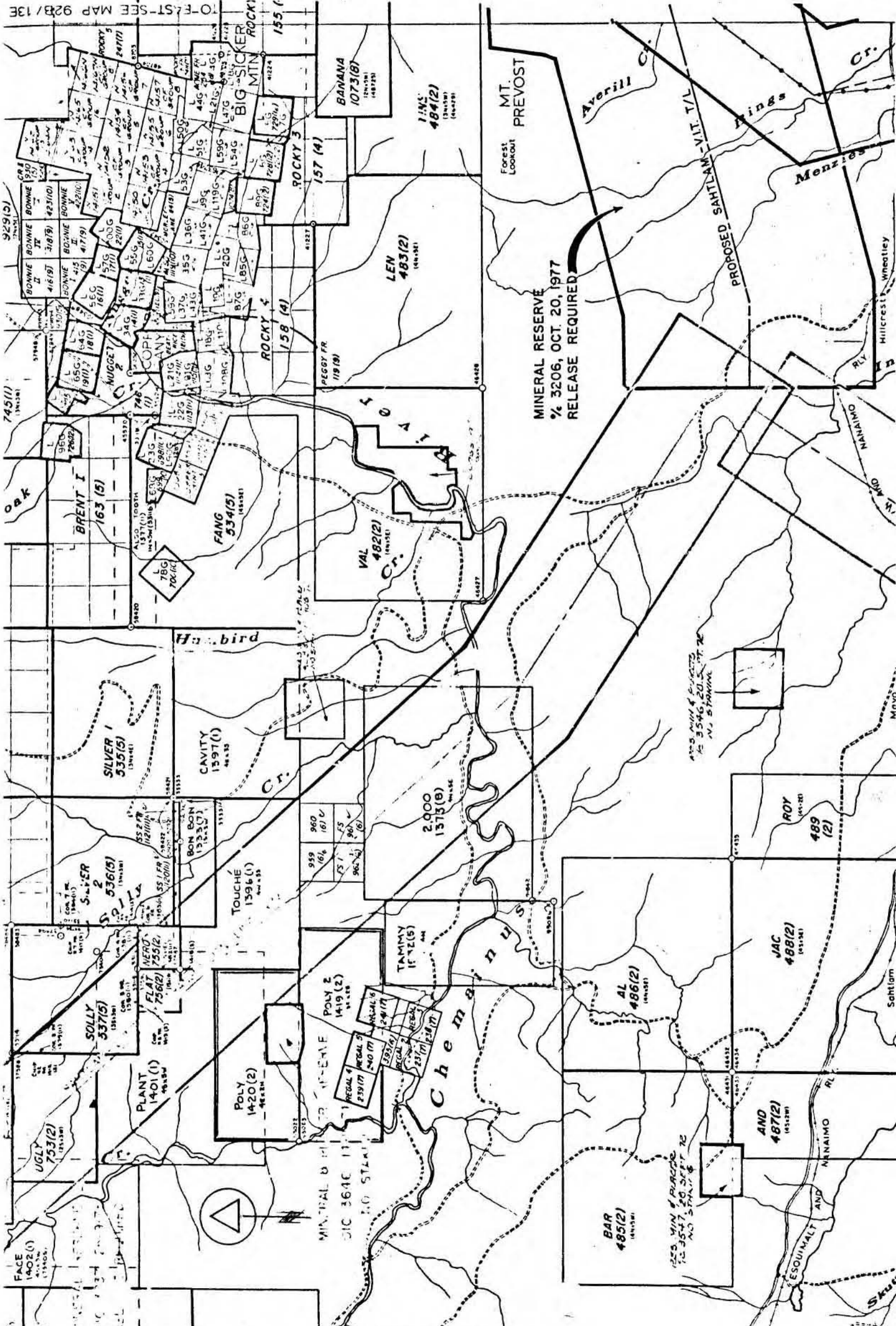

TO EAST-SEE MAP 92B/13E

PROSPECTING AND PHYSICAL REPORT  
ON THE POLY AND POLY 2 CLAIMS, VANCOUVER I.

INTRODUCTION AND DESCRIPTION

The Poly and Poly 2 consist of eight and ten units respectively. They are located on the eastern side of Chipman Creek. The centre of the claims is approximately twenty kilometres west of Crofton and can be reached by the Mac-Millan Bloodell Chemainus logging road to just past the Dunsmuir Power line. Access to the claims is then by the power line road and several old logging roads. All the roads are good except on the claims.

The writer located the claims in January 1985, part of the claim for the second time in four years. CanaMin Resources Ltd. is the beneficial owner of Poly and Poly2.

GENERAL GEOLOGY

Sicker rocks are predominant in the area followed by Nanaimo sediment. The sicker overlays the Nanaimo at least at three localities between the BonBon and Silver mineral claims. Also between Poly2, Tammy and the Western side of the Chemainus River, and in the Chemainus valley.

LOCAL GEOLOGY

On the Poly mineral claims, volcanic and sicker diorite cut the sedimentary sill (sicker) unit. To the northwest of the claim thin banded myra rocks are exposed in road cuts.

From the northern part of the Poly to the southern part of Poly2 sedimentary sill, myra and some Nitinat volcanic are exposed. These last ones are overlaying the Nanaimo sediments.

MINERALIZATION

On the Poly the sedimentary sills are metamorphized from poor slate to good slate, pyrite, pyrrhotite and traces of chalcopyrite occur concordant to bedding.

On Poly2 rhodonite in thin discontinuous bands occur associated with quartz in chert beds. Manganese oxides stain all rocks. Bull quartz is the predominant mineral.

#### WORK

Prospecting, rock chips sampling and two rock cuts were carried out on the property on the specified dates: Feb. 20, March 12 with Marino, March 15 half a day, April 1, 8, 9, 12 drilling with one cobra and a nonjar, blasting and cleaning the trenches, helped by Bruno Cosmacini. April 19 a VLF-EM sapling, 23 with Chandler of Falconbridge, 24 visited Forestry in Duncan in regard of tree reserve on property. August 14 with DeLane of Newmont, 18 with British Petroleum (SEICO), half a day on BonBon and half a day on Poly.

Thirty rock chip samples were collected and Fire Assay'd for Gold, ten for Mercury and twenty one for Silver.

APENDIX I

STATEMENT OF EXPENSES

SERVICES 14 day at \$200 per Day	\$ 2800.00
TRAVEL Km. 1235 X 40¢	204.00
Drill RENTAL 2 day X 70	140.00
Explosive	50.00
ASSAYS 31 X 10	310.00
Other supply	100.00
TOTAL	<u>3604.00</u>



APENDIX II

STATEMENT OF QUALIFICATION

I, Efrem Specogna of 1704 Centenary Dr., Nanaimo

B. C. ,certify that:

1. I am a self taught prospector.
2. I have been prospecting for over 20 years.
3. Beside many minor discoveries, I co-discovered the Babe property ( now Cinola), the Bella & Marino ,on Queen Charlotte Island.
4. On Vancouver Island,I discovered:  
The Villalta, the Amore, the Jackie, the Carol Cobalt, this last a 1985 discovery.
5. I consider my performance to be my best qualification.

E. Specogna Free Miner

February 1986





**SGS SUPERVISION SERVICES INC.**

General Testing Laboratories Division

1001 East Pender Street,  
Vancouver, B.C., Canada. V6A 1W2  
Telephone: (604) 254-1647  
Telex: 04-507514**CERTIFICATE OF ASSAY**Date: **April 15, 1985**File: **8504-1155****TO: CANAMIN RESOURCES LTD.**  
1704 Centenary Drive  
R.R. #1 Nanaimo, B.C.  
V9R 5K1We hereby certify that the following are the results of assays on: **Ore**

MARKED	GOLD	SILVER	XXX	XXX	XX	XXX	XXX	XXX
	oz/st	oz/st						
1	0.010	0.01						
2	0.008	0.12						
3	0.008	0.04						
4	0.006	0.10						
5	0.020	0.20						
6	0.016	0.14						
7	0.024	0.41						
8	0.016	0.15						
9	0.010	0.28						
10	0.014	0.36						
11	0.010	0.14						
12	0.010	0.17						

NOTE: REJECTS RETAINED ONE MONTH. PULPS RETAINED THREE MONTHS ON REQUEST PULPS AND AND REJECTS WILL BE STORE FOR A MAXIMUM OF ONE YEAR.

ALL REPORTS ARE THE CONFIDENTIAL PROPERTY OF CLIENTS. PUBLICATION OF STATEMENTS, CONCLUSION OR EXTRACTS FROM OR REGARDING OUR REPORTS IN NOT PERMITTED WITHOUT OUR WRITTEN APPROVAL. ANY LIABILITY ATTACHED THERETO IS LIMITED TO THE FEE CHARGED.

**P. Buschlen, Chemist**

PROCESSED BY

**Analytical and Consulting Chemists, Bulk Cargo Specialists, Surveyors, Inspectors, Samplers, Weighers**MEMBER: American Society For Testing Materials • The American Oil Chemists Society • Canadian Testing association  
REFEREE AND OR OFFICIAL CHEMISTS FOR: National Institute of Oilseed Products • The American Oil Chemists' Society  
OFFICIAL WEIGHMASTERS FOR: Vancouver Board Of Trade

**CERTIFICATE OF ASSAY**

Date: **May 1, 1985**

**SERVICES INC.**

File: **8504-1155**

Laboratories Division

**TO: CANAMIN RESOURCES LTD.**  
**1704 Centenary Drive**  
**R.R. #1**  
**Nanaimo, B.C.**  
**V9R 5K1**

...ender Street,  
 ...ouver, B.C., Canada. V6A 1W2  
 Telephone: (604) 254-1647  
 Telex: 04-507514

We hereby certify that the following are the results of assays on: **Ore samples** (corrected certificate)

MARKED	GOLD	SILVER	XXX	XXX	XXX	XXX	XXX	XXX
	oz/st	oz/st						
<i>CHEKS of File</i>	<i>8504-1155</i>							
1	0.010	0.01						
2	0.008	0.12						
3	0.008	0.04						
4	0.006	0.10						
5	0.032	0.13						
6	0.002	0.09						
7	0.006	0.33						
8	0.002	0.12						
9	0.002	0.05						
10	0.012	0.06						
11	0.002	0.01						
12	0.012	0.09						

NOTE: REJECTS RETAINED ONE MONTH. PULPS RETAINED THREE MONTHS ON REQUEST PULPS AND AND REJECTS WILL BE STORE FOR A MAXIMUM OF ONE YEAR.

ALL REPORTS ARE THE CONFIDENTIAL PROPERTY OF CLIENTS. PUBLICATION OF STATEMENTS, CONCLUSION OR EXTRACTS FROM OR REGARDING OUR REPORTS IN NOT PERMITTED WITHOUT OUR WRITTEN APPROVAL. ANY LIABILITY ATTACHED THERETO IS LIMITED TO THE FEE CHARGED.

**L. Wong**

PROVINCIAL ASSAYER

*Analytical and Consulting Chemists, Bulk Cargo Specialists, Surveyors, Inspectors, Samplers, Weighers*

MEMBER: American Society For Testing Materials • The American Oil Chemists Society • Canadian Testing association  
 REFEREE AND OR OFFICIAL CHEMISTS FOR: National Institute of Oilseed Products • The American Oil Chemists' Society  
 OFFICIAL WEIGHMASTERS FOR: Vancouver Board Of Trade

ACME ANALYTICAL LABORATORIES LTD.  
852 E. HASTINGS, VANCOUVER B.C.  
PH: (604)253-3158 COMPUTER LINE:251-1011

DATE RECEIVED APR 29 1985

DATE REPORTS MAILED May 3/85

### GEOCHEMICAL ASSAY CERTIFICATE

SAMPLE TYPE : ROCK - CRUSHED AND PULVERIZED TO -100 MESH.

Au\* - 10 GM. IGNITED, HOT AQUA REGIA LEACHED, MIBK EXTRACTION, AA ANALYSIS.

Hg - STANDARD BASE METAL DIGESTION, COLD VAPOUR REDUCTION AA ANALYSIS.

ASSAYER T. Saundry DEAN TOYE OR TOM SAUNDRY, CERTIFIED B.C. ASSAYER

CANAMIN RESOURCES FILE# 85-0466

PAGE# 1

SAMPLE	Au* ppb	Hg ppb
A1	110	10
A2	12	30
A3	6	30
A4	14	20
A5	10	30
A6	32	40
A7	10	50
A8	6	30
A9	26	90
A10	3	20
A11	25	30

**CERTIFICATE OF ASSAY**

Date: **April 24, 1985**

File: **8504-1953**



**SGS SUPERVISION SERVICES INC.**

General Testing Laboratories Division

1001 East Pender Street,  
Vancouver, B.C., Canada. V6A 1W2  
Telephone: (604) 254-1647  
Telex: 04-507514

**TO: CANAMIN RESOURCES LTD.**  
**1704 - Centenary Drive**  
**R.R. #1, Nanaimo, B.C.**  
**V9R 5K1**

We hereby certify that the following are the results of assays on: **Ore**

MARKED	GOLD	SILVER	XXX	XXX	XXX	XXX	XXX	XXX
	oz/st	oz/st						
P1	0.002	0.01						
P2	0.004	0.01						
P3	0.002	0.01						
P4	0.002	0.04						
P5	0.002	0.08						
P6	0.002	0.01						
P7	0.002	0.01						
P8	0.008	0.01						

NOTE: REJECTS RETAINED ONE MONTH. PULPS RETAINED THREE MONTHS ON REQUEST PULPS AND AND REJECTS WILL BE STORE FOR A MAXIMUM OF ONE YEAR.

ALL REPORTS ARE THE CONFIDENTIAL PROPERTY OF CLIENTS. PUBLICATION OF STATEMENTS, CONCLUSION OR EXTRACTS FROM OR REGARDING OUR REPORTS IN NOT PERMITTED WITHOUT OUR WRITTEN APPROVAL. ANY LIABILITY ATTACHED THERETO IS LIMITED TO THE FEE CHARGED.

*P. Buschlen*  
**P. Buschlen, Chemist**

**Analytical and Consulting Chemists, Bulk Cargo Specialists, Surveyors, Inspectors, Samplers, Weighers**

MEMBER: American Society For Testing Materials • The American Oil Chemists Society • Canadian Testing association  
REFEREE AND OR OFFICIAL CHEMISTS FOR: National Institute of Oilseed Products • The American Oil Chemists' Society  
OFFICIAL WEIGHMASTERS FOR: Vancouver Board Of Trade

# CERTIFICATE OF ASSAY

Date: **March 27, 1985**

File: **8503-2551**



**SGS SUPERVISION SERVICES INC.**

General Testing Laboratories Division

1001 East Pender Street,  
Vancouver, B.C., Canada. V6A 1W2  
Telephone: (604) 254-1647  
Telex: 04-507514

**TO: CANAMIN RESOURCES LTD.**  
1704 Centenary Drive  
R.R. #1, Nanaimo, B.C.  
V9R 5K1

We hereby certify that the following are the results of assays on:

**Ore (DDC)**

MARKED	GOLD	SILVER	Copper	XXX	XXX	XXX	XXX	XXX
	oz/st	oz/st	Cu (%)					
C 1 (1-14)	0.008	0.02	0.060					
C 1 (14 - 42)	0.018	0.02	0.012					
C 2	0.008	0.10	0.099					
C 3	0.012	0.20	0.68					
P 1	0.008	0.21	-					
<b>P 2</b>	0.010	0.06	-					
P 3	0.014	0.08	-					

NOTE: REJECTS RETAINED ONE MONTH. PULPS RETAINED THREE MONTHS ON REQUEST PULPS AND AND REJECTS WILL BE STORE FOR A MAXIMUM OF ONE YEAR

ALL REPORTS ARE THE CONFIDENTIAL PROPERTY OF CLIENTS. PUBLICATION OF STATEMENTS, CONCLUSION OR EXTRACTS FROM OR REGARDING OUR REPORTS IN NOT PERMITTED WITHOUT OUR WRITTEN APPROVAL. ANY LIABILITY ATTACHED THERETO IS LIMITED TO THE FEE CHARGED.

**P. Buschlen, Chemist**

PROVINCIAL ASSAYER

*Analytical and Consulting Chemists, Bulk Cargo Specialists, Surveyors, Inspectors, Samplers, Weighers*

MEMBER: American Society For Testing Materials • The American Oil Chemists Society • Canadian Testing association  
REFEREE AND OR OFFICIAL CHEMISTS FOR: National Institute of Oilseed Products • The American Oil Chemists' Society  
OFFICIAL WEIGHMASTERS FOR: Vancouver Board Of Trade

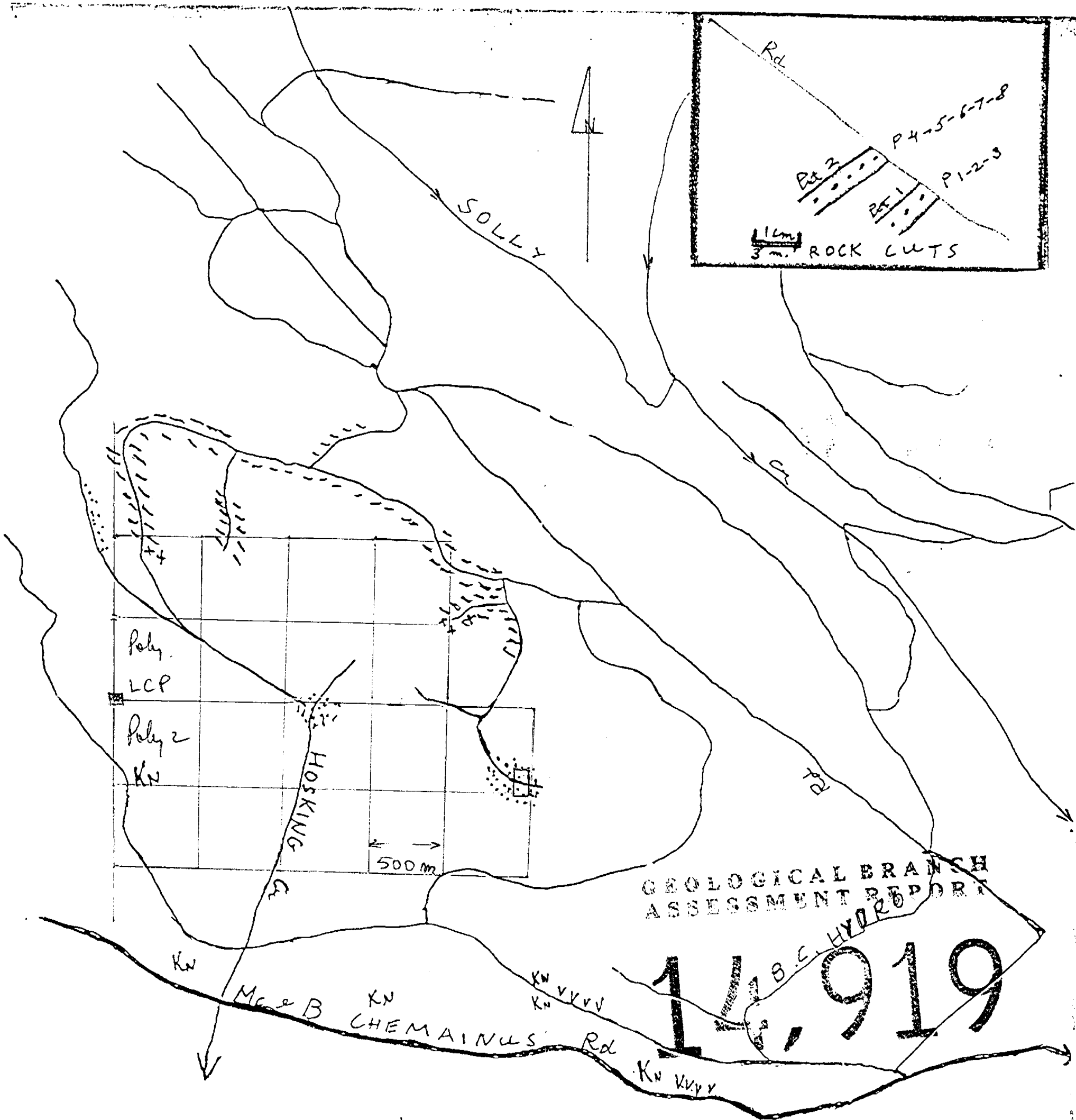

GEOLOGICAL BRANCH  
ASSESSMENT REPORT

11, 1919  
B.C. HYDRO

Scale  
1:22650

SEDIMENT SILL	MYRA	NITINAT	NAVAIMO	SICKER DIORITE	ROCK PITS
PM	PM	V P V V V V P V V V	KN	+ P + + P +	

POLY & POLY 2 PROPERTY

---

Local Geology

---

NTS 92B/13W Map 2

Rock

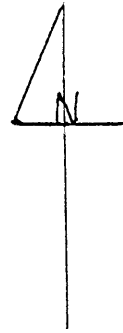

ROCK CHIP DESCRIPTION

- |                      |                             |                             |
|----------------------|-----------------------------|-----------------------------|
| 1 random             | A1 Myra float               | P1 rhodonite no quartz      |
| 2 quartz             | A2 rhodonite                | P2 fresh rhodonite          |
| 3 chert              | A3 slate                    | P3 scoop of rhodonite fines |
| 4 chert              | A4 " " " " " "              | P4 mixt quartz & rhodonite  |
| 5 rhodonite          | A5 " " " " " "              | P5 " " " " evenly & fresh   |
| 6 quartz             | A6 " " " " " "              | P6 " " " " " " " " " " " "  |
| 7 quartz & rhodonite | A7 " " " " " "              | P7 more rhod. than quartz   |
| 8 quartz             | A8 slate with quartz vein   | P8 Same, more Mn. oxide     |
| 9 slate              | A9 quartz near Sill         |                             |
| 10 " " " "           | A10 " " " " " " " " " " " " |                             |
| 11 " " " "           | J24 slate float             |                             |
|                      | P1 slate                    |                             |

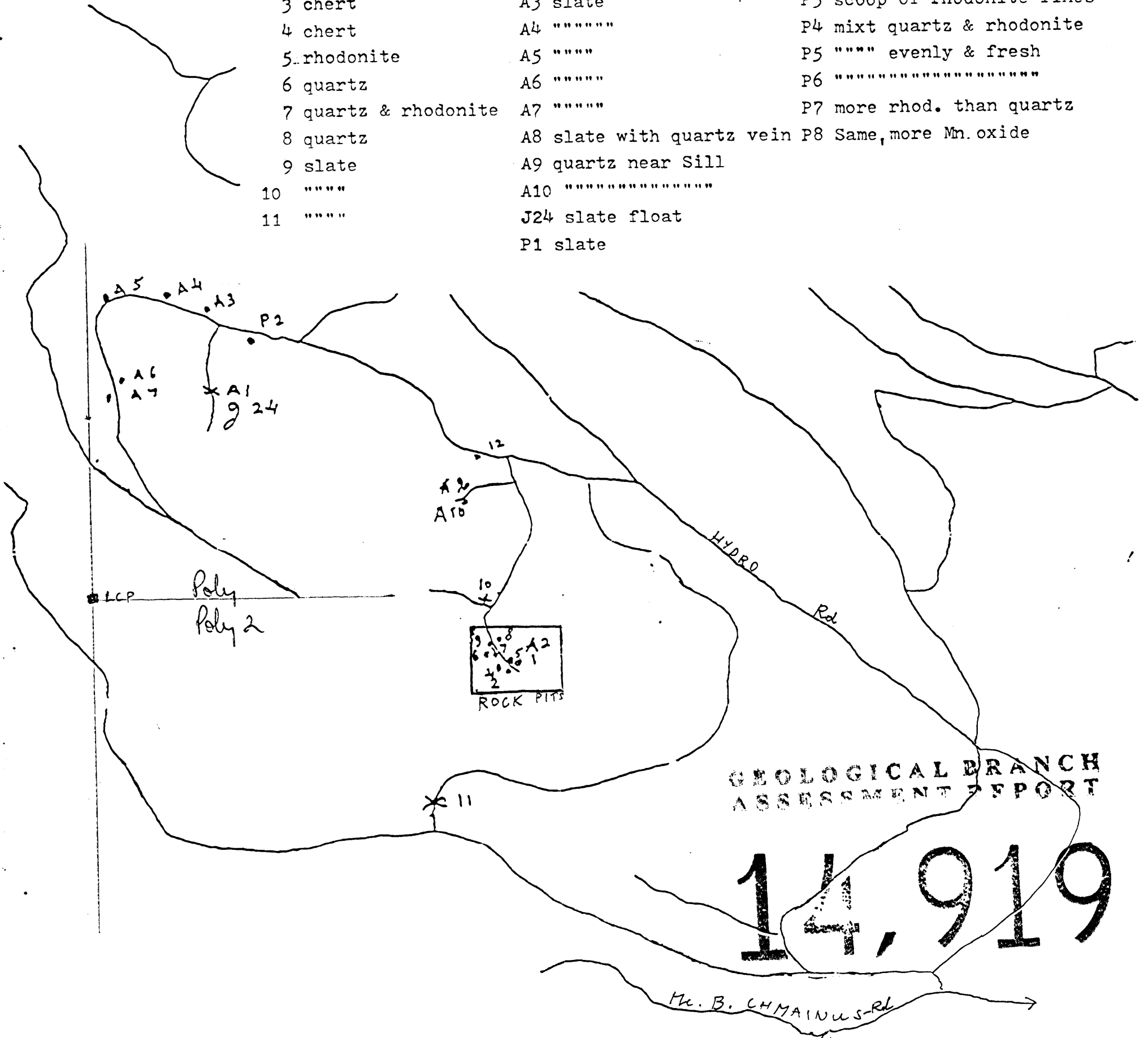

GEOLOGICAL BRANCH  
ASSESSMENT REPORT

14,919

Rock CHIP POSITION •

POLY & POLY 2 PROPERTY

Rock Chip & Trench Loc..

NTS 92B/13W

Map #