

86-535-15163
09/87

GEOCHEMICAL REPORT
ON THE
ROCK 1-11, 13-14 MINERAL CLAIMS
GREENWOOD M. D.
MAP #82E-3E

119° 05.2' West
49° 01.8' North

for

Owner(s)/Operator(s):

STAN WIRTH
11336 - 133A Street
Surrey, B.C.
V3R 2Y9

D. Hopper

**GEOLOGICAL BRANCH
ASSESSMENT REPORT**

by

DOUG HOPPER
P.I.M. ONTARIO

15,163

September 15, 1986

Vancouver, B.C.

FILMED

KAMLOOPS

86-535-15163



Province of British Columbia

Ministry of Energy, Mines and Petroleum Resources

ASSESSMENT REPORT TITLE PAGE AND SUMMARY

TYPE OF REPORT/SURVEY(S)	PROSPECTING	TOTAL COST
		\$3,285.91

AUTHOR(S) Doug Hopper SIGNATURE(S) Doug Hopper

DATE STATEMENT OF EXPLORATION AND DEVELOPMENT FILED September 17, 1986 YEAR OF WORK 1986

PROPERTY NAME(S) ROCK

COMMODITIES PRESENT

B.C. MINERAL INVENTORY NUMBER(S), IF KNOWN

MINING DIVISION Greenwood NTS 82E/3E

LATITUDE 49°01.8' LONGITUDE 119°05.2'

NAMES and NUMBERS of all mineral tenures in good standing (when work was done) that form the property [Examples: TAX 1-4, FIRE 2 (12 units); PHOENIX (Lot 1706); Mineral Lease M 123; Mining or Certified Mining Lease ML 12 (claims involved)]:

ROCK 1-11 (11 units total), ROCK 13-14 (2 units total)

OWNER(S) (1) Doug Hopper (2) S. Wirth

MAILING ADDRESS 203-828 West Hastings Street Vancouver, B.C. V6C 1C8 11336 - 133A Street Surrey, B.C. V3R 2Y9

OPERATOR(S) (that is, Company paying for the work) (1) S. Wirth (2) D. Hopper

MAILING ADDRESS 11336 - 133A Street Surrey, B.C. V3R 2Y9 203-828 West Hastings Street Vancouver, B.C. V6C 1C8

SUMMARY GEOLOGY (lithology, age, structure, alteration, mineralization, size, and attitude):

The claims appear to be underlain by ultramafic rocks. Soil and rock sample results are inconclusive.

REFERENCES TO PREVIOUS WORK

TABLE OF CONTENTS

	<u>Page</u>
CLAIM GROUP.....	1
CLAIM LOCATION.....	1
WORK DONE.....	1
CLAIM ACCESS.....	2
ROCK CLAIMS.....	2
GEOCHEMISTRY.....	2
ROCK SAMPLES.....	3
BRITISH COLUMBIA MAP.....	4
CLAIM MAP.....	5
CERTIFICATE - D. HOPPER.....	6
ANALYTICAL REPORT.....	7
GEOCHEMICAL ANALYSIS CERTIFICATE.....	8 - 11
ROCK GEOCHEM-ICP SURVEY.....	12
COSTS FOR ASSESSMENT.....	13.

MAPS

NICKEL GEOCHEM & SAMPLE LOCATION 1 - 500.....	[In pocket]
SILVER & GOLD GEOCHEM MAP 1-500.....	[In pocket]

CLAIM GROUP

<u>Claim Name</u>	<u>Staked by</u>	<u>Record No.</u>	<u>Recorded Date</u>
Rock # 1	D. Hopper	4393	September 27, 1985
Rock # 2	"	4394	"
Rock # 3	"	4395	"
Rock # 4	"	4396	"
Rock # 5	E. Fowler	4397	September 27, 1985
Rock # 6	"	4398	"
Rock # 7	"	4399	"
Rock # 8	"	4400	"
Rock # 9	"	4401	"
Rock #10	"	4402	"
Rock #11	"	4403	"
Rock #13	S. Wirth	4404	September 27, 1985
Rock #14	"	4405	"

CLAIM LOCATION

The claims are located along Budy Creek, south of the old railroad bed and thence west for four claims. See Map #82E-3E [S.E. corner] 119° 5' west and 49° 2' north, also 5 km due east of Bridesville, B.C.

WORK DONE

The work done on the Rock claims was general prospecting, geochem sampling, rock sampling, some geological data collected by Ernest Fowler and Doug Hopper between the dates of September 17, 1985 and September 18, 1986; also some line chaining; blazed and flagged lines with 50 metre intervals for the geochem samples.

CLAIM ACCESS

Claim access may be gained by going 750 m. west of the large bridge [3 km east of Bridesville, B.C.] to a cattle rancher by the name of Bateman, who will grant the permission to cross his land south up to the railroad bed which leads exactly to the north end of the claim group by going east.

ROCK CLAIMS

The rock claims were staked to cover a part of a Nickel anomaly that was written up by Livgard Consultants in 1980, Report #9296 [Old Nick Nickel Property].

GEOCHEMISTRY

Forty soil samples were taken from the area and assayed for Nickel [ppm], Silver [ppm] and Gold [ppb].

The samples were taken from the "B" horizon, 6 - 12" of depth, at 50 meter intervals across a couple of lines that crossed the old grid area.

The Nickel values that were attained compared to the past results. This was done primarily to test the validity of past results.

The Silver values are somewhat anomalous over the higher Nickel anomalous area and will probably conform to the Nickel values established previously.

ROCK SAMPLES

071411	16S - 1.5W	Serpentine rock
071414	8S - 1.5W	Serpentine rock
071415	16S - 5.0W	Large quartz-carbonate brecciated zone, orange stained in contact with the serpentine.
071416	8S - 3 W	Mafic tuff, angular, $\frac{1}{2}$ " fragments, $\frac{1}{2}$ % pyrite
071417	8S - 9 W	Quartz veining, small zone on the andesite. Pyrite and magnetite, epidote alteration.
071418	16S - 2 W	Quartz veining to 1" and pyrite in the serpentine
071420	16S - 6 W	Same as sample #071415

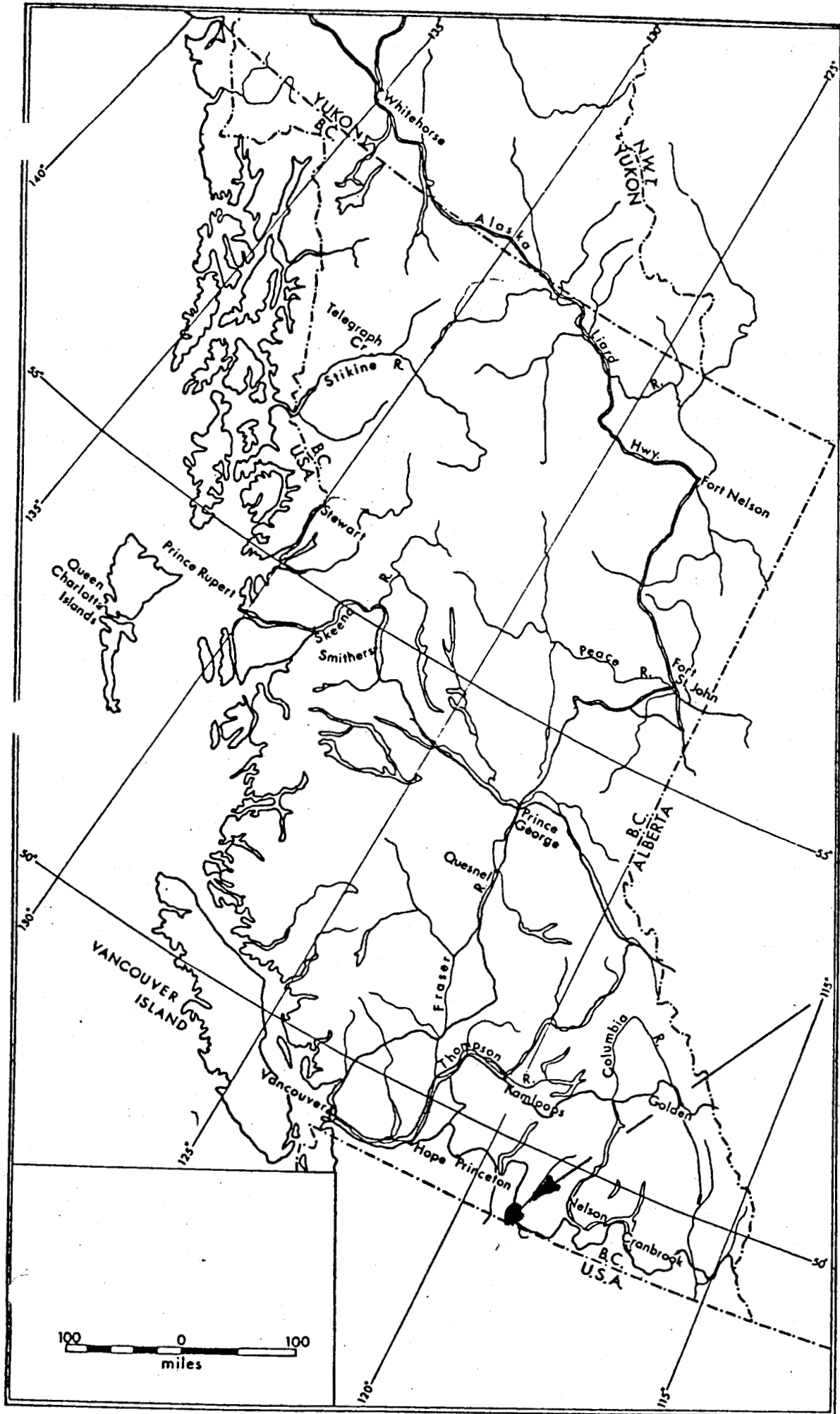

ROCK CLAIM
GROUP

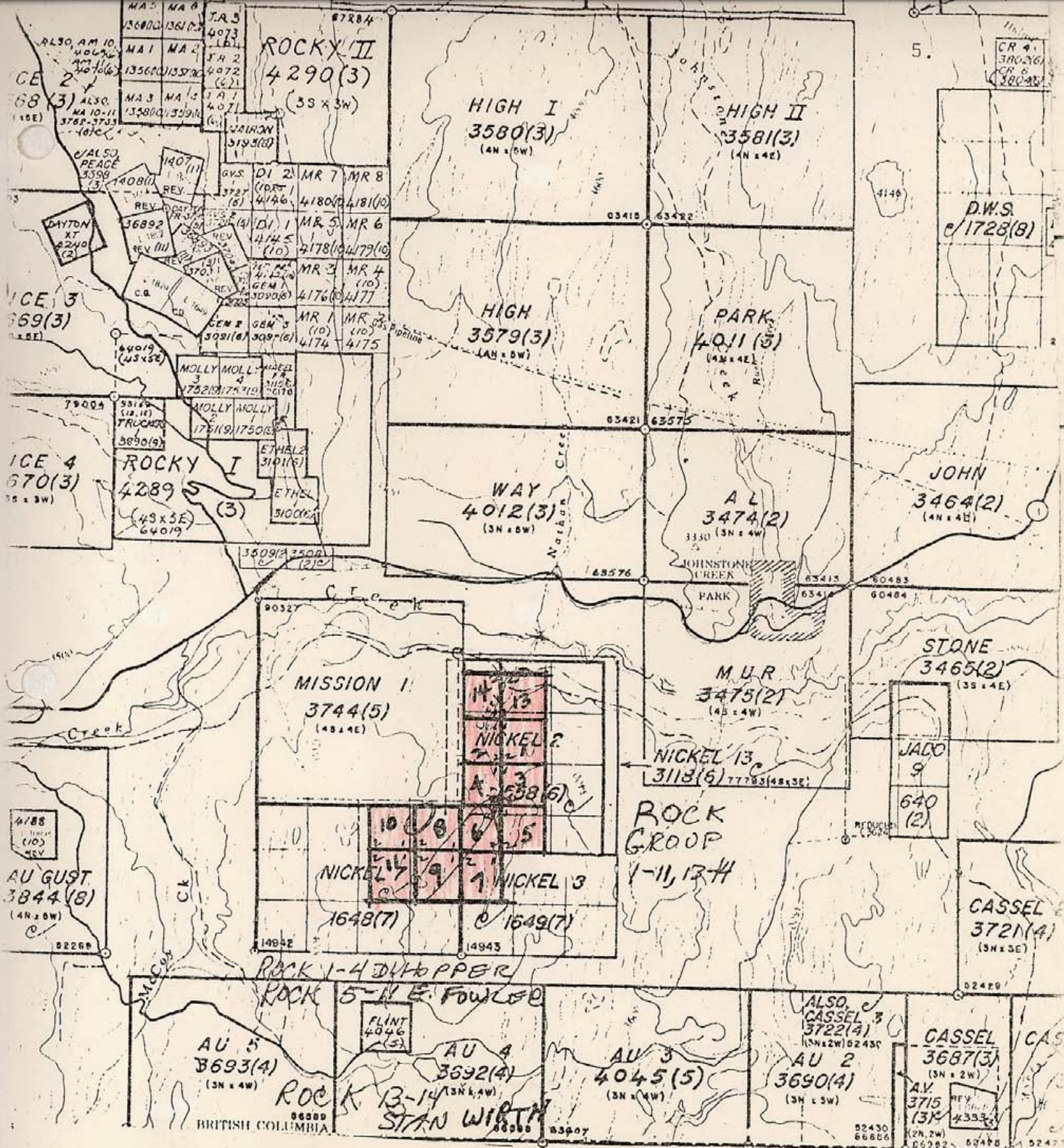

MAP 82F / 3 E

DATE OF MICROFILM: A50901

CERTIFICATE

I, H. DOUGLAS HOPPER of 828 West Hastings Street, Vancouver, B.C., did attend the Provincial Institute of Mining, Haileybury, Ontario in the years 1962-1964, 1965 and 1966, for which I am a Mining Engineering Technologist.

Since 1966, I have worked with various mining companies as Field Geologist, Junior Engineer, looking after diamond drilling projects, underground mining exploration and surface exploration.

Dated at Vancouver, British Columbia, this 15th day of Sept. 1986.

H. Douglas Hopper
H. Douglas Hopper

H. Douglas Hopper

MIN-EN Laboratories Ltd.

705 WEST 15th STREET,
NORTH VANCOUVER, B.C., CANADA V7M 1T2
TELEPHONE (604) 980-5814

ANALYTICAL REPORT

Project Acapulco Res Date of report Sept. 28/85.

File No. 5-706 Date samples received Sept. 23/85.

Samples submitted by:

Company: Doug Hopper

Report on: 40 soils 10 rocks assay prep (1 rock) Geochem samples

Assay samples

Copies sent to:

1. Doug Hopper, Vancouver, BC
2.
3.

Samples: Sieved to mesh Ground to mesh -100

Prepared samples stored discarded
 rejects stored discarded

Methods of analysis: Geochem Ni, Ag, Cr-nitric, perchloric digestion. A.A.,
Au-fire. 31 element ICP. Soil Geochem Au-aqua regia A.A.

Remarks:

MUN-EN Laboratories Ltd.

Specialists in Mineral Environments

705 WEST 15th STREET NORTH VANCOUVER, B.C. CANADA V7M 1T2

8.

PHONE: (604) 980-5814 OR (604) 988-4571

TELEX: 04-352828

GEOCHEMICAL ANALYSIS CERTIFICATE

COMPANY: DOUG HOPPER
PROJECT:
ATTENTION: DOUG HOPPER

FILE: 5-706/P1
DATE: OCT. 2/85.
TYPE: SOIL GEOCHEM

We hereby certify that the following are the results of the geochemical analysis made on 30 samples submitted.

SAMPLE NUMBER	NI PPM	AG PPM	AU PPB
85-0.5E	52	0.2	5
1.0E	29	0.3	10
1.5E	60	0.4	5
2.0E	26	0.2	35
2.5E	16	0.4	5
0+0	67	0.3	5
0.5W	122	0.3	10
1.0W	73	0.3	3
1.5W	260	0.8	5
2.0W	60	0.5	10
2.5W	170	0.9	5
85-3.0W	245	0.8	5
L1680.0	23	0.3	5
0.5W	30	0.3	10
1.0W	33	0.2	10
1.5W	16	0.2	5
2.0W	12	0.2	10
2.5W	42	0.3	5
3.0W	60	0.3	5
3.5W	26	0.2	5
4.0W	45	0.2	5
4.5W	50	0.3	5
5.0W	92	1.3	10
5.5W	42	1.5	5
6.0W	57	1.2	10
6.5W	72	0.6	5
7.0W	60	0.5	5
7.5W	32	0.4	5
8.0W	46	0.7	5
L1658.5W	18	0.4	5

Certified by



PHONE: (604) 980-5814 OR (604) 988-4521

TELEY: 04-352828

GEOCHEMICAL ANALYSIS CERTIFICATE

COMPANY: DOUG HOPPER
PROJECT:
ATTENTION: DOUG HOPPER

FILE: 5-706/P2
DATE: OCT. 1/85.
TYPE: SOIL GEOCHEM

We hereby certify that the following are the results of the geochemical analysis made on 10 samples submitted.

SAMPLE NUMBER	NI PPM	AG PPM	AU PPB
L1487.0W	38	0.3	5
7.5W	36	0.4	10
10.0W	48	0.2	5
10.5W	21	0.2	5
11.0W	22	0.2	15
11.5W	22	0.1	10
12.0W	24	0.3	5
12.5W	16	0.3	5
13.0W	24	0.4	20
L16813.5W	20	0.2	5

Certified by

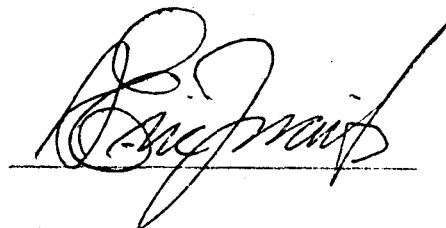

PHONE: (604) 988-5814 OR (604) 988-4524

TELEX: 04-352829

GEOCHEMICAL ANALYSIS CERTIFICATE

COMPANY: DOUG HOPPER
PROJECT: ACAPULCO RES.
ATTENTION: DOUG HOPPER

FILE: 5-706
DATE: SEPT. 28/85.
TYPE: ROCK GEOCHEM

We hereby certify that the following are the results of the geochemical analysis made on 10 samples submitted.

SAMPLE NUMBER	NI PPM	AG PPM	AU-FIRE PPB	CR PPM	LOCATION
071411	70	2.3	16		16S- 1.5W
412	66			230	
413	30	2.2	1		
414	205	1.4	4		8S- 1.5W
415	20	0.7	8		16S- 5W
416	210	1.3	2		8S- 3W
417		1.9	7		8S- 9W
418	22	0.6	2		16S- 2W
419	10	1.2	3	25	
071420	26	0.9	6		16S- 6W

Certified by



PHONE: (604) 989-5814 OR (604) 988-4524

TELEX: 04-352829

GEOCHEMICAL ANALYSIS CERTIFICATE

COMPANY: DOUG HOPPER
PROJECT:
ATTENTION: DOUG HOPPER

FILE: 5-706
DATE: OCT. 1/85.
TYPE: ROCK GEOCHEM

We hereby certify that the following are the results of the geochemical analysis made on 1 samples submitted.

SAMPLE NUMBER	NI PPM	AG PPM	AU PPB
18A7.50	44	0.4	15

Certified by

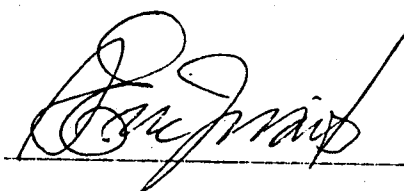

COMPANY: DOUG HOPFER
PROJECT NO: ACAFULCO RES.
ATTENTION: DOUG HOPFER

MIN-EN LABS LTD REPORT

705 WEST 15TH ST., NORTH VANCOUVER, B.C. V7M 1T2

(ACT:GEO27) PAGE 1 OF 1

FILE NO: 5-706

(604)980-5814 OR (604)986-4524

* TYPE ROCK GEOCHEM *

DATE: SEPT 28, 1985

(PFM) 071418

165 - 2W

SERPENTINE (AT2 UNS - PY.)

AG .5
AL 9550
AS 19
B 7
BA 175

12.

BE 1.8
BI 5
CA 7550
CD .5
CO 9

CU 34
FE 18490
K 660
LI 11
MG 7950

MN 586
MO 7
NA 220
NI 22
P 270

PE 26
SB 5
SP 31
TH 3
U 1

V 58.5
ZN 34
GA 5
GE 6
SE 1

SH 3
W 6

ROCK CLAIM EXPENSESOctober 2, 1985 - September 15, 1986

Supplies	\$ 89.47
Travel - Gas & Oil and Truck Rental	529.62
Meals and Lodging	197.08
Groceries	142.58
Wages for E. Fowler	550.00
Wages for D. Hopper	780.00
Compensation	63.84
Accounting	<u>235.00</u>
	2,587.59
Assaying	<u>469.00</u>
	3,056.59
D. Hopper - Drafting & Report Preparation	162.50
Printing of Maps	25.31
Typing and Folders	<u>41.51</u>
TOTAL	\$ <u><u>3,285.91</u></u>

BAKER CREEK

MISSION #1
3744 (5)
4S x 4E

GEOLOGICAL BRANCH
ASSESSMENT REPORT

15,163

LEGEND

RAIL ROAD BED	CLAIMS, BRIDESVILLE, B.C.
SCALE 1-500	
0 100 200 300 METERS	
□ CLAIM POST	
NICKLE GEOCHEM MAP	
71417 → ROCK SAMPLE LOCATION	

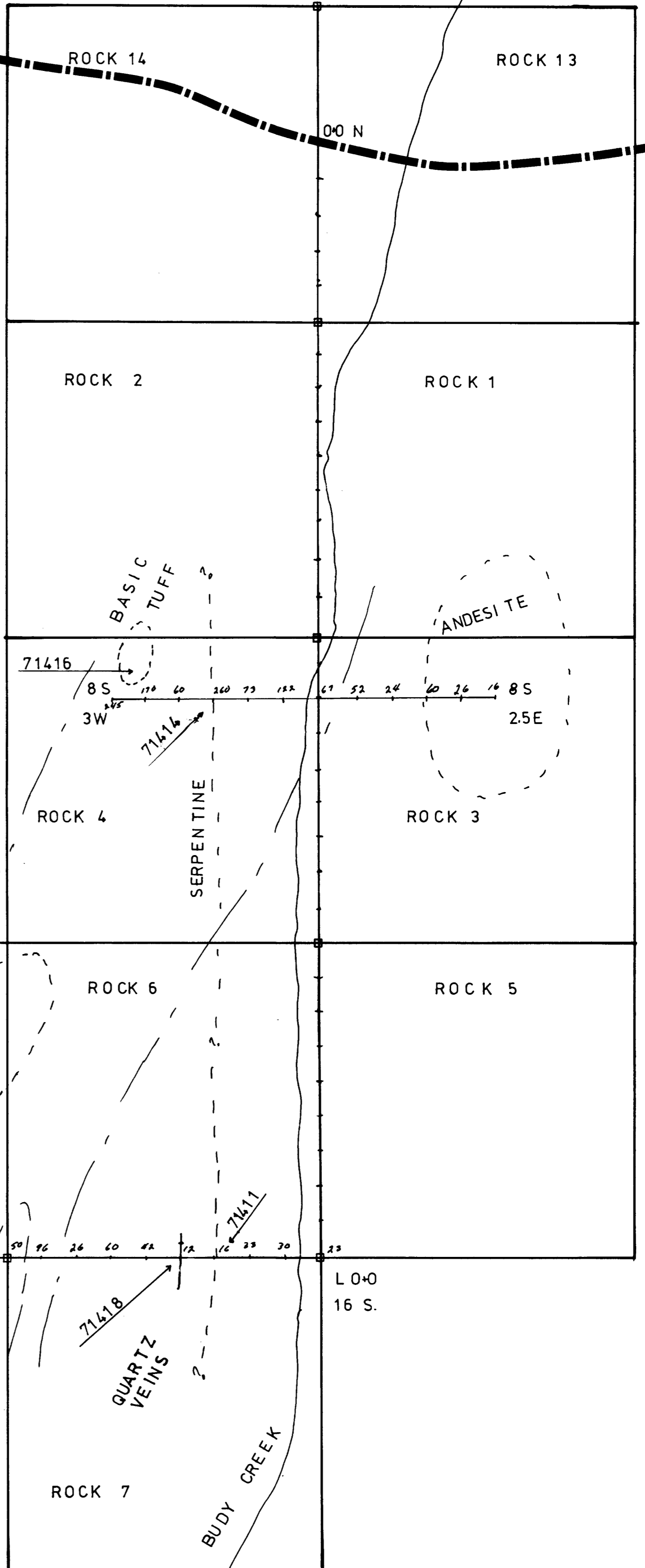
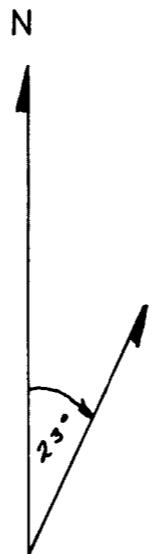

16 S.
13.5 W.

L 0+0
16 S.

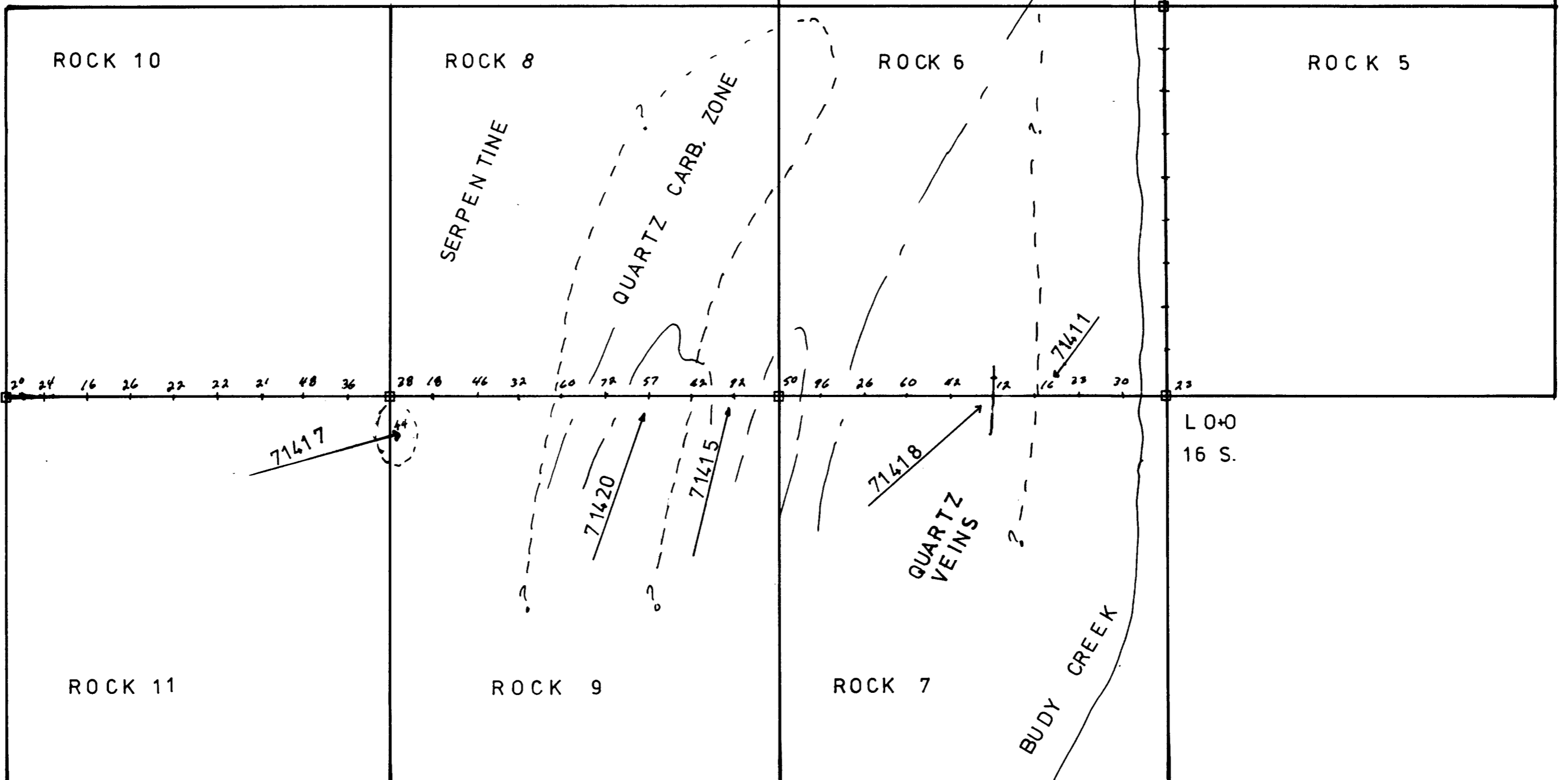

BAKER CREEK

MISSION #1
3744 (5)
4S x 4E

GEOLOGICAL BRANCH
ASSESSMENT REPORT

15, 163

ROCK CLAIMS BRIDESVILLE, B.C.
RAIL ROAD BED
SCALE: 1-500
0 100 200 300 METERS
□ CLAIM POST <i>J. HOPPER SET</i>

SILVER GOLD GEOCHEM MAP

A.G. RPM. 1.2
AU. PPB. 10



16 S.
13.5 W.

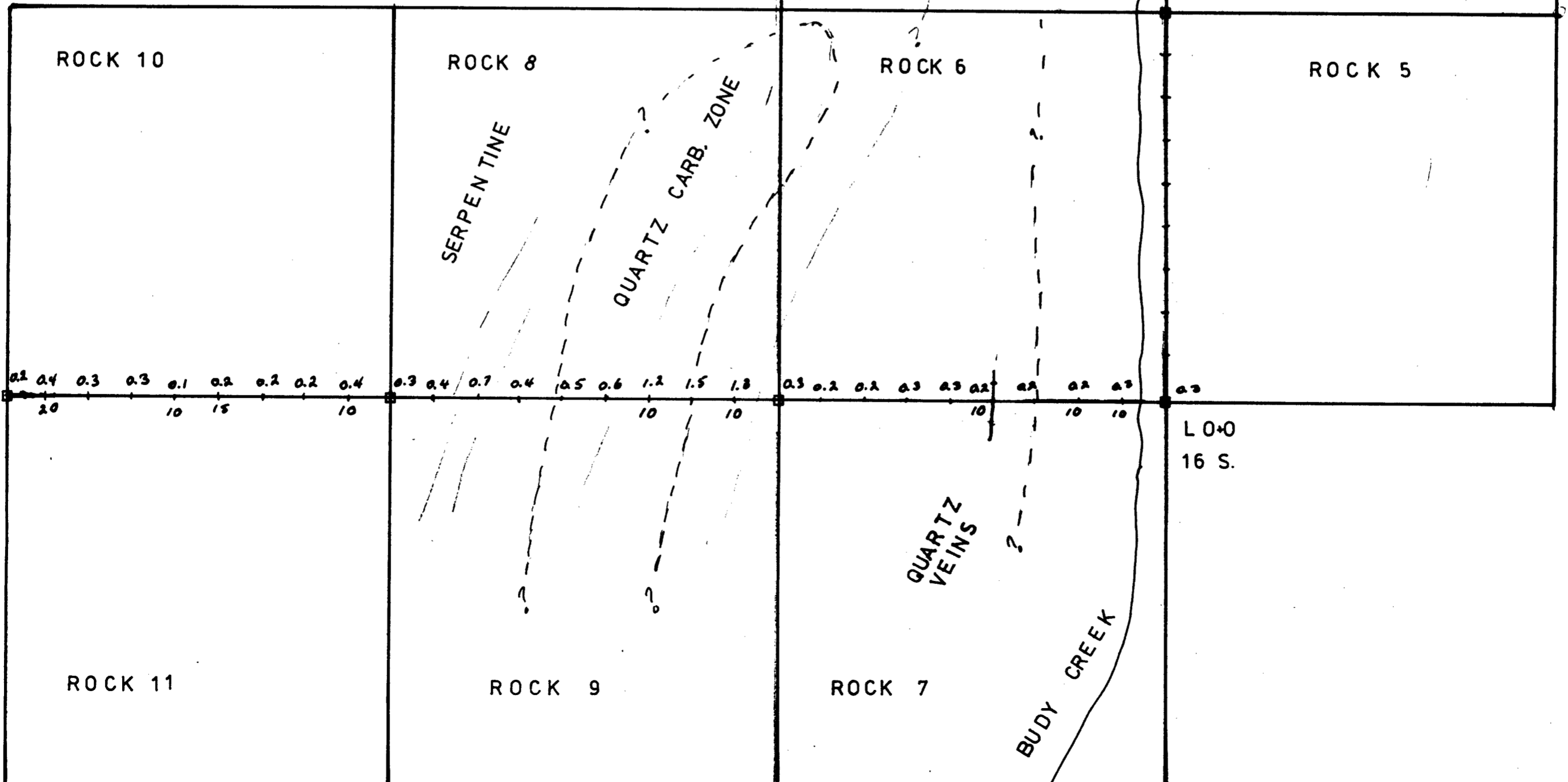

8S 0.1 0.2 0.3 0.4 0.5 0.6 0.7 0.8 0.9 1.0 1.1 1.2 1.3 1.4 1.5 1.6 1.7 1.8 1.9 2.0 2.1 2.2 2.3 2.4 2.5 2.6 2.7 2.8 2.9 3.0 3.1 3.2 3.3 3.4 3.5 3.6 3.7 3.8 3.9 4.0 4.1 4.2 4.3 4.4 4.5 4.6 4.7 4.8 4.9 5.0 5.1 5.2 5.3 5.4 5.5 5.6 5.7 5.8 5.9 6.0 6.1 6.2 6.3 6.4 6.5 6.6 6.7 6.8 6.9 7.0 7.1 7.2 7.3 7.4 7.5 7.6 7.7 7.8 7.9 8.0 8.1 8.2 8.3 8.4 8.5 8.6 8.7 8.8 8.9 9.0 9.1 9.2 9.3 9.4 9.5 9.6 9.7 9.8 9.9 10.0 10.1 10.2 10.3 10.4 10.5 10.6 10.7 10.8 10.9 11.0 11.1 11.2 11.3 11.4 11.5 11.6 11.7 11.8 11.9 12.0 12.1 12.2 12.3 12.4 12.5 12.6 12.7 12.8 12.9 13.0 13.1 13.2 13.3 13.4 13.5 13.6 13.7 13.8 13.9 14.0 14.1 14.2 14.3 14.4 14.5 14.6 14.7 14.8 14.9 15.0 15.1 15.2 15.3 15.4 15.5 15.6 15.7 15.8 15.9 16.0 16.1 16.2 16.3 16.4 16.5 16.6 16.7 16.8 16.9 17.0 17.1 17.2 17.3 17.4 17.5 17.6 17.7 17.8 17.9 18.0 18.1 18.2 18.3 18.4 18.5 18.6 18.7 18.8 18.9 19.0 19.1 19.2 19.3 19.4 19.5 19.6 19.7 19.8 19.9 20.0 20.1 20.2 20.3 20.4 20.5 20.6 20.7 20.8 20.9 21.0 21.1 21.2 21.3 21.4 21.5 21.6 21.7 21.8 21.9 22.0 22.1 22.2 22.3 22.4 22.5 22.6 22.7 22.8 22.9 23.0 23.1 23.2 23.3 23.4 23.5 23.6 23.7 23.8 23.9 24.0 24.1 24.2 24.3 24.4 24.5 24.6 24.7 24.8 24.9 25.0 25.1 25.2 25.3 25.4 25.5 25.6 25.7 25.8 25.9 26.0 26.1 26.2 26.3 26.4 26.5 26.6 26.7 26.8 26.9 27.0 27.1 27.2 27.3 27.4 27.5 27.6 27.7 27.8 27.9 28.0 28.1 28.2 28.3 28.4 28.5 28.6 28.7 28.8 28.9 29.0 29.1 29.2 29.3 29.4 29.5 29.6 29.7 29.8 29.9 30.0 30.1 30.2 30.3 30.4 30.5 30.6 30.7 30.8 30.9 31.0 31.1 31.2 31.3 31.4 31.5 31.6 31.7 31.8 31.9 32.0 32.1 32.2 32.3 32.4 32.5 32.6 32.7 32.8 32.9 33.0 33.1 33.2 33.3 33.4 33.5 33.6 33.7 33.8 33.9 34.0 34.1 34.2 34.3 34.4 34.5 34.6 34.7 34.8 34.9 35.0 35.1 35.2 35.3 35.4 35.5 35.6 35.7 35.8 35.9 36.0 36.1 36.2 36.3 36.4 36.5 36.6 36.7 36.8 36.9 37.0 37.1 37.2 37.3 37.4 37.5 37.6 37.7 37.8 37.9 38.0 38.1 38.2 38.3 38.4 38.5 38.6 38.7 38.8 38.9 39.0 39.1 39.2 39.3 39.4 39.5 39.6 39.7 39.8 39.9 40.0 40.1 40.2 40.3 40.4 40.5 40.6 40.7 40.8 40.9 41.0 41.1 41.2 41.3 41.4 41.5 41.6 41.7 41.8 41.9 42.0 42.1 42.2 42.3 42.4 42.5 42.6 42.7 42.8 42.9 43.0 43.1 43.2 43.3 43.4 43.5 43.6 43.7 43.8 43.9 44.0 44.1 44.2 44.3 44.4 44.5 44.6 44.7 44.8 44.9 45.0 45.1 45.2 45.3 45.4 45.5 45.6 45.7 45.8 45.9 46.0 46.1 46.2 46.3 46.4 46.5 46.6 46.7 46.8 46.9 47.0 47.1 47.2 47.3 47.4 47.5 47.6 47.7 47.8 47.9 48.0 48.1 48.2 48.3 48.4 48.5 48.6 48.7 48.8 48.9 49.0 49.1 49.2 49.3 49.4 49.5 49.6 49.7 49.8 49.9 50.0 50.1 50.2 50.3 50.4 50.5 50.6 50.7 50.8 50.9 51.0 51.1 51.2 51.3 51.4 51.5 51.6 51.7 51.8 51.9 52.0 52.1 52.2 52.3 52.4 52.5 52.6 52.7 52.8 52.9 53.0 53.1 53.2 53.3 53.4 53.5 53.6 53.7 53.8 53.9 54.0 54.1 54.2 54.3 54.4 54.5 54.6 54.7 54.8 54.9 55.0 55.1 55.2 55.3 55.4 55.5 55.6 55.7 55.8 55.9 56.0 56.1 56.2 56.3 56.4 56.5 56.6 56.7 56.8 56.9 57.0 57.1 57.2 57.3 57.4 57.5 57.6 57.7 57.8 57.9 58.0 58.1 58.2 58.3 58.4 58.5 58.6 58.7 58.8 58.9 59.0 59.1 59.2 59.3 59.4 59.5 59.6 59.7 59.8 59.9 60.0 60.1 60.2 60.3 60.4 60.5 60.6 60.7 60.8 60.9 61.0 61.1 61.2 61.3 61.4 61.5 61.6 61.7 61.8 61.9 62.0 62.1 62.2 62.3 62.4 62.5 62.6 62.7 62.8 62.9 63.0 63.1 63.2 63.3 63.4 63.5 63.6 63.7 63.8 63.9 64.0 64.1 64.2 64.3 64.4 64.5 64.6 64.7 64.8 64.9 65.0 65.1 65.2 65.3 65.4 65.5 65.6 65.7 65.8 65.9 66.0 66.1 66.2 66.3 66.4 66.5 66.6 66.7 66.8 66.9 67.0 67.1 67.2 67.3 67.4 67.5 67.6 67.7 67.8 67.9 68.0 68.1 68.2 68.3 68.4 68.5 68.6 68.7 68.8 68.9 69.0 69.1 69.2 69.3 69.4 69.5 69.6 69.7 69.8 69.9 70.0 70.1 70.2 70.3 70.4 70.5 70.6 70.7 70.8 70.9 71.0 71.1 71.2 71.3 71.4 71.5 71.6 71.7 71.8 71.9 72.0 72.1 72.2 72.3 72.4 72.5 72.6 72.7 72.8 72.9 73.0 73.1 73.2 73.3 73.4 73.5 73.6 73.7 73.8 73.9 74.0 74.1 74.2 74.3 74.4 74.5 74.6 74.7 74.8 74.9 75.0 75.1 75.2 75.3 75.4 75.5 75.6 75.7 75.8 75.9 76.0 76.1 76.2 76.3 76.4 76.5 76.6 76.7 76.8 76.9 77.0 77.1 77.2 77.3 77.4 77.5 77.6 77.7 77.8 77.9 78.0 78.1 78.2 78.3 78.4 78.5 78.6 78.7 78.8 78.9 79.0 79.1 79.2 79.3 79.4 79.5 79.6 79.7 79.8 79.9 80.0 80.1 80.2 80.3 80.4 80.5 80.6 80.7 80.8 80.9 81.0 81.1 81.2 81.3 81.4 81.5 81.6 81.7 81.8 81.9 82.0 82.1 82.2 82.3 82.4 82.5 82.6 82.7 82.8 82.9 83.0 83.1 83.2 83.3 83.4 83.5 83.6 83.7 83.8 83.9 84.0 84.1 84.2 84.3 84.4 84.5 84.6 84.7 84.8 84.9 85.0 85.1 85.2 85.3 85.4 85.5 85.6 85.7 85.8 85.9 86.0 86.1 86.2 86.3 86.4 86.5 86.6 86.7 86.8 86.9 87.0 87.1 87.2 87.3 87.4 87.5 87.6 87.7 87.8 87.9 88.0 88.1 88.2 88.3 88.4 88.5 88.6 88.7 88.8 88.9 89.0 89.1 89.2 89.3 89.4 89.5 89.6 89.7 89.8 89.9 90.0 90.1 90.2 90.3 90.4 90.5 90.6 90.7 90.8 90.9 91.0 91.1 91.2 91.3 91.4 91.5 91.6 91.7 91.8 91.9 92.0 92.1 92.2 92.3 92.4 92.5 92.6 92.7 92.8 92.9 93.0 93.1 93.2 93.3 93.4 93.5 93.6 93.7 93.8 93.9 94.0 94.1 94.2 94.3 94.4 94.5 94.6 94.7 94.8 94.9 95.0 95.1 95.2 95.3 95.4 95.5 95.6 95.7 95.8 95.9 96.0 96.1 96.2 96.3 96.4 96.5 96.6 96.7 96.8 96.9 97.0 97.1 97.2 97.3 97.4 97.5 97.6 97.7 97.8 97.9 98.0 98.1 98.2 98.3 98.4 98.5 98.6 98.7 98.8 98.9 99.0 99.1 99.2 99.3 99.4 99.5 99.6 99.7 99.8 99.9 100.0

L 0-0
16 S.