

86-620 - 15255  
09/8

GEOLOGICAL BRANCH  
ASSESSMENT REPORT

15,255

A GEOCHEMICAL AND GEOLOGICAL REPORT ON THE  
EASY CLAIM GROUP  
NEW WESTMINSTER MINING DIVISION, B.C.

Claim Names: Easy No. 1 (1541)  
Easy No. 2 (1542)  
NTS Reference: 92G16-W  
Longitude: 122° 26' W  
Latitude: 49° 57' N  
566

Consultant:  
NEVIN SADLIER-BROWN GOODBRAND LTD.

Report Prepared by:  
D. Cukor  
T.L. Sadlier-Brown

October 21, 1986

Owner: Hillside Energy Corporation  
Operator: Lacana Mining/Hillside Energy Joint Venture

FILMED

## TABLE OF CONTENTS

	PAGE
<b>SUMMARY AND RECOMMENDATIONS</b>	1
<b><u>1. INTRODUCTION</u></b>	
1.1 Terms of Reference	1
1.2 Claims and Ownership	1
1.3 Location and Access	2
1.4 Physiography	2
1.5 Previous Work	2 & 3
<b><u>2. GEOLOGY</u></b>	
2.1 Regional Setting	3 & 4
2.2 Property Geology	4
2.3 Mineralization	4 & 5
2.4 Alteration	5
<b><u>3. SOIL GEOCHEMISTRY</u></b>	
3.1 Sampling and Analytical Method	5
3.2 Discussion of Results	6
<b><u>4. CONCLUSION</u></b>	6 & 7
<b><u>FIGURES</u></b>	
Figure 1 - General Location Map	
Figure 2 - Claim Map	
Figure 3 - Geology	
Figure 4 - Silver Geochemistry	
Figure 5 - Lead Geochemistry	
<b><u>APPENDICES</u></b>	
Appendix A - Certificate and Statement of Qualifications	
Appendix B - Certificates of Analysis	
Appendix C - Itemized Cost Statement	

## SUMMARY AND RECOMMENDATIONS

During September 1986, Nevin Sadlier-Brown Goodbrand Ltd., on behalf of Hillside Energy Corporation and Lacana Mining, carried out a program of geological mapping and geochemical soil sampling on the Easy Claims, New Westminster M.D., B.C. Samples were tested for silver and lead; results suggest a limited northward extension of a zone of disseminated sulphide mineralization discovered in 1983.

### 1. INTRODUCTION

#### 1.1 Terms of Reference

At the request of management of Hillside Energy Corporation and Lacana Mining, Nevin Sadlier-Brown Goodbrand carried out a program of geological mapping and geochemical sampling of the Easy #1 Claim in an unmapped area north of the existing Easy grid. The work was carried out for the purpose of delineating a silver/lead geochemical anomaly and associated zone of sulphide mineralization discovered during the course of exploration carried out in the area during 1983 and 1984.

The field work under discussion was performed between September 8th and 12th 1986 by D. Cukor, Geologist and T. Sunderbruch.

#### 1.2 Claims and Ownership

The Easy property consists of the Easy #1 (20 units) and the Easy #2 (6 units) mineral claims situated in the New Westminster Mining Division and depicted on Claim Sheet 92G-16W. The claims are registered in the name of Hillside Energy Corporation and subject to terms of a joint venture agreement between Hillside and Lacana Mining Corporation. Pertinent data on the claims are as follows:

<u>CLAIM NAME</u>	<u>NO OF UNITS</u>	<u>RECORD NO</u>	<u>RECORD DATE</u>
Easy #1	20	1541	September 17, 1982
Easy #2	6	1542	September 17, 1982

### 1.3 Location and Access

The Easy Claims are located on the west bank of the Lilloet River 2 km west of the village of Skookumchuck which is mid-way between Pemberton and Harrison Hot Springs. The property is centred at longitude  $122^{\circ} 26'$  west and latitude  $49^{\circ} 57'$  north and is depicted on Claim Map 92G-16 W.

Although the property can be reached from either Pemberton or Harrison Hot Springs via forestry and power line roads, access is best from Pemberton to the north via 65 km of gravel road. The forestry road on the southwest side of the Lilloet Valley crosses the northeast corner of the Claim Group.

### 1.4 Physiography

The Easy Claims cover part of the Lilloet River Valley and the lower slope of an unnamed mountain north of Glacier Lake. The area of interest lies on a gently sloping bench approximately 180 meters above the river. Elevations on the property range from 140 meters to 880 meters above sea level.

The Claim Group is drained by Chief Paul Creek and its tributaries. The creek passes through the central part of the property and into the Lilloet River above the mouth of Snowcap Creek.

Vegetation consists of coniferous forests, principally fir and hemlock, with approximately 25% of the area in dense second growth having been logged within the past decade.

### 1.5 Previous Work

Mineralization in the vicinity of the Easy Claims has been known since the late 19th century when claims were staked to cover a rhyolite breccia zone mineralized with gold bearing sulphides. The claim group, which was known as the Mayflower property lies to the north of the Easy grid and for the most part is covered by the Jo Claim which is presently recorded in the name of Lacana Mining. By 1904 an adit had been driven 47 meters and a winze sunk 2.4 meters into the rhyolite breccia which was reported to average \$15 per ton in gold. A stamp mill was erected but little or no production was achieved and the claims later lapsed.

### 1.5 Previous Work (Cont'd)

In 1929 the property was re-staked as the Dandy Claim but little additional work appears to have been done and the property reverted to the Crown.

In the late 1970's the area was again staked and a program of geological mapping and soil sampling was carried out on behalf of the owner, G. Nagy, of Sardis, B.C. The claim which was known as the Moneymaker was later allowed to lapse and, early in September 1982, Lacana staked the Jo Claim, which covers the site of the old workings. Also in September, 1982, Hillside Energy Corporation staked the Easy #1 and Easy #2 Claims which adjoin and surround the four-unit Jo Claim.

Both Lacana and Hillside subsequently carried out geological mapping and geochemical soil surveys on their respective properties. The claims were later combined under terms of the joint venture agreement and in 1984 an IP survey and diamond drilling were carried out on the Easy #1 Claim by the partnership.

## 2. GEOLOGY

### 2.1 Regional Geology

The Claim Group is underlain principally by the Fire Lake group, a sequence of Upper Jurassic and Lower Cretaceous sedimentary and volcanic rocks. The assemblage is over 4500 meters in thickness and has been subdivided into three sub-groups. The oldest consists principally of fine grained thinly bedded granulite with minor andesite, limestone and conglomerate. It is overlain by a sequence of argillites, slates and graywackes which are in turn overlain by an upper sub-group composed of greenstone, tuff, chlorite schist, minor conglomerate, quartzite and graywacke.

Northeast of the property on the opposite side of the Lilloet River the rocks of the Fire Lake group are intruded by an extensive body of granodiorite of reported Tertiary age.

The rocks of the Fire Lake groups dips deeply and have a strong regional foliation parallel to the Lilloet River valley which, in the area of interest, strikes at approximately 325°. Both Mesozoic and Tertiary rocks are cut by a number of faults of which the most important appear to be the Lilloet River fault, the Snowcap Creek fault and the Skookumchuck fault.

## 2.1 Regional Geology (Cont'd)

Metamorphism ranges from negligible for the middle member of the Fire Lake group to mesozonal for the granulites of the basal member. The upper member exhibits low temperature alteration, principally albitization and chloritization.

## 2.2 Property Geology

In 1986 geological mapping was carried out over a 250 meter square area located to the north of the main grid on the Easy #1 Claim. To facilitate mapping the grid used for the earlier surveys was extended using chain and compass for control. Lines were put in at 50 meter spacing with stations at 25 meter intervals along each line. In general, the southern half of the grid extension covers rugged, sloping terrain with excellent rock exposure while the northern half is generally underlain by scree.

Geological mapping has resulted in identification of three principal rock units: chlorite schist, greenstone and rhyolite breccia.

Chlorite schist underlies most of the mapped area. Its metamorphic texture varies from a schist to a gneissic schist with a ropey texture to the weathered surface. The gneissic schist was observed on the western portion of the map area, principally in the vicinities of lines 10+50S and 11S between stations 4+50E and 5+50E. Minor phyllite was noted at 10+50S, 5+25E. Graphitic horizons are locally associated with the phyllite.

The southeastern part of the map area is underlain by greenstone which is in sharp contact with the chlorite schist.

Uphill and to the south of the greenstone terrain is an east-west trending horizon of rhyolite and/or rhyolite breccia. This unit is generally fine grained and buff weathering. It forms a series of bluffs and small cliffs in the northern part of the original grid area.

## 2.3 Mineralization

Of the mineralization found on the mapped area the most significant is a narrow vein filled with gouge and galena. It is up to 4 centimeters wide and striking at 030° and dipping at 57° westerly. The vein is accompanied by a wide silicified zone which contains steep to vertical quartz veins.

### 2.3 Mineralization (Cont'd)

Galena bearing float resembling the material which occurs in the vein was also found in talus uphill from the showing. The source of this material has not been discovered.

Disseminated pyrite and gossanous iron oxide material are also wide spread on the property but their presence is not considered to be of economic significance.

### 2.4 Alteration

Two types of alteration were observed on the property. Wide spread chloritization and minor kaolinization are attributed to retrograde regional metamorphism. It is not considered to influence mineral deposition. A second type of alteration, silicification, is apparently due to a late period of epithermal activity and may be associated with emplacement of the silver, base metal and gold bearing occurrences in the general area. The silicified zone observed during the course of the recent mapping extends from line 11S, 4E to 12+50S, 3+50E and is about 50 to 75 meters in width.

## **3. SOIL GEOCHEMISTRY**

### 3.1 Sampling and Analytical Method

Soil geochemical sampling was carried out over the Easy Claims employing the same grid used for geological mapping. A total of 45 samples were taken from shallow pits dug with a mattock, preferably from the B soil horizon, packed in standard soil sample envelopes, marked, partially dried in the field and submitted for analysis to General Testing Laboratories of Vancouver, B.C. The analytical procedure employed is as follows:

1. Samples are dried then sieved to -80 mesh.
2. One gram of each -80 mesh fraction is dissolved in nitric perchloric acid.
3. Each sample is tested for silver and lead using an atomic absorption spectrophotometer.

Results quoted in parts per million are included in the Appendix to this report and are plotted on Maps 4 and 5.

### 3.2 Discussion of Results

Soil silver values vary from 0.2 to 12.1 PPM and soil lead values from 13 to 5662 PPM. Values in excess of 1.5 PPM silver and 100 PPM lead are considered anomalous for purposes of this report. Plots of the geochemical data have delineated three areas of elevated metal concentration in the soil.

Zone A is a coincident silver and lead anomaly situated in the southeastern part of the survey area. It is a northward extension of the main silver anomaly discovered during the 1983 field season. The highest silver value in this area was found to be 12.1 PPM (approximately 0.35 oz per ton) and the highest lead value was found to be 5662 PPM. The zone remains open downhill and along the slope to the east.

Zone B is another coincident lead/silver anomaly situated in the extreme northern part of the grid area in the general vicinity of lines 11S and 11+50S stations 5+75 East and 600 East. The zone is open to the north.

Zone C is a lead anomaly with no significant associated silver values. It is centred on line 12+50S, 4+50E and is open to the east.

The strong silver and lead values associated with Zone A appear to be derived from disseminated mineralization occurring in the rhyolite and rhyolite breccia unit located in the extreme southeastern of the survey area. The source of the anomalous values in Zones B and C is at present unknown.

## **4. CONCLUSION**

Geological mapping and silver/lead geochemical sampling indicate that the mineralization associated with the rhyolite and rhyolite breccia on the Easy #1 Claim extends further north than was previously known. It nevertheless corroborates survey work carried out in 1983 and confirms that, from a geochemical point of view, the most intense concentration of silver and lead is in the general vicinity of lines 1150 South and 1200 South between stations 250 East and 350 East. In this general area rhyolite and rhyolite breccia hosted silver/lead mineralization is pervasive. It appears to occur both disseminated in tuffaceous rhyolite, as breccia fillings and occasionally as veins and stringers associated with later fractures.



CONCLUSION (Cont'd)

Although silver values obtained to date within this zone are, for the most part, sub-economic at contemporary prices the area is nevertheless considered to constitute an excellent exploration target, the objective being to evaluate a zone of pervasive silver/lead mineralization with a north/south strike in excess of 450 meters and a width to the order of 100 meters. Future work should consist of detailed geological mapping and additional diamond drilling.

Respectfully submitted

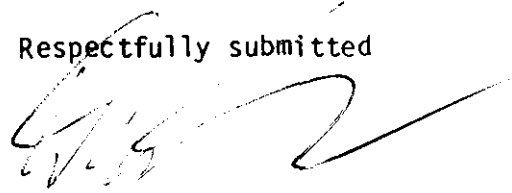

D. Cukor

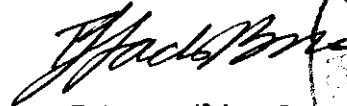

T.L. Sadlier-Brown

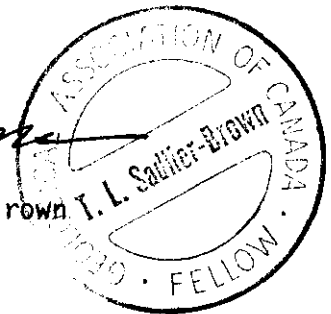

## BIBLIOGRAPHY

Melrose, D. Geochemical and Geological Report of the Easy Claim Group, New Westminster MD B.C. Hillside Energy Corporation unpublished report, October 7, 1983.

Nevin Sadler-Brown Goodbrand Ltd. Hillside/Lacana Joint Venture Preliminary Report on Phase One October 2, 1984.

Nevin Sadler-Brown Goodbrand Ltd. Summary Report on Drilling at the Easy #1 Claim Hillside Energy/Lacana Mining unpublished report, November, 1984.

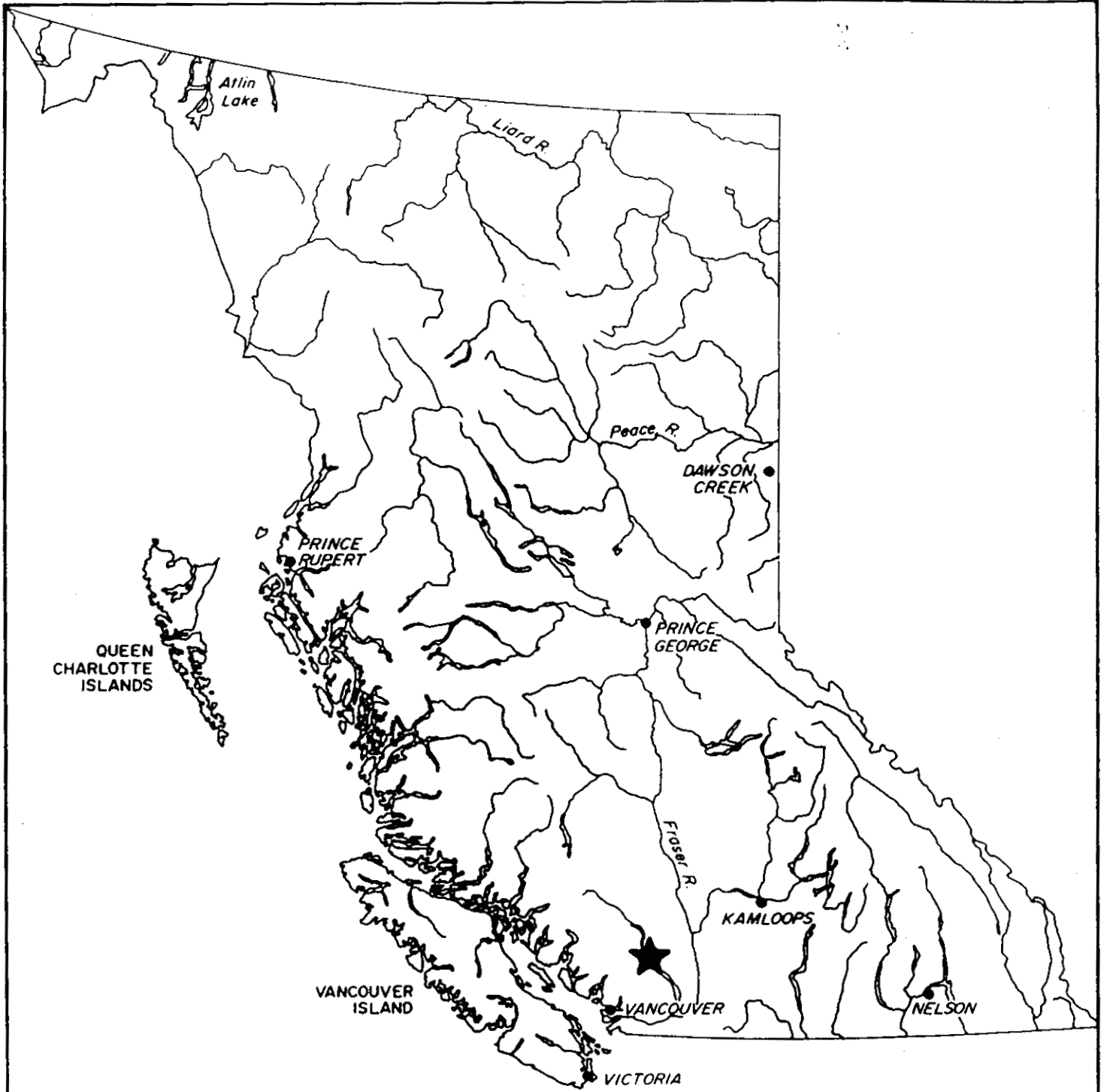

QUEEN CHARLOTTE ISLANDS

VANCOUVER ISLAND

VICTORIA



HILLSIDE ENERGY CORPORATION	
<b>LOCATION MAP EASY CLAIMS</b>	
NEW WESTMINSTER M.D., B.C.	NTS MAP 92G/16
FIGURE 1	SCALE: AS SHOWN
DATE: OCTOBER 1986	
NEVIN SADLIER-BROWN GOODBRAND LTD.	

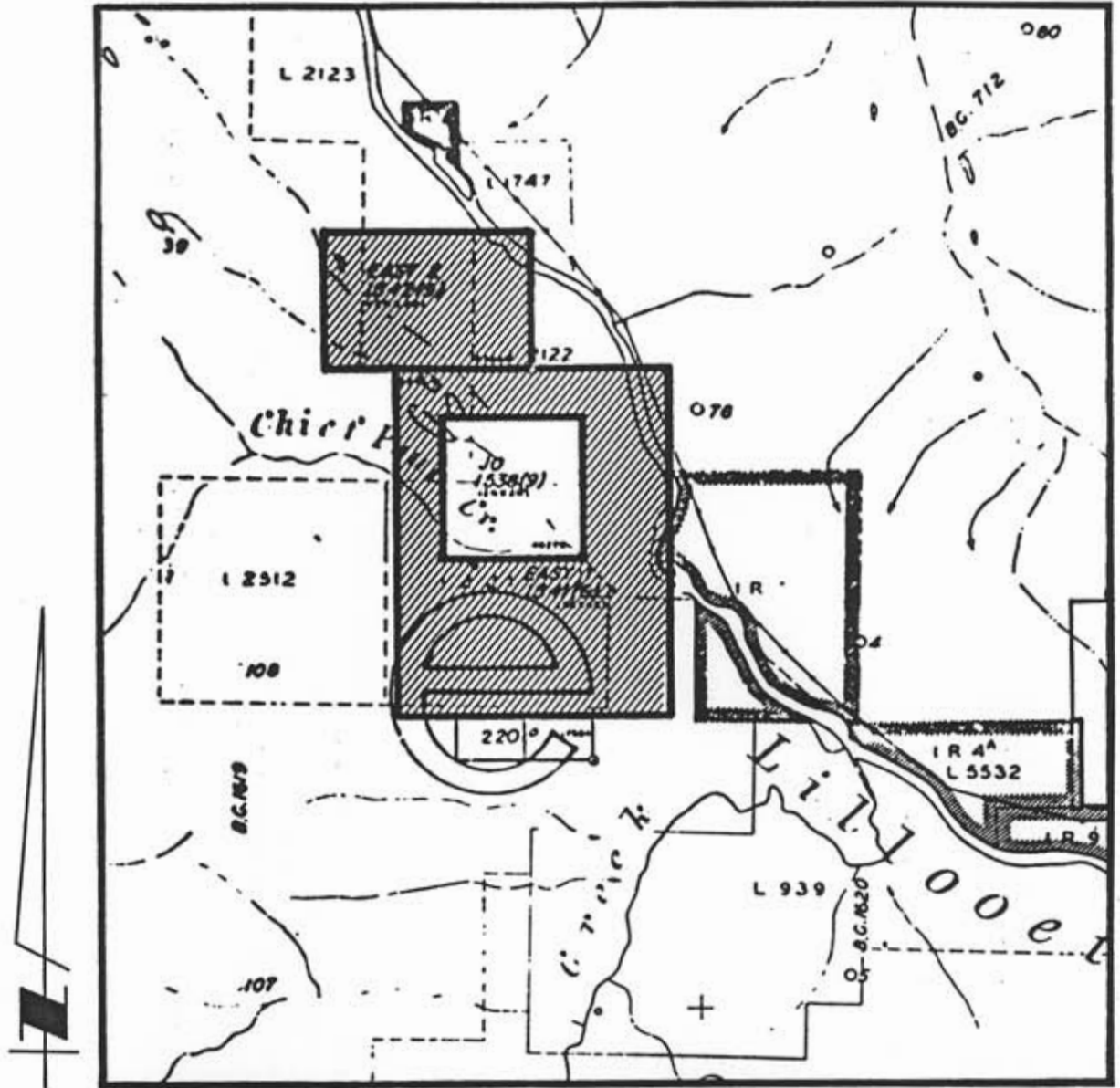

HILLSIDE ENERGY CORPORATION	
CLAIM MAP EASY CLAIMS	
NEW WESTMINSTER M.D., B.C. MAP M92G/16W	
FIGURE 2	SCALE 1:50 000
DATE: OCTOBER 1986	
NEVIN SADLER-BROWN GOODBRAND LTD.	

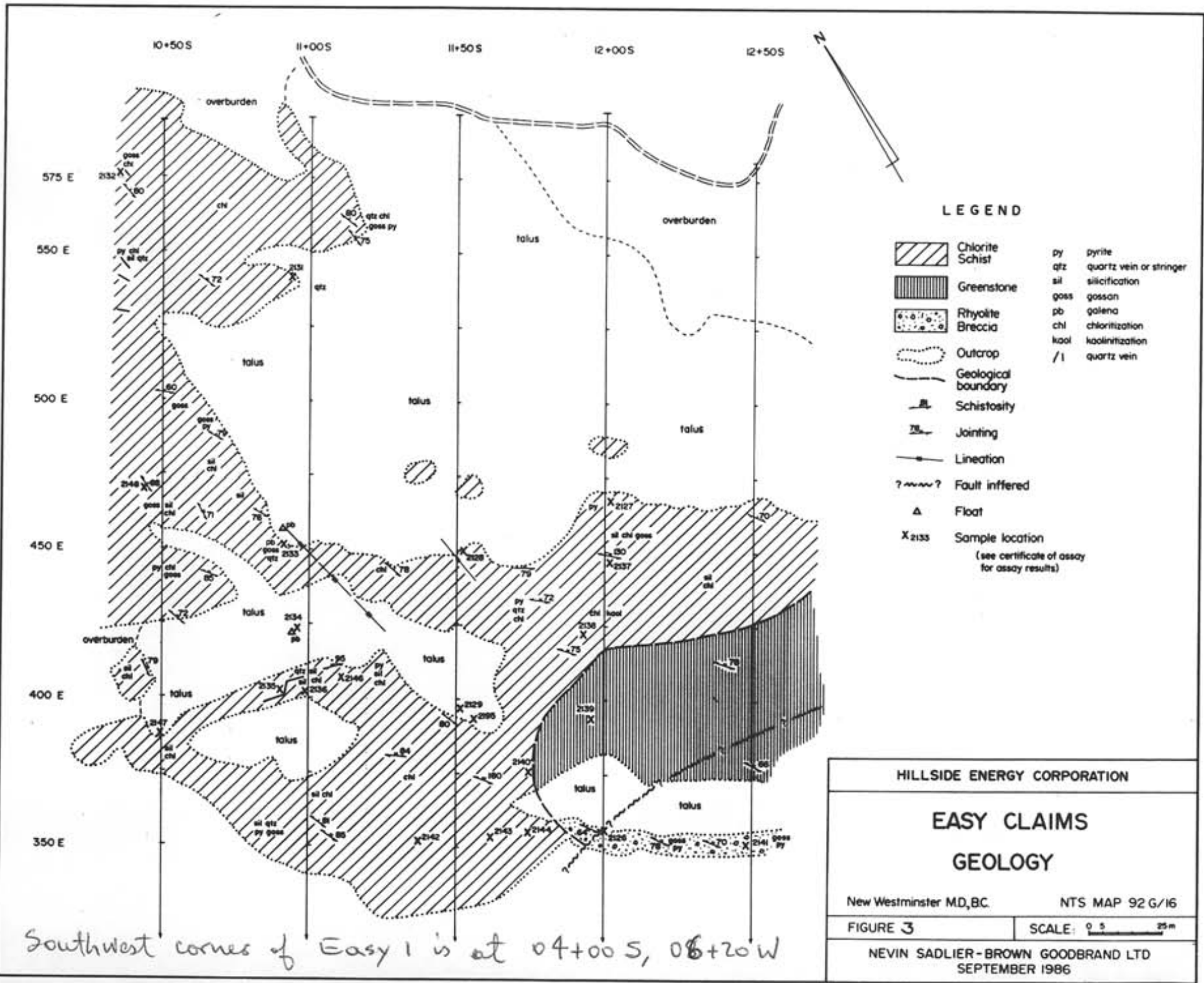

HILLSIDE ENERGY CORPORATION

**EASY CLAIMS  
GEOLOGY**

New Westminster MD, BC. NTS MAP 92 G/16

FIGURE 3 SCALE: 0 5 25m

NEVIN SADLER-BROWN GOODBRAND LTD  
SEPTEMBER 1986

Southwest corner of Easy 1 is at 04+00 S, 08+20 W

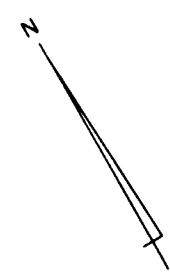
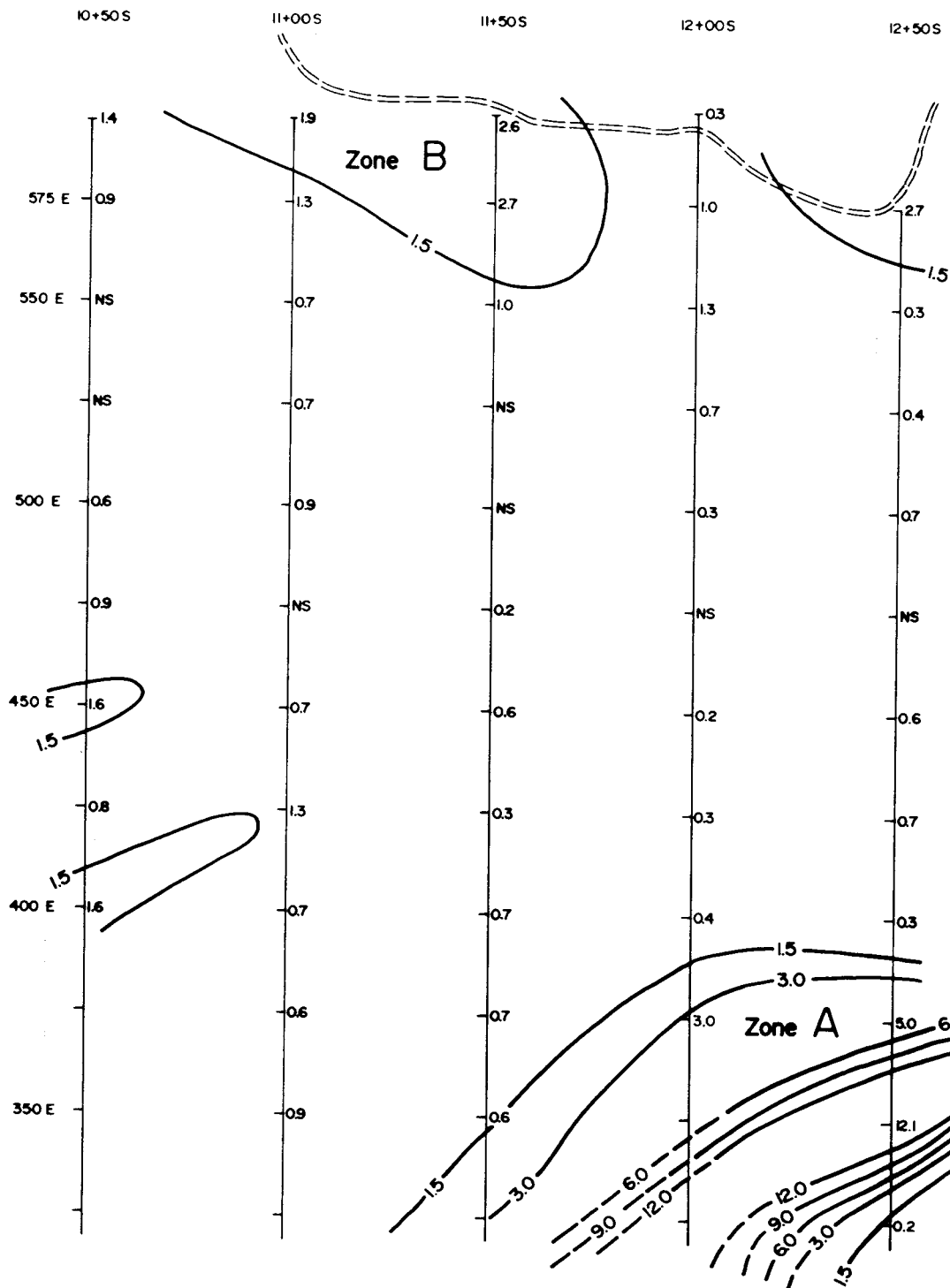

LEGEND

1.6 Ag assay values in ppm

Contour interval

- 1.5 ppm
- 3.0 ppm
- 6.0 ppm
- 9.0 ppm
- 12.0 ppm

HILLSIDE ENERGY CORPORATION	
<b>EASY CLAIMS</b>	
<b>SILVER GEOCHEMISTRY</b>	
New Westminster M.D., B.C.	NTS MAP 92 G/16
FIGURE 4	SCALE: 0 5 25 m
NEVIN SADLIER-BROWN GOODBRAND LTD SEPTEMBER 1986	

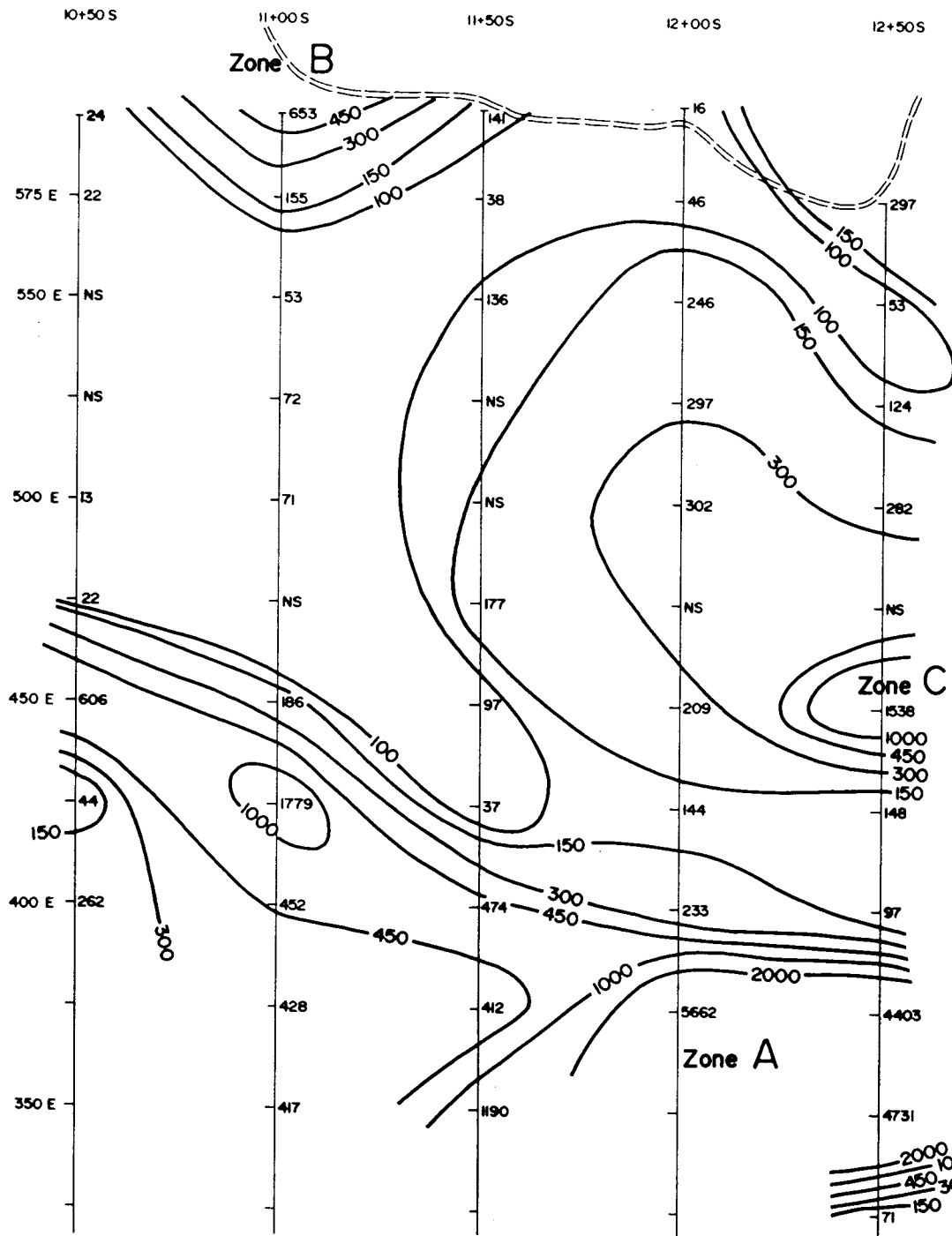

LEGEND

- 177 Pb assay values in ppm
- Contour interval
- 100 ppm (anomalous)
  - 150 ppm "
  - 300 ppm "
  - 450 ppm "
  - 1000 ppm "
  - 2000 ppm "

HILLSIDE ENERGY CORPORATION

**EASY CLAIMS  
LEAD GEOCHEMISTRY**

New Westminster M.D., B.C.      NTS MAP 92 G/16

FIGURE 5      SCALE: 0 5 25m

NEVIN SADLIER - BROWN GOODBRAND LTD.  
SEPTEMBER 1986

AUTHOR'S CERTIFICATE

I, DAMIR CUKOR of 976 East 26th Avenue, Vancouver British Columbia, state that:

1. I graduated from the University of British Columbia in 1984 as a Bachelor of Science in Geology.
2. Since 1983 I have been employed as a geologist by NVC Engineering Ltd.
3. I have worked in the field of exploration geology and geophysics for 10 seasons and have held positions of responsibility since 1982.
4. I performed the geological mapping and supervised the geochemical surveys on the Easy Claims as documented in this report.

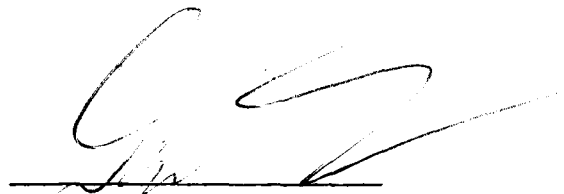

D. Cukor, B.Sc.  
NVC Engineering Ltd.

October 21, 1986



APPENDIX A

Certificate and Statement of Qualifications

I, Timothy L. Sadlier-Brown hereby certify that:

1. I am a consulting geologist and partner in the firm of Nevin Sadlier-Brown Goodbrand Ltd. with offices at 401 - 134 Abbott Street, Vancouver, B.C. V6B 2K4
2. I was educated in Geological Sciences at Carleton University in Ottawa, Ontario and am a Fellow of the Geological Association of Canada.
3. I have acted in the field of exploration geology in positions of responsibility since 1965 and have been a principal in the firm of Nevin Sadlier-Brown Goodbrand Ltd. since 1972.
4. I have personally examined the Easy Claims and supervised the survey work described herein.

*Timothy L. Sadlier-Brown*

T.L. Sadlier-Brown, FGAC

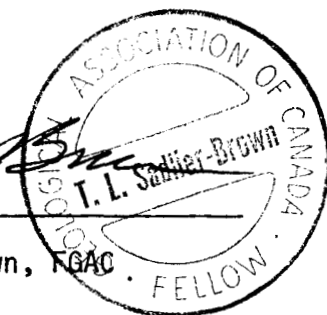

October 21, 1986

---

---

---



**SGS SUPERVISION SERVICES INC.**

General Testing Laboratories Division

1001 East Pender Street,  
Vancouver, B.C., Canada V6A 1W2  
Telephone: (604) 254-1647  
Telex: 04-507514

TO: HILLSIDE ENERGY CORPORATION  
401 - 134 Abbott Street  
Vancouver, B.C.  
V6B 2K4

We hereby certify that the following are the results of assays on: ore samples (geochem)

MARKED	GOLD	SILVER	Lead	xxxxxxx	xxxxxxxxxxx	xxxxxxxxxxx	xxxxxxxxxxx	xxxxxxxxxxx
	Au (ppm)	Ag (ppm)	Pb (ppm)					
2126	0.03	3.5	685					
2127	0.02	0.7	10					
2128	0.04	0.6	4					
2129	0.04	0.6	6					
2130	0.07	0.2	3					
2131	0.03	0.2	5					
2132	0.06	0.3	5					
2133	0.19	52.4	25967					
2134	0.05	5.2	5711					
2135	0.05	1.8	507					
2136	0.03	0.2	183					
2137	0.03	1.7	276					
2138	0.02	0.3	12					
2139	0.03	0.5	38					
2140	0.03	1.0	14					
2141	0.02	0.9	44					
2142	0.03	0.5	8					
2143	0.03	0.6	611					
2144	0.03	0.8	38					
2145	0.04	0.4	18					
2146	0.03	1.2	37					
2147	0.07	5.3	4422					
cc. N.V.C. Engineering								

NOTE: REJECTS RETAINED ONE MONTH. PULPS RETAINED THREE MONTHS ON REQUEST PULPS AND AND REJECTS WILL BE STORE FOR A MAXIMUM OF ONE YEAR.

ALL REPORTS ARE THE CONFIDENTIAL PROPERTY OF CLIENTS. PUBLICATION OF STATEMENTS, CONCLUSION OR EXTRACTS FROM OR REGARDING OUR REPORTS IS NOT PERMITTED WITHOUT OUR WRITTEN APPROVAL. ANY LIABILITY ATTACHED THERETO IS LIMITED TO THE FEE CHARGED.

L. Wong  
PROVINCIAL ASSAYER

**CERTIFICATE OF ASSAY**

Date September 23, 1986

File 8609-1255



**SGS SUPERVISION SERVICES INC.**  
 General Testing Laboratories Division  
 1001 East Pender Street,  
 Vancouver, B.C., Canada V6A 1W2  
 Telephone (604) 254-1647  
 Telex: 04-507514

TO: HILLSIDE ENERGY CORPORATION  
 401 - 134 Abbott Street  
 Vancouver, B.C.  
 V6B 2K4

We hereby certify that the following are the results of assays on: soil samples

MARKED	SILVER		Lead		XXXXXX	XXXXXXXXXX	XXXXXXXXXX	XXXXXXXXXX	XXXX
	Ag (ppm)	Pb (ppm)							
<u>10+50S</u>									
4+00 E	1.6	262							
4+25	0.8	44							
4+50	1.6	606							
4+75	0.9	22							
5+00	0.6	13							
5+75	0.9	22							
6+00	1.4	24							
<u>11+00S</u>									
3+50E	0.9	417							
3+75	0.6	428							
4+00	0.7	452							
4+25	1.3	1779							
4+50	0.7	186							
5+00	0.9	71							
5+25	0.7	72							
5+50	0.7	53							
5+75	1.3	155							
6+00	1.9	653							
<u>11+50S</u>									
3+50 E	0.6	1190							
3+75	0.7	412							
4+00	0.7	474							
4+25	0.3	37							
4+50	0.6	97							
4+75	0.2	177							
5+50	1.0	136							
5+75	2.7	38							
6+00	2.6	141							

/ Continued on pg. 2 .....

NOTE: REJECTS RETAINED ONE MONTH. PULPS RETAINED THREE MONTHS ON REQUEST. PULPS AND AND REJECTS WILL BE STORED FOR A MAXIMUM OF ONE YEAR.

ALL REPORTS ARE THE CONFIDENTIAL PROPERTY OF CLIENTS. PUBLICATION OF STATEMENTS, CONCLUSIONS OR EXTRACTS FROM OR REGARDING OUR REPORTS IS NOT PERMITTED WITHOUT OUR WRITTEN APPROVAL. ANY LIABILITY ATTACHED THERETO IS LIMITED TO THE FEE CHARGED.

*L. Wong*  
 PROVINCIAL ASSAYER

Analytical and Consulting Chemists, Bulk Cargo Specialists, Surveyors, Inspectors, Samplers, Weighers

MEMBER American Society For Testing Materials • The American Oil Chemists Society • Canadian Testing Association  
 REFEREE AND/OR OFFICIAL CHEMISTS FOR: National Institute of Oilseed Products • The American Oil Chemists Society  
 OFFICIAL WEIGHMASTERS FOR: Vancouver Board Of Trade

**CERTIFICATE OF ASSAY**

Date Sept. 23, 1986

File 8609-1255



**SGS SUPERVISION SERVICES INC.**  
 General Testing Laboratories Division  
 1001 East Pender Street,  
 Vancouver, B.C., Canada V6A 1W2  
 Telephone (604) 254-1647  
 Telex: 04-507514

TO: HILLSIDE ENERGY CORPORATION

( page 2 )

We hereby certify that the following are the results of assays on: soil samples

MARKED	SILVER		Lead		XXXXXX	XXXXXXXXXX	XXXXXXXXXX	XXXXXXXXXX	XXXX
	Ag (ppm)	Pb (ppm)							
<u>12+00 S</u>									
3+75 E	3.0	5662							
4+00	0.4	233							
4+25	0.3	144							
4+50	0.2	290							
5+00	0.3	302							
5+25	0.7	297							
5+50	1.3	246							
5+75	1.0	46							
6+00	0.3	16							
<u>12+50 S</u>									
3+25 E	0.2	71							
3+50	12.1	4731							
3+75	5.0	4403							
4+00	0.3	97							
4+25	0.7	148							
4+50	0.6	1538							
5+00	0.7	282							
5+25	0.4	124							
5+50	0.3	53							
5+75	2.7	297							

cc. N.V.C. ENGINEERING

NOTE: REJECTS RETAINED ONE MONTH. PULPS RETAINED THREE MONTHS ON REQUEST. PULPS AND AND REJECTS WILL BE STORED FOR A MAXIMUM OF ONE YEAR.

ALL REPORTS ARE THE CONFIDENTIAL PROPERTY OF CLIENTS. PUBLICATION OF STATEMENTS, CONCLUSIONS OR EXTRACTS FROM OR REGARDING OUR REPORTS IS NOT PERMITTED WITHOUT OUR WRITTEN APPROVAL. ANY LIABILITY ATTACHED THERETO IS LIMITED TO THE FEE CHARGED.

*L. Wong*  
 PROVINCIAL ASSAYER

Analytical and Consulting Chemists, Bulk Cargo Specialists, Surveyors, Inspectors, Samplers, Weighers

MEMBER American Society For Testing Materials • The American Oil Chemists Society • Canadian Testing Association  
 REFEREE AND/OR OFFICIAL CHEMISTS FOR: National Institute of Oilseed Products • The American Oil Chemists Society  
 OFFICIAL WEIGHMASTERS FOR: Vancouver Board Of Trade

ITEMIZED COST STATEMENT

GEOLOGY AND FIELD SUPERVISION

D. Cukor; 4 days @ \$225/diem \$ 900.00

FIELD ASSISTANT

T. Sunderbruch; 4 days @ \$150/diem 632.00

CAMP COSTS

Equipment Rental	\$ 100.00	
Food & Supplies	270.00	370.00

TRANSPORTATION

Vehicle Rental - 4 days @ \$50/day	200.00	
Gasoline & Misc. Exp.	97.57	297.57

ANALYTICAL COSTS

469.20

REPORT PREPARATION

NVC	565.00	
NSBG	1,327.00	<u>1,892.00</u>

TOTAL \$4,560.77

=====