

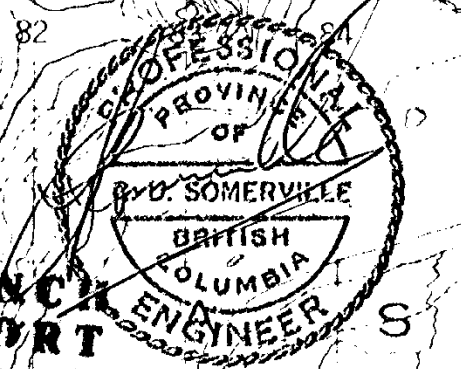

GEOLOGICAL BRANCH
ASSESSMENT REPORT



15,276

ERICKSON GOLD MINING CORP.

TARA 85 GROUP
ERICKSON
MINERAL CLAIMS

Claim boundaries approximate
Survey by diameter, chain
and compass unless otherwise
noted

Project Name: ERICKSON Project No. 1003
Latitude _____ Longitude _____
Mining Division: LIARD NTS 104 P/4E

To accompany a report by E. DUSSELL, B.Sc.
Under the supervision of R. SOMERVILLE, P. Eng.

Date: FEB. 20, 1986 Map No. 1

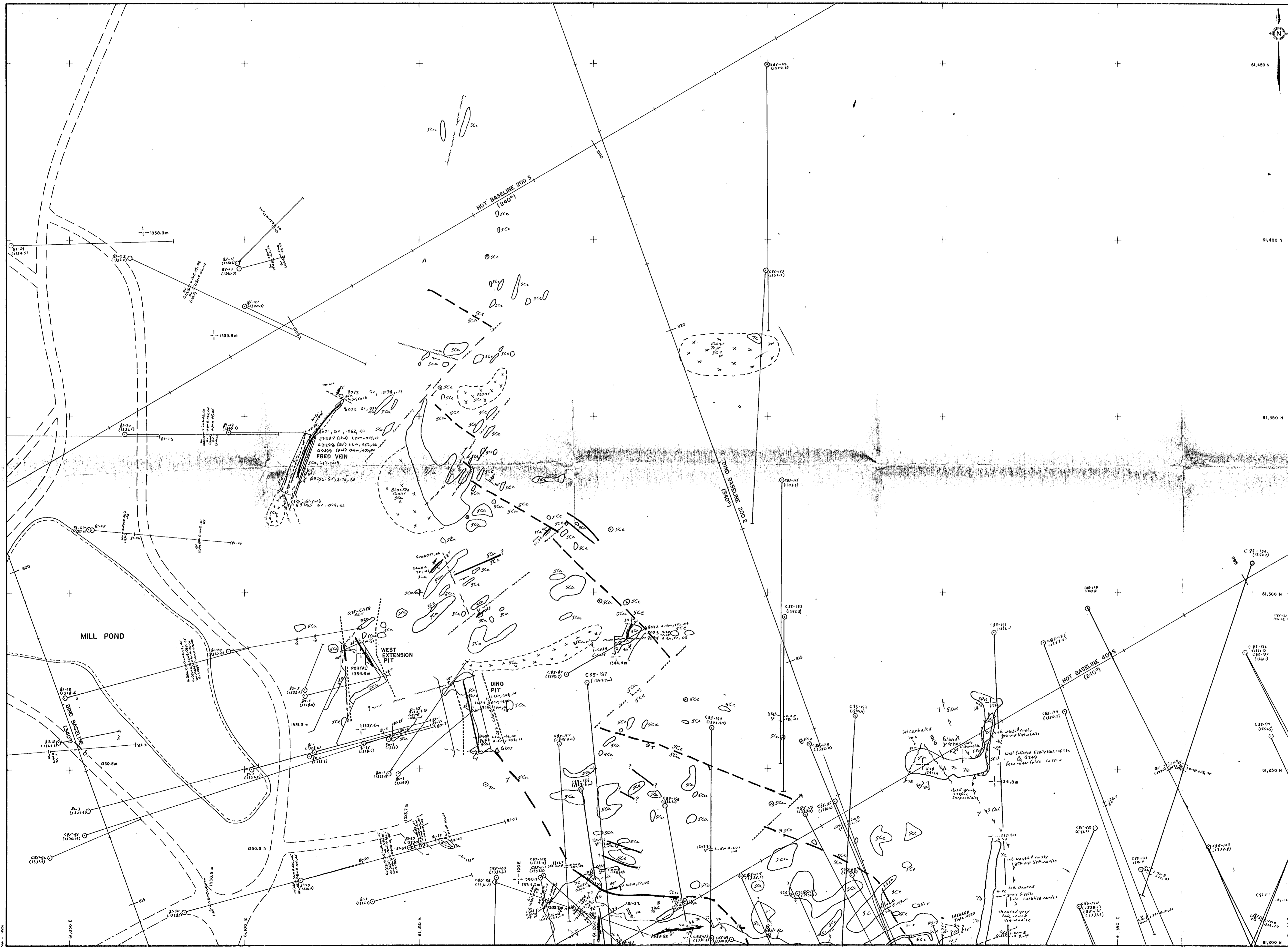

AREA INDEX

19	18	17	6,570,000 N
6	5	4	6,568,000 N
7	0	3	6,566,000 N
8	1	2	6,564,000 N
			6,562,000 N

3	Q	3	P	3	O	3	N	3	M
2	1	2	1	2	1	2	1	2	1
3	R	4	E	4	D	4	C	4	L
2	1	2	1	2	1	2	1	2	1
3	S	3	F	3	A	3	B	3	K
2	1	2	1	2	1	2	1	2	1
3	T	4	G	4	H	4	I	4	J
2	1	2	1	2	1	2	1	2	1
3	U	4	V	4	W	4	X	4	Y
2	1	2	1	2	1	2	1	2	1

ENLARGEMENT OF AREA

SYMBOLS

- Rock outcrop, area of outcrop, float
- Geological boundary (defined, inferred)
- Bedding (horizontal, inclined, vertical, overturned, dip unknown)
- Schistosity, gneissosity, cleavage, foliation (horizontal, inclined, vertical, dip unknown)
- Lineation, axis of minor folds (horizontal, inclined, vertical)
- Drag-fold (arrow indicates plunge)
- Fault (defined, interpreted)
- Fault (inclined, vertical, relative movement)
- Surface joint (horiz, inclined, vert, dip unknown)
- U/G joint (horiz, inclined, vert, dip unknown)
- Syncline (defined, approximate)
- Anticline (defined, approximate)
- Anticline and syncline (overturned)
- Intensity (weak, moderate, strong)
- Vein (inclined, vertical, dip unknown)
- Zone of alteration
- Rock sample, X 0.324, 0.15 Assay Au, Ag ounce/ton
- Trench
- Adit or tunnel
- Rock dump or tailings
- Shaft, raise, winze
- Diamond drill hole (entering section, leaving section) (on section / plan)
- Contours - 2500
- Marsh or creek (perennial, intermittent)
- Stream
- Lake
- Road

SCALE 1:500

ERICKSON GOLD MINING CORP.
GEOLOGICAL BRANCH
ASSETARYMBO GROUP REPORT

GEOLOGY AND
DIAMOND DRILLING
15,276

Project Name CUSAC Project No. 1003
 Latitude 59°11' APPROX Longitude 129°41' APPROX.
 Mining Division LIARD NTS 104 P/4E

To accompany a report by R. SOMERVILLE, P. Eng.
E. DUSSEL, B.Sc.
 Alpha No. _____ Drawing No. _____
 Date FEB. 20, 1986 Map No. FHI

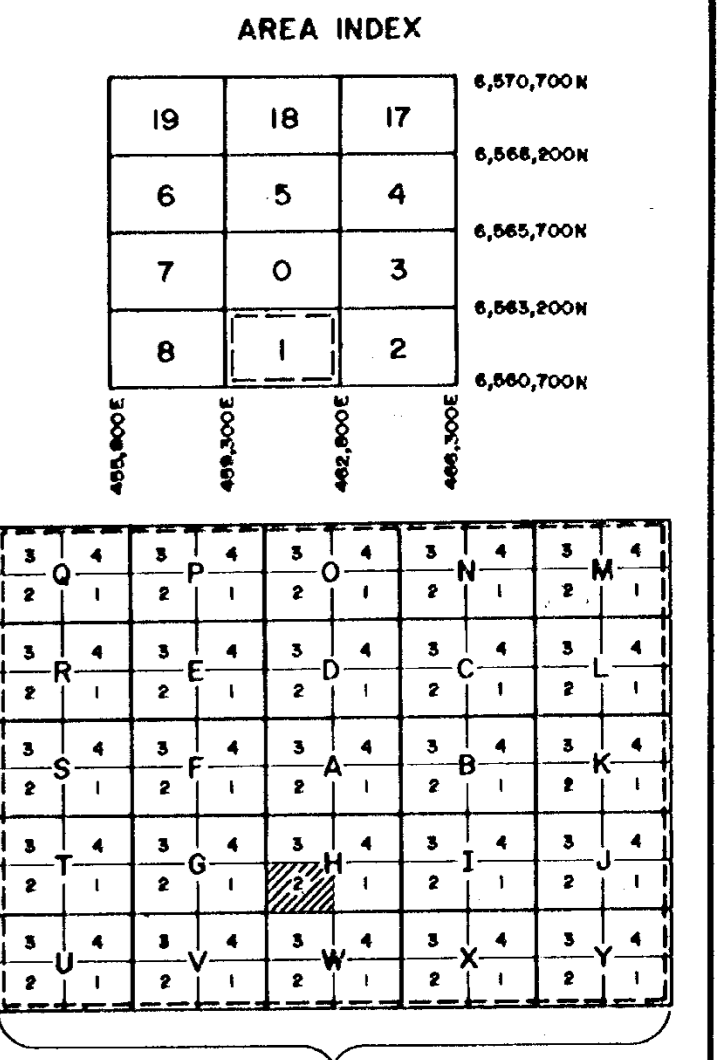
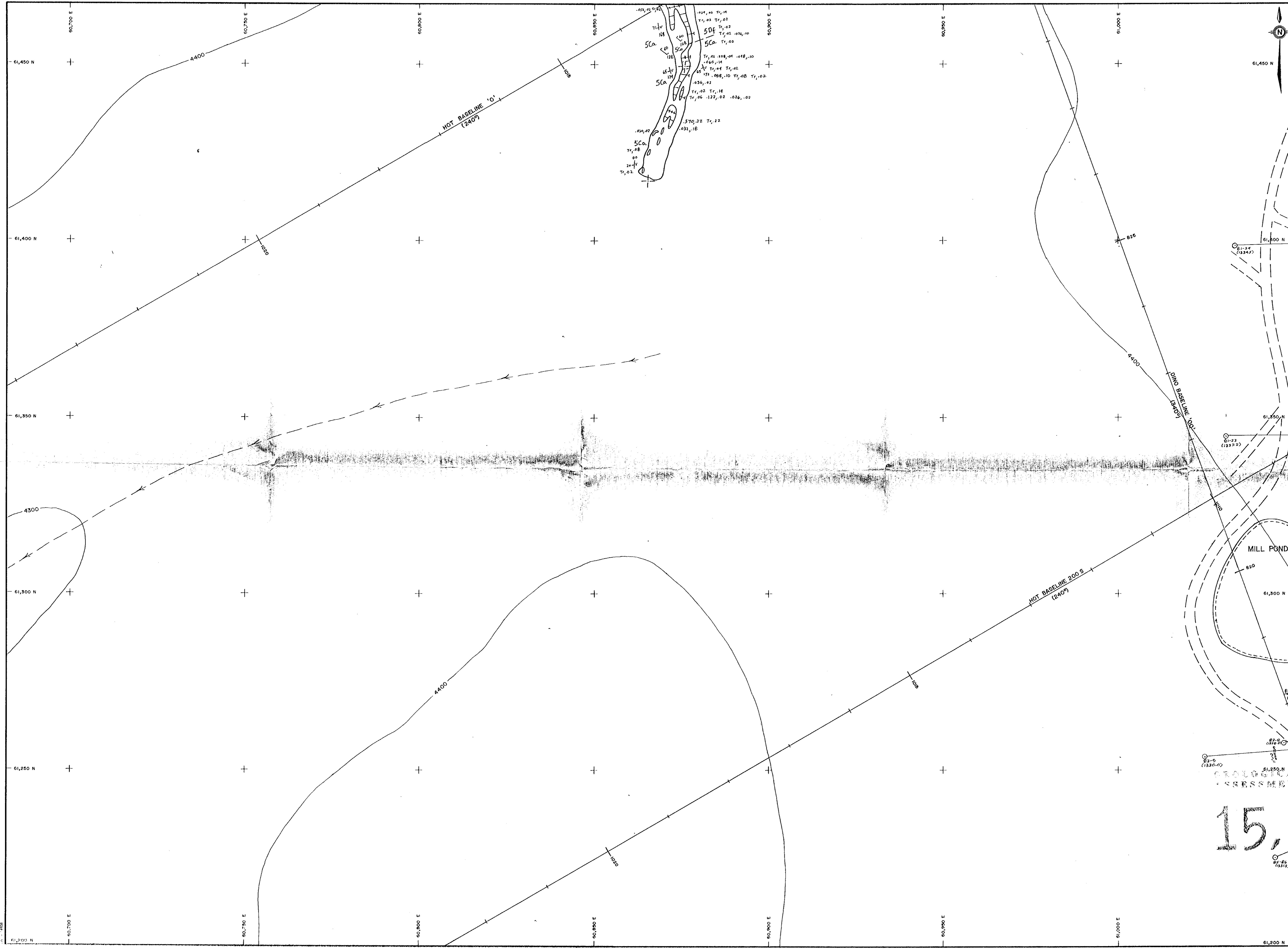

- ENLARGEMENT OF AREA 1**
- SYMBOLS**
- Rock outcrop, area of outcrop, float
 - Geological boundary (defined, inferred)
 - Bedding (horizontal, inclined, vertical, overturned, dip unknown)
 - Schistosity, gneissosity, cleavage, foliation (horizontal, inclined, vertical, dip unknown)
 - Lination, axis of minor folds (horizontal, inclined, vertical)
 - Drag-fold (arrow indicates plunge)
 - Fault (defined, interpreted)
 - Fault (inclined, vertical, relative movement)
 - Surface joint (horiz., inclined, vert., dip unknown)
 - U/G joint (horiz., inclined, vert., dip unknown)
 - Syncline (defined, approximate)
 - Anticline (defined, approximate)
 - Anticline and syncline (overturned)
 - Intensity (weak, moderate, strong)
 - Vein (inclined, vertical, dip unknown)
 - Zone of alteration
 - Rock sample, X 0.824, 0.15 Assay: Au, Ag ounce/ton
 - Trench
 - Adit or tunnel
 - Rock dump or tailings
 - Shaft, raise, winze
 - Diamond drill hole (entering section, leaving section) (on section / plan)
 - Contours 2500
 - Stream or creek (perennial, intermittent)
 - Marsh
 - Lake
 - Road
- SCALE: 1:500

ERICKSON GOLD MINING CORP.

ALBERTA BRANCH

ASSESSMENT REPORT 85 GROUP

GEOLOGY AND DIAMOND DRILLING

15,276

Project Name: CUSAC Project No.: 1003

Latitude: 59°11' APPROX. Longitude: 129°41' APPROX.

Mining Division: LIARD NTS: 104 P/4E

To accompany a report by: R. SOMERVILLE, P. Eng.
E. DUSSEL, B. Sc.

Alpha No.: Drawing No.:

Date: FEB. 20, 1986 Map No.: 1-H2

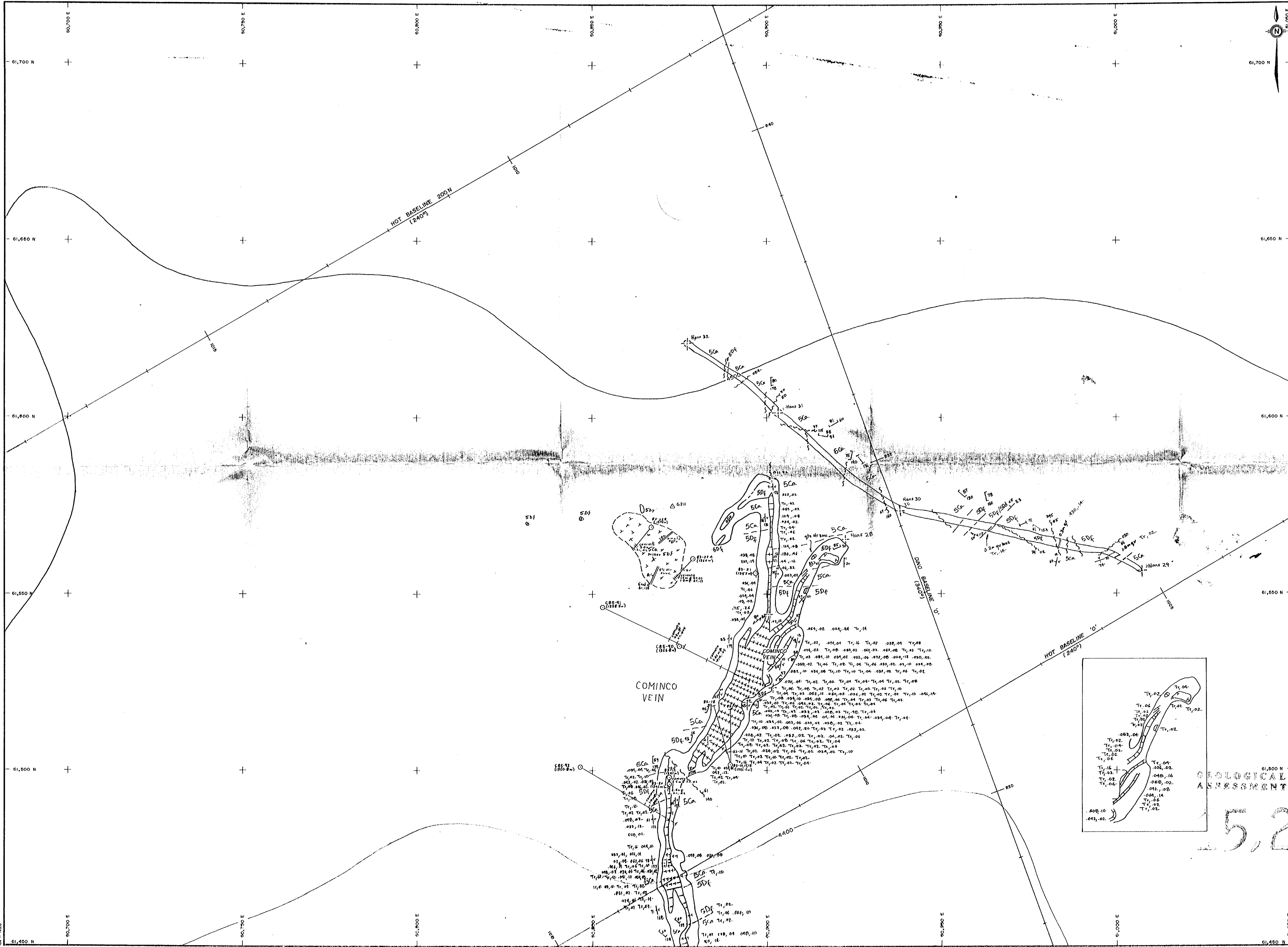

AREA INDEX

19	18	17	6,870,000
6	5	4	6,868,000
7	0	3	6,865,000
8	1	2	6,863,000
			6,860,000

ENLARGEMENT OF AREA 1

Q	P	O	N	M
1	2	1	2	1
R	E	D	C	L
1	2	1	2	1
S	F	A	B	K
1	2	1	2	1
T	G	H	I	J
1	2	1	2	1
U	V	W	X	Y
1	2	1	2	1

- SYMBOLS**
- Rock outcrop, area of outcrop, float:
 - Geological boundary (defined, inferred):
 - Bedding (horizontal, inclined, vertical, overturned, dip unknown):
 - Schistosity, gneissosity, cleavage, foliation (horizontal, inclined, vertical, dip unknown):
 - Lineation, axis of minor folds (horizontal, inclined, vertical):
 - Drag-fold (arrow indicates plunge):
 - Fault (defined, interpreted):
 - Fault (inclined, vertical, relative movement):
 - Surface joint (horiz, inclined, vert, dip unknown):
 - U/G joint (horiz, inclined, vert, dip unknown):
 - Syncline (defined, approximate):
 - Anticline (defined, approximate):
 - Anticline and syncline (overturned):
 - Intensity (weak, moderate, strong):
 - Vein (inclined, vertical, dip unknown):
 - Zone of alteration:
 - Rock sample, X 0.324, 0.15 Assay: Au, Ag ounce/ton:
 - Trench:
 - Adit or tunnel:
 - Rock dump or tailings:
 - Shaft, raise, winze:
 - Diamond drill hole (entering section, leaving section) (on section / plan):
 - Contours: 2500:
 - Stream or creek (perennial, intermittent):
 - Marsh:
 - Lake:
 - Road:

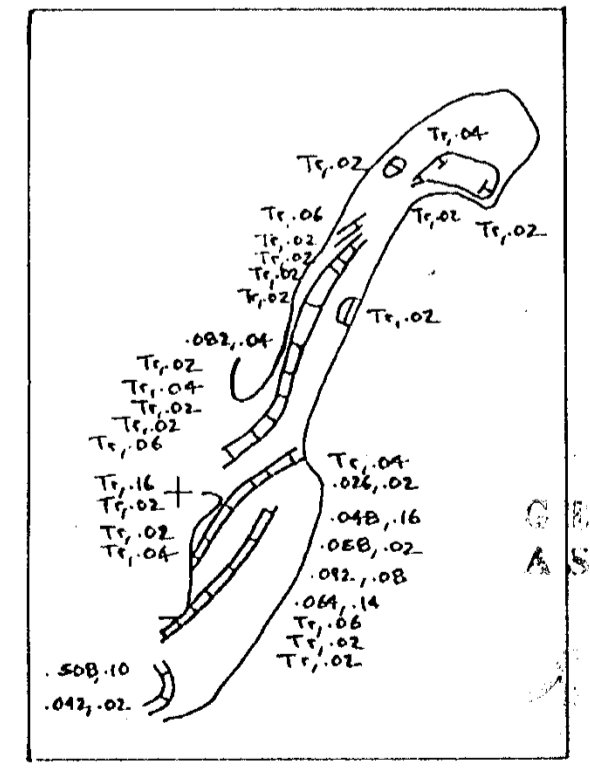

ERICKSON GOLD MINING CORP.

BRANCHARA 85 GROUP

GEOLGICAL ASSESSMENT REPORT

GEOLGY AND DIAMOND DRILLING

5,276

Project Name: CUSAC Project No.: 1003

Latitude: 59°11' APPROX. Longitude: 129°41' APPROX.

Mining Division: LIARD NTS: 104 P/4E

To accompany a report by: R. SOMERVILLE, P. Eng. E. DUSSEL, B. Sc.

Alpha No.: Drawing No.: Date: FEB. 20, 1990 Map No.: 1-H3

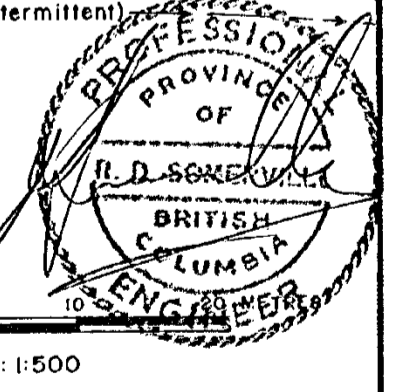

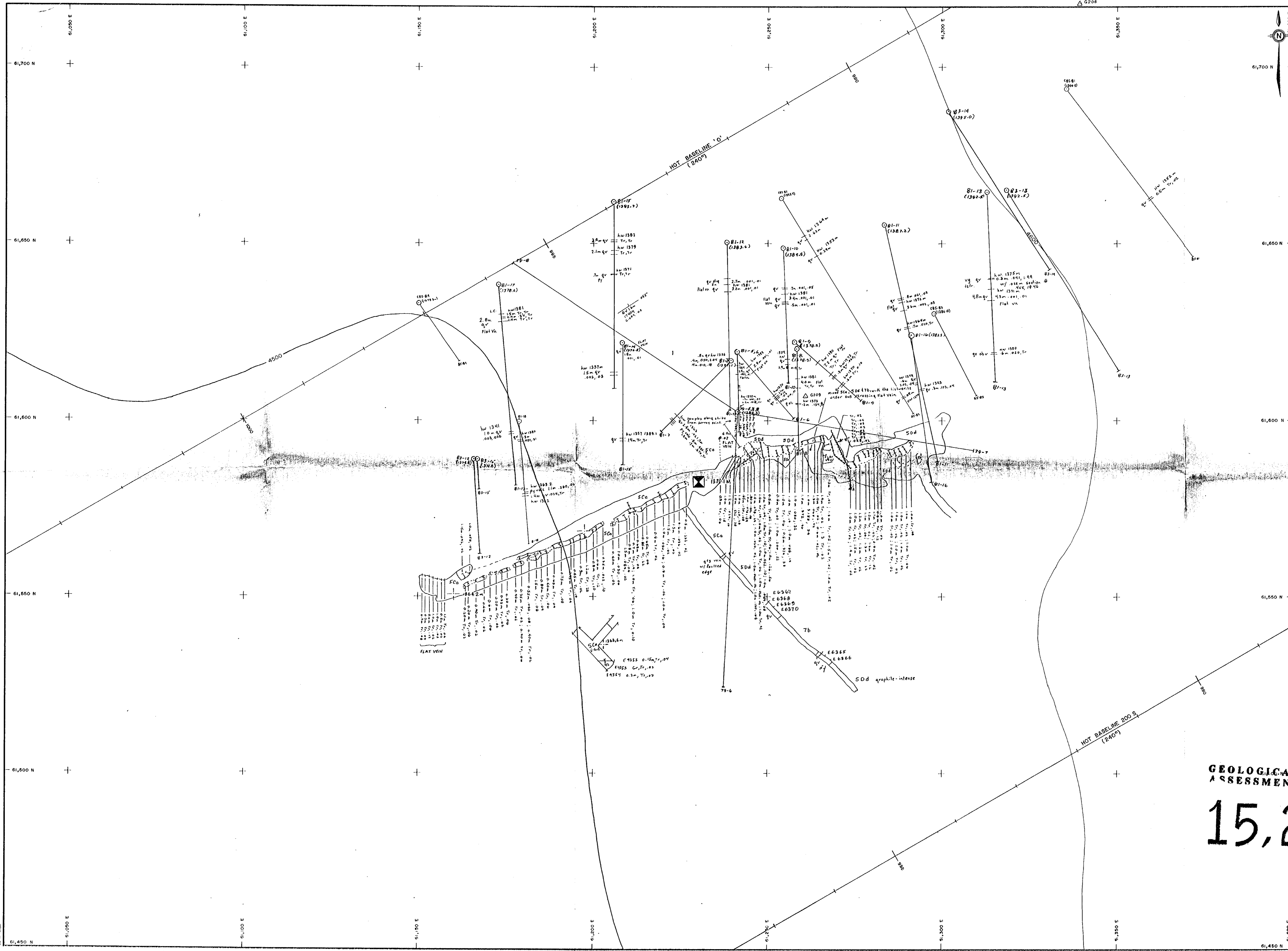

AREA INDEX

19	18	17	6,570,700N
6	5	4	6,568,200N
7	0	3	6,565,700N
8	1	2	6,563,200N
			6,560,700N
485,000E	495,000E	505,000E	495,000E

3	Q	4	P	4	S	0	4	S	N	4	M	4
2	1	2	1	2	1	2	1	2	1	2	1	2
3	R	4	E	4	D	4	C	4	L	4		
2	1	2	1	2	1	2	1	2	1	2	1	2
3	4	3	4	3	4	3	4	3	4	3	4	3
2	1	2	1	2	1	2	1	2	1	2	1	2
3	T	4	G	4	H	4	I	4	J	4		
2	1	2	1	2	1	2	1	2	1	2	1	2
3	4	3	4	3	4	3	4	3	4	3	4	3
2	1	2	1	2	1	2	1	2	1	2	1	2

- ENLARGEMENT OF AREA 1**
- SYMBOLS**
- Rock outcrop, area of outcrop, float
 - Geological boundary (defined, inferred)
 - Bedding (horizontal, inclined, vertical, overturned, dip unknown)
 - Schistosity, gneissosity, cleavage, foliation (horizontal, inclined, vertical, dip unknown)
 - Lineation, axis of minor folds (horizontal, inclined, vertical)
 - Drag-fold (arrow indicates plunge)
 - Fault (defined, interpreted)
 - Fault (inclined, vertical, relative movement)
 - Surface joint (horiz, inclined, vert, dip unknown)
 - U/G joint (horiz, inclined, vert, dip unknown)
 - Syncline (defined, approximate)
 - Anticline (defined, approximate)
 - Anticline and syncline (overturned)
 - Intensity (weak, moderate, strong)
 - Vein (inclined, vertical, dip unknown)
 - Zone of alteration
 - Rock sample, X 0.324, 0.15 Assay: Au, Ag ounce/ton
 - Trench
 - Adit or tunnel
 - Rock dump or tailings
 - Shaft, raise, winze
 - Diamond drill hole (entering section, leaving section) (on section / plan)
 - Contours 2500
 - Stream or creek (perennial, intermittent)
 - Marsh
 - Lake
 - Road
- SCALE: 1:500

ERICKSON GOLD MINING CORP.
BRANCH ASSESSMENT REPORT
 85 GROUP
GEOLGY AND DIAMOND DRILLING
15,276

Project Name: CUSAC Project No: 1003
 Latitude: 59°11' APPROX Longitude: 129°41' APPROX
 Mining Division: LIARD NTS: 104 P/4E
 To accompany a report by: R. SOMERVILLE, P. Eng. E. DUSSEL, B.Sc.
 Alpha No: Drawing No:
 Date: FEB. 20, 1986 Map No: 114

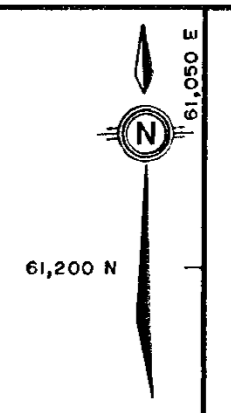
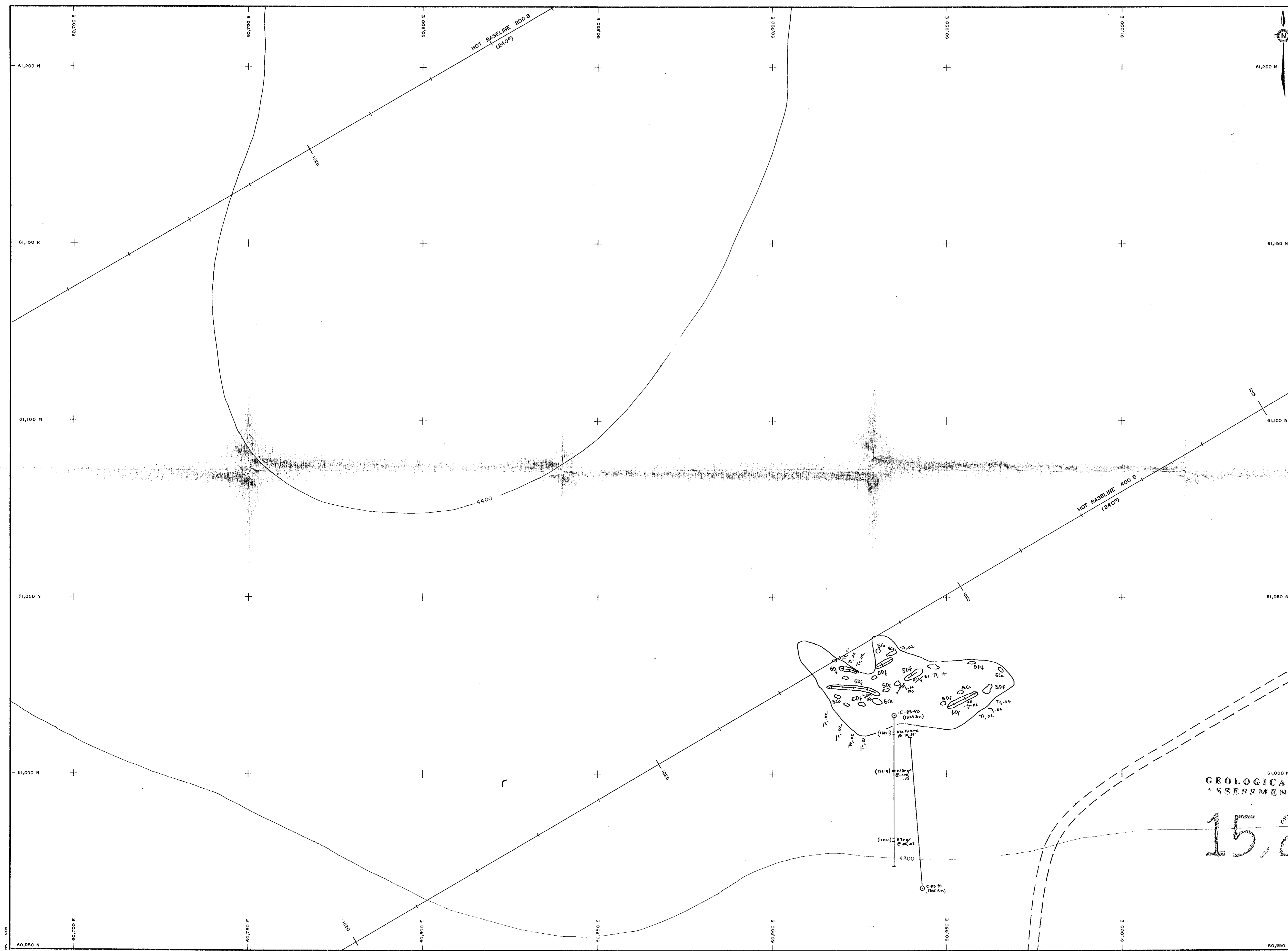

AREA INDEX

19	18	17	6,570,700N
6	5	4	6,568,700N
7	0	3	6,565,700N
8	1	2	6,563,700N
			6,560,700N

498,800E 498,300E 497,800E 497,300E

3	4	3	4	3	4	3	4	3	4
2	1	2	1	2	1	2	1	2	1
3	4	3	4	3	4	3	4	3	4
2	1	2	1	2	1	2	1	2	1
3	4	3	4	3	4	3	4	3	4
2	1	2	1	2	1	2	1	2	1
3	4	3	4	3	4	3	4	3	4
2	1	2	1	2	1	2	1	2	1
3	4	3	4	3	4	3	4	3	4
2	1	2	1	2	1	2	1	2	1

- ENLARGEMENT OF AREA 1
- SYMBOLS**
- Rock outcrop, area of outcrop, float
 - Geological boundary (defined, inferred)
 - Bedding (horizontal, inclined, vertical, overturned, dip unknown)
 - Schistosity, gneissosity, cleavage, foliation (horizontal, inclined, vertical, dip unknown)
 - Lination, axis of minor folds (horizontal, inclined, vertical)
 - Drag-fold (arrow indicates plunge)
 - Fault (defined, interpreted)
 - Fault (inclined, vertical, relative movement)
 - Surface joint (horiz., inclined, vert, dip unknown)
 - U/G joint (horiz., inclined, vert., dip unknown)
 - Syncline (defined, approximate)
 - Anticline (defined, approximate)
 - Anticline and syncline (overturned)
 - Intensity (weak, moderate, strong)
 - Vein (inclined, vertical, dip unknown)
 - Zone of alteration
 - Rock sample, X 0.324, 0.15
Assay: Au, Ag ounce/ton
 - Trench
 - Adit or tunnel
 - Rock dump or tailings
 - Shaft, raise, winze
 - Diamond drill hole (entering section, leaving section) (on section / plan)
 - Contours 2500
 - Stream or creek (perennial, intermittent)
 - Marsh
 - Lake
 - Road

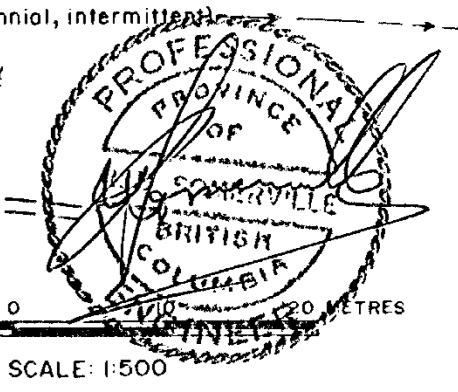

ERICKSON GOLD MINING CORP.

GEOLOGICAL ASSESSMENT REPORT

BRANCARA 85 GROUP

GEOLOGY AND DIAMOND DRILLING

15,276

Project Name: CUSAC Project No: 1003

Latitude: 59°11' APPROX. Longitude: 129°41' APPROX.

Mining Division: LIARD NTS: 104 P/4E

To accompany a report by: R. SOMERVILLE, P. Eng.
E. DUSSEL, B. Sc.

Alpha No: _____ Drawing No: _____

Date: FEB. 20, 1986 Map No: I-W3

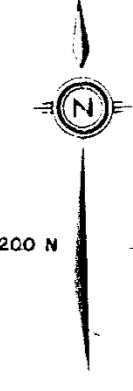
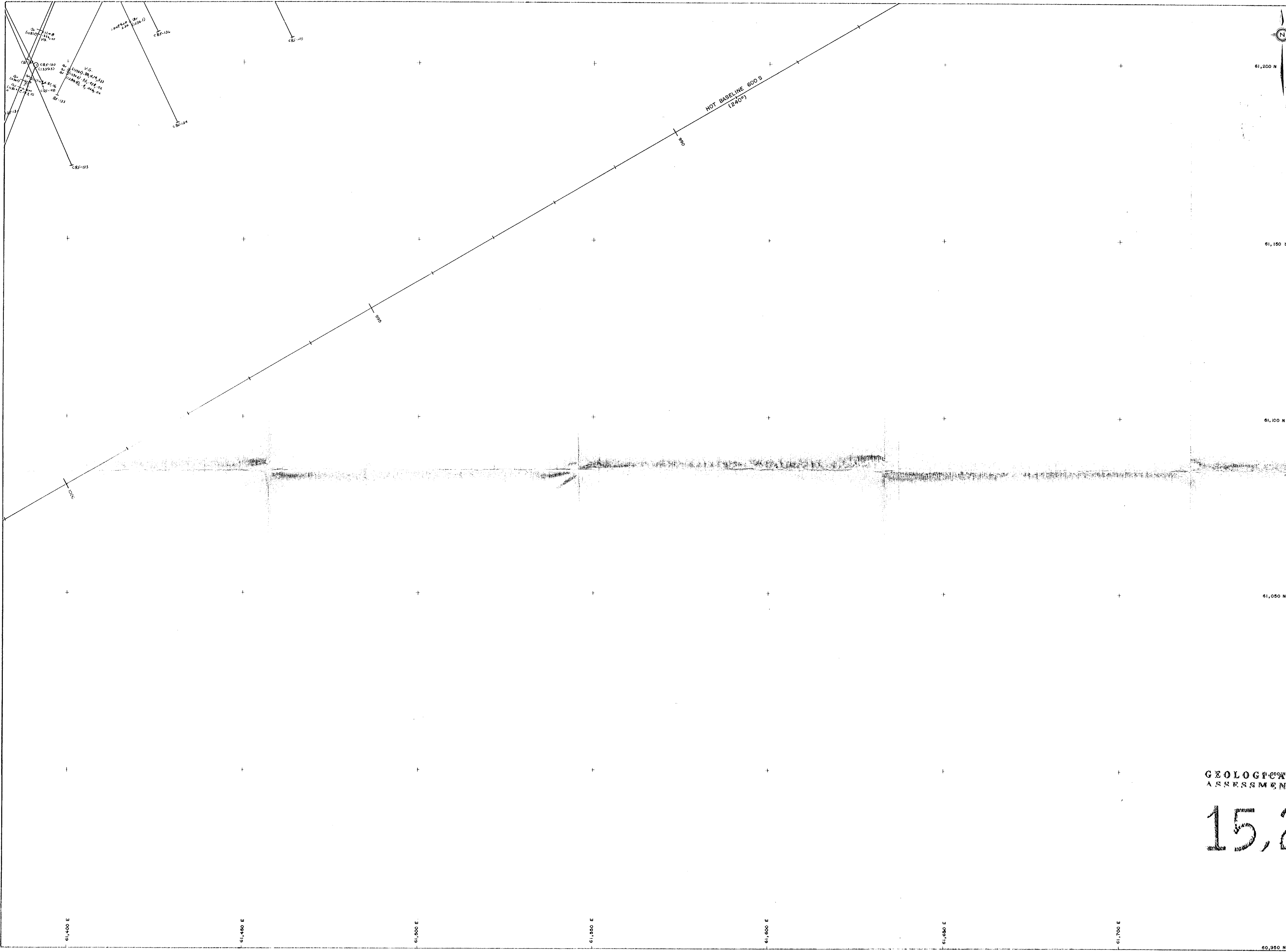

AREA INDEX

19	18	17	6,570,700 N
6	5	4	6,568,200 N
7	0	3	6,565,700 N
8	1	2	6,563,200 N
			6,560,700 N

ENLARGEMENT OF AREA

3	4	3	4	3	4	3	4	3	4
2	Q	2	P	2	O	2	N	2	M
3	R	4	E	4	D	4	C	4	L
2	1	2	1	2	1	2	1	2	1
3	S	4	F	4	A	4	B	4	K
2	1	2	1	2	1	2	1	2	1
3	T	4	G	4	H	4	I	4	J
2	1	2	1	2	1	2	1	2	1
3	U	4	V	4	W	4	X	4	Y
2	1	2	1	2	1	2	1	2	1

SYMBOLS

- Rock outcrop area of outcrop float: XXX
- Geologic boundary (defined, approximate, inferred):
- Bedding, tops known (horizontal, inclined, vertical, overturned, dip unknown):
- Bedding, tops unknown (inclined, vertical, dip unknown):
- Schistosity, gneissosity, cleavage, foliation (horizontal, inclined, vertical, dip unknown):
- Lineation, axis of minor folds (horizontal, inclined, vertical):
- Drag-fold (arrow indicates plunge):
- Fault (defined, approximate, interpreted):
- Joint (horizontal, inclined, vertical, dip unknown):
- Syncline (defined, approximate):
- Anticline (defined, approximate):
- Anticline and syncline, overturned:
- Intensity (weak, moderate, strong):
- Zone of alteration:
- Trench:
- Adit or tunnel:
- Rock dump or tailings:
- Shaft, raise, winze:
- Diamond drill hole:
- entering section, leaving section:

- Contours: 2500
- Stream or creek (perennial, intermittent):
- Marsh:
- Lake:
- Road:
- Trip:
- Treed area:

ERICKSON GOLD MINING CORP.

GEOLOGICAL BRANCH
ASSESSMENT REPORT

15,276
GEOLOGY AND
DIAMOND DRILLING

Project Name: CUSAC Project No: 1003
 Latitude: 59° 13' Longitude: 129° 41'
 Mining Division: LIARD NTS: 104P4E
 To accompany a report by: R. SOMERVILLE, P. Eng.
 E. DUSSEL, B.Sc.
 Alpha No: Drawing No:
 Date: FEB. 20, 1986 Map No: I-X3