

87-28-15525

1/88

SOIL GEOCHEMISTRY AND  
 PRELIMINARY GEOLOGICAL MAPPING  
 LYNN AND ALAMO MINERAL CLAIM GROUP  
 SLOCAN MINING DIVISION  
 THREE FORKS, B.C.  
 NTS 82 K/3 W

LATITUDE 50°01'30"N, LONGITUDE 117°~~18~~<sup>01.4</sup>W

FILMED

Prepared for

Owner: MINOTAUR EXPLORATIONS LTD.

Operator: Locke B. Goldsmith

GEOLOGICAL BRANCH  
 ASSESSMENT REPORT

15,525

ARCTEX ENGINEERING SERVICES

Locke B. Goldsmith, P.Eng.  
 Consulting Geologist

November 3, 1986

## TABLE OF CONTENTS

SUMMARY	1
INTRODUCTION	2
HISTORY	2
LOCATION MAP	3
CLAIM MAP	4
GEOLOGY AND MINERALIZATION	5
SOIL GEOCHEMISTRY	6
Silver	6
Zinc	7
Lead	7
CONCLUSIONS	8
RECOMMENDATIONS	8
COST ESTIMATE	9
ENGINEER'S CERTIFICATE	10
REFERENCES	11
COST STATEMENT, 1986 PROGRAMME	12

### APPENDIX:

ANALYTICAL PROCEDURES  
ASSAYS  
SOIL AND ROCK GEOCHEMICAL ANALYSES

### MAPS:

(Pocket inside back cover)

PRELIMINARY GEOLOGY  
SOIL GEOCHEMISTRY: SILVER  
LEAD  
ZINC

SOIL GEOCHEMISTRY AND  
PRELIMINARY GEOLOGICAL MAPPING  
LYNN AND ALAMO MINERAL CLAIM GROUP  
SLOCAN MINING DIVISION  
THREE FORKS, B.C.

SUMMARY

Soil geochemistry has confirmed and expanded silver and zinc anomalies which were located in earlier surveys, and has detected additional anomalies. Rocks are favourable to host economic concentrations of precious and base metals. Detailed soil geochemistry and dozer and backhoe trenching should be undertaken to explore for bedrock sources of metals. A budget of \$35,200 in Phase 2 and a total of \$115,200 in two Phases is estimated.

## INTRODUCTION

The property is located on the western end of London Ridge, immediately east and northeast of the confluence of Seaton and Kane creeks. Highway 31A, which joins New Denver and Kaslo, passes through the southern part of the claim block. New Denver is located approximately 9 km to the west. A logging road extends from Highway 31A northerly onto an abandoned railway grade, westerly along the grade, and thence northerly to within 100 m of the north boundary of the Alamo claim. Elevations range from 760 m (2500') at Three Forks to 1585 m (5200') on London Ridge.

Record data of the claims are as follows.

<i>Claim Name</i>	<i>Size in Units</i>	<i>Record Number</i>	<i>Record Date</i>
Lynn	6	4257(3)	March 21, 1984
Alamo	9	4746(7)	July 9, 1985
Alamo 2	2	4759(7)	July 30, 1985
Alamo 3	2	4786(9)	September 3, 1985

A total of 27.75 km of grid was established. Base line trends north-south along the west side of the claims with cross lines oriented east-west. Line spacing is 100 m with sample sites at 50 m intervals.

## HISTORY

Old pits or adits have been noted in four locations on the property. An adit at the north side of Highway 31A on the Alamo 2 claim was mapped by Lynn (Tully, 1985, fig. 12-5). A trench or possibly caved adit portal is located at 1+00S 12+00E of the present grid. Shallow cuts or trenches are present to the east and west of the access road in the vicinity of 4+50S 8+00E, and 4+50S 11+00E. An adit at 17+00S 2+55E, some 8 m in length, was not shown on previous maps.

Reconnaissance soil geochemistry along the railroad grade and along an existing logging road was commenced by Snell (1980). A geochemical survey was

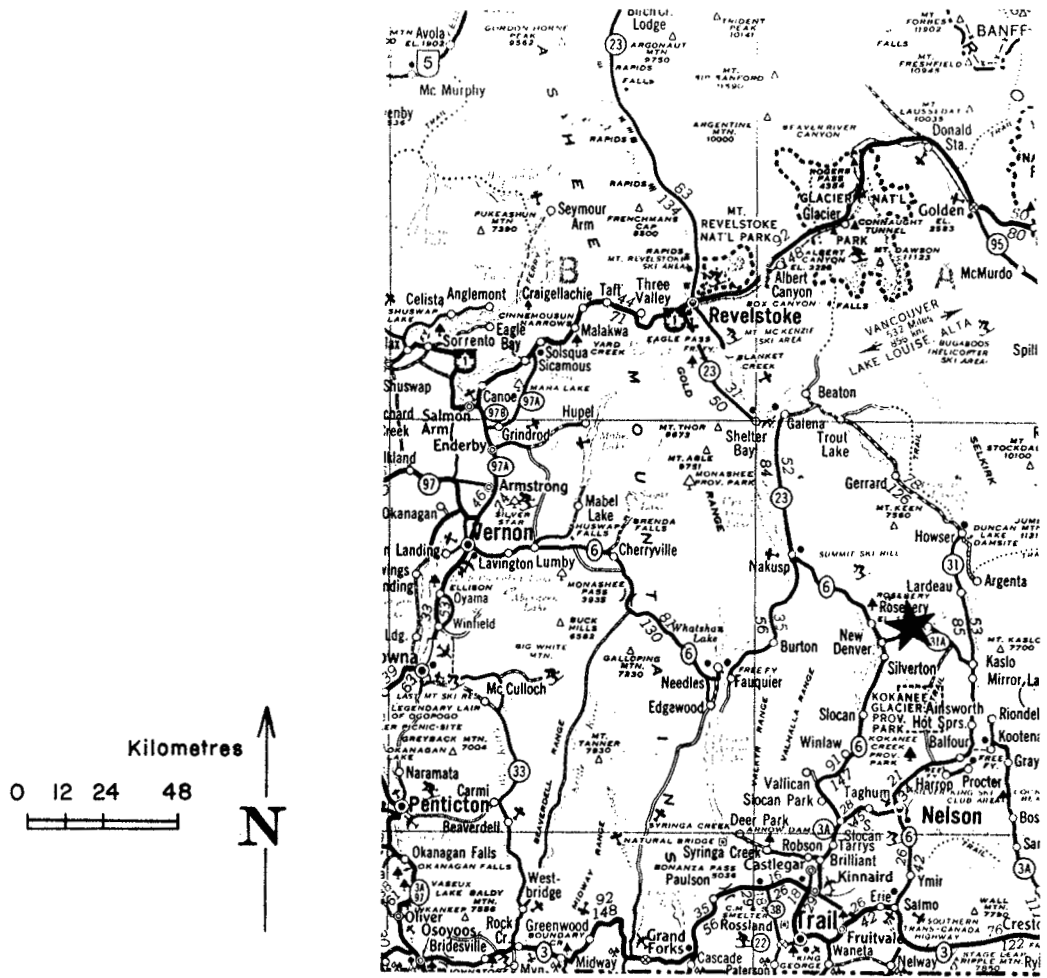

## Location Map

**MINOTAUR EXPLORATIONS LTD.**

**Alamo Claim Group**

*Alamo 4746(7) Alamo 2 4759(7) Alamo 3 4786(9) Lynn 4257(3)*

*Three Forks, B. C. Stocan Mining Division*



L.B. GOLDSMITH, P. Eng., CONSULTING GEOLOGIST.

*Arctex Engineering Services*

*September 1986*

83K/3W

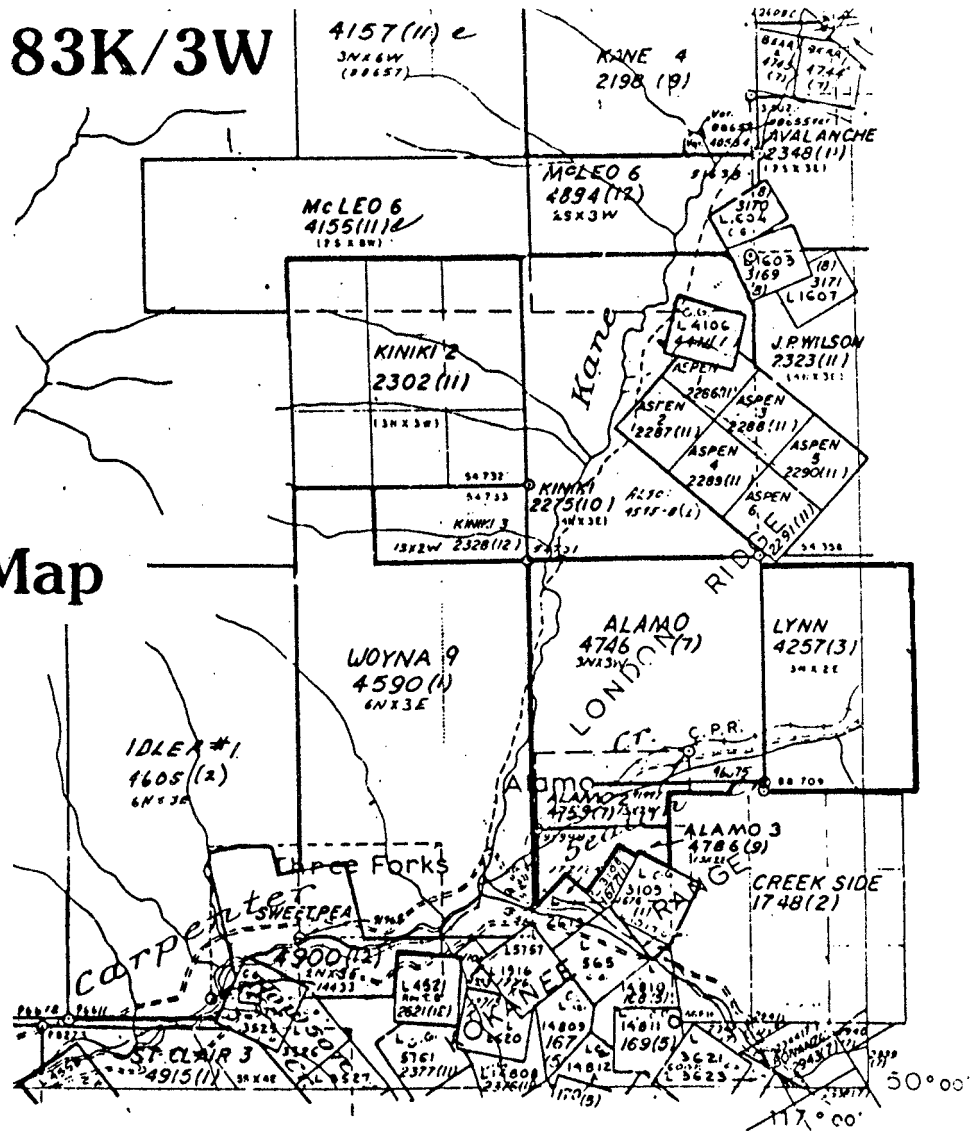

### Claim Map

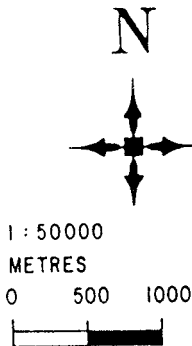

## MINOTAUR EXPLORATIONS LTD.

### Alamo Claim Group

*Alamo 4746(7) Alamo 2 4759(7) Alamo 3 4786(9) Lynn 4257(3)*

*Three Forks, B. C. Placer Mining Division*



L.B. GOLDSMITH, P. Eng., CONSULTING GEOLOGIST.

*Arctex Engineering Services*

*September 1986*

completed the following year over the area then held by a previous Alamo claim, now included within the subject property (Snell, 1981). Preliminary geological mapping and soil sampling within four of the 1981 anomalies was completed by Lynn (Tully, 1985).

No history of production is known, but only a very small tonnage could have been extracted. The Alamo Mine quoted in earlier reports (Tully, 1984, 1985) is situated 5 km southwest of the southwest corner of the claim group. Confusion in location is caused by an error on topographic and claim maps which shows the Alamo millsite 0.5 km east of Three Forks, in the southwest corner of the claims, whereas it is in fact situated at the junction of Howson and Carpenter creeks, some 1.5 km west of Three Forks.

## GEOLOGY AND MINERALIZATION

The claims are underlain by clastic sediments of the Triassic-Jurassic Slocan Group. Granitic dykes, possibly coeval with the Nelson batholith, intrude the sediments. Foliation trends northwesterly, with variable dips which are predominantly westerly.

Grey and smoky quartz without visible sulphides form a train of float which extends northeasterly (upslope) and southwesterly at 1+00S 12+00E. Veinlets and small veins of quartz in granitic float also form part of the dispersion pattern. One float sample (MIN-2) contains 9.4 ppm Ag. It is possible that the quartz may be related to the bedrock source of a silver anomaly in soils.

White and grey quartzite exposed in outcrop and in an adit 8 m long at 17+00S 2+55E contains abundant disseminated pyrite.

Rusty gossan, probably after pyrite in sediments, is present near the portal of an adit on the north side of Highway 31A (Snell, 1981).

A rhyolite dyke with quartz veinlets which contain silver-lead mineralization (Snell, 1981) is located to the east of the present claim group.

## SOIL GEOCHEMISTRY

A narrow, elongate spade was used to collect a total of 527 soil samples from 30-45 cm below organic debris. In general, the survey provided better resolution of silver and zinc anomalies which were detected in previous work.

The following table displays statistical data concerning metal abundance derived from lognormal probability plots. Years of soil sampling results over Slocan Group rocks have been compiled into this information.

	<i>Ag</i> ppm	<i>Pb</i> ppm	<i>Zn</i> ppm
Background	<2.3	<38	
Threshold	2.3 to 4.9	38 to 150	
Anomalous	>4.9	>150	>980

} Possibly two populations

### Silver

On line 00 from 10+00E to 16+00E a broken pattern of threshold to sub-anomalous values occurs in sandy soil near the crest of London Ridge. It is possible that additional sampling to the north would produce a continuous anomaly. No outcrop was observed. Samples taken near old trenches at 1+00S 12+00E have only background amounts of silver. The train of quartz in float, one sample of which (MIN-2) contains 9.4 ppm Ag, does not appear to be reflected in the soil geochemistry on line 1+00S.

A single sample anomalous value of 5.6 ppm at 2+00S 10+50E is coincident with anomalous zinc.

Threshold to anomalous values on the flat area in the vicinity of 4+00S 8+00E to 7+00S 10+00E have no obvious explanation. A low ridge with rounded granitic boulders and angular argillite fragments trends northwesterly with its northern margin at 5+00S 8+40E. Otherwise the silver values occur on a featureless expanse of overburden; lead and zinc values are not elevated.



A cluster of threshold silver values occur on a steep westerly slope from 10+00S 2+00E to 12+00S 1+50E. Scattered outcrops of argillite and shaly argillite were observed but no source of the metal values was visible.

A single sample value of 6.0 ppm Ag at 10+00S 10+50E has been duplicated in other surveys. Because of proximity to the railroad grade contamination is suspected, but additional investigation is required.

Subanomalous values at 17+00S 0+50 to 1+00E and 18+00S 1+00E are unexplained. Argillite float is present on a steep slope on the south side of Carpenter Creek.

### Zinc

Two clusters of zinc anomalies each have one associated anomalous silver value. On lines 1+00S 10+50E to 11+00E and 2+00S 10+50E values to 1250 ppm Zn occur with 5.6 ppm Ag. No outcrop could be found, but float is predominantly argillite with lesser amounts of granitics. At 9+00S 11+00E and 10+00S 9+50E to 11+00E zinc values to 1550 ppm with one silver of 6.0 ppm define an anomaly upslope from the railroad grade. Argillite outcrops along the roads and to the northwest of the high metal values but no bedrock source was observed.

Single sample highs at 2+00S 4+00E (3250 ppm Zn) and 2+00S 5+00E (1200 ppm Zn) may be derived from shale which outcrops nearby. Similarly, values at 4+00S 11+50E, and 12+00S 4+50E and 13+00S 4+50E may be related to inherent zinc content of shale or shaly argillite. Black graphitic shale in float underlies the eastern ends of lines 17+00S and 18+00S where zinc levels are elevated. One anomalous sample beside the railroad grade at 8+00S 21+00E is attributed to contamination.

### Lead

No clearly anomalous lead values were obtained.

## CONCLUSIONS

Elevated metal values occur in seven locations where the source could be economic concentrations of silver and/or zinc in bedrock.

<i>Coordinates</i>	<i>Metals</i>
00 10+00E to 16+00E	Ag
2+00S 4+00E & 5+00E	Zn (Ag?)
2+00S 10+50E	Ag + Zn
4+00S 7+50E - 7+00S 10+00E	Ag
10+00S 2+00E - 12+00S 1+50E	Ag
10+00S 9+50E to 11+00E	Ag + Zn
17+00S 0+50E - 18+00S 1+00E	Ag

## RECOMMENDATIONS

Phase 1 geochemistry as recommended by Tully (1985) is completed and documented in this report.

### Phase 2

Detailed soil geochemical sampling on 25-metre centres should be completed around each of the zones listed above. Dozer-backhoe trenching should be undertaken on anomalies which are considered significant after results of soil geochemistry are evaluated.

### Phase 3

Diamond drilling may be required on selected targets.

## COST ESTIMATE

## Phase 2

Soil sampling	\$ 2,500	
Analyses	3,000	
Dozer/backhoe trenching	15,000	
Geological supervision	6,000	
Vehicle, fuel	1,500	
Room, board, supplies	500	
Engineering	1,000	
Report	2,500	
	<u>32,000</u>	
Contingencies @ 10%	3,200	
Total, Phase 2	35,200	\$ 35,200

## Phase 3

A budget for 500 metres of diamond drilling in short holes should be available.

Diamond drilling totalling 500 metres at \$100/metre might be required. A budget of \$80,000 should be available.

\$ 80,000

Total, Phases 2 and 3

\$115,200

Results of Phase 2 should be compiled into an engineering report; continuance to Phase 3 should be contingent upon receiving favourable conclusions and recommendations from an Engineer.

Respectfully submitted,

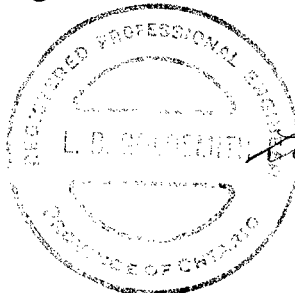

*Locke B. Goldsmith*

Locke B. Goldsmith, P.Eng.  
Consulting Geologist

Vancouver, B.C.  
November 3, 1986

**ENGINEER'S CERTIFICATE**  
**LOCKE B. GOLDSMITH**

1. I, Locke B. Goldsmith, am a Registered Professional Engineer in the Province of Ontario and the Northwest Territories, and a Registered Professional Geologist in the State of Oregon. My address is 301, 1855 Balsam Street, Vancouver, B.C.
2. I have a B.Sc. (Honours) degree in Geology from Michigan Technological University, a M.Sc. degree in Geology from the University of British Columbia, and have done postgraduate study in Geology at Michigan Tech and the University of Nevada. I am a graduate of the Haileybury School of Mines, and am a Certified Mining Technician. I am a Member of the Society of Economic Geologists, the AIME, and the Australasian Institute of Mining and Metallurgy, and a Fellow of the Geological Association of Canada.
3. I have been engaged in mining exploration for the past 27 years.
4. I have authored the report entitled, "Soil Geochemistry and Preliminary Geological Mapping, Lynn and Alamo Mineral Claim Group, Slocan Mining Division, Three Forks Area, B.C.", dated November 3, 1986. The report is based upon fieldwork and research supervised by the author.
5. I have no ownership in the property, nor in the stocks of Minotaur Explorations Ltd..
6. I consent to the use of this report in a prospectus, or in a statement of material facts related to the raising of funds.

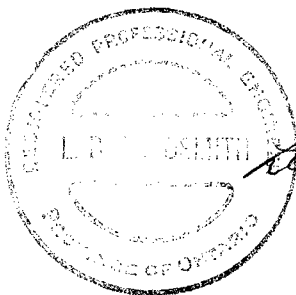

Respectfully submitted,

*Locke B. Goldsmith*

Locke B. Goldsmith, P.Eng.  
Consulting Geologist

Vancouver, B.C.  
November 3, 1986

## REFERENCES

- Snell, J.C. 1980. Geological report on the Alamo Claim, London Ridge, Slocan Mining Division. Private report for Kanaka Creek Holdings Ltd.
- Snell, J.C. 1981. Geochemical survey results on the Alamo Mineral Claim, Slocan Mining Division, B.C. Private report for Kanaka Creek Holdings Ltd.
- Tully, D.W. 1984. Report on the Hynn Mineral Claim, Seaton Creek-Three Forks-Alamo area, Slocan Mining Division, Sandon, B.C. Private report for Minotaur Explorations Ltd.
- Tully, D.W. 1985. Report on the Lynn, Alamo, Alamo 2, Alamo 3 Mineral Claim Group, Seaton Creek-Three Forks-Alamo area, Slocan Mining Division, Sandon, B.C. Private report for Minotaru Explorations Ltd.

## COST STATEMENT, 1986 PROGRAMME

## Personnel:

L.B. Goldsmith, Jul. 29, $\frac{1}{2}$ Oct. 7, $\frac{1}{2}$ 12, 14, $\frac{1}{2}$ 15, $\frac{1}{4}$ 16, $\frac{1}{4}$ 18, $\frac{1}{2}$ 21, $\frac{1}{2}$ 23, $\frac{1}{4}$ 24, $\frac{1}{2}$ Nov. 2, $\frac{1}{2}$ 3 - total $5\frac{3}{4}$ days @ \$400/day	\$2,300.00	
G. Bennett, Jul. 29, 30, 31, Aug. 1-7 - total 10 days @ \$230/day	2,300.00	
T. Gustavson, Jul. 30, 31, Aug. 1-7 - total 9 days @ \$230/day	<u>2,070.00</u>	
	6,670.00	\$ 6,670.00

## Food, Accommodation:

\$125.95 $\div$ $21\frac{1}{2}$ field days = \$5.86/day	125.95
---	--------

## Transportation:

4x4 vehicle, $10\frac{3}{4}$ days @ \$45/day	\$ 483.75	
1787 km @ \$0.30/km	535.50	
Gas	<u>83.88</u>	
	1,103.13	1,103.13

## Analyses:

527 soil samples cost	\$2,579.99	
3 rock samples cost	<u>34.05</u>	
	2,614.04	2,614.04
$\div$ 530 samples = \$4.93/sample		

## Report:

Drafting, prints, typing, photocopying, materials		<u>1,096.85</u>
TOTAL:		\$11,609.97

APPENDIX

Gold F.A.-A.A. Combo Method ppb:

For low grade samples and geochemical materials, 10 gram samples are fused in litharge, carbonate and siliceous flux with the addition of 10 mg of Au-free Ag metal and cupelled. The silver bead is parted with dilute HNO<sub>3</sub> and then treated with aqua regia. The salts are dissolved in dilute HCl and analyzed for Au on an atomic absorption spectrophotometer.

Detection limit: 5 ppb

Copper, Lead, Zinc, Silver ppm:

1.0 gm sample is digested with perchloric-nitric acid (HClO<sub>4</sub>-HNO<sub>3</sub>) for approximately 2 hours. The digested sample is cooled and made up to 25 mls with distilled water. The solution is mixed and solids are allowed to settle. Copper, lead, zinc and silver are determined by atomic absorption techniques. Silver and lead are corrected for background absorption.

Detection limit: Copper, Zinc - 1 ppm  
Silver - 0.2 ppm  
Lead - 2 ppm

Arsenic ppm:

A 1.0 gm sample is digested with a mixture of perchloric and nitric acid to strong fumes of perchloric acid. The digested solution is diluted to volume and mixed. An aliquot of the digest is acidified, reduced with KI and mixed. A portion of the reduced solution is converted to arsine with NaBH<sub>4</sub> and the arsenic content determined using flameless atomic absorption.

Detection limit: 1 ppm





# Chemex Labs Ltd.

212 Brooksbank Ave.  
North Vancouver, B.C.  
Canada V7J 2C1

Analytical Chemists • Geochemists • Registered Assayers

Phone: (604) 984-0221  
Telex: 043-52597

## CERTIFICATE OF ANALYSIS

TO : ARCTEX ENGINEERING  
  
301 - 1855 BALSAM ST.  
VANCOUVER, B.C.  
V6K 3M3

CERT. # : A8619579-001-A  
INVOICE # : I8619579  
DATE : 27-OCT-86  
P.O. # : NGNE  
MINCTAUR

Sample description	Prep code	Ag ppm Aqua R	Au ppb FA+AA				
MIN-1	205	0.7	<5	--	--	--	--
MIN-2	205	9.4	<5	--	--	--	--
MIN-3	205	0.6	<5	--	--	--	--

Certified by *Hart Bichler*



# Chemex Labs Ltd.

Analytical Chemists • Geochemists • Registered Assayers

212 Brooksbank Ave.  
North Vancouver, B.C.  
Canada V7J 2C1  
Phone: (604) 984-0221  
Telex: 043-52597

## CERTIFICATE OF ANALYSIS

TO : GOLDSMITH, MR. L. B.  
  
#301-1855 BALSAM STREET  
VANCOUVER, B.C.  
V6K 3M3

CERT. # : A8617531-001-A  
INVOICE # : I8617531  
DATE : 10-SEP-86  
P.O. # : NONE

Sample description	Prep code	Pb ppm	Zn ppm	Ag ppm Aqua R			
BL 0+00	201	41	182	0.1	--	--	--
0+00 01+00E	201	10	260	0.1	--	--	--
0+00 01+50E	201	26	145	0.4	--	--	--
0+00 02+00E	201	19	136	0.4	--	--	--
0+00 02+50E	201	78	118	0.5	--	--	--
0+00 03+00E	201	13	250	0.7	--	--	--
0+00 03+50E	201	8	260	0.7	--	--	--
0+00 04+00E	201	1	77	0.1	--	--	--
0+00 04+50E	201	23	800	0.5	--	--	--
0+00 05+00E	201	35	193	0.6	--	--	--
0+00 05+50E	201	16	365	0.7	--	--	--
0+00 06+00E	201	14	210	1.5	--	--	--
0+00 06+50E	201	18	315	0.4	--	--	--
0+00 07+00E	201	21	400	0.1	--	--	--
0+00 07+50E	201	14	430	0.8	--	--	--
0+00 08+00E	201	19	438	2.3	--	--	--
0+00 08+50E	201	13	290	1.1	--	--	--
0+00 09+00E	201	8	190	0.2	--	--	--
0+00 09+50E	201	11	315	1.7	--	--	--
0+00 10+00E	201	15	560	2.7	--	--	--
0+00 10+50E	201	25	500	2.2	--	--	--
0+00 11+00E	201	14	610	1.3	--	--	--
0+00 11+50E	201	16	475	3.5	--	--	--
0+00 12+00E	201	14	390	2.8	--	--	--
0+00 12+50E	201	9	265	0.5	--	--	--
0+00 13+00E	201	12	188	3.6	--	--	--
0+00 13+50E	201	5	218	4.8	--	--	--
0+00 14+00E	201	8	82	0.4	--	--	--
0+00 14+50E	201	16	290	1.7	--	--	--
0+00 15+00E	201	14	330	1.7	--	--	--
0+00 15+50E	201	9	290	0.8	--	--	--
0+00 16+00E	201	18	272	3.8	--	--	--
0+00 16+50E	201	16	185	1.0	--	--	--
0+00 17+00E	201	15	245	0.9	--	--	--
0+00 17+50E	201	21	176	0.5	--	--	--
0+00 18+00E	201	19	215	1.2	--	--	--
0+00 18+50E	201	16	165	0.5	--	--	--
0+00 19+00E	201	12	105	0.2	--	--	--
0+00 19+50E	201	17	228	0.3	--	--	--
0+00 20+00E	201	18	253	0.9	--	--	--

VOI rev. 4/85

Certified by .. *Hart Bichler* ..



# Chemex Labs Ltd.

212 Brooksbank Ave.  
North Vancouver, B.C.  
Canada V7J 2C1

Analytical Chemists • Geochemists • Registered Assayers

Phone: (604) 984-0221  
Telex: 043-52597

## CERTIFICATE OF ANALYSIS

TO : GOLDSMITH, MR. L. B.

#301-1855 BALSAM STREET  
VANCOUVER, B.C.  
V6K 3M3

CERT. # : A8617531-002-A  
INVOICE # : I8617531  
DATE : 10-SEP-86  
P.O. # : NONE

Sample description	Prep code	Pb ppm	Zn ppm	Ag ppm Aqua R			
0+00 20+50E	201	40	220	1.0	--	--	--
0+00 21+00E	203	14	192	0.1	--	--	--
0+00 21+50E	201	15	218	0.2	--	--	--
0+00 22+00E	201	12	120	0.2	--	--	--
0+00 22+50E	201	6	150	0.1	--	--	--
0+00 23+00E	201	36	740	0.3	--	--	--
0+00 23+50E	201	10	210	0.4	--	--	--
0+00 24+00E	201	18	240	0.4	--	--	--
3L 1+00S	201	12	230	0.2	--	--	--
1S 00+50E	217	28	148	0.1	--	--	--
1S 01+00E	203	30	155	0.3	--	--	--
1S 01+50E	201	32	155	0.4	--	--	--
1S 02+00E	203	34	125	0.7	--	--	--
1S 02+50E	201	14	175	1.2	--	--	--
1S 03+00E	201	8	148	0.1	--	--	--
1S 03+50E	201	24	170	0.3	--	--	--
1S 04+00E	201	18	172	0.6	--	--	--
1S 04+50E	201	25	150	0.2	--	--	--
1S 05+00E	201	5	365	0.3	--	--	--
1S 05+50E	203	9	147	0.4	--	--	--
1S 06+00E	201	18	620	0.5	--	--	--
1S 06+50E	201	18	225	0.7	--	--	--
1S 07+00E	201	17	209	0.4	--	--	--
1S 07+50E	201	10	660	0.8	--	--	--
1S 08+00E	201	11	300	0.4	--	--	--
1S 08+50E	201	23	262	0.6	--	--	--
1S 09+00E	201	7	470	1.2	--	--	--
1S 09+50E	201	14	810	0.3	--	--	--
1S 10+00E	201	15	690	1.4	--	--	--
1S 10+50E	201	12	1050	1.3	--	--	--
1S 11+00E	201	7	1100	1.1	--	--	--
1S 11+50E	201	10	260	1.8	--	--	--
1S 12+00E	201	32	350	0.2	--	--	--
1S 12+50E	201	41	219	0.1	--	--	--
1S 13+00E	201	14	580	0.6	--	--	--
1S 13+50E	201	7	164	0.1	--	--	--
1S 14+00E	201	23	252	0.2	--	--	--
1S 14+50E	201	12	154	0.2	--	--	--
1S 15+00E	201	10	240	0.8	--	--	--
1S 15+50E	201	20	180	0.2	--	--	--

VOI rev. 4/85

Certified by Hart Bichler



# Chemex Labs Ltd.

Analytical Chemists • Geochemists • Registered Assayers

212 Brooksbank Ave.  
North Vancouver, B.C.  
Canada V7J 2C1

Phone: (604) 984-0221  
Telex: 043-52597

## CERTIFICATE OF ANALYSIS

TO : GOLDSMITH, MR. L. B.

#301-1855 BALSAM STREET  
VANCOUVER, B.C.  
V6K 3M3

CERT. # : A8617531-003-A  
INVOICE # : I8617531  
DATE : 10-SEP-86  
P.O. # : NONE

Sample description	Prep code	Pb ppm	Zn ppm	Ag ppm Aqua R			
1S 16+00E	201	8	275	0.6	--	--	--
1S 16+50E	201	28	170	1.2	--	--	--
1S 17+00E	201	21	190	0.8	--	--	--
1S 17+50E	201	17	119	0.2	--	--	--
1S 18+00E	201	9	170	0.1	--	--	--
1S 18+50E	201	21	178	0.4	--	--	--
1S 19+00E	201	18	235	0.5	--	--	--
1S 19+50E	201	58	185	1.6	--	--	--
1S 20+00E	201	8	210	0.1	--	--	--
1S 20+50E	201	10	155	0.3	--	--	--
1S 21+00E	201	9	156	0.3	--	--	--
1S 21+50E	201	17	110	0.3	--	--	--
1S 22+00E	201	6	200	0.1	--	--	--
1S 22+50E	201	15	184	0.4	--	--	--
1S 23+00E	201	21	150	0.2	--	--	--
8L 2+00S	203	20	300	0.2	--	--	--
4S 01+50E	203	70	285	1.0	--	--	--
4S 02+50E	201	14	170	0.3	--	--	--
4S 03+00E	203	16	137	0.6	--	--	--
4S 03+50E	201	15	145	0.3	--	--	--
4S 04+00E	201	18	105	0.3	--	--	--
4S 04+50E	201	8	84	0.3	--	--	--
4S 05+00E	201	22	270	0.1	--	--	--
4S 05+50E	203	22	175	0.5	--	--	--
4S 06+00E	201	10	195	1.9	--	--	--
4S 06+50E	201	16	167	1.1	--	--	--
4S 07+00E	201	20	200	0.1	--	--	--
4S 07+50E	201	8	139	2.5	--	--	--
3L 7+00S	203	28	160	0.6	--	--	--
7S 00+50E	201	13	147	0.1	--	--	--
7S 01+00E	201	60	147	0.5	--	--	--
7S 01+50E	201	13	135	1.2	--	--	--
7S 02+00E	203	17	218	0.2	--	--	--
7S 02+50E	201	8	164	0.7	--	--	--
7S 03+00E	201	11	245	2.2	--	--	--
7S 03+50E	203	20	300	0.3	--	--	--
7S 04+00E	201	17	215	1.2	--	--	--
7S 04+50E	201	9	305	1.1	--	--	--
7S 05+00E	201	11	245	0.6	--	--	--
7S 05+50E	201	33	228	0.2	--	--	--

VOI rev. 4/85

Certified by *Hart Bichler* .....



# Chemex Labs Ltd.

Analytical Chemists • Geochemists • Registered Assayers

212 Brooksbank Ave.  
North Vancouver, B.C.  
Canada V7J 2C1

Phone: (604) 984-0221  
Telex: 043-52597

## CERTIFICATE OF ANALYSIS

TO : GOLDSMITH, MR. L. B.

#301-1855 BALSAM STREET  
VANCOUVER, B.C.  
V6K 3M3

CERT. # : A8617531-004-A  
INVOICE # : I8617531  
DATE : 10-SEP-86  
P.O. # : NONE

Sample description	Prep code	Pb ppm	Zn ppm	Ag ppm Aqua R			
7S 06+00E	201	25	460	1.0	--	--	--
7S 06+50E	201	17	300	1.2	--	--	--
7S 07+00E	201	8	345	1.4	--	--	--
7S 07+50E	201	6	340	0.7	--	--	--
8L 8S	201	32	190	0.4	--	--	--
8S 00+50E	201	16	190	0.2	--	--	--
8S 01+00E	201	17	230	0.7	--	--	--
8S 01+50E	201	17	345	0.5	--	--	--
8S 02+00E	201	12	250	0.8	--	--	--
8S 02+50E	201	21	180	0.7	--	--	--
8S 03+00E	201	23	245	0.1	--	--	--
8S 03+50E	201	95	270	0.8	--	--	--
3S 04+00E	201	14	220	0.6	--	--	--
8S 04+50E	217	14	140	0.2	--	--	--
8S 05+00E	201	72	300	0.4	--	--	--
8S 05+50E	217	39	245	1.1	--	--	--
8S 06+00E	201	21	380	1.0	--	--	--
8S 06+50E	201	37	205	0.4	--	--	--
8S 07+00E	201	10	275	0.3	--	--	--
8S 07+50E	201	36	220	0.2	--	--	--
8S 08+00E	201	16	300	0.7	--	--	--
8S 08+50E	201	24	305	0.6	--	--	--
8S 09+00E	201	8	530	0.9	--	--	--
8S 09+50E	201	5	510	1.0	--	--	--
8S 10+00E	201	10	1360	2.1	--	--	--
8S 10+50E	217	14	370	0.3	--	--	--
8S 11+00E	201	13	395	0.3	--	--	--
8S 11+50E	201	10	560	1.0	--	--	--
8S 12+00E	201	11	126	0.2	--	--	--
8S 12+50E	201	11	93	0.1	--	--	--
9S 13+00E	201	10	215	0.1	--	--	--
8S 13+50E	201	5	78	0.2	--	--	--
8S 14+00E	201	10	86	0.2	--	--	--
8S 14+50E	201	7	146	0.1	--	--	--
8S 15+00E	201	4	120	0.1	--	--	--
8S 15+50E	201	10	82	0.2	--	--	--
8S 16+00E	201	15	235	0.6	--	--	--
8S 16+50E	201	14	155	0.5	--	--	--
JS 17+00E	201	20	115	0.1	--	--	--
8S 17+50E	201	7	182	0.3	--	--	--

VOI rev. 4/85

Certified by *Hart Buchler* .....



# Chemex Labs Ltd.

212 Brooksbank Ave.  
North Vancouver, B.C.  
Canada V7J 2C1

Analytical Chemists • Geochemists • Registered Assayers

Phone: (604) 984-0221  
Telex: 043-52597

## CERTIFICATE OF ANALYSIS

TO : GOLDSMITH, MR. L. B.

#301-1855 BALSAM STREET  
VANCOUVER, B.C.  
V6K 3M3

CERT. # : A8617531-005-A  
INVOICE # : I8617531  
DATE : 10-SEP-86  
P.O. # : NONE

Sample description	Prep code	Pb ppm	Zn ppm	Ag ppm Aqua R			
8S 18+00E	201	20	165	0.3	--	--	--
8S 18+50E	201	5	128	0.1	--	--	--
8S 19+00E	201	10	247	0.1	--	--	--
8S 19+50E	201	10	165	0.1	--	--	--
8S 20+00E	201	16	205	0.5	--	--	--
8S 20+50E	217	12	44	0.6	--	--	--
8S 21+00E	203	24	1750	2.1	--	--	--

Certified by Hart Bichler



# Chemex Labs Ltd.

Analytical Chemists • Geochemists • Registered Assayers

212 Brooksbank Ave.  
North Vancouver, B.C.  
Canada V7J 2C1

Phone: (604) 984-0221  
Telex: 043-52597

## CERTIFICATE OF ANALYSIS

TO : GOLDSMITH, MR. L. B.

#301-1855 BALSAM STREET  
VANCOUVER, B.C.  
V6K 3M3

CERT. # : A8617870-001-A  
INVOICE # : I8617870  
DATE : 16-SEP-86  
P.C. # : NONE

Sample description	Prep code	Pb ppm	Zn ppm	Ag ppm Aqua R			
L03S 08+00E	201	14	275	2.0	--	--	--
L03S 08+50E	201	14	340	1.7	--	--	--
L03S 09+00E	201	14	400	0.8	--	--	--
L03S 09+50E	201	14	200	0.5	--	--	--
L03S 10+00E	201	13	166	0.4	--	--	--
L03S 10+50E	201	15	200	0.5	--	--	--
L03S 11+00E	201	10	240	1.2	--	--	--
L03S 11+50E	201	22	1050	0.7	--	--	--
L03S 12+00E	201	13	175	0.7	--	--	--
L03S 12+50E	201	24	620	0.7	--	--	--
L03S 13+00E	201	16	265	0.9	--	--	--
L03S 13+50E	201	12	240	0.8	--	--	--
L03S 14+00E	201	17	220	0.7	--	--	--
L03S 14+50E	201	9	165	0.2	--	--	--
L03S 15+00E	201	12	96	0.7	--	--	--
L03S 15+50E	201	13	170	0.8	--	--	--
L03S 16+00E	201	11	200	0.4	--	--	--
L03S 16+50E	201	12	205	1.0	--	--	--
L03S 17+00E	201	20	155	0.3	--	--	--
L03S 17+50E	201	9	195	0.5	--	--	--
L03S 18+00E	201	11	164	0.5	--	--	--
L03S 18+50E	201	12	175	0.5	--	--	--
L03S 19+00E	201	10	194	0.4	--	--	--
L03S 19+50E	201	7	135	0.5	--	--	--
L03S 20+00E	201	15	250	0.2	--	--	--
L03S 20+50E	201	16	118	0.4	--	--	--
L03S 21+00E	201	34	189	0.9	--	--	--
L03S 21+50E	201	45	178	0.7	--	--	--
L03S 22+00E	201	50	165	0.4	--	--	--
L04S 08+00E	201	10	290	2.3	--	--	--
L04S 08+50E	201	10	388	4.3	--	--	--
L04S 09+00E	201	9	346	1.0	--	--	--
L04S 09+50E	201	13	248	1.1	--	--	--
L04S 10+00E	201	12	404	2.1	--	--	--
L04S 10+50E	201	11	400	2.4	--	--	--
L04S 11+00E	201	6	103	0.5	--	--	--
L04S 11+50E	201	12	1000	1.3	--	--	--
L04S 12+00E	201	14	415	0.8	--	--	--
L04S 12+50E	201	10	130	0.5	--	--	--
L04S 13+00E	201	18	240	0.7	--	--	--

VOI rev. 4/85

Certified by *Hart Bichler*



# Chemex Labs Ltd.

212 Brooksbank Ave.  
North Vancouver, B.C.  
Canada V7J 2C1  
Phone: (604) 984-0221  
Telex: 043-52597

Analytical Chemists • Geochemists • Registered Assayers

## CERTIFICATE OF ANALYSIS

TO : GOLDSMITH, MR. L. B.

#301-1855 BALSAM STREET  
VANCOUVER, B.C.  
V6K 3M3

CERT. # : A8617870-002-A  
INVOICE # : I8617870  
DATE : 16-SEP-86  
P.O. # : NONE

Sample description	Prep code	Pb ppm	Zn ppm	Ag ppm Aqua R			
L04S 13+50E	201	13	176	0.8	--	--	--
L04S 14+00E	201	9	187	0.7	--	--	--
L04S 14+50E	201	11	205	1.1	--	--	--
L04S 15+00E	201	18	135	0.8	--	--	--
L04S 15+50E	201	11	132	0.9	--	--	--
L04S 16+00E	201	9	143	1.3	--	--	--
L04S 16+50E	201	7	138	0.7	--	--	--
L04S 17+00E	201	9	166	0.3	--	--	--
L04S 17+50E	201	14	196	1.1	--	--	--
L04S 18+00E	201	5	105	0.4	--	--	--
L04S 18+50E	201	11	200	1.0	--	--	--
L04S 19+00E	201	10	210	0.2	--	--	--
L04S 19+50E	201	12	168	0.9	--	--	--
L04S 20+00E	201	24	215	1.0	--	--	--
L04S 20+50E	201	31	164	1.0	--	--	--
L04S 21+00E	201	34	150	0.8	--	--	--
L06S 08+00E	201	13	205	1.1	--	--	--
L06S 08+50E	201	12	265	1.1	--	--	--
L06S 09+00E	201	6	143	0.3	--	--	--
L06S 09+50E	201	15	315	2.6	--	--	--
L06S 10+00E	201	14	375	1.2	--	--	--
L06S 10+50E	201	12	237	1.5	--	--	--
L06S 11+00E	201	6	96	0.3	--	--	--
L06S 11+50E	201	7	128	2.0	--	--	--
L06S 12+00E	201	10	185	0.9	--	--	--
L06S 12+50E	201	12	133	1.1	--	--	--
L06S 13+00E	201	14	170	0.6	--	--	--
L06S 13+50E	201	13	156	0.6	--	--	--
L06S 14+00E	201	11	130	1.5	--	--	--
L06S 14+50E	201	14	120	0.6	--	--	--
L06S 15+00E	201	14	224	0.5	--	--	--
L06S 15+50E	201	17	148	1.0	--	--	--
L06S 16+00E	201	4	142	0.5	--	--	--
L06S 16+50E	201	8	140	0.3	--	--	--
L06S 17+00E	201	10	192	0.6	--	--	--
L06S 17+50E	201	11	249	0.6	--	--	--
L06S 18+00E	201	14	149	0.7	--	--	--
L06S 18+50E	201	5	103	0.2	--	--	--
L06S 19+00E	201	9	142	0.4	--	--	--
L06S 19+50E	201	16	138	0.2	--	--	--

VOI rev. 4/85

Certified by *Hart Bichler*





# Chemex Labs Ltd.

212 Brooksbank Ave.  
North Vancouver, B.C.  
Canada V7J 2C1

Analytical Chemists • Geochemists • Registered Assayers

Phone: (604) 984-0221  
Telex: 043-52597

## CERTIFICATE OF ANALYSIS

TO : GOLDSMITH, MR. L. B.

#301-1855 BALSAM STREET  
VANCOUVER, B.C.  
V6K 3M3

CERT. # : A8617870-003-A  
INVOICE # : I8617870  
DATE : 16-SEP-86  
P.O. # : NONE

Sample description	Prep code	Pb ppm	Zn ppm	Ag ppm Aqua R			
L06S 20+00E	201	17	145	0.5	--	--	--
BL 10S	201	14	380	1.2	--	--	--
L10S 00+50E	201	19	250	0.4	--	--	--
L10S 01+00E	201	15	335	0.4	--	--	--
L10S 01+50E	201	16	720	0.8	--	--	--
L10S 02+00E	201	13	332	2.9	--	--	--
L10S 02+50E	201	22	180	0.5	--	--	--
L10S 03+00E	201	16	355	0.9	--	--	--
L10S 03+50E	201	16	460	2.0	--	--	--
L10S 04+00E	201	16	430	1.2	--	--	--
L10S 04+50E	201	21	600	1.4	--	--	--
L10S 05+00E	201	12	340	0.8	--	--	--
L10S 05+50E	201	61	250	1.0	--	--	--
L10S 06+00E	201	17	355	0.9	--	--	--
L10S 06+50E	201	15	200	0.9	--	--	--
L10S 07+00E	201	12	230	0.5	--	--	--
BL 11S	201	13	195	1.7	--	--	--
L11S 00+50E	201	18	356	0.6	--	--	--
L11S 01+00E	201	22	390	1.0	--	--	--
L11S 01+50E	201	9	610	3.5	--	--	--
L11S 02+00E	201	31	450	3.1	--	--	--
L11S 02+50E	201	15	360	1.1	--	--	--
L11S 03+00E	201	15	650	1.0	--	--	--
L11S 03+50E	201	18	330	0.9	--	--	--
L11S 04+00E	201	16	356	1.0	--	--	--
L11S 04+50E	201	46	265	0.7	--	--	--
L11S 05+00E	201	70	430	1.1	--	--	--
L11S 05+50E	201	15	210	0.4	--	--	--
L11S 06+00E	201	12	325	0.2	--	--	--
L11S 06+50E	201	66	250	0.1	--	--	--
L11S 07+00E	201	12	160	0.4	--	--	--
L11S 07+50E	201	8	235	0.2	--	--	--
L11S 08+00E	201	9	200	0.2	--	--	--
L11S 08+50E	201	11	412	1.2	--	--	--
L11S 09+00E	201	16	195	0.5	--	--	--
BL 12S	201	17	274	0.5	--	--	--
L12S 00+50E	201	13	250	0.9	--	--	--
L12S 01+00E	201	15	290	0.8	--	--	--
L12S 01+50E	201	19	400	2.7	--	--	--
L12S 02+00E	201	10	780	1.4	--	--	--

VOI rev. 4/85

Certified by Hart Bichler



# Chemex Labs Ltd.

212 Brooksbank Ave.  
North Vancouver, B.C.  
Canada V7J 2C1

Analytical Chemists • Geochemists • Registered Assayers

Phone: (604) 984-0221  
Telex: 043-52597

## CERTIFICATE OF ANALYSIS

TO : GOLDSMITH, MR. L. B.

#301-1855 BALSAM STREET  
VANCOUVER, B.C.  
V6K 3M3

CERT. # : A8617870-004-A  
INVOICE # : I8617870  
DATE : 16-SEP-86  
P.O. # : NONE

Sample description	Prep code	Pb ppm	Zn ppm	Ag ppm Aqua R			
L12S 02+50E	201	14	380	0.9	--	--	--
L12S 03+00E	201	15	306	0.6	--	--	--
L12S 03+50E	201	23	610	1.2	--	--	--
L12S 04+00E	201	30	230	2.2	--	--	--
L12S 04+50E	201	26	1180	1.0	--	--	--
L12S 05+00E	201	22	600	0.5	--	--	--
L12S 05+50E	201	23	210	0.6	--	--	--
L12S 06+00E	201	17	420	3.4	--	--	--
BL 13S	201	13	173	1.0	--	--	--
L13S 00+50E	201	31	312	0.3	--	--	--
L13S 01+00E	201	19	416	0.6	--	--	--
L13S 01+50E	201	14	170	0.8	--	--	--
L13S 02+00E	201	22	410	0.6	--	--	--
L13S 02+50E	201	15	750	0.8	--	--	--
L13S 03+00E	201	13	227	0.7	--	--	--
L13S 03+50E	201	16	248	1.4	--	--	--
L13S 04+00E	201	14	236	1.4	--	--	--
L13S 04+50E	201	14	1150	1.1	--	--	--
BL 14S	201	19	190	0.5	--	--	--
L14S 00+50E	201	16	280	0.5	--	--	--
L14S 01+00E	201	12	205	0.5	--	--	--
L14S 01+50E	201	13	405	0.6	--	--	--
L14S 02+00E	201	11	176	0.6	--	--	--
L14S 02+50E	201	14	260	0.3	--	--	--
L14S 03+00E	201	35	210	0.8	--	--	--
BL 15S	201	35	255	1.0	--	--	--
L15S 00+50E	201	28	215	0.6	--	--	--
L15S 01+00E	201	15	294	0.5	--	--	--
L15S 01+50E	201	15	268	0.4	--	--	--
L17S 00+50E	201	10	600	3.6	--	--	--
L17S 01+00E	201	14	410	3.3	--	--	--
L17S 01+50E	201	16	285	0.7	--	--	--
L17S 02+00E	201	20	730	1.8	--	--	--
L17S 02+50E	201	40	680	1.3	--	--	--
L17S 02+55E	201	88	670	2.1	--	--	--
L17S 03+00E	201	25	1150	1.9	--	--	--
L17S 03+50E	201	13	930	0.6	--	--	--
L17S 04+00E	201	10	1200	1.3	--	--	--
L17S 04+50E	201	11	1100	0.9	--	--	--
L17S 05+00E	201	19	900	0.5	--	--	--

VOI rev. 4/85

Certified by *Hart Buchler*



# Chemex Labs Ltd.

Analytical Chemists • Geochemists • Registered Assayers

212 Brooksbank Ave.  
North Vancouver, B.C.  
Canada V7J 2C1  
Phone: (604) 984-0221  
Telex: 043-52597

## CERTIFICATE OF ANALYSIS

TO : GOLDSMITH, MR. L. B.

#301-1855 BALSAM STREET  
VANCOUVER, B.C.  
V6K 3M3

CERT. # : A8617870-005-A  
INVOICE # : 18617870  
DATE : 16-SEP-86  
P.O. # : NONE

Sample description	Prep code	Pb ppm	Zn ppm	Ag ppm Aqua R			
L17+50S 05+00E	201	27	1000	0.5	--	--	--
L18S 00+50E	201	19	260	0.8	--	--	--
L18S 01+00E	201	26	450	2.5	--	--	--
L18S 01+50E	201	12	250	0.2	--	--	--
L18S 02+00E	201	12	235	0.5	--	--	--
L18S 02+50E	201	34	290	0.9	--	--	--
L18S 03+00E	201	8	295	1.4	--	--	--
L18S 03+50E	201	12	345	0.8	--	--	--
L18S 04+00E	201	16	680	0.7	--	--	--
L18S 04+50E	201	13	820	0.7	--	--	--
L18S 05+00E	201	15	1150	1.2	--	--	--

Certified by *H. B. Bichler*...



# Chemex Labs Ltd.

Analytical Chemists • Geochemists • Registered Assayers

212 Brooksbank Ave.  
North Vancouver, B.C.  
Canada V7J 2C1

Phone: (604) 984-0221  
Telex: 043-52597

## CERTIFICATE OF ANALYSIS

TO : GOLDSMITH, MR. L. B.  
  
301 - 1855 BALSAM ST.  
VANCOUVER, B.C.  
V6K 3M3

CERT. # : A8617779-001-A  
INVOICE # : I8617779  
DATE : 18-SEP-86  
P.O. # : NONE

Sample description	Prep code	Pb ppm	Zn ppm	Ag ppm Aqua R			
L2S 0+50E	201	36	35	0.1	--	--	--
L2S 1+00E	201	24	265	1.2	--	--	--
L2S 1+50E	201	27	170	0.5	--	--	--
L2S 2+00E	201	24	204	0.8	--	--	--
L2S 2+50E	201	24	208	0.3	--	--	--
L2S 3+00E	201	10	155	0.5	--	--	--
L2S 3+50E	201	23	458	0.4	--	--	--
L2S 4+00E	201	29	3250	0.4	--	--	--
L2S 4+50E	217	5	425	0.5	--	--	--
L2S 5+00E	201	18	1200	1.4	--	--	--
L2S 5+50E	201	17	650	1.9	--	--	--
L2S 6+00E	201	16	460	0.7	--	--	--
L2S 6+50E	201	12	146	0.6	--	--	--
L2S 7+00E	201	20	260	1.1	--	--	--
L2S 7+50E	201	15	315	0.9	--	--	--
L2S 8+00E	201	14	215	0.9	--	--	--
L2S 8+50E	201	19	286	0.8	--	--	--
L2S 9+00E	201	19	253	0.5	--	--	--
L2S 9+50E	201	13	223	0.6	--	--	--
L2S 10+00E	201	16	421	0.8	--	--	--
L2S 10+50E	201	33	1250	5.6	--	--	--
L2S 11+00E	201	18	650	0.8	--	--	--
L2S 11+50E	201	15	300	0.9	--	--	--
L2S 12+00E	201	16	780	1.1	--	--	--
L2S 12+50E	201	20	1050	1.2	--	--	--
L2S 13+00E	201	30	306	0.8	--	--	--
L2S 13+50E	201	18	314	1.4	--	--	--
L2S 14+00E	201	20	410	1.2	--	--	--
L2S 14+50E	201	20	420	1.0	--	--	--
L2S 15+00E	201	12	150	0.3	--	--	--
L2S 15+50E	201	14	165	0.4	--	--	--
L2S 16+00E	201	12	173	1.1	--	--	--
L2S 16+50E	201	14	210	1.3	--	--	--
L2S 17+00E	201	16	141	0.3	--	--	--
L2S 17+50E	201	14	170	0.2	--	--	--
L2S 18+00E	201	15	275	0.3	--	--	--
L2S 18+50E	201	14	275	0.4	--	--	--
L2S 19+00E	201	12	138	0.8	--	--	--
L2S 19+50E	201	18	167	0.1	--	--	--
L2S 20+00E	201	10	212	0.2	--	--	--

VOI rev. 4/85

Certified by Hart Bichler



# Chemex Labs Ltd.

212 Brooksbank Ave.  
North Vancouver, B.C.  
Canada V7J 2C1

Analytical Chemists • Geochemists • Registered Assayers

Phone: (604) 984-0221  
Telex: 043-52597

## CERTIFICATE OF ANALYSIS

TO : GOLDSMITH, MR. L. B.  
301 - 1855 BALSAM ST.  
VANCOUVER, B.C.  
V6K 3M3

CERT. # : A8617779-002-A  
INVOICE # : 18617779  
DATE : 18-SEP-86  
P.O. # : NONE

Sample description	Prep code	Pb ppm	Zn ppm	Ag ppm Aqua R			
BL 3S	201	60	325	1.0	--	--	--
L3S 0+50E	201	32	115	0.5	--	--	--
L3S 1+50E	203	56	224	0.9	--	--	--
L3S 2+00E	201	50	160	0.2	--	--	--
L3S 2+50E	201	32	177	0.5	--	--	--
L3S 3+00E	201	48	230	0.3	--	--	--
L3S 3+50E	201	28	424	0.2	--	--	--
L3S 4+00E	201	22	340	3.4	--	--	--
L3S 4+50E	217	10	202	1.4	--	--	--
L3S 5+00E	201	10	314	1.3	--	--	--
L3S 5+50E	201	32	475	0.8	--	--	--
L3S 6+00E	201	22	600	3.4	--	--	--
L3S 6+50E	201	14	290	1.3	--	--	--
L3S 7+00E	201	18	79	0.6	--	--	--
L3S 7+50E	201	10	139	0.6	--	--	--
BL 4S	201	28	160	0.3	--	--	--
L5S 1+50E	201	17	150	0.5	--	--	--
L5S 2+00E	201	14	212	0.4	--	--	--
L5S 2+50E	201	15	159	0.7	--	--	--
L5S 3+00E	201	17	156	0.9	--	--	--
L5S 3+50E	201	26	186	0.3	--	--	--
L5S 4+00E	201	29	305	0.2	--	--	--
L5S 4+50E	201	30	150	0.6	--	--	--
L5S 5+00E	201	24	215	0.6	--	--	--
L5S 5+50E	201	22	250	0.5	--	--	--
L5S 6+00E	201	16	160	0.8	--	--	--
L5S 6+50E	201	52	43	0.5	--	--	--
L5S 7+00E	201	20	77	0.4	--	--	--
L5S 7+50E	201	19	155	3.2	--	--	--
L5S 8+00E	201	16	246	1.5	--	--	--
L5S 8+50E	201	12	275	5.2	--	--	--
L5S 9+00E	201	12	262	4.6	--	--	--
L5S 9+50E	201	12	340	0.8	--	--	--
L5S 10+00E	201	15	350	1.4	--	--	--
L5S 10+50E	201	16	415	1.4	--	--	--
L5S 11+00E	201	15	148	0.6	--	--	--
L5S 11+50E	201	12	140	0.3	--	--	--
L5S 12+00E	201	14	182	0.5	--	--	--
L5S 12+50E	201	9	87	0.1	--	--	--
L5S 13+00E	201	8	99	0.3	--	--	--

VOI rev. 4/85

Certified by *Hart Bichler*



# Chemex Labs Ltd.

212 Brooksbank Ave.  
 North Vancouver, B.C.  
 Canada V7J 2C1  
 Phone: (604) 984-0221  
 Telex: 043-52597

Analytical Chemists • Geochemists • Registered Assayers

CERTIFICATE OF ANALYSIS
-------------------------

TO : GOLDSMITH, MR. L. B.  
 301 - 1855 BALSAM ST.  
 VANCOUVER, B.C.  
 V6K 3M3

CERT. # : A8617779-003-A  
 INVOICE # : I8617779  
 DATE : 18-SEP-86  
 P.O. # : NONE

Sample description	Prep code	Pb ppm	Zn ppm	Ag ppm Aqua R			
L5S 13+50E	201	13	246	0.4	--	--	--
L5S 14+00E	201	9	151	0.4	--	--	--
L5S 14+50E	201	13	185	0.3	--	--	--
L5S 15+00E	201	10	133	0.8	--	--	--
L5S 15+50E	201	10	120	0.3	--	--	--
L5S 16+00E	201	10	202	2.0	--	--	--
L5S 16+50E	201	9	158	0.7	--	--	--
L5S 17+00E	201	32	154	0.3	--	--	--
L5S 17+50E	201	10	185	0.2	--	--	--
L5S 18+00E	201	16	128	0.7	--	--	--
L5S 18+50E	201	10	200	0.4	--	--	--
L5S 19+00E	201	8	198	0.5	--	--	--
L5S 19+50E	201	10	193	0.3	--	--	--
L5S 20+00E	201	11	170	0.2	--	--	--
L5S 20+40E	201	15	193	0.5	--	--	--
8L 6S	201	34	180	1.0	--	--	--
L6S 0+50E	201	36	152	0.4	--	--	--
L6S 1+00E	201	21	232	0.4	--	--	--
L6S 1+50E	201	12	51	0.4	--	--	--
L6S 2+00E	201	12	253	0.5	--	--	--
L6S 2+50E	201	22	226	0.5	--	--	--
L6S 3+00E	201	33	128	0.4	--	--	--
L6S 3+50E	201	12	174	1.1	--	--	--
L6S 4+00E	201	12	170	0.4	--	--	--
L6S 4+50E	201	14	275	0.7	--	--	--
L6S 5+00E	201	22	405	0.6	--	--	--
L6S 5+50E	201	36	373	1.4	--	--	--
L6S 6+00E	201	13	182	1.1	--	--	--
L6S 6+50E	201	12	268	2.0	--	--	--
L6S 7+00E	201	9	100	0.3	--	--	--
L6S 7+50E	201	28	305	0.3	--	--	--
L7S 8+00E	201	9	198	2.0	--	--	--
L7S 8+50E	201	12	352	1.7	--	--	--
L7S 9+00E	201	14	600	2.7	--	--	--
L7S 9+50E	201	11	402	1.8	--	--	--
L7S 10+00E	201	22	610	2.3	--	--	--
L7S 10+50E	201	7	143	1.3	--	--	--
L7S 11+00E	201	10	258	0.3	--	--	--
L7S 11+50E	201	12	222	0.9	--	--	--
L7S 12+00E	201	11	209	0.4	--	--	--

Certified by *Hart Bichler* .....



# Chemex Labs Ltd.

Analytical Chemists • Geochemists • Registered Assayers

212 Brooksbank Ave.  
North Vancouver, B.C.  
Canada V7J 2C1

Phone: (604) 984-0221  
Telex: 043-52597

## CERTIFICATE OF ANALYSIS

TO : GOLDSMITH, MR. L. B.  
301 - 1855 BALSAM ST.  
VANCOUVER, B.C.  
V6K 3M3

CERT. # : A8617779-004-A  
INVOICE # : I8617779  
DATE : 18-SEP-86  
P.O. # : NONE

Sample description	Prep code	Pb ppm	Zn ppm	Ag ppm Aqua R			
L7S 12+50E	201	18	103	0.4	--	--	--
L7S 13+00E	201	12	181	0.9	--	--	--
L7S 13+50E	201	14	153	1.0	--	--	--
L7S 14+00E	201	14	121	0.5	--	--	--
L7S 14+50E	201	10	127	0.4	--	--	--
L7S 15+00E	201	9	221	0.6	--	--	--
L7S 15+50E	201	8	155	0.3	--	--	--
L7S 16+00E	201	4	115	0.4	--	--	--
L7S 16+50E	201	10	185	0.4	--	--	--
L7S 17+00E	201	8	82	0.9	--	--	--
BL 9S	217	9	106	0.3	--	--	--
L9S 0+50E	201	22	174	0.2	--	--	--
L9S 1+00E	201	21	215	1.1	--	--	--
L9S 1+50E	201	18	223	0.7	--	--	--
L9S 2+00E	201	18	238	1.1	--	--	--
L9S 2+50E	201	15	160	0.3	--	--	--
L9S 3+00E	201	52	228	0.6	--	--	--
L9S 3+50E	201	21	320	0.8	--	--	--
L9S 4+00E	201	14	260	0.8	--	--	--
L9S 4+50E	201	15	374	1.2	--	--	--
L9S 5+00E	201	14	300	0.7	--	--	--
L9S 5+50E	203	31	163	0.3	--	--	--
L9S 6+00E	201	33	133	0.1	--	--	--
L9S 6+50E	201	16	260	0.4	--	--	--
L9S 7+00E	201	23	250	0.2	--	--	--
L9S 7+50E	201	10	126	0.2	--	--	--
L9S 8+00E	201	12	335	0.8	--	--	--
L9S 8+50E	201	13	233	0.5	--	--	--
L9S 9+00E	201	10	255	0.4	--	--	--
L9S 9+50E	201	13	490	0.9	--	--	--
L9S 10+00E	201	14	415	0.9	--	--	--
L9S 10+50E	201	12	750	1.0	--	--	--
L9S 11+00E	201	12	1300	0.4	--	--	--
L9S 11+50E	201	14	450	0.4	--	--	--
L9S 12+00E	201	36	285	0.8	--	--	--
L9S 12+50E	201	16	374	0.6	--	--	--
L9S 13+00E	201	12	163	0.6	--	--	--
L9S 13+50E	201	12	92	1.7	--	--	--
L9S 14+00E	201	8	143	0.5	--	--	--
L9S 14+50E	201	8	133	0.7	--	--	--

Certified by Haut Bichler



# Chemex Labs Ltd.

Analytical Chemists • Geochemists • Registered Assayers

212 Brooksbank Ave.  
North Vancouver, B.C.  
Canada V7J 2C1

Phone: (604) 984-0221  
Telex: 043-52597

## CERTIFICATE OF ANALYSIS

TO : GOLDSMITH, MR. L. B.  
  
301 - 1855 BALSAM ST.  
VANCOUVER, B.C.  
V6K 3M3

CERT. # : A8617779-005-A  
INVOICE # : 18617779  
DATE : 18-SEP-86  
P.O. # : NCNE

Sample description	Prep code	Pb ppm	Zn ppm	Ag ppm Aqua R			
L9S 15+00E	201	9	155	0.5	--	--	--
L9S 15+50E	201	14	124	0.3	--	--	--
L9S 16+00E	201	19	200	0.5	--	--	--
L9S 16+50E	201	10	135	0.5	--	--	--
L9S 17+00E	201	43	148	0.1	--	--	--
L9S 17+50E	201	17	218	0.3	--	--	--
L9S 18+00E	201	22	165	0.8	--	--	--
L9S 18+50E	201	9	170	0.3	--	--	--
L9S 19+00E	201	9	158	0.2	--	--	--
L9S 19+50E	201	10	310	0.6	--	--	--
L10S 7+50E	201	18	283	1.2	--	--	--
L10S 8+00E	201	16	170	0.5	--	--	--
L10S 8+50E	201	12	195	0.2	--	--	--
L10S 9+00E	201	34	430	0.5	--	--	--
L10S 9+50E	201	16	1350	0.7	--	--	--
L10S 10+00E	203	16	900	1.0	--	--	--
L10S 10+50E	203	42	1350	6.0	--	--	--
L10S 11+00E	201	21	1550	1.6	--	--	--
L10S 11+50E	201	14	380	0.3	--	--	--
L10S 12+00E	201	10	133	0.2	--	--	--
L10S 12+50E	201	16	350	0.2	--	--	--
L10S 13+00E	201	22	172	0.3	--	--	--
L10S 13+50E	201	11	143	0.6	--	--	--
L10S 14+00E	201	10	85	0.9	--	--	--
L10S 14+50E	201	11	148	0.8	--	--	--
L10S 15+00E	201	10	79	0.5	--	--	--
L10S 15+50E	201	20	149	0.2	--	--	--
L10S 16+00E	201	20	179	0.1	--	--	--
L10S 16+50E	201	30	150	0.7	--	--	--

Certified by *Hart Bichler*



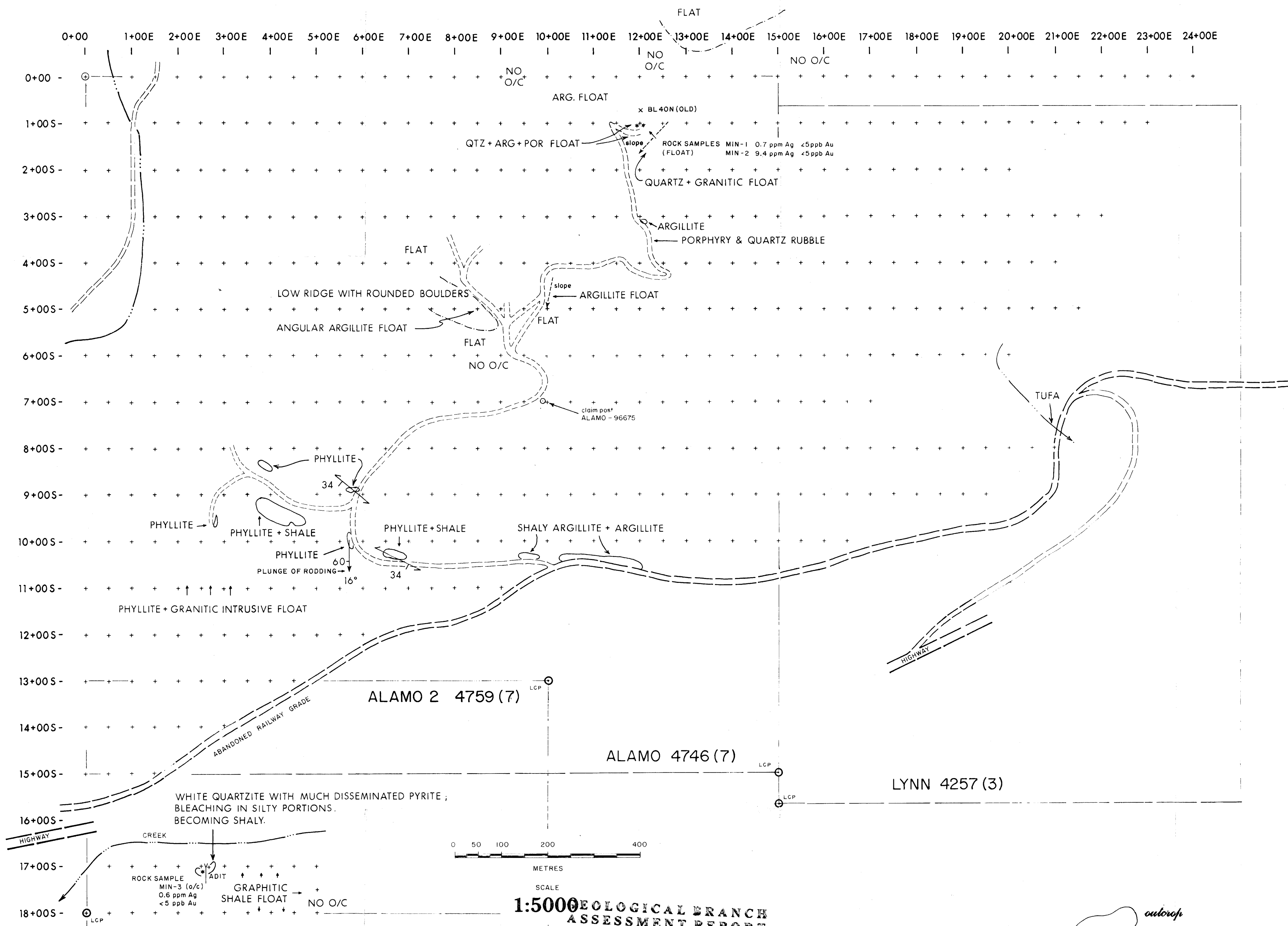

1:5000 GEOLOGICAL BRANCH ASSESSMENT REPORT

15,525

MINOTAUR EXPLORATIONS LTD.

Alamo Claim Group

Alamo 4746(7) Alamo 2 4759(7) Alamo 3 4786(9) Lynn 4257(3)

Three Forks, B.C. Stocan Mining Division

82K03W

Preliminary GEOLOGY



Arctex Engineering Services September 1986

LOCKE B. GOLDSMITH, P.Eng. CONSULTING GEOLOGIST

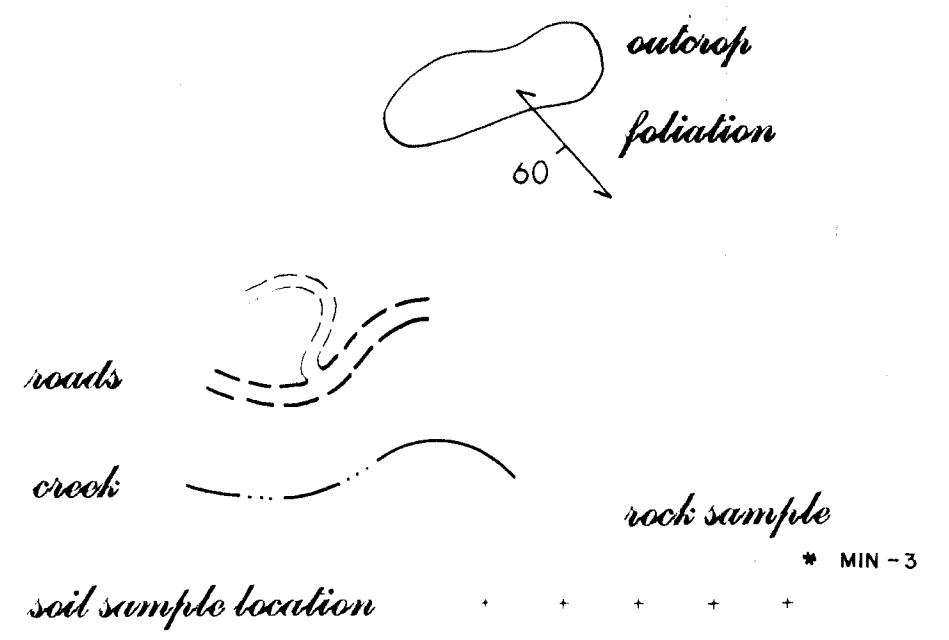

TRIASSIC - JURASSIC  
GRANITIC INTRUSIVES  
Stocan Group  
ARGILLITE, PHYLLITE, SHALE & QUARTZITE

North

ALAMO 3 4786 (9)

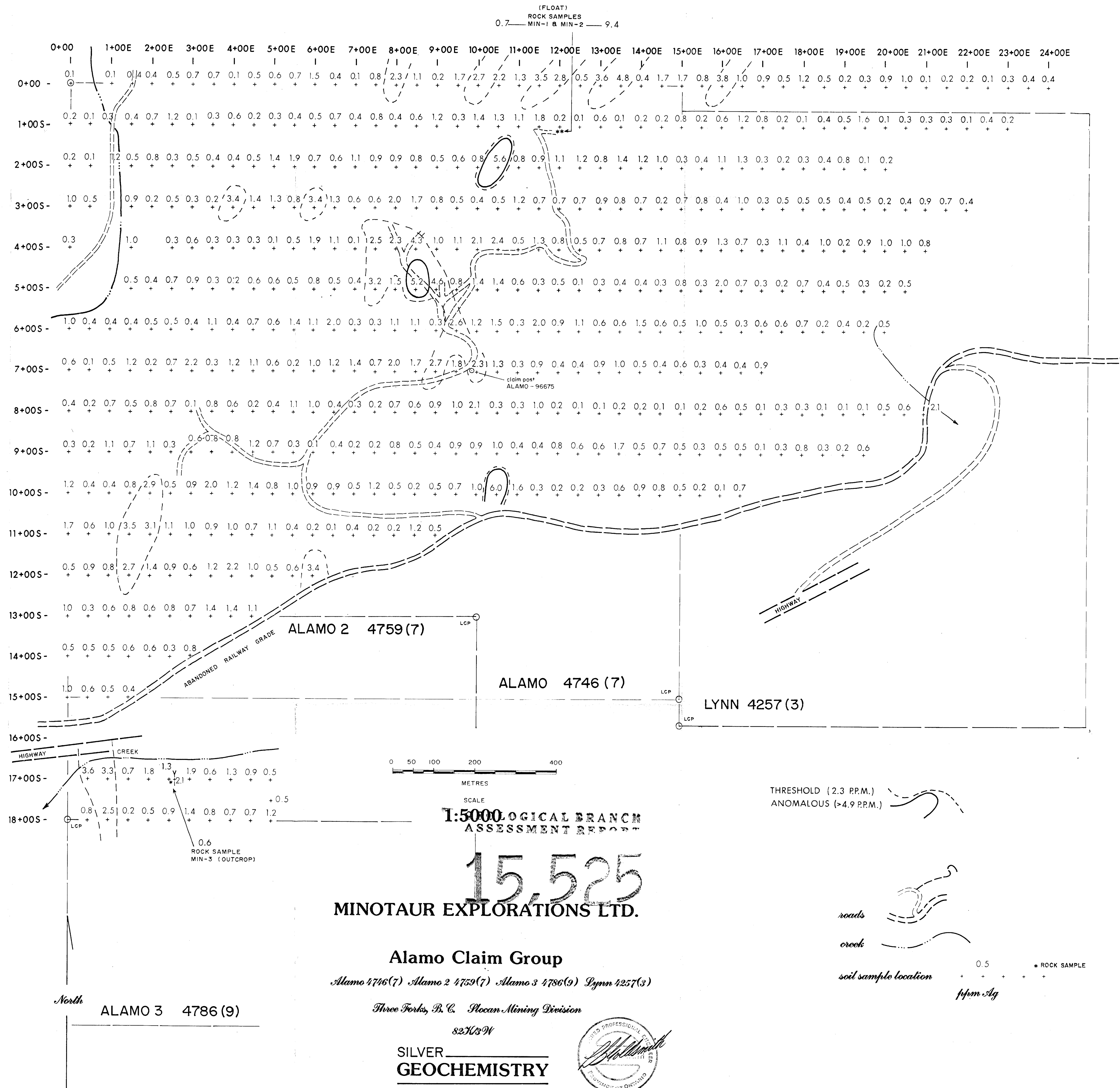

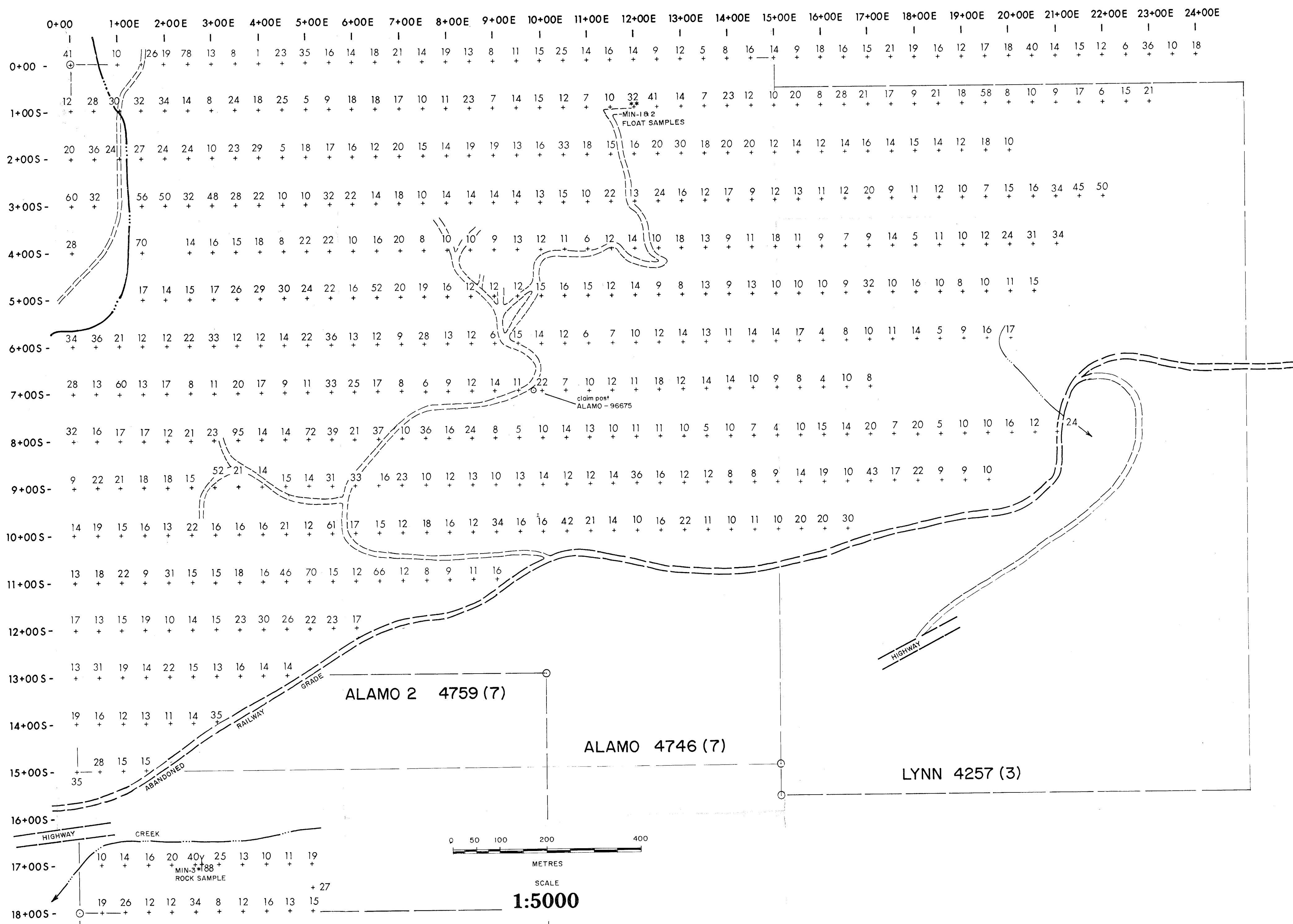

North  
ALAMO 3 4786 (9)

**MINOTAUR EXPLORATIONS LTD.**

**Alamo Claim Group**

*Alamo 4746(7) Alamo 2 4759(7) Alamo 3 4786(9) Lynn 4257(3)*

*Three Forks, B. C. Placer Mining Division*

*82N3W*

**LEAD  
GEOCHEMISTRY**



*Arctex Engineering Services September 1986*

LOCKE B. GOLDSMITH, P. Eng. CONSULTING GEOLOGIST  
GEOLOGICAL SEARCH  
ASSESSMENT REPORT

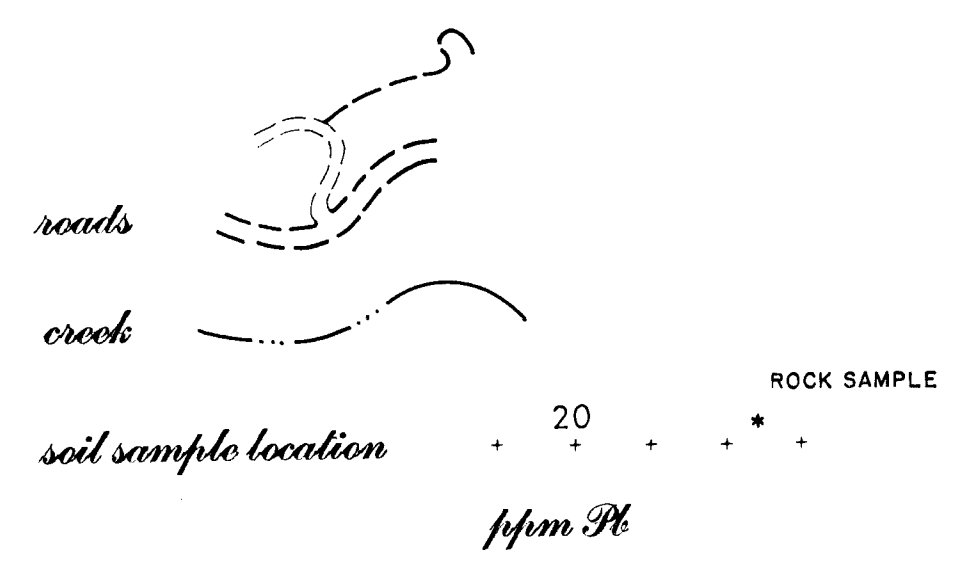

15,525

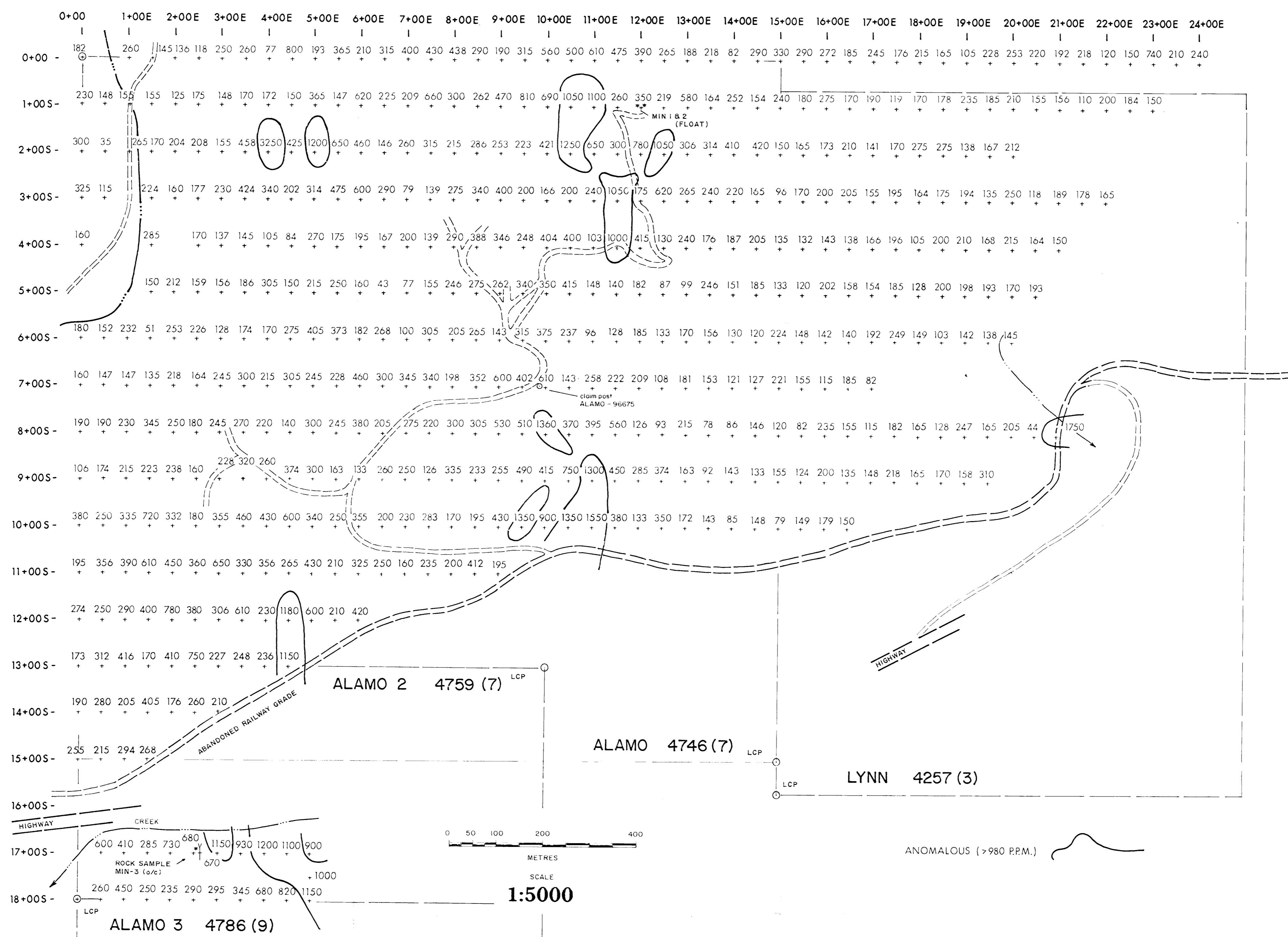

**MINOTAUR EXPLORATIONS LTD.**

**Alamo Claim Group**

*Alamo 4746(7) Alamo 2 4759(7) Alamo 3 4786(9) Lynn 4257(3)*

*Three Forks, B.C. Stocan Mining Division*

*S2T3S1W*

**ZINC  
GEOCHEMISTRY**



*Arctex Engineering Services*      *September 1986*  
 LOCKE B. GOLDSMITH, P. Eng.      CONSULTING GEOLOGIST

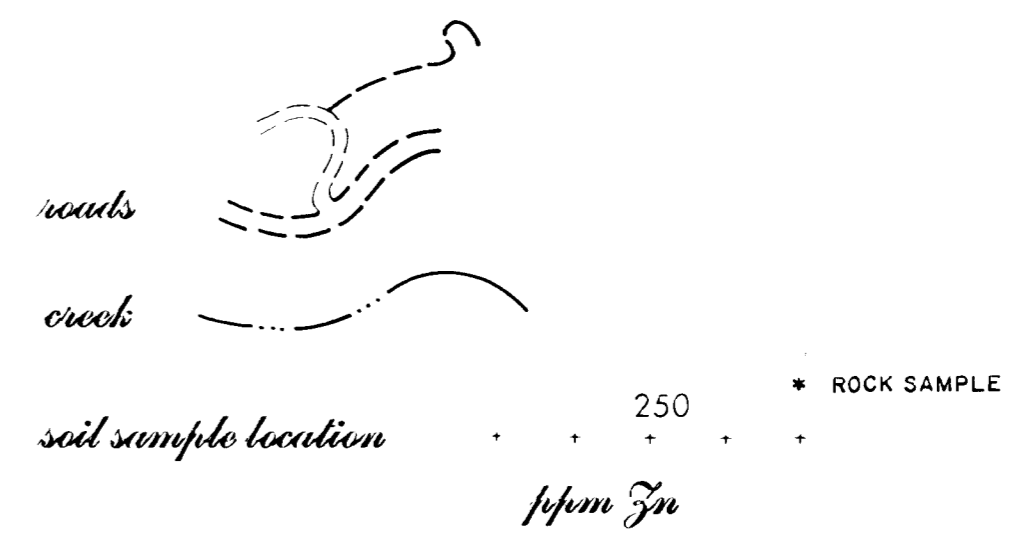

MINERAL BRANCH  
 ASSESSMENT REPORT

15,525