

Northair Mines Ltd.,  
860 625 Howe Street,  
Vancouver, B.C.  
V6C 2T6

February 20, 1987

Mr. John B. Gammon,  
Manager, Exploration British Columbia,  
Ministry of Energy Mines and Resources,  
Parliament Buildings,  
Victoria, B.C.  
V8V 1X7

FILMED

Dear Mr. Gammon,

Re: Exploration Grant # 10962E-38 Willa Project

Enclosed please find a completed Form 3 "Application for Payment" under the Financial Assistance for Mineral Exploration program together with an interim technical report on results of the exploration program between November 1986 and February 1987 at Willa Project, New Denver.

As the drill program is still in progress not all geological, assay, survey or cost data are available at present. In the meantime, I trust you will find the results presented satisfactory for the purpose of the application. We will be pleased to answer any queries you may have.

**GEOLOGICAL BRANCH  
ASSESSMENT REPORT**

Yours truly,



Robert J. Beckett, P. Geol.

15,726  
PART 1 OF 2

cc: F.G. Hewett, Northair, Vancouver  
E. Kraft

RJB:pb

LOG # 0223	ENG-F 4
ACR:	
FILE NO:	

NELSON



Province of British Columbia

Ministry of Energy, Mines and Petroleum Resources

ASSESSMENT REPORT TITLE PAGE AND SUMMARY

TYPE OF REPORT/SURVEY(S)	TOTAL COST
Drilling, geochemical, physical	\$ 399 197.00

AUTHOR(S) R. J. Beckett SIGNATURE(S)

DATE STATEMENT OF EXPLORATION AND DEVELOPMENT FILED 23 Feb, 1987 YEAR OF WORK 1986

PROPERTY NAME(S) Willa

COMMODITIES PRESENT Au, Ag, Cu, Pb, Zn

B.C. MINERAL INVENTORY NUMBER(S), IF KNOWN 82F NW - 70, 71, 73

MINING DIVISION Sloean NTS 82F/14W

LATITUDE 49° 53' LONGITUDE 117° 21'

NAMES and NUMBERS of all mineral tenures in good standing (when work was done) that form the property [Examples: TAX 1-4, FIRE 2 (12 units); PHOENIX (Lot 1706); Mineral Lease M 123; Mining or Certified Mining Lease ML 12 (claims involved)]:

Rockland (L 3883), Little Daisy (L 7302), Silver Band (L 5878), Willa (L 1529)

OWNER(S) (1) (2)

MAILING ADDRESS

OPERATOR(S) (that is, Company paying for the work)

(1) Northair Mines Ltd (2) B.P. Minerals Ltd

MAILING ADDRESS

Rio Algom Exploration Inc.

Owners/operators

SUMMARY GEOLOGY (lithology, age, structure, alteration, mineralization, size, and attitude):

A pendant of mafic volcanics and felsic intrusive rocks lies within the northern portion of the Nelson Batholith. The Aylwin pendant consists of a volcanic centre of intrusive breccia, ring dykes and radial dyke complexes. Current reserves are: 1) 3.4 million tonnes of 1.34g/t Au, 0.32% Cu, 4.8g/t Ag; 2) 1.8 million tonnes of 2.93g/t Au, 0.66% Cu, 9.3g/t Ag.

REFERENCES TO PREVIOUS WORK

A.R. 13382, 10927, 9796, 8759, 7853, 8859

TYPE OF WORK IN THIS REPORT	EXTENT OF WORK (IN METRIC UNITS)	ON WHICH CLAIMS	COST APPORTIONED
<b>GEOLOGICAL (scale, area)</b>			
Ground			
Photo			
<b>GEOPHYSICAL (line-kilometres)</b>			
Ground			
Magnetic			
Electromagnetic			
Induced Polarization			
Radiometric			
Seismic			
Other			
Airborne			
<b>GEOCHEMICAL (number of samples analysed for ....)</b>			
Soil			
Silt			
Rock			
Other			
<b>DRILLING (total metres; number of holes, size)</b>			
✓ Core	DIAD 2317.0 m, 51 holes,		
Non-core			
<b>RELATED TECHNICAL</b>			
✓ Sampling/assaying	1070, Lu, Au		
Petrographic			
Mineralogic			
Metallurgic			
<b>PROSPECTING (scale, area)</b>			
<b>PREPARATORY/PHYSICAL</b>			
Legal surveys (scale, area)			
Topographic (scale, area)			
Photogrammetric (scale, area)			
Line/grid (kilometres)			
Road, local access (kilometres)			
Trench (metres)			
✓ Underground (metres)	UNDV 290.0 m		
			<b>TOTAL COST</b> 399.197.00

FOR MINISTRY USE ONLY	NAME OF PAC ACCOUNT	DEBIT	CREDIT	REMARKS:
Value work done (from report)	399197.00			
Value of work approved				
Value claimed (from statement)				
Value credited to PAC account				
Value debited to PAC account				
Accepted <i>IEV</i> Date	Rept. No. FAME E38-15726			Information Class (2)



Province of  
British Columbia  
Ministry of  
Energy, Mines and  
Petroleum Resources



# EXPLORATION BRITISH COLUMBIA

FINANCIAL ASSISTANCE FOR MINERAL EXPLORATION

Grant  
Identification  
No. 10962E-38

## FORM 3

### APPLICATION FOR PAYMENT

#### INSTRUCTIONS:

- Please type or print
- Please submit completed forms, with a copy of the final technical report, to:  
Manager, EXPLORATION BRITISH COLUMBIA, Mineral Resources Division  
Ministry of Energy, Mines and Petroleum Resources  
Parliament Buildings, Victoria, B.C. V8V 1X4

LOG: 0223  
ACT: NGE-F #  
FILE NO:

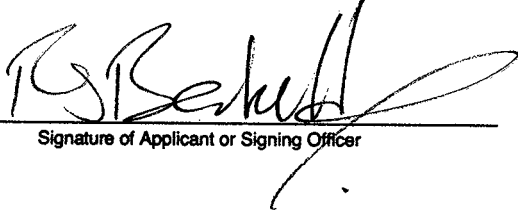
<b>1. Date of this Application</b>		February 20, 1987	
<b>2. Applicant's Identification and Location</b>		Name: Northair Mines Ltd.	
Address — Street Number and Name, Apt. No.		Telephone No.	
860 625 Howe Street,		687-7545	
City, Town, Village	Province	Postal Code	
Vancouver,	British Columbia	V 6 C 2 T 6	
<b>3. Head Office Location</b>		Telephone No.	
Address — Street Number and Name, Apt. No.			
As Above			
City, Town, Village	Province	Postal Code	
<b>4. Mailing Address (if different from above)</b>		Telephone No.	
Address — Street Number and Name, Apt. No.			
As Above			
City, Town, Village	Province	Postal Code	
<b>5. British Columbia Free Miner Certificate No.</b>			
296085			
<b>6. I/We,</b> Robert J. Beckett, hereby apply for payment of a grant under the Exploration British Columbia Financial Assistance for Mineral Exploration Program and declare the information given above to be true and accurate.			
 Signature of Applicant or Signing Officer		Robert J. Beckett Name (please print)	
Consultant, Northair Mines Ltd. Title/Occupation (please print)		Willa Project Name (please print)	
Northair Mines Ltd. Company (please print)		February 20, 1987 Date	

7. EXPENDITURES (N.B. Please provide actual all-inclusive costs, including salaries and wages, equipment and machinery rental, supplies, services, transportation and accommodation directly attributable to the field program.)

(a) For the following, the full cost (100% of expenditures) are eligible:

**Total  
Eligible Expenses**

	\$
<b>Geological Surveys, Map and Report Preparation and Related Costs</b>	
<b>Geophysical Surveys (line-kilometres)</b>	
Ground	
Magnetic .....	\$
Electromagnetic .....	\$
Induced Polarization .....	\$
Radiometric .....	\$
Seismic .....	\$
Other .....	\$
Airborne .....	\$ _____
	\$
<b>Geochemical Surveys (No. of samples analysed for _____)</b>	
Soil .....	\$
Silt .....	\$
Rock .....	\$
Other .....	\$ _____
	\$
<b>Drilling To Hole #87-143</b>	
Surface .....	m @ \$ _____ = \$
Underground 1617 .....	m @ \$58.46 = \$ 94531
	\$
	<b>\$94531</b>
<b>Related Technical Surveys</b>	
Sampling/Assaying .....	\$28058 \$
Petrographic .....	52 \$
Mineralogic .....	\$
Metallurgic .....	4500 \$ _____
	\$ 32610
	<b>\$32610</b>
<b>Preparatory/Physical</b>	
Line/Grid (kilometres) .....	\$
Trenching (metres) .....	\$ _____
	\$
	<b>\$</b>
<b>Other Exploration Costs (attach detailed schedules)</b>	
As per attached .....	\$
cost sheet .....	\$
	\$ 165096
	\$
	<b>\$165096</b>
<b>Total Eligible Expenses</b>	<b>\$292237</b>

(b) For the following activities only 25% of total costs are eligible:

<b>Tunneling, Drifting, Other Lateral Excavation, Shaft Sinking</b> (25% of total expenses are eligible)	
290 .....	m @ \$1475.30/m = \$ × 25% = \$ 106960
.....	m @ \$ ..... = \$ × 25% = \$ _____
	\$ 106960
	<b>\$ 106960</b>

(c) TOTAL ELIGIBLE EXPENDITURES: \$ ..... \$ 399197

8. **SUPPLEMENTARY INFORMATION:** The following information is required in order to help us determine the contribution which mineral exploration activity makes to the economy, and relates to the utilization of B.C. vs. outside labour and services. Only figures directly attributable to the funded program should be included (approximate figures acceptable, but please be as accurate as possible).

(a) **Employment, wages and salaries**

Type	No. Employed		No. Person-days		Salaries/Wages Paid	
	B.C.	Outside	B.C.	Outside	B.C.	Outside
Prospectors					\$	\$
Linecutters						
Technicians	3		163		21515.	
General Labourers	2		102		11387.	
Drillers/Helpers						
Equipment Operators Scoop Trams	2		99		20955.	
Geologists Consultant	1		105		21400.	
Geophysicists						
Geochemists						
Engineers Consultant	1		110		1887.	
Supervisory Manager	1		115		21101.	
Consulting						
Secretarial						
Managerial						
Legal						
Accounting						
Others (specify) Miners	4		189		58029.	
Others (specify) Mechanics	2		135		22120.	
<b>TOTALS</b>			1018		\$178394	\$

**(b) Goods and Services**

Description	Expenditure	
	B.C.	Outside
Meals, Groceries, etc.	\$ 8132.	\$
Camping Supplies, Equipment, etc.		
Accommodation	6090.	
Transportations — Scheduled Air	10835.	
— Air Charter		
— Vehicle Rentals	1000.	
— Vehicle O and M Costs	2673.	
— Other (specify)      Freight, to Jan.31/87	6590.	
Equipment Rentals —      Tunneling	164602.	
Equipment Rentals — Trenching, etc.		
— Geophysical, etc.		
— Other (specify)      Diamond Drilling Support	49625.	
Contract Drilling		
Consultant Services      Engineering & Geologists	49279.	
Assays and Analyses      Metalurgical Petrographical	32552.	
Communications      Telephone/Courier	3523.	
Other (specify)      Fuel/Hydro	35007.	

**9. IMPACT OF FAME GRANT**

(a) Please indicate what level of expansion of your project was attributable to receiving a FAME grant.

\$ 100,00 \_\_\_\_\_

\_\_\_\_\_ 135 \_\_\_\_\_ person/days employment.

(b) Please indicate what you feel to be the main achievement of this FAME funded program.

The FAME GRANT provided the final impetus to the decision to proceed with \_\_\_\_\_  
further exploration at Willa Project.  
\_\_\_\_\_  
\_\_\_\_\_  
\_\_\_\_\_  
\_\_\_\_\_  
\_\_\_\_\_

EXPLORATION WINTER 1986-1987

WILLA PROJECT

NEW DENVER, BRITISH COLUMBIA

NTS 82F/14

REPORT PREPARED FOR  
NORTHAIR MINES LTD.

R.J. BECKETT  
BECKETT GEOLOGICAL  
SERVICES  
FEBRUARY 1987



## CONTENTS

### SUMMARY

#### INTRODUCTION

Location & Access  
Property

#### PREVIOUS EXPLORATION

1986-1987 PROGRAM

#### GEOLOGY

Regional Geology  
Property Geology and Mineralization

#### COSTS

#### STATEMENT OF QUALIFICATIONS

### APPENDICES

- I Sampling and Analytical Procedure
- II Assay Analytical Reports
- III Drill Logs

### DRAWINGS

7WI	1025 Level Drill Hole Plan	1:500
7WII	1025 Level Assay Plan Muck Samples	1:250
7WIII	1025 Level Assay Plan Chip Samples	1:250

### TABLES

- I Willa Project Property
- II Estimated Costs

## SUMMARY

This report summarizes exploration performed by Northair Mines Ltd. at the Willa Project between November 15, 1986 and February 20, 1987 and accompanies an application under the Financial Assistance to Mineral Exploration Program.

Willa Project is a joint venture between Northair Mines Ltd. as operator, BP Minerals Limited and Rio Algom Exploration Inc..

The project property is located twelve kilometres south of New Denver, British Columbia. The property covers about 2925 hectares.

Previous exploration has identified two bodies of gold, copper mineralization. This report covers exploration to test the deeper, higher grade West Zone. Previous exploration includes geochemical surveying, 14,301 metres of diamond drilling in 46 holes and geological evaluation.

Present exploration includes 290 metres of drifting, 2317 metres of drilling in 51 holes, sampling and geological evaluation. Drilling in the present program is expected to be completed by February 28, 1987. (*taugh ground?*)

Costs of present program to February 20, 1987 are \$720,000.

## INTRODUCTION

This report is prepared as part of the requirement for the Financial Assistance for Mineral Exploration application made on behalf of Northair Mines Ltd..

This report describes exploration performed by Northair Mines Ltd. at the Willa Property, Silverton, British Columbia between November 15, 1986 and February 20, 1987.

This exploration included drifting, diamond drilling and sampling to test gold mineralized areas within the West Zone and diamond drilling and sampling to test gold mineralized intersection in hole 86-78 within the East Zone.

The property is held as a joint venture between Northair Mines Ltd., BP Minerals Limited and Rio Algom Exploration Incorporated.

Previous exploration at the property has identified two main bodies of mineralization; a near surface Main Zone containing 3.4 million tonnes at 1.34 gram gold per tonne and 0.32 percent copper, and a deeper higher grade West Zone containing about 0.56 million tonnes at 6.2 grams gold per tonne and 0.94 percent copper. Additionally, an intersection in hole 86-78 containing 12.7 grams gold per tonne over 7.5 metres has possibly indentified a previously undiscovered zone; this is called the East Zone.

The purpose of the present program is to test for a higher grade mineralized body within the West Zone and to further test the East Zone.

### Location, Access and Topography

Willa project area is located about twelve kilometres south of New Denver on the eastern side of Slocan Lake; it lies within NTS 82F/14 and is centered near 49°35' N latitude and 117°22' W longitude. The property is within Nelson Mining District.

The property is reached via a one kilometre long gravel road branching from Red Mountain road.

Elevations on the property range from 825 to 2400 metres and relief is rugged.

### Property

Claims held by the joint venture together with pertinent data are listed in Table I. The property comprises about 2925 hectares.

Exploration covered by this report was performed predominantly within L3884 and L1529 mineral claims.

TABLE I  
Willa Project Property

<u>CLAIM</u>	<u>LOT.NO</u>	<u>RECORD NO.</u>	<u>EXPIRY DATE</u>
Rockland	L3883	18213	January 3, 1994
	L3884	---	---
Rustler	L3885	18214	January 3, 1994
Trenton	L5232	1260	June 26, 1994
Last Chance II	L5233	1261	June 26, 1994
Silver Band	L5878	1262	June 26, 1994
AYL 7	1	1312	July 11, 1994
AYL 1	4	1271	June 29, 1994
AYL 2	6	1272	June 29, 1994
Rush	20	1263	June 29, 1994
ENT 1	4	1294	July 10, 1994
ENT 2	12	1313	July 11, 1994
ENT 3	16	1295	July 10, 1994
ENT 5	20	1970	May 30, 1994
ENT 6	8	1971	May 30, 1994
Little Daisy	L7302	327	January 4, 1994
Willa	L1529	18212	January 3, 1994
Golden	L7303	1222	May 18, 1994
Idler	L7304	1223	May 18, 1994
Golden Fraction	L7307	1224	May 18, 1994
Leona 7	1	1321	June 28, 1994
Leona 8	1	1322	June 28, 1994
Leona 9	1	1323	June 28, 1994
Leona 10	1	1324	June 28, 1994
Idler Fraction	1	2774	November 20, 1994
ENT 4	12	1296	July 10, 1994
Leon 5	1	4618	March 20, 1995
Leon 6	1	4602	February 13, 1995

## PREVIOUS EXPLORATION

B.P. Minerals and Rio Algom Exploration Incorporated acquired the property in 1980. Between 1980 and 1984 exploration comprising geochemical surveying, 14,301 metres of diamond drilling in forty six holes, and geological evaluation were performed.

In 1985 Northair Mines Ltd. became a member of the joint venture and performed drifting and diamond drilling between May 1985 and June 1986 to further explore the West Zone. Drifting comprised an 883 metre long adit and a crosscut 92 metres long. Drilling comprised 8,421 metres in sixty five holes.

## PRESENT EXPLORATION

Exploration was performed by Northair Mines Ltd. between November 15, 1986 and February 20, 1987 to test the West and East Zones. This exploration comprised 290 metres of drifting and crosscutting; 2317 metres of diamond drilling in 51 holes and sampling of drift rounds, drift faces and walls and drill core for copper and gold.

Drifting and crosscutting and all diamond drill holes completed to date during this period are shown in Dwg 7WI. Drift rounds, faces and walls were systematically sampled. Muck sampling procedures are detailed in Appendix I. Results are shown in Drawing 7WII and 7WIII. Drill core was geologically logged and select portions split, sampled and assayed for gold and copper at VanGeochem Lab Limited, North Vancouver. Assay analytical reports are included in Appendix II. Gold was assayed using a one assay ton sample and standard fire assay procedures. Drill core logs are included in Appendix III. Core is stored at Silverton.

## GEOLOGY

### Regional Geology

Willa project property overlies an inlier of Mesozoic age Rossland Group rocks within the Nelson Batholith of mid to late Jurassic age; this inlier covers an area of about six square kilometres. This inlier is intruded by felsic stocks and sills and by volcanic breccias.

## Property Geology

Lithologies within the property comprise volcanics, quartz latite porphyry, feldspar porphyry, heterogeneous breccia or fragmental and lamprophyre dykes.

The heterogeneous breccia forms an elongate steeply dipping pipe 100 to 150 metres in diameter intruding volcanics and quartz latite porphyry. Irregular elongate bodies of feldspar porphyry exist within the intrusive breccia; these may possibly be remnants or intrusive bodies.

Gold mineralization is associated with pyrite and chalcopyrite, predominantly as matrix within feldspar porphyry crackle breccia and heterogeneous breccia, but also to a lesser extent within volcanics.

## COST

Costs to February 20, 1987 of the present program total \$720,000. Detailed costs are included in Table II.



R. J. Beckett P.Geol.

	November 86		December 86		January 87		February 87
	25% Tunneling	100%	25% Tunneling	100%	25% Tunneling	100%	100%
120 Inventory - Supplies							
210 Admin. Charges (5%)							
211 Admin. Charges (20%)							
220 Field Office Costs			2994.65		601.45		
230 Hydro	440.71						
260 Maps, Drafting, Reprod'n	772.82						
270 Option Pmts/Prop Maint'ce					3848.95		
280 Telephone/Courier/Comm'n							
300 Salaries					3523.74		
310 Wages - Miners	2112.00	7112.38		18809.25		23622.00	19531.00
315 Wages - Maintenance	5263.00		30690.00		15582.00		
330 Employee Benefits	3742.50		8700.00		6010.50		
340 Bonus - Miners	1520.52	1066.16	5931.06	1892.41	3911.00	2429.08	1821.63
345 Bonus - Maintenance	4750.00		25021.50		9135.00		
350 Meals & Accomodation	399.00		2306.00		870.00		
370 Safety Supplies & Medical	1826.78		3424.70		6651.46		2320.00
380 Travel	1749.93		730.96		509.53		
400 Assays - Diamond Drilling	313.07					300.00	
405 Assays - Mining						11511.29	6000.00
410 Bulk Sample Costs						10547.17	
420 Diamond Drilling				21174.10		954.12	
421 Contract Drilling - Support						73357.71	
450 Metallurgy						4500.00	
475 Engineering/Consulting						18879.00	
500 Contractors - Electrical				981.84		2174.91	
501 Contractors - Construction				2001.70			
505 Equipment Rental - Northair	33206.00		78518.43		44803.51	23208.75	26417.00
506 Equipment Rental - Outside	2025.00		4500.00		1550.00		
510 Explosives	19964.22		5945.70		3002.74		
515 Freight Moving & Towing	2969.25		1092.29		2528.95		
520 Fuel & Lubricants	4771.65		13781.26		9404.94	4891.76	1157.70
525 Hoses & Tools	2765.31		550.56		111.43		
550 Pipe	5115.80		314.58		381.99		
560 Parts & Repairs - Electrical	699.92			2969.25		76.73	
561 Parts & Repairs - Mechanical	8617.50		5534.79		624.68		
565 Rockbolts Screen & Straps	1886.95						
570 Shop Supplies	234.21		431.91				
575 Shotcrete							
580 Steel & Bits	9618.73		53.50		2410.18	1529.19	
585 Timber					67.00		
590 Track							
595 Ventilation	4942.14				1479.81		
Rents Core Shack - Office	200.00	200.00	200.00	200.00	200.00	200.00	400.00
TOTAL:	\$119906.00	8378.00	190722.00	48029.00	117209.00	178182.00	57647.00

## Certificate of Qualifications

I, Robert J. Beckett, of West Vancouver, B.C. certify as follows:

1. I am a graduate of Oxford University, England with a M.A. degree in Geology.
2. I am registered with the Association of Professional Engineers, Geologists and Geophysicists of Alberta as a Professional Geologist.
3. I have practised my profession for twenty four years.
4. This report dated February 20, 1987 is based on data collected under my supervision as project manager.



---

R.J. Beckett M.A., P. Geol.



STATEMENT OF QUALIFICATIONS

I, Fred G. Hewett, with business address in the City of Vancouver, and residential address in the District of Coquitlam, in the Province of British Columbia, DO HEREBY CERTIFY THAT:

1. I am a graduate of the University of British Columbia with a Bachelor of Science Degree in Geology.
2. I am a registered member of the Association of Professional Engineers of the Province of British Columbia.
3. I am a member of the Canadian Institute of Mining & Metallurgy, a fellow of the Geological Association of Canada, and a member of the Society of Economic Geologists.
4. I have practiced various levels of my profession in Canada for approximately twenty years.
5. I am presently employed by Northair Mines Ltd., and have supervised the work performed at the Willa property and described in this report.

  
Fred G. Hewett, P. Eng.

Dated at the City of Vancouver,  
in the Province of British Columbia,  
this 15th day of February 1987.

APPENDIX I  
SAMPLING & ANALYTICAL  
PROCEDURE

Muck Sampling Procedure

Round blasted  
typically 3x3x2 containing  
about 55 tons or 50 tonnes

↓  
mucked from face  
↓  
dumped into remuck

↓  
dumped into 7 ton cars

↓  
trammed to portal

↓  
three full shovels taken from each car  
with proportion of fine and coarse muck  
similar to proportion present on surface of pile  
in car.  
Number of cars is recorded.

↙  
remainder dumped and  
trucked to storage.  
Material dumped in one  
pile.

↓  
sample placed in holding bin

↓  
coarse material broken up in bin with sledge  
hammer.

↓  
coarse crushed in jaw crusher with jaws set  
at  $\frac{1}{2}$  inch spacing

↓  
crushed material stored in five gallon metal pails  
number of pails of crushed material recorded.  
Typically sample comprises 5 to 7 pails or about  
350 to 500 lbs.

↓  
sampled divided in two parts by passing  
through riffle with  $\frac{3}{4}$  inch spacing.

↙  $\frac{1}{2}$   
Split retained in burlap  
sacks and labelled with  
sample #

↘  $\frac{1}{2}$   
all passed through jaw  
crusher set to  $\frac{1}{4}$  jaw spacing

↓  
sample split in riffle

↙  
remainder retained  
in burlap sack

↙  
labelled burlap sacks  
stored at portal

↘  
splitting continued  
until about 15-20 lbs  
remain

↓  
sample placed in plastic  
bag and forwarded to  
Vangeochem for analysis.

APPENDIX II  
ASSAY ANALYTICAL REPORT



# VANGEOCHEM LAB LIMITED

MAIN OFFICE  
1521 PEMBERTON AVE  
NORTH VANCOUVER, B.C. V7P 2S3  
(604) 986-5211 TELEX 04-352578

BRANCH OFFICE  
1630 PANDORA ST  
VANCOUVER, B.C. V5L 1L6  
(604) 251-5656

REPORT NUMBER: 860702AA

JOB NUMBER: 860702

NORHAIR MINES LIMITED

PAGE 2 OF 3

SAMPLE #	CU %	AG oz/ST	PH oz/ST
49001 CHIPS	.82	.068	---
49002 CHIPS	.50	.096	---
49003 CHIPS	.58	.132	---
49004 CHIPS	.82	.258	.226
49005 CHIPS	.57	.094	---
49006 CHIPS	.49	.054	---
49007 CHIPS	.54	.074	---
49008 CHIPS	.02	.046	---
49009 CHIPS	.48	.066	---
49010 CHIPS	.96	.358	.332
49011 CHIPS	.72	.082	---
49012 CHIPS	.76	.074	---
49013 CHIPS	.72	.178	---
49014 CHIPS	.73	.252	.242
49015 CHIPS	.44	.130	---
49016 CHIPS	.66	.196	.162
49017 CHIPS	.68	.100	---
49018 CHIPS	.74	.060	---
49019 CHIPS	.80	.484	1.828
49020 CHIPS	.69	.116	---
49021 CHIPS	.68	.096	---
49022 CHIPS	1.45	.186	.184
49023 CHIPS	1.50	.472	.404

DETECTION LIMIT

1 Troy oz/short ton = 34.28 ppm

.01

1 ppm = 0.0001%

.005

ppm = parts per million

.005

( = less than

signed: \_\_\_\_\_

*[Handwritten signature]*



# VANGEOCHEM LAB LIMITED

MAIN OFFICE  
1521 PEMBERTON AVE.  
NORTH VANCOUVER, B.C. V7P 2S3  
(604) 986-5211 TELEX 04-352578

BRANCH OFFICE  
1630 PANDORA ST  
VANCOUVER, B.C. V5L 1L6  
(604) 251-5656

REPORT NUMBER: 86070200

JOB NUMBER: 860702

NORTHAIR MINES LIMITED

PAGE 3 OF 3

SAMPLE #	%	Au oz/st	Au oz/st
49024 CHIPS	.65	.282	.292
49025 CHIPS	.44	.254	--
49026 CHIPS	.35	.242	--
49027 CHIPS	.42	.222	--
49028 CHIPS	.32	.154	.124
49029 CHIPS	.55	.114	--
49030 CHIPS	.23	.110	--

### DETECTION LIMIT

1 Troy oz/short ton = 34.28 ppm

.01

! ppm = 0.0001%

.005

ppm = parts per million

.005

( = less than

signed: \_\_\_\_\_



# VANGEOCHEM LAB LIMITED

MAIN OFFICE  
 1521 PEMBERTON AVE  
 NORTH VANCOUVER B.C. V7P 2S3  
 (604) 986-5211 TELEY 04-352578

BRANCH OFFICE  
 1630 PANDORA ST.  
 VANCOUVER, B.C. V5L 1L6  
 (604) 251-5656

REPORT NUMBER: 860722AA

JOB NUMBER: 860722

NORHAIR MINES LIMITED

PAGE 2 OF 3

SAMPLE #	Fe	Cu	Pb
	ppm	ppm	ppm
40038	1.17	1.030	
40039	1.17	1.008	
40040	1.17	1.034	
40041	1.17	1.030	
40042	1.17	1.040	
40043	1.17	1.008	
40044	1.03	1.040	
40031	1.03	1.018	
40032	1.37	1.030	
40033	1.08	1.108	1.102
40034	1.03	1.050	
40035	1.01	1.070	
40036	1.11	1.110	1.100
40037	1.01	1.150	1.150
40038	1.50	1.044	
40039	1.03	1.042	
40040	1.01	1.012	
40041	1.11	1.024	
40042	1.01	1.030	
40043	1.07	1.010	

### DETECTION LIMIT

1 Troy oz/short ton = 34.28 ppm

1.01

1 ppm = 0.0001%

1.005

ppm = parts per million

1.005

= less than

Signed: \_\_\_\_\_



# VANGEOCHEM LAB LIMITED

MAIN OFFICE  
1521 PEMBERTON AVE  
NORTH VANCOUVER, B.C. V7P 2S3  
(604) 986-5211 TELEX: 04-352578

BRANCH OFFICE  
1630 PANDORA ST.  
VANCOUVER, B.C. V5L 1L6  
(604) 251-5656

REPORT NUMBER: 860722AA

JOB NUMBER: 860722

NORTHAIR MINES LIMITED

PAGE 3 OF 3

SAMPLE #	Cu	Pb	Zn
	ppm	ppm	ppm
49044	1.1	0.1	0.1
49045	1.1	0.1	0.1
49046	1.1	0.1	0.1
49047	1.1	0.1	0.1
49051	1.1	0.1	0.1
49052	1.1	0.1	0.1
49053	1.1	0.1	0.1

### DETECTION LIMIT

1 Troy oz/short ton = 34.28 ppm

0.01

1 ppm = 0.0001%

0.005

5 ppm = parts per million

0.005

5 = less than

signed: \_\_\_\_\_





# VANGEOCHEM LAB LIMITED

MAIN OFFICE  
1521 PEMBERTON AVE.  
NORTH VANCOUVER, B.C. V7P 2S3  
(604) 986-5211 TELEX: 04-352578

BRANCH OFFICE  
1630 PANDORA ST.  
VANCOUVER, B.C. V5L 1L6  
(604) 251-5656

REPORT NUMBER: 86072400

JOB NUMBER: 860724

NORTHAIR MINES LIMITED

PAGE 2 OF 2

SAMPLE #	Cu %	Au oz/st	Au oz/st
49054	.15	.012	—
49055	.17	.014	
49056	.20	.054	
49057	.23	.016	
49058	.22	.014	
49059	.25	.056	
49060	.29	.040	
49061	.20	.026	
49062	.10	.008	
49063	.22	.024	
49064	1.00	.150	.150
49065	.75	.175	.175

### DETECTION LIMIT

1 Troy oz/short ton = 34.28 ppm

.01

.005

.005

1 ppm = 0.0001%

ppm = parts per million

( = less than

signed: \_\_\_\_\_



# VANGEOCHEM LAB LIMITED

MAIN OFFICE  
1521 PEMBERTON AVE  
NORTH VANCOUVER, B.C. V7P 2S3  
(604) 986-5211 TELEX: 04-352578

BRANCH OFFICE  
1630 PANDORA ST.  
VANCOUVER, B.C. V5L 1L6  
(604) 251-5656

REPORT NUMBER: 860737 AA

JOB NUMBER: 860737

NORHAIR MINES LIMITED

PAGE 1 OF 2

SAMPLE #	Cu %	Au oz/st
48082	.21	.020
48083	.25	.048
48084	.20	.038
48085	.10	.008
48086	.12	.012
48087	.07	.005
48088	.24	.014
48089	.61	.078
48090	.68	.034
49066	.78	.260
49067	3.21	.608
49068	1.96	.066
49069	1.20	.274
49070	1.28	.234
49071	.74	.112
49072	.82	.080
49073	1.64	.082
49074	.41	.044
49075	.15	.022
49076	.26	.042

### DETECTION LIMIT

1 Troy oz/short ton = 34.28 ppm

.01

1 ppm = 0.0001%

.005

0.005 = parts per million

( = less than

signed: \_\_\_\_\_



# VANGEOCHEM LAB LIMITED

MAIN OFFICE  
1521 PEMBERTON AVE.  
NORTH VANCOUVER, B.C. V7P 2S3  
(604) 986-5211 TELEX: 04-352578

BRANCH OFFICE  
1630 PANDORA ST  
VANCOUVER, B.C. V5L 1L6  
(604) 251-5656

REPORT NUMBER: 860737 AA

JOB NUMBER: 860737

NORTH AIR MINES LIMITED

PAGE 2 OF 2

SAMPLE #	Cu %	Au oz/st
49077	.12	.022
49078	.08	.019
49079	.07	.006
49080	.14	.006
49081	.45	.124
49082	.44	.082
49083	1.04	.100
49084	1.20	.080

### DETECTION LIMIT

1 Troy oz/short ton = 34.28 ppm

.01

1 ppm = 0.0001%

.005

ppm = parts per million

< = less than

Signed: \_\_\_\_\_



# VANGEOCHEM LAB LIMITED

MAIN OFFICE  
1521 PEMBERTON AVE  
NORTH VANCOUVER, B.C. V7P 2S3  
(604) 986-5211 TELEX 04-352578

BRANCH OFFICE  
1630 PANDORA ST  
VANCOUVER, B.C. V5L 1L6  
(604) 251-5656

REPORT NUMBER: 350747 AA

JOB NUMBER: 350747

NORTHAIR MINES LIMITED

PAGE 2 OF 2

SAMPLE #	Cu		Au
	%	ppm	
40111	.02	1.000	
40112	.33	1.240	
40113	.35	1.034	
40085	1.03	1.101	
40086	1.04	1.075	
40087	.55	1.045	
40088	.50	1.043	
40089	.55	1.034	
40090	.51	1.033	
40091	.53	1.055	
40092	.31	1.074	
40093	.65	1.034	1.070
40094	.65	1.115	1.100
40095	.34	1.040	
40096	.56	1.030	
40097	.34	1.034	
40098	.27	1.022	

### DETECTION LIMIT

1 Troy oz/short ton = 34.26 ppm

1 ppm = 0.0001%

1 ppb = parts per billion

( = less than

Signature:



# VANGEOCHEM LAB LIMITED

MAIN OFFICE  
1521 PEMBERTON AVE.  
NORTH VANCOUVER, B.C. V7P 2S3  
(604) 966-5211 TELEX. 04-352578

BRANCH OFFICE  
1630 PANDORA ST.  
VANCOUVER, B.C. V5L 1L6  
(604) 251-5656

REPORT NUMBER: 86276000

JOB NUMBER: 862760

NORTHAIR MINES LIMITED

PAGE 3 OF 4

SAMPLE #		Au oz/ft	Au oz/ft
49104	.73	.165	--
49109	.28	.020	--
49100	.00	.022	--
49101	.35	.028	--
49102	.57	.048	--
49103	.55	.070	--
49104	.30	.024	--
49105	.43	.036	--
49106	2.00	.106	--
49107	1.75	.096	--
49108	.20	.010	--
49109	.12	.014	--
49110	.33	.014	--
49111	.30	.040	--
49112	.29	.018	--
49113	1.02	.080	--
49114	.55	.044	--
49115	.40	.032	--
49116	1.75	.248	.252
49117	2.80	.184	--

### DETECTION LIMIT

1 Troy oz/short ton = 34.28 ppm

.01

1 ppm = 0.0001%

.005

ppm = parts per million

.005

( = less than

Signed: \_\_\_\_\_



# VANGEOCHEM LAB LIMITED

MAIN OFFICE  
1521 PEMBERTON AVE.  
NORTH VANCOUVER, B.C. V7P 2S3  
(604) 996-5211 TELEX. 04-352578

BRANCH OFFICE  
1630 PANDORA ST.  
VANCOUVER, B.C. V5L 1L6  
(604) 251-5656

REPORT NUMBER: 86075000A

JOB NUMBER: 860750

NORTHAIR MINES LIMITED

PAGE 4 OF 4

SAMPLE #	Cu %	Au oz/st	Au oz/st
49118	.70	.110	
49119	1.29	.093	--
49120	.94	.124	--
49121	1.00	.374	.388
49122	.49	.106	--
06926	.05	.005	--
06927	.29	.010	--
06928	.11	.015	--

### DETECTION LIMIT

1 Troy oz/short ton = 34.28 ppm

.01

1 ppm = 0.0001%

.005

ppm = parts per million

.005

( = less than

Signed: \_\_\_\_\_



# VANGEOCHEM LAB LIMITED

MAIN OFFICE  
1521 PEMBERTON AVE  
NORTH VANCOUVER, B.C. V7P 2S3  
(604) 986-5211 TELEX: 04-352578

BRANCH OFFICE  
1630 PANDORA ST  
VANCOUVER, B.C. V5L 1L6  
(604) 251-5656

REPORT NUMBER: 870026 AA

JOB NUMBER: 870026

NORTH AIR MINES LTD.

PAGE 1 OF 2

SAMPLE #	Cu		Au	
	%	oz/st	%	oz/st
48181	.23	.022	--	--
48182	.18	.005	--	--
48183	.37	.005	--	--
48184	.22	.006	--	--
48185	.25	.020	.22	.024
48186	.30	.008	--	--
48187	.09	.005	--	--
48188	.05	.005	--	--
48189	.05	.005	--	--
48190	.30	.058	.34	.078
48191	.31	.066	--	--
48192	.23	.034	--	--
49123	.63	.132	--	--
49124	.42	.062	--	--
49125	.53	.102	.53	.282
49126	.65	.068	--	--
49127	2.45	.592	--	--
49128	2.10	.276	--	--
49129	.96	.064	--	--
49130	.74	.102	.60	.112

### DETECTION LIMIT

1 Troy oz/short ton = 34.28 ppm

.01

1 ppm = 0.0001%

.005

ppm = parts per million

.01

.005

( = less than

signed: \_\_\_\_\_



# VANGEOCHEM LAB LIMITED

MAIN OFFICE  
1521 PEMBERTON AVE.  
NORTH VANCOUVER, B.C. V7P 2S3  
(604) 986-5211 TELEX: 04-352578

BRANCH OFFICE  
1630 PANDORA ST.  
VANCOUVER, B.C. V5L 1L6  
(604) 251-5656

REPORT NUMBER: 870026 AA

JOB NUMBER: 870026

NORTHAIR MINES LTD.

PAGE 2 OF 2

SAMPLE #	Cu		Au	
	%	oz/st	%	oz/st
49131	.21	.012	--	--
49132	.20	.008	--	--
49133	.19	.006	--	--
49134	.21	.005	--	--
49135	.59	.032	.60	.026
49136	.08	.005	--	--
49137	.03	<.005	--	--
49138	.15	<.005	--	--
49139	.06	<.005	--	--
49140	.06	.005	.06	.006
49141	.03	.005	--	--
49142	.60	.026	--	--
49143	.04	.005	--	--
49144	.15	.042	--	--
49145	.21	.052	.21	.052
49146	.19	.054	--	--

DETECTION LIMIT

1 Troy oz/short ton = 34.28 ppm

.01

1 ppm = 0.0001%

.005

ppm = parts per million

.01

.005

(< = less than

signed: \_\_\_\_\_





# VANGEOCHEM LAB LIMITED

MAIN OFFICE  
1521 PEMBERTON AVE.  
NORTH VANCOUVER, B.C. V7P 2S3  
(604) 986-5211 TELEX: 04-352578

BRANCH OFFICE  
1630 PANDORA ST.  
VANCOUVER, B.C. V5L 1L6  
(604) 251-5656

REPORT NUMBER: 870035 AA

JOB NUMBER: 870035

NORTHAIR MINES LTD.

PAGE 3 OF 3

SAMPLE #	Cu		Au	
	%	oz/st	%	oz/st
48233	.30	.048	--	--
48234	.28	.030	--	--
49147	.27	.028	--	--
49148	.33	.038	--	--
49149	.25	.036	--	--
49150	.16	.032	.14	.020
49151	.17	.028	--	--
49152	.18	.028	--	--
49153	.43	.040	--	--
49154	.26	.048	--	--
49155	.52	.146	.51	.096
49156	1.06	.544	--	--
49157	.63	.218	--	--
49158	.34	.100	--	--

### DETECTION LIMIT

1 Troy oz/short ton = 34.28 ppm

.01

1 ppm = 0.0001%

.005

ppm = parts per million

.01

.005

( = less than

signed: \_\_\_\_\_



# VANGEOCHEM LAB LIMITED

MAIN OFFICE  
1521 PEMBERTON AVE  
NORTH VANCOUVER, B.C. V7P 2S3  
(604) 986-5211 TELEX 04-352578

BRANCH OFFICE  
1630 PANDORA ST  
VANCOUVER, B.C. V5L 1L6  
(604) 251-5656

REPORT NUMBER: 872243 00

JOB NUMBER: 872243

NORRAIR MINES LTD.

PAGE : 01

SAMPLE #	Cu	Pb
	%	ppm
49155	.15	.015
49159	.53	.172
49160	.72	.058
49161	.26	.052
49162	.19	.020
49163	.30	.024

### DETECTION LIMIT

1 Troy oz/short ton = 34.28 ppm

.01  
1 ppm = 0.0001%

.005  
ppm = parts per million

( = less than

signed:



# VANGEOCHEM LAB LIMITED

MAIN OFFICE  
1521 PEMBERTON AVE  
NORTH VANCOUVER, B.C. V7P 2S3  
(604) 986-5211 TELEX: 04-352578

BRANCH OFFICE  
1630 PANDORA ST  
VANCOUVER, B.C. V5L 1L6  
(604) 251-5656

REPORT NUMBER: 850702AA

JOB NUMBER: 860702

NORTH AIR MINES LIMITED

PAGE 1 OF 3

SAMPLE #	Cu %	Au ppm	Ag ppm
48001 MUCK	.66	1.44	.320
48002 MUCK	.51	1.276	--
48003 MUCK	.56	1.120	--
48004 MUCK	.60	1.142	--
48005 MUCK	.51	1.110	--
48006 MUCK	.68	1.120	--
48007 MUCK	.71	1.150	--
48008 MUCK	.61	1.110	--
48009 MUCK	.80	1.280	.260
48010 MUCK	.54	1.060	--
48011 MUCK	.70	1.110	--
48012 MUCK	.51	1.010	.190
48013 MUCK	.50	1.300	.200
48014 MUCK	.59	1.090	--
48015 MUCK	.40	1.050	--
48016 MUCK	.27	1.010	--
48017 MUCK	.40	1.090	--
49001 CHIPS	.82	1.060	--
49002 CHIPS	.50	1.090	--
49003 CHIPS	.50	1.130	--

## DETECTION LIMIT

1 Troy oz/short ton = 34.28 ppm

.01

1 ppm = 0.0001%

.005

ppm = parts per million

.005

t = less than

Signed: \_\_\_\_\_



# VANGEOCHEM LAB LIMITED

MAIN OFFICE  
1521 PEMBERTON AVE  
NORTH VANCOUVER, B.C. V7P 2S3  
(604) 986-5211 TELEX 04-352578

BRANCH OFFICE  
1630 PANDORA ST  
VANCOUVER, B.C. V5L 1L6  
(604) 251-5656

REPORT NUMBER: 86072209

JOB NUMBER: 860722

NORRAIR MINES LIMITED

PAGE 1 OF 3

Sample No.	ppm	ppm	ppm
48015	1.08	1.100	1.100
48017	1.17	1.020	
48020	1.27	1.320	
48021	1.21	1.110	1.135
48022	1.53	1.100	
48023	1.09	1.200	
48024	1.70	1.170	1.100 ✓
48025	1.52	1.070	
48026	1.21	1.022	
48027	1.24	1.024	
48028	1.37	1.040	
48029	1.30	0.980	
48030	1.32	1.011	
48031	1.35	1.010	
48032	1.34	1.051	
48033	1.32	1.050	
48034	1.20	1.036	
48035	1.21	1.042	
48036	1.17	1.040	
48037	1.10	1.024	

Muck



DETECTION LIMIT

1 Troy oz/short ton = 34.26 ppm

1 ppm = 0.0001%

ppm = parts per million

= less than

signed: \_\_\_\_\_



# VANGEOCHEM LAB LIMITED

MAIN OFFICE  
1521 PEMBERTON AVE.  
NORTH VANCOUVER, B.C. V7P 2S3  
(604) 986-5211 TELEX 04-352578

BRANCH OFFICE  
1630 PANDORA ST.  
VANCOUVER, B.C. V5L 1L6  
(604) 251-5656

REPORT NUMBER: 860724AA

JOB NUMBER: 860724

NORRAIR MINES LIMITED

PAGE 1 OF 2

SAMPLE #	Pb %	Au oz/st	Ag oz/st
48045	.04	.050	
48046	.27	.01	
48047	.16	.050	
48048	.30	.026	
48049	.25	.030	
48050	.25	.060	
48051	.30	.032	
48052	.33	.030	
48053	.22	.052	
48054	.28	.026	
48055	.20	.130	.112 ✓
48056	.93	.172	.174 ✓
48057	.81	.240	.218 ✓
48058	.67	.140	.174 ✓
48059	.77	.166	.102 ✓
48060	.79	.276	.260 ✓
48061	.85	.30	.256 ✓
48062	.59	.110	.142 ✓
48063	.60	.020	
49054	.15	.012	

DETECTION LIMIT

1 Troy oz/short ton = 34.28 ppm

.01

1 ppm = 0.0001%

.005

ppm = parts per million

.005

( = less than

signed: \_\_\_\_\_





# VANGEOCHEM LAB LIMITED

MAIN OFFICE  
1521 PEMBERTON AVE  
NORTH VANCOUVER, B.C. V7P 2S3  
(604) 996-5211 TELEX: 04-352578

BRANCH OFFICE  
1630 PANDORA ST  
VANCOUVER, B.C. V5L 1L6  
(604) 251-5656

REPORT NUMBER: 862747 00

JOB NUMBER: 862747

NORTH AIR MINES LIMITED

PAGE 1 OF 2

SAMPLE #	Cu	Pb	Zn
	%	ppm	ppm
48001	.75	.040	
48002	.56	.060	
48003	.43	.034	
48004	.37	.006	
48005	.72	.460	.009
48075	.53	.134	
48077	.77	.104	.115
48078	.58	.140	
48079	.40	.054	
48100	.52	.048	
48101	.36	.034	
48102	.40	.030	
48103	.49	.056	
48104	.44	.056	
48105	.46	.056	
48106	.39	.038	
48107	.37	.044	
48108	.32	.034	
48109	.24	.020	
48110	.24	.018	

DETERMINATION LIMITS

Cu = 34.26 ppm

Pb = 0.0001%

Zn = 0.005

Zn = parts per million

( = less than

signed:



# VANGEOCHEM LAB LIMITED

MAIN OFFICE  
1521 PEMBERTON AVE  
NORTH VANCOUVER, B.C. V7P 2S3  
(604) 986-5211 TELEX: 04-352578

BRANCH OFFICE  
1630 PANDORA ST.  
VANCOUVER, B.C. V5L 1L6  
(604) 251-5656

REPORT NUMBER: 86076000

JOB NUMBER: 860752

NORTHAIR MINES LIMITED

PAGE 1 OF 4

NO. ANALYSIS	Cu %	Au oz/short ton	Ag oz/short ton
48114	.30	.042	---
48115	.26	.022	---
48116	.47	.054	---
48117	.30	.036	---
48118	.55	.080	---
48119	.47	.062	---
48120	.68	.072	---
48121	.41	.050	---
48122	.43	.042	---
48123	.43	.028	---
48124	.50	.032	---
48125	.43	.028	---
48126	.45	.034	---
48127	.40	.036	---
48128	.44	.034	---
48129	.47	.038	---
48130	.28	.024	---
48131	.30	.016	---
48132	.25	.018	---
48133	.32	.028	---

*M. 1001*

*48118*

**DETECTION LIMIT**

1 Troy oz/short ton = 34.26 ppm

.01

1 ppm = 0.0001%

.005

ppm = parts per million

.005

( = less than

*[Handwritten signature]*





# VANGEOCHEM LAB LIMITED

MAIN OFFICE  
1521 PEMBERTON AVE.  
NORTH VANCOUVER, B.C. V7P 2S3  
(604) 986-5211 TELEX: 04-352578

BRANCH OFFICE  
1630 PANDORA ST.  
VANCOUVER, B.C. V5L 1L6  
(604) 251-5656

REPORT NUMBER: 862762AA

JOB NUMBER: 862762

NORTH AIR MINES LIMITED

PAGE 2 OF 4

SAMPLE #	Cu	Au	Au
	%	oz/short	oz/short
48134	.70	.055	--
48135	.74	.088	--
48136	.45	.042	--
48137	.90	.226	.052
48138	.73	.242	.230
48139	.72	.124	--
48140	.62	.104	--
48141	.75	.126	--
48142	.29	.058	--
48143	.85	.210	.204
48144	.74	.306	.295
48145	.78	.182	--
48146	.58	.156	--
48147	.74	.154	--
48148	.89	.200	.194
48149	.86	.144	--
48150	.47	.120	--
48151	.57	.098	--
48152	.79	.154	--
48153	.65	.018	--
48154	.73	.166	--

*Check*

### DETECTION LIMIT

1 Troy oz/short ton = 34.28 ppm

1 ppm = 0.0001%

1 ppm = parts per million

-- = less than

Signed: \_\_\_\_\_



# VANGEOCHEM LAB LIMITED

MAIN OFFICE  
1521 PEMBERTON AVE.  
NORTH VANCOUVER, B.C. V7P 2S3  
(604) 986-5211 TELEX 04-352578

BRANCH OFFICE  
1630 PANDORA ST  
VANCOUVER, B.C. V5L 1L6  
(604) 251-5656

REPORT NUMBER: 870014 AA

JOB NUMBER: 870014

NORTHAIR MINES LTD.

PAGE 1 OF 2

SAMPLE #	Cu %	Au oz/st	Cu %	Au oz/st
48155	.17	.030	.17	.030
48156	.34	.113	--	--
48157	.43	.092	--	--
48158	.40	.032	--	--
48159	.63	.064	--	--
48160	1.24	.085	1.16	.076
48161	1.03	.070	--	--
48162	.74	.092	--	--
48163	.30	.036	--	--
48164	.80	.058	--	--
48165	.77	.114	.92	.062
48166	1.07	.164	--	--
48167	.80	.078	--	--
48168	.76	.070	--	--
48169	.88	.088	--	--
48170	.73	.058	.76	.062
48171	1.03	.072	--	--
48172	.96	.796	--	.124
48173	.84	.080	--	--
48174	.69	.076	--	--

### DETECTION LIMIT

1 Troy oz/short ton = 34.28 ppm

.01

1 ppm = 0.0001%

.005

ppm = parts per million

.01

.005

( = less than

signed: \_\_\_\_\_



# VANGEOCHEM LAB LIMITED

MAIN OFFICE  
1521 PEMBERTON AVE  
NORTH VANCOUVER, B.C. V7P 2S3  
(604) 986-5211 TELEX 04-352578

BRANCH OFFICE  
1630 PANDORA ST  
VANCOUVER, B.C. V5L 1L6  
(604) 251-5656

REPORT NUMBER: 870014 AA

JOB NUMBER: 870014

NORTHAIR MINES LTD.

PAGE 2 OF 2

SAMPLE #	Cu		Au	
	%	oz/tst	%	oz/tst
48175	.04	.000	.00	.000
48176	.60	.074		
48177	.60	.070		
48178	.45	.110		
48179	.73	.078		
48180	.13	.000	.14	.000

### DETECTION LIMIT

1 Troy oz/short ton = 34.28 ppm

.01

1 ppm = 0.0001%

.005

ppm = parts per million

.01

.005

( = less than

Signed: \_\_\_\_\_



# VANGEOCHEM LAB LIMITED

MAIN OFFICE  
1521 PEMBERTON AVE.  
NORTH VANCOUVER, B.C. V7P 2S3  
(604) 986-5211 TELEX: 04-352578

BRANCH OFFICE  
1630 PANDORA ST.  
VANCOUVER, B.C. V5L 1L6  
(604) 251-5656

REPORT NUMBER: B70036 AA

JOB NUMBER: B70035

NORTHAIR MINES LTD.

PAGE 1 OF 3

SAMPLE #	Cu		Au	
	%	oz/st	%	oz/st
48193	.28	.040	--	--
48194	.26	.046	--	--
48195	.26	.034	.26	.024
48196	.22	.034	--	--
48197	.30	.034	--	--
48198	.25	.050	--	--
48199	.28	.052	--	--
48200	.34	.078	.35	.074
48201	.34	.086	--	--
48202	.37	.096	--	--
48203	.57	.166	--	--
48204	.52	.206	--	--
48205	.43	.124	.42	.108
48206	.52	.152	--	--
48207	.47	.156	--	--
48208	.60	.222	--	--
48209	.47	.200	--	--
48210	.60	.196	.66	.202
48211	.56	.182	--	--
48212	.53	.232	--	--

### DETECTION LIMIT

1 Troy oz/short ton = 34.28 ppm

.01  
1 ppm = 0.0001%

.005  
ppm = parts per million

.01  
( = less than

signed: \_\_\_\_\_



# VANGEOCHEM LAB LIMITED

MAIN OFFICE  
1521 PEMBERTON AVE.  
NORTH VANCOUVER, B.C. V7P 2S3  
(604) 966-5211 TELEX: 04-352578

BRANCH OFFICE  
1630 PANDORA ST.  
VANCOUVER, B.C. V5L 1L6  
(604) 251-5656

REPORT NUMBER: 870035 AA

JOB NUMBER: 870035

NORTHAIR MINES LTD.

PAGE 2 OF 3

SAMPLE #	Cu %	Au oz/st	Cu %	Au oz/st
48213	.69	.292	--	--
48214	.76	.258	--	--
48215	.76	.254	.78	.280
48216	.74	.258	--	--
48217	.66	.252	--	--
48218	.66	.154	--	--
48219	.74	.360	--	--
48220	.78	.212	.76	.238
48221	.51	.158	--	--
48222	.60	.300	--	--
48223	.56	.178	--	--
48224	.44	.106	--	--
48225	.44	.132	.44	.110
48226	.51	.110	--	--
48227	.56	.164	--	--
48228	.70	.268	--	--
48229	.38	.112	--	--
48230	.52	.170	.54	.134
48231	.38	.058	--	--
48232	.33	.034	--	--

### DETECTION LIMIT

1 Troy oz/short ton = 34.28 ppm

.01

1 ppm = 0.0001%

.005

ppm = parts per million

.01

.005

( = less than

signed: \_\_\_\_\_



# VANGEOCHEM LAB LIMITED

MAIN OFFICE  
1521 PEMBERTON AVE.  
NORTH VANCOUVER, B.C. V7P 2S3  
(604) 986-5211 TELEX: 04-352578

BRANCH OFFICE  
1630 PANDORA ST.  
VANCOUVER, B.C. V5L 1L6  
(604) 251-5656

REPORT NUMBER: 870083 AA

JOB NUMBER: 870083

NORTH AIR MINES LTD.

PAGE 6 OF 6

SAMPLE #	Cu %	Au oz/st	Cu %	Au oz/st
49262 MUCK	1.33	.162	---	---
49263 MUCK	.86	.114	---	---
49264 MUCK	.76	.060	---	---
49265 MUCK	.57	.058	.56	.050
49266 MUCK	.80	.072	---	---
49267 MUCK	.80	.062	---	---
8 MSR 0 - 6 SLUDGE	1.02	.164	---	---
8 MSR 6 - 12 SLUDGE	.60	.168	---	---
8 MSR 12 - 18 SLUDGE	.80	.206	---	---
8 MSR 18 - 24 SLUDGE	.74	.160	---	---
13 MNL 0 - 6 SLUDGE	.43	<.005	---	---
13 MNL 6 - 12 SLUDGE	.69	.122	---	---
13 MNL 12 - 18 SLUDGE	.30	.028	---	---
13 MNL 18 - 24 SLUDGE	.13	<.005	---	---
13 MNR 0 - 6 SLUDGE	.45	.060	---	---
13 MNR 6 - 12 SLUDGE	.51	.054	---	---
13 MNR 12 - 18 SLUDGE	.22	.012	---	---
13 MNR 18 - 24 SLUDGE	.21	<.005	---	---
WHOLE SACK A ) 48236	.38	.030	---	---
WHOLE SACK B	.32	.020	---	---

DETECTION LIMIT

1 Troy oz/short ton = 34.28 ppm

.01

1 ppm = 0.0001%

.005

ppm = parts per million

.01

.005

(< = less than

signed: \_\_\_\_\_



# VANGEOCHEM LAB LIMITED

MAIN OFFICE  
1521 PEMBERTON AVE.  
NORTH VANCOUVER, B.C. V7P 2S3  
(604) 986-5211 TELEX 04-352578

BRANCH OFFICE  
1630 PANDORA ST.  
VANCOUVER, B.C. V5L 1L6  
(604) 251-5656

REPORT NUMBER: 870060 AA

JOB NUMBER: 972262

NORHAIR MINES LTD.

PAGE 1 OF 7

SAMPLE #	Cu %	Au oz/st	Co %	Pb oz/st
480070	.74	.098		
48007B	.75	.100		
48065A	1.16	.382	1.10	.384
48065B	1.18	.394	1.01	.474
48066A	1.20	.656		
48066B	1.12	.254		
48079A	.74	.118		
48079B	.80	.108		
48102A	.39	.022		
48102B	.37	.024		
48135A	.80	.056	.80	.088
48135B	.74	.144	.78	.090
48152A	.76	.150		
48152B	.74	.158		
48421	.25	.030		
48422	.36	.024		
48423	.37	.052		
48424	.30	.035		
48425	.88	.034	.98	.038
48426	.43	.050		

### DETECTION LIMIT

1 Troy oz/short ton = 34.28 ppm

.01

1 ppm = 0.0001%

.005

ppm = parts per million

.01

.005

( = less than

Signed: \_\_\_\_\_



# VANGEOCHEM LAB LIMITED

MAIN OFFICE  
1521 PEMBERTON AVE.  
NORTH VANCOUVER, B.C. V7P 2S3  
(604) 986-5211 TELEX 04-352578

BRANCH OFFICE  
1630 PANDORA ST  
VANCOUVER, B.C. V5L 1L6  
(604) 251-5656

REPORT NUMBER: 860702 AC

JOB NUMBER: 860702

NORTHAIR MINES LIMITED

PAGE 1 OF 1

SAMPLE #	WEIGHT gram	Au mg	Au oz/st
48001 MUCK (TOTAL)	166.07	--	.168
48001 MUCK (+140)	9.49	.177	--
48001 MUCK (-140)	156.58	--	.144 ✓
48006 MUCK (TOTAL)	248.41	--	.112
48006 MUCK (+140)	7.63	.028	--
48006 MUCK (-140)	240.78	--	.112 ✓
48009 MUCK (TOTAL)	165.87	--	.265
48009 MUCK (+140)	8.59	.354	--
48009 MUCK (-140)	157.28	--	.216
48014 MUCK (TOTAL)	275.48	--	.094 ✓
48014 MUCK (+140)	20.50	.081	--
48014 MUCK (-140)	254.98	--	.092

*Match to 100 ticks*

### DETECTION LIMIT

1 Troy oz/short ton = 34.28 ppm

1 ppm = 0.0001%

.001

.005

ppm = parts per million

( = less than

signed: \_\_\_\_\_





# VANGEOCHEM LAB LIMITED

MAIN OFFICE  
1521 PEMBERTON AVE.  
NORTH VANCOUVER, B.C. V7P 2S3  
(604) 986-5211 TELEX: 04-352578

BRANCH OFFICE  
1630 PANDORA ST.  
VANCOUVER, B.C. V5L 1L6  
(604) 251-5656

REPORT NUMBER: 860702AB

JOB NUMBER: 860702

NORTHAIR MINES LTD.

PAGE 1 OF 1

SAMPLE #	WEIGHT gram	Au mg	Au oz/st
48013 MUCK (TOTAL)	101.62	--	.218
48013 MUCK (+140)	5.24	.216	--
48013 MUCK (-140)	175.58	--	.190
49010 CHIPS (TOTAL)	198.08	--	.322
49010 CHIPS (+140)	4.20	.205	--
49010 CHIPS (-140)	193.98	--	.298
49019 CHIPS (TOTAL)	160.22	--	1.370
49019 CHIPS (+140)	.74	3.404	--
49019 CHIPS (-140)	159.48	--	.754
49023 CHIPS (TOTAL)	163.88	--	.513
49023 CHIPS (+140)	6.50	.623	--
49023 CHIPS (-140)	157.38	--	.303

MUCK & P. 1000000

DETECTION LIMIT

1 Troy oz/short ton = 34.28 ppm

1 ppm = 0.0001%

.001

.005

ppm = parts per million

( = less than

signed: \_\_\_\_\_



# VANGEOCHEM LAB LIMITED

MAIN OFFICE  
1521 PEMBERTON AVE  
NORTH VANCOUVER, B.C. V7P 2S3  
(604) 986-5211 TELEX: 04-352578

BRANCH OFFICE  
1630 PANDORA ST  
VANCOUVER, B.C. V5L 1L6  
(604) 251-5656

REPORT NUMBER: 860724 AB

JOB NUMBER: 660724

NORTHAIR MINES LIMITED

PAGE 1 OF 2

SAMPLE #	Weight (gm)	Au (mg)	Au oz/t
48054 TOTAL	335.15		.210 ✓
140	10.77	.050	
140	324.38		.170
48055 TOTAL	284.33		.250 ✓
140	15.75	.050	
140	268.58		.200
48056 TOTAL	218.00		.250 ✓
140	20.70	.057	
140	197.30		.200
48056 TOTAL	257.40		.215 ✓
140	25.55	.387	
140	231.85		.190
48057 TOTAL	240.05		.142 ✓
140	15.75	.170	
140	224.30		.130
48058 TOTAL	210.21		.157 ✓
140	21.63	.243	
140	188.58		.130
48059 TOTAL	236.20		.130 ✓
140	15.54	.447	

### DETECTION LIMIT

1 Troy oz/short ton = 34.28 ppm

1 ppm = 0.0001%

.001

.005

ppm = parts per million

( = less than

signed: \_\_\_\_\_



# VANGEOCHEM LAB LIMITED

MAIN OFFICE  
1521 PEMBERTON AVE.  
NORTH VANCOUVER, B.C. V7P 2S3  
(604) 986-5211 TELEX: 04-352578

BRANCH OFFICE  
1630 PANDORA ST  
VANCOUVER, B.C. V5L 1L6  
(604) 251-5656

REPORT NUMBER: 860724 AF

JOB NUMBER: 860724

NORTHAIR MINES LIMITED

PAGE 2 OF 2

SAMPLE #	Weight (gm)	Au (mg)	Au oz/st
140	26.20		.086
48060 TOTAL	267.02		.167
140	18.14	.263	
140	241.78		.148
48061 TOTAL	240.92		.239 ✓
140	6.84	.101	
140	231.08		.226
48062 TOTAL	230.92		.226 ✓
140	11.77	.423	
140	217.70		.184

### DETECTION LIMIT

1 Troy oz/short ton = 34.28 ppm

1 ppm = 0.0001%

.001

.005

ppm parts per million

( = less than

Signed: \_\_\_\_\_



# VANGEOCHEM LAB LIMITED

MAIN OFFICE  
1521 PEMBERTON AVE.  
NORTH VANCOUVER, B.C. V7P 2S3  
(604) 986-5211 TELEX: 04-352578

BRANCH OFFICE  
1630 PANDORA ST.  
VANCOUVER, B.C. V5L 1L6  
(604) 251-5656

REPORT NUMBER: 870002 AA

JOB NUMBER: 870002

NORTHAIR MINES LTD.

PAGE 1 OF 3

SAMPLE #	Cu	Au
	%	ppm
48005	.55	.090
48010	.56	.136
48015	.42	.054
48020	.22	.030
48025	.45	.053
48030	.34	.025
48035	.22	.050
48040	.17	.039
48045	.21	.038
48050	.33	.042
48055	.25	.051
48060	.70	.188
48065	1.80	.380
48070	.75	.190
48075	.96	.298
48080	.49	.068
48085	.12	.014
48090	.73	.078
48095	.62	.084
48100	.46	.034

*Much  
Feeder*

### DETECTION LIMIT

1 Troy oz/short ton = 34.28 ppm

.01

1 ppm = 0.0001%

.005

ppm = parts per million

( = less than

Signed: \_\_\_\_\_



# VANGEOCHEM LAB LIMITED

MAIN OFFICE  
1521 PEMBERTON AVE  
NORTH VANCOUVER, B.C. V7P 2S3  
(604) 986-5211 TELEX 04-352578

BRANCH OFFICE  
1630 PANDORA ST.  
VANCOUVER, B.C. V5L 1L6  
(604) 251-5656

REPORT NUMBER: 870002 AA

JOB NUMBER: 870002

NORTH AIR MINES LTD.

PAGE 2 OF 3

SAMPLE #	Cu %	Au oz/st
48105	.49	.072
48110	.23	.022
48115	.25	.030
48120	.65	.060
48125	.42	.040
48130	.29	.040
48135	.76	.338
48140	.70	.144
48145	.70	.148
48150	.47	.112
48154	.68	.156
49005	.55	.092
49010	1.05	.306
49015	.49	.134
49020	.75	.140
49025	.52	.066
49030	.51	.100
49035	.47	.044
49040	.29	.005
49045	.20	.026

Muck  
REFER

REFER

### DETECTION LIMIT

1 Troy oz/short ton = 34.28 ppm

.01 ppm = 0.0001%  
.005 ppm = parts per million

( = less than

signed: \_\_\_\_\_



# VANGEOCHEM LAB LIMITED

MAIN OFFICE  
1521 PEMBERTON AVE.  
NORTH VANCOUVER, B.C. V7P 2S3  
(604) 986-5211 TELEX: 04-352578

BRANCH OFFICE  
1630 PANDORA ST.  
VANCOUVER, B.C. V5L 1L6  
(604) 251-5656

REPORT NUMBER: 870002 AA

JOB NUMBER: 870002

NORTH AIR MINES LTD.

PAGE 3 OF 3

SAMPLE #	Cu %	Au oz/ft
49055	.15	.014
49060	.29	.056
49065	.72	.186
49070	1.60	.266
49075	.15	.018
49080	.11	.005
49085	1.08	.072
49090	.47	.018
49095	.32	.044
49100	.17	.012
49105	.49	.030
49110	.31	.022
49115	.39	.026
49120	.08	.142

*FACTORY  
REJECT  
CHECKS*



### DETECTION LIMIT

1 Troy oz/short ton = 34.28 ppm

.01  
1 ppm = 0.0001%

.005  
ppm parts per million

( = less than

signed: \_\_\_\_\_



# VANGEOCHEM LAB LIMITED

MAIN OFFICE  
1521 PEMBERTON AVE.  
NORTH VANCOUVER, B.C. V7P 2S3  
(604) 986-6211 TELEX: 04-352578

BRANCH OFFICE  
1630 PANDORA ST.  
VANCOUVER, B.C. V5L 1L6  
(604) 251-6656

## ASSAY ANALYTICAL REPORT

-----

CLIENT: NORTHAIR MINES LTD.  
ADDRESS: 860 - 625 Howe Street  
: Vancouver, B.C.  
: V6C 2T6

DATE: Feb 16 1987

REPORT#: 870116 AA  
JOB#: 870116

PROJECT#: WILLA  
SAMPLES ARRIVED: Feb 5 1987  
REPORT COMPLETED: Feb 16 1987  
ANALYSED FOR: Cu Au Cu Au

INVOICE#: 870116 NA  
TOTAL SAMPLES: 203  
REJECTS/PULPS: 90 DAYS/1 YR  
SAMPLE TYPE: 203 CORE

SAMPLES FROM: New Denver, B.C.  
COPY SENT TO: New Denver, B.C.

PREPARED FOR: MR. ROB BECKETT

ANALYSED BY: David Chiu

SIGNED: \_\_\_\_\_

Registered Provincial Assayer

GENERAL REMARK: None



# VANGEOCHEM LAB LIMITED

MAIN OFFICE  
1521 PEMBERTON AVE.  
NORTH VANCOUVER, B.C. V7P 2S3  
(604) 966-6211 TELEX: 04-362578

BRANCH OFFICE  
1630 PANDORA ST.  
VANCOUVER, B.C. V5L 1L6  
(604) 251-6668

REPORT NUMBER: 870116 AA

JOB NUMBER: 870116

NORTHAIR MINES LTD.

PAGE 1 OF 11

SAMPLE #	Cu		Au	
	%	oz/st	%	oz/st
00501	.12	.024	---	---
00502	.11	.005	---	---
00503	.20	.028	---	---
00504	.17	.026	---	---
00505	.29	.032	.33	.026
00506	.31	.034	---	---
00507	.30	.034	---	---
00508	.26	.030	---	---
00509	.26	.016	---	---
00510	.36	.036	.41	.030
00511	.45	.108	---	---
00512	.54	.076	---	---
00513	2.65	.276	---	---
00514	1.35	.122	---	---
00534	.79	.034	---	---
00535	.56	.058	.56	.058
00536	1.80	.296	---	---
00537	1.90	.324	---	---
00538	1.04	.074	---	---
00539	1.45	.050	---	---

### DETECTION LIMIT

1 Troy oz/short ton = 34.28 ppm

.01

1 ppm = 0.0001%

.005

ppm = parts per million

.01

.005

( = less than

signed: \_\_\_\_\_





# VANGEOCHEM LAB LIMITED

MAIN OFFICE  
1521 PEMBERTON AVE.  
NORTH VANCOUVER, B.C. V7P 2S3  
(604) 968-6211 TELEX: 04-352578

BRANCH OFFICE  
1630 PANDORA ST.  
VANCOUVER, B.C. V5L 1L6  
(604) 251-6656

REPORT NUMBER: 870116 AA

JOB NUMBER: 870116

NORTHAIR MINES LTD.

PAGE 2 OF 11

SAMPLE #	Cu		Au	
	%	oz/st	%	oz/st
00540	1.04	.082	.96	.086
00541	.41	.042	--	--
00542	.49	.048	--	--
00543	.44	.024	--	--
00544	.72	.032	--	--
00545	.38	.026	.40	.026
00546	.58	.054	--	--
00547	.82	.104	--	--
00548	.64	.048	--	--
00549	1.18	.036	--	--
00550	.60	.080	.60	.072
03151	.47	.132	--	--
03152	.25	.078	--	--
03153	.36	.110	--	--
03154	.76	.226	--	--
03155	.42	.116	.41	.114
03156	1.07	.082	--	--
03157	1.60	.606	--	--
03158	1.40	.276	--	--
03159	.54	.028	--	--

DETECTION LIMIT

1 Troy oz/short ton = 34.28 ppm

.01

1 ppm = 0.0001%

.005

ppm = parts per million

.01

.005

( = less than

signed: \_\_\_\_\_



# VANGEOCHEM LAB LIMITED

MAIN OFFICE  
1521 PEMBERTON AVE.  
NORTH VANCOUVER, B.C. V7P 2S3  
(604) 966-5211 TELEX: 04-352578

BRANCH OFFICE  
1630 PANDORA ST.  
VANCOUVER, B.C. V5L 1L6  
(604) 251-5656

REPORT NUMBER: 870116 AA

JOB NUMBER: 870116

NORTHAIR MINES LTD.

PAGE 3 OF 11

SAMPLE #	Cu		Au	
	%	oz/st	%	oz/st
03160	.27	.044	.30	.054
03161	.25	.070	--	--
03162	.37	.112	--	--
03163	.48	.152	--	--
03164	.84	.284	--	--
03165	.31	.064	.33	.080
03166	.53	.206	--	--
03167	.26	.034	--	--
03168	.30	.066	--	--
03169	.26	.066	--	--
03170	.41	.162	.43	.172
03171	.22	.058	--	--
03172	.29	.088	--	--
03173	.35	.116	--	--
03174	.35	.104	--	--
03175	.39	.166	.41	.134
03176	.31	.072	--	--
03177	.45	.014	--	--
03178	.28	.106	--	--
03179	.48	.246	--	--

### DETECTION LIMIT

1 Troy oz/short ton = 34.28 ppm

.01

1 ppm = 0.0001%

.005

ppm = parts per million

.01

.005

( = less than

signed: \_\_\_\_\_



# VANGEOCHEM LAB LIMITED

MAIN OFFICE  
1521 PEMBERTON AVE.  
NORTH VANCOUVER, B.C. V7P 2S3  
(604) 966-5211 TELEX: 04-352578

BRANCH OFFICE  
1630 PANDORA ST.  
VANCOUVER, B.C. V5L 1L6  
(604) 251-5656

REPORT NUMBER: 870116 AA

JOB NUMBER: 870116

NORTHAIR MINES LTD.

PAGE 4 OF 11

SAMPLE #	Cu		Au	
	%	oz/st	%	oz/st
03180	.25	.148	.24	.112
03181	.48	.138	--	--
03182	.63	.158	--	--
03183	.69	.228	--	--
03184	.56	.172	--	--
03185	.35	.086	.36	.084
03186	.41	.132	--	--
49323	.18	.020	--	--
49324	.15	.014	--	--
49325	.14	.020	.14	.016
49326	.23	.024	--	--
49327	.17	.018	--	--
49328	.34	.050	--	--
49329	.22	.056	--	--
49330	.27	.064	.27	.076
49331	.25	.062	--	--
49332	.31	.042	--	--
49333	.20	.032	--	--
49334	.98	.005	--	--
49335	.68	.372	.67	.512

**DETECTION LIMIT**

1 Troy oz/short ton = 34.28 ppm

.01

1 ppm = 0.0001%

.005

ppm = parts per million

.01

.005

( = less than

signed: \_\_\_\_\_



# VANGEOCHEM LAB LIMITED

MAIN OFFICE  
1521 PEMBERTON AVE.  
NORTH VANCOUVER, B.C. V7P 2S3  
(604) 966-5211 TELEX: 04-352578

BRANCH OFFICE  
1630 PANDORA ST.  
VANCOUVER, B.C. V5L 1L6  
(604) 251-6656

REPORT NUMBER: 870116 AA

JOB NUMBER: 870116

NORTHAIR MINES LTD.

PAGE 5 OF 11

SAMPLE #	Cu		Au	
	%	oz/st	%	oz/st
49336	.35	.092	--	--
49337	.45	.096	--	--
49338	.76	.394	--	--
49339	.34	.088	--	--
49340	.37	.082	.38	.082
49341	.22	.026	--	--
49342	.28	.010	--	--
49343	.20	.024	--	--
49344	.28	.046	--	--
49345	.27	.020	.27	.014
49346	.19	.018	--	--
49347	.29	.042	--	--
49348	.38	.046	--	--
49349	.41	.050	--	--
49350	.40	.040	.44	.032
49351	.35	.056	--	--
49352	.51	.005	--	--
49353	.33	.026	--	--
49354	.33	.010	--	--
49355	.22	.012	.23	.014

**DETECTION LIMIT**

1 Troy oz/short ton = 34.28 ppm

.01

1 ppm = 0.0001%

.005

ppm = parts per million

.01

.005

( = less than

signed: \_\_\_\_\_



# VANGEOCHEM LAB LIMITED

MAIN OFFICE  
1521 PEMBERTON AVE.  
NORTH VANCOUVER, B.C. V7P 2S3  
(604) 966-6211 TELEX: 04-352578

BRANCH OFFICE  
1630 PANDORA ST.  
VANCOUVER, B.C. V5L 1L6  
(604) 251-6656

REPORT NUMBER: 870116 AA

JOB NUMBER: 870116

NORTHAIR MINES LTD.

PAGE 6 OF 11

SAMPLE #	Cu		Au	
	%	oz/st	%	oz/st
49356	.26	.010	--	--
49357	.24	.020	--	--
49358	.41	.028	--	--
49359	.55	.028	--	--
49360	.50	.032	.52	.030
49361	.26	.026	--	--
49362	.26	.024	--	--
49363	.30	.018	--	--
49364	.78	.108	--	--
49365	.32	.024	.36	.028
49366	.50	.062	--	--
49367	.50	.062	--	--
49368	.38	.046	--	--
49369	.46	.040	--	--
49370	1.50	.172	1.65	.178
49371	.94	.194	--	--
49372	.56	.082	--	--
49373	.70	.128	--	--
49374	.39	.062	--	--
49375	.53	.048	.53	.028

**DETECTION LIMIT**

1 Troy oz/short ton = 34.28 ppm

.01

1 ppm = 0.0001%

.005

ppm = parts per million

.01

.005

( = less than

signed: \_\_\_\_\_



# VANGEOCHEM LAB LIMITED

MAIN OFFICE  
1521 PEMBERTON AVE.  
NORTH VANCOUVER, B.C. V7P 2S3  
(604) 966-5211 TELEX: 04-352578

BRANCH OFFICE  
1630 PANDORA ST.  
VANCOUVER, B.C. V5L 1L6  
(604) 251-6858

REPORT NUMBER: 870116 AA

JOB NUMBER: 870116

NORTHAIR MINES LTD.

PAGE 8 OF 11

SAMPLE #	Cu		Au	
	%	oz/st	%	oz/st
49396	.04	.005	--	--
49397	.05	.005	--	--
49398	.07	.006	--	--
49399	.07	<.005	--	--
49400	.03	.006	.04	.005
49401	.06	.012	--	--
49402	.02	.014	--	--
49403	.02	<.005	--	--
49404	.42	.040	--	--
49405	.11	.018	.12	.012
49406	.19	.028	--	--
49407	.22	.016	--	--
49408	.20	.012	--	--
49409	.24	.022	--	--
49410	.22	.030	.23	.032
49411	.16	.014	--	--
49412	.22	.014	--	--
49413	.29	.018	--	--
49414	.47	.116	--	--
49415	.44	.076	.46	.090

### DETECTION LIMIT

1 Troy oz/short ton = 34.28 ppm

.01

1 ppm = 0.0001%

.005

ppm = parts per million

.01

.005

( = less than

signed: \_\_\_\_\_



# VANGEOCHEM LAB LIMITED

MAIN OFFICE  
1521 PEMBERTON AVE.  
NORTH VANCOUVER, B.C. V7P 2S3  
(604) 966-5211 TELEX: 04-352578

BRANCH OFFICE  
1630 PANDORA ST.  
VANCOUVER, B.C. V5L 1L8  
(604) 251-5656

REPORT NUMBER: 870116 AA

JOB NUMBER: 870116

NORTHAIR MINES LTD.

PAGE 9 OF 11

SAMPLE #	Cu		Au	
	%	oz/st	%	oz/st
49416	.43	.058	--	--
49417	.42	.132	--	--
49418	.32	.136	--	--
49419	.34	.084	--	--
49420	.15	.016	.16	.014
49421	.22	.006	--	--
49422	.17	.005	--	--
49423	.23	.005	--	--
49424	.29	.020	--	--
49425	.22	.038	.22	.042
49426	.14	.026	--	--
49427	.12	.014	--	--
49428	.10	.018	--	--
49429	.29	.058	--	--
49430	.50	.086	.52	.076
49431	.34	.088	--	--
49432	.22	.074	--	--
49433	.16	.016	--	--
49434	.09	.006	--	--
49435	.10	.005	.11	.005

DETECTION LIMIT

1 Troy oz/short ton = 34.28 ppm

.01

1 ppm = 0.0001%

.005

ppm = parts per million

.01

.005

( = less than

signed: \_\_\_\_\_



# VANGEOCHEM LAB LIMITED

MAIN OFFICE  
1521 PEMBERTON AVE.  
NORTH VANCOUVER, B.C. V7P 2S3  
(604) 906-5211 TELEX: 04-352578

BRANCH OFFICE  
1630 PANDORA ST.  
VANCOUVER, B.C. V5L 1L6  
(604) 251-6656

REPORT NUMBER: 870116 AA

JOB NUMBER: 870116

NORThAIR MINES LTD.

PAGE 10 OF 11

SAMPLE #	Cu		Au	
	%	oz/st	%	oz/st
49436	.10	<.005	--	--
49437	.11	<.005	--	--
49438	.08	.010	--	--
49439	.10	.005	--	--
49440	.06	.005	.08	.005
49441	1.90	.052	--	--
49442	.31	.064	--	--
49443	.36	.034	--	--
49444	.33	.024	--	--
49445	.32	.036	.32	.040
49446	.40	.018	--	--
49447	.31	.024	--	--
49448	.39	.076	--	--
49449	.40	.022	--	--
49450	.23	.032	.24	.044
49451	.17	.005	--	--
49452	.10	.006	--	--
49453	.12	.006	--	--
49454	.11	.010	--	--
06924A	2.50	.110	--	--

DETECTION LIMIT

1 Troy oz/short ton = 34.28 ppm

.01      .005      .01      .005  
1 ppm = 0.0001%      ppm = parts per million      (= less than

signed: \_\_\_\_\_





# VANGEOCHEM LAB LIMITED

MAIN OFFICE  
1521 PEMBERTON AVE.  
NORTH VANCOUVER, B.C. V7P 2S3  
(604) 966-5211 TELEX: 04-362578

BRANCH OFFICE  
1630 PANDORA ST.  
VANCOUVER, B.C. V6L 1L6  
(604) 251-5656

REPORT NUMBER: 870116 AA

JOB NUMBER: 870116

NORTHAIR MINES LTD.

PAGE 11 OF 11

SAMPLE #	Cu %	Au oz/st	Cu %	Au oz/st
06924B	1.04	.222	---	---
06925A	.84	.164	---	---
06925B	.96	.242	---	---

### DETECTION LIMIT

1 Troy oz/short ton = 34.28 ppm

.01

1 ppm = 0.0001%

.005

ppm = parts per million

.01

.005

( = less than

signed: \_\_\_\_\_



# VANGEOCHEM LAB LIMITED

MAIN OFFICE  
1521 PEMBERTON AVE.  
NORTH VANCOUVER, B.C. V7P 2S3  
(604) 986-5211 TELEX: 04-352578

BRANCH OFFICE  
1630 PANDORA ST.  
VANCOUVER, B.C. V5L 1L6  
(604) 251-5656

## ASSAY ANALYTICAL REPORT

=====

CLIENT: NORTHAIR MINES LTD.  
ADDRESS: 860 - 625 Howe Street  
: Vancouver, B.C.  
: V6C 2T6

DATE: Feb 11 1987

REPORT#: 870113 AA  
JOB#: 870113

PROJECT#: WILLA  
SAMPLES ARRIVED: Feb 5 1987  
REPORT COMPLETED: Feb 11 1987  
ANALYSED FOR: Cu Au Cu Au

INVOICE#: 870113 NA  
TOTAL SAMPLES: 79  
REJECTS/PULPS: 90 DAYS/1 YR  
SAMPLE TYPE: 79 ROCK

SAMPLES FROM: New Denver, B.C.  
COPY SENT TO: New Denver, B.C.

PREPARED FOR: MR. ROB BECKETT

ANALYSED BY: David Chiu

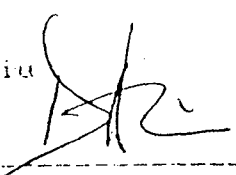
SIGNED: 

-----  
Registered Provincial Assayer

GENERAL REMARK: None



# VANGEOCHEM LAB LIMITED

MAIN OFFICE  
1521 PEMBERTON AVE.  
NORTH VANCOUVER, B.C. V7P 2S3  
(604) 986-5211 TELEX: 04-352578

BRANCH OFFICE  
1630 PANDORA ST.  
VANCOUVER, B.C. V5L 1L6  
(604) 251-5656

REPORT NUMBER: 870113 AA

JOB NUMBER: 870113

NORTHAIR MINES LTD.

PAGE 1 OF 4

SAMPLE #	Cu %	Au oz/st	Cu %	Au oz/st
00441	1.40	.184	---	---
00442	1.73	.275	---	---
00443	.44	.080	---	---
00444	.29	.054	---	---
00445	.30	.070	.27	.060
00446	.64	.090	---	---
00447	.70	.156	---	---
00448	.84	.254	---	---
00449	.74	.188	---	---
00450	.70	.108	.80	.120
00515	.92	.152	.94	.136
00516	.94	.230	---	---
00517	.62	.096	---	---
00518	.77	.112	---	---
00519	.46	.234	---	---
00520	1.35	.146	1.20	.150
00521	.67	.130	---	---
00522	1.40	.130	---	---
00523	1.35	.132	---	---
00524	.51	.082	---	---

DETECTION LIMIT

1 Troy oz/short ton = 34.28 ppm

.01

1 ppm = 0.0001%

.005

ppm = parts per million

.01

.005

( = less than

signed: \_\_\_\_\_



# VANGEOCHEM LAB LIMITED

MAIN OFFICE  
1521 PEMBERTON AVE.  
NORTH VANCOUVER, B.C. V7P 2S3  
(604) 986-5211 TELEX: 04-352578

BRANCH OFFICE  
1630 PANDORA ST.  
VANCOUVER, B.C. V5L 1L6  
(604) 251-5656

REPORT NUMBER: 870113 AA

JOB NUMBER: 870113

NORTHAIR MINES LTD.

PAGE 3 OF 4

SAMPLE #	Cu %	Au oz/st	Cu %	Au oz/st
00562	.17	.028	--	--
00563	.17	.020	--	--
00564	.37	.056	--	--
00565	.40	.190	.37	.194
00566	.39	.152	--	--
00567	.41	.094	--	--
00568	1.30	.308	--	--
00569	.84	.210	--	--
00570	.47	.082	.40	.084
00571	.52	.080	--	--
00572	.55	.074	--	--
00573	.58	.056	--	--
00574	.92	.124	--	--
00575	.64	.148	.67	.166
00576	.60	.126	--	--
00577	.31	.102	--	--
00578	.90	.212	--	--
00579	.21	.016	--	--
00580	.25	.022	.21	.016
00581	.33	.036	--	--

DETECTION LIMIT

1 Troy oz/short ton = 34.28 ppm

.01  
1 ppm = 0.0001%

.005 .01  
ppm = parts per million

.005  
( = less than

signed: \_\_\_\_\_



# VANGEOCHEM LAB LIMITED

MAIN OFFICE  
1521 PEMBERTON AVE.  
NORTH VANCOUVER, B.C. V7P 2S3  
(604) 968-5211 TELEX: 04-352578

BRANCH OFFICE  
1630 PANDORA ST.  
VANCOUVER, B.C. V5L 1L6  
(604) 251-5656

REPORT NUMBER: 870113 AA

JOB NUMBER: 870113

NORTHAIR MINES LTD.

SAMPLE #	Cu %	Au oz/st	Cu %	Au oz/st
00582	.66	.024	---	---
00583	.54	.034	---	---
00584	.36	.056	---	---
00585	.37	.044	.38	.044
00586	.41	.062	---	---
00587	.54	.074	---	---
00588	.33	.060	---	---
00589	.57	.210	---	---
00590	.48	.064	.51	.082
00591	.08	.010	---	---
00592	.25	.066	---	---
00593	.54	.028	---	---
00594	1.04	.054	---	---
00595	.53	.034	.51	.040
00596	.86	.046	---	---
00597	.37	.038	---	---
00598	.40	.046	---	---
00599	.26	.020	---	---
00600	.52	(.005	.49	(.005

DETECTION LIMIT

1 Troy oz/short ton = 34.28 ppm

.01  
1 ppm = 0.0001%

.005  
ppm = parts per million

.01  
( = less than

signed: \_\_\_\_\_



# VANGEOCHEM LAB LIMITED

MAIN OFFICE  
1521 PEMBERTON AVE.  
NORTH VANCOUVER, B.C. V7P 2S3  
(604) 966-5211 TELEX: 04-352578

BRANCH OFFICE  
1630 PANDORA ST.  
VANCOUVER, B.C. V5L 1L6  
(604) 251-5656

## =====

### ASSAY ANALYTICAL REPORT

## =====

CLIENT: NORTHAIR MINES LTD.  
ADDRESS: 860 - 625 Howe Street  
: Vancouver, B.C.  
: V6C 2T6

DATE: Feb 10 1987

REPORT#: 870091 AA  
JOB#: 870091

PROJECT#: WILLA  
SAMPLES ARRIVED: Jan 28 1987  
REPORT COMPLETED: Feb 10 1987  
ANALYSED FOR: Cu Au Cu Au

INVOICE#: 870091 NA  
TOTAL SAMPLES: 202  
REJECTS/PULPS: 30 DAYS/1 YR  
SAMPLE TYPE: 202 SLUDGE

SAMPLES FROM: New Denver, B.C.  
COPY SENT TO: New Denver, B.C.

PREPARED FOR: MR. ROB BECKETT

ANALYSED BY: David Chiu

SIGNED: \_\_\_\_\_

Registered Provincial Assayer

GENERAL REMARK: None



# VANGEOCHEM LAB LIMITED

MAIN OFFICE  
1521 PEMBERTON AVE.  
NORTH VANCOUVER, B.C. V7P 2S3  
(604) 986-5211 TELEX: 04-352578

BRANCH OFFICE  
1630 PANDORA ST.  
VANCOUVER, B.C. V5L 1L6  
(604) 251-5656

REPORT NUMBER: 870091 AA

JOB NUMBER: 870091

NORTH AIR MINES LTD.

PAGE 2 OF 11

SAMPLE #	Cu %	Au oz/st	Cu %	Au oz/st
00261	.20	.016	--	--
00262	.66	.035	--	--
00263	.64	.118	--	--
00264	1.62	.034	--	--
00265	.91	.088	.84	.054
00266	.35	.020	--	--
00267	.26	.028	--	--
00268	.45	.032	--	--
00269	.50	.036	--	--
00270	.57	.056	.54	.018
00271	.34	.062	--	--
00272	.25	.044	--	--
00273	.41	.028	--	--
00274	.30	.010	--	--
00275	.22	.005	.23	.024
00276	.34	.012	--	--
00277	.37	.066	--	--
00278	1.58	.180	--	--
00279	.92	.124	--	--
00280	1.16	.060	1.07	.152

**DETECTION LIMIT**

1 Troy oz/short ton = 34.28 ppm

.01  
1 ppm = 0.0001%

.005  
ppm = parts per million

.01  
( = less than

signed: \_\_\_\_\_



# VANGEOCHEM LAB LIMITED

MAIN OFFICE  
1521 PEMBERTON AVE.  
NORTH VANCOUVER, B.C. V7P 2S3  
(604) 966-5211 TELEX: 04-352578

BRANCH OFFICE  
1630 PANDORA ST.  
VANCOUVER, B.C. V5L 1L6  
(604) 251-5656

REPORT NUMBER: 870091 AA

JOB NUMBER: 870091

NORTH AIR MINES LTD.

PAGE 3 OF 11

SAMPLE #	Cu %	Au oz/st	Cu %	Au oz/st
00281	2.40	.550	--	--
00282	.62	.064	--	--
00283	.45	.056	--	--
00284	3.40	.474	--	--
00285	3.60	.460	3.50	.050
00286	1.12	.143	--	--
00287	1.04	.150	--	--
00288	.71	.130	--	--
00289	.26	.020	--	--
00290	.44	.082	.43	.032
00291	1.80	.126	--	--
00292	.70	.158	--	--
00293	2.60	.450	--	--
00294	.43	.084	--	--
00295	.16	.020	.16	.016
00296	.22	.028	--	--
00297	.11	.028	--	--
00298	.07	.010	--	--
00299	.55	.046	--	--
00300	.76	.178	.70	.026

**DETECTION LIMIT**

1 Troy oz/short ton = 34.28 ppm

.01

1 ppm = 0.0001%

.005

ppm parts per million

.01

.005

( = less than

signed: \_\_\_\_\_





# VANGEOCHEM LAB LIMITED

MAIN OFFICE  
1521 PEMBERTON AVE.  
NORTH VANCOUVER, B.C. V7P 2S3  
(604) 966-5211 TELEX: 04-352578

BRANCH OFFICE  
1630 PANDORA ST.  
VANCOUVER, B.C. V5L 1L6  
(604) 251-5656

REPORT NUMBER: 870091 AA

JOB NUMBER: 870091

NORTHAIR MINES LTD.

PAGE 4 OF 11

SAMPLE #	Cu %	Au oz/st	Cu %	Au oz/st
00301	.24	.008	--	--
00302	.21	.012	--	--
00303	.14	.010	--	--
00304	.35	.018	--	--
00305	.32	.012	.30	.040
00306	.43	.005	--	--
00307	.25	.022	--	--
00308	.24	.010	--	--
00309	.39	.012	--	--
00310	.33	.014	.32	.030
00311	.31	.006	--	--
00312	.19	.005	--	--
00313	.29	.014	--	--
00314	.26	.020	--	--
00315	.23	.026	.23	.028
00316	.18	.026	--	--
00317	.30	.082	--	--
00318	.86	.094	--	--
00319	.45	.044	--	--
00320	.60	.030	.52	.032

DETECTION LIMIT

1 Troy oz/short ton = 34.28 ppm

1 ppm = 0.0001%

.01      .005      .01      .005  
ppm = parts per million

( = less than

signed: \_\_\_\_\_



# VANGEOCHEM LAB LIMITED

MAIN OFFICE  
1521 PEMBERTON AVE.  
NORTH VANCOUVER, B.C. V7P 2S3  
(604) 986-5211 TELEX: 04-352578

BRANCH OFFICE  
1630 PANDORA ST.  
VANCOUVER, B.C. V5L 1L6  
(604) 251-5656

REPORT NUMBER: 870091 AA

JOB NUMBER: 870091

NORTH AIR MINES LTD.

PAGE 5 OF 11

SAMPLE #	Cu %	Au oz/st	Cu %	Au oz/st
00321	.64	.036	--	--
00322	1.12	.024	--	--
00323	.16	.008	--	--
00324	.81	.112	--	--
00325	.51	.194	.56	.050
00326	1.08	.332	--	--
00327	.70	.272	--	--
00328	.76	.302	--	--
00329	.98	.152	--	--
00330	.97	.726	1.10	.272
00331	1.45	.668	--	--
00332	.50	.134	--	--
00333	.45	.146	--	--
00334	.92	.478	--	--
00335	1.53	.248	1.55	.142
00336	2.45	.372	--	--
00337	2.32	.166	--	--
00338	2.75	.156	--	--
00339	1.03	.088	--	--
00340	1.95	.076	1.95	.088

DETECTION LIMIT

1 Troy oz/short ton = 34.28 ppm

.01

1 ppm = 0.0001%

.005

ppm = parts per million

.01

.005

( = less than

signed: \_\_\_\_\_



# VANGEOCHEM LAB LIMITED

MAIN OFFICE  
1521 PEMBERTON AVE.  
NORTH VANCOUVER, B.C. V7P 2S3  
(604) 986-5211 TELEX: 04-352578

BRANCH OFFICE  
1630 PANDORA ST.  
VANCOUVER, B.C. V5L 1L6  
(604) 251-5656

REPORT NUMBER: 870091 AA

JOB NUMBER: 870091

NORTHAIR MINES LTD.

PAGE 6 OF 11

SAMPLE #	Cu		Au	
	%	oz/st	%	oz/st
00341	.70	.548	--	--
00342	.01	.104	--	--
00343	.20	.056	--	--
00344	.74	.090	--	--
00345	.55	.090	.58	.062
00346	.98	.058	--	--
00347	.38	.040	--	--
00348	.72	.042	--	--
00349	.27	.026	--	--
00350	.16	.008	.15	.012
00351	.45	.016	--	--
00352	.14	.018	--	--
00353	.18	.014	--	--
00354	.27	.026	--	--
00355	.62	.068	.56	.062
00356	.86	.170	--	--
00357	1.02	.282	--	--
00359	.68	.090	--	--
00360	.74	.258	.70	.312
00361	.15	.005	--	--

**DETECTION LIMIT**

1 Troy oz/short ton = 34.28 ppm

.01

1 ppm = 0.0001%

.005

ppm = parts per million

.01

.005

(&lt; = less than

signed: \_\_\_\_\_



# VANGEOCHEM LAB LIMITED

MAIN OFFICE  
1521 PEMBERTON AVE.  
NORTH VANCOUVER, B.C. V7P 2S3  
(604) 966-5211 TELEX: 04-352578

BRANCH OFFICE  
1630 PANDORA ST.  
VANCOUVER, B.C. V5L 1L6  
(604) 251-5656

REPORT NUMBER: B70091 AA

JOB NUMBER: B70091

NORTH AIR MINES LTD.

PAGE 7 OF 11

SAMPLE #	Cu %	Au oz/st	Cu %	Au oz/st
00362	.06	.005	--	--
00363	.25	.026	--	--
00364	.51	.116	--	--
00365	.49	.122	.47	.144
00366	.38	.098	--	--
00367	.30	.098	--	--
00368	.42	.096	--	--
00369	.45	.136	--	--
00370	.64	.224	.62	.182
00371	.16	.014	--	--
00372	.04	.010	--	--
00373	.09	.012	--	--
00374	.28	.116	--	--
00375	.29	.084	.31	.108
00376	.86	1.018	--	--
00377	1.02	.714	--	--
00378	.51	.268	--	--
00379	.37	.108	--	--
00380	.25	.058	.25	.060
00381	.37	.080	--	--

### DETECTION LIMIT

1 Troy oz/short ton = 34.28 ppm

.01  
1 ppm = 0.0001%

.005  
ppm = parts per million

.01  
( = less than

signed: \_\_\_\_\_



# VANGEOCHEM LAB LIMITED

MAIN OFFICE  
1521 PEMBERTON AVE.  
NORTH VANCOUVER, B.C. V7P 2S3  
(604) 986-5211 TELEX: 04-352578

BRANCH OFFICE  
1630 PANDORA ST.  
VANCOUVER, B.C. V5L 1L6  
(604) 251-5656

REPORT NUMBER: 870091 AA

JOB NUMBER: 870091

NORTH AIR MINES LTD.

PAGE 8 OF 11

SAMPLE #	Cu %	Au oz/st	Cu %	Au oz/st
49268	.51	.072	---	---
49269	.98	.090	---	---
49270	.53	.116	.52	.094
49271	.28	.014	---	---
49272	.32	.026	---	---
49273	.53	.052	---	---
49274	.87	.082	---	---
49275	1.14	.114	1.08	.092
49276	1.85	.468	---	---
49277	1.14	.102	---	---
49278	1.12	.316	---	---
49279	.76	.092	---	---
49280	.66	.036	.58	.052
49281	2.20	.008	---	---
49282	.18	.010	---	---
49283	.29	.010	---	---
49284	1.40	.054	---	---
49285	1.90	.018	1.60	.020
49286	1.80	.216	---	---
49287	.94	.214	---	---

**DETECTION LIMIT**

1 Troy oz/short ton = 34.28 ppm

.01

1 ppm = 0.0001%

.005

ppm = parts per million

.01

.005

( = less than

signed: \_\_\_\_\_



# VANGEOCHEM LAB LIMITED

MAIN OFFICE  
 1521 PEMBERTON AVE.  
 NORTH VANCOUVER, B.C. V7P 2S3  
 (604) 986-5211 TELEX: 04-352578

BRANCH OFFICE  
 1630 PANDORA ST.  
 VANCOUVER, B.C. V5L 1L6  
 (604) 251-5656

REPORT NUMBER: 870091 AA

JOB NUMBER: 870091

NORTHAIR MINES LTD.

PAGE 9 OF 11

SAMPLE #	Cu %	Au oz/st	Cu %	Au oz/st
49288	.50	.060	---	---
49289	.51	.042	---	---
49290	.55	.038	.48	.050
49291	.57	.022	---	---
49292	.43	.040	---	---
49293	.51	.100	---	---
49294	.68	.086	---	---
49295	.74	.200	.66	.108
49296	.78	.082	---	---
49297	.94	.114	---	---
06908A	.92	.154	---	---
06908B	.41	.054	---	---
06909A	.13	.022	---	---
06909B	.11	.016	---	---
06910A	.21	.056	---	---
06910B	.33	.242	---	---
06911A	.12	.014	---	---
06911B	.08	.018	---	---
06912A	.53	.050	---	---
06912B	.62	.048	---	---

DETECTION LIMIT

1 Troy oz/short ton = 34.28 ppm      .01 ppm = 0.0001%      .005 ppm = parts per million      .005 (= less than

signed: \_\_\_\_\_



# VANGEOCHEM LAB LIMITED

MAIN OFFICE  
1521 PEMBERTON AVE.  
NORTH VANCOUVER, B.C. V7P 2S3  
(604) 986-5211 TELEX: 04-352578

BRANCH OFFICE  
1630 PANDORA ST.  
VANCOUVER, B.C. V5L 1L6  
(604) 251-5656

REPORT NUMBER: 870091 AA

JOB NUMBER: 870091

NORTHAIR MINES LTD.

PAGE 10 OF 11

SAMPLE #	Cu %	Au oz/st	Cu %	Au oz/st
06913A	.52	.048	---	---
06913B	.27	.028	---	---
06914A	.78	.228	---	---
06914B	.36	.212	---	---
06915A	.80	.314	---	---
06915B	1.08	.220	---	---
06916A	.33	.020	---	---
06916B	.52	.030	---	---
06917A	.44	.040	---	---
06917B	.64	.114	---	---
06918A	.16	.034	---	---
06918B	.24	.034	---	---
06919A	.32	.012	---	---
06919B	.43	.012	---	---
06920A	.30	.168	---	---
06920B	.20	.006	---	---
06921A	.45	.066	---	---
06921B	.81	.380	---	---
06922A	.38	.064	---	---
06922B	.40	.012	---	---

**DETECTION LIMIT**

1 Troy oz/short ton = 34.28 ppm

.01

1 ppm = 0.0001%

.005

ppm = parts per million

.01

.005

( = less than

signed: \_\_\_\_\_



# VANGEOCHEM LAB LIMITED

MAIN OFFICE  
1521 PEMBERTON AVE.  
NORTH VANCOUVER, B.C. V7P 2S3  
(604) 986-5211 TELEX: 04-352578

BRANCH OFFICE  
1630 PANDORA ST.  
VANCOUVER, B.C. V5L 1L6  
(604) 251-5656

REPORT NUMBER: 870091 AA

JOB NUMBER: 870091

NORTHAIR MINES LTD.

PAGE 11 OF 11

SAMPLE #	Cu		Au	
	%	oz/st	%	oz/st
06923A	.35	.056	--	--
06923B	1.02	.058	--	--

### DETECTION LIMIT

1 Troy oz/short ton = 34.28 ppm

.01

1 ppm = 0.0001%

.005

ppm = parts per million

.01

.005

( = less than

signed: \_\_\_\_\_





# VANGEOCHEM LAB LIMITED

MAIN OFFICE  
1521 PEMBERTON AVE.  
NORTH VANCOUVER, B.C. V7P 2S3  
(604) 986-5211 TELEX: 04-352578

BRANCH OFFICE  
1630 PANDORA ST.  
VANCOUVER, B.C. V5L 1L6  
(604) 251-5656

## ASSAY ANALYTICAL REPORT

=====

CLIENT: NORTHAIR MINES LTD.  
ADDRESS: 860 625 Howe Street  
: Vancouver, B.C.  
: V6C 2T6

DATE: Feb 4 1987

REPORT#: 870083 AA  
JOB#: 870083

PROJECT#: WILLA  
SAMPLES ARRIVED: Jan 28 1987  
REPORT COMPLETED: Feb 4 1987  
ANALYSED FOR: Cu Au Cu Au

INVOICE#: 870083 NA  
TOTAL SAMPLES: 120  
REJECTS/PULPS: 00 DAYS/1 YR  
SAMPLE TYPE: 120 DRILL CORE

SAMPLES FROM: New Denver, B.C.  
COPY SENT TO: New Denver, B.C.

PREPARED FOR: MR. ROB BECKETT

ANALYSED BY: David Chiu

SIGNED:

Registered Provincial Assayer

GENERAL REMARK: None



# VANGEOCHEM LAB LIMITED

MAIN OFFICE  
1521 PEMBERTON AVE.  
NORTH VANCOUVER, B.C. V7P 2S3  
(604) 906-5211 TELEX: 04-352578

BRANCH OFFICE  
1630 PANDORA ST.  
VANCOUVER, B.C. V5L 1L6  
(604) 251-5656

REPORT NUMBER: 870083 AA

JOB NUMBER: 870083

NORTH AIR MINES LTD.

PAGE 1 OF 6

SAMPLE #	Cu		Au	
	%	oz/st	%	oz/st
00201	.70	.070	---	---
00202	.38	.040	---	---
00203	.74	.102	---	---
00204	.25	.042	---	---
00205	.43	.088	.44	.120
00206	.82	.164	---	---
00207	.56	.084	---	---
00208	.62	.144	---	---
00209	.24	.034	---	---
00210	.17	.026	.16	.020
00211	.71	.066	---	---
00212	.64	.082	---	---
00213	.72	.192	---	---
00214	.42	.102	---	---
00215	.37	.068	.39	.062
00216	.28	.060	---	---
00217	.29	.038	---	---
00218	.19	.012	---	---
00219	.25	.016	---	---
00220	.38	.016	.38	.018

DETECTION LIMIT

1 Troy oz/short ton = 34.28 ppm

.01

1 ppm = 0.0001%

.005

ppm = parts per million

.01

.005

( = less than

signed: \_\_\_\_\_



# VANGEOCHEM LAB LIMITED

MAIN OFFICE  
1521 PEMBERTON AVE.  
NORTH VANCOUVER, B.C. V7P 2S3  
(604) 986-5211 TELEX: 04-352578

BRANCH OFFICE  
1630 PANDORA ST.  
VANCOUVER, B.C. V5L 1L6  
(604) 251-5656

REPORT NUMBER: 870083 AA

JOB NUMBER: 870083

NORTH AIR MINES LTD.

PAGE 2 OF 6

SAMPLE #	Cu %	Au oz/st	Cu %	Au oz/st
00221	.34	.036	---	---
00222	.34	.036	---	---
00223	.19	.044	---	---
00224	.12	.004	---	---
00225	1.12	.078	1.30	.126
00226	.84	.136	---	---
00227	.53	.124	---	---
00228	.41	.126	---	---
00229	.86	.134	---	---
00230	.80	.120	.78	.140
00231	.94	.150	---	---
00232	.17	.154	---	---
00233	.46	.076	---	---
00234	.46	.092	---	---
00235	.30	.072	.30	.060
00236	.47	.178	---	---
00237	.60	.310	---	---
00238	.62	.146	---	---
00239	.58	.394	---	---
00240	.56	.166	.57	.164

### DETECTION LIMIT

1 Troy oz/short ton = 34.28 ppm

.01  
1 ppm = 0.0001%

.005  
ppm = parts per million

.005  
( = less than

signed: \_\_\_\_\_



# VANGEOCHEM LAB LIMITED

MAIN OFFICE  
1521 PEMBERTON AVE.  
NORTH VANCOUVER, B.C. V7P 2S3  
(604) 966-5211 TELEX: 04-352578

BRANCH OFFICE  
1630 PANDORA ST.  
VANCOUVER, B.C. V5L 1L6  
(604) 251-5656

REPORT NUMBER: 870083 AA

JOB NUMBER: 870083

NORTH AIR MINES LTD.

PAGE 3 OF 6

SAMPLE #	Cu %	Au oz/st	Cu %	Au oz/st
48291	.45	.044	--	--
48292	.55	.026	--	--
48293	.32	.024	--	--
48294	.62	.056	--	--
48295	.54	.030	.58	.032
48296	.50	.020	--	--
48297	1.00	.100	--	--
48298	.78	.062	--	--
48299	.58	.052	--	--
48300	1.08	.356	1.02	.168
48301	1.02	.114	--	--
48302	.65	.128	--	--
48303	.81	.104	--	--
48304	.35	.006	--	--
48305	.44	.016	.49	.024
48306	.30	<.005	--	--
48307	.12	<.005	--	--
48308	.36	.084	--	--
48309	1.40	.276	--	--
48310	.43	.066	.43	.060

### DETECTION LIMIT

1 Troy oz/short ton = 34.28 ppm

.01 ppm = 0.0001%

.005 ppm = parts per million

.005 (= less than

signed: \_\_\_\_\_

# VANGEOCHEM LAB LIMITED

MAIN OFFICE  
1521 PEMBERTON AVE.  
NORTH VANCOUVER, B.C. V7P 2S3  
(604) 986-5211 TELEX: 04-352578

BRANCH OFFICE  
1630 PANDORA ST.  
VANCOUVER, B.C. V5L 1L6  
(604) 251-5656

REPORT NUMBER: 870083 AA

JOB NUMBER: 870083

NORTH AIR MINES LTD.

PAGE 4 OF 6

SAMPLE #	Cu %	Au oz/st	Cu %	Au oz/st
48311	.68	.084	--	--
48312	.26	.026	--	--
48313	.03	<.005	--	--
48314	.21	.016	--	--
48315	.23	.022	.22	.028
48316	.33	.046	--	--
48317	.41	.064	--	--
48318	.32	.024	--	--
48319	.37	.036	--	--
48320	.50	.034	.51	.034
48321	.42	.030	--	--
48322	.50	.024	--	--
48323	.53	.050	--	--
48324	1.08	.118	--	--
48325	.92	.134	.96	.132
48326	.84	.096	--	--
48327	1.14	.170	--	--
48328	.80	.104	--	--
48329	.51	.044	--	--
48330	.25	<.005	.18	<.005

**DETECTION LIMIT**

1 Troy oz/short ton = 34.28 ppm

.01  
1 ppm = 0.0001%

.005  
ppm = parts per million

.01  
( = less than

signed: \_\_\_\_\_



# VANGEOCHEM LAB LIMITED

MAIN OFFICE  
1521 PEMBERTON AVE.  
NORTH VANCOUVER, B.C. V7P 2S3  
(604) 906-5211 TELEX: 04-352578

BRANCH OFFICE  
1830 PANDORA ST.  
VANCOUVER, B.C. V5L 1L8  
(604) 251-6656

REPORT NUMBER: 870083 AA

JOB NUMBER: 870083

NORTHAIR MINES LTD.

SAMPLE #	Cu %	Au oz/st	Cu %	Au oz/st
48331	.06	.005	--	--
48332	.10	.005	--	--
48333	.70	.064	--	--
48334	1.50	.154	--	--
48335	.90	.076	1.02	.070
48336	1.56	.132	--	--
48337	.70	.068	--	--
48338	.51	.698	--	--
48339	1.00	.118	--	--
48340	.44	.076	.44	.060
48341	1.45	.128	--	--
48342	1.60	.226	--	--
48343	1.16	.120	--	--
48344	.66	.616	--	--
48345	.66	.090	.69	.082
48346	1.90	.262	--	--
48347	.28	.014	--	--
48348	.24	.016	--	--
48349	1.50	.120	--	--
48350	.92	.050	.98	.042

DETECTION LIMIT  
1 Troy oz/short ton = 34.28 ppm

.01 ppm = 0.0001%  
.005 ppm = parts per million  
.01 (= less than  
.005

signed: \_\_\_\_\_

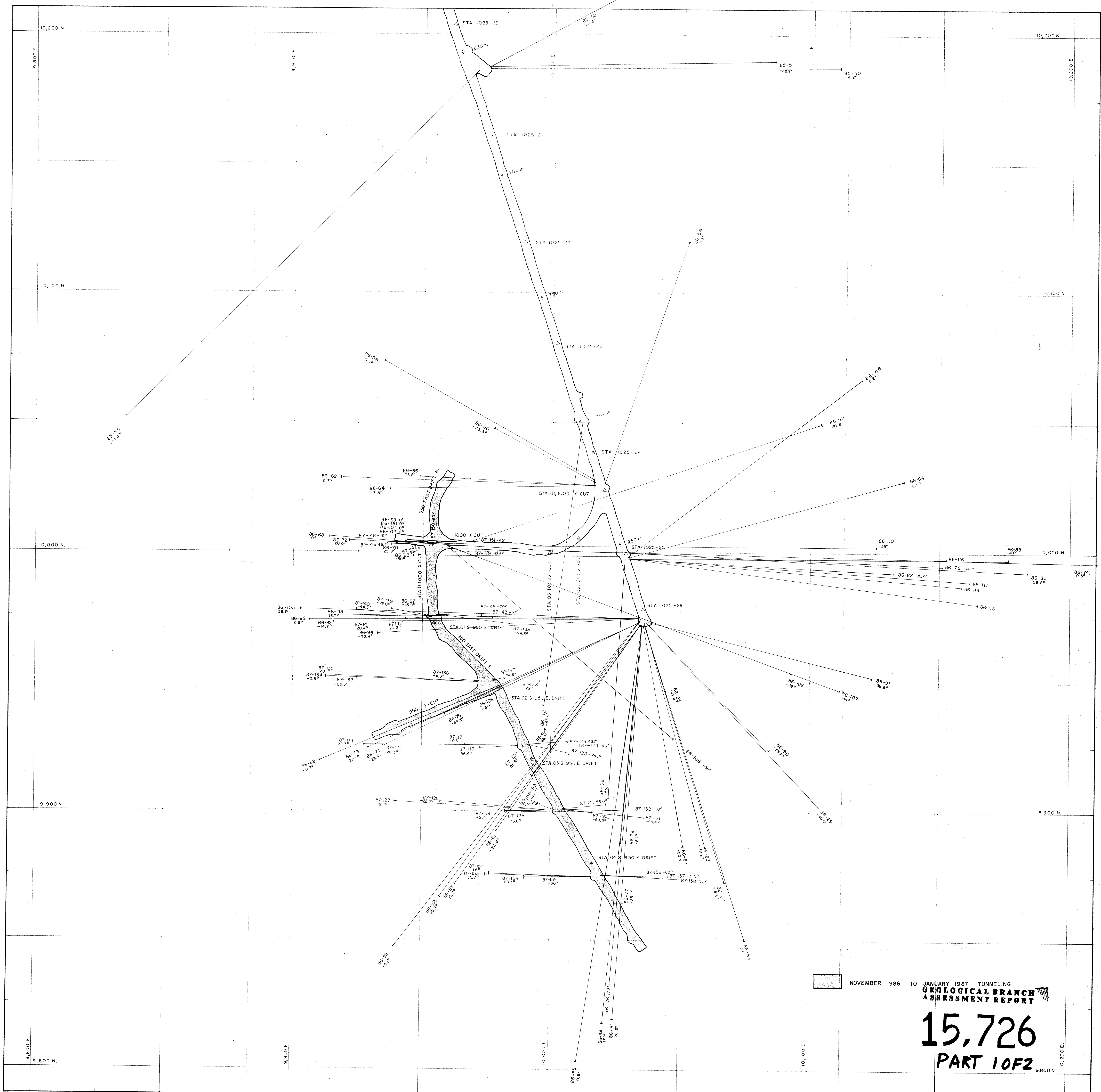

NOVEMBER 1986 TO JANUARY 1987 TUNNELING  
**GEOLOGICAL BRANCH**  
**ASSESSMENT REPORT**

**15,726**  
**PART 10F2**

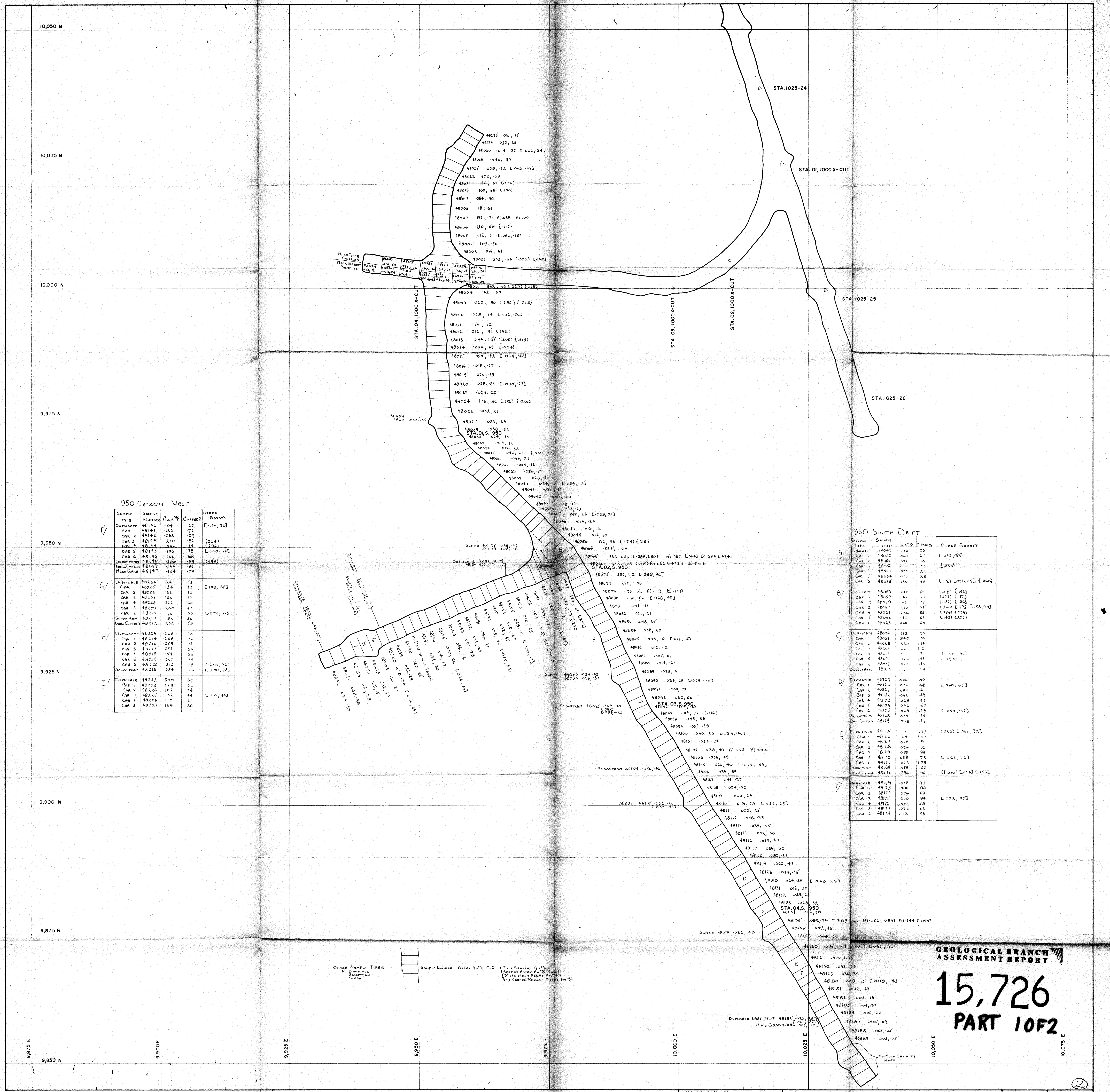

950 CROSSCUT - WEST

SAMPLE TYPE	SAMPLE NUMBER	Gold %	Copper %	Other Assays
Duplicate	48140	104	62	[144, 70]
CAR 1	48141	112	76	
CAR 2	48142	058	29	
CAR 3	48143	210	86	(204)
CAR 4	48144	206	74	(192)
CAR 5	48145	186	78	[140, 70]
CAR 6	48146	146	68	
Scoopgram	48147	200	82	(18)
Duplicate	48148	144	82	
Muck Grab	48149	144	74	
Duplicate	48204	104	42	
CAR 1	48205	112	45	[108, 42]
CAR 2	48206	152	51	
CAR 3	48207	184	47	
CAR 4	48208	222	40	
CAR 5	48209	200	47	
CAR 6	48210	192	40	
Scoopgram	48211	182	36	[102, 66]
Duplicate	48212	152	33	
Duplicate	48218	248	70	
CAR 1	48219	258	74	
CAR 2	48220	258	74	
CAR 3	48221	252	66	
CAR 4	48222	154	40	
CAR 5	48223	320	74	[128, 76]
CAR 6	48224	212	78	[120, 78]
Scoopgram	48225	254	70	
Duplicate	48222	300	60	
CAR 1	48223	178	56	
CAR 2	48224	106	44	
CAR 3	48225	134	44	
CAR 4	48226	110	57	[110, 44]
CAR 5	48227	144	56	

950 SOUTH DRIFT

SAMPLE TYPE	SAMPLE NUMBER	Gold %	Copper %	Other Assays
Duplicate	48043	050	25	
CAR 1	48044	044	26	[041, 55]
CAR 2	48045	092	30	
CAR 3	48046	050	33	[050]
CAR 4	48047	082	22	
CAR 5	48048	022	28	
CAR 6	48049	150	28	(112) [051, 25] [040]
Duplicate	48057	144	81	(118) [142]
CAR 1	48058	142	77	(174) [142]
CAR 2	48059	146	77	(181) [142]
CAR 3	48060	172	79	(120) [175] [188, 70]
CAR 4	48061	228	85	(224) [224]
CAR 5	48062	142	59	(142) [142]
CAR 6	48063	080	60	
Duplicate	48074	212	90	
CAR 1	48075	240	84	
CAR 2	48076	350	114	
CAR 3	48077	224	112	
CAR 4	48078	72	71	[144, 74]
CAR 5	48079	324	84	[124]
CAR 6	48080	402	110	
Scoopgram	48081	372	74	
Duplicate	48127	056	40	
CAR 1	48128	072	48	[060, 65]
CAR 2	48129	080	41	
CAR 3	48130	042	49	
CAR 4	48131	028	43	
CAR 5	48132	052	50	
CAR 6	48133	028	45	[040, 42]
Scoopgram	48134	054	44	
Duplicate	48129	058	47	
Duplicate	48145	114	37	(210) [061, 32]
CAR 1	48146	144	37	
CAR 2	48147	078	30	
CAR 3	48148	076	36	
CAR 4	48149	088	88	[061, 76]
CAR 5	48150	058	75	
CAR 6	48151	071	105	
Scoopgram	48152	068	80	(115) [114, 154]
Duplicate	48171	076	70	
CAR 1	48172	080	84	
CAR 2	48173	076	69	
CAR 3	48174	076	69	
CAR 4	48175	070	84	[072, 90]
CAR 5	48176	076	68	
CAR 6	48177	070	62	
CAR 6	48178	112	46	

OTHER SAMPLE TYPES  
 IF Duplicate  
 Scoopgram  
 Slush

SAMPLE NUMBER ASSAY Au% Cu% (PURE REAGENT Au% Cu%)  
 IF Duplicate  
 Scoopgram  
 Slush

**GEOLOGICAL BRANCH  
 ASSESSMENT REPORT**

**15,726  
 PART 10F2**



820 Crosscut West

Sample Number	Grade %	Copper %	Sample Number	Grade %	Copper %
A 05588	0.06	15	R 06490	0.10	21
B 05589	0.04	15	S 06491	0.04	11
C 05590	0.14	14	T 06492	0.00	15
D 05591	0.44	55	U 06493	0.58	54
E 05592	0.44	39	V 06494	0.26	34
F 05593	0.34	35	W 06495	0.16	18
G 05594	0.51	46	X 06496	0.52	34
H 05595	0.68	40	Y 06497	1.04	61
I 05596	1.14	53	Z 06498	1.12	78
J 05597	3.20	140	AA 06499	5.04	90
K 05598	2.08	79	AB 06500	1.64	90
L 05599	5.76	114	AC 06501	1.52	32
M 06486	348	100	AD 06502	8.14	174
N 06487	432	235	AE 06503	2.00	118
O 06488	408	331	AF 06504	2.12	194
P 06489	260	115	AG 06505	1.54	90
Q 06490	0.68	52	AH 06506	1.08	59
R 06491	0.68	71	AI 06507	0.92	73
S 06492	0.44	50	AJ 06508	0.28	38
T 06493	1.14	59	AK 06509	0.08	12
U 06494	0.16	15	AL 06510	0.08	19
V 06495	0.10	15	AM 06511	0.10	12

950 SOUTH

Sample Number	Grade %	Copper %	Sample Number	Grade %	Copper %
52-35m No Sample			53-34m	0.80	40
53-34m	0.80	40	54-33m	0.80	32
54-33m	0.80	32	55-32m	0.80	11
55-32m	0.88	23	56-31m	0.88	150
56-31m	0.88	150	57-30m	0.88	150
57-30m	0.88	150	58-29m	0.88	150
58-29m	0.88	150	59-28m	0.88	150
59-28m	0.88	150	60-27m	0.88	150
60-27m	0.88	150	61-26m	0.88	150
61-26m	0.88	150	62-25m	0.88	150
62-25m	0.88	150	63-24m	0.88	150
63-24m	0.88	150	64-23m	0.88	150
64-23m	0.88	150	65-22m	0.88	150
65-22m	0.88	150	66-21m	0.88	150
66-21m	0.88	150	67-20m	0.88	150
67-20m	0.88	150	68-19m	0.88	150
68-19m	0.88	150	69-18m	0.88	150
69-18m	0.88	150	70-17m	0.88	150
70-17m	0.88	150	71-16m	0.88	150
71-16m	0.88	150	72-15m	0.88	150
72-15m	0.88	150	73-14m	0.88	150
73-14m	0.88	150	74-13m	0.88	150
74-13m	0.88	150	75-12m	0.88	150
75-12m	0.88	150	76-11m	0.88	150
76-11m	0.88	150	77-10m	0.88	150
77-10m	0.88	150	78-9m	0.88	150
78-9m	0.88	150	79-8m	0.88	150
79-8m	0.88	150	80-7m	0.88	150
80-7m	0.88	150	81-6m	0.88	150
81-6m	0.88	150	82-5m	0.88	150
82-5m	0.88	150	83-4m	0.88	150
83-4m	0.88	150	84-3m	0.88	150
84-3m	0.88	150	85-2m	0.88	150
85-2m	0.88	150	86-1m	0.88	150
86-1m	0.88	150	87-0m	0.88	150

Sample Number	Grade %	Copper %	Sample Number	Grade %	Copper %
53-35m	0.12	18	54-34m	0.10	22
54-34m	0.10	22	55-33m	0.08	20
55-33m	0.08	20	56-32m	0.06	18
56-32m	0.06	18	57-31m	0.04	16
57-31m	0.04	16	58-30m	0.02	14
58-30m	0.02	14	59-29m	0.01	12
59-29m	0.01	12	60-28m	0.01	10
60-28m	0.01	10	61-27m	0.01	8
61-27m	0.01	8	62-26m	0.01	6
62-26m	0.01	6	63-25m	0.01	4
63-25m	0.01	4	64-24m	0.01	2
64-24m	0.01	2	65-23m	0.01	1
65-23m	0.01	1	66-22m	0.01	1
66-22m	0.01	1	67-21m	0.01	1
67-21m	0.01	1	68-20m	0.01	1
68-20m	0.01	1	69-19m	0.01	1
69-19m	0.01	1	70-18m	0.01	1
70-18m	0.01	1	71-17m	0.01	1
71-17m	0.01	1	72-16m	0.01	1
72-16m	0.01	1	73-15m	0.01	1
73-15m	0.01	1	74-14m	0.01	1
74-14m	0.01	1	75-13m	0.01	1
75-13m	0.01	1	76-12m	0.01	1
76-12m	0.01	1	77-11m	0.01	1
77-11m	0.01	1	78-10m	0.01	1
78-10m	0.01	1	79-9m	0.01	1
79-9m	0.01	1	80-8m	0.01	1
80-8m	0.01	1	81-7m	0.01	1
81-7m	0.01	1	82-6m	0.01	1
82-6m	0.01	1	83-5m	0.01	1
83-5m	0.01	1	84-4m	0.01	1
84-4m	0.01	1	85-3m	0.01	1
85-3m	0.01	1	86-2m	0.01	1
86-2m	0.01	1	87-1m	0.01	1
87-1m	0.01	1	88-0m	0.01	1

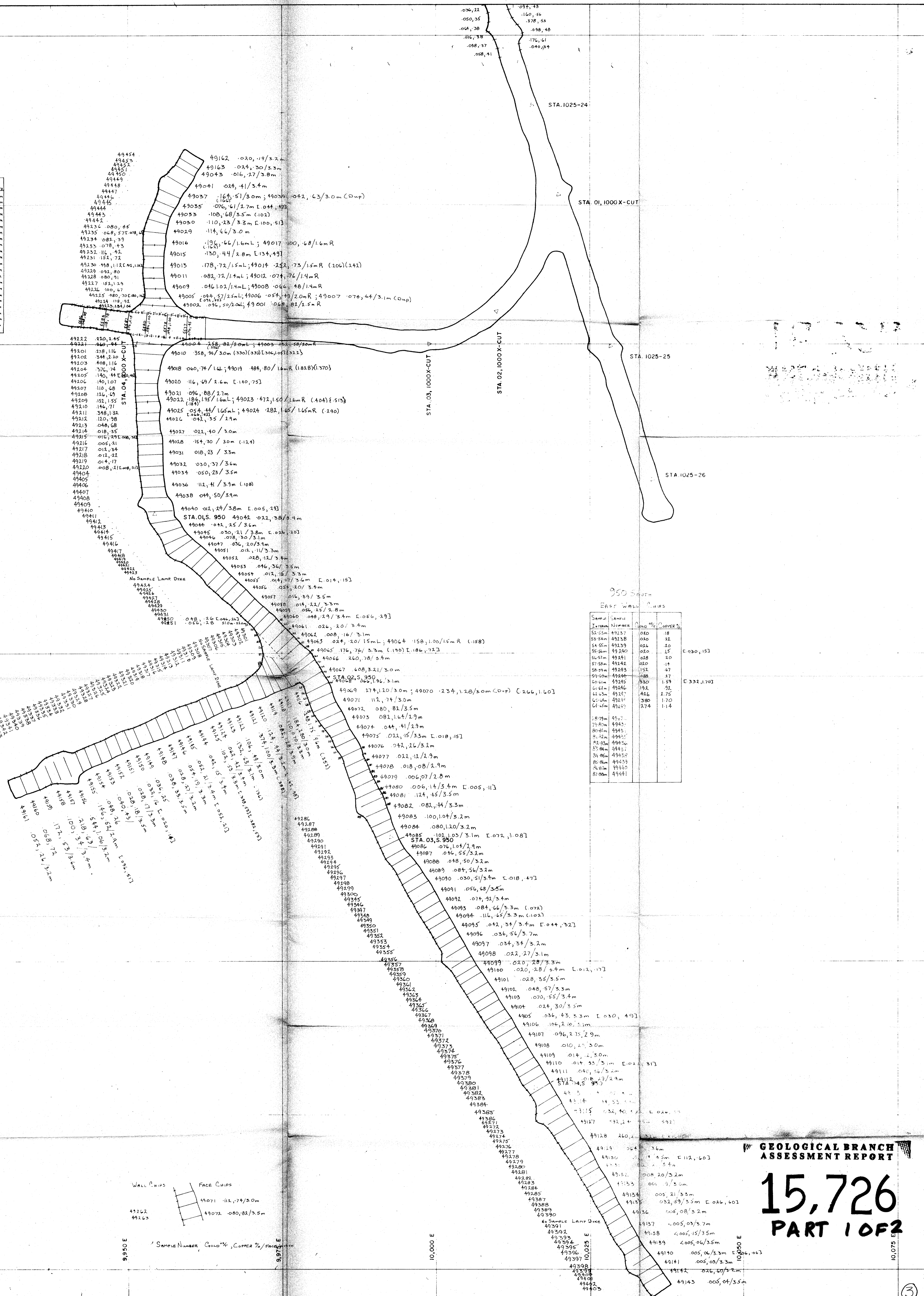

GEOLOGICAL BRANCH  
ASSESSMENT REPORT  
**15,726**  
PART 1 OF 2



NOVEMBER 1986 TO JANUARY 1987 TUNNELING  
 GEOLOGICAL BRANCH  
 ASSESSMENT REPORT

**15,726**  
 PART 1 OF 2

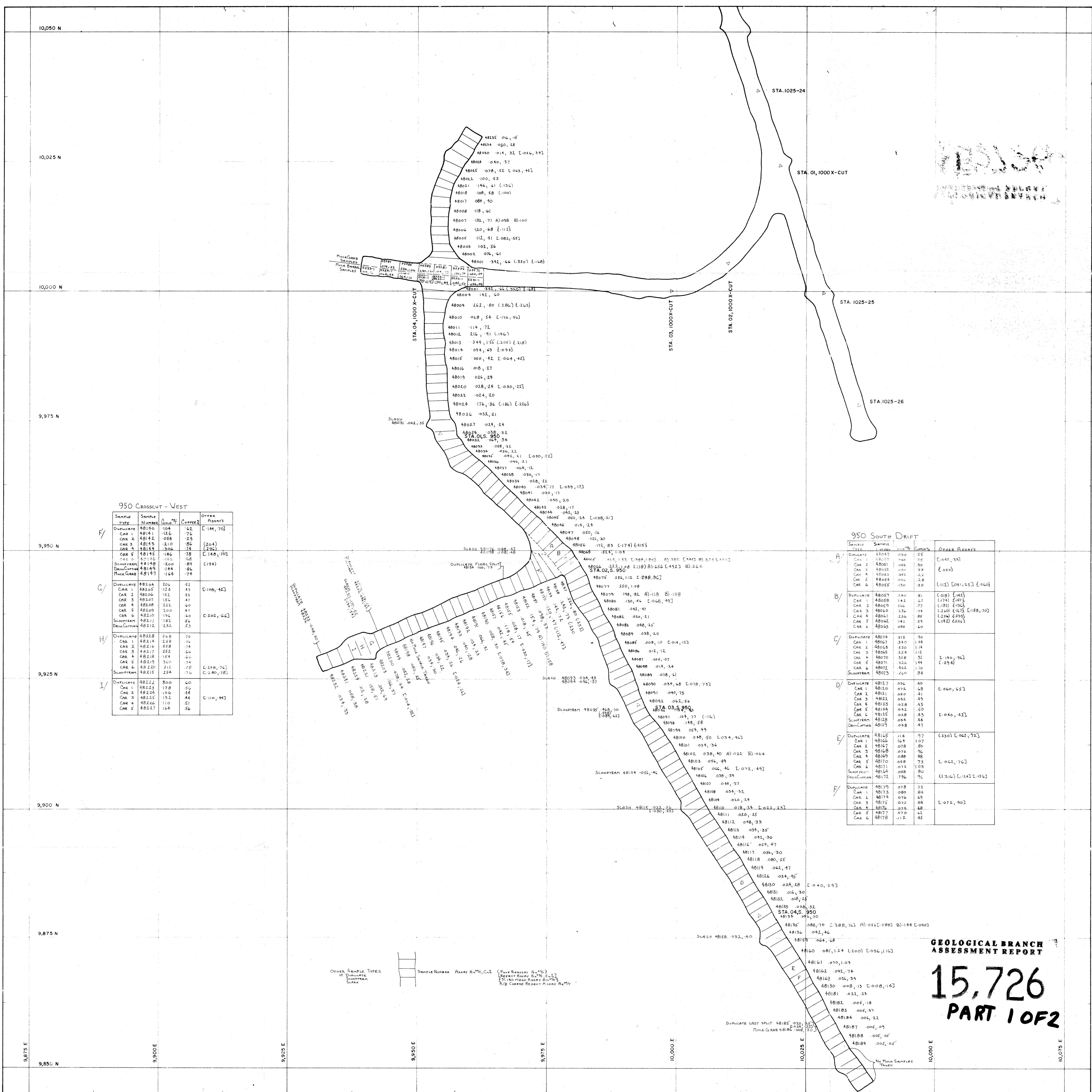

950 CROSSCUT - WEST

SAMPLE TYPE	SAMPLE NUMBER	A %	COPPER %	OTHER ASSAYS
Duplicate	48140	104	62	
CAR 1	48141	116	76	[144, 70]
CAR 2	48142	108	23	
CAR 3	48143	120	36	(104)
CAR 4	48144	136	74	(126)
CAR 5	48145	186	78	[148, 75]
CAR 6	48146	166	58	
SCOOPTRAM	48147	200	89	(194)
Duplicate	48148	144	84	
Duplicate	48149	144	74	
Duplicate	48150	104	52	
CAR 1	48151	114	43	[108, 42]
CAR 2	48152	152	81	
CAR 3	48153	162	41	
CAR 4	48154	222	60	
CAR 5	48155	200	47	[102, 66]
CAR 6	48156	196	60	
SCOOPTRAM	48157	182	56	[128, 74]
Duplicate	48158	132	53	
Duplicate	48218	248	70	
CAR 1	48219	268	76	
CAR 2	48220	288	74	
CAR 3	48221	252	64	
CAR 4	48222	154	66	
CAR 5	48223	360	74	[128, 74]
CAR 6	48224	212	78	[120, 78]
SCOOPTRAM	48225	254	74	
Duplicate	48226	300	60	
CAR 1	48227	178	56	
CAR 2	48228	106	44	
CAR 3	48229	132	44	
CAR 4	48230	110	51	
CAR 5	48231	164	56	[110, 44]

950 SOUTH DRIFT

SAMPLE TYPE	SAMPLE NUMBER	A %	COPPER %	OTHER ASSAYS
Duplicate	48043	104	25	
CAR 1	48044	108	32	[104, 30]
CAR 2	48045	102	38	[104, 30]
CAR 3	48046	108	33	[104, 30]
CAR 4	48047	102	22	
CAR 5	48048	102	28	
CAR 6	48049	150	28	(112) [104, 25] [104, 25]
Duplicate	48057	240	81	(118) [102]
CAR 1	48058	142	67	(118) [102]
CAR 2	48059	144	77	(118) [102]
CAR 3	48060	176	79	(120) [102] [188, 70]
CAR 4	48061	226	85	(120) [102]
CAR 5	48062	142	69	(142) [102]
CAR 6	48063	150	40	
Duplicate	48079	212	90	
CAR 1	48080	340	84	
CAR 2	48081	330	112	
CAR 3	48082	274	111	
CAR 4	48083	358	34	[190, 92]
CAR 5	48084	326	144	
CAR 6	48085	462	10	
SCOOPTRAM	48086	260	84	
Duplicate	48127	104	40	
CAR 1	48128	102	48	
CAR 2	48129	106	41	[106, 65]
CAR 3	48130	102	49	
CAR 4	48131	102	43	
CAR 5	48132	102	43	
CAR 6	48133	102	43	[104, 42]
SCOOPTRAM	48134	102	44	
Duplicate	48165	114	97	(130) [102, 92]
CAR 1	48166	164	107	
CAR 2	48167	108	80	
CAR 3	48168	102	96	
CAR 4	48169	108	88	[102, 76]
CAR 5	48170	108	73	
CAR 6	48171	102	103	
SCOOPTRAM	48172	108	80	(136) [102, 156]
Duplicate	48179	108	73	
CAR 1	48180	108	84	
CAR 2	48181	102	69	
CAR 3	48182	102	84	[102, 90]
CAR 4	48183	102	68	
CAR 5	48184	102	62	
CAR 6	48185	112	48	

GEOLOGICAL BRANCH ASSESSMENT REPORT

15,726 PART 1 OF 2

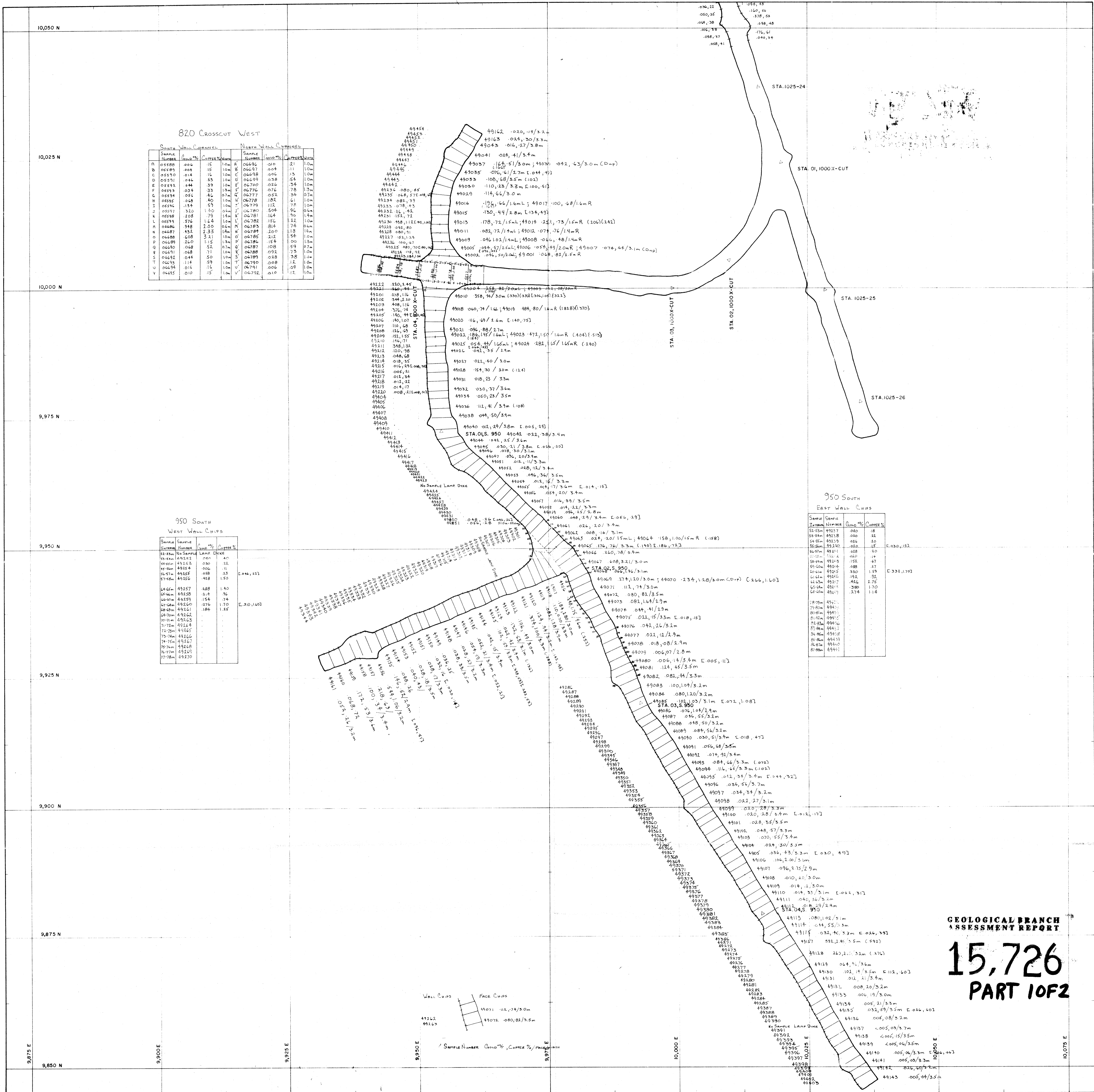

820 Crosscut West

South Wall Channel				North Wall Channel			
Sample Number	Gold %	Copper %	Notes	Sample Number	Gold %	Copper %	Notes
A 05588	006	15	1.0m	A 06096	010	21	1.0m
B 05589	008	15	1.0m	B 06097	004	11	1.0m
C 05590	014	16	1.0m	C 06098	006	13	1.0m
D 05591	044	53	1.0m	D 06099	038	54	1.0m
E 05592	044	39	1.0m	E 06700	026	34	1.0m
F 05593	034	33	1.5m	F 06776	076	78	3.5m
G 05594	056	46	0.7m	G 06777	052	34	0.7m
H 05595	048	40	1.0m	H 06778	182	61	1.0m
I 05596	154	59	1.0m	I 06779	112	78	1.0m
J 05597	323	130	0.6m	J 06780	504	94	0.6m
K 05598	208	79	1.5m	K 06781	164	90	1.5m
L 05599	576	164	1.0m	L 06782	156	122	1.0m
M 06686	948	230	0.6m	M 06783	814	74	0.6m
N 06687	432	735	1.4m	N 06784	210	118	1.4m
O 06688	608	321	1.0m	O 06785	212	54	1.0m
P 06689	240	115	1.3m	P 06786	157	00	1.3m
Q 06690	068	52	0.7m	Q 06787	108	59	0.7m
R 06691	068	71	1.0m	R 06788	092	73	1.0m
S 06692	044	50	1.0m	S 06789	028	38	1.0m
T 06693	014	59	1.0m	T 06790	008	12	1.0m
U 06694	014	12	1.0m	U 06791	006	09	1.0m
V 06695	010	15	1.0m	V 06792	010	12	1.0m

950 SOUTH WEST WALL CHIPS

Sample Number	Gold %	Copper %	Notes
82-83m	No Sample	None	None
83-84m	49252	010	40
84-85m	49253	030	22
85-86m	49254	006	11
86-87m	49255	058	23
87-88m	49256	418	150
88-89m	49257	288	140
89-90m	49258	214	96
90-91m	49259	154	74
91-92m	49260	236	170
92-93m	49261	184	126
93-94m	49262		
94-95m	49263		
95-96m	49264		
96-97m	49265		
97-98m	49266		
98-99m	49267		
99-100m	49268		

950 SOUTH EAST WALL CHIPS

Sample Number	Gold %	Copper %	Notes
82-83m	49267	040	18
83-84m	49268	040	22
84-85m	49269	026	20
85-86m	49270	020	15
86-87m	49271	018	20
87-88m	49272	040	11
88-89m	49273	152	67
89-90m	49274	088	57
90-91m	49275	330	159
91-92m	49276	182	92
92-93m	49277	426	175
93-94m	49278	380	170
94-95m	49279	274	114
95-96m	49280		
96-97m	49281		
97-98m	49282		
98-99m	49283		
99-100m	49284		

**GEOLOGICAL BRANCH  
ASSESSMENT REPORT**  
  
**15,726  
PART 10F2**