

**GEOLOGICAL BRANCH
ASSESSMENT REPORT****15,765
PART 2 OF 6**

DIAMOND DRILLING REPORT

ON

THE RAINBOW CLAIM GROUP

NANAIMO MINING DIVISION

FILMED

N.T.S.

92F/11W & 92F/14W

LAT. 49°45.5'N

LONG. 125°15'W

OF

BETTER RESOURCES LIMITED

BY

JAMES F. BRISTOW, P. ENG.

RICHMOND, B.C.

OCTOBER, 1986

DIAMOND DRILLING REPORT
ON
THE RAINBOW CLAIM GROUP

TABLE OF CONTENTS

	PAGE
GENERAL LOCATION MAP.....	1
SUMMARY.....	2
INTRODUCTION.....	2
LOCATION AND ACCESS.....	2
TOPOGRAPHY AND CLIMATE.....	2
HISTORY.....	4
PROPERTY DESCRIPTION.....	4
MINERAL CLAIM MAP.....	6
DISCUSSION.....	7
COST STATEMENT.....	8
AUTHOR'S QUALIFICATIONS & CERTIFICATION.....	9
APPENDIX	
1) INVOICES.....	10
2) DIAMOND DRILL LOG.....	11
3) ASSAY CERTIFICATES.....	12

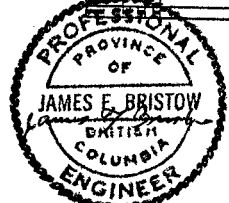
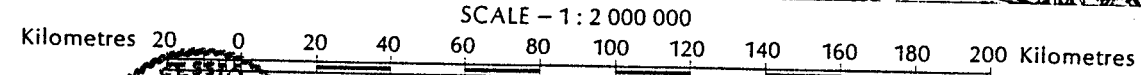
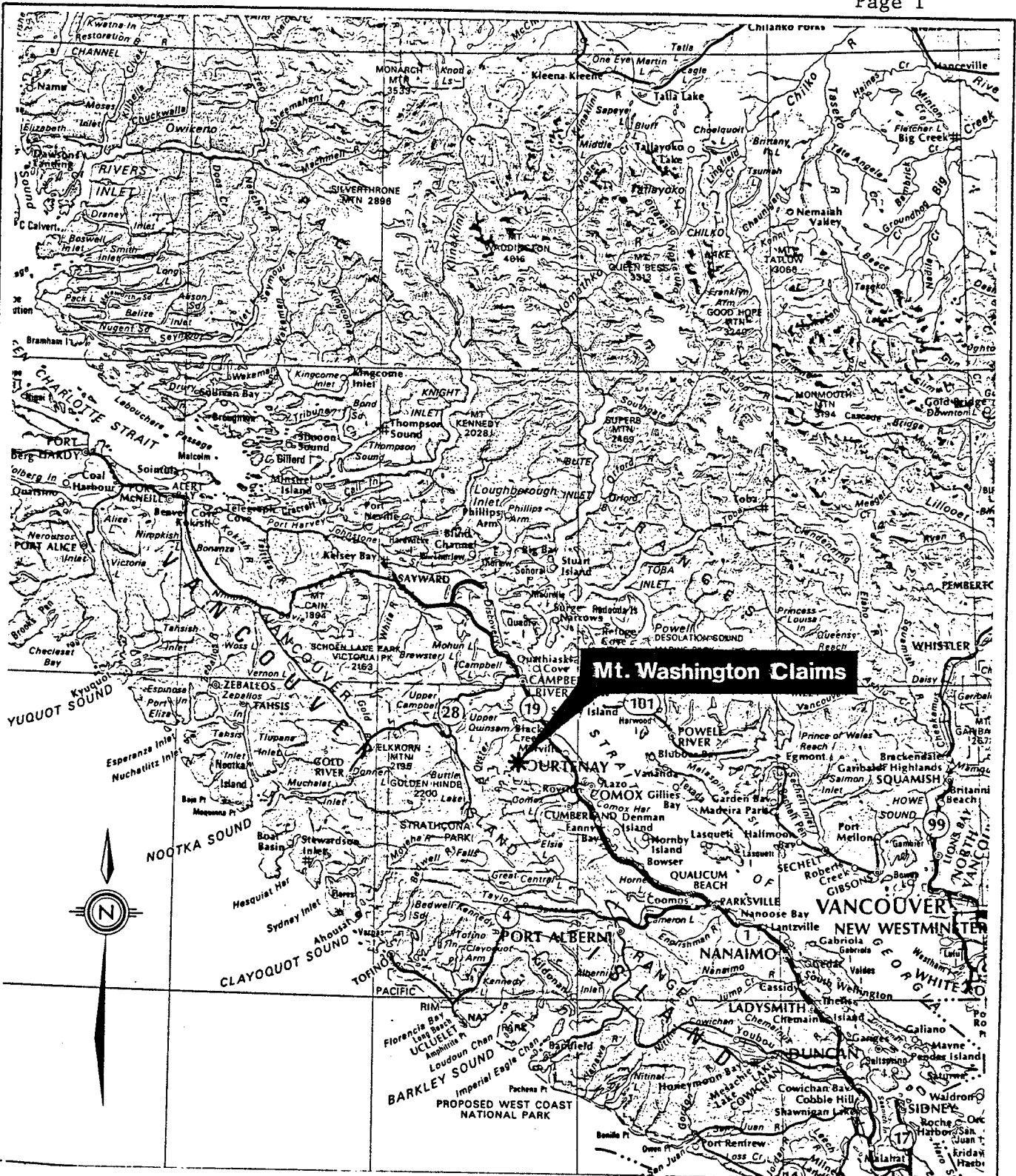

Drawn By: D.P.B.	BETTER RESOURCES LIMITED	Scale: 1:2,000,000
Checked By: J.F.B.		Figure:
Date: OCT./ 1986		INDEX MAP

SUMMARY

One NQ wireline diamond drill hole totalling 61 metres was drilled on the Rainbow Claim Group. This hole confirms the presence of economic grade gold values within brecciated karmutsen volcanics which form the southwest margin of the Murex Breccia body.

Cost of the drilling programme was in excess of \$ 10,000.00.

INTRODUCTION

This report contains the results obtained from 61 metres of NQ wireline diamond drilling conducted on the Rainbow Claim Group between 25 August 1986 and 28 August 1986 by Globe Drilling Ltd. of Vancouver British Columbia.

LOCATION AND ACCESS

The Rainbow Group of Mineral Claims are centred on Latitude $49^{\circ}45.5'$ North, Longitude $125^{\circ}15'$ West within map sheets N.T.S. 92F/11W, 92F/14W and the Nanaimo Mining Division. The claims are located approximately 20 kilometres northwest of Courtenay, B.C. The western claim boundary is located approximately 0.5 kilometres east of the summit of Mt. Washington. The claim Group encompasses the Murex Creek basin and immediately adjoining areas. (See Figure 2).

Access to the claims is by a network of well maintained paved and gravel mining and logging roads. Depending on snowfall and runoff conditions access to within 1.0 kilometres of any point on the property is usually possible by four wheel drive vehicle between July and November.

TOPOGRAPHY AND CLIMATE

Mt. Washington is located along the eastern margin of the northwest trending Vancouver Island Ranges in the Insular Belt. The landscape is characterized by moderate to precipitous topography covered generally, by a thick mixed coniferous forest of hemlock, red and yellow cedar, douglas fir and balsam fir. Locally this forest has been extensively logged and is currently covered by thick impenetrable second growth. A subalpine forest of heather and krumholtz is developed above 1500 metres. Property elevations range from 300 metres to 1480 metres. Evidence of recent glaciation is noted by cirque development, glacial striae and thin to moderate but pervasive glacial till development.

October to May is characterized by cold and wet weather with considerable snow accumulations. Depth may exceed 5 metres at higher levels where patches of snow may persist in sheltered areas well into the summer months. June through September are drier with temperatures ranging from near freezing to greater than 25°C .

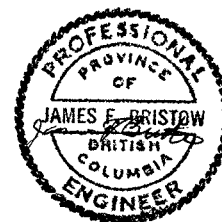

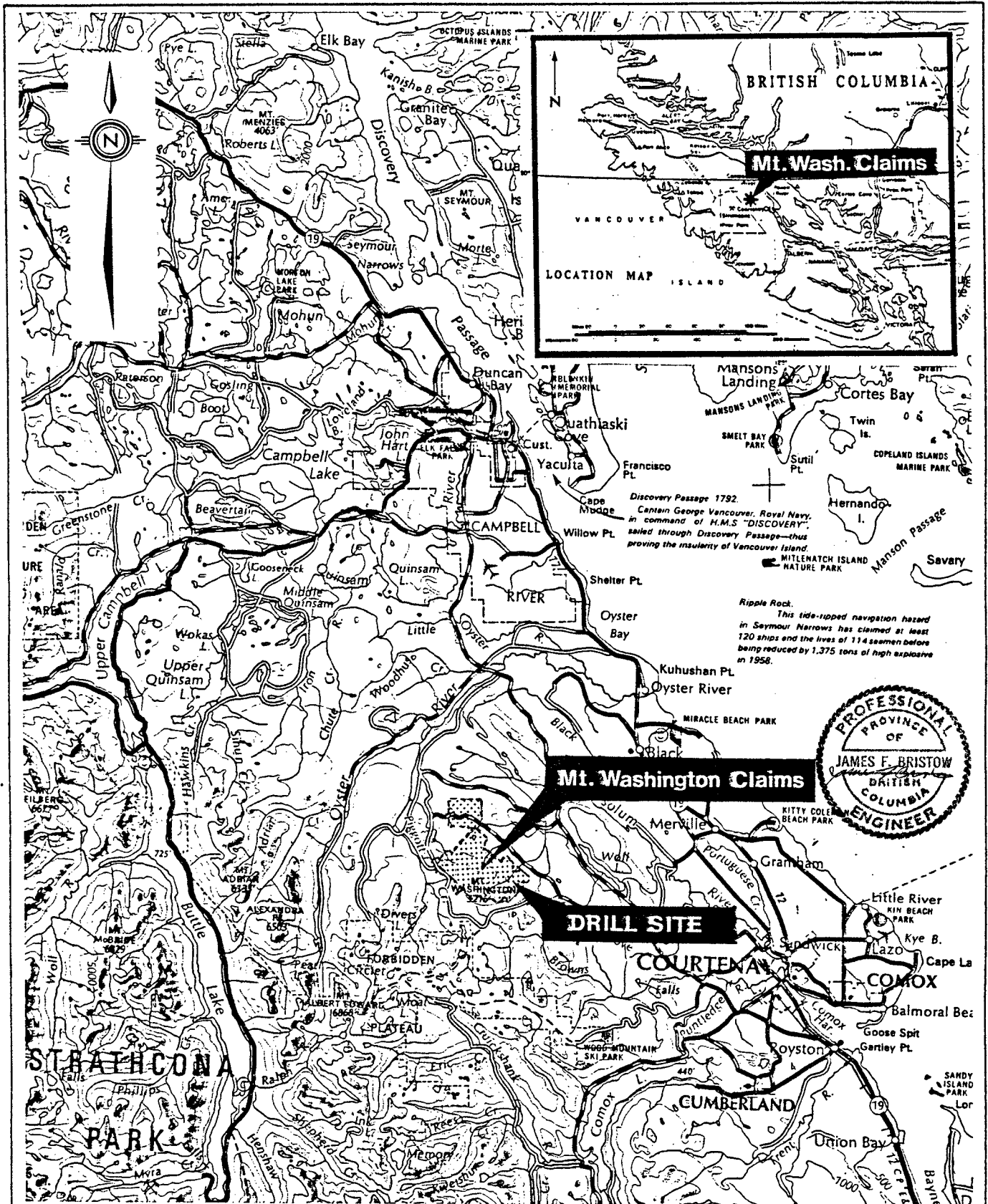

Discovery Passage 1792.
 Captain George Vancouver, Royal Navy,
 in command of H.M.S. "DISCOVERY",
 sailed through Discovery Passage—thus
 proving the insularity of Vancouver Island.

Ripple Rock.
 This tide-rippled navigation hazard
 in Seymour Narrows has claimed at least
 120 ships and the lives of 114 seamen before
 being reduced by 1,375 tons of high explosive
 in 1958.

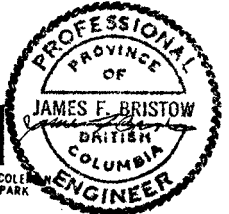

Scale: 6 Miles to 1 Inch

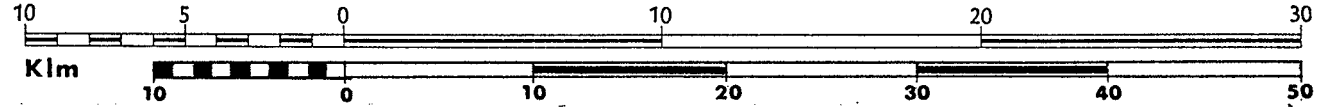

Drawn By: D.P.B.	BETTER RESOURCES LIMITED	Scale:
Checked By: J.F.B.		Figure: 1
Date: OCT. / 1986		James F. Bristow P. Eng.
LOCATION MAP		

HISTORY

Since 1940 the Mt. Washington area has been the focus of sporadic intensive exploration activity.

The following chronological summary from K.E. Northcote's report dated May 1983, covers the time span from discovery of gold mineralization in 1940 to 1982.

"Gold mineralization was discovered in place on Mt. Washington in May 1940 by J.M. McKay, a young mining engineer and prospector who systematically panned creeks up from the Oyster River to find course colours in a creek draining into McKay Lake. The gold bearing structures were prospected, trenched and sampled under the direction of Dr. D.F. Kidd in 1940 - 41. In 1944 - 45 Karl Springer financed adits on the copper bearing veins north of the area sampled for gold. Mt. Washington Copper Co. Ltd. was formed in 1956 by Gordon C. Murray and various joint agreements and options with Noranda and Cominco explored the property until 1964. From 1964 to 1966 Mt. Washington under revised agreement with Cominco and a joint Venture with Cumberland Mining Co. mined and milled 392,173 tons of 1.16% Cu, 0.01 oz per ton Au and 0.5 oz per ton Ag. Upon exhaustion of economic open pit copper mineralization the mill was dismantled.

The property was optioned by Marietta Resources Company Ltd. in 1969 further explored by Mt. Washington in 1970 - 71 and then optioned to Imperial Oil from 1973 to 1982. During this latter period the exploration emphasis appears to have been directed towards a search for more extensive copper mineralization with little exploration for gold."

In May, 1983, Better Resources Limited acquired via Veerman Botel Limited, an option on a block of claims previously controlled by Mt. Washington Copper Co. Ltd. By 1984, this land position was expanded to 130 units and a programme to assess the areas precious metal potential was initiated. By the spring of 1986 the land position was expanded to approximately 230 units. Two diamond drills are currently operating continuously to expand and delineate known precious metal occurrences previously found by trenching, soil geochemical surveys and prospecting.

PROPERTY DESCRIPTION

The Rainbow Claim Group owned by Better Resources Limited of Vancouver, British Columbia, is comprised of the following contiguous two past mineral claims as shown in figure 2.

Claim Name	Record No.	No. of Units	Record Date	Due Date
MWC 101	37196	1	Sept. 13/73	Sept. 13/87
MWC 102	37197	1	"	Sept. 13/86
MWC 103	37198	1	"	"
MWC 104	37199	1	"	"
MWC 105	37200	1	"	"
MWC 106	37201	1	"	"
MWC 115	37210	1	"	"
MWC 116	37211	1	"	"
MWC 117	37212	1	"	"
MWC 143	37078	1	Sept. 14/73	Sept. 14/86
MWC 144	37079	1	"	"
MWC 147	37082	1	"	"
MWC 148	37083	1	"	"
MWC 150	37085	1	"	"
MWC 151	37227	1	Sept. 13/73	Sept. 13/86
MWC 152	37228	1	"	"
MWC 153	37229	1	"	"
MWC 175	37243	1	"	"
MWC 176	37244	1	"	"
MWC 271	37108	1	Sept. 14/73	Sept. 14/86
MWC 272	37109	1	"	"
MWC 294	37131	1	"	"
Mink #1	1580	1	Sept. 27/83	Sept. 27/86
Mink #2	1581	1	"	"
Mink #3	1582	1	"	"
Mink #4	1583	1	"	"
Mink #5	1584	1	"	"
Mink #6	1585	1	"	"
Mink #7	1586	1	"	"
Mink #8	1587	1	"	"
Stoat #1	1576	1	"	"
Stoat #2	1577	1	"	"
HKR #1	2404	1	June 11/86	June 11/87
HKR #2	2405	1	"	"
HKR #3	2406	1	"	"
HKR #4	2407	1	"	"
HKR #5	2408	1	"	"
HKR #6	2409	1	"	"
HKR #7	2410	1	"	"
Mike #1	2394	1	"	"
Mike #2	2395	1	"	"
Mike #3	2396	1	"	"
Mike #4	2397	1	"	"
Mike #5	2398	1	"	"
Mike #6	2399	1	"	"
Mike #7	2400	1	"	"
Fox #1	2401	1	"	"
Fox #2	2402	1	"	"
Fox #3	2403	1	"	"

TOTAL

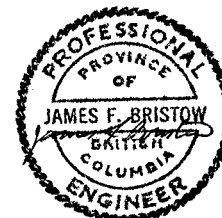
49

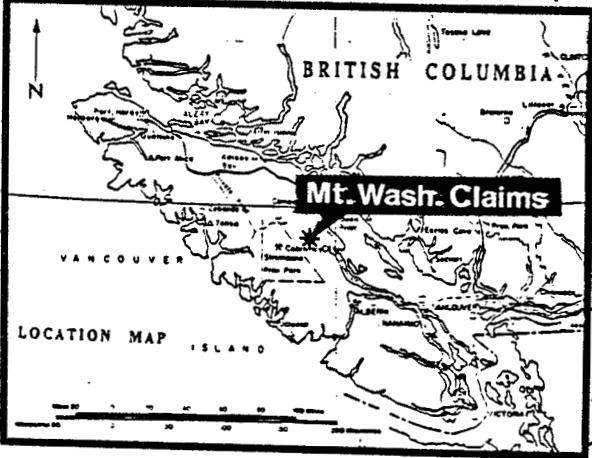
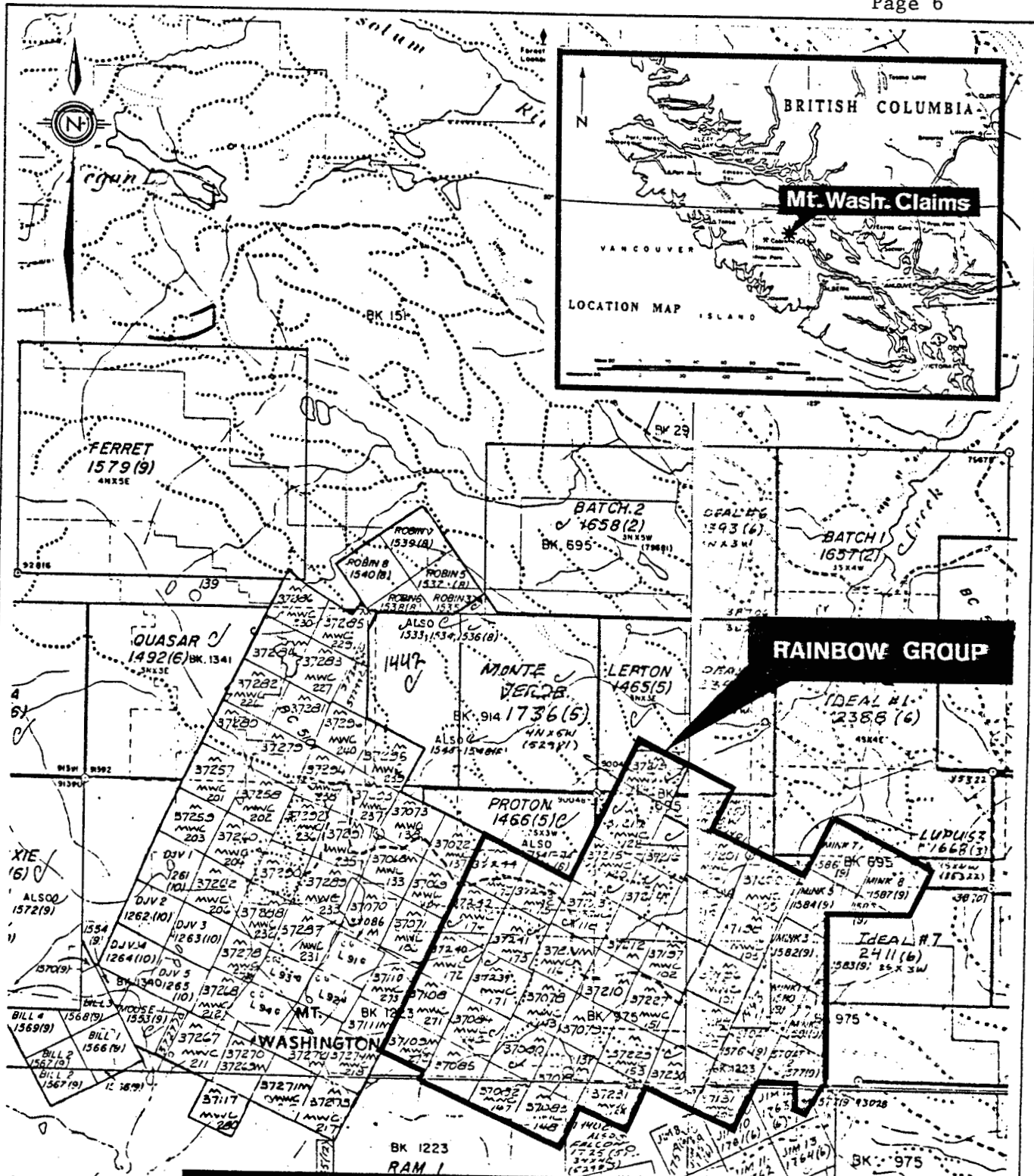

NTS Numbers 92F/14W, 14E, 11W & 11E

Province of British Columbia
Ministry of Energy, Mines and Petroleum Resources

DE ANNE S
1939(10)
45X5E

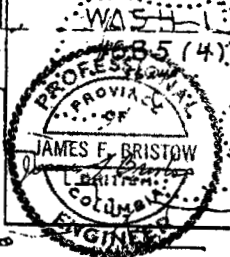
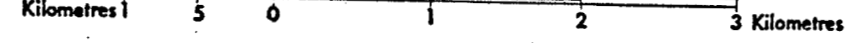
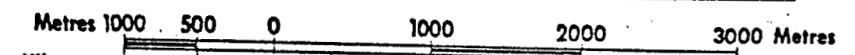
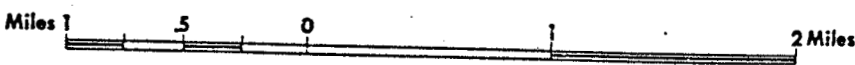

Drawn By: D.P.B.	BETTER RESOURCES LIMITED	Scale: 1:50,000
Checked By: J.F.B.		Figure: 2
Date: OCT. / 1986		CLAIM MAP

DISCUSSION

The general geology of the Mt. Washington area shows a thick sequence of Tertiary Karmutsen volcanics overlain by sediments of the Cretaceous Comox formation. Both sequences are cut by intrusive feldspar porphyry and dioritic dykes and sills of Tertiary age. The formations are in turn pierced by breccia systems of various composition, size, shape and possibly of different ages.

One such multistage breccia (Murex Breccia) is located within the Rainbow Claim Group. Limited past surface sampling indicated the presence of economic grade gold mineralization within the boundaries of the breccia system.

The purpose of NQ size diamond drill hole Mx-86-1 was to confirm the presence of this mineralization.

The drill hole is located totally within the breccia body. Fragments vary from a mixture of basalt/andesite and argillite near the top of the hole to mainly chloritized amygdoloidal basalt and diorite fragments near the bottom. Mineralization occurs as sulphide clots, irregular blebs and disseminations interstitial to the breccia fragments. Pyrrhotite, pyrite, and chalcopryrite are the main sulphide minerals. The top 17.5 metres of the drill hole was found to contain significant gold values.

Drilling to date has not penetrated the breccia sequence.

The drill core is currently stored within Franklin Electric's storage yard in Courtenay, B.C. Drill core was logged by the writer. The diamond drilling program was supervised by Barry Needham or the writer depending on the availability of personnel.

Diamond Drill Hole Mx-86-1 was surveyed with respect to No 1 post Fox #1 claim. This information was used to prepare a 1:2500 scale Diamond Drill Hole Plan (See Figure 3).

A one hole drill section was prepared to accompany the drill hole plan.

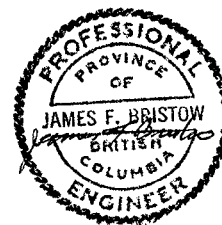

COST STATEMENT

RAINBOW CLAIM GROUP

Location of Drillsite and Access Road

James F. Bristow P. Eng. 22 Aug/86 1 day @ \$ 250.00/day	\$ 250.00
R.D. Bristow 22 Aug/86 1 day @ \$ 95.00/day	95.00
Drillsite and Access Road Construction	
Dennis Pye Bulldozing Ltd. 23/24 Aug/86 As per invoice	1,771.50
Barry Needham 23/24 Aug/86 2 days @ \$ 120.00/day	240.00
Diamond Drilling (as per invoice) 61 metres @ \$ 76.92/metre	4,692.00
Demobilization E.D. Yakichuk Excavating Ltd. as per invoice	810.00
Supervision and Core Logging	
James F. Bristow P. Eng. 24 - 31 Aug/86 Total 3 days @ \$ 250.00/day	750.00
Core Splitting 26,29,30 Aug/86 S Jut 3 days @ \$ 95.00/day	285.00
Assaying 26 core samples for gold silver	
26 @ \$ 14.25/sample	370.50
Sample Freight	50.00
4 X 4 Truck Rental 7 days @ \$ 25.00/day	280.00
Food and Lodging 10 days @ \$ 25.00/day	250.00
Report Preparation (including drafting & typing)	500.00
CERTIFIED CORRECT	\$ 10,344.00

James F. Bristow

James F. Bristow, P. Eng.

QUALIFICATIONS AND CERTIFICATION

I, James F. Bristow, of 3431 Bowen Drive, in the Municipality of Richmond, Province of British Columbia, hereby certify as follows:

- 1) I am a graduate of the University of British Columbia with a B.A. Degree (Geology and Physics)
- 2) I am a Professional Engineer registered in the province of British Columbia.
- 3) I am a member of The Association of Exploration Geochemists, the Geological Society of South Africa and the Canadian Institute of Mining and Metallurgy.
- 4) I have actively practiced my profession in mineral exploration and mining geology since my graduation in 1957.
- 5) That this report is based on data either gathered by myself or by persons working under my direct supervision.
- 6) That I am a Director of Better Resources Limited and hold a direct interest in the Securities of this company.

Dated at Richmond, British Columbia, this 3rd day of November 1986.

James F. Bristow
James F. Bristow P. Eng.

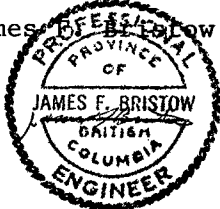
A circular professional seal for James F. Bristow, a Professional Engineer in the Province of British Columbia. The seal features the text "PROFESSIONAL ENGINEER" around the perimeter, "PROVINCE OF BRITISH COLUMBIA" in the center, and "JAMES F. BRISTOW" in a smaller circle in the middle.

APPENDIX I

INVOICES

*Paid by
Invoice # 158
6 Sept 86*

OUR NUMBER	076651
DATE	SEPTEMBER 86
CUSTOMER'S ORDER	MT. WASHINGTON
SALESMAN	#133
TERMS	
F.O.B.	

SOLD TO BETTER RESOURCES

SHIPPED TO _____

ADDRESS _____ VIA _____

INVOICE

DDH MX-86-1			
MURRY 4 FEET NW @ 23.00/feet			92.00
200 FEET NQ @ 23.00/feet			4600.00
			<u>4692.00</u>
B 86-1 TO B 86-7			
55 FEET NW			1265.00
55 FEET NQ V			12,811.00
<i>with Rental Cable Drilling</i>			18,768.00

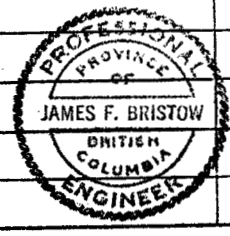

E. D. YAKICHIK EXCAVATING LTD.

JOB INVOICE

No. 568

R.R. 2
2427 Coleman Road
COURTENAY, B.C. V9N 5M9
Phone 334-2232

CUSTOMERS ORDER NO	DATE ORDERED
ORDER TAKEN BY	DATE PROMISED <input type="checkbox"/> A.M. <input type="checkbox"/> P.M.

BILL TO	<i>Better Resources Ltd</i>	PHONE
ADDRESS		MECHANIC
CITY		HELPER
JOB NAME AND LOCATION		<input type="checkbox"/> DAY WORK <input type="checkbox"/> CONTRACT <input type="checkbox"/> EXTRA
DESCRIPTION OF WORK		
<i>Mount Washington</i>		
<i>N01 Drill site.</i>		
<i>MURTEX</i>		

QUANT	DESCRIPTION OF MATERIAL USED	PRICE	AMOUNT
<i>Aug 29</i>	<i>mount drill</i>		
<i>30</i>	<i>peck up machine</i>		
	<i>7 to 1/4 to 10 15hr</i>		
	<i>7AM to 10AM = 3 hrs.</i>		
	<i>moved machine back 350' per</i>		
	<i>load up drill</i>		
	<i>loaded up 450' moved to</i>		
	<i>job</i>		
	<i>Truck & Trailer @ 450' at 45/hr.</i>		
		<i>to 18hr</i>	<i>\$ 810 XY</i>
<i>Paid by #157 / 6 Sept / 66</i> <i>Reque</i>			

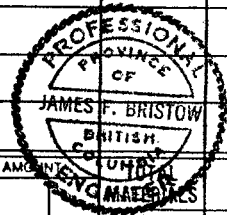

HOURS	LABOUR	AMOUNT	TOTAL
	MECHANICS @		
	HELPERS @		
I hereby acknowledge the satisfactory completion of the above described work:		TOTAL LABOUR	TAX
SIGNATURE		DATE COMPLETED	TOTAL

NEBS

STATEMENT

Dennis Phye
BULLDOZING LTD.

DOLBY TILT BLADE
Land Clearing • approved Subdivision Rd.
Complete Burning & Farm Land Clearing

Free Estimates
334-2825

4901 Topland Road
Courtenay, B.C.
V9N 6N1

DATE Aug 25 1986

Name Better Resources Ltd.
Address 3731 Bowen Rd. Drive
City Richmond, BC Telephone _____
V7C 4C8

MURRY

		07- excavator			
Aug	23	-07-low bed move			225.00
	23	-07-6 ⁰⁰ -1 ⁰⁰ making drill rd. 7.0			
	24	-07-7 ³⁰ -9 ³⁰ drilled rd	2.0		
	24	-07- drill road	2.5		
	24	-07- Towing drill in			
		07 moving out	2.0		
	24	-07- low bed move			240.00
					<u>13.506</u>
		Hitachi Excavator			1053.00
		x 7800 per hr			
		work done at Mt. Washington			
		by Radio-T.V. Road. off of			
		Crown Forests Main. Co. B.C.			
		Paid by <i>[Signature]</i>			
		<i>[Signature]</i>			
			Total	1518.00	
			Sept 3/86		
			Dennis		

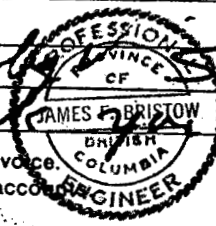

TERMS: Net 30 days from date of invoice.
2% per month on overdue account
24% per annum.

STATEMENT

Dennis Phye
BULLDOZING LTD.

DOZ TILT BLADE
Land Clearing • Approved Subdivision Rd.
Complete Burning • Farm Land Clearing

Free Estimates
334-2825

4901 Topland Road
Courtenay, B.C.
V9N 6N1

DATE Aug 30 1986

Name Better Resources Ltd

Address Mt. Washington site.

City MUNEX Telephone _____

*These invoices
one for your
father as
requested*

No 1 - Drill site T.V. Road.

Aug	24	long distance D4 call (1) - 2.00 each		
	25	450 J.D. "(2)		6.0
	28	labour - rental - contractors 1/4 hr		9.0
	29	labour - moving truck 1/2 hr		9.0
	29	labour 1 ³⁰ AM - 10 ¹⁵ PM		157.50
	30	labour - 6 ³⁰ 9 ³⁰ AM		54.00
	30	350 J.D. fuel		9.00
	30	labour - down - travel		9.00
				<u>\$ 253.50</u>

*Towing drill from No 1 site
up hill to load.
Loading drill and returning
350 J. Deere. cleaning - fueling
up. - travel
Paid by ✓ Sept 30/86*

Thank you Dennis

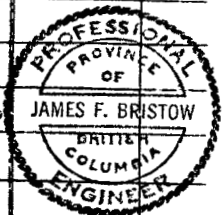

T TERMS: Net 30 days from date of invoice.
2% per month on overdue accounts.
24% per annum.

APPENDIX II

DIAMOND DRILL LOG
(Mx-86-1 in pocket)

APPENDIX III

ASSAY CERTIFICATES

CTA

 Member
 Canadian Testing
 Association

KAMLOOPS RESEARCH & ASSAY LABORATORY LTD.

912 - 1 LAVAL CRESCENT — KAMLOOPS, B.C.

V2C 5P5

PHONE: (604) 372-2784 — TELEX: 048-8320

CERTIFICATE OF ASSAY

 B.C. LICENSED ASSAYERS
 GEOCHEMICAL ANALYSTS
 METALLURGISTS

 TO Better Resources Ltd.
3431 Bowen Dr.,
Richmond, B.C. V7C 4C6

 Certificate No. K 7616

 Date September 15, 1986

I hereby certify that the following are the results of assays made by us upon the herein described _____ samples

Kra No	Marked	Au	Ag						
		ozs/ton	ozs/ton						
✓ 1		28526	.137	.42	MUREX GRAB SAMPLE FROM JUNCTION OF OLD TRENCH				
2	B-86-1	28527 23 to 25.4	L.001	.14					
3	MX 86-1	28528 5 to 15	.034	.10					
4	MX 86-1	28529 15 to 25	.113	.12					
5	MX 86-1	28530 25 to 35	.066	.10					
6	MX 86-1	28531 35 to 45	* .22	.19					
7	MX 86-1	28532 45 to 51	.44	.12					
8	MX 86-1	28533 51 to 57.3	* .37	.10					
9	MX 86-1	28534 73 to 80	.010	.08					
10	MX 86-1	28535 97 to 105	.001	.09					
11	MX 86-1	28536 117 to 127	.004	.08					
12	MX 86-1	28537 127 to 137	.084	.08					
13	MX 86-1	28538 137 to 142	L.001	.08					
14	B 86-2	28539 15 to 18	.43	2.62					
15	B 86-2	28540 18 to 21	.93	2.97					
16	B 86-2	28541 21 to 25	.022	.37					
17	B 86-2	28542 25 to 29	.014	.70					
18	B 86-2	28543 29 to 32	.022	.09					
19	B 86-2	28544 32 to 32.6	.115	2.50					
20	MX 86-1	28545 142 to 150	L.001	.08					

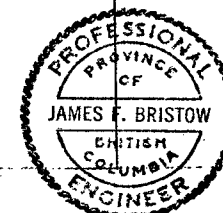

James F. Bristow

 Note:
 Report retained three weeks.
 Film retained 12 months.
 Samples returned as requested.



Member
Canadian Testing
Association

KAMLOOPS RESEARCH & ASSAY LABORATORY LTD.

912-1 LAVAL CRESCENT — KAMLOOPS, B.C.

V2C 5P5

PHONE: (604) 372-2784 — TELEX: 048-8320

CERTIFICATE OF ASSAY

B.C. LICENSED ASSAYERS
GEOCHEMICAL ANALYSTS
METALLURGISTS

TO Better Resources Ltd.

Certificate No. K 7616 -2

Date _____

I hereby certify that the following are the results of assays made by us upon the herein described _____ samples

No.	Marked	Au	Ag						
		ozs/ton	ozs/ton						
21	Mx 86-1 28546	150 to 160	.001	.08					
22	Mx 86-1 28547	160 to 170	.004	.08					
23	Mx 86-1 28548	170 to 180	L.001	.08					
24	Mx 86-1 28549	180 to 190	.003	.08					
25	Mx 86-1 28550	190 to 200	L.001	.07					
26	28551		.006	.27					
27	28552		.031	.45					
Samples Marked * have been screened & found to contain coarse gold.									
			Percent Weight	Au ozs/ton	Combined Au ozs/ton				
	28531	-100 mesh	97.75	.152	.22				
		+100 mesh	2.25	3.02					
	28533	-100 mesh	94.42	.34	.37				
		+100 mesh	5.58	.915					

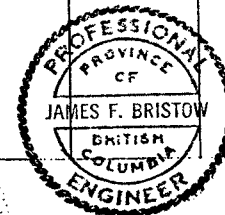

James F. Bristow

Professional Engineer, Province of British Columbia



Member
Canadian Testing
Association

KAMLOOPS RESEARCH & ASSAY LABORATORY LTD.

912-1 LAVAL CRESCENT — KAMLOOPS, B.C.
V2C 5P5

PHONE: (604) 372-2784 — TELEX: 048-8320

CERTIFICATE OF ASSAY

B.C. LICENSED ASSAYERS
GEOCHEMICAL ANALYSTS
METALLURGISTS

TO Better Resources Ltd.
3431 Bowen Dr.,
Richmond, B.C. V7C 4C6

Certificate No. K 7661
Date September 29, 1986

I hereby certify that the following are the results of assays made by us upon the herein described _____ samples

Kral No.	Marked	Au	Ag						
		ozs/ton	ozs/ton						
1	18157	.183	.87						
2	18158	.012	.12						
3	18159	L.001	.07						
4	18160	L.001	L.01						
5	18161	L.001	L.01						
6	18162	L.001	L.01						
7	18163	.001	L.01						
8	18164	.001	.04						
9	18165	L.001	L.01						
10	18166	L.001	L.01						
11	18167	.005	L.01						
12	18168	L.001	L.01						
13	18169	L.001	L.01						
14	18170	L.001	.04						
15	18171	L.001	L.01						
16	18172	L.001	.02						
17	MX 86-1 18173 573 to 63	.021	L.01						
18	MX 86-1 18174 63 to 68	.008	.02						
19	18175	.004	.12						
20	18183	.001	.02						

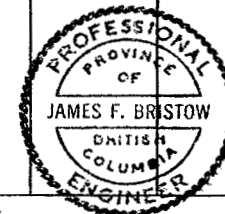

NOTE:
Rejects retained three weeks
Pulps retained three months
unless otherwise arranged

David A. Bristow
Registered Assayer, Province of British Columbia



Member
Canadian Testing
Association

KAMLOOPS RESEARCH & ASSAY LABORATORY LTD.

912 - 1 LAVAL CRESCENT — KAMLOOPS, B.C.
V2C 5P5

PHONE: (604) 372-2784 — TELEX: 048-8320

CERTIFICATE OF ASSAY

B.C. LICENSED ASSAYERS
GEOCHEMICAL ANALYSTS
METALLURGISTS

TO Better Resources Ltd.

Certificate No. K 7661

Date September 29, 1986

I hereby certify that the following are the results of assays made by us upon the herein described _____ samples

Kral No.	Marked	Au	Ag							
		ozs/ton	ozs/ton							
21		18184	.001	.02						
22	MX86-1	23977 68 to 73	L.001	L.01						
23	MX86-1	23978 80 to 200	L.001	L.01						
24	MX86-1	23979 90 to 97	.081	L.01						
25	MX86-1	23980 105 to 111	L.001	.02						
26	MX86-1	23981 111 to 117	L.001	.04						
27		23982	L.001	L.01						
28		23983	.048	.15						
29		23984	.020	.12						
30		23985	.28	.92						
31		23986	.031	.04						
32		23987	.019	.07						
33		23988	.001	L.01						
34		23989	.020	.02						
35		23990	.014	.02						

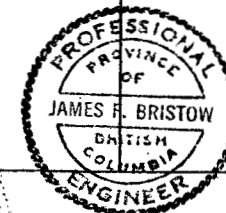

NOTE:
Rejects retained three weeks
Pulps retained three months
unless otherwise arranged.

James F. Bristow
Registered Assayer, Province of British Columbia

Drill Plan

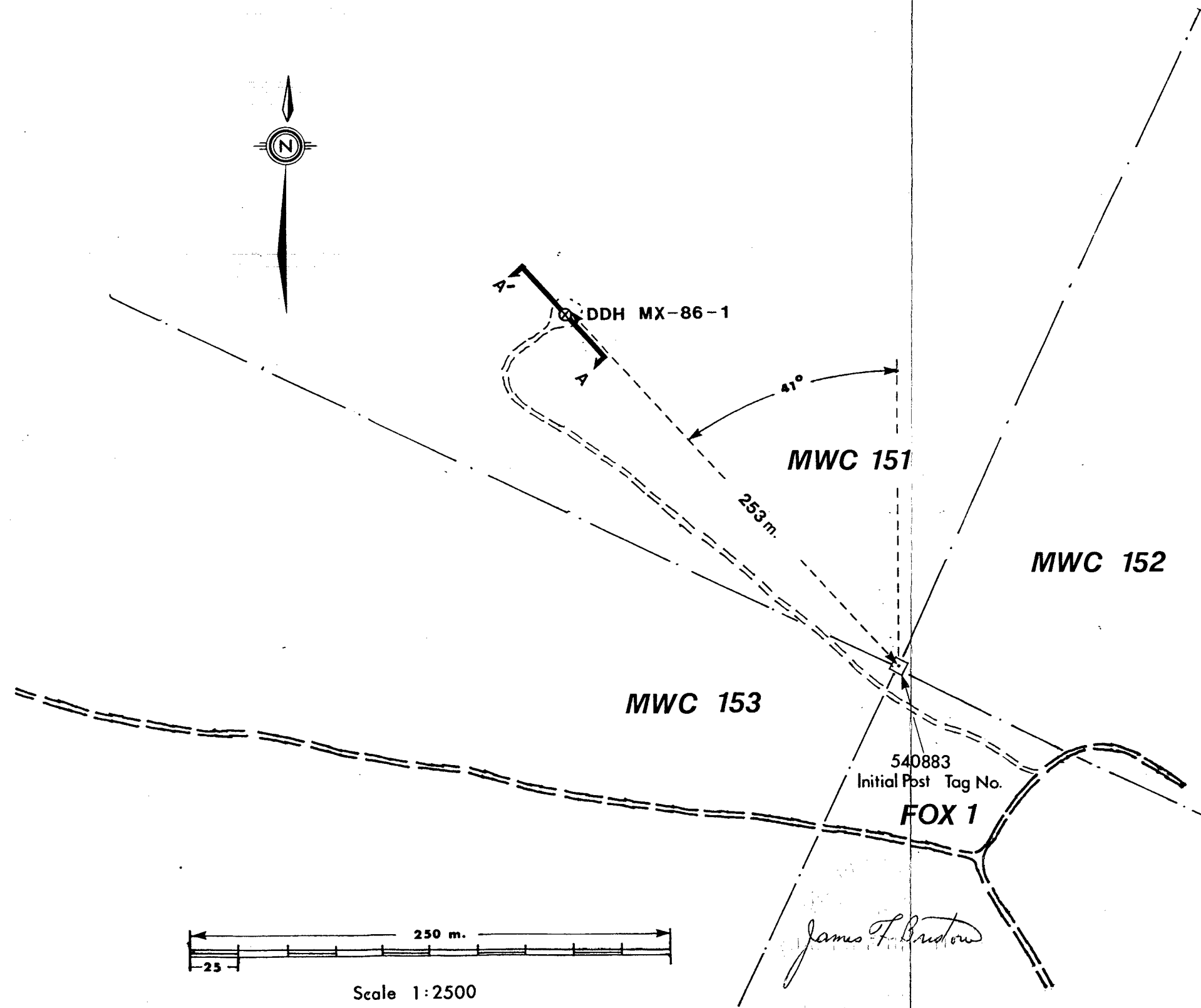

Section A - A'

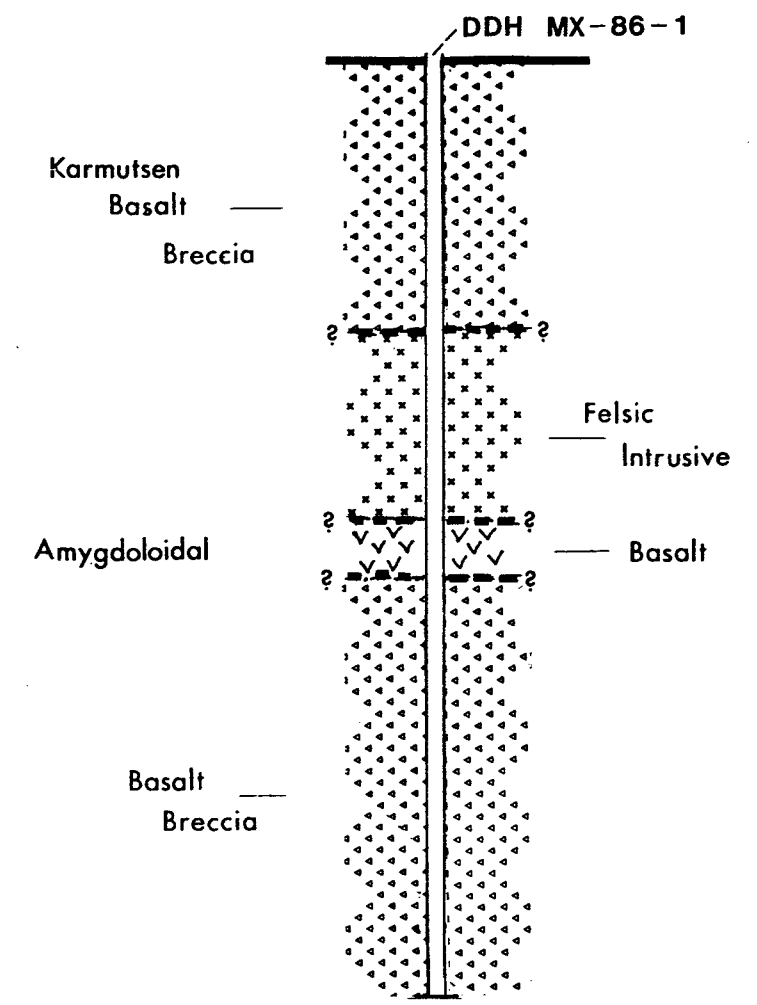

Legend

- ⊗ Diamond Drill Hole
- Claim Post
- Claim Boundary
- - - Access Road
- == Main Road

BETTER RESOURCES LTD.

SCALE:	APPROVED BY:	DRAWN BY BERKSHIRE
DATE: Oct. 1986	J. F. Bristow P. Eng.	REVISED

DRILL PLAN & SECTION MAP

RAINBOW GROUP DRAWING NUMBER **3**

James F. Bristow

DIAMOND DRILL CORE LOG - SAMPLE RECORD

DEPTH	DIP	BEARING AST.
COLLAR	-90	—

PROPERTY Mt WASHINGTON CLAIM MWC 151
 LATITUDE STARTED AUGUST 25 1986
 DEPARTURE FINISHED AUGUST 28 1986
 ELEVATION 930 (Approx.) TOTAL LENGTH 61 Metres (200ft)

LOGGED BY JFB
 CORE SIZE NQ
 SECTION
 HOLE NO. Mx-86-1

1 of 2 Pages

Footage	DESCRIPTION	MINERALIZATION	Sample	From	To	Length	Copper %	Mo %	Gold Oz.	Silver Oz.
0 (1.5M)				ft						
(0) 5ft	Overburden		28528	5	15	10			.034	0.10
5 (17.5M)										
(1.5M) 57.3'	Karmutsen	po Py Cpx	28529	15	25	10			.113	0.12
	Basalt / Andesite / minor diorite /	occurs as blebs,	28530	25	35	10			.066	0.10
	granodiorite breccia	& patches in breccia	28531	35	45	10			.220	0.19
	breccia fragments up to 16 cm	filling	28532	45	51	6			.440	0.12
	limonite on fractures to 10.5 ft		28533	51	57.3	6.3			.37	0.10
	Basalt / andesite fragments both		18173	57.3	63	5.7			.021	TL
	amygdoloidal & porphyritic (?)		18174	63	68	5.0			.008	0.02
	Minor qtz in interstices		23977	68	73	5.0			TL	TL
	Approximately 10% Sulphide Mineralization									
	31.5-33.0, 35-37, 40-44									
	Approximately 80% of fragments 5 to									
	57.3 ft andesite / Basalt									
57.3' (30M)										
(17.5M) 98.5'	Intrusive Dyke (?)		28534	73	80	7.0			.010	0.08
	fine to medium grained felsic		23978	80	90	10			TL	TL
	Occasional fracture filling and/or bleb									
	of sulphides 73-80, 92.5-94.0									

DIAMOND DRILL CORE LOG -- SAMPLE RECORD

PROPERTY MT. WASHINGTON

HOLE No. Mx-86-1 Page No. 2 of 2

Footage	DESCRIPTION	MINERALIZATION	Sample	From	To	Length	Copper %	Mo %	Gold Oz.	Silver Oz.
98.5' (33.8m)	Basalt amygdoloidal brecciated and silicified alteration accompanied with some bleaching along fractures - epidote developed	py minor cpy as fracture filling	23979	90	97	7.0			.081	TL
30.0' 111			28535	97	105	8.0			.001	.09
			23980	105	111	6.0			TL	.02
			23981	111	117	6.0			TL	.04
			28536	117	127	10			.004	.08
111' (61m)	Basalt fine grained (Massive 111-115) Brecciated - some fragments andesitic occasionally cemented (enclosed) in felsic porphyritic matrix eg 118-118 1/2, 133 1/2 - 134 1/2 Appears silicified 117-144 - irregular blebs and veinlets of sulphides also 161 to end of hole. blotches of blebs of epidote up to 1.5cm 147-160, 174-174.5 Minor calcite along fractures is common D.D. Hole Ends @ 61 Metres 200 ft	pe. py cpy	28537	127	137	10			.084	.08
33.8m) 200			28538	137	142	5.0			L.001	.08
			28545	142	150	8.0			L.001	.08
			28546	150	160	10			.001	.08
			28547	160	170	10			.004	.08
			28548	170	180	10			L.001	.08
			28549	180	190	10			.003	.08
			28550	190	200	10			L.001	.07

