

FERNIE

87-558-16222



Province of
British Columbia

Ministry of
Energy, Mines and
Petroleum Resources

TYPE OF REPORT/SURVEY(S)
DRILLING

\$153,942.43

AUTHOR(S) **Alfred R. Allen**

SIGNATURE(S) *Alfred R. Allen*

DATE STATEMENT OF EXPLORATION AND DEVELOPMENT FILED **June 16, 1987**

DATE OF WORK **1986**

PROPERTY NAME(S)

GREAT WESTERN CEDAR

COMMODITIES PRESENT

Cu, Ag, Pb, Zn, Au

B.C. MINERAL INVENTORY NUMBER(S) IF KNOWN

82G/SW-40, 54

MINING DIVISION

Fort Steele

NTS

82G/6W

LATITUDE

49°26'42"

LONGITUDE

115°16'

NAMES and NUMBERS of all mineral tenures in good standing (when work was done) that form the property. Examples: TAX 1-4, FIRE 2 (12 units), PHOENIX (Lot 1706), Mineral Lease M 123, Mining or Certified Mining Lease ML 12 (claims involved).

Cedar 10, Cedar 12, Cedar 13, Cedar 14 (80 Units total)

OWNER(S)

(1) **R.H. Stanfield**

**GEOLOGICAL BRANCH
ASSESSMENT REPORT**

MAILING ADDRESS

#350-4723 1st Street S.W.

Calgary, Alberta T2G 0A1

OPERATOR(S) (that is, Company paying for the work)

(1) **Same as above**

MAILING ADDRESS

Same as above

16,222

SUB-RECORDER
RECORDED

SEP 11 1987

M.R. #

\$

VANCOUVER, B.C.

FILMED

SUMMARY GEOLOGY (lithology, age, structure, alteration, mineralization, size, and attitude)

thin bedded, flat-lying Proterozoic
The claims are underlain by Aldridge Formation grey to black banded argillite, siltstone and argillaceous quartzite.
Mineralization, consists of
narrow veins of siderite-quartz with pyrite, pyrrhotite and chalcopyrite and thin fractures filled with pyrrhotite and pyrite.

REFERENCES TO PREVIOUS WORK

CONTENTS

TITLE PAGE AND SUMMARY	1.& 2.
A. INTRODUCTION.....	3.
B. LOCATION	3.
C. PROPERTY	3.
D. PHYSIOGRAPHY.....	3.
E. GEOLOGY	4.
F. THEORY	4.
G. OBJECT OF THE DRILLING	4.
H. PREVIOUS WORK	5.
I. DIAMOND DRILLING	5.
J. DRILLING RESULTS	6.
K. DISCUSSION	7.
L. SUMMARY	7.
REFERENCES	8.

COSTS STATEMENT

CERTIFICATE

MAPS:

1. Location
2. Topography, Claims, Drill Location
3. Cedar #10 Claim, Hole C-10-1-86, 1/12,500

* * * * *

A. INTRODUCTION

The C-10-1-86 diamond drill hole was collared at the 1218 metre level near the south-central area of the Cedar #10 mineral claim. The lower 801 metres, drilled June 18 - September 30, 1986, is the subject of this report.

The Cedar 10, 12, 13 and 14 make up the Cedar 2A Group.

B. LOCATION

The property is located on #4 Mountain 4.5 kilometres north of Rosen Lake, and 9 kilometres by secondary road north of Galloway.

Access is via the mine road from Galloway or the Big Sand Creek road to its headwaters.

C. PROPERTY

Cedar 2A Group, Cedar 10, 12, 13, 14, 214(6) 215(6), 235(6), 236(7).

D. PHYSIOGRAPHY

The property extends from elevation 1036 metres in the Rocky Mountain Trench north up the west slopes of #4 Mountain to the summit at 2130 metres and to the valley of Big Sand Creek and headwaters at 1830 metres above sea level. Big Sand Creek flows southwesterly. Little Sand Creek heads at 1830 metres and flows southerly across Cedar 12 and Cedar 10 claims.

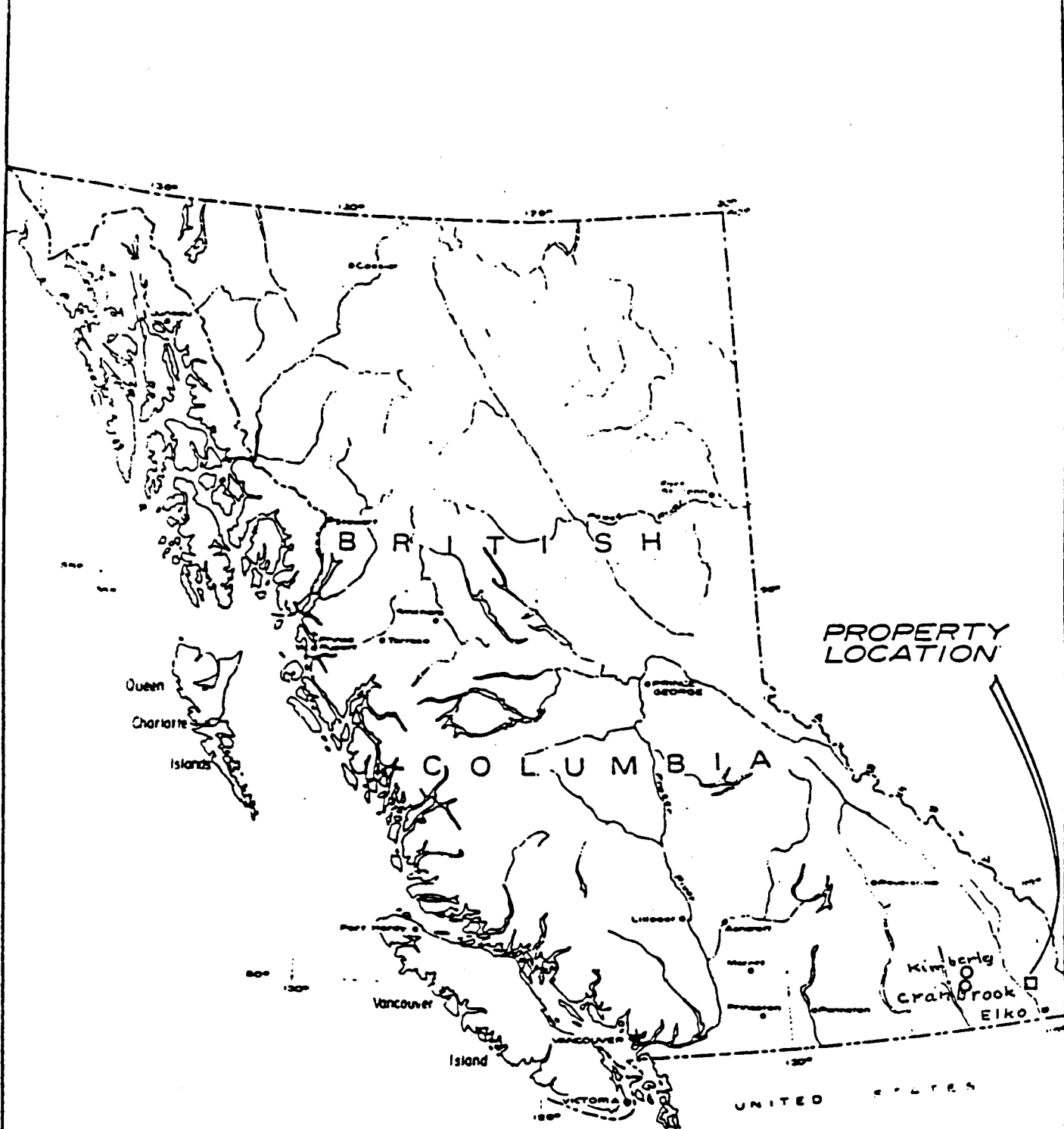

R.H. STANFIELD PROPERTY		
LOCATION MAP		
SCALE: 1" = 136 Mils.		
Drawn by	Drg no.	ALLEN GEOLOGICAL ENGINEERING LTD.
Checked by	Drg no.	

E. GEOLOGY

The property is underlain by Aldridge and Creston Precambrian formations. Aldridge strata are composed of red weathering argillite, argillaceous quartzite and siltstone. The Creston formation includes grey and green argillite and argillaceous quartzite, and white and purple quartzite.

The general strike is northwest and dips flat to 30 degrees northeast.

The portal of an adit tunnel is located 800 metres to the southeast. It is driven on a strong shear zone in which high grade silver-lead mineralization has been partially developed.

Several narrow fracture zones containing pyrite and chalcopyrite have been exposed on the Cedar 2A Group.

F. THEORY

Magnetic and electromagnetic surveys have been completed over the area of the Cedar 2A Group and anomalous zones have been detected, which warrant additional investigations including diamond drilling.

G. OBJECT OF THE DRILLING

The drilling is located in the area of anomalous geophysical determinations, mineralized fractures and shears, in order to determine the possibility of similar mineralization within the underlying Aldridge strata.

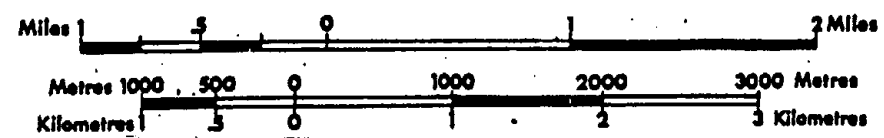
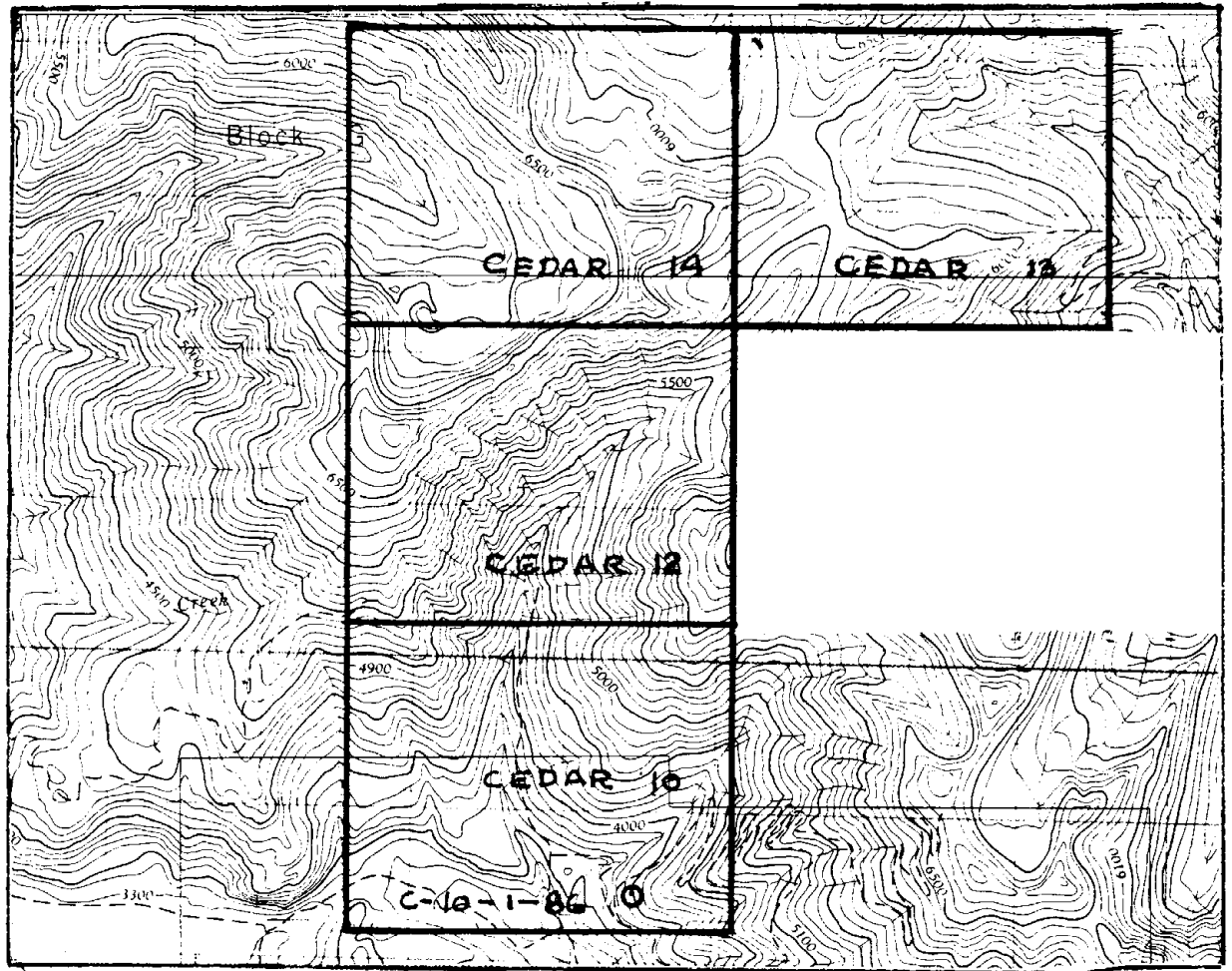

R.H. STANFIELD

CEDAR 10, 12, 13, 14

CORE HOLE C-10-1-86

TOPOGRAPHY AND CLAIMS

Aug/87

No.2 Allen Geological Eng. Ltd.

Per Alfred R. Allen P.Eng.

H. PREVIOUS WORK

Leech, G.B., G.S.C. Paper 58-10 1958
Allen, A.R., R.H. Stanfield Holdings 1973
Chiang, M.C., Placid Oil Co. Reports, Bull River 1973-76

I. DIAMOND DRILLING

Diamond drill hole C-10-1-86 is located in the southwest area of the Cedar #10 claim.

Equipment

1 Longyear #44 core drill and accessory equipment
1 Ford F250 4x4 truck

Crew

Frank Thelland, driller P.O. Box 874 Kamloops, B.C.
Liam O'Fee, helper c/o " " " "
Ross Stanfield Jr. foreman, Galloway, B.C. Box #24
Alfred R. Allen, Consulting, reports and maps
702-2025 Bellevue, West Vancouver, B.C.

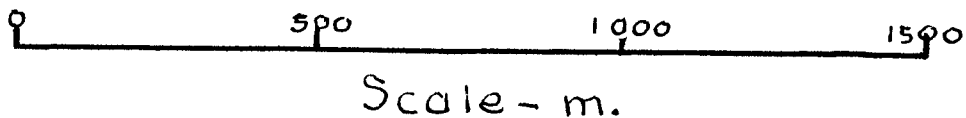
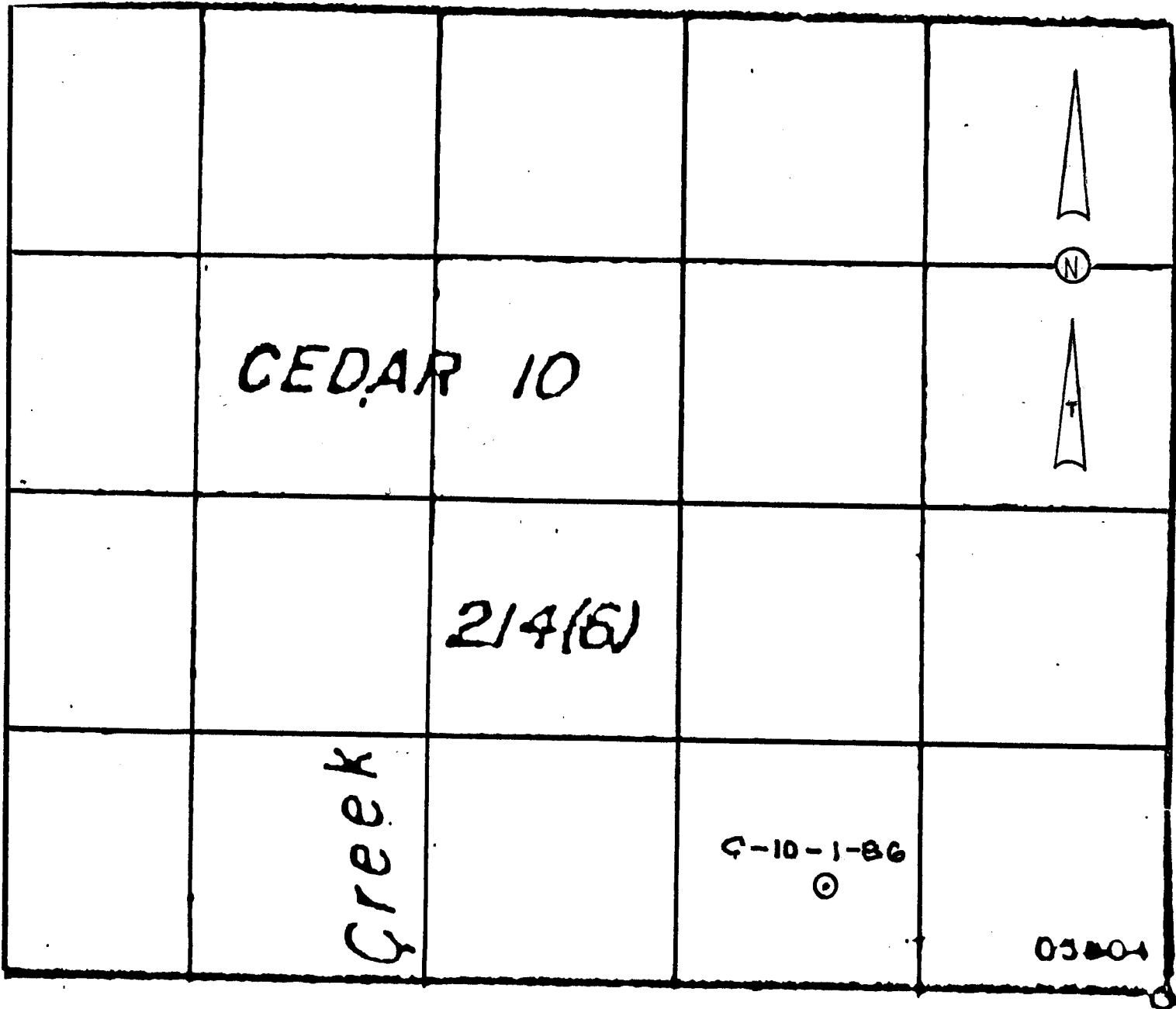

R.H. STANFIELD

CEDAR # 10 CLAIM

DRILL HOLE C-10-1-86

Aug/87

No.3 Allen Geological Eng. Ltd.

Per Alfred B. Allen P. Eng.

J. DRILLING RESULTSOwner

R.H. Stanfield

Drill: Longyear #44, N.Q.W.Start: This section, June 18, 1986Completion: September 30, 1986Location: Fort Steele M.D. Cedar #10 Claim NTS 82G/6Collar Elevation: 1218m - this section 545m down holeLog - metres

545	Grey to black thin-bedded argillite, flat, siderite veins 1cm.
545-623	Grey to black banded argillite, 86 ^o , pyrite in fractures
623-631	Black mudstone, fractured, siderite and quartz veins
631-704	Dark grey argillite, siderite and pyrite bands
704-716	Same with 15cm, quartz-siderite pyrite chalcopryrite pyrrhotite
716-724	Same with one veinlet of pyrite, chalcopryrite pyrrhotite
724-762	Same with 6cm vein pyrite, chalcopryrite and pyrrhotite
762-770	Same with 5cm quartz-siderite vein, with hole
770-841	Same quartz and siderite veinlets, flat bedding
841-909	Same 1 fracture with bedding chalcopryrite, pyrite
909-1135	Banded black argillite blebs pyrite and chalcopryrite
1135-1252	Same, some crossbedding, blebs pyrite, pyrrhotite
1252-1346	Same black argillite, siderite veinlets minor sulphides

END OF HOLE

K. DISCUSSION

Diamond drill hole c-10-1-86 penetrated uniform Aldridge formation, composed of thin banded grey and black argillite. Pyrite, pyrrhotite and minor chalcopyrite, in thin fractures, blebs and quartz-siderite veinlets are evident throughout the length of the hole.

It is evident that the 2 to 3 percent of sulphides throughout the formation was sufficient to be detected by the magnetic and electromagnetic surface surveys.

L. SUMMARY

A B.Q.W. diamond drill vertical hole from a depth of 545 metres to 1346 metres penetrated Aldridge argillite.

The thinly bedded strata is uniformly nearly flat lying. Throughout the entire length of the hole, pyrite, pyrrhotite and minor chalcopyrite occur in thin fractures, blebs and quartz-siderite veinlets.

The core was logged by the writer and it is stored in the core house at the Stanfield camp.

Submitted by:

Allen Geological Engineering Ltd.

Per Alfred R. Allen P.Eng.
Alfred R. Allen

August 1987.



FORT STEELE MINERAL CORPORATION LTD.

COSTS STATEMENT

DIAMOND DRILLING REPORT

R.H. STANFIELD

BY CONTRACT: Cedar #10 Claim, June 18/86 - Sept.30/86
Vertical hole - 801 metres

PERSONNEL

Drill Crew:	Frank Thelland, driller Liam O'Fee, helper Ross Stanfield, Foreman	
Drill:	Longyear #44	
Drilling:	801 metres @ \$163.43/metre	\$130,907.43
Meals and Accommodation:	3 men, 59 days @ \$65/day	\$ 11,505.00
Foreman:	472 hours @ \$15/hr.	\$ 7,080.00
Truck, Ford F250 4X4 :	59 days @ \$50/day	\$ 2,950.00
Alfred R. Allen, Consulting & Reporting:		\$ 1,500.00
To all inclusive:		<hr/> \$153,942.43

LILLIAN MORASH
Secretary

REFERENCES

- Schofield, S.J., G.S.C. Cranbrook Map area
Mem 76 1915
- Rice, H.M.A. G.S.C. Nelson Map Area East Half
Mem. 228 1941
- Leech, G.B., G.S.C. Fernie Map Area Paper 58-10
1958
- Leech, G.B., International Geological Congress
24th Session, Canada 1972
Field Excursion A03-C03 pp 21-26
- Allen, A.R., Altemont Exploration Co. Report 1967
- " " R.H. Stanfield Holdings Report 1973
- " " The Bull River Copper-Silver-Gold Mine
1976
- Chiang, G.B., Placid Oil Company Reports 1973-76

* * * * *

702 - 2025 Bellevue Avenue
West Vancouver, B.C.
V7V 1B9

CERTIFICATE

I, Alfred R. Allen, certify that:

I am a graduate of the University of British Columbia
and hold the following degrees therefrom:

BASc Geological Engineering 1939

MASc Geological Engineering 1941

I am a Life Member of the Association of Professional
Engineers of the Province of British Columbia.

I have practised my profession for the past forty years.

I hold no interest in the properties or securities of
R.H. Stanfield, or affiliates thereof, nor do I expect
to receive any directly or indirectly.

The report onn the diamond drilling programme of the
Cedar #10 claim is based on consulting, inspection of the
drill core, August 4,5,6, 1987, and preparation of the
report and maps.

I consent to this report being filed with the British
Columbia Securities Commission.

Alfred R. Allen P.Eng.
Alfred R. Allen

August 1987.